

INGHAM COUNTY REMONUMENTATION
LAND CORNER RECORDATION CERTIFICATE
Filing Requirement of Act 74, Mich. P.A. 1970

For Corners in
INGHAM
(county)

Located In:

Corner Code #

1. Public Land Survey
CORNER COMMON
TO SECTIONS 4 & 5
AURELIUS TOWNSHIP

T 2N R 2W

E-1

T _____ R _____

T _____ R _____

T _____ R _____

B: 13 P: 137 09/25/2007 09:14 AM
2007-041774 LAND CORNERS Receipt #32274
Paula Johnson, Ingham County, Michigan

Pages: 2



2. Property Controlling
in Section S _____ T _____ R _____
S _____ T _____ R _____

3. Miscellaneous S _____ T _____ R _____

4. Lot No _____, Recorded Plat _____

5. Private Claims _____

Register of Deeds Stamp & File Number

	A	B	C	D	E	F	G	H	I	J	K	L	M
1													
2	6			5		4			3		2		1
3													
4	7			8		9			10		11		12
5													
6	18			17		16			15		14		13
7													
8	19			20		21			22		23		24
9													
10	30			29		28			27		26		25
11													
12	31			32		33			34		35		36
13													

I, Brian Reynolds, in a field survey on August 16, 2007 do hereby certify that under requirements of P.A. 74, Michigan P.A. of 1970, the corner points mentioned in lines 1 and 2 above were in conformance with regulations and rules therefore as required in the current manual of survey instructions of the United States Department of the Interior, Bureau of Land Management or by a decree of a Court of Law and/or that the corner points mentioned in lines 3, 4, and 5 above were in conformance with the rules of the Michigan Board of Land Surveyors or by a Decree of a Court of Law; established, re-established, monumented, re-monumented, recovered, found as expressed below.

NOTE: Not more than 2 corners, in the same town and range, may be recorded on this certificate.

A. Description of original monument and accessories and/or subsequent restoration:

1825 REGARDING THE CORRESPONDING STANDARD CORNER, MAY 1825, GENERAL LAND OFFICE DEPUTY SURVEYOR JOHN MULLETT, MAY 1825, "...WEST ON S BDY 34 T3N R2W.....80.00 SET (POST) COR 33 & 34 (FROM WHICH) BE 7 N40E 28 Do 6 N72W 20 ..."
CORNER HISTORY CONTINUED ON PAGE TWO

B. Description of corner evidence found and/or method applied in restoring or reestablishing corner:

THE POWER POLE WITNESS FROM 1978 REMAINS, AS DOES THE MAPLE NORTHEAST, NOW OBSCURED BY DENSE SHRUBBERY. FOUND A CONCRETE MONUMENT IN A CONCRETE ENCLOSURE FILLED WITH CONCRETE. DUE TO EXTENSIVE EXCAVATION PERFORMED AND VERY WELL DOCUMENTED IN 1978 AS RECORDED BY SURVEYORS LESTER, DID NOT PERFORM EXTENSIVE EXCAVATION AT THIS TIME. HOWEVER, THE CONFLICTING EVIDENCE FROM 1978, THAT BEING THE DISCREPANCY BETWEEN THE REPORTED GLO FALLING AND THE MEASURED DISTANCE TO E-13, T3N R2W, HAS SINCE BEEN RESOLVED IN FAVOR OF THE POSITION OF THE SUBJECT CLOSING CORNER. E-13 AS REMONUMENTED IN 2005 AND AS RECORDED IN LIBER 12 ON PAGE 186, HOLDS THE POSITION OF THE SUBJECT CLOSING CORNER AS MONUMENTED IN 1978 FOR CONTROLLING THE LOCATION OF THE CORRESPONDING STANDARD CORNER AND CONTROLLING THE LOCATION OF THE TOWN LINE. THE LOCATION OF THE SUBJECT CORNER IS THUS CORRECT BY DEFINITION.

THE MONUMENT AND ENCLOSURE COULD NOT BE LEFT AS FOUND, AS THE CONCRETE FILLING THE ENCLOSURE INCLUDED SOME REINFORCING MESH THAT WAS LEFT EXPOSED ABOVE THE BITUMINOUS PAVEMENT. REMOVED THE MESH, AND MOST OF THE CONCRETE SURROUNDING THE MONUMENT, BUT IN THE PROCESS, DESTROYED THE ORIGINAL CONCRETE ENCLOSURE. REPLACED THE CONCRETE ENCLOSURE WITH A MODERN CAST IRON MONUMENT BOX, LEFT THE CONCRETE MONUMENT IN PLACE, CAPPED THE MONUMENT WITH A STANDARD INGHAM COUNTY REMONUMENTATION ALUMINUM CAP STAMPED "31602" AND WITNESSED AS DESCRIBED BELOW.

C. Description of monument for corner and accessories established to perpetuate locating the position of the corner:

WITNESSES TO CONCRETE MONUMENT WITH AN ALUMINUM CAP STAMPED "31602" IN MONUMENT BOX
FOUND NAIL & TAG No. 31602 IN THE SOUTHWEST SIDE OF A UTILITY POLE N05°W 44.68 FEET
FOUND "PK" NAIL IN THE SOUTHEAST SIDE OF THE SAME UTILITY POLE N05°W 44.74 FEET
FOUND NAIL & TAG No. 31602 IN THE SOUTH SIDE OF A 24" WALNUT N80°E 124.14 FEET
FOUND NAIL & TAG No. 28414 (MAURICE E. MAHIEU, P.S.) IN THE SW SIDE OF A UTILITY POLE N05°W 44.68 FEET
SET MAGNETIC NAIL & REMON TAG IN THE SOUTH SIDE OF A 12" MAPLE N68°W 97.58 FEET
N89°40'35"W 2662.10 FEET TO D-1 S89°19'17"E 2661.15 FEET TO F-1 S00°02'50"W 2747.24 FEET TO E-2
E-13 T3N R2W EAST 35.64 FEET 8± FEET WEST OF PROJECTED CENTERLINE SOUTH

P.A. 345 INGHAM COUNTY
PEER APPROVED 8/21/2007 *BR*

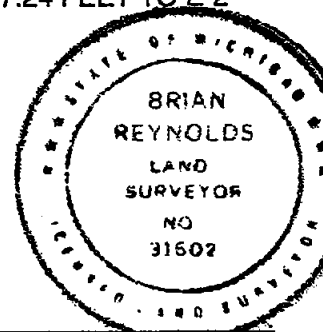

Signed by [Signature]
Surveyor's Michigan License No 31602

Date AUGUST 17, 2007

FORM APPROVED BY MICHIGAN STATE BOARD OF LAND SURVEYORS. JAN. 28, 1971

REVISED MAY 14, 1975 REVISED JANUARY, 1983 REVISED OCTOBER 1995

PAGE TWO

NOTE: Not more than 2 corners, in the same town and range, may be recorded on this certificate. T2N R2W E-1 CONTINUED

- 1826 REGARDING THE SUBJECT CLOSING CORNER, GENERAL LAND OFFICE DEPUTY SURVEYOR HERVEY PARKE, FEBRUARY, 1826 "...NORTH BTW 4 & 5..... 81.49 INT N BDY 54 (LINKS) W OF (POST) SET (POST) COR 4 & 5 (FROM WHICH) LN 22 S84E 19 BE 7 S21W 33 ..." A MARGINAL NOTE, NO NAME OR DATE, ADDS THE FOLLOWING: "...WHITE ASH 10 IN. N20°E 49 LKS NEW ..."
- 1880 T. J. BROWN, SURVEY OF SECTION 5 IN AURELIUS FOLDER CALLS FOR "...STONE W. ASH 10 N20E 49 ..."
- 1912 INGHAM COUNTY SURVEYOR RECORD BY R. J. ROBB, VOLUME 2, PAGE 79, "...BUGGY AXLE S.E. COR. SCH HOUSE N-W 111.75 FEET B. WALNUT 14" N-E 81 FEET..."
- NO CORNER INFORMATION ON THE INGHAM COUNTY ROAD COMMISSION WITNESS MAP FOR AURELIUS TOWNSHIP.
- 1978 LAND CORNER RECORDATION CERTIFICATE BY RONNIE M. LESTER, P.S. 18998, COUNTERSIGNED BY GARY D. LESTER, P.S. 17624, DATED AUGUST 31, 1978, RECORDED SEPTEMBER 5, 1978 IN LIBER 4, PAGE 333, PART A READS, "...POST SET BY MUSGROVE EVANS IN ORIGINAL GOVERNMENT SURVEY BETWEEN DEC. 24, 1826 - JAN. 8, 1827. CORNER IDENTIFIED AS STONE BY T.J. BROWN, COUNTY SURVEYOR, IN SURVEY DATED MAY 3, 1870 (V.3, P.52). CORNER IDENTIFIED AS BUGGY AXLE BY R.J. ROBB, COUNTY SURVEYOR, IN SURVEY DATED 1912 (V.2, P.79 COPY)..." PART B READS, "...EXCAVATED HOLE 20.6' X 8' TO AN AVERAGE DEPTH OF 2.7' IN CENTERLINE OF NICHOLS ROAD AND WEST OF CENTERLINE OF ONONDAGA ROAD. FOUND 1/2" BOAT SPIKE IN CENTERLINE OF NICHOLS ROAD AND 13.5'± WEST OF THE CENTERLINE OF ONONDAGA ROAD. FOUND 1" X 21" BUGGY AXLE IN UPRIGHT POSITION SURROUNDED BY 5 LARGE ROCKS, 2' BELOW SURFACE, 35'± WEST OF EXTENDED PHYSICAL CENTERLINE OF ONONDAGA ROAD TO NORTH AND ON PHYSICAL CENTERLINE OF NICHOLS ROAD. ACCEPTED BUGGY AXLE AS CORNER DESCRIBED BY R.J. ROBB IN SURVEY DATED 1912. FALLING RECORDED TO BE 35.64' IN G.L.O. MEASURED 32.64' TO 1/2" BAR E-13, DELHI TWP., T3N-R2W AS RECORDED IN L.3, P.93, (PA 74). EXCAVATION CONDUCTED BY INGHAM COUNTY SURVEY AND REMONUMENTATION PROJECT CREW..." PART C READS, "...NORTHWEST CORNER, SECTION 4, T2N-R2W SET 4" X 36" CONCRETE MONUMENT WITH 1/2" X 38" REROD WITH CAP #18998, AND CONCRETE COLLAR WITH COVER AT LOCATION OF BUGGY AXLE DESCRIBED ABOVE: NAIL & TAG, #18998, SOUTH SIDE 18" MAPLE, WNW, 152.94' FOUND P.K. NAIL, NORTHWEST SIDE 36" WALNUT, NE, 81.90' FOUND P.K. NAIL, SOUTHEAST SIDE POWER POLE, NE, 86.98' FOUND P.K. NAIL, NORTHEAST SIDE POWER POLE, SSE, 100.23' 1/2" BAR, E-13, DELHI TWP., T3N-R2W, EAST, 32.64'..."
- 1980 ACT 132 SURVEY BY WILLIAMS SURVEYING, SIGNED AND SEALED BY AUSTIN C. WILLIAMS, P.S. 21275, NO DATE, RECORDED APRIL 29, 1980 IN LIBER 3, PAGES 1275 & 1276, SUBJECT CORNER DESCRIBED THUS: "...NW CORNER SEC. 4, T2N, RW2 NAIL & TAG IN S/S 18" MAPLE WNW 152.94' PK NAIL IN NW/S 36" WALNUT NE 81.90' PK NAIL IN NE/S POWER POLE SSE 100.23' PK NAIL IN SE/S POWER POLE NE 86.98'..."

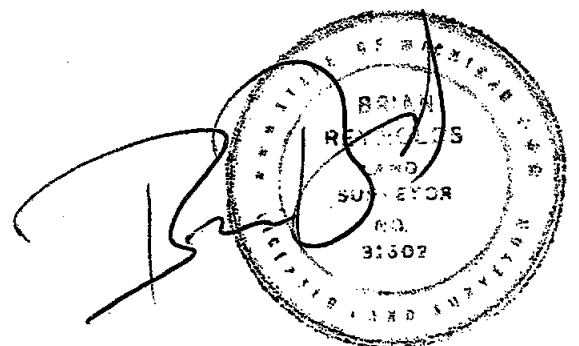

INGHAM COUNTY REMONUMENTATION
LAND CORNER RECORDATION CERTIFICATE
Filing Requirement of Act 74, Mich. P.A. 1970

For Corners in
INGHAM
(county)

Located In:

Corner Code #

1. Public Land Survey
1/4 CORNER COMMON
TO SECTIONS 4 & 5
AURELIUS TOWNSHIP

T 2N R 2W
T _____ R _____
T _____ R _____
T _____ R _____

E-2

B: 13 P: 158 10/23/2007 11:02 AM
2007-045648 LAND CORNERS Receipt #33528
Paula Johnson, Ingham County, Michigan

Pages: 2



2. Property Controlling
in Section S _____ T _____ R _____
S _____ T _____ R _____

3. Miscellaneous S _____ T _____ R _____

4. Lot No _____, Recorded Plat _____

5. Private Claims _____

Register of Deeds Stamp & File Number

I, Brian Reynolds, in a field survey on AUGUST 22, 2007 do hereby certify that under requirements of P.A. 74, Michigan P.A. of 1970, the corner points mentioned in lines 1 and 2 above were in conformance with regulations and rules therefore as required in the current manual of survey instructions of the United States Department of the Interior, Bureau of Land Management or by a decree of a Court of Law and/or that the corner points mentioned in lines 3, 4, and 5 above were in conformance with the rules of the Michigan Board of Land Surveyors or by a Decree of a Court of Law; established, re-established, monumented, re-monumented, recovered, found as expressed below.

NOTE: Not more than 2 corners, in the same town and range, may be recorded on this certificate.

A. Description of original monument and accessories and/or subsequent restoration:

1826 GENERAL LAND OFFICE DEPUTY SURVEYOR HERVEY PARKE, FEBRUARY, 1826 "...40.00 SET QR POST (FROM WHICH) BE 9 S48E 11 Do. 8 N58-1/2W 2981.49 INT N BDY 54 (LINKS) W OF (POST)"

1848 INGHAM COUNTY SURVEYOR RECORD BY A. JACKSON, VOLUME 1, PAGE 239, "...BEECH 9 S 48 E 11 D O 8 N 58-1/2 W 29...": SAME WITNESSES BY A. JACKSON IN 1854, VOLUME 1, PAGE 385.

1880 T. J. BROWN, SURVEY OF SECTION 5 IN AURELIUS FOLDER CALLS FOR "...POST OR STONE .." NO WITNESSES.

UNDATED INGHAM COUNTY ROAD COMMISSION CORNER WITNESS MAP FOR AURELIUS TOWNSHIP CALLS FOR
" ...STONE & TILE 18" MAPLE N.W. 44.6' 15" MAPLE S.W. 39.4' 18" ELM N.E. 50.0' ..."

CORNER HISTORY CONTINUED ON PAGE TWO

B. Description of corner evidence found and/or method applied in restoring or reestablishing corner:

ALL WITNESSES BY SURVEYORS PORTER AND WILLIAMS ARE NOW GONE. FOUND A RAILROAD SPIKE 0.5 FEET BELOW BITUMINOUS SURFACE ON CENTERLINE OF ONONDAGA ROAD. TRAVERSED ALL OF SECTIONS 4 & 5, MEASURED 5392.76 FEET FROM E-1 TO E-3, GOVERNMENT SURVEY RECORD DISTANCE 81.49 CHAINS = 5378.92 FEET. PROPORTIONED DISTANCE FROM E-3 WOULD BE 2647.08 FEET, MEASURED = 2645.52 FEET. EXCAVATED A 1.5 FOOT ROUND HOLE TO A DEPTH OF 2± FEET, FOUND NO ADDITIONAL EVIDENCE OF PREVIOUS MONUMENTATION. ACCEPTED RAILROAD SPIKE AS BEST AVAILABLE EVIDENCE OF CORNER POSITION, REPLACED WITH STANDARD MONUMENT AND BOX, WITNESSED AS DESCRIBED BELOW.

C. Description of monument for corner and accessories established to perpetuate locating the position of the corner:

WITNESSES TO 3/4" X 24" STEEL FORM PIN WITH AN ALUMINUM CAP STAMPED "31602" IN MONUMENT BOX FOUND NAIL & FLAGGING IN THE SOUTH SIDE OF A UTILITY POLE EAST 49.24 FEET
SET 1/2" IRON & CAP No. 31602 IN THE WEST EDGE OF THE BITUMINOUS ROADWAY N15°W 58.40 FEET
SET 1/2" IRON & CAP No. 31602 IN THE EAST EDGE OF THE BITUMINOUS ROADWAY N15°E 58.18 FEET
SET 1/2" IRON & CAP No. 31602 IN THE EAST EDGE OF THE BITUMINOUS ROADWAY S15°E 58.26 FEET
SET 1/2" IRON & CAP No. 31602 IN THE WEST EDGE OF THE BITUMINOUS ROADWAY S15°W 57.68 FEET
N00°02'50"E 2747.24 FEET TO E-1 N89°31'42"W 2662.80 FEET TO D-2
S89°52'50"E 2662.92 FEET TO F-2 S00°05'56"W 2645.52 FEET TO E-3

P.A. 345 INGHAM COUNTY
PEER APPROVED 9/25/07 M

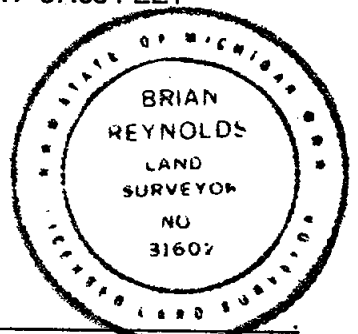

Signed by [Signature]
Surveyor's Michigan License No 31602

Date September 24, 2007

FORM APPROVED BY MICHIGAN STATE BOARD OF LAND SURVEYORS. JAN. 28, 1971

REVISED MAY 14, 1975 REVISED JANUARY, 1983 REVISED OCTOBER 1995

PAGE TWO

A. Description of original monument and accessories and/or subsequent restoration: T2N R2W E-2 CONTINUED

- 1974 ACT 132 SURVEY BY EMERY AND PORTER, INC., SIGNED AND SEALED BY JAMES A. PORTER, P.S. 19003, DATED 9-23-1974, RECORDED NOVEMBER 27, 1974 IN LIBER 2 PAGE 216, MONUMENT SHOWN, NO WITNESSES.
- 1978 LAND CORNER RECORDATION CERTIFICATE BY JAMES A. PORTER, P.S. 19003, DATED APRIL 20, 1978, RECORDED JUNE 28, 1978 IN LIBER 4, PAGE 219, PART A READS, "...ORIGINAL POST & WITNESSES DESTROYED..." PART B READS, "...INGHAM COUNTY ROAD COMMISSION RECORDS INDICATE STONE & TILE 18" MAPLE NW 44.6 FEET 15" MAPLE SW 39.4 FEET 18" ELM NE 50.0 FEET FOUND BOATSPIKE IN CENTERLINE ONONADAGA (sic) ROAD ..." PART C READS, "...LEFT BOATSPIKE IN PLACE WITH FOLLOWING WITNESSES NAIL AND TAG IN 28" MAPLE N 20° W 105.30 FEET 28" MAPLE N 30° W 74.70 FEET 28" MAPLE N 45° W 46.78 FEET POWER POLE WEST 56.48 FEET..."
- 1980 ACT 132 SURVEY BY WILLIAMS SURVEYING, SIGNED AND SEALED BY AUSTIN C. WILLIAMS, P.S. 21275, NO DATE, RECORDED APRIL 29, 1980 IN LIBER 3, PAGES 1275 & 1276, SUBJECT CORNER DESCRIBED THUS: "...WEST 1/4 CORNER SEC. 4, T2N, RW2 NAIL & TAG IN 28" MAPLE N20°W 105.30' NAIL & TAG IN 28" MAPLE N 30°W 74.70' NAIL & TAG IN 28" MAPLE N45°W 46.78' NAIL & TAG IN POWER POLE WEST 56.48'..."

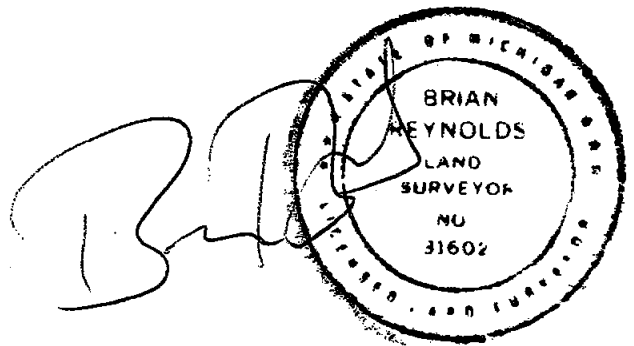

INGHAM COUNTY REMONUMENTATION
LAND CORNER RECORDATION CERTIFICATE
Filing Requirement of Act 74, Mich. P.A. 1970

For Corners in
INGHAM
(county)

Located In:

Corner Code #

1. Public Land Survey
CORNER COMMON
TO SECTIONS 4, 5, 8 & 9
AURELIUS TOWNSHIP

T 2N R 2W
T _____ R _____
T _____ R _____
T _____ R _____

E-3

B: 13 P: 138 09/25/2007 09:14 AM
2007-041775 LAND CORNERS Receipt #32274
Paula Johnson, Ingham County, Michigan

Pages: 3



2. Property Controlling S _____ T _____ R _____
in Section S _____ T _____ R _____

3. Miscellaneous S _____ T _____ R _____

4. Lot No _____, Recorded Plat _____

5. Private Claims _____

Register of Deeds Stamp & File Number

I, Brian Reynolds, in a field survey on AUGUST 17, 2007 do hereby certify that under requirements of P.A. 74, Michigan P.A. of 1970, the corner points mentioned in lines 1 and 2 above were in conformance with regulations and rules therefore as required in the current manual of survey instructions of the United States Department of the Interior, Bureau of Land Management or by a decree of a Court of Law and/or that the corner points mentioned in lines 3, 4, and 5 above were in conformance with the rules of the Michigan Board of Land Surveyors or by a Decree of a Court of Law; established, re-established, monumented, re-monumented, recovered, found as expressed below.

NOTE: Not more than 2 corners, in the same town and range, may be recorded on this certificate.

A. Description of original monument and accessories and/or subsequent restoration:

1826 GENERAL LAND OFFICE DEPUTY SURVEYOR HERVEY PARKE, FEBRUARY, 1826 "... 80.00 SET (POST) COR 4, 5, 8, & 9 (FROM WHICH) SUG 26 N26W .08-1/2 BE 9 S28-1/2E 9

1840 INGHAM COUNTY SURVEYOR RECORD BY A. JACKSON, VOLUME 1, PAGE 42, "...SUGAR 26 N 26 W 8-1/2 LKS BEECH 9 S 28-1/2 E 49 LKS..."

1848 INGHAM COUNTY SURVEYOR RECORD BY A. JACKSON, VOLUME 1, PAGE 239, "...SUGAR 26 N 26 W 8-1/2 BEECH 9 S 28-1/2 E 49..."

1854 TWO INGHAM COUNTY SURVEYOR RECORDS BY A. JACKSON, VOLUME 1, PAGE 385 & 386, "...SUGAR 26 N 26 W 8-1/2 BEECH 9 S 28-1/2 E 49..."

UNDATED INGHAM COUNTY ROAD COMMISSION CORNER WITNESS MAP FOR AURELIUS TOWNSHIP CALLS FOR "...STONE 30" ELM N.E. 46.7' 16" MAPLE N.W. 45.3' 14" MAPLE S.W. 66.2'..."

CORNER HISTORY CONTINUED ON PAGE TWO

B. Description of corner evidence found and/or method applied in restoring or reestablishing corner:
ALL OF THE WITNESSES BY POLARIS, 2004 REMAIN IN GOOD CONDITION. NEARLY ALL OF THE EARLIER POWER POLE WITNESSES ARE GONE. FOUND 1/2" IRON IN A MONUMENT BOX AT THE INTERSECTION OF CENTERLINES OF COLUMBIA ROAD AND ONONDAGA ROAD. TRAVERSED SECTIONS 4 AND 5, RESULTING MEASUREMENTS CONFORMING WELL WITH DISTANCES OF RECORD. EXCAVATED THROUGH BOX, FOUND NO ADDITIONAL EVIDENCE OF PRIOR MONUMENTATION. ACCEPTED FOUND IRON AS PROPER PERPETUATION OF CORNER POSITION. REPLACED WITH STANDARD FORM PIN MONUMENT AND ALUMINUM CAP, WITNESSED AS DESCRIBED BELOW.

C. Description of monument for corner and accessories established to perpetuate locating the position of the corner:
WITNESSES TO 3/4" X 24" STEEL FORM PIN WITH AN ALUMINUM CAP STAMPED "31602" IN A MONUMENT BOX
FOUND NAIL & TAG No. 30090 IN THE SOUTH SIDE OF A UTILITY POLE N60°W 75.42 FEET
FOUND NAIL & TAG No. 30090 IN THE SOUTHEAST SIDE OF A UTILITY POLE S56°E 66.64 FEET
FOUND NAIL & TAG No. 18998 IN THE SOUTH SIDE OF A UTILITY POLE N60°W 75.42 FEET
SET MAGNETIC NAIL & REMON TAG IN THE NORTHEAST SIDE OF A UTILITY POLE N32°W 119.10 FEET
ON CENTERLINE OF BOTH ROADS N89°22'10"W 2661.58 FEET TO D-3
N00°05'56"E 2645.52 FEET TO E-2 S89°51'47"E 2667.19 FEET TO F-3

P.A. 345 INGHAM COUNTY
PEER APPROVED 8/21/2007 PL

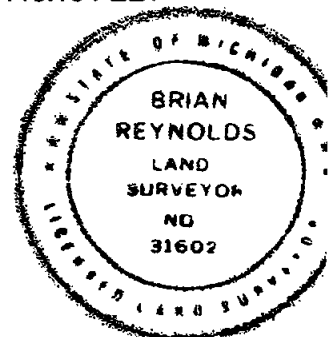

Signed by [Signature]
Surveyor's Michigan License No 31602

Date AUGUST 20, 2007

FORM APPROVED BY MICHIGAN STATE BOARD OF LAND SURVEYORS. JAN. 28, 1971

REVISED MAY 14, 1975 REVISED JANUARY, 1983 REVISED OCTOBER 1995

PAGE TWO

A. Description of original monument and accessories and/or subsequent restoration: T2N R2W E-3 CONTINUED

- 1972 ACT 132 SURVEY BY WOLVERINE ENGINEERING CO., SIGNED AND SEALED BY GEORGE M. YOUNG, P.S. 17640, DATED JUNE 19, 1972, RECORDED JUNE 20, 1972 IN LIBER 1 PAGE 290, SUBJECT CORNER DESCRIBED THUS: "...FOUND BOAT SPIKE S 1/4 COR. SEC 5, T2N-R2W..." NO WITNESSES CITED.
- 1974 ACT 132 SURVEY BY EMERY AND PORTER, INC., SIGNED AND SEALED BY JAMES A. PORTER, P.S. 19003, DATED 9-23-1974, RECORDED NOVEMBER 27, 1974 IN LIBER 2 PAGE 216, SUBJECT CORNER DESCRIBED THUS: "...SW COR. SEC. 4 T2N, R2W AURELIUS TWP. INGHAM COUNTY, MI. WITNESSES: FND. STEPHEN'S ENG. N&T 28" MAPLE 51.10' N.W. E&P N&T P.P. 63.96' NNW P.P. E&P N&T 67.10' NW P.P. N&T E&P 119.90' SE STL. F.P. 49.85' SW ..."
- 1976 LAND CORNER RECORDATION CERTIFICATE BY JAMES A PORTER, P.S. 19003, DATED JANUARY 23, 1976, RECORDED APRIL 13, 1976 IN LIBER 3, PAGE 560, PART A READS, "...ORIGINAL POST AND WITNESSES DESTROYED..." PART B READS, "...FOUND BOATSPIKE IN INTERSECTION OF ONONDAGA AND COLUMBIA ROADS WITH STEPHENS ENGINEERING TAGS IN 28" MAPLE NW 51.10 FEET..." PART C READS, "...STEEL FENCE POST SW 49.85 FEET NAIL AND TAG IN POWER POLE SE 119.90 FEET NAIL AND TAG IN POWER POLE NNW 63.96 FEET NAIL AND TAG IN POWER POLE NW 67.10 FEET..."
- 1977 ACT 132 SURVEY BY G. A. STEADMAN & SON, INC., SIGNED AND SEALED BY RICHARD W. STEADMAN, P.S. 11370, DATED JUNE 16, 1977, RECORDED JULY 6, 1977 IN LIBER 2, PAGE 1176, SUBJECT CORNER DESCRIBED THUS: "...N.E. CORNER, SEC. 8 T2N, R2W, FOUND BOATSPIKE POWER POLE S.E. 119.90' FENCE POST S.W. 49.85' POWER POLE N.N.W. 63.96' ..."
- 1977 ACT 132 SURVEY BY POLARIS SURVEYING CO., SIGNED AND SEALED BY RONNIE LESTER, P.S. 18998, DATED 9/2/77, RECORDED SEPTEMBER 29, 1977 IN LIBER 3, PAGES 59 & 60, SUBJECT CORNER DESCRIBED THUS: "...NORTHEAST CORNER SECTION 8, T2N, R2W STEEL FENCE POST, SW 49.85' NAIL AND TAG IN POWER POLE SE, 119.90' NAIL AND TAG IN POWER POLE NNE, 63.96' NAIL AND TAG IN POWER POLE NW, 67.10'..." DRAWING INDICATES N 89-15-07 W 2661.62 FEET TO D-3.
- 1978 ACT 132 SURVEY BY POLARIS SURVEYING CO., SIGNED AND SEALED BY RONNIE LESTER, P.S. 18998, DATED 1/30/78, RECORDED MARCH 30, 1978 IN LIBER 3, PAGES 329 & 330, SUBJECT CORNER DESCRIBED THUS: "...NORTHEAST CORNER SECTION 8, T2N, R2W STEEL FENCE POST, SW 49.85' NAIL & TAG IN POWER POLE SE, 119.90' NAIL AND TAG IN POWER POLE NNE, 63.96' NAIL AND TAG IN POWER POLE NW, 67.10'..." DRAWING INDICATES N 89°15'07" W 2661.62 FEET TO D-3.
- 1980 ACT 132 SURVEY BY WOLVERINE ENGINEERS & SURVEYORS, INC., SIGNED AND SEALED BY GEORGE M. YOUNG, P.S. 17640, DATED JULY 23, 1980, RECORDED APRIL 25, 1980 IN LIBER 4, PAGE 105, SUBJECT CORNER DESCRIBED THUS: "...N.W. CORNER, SEC. 9 T2N-R2W, AURELIUS TWP, INGHAM CO., MI N. & TAG IN POWER POLE S.E. 119.90' N. & TAG IN POWER POLE N.W. 67.10' N. & TAG IN POWER POLE N.N.W. 63.96' STEEL FENCE POST S.W. 49.85' RECORDED L-3 PG-560 ..."
- 1986 ACT 132 SURVEY BY R. W. STEADMAN & ASSOCIATES, INC., SIGNED AND SEALED BY RICHARD W. STEADMAN, P.S. 11370, DATED APRIL 18, 1986, RECORDED MAY 22, 1986 IN LIBER 4, PAGE 1231, SUBJECT CORNER DESCRIBED THUS: "...N.W. COR. SEC. 9 T2N, R2W, FOUND BOAT SPIKE STEEL FENCE POST SW 49.85 FEET POWER POLE SE 119.90 FEET POWER POLE NNW 63.96 FEET POWER POLE NE 67.10 FEET ..."
- 1993 ACT 132 SURVEY BY POLARIS SURVEYING CO., SIGNED AND SEALED BY RONNIE LESTER, P.S. 18998, DATED APRIL 6, 1993, RECORDED MAY 3, 1993 IN LIBER 6, PAGES 1217 - 1219, SUBJECT CORNER DESCRIBED THUS: "...WITNESSES TO GOVERNMENT CORNERS: NORTHEAST CORNER SECTION 8, T2N, R2W. 1/2" BAR IN MONUMENT BOX. LIBER 3, PAGE 560. SET NAIL AND TAG IN EAST SIDE 15" WALNUT, 202°AZ., 118.2' SET NAIL AND TAG IN SOUTH SIDE 30" MAPLE, 287°AZ., 156.7' SET NAIL AND TAG IN SOUTH SIDE NEW U. POLE 308°AZ., 75.4' SET NAIL AND TAG IN SOUTH SIDE NEW U. POLE, 62°AZ., 66.7' ..." DRAWING INDICATES N 89°15'07" W 2661.62 FEET TO D-3.
- 1996 SEVERAL ACT 132 SURVEY BY POLARIS SURVEYING CO., SIGNED AND SEALED BY RONNIE LESTER, P.S. 18998, DATED 7/9/96, 11/25/96 AND 4/21/97, RECORDED 8/07/1996, IN LIBER 7, PAGES 853 & 854, 02/27/1997 IN LIBER 7, PAGES 1006 & 1007, AND 05/13/1997 IN LIBER 7, PAGES 1115 AND 1116, SUBJECT CORNER DESCRIBED THE SAME AS IN 1993 SURVEY ABOVE. DRAWING INDICATES 2667.19 FEET TO F-3.
- 1997 ACT 132 SURVEY BY BEERY & ASSOCIATES, INC, SIGNED AND SEALED BY DAVID R. LOHR, P.S. # 30090, DATED SEPTEMBER 8, 1997, RECORDED 09/17/1997 IN LIBER 7, PAGES 1280 & 1281, SUBJECT CORNER DESCRIBED THUS: "...WITNESSES TO SECTION CORNERS: SECTION 4, T2N, R2W, AURELIUS TOWNSHIP. SOUTHWEST CORNER: E-3 FD. 1/2" IRON IN MON. BOX. C/L-C/L COLUMBIA AND ONONDAGA RDS. FD. N&T #18998, S/S P. POLE, N57E, 66.63' FD. N&T #18998, E/S 18" WALNUT, S10W, 118.16' SET N&T #30090, SE/S P. POLE, S58W, 61.14' SET N&T #30090, S/S P. POLE, N58W, 75.44'..."

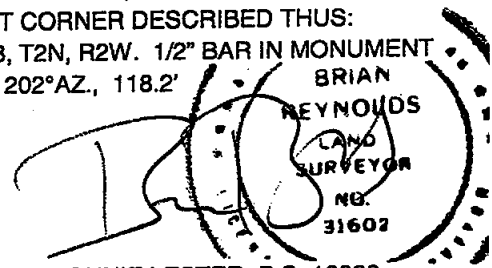

CORNER HISTORY CONTINUED ON PAGE THREE

PAGE THREE

A. Description of original monument and accessories and/or subsequent restoration: T2N R2W E-3 CONTINUED

- 1998 SEVERAL ACT 132 SURVEYS BY POLARIS SURVEYING CO., SIGNED AND SEALED BY RONNIE M. LESTER, P.S. 18998, DATED 6/29/98 AND 8/28/98, RECORDED 08/17/1998 IN LIBER 8 PAGES 298-299 AND PAGES 300-301, AND 09/28/1998 IN LIBER 8, PAGES 307 & 308 SUBJECT CORNER DESCRIBED AS WITNESSED ABOVE IN 1993 SURVEY BY POLARIS. DRAWING INDICATES N 89°15'07" W 2661.72 FEET TO D-3.
- 2000 ACT 132 SURVEY BY POLARIS SURVEYING CO., PAGE 2 MISSING, NO SIGNATURE OR SEAL, INITIALS RL (RONNIE M. LESTER, P.S. 18998, DATED MAR 2000, RECORDED 04/18/2000 IN LIBER 8, PAGE 701, SUBJECT CORNER DESCRIBED THUS: "...NORTHEAST CORNER SECTION 8 T2N, R2W 1/2" BAR IN MONUMENT BOX. LIBER 3, PAGE 560..." NO WITNESSES. DRAWING INDICATES N 89°15'07" W 2661.72 FEET TO D-3.
- 2002 ACT 132 SURVEY BY POLARIS SURVEYING CO., SIGNED AND SEALED BY RONNIE LESTER, P.S. 18998, DATED APRIL 18, 2002, RECORDED 05/13/2002 IN LIBER 8, PAGE 986, SUBJECT CORNER DESCRIBED THUS: "...NORTHEAST CORNER SECTION 8, T2N, R2W. 1/2" BAR IN MONUMENT BOX. LIBER 3, PAGE 560.
FOUND NAIL AND TAG #18998 EAST SIDE 15" WALNUT, 202°AZ., 118.2'
FOUND NAIL AND TAG #18998 SOUTH SIDE 30" MAPLE, 287°AZ., 156.7'
FOUND NAIL AND TAG #18998 SOUTH SIDE NEW U. POLE, 308°AZ., 75.4'
FOUND NAIL AND TAG #18998 SOUTH SIDE NEW U. POLE, 62°AZ., 66.7' ..."
DRAWING INDICATES N 89°15'07" W 2661.72 FEET TO D-3.
- 2004 ACT 132 SURVEY BY POLARIS SURVEYING CO., SIGNED AND SEALED BY RONNIE LESTER, P.S. 18998, DATED 1/06/04, RECORDED 03/04/2004 IN LIBER 9, PAGE 33, SUBJECT CORNER DESCRIBED THUS: "...NORTHEAST CORNER SECTION 8, T2N, R2W. 1/2" BAR IN MONUMENT BOX. LIBER 3, PAGE 560.
FOUND NAIL AND TAG #18998 EAST SIDE 15" WALNUT, 202°AZ., 118.2'
FOUND NAIL AND TAG #18998 SOUTH SIDE 30" MAPLE, 287°AZ., 156.7'
FOUND NAIL AND TAG #18998 SOUTH SIDE NEW U. POLE, 308°AZ., 75.4'
FOUND NAIL AND TAG #18998 SOUTH SIDE NEW U. POLE, 62°AZ., 66.7' ..."
DRAWING INDICATES N 89°15'07" W 2661.72 FEET TO D-3.

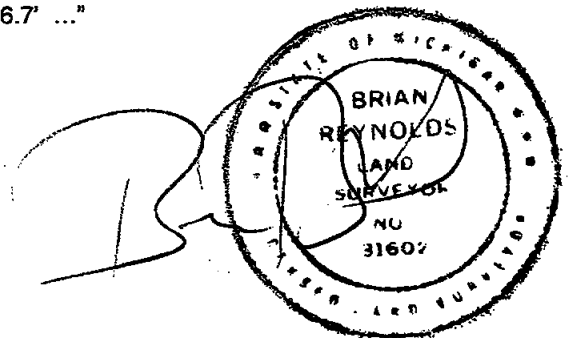

P.A. 345 INGHAM COUNTY
PEER APPROVED 8/21/2007 RL

INGHAM COUNTY REMONUMENTATION

LAND CORNER RECORDATION CERTIFICATE

Filing Requirement of Act 74, Mich. P.A. 1970

For Corners in
INGHAM
(county)

Located In:

Corner Code #

1. Public Land Survey
NORTH 1/4 CORNER
SECTION 4
AURELIUS TOWNSHIP

T 2N R 2W
T R
T R
T R

F-1

B: 13 P: 139 09/25/2007 09:14 AM
2007-041776 LAND CORNERS Receipt #32274
Paula Johnson, Ingham County, Michigan

Pages: 2



2. Property Controlling S T R
in Section S T R

3. Miscellaneous S T R

4. Lot No _____, Recorded Plat _____

5. Private Claims _____

Register of Deeds Stamp & File Number

I, Brian Reynolds, in a field survey on AUGUST 16, 2007 do hereby certify that under requirements of P.A. 74, Michigan P.A. of 1970, the corner points mentioned in lines 1 and 2 above were in conformance with regulations and rules therefore as required in the current manual of survey instructions of the United States Department of the Interior, Bureau of Land Management or by a decree of a Court of Law and/or that the corner points mentioned in lines 3, 4, and 5 above were in conformance with the rules of the Michigan Board of Land Surveyors or by a Decree of a Court of Law; established, re-established, monumented, re-monumented, recovered, found as expressed below.

NOTE: Not more than 2 corners, in the same town and range, may be recorded on this certificate.

A. Description of original monument and accessories and/or subsequent restoration:

CLOSING QUARTER CORNER NOT MONUMENTED BY THE GENERAL LAND OFFICE SURVEY

1825 REGARDING THE CORRESPONDING STANDARD CORNER, GENERAL LAND OFFICE DEPUTY SURVEYOR JOHN MULLETT, MAY 1825, "...WEST ON S BDY 33 T3N R2W.....40.00 SET QR. (POST) (FROM WHICH) BE 5 N75-1/2W 24 Do 8 N72E 37 ..."

1840 INGHAM COUNTY SURVEYOR RECORD BY A. JACKSON, VOLUME 1, PAGE 43, "...BEECH 16 IN S 64 E 47 LKS BEECH 12 IN S 46-1/2 W 24-1/2 LKS..."

NO CORNER INFORMATION ON THE INGHAM COUNTY ROAD COMMISSION WITNESS MAP FOR AURELIUS TOWNSHIP. CORNER HISTORY CONTINUED ON PAGE 2

B. Description of corner evidence found and/or method applied in restoring or reestablishing corner:
FOUND A CONCRETE MONUMENT IN A MONUMENT BOX FILLED WITH BITUMINOUS. THREE OF SURVEYOR LESTER'S WITNESSES REMAIN, THE TREES (BOTH ARE WALNUTS) AND THE STANDARD CORNER. OTHERS ARE GONE. DID NOT EXCAVATE DUE TO WELL-DOCUMENTED EXTENSIVE EXCAVATION IN 1978. TRAVERSED ALL OF SECTION 4, TYING IN FOUND MONUMENTATION AROUND THE EXTERIOR OF THE SECTION, AND TYING IN THE CORRESPONDING STANDARD CORNERS. RESULTING MEASUREMENTS REVEAL THAT THE SUBJECT CLOSING CORNER MONUMENT IS 0.87 FEET SOUTH OF TOWN LINE AS DEFINED BY THE CONTROLLING STANDARD CORNERS. ACCEPTED MONUMENT AS PROPER PERPETUATION OF CORNER POSITION, LEFT MONUMENT IN POSITION AS FOUND, CAPPED WITH A STANDARD INGHAM COUNTY ALUMINUM REMONUMENTATION CAP, WITNESSED AS DESCRIBED BELOW.

C. Description of monument for corner and accessories established to perpetuate locating the position of the corner:
WITNESSES TO CONCRETE MONUMENT WITH AN ALUMINUM CAP STAMPED "31602" IN MONUMENT BOX
FOUND A "PK" NAIL IN THE SOUTH SIDE OF A WOODEN POST N56°E 49.52 FEET
FOUND A NAIL & TAG No. 18998 IN THE SOUTHWEST SIDE OF A UTILITY POLE S80°E 50.98 FEET
SET MAGNETIC NAIL & REMON TAG IN THE SOUTHEAST SIDE OF A NEWER UTILITY POLE N45°E 42.14 FEET
SET MAGNETIC NAIL & REMON TAG IN THE WEST SIDE OF A 6" APPLE N18°E 29.44 FEET
F-13 EAST 26.36 FEET N89°19'17"W 2661.15 FEET TO E-1
S00°00'23"W 2721.28 FEET TO F-2 S89°19'18"E 2659.92 FEET TO G-1
IN LINE WITH ROW OF MATURE CONIFERS SOUTH

P.A. 345 INGHAM COUNTY
PEER APPROVED 0/21/2007 M

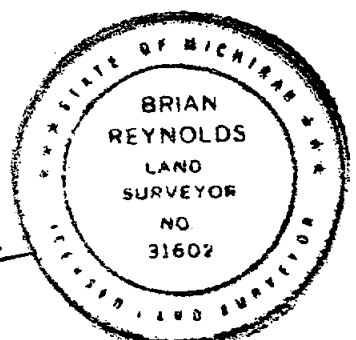

Signed by [Signature]
Surveyor's Michigan License No 31602

Date AUGUST 17, 2007

FORM APPROVED BY MICHIGAN STATE BOARD OF LAND SURVEYORS. JAN. 28, 1971
REVISED MAY 14, 1975 REVISED JANUARY, 1983 REVISED OCTOBER 1995

PAGE TWO

A. Description of original monument and accessories and/or subsequent restoration: **T2N R2W F-1 CONTINUED**

- 1978 LAND CORNER RECORDATION CERTIFICATE BY RONNIE M. LESTER, P.S. 18998, COUNTERSIGNED BY GARY D. LESTER, P.S. 17624, DATED SEPTEMBER 17, 1978, RECORDED SEPTEMBER 19, 1978 IN LIBER 4, PAGE 376, PART A READS, "...NO RECORD OF CORNER BEING ESTABLISHED IN ORIGINAL GOVERNMENT SURVEY. CORNER ESTABLISHED IN A SURVEY BY A. JACKSON, COUNTY SURVEYOR, DATED MAY, 1840. (V.1, P.42)..." PART B READS, "...EXCAVATED HOLE 10.2' X 7.8' TO AN AVERAGE DEPTH OF 3.6' SOUTH OF AND INCLUDING CENTERLINE OF NICHOLS ROAD AND ON EXTENDED POLE LINE TO THE SOUTH. FOUND 1" X 2.5' GAS PIPE JUST BELOW ASPHALT SURFACE, LOCATED $\pm 2.0'$ SOUTH OF CENTERLINE NICHOLS ROAD AND ON EXTENDED POLE LINE TO THE SOUTH. FURTHER EXCAVATION REVEALED VARIOUS STONES AROUND AND BENEATH THE GAS PIPE. ACCEPTED GAS PIPE AS CORNER AS IT IS SIMILAR TO OTHER MONUMENTATION FOUND IN THE AREA AND IT IS IN ACCORD WITH ADJACENT OCCUPATION. MEASURED EAST $\pm 26.45'$ TO GAS PIPE AT APPARENT LOCATION OF F-13. DELHI TWP., T3N-R2W. EXCAVATION CONDUCTED BY INGHAM COUNTY SURVEY AND REMONUMENTATION PROJECT CREW..." PART C READS, "...N 1/4 CORNER, SECTION 4, T2N-R2W SET 4" X 36" CONCRETE MONUMENT WITH 1/2" X 38" REROD WITH CAP #18998, AND CONCRETE COLLAR WITH COVER IN LOCATION OF GAS PIPE DESCRIBED ABOVE:
NAIL & TAG, #18998, SOUTH SIDE 30" WALNUT, WEST, 636.66'
NAIL & TAG, #18998, EAST SIDE FENCE CORNER POST, NE, 36.61'
NAIL & TAG, #18998, SOUTH SIDE 32" OAK, EAST, 584.77'
NAIL & TAG, #18998, WEST SIDE TELEPHONE POLE, SOUTH, 28.30'
2" GAS PIPE (F-13, T3N-R2W), UNRECORDED CORNER, EAST, 26.45'..."
- 2002 ACT 132 SURVEY BY WOLVERINE ENGINEERS & SURVEYORS, INC., SIGNED AND SEALED BY MAURICE H. MAHIEU, P.S. 28414, DATED 6-25-02, RECORDED 8/05/2002 IN LIBER 8, PAGE 1035, SUBJECT CORNER DESCRIBED THUS:
"...NORTH 1/4 COR. SEC. 4 T2N, R2W, AURELIUS TWP. 1/2" REROD W/CAP #18998 WITNESSES:
N&T #18998 S. SIDE 30" WALNUT, W. 636.66' N&T #18998 E. SIDE FENCE COR. POST, NE, 36.61'
N&T #18998 S. SIDE 32" OAK, E. 584.77' N&T #18998 W. SIDE TELEPHONE POLE, S. 28.30'
2" GAS PIPE (F-13, T3N-R2W), UNRECORDED CORNER, E. 26.45' ..."

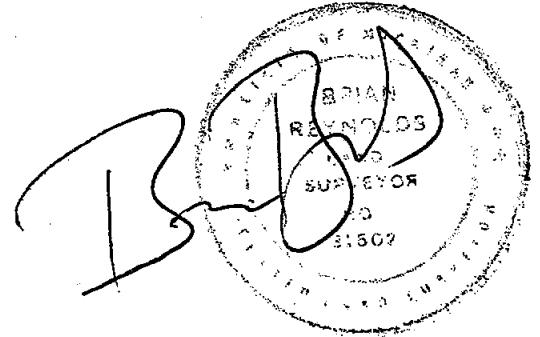

Filing Requirement of Act 74, Mich. P.A. 1970

REvised MAY 14, 1975 REvised JANUARY, 1983 REvised OCTOBER 1995

INGHAM COUNTY REMONUMENTATION

LAND CORNER RECORDATION CERTIFICATE

Filing Requirement of Act 74, Mich. P.A. 1970

For Corners in
INGHAM
(county)

Located In:

Corner Code #

1. Public Land Survey
**1/4 CORNER COMMON
TO SECTIONS 4 & 9
AURELIUS TOWNSHIP**

T 2N R2W
T____ R____
T____ R____
T____ R____

F-3

B: 13 P: 140 09/25/2007 09:14 AM
2007-041777 LAND CORNERS Receipt #32274
Paula Johnson, Ingham County, Michigan

Pages: 2



2. Property Controlling
in Section S____ T____ R____
S____ T____ R____

3. Miscellaneous S____ T____ R____

4. Lot No_____, Recorded Plat_____

5. Private Claims_____

Register of Deeds Stamp & File Number

I, Brian Reynolds, in a field survey on AUGUST 17, 2007 do hereby certify that under requirements of P.A. 74, Michigan P.A. of 1970, the corner points mentioned in lines 1 and 2 above were in conformance with regulations and rules therefore as required in the current manual of survey instructions of the United States Department of the Interior, Bureau of Land Management or by a decree of a Court of Law and/or that the corner points mentioned in lines 3, 4, and 5 above were in conformance with the rules of the Michigan Board of Land Surveyors or by a Decree of a Court of Law; established, re-established, monumented, re-monumented, recovered, found as expressed below.

NOTE: Not more than 2 corners, in the same town and range, may be recorded on this certificate.

A. Description of original monument and accessories and/or subsequent restoration:

1826 GENERAL LAND OFFICE DEPUTY SURVEYOR HERVEY PARKE, FEBRUARY, 1826. "...WEST CORRECTED 40.28-1/2 SET QR. POST AV. DIST ON TRUE LINE (FROM WHICH) BE 12 N85E 31-1/2 W. ASH (NO DIAM) S57W 39 ..."

1840 INGHAM COUNTY SURVEYOR RECORD BY A. JACKSON, VOLUME 1, PAGE 42, "...BEECH 12 IN N 85 E 31-1/2 LKS W ASH 16 S 87 W 39 LKS..."; SAME WITNESSES BY A. JACKSON, DATED 1852, IN VOLUME 1, PAGE 268.

1845 INGHAM COUNTY SURVEYOR RECORD BY A. JACKSON, VOLUME 1, PAGE 166, "...BEECH 12 IN N 85 E 31-1/2 LKS W ASH 18 S 89 W 39 LKS..."

UNDATED INGHAM COUNTY ROAD COMMISSION CORNER WITNESS MAP FOR AURELIUS TOWNSHIP CALLS FOR "...STONE & BRICK 14" OAK N.N.W. 58.2' ANCH. POST S. 25.5' ANCH. POST N. 28.2'..."

CORNER HISTORY CONTINUED ON PAGE TWO

B. Description of corner evidence found and/or method applied in restoring or reestablishing corner:

FOUND 3/4" X 36" PIPE IN A MONUMENT BOX ON THE CENTERLINE OF COLUMBIA ROAD. TWO OF SURVEYOR LOHR'S 1997 WITNESSES ARE STILL INTACT, THE OAK NORTHWEST, AND THE TELEPHONE RISER. ALL OF SURVEYOR PORTER'S 1978 WITNESSES ARE GONE. EXCAVATED THROUGH MONUMENT BOX, FOUND NO OTHER EVIDENCE OF PRIOR MONUMENTATION. ACCEPTED PIPE AS PROPER PERPETUATION OF CORNER POSITION, REPLACED WITH STANDARD FORM PIN MONUMENT AND ALUMINUM CAP, WITNESSED AS DESCRIBED BELOW.

C. Description of monument for corner and accessories established to perpetuate locating the position of the corner:

WITNESSES TO 3/4" X 24" STEEL FORM PIN WITH AN ALUMINUM CAP STAMPED "31602" IN MONUMENT BOX FOUND "PK" NAIL IN THE SOUTHEAST SIDE OF A UTILITY POLE S07°W 33.46 FEET
SET MAGNETIC NAIL & REMON TAG IN THE SOUTH SIDE OF A 60" OAK N65°W 61.08 FEET
SET MAGNETIC NAIL & REMON TAG IN THE NORTHEAST SIDE OF A 12" MAPLE N75°W 111.20 FEET
SET MAGNETIC NAIL & REMON TAG IN THE NORTHEAST SIDE OF A 12" MAPLE N38°W 97.42 FEET
ON THE CENTERLINE OF COLUMBIA ROAD. NO OCCUPATION LINES NORTH OR SOUTH
N89°51'47"W 2667.19 FEET TO E-3 N00°00'23"E 2646.34 FEET TO F-2 N89°56'36"W 2667.04 FEET TO G-3

P.A. 345 INGHAM COUNTY
PEER APPROVED 8/21/2007 *M*

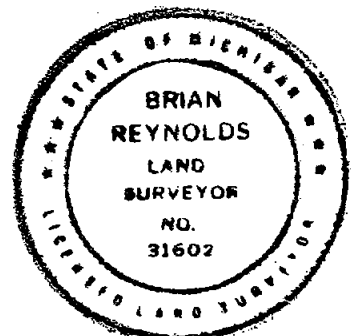

Signed by *[Signature]*
Surveyor's Michigan License No 31602

Date AUGUST 20, 2007

FORM APPROVED BY MICHIGAN STATE BOARD OF LAND SURVEYORS. JAN. 28, 1971

REVISED MAY 14, 1975 REVISED JANUARY, 1983 REVISED OCTOBER 1995

PAGE TWO

A. Description of original monument and accessories and/or subsequent restoration: T2N R2W F-3 CONTINUED

- 1974 ACT 132 SURVEY BY EMERY AND PORTER, INC., SIGNED AND SEALED BY JAMES A. PORTER, P.S. 19003, DATED SEPTEMBER 23, 1974, RECORDED NOVEMBER 27, 1974 IN LIBER 2, PAGE 216, SUBJECT CORNER DESCRIBED THUS: "...S 1/4 COR. SEC. 4..." NO WITNESSES DESCRIBED.
- 1978 LAND CORNER RECORDATION CERTIFICATE BY JAMES A. PORTER, P.S. 19003, DATED APRIL 20, 1978, RECORDED JUNE 28, 1978 IN LIBER 4, PAGE 219, PART A READS, "...ORIGINAL POST & WITNESSES DESTROYED..." PART B READS, "...INGHAM COUNTY ROAD COMMISSION RECORDS INDICATE STONE AND BRICK 14" OAK NNW 58.2 FEET ANCHOR POST SOUTH 25.5 FEET ANCHOR POST NORTH 28.2 FEET FOUND 3/4" IRON PIPE IN CENTERLINE COLUMBIA ROAD..." PART C READS, "... LEFT PIPE IN PLACE WITH THE FOLLOWING WITNESSES NAIL AND TAG IN 50" MAPLE N 60° W 60.28 FEET 2ND FENCE POST EAST OF POWER POLE S 45° E 39.00 FEET STEPHENS ENG. NAIL AND TAG IN TELEPHONE POLE NORTH 31.00 FEET STEPHENS ENG. NAIL AND TAG IN TELEPHONE POLE SOUTH 80.92 FEET..."
- 1980 ACT 132 SURVEY BY WILLIAMS SURVEYING, SIGNED AND SEALED BY AUSTIN C. WILLIAMS, P.S. 21275, DATED MARCH, 1980, RECORDED MARCH 24, 1980 IN LIBER 3, PAGES 1229 & 1230, SUBJECT CORNER DESCRIBED THUS: "...SOUTH 1/4 CORNER SEC. 4 T2N, R2W NAIL & TAG 50" MAPLE N60°W 60.28' 2ND FENCE POST EAST OF POWER POLE S45°E 39.0' STEPHENS ENG NAIL & TAG IN TEL. POLE NORTH 31.00' STEPHENS ENG. NAIL & TAG IN TEL. POLE SOUTH 80.92'..."
- 1986 ACT 132 SURVEY BY R. W. STEADMAN & ASSOCIATES, INC., SIGNED AND SEALED BY RICHARD W. STEADMAN, P.S. 11370, DATED APRIL 18, 1986, RECORDED MAY, 1986 IN LIBER 4, PAGE 1231, SUBJECT CORNER DESCRIBED THUS: "...N. 1/4 COR. SEC. 9, T2N, R2W FOUND 3/4" IRON PIPE 50" OAK N60°W 60.28 FEET TELEPHONE POLE SOUTH 80.92 FEET TELEPHONE POLE NORTH 31.00 FEET..."
- 1997 ACT 132 SURVEY BY BEERY & ASSOCIATES, INC, SIGNED AND SEALED BY DAVID R. LOHR, P.S. # 30090, DATED SEPTEMBER 8, 1997, RECORDED 09/17/1997 IN LIBER 7, PAGES 1280 & 1281, SUBJECT CORNER DESCRIBED THUS: "...WITNESSES TO SECTION CORNERS: SECTION 4, T2N, R2W, AURELIUS TOWNSHIP. SOUTH 1/4 CORNER: F-3 FD. 3/4" IRON BAR IN MON. BOX. C/L COLUMBIA RD. SET N&T #30090, TOP FENCE POST, S11W, 26.90' SET N&T #30090, TOP FENCE POST, S35W, 32.35' SET N&T #30090, S/S 60° OAK, N66W, 61.40' TOP C/L MBTC BOX, N09W, 30.35'..." DRAWING INDICATES 2667.19 FEET TO E-3.
- 1999 ACT 132 SURVEY BY ENGER SURVEYING AND ENGINEERING, SIGNED AND SEALED BY RONALD L. ENGER, P.S. No. 28409, , DATED SEPTEMBER 22, 1999, RECORDED 05/09/2001, IN LIBER 8, PAGE 856, SUBJECT CORNER DESCRIBED THUS: "...NORTH 1/4 CORNER SECTION 9, RECORDED LIBER 4 PAGE 219, 3/4" PIPE IN MONUMENT BOX NAIL & TAG IN 50" MAPLE N60°W 60.28' SECOND FENCE POST EAST OF POWER POLE S45°E 39.00' STEPHENS NAIL & TAG IN TELEPHONE POLE NORTH 31.00' STEPHENS NAIL & TAG IN TELEPHONE POLE SOUTH 80.92'

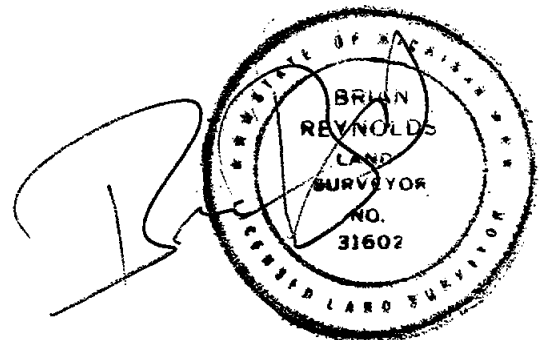

SUB &
REMONUMENTATION

DEC 1 1996

COMMISSION

LAND CORNER RECORDATION CERTIFICATE
Filing Requirement of Act 74, Mich. P.A. 1970

Liber 9 Page 103

For corners in

INGHAM COUNTY
Aurelius Township

Located In:

Corner Code #

- | | | |
|------------------------------------|-----------|-----|
| 1. Public Land Survey | T 2N R 2W | G-1 |
| | T R | |
| | T R | |
| | T R | |
| 2. Property Controlling in Section | S T R | |
| | S T R | |
| 3. Miscellaneous | S T R | |
| Property in Sec. | S T R | |

FILED

960045752
12/02/1996 09:31:40
REGISTER OF DEEDS
Paula Johnson
INGHAM COUNTY, MI

Register of Deeds Stamp & File Number

4. Lot No. _____, Recorded Plat _____
5. Private Claims _____

I, Richard W. Steadman, in a field survey on September 4, 1996, do hereby state that under requirements of P.A. 74, Michigan P.A. of 1970, the corner points mentioned in lines 1 and 2 above were in conformance with regulations and rules therefore as required in the current manual of survey instructions of the United States Department of the Interior, Bureau of Land Management or by a decree of a Court of Law and for that the corner points mentioned in lines 3, 4 and 5 above were in conformance with the rules of the Michigan Board of Land Surveyors or by a Decree of a Court of Law; established, re-established, monumented, recovered, found as expressed below:

NOTE: Not more than 2 corners, all in the same town and range, may be recorded on this certificate.

A. Description of original monument and accessories and/or subsequent restoration:

- 1). 1826: U. S. Public Land Survey Field Notes, Deputy Surveyor Harvey Parke "at 80.63 chains intersect N. Bdry. 30 links (19.80 feet) W. of post, set post, corner to Secs. 3 and 4 from which bears 8" Beech S84°E 47 links and 8" W. Ash S22°W 10-1/2 links."

- 2). 05-10-1840: Record of Surveys, Vol. 1, Page 42, County Surveyor Anson Jackson used this corner and notes the U. S. witnesses.

- 3). 01-12-1844: Record of Surveys, Vol. 1, Page 99, County Surveyor Anson Jackson again used this corner and again notes the U. S. witnesses.

(Continued on back)

B. Description of corner evidence found and/or method applied in restoring or reestablishing corner:

About 1 foot deep in monument box, found large stone. Raised location of stone with an 8" long piece of standard Ingham County Remonumentation rod and cap and packed asphalt around it for stability. Measured 2656.83 feet to H-1 and 2696.24 feet to G-2.

C. Description of monument for corner and accessories established to perpetuate locating the position of the corner:

Set 3/4" smooth iron rod and cap stamped "P. A. 345 PS 11370" in monument box over stone and took the following witnesses (bearings are magnetic):

Found nail and tag (illegible) in S. side 24" Oak N58°W 68.36 feet:

Found nail and tag 25832 in E. side 30" Cherry S16°W 126.24 feet:

NE Corner of House Foundation S51°W 114.32 feet

SW Corner of House Foundation N62°E 67.35 feet

Set 3/4" iron rod and cap stamped "P. A. 345 PS 11370, 0.3 feet north of stone in monument box S85°E 19.71 feet (G-13, T3N, R2W)



Signed by Richard W. Steadman

Date November 2, 1996

Surveyor's Michigan License No. 11370

FORM APPROVED BY MICHIGAN STATE BOARD OF PROFESSIONAL SURVEYORS, JAN. 28, 1971

REVISED MAY 14, 1978

REVISED JAN. 1983

REVISED OCT. 1986

P.A. 345 INGHAM COUNTY

PEER-APPROVED: 11/14/96 M

Part A - Continued

- 1951 1952 1953

DEC 16 1996

COMMISSION

LAND CORNER RECORDATION CERTIFICATE
Filing Requirement of Act 74, Mich. P.A. 1970

Liber 9 Page 105

For corners in

INGHAM COUNTY
Aurelius Township

Located In:

Corner Code #

- | | | |
|------------------------------------|-----------|-----|
| 1. Public Land Survey | T 2N R 2W | G-2 |
| | T R | |
| | T R | |
| | T R | |
| 2. Property Controlling in Section | S T R | |
| | S T R | |
| 3. Miscellaneous Property in Sec. | S T R | |
| | S T R | |

FILED

960045753
12/02/1996 09:31:41
REGISTER OF DEEDS
Paula Johnson
INGHAM COUNTY, MI

Register of Deeds Stamp & File Number

4. Lot No. _____, Recorded Plat _____
5. Private Claims _____

I, Richard W. Steadman, a field surveyor on September 4, 1996, do hereby state that under requirements of P.A. 74, Michigan P.A. of 1970, the corner points mentioned in lines 1 and 2 above were in conformance with regulations and rules therefore as required in the current manual of survey instructions of the United States Department of the Interior, Bureau of Land Management or by a decree of a Court of Law and for that the corner points mentioned in lines 3, 4 and 5 above were in conformance with the rules of the Michigan Board of Land Surveyors or by a Decree of a Court of Law; established, re-established, monumented, recovered, found as expressed below:

NOTE: Not more than 2 corners, all in the same town and range, may be recorded on this certificate.

A. Description of original monument and accessories and/or subsequent restoration:

- 1). 1826: U. S. Public Land Survey Field Notes, Deputy Surveyor Harvey Parke "set 1/4 post from which 16" Beech S70-1/2°W 23 links and 9" Beech S74-1/2°E 24-1/2 links."

- 2). 05-10-1840: Record of Surveys, Vol. 1, Page 42, County Surveyor Anson Jackson used this corner and notes the U. S. witnesses.

- 3). 01-12-1844: Record of Surveys, Vol. 1, Page 99, County Surveyor Anson Jackson again used this corner and again notes the U. S. witnesses.

(Continued on back)

B. Description of corner evidence found and/or method applied in restoring or reestablishing corner:

Found 1/2" iron rod in C/L Elfert Road opposite fence and tree line East. Dug hole, and about 18" deep, found 3/4" iron pipe with concrete poured around it directly under the rod. Broke out the concrete and found plow point directly under the pipe. Replaced the 1/2" iron rod with standard Ingham County Remonumentation rod and cap and set monument box. Measured 2696.24 feet to G-1, 2643.42 feet to G-3, and 2655.96 feet to H-2.

C. Description of monument for corner and accessories established to perpetuate locating the position of the corner:

Set 3/4" smooth iron rod and cap stamped "P. A. 345 PS 11370" in monument box over 3/4" iron pipe and plow point; and took the following witnesses (bearings are magnetic):

- Found nail and tag 18994 (Ron Helsel) in S. side 28" Walnut N34°W 40.94 feet
(To C/L of tree = 42.3' +/-)
Found nail and tag 18994 in E. side 30" Walnut N15°W 70.59 feet
Found nail and tag 18994 in N. side 8" Walnut S84°E 43.66 feet
Found nail and tag 18994 in NE side 20" Walnut S45°E 37.05 feet

Signed by

Richard W. Steadman



Surveyor's Michigan License No. 11370

Date November 2, 1996

G-2, T2N, R2W

Part A - Continued

- 4). 01-13-1866: Record of Surveys, Vol. 3, Page 21, Deputy County Surveyor T. J. Brown used this corner but gives no information about it other than referring to it as the quarter post on the west section line.
- 5). 01-01-1969: County Road Commission Corner Grid Sheet calls for a plow point witnessed by anchor post East 27.5 feet, 12" Walnut NW 42.3 feet, 12" Maple SW 51.2 feet.
- 6). 02-13-1973: Land Corner Recordation Certificate (Rec. 2-15-73, L2-P349), L. J. Hendryx, L.P.S. 3276 states "found RR Spike in center of blacktop road but it didn't check with old witnesses of 1945 that showed a plow point; walnut NW 42.3 feet, 12" Maple SW 51.2 feet."
- 7). March 1980: Certified Survey Map (Rec. 3-24-80, L3-P1229), A. C. Williams, L.P.S. 21275 calls for the "East 1/4 Cor. Sec. 4, T2N, R2W, nail in Walnut NW 42.3 feet, nail in 12" Maple SW 51.2 feet." He also gives a distance of 2645.24 feet to G-3.
- 8). March 1980: Certified Survey Map (Rec. 3-24-80, L3-P1233), A. C. Williams gives the same notation, witnesses, and distance as Item 7 above.

FILED

FILED

2000 1007

SURVEY & REMONUMENTATION

DEC 16 1996

COMMISSION

For corners in

LAND CORNER RECORDATION CERTIFICATE Liber
Filing Requirement of Act 74, Mich. P.A. 1970

9 Page 107

INGHAM COUNTY
Aurelius Township

Located in:

Corner Code #

- | | | |
|------------------------------------|-----------|-----|
| 1. Public Land Survey | T 2N R 2W | G-3 |
| | T R | |
| | T R | |
| | T R | |
| 2. Property Controlling in Section | S T R | |
| | S T R | |
| 3. Miscellaneous Property in Sec. | S T R | |
| | S T R | |

FILED

960045754
12/02/1996 09:31:43
REGISTER OF DEEDS
Paula Johnson
INGHAM COUNTY, MI

Register of Deeds Stamp & File Number

4. Lot No. _____, Recorded Plat _____
5. Private Claims _____

I, Richard W. Steadman, in a field survey on August 21, 1996, do hereby state that under requirements of P.A. 74, Michigan P.A. of 1970, the corner points mentioned in lines 1 and 2 above were in conformance with regulations and rules therefore as required in the current manual of survey instructions of the United States Department of the Interior, Bureau of Land Management or by a decree of a Court of Law and for that the corner points mentioned in lines 3, 4 and 5 above were in conformance with the rules of the Michigan Board of Land Surveyors or by a Decree of a Court of Law, established, re-established, monumented, recovered, found as expressed below:

A	B	C	D	E	F	G	H	I	J	K	L	M
1												
2	6	5	4	3	2	1						
3												
4	7	8	9	10	11	12						
5												
6	10	17	16	15	14	13						
7												
8	19	20	21	22	23	24						
9												
10	30	29	28	27	26	25						
11												
12	31	32	33	34	35	36						
13												

NOTE: Not more than 2 corners, all in the same town and range, may be recorded on this certificate.

A. Description of original monument and accessories and/or subsequent restoration:

- 1). 1826: U. S. Public Land Survey Field Notes, Deputy Surveyor Harvey Parke "set post, corner to Secs. 3, 4, 9, and 10 from which bears 6" Lynn N31-1/2°W 15 links and 12" Beech S56°E 18-1/2 links."
- 2). 12-11-1845: Record of Surveys, Vol. 1, Pages 181 and 182, County Surveyor Anson Jackson used this corner and notes the U. S. witnesses.
- 3). 01-13-1866: Record of Surveys, Vol. 3, Page 21, Deputy County Surveyor T. J. Brown used this corner but gives no information about it other than referring to it as "the SW corner of the section (no bearing trees)."

(Continued on back)

B. Description of corner evidence found and/or method applied in restoring or reestablishing corner:

Found 3/4" iron pipe and cap 11370 in good condition in monument box. Measured 2643.42 feet to G-2 and 2654.52 feet to H-3.

C. Description of monument for corner and accessories established to perpetuate locating the position of the corner:

Left the 3/4" iron pipe and cap 11370 over stone in monument box to mark the corner and took the following witnesses (bearings are magnetic):

Found nail and tag 11370 in W. side Power Pole N49°E 58.50 feet
Found nail and tag 11370 in E. side cut off Telephone Pole S15°E 70.96 feet
Set nail and tag 11370 in E. side 40" Box Elder N13°W 131.63 feet
Set nail and tag 11370 in S. side Power Pole N68°W 114.22 feet
Set nail and tag 11370 in S. side Power Pole S83°W 138.42 feet



Signed by Richard W. Steadman

Date November 4, 1996

Surveyor's Michigan License No. 11370

P.A. 345 INGHAM COUNTY
PEER APPROVED 11/14/96

FORM APPROVED BY MICHIGAN STATE BOARD OF PROFESSIONAL SURVEYORS, JUL 28, 1971
REVISED MAY 14, 1975
REVISED JAN, 1983
REVISED OCT, 1995

G-3, T2N, R2W

Part A - Continued

- 4). 05-01-1895: Record of Surveys, Vol. 3, Page 232, County Surveyor W. A. Rowe calls for a stone, brick, and crockery witnessed by a 12" Sugar N60°W 144 links and a 6" Sugar S71-1/4°E 150 links (99 feet).
- 5). 01-10-1969: County Road Commission Corner Grid Sheet calls for a stone and brick witnessed by 8" Maple WNW 76.0 feet, 14" Maple ENE 99.7 feet, anchor post NE 37.0 feet.
- 6). 07-05-1973: Land Corner Recordation Certificate (Rec. 7-29-75, L3-P418), R. W. Steadman, L.P.S. 11370 "dug hole in the intersection of Columbia and Eiffert Roads and found a 1/2" iron pipe alongside a pointed stone with broken brick around it. All the Road Commission witnesses are gone. Removed the 1/2" pipe and raised the location of the stone to the surface with a 3/4" iron pipe in a monument box; Power Pole NE 58.44 feet, 18" Walnut SE 82.58 feet, Telephone Pole SSE 71.00 feet."
- 7). 01-06-1976: Certified Survey Map (Rec. 9-16-77, L2-P1271), L. J. Hendryx, L.P.S. 3276 notes "SE Corner of Section 4, T2N, R2W."
- 8). March 1980: Certified Survey Map (Rec. 3-24-80, L3-P1229), A. C. Williams, L.P.S. 21275 calls for the SE Cor. Sec. 4, T2N, R2W and gives the same witnesses as Item 6 above. He also gives distances of 2645.24 feet to G-2 and 2668.80 feet to F-3.
- 9). March 1980: Certified Survey Map (Rec. 3-24-80, L3-P1233), A. C. Williams again calls for the SE Cor. Sec. 4, T2N, R2W and gives the same witnesses as Item 6 above and the same distances as Item 8 above.
- 10). 10-28-1982: Certified Survey Map (Rec. 10-19-83, L4-P760), R. W. Steadman calls for the same monument and witnesses given in Item 6 above. He also gives a distance of 2654.40 feet to H-3.