

INGHAM COUNTY REMONUMENTATION

LAND CORNER RECORDATION CERTIFICATE

Filing Requirement of Act 74, Mich. P.A. 1970

For Corners in

Located In:

Corner Code #

INGHAM

(county)

1. Public Land Survey
CORNER COMMON
TO SECTIONS 5 AND 6
AURELIUS TOWNSHIP

T 2N R 2W

C-1

T R

T R

T R

B: 13 P: 156 10/23/2007 11:02 AM

Pages: 2

2007-045646 LAND CORNERS Receipt #33528
Paula Johnson, Ingham County, Michigan



2. Property Controlling in Section S T R
S T R

3. Miscellaneous S T R

4. Lot No , Recorded Plat

5. Private Claims

Register of Deeds Stamp & File Number

	A	B	C	D	E	F	G	H	I	J	K	L	M
1													
2	6		5		4		3		2		1		
3													
4	7		8		9		10		11		12		
5													
6	18		17		16		15		14		13		
7													
8	19		20		21		22		23		24		
9													
10	30		29		28		27		26		25		
11													
12	31		32		33		34		35		36		
13													

I, Brian Reynolds, in a field survey on August 20, 2007 do hereby certify that under requirements of P.A. 74, Michigan P.A. of 1970, the corner points mentioned in lines 1 and 2 above were in conformance with regulations and rules therefore as required in the current manual of survey instructions of the United States Department of the Interior, Bureau of Land Management or by a decree of a Court of Law and/or that the corner points mentioned in lines 3, 4, and 5 above were in conformance with the rules of the Michigan Board of Land Surveyors or by a Decree of a Court of Law; established, re-established, monumented, re-monumented, recovered, found as expressed below.

NOTE: Not more than 2 corners, in the same town and range, may be recorded on this certificate.

A. Description of original monument and accessories and/or subsequent restoration:

- 1825 REGARDING THE CORRESPONDING STANDARD CORNER, GENERAL LAND OFFICE DEPUTY SURVEYOR JOHN MULLETT, MAY 1825, "...WEST ON S BDY 32 T3N R2W.....80.00 SET (POST) COR 31 & 32 (FROM WHICH) ELM 12 N60E 32 B. ASH 12 N82W 43 ..."
- 1826 REGARDING THE SUBJECT CLOSING CORNER, MAY 1825, GENERAL LAND OFFICE DEPUTY SURVEYOR HERVEY PARKE, FEBRUARY, 1826 "...NORTH BTW 5 & 6.....81.27 INT N BDY 68 (LINKS) W OF (POST) TO SECS 31 & 32 T3N R2W & SET (POST) COR 5 & 6 (FROM WHICH) B. ASH 14 S82-1/2E 25 ELM 12 S37W 62 ..."
- 1852 INGHAM COUNTY SURVEYOR RECORD BY A. JACKSON, VOLUME 1, PAGE 282, "...B ASH 14 S 82-1/2 E 25, ELM 12 S 37 62..." AN 1856 SURVEY BY JACKSON, VOL. 3, PAGE 122, SAME WITNESSES, NO MONUMENT RECITED NO CORNER INFORMATION ON THE INGHAM COUNTY ROAD COMMISSION WITNESS MAP FOR AURELIUS TOWNSHIP.
- 1976 ACT 132 SURVEY BY WOLVERINE ENGINEERS & SURVEYORS, INC., SIGNED AND SEALED BY GEORGE M. YOUNG, P.S. 17640, DATED 5-13-76, RECORDED JULY 6, 1976 IN LIBER 2, PAGE 783 & 784, SUBJECT CORNER DESCRIBED THUS: "...NORTHEAST CORNER, SECTION 6 T2N, R2W, AURELIUS TWP., INGHAM COUNTY SET 1/2" RE-ROD ON EAST SIDE 24" CLAY C.B. N 05° W 31.48' NAIL IN 6" WILD CHERRY S 45° W 47.55' NAIL IN POWER POLE N 75° E 139.31' SET 1/2" RE-ROD WITH CAP FLUSH WITH ASPHALT..." DRAWING INDICATES N89°47'28"W 2656.74 FEET TO B-1. CORNER HISTORY CONTINUED ON PAGE TWO

B. Description of corner evidence found and/or method applied in restoring or reestablishing corner:

THE "PK" BY SURVEYOR BEAVER, AND ANY OTHER EVIDENCE OF PRIOR MONUMENTATION CAN BE PRESUMED TO BE DESTROYED BY INSTALLATION OF UNDERGROUND UTILITIES. THERE IS A BITUMINOUS PATCH THE ENTIRE NORTH - SOUTH WIDTH OF THE ROAD ABOUT 6 FEET WIDE, WHERE THERE CLEARLY HAD BEEN SOME TRENCHING IN RECENT YEARS. ALL OF SURVEYOR BEAVER'S WITNESSES ARE INTACT, AS IS THE MONUMENT AT C-13 T3N R2W. RESTORED THE SUBJECT CORNER AS IT WAS RESTORED BY SURVEYOR YOUNG IN 1976, AT THE RECORD DISTANCE AND DIRECTION FROM THE STANDARD CORNER, AND ON THE TOWN LINE. INSTALLED STANDARD INGHAM MONUMENT AND CAP, WITNESSED AS DESCRIBED BELOW.

C. Description of monument for corner and accessories established to perpetuate locating the position of the corner:

WITNESSES TO 3/4" X 24" STEEL FORM PIN WITH AN ALUMINUM CAP STAMPED "31602" IN MONUMENT BOX FOUND "BEAVER" NAIL & TAG IN THE NORTHWEST SIDE OF A 24" HICKORY SOUTH 57.44 FEET FOUND "BEAVER" NAIL & TAG IN THE SOUTHWEST SIDE OF A UTILITY POLE S64°E 66.26 FEET NORTHWEST CORNER OF GARAGE AT HOUSE No. 5991 S52°E 145.40 FEET SET MAGNETIC NAIL & TAG IN THE TOP OF A 12" CMP CULVERT NORTH 80.06 FEET N89°55'17"W 2656.76 FEET TO B-1 S89°32'14"E 2656.71 FEET TO D-1 S00°06'39"W 2734.15 FEET TO C-2 1± FOOT NORTH OF CENTERLINE OF NICHOLS ROAD 1/2" IRON AND "BEAVER" CAP SOUTH 33.02 FEET C-13 T3N R2W EAST 44.88 FEET ON TOWN LINE

P.A. 345 INGHAM COUNTY

PEER APPROVED 8/21/2007

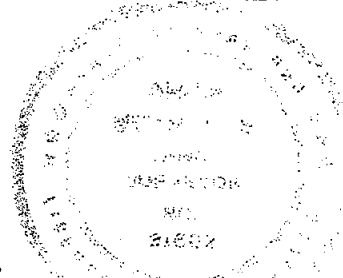

Signed by
Surveyor's Michigan License No 31602

Date September 17, 2007

FORM APPROVED BY MICHIGAN STATE BOARD OF LAND SURVEYORS. JAN. 28, 1971

REVISED MAY 14, 1975 REVISED JANUARY, 1983 REVISED OCTOBER 1995

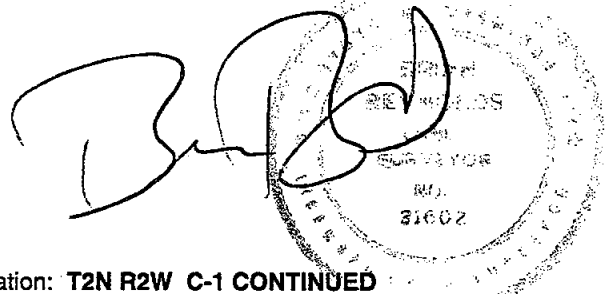

- A. Description of original monument and accessories and/or subsequent restoration: **T2N R2W C-1 CONTINUED**
- 1976 LAND CORNER RECORDATION CERTIFICATE BY GEORGE M. YOUNG, P.S. 17640, DATED MAY 17, 1976, RECORDED JULY 6, 1976 IN LIBER 3, PAGE 584, PART A READS, "...ORIGINAL MONUMENT & ACCESSORIES OBLITERATED NO OTHER DATA AVAILABLE..." PART B READS, "...SET 1/2" RE-ROD & CAP FLUSH WITH ASPHALT, RE-ESTABLISHED CORNER BY USING RECORDED JOG BETWEEN STANDARD CORNER, SECTION 31, T3N, R2W, DELHI TOWNSHIP & NE COR. SECTION 6, T2N, R2W, AURELIUS TOWNSHIP..." PART C READS, "...SET 1/2" RE-ROD ON EAST SIDE 24" CLAY C.B. N05° W 31.48' NAIL IN 6" WILD CHERRY S 45° W 47.55' NAIL IN POWER POLE N 75° E 139.31'..."
- 1978 ACT 132 SURVEY BY WOLVERINE ENGINEERING COMPANY, SIGNED AND SEALED BY GEORGE M. YOUNG, P.S. 17640, DATED JUNE 1, 1978, RECORDED JUNE 20, 1978 IN LIBER 3 PAGES 376 & 377, SUBJECT CORNER DESCRIBED THUS: "...NORTHEAST CORNER - C1 SECTION 6, T2N-R2W AURELIUS TOWNSHIP, INGHAM COUNTY AS RECORDED, LIBER 2, PAGE 783, INGHAM COUNTY RECORDS..." NO WITNESSES. TO C-2 IS SHOWN AS S00°01'20"W 2718.07 FEET
- 1978 ACT 132 SURVEY BY WOLVERINE ENGINEERING COMPANY, SIGNED AND SEALED BY GEORGE M. YOUNG, P.S. 17640, DATED JUNE 26, 1978, RECORDED JULY 6, 1978 IN LIBER 3 PAGE 386, SUBJECT CORNER DESCRIBED THUS: "...NORTHEAST CORNER SECTION 6, T2N-R2W AURELIUS TWP., INGHAM CO., MICH. FOUND 1/2" REROD W/CAP FLUSH W/ASPH. AS RECORDED, LIBER 2, PAGE 783, INGHAM COUNTY RECORDS..." NO WITNESSES.
- 1978 ACT 132 SURVEY BY WOLVERINE ENGINEERING COMPANY, SIGNED AND SEALED BY GEORGE M. YOUNG, P.S. 17640, DATED JULY 17, 1978, RECORDED SEPTEMBER 15, 1978 IN LIBER 3 PAGE 526, SUBJECT CORNER DESCRIBED THUS: "...NORTHEAST CORNER SECTION 6, T2N-R2W AURELIUS TWP., INGHAM CO., MICH. FOUND 1/2" REROD W/CAP FLUSH W/ASPH. AS RECORDED, LIBER 2, PAGE 783, INGHAM COUNTY RECORDS..." NO WITNESSES.
- 1979 SEVERAL ACT 132 SURVEYS BY WOLVERINE ENGINEERING CO., SIGNED AND SEALED BY GEORGE M. YOUNG, P.S. 17640, DATED JANUARY 26, 1979, RECORDED MARCH 5, 1979 IN LIBER 3 PAGES 765, 766 & 767, AND LIBER 4 PAGE 355, SUBJECT CORNER DESCRIBED THUS: "...NORTHEAST CORNER, SEC. 6, T2N-R2W AURELIUS TOWNSHIP, INGHAM COUNTY FND. 1/2" RE-ROD ON E SIDE 24" CLAY C.B. N 05° W 31.48' NAIL IN 6" WILD CHERRY, S 45° W 47.55' NAIL IN POWER POLE, N 75° E 139.31' FND. 1/2" RE-ROD WITH CAP FLUSH WITH ASPHALT, AS RECORDED IN LIBER 2, PAGE 783, INGHAM COUNTY RECORDS..." DRAWING INDICATES S00°01'30"W 2732.63 FEET TO C-2 TO B-1 IS SHOWN AS 2656.74 FEET.
- 1979 ACT 132 SURVEY BY WOLVERINE ENGINEERING COMPANY, SIGNED AND SEALED BY GEORGE M. YOUNG, P.S. 17640, DATED 6/15/79, RECORDED JUNE 21, 1979 IN LIBER 3 PAGE 890, SUBJECT CORNER DESCRIBED THUS: "...NORTHEAST CORNER, SECTION 6, T2N, R2W AURELIUS TOWNSHIP, INGHAM COUNTY, MICHIGAN SET 1/2" RE-ROD ON EAST SIDE 24" CLAY C.B. N 05° W 31.48' NAIL IN 6" WILD CHERRY, S 45° W 47.55' NAIL IN POWER POLE, N 75° E 139.31' SET 1/2" RE-ROD WITH CAP FLUSH WITH ASPHALT, RECORDED LIBER 2, PAGE 783 ..."
- 1982 ACT 132 SURVEY BY WOLVERINE ENGINEERING COMPANY, SIGNED AND SEALED BY GEORGE M. YOUNG, P.S. 17640, DATED NOV. 23, 1982, RECORDED MARCH 17, 1983 IN LIBER 4 PAGE 633, SUBJECT CORNER DESCRIBED THUS: "...NE COR., SEC. 6, T2N-R2W AURELIUS TOWNSHIP, INGHAM CO., MICHIGAN FND. 1/2" REROD W/CAP FLUSH W/ASPHALT AS RECORDED LIBER 2, PAGE 783, INGHAM CO. RECORDS..." NO WITNESSES.
- 1985 RECORDED PLAT OF "RIVER BEND PARK SUBDIVISION" BY POLARIS SURVEYING COMPANY, SIGNED AND SEALED BY RONNIE M. LESTER, P.S. No. 18998, RECORDED JULY 25, 1985 IN LIBER 39 OF PLATS, ON PAGES 23 & 24. SUBJECT CLOSING SECTION CORNER IS SHOWN, MONUMENT NOT DESCRIBED, NO WITNESSES.
- 1999 ACT 132 SURVEY BY SOUTHERN MICHIGAN LAND SURVEYING, SIGNED AND SEALED BY PETER D. BEAVER, P.S. 25828, DATED 12-3-1999, RECORDED 8/04/2000 IN LIBER 8, PAGE 740, SUBJECT CORNER DESCRIBED THUS: "...NW CORNER SECTION 5 T2N, R2W RESET CORNER @ L3, P584 WITH P.K. AND TAG #25828 SET N/T #25828 SW/S U.P. AZ=115° 6.18' SET N/T #25828 SE/S P.P., AZ=69° 139.96' SET N/T #25828 N/S 20" MAPLE, AZ=249° 93.64' SET N/T #25828 N/S P.P., AZ=281° 251.57' ... DRAWING INDICATES S00°01'55"W 2634.26 FEET TO C-2 (ALSO NOTED ON DRAWING IS WOLVERINE S99°01'30"W 2632.63 FEET) DRAWING INDICATES S89°36'23"E 2611.86 FEET FROM C-13 TO D-1, N90°00'00"E FROM C-1 TO C-13.
- 1999 LAND CORNER RECORDATION CERTIFICATE LIBER 9 PAGE 572 BY PETER D. BEAVER, P.S. No. 25828, DATED DECEMBER 3, 1999, RECORDED AUGUST 4, 2000, PART A IS BLANK, PART B READS, "...FOUND NOTHING, RESET CORNER FROM L.C.R.C. TIES @ L3, P584 & CERTIFIED SURVEY @ L3, P376 ..." PART "C" CALLS FOR THE SAME MONUMENT AND WITNESSES AS THE 1999 ACT 132 SURVEY BY BEAVER, RECITED ABOVE.
- 2000 ACT 132 SURVEY BY WOLVERINE ENGINEERS & SURVEYORS, INC., SIGNED AND SEALED BY MAURICE H. MAHIEU, P.S. 28414, DATED 8-16-00, RECORDED 10/13/2000 IN LIBER 8, PAGE 778, SUBJECT CORNER DESCRIBED THUS: "...NW CORNER SEC 5 T2N, R2W, AURELIUS TWP. P.K. & TAG #25828 WITNESSES: N&T #25828 SW SIDE U.P., AZ=115° 66.18' N&T #25828 SE SIDE P.P., AZ=69° 139.96' N&T #25828 N. SIDE 20" MAPLE, AZ=249° 93.64' N&T #25828 N. SIDE P.P., AZ=281° 251.57' ... DRAWING INDICATES S89°36'23"E 2611.86 FEET FROM C-13 TO D-1, N90°00'00"E 44.88' FROM C-1 - C-13, SEC 32.
- 2002 ACT 132 SURVEY BY ENGER SURVEYING & ENGINEERING, SIGNED AND SEALED BY RONALD L. ENGER, P.S. 28409, DATED AUGUST 1, 2002, RECORDED 6/19/2003 IN LIBER 8, PAGE 1125, SUBJECT CORNER DESCRIBED THUS: "...T2N, R2W NORTHWEST CORNER SECTION 5 RECORDED LIBER 9 PAGE 572 SET P.K. NAIL & WASHER 25828 NAIL & TAG 25828 IN SW SIDE UTILITY POLE NAZ. 115° 66.18' NAIL & TAG 25828 IN SE SIDE POWER POLE NAZ. 69° 139.96' NAIL & TAG 25828 IN NORTH SIDE 20" MAPLE NAZ. 249° 93.64' NAIL & TAG 25828 IN NORTH SIDE POWER POLE NAZ. 281° 251.57' IRON IN MONUMENT BOX AT SE CORNER SECTION 31, T3N, R2W NAZ. 90° 44.88' ... DRAWING INDICATES S89°36'23"E 2611.75 FEET (PAGE 2 INDICATES 2611.76 FEET) FROM C-13 SEC 32 TO D-1 AND N90°00'00"E 44.88 FEET FROM C-1 TO C-13.

INGHAM COUNTY REMONUMENTATION
LAND CORNER RECORDATION CERTIFICATE
Filing Requirement of Act 74, Mich. P.A. 1970

For Corners in
INGHAM
(county)

Located In:

Corner Code #

1. Public Land Survey
1/4 CORNER COMMON
TO SECTIONS 5 & 6
AURELIUS TOWNSHIP

T 2N R 2W

C-2

T R

T R

T R

B: 13 P: 133 09/25/2007 09:14 AM
2007-041770 LAND CORNERS Receipt #32274
Paula Johnson, Ingham County, Michigan

Pages: 2



2. Property Controlling S T R
in Section S T R

3. Miscellaneous S T R

4. Lot No _____, Recorded Plat _____

5. Private Claims _____

Register of Deeds Stamp & File Number

1	A	B	C	D	E	F	G	H	I	J	K	L	M
2	6	5	4	3	2	1							
3													
4	7	8	9	10	11	12							
5													
6	18	17	16	15	14	13							
7													
8	19	20	21	22	23	24							
9													
10	30	29	28	27	26	25							
11													
12	31	32	33	34	35	36							
13													

I, Brian Reynolds, in a field survey on March 27, 2007 do hereby certify that under requirements of P.A. 74, Michigan P.A. of 1970, the corner points mentioned in lines 1 and 2 above were in conformance with regulations and rules therefore as required in the current manual of survey instructions of the United States Department of the Interior, Bureau of Land Management or by a decree of a Court of Law and/or that the corner points mentioned in lines 3, 4, and 5 above were in conformance with the rules of the Michigan Board of Land Surveyors or by a Decree of a Court of Law; established, re-established, monumented, re-monumented, recovered, found as expressed below.

NOTE: Not more than 2 corners, in the same town and range, may be recorded on this certificate.

A. Description of original monument and accessories and/or subsequent restoration:

1826 GENERAL LAND OFFICE DEPUTY SURVEYOR HERVEY PARKE, FEBRUARY 1826, "...N BTW 5 & 640.00 SET QR (POST) (FROM WHICH) TAM 14 S46E 33 TAM 14 N66W 04 ..."

1856 INGHAM COUNTY SURVEYOR RECORD BY A. JACKSON, VOLUME 3, PAGE 122, "...TAM 14 S 46 E 55 Do. 14 N 66 W 4..."

NO CORNER INFORMATION ON THE INGHAM COUNTY ROAD COMMISSION WITNESS MAP FOR AURELIUS TOWNSHIP.

1976 ACT 132 SURVEY BY WOLVERINE ENGINEERS & SURVEYORS, INC., SIGNED AND SEALED BY GEORGE M. YOUNG, P.S. 17640, DATED 5-13-76, RECORDED JULY 6, 1976 IN LIBER 2, PAGES 783 & 784, SUBJECT CORNER DESCRIBED THUS: "...EAST 1/4 POST, SECTION 6 T2N, R2W, AURELIUS TWP., INGHAM COUNTY
NAIL IN 4" MAPLE N 03° W 11.8' NAIL IN 12" OAK S 80° E 33.3'
NAIL IN 24" SWAMP OAK N 85° W 20.1' FOUND ANCHOR POST SET 1/2" RE-ROD WITH CAP..."
TO B-2 IS SHOWN AS 2654.62 FEET

CORNER HISTORY CONTINUED ON PAGE TWO

B. Description of corner evidence found and/or method applied in restoring or reestablishing corner:

FOUND 1/2" IRON IN ROCK PILE IN CENTER OF ROTTED OFF 10" WOOD POST WITH 4 WAY FENCE IN MARSH ALSO FOUND ONE WITNESS BY SURVEYOR YOUNG (1979) viz. 4" MAPLE, N 03° W 11.8' TWO WITNESSES BY SURVEYOR BEAVER, viz. 8" MAPLE AZ=230° 15.65' & 18" MAPLE AZ=0° 11.99', AND ALL WITNESSES BY WOLVERINE (2004) AND KEBS (2006). IRON AS FOUND WAS CONSISTENT WITH ALL FOUND WITNESSES. REPLACED FOUND IRON WITH STANDARD REMON IRON AND CAP, WITNESSED AS DESCRIBED BELOW.

C. Description of monument for corner and accessories established to perpetuate locating the position of the corner:

WITNESSES TO 3/4" X 24" STEEL FORM PIN WITH AN ALUMINUM CAP STAMPED "31602"
FOUND KEBS TAG IN THE SOUTH SIDE OF A 12" MAPLE S45°E 2.52 FEET
FOUND N & T "BEAVER" IN THE WEST SIDE OF A 12" MAPLE N10°W 11.95 FEET
FOUND BEAVER TAG IN THE NORTH SIDE OF A 6" MAPLE S45°W 15.79 FEET
FOUND KEBS TAG IN THE WEST SIDE OF A 12" MAPLE SOUTH 30.44 FEET
N89°59'10"W 2654.22 FEET TO B-2 S89°24'13"E 2659.13 FEET TO D-2
N00°06'39"E 2734.15 FEET TO C-1 S00°03'51"E 2644.81 FEET TO C-3
FENCES NORTH, SOUTH, EAST & WEST

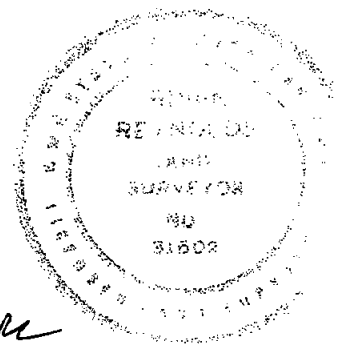

P.A. 345 INGHAM COUNTY
PEER APPROVED 6/19/2007 MC

Signed by [Signature]
Surveyor's Michigan License No. 31602

Date AUGUST 19, 2007

FORM APPROVED BY MICHIGAN STATE BOARD OF LAND SURVEYORS. JAN. 28, 1971

REVISED MAY 14, 1975 REVISED JANUARY, 1983 REVISED OCTOBER 1995

PAGE TWO

A. Description of original monument and accessories and/or subsequent restoration: T2N R2W C-2 CONTINUED

- 1976 LAND CORNER RECORDATION CERTIFICATE BY GEORGE M. YOUNG, P.S. 17640, DATED MAY 17, 1976, RECORDED JULY 6, 1976 IN LIBER 3, PAGE 584, PART A READS, "...ORIGINAL MONUMENT & ACCESSORIES OBLITERATED NO OTHER DATA AVAILABLE..." PART B READS, "...FOUND ANCHOR POST AND SET 1/2" RE-ROD & CAP BESIDE ACCEPTED FENCE CORNER AS PERPETUATION OF ORIGINAL 1/4 POST FITS VERY CLOSE TO PRORATED DISTANCE BETWEEN SE COR. & NE COR OF SAID SECTION..."; PART C READS, "...NAIL IN 12" OAK S80° E 33.3' NAIL IN 24" SWAMP OAK N85° W 20.1' NAIL IN 4" MAPLE N03° W 11.8'..."
- 1978 ACT 132 SURVEY BY WOLVERINE ENGINEERING COMPANY, SIGNED AND SEALED BY GEORGE M. YOUNG, P.S. 17640, DATED JUNE 1, 1978, RECORDED JUNE 20, 1978 IN LIBER 3 PAGES 376 & 377, SUBJECT CORNER DESCRIBED THUS: "... EAST 1/4 CORNER - C2 SECTION 6, T2N-R2W AURELIUS TOWNSHIP, INGHAM COUNTY AS RECORDED, LIBER 2, PAGE 783, INGHAM COUNTY RECORDS..." NO WITNESSES.
- 1979 ACT 132 SURVEY BY WOLVERINE ENGINEERING CO., SIGNED AND SEALED BY GEORGE M. YOUNG, P.S. 17640, DATED JANUARY 26, 1979, RECORDED MARCH 5, 1979 IN LIBER 3 PAGE 765, SUBJECT CORNER DESCRIBED THUS: "...EAST 1/4 POST, SECTION 6, T2N-R2W AURELIUS TOWNSHIP, INGHAM COUNTY NAIL IN 4" MAPLE, N 03° W 11.8' NAIL IN 12" OAK, S 80° E 33.3' NAIL IN 24" SWAMP OAK N 85° W 20.1' FND. ANCHOR POST AND 1/2" RE-ROD WITH CAP. AS RECORDED IN LIBER 3, PAGE 584, INGHAM COUNTY RECORDS..."
- 1999 ACT 132 SURVEY BY SOUTHERN MICHIGAN LAND SURVEYING, SIGNED AND SEALED BY PETER D. BEAVER, P.S. 25828, DATED 12-3-1999, RECORDED AUGUST 4, 2000 IN LIBER 8, PAGE 740, SUBJECT CORNER DESCRIBED THUS: "...W 1/4 CORNER SECTION 5 T2N, R2W FOUND 1/2" ROD BESIDE ANCHOR POST @ L3, P584 SET N/T #25828 W/S 8" MAPLE AZ=320° 14.22' SET N/T #25828 N/S 8" MAPLE AZ=230° 15.65' SET N/T #25828 W/S 18" MAPLE AZ=0° 11.99' SET N/T #25828 W/S TWIN 12" MAPLE AZ=165° 9.83' ..."
- 2002 ACT 132 SURVEY BY ENGER SURVEYING & ENGINEERING, SIGNED AND SEALED BY RONALD L. ENGER, P.S. 28409, DATED JULY 9, 2002, RECORDED 6/19/2003 IN LIBER 8 PAGE 1124, SUBJECT CORNER DESCRIBED THUS: "...T2N R2W WEST 1/4 CORNER SECTION 5 RECORDED LIBER 3 PAGE 584 1/2" BAR AT FOUR-WAY FENCE CORNER NAIL IN 12" OAK S80°E 33.3' NAIL IN 24" SWAMP OAK N85°W 20.1' NAIL IN 4" MAPLE N03°W 11.8'..."
- 2002 ACT 132 SURVEY BY ENGER SURVEYING & ENGINEERING, SIGNED AND SEALED BY RONALD L. ENGER, P.S. 28409, DATED AUGUST 1, 2002, RECORDED 6/19/2003 IN LIBER 8, PAGE 1125, SUBJECT CORNER DESCRIBED THUS: "...T2N, R2W WEST 1/4 CORNER SECTION 5 RECORDED LIBER 3 PAGE 584 1/2" BAR AT FOUR-WAY FENCE CORNER NAIL IN 12" OAK S80°E 33.3' NAIL IN 24" SWAMP OAK N85°W 20.1' NAIL IN 4" MAPLE N03°W 11.8' ..."
- 2004 ACT 132 SURVEY BY WOLVERINE ENGINEERS & SURVEYORS, INC., SIGNED AND SEALED BY MAURICE H. MAHIEU, P.S. 28414, DATED 12-29-04, RECORDED 01/10/2005 IN LIBER 9, PAGE 141, SUBJECT CORNER DESCRIBED THUS: "...EAST 1/4 CORNER, SECTION 6 T2N, R2W, AURELIUS TWP. FND. 1/2" IRON ROD AT FENCE ANCHOR POST WITNESSES: N&T #25828 W. SIDE 18" MAPLE, NORTH 12.03' N&T #25828 N. SIDE 9" MAPLE, S40°W 15.66' N&T #28414 S. SIDE 15" MAPLE, EAST 2.56' N&T #28414 W. SIDE 15" MAPLE, SOUTH 30.23' ..." DRAWING SHOWS S00°08'46"E 2644.76 FEET TO C-3
- 2006 ACT 132 SURVEY BY KEBS, INC, SIGNED AND SEALED BY JEFFREY K. AUTENRIETH, P.S. 31588, DATED 3-6-06, RECORDED 5/26/06 IN LIBER 9 PAGE 308, SUBJECT CORNER DESCRIBED THUS: "...WEST 1/4 CORNER SECTION 5, T2N, R2W FOUND 1/2" BAR AT BASE OF OLD ANCHOR POST FOUND NAIL & TAG #28414 SOUTHWEST SIDE 10" MAPLE, S40°E, 2.53' FOUND NAIL & TAG #28414 WEST SIDE 10" MAPLE, S10°E, 30.30' FOUND NAIL & WASHER "BEAVER" NORTH SIDE 6" MAPLE, S25°W, 15.65' FOUND NAIL & WASHER "BEAVER" WEST SIDE 14" MAPLE, N10°W, 11.94' ..." DRAWING SHOWS S00°31'03"E 2644.86 FEET TO C-3

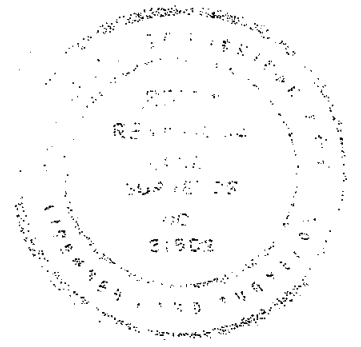

INGHAM COUNTY REMONUMENTATION
LAND CORNER RECORDATION CERTIFICATE
Filing Requirement of Act 74, Mich. P.A. 1970

For Corners in
INGHAM
(county)

Located In:

Corner Code #

1. Public Land Survey
CORNER COMMON
TO SECTIONS 5, 6, 7 & 8
AURELIUS TOWNSHIP

T 2N R 2W
T _____ R _____
T _____ R _____
T _____ R _____

C-3

B: 13 P: 134 09/25/2007 09:14 AM
2007-041771 LAND CORNERS Receipt #32274
Paula Johnson, Ingham County, Michigan

Pages: 2



2. Property Controlling S _____ T _____ R _____
in Section S _____ T _____ R _____

3. Miscellaneous S _____ T _____ R _____

4. Lot No _____, Recorded Plat _____

5. Private Claims _____

Register of Deeds Stamp & File Number

I, Brian Reynolds, in a field survey on August 17, 2007 do hereby certify that under requirements of P.A. 74, Michigan P.A. of 1970, the corner points mentioned in lines 1 and 2 above were in conformance with regulations and rules therefore as required in the current manual of survey instructions of the United States Department of the Interior, Bureau of Land Management or by a decree of a Court of Law and/or that the corner points mentioned in lines 3, 4, and 5 above were in conformance with the rules of the Michigan Board of Land Surveyors or by a Decree of a Court of Law; established, re-established, monumented, re-monumented, recovered, found as expressed below.

NOTE: Not more than 2 corners, in the same town and range, may be recorded on this certificate.

A. Description of original monument and accessories and/or subsequent restoration:

- 1826 GENERAL LAND OFFICE DEPUTY SURVEYOR HERVEY PARKE, FEBRUARY, 1826, "...80.00 SET (POST) COR. 5, 6, 7 & 8 (FROM WHICH) BE 12 N67-1/2W 20 Do. 10 S57E 16 ..."
- 1867 INGHAM COUNTY SURVEYOR RECORD BY THOS. J. BROWN, DEP. CO. SURVEYOR, VOLUME 2, PAGE 52, "...NO TREES BUT A POST DOWN EVEN WITH THE SURFACE..."
- NO CORNER INFORMATION ON THE INGHAM COUNTY ROAD COMMISSION WITNESS MAP FOR AURELIUS TOWNSHIP.
- 1972 ACT 132 SURVEY BY POLARIS ASSOCIATES INC, SIGNED AND SEALED BY RONNIE M. LESTER, P.S. 18998, DATED 12-1-72, RECORDED FEBRUARY 2, 1973 IN LIBER 1 PAGES 595 & 596, SUBJECT CORNER DESCRIBED THUS:
"...NW CORNER SECTION 8, T2N R2W SET NAIL & TAG EAST SIDE 24" HICKORY, SW, 56.8'
SET NAIL & TAG NW SIDE 24" STUMP, SW, 41.42' SET NAIL & TAG WEST SIDE 18" HICKORY, NORTH, 49.33'..."
DRAWING INDICATES 2656.01 FEET TO D-3.
- 1972 LAND CORNER RECORDATION CERTIFICATE BY RONNIE M. LESTER, P.S. 18998, DATED DECEMBER 4, 1972, RECORDED FEBRUARY 2, 1973 IN LIBER 2, PAGE 303, PART A READS, "...ORIGINAL MONUMENT AND ACCESSORIES OBLITERATED..." PART B READS, "...FOUND 1" BOATSPIKE IN CENTERLINE INTERSECTION COLUMBIA AND GALE HIGHWAYS CORNER IN ACCORD WITH EXISTING OCCUPATION AND SURVEYS..." PART C READS,
"...NW CORNER SECTION 8 SET NAIL & TAG EAST SIDE 24" HICKORY, SW, 56.8'
SET NAIL & TAG NW SIDE 24" STUMP, SW, 41.42' SET NAIL & TAG WEST SIDE 18" HICKORY, NORTH, 49.33'..."
- 1976 ACT 132 SURVEY BY FRED WHITE ENGINEERING COMPANY, INC, SIGNED AND SEALED BY RON HELSEL, P.S. 18994, DATED FEBRUARY 24, 1976, RECORDED MARCH 23, 1976 IN LIBER 2, PAGE 647, SUBJECT CORNER DESCRIBED THUS:
"...NW COR. SEC. 8, T2N-R2W, WITNESS TO NW COR: LIBER 2, PG. 303)
SW 56.8' N. & T. E. SIDE 24" HICKORY SW 41.42' N. & T. NW SIDE 24" STUMP
NORTH 49.33' N. & T. W. SIDE 18" HICKORY..."
DRAWING INDICATES 2168.90 FEET TO D-3.
- CORNER HISTORY CONTINUED ON PAGE TWO

B. Description of corner evidence found and/or method applied in restoring or reestablishing corner:

FOUND 5/8" IRON & CAP No. 18998 IN A MONUMENT BOX AT THE INTERSECTION OF THE CENTERLINES OF COLUMBIA ROAD AND GALE ROAD. EXCAVATED THROUGH MONUMENT BOX, FOUND NO FURTHER EVIDENCE OF PREVIOUS MONUMENTATION HALF-MILE MEASUREMENTS NORTH, WEST, AND EAST, ARE ALL IN VERY CLOSE ACCORD WITH DISTANCES OF RECORD IN PART A. ACCEPTED FOUND IRON AS PROPER PERPETUATION OF CORNER POSITION, REPLACED WITH 3/4" X 24" STEEL FORM PIN WITH AN ALUMINUM CAP STAMPED "31602", WITNESSED AS DESCRIBED BELOW.

C. Description of monument for corner and accessories established to perpetuate locating the position of the corner:

WITNESSES TO 3/4" X 24" STEEL FORM PIN WITH AN ALUMINUM CAP STAMPED "31602" IN MONUMENT BOX
FOUND NAIL & TAG No. 28414 IN THE WEST SIDE OF A 12" MAPLE N02°E 55.74 FEET
SET MAGNETIC NAIL & REMON TAG IN THE SOUTH SIDE OF A UTILITY POLE N85°W 300.88 FEET
SET MAGNETIC NAIL & REMON TAG IN THE SOUTHWEST SIDE OF A UTILITY POLE N60°W 48.44 FEET
FOUND CAPPED IRON No. 28414 NORTH 32.98 FEET N89°50'47"W 2660.19' TO B-3
N00°03'51"W 2644.81' TO C-2 S89°32'46"E 2652.85' TO D-3 IN LINE WITH FENCE NORTH
ON CENTERLINE OF COLUMBIA ROAD IN LINE WITH CENTERLINE OF GALE ROAD

P.A. 345 INGHAM COUNTY
PEER APPROVED 8/21/2007

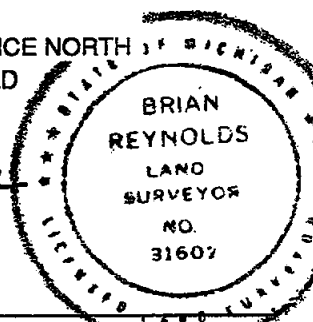

Signed by [Signature]
Surveyor's Michigan License No 31602

Date AUGUST 17, 2007

FORM APPROVED BY MICHIGAN STATE BOARD OF LAND SURVEYORS JAN. 28, 197
REVISED MAY 14, 1975 REVISED JANUARY, 1983 REVISED OCTOBER 1995

PAGE TWO

A. Description of original monument and accessories and/or subsequent restoration: T2N R2W C-3 CONTINUED

- 1976 ACT 132 SURVEY BY WOLVERINE ENGINEERS & SURVEYORS, INC., SIGNED AND SEALED BY GEORGE M. YOUNG, P.S. 17640, DATED 5-13-76, RECORDED JULY 6, 1976 IN LIBER 2, PAGES 783 & 784, SUBJECT CORNER DESCRIBED THUS: "...SOUTHEAST CORNER, SECTION 6 T2N, R2W, AURELIUS TWP., INGHAM COUNTY
NAIL & WASHER IN 24" SHAG BARK HICKORY N 10° W 49.41' NAIL IN 24" MAPLE S 30° W 56.80'
NAIL IN POWER POLE N 45° W 48.55' FOUND BOAT SPIKE SET 1/2" RE-ROD WITH CAP
RECORDED LIBER 2, PAGE 303 ... DRAWING INDICATES N89°55'35"W 2660.10 FEET TO B-3.
- 1976 ACT 132 SURVEY BY POLARIS ASSOCIATES INC, SIGNED AND SEALED BY RONNIE M. LESTER, P.S. 18998, DATED 8-2-76, RECORDED AUGUST 12, 1976 IN LIBER 2 PAGES 846 & 847, SUBJECT CORNER DESCRIBED THUS: "...NE CORNER SECTION 7, T2N R2W NAIL & TAG IN EAST SIDE 24" HICKORY, SW, 56.8'
NAIL & TAG IN NW SIDE 24" STUMP, SW, 41.42' NAIL & TAG IN WEST SIDE 18" HICKORY, NORTH, 49.33'..."
- 1978 ACT 132 SURVEY BY FRED WHITE ENGINEERING COMPANY, SIGNED AND SEALED BY FRED N. WHITE, P.S. 12034, DATED JUNE 7, 1978, RECORDED AUGUST 29, 1978 IN LIBER 3, PAGE 504, SUBJECT CORNER DESCRIBED THUS: "SE COR. SEC 6 T2N, R2W (LIBER 2-PG. 305, EAST LINE SEC. 6..." DRAWING INDICATES 2660.25 FEET TO B-3.
- 1980 ACT 132 SURVEY BY POLARIS ASSOCIATES INC, SIGNED AND SEALED BY RONNIE M. LESTER, P.S. 18998, DATED 10/13/80, RECORDED FEBRUARY 2, 1981 IN LIBER 4 PAGES 209-212, SUBJECT CORNER DESCRIBED THUS: "...NORTHWEST CORNER SECTION 8, T2N, R2W NAIL & TAG IN EAST SIDE 24" HICKORY, S.W., 56.8'
NAIL & TAG IN N.W. SIDE 24" STUMP, S.W., 41.42' NAIL & TAG IN WEST SIDE 18" HICKORY, NORTH, 49.33'..."
- 1983 ACT 132 SURVEY SIGNED AND SEALED BY MARVIN F. FOUTY, P.S. 18989, DATED MAY 31, 1983, RECORDED DATE ILLEGIBLE IN LIBER 4 PAGES 1089 & 1090, SUBJECT CORNER DESCRIBED THUS: "...NW CORNER SEC. 8, T2N, R2W FOUND NAIL AND TAG E/SIDE 24" HICK. SW, 56.8'
FOUND NAIL AND TAG NW SIDE 24" STUMP, SW, 41.42' FOUND NAIL AND TAG W/SIDE 18" HICKORY, NORTH, 49.33'..."
- 1998 ACT 132 SURVEY BY POLARIS SURVEYING, SIGNED AND SEALED BY RONNIE M. LESTER, P.S. 18998, DATED 10/19/98, RECORDED 12/03/1998 IN LIBER 8, PAGES 372-374, SUBJECT CORNER DESCRIBED THUS: "...NORTHEAST CORNER SECTION 7, T2N, R2W. SET 1/2" BAR WITH GEAR TOP AT LOCATION RECORDED LIBER 2, PAGE 303.
FOUND NAIL AND TAG #18998 WEST SIDE 24" SHAGBARK MAG. AZ. 350°, 49.33'
FOUND NAIL AND TAG #18998 NE SIDE UTILITY POLE MAG. AZ. 315°, 48.35'
SET GALVANIZED NAIL & 1 1/4" BRASS TAG STAMPED "18998 LESTER" EAST SIDE 20" MAPLE MAG. AZ., 192°, 200.43'
SET GALVANIZED NAIL & 1 1/4" BRASS TAG STAMPED "18998 LESTER" EAST SIDE 6" MAPLE MAG. AZ., 09°, 45.58'..."
- 2001 ACT 132 SURVEY BY WOLVERINE ENGINEERS & SURVEYORS, INC, SIGNED AND SEALED BY MAURICE H. MAHIEU, P.S. 28414, RECORDED 05/22/2001, LIBER 8, PAGE 869, SUBJECT CORNER DESCRIBED THUS: "...NW CORNER SEC. 8, T2N, R2W AURELIUS TWP., INGHAM CO. AXLE SHAFT C/L INTERSECTION COLUMBIA & GALE ROADS
WITNESSES: N&T #28414 W. SIDE 10" MAPLE, N. 55.75' N&T #18998 W. SIDE 28" HICKORY, N10°W 49.33'
N&T #18998 NE SIDE UTILITY POLE, N45°W 48.35' N&T #18998 E. SIDE 21" MAPLE, S12°W 200.43'..."
- 2002 ACT 132 SURVEY BY ENGER SURVEYING & ENGINEERING, SIGNED AND SEALED BY RONALD L. ENGER, P.S. 28409, DATED JULY 9, 2002, RECORDED 6/19/2003 IN LIBER 8 PAGE 1124, SUBJECT CORNER DESCRIBED THUS: "...T2N R2W NORTHEAST CORNER SECTION 7 RECORDED ON SURVEY LIBER 8 PAGE 372 1/2" BAR WITH GEAR TOP
NAIL & TAG #28414 NORTH SIDE 15" SHAGBARK NAZ 26° 58.70'
NAIL & TAG #28414 WEST SIDE 24" SHAGBARK NAZ 41° 40.95'
NAIL & TAG #28414 WEST SIDE 40" HICKORY NAZ 139° 38.73'
NAIL & TAG #18998 SE SIDE 30" MAPLE NAZ 230° 34.22'
NAIL & TAG #18998 SW SIDE 40" HICKORY NAZ 139° 39.55'..."
DRAWING INDICATES S89°36'34"E 2652.62 FEET TO D-3.
- 2004 ACT 132 SURVEY SIGNED AND SEALED BY RON HELSEL, P.S. 18994, DATED 4/02/04, RECORDED 04/29/2004 IN LIBER 9, PAGE 46, SUBJECT CORNER DESCRIBED THUS: "...NORTHEAST (sic) CORNER SECTION 8, T2N, R2W, LIBER 2, PAGE 303 OF CORNERS ORIGINALLY DESCRIBED AS A BOAT SPIKE, FOUND 1/2" IRON BAR.
FOUND NAIL AND TAG #18998 EAST/SIDE 8" MAPLE, AZ. 10°, 45.58 FEET
FOUND NAIL AND TAG #18998 NORTHEAST/SIDE POWER POLE, AZ. 315°, 48.34 FEET
FOUND NAIL AND TAG #18998 WEST/SIDE 24" HICKORY, AZ. 350°, 49.33 FEET
FOUND NAIL AND TAG #18998 EAST/SIDE 22" MAPLE, AZ. 190°, 200.40 FEET
MEASURED 2640.45 FEET TO WEST 1/4 CORNER SECTION 8 ..."
- 2004 ACT 132 SURVEY BY WOLVERINE ENGINEERS & SURVEYORS, INC., SIGNED AND SEALED BY MAURICE H. MAHIEU, P.S. 28414, DATED 12-29-04, RECORDED 01/10/2005 IN LIBER 9, PAGE 141, SUBJECT CORNER DESCRIBED THUS: "...SOUTHEAST CORNER, SECTION 6 T2N, R2W, AURELIUS TWP. FND. SMALL AXLE SHAFT WITNESSES:
N&T #28414 W. SIDE 18" MAPLE, N09°E 55.78' N&T #18998 W. SIDE 36" HICKORY, N10°W 49.39'
N&T #18998 E. SIDE UTILITY POLE, N44°W 48.40' N&T #18998 E. SIDE 28" MAPLE, S 12°W 200.45' ..."
DRAWING INDICATES 89°55'35"E 2660.12 FEET TO B-3 TO C-2 IS N00°08'46"W 2644.76 FEET
- 2006 ACT 132 SURVEY BY KEBS, INC, SIGNED AND SEALED BY JEFFREY K. AUTENRIETH, P.S. 31588, DATED 3-6-06, RECORDED 5/26/06 IN LIBER 9 PAGE 308, SUBJECT CORNER DESCRIBED THUS: "...SOUTHWEST CORNER SECTION 5, T2N, R2W FOUND 5/8" BEVELED GEAR IN C/L INTERSECTION OF COLUMBIA AND GALE ROADS
FOUND NAIL & TAG #18998 EAST SIDE 8" MAPLE, NORTH, 45.67'
FOUND NAIL & TAG #18998 NORTHEAST SIDE POWER POLE N35°W, 48.35'
FOUND KEBS NAIL & TAG NORTH SIDE 30" MAPLE, S80°W, 150.15' WEST EDGE OF STOP SIGN, S30°E, 52.86'..."
DRAWING INDICATES N00°31'03"W 2644.86 FEET TO C-2 TO D-3 IS 2652.65 FEET
- 2007 UNRECORDED SURVEY OF THREE PARCELS IN SECTION 7 BY POLARIS SURVEYING COMPANY, DATED 3/19/2007, SIGNED AND SEALED BY RONNIE M. LESTER, P.S. No. 18998, SUBJECT CORNER DESCRIBED THUS, "... NORTHEAST CORNER SECTION 7, T2N, R2W, SET 3/4" BAR & CAP IN MONUMENT BOX.." WITNESSED BY, "... FOUND NAIL AND TAG #28414 WEST SIDE 12" MAPLE MAG. AZ. 10°, 55.61' FOUND BAR AND CAP #28414 MAG. AZ. 05°, 33.00'
FOUND NAIL & TAG #18998 NORTHEAST SIDE UTILITY POLE MAG. AZ. 315° 48.35'
FOUND NAIL & TAG #18998 WEST SIDE 24" SHAGBARK HICKORY MAG. AZ. 350° 49.33'

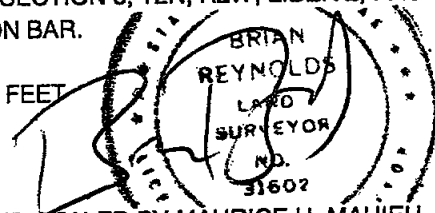

INGHAM COUNTY REMONUMENTATION
LAND CORNER RECORDATION CERTIFICATE
Filing Requirement of Act 74, Mich. P.A. 1970

For Corners in
INGHAM
(county)

Located In:

Corner Code #

1. Public Land Survey
NORTH 1/4 CORNER
SECTION 5
AURELIUS TOWNSHIP
ON TOWN LINE

T 2N R2W
T____ R____
T____ R____
T____ R____

D-1

B: 13 P: 135 09/25/2007 09:14 AM
2007-041772 LAND CORNERS Receipt #32274
Paula Johnson, Ingham County, Michigan

Pages: 2



2. Property Controlling S____ T____ R____
in Section S____ T____ R____

3. Miscellaneous S____ T____ R____

4. Lot No____, Recorded Plat____

5. Private Claims____

Register of Deeds Stamp & File Number

I, Brian Reynolds, in a field survey on August 16, 2007 do hereby certify that under requirements of P.A. 74, Michigan P.A. of 1970, the corner points mentioned in lines 1 and 2 above were in conformance with regulations and rules therefore as required in the current manual of survey instructions of the United States Department of the Interior, Bureau of Land Management or by a decree of a Court of Law and/or that the corner points mentioned in lines 3, 4, and 5 above were in conformance with the rules of the Michigan Board of Land Surveyors or by a Decree of a Court of Law; established, re-established, monumented, re-monumented, recovered, found as expressed below.

NOTE: Not more than 2 corners, in the same town and range, may be recorded on this certificate.

A. Description of original monument and accessories and/or subsequent restoration:

CLOSING QUARTER CORNER NOT MONUMENTED BY THE GENERAL LAND OFFICE SURVEY

1825 REGARDING THE CORRESPONDING STANDARD CORNER, GENERAL LAND OFFICE DEPUTY SURVEYOR JOHN MULLETT, MAY 1825, "...WEST ON S BDY 32 T3N R2W.....40.00 SET QR. (POST) (FROM WHICH) ELM 14 N80E .09 (ILLEGIBLE) 6 N78W 32 ..."

1856 INGHAM COUNTY SURVEYOR RECORD BY A. JACKSON, VOLUME 3, PAGE 122, "...DOUB MAPLE 18 S 3 W 38 MAPLE 14 S 70-1/2 E 46..."

CORNER HISTORY CONTINUED ON PAGE TWO

B. Description of corner evidence found and/or method applied in restoring or reestablishing corner:

FOUND A 4" X 36" CONCRETE MONUMENT WITH 1/2" X 38" REROD WITH CAP 18998 AND CONCRETE COLLAR WITH LID AS DESCRIBED BY SURVEYOR LESTER IN 1978. ALSO FOUND CYCLONE FENCE POST AS DESCRIBED BY SURVEYOR BEAVER (1999) AND SURVEYOR MAHIEU (2000), AND REMONUMENTED D-13, T3N R2W. DID NOT EXCAVATE, DUE TO PREVIOUS WELL DOCUMENTED EXTENSIVE EXCAVATION. ACCEPTED CORNER POSITION AS FOUND AND RESTORED BY SURVEYORS ROBB AND LESTER, AND AS PERPETUATED BY SURVEYORS BEAVER, MAHIEU, AND ENGER. TRAVERSED TO TIE IN SUBJECT CORNER, ADJACENT GRID CORNERS, AND CONTROLLING STANDARD CORNERS. MONUMENT AS FOUND IS 0.52 FEET SOUTH OF TOWN LINE AS DEFINED BY STANDARD CORNERS. DID NOT MOVE EXISTING MONUMENT TO TRUE TOWN LINE. CAPPED CONCRETE MONUMENT AS FOUND WITH STANDARD INGHAM COUNTY ALUMINUM CAP, WITNESSED AS DESCRIBED BELOW.

C. Description of monument for corner and accessories established to perpetuate locating the position of the corner:

WITNESSES TO CONCRETE MONUMENT WITH AN ALUMINUM CAP STAMPED "31602" IN MONUMENT BOX:
SET MAGNETIC NAIL & REMON TAG IN THE WEST SIDE OF A 12" ELM CLUSTER N15°E 32.06 FEET
SET MAGNETIC NAIL & REMON TAG IN THE SOUTHWEST SIDE OF A 12" TWIN POPLAR S40°E 36.50 FEET
SET MAGNETIC NAIL & REMON TAG IN THE NORTH SIDE OF A 10" POPLAR S70°W 78.70 FEET
2 1/2" STEEL FENCE POST S70°W 66.20 FEET D-13 T3N R2W EAST 40.01 FEET
TOWN LINE AS DEFINED BY CONTROLLING STANDARD CORNERS NORTH 0.52 FEET
N89°32'14"W 2656.71 FEET TO C-1 S89°40'35"E 2654.58 FEET TO E-1
S00°03'39"W 2740.36 FEET FROM MONUMENT AS FOUND TO D-2
ON CENTERLINE OF NICHOLS ROAD

P.A. 345 INGHAM COUNTY
PEER APPROVED 8/24/2007 RE

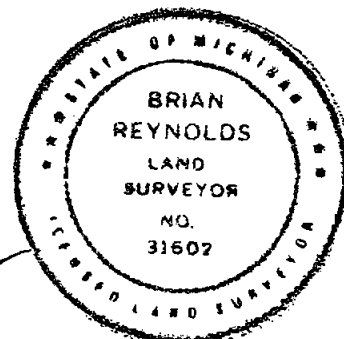

Signed by [Signature]
Surveyor's Michigan License No 31602

Date AUGUST 17, 2007

FORM APPROVED BY MICHIGAN STATE BOARD OF LAND SURVEYORS. JAN. 28, 1971
REVISED MAY 14, 1975 REVISED JANUARY, 1983 REVISED OCTOBER 1995

PAGE TWO

A. Description of original monument and accessories and/or subsequent restoration: **T2N R2W D-1 CONTINUED**

- 1880 T. J. BROWN, SURVEY OF SECTION 5 IN AURELIUS FOLDER CALLS FOR "...STONE SET UNDER CROSSWAY ..."
- 1912 INGHAM COUNTY SURVEYOR RECORD BY R. J. ROBB, VOLUME 2, PAGE 79, "...GAS PIPE MAPLE 22" N 30-1/2° E 51.5 FEET
MAPLE 24" N 52° W 39 FEET..."
- UNDATED INGHAM COUNTY ROAD COMMISSION CORNER WITNESS MAP FOR AURELIUS TOWNSHIP CALLS FOR
"...STONE & BRICK 30" ELM S.W. 79.0' 24" ELM S.W. 34.5' 6" MAPLE N.E. 34.0' ..."
- 1978 LAND CORNER RECORDATION CERTIFICATE BY RONNIE M. LESTER, P.S. 18998, COUNTERSIGNED BY GARY D. LESTER, P.S. 17624, DATED AUGUST 22, 1978, RECORDED AUGUST 23, 1978 IN LIBER 4, PAGE 294, PART A READS, "...NO RECORD OF CORNER BEING ESTABLISHED IN ORIGINAL GOVERNMENT SURVEY. PUBLIC COUNTY SURVEYOR RECORDS SHOW CORNER ESTABLISHED OR USED BY A. JACKSON, COUNTY SURVEYOR ON NOV. 1, 1856 (V.2, P.301), T.J.BROWN, COUNTY SURVEYOR CALLS FOR STONE AS MONUMENT IN SURVEY ON MAY 3, 1870 (V.3, P.52). SURVEY RECORDS OF R.J. ROBB, COUNTY SURVEYOR, CALL FOR MONUMENT OF GAS PIPE DATED APRIL, 1912 (V.2, P.79)..." PART B READS, "...EXCAVATED 5' X 10' HOLE TO AVERAGE DEPTH OF 5' CENTERED ON EXTENDED FIELD LINE AND 3.4' SOUTH OF CENTERLINE OF NICHOLS ROAD. FOUND 2" GAS PIPE SURROUNDED BY LARGE ROCKS AND BOUNDED BY TWO CEDAR POSTS, 2' APART AND 2.5 DOWN FROM THE SURFACE. ACCEPTED GAS PIPE AS CORNER AS CALLED FOR BY ROBB IN 1912 SURVEY. ROBB'S MEASUREMENT EAST RECORDED AT 2660'±, OUR MEASUREMENT 2660'±. EXCAVATION CONDUCTED BY INGHAM COUNTY SURVEY AND REMONUMENTATION PROJECT CREW..." PART C READS, "...NORTH 1/4 CORNER, SECTION 5, T2N-R2W SET 4" X 36" CONCRETE MONUMENT WITH 1/2" X 38" REROD WITH CAP #18998 AND CONCRETE COLLAR WITH LID AT LOCATION OF 2" GAS PIPE AS DESCRIBED ABOVE:
NAIL & TAG, #18998, NORTHWEST SIDE 26" OAK, SSW, 19.64'
NAIL & TAG, #18998, NORTHEAST SIDE 20" OAK, SSE, 26.26'
NAIL & TAG, #18998, SOUTHEAST SIDE 38" OAK, NNE, 38.95'
NAIL & TAG, #18998, WEST SIDE TWIN MAPLE, NNW, 31.36'
S 1/4 CORNER, SECTION 32, DELHI TWP., CONCRETE MONUMENT IN MONUMENT BOX, EAST, 40.07'..."
- 1999 ACT 132 SURVEY BY SOUTHERN MICHIGAN LAND SURVEYING, SIGNED AND SEALED BY PETER D. BEAVER, P.S. 25828, DATED 12-3-1999, RECORDED 8/04/2000 IN LIBER 8, PAGE 740, SUBJECT CORNER DESCRIBED THUS:
"...N 1/4 CORNER SECTION 5, T2N, R2W FOUND 1/2" ROD IN MON BOX @ L4, P294
S 1/4 CORNER SECTION 32, T3N, R2W, IRON IN MON BOX - EAST 40.08'
C/L 2" POST @ SW CORNER CYCLONE FENCE AZ=45° 66.14'
SET N/T #25828 E/S 12" MAPLE AZ=350° 54.96' SET N/T #25828 S/S 8" TREE AZ=105° 127.28' ..."
DRAWING INDICATES N89°36'23"W 2611.86 FEET TO C-13, S90°00'00"W FROM C-13 TO C-1
- 2000 ACT 132 SURVEY BY WOLVERINE ENGINEERS & SURVEYORS, INC., SIGNED AND SEALED BY MAURICE H. MAHIEU, P.S. 28414, DATED 8-16-00, RECORDED 10/13/2000 IN LIBER 8, PAGE 778, SUBJECT CORNER DESCRIBED THUS:
"...NORTH 1/4 CORNER SEC 5 T2N, R2W, AURELIUS TWP. 1/2" ROD IN MON. BOX @ L4, P294 WITNESSES:
S 1/4 COR., SEC 32, T3N, R2W, IRON IN MON. BOX, EAST 40.08'
C/L 2" POST @ SW CORNER CYCLONE FENCE, AZ=45° 66.14
N&T #25828 E. SIDE 12" MAPLE, AZ=350° 54.96' N&T #25828 S. SIDE 8" TREE, AZ=105° 127.28' ..."
DRAWING INDICATES N89°36'23"W 2611.86 FEET TO C-13, SEC 32., S90°00'00"W 44.88 FEET FROM C-13 TO C-1
- 2002 ACT 132 SURVEY BY ENGER SURVEYING & ENGINEERING, SIGNED AND SEALED BY RONALD L. ENGER, P.S. 28409, DATED AUGUST 1, 2002, RECORDED 6/19/2003 IN LIBER 8, PAGE 1125, SUBJECT CORNER DESCRIBED THUS: "...T2N, R2W NORTH 1/4 CORNER SECTION 5 RECORDED LIBER 4 PAGE 294, SET 4" X 36" CONCRETE MONUMENT WITH 1/2" X 38" REROD WITH CAP 18998 AND CONCRETE COLLAR WITH LID AT LOCATION OF 2" GAS PIPE
NAIL & TAG 18998 IN NW SIDE 26" OAK SSW 19.64' NAIL & TAG 18998 IN NE SIDE 20" OAK SSE 26.26'
NAIL & TAG 18998 IN SE SIDE 38" OAK NNE 38.95' NAIL & TAG 18998 IN WEST SIDE TWIN MAPLE NNW 31.36'
SOUTH 1/4 CORNER, SECTION 32, DELHI TWP., CONCRETE MONUMENT IN MONUMENT BOX EAST 40.07' ..."
DRAWING INDICATES N89°36'23"W 2611.75 FEET (PAGE 2 INDICATES 2611.76 FEET) TO C-13 SEC 32 AND S90°00'00"W 44.88 FEET FROM C-13 TO C-1.

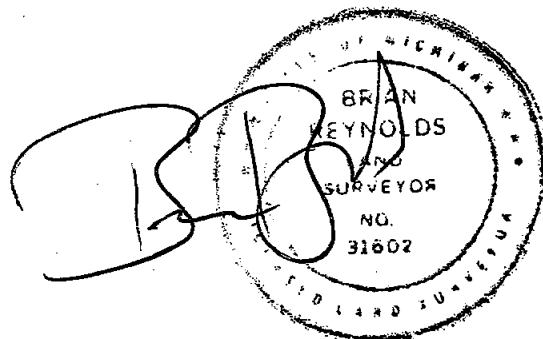

INGHAM COUNTY REMONUMENTATION
LAND CORNER RECORDATION CERTIFICATE
Filing Requirement of Act 74, Mich. P.A. 1970

For Corners in
INGHAM
(county)

Located In:

Corner Code #

1. Public Land Survey
CENTER 1/4 CORNER
SECTION 5
AURELIUS TOWNSHIP

T 2N R 2W D-2
T R
T R
T R

B: 13 P: 157 10/23/2007 11:02 AM Pages: 2
2007-045647 LAND CORNERS Receipt #33528
Paula Johnson, Ingham County, Michigan



2. Property Controlling S T R
in Section S T R

3. Miscellaneous S T R

4. Lot No., Recorded Plat

5. Private Claims

Register of Deeds Stamp & File Number

I, Brian Reynolds, in a field survey on August 16, 2007 do hereby certify that under requirements of P.A. 74, Michigan P.A. of 1970, the corner points mentioned in lines 1 and 2 above were in conformance with regulations and rules therefore as required in the current manual of survey instructions of the United States Department of the Interior, Bureau of Land Management or by a decree of a Court of Law and/or that the corner points mentioned in lines 3, 4, and 5 above were in conformance with the rules of the Michigan Board of Land Surveyors or by a Decree of a Court of Law; established, re-established, monumented, re-monumented, recovered, found as expressed below.

NOTE: Not more than 2 corners, in the same town and range, may be recorded on this certificate.

A. Description of original monument and accessories and/or subsequent restoration:

CENTER OF SECTION NOT MONUMENTED BY THE GENERAL LAND OFFICE SURVEY

1856 INGHAM COUNTY SURVEYOR RECORD BY A. JACKSON, VOLUME 3, PAGE 122, "...BEECH 8 N 43 W 26
Do 20 S 3 E 5-1/2..."

1880 T. J. BROWN, SURVEY OF SECTION 5 IN AURELIUS FOLDER CALLS FOR "...BEECH 8 N43W 26 Do. 20 S33E 1..."

NO CORNER INFORMATION ON THE INGHAM COUNTY ROAD COMMISSION WITNESS MAP FOR AURELIUS TOWNSHIP.

NOT PREVIOUSLY RECORDED UNDER ACT 74

CORNER HISTORY CONTINUED ON PAGE TWO

B. Description of corner evidence found and/or method applied in restoring or reestablishing corner:

FOUND A 1/2" IRON AT THE 4-WAY INTERSECTION OF FENCES IN DISREPAIR, MOSTLY DOWN. ALSO FOUND ALL WITNESSES BY ENGER, ASH WITNESS NOW A STUMP. TRAVERSE OF SECTION 5 DISCLOSES THAT THE IRON AS FOUND IS 2.89 FEET SOUTH AND 0.24 FEET EAST OF DIRECT LINES CONNECTING EXTERIOR QUARTER CORNERS. ACCEPTED FOUND IRON AS PROPER ESTABLISHMENT OF SUBJECT CORNER AS ORIGINALLY MONUMENTED BY UNKNOWN SURVEYOR AND AS PERPETUATED BY SURVEYORS ENGER AND AUTENRIETH. REPLACED FOUND IRON WITH 3/4" X 24" FORM PIN WITH AN ALUMINUM CAP STAMPED "31602", WITNESSED AS DESCRIBED BELOW.

C. Description of monument for corner and accessories established to perpetuate locating the position of the corner:

WITNESSES TO 3/4" X 24" STEEL FORM PIN WITH AN ALUMINUM CAP STAMPED "31602"
FOUND NAIL IN THE WEST SIDE OF A 12" HICKORY SOUTH 7.34'
FOUND PK NAIL IN THE SOUTHWEST SIDE OF A 12" STUMP N20°W 22.74'
FOUND NAIL IN THE NORTH SIDE OF A 30" CHERRY S85°W 29.11'
SET MAGNETIC NAIL & REMON TAG IN THE SOUTHWEST SIDE OF A 30" MAPLE N55°E 24.65'
SET MAGNETIC NAIL & REMON TAG IN THE SOUTH SIDE OF A 24" BEECH EAST 36.15'
N00°03'39"E 2740.36 FEET TO D-1 S00°04'15"W 2638.15 FEET TO D-3
N89°24'13"W 2659.13 FEET TO C-2 N89°31'42"W 2662.80 FEET TO E-2
FENCES NORTH, SOUTH, EAST AND WEST (MOSTLY DOWN)

P.A. 345 INGHAM COUNTY
PEER APPROVED 9/25/2007 *m*

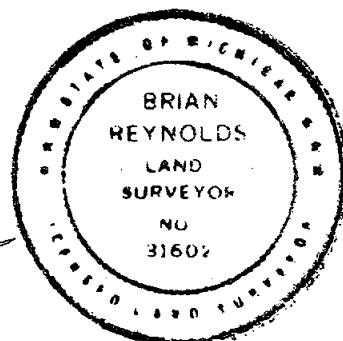

Signed by [Signature]
Surveyor's Michigan License No 31602

Date AUGUST 17, 2007

FORM APPROVED BY MICHIGAN STATE BOARD OF LAND SURVEYORS. JAN. 28, 1971

REVISED MAY 14, 1975 REVISED JANUARY, 1983 REVISED OCTOBER 1995

PAGE TWO

A. Description of original monument and accessories and/or subsequent restoration: T2N R2W D-2 CONTINUED

- 1999 ACT 132 SURVEY BY ENGER SURVEYING & ENGINEERING, SIGNED AND SEALED BY RONALD L. ENGER, P.S. 28409, DATED OCTOBER 26, 1999, RECORDED 5/09/2001 IN LIBER 8, PAGE 850, SUBJECT CORNER DESCRIBED THUS: "...CENTER SECTION 5 FOUND 1/2" BAR & CAP (PS 18989) IN OLD FENCE CORNER POST HOLE
NAIL & TAG (PS 18989) IN WEST SIDE 10" HICKORY S05°W 7.40'
NAIL & TAG (PS 25837) IN NORTH SIDE 19" CHERRY WEST 29.11'
NAIL & TAG (PS 18989) IN SW SIDE 14" ASH N19°W 22.66'
NAIL & TAG (PS 25837) IN NORTH SIDE 19" BEECH S85°E 35.93' ..."
DRAWING INDICATES S00°33'13"E 2638.29 FEET TO D-3
- 2002 ACT 132 SURVEY BY ENGER SURVEYING & ENGINEERING, SIGNED AND SEALED BY RONALD L. ENGER, P.S. 28409, DATED JULY 9, 2002, RECORDED 6/19/2003 IN LIBER 8 PAGE 1124, SUBJECT CORNER DESCRIBED THUS: "...T2N R2W CENTER SECTION 5, FOUND 1/2" BAR & CAP 18989 IN OLD FENCE CORNER POST HOLE
NAIL & TAG #18989 IN WEST SIDE 10" HICKORY S05°W 7.40'
NAIL & TAG #25837 IN NORTH SIDE 19" CHERRY WEST 29.11'
NAIL & TAG #18998 IN SW SIDE 14" ASH SW N19°W 22.66'
NAIL & TAG #25837 IN NORTH SIDE 19" BEECH S85°E 35.93' ..."
- 2002 ACT 132 SURVEY BY ENGER SURVEYING & ENGINEERING, SIGNED AND SEALED BY RONALD L. ENGER, P.S. 28409, DATED AUGUST 1, 2002, RECORDED 6/19/2003 IN LIBER 8, PAGE 1125, SUBJECT CORNER DESCRIBED THUS: "...CENTER SECTION 5 FOUND 1/2" BAR & CAP 18989 IN OLD FENCE CORNER POST HOLE
NAIL & TAG 18989 IN WEST SIDE 10" HICKORY S05°W 7.40'
NAIL & TAG 25837 IN NORTH SIDE 19" CHERRY WEST 29.11'
NAIL & TAG 18989 IN SW SIDE 14" ASH N19°W 22.66'
NAIL & TAG 25837 IN NORTH SIDE 19" BEECH S85°E 35.93' ..."
DRAWING INDICATES N89°28'07"W 2659.17 FEET TO C-2.
- 2006 ACT 132 SURVEY BY KEBS, INC, SIGNED AND SEALED BY JEFFREY K. AUTENRIETH, P.S. 31588, DATED 3-6-06, RECORDED 5/26/06 IN LIBER 9 PAGE 308, SUBJECT CORNER DESCRIBED THUS: "...CENTER OF SECTION 5, T2N, R2W FOUND BAR & CAP # 18988 AT NORTH BASE OF FALLEN ANCHOR POST, FENCE SOUTH, REMNANTS WEST, NORTH AND EAST FOUND NAIL & TAG #18988 WEST SIDE 12" ASH, NORTH, 7.36'
FOUND NAIL & TAG #18988 NORTH SIDE 4" DEAD ELM, EAST 16.80'
FOUND NAIL & TAG #25837 NORTH SIDE 18" BEECH, EAST, 35.87'
FOUND NAIL & TAG #25837 NORTH SIDE 16" CHERRY, WEST, 29.05'
FOUND NAIL & TAG #18988 WEST SIDE 12" HICKORY, NORTH, 22.67' ..."
DRAWING INDICATES N89°51'28"W 2659.19 FEET TO C-2, S00°22'37"E 2275.21 FEET TO D-3.

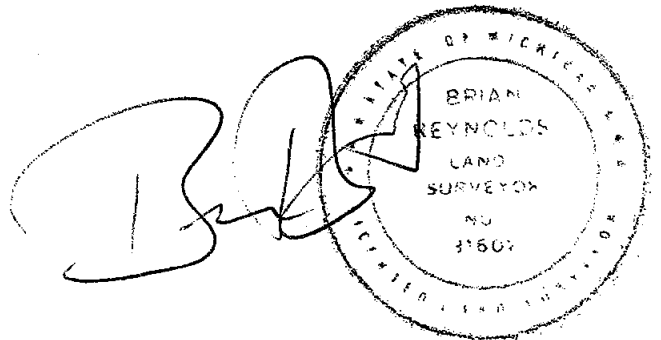

INGHAM COUNTY REMONUMENTATION
LAND CORNER RECORDATION CERTIFICATE
Filing Requirement of Act 74, Mich. P.A. 1970

For Corners in
INGHAM
(county)

Located In:

Corner Code #

1. Public Land Survey
**1/4 CORNER COMMON
TO SECTIONS 5 & 8
AURELIUS TOWNSHIP**

T 2N R2W
T____ R____
T____ R____
T____ R____

D-3

B: 13 P: 136 09/25/2007 09:14 AM
2007-041773 LAND CORNERS Receipt #32274
Paula Johnson, Ingham County, Michigan

Pages: 2



2. Property Controlling S____ T____ R____
in Section S____ T____ R____

Register of Deeds Stamp & File Number

3. Miscellaneous S____ T____ R____

4. Lot No_____, Recorded Plat_____

5. Private Claims_____

I, Brian Reynolds, in a field survey on August 17, 2007 do hereby certify that under requirements of P.A. 74, Michigan P.A. of 1970, the corner points mentioned in lines 1 and 2 above were in conformance with regulations and rules therefore as required in the current manual of survey instructions of the United States Department of the Interior, Bureau of Land Management or by a decree of a Court of Law and/or that the corner points mentioned in lines 3, 4, and 5 above were in conformance with the rules of the Michigan Board of Land Surveyors or by a Decree of a Court of Law; established, re-established, monumented, re-monumented, recovered, found as expressed below.

NOTE: Not more than 2 corners, in the same town and range, may be recorded on this certificate.

A. Description of original monument and accessories and/or subsequent restoration:

- 1826 GENERAL LAND OFFICE DEPUTY SURVEYOR HERVEY PARKE, FEBRUARY, 1826,
"... 40.17 SET QR (POST) (FROM WHICH) BE 7 N25W 10 Do 12 S1-1/2E 29 ..."
- 1854 INGHAM COUNTY SURVEYOR RECORD BY A. JACKSON, VOLUME 1, PAGE 386, "...BEECH 7 N 25 W 10
Do 12 S 1-1/2 E 29..."
- 1867 INGHAM COUNTY SURVEYOR RECORD BY THOS. J. BROWN, DEP. CO. SURVEYOR, VOLUME 2, PAGE 52, "...NO TREES
BUT A POST DOWN BELOW THE SURFACE..."
- UNDATED INGHAM COUNTY ROAD COMMISSION CORNER WITNESS MAP FOR AURELIUS TOWNSHIP CALLS FOR
"...STONE 10" MAPLE N.W. 95.5' 10" CHERRY N. 33.3' ..."
- 1972 ACT 132 SURVEY BY WOLVERINE ENGINEERING CO., SIGNED AND SEALED BY GEORGE M. YOUNG, P.S. 17640, DATED
JUNE 19, 1972, RECORDED JUNE 20, 1972 IN LIBER 1 PAGE 290, SUBJECT CORNER DESCRIBED THUS: "...FOUND
BOAT SPIKE S 1/4 COR. SEC. 5, T2N R2W ..." NO WITNESSES CITED.
- 1972 ACT 132 SURVEY BY POLARIS ASSOCIATES INC, SIGNED AND SEALED BY RONNIE M. LESTER, P.S. 18998, DATED
12-1-72, RECORDED FEBRUARY 2, 1973 IN LIBER 1 PAGES 595 & 596, SUBJECT CORNER DESCRIBED THUS: "...N 1/4
CORNER SECTION 8, T2N R2W
SET NAIL & TAG NE SIDE 32" MAPLE, SOUTH, 30.43' SET NAIL & TAG EAST SIDE MAPLE, NORTH, 83.73'
SET NAIL & TAG SW SIDE 8" MAPLE, NW, 43.84'..." DRAWING INDICATES 2653.01 FEET TO C-3
CORNER HISTORY CONTINUED ON PAGE TWO

B. Description of corner evidence found and/or method applied in restoring or reestablishing corner:

TWO OF SURVEYOR LESTER'S 1972 MAPLE WITNESSES REMAIN, NAILS OVERGROWN. ON INITIAL VISIT TO THIS CORNER (MARCH 2007), FOUND TWO BOAT SPIKES IN A MONUMENT BOX. TRAVERSED SECTION 5, TIED IN FOUND MONUMENTATION THROUGHOUT, INCLUDING BOTH BOAT SPIKES. RESULTING MEASUREMENTS WERE INCONCLUSIVE BETWEEN THE TWO SPIKES. RETURNED ON AUGUST 17, 2007, ONE OF THE BOAT SPIKES HAD BEEN REMOVED. SET OFFSETS FOR REMAINING BOAT SPIKE, EXCAVATED THROUGH MONUMENT BOX, FOUND NO EVIDENCE OF PRIOR MONUMENTATION. ACCEPTED REMAINING BOAT SPIKE AS PROPER PERPETUATION OF CORNER POSITION. REPLACED WITH STANDARD IRON AND CAP WITNESSED AS DESCRIBED BELOW.

C. Description of monument for corner and accessories established to perpetuate locating the position of the corner:

WITNESSES TO 3/4" X 24" STEEL FORM PIN WITH AN ALUMINUM CAP STAMPED "31602" IN MONUMENT BOX
SET MAGNETIC NAIL & REMON TAG IN THE SOUTHWEST SIDE OF A 32" ASH N40°W 43.26 FEET
FOUND NAIL & TAG "KEBS 31588" IN THE WEST SIDE OF A UTILITY POLE N04°W 47.38 FEET
FOUND NAIL & TAG "KEBS 31588" IN THE WEST SIDE OF A 12" ASH S25°E 36.76 FEET
FOUND NAIL & TAG "KEBS 31588" IN THE NORTH SIDE OF A 20" WALNUT S66°W 72.84 FEET
N89°32'46"W 2652.85 FEET TO C-3 N00°04'15"E 2638.15 FEET TO D-2 S89°22'10"E 2661.58 FEET TO E-3

P.A. 345 INGHAM COUNTY
PEER APPROVED 8/21/2007 me

Signed by [Signature]
Surveyor's Michigan License No 31602

Date AUGUST 17, 2007

FORM APPROVED BY MICHIGAN STATE BOARD OF LAND SURVEYORS, JAN 28, 197

REVISED MAY 14, 1975 REVISED JANUARY, 1983 REVISED OCTOBER 1995

PAGE TWO

A. Description of original monument and accessories and/or subsequent restoration: T2N R2W D-3 CONTINUED

- 1972 LAND CORNER RECORDATION CERTIFICATE BY RONNIE M. LESTER, P.S. 18998, DATED DECEMBER 4, 1972, RECORDED FEBRUARY 2, 1973 IN LIBER 2, PAGE 303, PART A READS, "...ORIGINAL MONUMENT AND ACCESSORIES OBLITERATED..." PART B READS, "...FOUND 1" BOATSPIKE IN CENTERLINE COLUMBIA ROAD AND ON FENCE LINE NORTH AND SOUTH..." PART C READS, "...N 1/4 CORNER SECTION 8 SET NAIL & TAG EAST NE 32" MAPLE, SOUTH, 30.43 SET NAIL & TAG EAST SIDE MAPLE, NORTH, 82.73' SET NAIL & TAG SW SIDE 8" MAPLE, NW, 43.84'..."
- 1976 ACT 132 SURVEY BY FRED WHITE ENGINEERING COMPANY, INC, SIGNED AND SEALED BY RON HELSEL, P.S. 18994, DATED FEBRUARY 24, 1976, RECORDED MARCH 23, 1976 IN LIBER 2, PAGE 647, SUBJECT CORNER DESCRIBED THUS: "...N 1/4 COR. SEC. 8, T2N-R2W, WITNESS TO N 1/4 COR: LIBER 2, PG. 303) N. & T. NE SIDE 32" MAPLE SOUTH 30.48' N. & T. E. SIDE MAPLE NORTH 82.73' N. & T. SW SIDE 8" MAPLE NW 43.84'..."
- 1977 ACT 132 SURVEY BY POLARIS SURVEYING CO., SIGNED AND SEALED BY RONNIE LESTER, P.S. 18998, DATED 9/2/77, RECORDED SEPTEMBER 29, 1977 IN LIBER 3, PAGES 59 & 60, SUBJECT CORNER DESCRIBED THUS: "...NORTH 1/4 CORNER SECTION 8, T2N, R2W NAIL & TAG NE SIDE 32" MAPLE, SOUTH, 30.43' NAIL & TAG EAST SIDE MAPLE, NORTH, 82.73' NAIL & TAG SW SIDE 8" MAPLE, NW 43.84'..." DRAWING INDICATES S 89-15-07 E 2661.62 FEET TO E-3.
- 1978 ACT 132 SURVEY BY POLARIS SURVEYING CO., SIGNED AND SEALED BY RONNIE LESTER, P.S. 18998, DATED 1/30/78, RECORDED MARCH 30, 1978 IN LIBER 3, PAGES 329 & 330, SUBJECT CORNER DESCRIBED THUS: "...NORTH 1/4 CORNER SECTION 8, T2N, R2W NAIL & TAG NE SIDE 32" MAPLE, SOUTH, 30.43' NAIL & TAG EAST SIDE MAPLE, NORTH, 82.73' NAIL & TAG SW SIDE 8" MAPLE, NW 43.84'..." DRAWING INDICATES S 89° 13'07" E 2661.62 FEET TO E-3.
- 1983 ACT 132 SURVEY SIGNED AND SEALED BY MARVIN F. FOUTY, P.S. 18989, DATED MAY 31, 1983, RECORDED DATE ILLEGIBLE IN LIBER 4 PAGES 1089 & 1090, SUBJECT CORNER DESCRIBED THUS: "...N 1/4 CORNER SEC. 8, T2N, R2W FOUND NAIL AND TAG NE/S 32" MAPLE SOUTH 30.43' FOUND NAIL AND TAG E/SIDE MAPLE, NORTH, 83.73' FOUND NAIL AND TAG SW/SIDE 10" MAPLE, NW 43.84'..."
- 1993 ACT 132 SURVEY BY POLARIS SURVEYING CO., SIGNED AND SEALED BY RONNIE M. LESTER, P.S. 18998, DATED APRIL 6, 1993, RECORDED MAY 3, 1993 IN LIBER 6 PAGES 1217 - 1219, SUBJECT CORNER DESCRIBED THUS: "...WITNESSES TO GOVERNMENT CORNERS: NORTH 1/4 CORNER SECTION 8, T2N, R2W. BOATSPIKE. LIBER 2, PAGE 303. NORTHEAST CORNER FOUNDATION HOUSE #5741, 207°AZ., 96.3' SOUTHEAST CORNER FOUNDATION HOUSE #5756, 355°AZ., 116.8' SET NAIL AND TAG NE SIDE 40" MAPLE, 184°AZ., 30.8' SET NAIL AND TAG SW SIDE 18" PIGNUT, 328°AZ., 43.8'..." DRAWING INDICATES S 89° 15'07" E 2661.62 FEET TO E-3.
- 1998 SEVERAL ACT 132 SURVEYS BY POLARIS SURVEYING CO., SIGNED AND SEALED BY RONNIE M. LESTER, P.S. 18998, DATED 6/29/98 AND 8/28/98, RECORDED 08/17/1998 IN LIBER 8 PAGES 298-299 AND PAGES 300-301, AND 09/28/1998 IN LIBER 8, PAGES 307 & 308 SUBJECT CORNER DESCRIBED THUS AS WITNESSED ABOVE IN 1993 SURVEY BY POLARIS. DRAWING INDICATES S89°15'07" E 2661.72 FEET TO E-3.
- 1999 ACT 132 SURVEY BY ENGER SURVEYING & ENGINEERING, SIGNED AND SEALED BY RONALD L. ENGER, P.S. 28409, DATED OCTOBER 26, 1999, RECORDED 05/09/2001 IN LIBER 8 PAGE 850, SUBJECT CORNER DESCRIBED THUS: "...T2N R2W S 1/4 CORNER SECTION 5, RECORDED LIBER 2 PAGE 303 1" BOATSPIKE NAIL & TAG (PS 18998) IN SW SIDE 24" ASH NW 43.75' NAIL & TAG (PS 18998) IN W SIDE 30" MAPLE NORTH 83.0' NAIL & TAG (PS 18998) IN N SIDE 18" WALNUT SW 73.30' NAIL & TAG (PS 18998) IN W SIDE 6" ASH SOUTH 36.2' ..." DRAWING INDICATES N90°00'00"E 2661.70 FEET TO E-3.
- 2001 ACT 132 SURVEY BY POLARIS SURVEYING CO., SIGNED AND SEALED BY RONNIE M. LESTER, P.S. 18998, DATED MAR 00, RECORDED 04/18/2000 IN LIBER 8, PAGE 701, SUBJECT CORNER DESCRIBED THUS: "...NORTH 1/4 CORNER SECTION 8 T2N, R2W BOATSPIKE, LIBER 2, PAGE 303..." WITNESSES SAME AS RECITED IN 1993 BY POLARIS DRAWING INDICATES S89°15'07"E 2661.72 FEET TO E-3.
- 2002 ACT 132 SURVEY BY POLARIS SURVEYING CO., SIGNED AND SEALED BY RONNIE LESTER, P.S. 18998, DATED 4/18/2002, RECORD 05/13/2002 IN LIBER 8, PAGE 986, SUBJECT CORNER DESCRIBED THUS: "...NORTH 1/4 CORNER SECTION 8, T2N, R2W. BOATSPIKE. LIBER 2, PAGE 303. NORTHEAST CORNER FOUNDATION HOUSE #5741, 207°AZ., 96.3' SOUTHEAST CORNER FOUNDATION HOUSE #5756, 355°AZ., 116.8' FOUND NAIL AND TAG #18998 NE SIDE 40" MAPLE, 184°AZ., 30.8' FOUND NAIL AND TAG #18998 SW SIDE 18" PIGNUT, 328°AZ., 43.8' ..." DRAWING INDICATES S89°15'07"E 2661.72 FEET TO E-3.
- 2002 ACT 132 SURVEY BY ENGER SURVEYING & ENGINEERING, SIGNED AND SEALED BY RONALD L. ENGER, P.S. 28409, DATED JULY 9, 2002, RECORDED 6/19/2003 IN LIBER 8 PAGE 1124, SUBJECT CORNER DESCRIBED THUS: "...T2N R2W S 1/4 CORNER SECTION 5, RECORDED LIBER 2 PAGE 303 FOUND 1" BOATSPIKE NAIL & TAG #18998 IN SW SIDE 24" ASH NW 43.75' NAIL & TAG #18998 IN WEST SIDE 30" MAPLE NORTH 83.0' NAIL & TAG #18998 IN NORTH SIDE 18" WALNUT SW 73.30' NAIL & TAG #18998 IN WEST SIDE 6" ASH SOUTH 36.2' ..." DRAWING INDICATES S89°15'07"E 2661.72 FEET TO E-3.
- 2003 ACT 132 SURVEY BY POLARIS SURVEYING CO., SIGNED AND SEALED BY RONNIE LESTER, P.S. 18998, DATED 1/06/04, RECORD 03/04/2004 IN LIBER 9, PAGE 33, SUBJECT CORNER DESCRIBED THUS: "...NORTH 1/4 CORNER SECTION 8, T2N, R2W. BOATSPIKE. LIBER 2, PAGE 303. NORTHEAST CORNER FOUNDATION HOUSE #5741, 207°AZ., 96.3' SOUTHEAST CORNER FOUNDATION HOUSE #5756, 355°AZ., 116.8' FOUND NAIL AND TAG #18998 NE SIDE 40" MAPLE, 184°AZ., 30.8' FOUND NAIL AND TAG #18998 SW SIDE 18" PIGNUT, 328°AZ., 43.8' ..." DRAWING INDICATES S89°15'07"E 2661.72 FEET TO E-3.
- 2006 ACT 132 SURVEY BY KEBS, INC, SIGNED AND SEALED BY JEFFREY K. AUTENRIETH, P.S. 31588, DATED 3-6-06, RECORDED 5/26/06 IN LIBER 9 PAGE 308, SUBJECT CORNER DESCRIBED THUS: "...SOUTH 1/4 CORNER SECTION 5, T2N, R2W FOUND 5/8" BAR IN MON BOX IN C/L OF COLUMBIA ROAD SET NAIL & TAG EAST SIDE 28" ASH, N40°W, 43.23' SET NAIL & TAG NORTH SIDE 20" WALNUT, S78°W, 72.85' FOUND KEBS NAIL & TAG WEST SIDE 8" BOX ELDER, S40°E, 36.82' ..." DRAWING INDICATES 2652.65 FEET TO C-3, N00°33'37"W 2275.21 FEET TO D-2.

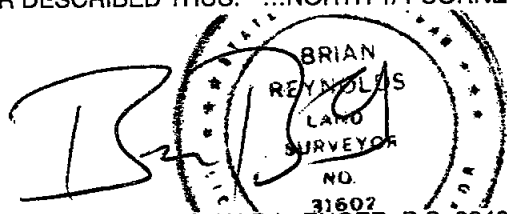

INGHAM COUNTY REMONUMENTATION
LAND CORNER RECORDATION CERTIFICATE
Filing Requirement of Act 74, Mich. P.A. 1970

For Corners in
INGHAM
(county)

Located In: Corner Code #

1. Public Land Survey
**CORNER COMMON
TO SECTIONS 4 & 5
AURELIUS TOWNSHIP**

T 2N R R2W E-1
T _____ R _____
T _____ R _____
T _____ R _____

B: 13 P: 137 09/25/2007 09:14 AM
2007-041774 LAND CORNERS Receipt #32274
Paula Johnson, Ingham County, Michigan

Pages: 2



2. Property Controlling S _____ T _____ R _____
in Section S _____ T _____ R _____



Register of Deeds Stamp & File Number

3. Miscellaneous S _____ T _____ R _____

4. Lot No _____, Recorded Plat _____

5. Private Claims _____

I, Brian Reynolds, in a field survey on August 16, 2007 do hereby certify that under requirements of P.A. 74, Michigan P.A. of 1970, the corner points mentioned in lines 1 and 2 above were in conformance with regulations and rules therefore as required in the current manual of survey instructions of the United States Department of the Interior, Bureau of Land Management or by a decree of a Court of Law and/or that the corner points mentioned in lines 3, 4, and 5 above were in conformance with the rules of the Michigan Board of Land Surveyors or by a Decree of a Court of Law; established, re-established, monumented, re-monumented, recovered, found as expressed below.

NOTE: Not more than 2 corners, in the same town and range, may be recorded on this certificate.

A. Description of original monument and accessories and/or subsequent restoration:

1825 REGARDING THE CORRESPONDING STANDARD CORNER, MAY 1825, GENERAL LAND OFFICE DEPUTY SURVEYOR JOHN MULLETT, MAY 1825, "...WEST ON S BDY 34 T3N R2W.....80.00 SET (POST) COR 33 & 34 (FROM WHICH) BE 7 N40E 28 Do 6 N72W 20 ..."

CORNER HISTORY CONTINUED ON PAGE TWO

B. Description of corner evidence found and/or method applied in restoring or reestablishing corner:

THE POWER POLE WITNESS FROM 1978 REMAINS, AS DOES THE MAPLE NORTHEAST, NOW OBSCURED BY DENSE SHRUBBERY. FOUND A CONCRETE MONUMENT IN A CONCRETE ENCLOSURE FILLED WITH CONCRETE. DUE TO EXTENSIVE EXCAVATION PERFORMED AND VERY WELL DOCUMENTED IN 1978 AS RECORDED BY SURVEYORS LESTER, DID NOT PERFORM EXTENSIVE EXCAVATION AT THIS TIME. HOWEVER, THE CONFLICTING EVIDENCE FROM 1978, THAT BEING THE DISCREPANCY BETWEEN THE REPORTED GLO FALLING AND THE MEASURED DISTANCE TO E-13, T3N R2W, HAS SINCE BEEN RESOLVED IN FAVOR OF THE POSITION OF THE SUBJECT CLOSING CORNER. E-13 AS REMONUMENTED IN 2005 AND AS RECORDED IN LIBER 12 ON PAGE 186, HOLDS THE POSITION OF THE SUBJECT CLOSING CORNER AS MONUMENTED IN 1978 FOR CONTROLLING THE LOCATION OF THE CORRESPONDING STANDARD CORNER AND CONTROLLING THE LOCATION OF THE TOWN LINE. THE LOCATION OF THE SUBJECT CORNER IS THUS CORRECT BY DEFINITION.

THE MONUMENT AND ENCLOSURE COULD NOT BE LEFT AS FOUND, AS THE CONCRETE FILLING THE ENCLOSURE INCLUDED SOME REINFORCING MESH THAT WAS LEFT EXPOSED ABOVE THE BITUMINOUS PAVEMENT. REMOVED THE MESH, AND MOST OF THE CONCRETE SURROUNDING THE MONUMENT, BUT IN THE PROCESS, DESTROYED THE ORIGINAL CONCRETE ENCLOSURE. REPLACED THE CONCRETE ENCLOSURE WITH A MODERN CAST IRON MONUMENT BOX, LEFT THE CONCRETE MONUMENT IN PLACE, CAPPED THE MONUMENT WITH A STANDARD INGHAM COUNTY REMONUMENTATION ALUMINUM CAP STAMPED "31602" AND WITNESSED AS DESCRIBED BELOW.

C. Description of monument for corner and accessories established to perpetuate locating the position of the corner:

WITNESSES TO CONCRETE MONUMENT WITH AN ALUMINUM CAP STAMPED "31602" IN MONUMENT BOX FOUND NAIL & TAG No. 31602 IN THE SOUTHWEST SIDE OF A UTILITY POLE N05°W 44.68 FEET FOUND "PK" NAIL IN THE SOUTHEAST SIDE OF THE SAME UTILITY POLE N05°W 44.74 FEET FOUND NAIL & TAG No. 31602 IN THE SOUTH SIDE OF A 24" WALNUT N80°E 124.14 FEET FOUND NAIL & TAG No. 28414 (MAURICE E. MAHIEU, P.S.) IN THE SW SIDE OF A UTILITY POLE N05°W 44.68 FEET SET MAGNETIC NAIL & REMON TAG IN THE SOUTH SIDE OF A 12" MAPLE N68°W 97.58 FEET N89°40'35"W 2662.10 FEET TO D-1 S89°19'17"E 2661.15 FEET TO F-1 S00°02'50"W 2747.24 FEET TO E-2 E-13 T3N R2W EAST 35.64 FEET 8± FEET WEST OF PROJECTED CENTERLINE SOUTH

Signed by _____
Surveyor's Michigan License No 31602

P.A. 345 INGHAM COUNTY
PEER APPROVED 8/21/2007

Date AUGUST 17, 2007

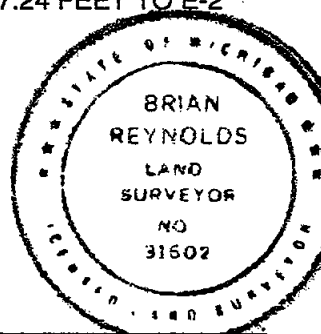

FORM APPROVED BY MICHIGAN STATE BOARD OF LAND SURVEYORS. JAN. 28, 1971

REVISED MAY 14, 1975 REVISED JANUARY, 1983 REVISED OCTOBER 1995

PAGE TWO

NOTE: Not more than 2 corners, in the same town and range, may be recorded on this certificate. T2N R2W E-1 CONTINUED

1826 REGARDING THE SUBJECT CLOSING CORNER, GENERAL LAND OFFICE DEPUTY SURVEYOR HERVEY PARKE, FEBRUARY, 1826 "...NORTH BTW 4 & 5..... 81.49 INT N BDY 54 (LINKS) W OF (POST) SET (POST) COR 4 & 5 (FROM WHICH) LN 22 S84E 19 BE 7 S21W 33 ..." A MARGINAL NOTE, NO NAME OR DATE, ADDS THE FOLLOWING: "...WHITE ASH 10 IN. N20°E 49 LKS NEW ..."

1880 T. J. BROWN, SURVEY OF SECTION 5 IN AURELIUS FOLDER CALLS FOR "...STONE W. ASH 10 N20E 49 ..."

1912 INGHAM COUNTY SURVEYOR RECORD BY R. J. ROBB, VOLUME 2, PAGE 79, "...BUGGY AXLE S.E. COR. SCH HOUSE N-W 111.75 FEET B. WALNUT 14" N-E 81 FEET..."

NO CORNER INFORMATION ON THE INGHAM COUNTY ROAD COMMISSION WITNESS MAP FOR AURELIUS TOWNSHIP.

1978 LAND CORNER RECORDATION CERTIFICATE BY RONNIE M. LESTER, P.S. 18998, COUNTERSIGNED BY GARY D. LESTER, P.S. 17624, DATED AUGUST 31, 1978, RECORDED SEPTEMBER 5, 1978 IN LIBER 4, PAGE 333, PART A READS, "...POST SET BY MUSGROVE EVANS IN ORIGINAL GOVERNMENT SURVEY BETWEEN DEC. 24, 1826 - JAN. 8, 1827. CORNER IDENTIFIED AS STONE BY T.J. BROWN, COUNTY SURVEYOR, IN SURVEY DATED MAY 3, 1870 (V.3, P.52). CORNER IDENTIFIED AS BUGGY AXLE BY R.J. ROBB, COUNTY SURVEYOR, IN SURVEY DATED 1912 (V.2, P.79 COPY)..." PART B READS, "...EXCAVATED HOLE 20.6' X 8' TO AN AVERAGE DEPTH OF 2.7' IN CENTERLINE OF NICHOLS ROAD AND WEST OF CENTERLINE OF ONONDAGA ROAD. FOUND 1/2" BOAT SPIKE IN CENTERLINE OF NICHOLS ROAD AND 13.5'± WEST OF THE CENTERLINE OF ONONDAGA ROAD. FOUND 1" X 21" BUGGY AXLE IN UPRIGHT POSITION SURROUNDED BY 5 LARGE ROCKS, 2' BELOW SURFACE, 35'± WEST OF EXTENDED PHYSICAL CENTERLINE OF ONONDAGA ROAD TO NORTH AND ON PHYSICAL CENTERLINE OF NICHOLS ROAD. ACCEPTED BUGGY AXLE AS CORNER DESCRIBED BY R.J. ROBB IN SURVEY DATED 1912. FALLING RECORDED TO BE 35.64' IN G.L.O. MEASURED 32.64' TO 1/2" BAR E-13, DELHI TWP., T3N-R2W AS RECORDED IN L.3, P.93, (PA 74). EXCAVATION CONDUCTED BY INGHAM COUNTY SURVEY AND REMONUMENTATION PROJECT CREW..." PART C READS, "...NORTHWEST CORNER, SECTION 4, T2N-R2W SET 4" X 36" CONCRETE MONUMENT WITH 1/2" X 38" REROD WITH CAP #18998, AND CONCRETE COLLAR WITH COVER AT LOCATION OF BUGGY AXLE DESCRIBED ABOVE: NAIL & TAG, #18998, SOUTH SIDE 18" MAPLE, WNW, 152.94' FOUND P.K. NAIL, NORTHWEST SIDE 36" WALNUT, NE, 81.90' FOUND P.K. NAIL, SOUTHEAST SIDE POWER POLE, NE, 86.98' FOUND P.K. NAIL, NORTHEAST SIDE POWER POLE, SSE, 100.23' 1/2" BAR, E-13, DELHI TWP., T3N-R2W, EAST, 32.64'..."

1980 ACT 132 SURVEY BY WILLIAMS SURVEYING, SIGNED AND SEALED BY AUSTIN C. WILLIAMS, P.S. 21275, NO DATE, RECORDED APRIL 29, 1980 IN LIBER 3, PAGES 1275 & 1276, SUBJECT CORNER DESCRIBED THUS: "...NW CORNER SEC. 4, T2N, RW2 NAIL & TAG IN S/S 18" MAPLE WNW 152.94' PK NAIL IN NW/S 36" WALNUT NE 81.90' PK NAIL IN NE/S POWER POLE SSE 100.23' PK NAIL IN SE/S POWER POLE NE 86.98'..."

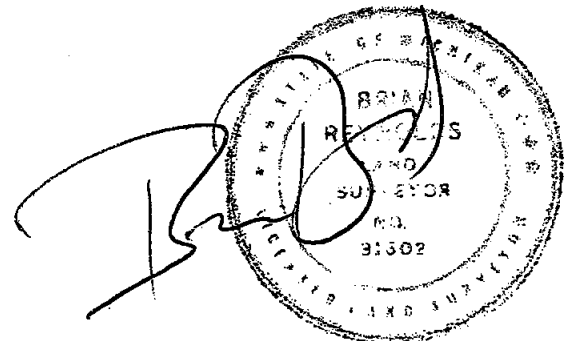

INGHAM COUNTY REMONUMENTATION
LAND CORNER RECORDATION CERTIFICATE
Filing Requirement of Act 74, Mich. P.A. 1970

For Corners in
INGHAM
(county)

Located In:

Corner Code #

1. Public Land Survey
**1/4 CORNER COMMON
TO SECTIONS 4 & 5
AURELIUS TOWNSHIP**

T 2N R R2W E-2
T _____ R _____
T _____ R _____
T _____ R _____

B: 13 P: 158 10/23/2007 11:02 AM Pages: 2
2007-045648 LAND CORNERS Receipt #33528
Paula Johnson, Ingham County, Michigan



2. Property Controlling S _____ T _____ R _____
in Section S _____ T _____ R _____

3. Miscellaneous S _____ T _____ R _____

4. Lot No _____, Recorded Plat _____

5. Private Claims _____

Register of Deeds Stamp & File Number

I, Brian Reynolds, in a field survey on AUGUST 22, 2007 do hereby certify that under requirements of P.A. 74, Michigan P.A. of 1970, the corner points mentioned in lines 1 and 2 above were in conformance with regulations and rules therefore as required in the current manual of survey instructions of the United States Department of the Interior, Bureau of Land Management or by a decree of a Court of Law and/or that the corner points mentioned in lines 3, 4, and 5 above were in conformance with the rules of the Michigan Board of Land Surveyors or by a Decree of a Court of Law; established, re-established, monumented, re-monumented, recovered, found as expressed below.

NOTE: Not more than 2 corners, in the same town and range, may be recorded on this certificate.

A. Description of original monument and accessories and/or subsequent restoration:

1826 GENERAL LAND OFFICE DEPUTY SURVEYOR HERVEY PARKE, FEBRUARY, 1826 "...40.00 SET QR POST (FROM WHICH) BE 9 S48E 11 Do. 8 N58-1/2W 2981.49 INT N BDY 54 (LINKS) W OF (POST)"

1848 INGHAM COUNTY SURVEYOR RECORD BY A. JACKSON, VOLUME 1, PAGE 239, "...BEECH 9 S 48 E 11 D O 8 N 58-1/2 W 29...": SAME WITNESSES BY A. JACKSON IN 1854, VOLUME 1, PAGE 385.

1880 T. J. BROWN, SURVEY OF SECTION 5 IN AURELIUS FOLDER CALLS FOR "...POST OR STONE .." NO WITNESSES.

UNDATED INGHAM COUNTY ROAD COMMISSION CORNER WITNESS MAP FOR AURELIUS TOWNSHIP CALLS FOR
" ...STONE & TILE 18" MAPLE N.W. 44.6' 15" MAPLE S.W. 39.4' 18" ELM N.E. 50.0' ..."

CORNER HISTORY CONTINUED ON PAGE TWO

B. Description of corner evidence found and/or method applied in restoring or reestablishing corner:

ALL WITNESSES BY SURVEYORS PORTER AND WILLIAMS ARE NOW GONE. FOUND A RAILROAD SPIKE 0.5 FEET BELOW BITUMINOUS SURFACE ON CENTERLINE OF ONONDAGA ROAD. TRAVERSED ALL OF SECTIONS 4 & 5, MEASURED 5392.76 FEET FROM E-1 TO E-3, GOVERNMENT SURVEY RECORD DISTANCE 81.49 CHAINS = 5378.92 FEET. PROPORTIONED DISTANCE FROM E-3 WOULD BE 2647.08 FEET, MEASURED = 2645.52 FEET. EXCAVATED A 1.5 FOOT ROUND HOLE TO A DEPTH OF 2± FEET, FOUND NO ADDITIONAL EVIDENCE OF PREVIOUS MONUMENTATION. ACCEPTED RAILROAD SPIKE AS BEST AVAILABLE EVIDENCE OF CORNER POSITION, REPLACED WITH STANDARD MONUMENT AND BOX, WITNESSED AS DESCRIBED BELOW.

C. Description of monument for corner and accessories established to perpetuate locating the position of the corner:

WITNESSES TO 3/4" X 24" STEEL FORM PIN WITH AN ALUMINUM CAP STAMPED "31602" IN MONUMENT BOX
FOUND NAIL & FLAGGING IN THE SOUTH SIDE OF A UTILITY POLE EAST 49.24 FEET
SET 1/2" IRON & CAP No. 31602 IN THE WEST EDGE OF THE BITUMINOUS ROADWAY N15°W 58.40 FEET
SET 1/2" IRON & CAP No. 31602 IN THE EAST EDGE OF THE BITUMINOUS ROADWAY N15°E 58.18 FEET
SET 1/2" IRON & CAP No. 31602 IN THE EAST EDGE OF THE BITUMINOUS ROADWAY S15°E 58.26 FEET
SET 1/2" IRON & CAP No. 31602 IN THE WEST EDGE OF THE BITUMINOUS ROADWAY S15°W 57.68 FEET
N00°02'50"E 2747.24 FEET TO E-1 N89°31'42"W 2662.80 FEET TO D-2
S89°52'50"E 2662.92 FEET TO F-2 S00°05'56"W 2645.52 FEET TO E-3

P.A. 345 INGHAM COUNTY
PEER APPROVED 9/25/07 M

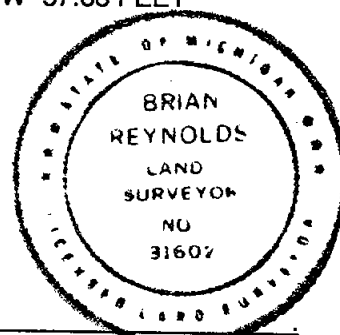

Signed by [Signature]
Surveyor's Michigan License No 31602

Date September 24, 2007

FORM APPROVED BY MICHIGAN STATE BOARD OF LAND SURVEYORS. JAN. 28, 1971

REVISED MAY 14, 1975 REVISED JANUARY, 1983 REVISED OCTOBER 1995

PAGE TWO

A. Description of original monument and accessories and/or subsequent restoration: T2N R2W E-2 CONTINUED

- 1974 ACT 132 SURVEY BY EMERY AND PORTER, INC., SIGNED AND SEALED BY JAMES A. PORTER, P.S. 19003, DATED 9-23-1974, RECORDED NOVEMBER 27, 1974 IN LIBER 2 PAGE 216, MONUMENT SHOWN, NO WITNESSES.
- 1978 LAND CORNER RECORDATION CERTIFICATE BY JAMES A. PORTER, P.S. 19003, DATED APRIL 20, 1978, RECORDED JUNE 28, 1978 IN LIBER 4, PAGE 219, PART A READS, "...ORIGINAL POST & WITNESSES DESTROYED..." PART B READS, "...INGHAM COUNTY ROAD COMMISSION RECORDS INDICATE STONE & TILE 18" MAPLE NW 44.6 FEET 15" MAPLE SW 39.4 FEET 18" ELM NE 50.0 FEET FOUND BOATSPIKE IN CENTERLINE ONONADAGA (sic) ROAD ..." PART C READS, "...LEFT BOATSPIKE IN PLACE WITH FOLLOWING WITNESSES NAIL AND TAG IN 28" MAPLE N 20° W 105.30 FEET 28" MAPLE N 30° W 74.70 FEET 28" MAPLE N 45° W 46.78 FEET POWER POLE WEST 56.48 FEET..."
- 1980 ACT 132 SURVEY BY WILLIAMS SURVEYING, SIGNED AND SEALED BY AUSTIN C. WILLIAMS, P.S. 21275, NO DATE, RECORDED APRIL 29, 1980 IN LIBER 3, PAGES 1275 & 1276, SUBJECT CORNER DESCRIBED THUS: "...WEST 1/4 CORNER SEC. 4, T2N, RW2 NAIL & TAG IN 28" MAPLE N20°W 105.30' NAIL & TAG IN 28" MAPLE N 30°W 74.70' NAIL & TAG IN 28" MAPLE N45°W 46.78' NAIL & TAG IN POWER POLE WEST 56.48'..."

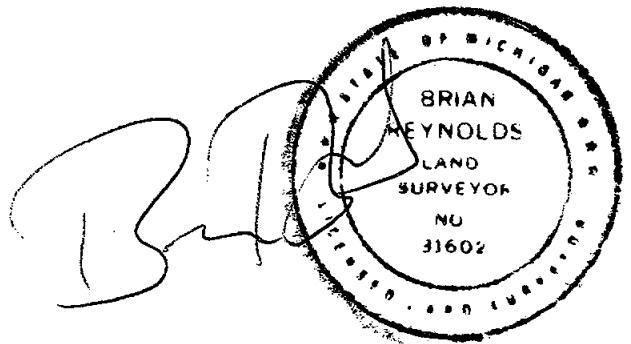

INGHAM COUNTY REMONUMENTATION

LAND CORNER RECORDATION CERTIFICATE

Filing Requirement of Act 74, Mich. P.A. 1970

For Corners in
INGHAM
(county)

Located In:

Corner Code #

1. Public Land Survey
CORNER COMMON
TO SECTIONS 4, 5, 8 & 9
AURELIUS TOWNSHIP

T 2N R 2W
T R
T R
T R

E-3

B: 13 P: 138 09/25/2007 09:14 AM
2007-041775 LAND CORNERS Receipt #32274
Paula Johnson, Ingham County, Michigan

Pages: 3



2. Property Controlling S T R
in Section S T R



Register of Deeds Stamp & File Number

3. Miscellaneous S T R

4. Lot No , Recorded Plat

5. Private Claims

I, Brian Reynolds, in a field survey on AUGUST 17, 2007 do hereby certify that under requirements of P.A. 74, Michigan P.A. of 1970, the corner points mentioned in lines 1 and 2 above were in conformance with regulations and rules therefore as required in the current manual of survey instructions of the United States Department of the Interior, Bureau of Land Management or by a decree of a Court of Law and/or that the corner points mentioned in lines 3, 4, and 5 above were in conformance with the rules of the Michigan Board of Land Surveyors or by a Decree of a Court of Law; established, re-established, monumented, re-monumented, recovered, found as expressed below.

NOTE: Not more than 2 corners, in the same town and range, may be recorded on this certificate.

A. Description of original monument and accessories and/or subsequent restoration:

1826 GENERAL LAND OFFICE DEPUTY SURVEYOR HERVEY PARKE, FEBRUARY, 1826 "... 80.00 SET (POST) COR 4, 5, 8, & 9 (FROM WHICH) SUG 26 N26W .08-1/2 BE 9 S28-1/2E 9

1840 INGHAM COUNTY SURVEYOR RECORD BY A. JACKSON, VOLUME 1, PAGE 42, "...SUGAR 26 N 26 W 8-1/2 LKS BEECH 9 S 28-1/2 E 49 LKS..."

1848 INGHAM COUNTY SURVEYOR RECORD BY A. JACKSON, VOLUME 1, PAGE 239, "...SUGAR 26 N 26 W 8-1/2 BEECH 9 S 28-1/2 E 49..."

1854 TWO INGHAM COUNTY SURVEYOR RECORDS BY A. JACKSON, VOLUME 1, PAGE 385 & 386, "...SUGAR 26 N 26 W 8-1/2 BEECH 9 S 28-1/2 E 49..."

UNDATED INGHAM COUNTY ROAD COMMISSION CORNER WITNESS MAP FOR AURELIUS TOWNSHIP CALLS FOR "...STONE 30" ELM N.E. 46.7' 16" MAPLE N.W. 45.3' 14" MAPLE S.W. 66.2'..."

CORNER HISTORY CONTINUED ON PAGE TWO

B. Description of corner evidence found and/or method applied in restoring or reestablishing corner:

ALL OF THE WITNESSES BY POLARIS, 2004 REMAIN IN GOOD CONDITION. NEARLY ALL OF THE EARLIER POWER POLE WITNESSES ARE GONE. FOUND 1/2" IRON IN A MONUMENT BOX AT THE INTERSECTION OF CENTERLINES OF COLUMBIA ROAD AND ONONDAGA ROAD. TRAVERSED SECTIONS 4 AND 5, RESULTING MEASUREMENTS CONFORMING WELL WITH DISTANCES OF RECORD. EXCAVATED THROUGH BOX, FOUND NO ADDITIONAL EVIDENCE OF PRIOR MONUMENTATION. ACCEPTED FOUND IRON AS PROPER PERPETUATION OF CORNER POSITION. REPLACED WITH STANDARD FORM PIN MONUMENT AND ALUMINUM CAP, WITNESSED AS DESCRIBED BELOW.

C. Description of monument for corner and accessories established to perpetuate locating the position of the corner:

WITNESSES TO 3/4" X 24" STEEL FORM PIN WITH AN ALUMINUM CAP STAMPED "31602" IN A MONUMENT BOX FOUND NAIL & TAG No. 30090 IN THE SOUTH SIDE OF A UTILITY POLE N60°W 75.42 FEET
FOUND NAIL & TAG No. 30090 IN THE SOUTHEAST SIDE OF A UTILITY POLE S56°E 66.64 FEET
FOUND NAIL & TAG No. 18998 IN THE SOUTH SIDE OF A UTILITY POLE N60°W 75.42 FEET
SET MAGNETIC NAIL & REMON TAG IN THE NORTHEAST SIDE OF A UTILITY POLE N32°W 119.10 FEET
ON CENTERLINE OF BOTH ROADS N89°22'10"W 2661.58 FEET TO D-3
N00°05'56"E 2645.52 FEET TO E-2 S89°51'47"E 2667.19 FEET TO F-3

P.A. 345 INGHAM COUNTY
PEER APPROVED 8/21/2007 AL

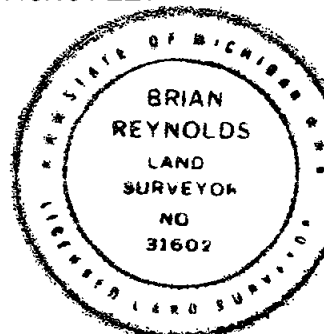

Signed by [Signature]
Surveyor's Michigan License No 31602

Date AUGUST 20, 2007

FORM APPROVED BY MICHIGAN STATE BOARD OF LAND SURVEYORS. JAN. 28, 1971

REVISED MAY 14, 1975 REVISED JANUARY, 1983 REVISED OCTOBER 1995

PAGE TWO

A. Description of original monument and accessories and/or subsequent restoration: T2N R2W E-3 CONTINUED

- 1972 ACT 132 SURVEY BY WOLVERINE ENGINEERING CO., SIGNED AND SEALED BY GEORGE M. YOUNG, P.S. 17640, DATED JUNE 19, 1972, RECORDED JUNE 20, 1972 IN LIBER 1 PAGE 290, SUBJECT CORNER DESCRIBED THUS: "...FOUND BOAT SPIKE S 1/4 COR. SEC 5, T2N-R2W..." NO WITNESSES CITED.
- 1974 ACT 132 SURVEY BY EMERY AND PORTER, INC., SIGNED AND SEALED BY JAMES A. PORTER, P.S. 19003, DATED 9-23-1974, RECORDED NOVEMBER 27, 1974 IN LIBER 2 PAGE 216, SUBJECT CORNER DESCRIBED THUS: "...SW COR. SEC. 4 T2N, R2W AURELIUS TWP. INGHAM COUNTY, MI. WITNESSES: FND. STEPHEN'S ENG. N&T 28" MAPLE NW 51.10' N.W. E&P N&T P.P. 63.96' NNW P.P. E&P N&T 67.10' NW P.P. N&T E&P 119.90' SE STL. F.P. 49.85' SW ..."
- 1976 LAND CORNER RECORDATION CERTIFICATE BY JAMES A PORTER, P.S. 19003, DATED JANUARY 23, 1976, RECORDED APRIL 13, 1976 IN LIBER 3, PAGE 560, PART A READS, "...ORIGINAL POST AND WITNESSES DESTROYED..." PART B READS, "...FOUND BOATSPIKE IN INTERSECTION OF ONONDAGA AND COLUMBIA ROADS WITH STEPHENS ENGINEERING TAGS IN 28" MAPLE NW 51.10 FEET..." PART C READS, "...STEEL FENCE POST SW 49.85 FEET NAIL AND TAG IN POWER POLE SE 119.90 FEET NAIL AND TAG IN POWER POLE NNW 63.96 FEET NAIL AND TAG IN POWER POLE NW 67.10 FEET..."
- 1977 ACT 132 SURVEY BY G. A. STEADMAN & SON, INC., SIGNED AND SEALED BY RICHARD W. STEADMAN, P.S. 11370, DATED JUNE 16, 1977, RECORDED JULY 6, 1977 IN LIBER 2, PAGE 1176, SUBJECT CORNER DESCRIBED THUS: "...N.E. CORNER, SEC. 8 T2N, R2W, FOUND BOATSPIKE POWER POLE S.E. 119.90' FENCE POST S.W. 49.85' POWER POLE N.N.W. 63.96' ..."
- 1977 ACT 132 SURVEY BY POLARIS SURVEYING CO., SIGNED AND SEALED BY RONNIE LESTER, P.S. 18998, DATED 9/2/77, RECORDED SEPTEMBER 29, 1977 IN LIBER 3, PAGES 59 & 60, SUBJECT CORNER DESCRIBED THUS: "...NORTHEAST CORNER SECTION 8, T2N, R2W STEEL FENCE POST, SW 49.85' NAIL AND TAG IN POWER POLE SE, 119.90' NAIL AND TAG IN POWER POLE NNE, 63.96' NAIL AND TAG IN POWER POLE NW, 67.10'..." DRAWING INDICATES N 89-15-07 W 2661.62 FEET TO D-3.
- 1978 ACT 132 SURVEY BY POLARIS SURVEYING CO., SIGNED AND SEALED BY RONNIE LESTER, P.S. 18998, DATED 1/30/78, RECORDED MARCH 30, 1978 IN LIBER 3, PAGES 329 & 330, SUBJECT CORNER DESCRIBED THUS: "...NORTHEAST CORNER SECTION 8, T2N, R2W STEEL FENCE POST, SW 49.85' NAIL & TAG IN POWER POLE SE, 119.90' NAIL AND TAG IN POWER POLE NNE, 63.96' NAIL AND TAG IN POWER POLE NW, 67.10'..." DRAWING INDICATES N 89°15'07" W 2661.62 FEET TO D-3.
- 1980 ACT 132 SURVEY BY WOLVERINE ENGINEERS & SURVEYORS, INC., SIGNED AND SEALED BY GEORGE M. YOUNG, P.S. 17640, DATED JULY 23, 1980, RECORDED APRIL 25, 1980 IN LIBER 4, PAGE 105, SUBJECT CORNER DESCRIBED THUS: "...N.W. CORNER, SEC. 9 T2N-R2W, AURELIUS TWP, INGHAM CO., MI N. & TAG IN POWER POLE S.E. 119.90' N. & TAG IN POWER POLE N.N.W. 63.96' N. & TAG IN POWER POLE N.W. 67.10' STEEL FENCE POST S.W. 49.85' RECORDED L-3 PG-560 ..."
- 1986 ACT 132 SURVEY BY R. W. STEADMAN & ASSOCIATES, INC., SIGNED AND SEALED BY RICHARD W. STEADMAN, P.S. 11370, DATED APRIL 18, 1986, RECORDED MAY 22, 1986 IN LIBER 4, PAGE 1231, SUBJECT CORNER DESCRIBED THUS: "...N.W. COR. SEC. 9 T2N, R2W, FOUND BOAT SPIKE STEEL FENCE POST SW 49.85 FEET POWER POLE SE 119.90 FEET POWER POLE NNW 63.96 FEET POWER POLE NE 67.10 FEET ..."
- 1993 ACT 132 SURVEY BY POLARIS SURVEYING CO., SIGNED AND SEALED BY RONNIE LESTER, P.S. 18998, DATED APRIL 6, 1993, RECORDED MAY 3, 1993 IN LIBER 6, PAGES 1217 - 1219, SUBJECT CORNER DESCRIBED THUS: "...WITNESSES TO GOVERNMENT CORNERS: NORTHEAST CORNER SECTION 8, T2N, R2W. 1/2" BAR IN MONUMENT BOX. LIBER 3, PAGE 560. SET NAIL AND TAG IN EAST SIDE 15" WALNUT, 202°AZ., 118.2' SET NAIL AND TAG IN SOUTH SIDE 30" MAPLE, 287°AZ., 156.7' SET NAIL AND TAG IN SOUTH SIDE NEW U. POLE 308°AZ., 75.4' SET NAIL AND TAG IN SOUTH SIDE NEW U. POLE, 62°AZ., 66.7' ..." DRAWING INDICATES N 89°15'07" W 2661.62 FEET TO D-3.
- 1996 SEVERAL ACT 132 SURVEY BY POLARIS SURVEYING CO., SIGNED AND SEALED BY RONNIE LESTER, P.S. 18998, DATED 7/9/96, 11/25/96 AND 4/21/97, RECORDED 8/07/1996, IN LIBER 7, PAGES 853 & 854, 02/27/1997 IN LIBER 7, PAGES 1006 & 1007, AND 05/13/1997 IN LIBER 7, PAGES 1115 AND 1116, SUBJECT CORNER DESCRIBED THE SAME AS IN 1993 SURVEY ABOVE. DRAWING INDICATES 2667.19 FEET TO F-3.
- 1997 ACT 132 SURVEY BY BEERY & ASSOCIATES, INC, SIGNED AND SEALED BY DAVID R. LOHR, P.S. # 30090, DATED SEPTEMBER 8, 1997, RECORDED 09/17/1997 IN LIBER 7, PAGES 1280 & 1281, SUBJECT CORNER DESCRIBED THUS: "...WITNESSES TO SECTION CORNERS: SECTION 4, T2N, R2W, AURELIUS TOWNSHIP. SOUTHWEST CORNER: E-3 FD. 1/2" IRON IN MON. BOX. C/L-C/L COLUMBIA AND ONONDAGA RDS. FD. N&T #18998, S/S P. POLE, N57E, 66.63' FD. N&T #18998, E/S 18" WALNUT, S10W, 118.16' SET N&T #30090, SE/S P. POLE, S58W, 61.14' SET N&T #30090, S/S P. POLE, N58W, 75.44'..."

CORNER HISTORY CONTINUED ON PAGE THREE

PAGE THREE

A. Description of original monument and accessories and/or subsequent restoration: **T2N R2W E-3 CONTINUED**

- 1998 SEVERAL ACT 132 SURVEYS BY POLARIS SURVEYING CO., SIGNED AND SEALED BY RONNIE M. LESTER, P.S. 18998, DATED 6/29/98 AND 8/28/98, RECORDED 08/17/1998 IN LIBER 8 PAGES 298-299 AND PAGES 300-301, AND 09/28/1998 IN LIBER 8, PAGES 307 & 308 SUBJECT CORNER DESCRIBED AS WITNESSED ABOVE IN 1993 SURVEY BY POLARIS. DRAWING INDICATES N 89°15'07" W 2661.72 FEET TO D-3.
- 2000 ACT 132 SURVEY BY POLARIS SURVEYING CO., PAGE 2 MISSING, NO SIGNATURE OR SEAL, INITIALS RL (RONNIE M. LESTER, P.S. 18998, DATED MAR 2000, RECORDED 04/18/2000 IN LIBER 8, PAGE 701, SUBJECT CORNER DESCRIBED THUS: "...NORTHEAST CORNER SECTION 8 T2N, R2W 1/2" BAR IN MONUMENT BOX. LIBER 3, PAGE 560..." NO WITNESSES. DRAWING INDICATES N 89°15'07" W 2661.72 FEET TO D-3.
- 2002 ACT 132 SURVEY BY POLARIS SURVEYING CO., SIGNED AND SEALED BY RONNIE LESTER, P.S. 18998, DATED APRIL 18, 2002, RECORDED 05/13/2002 IN LIBER 8, PAGE 986, SUBJECT CORNER DESCRIBED THUS: "...NORTHEAST CORNER SECTION 8, T2N, R2W. 1/2" BAR IN MONUMENT BOX. LIBER 3, PAGE 560.
FOUND NAIL AND TAG #18998 EAST SIDE 15" WALNUT, 202°AZ., 118.2'
FOUND NAIL AND TAG #18998 SOUTH SIDE 30" MAPLE, 287°AZ., 156.7'
FOUND NAIL AND TAG #18998 SOUTH SIDE NEW U. POLE, 308°AZ., 75.4'
FOUND NAIL AND TAG #18998 SOUTH SIDE NEW U. POLE, 62°AZ., 66.7' ..."
DRAWING INDICATES N 89°15'07" W 2661.72 FEET TO D-3.
- 2004 ACT 132 SURVEY BY POLARIS SURVEYING CO., SIGNED AND SEALED BY RONNIE LESTER, P.S. 18998, DATED 1/06/04, RECORDED 03/04/2004 IN LIBER 9, PAGE 33, SUBJECT CORNER DESCRIBED THUS: "...NORTHEAST CORNER SECTION 8, T2N, R2W. 1/2" BAR IN MONUMENT BOX. LIBER 3, PAGE 560.
FOUND NAIL AND TAG #18998 EAST SIDE 15" WALNUT, 202°AZ., 118.2'
FOUND NAIL AND TAG #18998 SOUTH SIDE 30" MAPLE, 287°AZ., 156.7'
FOUND NAIL AND TAG #18998 SOUTH SIDE NEW U. POLE, 308°AZ., 75.4'
FOUND NAIL AND TAG #18998 SOUTH SIDE NEW U. POLE, 62°AZ., 66.7' ..."
DRAWING INDICATES N 89°15'07" W 2661.72 FEET TO D-3.

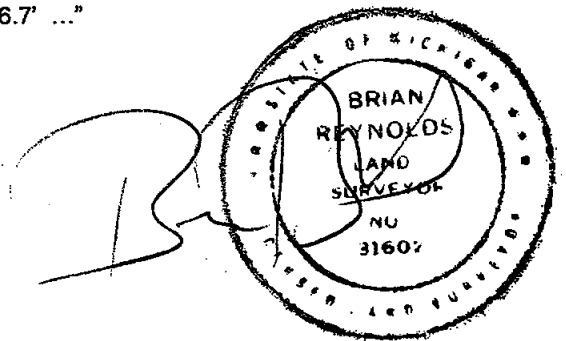

P.A. 345 INGHAM COUNTY
PEER APPROVED 8/21/2007 RL