

LAND CORNER RECORDATION CERTIFICATE
Filing Requirement of Act 74, Mich. P.A. 1970.

For Corners in
INGHAM
(county)

Located In:

Corner Code #

1. Public Land Survey
**CORNER COMMON TO
TOWNS 2 & 3 NORTH
RANGES 2 AND 3 WEST**

T 2N R 2W
T R
T R
T R

A-01

B:13 P:22 11/21/06 10:04 AM
2006-068537 LAND CORNERS Receipt #19823
Paula Johnson, Ingham County, Michigan

Page: 2



2. Property Controlling
in Section

S T R
S T R



Register of Deeds Stamp & File Number

3. Miscellaneous S T R

4. Lot No , Recorded Plat
5. Private Claims

I, Brian Reynolds, in a field survey on AUGUST 25, 2006, do hereby certify that under requirements of P.A. 74, Michigan P.A. of 1970, the corner points mentioned in lines 1 and 2 above were in conformance with regulations and rules therefore as required in the current manual of survey instructions of the United States Department of the Interior, Bureau of Land Management or by a decree of a Court of Law and/or that the corner points mentioned in lines 3, 4, and 5 above were in conformance with the rules of the Michigan Board of Land Surveyors or by a Decree of a Court of Law; established, re-established, monumented, re-monumented, recovered, found as expressed below.

NOTE: Not more than 2 corners, all in the same town and range, may be recorded on this certificate.

A. Description of original monument and accessories and/or subsequent restoration:

1. GENERAL LAND OFFICE DEPUTY SURVEYOR JOHN MULLETT, MAY 13, 1825, "...82.56 INT. THE RANGE LINE 9 LKS N. OF THE TEMP POST AND SET POST COR. TO TOWNS 2 & 3 NORTH, RANGES 2 & 3 WEST FW
A W.O. 9 IN. S16W 12 LKS AND A BEECH 10 N47E 30 LKS"
2. E. A. CALKINS, DEPUTY COUNTY SURVEYOR, IN A SURVEY TO PARTITION THAT PART OF THE NORTHWEST 1/4 OF SECTION 6, T2N R2W, LYING WEST OF THE GRAND RIVER, DATED FEBRUARY 20-21 AND MARCH 3RD, 1900, BOOK 1, PAGE 8, "POST IN GROUND, NO TREES" ON THE PLAT, CALKINS SHOWS A DISTANCE OF 16.21 CHAINS (1069.86 FEET) FROM THE SUBJECT CORNER TO THE MEANDER CORNER ON THE NORTH LINE OF SECTION 6 ON THE WEST BANK OF THE GRAND RIVER. THE GOVERNMENT SURVEY NOTES AND PLAT SHOW 16.22 CHAINS (1070.52 FEET) FOR THAT SAME INTERVAL. IN HIS NARRATIVE, CALKINS DESCRIBES, "...I COMMENCED AT THE MARGIN OF RIVER 16.20 CHAINS N89°32'E, FROM THE NORTHWEST CORNER OF SECTION 6 AND RAN THE MEANDER LINE..."
3. NOTHING ON ROAD COMMISSION WITNESS MAP.

CORNER HISTORY CONTINUED ON PAGE TWO

B. Description of corner evidence found and/or method applied in restoring or reestablishing corner:

FOUND MONUMENT BOX 2 1/2" BELOW BITUMINOUS SURFACE AT INTERSECTION OF CENTERLINE OF WAVERLY ROAD NORTH-SOUTH AND WILBUR HIGHWAY WEST. FOUND 1/2" X 24" REBAR OVER ANOTHER REBAR. COULD NOT REMOVE DEEPER REBAR. ACCEPTED FOUND IRON AS A PROPER PERPETUATION OF THE CORNER POSITION. SET STANDARD REMON IRON AND CAP, RAISED MONUMENT BOX TO SURFACE, WITNESSED AS DESCRIBED BELOW.

C. Description of monument for corner and accessories established to perpetuate locating the position of the corner:

WITNESSES TO 3/4" X 24" STEEL FORM PIN WITH ALUMINUM CAP STAMPED "31602"
FOUND NAIL AND "17640" TAG IN NORTHEAST SIDE OF POWER POLE S30°E 56.55'
SET NAIL AND TAG "REYNOLDS 31602" IN WEST SIDE OF 38" OAK S10°E 113.60'
FOUND NAIL AND "18994" TAG, SET NAIL & "REYNOLDS 31602" TAG IN SOUTH SIDE OF 13" PINE N60°W 82.65'
FOUND NAIL AND "MDOT" TAG IN EAST SIDE OF 46" OAK N12°W 88.50'
TO B-13 T3N R2W IS S89°42'30"E 2819.91'

TO A-12 T3N R2W IS N00°05'27"W 2636.66'

P.A. 345 INGHAM COUNTY
PEER APPROVED 10/24/2006

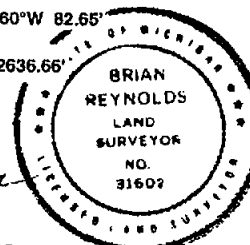

Signed by [Signature]
Surveyor's Michigan License No 31602

Date September 25, 2006

FORM APPROVED BY MICHIGAN STATE BOARD OF LAND SURVEYORS, JAN. 28, 1971
REVISED MAY 14, 1975 REVISED JANUARY, 1983 REVISED OCTOBER 1995

PAGE TWO

A. Description of original monument and accessories and/or subsequent restoration: T2N R2W A-01 CONTINUED

4. SUBJECT TOWNSHIP CORNER RECORDED IN EATON COUNTY AS M-1, T3N, R2W IN LAND CORNER RECORDATION CERTIFICATE, LIBER 2, PAGE 193, RECORDED MAY 23, 1974, SIGNED BY PHILIP WETOSKEY, P.S. No. 19847, COUNTERSIGNED BY N. C. JONES, P.S. No. 2934. PART A: BLANK PART B: "...FOUND 3/8" IRON ROD IN PAVEMENT AT THE INTERSECTION OF WAVERLY & WILBUR RDS..." PART C: "WITNESSED ABOVE DESCRIBED ROD AS FOLLOWS: N15°W 88.33' 32" OAK N57°W 36.58' STEEL FENCE POST S63°W 35.81 STREET SIGN S62°E 48.47' 10" PINE..."
5. SUBJECT TOWNSHIP CORNER RECORDED IN EATON COUNTY AS A-1, T2N, R2W IN LAND CORNER RECORDATION CERTIFICATE, LIBER 3, PAGE 586, RECORDED JULY 6, 1976 BY GEORGE M. YOUNG, P.S. No. 17640, PART A: "...ORIGINAL MONUMENT & ACCESSORIES OBLITERATED. INGHAM COUNTY ROAD COMMISSION. (NEXT LINE OBLITERATED) 30" OAK NNW 87.3' 32" TWIN ELM NW 30.9' " PART B: "...FOUND 1/2" RE-ROD 2.2' UNDER ASPHALT RAISED IRON TO SURFACE WITH 1/2" RE-ROD & CAP. RELOCATED FROM ABOVE REFERENCES..." PART C: "...MDSH NAIL & WASHER IN 30" OAK N15°W 88.45'..."
6. ACT 132 SURVEY BY LAVERNE J. HENDRYX, P.S. No. 3276, EATON COUNTY LIBER 2, PAGE 412, RECORDED SEPTEMBER 21, 1977, SUBJECT CORNER IS DESCRIBED THUS: "...N.E. CORNER, SECTION 1, T2N, R3W EATON RAPIDS TOWNSHIP, EATON COUNTY, MICH. L2 - P193..." NO MONUMENT OR WITNESSES DESCRIBED.
7. ACT 132 SURVEYS BY LAVERNE J. HENDRYX, EATON COUNTY LIBER 2, PAGE 713-714, RECORDED OCTOBER 19, 1978, SUBJECT CORNER IS DESCRIBED THUS: "S.E. CORNER, SECTION 36, T3N, R3W WINDSOR TWP. EATON COUNTY, MICH. ..." NO MONUMENT OR WITNESSES DESCRIBED.
8. ACT 132 SURVEY BY LARRY A. BRYAN, P.S. No. 25832, EATON COUNTY LIBER 4, PAGE 777-778, SUBJECT CORNER IS DESCRIBED THUS: "NORTHEAST CORNER, SECTION 1, T2N, R3W LIBER 2, PAGE 193 FOUND BAR & CAP IN MONUMENT BOX AT CENTERLINES OF WAVERLY & WILBUR HWY. FOUND NAIL & TAG EAST SIDE 60" OAK, N15°W 88.47' FOUND MDOT NAIL & TAG NORTH SIDE 16" PINE, S60°E 50.05' SET NAIL & TAG WEST SIDE 10" TWIN MAPLE, S10°E 87.51'..."
9. ACT 132 SURVEY BY WOLVERINE ENGINEERS AND SURVEYORS, INC. SIGNED AND SEALED BY MAURICE H. MAHIEU, P.S. No. 28414, RECORDED NOVEMBER 15, 1990 IN EATON COUNTY LIBER 5, PAGE 169, SUBJECT CORNER IS DESCRIBED THUS: "N. E. COR. FND. 3/8" ROD, WITNESSED BY: N&T 12" OAK S65°E 30.39' N&T UTIL. POLE S10°E 56.60' N&T 12" HICKORY S15°E 87.47' N&T 42" OAK (NO BEARING) 88.40'..."
10. ACT 132 SURVEY BY SOUTHERN MICHIGAN LAND SURVEYING, SIGNED AND SEALED BY PETER D. BEAVER, P.S. No. 25828, RECORDED JUNE 26, 1997 IN LIBER 6 ON PAGE 971 CORNER IS DESCRIBED THUS: "...SE COR SECT 36 T3N - R3W..." NOT OTHERWISE DESCRIBED.
11. ACT 132 SURVEY, EATON COUNTY LIBER 10, PAGE 930, BY RON HELSEL, P.S. 18994, RECORDED AUGUST 8, 2002, SUBJECT CORNER IS DESCRIBED THUS: "...SE CORNER SECTION 36, LIBER 2, PAGE 194 (SHOULD READ PAGE 193) NAIL & TAG #17640 E/SIDE P. POLE, NAZ 155°, 56.6 FEET SET NAIL & TAG S/SIDE QUAD OAK, NAZ 121°, 30.4 FEET MDOT NAIL & TAG E/SIDE 48" OAK, NAZ 350°, 88.4 FEET SET NAIL & TAG S/SIDE 12" PINE, NAZ 303°, 82.5 FEET..."
12. ACT 132 SURVEY BY KEBS, INC. SIGNED AND SEALED BY ANTHONY BUMSTEAD, P.S. 41095, RECORDED IN EATON COUNTY LIBER 11, PAGES 138-140, SUBJECT CORNER IS DESCRIBED THUS: "NORTHEAST CORNER, SECTION 1, T2N, R3W LIBER 2, PAGE 193 FOUND BAR & CAP IN MONUMENT BOX. FOUND NAIL & TAG NORTH SIDE 18" PINE, S65°E 50.17' FOUND NAIL & TAG SOUTH SIDE 14" PINE, N60°W 82.58' FOUND MDOT NAIL & TAG EAST SIDE 40" OAK, N15°W 88.43' FOUND STOP SIGN, S70°W 41.87'..."
13. ACT 132 SURVEY BY FRED WHITE, P.S. No. 12034, RECORDED IN EATON COUNTY LIBER 11, PAGES 215-217, REVISED AND RE-RECORDED IN LIBER 1871, PAGES 144-146, SUBJECT CORNER IS SHOWN, AND DESCRIBED THUS: "...SOUTHEAST CORNER, SECTION 36, T3N, R3W..." NO MONUMENT OR WITNESSES DESCRIBED.
14. ACT 132 SURVEY BY KEBS, INC. SIGNED AND SEALED BY DAVID BOWERMAN, P.S. No. 49275, RECORDED IN EATON COUNTY LIBER 1874, PAGES 646-648, SUBJECT CORNER IS DESCRIBED THUS: "NORTHEAST CORNER, SECTION 1, T2N, R3W LIBER 2, PAGE 193 FOUND BAR & CAP IN MONUMENT BOX. FOUND NAIL & TAG NORTH SIDE 18" PINE, S65°E 50.17' FOUND NAIL & TAG SOUTH SIDE 14" PINE, N60°W 82.58' FOUND MDOT NAIL & TAG EAST SIDE 40" OAK, N15°W 88.43' FOUND STOP SIGN, S70°W 41.87'..."

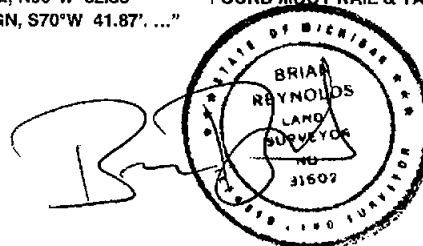

INGHAM COUNTY REMONUMENTATION
LAND CORNER RECORDATION CERTIFICATE
Filing Requirement of Act 74, Mich. P.A. 1970

For Corners in
INGHAM
(county)

Located In:

Corner Code #

1. Public Land Survey
WEST 1/4 CORNER
SECTION 6
AURELIUS TOWNSHIP

T 2N R 2W

A-2

T _____ R _____

T _____ R _____

T _____ R _____

2. Property Controlling S _____ T _____ R _____
in Section S _____ T _____ R _____

3. Miscellaneous S _____ T _____ R _____

4. Lot No _____, Recorded Plat _____

5. Private Claims _____

B: 13 P: 128 09/25/2007 09:14 AM
2007-041765 LAND CORNERS Receipt #32274
Paula Johnson, Ingham County, Michigan

Pages: 2



Register of Deeds Stamp & File Number

	A	B	C	D	E	F	G	H	I	J	K	L	M
1													
2	6		5		4		3		2		1		
3													
4	7		8		9		10		11		12		
5													
6	18		17		16		15		14		13		
7													
8	19		20		21		22		23		24		
9													
10	30		29		28		27		26		25		
11													
12	31		32		33		34		35		36		
13													

I, Brian Reynolds, in a field survey on August 20, 2007 do hereby certify that under requirements of P.A. 74, Michigan P.A. of 1970, the corner points mentioned in lines 1 and 2 above were in conformance with regulations and rules therefore as required in the current manual of survey instructions of the United States Department of the Interior, Bureau of Land Management or by a decree of a Court of Law and/or that the corner points mentioned in lines 3, 4, and 5 above were in conformance with the rules of the Michigan Board of Land Surveyors or by a Decree of a Court of Law; established, re-established, monumented, re-monumented, recovered, found as expressed below.

NOTE: Not more than 2 corners, in the same town and range, may be recorded on this certificate.

A. Description of original monument and accessories and/or subsequent restoration:

CLOSING QUARTER CORNER NOT MONUMENTED BY THE GENERAL LAND OFFICE SURVEY

1900 INGHAM COUNTY SURVEYOR RECORD BY E. A. CALKINS, DEPUTY SURVEYOR, VOLUME 5, PAGE 8, "...POST IN GROUND 1.60 CHS. SOUTH ON RANGE LINE FROM E 1/4 POST OF SEC. 1 T2N R3W. FROM WHICH POST (8) BEARS BUTTERNUT 6 N 27-1/2 W. 76-1/2 CHS. SYCAMORE 17 S 21 E. 1.48-1/2 CHS. ..."

NO CORNER INFORMATION ON THE INGHAM COUNTY ROAD COMMISSION WITNESS MAP FOR AURELIUS TOWNSHIP.

CORNER HISTORY CONTINUED ON PAGE TWO

B. Description of corner evidence found and/or method applied in restoring or reestablishing corner:

FOUND A 1/2" CAPPED REROD (17640 GEORGE M. YOUNG, P.S.), 24" LONG IN A MONUMENT BOX, 0.5 FEET BELOW BITUMINOUS ROAD SURFACE. ALSO FOUND SYCAMORE WITNESS BY SURVEYOR YOUNG, 1976. THE 1900 SURVEY BY CALKINS CALL FOR THE SUBJECT CLOSING CORNER TO BE 1.60 CHAINS (105.6 FEET) SOUTH OF THE CORRESPONDING STANDARD CORNER. TRAVERSE OF SECTION 6, INCLUDING TIES TO STANDARD CORNERS, CONFIRMS FOUND IRON TO BE 105.91 FEET SOUTH OF APPARENT STANDARD M-2, T2N R3W, AND 0.20 FEET EAST OF RANGE LINE DEFINED BY STANDARD CORNERS. REMOVED FOUND IRON, EXCAVATED THROUGH MONUMENT BOX, FOUND NO FURTHER EVIDENCE OF PRIOR MONUMENTATION. ACCEPTED FOUND IRON AS A PROPER RESTORATION BY SURVEYOR YOUNG OF CORNER POSITION ORIGINALLY MONUMENTED BY COUNTY SURVEYOR CALKINS IN 1900. REPLACED FOUND IRON WITH STANDARD INGHAM MONUMENT AND CAP AS FOUND, 0.20 FEET EAST OF RANGE LINE, WITNESSED AS DESCRIBED BELOW.

C. Description of monument for corner and accessories established to perpetuate locating the position of the corner:

WITNESSES TO 3/4" X 24" STEEL FORM PIN WITH AN ALUMINUM CAP STAMPED "31602" IN A MONUMENT BOX NAIL & TAG "KEBS" (KYES ENGINEERING BRYAN SURVEYS) IN THE W. SIDE OF 36" SYCAMORE S14°E 94.88 FEET SET MAGNETIC NAIL & REMON TAG IN THE EAST SIDE OF A 14" HICKORY N13°W 118.96 FEET SET MAGNETIC NAIL & REMON TAG IN THE WEST SIDE OF AN 8" ASH N21°E 89.22 FEET SET MAGNETIC NAIL & REMON TAG IN THE WEST SIDE OF A 6" ASH N17°E 104.30 FEET IRON IN ROAD REPRESENTING M-2 T2N R3W NORTH 105.91 FEET N00°15'53"W 2752.25 FEET TO A-1 S00°17'38"E 2646.27 FEET TO A-3 N89°59'04"E 2764.36 FEET TO B-2

P.A. 345 INGHAM COUNTY
PEER APPROVED 8/21/2007 PL

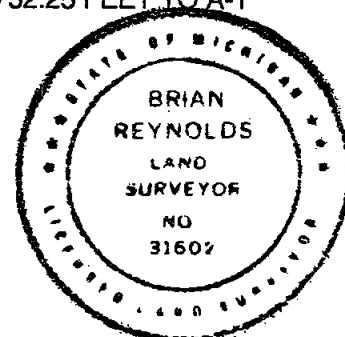

Signed by [Signature]
Surveyor's Michigan License No 31602

Date AUGUST 20, 2007

FORM APPROVED BY MICHIGAN STATE BOARD OF LAND SURVEYORS. JAN. 28, 1971

REVISED MAY 14, 1975 REVISED JANUARY, 1983 REVISED OCTOBER 1995

PAGE TWO

A. Description of original monument and accessories and/or subsequent restoration: T2N R2W A-2 CONTINUED

- 1976 ACT 132 SURVEY BY WOLVERINE ENGINEERS & SURVEYORS, INC., SIGNED AND SEALED BY GEORGE M. YOUNG, P.S. 17640, DATED 5-13-76, RECORDED JULY 6, 1976 IN LIBER 2, PAGES 783 & 784, SUBJECT CORNER DESCRIBED THUS: "...WEST 1/4 POST, SECTION 6 T2N, R2W, AURELIUS TWP., INGHAM COUNTY
NAIL IN 15" ASH N 20° W 109.75' NAIL IN 24" MAPLE S 85° E 86.90'
NAIL IN 36" SYCAMORE S 20° E 94.08' SET 1/2" RE-ROD WITH CAP IN MONUMENT BOX..."
DRAWING INDICATES N89°54'01"E 2764.36 FEET TO B-2
- 1976 LAND CORNER RECORDATION CERTIFICATE BY GEORGE M. YOUNG, P.S. 17640, DATED MAY 17, 1976, RECORDED JULY 6, 1976 IN LIBER 3, PAGES 586 & 587, PART A READS, "ORIGINAL MONUMENT & ACCESSORIES OBLITERATED BUTTERNUT 6" N 27.5° W 0.765 CH. SYCAMORE S21° E 1.48 CH.
GRAND RIVER EAST 1.77 CH. TAKEN FROM OLD RECORDS FROM 1940'S..."; PART B READS, "SET 1/2" IRON WITH CAP IN MON. BOX. SET ON LINE BETWEEN SE SEC. COR. T2N, R3W, EATON COUNTY & NW COR. OF ABOVE SAID SECTION PRORATED MEASURED DISTANCE TO ORIGINAL DISTANCE RECORDED IN ORIGINAL GOV'T FIELD NOTES..."; PART C READS: NAIL IN 15" ASH N20° W 109.75' NAIL IN 24" MAPLE S85° E 86.90'
NAIL IN 36" SYCAMORE S20° E 94.08'..."
- 1986 ACT 132 SURVEY BY WOLVERINE ENGINEERS & SURVEYORS, INC., SIGNED AND SEALED BY GEORGE M. YOUNG, P.S. 17640, DATED AUGUST 19, 1986, RECORDED SEPTEMBER 26, 1986 IN LIBER 5, PAGES 53 & 54, SUBJECT CORNER DESCRIBED THUS: "...WEST 1/4 POST, SECTION 6 T2N, R2W, AURELIUS TWP., INGHAM COUNTY
1/2" RE-ROD WITH CAP IN MONUMENT BOX
NAIL IN 15" ASH N 20° W 109.75' NAIL IN 24" MAPLE S 85° E 86.90'
NAIL IN 36" SYCAMORE S 20° E 94.08'..."
- 1987 ACT 132 SURVEY BY WOLVERINE ENGINEERS & SURVEYORS, INC., SIGNED AND SEALED BY GEORGE M. YOUNG, P.S. 17640, DATED FEBRUARY, 1987, RECORDED MARCH 31, 1987 IN LIBER 5, PAGES 170 & 171, SUBJECT CORNER DESCRIBED THUS: "...WEST 1/4 POST, SEC. 6, T2N-R2W, AURELIUS TOWNSHIP, INGHAM CO., MI
FOUND 1/2" RE-ROD WITH CAP IN MON. BOX
NAIL IN 15" ASH N 20° W 109.75' NAIL IN 24" MAPLE S 85° E 86.90'
NAIL IN 26" SYCAMORE S 20° E 94.08' RECORDED IN LIBER 3, PAGE 586..."
DRAWING INDICATES N00°21'46"W 2751.84 FEET TO A-1
- 1988 ACT 132 SURVEY BY R. W. STEADMAN & ASSOCIATES, INC., SIGNED AND SEALED BY RICHARD W. STEADMAN, P.S. 11370, DATED NOVEMBER 14, 1988, RECORDED DECEMBER 27, 1990 IN LIBER 6, PAGES 629 & 630, SUBJECT CORNER DESCRIBED THUS: "...WEST 1/4 OF SECTION 6, T2N, R2W, FOUND 1/2" RE-ROD WITH CAP IN MONUMENT BOX
AS RECORDED IN LIBER 3 ON PAGE 586 OF LAND CORNER RECORDATION CERTIFICATES OF INGHAM COUNTY.
15" ASH N20°W 109.75 FEET 24" MAPLE S85°E 86.90 FEET 36" SYCAMORE S20°E 94.08 FEET..."

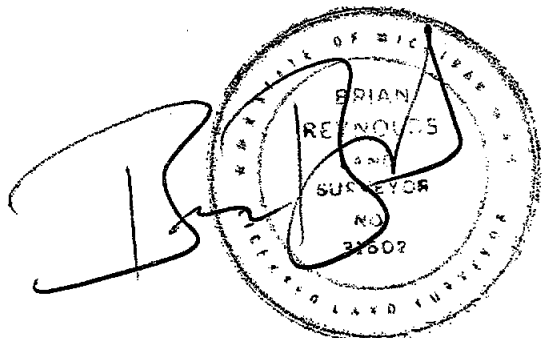

INGHAM COUNTY REMONUMENTATION
LAND CORNER RECORDATION CERTIFICATE
Filing Requirement of Act 74, Mich. P.A. 1970

For Corners in
INGHAM
(county)

Located In:

Corner Code #

1. Public Land Survey
**CORNER COMMON
TO SECTIONS 6 & 7
AURELIUS TOWNSHIP
ON RANGE LINE**

T 2N R 2W
T _____ R _____
T _____ R _____
T _____ R _____

A-3

B: 13 P: 129 09/25/2007 09:14 AM
2007-041766 LAND CORNERS Receipt #32274
Paula Johnson, Ingham County, Michigan

Pages: 2



2. Property Controlling S _____ T _____ R _____
in Section S _____ T _____ R _____

3. Miscellaneous S _____ T _____ R _____

4. Lot No _____, Recorded Plat _____

5. Private Claims _____

Register of Deeds Stamp & File Number

I, Brian Reynolds, in a field survey on March 2, 2007 do hereby certify that under requirements of P.A. 74, Michigan P.A. of 1970, the corner points mentioned in lines 1 and 2 above were in conformance with regulations and rules therefore as required in the current manual of survey instructions of the United States Department of the Interior, Bureau of Land Management or by a decree of a Court of Law and/or that the corner points mentioned in lines 3, 4, and 5 above were in conformance with the rules of the Michigan Board of Land Surveyors or by a Decree of a Court of Law; established, re-established, monumented, re-monumented, recovered, found as expressed below.

NOTE: Not more than 2 corners, in the same town and range, may be recorded on this certificate.

A. Description of original monument and accessories and/or subsequent restoration:

1826 GENERAL LAND OFFICE DEPUTY SURVEYOR HERVEY PARKE, FEBRUARY 1826, "...81.70 INT W (BOUNDARY) 160 LKS S OF (POST) COR TO SECS 1 & 12 T2N R3W SET (POST) COR TO SECS 6 & 7 (FROM WHICH) BE 6 N14E 16-1/2 Do 12 S31E 24 ..."

1867 INGHAM COUNTY DEPUTY SURVEYOR T. J. BROWN, MARCH 14, 1867, VOLUME 3, PAGE 24, SUBJECT CORNER IS DESIGNATED CORNER "D" ON THE PLAT, MONUMENT IS DESCRIBED AS "POST", NO WITNESSES. TOTAL DISTANCE OF 41.70 CHAINS SHOWN TO B-3, 40.00 CHAINS TO A-2.

NO CORNER INFORMATION ON THE INGHAM COUNTY ROAD COMMISSION WITNESS MAP FOR AURELIUS TOWNSHIP.

CORNER HISTORY CONTINUED ON PAGE TWO

B. Description of corner evidence found and/or method applied in restoring or reestablishing corner:

FOUND A 2-1/2" SOLID AXLE & HUB 2' LONG 71'± SOUTH OF CL COLUMBIA RD. ALSO FOUND TWO WITNESSES BY SURVEYOR YOUNG (1976) AND SURVEYOR STEADMAN (1977). EXCAVATED 2' X 2' X 2' HOLE. FOUND NO ADDITIONAL EVIDENCE OF PRIOR MONUMENTATION. MEASURED DISTANCE TO B-3 (2747.80') COMPARED FAVORABLY WITH DISTANCES OF RECORD. ACCEPTED AXLE SHAFT AS PROPER PERPETUATION OF ORIGINAL CORNER POSITION. TRAVERSE DISCLOSED THAT AXLE WAS 0.58 FEET EAST OF RANGE LINE. REPLACED AXLE SHAFT WITH STANDARD MONUMENT ON RANGE LINE.

C. Description of monument for corner and accessories established to perpetuate locating the position of the corner:

WITNESSES TO 3/4" X 24" STEEL FORM PIN WITH AN ALUMINUM CAP STAMPED "31602"
SET REMON IRON & CAP ON TOWN LINE AT AXLE SHAFT.
FOUND NAIL & TAG #28414 IN THE WEST SIDE OF A 50" SYCAMORE S15°E 9.25'
FOUND NAIL & TAG #28414 IN THE NORTH SIDE OF A 20" OAK EAST 38.05'
SET MAGNETIC NAIL & REMON TAG IN THE SOUTH SIDE OF A 5" MAPLE N85°E 6.28'
SET MAGNETIC NAIL & REMON TAG IN THE EAST SIDE OF A 5" HICKORY NORTH 7.43'
TO B-3 IS N89°49'08"E 2748.38 FEET TO A-2 IS N00°17'54"W 2752.18'
TO MC-4 (MEANDER CORNER ON THE WEST BANK OF THE GRAND RIVER) N89°49'08"E 168.30 FEET
71± FEET SOUTH OF THE CENTERLINE OF COLUMBIA ROAD S00°21'10"E 2542.27 FEET TO M-4 T2N R3W

P.A. 345 INGHAM COUNTY
PEER APPROVED 6/19/2007 M

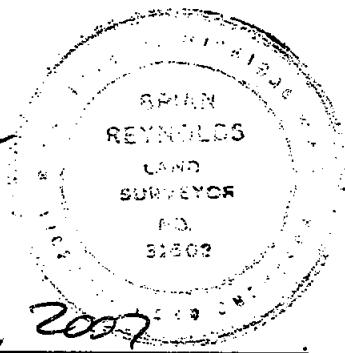

Signed by [Signature]
Surveyor's Michigan License No. 31602

Date SEPT 12, 2007
FORM APPROVED BY MICHIGAN STATE BOARD OF LAND SURVEYORS. JAN. 28, 1971
REVISED MAY 14, 1975 REVISED JANUARY, 1983 REVISED OCTOBER 1995

PAGE TWO

A. Description of original monument and accessories and/or subsequent restoration: **T2N R2W A-3 CONTINUED**

- 1976 ACT 132 SURVEY BY WOLVERINE ENGINEERS & SURVEYORS, INC., SIGNED AND SEALED BY GEORGE M. YOUNG, P.S. 17640, DATED 5-13-76, RECORDED JULY 6, 1976 IN LIBER 2, PAGES 783 & 784, SUBJECT CORNER DESCRIBED THUS: "...SOUTHWEST CORNER, SECTION 6 T2N, R2W, AURELIUS TWP., INGHAM COUNTY
NAIL IN 6" ASH N 45° E 13.68' NAIL IN 15" ASH "E" 37.85' NAIL IN 48" SYCAMORE S 05° E 8.68'
FOUND SHEARED OFF 1" AXLE SHAFT ..." DRAWING SHOWS TO B-3 IS N89°44'08"E 2747.99 FEET.
- 1976 LAND CORNER RECORDATION CERTIFICATE BY GEORGE M. YOUNG, P.S. 17640, DATED MAY 17, 1976, RECORDED JULY 6, 1976 IN LIBER 3, PAGES 586 & 587, PART A READS, "ORIGINAL MONUMENT & ACCESSORIES OBLITERATED- NO OTHER DATA AVAILABLE..."; PART B READS, "FOUND 1" SHEARED AXLE SHAFT 90°± SOUTH OF COLUMBIA ROAD..."; PART C READS, "NAIL IN 6" ASH N45° E 13.68' NAIL IN 15" ASH E 37.85'
NAIL IN 48" SYCAMORE S05° E 8.68'..."
- 1977 ACT 132 SURVEY BY G. A. STEADMAN & SON, INC., SIGNED AND SEALED BY RICHARD W. STEADMAN, P.S. 11370, DATED SEPTEMBER 14, 1977, RECORDED SEPTEMBER 16, 1977 IN LIBER 2, PAGES 1228 & 1229, SUBJECT CORNER DESCRIBED THUS: "...SOUTHWEST CORNER, SECTION 6, T2N, R2W FOUND 1" AXLE SHAFT
6" ASH N45°E 13.68' 15" ASH EAST 37.85' 48" SYCAMORE S5°E 8.68'..."
- 1978 MONUMENTED CORNER REPORT FROM INGHAM COUNTY SURVEY & REMONUMENTATION PROJECT DATED 3-28-1978, MONUMENT AND WITNESSES IDENTICAL TO THOSE BY SURVEYOR RICHARD STEADMAN ABOVE. THE GRAPHICAL SKETCH SHOWS THE CORNER BEING 70.55 FEET SOUTH OF CENTERLINE OF COLUMBIA ROAD, AND 434.50 FEET EAST OF TP 1232, WHICH IS ALSO AT CENTERLINE INTERSECTION WITH WAVERLY ROAD NORTH..
- 1978 ACT 132 SURVEY SIGNED AND SEALED BY ARTHUR A. IVEY, P.S. 6519, NOT DATED, RECORDED MAY 9, 1978 IN LIBER 3 PAGES 324 & 325, SUBJECT CORNER DESCRIBED THUS: "...NW COR. SEC. 7 A 1-1/2" STEEL SHAFT ABOUT 90' S. OF COLUMBIA ROAD AND ABOUT 100' W. OF THE RIVER,
NAIL IN 15" ASH, EAST 37.85' NAIL IN 6" ASH, N 45°E 13.68' NAIL IN 48" SYCAMORE, S 05°E 08.68'..."
DRAWING SHOWS TO B-3 IS S89°48'44"E 2747.80 FEET.
- 1986 ACT 132 SURVEY BY BRYAN LAND SURVEYS, P.C., SIGNED AND SEALED BY LARRY A. BRYAN, P.S. 25832, DATED 11-3-86, RECORDED APRIL 13, 1987 IN LIBER 5, PAGES 175-177, SUBJECT CORNER DESCRIBED THUS:
"...NORTHWEST CORNER SECTION 7, T2N, R2W FOUND 1" SHEARED AXLE SHAFT, LIBER 3, PAGE 586
SET NAIL & TAG IN NORTHWEST SIDE 6" ASH, EAST 13.70' SET NAIL & TAG IN NORTH SIDE 15" ASH, N45°E, 37.65'
SET NAIL & TAG IN NORTHEAST SIDE 48" SYCAMORE, S5°E, 9.28'..." TO B-3 IS S89°49'56"E 2747.85 FEET.
- 1988 TWO ACT 132 SURVEYS BY R. W. STEADMAN & ASSOCIATES, INC., SIGNED AND SEALED BY RICHARD W. STEADMAN, P.S. 11370, DATED JUNE 14, 1988 AND NOVEMBER 14, 1988, RECORDED DECEMBER 27, 1990 IN LIBER 6, PAGES 627 - 630, SUBJECT CORNER DESCRIBED THUS: "...S.W. CORNER OF SECTION 6, T2N, R2W - FOUND 1" IRON ROD AS RECORDED IN LIBER 3 ON PAGE 586 OF LAND CORNER RECORDATION CERTIFICATES OF INGHAM COUNTY.
6" ASH N45°E 13.68 FEET 15" ASH EAST 37.85 FEET 48" SYCAMORE S05°E 8.68 FEET..."
- 2000 SEVERAL ACT 132 SURVEYS BY WOLVERINE ENGINEERS & SURVEYORS, INC., SIGNED AND SEALED BY MAURICE H. MAHIEU, P.S. 28414, FIRST DATED 5/02/00, RECORDED 05/12/2000 IN LIBER 8, PAGE 716, SECOND DATED 4/26/00, RECORDED 5/12/2000, IN LIBER 8, PAGE 717, THIRD DATED JUNE 2, 2000, RECORDED 3/27/2001 IN LIBER 8, PAGE 826, SUBJECT CORNER DESCRIBED THUS: "...NORTHWEST CORNER SECTION 7 FOUND 1" SHEARED AXLE SHAFT ±90' S. OF COLUMBIA RD., WITNESSES: FOUND NAIL & CAP #25832 NW SIDE 8" ASH N4°SE 13.76'
SET NAIL & TAG #28414 W. SIDE 36" SYCAMORE, S10°10'E 37.53'
SET NAIL & TAG #28414 N. SIDE 18" ASH EAST 37.53'
SET NAIL & TAG #28414 NW SIDE 12" MAPLE, S55°W 35.58' ..." TO B-3 IS SHOWN AS S89°49'56"E 2747.76 FEET.

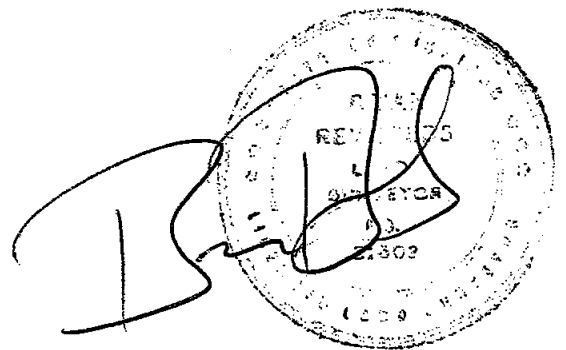

INGHAM COUNTY REMONUMENTATION
LAND CORNER RECORDATION CERTIFICATE
Filing Requirement of Act 74, Mich. P.A. 1970

For Corners in
INGHAM
(county)

Located In:

Corner Code #

1. Public Land Survey
NORTH 1/4 CORNER
SECTION 6
AURELIUS TOWNSHIP

T 2N R 2W

B-1

T _____ R _____

T _____ R _____

T _____ R _____

B: 13 P: 130 09/25/2007 09:14 AM
2007-041767 LAND CORNERS Receipt #32274
Paula Johnson, Ingham County, Michigan

Pages: 2



2. Property Controlling S _____ T _____ R _____
in Section S _____ T _____ R _____

Register of Deeds Stamp & File Number

3. Miscellaneous S _____ T _____ R _____

4. Lot No _____, Recorded Plat _____

5. Private Claims _____

I, Brian Reynolds, in a field survey on March 2, 2007 do hereby certify that under requirements of P.A. 74, Michigan P.A. of 1970, the corner points mentioned in lines 1 and 2 above were in conformance with regulations and rules therefore as required in the current manual of survey instructions of the United States Department of the Interior, Bureau of Land Management or by a decree of a Court of Law and/or that the corner points mentioned in lines 3, 4, and 5 above were in conformance with the rules of the Michigan Board of Land Surveyors or by a Decree of a Court of Law; established, re-established, monumented, re-monumented, recovered, found as expressed below.

NOTE: Not more than 2 corners, in the same town and range, may be recorded on this certificate.

A. Description of original monument and accessories and/or subsequent restoration:

CLOSING QUARTER CORNER NOT MONUMENTED BY THE GENERAL LAND OFFICE SURVEY

1825 REGARDING THE CORRESPONDING STANDARD CORNER, GENERAL LAND OFFICE DEPUTY SURVEYOR
JOHN MULLETT, MAY 1825, "...WEST ON S BDY 31 T3N R2W.....40.00 SET QR. (POST)
(FROM WHICH) BE 7 N79E 42 Do 7 N21W 29 ..."

1852 INGHAM COUNTY SURVEYOR RECORD BY A. JACKSON, VOLUME 1, PAGE 282, "...BEECH 10 S 76-1/4 E 42,
D O 10 N 8 E 7..." MONUMENT NOT DESCRIBED. DISTANCE TO C-1 IS SHOWN AS "160 RODS."

NO CORNER INFORMATION ON THE INGHAM COUNTY ROAD COMMISSION WITNESS MAP FOR AURELIUS TOWNSHIP.

CORNER HISTORY CONTINUED ON PAGE TWO

B. Description of corner evidence found and/or method applied in restoring or reestablishing corner:

AT APPARENT CORNER LOCATION, FOUND A 1/2" IRON, CAP OBLITERATED. TIED IN THE IRON, THEN DUG 2' X 2' HOLE. AT 1.5' BELOW GRADE, FOUND A 5" X 5" X 15" STONE WITH SOME BRICK & PARTS OF OLD METAL BUCKET AROUND IT. THE IRON AS FOUND WAS ON THE SOUTH SIDE OF STONE. TIED IN THE STONE, COMPUTED POSITION RELATIVE TO TOWN LINE. AS FOUND, THE IRON WAS 0.16 FEET SOUTH OF TOWN LINE, THE STONE WAS 0.20 FEET NORTH OF TOWN LINE. MEASURED DISTANCE TO B-2 2731.31, CLOSELY CONFORMING WITH DISTANCE BY WOLVERINE. ACCEPTED STONE WITH BRICK AND IRON AS PROPER PERPETUATION OF CORNER POSITION AS ORIGINALLY MONUMENTED BY COUNTY SURVEYOR A. JACKSON IN 1852. REMOVED IRON AND STONE, REPLACED BOTH WITH A STANDARD REMONUMENTATION IRON & CAP ON TOWN LINE AT STONE LOCATION.

C. Description of monument for corner and accessories established to perpetuate locating the position of the corner:

WITNESSES TO 3/4" X 24" STEEL FORM PIN WITH AN ALUMINUM CAP STAMPED "31602"
FOUND NAIL & TAG #28414 IN THE SOUTHEAST SIDE OF A 36" MAPLE N°19E 33.62 FEET
FOUND NAIL & TAG #28414 3'± HIGH IN THE EAST SIDE OF A 24" SASSAFRAS N55°W 49.80 FEET
FOUND NAIL & TAG #28414 3'± HIGH IN THE WEST SIDE OF A 12" OAK S5°W 28.08 FEET
FOUND NAIL & STEPHENS TAG IN THE NORTHWEST SIDE OF A CUT OFF POWER POLE S30°W 38.08 FEET
FOUND NAIL & TAG #18998 5'± HIGH IN THE EAST SIDE OF A 12" OAK S40°W 19.96 FEET
SET MAGNETIC NAIL & INGHAM REMON TAG IN THE NORTHWEST SIDE OF A RAILROAD TIE N45°E 50.04 FEET
THIS CORNER IS OFF THE ROAD TO THE NORTHWEST OF THE ARC FORM NICHOLS ROAD TO KINGMAN ROAD.
B-13 T3N R2W (REMON IRON) EAST 40.00 FEET TO A-1 IS N89°42'30"W 2779.91 FEET
TO B-2 IS S00°02'31"E 2731.31 FEET TO C-1 IS S89°55'17"E 2656.76 FEET

Signed by [Signature]
Surveyor's Michigan License No 31602

P.A. 345 INGHAM COUNTY
PEER APPROVED 6/19/2007 PC

Date SEP 12, 2007
FORM APPROVED BY MICHIGAN STATE BOARD OF LAND SURVEYORS JAN. 28, 1971
REVISED MAY 14, 1975 REVISED JANUARY, 1983 REVISED OCTOBER 1995

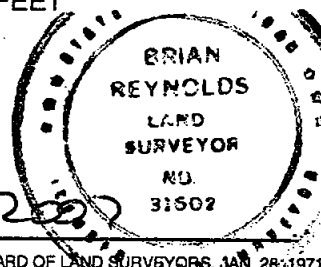

PAGE TWO

A. Description of original monument and accessories and/or subsequent restoration: T2N R2W B-1 CONTINUED

- 1976 LAND CORNER RECORDATION CERTIFICATE BY GEORGE M. YOUNG, P.S. 17640, DATED MAY 17, 1976, RECORDED JULY 6, 1976 IN LIBER 3, PAGES 588 & 589, PART A READS, "... ORIGINAL MONUMENT & ACCESSORIES OBLITERATED - NO OTHER DATA AVAILABLE..." PART B READS, "...FOUND STONE WITH PIECES OF OLD FIRE BRICK & A FOLDED PIECE OF SHEET METAL BESIDE. SET 1/2" RE-ROD WITH CAP BESIDE..." PART C READS, "... NAIL & WASHER IN 24" MAPLE N02° E 33.9' NAIL & WASHER IN 30" WALNUT N50° W 49.4' NAIL & WASHER IN 12" WALNUT S45° E 28.2'..." ACT 132 SURVEY BY WOLVERINE ENGINEERS & SURVEYORS, INC, ALSO SIGNED AND SEALED BY GEORGE M. YOUNG, DATED 5-13-76, RECORDED JULY 6, 1976 IN LIBER 2, PAGES 783 & 784, DESCRIBES SAME WITNESSES. TO A-1 IS SHOWN N89°47'28"W 2780.84 FEET TO C-1 IS SHOWN EAST 2656.74 FEET TO B-2 IS SHOWN S00°01'10"E 2731.89 FEET
- 1977 INGHAM COUNTY SURVEY & REMONUMENTATION PROJECT TRAVERSE POINT WITNESS REPORT DATED 12-12-1977 "...FD. 1/2" REROD W/ CAP RLS #17640 SURVEY TAG ON E. SIDE OF 14" WALNUT S45° E 27.96' SURVEY TAG ON W. SIDE OF 26" MAPLE N02° E 34.34' SURVEY TAG ON E. SIDE OF 32" WALNUT N50° W 49.61' ..."
- 1978 ACT 132 SURVEY BY WOLVERINE ENGINEERING COMPANY, SIGNED AND SEALED BY GEORGE M. YOUNG, P.S. 17640, DATED JUNE 1, 1978, RECORDED JUNE 20, 1978 IN LIBER 3 PAGES 376 & 377, SUBJECT CORNER DESCRIBED THUS: "... NORTH 1/4 CORNER - B1 SECTION 6, T2N-R2W AURELIUS TOWNSHIP, INGHAM COUNTY AS RECORDED, LIBER 2, PAGE 783, INGHAM COUNTY RECORDS..." NO WITNESSES.
- 1978 ACT 132 SURVEY BY WOLVERINE ENGINEERING COMPANY, SIGNED AND SEALED BY GEORGE M. YOUNG, P.S. 17640, DATED JUNE 26, 1978, RECORDED JULY 6, 1978 IN LIBER 3 PAGE 386, SUBJECT CORNER DESCRIBED THUS: "... NORTH 1/4 CORNER SECTION 6, T2N-R2W AURELIUS TWP., INGHAM CO., MICH. FOUND 1/2" CAPPED REROD AS RECORDED, LIBER 2, PAGE 783, INGHAM COUNTY RECORDS..." NO WITNESSES.
- 1978 ACT 132 SURVEY BY WOLVERINE ENGINEERING COMPANY, SIGNED AND SEALED BY GEORGE M. YOUNG, P.S. 17640, DATED JULY 17, 1978, RECORDED SEPTEMBER 15, 1978 IN LIBER 3 PAGE 526, SUBJECT CORNER DESCRIBED THUS: "... NORTH 1/4 CORNER SECTION 6, T2N-R2W AURELIUS TWP., INGHAM CO., MICH. FOUND STONE W/1/2" CAPPED REROD. AS RECORDED, LIBER 2, PAGE 783, INGHAM COUNTY RECORDS..." NO WITNESSES.
- 1979 SEVERAL ACT 132 SURVEYS BY WOLVERINE ENGINEERING CO., SIGNED AND SEALED BY GEORGE M. YOUNG, P.S. 17640, DATED JANUARY 26, 1979, RECORDED MARCH 5, 1979 IN LIBER 3 PAGES 765, 766 & 767, AND LIBER 4, PAGE 355, SUBJECT CORNER DESCRIBED THUS: "... NORTH 1/4 CORNER, SEC 6, T2N-R2W AURELIUS TOWNSHIP, INGHAM COUNTY NAIL & WASHER IN 30" WALNUT, N 50° W 49.4' NAIL & WASHER IN 24" MAPLE, N 02° E 33.9' NAIL & WASHER IN 12" WALNUT, S 45° E 28.2' FOUND STONE AND 1/2" RE-ROD WITH CAP. AS RECORDED IN LIBER 2, PAGE 783, INGHAM COUNTY RECORDS..."
- 1979 ACT 132 SURVEY BY WOLVERINE ENGINEERING CO., SIGNED AND SEALED BY GEORGE M. YOUNG, P.S. 17640, DATED 6/15/79, RECORDED JUNE 21, 1979 IN LIBER 3 PAGE 890, SUBJECT CORNER DESCRIBED THUS: "... NORTH 1/4 POST, SECTION 6, T2N, R2W AURELIUS TOWNSHIP, INGHAM COUNTY NAIL & WASHER IN 30" WALNUT, N 50° W 49.4' NAIL & WASHER IN 24" MAPLE, N 02° E 33.9' NAIL & WASHER IN 12" WALNUT, S 45° E 28.2' FOUND STONE SET 1/2" RE-ROD WITH CAP RECORDED LIBER 2, PAGE 783 ..."
- 1982 ACT 132 SURVEY BY WOLVERINE ENGINEERING COMPANY, SIGNED AND SEALED BY GEORGE M. YOUNG, P.S. 17640, DATED NOV. 23, 1982, RECORDED MARCH 17, 1983 IN LIBER 4 PAGE 633, SUBJECT CORNER DESCRIBED THUS: "... NORTH 1/4 COR., SEC. 6, T2N-R2W AURELIUS TOWNSHIP, INGHAM CO., MI FND. STONE W/1/2" CAPPED REROD AS RECORDED LIBER 2, PAGE 783, INGHAM COUNTY RECORDS..." NO WITNESSES.
- 1985 RECORDED PLAT OF RIVER BEND PARK SUBDIVISION, BY POLARIS SURVEYING COMPANY, SIGNED AND SEALED BY RONNIE M. LESTER, P.S. No. 18998, RECORDED JULY 25, 1985 IN LIBER 39 OF PLATS, PAGES 23 & 24, SUBJECT CENTER OF SECTION IS SHOWN ON THE PLAT DRAWING, MONUMENT NOT DESCRIBED, NOT WITNESSED.
- 1987 ACT 132 SURVEY BY WOLVERINE ENGINEERING CO., SIGNED AND SEALED BY GEORGE M. YOUNG, P.S. 17640, DATED FEBRUARY, 1987, RECORDED MARCH 31, 1987 IN LIBER 5 PAGES 470 & 471, SUBJECT CORNER DESCRIBED THUS: "... NORTH 1/4 POST, SEC. 6, T2N,-R2W AURELIUS TOWNSHIP, INGHAM CO., MI FND. 1/2" RE-ROD WITH CAP NAIL & WASHER IN 30" WALNUT, N 50° W 49.4' NAIL & WASHER IN 24" MAPLE, N 02° E 33.9' NAIL & WASHER IN 12" WALNUT, S 45° E 28.2' RECORDED LIBER 3, PAGE 588 ..."
- 1998 ACT 132 SURVEY BY POLARIS SURVEYING CO., SIGNED AND SEALED BY RONNIE M. LESTER, P.S. 18998, RECORDED 06/01/1998 IN LIBER 8, PAGES 206-207, SUBJECT CORNER DESCRIBED THUS: "...WITNESSES TO GOVERNMENT CORNERS: NORTH 1/4 CORNER SECTION 6, T2N, R2W. 1/2" BAR AND CAP. LIBER 3, PAGE 588. FOUND NAIL AND TAG #28414 E. SIDE 36" MAPLE MAG. AZ. 20°, 33.67' FOUND NAIL AND TAG #28414 E. SIDE 30" WALNUT MAG. AZ. 310°, 49.83' FOUND NAIL AND TAG #28414 W. SIDE 10" WALNUT MAG. AZ. 190°, 27.90' FOUND NAIL AND TAG #18998 E. SIDE 15" ASH MAG. AZ. 230°, 19.85'..."
- 1999 ACT 132 SURVEY BY WOLVERINE ENGINEERING CO., SIGNED AND SEALED BY MAURICE H. MAHIEU, P.S. 28414, DATED 6-3-99, RECORDED DATE OBLITERATED, IN LIBER PAGE 604, SUBJECT CORNER DESCRIBED THUS: "...NORTH 1/4 COR., SEC. 6, T2N, R2W, AURELIUS TWP. 1/2" REROD WITH CAP WITNESSES: NAIL & WASHER IN 24" MAPLE, N02°E 33.9' NAIL & WASHER IN 30" WALNUT, N50°E 49.4' NAIL & WASHER IN 12" WALNUT, S45°E 28.2'..."

BRIAN REYNOLDS
LAND SURVEYOR
NO. 31602

INGHAM COUNTY REMONUMENTATION

LAND CORNER RECORDATION CERTIFICATE

Filing Requirement of Act 74, Mich. P.A. 1970

For Corners in

Located In:

Corner Code #

INGHAM

(county)

1. Public Land Survey
CENTER 1/4 CORNER
SECTION 6
AURELIUS TOWNSHIP

T 2N R 2W

B-2

T R

T R

T R

B: 13 P: 131 09/25/2007 09:14 AM
2007-041768 LAND CORNERS Receipt #32274
Paula Johnson, Ingham County, Michigan

Pages: 2



2. Property Controlling S T R
in Section S T R

3. Miscellaneous S T R

4. Lot No , Recorded Plat

5. Private Claims

Register of Deeds Stamp & File Number

	A	B	C	D	E	F	G	H	I	J	K	L	M
1													
2		6		5		4		3		2		1	
3													
4		7		8		9		10		11		12	
5													
6		18		17		16		15		14		13	
7													
8		19		20		21		22		23		24	
9													
10		30		29		28		27		26		25	
11													
12		31		32		33		34		35		36	
13													

I, Brian Reynolds, in a field survey on August 20, 2007 do hereby certify that under requirements of P.A. 74, Michigan P.A. of 1970, the corner points mentioned in lines 1 and 2 above were in conformance with regulations and rules therefore as required in the current manual of survey instructions of the United States Department of the Interior, Bureau of Land Management or by a decree of a Court of Law and/or that the corner points mentioned in lines 3, 4, and 5 above were in conformance with the rules of the Michigan Board of Land Surveyors or by a Decree of a Court of Law; established, re-established, monumented, re-monumented, recovered, found as expressed below.

NOTE: Not more than 2 corners, in the same town and range, may be recorded on this certificate.

A. Description of original monument and accessories and/or subsequent restoration:

CENTER OF SECTION NOT MONUMENTED BY THE GENERAL LAND OFFICE SURVEY

NO CORNER INFORMATION ON THE INGHAM COUNTY ROAD COMMISSION WITNESS MAP FOR AURELIUS TOWNSHIP.

CORNER HISTORY CONTINUED ON PAGE TWO

B. Description of corner evidence found and/or method applied in restoring or reestablishing corner:

AT APPARENT CORNER LOCATION, FOUND TWO IRON BARS IN ROAD PAVEMENT, ABOUT 8 FEET APART IN A NORTHEAST-SOUTHWEST LINE, BOTH APPEARING TO BE "OLD". TRAVERSED ALL OF SECTION 6, RESULTING MEASUREMENTS DISCLOSE THAT THE SOUTHWESTERLY OF THE TWO IRONS IS 0.72 FEET NORTH-NORTHEAST OF THE INTERSECTION OF RIGHT LINES, THE OTHER 8.33 FEET NORTHEAST. NO DOCUMENT CAN BE FOUND SUPPORTING THE NORTHEASTERLY IRON, EXCEPT THE FENCE SHOWN ON THE SURVEY (LIBER 2 PAGE 784) BY GEORGE YOUNG DATED 1976 WHICH SHOWS A FENCE LINE THAT WOULD VERY NEARLY LINE UP WITH THE NORTHEASTERLY IRON. REMAINING WITNESSES, HALF-MILE MEASUREMENTS AND PROXIMITY TO INTERSECTION OF RIGHT LINES ALL FAVOR THE SOUTHWESTERLY IRON. BASED ON THE PREPONDERANCE OF THE EVIDENCE, ACCEPTED THE SOUTHWESTERLY IRON AS THE PROPER CORNER LOCATION ORIGINALLY MONUMENTED BY SURVEYOR YOUNG. REPLACED FOUND IRON WITH 3/4" X 24" STEEL FORM PIN WITH AN ALUMINUM CAP STAMPED "31602", INSTALLED MONUMENT BOX, WITNESSED AS DESCRIBED BELOW. LEFT UNDOCUMENTED IRON IN PLACE.

C. Description of monument for corner and accessories established to perpetuate locating the position of the corner:

WITNESSES TO 3/4" X 24" STEEL FORM PIN WITH AN ALUMINUM CAP STAMPED "31602" IN MONUMENT BOX
FOUND NAIL & TAG No. 28414 IN THE EAST SIDE OF A 14" POPLAR N30°W 61.66 FEET
FOUND NAIL & TAG No. 28414 IN THE EAST SIDE OF A 40" MAPLE N10°W 168.20 FEET
FOUND NAIL & TAG No. 28414 IN THE WEST SIDE OF A 40" WALNUT N08°E 196.00 FEET
FOUND NAIL & TAG No. 28414 IN THE WEST SIDE OF A UTILITY POLE S19°E 136.80 FEET
1/2" IRON OF UNKNOWN ORIGIN N39°E 7.67 FEET
S89°59'04"W 2764.36' TO A-2 S89°59'10"E 2654.22' TO C-2
S00°03'55"W 2638.31' TO B-3 N00°03'30"E 2737.30' TO B-1
5 FEET WEST OF PHYSICAL ROAD CENTERLINE
NO VISIBLE LINES OF OCCUPATION EAST OR WEST

P.A. 345 INGHAM COUNTY
PEER APPROVED 8/21/2007 re

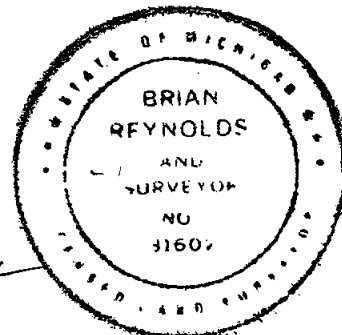

Signed by [Signature]
Surveyor's Michigan License No 31602

Date AUGUST 20, 2007

FORM APPROVED BY MICHIGAN STATE BOARD OF LAND SURVEYORS. JAN. 28, 1971

REVISED MAY 14, 1975 REVISED JANUARY, 1983 REVISED OCTOBER 1995

PAGE TWO

A. Description of original monument and accessories and/or subsequent restoration: T2N R2W B-2, CONTINUED

- 1976 TWO ACT 132 SURVEYS BY WOLVERINE ENGINEERS & SURVEYORS, INC., SIGNED AND SEALED BY GEORGE M. YOUNG, P.S. 17640, DATED 5-13-76 AND 6-16-76, RECORDED JULY 6, 1976 IN LIBER 2, PAGES 783 & 784, AND JULY 15, 1976 IN LIBER 2, PAGE 816, SUBJECT CORNER DESCRIBED THUS: "...CENTER OF SECTION, SECTION 6 T2N, R2W, AURELIUS TWP., INGHAM COUNTY
NAIL IN 24" MAPLE N 15° W 167.10' NAIL IN 36" WALNUT N 20° E 196.41'
NAIL IN POWER POLE S 20° E 134.82' SET 1/2" RE-ROD WITH CAP FLUSH WITH ASPHALT ..."
TO A-2 IS SHOWN AS S89°54'01"W 2764.36 FEET TO C-2 IS SHOWN AS 2654.62 FEET
TO B-1 IS SHOWN AS N00°01'10"W 2731.89 FEET TO B-3 IS SHOWN AS S00°01'10"E 2638.04 FEET
- 1976 LAND CORNER RECORDATION CERTIFICATE BY GEORGE M. YOUNG, P.S. 17640, DATED MAY 17, 1976, RECORDED JULY 6, 1976 IN LIBER 3, PAGES 588 & 589, PART A READS, "... NO DATA AVAILABLE..." PART B READS, "...SET 1/2" RE-ROD WITH CAP FLUSH WITH ASPHALT AT THE INTERSECTION OF 2 STRAIGHT LINES BETWEEN THE N & S 1/4 POSTS AND THE E & W 1/4 POSTS RESPECTIVELY..." PART C READS, "...NAIL IN 24" MAPLE N15°W 167.10' NAIL IN 36" WALNUT N20° E 196.41' NAIL IN POWER POLE S20° E 134.82'..."
- 1977 ACT 132 SURVEY BY G. A. STEADMAN & SON, INC., SIGNED AND SEALED BY RICHARD W. STEADMAN, P.S. 11370, DATED SEPTEMBER 14, 1977, RECORDED SEPTEMBER 16, 1977 IN LIBER 2, PAGES 1228 & 1229, SUBJECT CORNER DESCRIBED THUS: "...CENTER OF SECTION 6, T2N, R2W FOUND 1/2" IRON ROD
24" MAPLE N15°W 167.10' 36" WALNUT N20°E 196.41' P POLE S20°E 134.82'..."
- 1978 ACT 132 SURVEY BY WOLVERINE ENGINEERING COMPANY, SIGNED AND SEALED BY GEORGE M. YOUNG, P.S. 17640, DATED JUNE 1, 1978, RECORDED JUNE 20, 1978 IN LIBER 3 PAGES 376 & 377, SUBJECT CORNER DESCRIBED THUS: "... CENTER OF SECTION - B2 SECTION 6, T2N-R2W AURELIUS TOWNSHIP, INGHAM COUNTY AS RECORDED, LIBER 2, PAGE 783, INGHAM COUNTY RECORDS..." NO WITNESSES.
TO B-1 IS SHOWN AS N00°01'10"W 2737.25 FEET
- 1985 RECORDED PLAT OF RIVER BEND PARK SUBDIVISION, BY POLARIS SURVEYING COMPANY, SIGNED AND SEALED BY RONNIE M. LESTER, P.S. No. 18998, RECORDED JULY 25, 1985 IN LIBER 39 OF PLATS, PAGES 23 & 24, SUBJECT CENTER OF SECTION IS SHOWN ON THE PLAT DRAWING, MONUMENT NOT DESCRIBED, NOT WITNESSED.
- 1986 ACT 132 SURVEY BY WOLVERINE ENGINEERS & SURVEYORS, INC., SIGNED AND SEALED BY GEORGE M. YOUNG, P.S. 17640, DATED AUGUST 19, 1986, RECORDED SEPTEMBER 26, 1986 IN LIBER 5, PAGES 53 & 54, SUBJECT CORNER DESCRIBED THUS: "...CENTER OF SECTION, SECTION 6 T2N, R2W, AURELIUS TWP., INGHAM COUNTY
1/2" RE-ROD WITH CAP FLUSH WITH ASPHALT NAIL IN 24" MAPLE N 15° W 167.10'
NAIL IN 36" WALNUT N 20° E 196.41' NAIL IN POWER POLE S 20° E 134.82'..."
- 1987 ACT 132 SURVEY BY WOLVERINE ENGINEERS & SURVEYORS, INC., SIGNED AND SEALED BY GEORGE M. YOUNG, P.S. 17640, DATED FEBRUARY, 1987, RECORDED MARCH 31, 1987 IN LIBER 5, PAGES 170 & 171, SUBJECT CORNER DESCRIBED THUS: "...CENTER OF SECTION 6 T2N-R2W, AURELIUS TOWNSHIP, INGHAM CO., MI
FND. 1/2" RE-ROD WITH CAP FLUSH W/ASPHALT NAIL IN 24" MAPLE N 15° W 167.10'
NAIL IN 36" WALNUT N 20° E 196.41' NAIL IN P.P., S 20° E 134.82
RECORDED LIBER 3, PAGE 588'..."
- 1988 TWO ACT 132 SURVEYS BY R. W. STEADMAN & ASSOCIATES, INC., SIGNED AND SEALED BY RICHARD W. STEADMAN, P.S. 11370, DATED JUNE 14, 1988 AND NOVEMBER 14, 1988, RECORDED DECEMBER 27, 1990 IN LIBER 6, PAGES 627 - 630, SUBJECT CORNER DESCRIBED THUS: "...CENTER OF SECTION 6, T2N, R2W FOUND 1/2" IRON ROD AS RECORDED IN LIBER 3 ON PAGE 588 OF LAND CORNER RECORDATION CERTIFICATES OF INGHAM COUNTY.
24" MAPLE N15°W 167.10 FEET 36" WALNUT N20°E 196.41 FEET POWER POLE S20°E 134.82 FEET..."
- 1989 RECORDED PLAT OF THE GREAT OUTBACK, BY R. W. STEADMAN & ASSOCIATES, SIGNED AND SEALED BY RICHARD W. STEADMAN, P.S. No. 11370, RECORDED SEPTEMBER 1, 1989 IN LIBER 44 OF PLATS, PAGES 47 & 48, SUBJECT CENTER OF SECTION IS SHOWN ON THE PLAT DRAWING, MONUMENT NOT DESCRIBED, NOT WITNESSED.
- 1998 ACT 132 SURVEY BY POLARIS SURVEYING CO., SIGNED AND SEALED BY RONNIE M. LESTER, P.S. 18998, DATED 5/12/98, RECORDED 06/01/1998 IN LIBER 8, PAGES 206 & 207, SUBJECT CORNER DESCRIBED THUS: "...WITNESSES TO GOVERNMENT CORNERS: CENTER OF SECTION 6, T2N, R2W. 1/2" BAR 4.6' WEST OF CENTERLINE OF KINGMAN ROAD. LIBER 3, PAGE 588. WEST EDGE STEEL POST MAG. AZ. 85°, 37.00'
FOUND NAIL AND TAG #28414 E. SIDE 38" MAPLE MAG. AZ. 355°, 168.26'
FOUND NAIL AND TAG #28414 E. SIDE U. POLE MAG. AZ. 358°, 174.64'
FOUND NAIL AND TAG #28414 W. SIDE 40" WALNUT MAG. AZ. 13°, 196.31'..."
DRAWING SHOWS S00°16'02"E 2737.18 FEET TO B-1
- 1999 ACT 132 SURVEY BY WOLVERINE ENGINEERS AND SURVEYORS, INC, SIGNED AND SEALED BY MAURICE H. MAHIEU, P.S. 28414, DATED 6-3-99, RECORDED DATE OBLITERATED, IN LIBER 8, PAGE 604, SUBJECT CORNER DESCRIBED THUS: "...CENTER OF SEC. 6, T2N, R2W, AURELIUS TWP., 1/2" REROD WITH CAP WITNESSES:
NAIL IN 24" MAPLE, N15°W 167.10' NAIL IN 36"WALNUT, N20°E 196.41'
NAIL IN POWER POLE, S20°E 134.82'..." DRAWING SHOWS N00°00'00"E 2737.07 FEET TO B-1
- 2004 ACT 132 SURVEY BY WOLVERINE ENGINEERS & SURVEYORS, INC., SIGNED AND SEALED BY MAURICE H. MAHIEU, P.S. 28414, DATED 12-29-04, RECORDED 01/10/2005 IN LIBER 9, PAGE 141, SUBJECT CORNER DESCRIBED THUS: "...CENTER OF SECTION 6 T2N, R2W, AURELIUS TWP. FND. 1/2" IRON ROD 5'± WEST OF C/L KINGMAN RD.
WITNESSES: N&T #28414 E. SIDE 12" POPLAR, N25°W 61.71' N&T #28414 E. SIDE 40" MAPLE, N05°E 196.22'
N&T #28414 W. SIDE 48" WALNUT, N14°E 196.22' N&T #28414 W. SIDE UTILITY POLE, N23°E 168.90' ..."
DRAWING SHOWS N89°55'57"E 2654.22 FEET TO C-2 S00°01'06"E 2638.20 FEET TO B-3

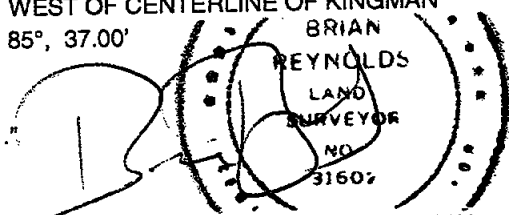

INGHAM COUNTY REMONUMENTATION
LAND CORNER RECORDATION CERTIFICATE
Filing Requirement of Act 74, Mich. P.A. 1970

For Corners in
INGHAM
(county)

Located In:

Corner Code #

1. Public Land Survey
1/4 CORNER COMMON
TO SECTIONS 6 & 7
AURELIUS TOWNSHIP

T 2N R 2W
T _____ R _____
T _____ R _____
T _____ R _____

B-3

B: 13 P: 132 09/25/2007 09:14 AM
2007-041769 LAND CORNERS Receipt #32274
Paula Johnson, Ingham County, Michigan

Pages: 2



2. Property Controlling S _____ T _____ R _____
in Section S _____ T _____ R _____

3. Miscellaneous S _____ T _____ R _____

4. Lot No _____, Recorded Plat _____

5. Private Claims _____

Register of Deeds Stamp & File Number

I, Brian Reynolds, in a field survey on August 17, 2007 do hereby certify that under requirements of P.A. 74, Michigan P.A. of 1970, the corner points mentioned in lines 1 and 2 above were in conformance with regulations and rules therefore as required in the current manual of survey instructions of the United States Department of the Interior, Bureau of Land Management or by a decree of a Court of Law and/or that the corner points mentioned in lines 3, 4, and 5 above were in conformance with the rules of the Michigan Board of Land Surveyors or by a Decree of a Court of Law; established, re-established, monumented, re-monumented, recovered, found as expressed below.

NOTE: Not more than 2 corners, in the same town and range, may be recorded on this certificate.

A. Description of original monument and accessories and/or subsequent restoration:

1826 GENERAL LAND OFFICE DEPUTY SURVEYOR HERVEY PARKE, FEBRUARY, 1826,
"... 40.00 SET QR (POST, FROM WHICH) TAM 16 S29E 17BLUE BE 6 N20W 25-1/2..."

NO CORNER INFORMATION ON THE INGHAM COUNTY ROAD COMMISSION WITNESS MAP FOR AURELIUS TOWNSHIP.

1976 TWO ACT 132 SURVEYS BY WOLVERINE ENGINEERS & SURVEYORS, INC., SIGNED AND SEALED BY GEORGE M. YOUNG, P.S. 17640, DATED 5-13-76 AND 6-16-76, RECORDED JULY 6, 1976 IN LIBER 2, PAGES 783 & 784, AND JULY 15, 1976 IN LIBER 2, PAGE 816, SUBJECT CORNER DESCRIBED THUS: "...SOUTH 1/4 POST, SECTION 6 T2N, R2W, AURELIUS TWP., INGHAM COUNTY NAIL IN GUY POLE S 80° E 117.30' NAIL IN POWER POLE N 80° E 91.03' NAIL IN POWER POLE N 80° W 101.87' FOUND BOAT SPIKE SET 1/2" RE-ROD WITH CAP ..."
(BOAT SPIKE NOT NOTED IN 6-16-76 SURVEY) DRAWING SHOWS S89°44'08"W 2747.99 FEET TO A-3
S89°55'35"E 2660.10 FEET TO C-3 N00°01'10"W 2638.04 FEET TO B-2
CORNER HISTORY CONTINUED ON PAGE TWO

B. Description of corner evidence found and/or method applied in restoring or reestablishing corner:

POWER POLE WITNESSES FROM 1976 ARE GONE. MOST WITNESSES FROM 2000 AND 2004 ARE INTACT. FOUND A 1/2" REBAR 3 FEET LONG IN A MONUMENT BOX AT THE INTERSECTION OF CENTERLINES OF COLUMBIA ROAD AND KINGMAN ROAD. SET OFFSETS, THEN EXCAVATED THROUGH MONUMENT BOX, FOUND NO ADDITIONAL EVIDENCE OF PRIOR CORNER MONUMENTATION. ACCEPTED FOUND REBAR AS A PROPER PERPETUATION OF CORNER POSITION, REPLACED WITH 3/4" X 24" STEEL FORM PIN WITH AN ALUMINUM CAP STAMPED "31602", WITNESSED AS DESCRIBED BELOW.

C. Description of monument for corner and accessories established to perpetuate locating the position of the corner:

WITNESSES TO 3/4" X 24" STEEL FORM PIN WITH AN ALUMINUM CAP STAMPED "31602" IN A MONUMENT BOX
FOUND NAIL & TAG No. 28414 IN THE SOUTH SIDE OF A UTILITY POLE N70°E 93.52 FEET
FOUND NAIL & TAG No. 28414 IN THE NORTH SIDE OF A 10" ASPEN S67°W 88.10 FEET
FOUND NAIL & TAG No. 28414 IN THE SOUTHEAST SIDE OF A 20" MAPLE N41°E 74.78 FEET
FOUND NAIL & TAG No. 18998 IN THE NORTH SIDE OF A UTILITY POLE N72°W 107.30 FEET
FOUND NAIL & TAG No. 18994 IN THE NORTH SIDE OF A UTILITY POLE S77°E 117.28 FEET
S89°49'08"W 2747.80 FEET TO A-3 S89°50'47"E 2660.19 FEET TO C-3
N00°03'55"E 2638.31 FEET TO B-2 1± FOOT NORTH OF MARKED ROAD CENTERLINE
ANY OCCUPATION TO THE SOUTH IS OBSCURED BY DENSE FOLIAGE

P.A. 345 INGHAM COUNTY
PEER APPROVED 8/21/2007 *m*

[Signature]

Signed by _____
Surveyor's Michigan License No 31602

Date AUGUST 17, 2007

FORM APPROVED BY MICHIGAN STATE BOARD OF LAND SURVEYORS. JAN. 28, 1971

REVISED MAY 14, 1975 REVISED JANUARY, 1983 REVISED OCTOBER 1995

PAGE TWO

A. Description of original monument and accessories and/or subsequent restoration: **T2N R2W B-3 CONTINUED**

- 1976 LAND CORNER RECORDATION CERTIFICATE BY GEORGE M. YOUNG, P.S. 17640, DATED MAY 17, 1976, RECORDED JULY 6, 1976 IN LIBER 3, PAGES 588 & 589, PART A READS, "... ORIGINAL MONUMENT & ACCESSORIES OBLITERATED - NO OTHER DATA AVAILABLE..." PART B READS, "...FOUND BOAT SPIKE 6" UNDER ASPHALT RE-SET WITH 1/2" RE-ROD & CAP CHECKS WITH OLD INGHAM COUNTY DRAIN COMMISSION RECORDS..." PART C READS, "...NAIL IN POWER POLE N80° W 101.87' NAIL IN POWER POLE N80° E 91.03' NAIL IN GUY POLE S80° E 117.30'..."
- 1977 ACT 132 SURVEY BY G. A. STEADMAN & SON, INC., SIGNED AND SEALED BY RICHARD W. STEADMAN, P.S. 11370, DATED SEPTEMBER 14, 1977, RECORDED SEPTEMBER 16, 1977 IN LIBER 2, PAGES 1228 & 1229, SUBJECT CORNER DESCRIBED THUS: "...SOUTH 1/4 CORNER SECTION 6, T2N, R2W FOUND 1/2" IRON ROD P POLE N80°W 101.87' P POLE N80°E 91.03' GUY POLE S80°E 117.03'..."
- 1978 ACT 132 SURVEY SIGNED AND SEALED BY ARTHUR A. IVEY, P.S. 6519, NOT DATED, RECORDED MAY 9, 1978 IN LIBER 3 PAGES 324 & 325, SUBJECT CORNER DESCRIBED THUS: "...N1/4 COR. SEC. 7 A 1/2" RE-ROD & CAP IN COLUMBIA & KINGMAN RDS NAIL IN P. POLE N80°W 101.87' NAIL IN P. POLE N80°E 91.03' NAIL IN GUY POLE, S80°E 117.30'..." DRAWING INDICATES N89°48'44"W 2430.97 FEET TO A-3
- 1978 ACT 132 SURVEY SIGNED AND SEALED BY FRED N. WHITE, P.S. 12034, DATED JUNE 7, 1978, RECORDED AUGUST 29, 1978 IN LIBER 3 PAGE 504, SUBJECT CORNER DESCRIBED THUS: "...S 1/4 COR. SEC. 6 T2N-R2W (LIBER 3-PG. 588)..." NO WITNESSES. DRAWING INDICATES 2660.25 FEET TO C-3
- 1986 AN ACT 132 SURVEY BY BRYAN LAND SURVEYS, P.C., SIGNED AND SEALED BY LARRY A. BRYAN, P.S. 25832, DATED 11-3-86, RECORDED ON APRIL 13, 1987 IN LIBER 5, PAGES 175-177, SUBJECT CORNER DESCRIBED THUS; "... NORTH 1/4 CORNER SECTION 7, T2N, R2W FOUND 1/2" BAR & CAP IN CENTERLINE OF COLUMBIA AND KINGMAN ROAD, LIBER 3, PAGE 588 FOUND 16 PENNY NAIL IN NORTHEAST SIDE POWER POLE N80°W, 101.96' FOUND 16 PENNY NAIL IN NORTH SIDE POWER POLE, N80°E, 91.08' FOUND 16 PENNY NAIL IN NORTH SIDE GUY POLE, S80°E, 117.30'..." DRAWING INDICATES N89°49'56" W 2747.85 FEET TO A-3.
- 1988 TWO ACT 132 SURVEYS BY R. W. STEADMAN & ASSOCIATES, INC., SIGNED AND SEALED BY RICHARD W. STEADMAN, P.S. 11370, DATED JUNE 14, 1988 AND NOVEMBER 14, 1988, RECORDED DECEMBER 27, 1990 IN LIBER 6, PAGES 627 - 630, SUBJECT CORNER DESCRIBED THUS: "...SOUTH 1/4 CORNER OF SECTION 6, T2N, R2W - FOUND 1/2" IRON ROD AS RECORDED IN LIBER 3 ON PAGE 588 OF LAND CORNER RECORDATION CERTIFICATES OF INGHAM COUNTY POWER POLE N80°W 101.87 FEET POWER POLE N80°E 91.03 FEET GUY POLE S80°E 117.03 FEET..."
- 2000 SEVERAL ACT 132 SURVEYS BY WOLVERINE ENGINEERS & SURVEYORS, INC., SIGNED AND SEALED BY MAURICE H. MAHIEU, P.S. 28414, FIRST DATED 5/02/00, RECORDED 05/12/2000 IN LIBER 8, PAGE 716, SECOND DATED 4/26/00, RECORDED 5/12/2000, IN LIBER 8, PAGE 717, THIRD DATED JUNE 2, 2000, RECORDED 3/27/2001 IN LIBER 8, PAGE 826, SUBJECT CORNER DESCRIBED THUS: "...NORTH 1/4 CORNER SECTION 7 FOUND 1" BAR 1.2' N. OF C/L COLUMBIA AND KINGMAN ROAD INTERSECTION, WITNESSED BY: FOUND NAIL & CAP #18994 N. SIDE GUY POLE S80E 117.30' SET NAIL & TAG #28414 S. SIDE POWER POLE N80°E 93.40' SET NAIL & TAG #28414 S. SIDE POWER POLE N80°W 103.78' PUNCHED HOLE IN TOP OF WEST END OF 12" CMP N30°46.92' ..." DRAWING INDICATES N89°49'56" 2747.76 FEET TO A-3.
- 2004 ACT 132 SURVEY BY WOLVERINE ENGINEERS & SURVEYORS, INC., SIGNED AND SEALED BY MAURICE H. MAHIEU, P.S. 28414, DATED 12-29-04, RECORDED 01/10/2005 IN LIBER 9, PAGE 141, SUBJECT CORNER DESCRIBED THUS: "...SOUTH 1/4 CORNER, SECTION 6 T2N, R2W, AURELIUS TWP. FND. 1/2" IRON ROD 2'± N. OF C/L COLUMBIA RD. WITNESSES: N&T #28414 N. SIDE 8" POPLAR, S73°W 88.16' N&T #28414 S. SIDE UTILITY POLE, N68°W 103.85' N&T #28414 S. SIDE UTILITY POLE, N75°E 93.53'N&T #28414 SE SIDE 21" MAPLE, N46°E 74.84' ..." DRAWING INDICATES N00°01'06"W 2638.20 FEET TO B-2 S89°55'35"E 2660.12 FEET TO C-3.
- 2007 UNRECORDED SURVEY OF THREE PARCELS IN SECTION 7 BY POLARIS SURVEYING COMPANY, DATED 3/19/2007, SIGNED AND SEALED BY RONNIE M. LESTER, P.S. No. 18998, SUBJECT CORNER DESCRIBED THUS, "... NORTH 1/4 CORNER SECTION 7, T2N, R2W, LIBER 3, PAGE 588. 1/2" BAR IN MONUMENT BOX.." WITNESSED BY, "... FOUND NAIL AND TAG #28414 SOUTH SIDE UTILITY POLE MAG. AZ. 76°, 93.63' FOUND NAIL AND TAG #28414 SOUTH SIDE UTILITY POLE MAG. AZ. 293°, 103.80' FOUND NAIL AND TAG #28414 NORTH SIDE UTILITY POLE MAG. AZ. 110°, 117.26' SET GALVANIZED NAIL AND 1 1/2" ALUMINUM TAG STAMPED PS 18998 WITNESS NORTH SIDE UTILITY POLE MAG. AZ. 257°, 107.35'

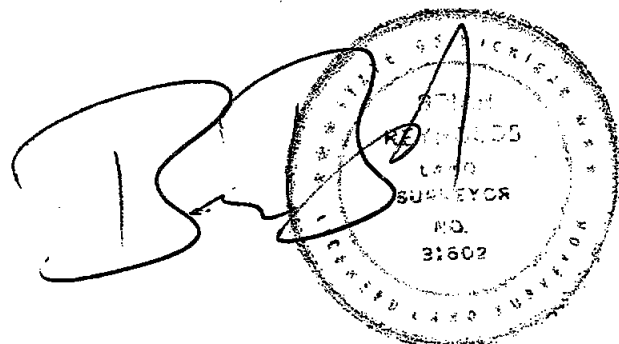

INGHAM COUNTY REMONUMENTATION
LAND CORNER RECORDATION CERTIFICATE
Filing Requirement of Act 74, Mich. P.A. 1970

For Corners in
INGHAM
(county)

Located In:

Corner Code #

1. Public Land Survey
1/4 CORNER COMMON
TO SECTIONS 5 & 6
AURELIUS TOWNSHIP

T 2N R 2W

C-2

T _____ R _____

T _____ R _____

T _____ R _____

B: 13 P: 133 09/25/2007 09:14 AM
2007-041770 LAND CORNERS Receipt #32274
Paula Johnson, Ingham County, Michigan

Pages: 2



2. Property Controlling S _____ T _____ R _____
in Section S _____ T _____ R _____

3. Miscellaneous S _____ T _____ R _____

4. Lot No _____, Recorded Plat _____

5. Private Claims _____

Register of Deeds Stamp & File Number

	A	B	C	D	E	F	G	H	I	J	K	L	M
1													
2		6	5		4			3		2		1	
3													
4		7		8		9		10		11		12	
5													
6		18		17		16		15		14		13	
7													
8		19		20		21		22		23		24	
9													
10		30		29		28		27		26		25	
11													
12		31		32		33		34		35		36	
13													

I, Brian Reynolds, in a field survey on March 27, 2007 do hereby certify that under requirements of P.A. 74, Michigan P.A. of 1970, the corner points mentioned in lines 1 and 2 above were in conformance with regulations and rules therefore as required in the current manual of survey instructions of the United States Department of the Interior, Bureau of Land Management or by a decree of a Court of Law and/or that the corner points mentioned in lines 3, 4, and 5 above were in conformance with the rules of the Michigan Board of Land Surveyors or by a Decree of a Court of Law; established, re-established, monumented, re-monumented, recovered, found as expressed below.

NOTE: Not more than 2 corners, in the same town and range, may be recorded on this certificate.

A. Description of original monument and accessories and/or subsequent restoration:

1826 GENERAL LAND OFFICE DEPUTY SURVEYOR HERVEY PARKE, FEBRUARY 1826, "...N BTW 5 & 640.00 SET QR (POST) (FROM WHICH) TAM 14 S46E 33 TAM 14 N66W 04 ..."

1856 INGHAM COUNTY SURVEYOR RECORD BY A. JACKSON, VOLUME 3, PAGE 122, "...TAM 14 S 46 E 55 Do. 14 N 66 W 4..."

NO CORNER INFORMATION ON THE INGHAM COUNTY ROAD COMMISSION WITNESS MAP FOR AURELIUS TOWNSHIP.

1976 ACT 132 SURVEY BY WOLVERINE ENGINEERS & SURVEYORS, INC., SIGNED AND SEALED BY GEORGE M. YOUNG, P.S. 17640, DATED 5-13-76, RECORDED JULY 6, 1976 IN LIBER 2, PAGES 783 & 784, SUBJECT CORNER DESCRIBED THUS: "...EAST 1/4 POST, SECTION 6 T2N, R2W, AURELIUS TWP., INGHAM COUNTY
NAIL IN 4" MAPLE N 03° W 11.8' NAIL IN 12" OAK S 80° E 33.3'
NAIL IN 24" SWAMP OAK N 85° W 20.1' FOUND ANCHOR POST SET 1/2" RE-ROD WITH CAP..."
TO B-2 IS SHOWN AS 2654.62 FEET

CORNER HISTORY CONTINUED ON PAGE TWO

B. Description of corner evidence found and/or method applied in restoring or reestablishing corner:

FOUND 1/2" IRON IN ROCK PILE IN CENTER OF ROTTED OFF 10" WOOD POST WITH 4 WAY FENCE IN MARSH ALSO FOUND ONE WITNESS BY SURVEYOR YOUNG (1979) viz. 4" MAPLE, N 03° W 11.8' TWO WITNESSES BY SURVEYOR BEAVER, viz. 8" MAPLE AZ=230° 15.65' & 18" MAPLE AZ=0° 11.99', AND ALL WITNESSES BY WOLVERINE (2004) AND KEBS (2006). IRON AS FOUND WAS CONSISTENT WITH ALL FOUND WITNESSES. REPLACED FOUND IRON WITH STANDARD REMON IRON AND CAP, WITNESSED AS DESCRIBED BELOW.

C. Description of monument for corner and accessories established to perpetuate locating the position of the corner:

WITNESSES TO 3/4" X 24" STEEL FORM PIN WITH AN ALUMINUM CAP STAMPED "31602"
FOUND KEBS TAG IN THE SOUTH SIDE OF A 12" MAPLE S45°E 2.52 FEET
FOUND N & T "BEAVER" IN THE WEST SIDE OF A 12" MAPLE N10°W 11.95 FEET
FOUND BEAVER TAG IN THE NORTH SIDE OF A 6" MAPLE S45°W 15.79 FEET
FOUND KEBS TAG IN THE WEST SIDE OF A 12" MAPLE SOUTH 30.44 FEET
N89°59'10"W 2654.22 FEET TO B-2 S89°24'13"E 2659.13 FEET TO D-2
N00°06'39"E 2734.15 FEET TO C-1 S00°03'51"E 2644.81 FEET TO C-3
FENCES NORTH, SOUTH, EAST & WEST

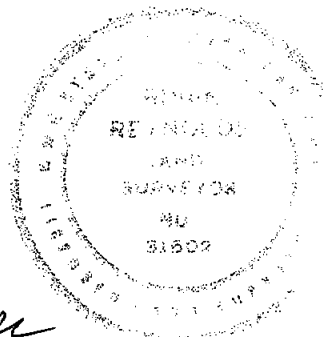

P.A. 345 INGHAM COUNTY
PEER APPROVED 6/19/2007 MC

Signed by [Signature]
Surveyor's Michigan License No. 31602

Date AUGUST 19, 2007

FORM APPROVED BY MICHIGAN STATE BOARD OF LAND SURVEYORS. JAN. 28, 1971

REVISED MAY 14, 1975 REVISED JANUARY, 1983 REVISED OCTOBER 1995

PAGE TWO

A. Description of original monument and accessories and/or subsequent restoration: T2N R2W C-2 CONTINUED

- 1976 LAND CORNER RECORDATION CERTIFICATE BY GEORGE M. YOUNG, P.S. 17640, DATED MAY 17, 1976, RECORDED JULY 6, 1976 IN LIBER 3, PAGE 584, PART A READS, "...ORIGINAL MONUMENT & ACCESSORIES OBLITERATED NO OTHER DATA AVAILABLE..." PART B READS, "...FOUND ANCHOR POST AND SET 1/2" RE-ROD & CAP BESIDE ACCEPTED FENCE CORNER AS PERPETUATION OF ORIGINAL 1/4 POST FITS VERY CLOSE TO PRORATED DISTANCE BETWEEN SE COR. & NE COR OF SAID SECTION..."; PART C READS, "...NAIL IN 12" OAK S80° E 33.3' NAIL IN 24" SWAMP OAK N85° W 20.1' NAIL IN 4" MAPLE N03° W 11.8'..."
- 1978 ACT 132 SURVEY BY WOLVERINE ENGINEERING COMPANY, SIGNED AND SEALED BY GEORGE M. YOUNG, P.S. 17640, DATED JUNE 1, 1978, RECORDED JUNE 20, 1978 IN LIBER 3 PAGES 376 & 377, SUBJECT CORNER DESCRIBED THUS: "... EAST 1/4 CORNER - C2 SECTION 6, T2N-R2W AURELIUS TOWNSHIP, INGHAM COUNTY AS RECORDED, LIBER 2, PAGE 783, INGHAM COUNTY RECORDS..." NO WITNESSES.
- 1979 ACT 132 SURVEY BY WOLVERINE ENGINEERING CO., SIGNED AND SEALED BY GEORGE M. YOUNG, P.S. 17640, DATED JANUARY 26, 1979, RECORDED MARCH 5, 1979 IN LIBER 3 PAGE 765, SUBJECT CORNER DESCRIBED THUS: "...EAST 1/4 POST, SECTION 6, T2N-R2W AURELIUS TOWNSHIP, INGHAM COUNTY NAIL IN 4" MAPLE, N 03° W 11.8' NAIL IN 12" OAK, S 80° E 33.3' NAIL IN 24" SWAMP OAK N 85° W 20.1 FND. ANCHOR POST AND 1/2" RE-ROD WITH CAP. AS RECORDED IN LIBER 3, PAGE 584, INGHAM COUNTY RECORDS..."
- 1999 ACT 132 SURVEY BY SOUTHERN MICHIGAN LAND SURVEYING, SIGNED AND SEALED BY PETER D. BEAVER, P.S. 25828, DATED 12-3-1999, RECORDED AUGUST 4, 2000 IN LIBER 8, PAGE 740, SUBJECT CORNER DESCRIBED THUS: "...W 1/4 CORNER SECTION 5 T2N, R2W FOUND 1/2" ROD BESIDE ANCHOR POST @ L3, P584 SET N/T #25828 W/S 8" MAPLE AZ=320° 14.22' SET N/T #25828 N/S 8" MAPLE AZ=230° 15.65' SET N/T #25828 W/S 18" MAPLE AZ=0° 11.99' SET N/T #25828 W/S TWIN 12" MAPLE AZ=165° 9.83' ..."
- 2002 ACT 132 SURVEY BY ENGER SURVEYING & ENGINEERING, SIGNED AND SEALED BY RONALD L. ENGER, P.S. 28409, DATED JULY 9, 2002, RECORDED 6/19/2003 IN LIBER 8 PAGE 1124, SUBJECT CORNER DESCRIBED THUS: "...T2N R2W WEST 1/4 CORNER SECTION 5 RECORDED LIBER 3 PAGE 584 1/2" BAR AT FOUR-WAY FENCE CORNER NAIL IN 12" OAK S80°E 33.3' NAIL IN 24" SWAMP OAK N85°W 20.1' NAIL IN 4" MAPLE N03°W 11.8'..."
- 2002 ACT 132 SURVEY BY ENGER SURVEYING & ENGINEERING, SIGNED AND SEALED BY RONALD L. ENGER, P.S. 28409, DATED AUGUST 1, 2002, RECORDED 6/19/2003 IN LIBER 8, PAGE 1125, SUBJECT CORNER DESCRIBED THUS: "...T2N, R2W WEST 1/4 CORNER SECTION 5 RECORDED LIBER 3 PAGE 584 1/2" BAR AT FOUR-WAY FENCE CORNER NAIL IN 12" OAK S80°E 33.3' NAIL IN 24" SWAMP OAK N85°W 20.1' NAIL IN 4" MAPLE N03°W 11.8' ..."
- 2004 ACT 132 SURVEY BY WOLVERINE ENGINEERS & SURVEYORS, INC., SIGNED AND SEALED BY MAURICE H. MAHIEU, P.S. 28414, DATED 12-29-04, RECORDED 01/10/2005 IN LIBER 9, PAGE 141, SUBJECT CORNER DESCRIBED THUS: "...EAST 1/4 CORNER, SECTION 6 T2N, R2W, AURELIUS TWP. FND. 1/2" IRON ROD AT FENCE ANCHOR POST WITNESSES: N&T #25828 W. SIDE 18" MAPLE, NORTH 12.03' N&T #25828 N. SIDE 9" MAPLE, S40°W 15.66' N&T #28414 S. SIDE 15" MAPLE, EAST 2.56' N&T #28414 W. SIDE 15" MAPLE, SOUTH 30.23' ..." DRAWING SHOWS S00°08'46"E 2644.76 FEET TO C-3
- 2006 ACT 132 SURVEY BY KEBS, INC, SIGNED AND SEALED BY JEFFREY K. AUTENRIETH, P.S. 31588, DATED 3-6-06, RECORDED 5/26/06 IN LIBER 9 PAGE 308, SUBJECT CORNER DESCRIBED THUS: "...WEST 1/4 CORNER SECTION 5, T2N, R2W FOUND 1/2" BAR AT BASE OF OLD ANCHOR POST FOUND NAIL & TAG #28414 SOUTHWEST SIDE 10" MAPLE, S40°E, 2.53' FOUND NAIL & TAG #28414 WEST SIDE 10" MAPLE, S10°E, 30.30' FOUND NAIL & WASHER "BEAVER" NORTH SIDE 6" MAPLE, S25°W, 15.65' FOUND NAIL & WASHER "BEAVER" WEST SIDE 14" MAPLE, N10°W, 11.94' ..." DRAWING SHOWS S00°31'03"E 2644.86 FEET TO C-3



INGHAM COUNTY REMONUMENTATION
LAND CORNER RECORDATION CERTIFICATE
Filing Requirement of Act 74, Mich. P.A. 1970

For Corners in
INGHAM
(county)

Located In:

Corner Code #

1. Public Land Survey
CORNER COMMON
TO SECTIONS 5, 6, 7 & 8
AURELIUS TOWNSHIP

T 2N R2W
T R
T R
T R

C-3

B: 13 P: 134 09/25/2007 09:14 AM
2007-041771 LAND CORNERS Receipt #32274
Paula Johnson, Ingham County, Michigan

Pages: 2



2. Property Controlling S T R
in Section S T R

3. Miscellaneous S T R

4. Lot No. , Recorded Plat

5. Private Claims

Register of Deeds Stamp & File Number

I, Brian Reynolds, in a field survey on August 17, 2007 do hereby certify that under requirements of P.A. 74, Michigan P.A. of 1970, the corner points mentioned in lines 1 and 2 above were in conformance with regulations and rules therefore as required in the current manual of survey instructions of the United States Department of the Interior, Bureau of Land Management or by a decree of a Court of Law and/or that the corner points mentioned in lines 3, 4, and 5 above were in conformance with the rules of the Michigan Board of Land Surveyors or by a Decree of a Court of Law; established, re-established, monumented, re-monumented, recovered, found as expressed below.

NOTE: Not more than 2 corners, in the same town and range, may be recorded on this certificate.

A. Description of original monument and accessories and/or subsequent restoration:

- 1826 GENERAL LAND OFFICE DEPUTY SURVEYOR HERVEY PARKE, FEBRUARY, 1826, "...80.00 SET (POST) COR. 5, 6, 7 & 8 (FROM WHICH) BE 12 N67-1/2W 20 Do. 10 S57E 16 ..."
- 1867 INGHAM COUNTY SURVEYOR RECORD BY THOS. J. BROWN, DEP. CO. SURVEYOR, VOLUME 2, PAGE 52, "...NO TREES BUT A POST DOWN EVEN WITH THE SURFACE..."
- NO CORNER INFORMATION ON THE INGHAM COUNTY ROAD COMMISSION WITNESS MAP FOR AURELIUS TOWNSHIP.
- 1972 ACT 132 SURVEY BY POLARIS ASSOCIATES INC, SIGNED AND SEALED BY RONNIE M. LESTER, P.S. 18998, DATED 12-1-72, RECORDED FEBRUARY 2, 1973 IN LIBER 1 PAGES 595 & 596, SUBJECT CORNER DESCRIBED THUS:
"...NW CORNER SECTION 8, T2N R2W SET NAIL & TAG EAST SIDE 24" HICKORY, SW, 56.8'
SET NAIL & TAG NW SIDE 24" STUMP, SW, 41.42' SET NAIL & TAG WEST SIDE 18" HICKORY, NORTH, 49.33'..."
DRAWING INDICATES 2656.01 FEET TO D-3.
- 1972 LAND CORNER RECORDATION CERTIFICATE BY RONNIE M. LESTER, P.S. 18998, DATED DECEMBER 4, 1972, RECORDED FEBRUARY 2, 1973 IN LIBER 2, PAGE 303, PART A READS, "...ORIGINAL MONUMENT AND ACCESSORIES OBLITERATED..." PART B READS, "...FOUND 1" BOATSPIKE IN CENTERLINE INTERSECTION COLUMBIA AND GALE HIGHWAYS CORNER IN ACCORD WITH EXISTING OCCUPATION AND SURVEYS..." PART C READS,
"...NW CORNER SECTION 8 SET NAIL & TAG EAST SIDE 24" HICKORY, SW, 56.8'
SET NAIL & TAG NW SIDE 24" STUMP, SW, 41.42' SET NAIL & TAG WEST SIDE 18" HICKORY, NORTH, 49.33'..."
- 1976 ACT 132 SURVEY BY FRED WHITE ENGINEERING COMPANY, INC, SIGNED AND SEALED BY RON HELSEL, P.S. 18994, DATED FEBRUARY 24, 1976, RECORDED MARCH 23, 1976 IN LIBER 2, PAGE 647, SUBJECT CORNER DESCRIBED THUS:
"...NW COR. SEC. 8, T2N-R2W, WITNESS TO NW COR: LIBER 2, PG. 303)
SW 56.8' N. & T. E. SIDE 24" HICKORY SW 41.42' N. & T. NW SIDE 24" STUMP
NORTH 49.33' N. & T. W. SIDE 18" HICKORY..."
DRAWING INDICATES 2168.90 FEET TO D-3.

CORNER HISTORY CONTINUED ON PAGE TWO

B. Description of corner evidence found and/or method applied in restoring or reestablishing corner:

FOUND 5/8" IRON & CAP No. 18998 IN A MONUMENT BOX AT THE INTERSECTION OF THE CENTERLINES OF COLUMBIA ROAD AND GALE ROAD. EXCAVATED THROUGH MONUMENT BOX, FOUND NO FURTHER EVIDENCE OF PREVIOUS MONUMENTATION. HALF-MILE MEASUREMENTS NORTH, WEST, AND EAST, ARE ALL IN VERY CLOSE ACCORD WITH DISTANCES OF RECORD IN PART A. ACCEPTED FOUND IRON AS PROPER PERPETUATION OF CORNER POSITION, REPLACED WITH 3/4" X 24" STEEL FORM PIN WITH AN ALUMINUM CAP STAMPED "31602", WITNESSED AS DESCRIBED BELOW.

C. Description of monument for corner and accessories established to perpetuate locating the position of the corner:
WITNESSES TO 3/4" X 24" STEEL FORM PIN WITH AN ALUMINUM CAP STAMPED "31602" IN MONUMENT BOX
FOUND NAIL & TAG No. 28414 IN THE WEST SIDE OF A 12" MAPLE N02°E 55.74 FEET
SET MAGNETIC NAIL & REMON TAG IN THE SOUTH SIDE OF A UTILITY POLE N85°W 300.88 FEET
SET MAGNETIC NAIL & REMON TAG IN THE SOUTHWEST SIDE OF A UTILITY POLE N60°W 48.44 FEET
FOUND CAPPED IRON No. 28414 NORTH 32.98 FEET N89°50'47"W 2660.19' TO B-3
N00°03'51"W 2644.81' TO C-2 S89°32'46"E 2652.85' TO D-3 IN LINE WITH FENCE NORTH OF COLUMBIA ROAD
ON CENTERLINE OF COLUMBIA ROAD IN LINE WITH CENTERLINE OF GALE ROAD

Signed by [Signature]
Surveyor's Michigan License No 31602

F.A. 345 INGHAM COUNTY
PEER APPROVED 8/21/2007

Date AUGUST 17, 2007

FORM APPROVED BY MICHIGAN STATE BOARD OF LAND SURVEYORS JAN. 28, 1971

REVISED MAY 14, 1975 REVISED JANUARY, 1983 REVISED OCTOBER 1995

PAGE TWO

A. Description of original monument and accessories and/or subsequent restoration: T2N R2W C-3 CONTINUED

- 1976 ACT 132 SURVEY BY WOLVERINE ENGINEERS & SURVEYORS, INC., SIGNED AND SEALED BY GEORGE M. YOUNG, P.S. 17640, DATED 5-13-76, RECORDED JULY 6, 1976 IN LIBER 2, PAGES 783 & 784, SUBJECT CORNER DESCRIBED THUS: "...SOUTHEAST CORNER, SECTION 6 T2N, R2W, AURELIUS TWP., INGHAM COUNTY
NAIL & WASHER IN 24" SHAG BARK HICKORY N 10° W 49.41' NAIL IN 24" MAPLE S 30° W 56.80'
NAIL IN POWER POLE N 45° W 48.55' FOUND BOAT SPIKE SET 1/2" RE-ROD WITH CAP
RECORDED LIBER 2, PAGE 303 ... DRAWING INDICATES N89°55'35"W 2660.10 FEET TO B-3.
- 1976 ACT 132 SURVEY BY POLARIS ASSOCIATES INC, SIGNED AND SEALED BY RONNIE M. LESTER, P.S. 18998, DATED 8-2-76, RECORDED AUGUST 12, 1976 IN LIBER 2 PAGES 846 & 847, SUBJECT CORNER DESCRIBED THUS: "...NE CORNER SECTION 7, T2N R2W NAIL & TAG IN EAST SIDE 24" HICKORY, SW, 56.8'
NAIL & TAG IN NW SIDE 24" STUMP, SW, 41.42' NAIL & TAG IN WEST SIDE 18" HICKORY, NORTH, 49.33'..."
- 1978 ACT 132 SURVEY BY FRED WHITE ENGINEERING COMPANY, SIGNED AND SEALED BY FRED N. WHITE, P.S. 12034, DATED JUNE 7, 1978, RECORDED AUGUST 29, 1978 IN LIBER 3, PAGE 504, SUBJECT CORNER DESCRIBED THUS: "SE COR. SEC 6 T2N, R2W (LIBER 2-PG. 305, EAST LINE SEC. 6..." DRAWING INDICATES 2660.25 FEET TO B-3.
- 1980 ACT 132 SURVEY BY POLARIS ASSOCIATES INC, SIGNED AND SEALED BY RONNIE M. LESTER, P.S. 18998, DATED 10/13/80, RECORDED FEBRUARY 2, 1981 IN LIBER 4 PAGES 209-212, SUBJECT CORNER DESCRIBED THUS: "...NORTHWEST CORNER SECTION 8, T2N, R2W NAIL & TAG IN EAST SIDE 24" HICKORY, S.W., 56.8'
NAIL & TAG IN N.W. SIDE 24" STUMP, S.W., 41.42' NAIL & TAG IN WEST SIDE 18" HICKORY, NORTH, 49.33'..."
- 1983 ACT 132 SURVEY SIGNED AND SEALED BY MARVIN F. FOUTY, P.S. 18989, DATED MAY 31, 1983, RECORDED DATE ILLEGIBLE IN LIBER 4 PAGES 1089 & 1090, SUBJECT CORNER DESCRIBED THUS: "...NW CORNER SEC. 8, T2N, R2W FOUND NAIL AND TAG E/SIDE 24" HICK. SW, 56.8'
FOUND NAIL AND TAG NW SIDE 24" STUMP, SW, 41.42' FOUND NAIL AND TAG W/SIDE 18" HICKORY, NORTH, 49.33'..."
- 1998 ACT 132 SURVEY BY POLARIS SURVEYING, SIGNED AND SEALED BY RONNIE M. LESTER, P.S. 18998, DATED 10/19/98, RECORDED 12/03/1998 IN LIBER 8, PAGES 372-374, SUBJECT CORNER DESCRIBED THUS: "...NORTHEAST CORNER SECTION 7, T2N, R2W. SET 1/2" BAR WITH GEAR TOP AT LOCATION RECORDED LIBER 2, PAGE 303.
FOUND NAIL AND TAG #18998 WEST SIDE 24" SHAGBARK MAG. AZ. 350°, 49.33'
FOUND NAIL AND TAG #18998 NE SIDE UTILITY POLE MAG. AZ. 315°, 48.35'
SET GALVANIZED NAIL & 1 1/4" BRASS TAG STAMPED "18998 LESTER" EAST SIDE 20" MAPLE MAG. AZ., 192°, 200.43'
SET GALVANIZED NAIL & 1 1/4" BRASS TAG STAMPED "18998 LESTER" EAST SIDE 6" MAPLE MAG. AZ., 09°, 45.58'..."
- 2001 ACT 132 SURVEY BY WOLVERINE ENGINEERS & SURVEYORS, INC, SIGNED AND SEALED BY MAURICE H. MAHIEU, P.S. 28414, RECORDED 05/22/2001, LIBER 8, PAGE 869, SUBJECT CORNER DESCRIBED THUS: "...NW CORNER SEC. 8, T2N, R2W AURELIUS TWP., INGHAM CO. AXLE SHAFT C/L INTERSECTION COLUMBIA & GALE ROADS
WITNESSES: N&T #28414 W. SIDE 10" MAPLE, N. 55.75' N&T #18998 W. SIDE 28" HICKORY, N10°W 49.33'
N&T #18998 NE SIDE UTILITY POLE, N45°W 48.35' N&T #18998 E. SIDE 21" MAPLE, S12°W 200.43'..."
- 2002 ACT 132 SURVEY BY ENGER SURVEYING & ENGINEERING, SIGNED AND SEALED BY RONALD L. ENGER, P.S. 28409, DATED JULY 9, 2002, RECORDED 6/19/2003 IN LIBER 8 PAGE 1124, SUBJECT CORNER DESCRIBED THUS: "...T2N R2W NORTHEAST CORNER SECTION 7 RECORDED ON SURVEY LIBER 8 PAGE 372 1/2" BAR WITH GEAR TOP
NAIL & TAG #28414 NORTH SIDE 15" SHAGBARK NAZ 26° 58.70'
NAIL & TAG #28414 WEST SIDE 24" SHAGBARK NAZ 41° 40.95'
NAIL & TAG #28414 WEST SIDE 40" HICKORY NAZ 139° 38.73'
NAIL & TAG #18998 SE SIDE 30" MAPLE NAZ 230° 34.22'
NAIL & TAG #18998 SW SIDE 40" HICKORY NAZ 139° 39.55'..."
DRAWING INDICATES S89°36'34"E 2652.62 FEET TO D-3.
- 2004 ACT 132 SURVEY SIGNED AND SEALED BY RON HELSEL, P.S. 18994, DATED 4/02/04, RECORDED 04/29/2004 IN LIBER 9, PAGE 46, SUBJECT CORNER DESCRIBED THUS: "...NORTHEAST (sic) CORNER SECTION 8, T2N, R2W, LIBER 2, PAGE 303 OF CORNERS ORIGINALLY DESCRIBED AS A BOAT SPIKE, FOUND 1/2" IRON BAR.
FOUND NAIL AND TAG #18998 EAST/SIDE 8" MAPLE, AZ. 10°, 45.58 FEET
FOUND NAIL AND TAG #18998 NORTHEAST/SIDE POWER POLE, AZ. 315°, 48.34 FEET
FOUND NAIL AND TAG #18998 WEST/SIDE 24" HICKORY, AZ. 350°, 49.33 FEET
FOUND NAIL AND TAG #18998 EAST/SIDE 22" MAPLE, AZ. 190°, 200.40 FEET
MEASURED 2640.45 FEET TO WEST 1/4 CORNER SECTION 8 ..."
- 2004 ACT 132 SURVEY BY WOLVERINE ENGINEERS & SURVEYORS, INC., SIGNED AND SEALED BY MAURICE H. MAHIEU, P.S. 28414, DATED 12-29-04, RECORDED 01/10/2005 IN LIBER 9, PAGE 141, SUBJECT CORNER DESCRIBED THUS: "...SOUTHEAST CORNER, SECTION 6 T2N, R2W, AURELIUS TWP. FND. SMALL AXLE SHAFT WITNESSES:
N&T #28414 W. SIDE 18" MAPLE, N09°E 55.78' N&T #18998 W. SIDE 36" HICKORY, N10°W 49.39'
N&T #18998 E. SIDE UTILITY POLE, N44°W 48.40' N&T #18998 E. SIDE 28" MAPLE, S 12°W 200.45' ..."
DRAWING INDICATES 89°55'35"E 2660.12 FEET TO B-3 TO C-2 IS N00°08'46"W 2644.76 FEET
- 2006 ACT 132 SURVEY BY KEBS, INC, SIGNED AND SEALED BY JEFFREY K. AUTENRIETH, P.S. 31588, DATED 3-6-06, RECORDED 5/26/06 IN LIBER 9 PAGE 308, SUBJECT CORNER DESCRIBED THUS: "...SOUTHWEST CORNER SECTION 5, T2N, R2W FOUND 5/8" BEVELED GEAR IN C/L INTERSECTION OF COLUMBIA AND GALE ROADS
FOUND NAIL & TAG #18998 EAST SIDE 8" MAPLE, NORTH, 45.67'
FOUND NAIL & TAG #18898 NORTHEAST SIDE POWER POLE N35°W, 48.35'
FOUND KEBS NAIL & TAG NORTH SIDE 30" MAPLE, S80°W, 150.15' WEST EDGE OF STOP SIGN, S30°E, 52.86'..."
DRAWING INDICATES N00°31'03"W 2644.86 FEET TO C-2 TO D-3 IS 2652.65 FEET
- 2007 UNRECORDED SURVEY OF THREE PARCELS IN SECTION 7 BY POLARIS SURVEYING COMPANY, DATED 3/19/2007, SIGNED AND SEALED BY RONNIE M. LESTER, P.S. No. 18998, SUBJECT CORNER DESCRIBED THUS, "... NORTHEAST CORNER SECTION 7, T2N, R2W, SET 3/4" BAR & CAP IN MONUMENT BOX.." WITNESSED BY, "... FOUND NAIL AND TAG #28414 WEST SIDE 12" MAPLE MAG. AZ. 10°, 55.61' FOUND BAR AND CAP #28414 MAG. AZ. 05°, 33.00'
FOUND NAIL & TAG #18998 NORTHEAST SIDE UTILITY POLE MAG. AZ. 315° 48.35'
FOUND NAIL & TAG #18998 WEST SIDE 24" SHAGBARK HICKORY MAG. AZ. 350° 49.33'

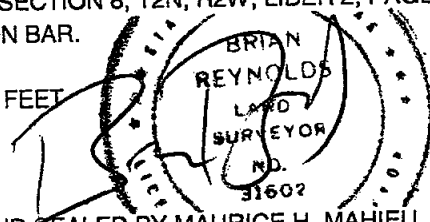

INGHAM COUNTY REMONUMENTATION

LAND CORNER RECORDATION CERTIFICATE

Filing Requirement of Act 74, Mich. P.A. 1970

For Corners in

INGHAM

(county)

Located In:

Corner Code #

1. Public Land Survey
CORNER COMMON
TO SECTIONS 5 AND 6
AURELIUS TOWNSHIP

T 2N R 2W

C-1

T _____ R _____

T _____ R _____

T _____ R _____

B: 13 P: 156 10/23/2007 11:02 AM
2007-045646 LAND CORNERS Receipt #33528
Paula Johnson, Ingham County, Michigan

Pages: 2

2. Property Controlling
in Section

S _____ T _____ R _____
S _____ T _____ R _____



3. Miscellaneous

S _____ T _____ R _____

4. Lot No _____, Recorded Plat _____

5. Private Claims _____

Register of Deeds Stamp & File Number

I, Brian Reynolds, in a field survey on August 20, 2007 do hereby certify that under requirements of P.A. 74, Michigan P.A. of 1970, the corner points mentioned in lines 1 and 2 above were in conformance with regulations and rules therefore as required in the current manual of survey instructions of the United States Department of the Interior, Bureau of Land Management or by a decree of a Court of Law and/or that the corner points mentioned in lines 3, 4, and 5 above were in conformance with the rules of the Michigan Board of Land Surveyors or by a Decree of a Court of Law; established, re-established, monumented, re-monumented, recovered, found as expressed below.

NOTE: Not more than 2 corners, in the same town and range, may be recorded on this certificate.

A. Description of original monument and accessories and/or subsequent restoration:

- 1825 REGARDING THE CORRESPONDING STANDARD CORNER, GENERAL LAND OFFICE DEPUTY SURVEYOR JOHN MULLETT, MAY 1825, "...WEST ON S BDY 32 T3N R2W.....80.00 SET (POST) COR 31 & 32 (FROM WHICH) ELM 12 N60E 32 B. ASH 12 N82W 43 ..."
- 1826 REGARDING THE SUBJECT CLOSING CORNER, MAY 1825, GENERAL LAND OFFICE DEPUTY SURVEYOR HERVEY PARKE, FEBRUARY, 1826 "...NORTH BTW 5 & 6.....81.27 INT N BDY 68 (LINKS). W OF (POST) TO SECS 31 & 32 T3N R2W & SET (POST) COR 5 & 6 (FROM WHICH) B. ASH 14 S82-1/2E 25 ELM 12 S37W 62 ..."
- 1852 INGHAM COUNTY SURVEYOR RECORD BY A. JACKSON, VOLUME 1, PAGE 282, "...B ASH 14 S 82-1/2 E 25, ELM 12 S 37 62..." AN 1856 SURVEY BY JACKSON, VOL. 3, PAGE 122, SAME WITNESSES, NO MONUMENT RECITED NO CORNER INFORMATION ON THE INGHAM COUNTY ROAD COMMISSION WITNESS MAP FOR AURELIUS TOWNSHIP.
- 1976 ACT 132 SURVEY BY WOLVERINE ENGINEERS & SURVEYORS, INC., SIGNED AND SEALED BY GEORGE M. YOUNG, P.S. 17640, DATED 5-13-76, RECORDED JULY 6, 1976 IN LIBER 2, PAGE 783 & 784, SUBJECT CORNER DESCRIBED THUS: "...NORTHEAST CORNER, SECTION 6 T2N, R2W, AURELIUS TWP., INGHAM COUNTY SET 1/2" RE-ROD ON EAST SIDE 24" CLAY C.B. N 05° W 31.48' NAIL IN 6" WILD CHERRY S 45° W 47.55' NAIL IN POWER POLE N 75° E 139.31' SET 1/2" RE-ROD WITH CAP FLUSH WITH ASPHALT..." DRAWING INDICATES N89°47'28"W 2656.74 FEET TO B-1. CORNER HISTORY CONTINUED ON PAGE TWO

	A	B	C	D	E	F	G	H	I	J	K	L	M
1													
2	6		5		4		3		2		1		
3													
4	7		8		9		10		11		12		
5													
6	18		17		16		15		14		13		
7													
8	19		20		21		22		23		24		
9													
10	30		29		28		27		26		25		
11													
12	31		32		33		34		35		36		
13													

B. Description of corner evidence found and/or method applied in restoring or reestablishing corner:

THE "PK" BY SURVEYOR BEAVER, AND ANY OTHER EVIDENCE OF PRIOR MONUMENTATION CAN BE PRESUMED TO BE DESTROYED BY INSTALLATION OF UNDERGROUND UTILITIES. THERE IS A BITUMINOUS PATCH THE ENTIRE NORTH - SOUTH WIDTH OF THE ROAD ABOUT 6 FEET WIDE, WHERE THERE CLEARLY HAD BEEN SOME TRENCHING IN RECENT YEARS. ALL OF SURVEYOR BEAVER'S WITNESSES ARE INTACT, AS IS THE MONUMENT AT C-13 T3N R2W. RESTORED THE SUBJECT CORNER AS IT WAS RESTORED BY SURVEYOR YOUNG IN 1976, AT THE RECORD DISTANCE AND DIRECTION FROM THE STANDARD CORNER, AND ON THE TOWN LINE. INSTALLED STANDARD INGHAM MONUMENT AND CAP, WITNESSED AS DESCRIBED BELOW.

C. Description of monument for corner and accessories established to perpetuate locating the position of the corner:

WITNESSES TO 3/4" X 24" STEEL FORM PIN WITH AN ALUMINUM CAP STAMPED "31602" IN MONUMENT BOX FOUND "BEAVER" NAIL & TAG IN THE NORTHWEST SIDE OF A 24" HICKORY SOUTH 57.44 FEET FOUND "BEAVER" NAIL & TAG IN THE SOUTHWEST SIDE OF A UTILITY POLE S64°E 66.26 FEET NORTHWEST CORNER OF GARAGE AT HOUSE No. 5991 S52°E 145.40 FEET SET MAGNETIC NAIL & TAG IN THE TOP OF A 12" CMP CULVERT NORTH 80.06 FEET N89°55'17"W 2656.76 FEET TO B-1 S89°32'14"E 2656.71 FEET TO D-1 S00°06'39"W 2734.15 FEET TO C-2 1± FOOT NORTH OF CENTERLINE OF NICHOLS ROAD 1/2" IRON AND "BEAVER" CAP SOUTH 33.02 FEET C-13 T3N R2W EAST 44.88 FEET ON TOWN LINE

P.A. 345 INGHAM COUNTY

PEER APPROVED 8/21/2007 AL

Signed by

Surveyor's Michigan License No 31602

Date September 17, 2007

FORM APPROVED BY MICHIGAN STATE BOARD OF LAND SURVEYORS, JAN. 28, 1971

REVISED MAY 14, 1975 REVISED JANUARY, 1983 REVISED OCTOBER 1995

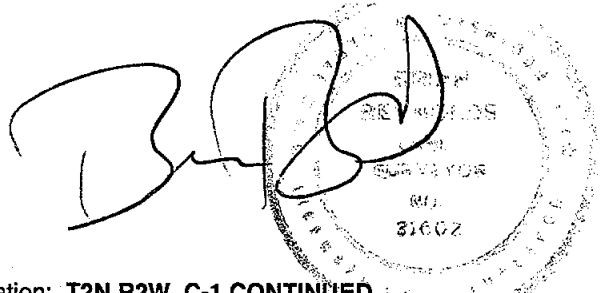

- A. Description of original monument and accessories and/or subsequent restoration: **T2N R2W C-1 CONTINUED**
- 1976 LAND CORNER RECORDATION CERTIFICATE BY GEORGE M. YOUNG, P.S. 17640, DATED MAY 17, 1976, RECORDED JULY 6, 1976 IN LIBER 3, PAGE 584, PART A READS, "...ORIGINAL MONUMENT & ACCESSORIES OBLITERATED NO OTHER DATA AVAILABLE..." PART B READS, "...SET 1/2" RE-ROD & CAP FLUSH WITH ASPHALT, RE-ESTABLISHED CORNER BY USING RECORDED JOG BETWEEN STANDARD CORNER, SECTION 31, T3N, R2W, DELHI TOWNSHIP & NE COR. SECTION 6, T2N, R2W, AURELIUS TOWNSHIP..." PART C READS, "...SET 1/2" RE-ROD ON EAST SIDE 24" CLAY C.B. N05° W 31.48' NAIL IN 6" WILD CHERRY S 45° W 47.55' NAIL IN POWER POLE N 75° E 139.31'..."
- 1978 ACT 132 SURVEY BY WOLVERINE ENGINEERING COMPANY, SIGNED AND SEALED BY GEORGE M. YOUNG, P.S. 17640, DATED JUNE 1, 1978, RECORDED JUNE 20, 1978 IN LIBER 3 PAGES 376 & 377, SUBJECT CORNER DESCRIBED THUS: "...NORTHEAST CORNER - C1 SECTION 6, T2N-R2W AURELIUS TOWNSHIP, INGHAM COUNTY AS RECORDED, LIBER 2, PAGE 783, INGHAM COUNTY RECORDS..." NO WITNESSES. TO C-2 IS SHOWN AS S00°01'20"W 2718.07 FEET
- 1978 ACT 132 SURVEY BY WOLVERINE ENGINEERING COMPANY, SIGNED AND SEALED BY GEORGE M. YOUNG, P.S. 17640, DATED JUNE 26, 1978, RECORDED JULY 6, 1978 IN LIBER 3 PAGE 386, SUBJECT CORNER DESCRIBED THUS: "...NORTHEAST CORNER SECTION 6, T2N-R2W AURELIUS TWP., INGHAM CO., MICH. FOUND 1/2" REROD W/CAP FLUSH W/ASPH. AS RECORDED, LIBER 2, PAGE 783, INGHAM COUNTY RECORDS..." NO WITNESSES.
- 1978 ACT 132 SURVEY BY WOLVERINE ENGINEERING COMPANY, SIGNED AND SEALED BY GEORGE M. YOUNG, P.S. 17640, DATED JULY 17, 1978, RECORDED SEPTEMBER 15, 1978 IN LIBER 3 PAGE 526, SUBJECT CORNER DESCRIBED THUS: "...NORTHEAST CORNER SECTION 6, T2N-R2W AURELIUS TWP., INGHAM CO., MICH. FOUND 1/2" REROD W/CAP FLUSH W/ASPH. AS RECORDED, LIBER 2, PAGE 783, INGHAM COUNTY RECORDS..." NO WITNESSES.
- 1979 SEVERAL ACT 132 SURVEYS BY WOLVERINE ENGINEERING CO., SIGNED AND SEALED BY GEORGE M. YOUNG, P.S. 17640, DATED JANUARY 26, 1979, RECORDED MARCH 5, 1979 IN LIBER 3 PAGES 765, 766 & 767, AND LIBER 4 PAGE 355, SUBJECT CORNER DESCRIBED THUS: "...NORTHEAST CORNER, SEC. 6, T2N-R2W AURELIUS TOWNSHIP, INGHAM COUNTY FND. 1/2" RE-ROD ON E SIDE 24" CLAY C.B. N 05° W 31.48' NAIL IN 6" WILD CHERRY, S 45° W 47.55' NAIL IN POWER POLE, N 75° E 139.31' FND. 1/2" RE-ROD WITH CAP FLUSH WITH ASPHALT, AS RECORDED IN LIBER 2, PAGE 783, INGHAM COUNTY RECORDS..." DRAWING INDICATES S00°01'30"W 2732.63 FEET TO C-2 TO B-1 IS SHOWN AS 2656.74 FEET.
- 1979 ACT 132 SURVEY BY WOLVERINE ENGINEERING COMPANY, SIGNED AND SEALED BY GEORGE M. YOUNG, P.S. 17640, DATED 6/15/79, RECORDED JUNE 21, 1979 IN LIBER 3 PAGE 890, SUBJECT CORNER DESCRIBED THUS: "...NORTHEAST CORNER, SECTION 6, T2N, R2W AURELIUS TOWNSHIP, INGHAM COUNTY, MICHIGAN SET 1/2" RE-ROD ON EAST SIDE 24" CLAY C.B. N 05° W 31.48' NAIL IN 6" WILD CHERRY, S 45° W 47.55' NAIL IN POWER POLE, N 75° E 139.31' SET 1/2" RE-ROD WITH CAP FLUSH WITH ASPHALT, RECORDED LIBER 2, PAGE 783 ..."
- 1982 ACT 132 SURVEY BY WOLVERINE ENGINEERING COMPANY, SIGNED AND SEALED BY GEORGE M. YOUNG, P.S. 17640, DATED NOV. 23, 1982, RECORDED MARCH 17, 1983 IN LIBER 4 PAGE 633, SUBJECT CORNER DESCRIBED THUS: "...NE COR., SEC. 6, T2N-R2W AURELIUS TOWNSHIP, INGHAM CO., MICHIGAN FND. 1/2" REROD W/CAP FLUSH W/ASPHALT AS RECORDED LIBER 2, PAGE 783, INGHAM CO. RECORDS..." NO WITNESSES.
- 1985 RECORDED PLAT OF "RIVER BEND PARK SUBDIVISION" BY POLARIS SURVEYING COMPANY, SIGNED AND SEALED BY RONNIE M. LESTER, P.S. No. 18998, RECORDED JULY 25, 1985 IN LIBER 39 OF PLATS, ON PAGES 23 & 24. SUBJECT CLOSING SECTION CORNER IS SHOWN, MONUMENT NOT DESCRIBED, NO WITNESSES.
- 1999 ACT 132 SURVEY BY SOUTHERN MICHIGAN LAND SURVEYING, SIGNED AND SEALED BY PETER D. BEAVER, P.S. 25828, DATED 12-3-1999, RECORDED 8/04/2000 IN LIBER 8, PAGE 740, SUBJECT CORNER DESCRIBED THUS: "...NW CORNER SECTION 5 T2N, R2W RESET CORNER @ L3, P584 WITH P.K. AND TAG #25828 SET N/T #25828 SW/S U.P. AZ=115° 6.18' SET N/T #25828 SE/S P.P., AZ=69° 139.96' SET N/T #25828 N/S 20° MAPLE, AZ=249° 93.64' SET N/T #25828 N/S P.P., AZ=281° 251.57' ..." DRAWING INDICATES S00°01'55"W 2634.26 FEET TO C-2 (ALSO NOTED ON DRAWING IS WOLVERINE S99°01'30"W 2632.63 FEET) DRAWING INDICATES S89°36'23"E 2611.86 FEET FROM C-13 TO D-1, N90°00'00"E FROM C-1 TO C-13.
- 1999 LAND CORNER RECORDATION CERTIFICATE LIBER 9 PAGE 572 BY PETER D. BEAVER, P.S. No. 25828, DATED DECEMBER 3, 1999, RECORDED AUGUST 4, 2000, PART A IS BLANK, PART B READS, "...FOUND NOTHING, RESET CORNER FROM L.C.R.C. TIES @ L3, P584 & CERTIFIED SURVEY @ L3, P376 ..." PART "C" CALLS FOR THE SAME MONUMENT AND WITNESSES AS THE 1999 ACT 132 SURVEY BY BEAVER, RECITED ABOVE.
- 2000 ACT 132 SURVEY BY WOLVERINE ENGINEERS & SURVEYORS, INC., SIGNED AND SEALED BY MAURICE H. MAHIEU, P.S. 28414, DATED 8-16-00, RECORDED 10/13/2000 IN LIBER 8, PAGE 778, SUBJECT CORNER DESCRIBED THUS: "...NW CORNER SEC 5 T2N, R2W, AURELIUS TWP. P.K. & TAG #25828 WITNESSES: N&T #25828 SW SIDE U.P., AZ=115° 66.18' N&T #25828 SE SIDE P.P., AZ=69° 139.96' N&T #25828 N. SIDE 20° MAPLE, AZ=249° 93.64' N&T #25828 N. SIDE P.P., AZ=281° 251.57' ..." DRAWING INDICATES S89°36'23"E 2611.86 FEET FROM C-13 TO D-1, N90°00'00"E 44.88' FROM C-1 - C-13, SEC 32.
- 2002 ACT 132 SURVEY BY ENGER SURVEYING & ENGINEERING, SIGNED AND SEALED BY RONALD L. ENGER, P.S. 28409, DATED AUGUST 1, 2002, RECORDED 6/19/2003 IN LIBER 8, PAGE 1125, SUBJECT CORNER DESCRIBED THUS: "...T2N, R2W NORTHWEST CORNER SECTION 5 RECORDED LIBER 9 PAGE 572 SET P.K. NAIL & WASHER 25828 NAIL & TAG 25828 IN SW SIDE UTILITY POLE NAZ. 115° 66.18' NAIL & TAG 25828 IN SE SIDE POWER POLE NAZ. 69° 139.96' NAIL & TAG 25828 IN NORTH SIDE 20° MAPLE NAZ. 249° 93.64' NAIL & TAG 25828 IN NORTH SIDE POWER POLE NAZ. 281° 251.57' IRON IN MONUMENT BOX AT SE CORNER SECTION 31, T3N, R2W NAZ. 90° 44.88' ..." DRAWING INDICATES S89°36'23"E 2611.75 FEET (PAGE 2 INDICATES 2611.76 FEET) FROM C-13 SEC 32 TO D-1 AND N90°00'00"E 44.88 FEET FROM C-1 TO C-13.

INGHAM COUNTY REMONUMENTATION
LAND CORNER RECORDATION CERTIFICATE
Filing Requirement of Act 74, Mich. P.A. 1970

For Corners in
INGHAM
(county)

Located In:

Corner Code #

B: 13 P: 160 10/23/2007 11:02 AM
2007-045650 LAND CORNERS Receipt #33528
Paula Johnson, Ingham County, Michigan

Pages: 1



1. Public Land Survey T 2N R 2W
MEANDER CORNER T R
LINE COMMON TO SECTIONS T R
6 & 7 AURELIUS TOWNSHIP T R

MEANDER CORNER
No. 3 ON EAST SIDE
OF GRAND RIVER

2. Property Controlling S 6 T R
in Section S 7 T R

3. Miscellaneous S T R

4. Lot No , Recorded Plat

5. Private Claims

Register of Deeds Stamp & File Number

	A	B	C	D	E	F	G	H	I	J	K	L	M
1													
2		6		5		4		3		2		1	
3													
4		7		8		9		10		11		12	
5													
6		18		17		16		15		14		13	
7													
8		19		20		21		22		23		24	
9													
10		30		29		28		27		26		25	
11													
12		31		32		33		34		35		36	
13													

I, Brian Reynolds, in a field survey on AUGUST 22, 2007 do hereby certify that under requirements of P.A. 74, Michigan P.A. of 1970, the corner points mentioned in lines 1 and 2 above were in conformance with regulations and rules therefore as required in the current manual of survey instructions of the United States Department of the Interior, Bureau of Land Management or by a decree of a Court of Law and/or that the corner points mentioned in lines 3, 4, and 5 above were in conformance with the rules of the Michigan Board of Land Surveyors or by a Decree of a Court of Law; established, re-established, monumented, re-monumented, recovered, found as expressed below.

NOTE: Not more than 2 corners, in the same town and range, may be recorded on this certificate.

A. Description of original monument and accessories and/or subsequent restoration:

1826 GENERAL LAND OFFICE DEPUTY SURVEYOR HERVEY PARKE, FEBRUARY, 1826, "...WEST BTW 6 & 7 40.00 SET QR (POST) ...77.35 SET (POST) ON E. BANK G. RIVER (FROM WHICH) B. O. 9 N27E 29 BE 7 S76E 31.... 79.15 SET (POST) ON W BANK OF RIVER81.70 INT W BDY ..." (EMPHASIS ADDED TO HIGHLIGHT THE SUBJECT MEANDER POST)

B. Description of corner evidence found and/or method applied in restoring or reestablishing corner:

FOUND AND CONFIRMED CORNERS A-3 AND B-3. THE MEASURED DISTANCE BETWEEN THESE GRID CORNERS (2747.80 FEET) COMPARES FAVORABLY WITH THE DISTANCE REPORTED BY THE ORIGINAL GOVERNMENT SURVEY (41.70 CHAINS = 2752.2 FEET). COMPUTED THE SUBJECT MEANDER CORNER POSITION AT THE RECORD DISTANCE 37.35 CHAINS = 2465.1 FEET) WEST OF B-3, AND ON LINE BETWEEN A-3 AND B-3. TRAVERSED TO COMPUTED POSITION, SEARCHED FOR, BUT DID NOT FIND ANY EVIDENCE OF MONUMENTATION. SET STANDARD FORM PIN MARKER & ALUMINUM CAP STAMPED "MC 31602", WITNESSED AS DESCRIBED BELOW.

C. Description of monument for corner and accessories established to perpetuate locating the position of the corner:

WITNESSES TO 3/4" X 24" STEEL FORM PIN WITH AN ALUMINUM CAP STAMPED "MC 31602"
12± FEET EAST OF EAST BANK OF THE GRAND RIVER 45± FEET SOUTH OF THE COLUMBIA ROAD BRIDGE
SET MAGNETIC NAIL & TAG IN THE SOUTH SIDE OF A 4" ELM S85°E 3.62 FEET
SET MAGNETIC NAIL & TAG IN THE EAST SIDE OF A 32" TRIPLE WILLOW N05°E 5.18 FEET
SET MAGNETIC NAIL & TAG IN THE NORTH SIDE OF AN 8" ELM EAST 9.92 FEET
SET MAGNETIC NAIL & TAG IN THE NORTHEAST SIDE OF A 12" MAPLE S45°W 13.02 FEET
CENTERLINE OF NORTH - SOUTH BITUMINOUS ROAD (WAVERLY ROAD) EAST 54± FEET
A-3 IS S89°49'08"W 283.28 FEET MC-4 IS S89°49'08"W 114.98 FEET B-3 IS N89°49'08"E 2580.08 FEET

P.A. 345 INGHAM COUNTY
PEER APPROVED 9/25/2007 *M*

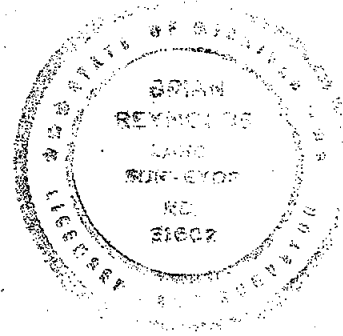

Signed by [Signature]
Surveyor's Michigan License No 31602

Date September 23, 2007

FORM APPROVED BY MICHIGAN STATE BOARD OF LAND SURVEYORS. JAN. 28, 1971

REVISED MAY 14, 1975 REVISED JANUARY, 1983 REVISED OCTOBER 1995

INGHAM COUNTY REMONUMENTATION
LAND CORNER RECORDATION CERTIFICATE
Filing Requirement of Act 74, Mich. P.A. 1970

For Corners in
INGHAM
(county)

Located In:

Corner Code #

B: 13 P: 161 10/23/2007 11:02 AM
2007-045651 LAND CORNERS Receipt #33528
Paula Johnson, Ingham County, Michigan

Pages: 1



1. Public Land Survey T 2N R 2W
MEANDER CORNER T R
LINE COMMON TO SECTIONS T R
6 & 7 AURELIUS TOWNSHIP T R

2. Property Controlling S 6 T R
in Section S 7 T R

MEANDER CORNER
No. 4 ON WEST SIDE
OF GRAND RIVER

3. Miscellaneous S T R

4. Lot No , Recorded Plat

5. Private Claims

Register of Deeds Stamp & File Number

I, Brian Reynolds, in a field survey on AUGUST 22, 2007 do hereby certify that under requirements of P.A. 74, Michigan P.A. of 1970, the corner points mentioned in lines 1 and 2 above were in conformance with regulations and rules therefore as required in the current manual of survey instructions of the United States Department of the Interior, Bureau of Land Management or by a decree of a Court of Law and/or that the corner points mentioned in lines 3, 4, and 5 above were in conformance with the rules of the Michigan Board of Land Surveyors or by a Decree of a Court of Law; established, re-established, monumented, re-monumented, recovered, found as expressed below.

NOTE: Not more than 2 corners, in the same town and range, may be recorded on this certificate.

A. Description of original monument and accessories and/or subsequent restoration:

1826 GENERAL LAND OFFICE DEPUTY SURVEYOR HERVEY PARKE, FEBRUARY, 1826, "...WEST BTW 6 & 7 40.00 SET QR (POST) ...77.35 SET (POST) ON E. BANK G. RIVER 79.15 SET (POST) ON W BANK OF RIVER (FROM WHICH) (ILLEGIBLE) 5 S11W 23 ELM 8 N47-1/2W 2681.70 INT W BDY ..." (EMPHASIS ADDED TO HIGHLIGHT THE SUBJECT MEANDER POST)

B. Description of corner evidence found and/or method applied in restoring or reestablishing corner:

FOUND AND CONFIRMED CORNERS A-3 AND B-3. THE MEASURED DISTANCE BETWEEN THESE GRID CORNERS (2747.80 FEET) COMPARES FAVORABLY WITH THE DISTANCE REPORTED BY THE ORIGINAL GOVERNMENT SURVEY (41.70 CHAINS = 2752.2 FEET). COMPUTED THE SUBJECT MEANDER CORNER POSITION AT THE RECORD DISTANCE (81.70 CH. - 79.15 CH. = 2.55 CHAINS = 168.3 FEET) EAST OF A-3, AND ON LINE BETWEEN A-3 AND B-3. TRAVERSED TO COMPUTED POSITION, SEARCHED FOR, BUT DID NOT FIND ANY EVIDENCE OF MONUMENTATION. SET STANDARD FORM PIN MARKER & ALUMINUM CAP STAMPED "MC 31602", WITNESSED AS DESCRIBED BELOW.

C. Description of monument for corner and accessories established to perpetuate locating the position of the corner:

WITNESSES TO 3/4" X 24" STEEL FORM PIN WITH AN ALUMINUM CAP STAMPED "MC 31602" ON WEST BANK OF THE GRAND RIVER 50± FEET SOUTH OF THE COLUMBIA ROAD BRIDGE SET MAGNETIC NAIL & TAG IN THE NORTHWEST SIDE OF A 40" WILLOW S60°W 14.12 FEET SET MAGNETIC NAIL & TAG IN THE WEST SIDE OF A 14" ASH NORTH 15.15 FEET SET MAGNETIC NAIL & TAG IN THE SOUTH SIDE OF A 12" WILLOW N15°W 13.13 FEET SET MAGNETIC NAIL & TAG IN THE EAST SIDE OF A 10" ASH N10°E 10.59 FEET A-3 IS S89°49'08"W 168.30 FEET MC-3 IS N89°49'08"E 114.98 FEET B-3 IS N89°49'08"E 2465.10 FEET

P.A. 345 INGHAM COUNTY
PEER APPROVED 9/25/2007 M



Signed by [Signature]
Surveyor's Michigan License No 31602

Date September 23, 2007

FORM APPROVED BY MICHIGAN STATE BOARD OF LAND SURVEYORS. JAN. 28, 1971

REVISED MAY 14, 1975 REVISED JANUARY, 1983 REVISED OCTOBER 1995