

LAND CORNER RECORDATION CERTIFICATE
Filing Requirement of Act 74, Mich. P.A. 1970

For corners in
INGHAM
(County)

Located In:

Corner Code #

DELHI TOWNSHIP.
1. Public Land Survey

T 3N R 2W
T R
T R
T R
S T R
S T R
S T R

K-05

B:12 P:302 10/12/06 8:55 AM
2006-051936 LAND CORNERS Receipt #17981
Paula Johnson, Ingham County, Michigan

Pages: 3



2. Property Controlling
in Section
3. Miscellaneous
Property in Sec.
4. Lot No. Recorded Plat
5. Private Claims

Register of Deeds Stamp & File Number

	A	B	C	D	E	F	G	H	I	J	K	L	M
1													
2	6		5		4		3		2		1		
3													
4	7		8		9		10		11		12		
5													
6	18		17		16		15		14		13		
7													
8	19		20		21		22		23		24		
9													
10	30		29		28		27		26		25		
11													
12	31		32		33		34		35		36		
13													

I, DAVID R. LOHR, P.S., in a field survey on JUNE 03, 2006, do hereby certify that under requirements of P.A. 74, Michigan P.A. of 1970, the corner points mentioned in lines 1 and 2 above were in conformance with regulations and rules therefore as required in the current manual of survey instructions of the United States Department of the Interior, Bureau of Land Management or by a decree of a Court of Law and/or that the corner points mentioned in lines 3, 4 and 5 above were in conformance with the rules of the Michigan Board of Land Surveyors or by a Decree of a Court of Law; established, re-established, monumented, re-monumented, recovered, found as expressed below:

NOTE: Not more than 2 corners, all in the same town and range, may be recorded on this certificate.

A. Description of original monument and accessories and/or subsequent restoration:

- 1) CORNER SET BY MUSGROVE EVANS, DEP. SURVEYORS, IN DEC. 1826. "NORTH BETWEEN SECTIONS. 13 & 14. 80.00 (CH) SET POST COR. TO SECS. 11, 12, 13 & 14." WITNESSED BY: MAPLE 4", N 64 E, 15 LKS. (9.90')
ELM 6", S 43 W, 3 LKS. (1.98')
GLO NOTES SHOW A DISTANCE NORTH & SOUTH OF 40.0 CH. (2640.0') EAST OF 39.85 CH. (2630.1') AND WEST OF 40.11 CH. (2647.26')

2) NO REFERENCE FOUND IN COUNTY SURVEYOR RECORDS.

3) CORNER REFERENCED IN PLAT OF "PINE TREE ACRES" BY R. J. ROBB, RLS #396, DATED 8/07/53 AND RECORDED IN LIBER 17, PAGE 12. NO MENTION OF MONUMENT OR WITNESSES GIVEN.

4) CORNER REFERENCED IN PLAT OF "PINE TREE ACRES NO. 2" BY LAVERNE J. HENDRYX, RLS #3276, DATED 6/07/67 AND RECORDED IN LIBER 28, PAGE 9. NO MENTION OF MONUMENT OR WITNESSES GIVEN.

CONTINUED ON BACK

B. Description of corner evidence found and/or method applied in restoring or reestablishing corner:

SEARCHED AT APPARENT LOCATION OF CORNER AND FOUND A 1-1/8" X 14" SOLID STEEL BAR, 12" DEEP, IN A MONUMENT BOX AT CENTERLINE-CENTERLINE OF WILLOUGHBY AND PINETREE ROADS. EXCAVATED TO FIND BAR ENTIRELY SURROUNDED BY ROCKS AT DEPTH OF 18". ACCEPTED FOUND STEEL BAR AS CORNER MATCHING ITEMS A-6, A-16 & A-20 ABOVE AND SET A STANDARD INGHAM COUNTY BAR AND PA 345 CAP #30090 IN FOUND POSITION. TRAVERSED SECTION 13, MEASURED SOUTH 2643.07' TO K-6 AND EAST 2647.90' TO L-5.

C. Description of monument for corner and accessories established to perpetuate locating the position of the corner:

K-05: T3N, R2W, DELHI TOWNSHIP, INGHAM COUNTY. FOUND SOLID STEEL BAR AND SET STANDARD INGHAM COUNTY BAR & PA 345 CAP #30090. WITNESSED BY:

SET MAG NAIL & REMON TAG, SOUTHEAST SIDE POWER POLE, N 60° E, 111.96'
CENTERLINE OF STORM MANHOLE, S 40° W, 44.38'
FOUND NAIL & TAG #28414, EAST SIDE GUY POLE, N 39° W, 44.25'
FOUND NAIL & TAG #16053, EAST SIDE POWER POLE, N 20° W, 79.24'
SET MAG NAIL & REMON TAG, EAST SIDE POWER POLE, N 07° W, 150.60'

SET MAG NAIL & REMON. TAG IS DEFINED AS A 1/4" X 2-1/2" MAGNETIC ALUMINUM ALLOY NAIL, WITH A 1-1/2" ALUMINUM DISC MARKED "INGHAM PA 345 WITNESS".

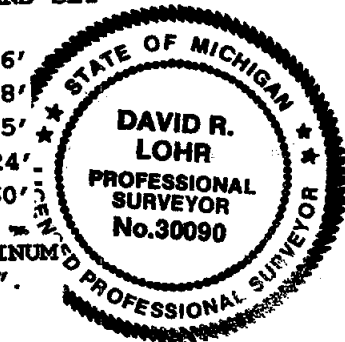

P.A. 345 INGHAM COUNTY
PEER APPROVED 6/20/2006 *ML*

Signed by

David R. Lohr

Date OCTOBER 4, 2006

Surveyor's Michigan License No. 30090

- 5) CORNER REFERENCED IN LCRC BY JAMES E. STEPHENS, RLS #16053, DATED 08/30/71 AND AND RECORDED IN LIBER 1, PAGE 277.

PART A STATES: THE ORIGINAL MONUMENT NOT FOUND.

PART B STATES: A 5/8 INCH IRON ROD WAS FOUND IN THE CENTERLINE OF THE TWO SECTION LINE ROADS (PINE TREE ROAD AND WILLOUGHBY ROAD).

PART C STATES: THE 5/8 INCH IRON ROD WAS LEFT IN POSITION WITH THE FOLLOWING WITNESSES:

SURVEY TAG IN A UTILITY POLE, N 18° 17' W, 76.10'
SURVEY TAG IN A 12 INCH WILD CHERRY, N 70° 12' W, 65.60'
SURVEY TAG IN A UTILITY POLE, S 30° 19' W, 53.02'
THE BEARING OF THE SECTIONLINE EAST OF THE CORNER IS S 88° 30' E.
THE BEARING OF THE SECTIONLINE SOUTH OF THE CORNER IS S 1° 30' 40" W.

- 6) CORNER REFERENCED IN LCRC BY RONNIE M. LESTER, RLS #18998, DATED 11/17/71 AND AND RECORDED IN LIBER 1, PAGE 283.

PART A STATES: ORIGINAL MONUMENT AND ACCESSORIES OBLITERATED.

PART B STATES: INGHAM COUNTY ROAD COMMISSION RECORDS: 1" IRON

POWER POLE, S 30° 30' W, 53.22'

12" HICKORY, N 63° 50' W, 45.49'

POWER POLE, N 18° 30' W, 76.55'

PART C STATES: FOUND 1" BAR IN CENTERLINE INTERSECTION OF WILLOUGHBY AND PINE TREE ROAD. WITNESSES BY:

NAIL & TAG, SOUTH SIDE POWER POLE, NNE, 76.15'

NAIL & TAG, EAST SIDE POWER POLE, SW, 52.98'

"X" IN TOP OF CONCRETE CORNER POST, NE, 35.41'

- 7) CORNER REFERENCED IN SURVEY BY LAVERNE J. HENDRYX, RLS #3276, DATED 6/23/72 AND RECORDED IN LIBER 1, PAGE 346. "NE CORNER, SECTION 14, T3N, R2W. NO MENTION OF MONUMENT OR WITNESSES GIVEN. SURVEY SHOWS A DISTANCE SOUTH OF 2643.25'.

- 8) CORNER REFERENCED IN SURVEY BY FRED N. WHITE, RLS #12034, DATED 4/18/74 AND RECORDED IN LIBER 1, PAGE 1270. "NE CORNER, SECTION 14, T3N, R2W. LIBER 1, PG. 283 & LIBER 1, PG. 277. NO MENTION OF MONUMENT OR WITNESSES GIVEN. SURVEY SHOWS A DISTANCE SOUTH OF 2643.14' AND WEST OF 2719.67'.

- 9) CORNER REFERENCED IN PLAT OF PINETREE ACRES NO. 3, BY LAVERNE J. HENDRYX, DATED 8/16/72 AND RECORDED IN LIBER 31, PAGE 41. NO MENTION OF MONUMENT OR WITNESSES GIVEN. NO DISTANCES TO ADJACENT SECTION CORNERS GIVEN.

- 10) CORNER REFERENCED IN SURVEY BY JAMES A. RICHARDSON, RLS #16383, DATED 8/09/78 AND RECORDED IN LIBER 3, PAGE 499. "NE CORNER, SEC. 14, T3N, R2W. LIBER 1, PG. 277, 283. NO MENTION OF MONUMENT OR WITNESSES GIVEN. NO DISTANCES TO ADJACENT SECTION CORNERS GIVEN.

- 11) CORNER REFERENCED IN SURVEY BY RONNIE M. LESTER, RLS #18998, DATED FEB. 1979 AND RECORDED IN LIBER 3, PAGE 868. "SOUTHEAST CORNER, SECTION 11, T3N, R2W, L1. PG. 283." NO MENTION OF MONUMENT. WITNESSED BY:

FOUND NAIL & TAG #12034 IN SOUTH SIDE POWER POLE, NNW, 78.86'

NAIL & TAG IN SE SIDE 6" POPLAR, NE, 88.33'

NAIL & TAG IN NORTH SIDE TW. 30" MAPLE, WSW, 110.28'

NAIL & TAG IN SOUTH SIDE 8" CHERRY, WNW, 65.97'

SURVEY SHOWS A DISTANCE NORTH OF 2638.50'.

- 12) CORNER REFERENCED IN SURVEY BY GEORGE M. YOUNG, RLS #17640, DATED 3/01/80 AND RECORDED IN LIBER 4, PAGE 32. "NE CORNER, SECTION 14." NO MENTION OF MONUMENT, OR DISTANCES TO ADJACENT SECTION CORNERS. SAME WITNESSES AS IN ITEM A-5 ABOVE.

- 13) CORNER REFERENCED IN LCRC BY JAMES E. STEPHENS, RLS #16053, DATED 04/02/87 AND AND RECORDED IN LIBER 6, PAGE 316.

PART A STATES: THE ORIGINAL MONUMENT WAS NOT FOUND.

PART B STATES: THE 5/8 INCH DIAMETER IRON ROD WAS FOUND IN THE INTERSECTION OF PINE TREE ROAD AND WILLOUGHBY ROAD AS PREVIOUSLY RECORDED.

THIS CERTIFICATE IS BEING RECORDED TO UP-DATE WITNESS INFORMATION.

PART C STATES: THE 5/8 INCH DIAMETER IRON ROD WITNESSED BY SURVEY TAGS NAILED TO:

UTILITY POLE, NNW, 79.30'

14" CHERRY TREE, NW, 65.95'

12" POPLAR TREE, NE, 97.75'

NE CORNER GARAGE, HOUSE NUMBER 2495, SW, 128.65'

CONTINUED ON PAGE 3:

14) CORNER REFERENCED IN SURVEY BY JAMES E. STEPHENS, RLS #16053, DATED 04/03/87 AND AND RECORDED IN LIBER 5, PAGE 276. "SE CORNER, SECTION 11, DELHI TWP." SAME DESCRIPTION AND WITNESSES AS IN ITEM A-11 ABOVE. SURVEY SHOWS A DISTANCE NORTH OF 2637.32'.

15) CORNER REFERENCED IN FOLLOWING PLATS:

- A. "HEARTHSIDE ACRES, BY FRED N. WHITE, RLS #12034, DATED 10/15/79 AND RECORDED IN LIBER 37, PAGE 26.
 - B. "HEARTHSIDE ACRES NO. 2", BY FRED N. WHITE, ILS #12034, DATED 12/11/87 AND RECORDED IN LIBER 43, PAGE 10.
 - C. "DUTCH MEADOWS", BY LARRY D. STEPHENS, PE #19365, DATED 00/00/00 AND RECORDED IN LIBER 43, PAGE 14.
 - D. "DUTCH MEADOWS II", BY LARRY D. STEPHENS, PE #19365, DATED 05/24/89 AND RECORDED IN LIBER 45, PAGE 17.
 - E. "DUTCH MEADOWS III", BY MARVIN F. FOUTY, LS #18989, DATED 11/30/90 AND RECORDED IN LIBER 47, PAGE 4.
 - F. "DUTCH MEADOWS NO. 4", BY JAMES E. SPEPHENS, PS #16053, DATED 04/28/94 AND RECORDED IN LIBER 49, PAGE 1.
 - G. "HEARTHSIDE ACRES NO. 3", BY DOUGLAS K. RICHARDSON, ILS #31603, DATED 10/13/93 AND RECORDED IN LIBER 48, PAGE 41.
 - H. "HEARTHSIDE ACRES NO. 4", BY FRED N. WHITE, ILS #12034, DATED 01/06/95 AND RECORDED IN LIBER 50, PAGE 42.
- NO MENTION OF MONUMENT OR WITNESSES GIVEN. PLATS SHOWS A DISTANCE WEST OF 2648.74', A DISTANCE EAST OF 2647.95' AND SOUTH OF 2643.42'.

16) CORNER REFERENCED IN SURVEY BY RONNIE M. LESTER, ILS #18998, DATED AUG. 1990 AND RECORDED IN LIBER 6, PAGE 383. "SOUTHWEST CORNER, SECTION 12, T3N, R2W, 1" BAR, LIBER 6, PAGE 316." WITNESSED BY:

NE CORNER GARAGE, 240° AZ., 128.6'
STEPHENS NAIL & TAG IN EAST SIDE UTILITY POLE, 342° AZ., 79.3'
SET NAIL AND TAG IN NORTH SIDE 8" CHERRY, 257° AZ., 89.0'
CENTERLINE OF HOLE IN TOP OF CATCH BASIN, 224° AZ., 44.3'
SURVEY SHOWS A DISTANCE NORTH OF 2637.34', AND EAST OF 2647.97'.

17) CORNER REFERENCED IN FOLLOWING CONDOMINIUMS:

- A. "HUNTERS GLEN," CONDO PLAN NO.125, BY MARVIN F. FOUTY, RLS #18989, DATED 01/02/97 AND RECORDED IN LIBER 2505, PAGE 123, AND LIBER 2503, PAGE 1067.
 - B. "APPLE RIDGE ESTATES," CONDO PLAN NO.134, BY LARRY A. BRYAN, LPS #25832, DATED 05/06/98 AND RECORDED IN LIBER 2597, PAGE 533.
- NO MENTION OF MONUMENT OR WITNESSES GIVEN. SURVEY PLANS SHOWS A DISTANCE WEST OF 2718.63' AND NORTH OF 2637.56'.

18) CORNER REFERENCED IN SURVEY BY FRED N. WHITE, RLS #12034, DATED 10/01/98 AND RECORDED IN LIBER 8, PAGE 357. "NE CORNER, SECTION 14, T3N, R2W. MON. BOX, LIBER 6, PG. 316. NO MENTION OF MONUMENT OR WITNESSES GIVEN OR DISTANCES TO ADJACENT SECTION CORNERS.

19) CORNER REFERENCED IN FOLLOWING PLATS:

- A. "AMENDED HEARTHSIDE ACRES NO. 3", BY MAURICE H. MAHIEU, LPS #28414, DATED 12/22/96 AND RECORDED IN LIBER 54, PAGE 10.
 - B. "HEARTHSIDE ACRES NO. 5, BY FRED N. WHITE, RLS #12034, DATED 02/25/00 AND RECORDED IN LIBER 54, PAGE 11.
- NO MENTION OF MONUMENT OR WITNESSES GIVEN. PLATS SHOWS A DISTANCE EAST OF 2648.74'.

20) CORNER REFERENCED IN SURVEY BY MAURICE H. MAHIEU, PS #28414, DATED 6/23/03 AND RECORDED IN LIBER 8, PAGE 1197. "SE CORNER, SECTION 11, T3N, R2W, DELHI TWP., FND. 3/4" IRON IN MON. BOX." WITNESSED BY:

N & T #28414, E. SIDE UTILITY POLE, N 45° W, 44.23'
N & T #16053, E. SIDE UTILITY POLE, N 30° W, 79.27'
N & T #28414, S. SIDE UTILITY POLE, N 60° E, 111.60'
N & T #28414, NE. SIDE 10" PINE, S 50° E, 90.95'
SURVEY SHOWS A DISTANCE WEST OF 2718.57'.

21) NO OTHER REFERENCES FOUND.

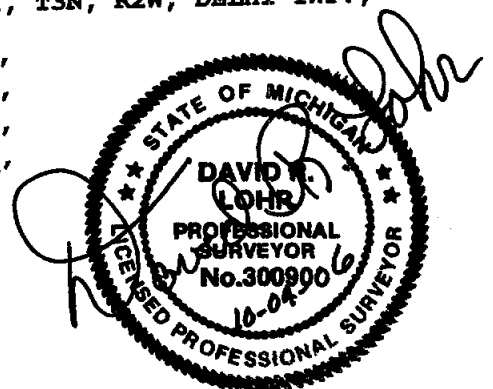

LAND CORNER RECORDATION CERTIFICATE
Filing Requirement of Act 74, Mich. P.A. 1970

For corners in

INGHAM

(County)

Located In:

Corner Code #

DELHI TOWNSHIP.

1. Public Land Survey

T 3N R 2W

K-06

B:12 P:303 10/12/06 8:55 AM
2006-051937 LAND CORNERS Receipt #17981
Paula Johnson, Ingham County, Michigan

Page: 3



2. Property Controlling
in Section

S T R

3. Miscellaneous
Property in Sec.

S T R

4. Lot No. Recorded Plat

5. Private Claims

Register of Deeds Stamp & File Number

	A	B	C	D	E	F	G	H	I	J	K	L	M
1													
2	6		5		4		3		2		1		
3													
4	7		8		9		10		11		12		
5													
6	18		17		16		15		14		13		
7													
8	19		20		21		22		23		24		
9													
10	30		29		28		27		26		25		
11													
12	31		32		33		34		35		36		
13													

I, DAVID R. LOHR, P.S., in a field survey on MAY 23, 2006,
do hereby certify that under requirements of P.A. 74, Michigan P.A. of 1970, the corner points
mentioned in lines 1 and 2 above were in conformance with regulations and rules therefore
as required in the current manual of survey instructions of the United States Department of the
Interior, Bureau of Land Management or by a decree of a Court of Law and/or that the corner
points mentioned in lines 3, 4 and 5 above were in conformance with the rules of the Michigan
Board of Land Surveyors or by a Decree of a Court of Law, established, re-established,
monumented, re-monumented, recovered, found as expressed below:

NOTE: Not more than 2 corners, all in the same town and range, may be recorded
on this certificate.

A. Description of original monument and accessories and/or subsequent restoration:

1) CORNER SET BY MUSGROVE EVANS, DEP. SURVEYORS, IN DEC.
1826. "NORTH BETWEEN SECTIONS. 13 & 14. 40.00 (CH) SET 1/4 SEC. POST."

WITNESSED BY: SUGAR 20", S 27 E, 20 LKS. (13.20')
BE 18", S 87 W, 38 LKS. (25.08')

GLO NOTES SHOW A DISTANCE NORTH & SOUTH OF 40.0 CH. (2640.0').

2) CORNER REFERENCED IN SURVEY BY ANSON JACKSON, CO. SURVEYOR, ON MAR. 5, 1841,
RECORDED IN BOOK 4, PAGE 70. NO MENTION OF MONUMENT. SAME WITNESSES AS IN ITEM A-1
ABOVE. SURVEY SHOWS A DISTANCE WEST OF 159 RODS, 2 LKS. (2624.82').

3) CORNER REFERENCED IN SURVEY BY ANSON JACKSON, CO. SURVEYOR, ON SEPT. 18, 1849,
RECORDED IN BOOK 4, PAGE 258, NO MENTION OF MONUMENT. WITNESSED BY:
BEECH 14", N 1-1/2 W, 9 LKS. (5.94')
DO 12", N 54-3/4 W, 36 LKS. (23.76')
SURVEY SHOWS NO DISTANCES TO ADJACENT SECTION CORNERS.

CONTINUED ON PAGE 2:

B. Description of corner evidence found and/or method applied in restoring or reestablishing corner:

SEARCHED AT APPARENT LOCATION OF CORNER AND FOUND A 1/2" X 12" REBAR, ON CENTERLINE OF
KELLER ROAD AND 6' EAST OF CENTERLINE OF PINETREE ROAD TO THE NORTH. EXCAVATED TO FIND
REBAR OVER A 3/4" X 18" PIPE AT 17" DEEP. CONTINUED EXCAVATING AND HIT WHITE CROCKERY AND
STONES AT 24" DEEP. EXCAVATED TO TOTAL DEPTH OF 30", FOUND NO ADDITIONAL EVIDENCE.
ACCEPTED FOUND REBAR, PIPE, CROCKERY & STONES AS CORNER AND SET A STANDARD INGHAM COUNTY
BAR AND PA 345 CAP #30090 IN A NEW MON. BOX. TRAVERSED SECTION 13, MEASURED NORTH
2643.07' TO K-5 AND EAST 2641.15' TO L-6.

C. Description of monument for corner and accessories established to perpetuate locating the position of the corner:

K-06: T3N, R2W, DELHI TOWNSHIP, INGHAM COUNTY. FOUND REBAR, PIPE, CROCKERY & STONES.
SET A STANDARD INGHAM COUNTY BAR & PA 345 CAP #30090 IN A NEW MON. BOX. WITNESSED BY:

FOUND NAIL & TAG #3829 (C. STEPHENS), SOUTHEAST SIDE 32" PINE, N 49° E, 41.54'

SET MAG NAIL & REMON TAG, SOUTHWEST SIDE POWER POLE, S 25° E, 25.44'

FOUND NAIL & TAG #28414, EAST SIDE 13" MAPLE, S 40° W, 49.33'

CENTERLINE SANITARY MAHOLE, N 62° W, 11.26'

SET MAG NAIL & REMON. TAG IS DEFINED AS A 1/4" X 2-1/2" MAGNETIC ALUMINUM
ALLOY NAIL, WITH A 1-1/2" ALUMINUM DISC MARKED "INGHAM PA 345 WITNESS".

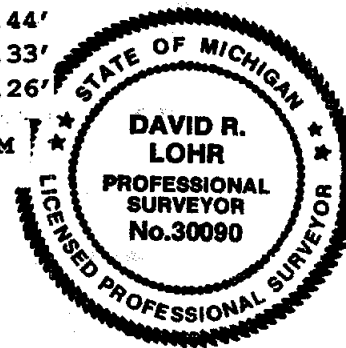

Signed by

David R. Lohr

Date

SEPTEMBER 26, 2006

Surveyor's Michigan License No. 30090

FORM APPROVED BY MICHIGAN STATE BOARD OF LAND SURVEYORS, JAN. 1971

REVISED MAY 14, 1976

REVISED JAN. 1983

REVISED OCT. 1986

ADAPTED FOR WORD PROCESSING JAN. 1999

P.A. 345 INGHAM COUNTY
PEER APPROVED 6/20/2006 M

- 4) CORNER REFERENCED IN UNDATED INGHAM COUNTY ROAD COMMISSION GRID MAP AS "STONE."
WITNESSED BY: 30" PINE, NE, 40.2'
4" ELM, SW, 32.5'
NW COR. HOUSE WALL, S., 53.0'
- 5) CORNER REFERENCED IN LCRC BY JAMES E. STEPHENS, RLS #16053, DATED 08/30/71 AND
AND RECORDED IN LIBER 1, PAGE 275.
PART A STATES: THE ORIGINAL MONUMENT WAS NOT FOUND.
PART B STATES: A 3/4 INCH IRON PIPE WAS FOUND IN THE CENTERLINE OF THE SECTION
LINE ROAD (PINE TREE ROAD) AND IN THE CENTERLINE OF THE 1/4 LINE
ROAD (KELLER ROAD).
PART C STATES: THE 3/4 INCH IRON PIPE FOUND AT THE W 1/4 CORNER WAS LEFT IN
POSITION WITH THE FOLLOWING WITNESSES:
SURVEY TAG IN A 36 INCH PINE, N 48° 57' E, 41.80'
SURVEY TAG IN A UTILITY POLE, S 52° 36' W, 38.14'
SURVEY TAG IN A UTILITY POLE, S 34° 51' E, 21.44'
THE BEARING OF THE SECTIONLINE NORTH OF THE CORNER IS N 88° 30' 40" E.
THE BEARING OF THE 1/4 LINE EAST OF THE CORNER IS S 88° 32' 23" E.
- 6) CORNER REFERENCED IN SURVEY BY LAVERNE J. HENDRYX, RLS #3276, DATED 6/23/72 AND
RECORDED IN LIBER 1, PAGE 346. "EAST 1/4 POST, SECTION 14, T3N, R2W. NO MENTION OF
MONUMENT OR WITNESSES GIVEN. SURVEY SHOWS A DISTANCE NORTH OF 2643.25'.
- 7) CORNER REFERENCED IN SURVEY BY FRED N. WHITE, RLS #12034, DATED 4/18/74 AND RECORDED
IN LIBER 1, PAGE 1270. "E 1/4 CORNER, SECTION 14, T3N, R2W. LIBER 1, PG. 275.
NO MENTION OF MONUMENT OR WITNESSES GIVEN. SURVEY SHOWS A DISTANCE NORTH OF
2643.14'.
- 8) CORNER REFERENCED IN SURVEY BY GEORGE M. YOUNG, RLS #17640, DATED 3/01/80 AND
RECORDED IN LIBER 4, PAGE 32. "EAST 1/4 POST, SECTION 14." NO MENTION OF MONUMENT,
OR DISTANCES TO ADJACENT SECTION CORNERS. SAME WITNESSES AS IN ITEM A-3 ABOVE.
- 9) CORNER REFERENCED IN LCRC BY JAMES E. STEPHENS, RLS #16053, DATED 09/13/84 AND
AND RECORDED IN LIBER 6, PAGE 256.
PART A STATES: THE ORIGINAL MONUMENT WAS NOT FOUND.
PART B STATES: A 3/4 INCH IRON PIPE WAS FOUND IN THE INTERSECTION OF PINE TREE
AND KELLER ROADS AS PREVIOUSLY RECORDED IN LIBER 1, PAGE 275.
THIS CERTIFICATE IS BEING RECORDED TO UP-DATE WITNESS INFORMATION.
PART C STATES: THE 3/4 INCH IRON PIPE WAS WITNESSED BY:
SURVEY TAG #11370 IN UTILITY POLE, S 80° E, 79.65'
SURVEY TAG #16053 IN 36" PINE TREE, N 49° E, 41.65'
SURVEY TAG #16053 IN UTILITY POLE, S 35° E, 21.40'
SURVEY TAG #12034 IN UTILITY POLE, S 53° W, 35.00'
- 10) CORNER REFERENCED IN SURVEY BY JAMES E. STEPHENS, RLS #16053, DATED 09/14/84 AND
AND RECORDED IN LIBER 4, PAGE 935. "EAST 1/4 CORNER, SECTION 14, DELHI TWP." SAME
DESCRIPTION AND WITNESSES AS IN ITEM A-7 ABOVE. SURVEY SHOWS A DISTANCE WEST OF
2684.96'.
- 11) CORNER REFERENCED IN SURVEY BY DAVID R. LOHR, LPS #30090, DATED 08/22/97 AND
AND RECORDED IN LIBER 7, PAGE 1278. "EAST 1/4 CORNER, SECTION 14, T3N, R2W.
STRONG MAG. READING, AREA UNDER CONSTRUCTION. SET MAG NAIL FROM WITNESSES."
WITNESSED BY: FD. N&T #16053, E/S P. POLE, N 18W, 99.90'
SET N&T #30090, SW/S P. POLE, S 28E, 25.45'
FD. N&T #16053, SE/S 36" PINE, N 49E, 41.65'
SURVEY SHOWS A DISTANCE SOUTH OF 2636.15'.

CONTINUED ON PAGE 3:

12) CORNER REFERENCED IN FOLLOWING PLATS:

- A. "HEARTHSIDE ACRES, BY FRED N. WHITE, RLS #12034, DATED 10/15/79 AND RECORDED IN LIBER 37, PAGE 26.
- B. "HEARTHSIDE ACRES NO. 3", BY DOUGLAS K. RICHARDSON, LLS #31603, DATED 10/13/93 AND RECORDED IN LIBER 48, PAGE 41.
- C. "HEARTHSIDE ACRES NO. 4", BY FRED N. WHITE, LLS #12034, DATED 01/06/95 AND RECORDED IN LIBER 50, PAGE 42.
- D. "KELLER'S RIDGE", BY MARVIN F. FOUTY, RLS #19989, DATED 10/21/98 AND RECORDED IN LIBER 52, PAGE 27.
- E. "AMENDED HEARTHSIDE ACRES NO. 3", BY MAURICE H. MAHIEU, LPS #28414, DATED 12/22/96 AND RECORDED IN LIBER 54, PAGE 10.
- F. "HEARTHSIDE ACRES NO. 5", BY FRED N. WHITE, LLS #12034, DATED 02/25/00 AND RECORDED IN LIBER 54, PAGE 11.
- G. "KELLER RIDGE NO. 2", BY RONALD L. ENGER, PS #28409, DATED 11/21/00 AND RECORDED IN LIBER 54, PAGE 5.
- H. "ARBORWOOD NO. 1", BY FRED N. WHITE, LLS #12034, DATED 09/15/01 AND RECORDED IN LIBER 54, PAGE 48.
- I. "ARBORWOOD NO. 2", BY FRED N. WHITE, LLS #12034, DATED 09/15/01 AND RECORDED IN LIBER 54, PAGE 50.
- J. "ARBORWOOD NO. 3", BY FRED N. WHITE, LLS #12034, DATED 09/17/01 AND RECORDED IN LIBER 54, PAGE 52.
- K. "ASPEN WOODS", BY FRED N. WHITE, LLS #12034, DATED 11/28/01 AND RECORDED IN LIBER 55, PAGE 2.
- L. "ASPEN WOODS EAST", BY FRED N. WHITE, LLS #12034, DATED 08/07/03 AND RECORDED IN LIBER 56, PAGE 4.
- M. "KELLER RIDGE NO. 4", BY RONALD L. ENGER, PS #28409, DATED 06/29/04 AND RECORDED IN LIBER 56, PAGE 10.

NO MENTION OF MONUMENT OR WITNESSES GIVEN. PLATS SHOWS A DISTANCE NORTH OF 2643.42', EAST OF 2642.58' AND SOUTH OF 2636.12'.

- 13) CORNER REFERENCED IN SURVEY BY JEFFREY K. AUTENRIETH, PS #31588, DATED 1/18/05 AND RECORDED IN LIBER 9, PAGE 163. "WEST 1/4 CORNER, SECTION 13, T3N, R2W, LIBER 6, PAGE 256, 3/4" IRON PIPE." SAME WITNESSES AS IN ITEM A-7 ABOVE. SURVEY SHOWS A DISTANCE SOUTH OF 2636.28'.

- 14) NO OTHER REFERENCES FOUND.



INFORMATION
RECORDATION

LIBER 8 PAGE 89
FILED

DEC 14 1993

LAND CORNER RECORDATION CERTIFICATE
Filing Requirement of Act 74; Mich. P.A. 1970

DEC 2 12 19 PM '93

For corners in **COMMISSION**

Ingham County

Located in:

Corner Code-#

Delhi Township

1. Public Land Survey

T 3N R 2W

K-7

T R

T R

T R

2. Property Controlling
in Section

S T R

S T R

3. Miscellaneous
Property in Sec.

S T R

S T R

REGISTER OF DEEDS

Richard W. Steedman

INGHAM COUNTY, MICH.

Register of Deeds Stamp & File Number

4. Lot No. , Recorded Plat

5. Private Claims

I, Richard W. Steedman, in a field survey on October 14, 1993,
do hereby certify that under requirements of P.A. 74, Michigan P.A. of 1970, the corner points mentioned
in lines 1 and 2 above were in conformance with regulations and rules therefore as required in the
current manual of survey instructions of the United States Department of the Interior, Bureau of Land
Management or by a decree of a Court of Law and/or that the corner points mentioned in lines 3, 4 and 5
above were in conformance with the rules of the Michigan Board of Land Surveyors or by a Decree of a
Court of Law, established, re-established, monumented, re-monumented, recovered, found as
expressed below:

NOTE: Not more than 4 corners, all in the same town and range, may be recorded
on this certificate.

A. Description of original monument and accessories and/or subsequent restoration:

1. Post set by Musgrove Evans Deputy Surveyor in January 1827
Tamarack 6" N37°W 26 LKS
Aspen 10" S44°W 44 LKS

(continued on back)

B. Description of corner evidence found and/or method applied in restoring or reestablishing corner:

Searched at apparent location of Corner and found 3/4" Iron Axle in monument box
in centerline Holt Road with no apparent occupation lines immediately adjacent.
Measured West along centerline Holt Road 92.4' to the East rail of the Michigan
Central Railroad as called for in surveys recorded by County Surveyors T.J. Brown,
and E.A. Calkins in 1867 & 1900 respectfully. Found Axle agrees with adjacent
Supervisor's plat #11 and Hacker Fruit Farms. Therefore accepted 3/4" Iron Axle as
Corner & capped with PA345 Cap PS #11370.

C. Description of monument for corner and accessories established to perpetuate locating the position of the corner:

3/4" Iron Axle with PA345 Cap #11370 in Monument Box
East rail MCRR at Q
Holt Road azimuth 270°, 92.4'
Southwest corner Frame Bldg. N10°E, 82.52'
Set Nail & Tag #25837 in 20" Pine N70°E, 104.45'
Q Railroad Signal Post azimuth 287° 92.27'
Northwest corner Trans. Tower leg azimuth 126° 66.30'
Found Tag #18989 in Power Pole N22°E, 37.5'



Signed by

Richard W. Steedman

Date

October 17, 1993

Surveyor's Michigan License No. 11370

FORM APPROVED BY MICHIGAN STATE BOARD OF LAND SURVEYORS, JAN. 28, 1971
REVISED MAY 14, 1975
REVISED JAN., 1981

P.A. 345 INGHAM COUNTY
PEER APPROVED 10/28/93 RL

2585

2. T.J. Brown Deputy County Surveyor in a survey dated December 1867 calls for post driven to surface
Elm 9° N14°W 143.5 LKS
Elm 30° S27 1/2°W 35 LKS
East rail MCRR 140 LKS (92.40')
3. E.A. Calkins County Surveyor calls for corner in a survey dated April 1900 and recorded in folder #1, page 54 as an iron wagon skeln with same witnesses as in item #2 above.
4. Nothstline notes (M. Berryman's personal notes) call for Iron with same witnesses as in item #2 above.
5. Corner is called for in Supervisor's plat no. 11 as recorded in Liber 13 of plats, pages 32 by Laverne Hendryx RLS in 1942 and Hacker's Fruit Farms a subdivision recorded in Liber 11 of plats, page 36 by E.W. Tappan PE in 1931.
6. Corner recorded by Fred White in Liber 1 of Corners, page 447 in April 1972 as a found Monument Box.
Northwest cor. Elec. P. Tower East Southeast 65.6'
Southwest cor. House N10°W 72.03'
Power Pole N20°E 34.45'
7. Ron Helsel LS #18984 used Corner in survey recorded in Liber 1 of surveys, page 228 in April 1972 with same witnesses as in item #6 above.
8. Laverne Hendryx LS #3276 used Corner in survey recorded in Liber 1 of surveys, page 708 in May of 1973 with no mention of monument or witnesses.
9. R. Lester LS #18998 used Corner in survey recorded in Liber 4 of surveys, page 1170 in December 1985.
Nail & Tag in West side power pole N.N.E. 34.8'
Centerline of catch basin cover North 30.5'
Northwest leg transmission line tower Southeast 66.7'
Nail & Tag in power pole S.S.E. 33.1'

LAND CORNER RECORDATION CERTIFICATE
Filing Requirement of Act 74, Mich. P.A. 1970

For corners in
INGHAM
(County)

Located In:

Corner Code #

DELHI TOWNSHIP.

1. Public Land Survey

T 3N R 2W

L-05

B:12 P:304 10/12/06 8:55 AM
2006-051938 LAND CORNERS Receipt #17981
Paula Johnson, Ingham County, Michigan

Page: 3



2. Property Controlling
in Section

S T R

3. Miscellaneous
Property in Sec.

S T R

4. Lot No. , Recorded Plat

S T R

5. Private Claims

Register of Deeds Stamp & File Number

	A	B	C	D	E	F	G	H	I	J	K	L	M
1													
2	6		5		4		3		2		1		
3													
4	7		8		9		10		11		12		
5													
6	18		17		16		15		14		13		
7													
8	19		20		21		22		23		24		
9													
10	30		29		28		27		26		25		
11													
12	31		32		33		34		35		36		
13													

I, DAVID R. LOHR, P.S., in a field survey on 6/08 & 08/22 & 9/07/06, do hereby certify that under requirements of P.A. 74, Michigan P.A. of 1970, the corner points mentioned in lines 1 and 2 above were in conformance with regulations and rules therefore as required in the current manual of survey instructions of the United States Department of the Interior, Bureau of Land Management or by a decree of a Court of Law and/or that the corner points mentioned in lines 3, 4 and 5 above were in conformance with the rules of the Michigan Board of Land Surveyors or by a Decree of a Court of Law, established, re-established, monumented, re-monumented, recovered, found as expressed below:

NOTE: Not more than 2 corners, all in the same town and range, may be recorded on this certificate.

A. Description of original monument and accessories and/or subsequent restoration:

1) CORNER SET BY MUSGROVE EVANS, DEP. SURVEYORS, IN DEC. 1826. "WEST CORRECTED BETWEEN SECS. 12 & 13. 39.85 (CH) SET 1/4 SEC. POST AT AV. D. ON TRUE LINE." WITNESSED BY:

BE. 3", S 11 W, 37 LKS. (24.42')
ELM 10", N 68 E, 63 LKS. (41.58')

GLO NOTES SHOW A DISTANCE EAST & WEST OF 39.85 CH. (2630.10')

CONTINUED ON PAGE 2:

B. Description of corner evidence found and/or method applied in restoring or reestablishing corner: SEARCHED AT APPARENT LOCATION OF CORNER AND FOUND A RAILROAD SPIKE (LIBER 1, PAGE 279) ON THE CENTERLINE OF WILLOUGHBY ROAD (BIT. PAVED) AND ON LINE WITH AN OLD FENCE TO THE NORTH. TRAVERSED EAST AND WEST, FOUND SPIKE FALLS 0.42' NORTH OF A TRUE LINE BETWEEN K-05 AND M-05. MY PRESUMPTION IS THAT THE RAILROAD SPIKE WAS SET ON THE SECTION LINE AND THE FENCELINE TO THE NORTH. MEASURED 25.2' SOUTH OF FACE OF FOUND HEXAGON CONCRETE ANCHOR POST TO NORTH, (ITEM A-3 ABOVE) AND GOT A WEAK MAGNETIC READING. EXCAVATED TO FIND A 1" X 18" STEEL FORM PIN, AT DEPTH OF 14". STEEL PIN WAS BENT TO THE NORTH, ALONG THE SOUTH SIDE OF A LARGE STONE, AT DEPTH OF 18" WHICH WAS ALSO LEANING TO THE NORTH. FOUND STEEL PIN WAS SET IN A CIRCLE OF SMALLER STONES. ACCEPTED FOUND STEEL PIN AS PERPETUATION OF CALKINS 1901 CORNER AND SET A STANDARD INGHAM COUNTY BAR AND PA 345 CAP #30090, IN A NEW MONUMENT BOX, AT LOCATION OF FOUND STEEL PIN. ALSO REPLACED THE FOUND RAILROAD SPIKE (PROPERTY CONTROLLING CORNER) WITH A 3/4" X 20" PIPE IN A NEW 6" MONUMENT BOX. TRAVERSED SECTION 13, MEASURED EAST 2604.46' TO M-5, WEST 2647.76' TO K-5 & SOUTH 2642.87' TO L-6.

C. Description of monument for corner and accessories established to perpetuate locating the position of the corner: L-05: T3N, R2W, DELHI TOWNSHIP, INGHAM COUNTY. FOUND STEEL PIN AND STONE,

SET STANDARD INGHAM COUNTY BAR & PA 345 CAP #30090 IN A MONUMENT BOX. WITNESSED BY:

FOUND NAIL & TAG #3829, (CLYDE STEPHENS), SOUTHWEST SIDE UTILITY POLE, S 40° E, 48.50'
FACE OF CONCRETE ANCHOR POST, DUE NORTH, 25.33'
SET MAG NAIL & REMON. TAG, SOUTH SIDE 15" MAPLE, S 70° E, 81.05'
FOUND 4" CONCRETE PLAT MONUMENT, DUE SOUTH, 51.80'
SET MAG NAIL & REMON. TAG, SOUTH SIDE 20" HICKORY, N 66° W, 80.90'
FOUND RAILROAD SPIKE (LIBER 1, PAGE 279), DUE SOUTH, 1.72'

PROPERTY CONTROLLING CORNER: FOUND RAILROAD SPIKE, REPLACED WITH A 3/4" X 20" PIPE IN A NEW 6" MONUMENT BOX. WITNESSED BY:

FOUND NAIL & TAG #3829, (CLYDE STEPHENS), SOUTHWEST SIDE UTILITY POLE, S 35° E, 47.05'
FACE OF CONCRETE ANCHOR POST, DUE NORTH, 27.05'
SET MAG NAIL & REMON. TAG, SOUTH SIDE 15" MAPLE, S 64° E, 80.25'
FOUND 4" CONCRETE PLAT MONUMENT, DUE SOUTH, 50.08'
SET MAG NAIL & REMON. TAG, SOUTH SIDE 20" HICKORY, N 65° W, 81.63'
SET BAR & PA 345 CAP IN MON. BOX, DUE NORTH, 1.72'

SET MAG NAIL & REMON. TAG IS DEFINED AS A 1/4" X 2-1/2" MAGNETIC ALUMINUM ALLOY NAIL, WITH A 1-1/2" ALUMINUM DISC MARKED "INGHAM PA 345 WITNESS".

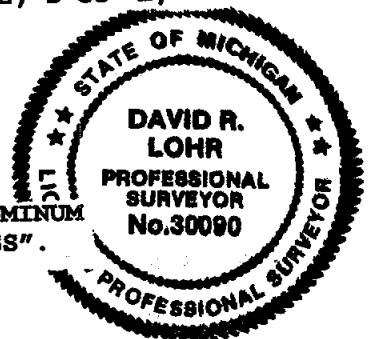

Signed by

David R. Lohr

Date SEPTEMBER 25, 2006

Surveyor's Michigan License No. 30090

FORM APPROVED BY MICHIGAN STATE BOARD OF LAND SURVEYORS, JAN. 1971
REVISED MAY 14, 1975
REVISED JAN. 1983
REVISED OCT. 1986
ADAPTED FOR WORD PROCESSING JAN. 1999

P.A. 345 INGHAM COUNTY
PEER APPROVED 9/26/2006 *ML*

- 2) CORNER REFERENCED IN SURVEY BY E.A. CALKINS, CO. SURVEYOR, DATED AUG. 26, 1901 AND RECORDED ON PAGE 174 OF MISC. SURVEYORS FIELDBOOK AS "OLD STONE & ?????, F.W."
WITNESSED BY: B. WALNUT, S 9-3/4° W, 45 LKS. (29.70')
B. WALNUT, S 35-1/2° W, 54 LKS. (35.64')
NOTES SHOW A DISTANCE EAST OF 39.40 CH. (2600.40')
- 3) CORNER REFERENCED IN UNDATED INGHAM COUNTY ROAD COMMISSION GRID MAP AS "IRON, STONE."
WITNESSED BY: 10" WALNUT, S, 30.2'
16" WALNUT, SSW, 35.8'
ANCH. POST, N, 25.2'
8" ELM, SE, 52.0'
- 4) CORNER REFERENCED IN LCRC BY JAMES E. STEPHENS, RLS #16053, DATED 08/30/71 AND AND RECORDED IN LIBER 1, PAGE 279.
PART A STATES: THE ORIGINAL MONUMENT NOT FOUND.
PART B STATES: A RAILROAD SPIKE WAS FOUND IN THE CENTERLINE OF THE SECTION LINE ROAD (WILLOUGHBY ROAD) AND ON A PROJECTION OF AN OLD FARM FENCE TO THE SOUTH.
PART C STATES: THE RAILROAD SPIKE FOUND AT THE N 1/4 CORNER WAS LEFT IN POSITION WITH THE FOLLOWING WITNESSES:
SURVEY TAG IN A 18 INCH WALNUT, S 55° 10' W, 46.45'
SURVEY TAG IN A 30 INCH WALNUT, S 11° 22' W, 27.95'
SURVEY TAG IN A UTILITY POLE, S 38° 04' E, 47.04'
THE BEARING OF THE SECTIONLINE WEST OF THE CORNER IS N 88° 30' W.
- 5) CORNER REFERENCED IN FOLLOWING PLATS:
A. "WILLOUGHBY HEIGHTS", BY JAMES E. STEPHENS, RLS #16053, DATED 10/06/71 AND RECORDED IN LIBER 30, PAGE 40.
B. "WILLOUGHBY HEIGHTS NO. 2", BY JAMES E. STEPHENS, RLS #16053, DATED 04/12/74 AND RECORDED IN LIBER 32, PAGE 37.
C. "WILLOUGHBY HEIGHTS NO. 3", BY JAMES E. STEPHENS, RLS #16053, DATED 05/07/80 AND RECORDED IN LIBER 37, PAGE 11.
D. "HEARTHSIDE ACRES", BY FRED N. WHITE, RLS #12034, DATED 10/15/79 AND RECORDED IN LIBER 37, PAGE 26.
E. "HEARTHSIDE ACRES NO. 2", BY FRED N. WHITE, LLS #12034, DATED 12/11/87 AND RECORDED IN LIBER 43, PAGE 10.
F. "DUTCH MEADOWS", BY LARRY D. STEPHENS, PE #19365, DATED 00/00/00 AND RECORDED IN LIBER 43, PAGE 14.
G. "COLLEGE HEIGHTS ESTATES", BY LARRY D. STEPHENS, PE #19365, DATED 04/01/88 AND RECORDED IN LIBER 43, PAGE 37.
H. "COLLEGE HEIGHTS ESTATES II", BY LARRY D. STEPHENS, PE #19365, DATED 04/24/89 AND RECORDED IN LIBER 45, PAGE 1.
I. "DUTCH MEADOWS II", BY LARRY D. STEPHENS, PE #19365, DATED 05/24/89 AND RECORDED IN LIBER 45, PAGE 17.
J. "DUTCH MEADOWS III", BY MARVIN F. FOUTY, LS #18989, DATED 11/30/90 AND RECORDED IN LIBER 47, PAGE 4.
K. "COLLEGE HEIGHTS ESTATES III", BY RON HELSEL, RLS #18994, DATED 12/21/93 AND RECORDED IN LIBER 48, PAGE 41.
L. "HEARTHSIDE ACRES NO. 3", BY DOUGLAS K. RICHARDSON, LLS #31603, DATED 10/13/93 AND RECORDED IN LIBER 48, PAGE 41.
M. "DUTCH MEADOWS NO. 4", BY JAMES E. SPEPHENS, PS #16053, DATED 04/28/94 AND RECORDED IN LIBER 49, PAGE 1.
N. "COLLEGE HEIGHTS ESTATES IV", BY TERRY L. WEIGMAN, LLS #31100, DATED 10/30/95 AND RECORDED IN LIBER 50, PAGE 14.
O. "HEARTHSIDE ACRES NO. 4", BY FRED N. WHITE, LLS #12034, DATED 01/06/95 AND RECORDED IN LIBER 50, PAGE 42.
P. "COLLEGE HEIGHTS ESTATES V", BY JAMES E. STEPHENS, LPS #16053, DATED 08/13/97 AND RECORDED IN LIBER 51, PAGE 32.
Q. "AMENDED HEARTHSIDE ACRES NO. 3", BY MAURICE H. MAHIEU, LPS #28414, DATED 12/22/96 AND RECORDED IN LIBER 54, PAGE 10.
R. "KELLER RIDGE NO. 3", BY RONALD L. ENGER, PS #28409, DATED 02/22/02 AND RECORDED IN LIBER 54, PAGE 44.
S. "KELLER RIDGE NO. 4", BY RONALD L. ENGER, PS #28409, DATED 06/29/04 AND RECORDED IN LIBER 56, PAGE 10.

NO MENTION OF MONUMENT OR WITNESSES GIVEN. PLATS SHOWS A DISTANCE WEST OF 2648.74' AND A DISTANCE EAST OF 2604.35' NORTH OF 2643.42'.

CONTINUED ON PAGE 3:

L-05: T3N, R2W, DELHI TOWNSHIP, INGHAM COUNTY-PAGE 3 (PART "A" CONTINUED)

- 6) CORNER REFERENCED IN THE FOLLOWING SURVEYS BY MARVIN F. FOUTY, RLS #18989:
DATED 01/02/87 AND RECORDED IN LIBER 5, PAGE 254.
DATED 07/30/87 AND RECORDED IN LIBER 5, PAGE 341.
DATED 08/01/88 AND RECORDED IN LIBER 5, PAGE 588.
DATED 12/09/88 AND RECORDED IN LIBER 5, PAGE 1144.
"S 1/4 CORNER, SEC. 13, T3N, R2W. NO MENTION OF MONUMENT OR WITNESSES GIVEN.
SURVEYS SHOW A DISTANCE NORTH OF 2635.55', EAST OF 2604.35'.
- 7) CORNER REFERENCED IN SURVEY BY RONNIE M. LESTER, LLS #18998, DATED AUG. 1990 AND RECORDED IN LIBER 6, PAGE 383. "SOUTH 1/4 CORNER, SECTION 12, T3N, R2W, RAILROAD SPIKE, LIBER 1, PAGE 279." WITNESSED BY:
STEPHENS NAIL & TAG IN WEST SIDE UTILITY POLE, 143° AZ., 47.0'
CENTERLINE OF HYDRANT, 86° AZ., 113.1'
CONCRETE MONUMENT, 03° AZ., 45.0'
CENTERLINE OF MANHOLE, 117° AZ., 42.4'
SURVEY SHOWS A DISTANCE NORTH OF 2635.47', AND WEST OF 2647.97'.
- 8) CORNER REFERENCED IN THE FOLLOWING SURVEYS BY RON HELSEL, RLS #18994:
DATED 04/23/91 AND RECORDED IN LIBER 6, PAGE 907.
DATED 02/23/93 AND RECORDED IN LIBER 7, PAGE 14.
"SOUTH 1/4 CORNER, SEC. 12, T3N, R2W, LIBER 1, PG. 279. FOUND RAILROAD SPIKE IN POSITION PER PREVIOUS DESCRIPTION. WITNESSED BY:
FOUND NAIL & TAG (#3829) ON WEST SIDE UTILITY POLE, S 38° 04' E, 46.99'
SET NAIL & TAG ON EAST SIDE 16" ELM, N 10° E, 30.07'
SET NAIL & TAG ON SW SIDE 15" ELM, N 53° W, 50.23'
SET NAIL & TAG ON SW SIDE 11" MAPLE, S 56° E, 54.88'
SURVEYS SHOW A DISTANCE EAST OF 2604.27'.
- 9) NO OTHER REFERENCES FOUND.



P.A. 345 INGHAM COUNTY
PEER APPROVED 9/26/2006 *me*

LAND CORNER RECORDATION CERTIFICATE
Filing Requirement of Act 74, Mich. P.A. 1970

For corners in
INGHAM
(County)

Located In:

Corner Code #

DELHI TOWNSHIP.

1. Public Land Survey

T 3N R 2W

L-06

B:12 P:306 10/12/06 8:55 AM
2006-051940 LAND CORNERS Receipt #17981
Paula Johnson, Ingham County, Michigan

Page: 2



2. Property Controlling
in Section

S

T R

3. Miscellaneous
Property in Sec.

S

T R

4. Lot No. _____, Recorded Plat

S

T R

5. Private Claims

Register of Deeds Stamp & File Number

	A	B	C	D	E	F	G	H	I	J	K	L	M
1													
2	6	5	4	3	2	1							
3													
4	7	8	9	10	11	12							
5													
6	18	17	16	15	14	13							
7													
8	19	20	21	22	23	24							
9													
10	30	29	28	27	26	25							
11													
12	31	32	33	34	35	36							
13													

I, DAVID R. LOHR, P.S., in a field survey on APRIL 11, 2006, do hereby certify that under requirements of P.A. 74, Michigan P.A. of 1970, the corner points mentioned in lines 1 and 2 above were in conformance with regulations and rules therefore as required in the current manual of survey instructions of the United States Department of the Interior, Bureau of Land Management or by a decree of a Court of Law and/or that the corner points mentioned in lines 3, 4 and 5 above were in conformance with the rules of the Michigan Board of Land Surveyors or by a Decree of a Court of Law, established, re-established, monumented, re-monumented, recovered, found as expressed below:

NOTE: Not more than 2 corners, all in the same town and range, may be recorded on this certificate.

A. Description of original monument and accessories and/or subsequent restoration:

1) CORNER NOT SET IN GLO SURVEY OF 1827.

2) CORNER REFERENCED IN SURVEY BY ANSON JACKSON, CO. SURVEYORS, ON MAR. 5, 1841, RECORDED IN BOOK 4, PAGE 70. NO MENTION OF MONUMENT. WITNESSED BY:

PEPRIDGE 10", S 78 E, 32-1/2 LKS. (21.45')
DO 14", S 4 E, 15 LKS. (9.90')

SURVEY SHOWS A DISTANCE NORTH OF 80 RODS, 4 LKS. (1322.64'), EAST OF 78 RODS, 21 LKS. (1300.86'), SOUTH OF 159 RODS, 11 LKS. (2630.76') AND WEST OF 159 RODS, 2 LKS. (2624.82'). (2640')

3) CORNER REFERENCED IN UNDATED NOTHSTINE NOTES, PAGE 7, ATTRIBUTED TO WM. BARRYMAN, CO. SURVEYOR, AS "ANCHOR POST AT CROSS FENCES." WITNESSED BY:

OAK 3", E, 31.1'
OAK 4", N, 53.3'
OAK 3", WSW, 7.9'

CONTINUED ON PAGE 2:

B. Description of corner evidence found and/or method applied in restoring or reestablishing corner:

SEARCHED AT APPARENT LOCATION OF CORNER AND FOUND A CONCRETE MONUMENT AS PER LCRC OF LIBER 11, PG. 171. (ITEM A-7 ABOVE). CORNER IS THE NORTHEAST CORNER OF LOT 16 (#3754 CALYPSO LANE), OF ASPEN WOODS EAST (LIBER 56, PG. 4). ACCEPTED FOUND MONUMENT AS A PERPETUATION OF JACKSON'S AND BARRYMAN'S CORNER (ITEM'S A-2 & A-3 ABOVE) AND SET A STANDARD INGHAM COUNTY PA 345 CAP #30090 ON TOP OF FOUND MONUMENT. CORNER FALLS ON A FENCELINE NORTH & EAST AND HEAVY TREE ROW TO THE SOUTH, NO VISIBLE OCCUPATION TO THE WEST REMAINS, EXCEPT FOR THE PLAT LINE. TRAVERSED SECTION 13, MEASURED NORTH 2642.87' TO L-5, EAST 2615.32' TO M-6, SOUTH 2648.94' TO L-7 AND WEST 2641.15' TO K-6. CORNER FALLS 2.14' NORTH X 5.28' WEST OF THE INTERSECTION OF TRUE LINES BETWEEN THE OPPOSITE 1/4 CORNERS.

C. Description of monument for corner and accessories established to perpetuate locating the position of the corner:

M-05: T3N, R2W, DELHI TOWNSHIP, INGHAM COUNTY. FOUND CONCRETE MONUMENT AND SET STANDARD INGHAM COUNTY PA 345 CAP #30090. WITNESSED BY:

SET MAG NAIL & REMON TAG, NORTH SIDE 8" ASH, S 81° E, 19.63'
SET MAG NAIL & REMON TAG, SOUTHWEST SIDE 12" ASH, S 30° E, 20.00'
SET MAG NAIL & REMON TAG, WEST SIDE 8" CHERRY, S 12° W, 30.90'
FOUND NAIL & TAG #25837, NORTHWEST SIDE 17" MAPLE, S 48° W, 23.88'
FOUND NAIL & TAG #25837, EAST SIDE 21" ASH, N 05° W, 36.97'

SET MAG NAIL & REMON. TAG IS DEFINED AS A 1/4" X 2-1/2" MAGNETIC ALUMINUM ALLOY NAIL, WITH A 1-1/2" ALUMINUM DISC MARKED "INGHAM PA 345 WITNESS".

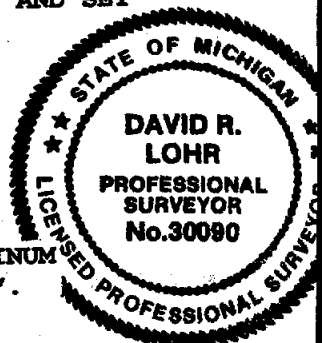

Signed by

David R. Lohr

Date SEPTEMBER 26, 2006

Surveyor's Michigan License No. 30090

FORM APPROVED BY MICHIGAN STATE BOARD OF LAND SURVEYORS, JAN. 1971
REVISED MAY 14, 1975
REVISED JAN., 1983
REVISED OCT, 1986
ADAPTED FOR WORD PROCESSING JAN, 1998

P.A. 345 INGHAM COUNTY
PEER APPROVED 8/29/2006 *ML*

- 4) CORNER REFERENCED IN LCRC BY DOUGLAS K. RICHARDSON, LLS # 31603, DATED 11/08/78 AND SIGNED 2/14/90 AND RECORDED IN LIBER 7, PAGE 172.

PART A STATES: L-6: NOT MONUMENTED IN ORIGINAL GOVERNMENT SURVEY. FOUND 1-1/2" IRON @ BASE OF WOOD ANCHOR POST.

PART B STATES: L-6: FOUND 1-1/2" IRON AT BASE OF WOOD ANCHOR POST AT INTERSECTION OF N-S AND E-W FENCE LINES.

PART C STATES: L-6: (CENTER SECTION 13, T3N, R2W.) FOUND 1-1/2" IRON.
(WITNESSES BY:)

SET NAIL & TAG, WEST SIDE 40" OAK, N 01° E, 3.75'
SET NAIL & TAG, NW SIDE 16" MAPLE, S 20° W, 23.83'
SET NAIL & TAG, NORTH SIDE 20" OAK, N 89° W, 41.35'

- 5) CORNER REFERENCED IN SURVEY BY RICHARD W. STEADMAN, RLS #11370, DATED 11/29/94 AND RECORDED IN LIBER 7, PAGE 668. "CENTER, SEC. 13, T3N, R2W. FOUND 1" IRON ROD."
WITNESSED BY: 20" CHERRY, NORTH, 3.82'

12" ASH, N 50° W, 41.08'

14" MAPLE, S 45° W, 23.45'

NO DISTANCES TO ADJACENT SECTION CORNERS SHOWN.

- 6) CORNER REFERENCED IN FOLLOWING PLATS:

A. "HEARTHSIDE ACRES NO. 3, BY DOUGLAS K. RICHARDSON, LLS #31603, DATED 10/11/93 AND RECORDED IN LIBER 48, PAGE 47.

B. "HEARTHSIDE ACRES NO. 4", BY FRED N. WHITE, LLS #12034, DATED 01/06/95 AND RECORDED IN LIBER 50, PAGE 42.

C. "KELLER RIDGE", BY MARVIN F. FOUTY, RLS #19989, DATED 10/21/98 AND RECORDED IN LIBER 52, PAGE 27.

D. "KELLER RIDGE NO. 2", BY RONALD L. ENGER, PS #28409, DATED 11/21/00 AND RECORDED IN LIBER 54, PAGE 5.

E. "AMENDED HEARTHSIDE ACRES NO. 3", BY MAURICE H. MAHIEU, LPS #28414, DATED 12/22/96 AND RECORDED IN LIBER 54, PAGE 10.

F. "HEARTHSIDE ACRES NO. 5", BY FRED N. WHITE, LLS #12034, DATED 02/25/00 AND RECORDED IN LIBER 54, PAGE 11.

G. "KELLER RIDGE NO. 3", BY RONALD L. ENGER, PS #28409, DATED 02/22/02 AND RECORDED IN LIBER 54, PAGE 44.

H. "ARBORWOOD NO. 1", BY FRED N. WHITE, LLS #12034, DATED 09/15/01 AND RECORDED IN LIBER 54, PAGE 48.

I. "ARBORWOOD NO. 2", BY FRED N. WHITE, LLS #12034, DATED 09/15/01 AND RECORDED IN LIBER 54, PAGE 50.

J. "ARBORWOOD NO. 3", BY FRED N. WHITE, LLS #12034, DATED 09/17/01 AND RECORDED IN LIBER 54, PAGE 52.

K. "ASPEN WOODS", BY FRED N. WHITE, LLS #12034, DATED 11/28/01 AND RECORDED IN LIBER 55, PAGE 2.

L. "ASPEN WOODS EAST", BY FRED N. WHITE, LLS #12034, DATED 08/07/03 AND RECORDED IN LIBER 56, PAGE 4.

M. "KELLER RIDGE NO. 4", BY RONALD L. ENGER, PS #28409, DATED 06/29/04 AND RECORDED IN LIBER 56, PAGE 10.

NO MENTION OF MONUMENT OR WITNESSES GIVEN. PLATS SHOWS A DISTANCE WEST OF 2642.58' AND A DISTANCE NORTH OF 2647.84'.

- 7) CORNER REFERENCED IN LCRC BY DAVID L. CLIFFORD, RLS #25837, DATED 12/15/03 AND AND RECORDED IN LIBER 11, PAGE 171.

PART A STATES: RECITES ITEMS A-1 THRU A-4 ABOVE.

PART B STATES: FIELD INVESTIGATION AT APPARENT LOCATION OF CORNER REVEALED 1" BAR WITH MUSHROOMED HEAD LYING IN BOTTOM OF HOLE CAUSED BY BLOWN OVER 40" OAK. SET CORNER BY EXTENDING 1/4 LINE FROM NORTH 1/4 CORNER THROUGH MONUMENT AT NORTH 1/8 CORNER ON 1/4 LINE TO FENCE LINE TO WEST. THIS LOCATION AGREES WITH WITNESSES FROM LIBER 7 PAGE 172.
SET CONCRETE MONUMENT.

PART C STATES: L-6, T3N, R2W, 36" X 4" CONCRETE MONUMENT. (WITNESSES BY:)

NAIL & TAG 25837, NW SIDE 17" MAPLE, S 55° W, 23.88'
NAIL & TAG 25837, NE SIDE 17" ASH, N 60° W, 40.29'
NAIL & TAG 25837, EAST SIDE 21" ASH, N 7° W, 36.97'
NAIL & TAG 25837, NORTH SIDE 36" DEAD OAK, N 82° W, 41.88'

- 8) NO OTHER REFERENCES FOUND.

RECEIVED

DEC 14 1993

COMMISSION

LAND CORNER RECORDATION CERTIFICATE
Filing Requirement of Act 74, Mich. P.A. 1970

LIBER 8 PAGE 99
FILED

DEC 2 12 21 PM '93

REGISTER OF DEEDS

Dana Johnson
INGHAM COUNTY, MICH.

For corners in

Ingham County	Located in:	Corner Code--#
Delhi Township		
1. Public Land Survey	T <u>3N</u> R <u>2W</u>	<u>L-7</u>
	T _____ R _____	_____
	T _____ R _____	_____
	T _____ R _____	_____
2. Property Controlling in Section	S _____ T _____ R _____	_____
	S _____ T _____ R _____	_____
3. Miscellaneous Property in Sec.	S _____ T _____ R _____	_____
	S _____ T _____ R _____	_____

Register of Deeds Stamp & File Number

4. Lot No. _____ Recorded Plat _____
5. Private Claims _____

I, Richard W. Steadman, in a field survey on October 15, 1993, do hereby certify that under requirements of P.A. 74, Michigan P.A. of 1970, the corner points mentioned in lines 1 and 2 above were in conformance with regulations and rules therefore as required in the current manual of survey instructions of the United States Department of the Interior, Bureau of Land Management or by a decree of a Court of Law and/or that the corner points mentioned in lines 3, 4 and 5 above were in conformance with the rules of the Michigan Board of Land Surveyors or by a Decree of a Court of Law; established, re-established, monumented, re-monumented, recovered, found as expressed below:

NOTE: Not more than 4 corners, all in the same town and range, may be recorded on this certificate.

A. Description of original monument and accessories and/or subsequent restoration:

1. Original Corner set by Musgrove Evans Deputy Surveyor in January 1827
B. Ash 12" S67°W 2 LKS
B. Ash 9" N32°W 17 LKS
2. A. Jackson County Surveyor reported using Corner in January 1841 in Volume 1, page 114, Ingham County Surveyors Records with same witnesses as GLO.

(continued on back)

B. Description of corner evidence found and/or method applied in restoring or reestablishing corner:

Searched area at apparent location of Corner and found L. Bryan's P.K. Nail 50.00' West of 1" Bar in Mon. Box as described in Item #6.
Tied occupation lines at apparent location of 1/16 line and found that they agree with L. Bryan's location of Corner and that distances between apparent 1/16th lines and Corner location agree very closely with T.J. Brown and E.A. Calkin's distances of 1867 and 1900 respectfully. The North-South location of P.K. agrees very closely with Supervisor's Plat #11 of Delhi Township as recorded in Liber 13 of plats, page 32 by Laverne Hendryx RLS in 1942 and Hacker Fruit Farms, a subdivision recorded in Liber 11 of plats, page 36 by E.W. Tappan PE in 1931. Therefore accepted "P.K." as location of Corner and replaced with standard Bar & Cap by drilling hole in concrete surface of Holt Road and setting iron. Corner is on Centerline of Holt Road on Fence & Tree line to North across swamp.

C. Description of monument for corner and accessories established to perpetuate locating the position of the corner:

Standard Ingham County Remonumentation 3/4" x 24" steel Bar & P.A.345 Cap #11370.
North West Cor. Fdn. House #3700, azimuth 83°, 526.08'
Found Nail & Tag #18989 (P.S. Marvin F. Fouty) in North side Power Pole, azimuth 98°, 317.29'
Found Nail & Tag #18989 in South side 24" Maple, azimuth 286°, 172.84'
Found Nail & Tag #18989 in North West side Power Pole, azimuth 148°, 48.65'
Found 1" Bar in Monument Box, azimuth 90°, 50.00'

Signed by Richard W. Steadman
Surveyor's Michigan License No. 11370

Date October 19, 1993

P.A. 345 INGHAM COUNTY
PEER APPROVED 10/28/93 *RL*

2590

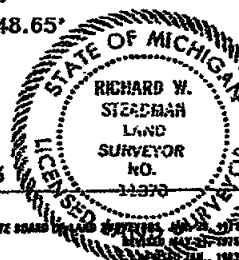

3. T.J. Brown Deputy County Surveyor reported using Corner in December 1867 in Volume 1, page 160, Ingham County Surveyors Records with same witnesses as in Item #1.
4. E. A. Colkins County Surveyor reported using Corner in April 1900 in Volume 5, page 9, Ingham County Surveyors Records with no mention of monument or witnesses.
5. Fred White LS #12037 recorded Corner in April 1972 in Liber 1 If Corners, page 427 as a found MSHD monument box.
P. Pole S75°W 121.81'
P. Pole S65°E 95.87'
6. Larry Bryan LS #25832 recorded Corner in June 1990 in Liber 7 of Corners, page 185 to correct Fred White's location per Item #5 above. Monument box recorded by Fred White is actually for P.I. of Holt Road as per MSDH plans 1-131-65-1 of State Project C5-33-97-C1. L. Bryan set P.K. Nail half way between K-7 and M-7 and on line between K-7 and aforementioned P.I.
Set Nail & Tag Northeast side U. Pole S45°E, 48.62'
Set Nail & Tag South side Utility Pole N80°W, 93.76'
Found 1" Bar in Mon. Box, P.I. of Holt Road, East, 50.00'

LAND CORNER RECORDATION CERTIFICATE
Filing Requirement of Act 74, Mich. P.A. 1970

For corners in
INGHAM

(County)

Located In:

Corner Code #

DELHI TOWNSHIP.

1. Public Land Survey

T 3N R 2W

M-05

B:12 P:305 10/12/06 8:55 AM
2006-051939 LAND CORNERS Receipt #17981
Paula Johnson, Ingham County, Michigan

Page: 3



2. Property Controlling
in Section

S T R

3. Miscellaneous
Property in Sec.

S T R

4. Lot No. Recorded Plat

5. Private Claims

Register of Deeds Stamp & File Number

	A	B	C	D	E	F	G	H	I	J	K	L	M
1													
2	6	5	4	3	2	1							
3													
4	7	8	9	10	11	12							
5													
6	18	17	16	15	14	13							
7													
8	19	20	21	22	23	24							
9													
10	30	29	28	27	26	25							
11													
12	31	32	33	34	35	36							
13													

I, DAVID R. LOHR, P.S., in a field survey on JUNE 08, 2006, do hereby certify that under requirements of P.A. 74, Michigan P.A. of 1970, the corner points mentioned in lines 1 and 2 above were in conformance with regulations and rules therefore as required in the current manual of survey instructions of the United States Department of the Interior, Bureau of Land Management or by a decree of a Court of Law and/or that the corner points mentioned in lines 3, 4 and 5 above were in conformance with the rules of the Michigan Board of Land Surveyors or by a Decree of a Court of Law; established, re-established, monumented, re-monumented, recovered, found as expressed below:

NOTE: Not more than 2 corners, all in the same town and range, may be recorded on this certificate.

A. Description of original monument and accessories and/or subsequent restoration:

- 1) CORNER SET BY MUSGROVE EVANS, DEP. SURVEYORS, IN JAN. 1827. "NORTH ON EAST BOUNDARY OF SEC. 13, SET POST, COR. TO SECS. 12 & 13, FW."

WITNESSED BY:

BEECH 11", S 4 W, 45 LKS. (29.70')

LYNN 14", N 22 W, 5 LKS. (3.30')

GLO NOTES SHOW A DISTANCE NORTH & SOUTH OF 40 CH. (2640')

- 2) CORNER REFERENCED IN SURVEY BY T. J. BROWN, CO. SURVEYOR, DATED JAN. 19, 1854, AND RECORDED IN VOLUM C, PAGE 33. NO MENTION OF MONUMENT. SAME WITNESSES AS ITEM A-1 ABOVE. SURVEY SHOWS A DISTANCE WEST OF 39.12 CH. (2581.92) AND NORTH OF 39.66 CH. (2617.56')

- 3) CORNER REFERENCED IN SURVEY BY E.A. CALKINS, CO. SURVEYOR, DATED AUG. 26, 1901 AND RECORDED ON PAGE 174 OF MISC. SURVEYORS FIELDBOOK AS "LARGE STONE @ CORNER, MADE "X" MARK, F.W." WITNESSED BY: ELM 16", N 1/2° W, 76 LKS. (50.16')

APPLE 10", N 25-1/2° W, 85 LKS. (56.10')

NOTES SHOW A DISTANCE WEST OF 39.40 CH. (2600.40') AND NORTH OF 19.92 CH. (1314.72') (SAME AS ITEM A-4 BELOW)

CONTINUED ON BACK

B. Description of corner evidence found and/or method applied in restoring or reestablishing corner:

SEARCHED AT APPARENT LOCATION OF CORNER AND FOUND 1/2" REBAR IN CONCRETE MONUMENT AS PER ITEM A-8 ABOVE. CONCRETE MONUMENT WAS SET IN A CONCRETE COLLAR WHICH WAS FOUND TO BE IN EXCELLENT CONDITION BUT 3" BELOW ROAD GRADE. CUT TOP 3" OFF REBAR AND RAISED MONUMENT BOX TO GRADE WITH 2 RISER RINGS. ACCEPTED POSITION OF FOUND CONCRETE MONUMENT AS CORNER AND SET A STANDARD INGHAM COUNTY PA 345 CAP #30090 ON IT. TRAVERSED SECTION 13, MEASURED SOUTH 2642.67' TO M-6 AND WEST 2604.31' TO L-5.

C. Description of monument for corner and accessories established to perpetuate locating the position of the corner:

M-05: T3N, R2W, DELHI TOWNSHIP, INGHAM COUNTY. FOUND CONCRETE MONUMENT IN MON. BOX. AND SET A STANDARD INGHAM COUNTY PA 345 CAP #30090 ON IT. WITNESSED BY:

SET MAG NAIL & REMON TAG, NORTH SIDE POWER POLE, N 89° E, 66.68'

FOUND NAIL & TAG #18998, NORTH SIDE 30" ELM, S 75° E, 53.76'

SET MAG NAIL & REMON TAG, NORTHWEST SIDE POWER POLE, N 42° E, 118.40'

SET MAG NAIL & REMON TAG, SOUTHWEST SIDE POWER POLE, N 32° W, 58.30'

FOUND MAG NAIL, A-5, T3N, R1W, DUE NORTH, 39.38'

SET MAG NAIL & REMON TAG IS DEFINED AS A 1/4" X 2-1/2" MAGNETIC ALUMINUM ALLOY NAIL, WITH A 1-1/2" ALUMINUM DISC MARKED "INGHAM PA 345 WITNESS".



Signed by

David R. Lohr

Date

SEPTEMBER 26, 2006

Surveyor's Michigan License No. 30090

FORM APPROVED BY MICHIGAN STATE BOARD OF LAND SURVEYORS, JAN. 1971
REVISED MAY 14, 1976
REVISED JAN. 1983
REVISED OCT. 1996
ADAPTED FOR WORD PROCESSING JAN. 1999

P.A. 345 INGHAM COUNTY
PEER APPROVED 6/20/2006

- 4) CORNER REFERENCED IN SURVEY BY E. A. CALKINS, CO. SURVEYOR, DATED JULY 30, 1901, AND RECORDED IN FOLDER #1, PAGE 24. "OLD STONE MARKED WITH A CROSS. NO WITNESSES GIVEN. SURVEY SHOWS A DISTANCE WEST OF 39.40 CH. (2600.40').
- 5) CORNER REFERENCED IN SURVEY BY E. A. CALKINS, CO. SURVEYOR, DATED AUG. 26, 1901, AND RECORDED IN VOLUMN 5, PAGE 21. "OLD STONE MARKED WITH A CROSS. NO WITNESSES GIVEN. SURVEY SHOWS A DISTANCE WEST OF 39.40 CH. (2600.40').
- 6) CORNER REFERENCED IN UNDATED NOTHSTINE NOTES, PAGE 7, ATTRIBUTED TO WM. BARRYMAN, CO. SURVEYOR, AS "STONE WITH CROSS, REPLACED WITH IRON." WITNESSED BY:
- | | |
|----------------------|--------|
| 18" TWIN WALNUT, SW, | 39.8' |
| 18" WALNUT, NE, | 72.1' |
| 24" CHERRY, E, | 132.5' |
- GIVEN. SURVEY SHOWS A DISTANCE WEST OF 39.40 CH. (2600.40').
- 7) CORNER REFERENCED IN MDOT FORM 280 CARD, BY C.E. SMITH, DATED OCT. 1963 AS "FOUND 1/2" IRON FOR NORTH EAST SECTION CORNER OF SECTION 13, DELHI TWP., INGHAM COUNTY. IN CENTER OF COLLEGE & WILLOUGHBY ROAD WEST." WITNESSED BY:
- | | |
|-----------------------------|-------|
| U.S.G.S. BM, S 25 W, | 40.9' |
| ROAD SIGN, S 55 W, | 42.2' |
| 13" TREE OF HEAVEN, S 70 E, | 97.63 |
- REAR OF CARD SHOWS A DISTANCE NORTH TO A-5, T3N, R1W, OF 39.60'.
- 8) CORNER REFERENCED IN LCRC BY RONNIE M. LESTER, RLS # 18998, DATED 07/24/79 AND RECORDED IN LIBER 5, PAGE 348.
- PART A STATES: M-5: RECITES ITEMS A-1 THRU A-6 ABOVE.
- PART B STATES: M-5: EXCAVATED A HOLE 5' X 5' TO AN AVERAGE DEPTH OF 2.5' AT THE INTERSECTION OF THE CENTERLINES OF COLLEGE ROAD AND WILLOUGHBY ROAD WEST. FOUND 1/2" IRON AT ROAD SURFACE AT THE INTERSECTION OF THE CENTERLINES OF COLLEGE ROAD AND WILLOUGHBY ROAD WEST. FOUND 3/4" BAR DIRECTLY BELOW 1/2" IRON AND A 1" PIPE DIRECTLY BELOW 3/4" BAR. AFTER FURTHER EXCAVATION BELOW 1" PIPE, FOUND A POINTED 1" STEEL ROD WITH WOODEN STAKE BESIDE AND SURROUNDED BY YELLOW AND RED BRICK. ACCEPTED 1" STEEL ROD FOR CORNER AS CALLED FOR IN THE RECORDS ATTRIBUTED TO WM. BARRYMAN, CO. SURVEYOR. MEASURED NORTH +/-2635' TO M-4 AND SOUTH +/-2642' TO M-6.
- PART C STATES: M-5: SE CORNER, SECTION 12, T3N, R2W. SET 4" X 36" CONCRETE MONUMENT WITH 1/2" X 38" REROD AND CAP #18998 WITH CONCRETE COLLAR AND COVER IN LOCATION OF 1" POINTED STEEL BAR DESCRIBED ABOVE: (WITNESSES BY:)
- | | |
|---|---------|
| NAIL & TAG, #18998, EAST SIDE 30" WALNUT, NNE, | 71.40' |
| NAIL & TAG, #18998, WEST SIDE POWER POLE, NE, | 118.92' |
| NAIL & TAG, #18998, NORTH SIDE 10" ELM, ESE, | 53.41' |
| NAIL & TAG, #18998, WEST SIDE POWER POLE, NNW, | 86.42' |
| PINCH PIPE, A-5 ALAIEDON TWP., T3N, R1W, NORTH, | 39.25' |
- 9) CORNER REFERENCED IN SURVEY BY AUSTIN C. WILLIAMS, RLS #21275, DATED AUG. 1979 AND RECORDED IN LIBER 3, PAGE 1072. NO MENTION OF MONUMENT. SAME WITNESSES AS IN ITEM A-7 ABOVE. NO DISTANCES TO ADJACENT SECTION CORNERS GIVEN.
- 10) CORNER REFERENCED IN SURVEY BY MAYNARD R. DYER, RLS #21565, DATED 12/03/80 AND RECORDED IN LIBER 4, PAGE 193. "FOUND CONCRETE MONUMENT IN CONC. COLLAR AS RECORDED IN LIBER 5, PG. 348. SAME WITNESSES AS IN ITEM A-7 ABOVE. SURVEY SHOWS A DISTANCE NORTH OF 2634.97'.
- 11) CORNER REFERENCED IN SURVEY BY MARVIN F. FOUTY, RLS #18989, DATED 01/02/87 AND RECORDED IN LIBER 5, PAGE 254. NO MENTION OF MONUMENT OR WITNESSES GIVEN. SURVEY SHOWS A DISTANCE NORTH OF 2635.02' AND WEST OF 2604.35'.
- 12) CORNER REFERENCED IN PLAT OF "COLLEGE HEIGHTS ESTATES" BY LARRY D. STEPHENS, PE #19365, DATED 04/01/88 AND RECORDED IN LIBER 43, PAGE 37. NO MENTION OF MONUMENT OR WITNESSES GIVEN. PLAT SHOWS A DISTANCE WEST OF 2604.35'.
- 13) CORNER REFERENCED IN SURVEY BY MARVIN F. FOUTY, RLS #18989, DATED 08/01/88 AND RECORDED IN LIBER 5, PAGE 588. NO MENTION OF MONUMENT OR WITNESSES GIVEN. SURVEY SHOWS A DISTANCE WEST OF 2604.35'.

14) CORNER REFERENCED IN SURVEY BY RON HELSEL, RLS #18994, DATED 03/01/93 AND RECORDED IN LIBER 7, PAGE 14. "FOUND 1/21/2" IRON ROD (NO CAP) IN MONUMENT BOX 0.9' EAST OF C/L COLLEGE ROAD AND 7.0' SOUTH OF WILLOUGHBY ROAD TO THE WEST.

WITNESSED BY: FD. N & T ON NORTH SIDE 18" ELM, S 80° E, 53.70'

FD. N & T ON NORTH SIDE UTILITY POLE, N 86° E, 66.83'

FD. N & T ON SE SIDE UTILITY POLE, N 40° E, 118.95'

FD. N & T ON WEST SIDE UTILITY POLE, N 17° W, 86.53'

NO DISTANCES GIVEN TO ADJACENT SECTION CORNERS.

15) CORNER REFERENCED IN FOLLOWING PLATS:

A. "COLLEGE HEIGHTS ESTATES III", BY RON HELSEL, RLS #18994, DATED 12/21/93 AND RECORDED IN LIBER 48, PAGE 41.

B. "COLLEGE HEIGHTS ESTATES IV", BY TERRY L. WEIGMAN, ILS #39100, DATED 10/30/95 AND RECORDED IN LIBER 50, PAGE 14.

C. "COLLEGE HEIGHTS ESTATES V", BY JAMES E. STEPHENS, PS #16053, DATED 10/21/96 AND RECORDED IN LIBER 51, PAGE 32.

D. "COLLEGE HEIGHTS ESTATES VI", BY JAMES E. STEPHENS, PS #16053, DATED 10/21/96 AND RECORDED IN LIBER 52, PAGE 25.

NO MENTION OF MONUMENT OR WITNESSES GIVEN. PLATS SHOWS A DISTANCE WEST OF 2604.35'.

16) NO OTHER REFERENCES FOUND.

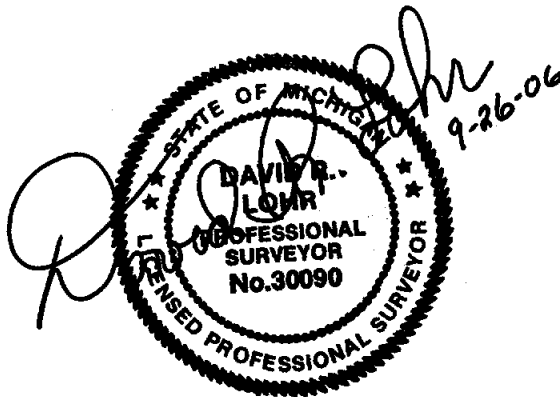

P.A. 345 INGHAM COUNTY
PEER APPROVED 6/20/2006

LAND CORNER RECORDATION CERTIFICATE
Filing Requirement of Act 74, Mich. P.A. 1970

For corners in
INGHAM
(County)

Located In:

Corner Code #

DELHI TOWNSHIP.

1. Public Land Survey

T 3N R 2W
T R
T R
T R
S T R
S T R
S T R
S T R

M-06

B:12 P:307 10/12/06 8:55 AM
2006-051941 LAND CORNERS Receipt #17981
Paula Johnson, Ingham County, Michigan

Page: 2



2. Property Controlling

in Section

3. Miscellaneous

Property in Sec.

4. Lot No.

Recorded Plat

5. Private Claims

Register of Deeds Stamp & File Number

	A	B	C	D	E	F	G	H	I	J	K	L	M
1													
2	6	5	4	3	2	1							
3													
4	7	8	9	10	11	12							
5													
6	18	17	16	15	14	13							
7													
8	19	20	21	22	23	24							
9													
10	30	29	28	27	26	25							
11													
12	31	32	33	34	35	36							
13													

I, DAVID R. LOHR, P.S., in a field survey on JUNE 08, 2006, do hereby certify that under requirements of P.A. 74, Michigan P.A. of 1970, the corner points mentioned in lines 1 and 2 above were in conformance with regulations and rules therefore as required in the current manual of survey instructions of the United States Department of the Interior, Bureau of Land Management or by a decree of a Court of Law and/or that the corner points mentioned in lines 3, 4 and 5 above were in conformance with the rules of the Michigan Board of Land Surveyors or by a Decree of a Court of Law; established, re-established, monumented, re-monumented, recovered, found as expressed below:

NOTE: Not more than 2 corners, all in the same town and range, may be recorded on this certificate.

A. Description of original monument and accessories and/or subsequent restoration:

1) CORNER SET BY MUSGROVE EVANS, DEP. SURVEYORS, IN JAN. 1827. "NORTH ON EAST BOUNDARY OF SEC. 13, SET 1/4 SEC. POST." WITNESSED BY:

BEECH 15", S 29 W, 32 LKS. (21.12')

LYNN 34", N 10 W, 22 LKS. (14.52')

GLO NOTES SHOW A DISTANCE NORTH & SOUTH OF 40 CH. (2640')

2) NO REFERENCES FOUND IN COUNTY SURVEYORS RECORDS.

CONTINUED ON PAGE 2:

B. Description of corner evidence found and/or method applied in restoring or reestablishing corner:

SEARCHED AT APPARENT LOCATION OF CORNER AND FOUND 1-1/8" X 36" SQUARE STEEL BAR, 8" DEEP, 1 FT. EAST OF C/L COLLEGE ROAD AND ON FENCELINE TO THE WEST. EXCAVATED TO FIND SQUARE BAR WAS SET OVER A 1" PIPE SURROUNDED BY ROCKS AT DEPTH OF 38". CORNER FALLS IN A FILL AREA OF ABOUT 2 FT. ACCEPTED FOUND PIPE AND STEEL BAR AS CORNER SET A STANDARD INGHAM COUNTY BAR & PA 345 CAP #30090 IN A NEW MON. BOX. TRAVERSED SECTION 13, MEASURED NORTH 2642.67' TO M-5, SOUTH 2650.81' TO M-7 AND WEST 2615.31' TO L-6.

C. Description of monument for corner and accessories established to perpetuate locating the position of the corner:

M-06: T3N, R2W, DELHI TOWNSHIP, INGHAM COUNTY. FOUND PIPE AND STEEL BAR AND SET STANDARD INGHAM COUNTY REMON. BAR & PA 345 CAP #30090. WITNESSED BY:

SET MAG NAIL & REMON TAG, NORTHWEST SIDE POWER POLE, N 30° E, 115.20'

SET MAG NAIL & REMON TAG, NORTHWEST SIDE 14" PINE, N 47° E, 47.75'

FOUND MAG NAIL, EAST SIDE 10" ASH, N 09° W, 125.40'

FOUND MAG NAIL, EAST SIDE 4" ASH, S 51° W, 37.99'

FOUND BAR & CAP #18998 IN MON. BOX, A-6, T3N, R1W, DUE NORTH, 28.53'

SET MAG NAIL & REMON. TAG IS DEFINED AS A 1/4" X 2-1/2" MAGNETIC ALUMINUM ALLOY NAIL, WITH A 1-1/2" ALUMINUM DISC MARKED "INGHAM PA 345 WITNESS".

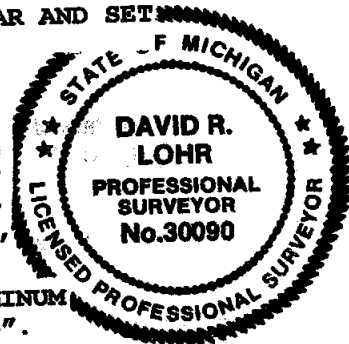

Signed by

David R. Lohr

Date

SEPTEMBER 26, 2006

Surveyor's Michigan License No.

30090

FORM APPROVED BY MICHIGAN STATE BOARD OF LAND SURVEYORS, JAN. 1971
REVISED MAY 14, 1975
REVISED JAN., 1983
REVISED OCT., 1985
ADAPTED FOR WORD PROCESSING JAN., 1995

P.A. 345 INGHAM COUNTY
PEER APPROVED 6/20/2006 *m*

- 2) CORNER REFERENCED IN UNDATED INGHAM COUNTY ROAD COMMISSION GRID MAP AS "POINTED STONE (1949)." WITNESSED BY:
- | | | |
|--------------|------|-------|
| 30" ELM, | W, | 23.5' |
| 1-1/2" IRON, | E, | 33.0' |
| 10" ELM, | SE, | 74.8' |
| 10" ELM, | ESE, | 29.9' |
- 3) CORNER REFERENCED IN PLAT OF "COLLEGE ROAD MANOR" BY LAVERN J. HENDRYXS, RLS #3276, DATED 11/10/53 AND RECORDED IN LIBER 17, PAGE 18. NO MENTION OF MONUMENT OR WITNESSES GIVEN. NO DISTANCES TO ADJACENT SECTION CORNERS GIVEN.
- 4) CORNER REFERENCED IN LCRC BY MARVIN F. FOUTY, RLS # 18989, DATED 04/14/75 AND RECORDED IN LIBER 3, PAGE 379.
- PART A STATES: M-6: ORIGINAL MONUMENT AND ACCESSORIES OBLITERATED.
- PART B STATES: M-6: FOUND 1" SQUARE BAR IN THE CENTERLINE OF COLLEGE ROAD IN ACCORD WITH THE PLAT OF "COLLEGE ROAD MANOR" AS RECORDED IN LIBER 17 OF PLATS, PAGE 18.
- PART C STATES: M-6: E 1/4 CORNER, SECTION 13, T3N, R2W. 1" SQUARE BAR.
- (WITNESSES BY:)
- | | | |
|--------------------------------|-------|--------|
| NAIL & TAG IN 4" SQUARE POST, | WEST, | 33.58' |
| NAIL & TAG IN N. SIDE 10" ELM, | ESE, | 44.73' |
| NAIL & TAG IN S. SIDE 8" ELM, | NE, | 58.70' |
- 5) CORNER REFERENCED IN SURVEY BY MARVIN F. FOUTY, RLS #18989, DATED 04/18/75 AND RECORDED IN LIBER 2, PAGE 350. NO MENTION OF MONUMENT, SAME WITNESSES AS IN ITEM A-3 ABOVE. SURVEY SHOWS A DISTANCE WEST OF 2581.24'.
- 6) NO OTHER REFERENCES FOUND.

SURVEY &
RECORDATION

DEC 14 1993

LIBER 8 PAGE 79
FILED

COMMISSION

LAND CORNER RECORDATION CERTIFICATE
Filing Requirement of Act 74, Mich. P.A. 1970

DEC 2 12 18 PM '93

For corners in

INGHAM

Located in:

Corner Code #

DELHI TOWNSHIP

1. Public Land Survey

T 3N R 2W

M-7

T R

T R

T R

T R

2. Property Controlling
in Section

S T R

S T R

3. Miscellaneous
Property in Sec.

S T R

S T R

REGISTER OF DEEDS

INCHAM COUNTY, MICH.

Register of Deeds Stamp & File Number

4. Lot No. , Recorded Plat
5. Private Claims

I, R.W. Steadman, in a field survey on September 10, 1993, do hereby certify that under requirements of P.A. 74, Michigan P.A. of 1970, the corner points mentioned in lines 1 and 2 above were in conformance with regulations and rules theretofore as required in the current manual of survey instructions of the United States Department of the Interior, Bureau of Land Management or by a decree of a Court of Law and/or that the corner points mentioned in lines 3, 4 and 5 above were in conformance with the rules of the Michigan Board of Land Surveyors or by a Decree of a Court of Law, established, re-established, monumented, re-monumented, recovered, found as expressed below:

NOTE: Not more than 4 corners, all in the same town and range, may be recorded on this certificate.

A. Description of original monument and accessories and/or subsequent restoration:

1. Original Post Set by Lucius Lyon D.S. in Jan 1825
Beech 11 S28°W 65
Sugar 14 N37W 11
GLO Notes for A-7 Alaledon call for intersecting Township
line 38 Links (25.08) North of Post

2. A. Jackson used corner in a Survey dated in Mar. 1841
recorded in Vol 1 page 69 with no mention of monument
or witnesses

(OVER)

B. Description of corner evidence found and/or method applied in restoring or reestablishing corner:

Searched apparent area of corner and found 1" bar in Monument box matching all of Surveyor Fouty's witnesses. Could not remove bar to excavate. Probed bottom of box and hit what is definitely a stone at 3.5'. Accepted 1" bar on top of stone as corner.

Field Work performed by Dave Clifford PS # 25837

C. Description of monument for corner and accessories established to perpetuate locating the position of the corner:

1" Solid Steel Bar in Monument box on centerline Holt and College Roads

Found Nail and Tag # 18998 (R. Lester) in S.E. Side Util. Pole Az. 143° 68.80'

Found Nail and tag # 28414 (M. Mahieu) in W. Side Util Pole Az 19° 83.10'

S.W. Corner Angle Iron Fence Post Az 150° 90.10'

3/4 Bar in Mon. Box Az 0° 25.15'

Set nail and tag #25837 in S.E. side power pole Az. 24° 59.70'

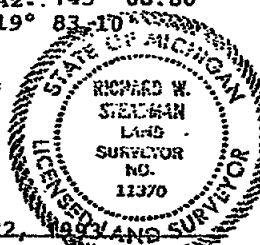

Signed by Richard W. Steadman Date NOVEMBER 22,

Surveyor's Michigan License No. 11370

P.A. 345 INGHAM COUNTY
PEER APPROVED 11/23/1993 14

2580

FORM APPROVED BY MICHIGAN STATE BOARD OF LAND SURVEYORS, JAN. 26, 1971
REVISED MAY 14, 1975
REVISED JAN., 1983

3. T.J. Brown Dep. County Surveyor used corner in a Survey dated Aug. 1844 recorded in Vol C page 5 Co. Surveyors Records with no mention of monument or witnesses.
4. T.J. Brown Deputy Co. Surveyor-used corner in a survey dated Dec. 1867 with no mention of monument or witnesses.
5. Nothstine Notes-so called-M.Berryman's (former County Surveyor) personal records call for a stone iron shaft on top.
6. C.E. Smith MDSH Party Chief witnessed corner in 1963.
T.P. S60W 66.95'
P.P. N15E 81.45'
T.P. S60E 109.07'
7. Marv Fouty LS#18989 recorded corner in May 1975 in Liber 3 of corners page 379 as a found 1" Bar in Monument box from witnesses supplied by MDSH.
Iron Bar in Monument box from witnesses supplied by MDSH
Iron Bar in Monument box N. 25.08' SW Corner. Sec 18, T3N, R1W
Nail and cap in Telephone pole SW 68.50'
Nail and cap in Power Pole NE 83.20'.