

LAND CORNER RECORDATION CERTIFICATE
Filing Requirement of Act 74, Mich. P.A. 1970

Liber

9 Page 219

FILED

For corners in

INGHAM

(County)

Located In:

Corner Code #

INGHAM TOWNSHIP
1. Public Land Survey

T	2N	R	1E	1-12
T		R		
T		R		
T		R		
T		R		
S		T	R	
S		T	R	
S		T	R	
S		T	R	

2. Property Controlling
in Section

3. Miscellaneous
Property in Sec.

970036978
09/26/1997 08:23:20
REGISTER OF DEEDS
Paula Johnson
INGHAM COUNTY, MI

Register of Deeds Stamp & File Number

4. Lot No. _____, Recorded Plat _____
5. Private Claims _____

I, DAVID R. LOHR, in a field survey on 3/25, 1997 do hereby state that under requirements of P.A. 74, Michigan P.A. of 1970, the corner points mentioned in lines 1 and 2 above were in conformance with regulations and rules therefore as required in the current manual of survey instructions of the United States Department of the Interior, Bureau of Land Management or by a decree of a Court of Law and for that the corner points mentioned in lines 3, 4 and 5 above were in conformance with the rules of the Michigan Board of Land Surveyors or by a Decree of a Court of Law; established, re-established, monumented, recovered, found as expressed below:

NOTE: Not more than 2 corners, all in the same town and range, may be recorded on this certificate.

	A	B	C	D	E	F	G	H	I	J	K	L	M
1													
2		6		5		4		3		2		1	
3													
4		7		8		9		10		11		12	
5													
6		18		17		16		15		14		13	
7													
8		19		20		21		22		23		24	
9													
10		30		29		28		27		26		25	
11													
12		31		32		33		34		35		36	
13													

A. Description of original monument and accessories and/or subsequent restoration:

L-11: 1. CORNER SET BY JOSEPH WAMPLER IN FEB. 1826. "SET QUARTER POST AT AVERAGE FROM WHICH" WITNESSED BY:

TAM 10 N 21 W 28 LKS (18.48')

TAM 9 S 21 W 31 1/2 LKS (20.79')

NOTES SHOW DISTANCE EAST & WEST EQUALS 40.15 CH. (2649.90')

CONTINUED ON BACK

B. Description of corner evidence found and/or method applied in restoring or reestablishing corner:

L-11: SEARCHED AT APPARENT LOCATION OF CORNER AND FOUND 1/2" OFFSET IRON IN STONES AS PER ITEM #A-5. ALSO FOUND SURVEYOR HANES IRON IN STONES AS PER ITEM A-7, 41.05 FEET SOUTH OF OFFSET IRON. ALSO FOUND STONES WITH POST REMAINS ON FENCE TO WEST, 14 FT. NORTH OF HANES IRON. TRAVERSED SECTION 36 AND FOUND HANES IRON TO BE 0.5 FT. NORTH OF TRUE EAST-WEST SECTION LINE. ACCEPTED SURVEYOR HANES CORNER LOCATION BASED ON REVIEW OF TRAVERSE DATA. SET 3/4" X 24" STANDARD REMON. BAR AND PA 345 CAP #30090 IN LOCATION OF HANES 1/2" IRON. MEASURED EAST 2686.87 TO M-11, WEST 2662.64 TO K-11, AND SOUTH 2638.84 TO L-12.

C. Description of monument for corner and accessories established to perpetuate locating the position of the corner:

L-11: SET 3/4" X 24" REMON. BAR/CAP IN STONES, AT LOCATION OF HANES IRON, 29 FT. SOUTH OF OPEN DITCH.

WITNESSED BY:

TRAV. PT. IN1-42-136, 1/2" IRON, AZ. 17-20-50, 440.74'

FD. 1/2" IRON, CAP #25832(BRYAN), NORTH, 41.05'

FD. N&T #28414, E/S 8" CHERRY, NORTH, 52.45'

SET N&T #30090, E/S 6" CHERRY, NORTH, 14.55'

SET N&T #30090, W/S 14" ELM, SOUTH, 3.89'

SET N&T #30090, W/S 12" CHERRY, SOUTH, 18.83'

Signed by

David R. Lohr

Date

9-25-97

Surveyor's Michigan License No. 30090

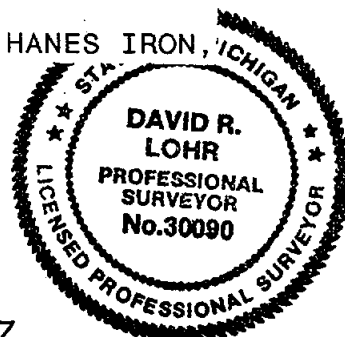

P.A. 345 INGHAM COUNTY
PEER APPROVED 9/25/97 ML

L-11: INGHAM TOWNSHIP, PART A - CONTINUED

2. A. JACKSON, COUNTY SURVEYOR IN AN 1840 SURVEY RECORDED IN BOOK 4, PAGE 138. NO REFERENCE TO MONUMENT, SAME WITNESSES AS ABOVE. SURVEY SHOWS A DISTANCE WEST TO NORTH 1/8 CORNER OF 80R-12 LKS. (1327.92'), AND A DISTANCE SOUTH TO L-12 OF 160R, (2640').
3. W.H. RAYNER, COUNTY SURVEYOR IN AN 1868 SURVEY (IN SECTION 25) RECORDED IN FOLDER. 1, PAGE 58, (1979 CETA REMON. DOSSIER) NO REFERENCE MADE TO MONUMENT, WITNESSED BY : TAM 1 N 82 1/4 W 16 1/2 LKS (10.89')
TAM 1 N 61 1/2 E 16 3/4 LKS (11.06')
4. NO REFERENCE MADE ON INGHAM COUNTY GRID MAP, DATED JAN. 1969.
5. SURVEY #80-B-520, BY LARRY BRYAN, PS #25832, DATED 11/20/80, RECORDED IN LIBER 7, PAGE 480, STATES: "NORTH 1/4 CORNER, SECTION 36, T2N, R1E, CORNER FALLS IN CENTERLINE OF DITCH ON NORTH-SOUTH FENCE LINE, SET REFERENCE IRON AT (AT) ANCHOR POST - NORTH 12.00 FEET; WITNESSES TO REFERENCE IRON." WITNESSED BY: SET NAIL & TAG 8" ASH, N45W, 16.48'
SET NAIL & TAG 4" ELM, N30W, 48.52'
SURVEY SHOWS A DISTANCE SOUTH TO L-12 OF 2667.74'. REVIEW OF TRAVERSE CALCULATION SHEET SHOWS A DISTANCE EAST TO M-11 OF 2684.60' AND A DISTANCE WEST TO K-11 OF 2667.12
6. LCRC BY LARRY BRYAN, PS #25832, DATED 12/01/80, RECORDED IN LIBER 6, PAGE 235, STATES: "ORIGINAL MONUMENT AND ACCESSORIES OBLITERATED... FOUND NO EVIDENCE OF SURVEYOR RESTORATION OF CORNER, DESTROYED IN CONSTRUCTION OF DRAIN. SET CORNER IN CENTERLINE OF DRAIN ON NORTH LINE SECTION IN CLOSE ACCORD WOTH G.L.O. DISTANCES...NORTH 1/4 CORNER, SECTION 36, CORNER FALLS IN CENTERLINE OF DITCH ON NORTH-SOUTH FENCE LINE, SET REFERENCE IRON 12.0' NORTH, WITNESSES TO REFERENCE IRON."
WITNESSED BY: SET NAIL & TAG 8" ASH, N45W, 16.48'
SET NAIL & TAG 4" ELM, N30W, 48.52'
7. SURVEY #84111, BY HATHAWAY J. HANES, RLS #5260, DATED 10/30/84, RECORDED IN LIBER 4, PG. 962, STATES: "NORTH 1/4 POST, SEC.36, T2N, R1E, PLACED 1/2" REBAR WITH CAP." WITNESSEED BY: 1/2" IRON, NORTH, 41.05'
P.K. NAIL IN 10" ELM, SOUTH, 4.15'
P.K. NAIL IN 12" ELM, S 15 E, 23.05'
SURVEY SHOWS DISTANCE SOUTH TO L-12 OF 2638.70', AND A DISTANCE WEST TO K-11 OF 2663.92'.
8. SURVEY #94-0567, BY MAURICE H. MAHIEU, PS #28414, DATED 05/18/94, RECORDED IN LIBER 7, PAGE 323, STATES: "SOUTH 1/4 CORNER, SECTION 25, T2N, R1E, ... REFERENCE IRON TO: SOUTH 1/4 CORNER, SECTION 25, T2N, R1E, INGHAM TOWNSHIP, INGHAM COUNTY, MICHIGAN, FOUND 1/2" IRON ROD IN N-S FENCE LINE AS RECORDED BY L. BRYAN. WITNESSED BY: N&T #28414 NE/S 8" CHERRY, N35W, 16.60'
N&T #28414 E/S 8" CHERRY, N10W, 15.90'
N&T #28414 E/S 6" CHERRY, N15W, 14.85'
N&T #28414 E/S 8" CHERRY, NORTH, 11.40'
9. NO OTHER REFERENCES FOUND.

LAND CORNER RECORDATION CERTIFICATE
Filing Requirement of Act 74, Mich. P.A. 1970

Liber 9 Page 221

For corners in

INGHAM

(County)

INGHAM TOWNSHIP
1. Public Land Survey

Located In:

Corner Code #

T 2N R 1E 1-12
T R
T R
T R
S T R
S T R
S T R
S T R

2. Property Controlling
in Section

3. Miscellaneous
Property in Sec.

FILED

970036979
09/26/1997 08:23:24
REGISTER OF DEEDS
Paula Johnson
INGHAM COUNTY, MI

Register of Deeds Stamp & File Number

4. Lot No. , Recorded Plat
5. Private Claims

I, DAVID R. LOHR, in a field survey on 3/28, 19 97 do hereby state that under requirements of P.A. 74, Michigan P.A. of 1970, the corner points mentioned in lines 1 and 2 above were in conformance with regulations and rules therefore as required in the current manual of survey instructions of the United States Department of the Interior, Bureau of Land Management or by a decree of a Court of Law and/or that the corner points mentioned in lines 3, 4 and 5 above were in conformance with the rules of the Michigan Board of Land Surveyors or by a Decree of a Court of Law; established, re-established, monumented, recovered, found as expressed below:

NOTE: Not more than 2 corners, all in the same town and range, may be recorded on this certificate.

	A	B	C	D	E	F	G	H	I	J	K	L	M
1													
2	6			5		4		3		2		1	
3													
4	7			8		9		10		11		12	
5													
6	18			17		16		15		14		13	
7													
8	19			20		21		22		23		24	
9													
10	30			29		28		27		26		25	
11													
12	31			32		33		34		35		36	
13													

A. Description of original monument and accessories and/or subsequent restoration:

L-12: 1. POST NOT SET IN ORIGINAL GOVERNMENT SURVEY.

2. A. JACKSON, CO. SURVEYOR IN AN 1840 SURVEY RECORDED IN BOOK 4, PAGE 138 (OLD VOL. 1, PG. 142). NO REFERENCE TO MONUMENT,

WITNESSED BY: PEPPERAGE, 10", S 34 W 58 LKS (38.28')
MAPLE, 14", S 6 1/2 W, 63 LKS (41.58')

SURVEY SHOWS DISTANCE WEST TO K-12 OF 160R-18 LKS. (2651.88'), A DISTANCE SOUTH TO L-13 OF 160R-9.5 LKS, (2646.27'), A DISTANCE NORTH TO L-11 OF 160 R (2640.00'), AND A DISTANCE EAST TO THE 1/8 CORNER OF 80R-16LKS. (1330.56')

B. Description of corner evidence found and/or method applied in restoring or reestablishing corner:

L-12: SEARCHED AT APPARENT LOCATION OF CORNER AND FOUND CONCRETE MONUMENT AS PER SURVEYOR BRYAN IN ITEM #7. COULD NOT FIND BOSS'S 1/2" IRON AT 47.37' WEST AS PER ITEM #6. THIS POSITION IS OCCUPIED BY THE REMAINS OF AN ANCHOR POST WITH FENCES TO THE NORTH AND WEST. TRAVERSED SECTION 36 AND DETERMINED MONUMENT TO BE WITHIN 0.62' OF CALCULATED INTERSECTION OF 1/4 LINES. ACCEPTED MONUMENT AS CORNER BASED ON TESTIMONY OF SURVEYOR BRYAN AND REVIEW OF TRAVERSE COMPUTATIONS. SET PA 345 CAP #30090 ON MONUMENT IRON. Measured 2638.84' North, 2659.25' East, 2641.84' South and 2668.40' West.

C. Description of monument for corner and accessories established to perpetuate locating the position of the corner:

L-12: CONCRETE MONUMENT WITH PA 345 CAP #30090 47.37 FT. EAST OF FENCE CORNER REMAINS.

WITNESSED BY:
SET N&T #30090, W/S 6" ASH, AZ. 00 DEG, 40.45'
FD. N&T #25832, W/S 12" ASH, AZ. 60 DEG, 24.85'
SET N&T #30090, SW/S 10" ASH, AZ. 142 DEG, 17.73'
SET N&T #30090, W/S 10" ASH, AZ. 195 DEG, 5.62'
SET N&T #30090, SW/S 12" ASH, AZ. 315 DEG, 21.85'

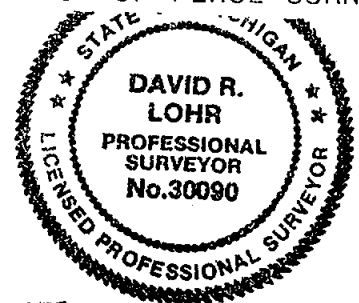

Signed by

David R. Lohr

Date

9-25-97

Surveyor's Michigan License No. 30090

P.A. 345 INGHAM COUNTY
PEER APPROVED 9/25/97 AL

L-12: INGHAM TOWNSHIP, PART A - CONTINUED

3. MARGINAL NOTE ON SAME PAGE BY F.G. LEE, DEP. SURVEYOR, DATED OCT. 28, 1844, NO MENTION OF MONUMENT, WITNESSES BY SAME AS ITEM A-2:
4. W.H. RAYNER, CO. SURVEYOR IN AN 1865 SURVEY RECORDED IN MISC. FIELD BOOK FOR INGHAM TOWNSHIP. NO REFERENCE TO MONUMENT,
WITNESSED BY: PEPPERAGE, 12", S 65 W, 56 LKS (36.96')
5. INGHAM COUNTY GRID MAP, DATED JAN. 1969, SHOWS; "1/2" IRON,"
WITNESSESED BY: 4" TREE S85E, 5.06'
MULTI-TRUNKED TREE N 88 W, 22.27'
MULTI-TRUNKED TREE N 45 W, 15.45'
6. SURVEY #4589, BY OSCAR BOSS, RLS #13574, DATED 4/19/74, RECORDED IN LIBER 1, PG. 1232, STATES: "CENTER OF SECTION 36, T2N, R1E, 1/2" IRON SET".
WITNESSED BY: S 85 E, 5.06' NAIL SET N/S 4" TREE
N 88 W, 22.27' NAIL SET S/S MULTI-TRUNKED TREE
N 45 W, 15.45' NAIL SET S/S MULTI-TRUNKED TREE
SURVEY SHOWS DISTANCE SOUTH TO L-13 OF 2644.64',
7. LCRC BY OSCAR BOSS, RLS #13574, DATED 10/07/74, RECORDED IN LIBER 3, PG. 247, STATES: "ORIGINAL MONUMENT UNKNOWN, 1/2" IRON SET"
"CENTER SECTION, SECTION 36," SAME WITNESSES AS ABOVE.
8. SURVEY #80-B-574, BY LARRY BRYAN, PS #25832, DATED 11/20/80, RECORDED IN LIBER 7, PAGE 480, STATES: "CENTER OF SECTION 36, T2N, R1E, SET CONCRETE MONUMENT AT INTERSECTION OF 1/4 LINES. FOUND 1/2" BAR/CAP "BOSS" RECORDED AS CENTER OF SECTION, WEST 47.37'". WITNESSED BY:
SET N&T N/S ASH CLUMP, N 60 E, 25.48'
SET N&T N/S 6" ASH, S 15 W, 5.42'
SET N&T S/S 8" ASH, N 45 W, 19.15'
SURVEY SHOWS DISTANCES SO. TO L-13 OF 2642.45' AND WEST TO K-12 OF 2668.65'.
9. SURVEY #80-B-520, BY LARRY BRYAN, PS #25832, DATED 11/20/80, RECORDED IN LIBER 7, PAGE 484, STATES: "CENTER OF SECTION 36, T2N, R1E, SET CONCRETE MONUMENT AT INTERSECTION OF 1/4 LINES. FOUND 1/2" BAR/CAP "BOSS" RECORDED AS CENTER OF SECTION, WEST 47.37'". SAME WITNESSES AS ABOVE.
SURVEY SHOWS DISTANCE NORTH TO L-11 OF 2667.74',
SURVEY SHOWS DISTANCE SOUTH TO L-13 OF 2642.45',
SURVEY SHOWS DISTANCE EAST TO M-12 OF 2659.05',
SURVEY SHOWS DISTANCE WEST TO K-12 OF 2668.65'.
10. LCRC, BY LARRY BRYAN, PS #25832, DATED 12/01/80, RECORDED IN LIBER 6, PAGE 235, STATES: "MONUMENT NOT SET IN ORIGINAL SURVEY. SET CENTER OF SECTION AT INTERSECTION OF 1/4 LINES." PART C. STATES: "CENTER OF SECTION 36, SET CONCRETE MONUMENT. FOUND 1/2" BAR/CAP RECORDED IN LIBER 3 PAGE 247, WEST 47.37'". SAME WITNESSES AS ABOVE.
11. SURVEY #84111, BY HATHAWAY J. HANES, RLS #5260, DATED 10/30/84, RECORDED IN LIBER 4, PG. 962, STATES: "CONC. MON.-CENTER POST, SEC.36, T2N, R1E," NO MENTION OF WITNESSES. SURVEY SHOWS DISTANCE NORTH TO L-11 OF 2638.70' SURVEY SHOWS DISTANCE WEST TO K-12 OF 2669.49'
12. LCRC, BY LARRY BRYAN, PS #25832, DATED 03/20/85, RECORDED IN LIBER 6, PAGE 267, STATES: "NO POST SET IN ORIGINAL GOVERNMENT SURVEY. SET CONCRETE MONUMENT AT INTERSECTION OF 1/4 LINES." PART C. STATES: "CENTER SECTION 36, FOUND 1/2" BAR/CAP "BOSS" RECORDED AS CENTER OF SECTION, WEST 47.37'". SAME WITNESSES AS ITEM #7 ABOVE.
13. UNRECORDED SURVEY #90-B-29711, BY LARRY BRYAN, PS #25832, DATED 07/10/90, STATES: "CENTER OF SECTION 36, T2N, R1E, LIBER 6, PAGE 267. FOUND CONCRETE MONUMENT. WITNESSED BY:
FOUND N&T N/S ASH CLUMP, N 60 E, 25.48'
FOUND N&T S/S 12" ASH, N 45 W, 19.15'
FOUND 1/2" BAR/CAP AS RECORDED IN LIBER 3, PAGE 247, WEST 47.37'
SURVEY SHOWS DISTANCE SOUTH TO L-13 OF 2642.45',
14. NO OTHER REFERENCES FOUND.

LAND CORNER RECORDATION CERTIFICATE
Filing Requirement of Act 74, Mich. P.A. 1970

Liber

9 Page

34

For corners in

Ingham

(County)

Ingham Twp.

1. Public Land Survey

Located In:

Corner Code #

T2N R1E

K-11

T R

T R

T R

T R

2. Property Controlling
in Section

S

T R

S

T R

3. Miscellaneous
Property in Sec.

S

T R

S

T R

4. Lot No. _____, Recorded Plat _____

5. Private Claims _____

I, David R. Lohr, in a field survey on Oct. 14, 1996 do hereby state that under requirements of P.A. 74, Michigan P.A. of 1970, the corner points mentioned in lines 1 and 2 above were in conformance with regulations and rules therefore as required in the current manual of survey instructions of the United States Department of the Interior, Bureau of Land Management or by a decree of a Court of Law and /or that the corner points mentioned in lines 3, 4 and 5 above were in conformance with the rules of the Michigan Board of Land Surveyors or by a Decree of a Court of Law; established, re-established, monumented, recovered, found as expressed below:

NOTE: Not more than 2 corners, all in the same town and range, may be recorded on this certificate.

	A	B	C	D	E	F	G	H	I	J	K	L	M
1													
2		6		5		4		3		2		1	
3													
4		7		8		9		10		11		12	
5													
6		18		17		16		15		14		13	
7													
8		19		20		21		22		23		24	
9													
10		30		29		28		27		26		25	
11													
12		31		32		33		34		35		36	
13													

A. Description of original monument and accessories and/or subsequent restoration:

K-11: 1. "POST" SET BY JOSEPH WAMPLER, DEP. SURVEYOR IN FEB. 1826,
WITNESSED BY: WHITE OAK 17" N 25 E, 26 lks (17.18')
WHITE OAK 9" N 88 W, 45 lks (29.70')

2. CORNER REFERENCED IN SURVEY BY A. JACKSON, COUNTY SURVEYOR,
IN MAY 1840, RECORDED IN BOOK 4, PAGE 138, (VOL. 1, PG. 142)
NO REFERENCE TO MONUMENT OR WITNESSES SHOWN.

CONTINUED ON BACK

B. Description of corner evidence found and/or method applied in restoring or reestablishing corner:

K:11: SEARCHED AT APPARENT LOCATION OF CORNER AND FOUND 1/2" IRON (NO CAP)
IN MONUMENT BOX 1.5' EAST OF CENTERLINE OF DEXTER TRAIL AND ON
OCCUPATION LINE TO WEST. FOUND ALL THREE OF HANES WITNESSES OF 1984.
CORNER FALLS WITHIN THE AREA EXCAVATED BY CETA PROJECT ON 6/12 & 6/13,
1980. DID NOT EXCAVATE INTERIOR OF MON. BOX DUE TO PREVIOUS EXTENSIVE
EXCAVATION. ACCEPTED IRON AS BEST PERPETUATION OF CORNER AND SET PA
#345 CAP #30090 ON IRON.

C. Description of monument for corner and accessories established to perpetuate locating the position of the corner:

K:11: FOUND 1/2" IRON IN MON. BOX 1.5' EAST OF C/L DEXTER TRAIL AND ON OF MICHIGAN
OCCUPATION LINE TO WEST. WITNESSED BY:
FD. N&T #28414 S/S P. POLE AZ. 78-50-00, 27.38'
SET N&T #30090 N/S ANCHOR POST AZ. 95-44-00, 36.90'
SET N&T #30090 W/S FENCE POST AZ. 149-05-00, 89.08'
SET N&T #30090 NW/S TW. 3" OAK AZ. 213-01-00, 43.13'
FD. N&T #28414 S/S P. POLE AZ. 269-12-00, 42.53'



Signed by David R. Lohr
Surveyor's Michigan License No. 30090

Date October 15, 1996

K:11-INGHAM TOWNSHIP, PART A, CONTINUED

3. CORNER REFERENCED IN SURVEY BY A. JACKSON, COUNTY SURVEYOR, IN JULY 1848, RECORDED IN VOL.2, PG.44, NO REFERENCE TO MONUMENT, WITNESSES SAME AS ITEM #2.
4. A 10' X 10' X 2.7' EXCAVATION CENTERED ON FENCELINE TO THE WEST AND ABOUT 6 FT. EAST OF THE WEST EDGE OF THE PAVEMENT WAS PERFORMED BY THE CETA REMON. PROGRAM ON JUNE 12 & 13, 1980. A FURTHER EXCAVATION OF 10' X 5' X 3.0' WAS PERFORMED ON JULY 8, 1980 ABOUT 3 FT. SOUTH OF THE FIRST EXCAVATION, ON A FENCE TO THE EAST, HOWEVER NO EVIDENCE OF A CORNER WAS FOUND AT EITHER LOCATION.
5. CORNER REFERENCED IN A PROPERTY SURVEY BY HATHAWAY HANES, L.S.# 5260, DATED 10/30/84 AND RECORDED IN LIBER 4, PAGE 962. "NORTHWEST CORNER SECTION 36, T2N, R1E, PLACED R.R. SPIKE IN BLACKTOP PAVEMENT." WITNESSED BY:

P.K. NAIL IN P.P.,	N85E,	27.66'
P.K. NAIL IN P.P.,	N80W,	42.63'
P.K. NAIL IN 24" MAPLE,	S30W,	119.85'

 SURVEY SHOWS DISTANCE OF 2663.92 EAST TO L-11 AND DISTANCE OF 2636.94 SOUTH TO K-12.
6. CORNER REFERENCED IN AN UNRECORDED PROPERTY SURVEY BY LARRY BRYAN, L.S. #25832, JOB #87-B-17513, DATED 9/29/87, STATES "NORTHEAST CORNER SECTION 35, T2N, R1E, FOUND RAILROAD SPIKE IN CENTERLINE DEXTER TRAIL ON EAST-WEST FENCE." WITNESSED BY:

FOUND P.K. NAIL IN SOUTH SIDE POWER POLE,	N85E,	27.60'
FOUND P.K. NAIL IN SOUTH SIDE POWER POLE,	N80W,	42.63'
FOUND P.K. NAIL IN 30" MAPLE,	S30W,	119.85'

 SURVEY SHOWS A DISTANCE OF 2615.76' WEST TO J-11.
7. L.C.R.C. BY LARRY BRYAN, PS #25832, DATED SEPT. 11, 1987, RECORDED IN LIBER 6, PAGE 366, STATES: "FOUND RAILROAD SPIKE IN CENTERLINE DEXTER TRAIL ON EAST-WEST FENCE LINE." WITNESSES BY SAME AS ITEM #6 ABOVE.
8. CORNER REFERENCED IN A PROPERTY SURVEY BY LARRY BRYAN, L.S.# 25832, DATED 4/24/89 AND RECORDED IN LIBER 5, PAGE 1275. "NORTHEAST CORNER SECTION 35, T2N, R1E, FOUND RAILROAD SPIKE IN CENTERLINE DEXTER TRAIL ON EAST-WEST FENCE." WITNESSED BY:

FOUND P.K. NAIL IN SOUTH SIDE POWER POLE,	N85E,	27.66'
FOUND P.K. NAIL IN SOUTH SIDE POWER POLE,	N80W,	42.63'
FOUND P.K. NAIL IN 30" MAPLE,	S30W,	119.85'

 SURVEY SHOWS A DISTANCE OF 2636.00' SOUTH TO K-12.
9. CORNER REFERENCED IN AN UNRECORDED PROPERTY SURVEY BY AUSTIN C. WILLIAMS, L.S.# 21275, JOB #8128, DATED OCT. 1989, STATES "SE CORNER SEC. 26, T2N, R1E," NO MENTION OF MONUMENT. WITNESSED BY:

POWER POLE	EAST	S/S	27.6'
POWER POLE	WEST	N/S	42.27'
40" TREE	SSW		120.0'

 SURVEY SHOWS A DISTANCE OF 2615.47' WEST TO J-11.

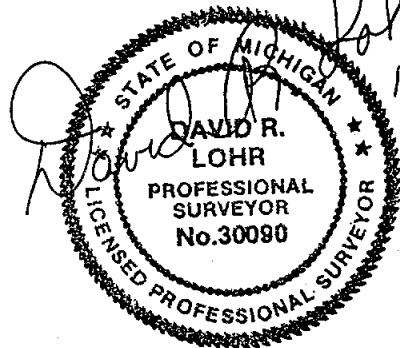

K:11-INGHAM TOWNSHIP, PART A, CONTINUED

10. PROPERTY SURVEY BY DAVID R. LOHR, L.S.#30090, DATED 5/07/93 AND RECORDED IN LIBER 7, PAGE 214. NO REFERENCE TO MONUMENT OR WITNESSES SHOWN. (RAILROAD SPIKE WAS USED AS CORNER)
11. PROPERTY SURVEY BY DAVID R. LOHR, L.S.#30090, DATED 5/21/93 AND RECORDED IN LIBER 7, PAGE 215. "SE COR, SEC 26, T2N, R1E," NO REFERENCE TO MONUMENT OR WITNESSES SHOWN. (RAILROAD SPIKE WAS USED AS CORNER)
12. PROPERTY SURVEY BY DAVID R. LOHR, L.S.#30090, DATED 10/25/93 AND RECORDED IN LIBER 7, PAGE 230. "SE COR, SEC 26, T2N, R1E, FD. R.R. SPIKE".
WITNESSED BY:
FD. P.K. NAIL S/S P. POLE, N85E, 27.66'
FD. P.K. NAIL S/S P. POLE, N80W, 42.63'
FD. P.K. NAIL S/S 30" MAPLE, S30W, 119.85'
SURVEY SHOWS A DISTANCE NORTH OF 2639.79' TO K-10.
13. PROPERTY SURVEY BY DAVID R. LOHR, L.S.#30090, DATED 11/19/93 AND RECORDED IN LIBER 7, PAGE 224. "SE COR, SEC 26, T2N, R1E, FD. R.R. SPIKE".
WITNESSED BY: SAME AS IN ITEM #9.
SURVEY SHOWS A DISTANCE NORTH OF 2639.93' TO K-10.
14. PROPERTY SURVEY BY MAURICE H. MAHIEU, L.S.#28414, DATED 5/18/94 AND RECORDED IN LIBER 7, PAGE 323. "SOUTHWEST CORNER, SECTION 25, T2N, R1E,... FOUND 1/2" IRON ROD IN MONUMENT BOX." WITNESSED BY:
NAIL & TAG No. 28414, S.SIDE UTILITY POLE, EAST, 27.45'
NAIL & TAG No. 28414, S.SIDE UTILITY POLE, WEST, 42.54'
NAIL & TAG No. 28414, E.SIDE(2) 6" BIRCH, N35W, 46.05'
NAIL & TAG No. 28414, W.SIDE 15" ELM, N20E, 89.70'
SURVEY SHOWS A DISTANCE EAST OF 2665.23' TO L-11.
15. PROPERTY SURVEY BY DAVID R. LOHR, L.S.#30090, DATED 04/24/95 AND RECORDED IN LIBER 7, PAGE 717. "SE COR, SEC 26, T2N, R1E, FD. R.R. SPIKE".
"SHOULD HAVE READ- FOUND 1/2" IRON IN MON. BOX"
WITNESSED BY: SAME AS IN ITEM #12.
SURVEY SHOWS A DISTANCE NORTH OF 2639.79' TO K-10.

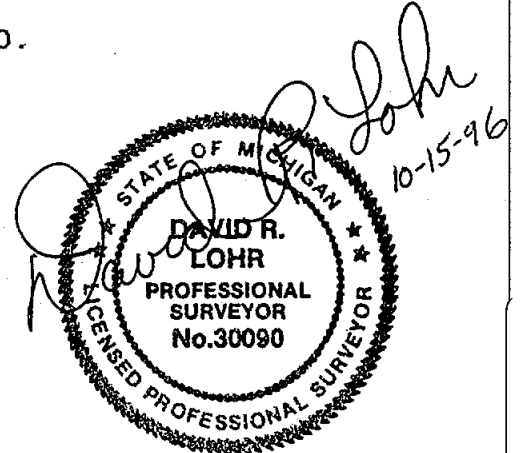

LAND CORNER RECORDATION CERTIFICATE
Filing Requirement of Act 74, Mich. P.A. 1970

Liber

9 Page 192

For corners in

INGHAM

(County)

Located In:

Corner Code #

INGHAM TOWNSHIP
1. Public Land Survey

T 2N R 1E K-12
T R
T R
T R
S T R
S T R
S T R
S T R

2. Property Controlling
in Section

3. Miscellaneous
Property in Sec.

FILED

970029261
08/06/1997 08:59:58
REGISTER OF DEEDS
Paula Johnson
INGHAM COUNTY, MI

Register of Deeds Stamp & File Number

4. Lot No. , Recorded Plat
5. Private Claims

I, DAVID R. LOHR, in a field survey on 3/25, 1997 do hereby state that under requirements of P.A. 74, Michigan P.A. of 1970, the corner points mentioned in lines 1 and 2 above were in conformance with regulations and rules therefore as required in the current manual of survey instructions of the United States Department of the Interior, Bureau of Land Management or by a decree of a Court of Law and /or that the corner points mentioned in lines 3, 4 and 5 above were in conformance with the rules of the Michigan Board of Land Surveyors or by a Decree of a Court of Law; established, re-established, monumented, recovered, found as expressed below:

NOTE: Not more than 2 corners, all in the same town and range, may be recorded on this certificate.

A. Description of original monument and accessories and/or subsequent restoration:

K-12: 1. "QUARTER POST" SET BY JOSEPH WAMPLER IN FEB. 1826.
WITNESSED BY: RO (RED OAK) 16 S 50 E 4 1/2L (2.97')
WO (WHITE OAK) 11 N 5 1/4 W 26L (17.16')
DISTANCE NORTH & SOUTH EQUALS 40 CH. (2640')

CONTINUED ON BACK

B. Description of corner evidence found and/or method applied in restoring or reestablishing corner:

K-12: SEARCHED AT APPARENT LOCATION OF CORNER AND FOUND 3/4" REBAR, WITH WITNESSES, IN STONE PILE ON FENCE LINE EAST AS PER ITEM A-10. FENCES SOUTH, WEST AND NORTH ARE DOWN AND BARELY VISIBLE. REVIEW OF TRAVERSE NOTES FOR ITEM A-8, SHOWS DISTANCE TO NORTH OF 2640.81 FT., DISTANCE EAST OF 2668.65 FT. AND DISTANCE SOUTH OF 2624.91 FT. ACCEPTED 3/4" REBAR AS CORNER, LEFT IT IN PLACE AND SET PA #345 CAP #30090 OVER IT.

C. Description of monument for corner and accessories established to perpetuate locating the position of the corner:

K-12: 3/4" REBAR WITH PA #345 CAP #30090, IN STONE PILE ON FENCE TO EAST.
WITNESSED BY:

SET N&T #30090, W/S 18" OAK, N 13 E, 25.50'
SET N&T #30090, NE/S 30" OAK, S 30 E, 18.65'
FD. N&T #25832, E/S 30" OAK, S 10 W, 22.84'
FD. NAIL, N/S TWIN 20" MAPLE, WEST, 11.31'
SET N&T #30090, S/S 12" OAK, N 72 W, 27.99'
SET N&T #30090, SW/S 12" CHERRY, N 35 W, 42.91'

Signed by

David R. Lohr

Date

6-16-97

Surveyor's Michigan License No.

30090

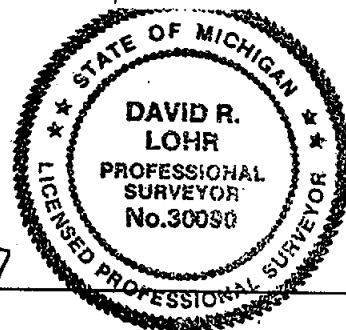

K-12: INGHAM TOWNSHIP, PART A - CONTINUED

2. A. JACKSON, COUNTY SURVEYOR IN AN 1840 SURVEY RECORDED IN BOOK 4, PAGE 138. NO REFERENCE TO MONUMENT, SAME WITNESSES AS ABOVE. SURVEY SHOWS A DISTANCE EAST TO L-12 OF 160R-18 LKS. (2651.88'), AND A DISTANCE NORTH TO THE WEST 1/8 CORNER OF 79R-15 LKS, (1313.40).
3. A. JACKSON, COUNTY SURVEYOR, IN AN 1844 SURVEY RECORDED IN VOL. 1, PAGE 142, (CETA DOSSIER) COPY OF SAME SURVEY AS ITEM #2.
4. INGHAM COUNTY GRID MAP, DATED JAN. 1969, SHOWS; "1/2" IRON,"
WITNESSES BY: 12" TREE WEST, 11.47'
30" OAK, S 10 W, 22.94'
24" OAK, S 35 E, 18.60'
5. SURVEY #4589, BY OSCAR BOSS, RLS #13574, DATED 4/19/74, RECORDED IN LIBER 1, PG. 1232, STATES: "W 1/4 CORNER, SECTION 36, 1/2" IRON SET".
WITNESSES BY: WEST, 11.47' NAIL SET N/S DBL. TRUNKED TREE 12"
S 10 W, 22.94' NAIL SET E/S 30" OAK
S 35 E, 18.6' NAIL SET N/E/S 24" OAK
SURVEY SHOWS DISTANCE SOUTH TO K-13 OF 2625.04'.
(CALCULATED DISTANCE EAST TO HIS L-12 OF 2621.16', WHICH IS 47.37' WEST OF BRYAN'S CENTER OF SECTION. THIS WOULD TOTAL 2668.53')
6. LCRC BY OSCAR BOSS, RLS #13574, DATED 10/07/74, RECORDED IN LIBER 3, PG. 247. STATES: PART A- "K-12. UNKNOWN" PART B- "1/2" IRON SET (FENCE INTERSECTION)" "W 1/4 COR, SEC 36." SAME WITNESSES AS ABOVE.
7. SURVEY #80-B-574, BY LARRY BRYAN, PS #25832, DATED 11/20/80, RECORDED IN LIBER 7, PAGE 480, STATES: "WEST 1/4 CORNER, SECTION 36, T2N, R1E, FD. 1/2" BAR W/CAP R.L.S. #13576* AT FENCE INTERSECTION, LIBER 3, PAGE 247.
WITNESSED BY: FD. NAIL, N/S TWIN TREE, WEST, 11.47'
FD. N&T E/S 30" OAK, S 10 W, 22.54'
FD. N&T NE/S 24" OAK, S 35 E, 182.64'
SURVEY SHOWS DISTANCE EAST TO L-12 OF 2668.65'.
* (RLS #13576 SHOULD READ #13574, OSCAR BOSS.)
8. SURVEY #80-B-520, BY LARRY BRYAN, PS #25832, DATED 11/20/80, RECORDED IN LIBER 7, PAGE 484, STATES: "WEST 1/4 CORNER, SECTION 36, T2N, R1E, FD. 1/2" BAR W/CAP R.L.S. #13576* AT FENCE INTERSECTION, LIBER 3, PAGE 247.
WITNESSED BY: FD. NAIL, N/S TWIN TREE, WEST, 11.47'
FD. N&T E/S 30" OAK, S 10 W, 22.54'
FD. N&T NE/S 24" OAK, S 35 E, 182.64'
SURVEY SHOWS DISTANCE EAST TO L-12 OF 2668.65'.
REVIEW OF TRAVERSE COMPUTATION SHEET SHOWS DISTANCE NORTH TO K-11 OF 2640.81' AND DISTANCE SOUTH TO K-13 OF 2624.91'.
* (RLS #13576 SHOULD READ #13574, OSCAR BOSS.)
9. SURVEY #84111, BY HATHAWAY J. HANES, RLS #5260, DATED 10/30/84, RECORDED IN LIBER 4, PG. 962, STATES: "WEST 1/4 POST, SEC. 36, T2N, R1E," NO MENTION OF MONUMENT OR WITNESSES. SURVEY SHOWS DISTANCE NORTH TO K-11 OF 2636.94', AND A DISTANCE EAST TO L-12 OF 2669.49'.
10. SURVEY #89-B-24536, BY LARRY BRYAN, PS #25832, DATED 04/24/89, RECORDED IN LIBER 5, PAGE 1275, STATES: "EAST 1/4 CORNER, SECTION 35, T2N, R1E, LIBER 3, PAGE 247. FOUND 3/4" REBAR AT FENCE INTERSECTION,
WITNESSED BY: FD. NAIL, N/S 20" TWIN MAPLE, WEST, 11.4'
SET N&T #25832 IN E/S 30" OAK, S 10 W, 22.54'
FD. NAIL IN NE/S 30" OAK, S 30 E, 18.68'
11. NO OTHER REFERENCES FOUND.

LAND CORNER RECORDATION CERTIFICATE
Filing Requirement of Act 74, Mich. P.A. 1970

Liber 9 Page 194

For corners in

INGHAM

(County)

Located In:

Corner Code #

INGHAM TOWNSHIP
1. Public Land Survey

T 2N R 1E K-13

T R

T R

T R

T R

2. Property Controlling
in Section

S T R

S T R

3. Miscellaneous
Property in Sec.

S T R

S T R

FILED

970029262
08/06/1997 09:00:00
REGISTER OF DEEDS
Paula Johnson
INGHAM COUNTY, MI

Register of Deeds Stamp & File Number

4. Lot No. , Recorded Plat

5. Private Claims

I, DAVID R. LOHR, in a field survey on 3/28, 1997 do hereby state that under requirements of P.A. 74, Michigan P.A. of 1970, the corner points mentioned in lines 1 and 2 above were in conformance with regulations and rules therefore as required in the current manual of survey instructions of the United States Department of the Interior, Bureau of Land Management or by a decree of a Court of Law and /or that the corner points mentioned in lines 3, 4 and 5 above were in conformance with the rules of the Michigan Board of Land Surveyors or by a Decree of a Court of Law; established, re-established, monumented, recovered, found as expressed below:

NOTE: Not more than 2 corners, all in the same town and range, may be recorded on this certificate.

	A	B	C	D	E	F	G	H	I	J	K	L	M
1													
2	6		5		4		3		2		1		
3													
4	7		8		9		10		11		12		
5													
6	18		17		16		15		14		13		
7													
8	19		20		21		22		23		24		
9													
10	30		29		28		27		26		25		
11													
12	31		32		33		34		35		36		
13													

A. Description of original monument and accessories and/or subsequent restoration:

K-13: 1. CORNER SET BY JOSEPH WAMPLER, DEP. SURVEYOR, IN FEB., 1824.
(SOUTH BOUNDARY - INGHAM TOWNSHIP) "SET POST, COR. OF 35 & 36 fw"
WITNESSED BY: WO 14 N 80 E, 36 LKS (23.76')
" 11 N 50 1/2 W, 28 1/2 LKS (18.81')
NOTES SHOW DISTANCE EAST OF 40 CH. (2640.00')
NOTES SHOW DISTANCE NORTH OF 40 CH. (2640.00')
MARGINAL NOTE: "UNREADABLE"... W.O. 30, S 19 W, 112 LKS (73.92')
B.O. 9, N 30 W, 104 LKS (68.64')

CONTINUED ON BACK

B. Description of corner evidence found and method applied in restoring or reestablishing corner:

K-13: SEARCHED AT APPARENT LOCATION OF CORNER AND FOUND 1/2" IRON AS PER ITEM #A-8. EXCAVATED AREA 8'X 8'X 2' DEEP AROUND IRON THRU 12" OF GRAVEL TO ORIGINAL GROUND (SAND) AND FOUND NOTHING. FENCE TO NORTH NO LONGER STANDING. ACCEPTED 1/2" IRON AS CORNER BASED ON TESTIMONY OF SURVEYOR BOSS IN ITEM #A-4 AS BEST EVIDENCE OF LOCATION OF CORNER. REPLACED 1/2" IRON WITH STANDARD 3/4" X 24" REMON. BAR AND PA #345 CAP #30090.

C. Description of monument for corner and accessories established to perpetuate locating the position of the corner:

K-13: SET STANDARD 3/4" X 24" REMON. BAR AND PA#345 CAP #30090 AT LOCATION OF 1/2" IRON OF LIBER 3, PAGE 247. WITNESSED BY:
FD. N&T #25832, S/S 48" OAK, AZ. 36-32-30, 29.80'
3/4" X 24" REMON BAR (K-1, B.H.) AZ. 90-00-00, 27.05' (GLO=24.42')
SET N&T #30090, E/S 12" CHERRY, AZ. 185-43-30, 46.25'
SET N&T #30090, S/S 36" OAK, AZ. 306-52-18, 38.35'
FD. N&T #25832, E/S 36" OAK, AZ. 344-46-00, 30.33'

Signed by

David R. Lohr

Date 6-16-97

Surveyor's Michigan License No. 30090

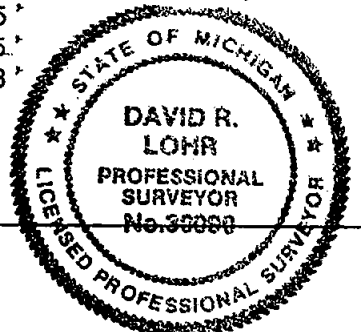

2. GLO NOTES FOR BUNKERHILL TOWNSHIP SHOW K-1 BUNKERHILL TO BE 37 LKS EAST (24.42')
2. CORNER REFERENCED IN SURVEY BY "W.H. RAYNER, CO. SURVEYOR, DATED APRIL 25, 1865, RECORDED IN FOLDER 1, PAGE 75, (CETA DOSSIER). NO MENTION OF MONUMENT
WITNESSED BY: W.O. 3, N 37 W, 52 LKS (34.32')
W.O. 3, N 21 E, 69 LKS (45.54')
3. CORNER REFERENCED ON INGHAM COUNTY GRID MAP, DATED JAN. 1969, AS "1/2 IRON"
WITNESSED BY: DUE E. N.W. COR., SEC. 1, T1N, R1E, IRON, 27'
40" OAK, N 40 E, 29.99'
TOP OF STUMP, N 70 E, 57.35'
4. LCRC, BY OSCAR BOSS, RLS #13574, DATED 04/17/74, RECORDED IN LIBER 3, PAGE 247. "K-13: (ORIGINAL) UNKNOWN... 1/2" IRON SET (ON FENCE TO NORTH)."
WITNESSED BY: DUE EAST NW CORNER, SEC. 1, T1N, R1E, IRON, 27'
N 40 E, 29.99, NAIL SET S/S 40" OAK
N 70 E, 57.35, NAIL SET TOP OF STUMP
5. CORNER REFERENCED IN SURVEY #4589, BY OSCAR BOSS, RLS #13574, DATED 04/10/74, RECORDED IN LIBER 1, PAGE 1232. "SW CORNER, SECTION 36, 1/2" IRON SET."
WITNESSED BY: DUE EAST NW CORNER, SEC. 1, T1N, R1E, IRON, 27'
N 40 E, 29.99, NAIL SET S/S 40" OAK
N 70 E, 57.35, NAIL SET TOP OF STUMP
- SURVEY SHOWS DISTANCE NORTH TO K-12 OF 2625.04'
SURVEY SHOWS DISTANCE EAST TO L-13 OF 2656.68'
6. CORNER REFERENCED IN SURVEY BY OSCAR BOSS, RLS #13574, DATED 05/18/74, RECORDED IN LIBER 1, PAGE 1254. "S.E. COR., SEC. 35, T2N, R1E, 1/2" IRON SET."
WITNESSED BY: DUE EAST NW CORNER, SEC. 1, T1N, R1E, IRON, 27'
N 40 E, 29.99, NAIL SET S/S 40" OAK
N 70 E, 57.35, NAIL SET TOP OF STUMP
- NO DISTANCES SHOWN.
7. CORNER REFERENCED IN SURVEY BY AUSTIN C. WILLIAMS, RLS #21275, DATED 5/09/74, RECORDED IN LIBER 3, PAGE 419. "SE CORNER OF SECTION 35, T2N, R1E."
NO MENTION OF MONUMENT, WITNESSED BY: DUE EAST, NW CORNER OF SECTION 1, T1N, R1E, IRON, 27'
N 40 E, 29.99, NAIL SET S/S 40" OAK
N 70 E, 57.35, NAIL SET IN TOP OF STUMP
- NO DISTANCES SHOWN.
8. SURVEY #80-B-520, BY LARRY BRYAN, PS #25832, DATED 11/20/80, RECORDED IN LIBER 7, PAGE 480, DOES NOT REFER TO K-13, HOWEVER REVIEW OF TRAVERSE COMPUTATION SHEET SHOWS DISTANCE NORTH TO K-12 OF 2624.91' AND DISTANCE EAST TO L-13 OF 2656.69'.
9. UNRECORDED SURVEY BY LARRY BRYAN, PS #25832, JOB NUMBER 90-B-29711, DATED 07/10/90, STATES: "SOUTHWEST CORNER SECTION 36, T2N, R1E, LIBER 3, PAGE 247. FOUND 1/2" BAR IN CENTERLINE OF EWERS ROAD ON FENCE LINE NORTH."
WITNESSED BY: FOUND NAIL & TAG EAST SIDE 46" OAK, N 30 W, 30.34'
FOUND 1/2" BAR, EAST, 27.00'
SET NAIL & TAG SOUTH SIDE 40" OAK, N 40 E, 29.95'

SURVEY SHOWS A DISTANCE EAST TO L-13 OF 2656.61'

10. NO OTHER REFERENCES FOUND.

LAND CORNER RECORDATION CERTIFICATE
Filing Requirement of Act 74, Mich. P.A. 1970

Liber

9 Page 196

For corners in

INGHAM

(County)

INGHAM TOWNSHIP

Located In:

Corner Code #

1. Public Land Survey

T 24 R 1E L-13

T R

T R

T R

2. Property Controlling
in Section

S T R

S T R

3. Miscellaneous
Property in Sec.

S T R

S T R

FILED

970029263
08/06/1997 09:00:01
REGISTER OF DEEDS
Paula Johnson
INGHAM COUNTY, MI

Register of Deeds Stamp & File Number

4. Lot No. , Recorded Plat

5. Private Claims

I, DAVID R. LOHR, in a field survey on 3/28, 19 97 do hereby state that under requirements of P.A. 74, Michigan P.A. of 1970, the corner points mentioned in lines 1 and 2 above were in conformance with regulations and rules therefore as required in the current manual of survey instructions of the United States Department of the Interior, Bureau of Land Management or by a decree of a Court of Law and /or that the corner points mentioned in lines 3, 4 and 5 above were in conformance with the rules of the Michigan Board of Land Surveyors or by a Decree of a Court of Law; established, re-established, monumented, recovered, found as expressed below:

NOTE: Not more than 2 corners, all in the same town and range, may be recorded on this certificate.

A. Description of original monument and accessories and/or subsequent restoration:

L-13: 1. CORNER SET BY JOSEPH WAMPLER, DEP SURVEYOR, IN FEB., 1824.
(SOUTH BOUNDARY - INGHAM TOWNSHIP) "SET QR. POST, fw" WITNESSED BY:
TAM 9 N 30 E, 36 LKS (23.76')
" 9 N 49 W, 108 LKS (71.28')
NOTES SHOW DISTANCES EAST & WEST OF 40 CH. (2640.00')
CONTINUED ON BACK

B. Description of corner evidence found and/or method applied in restoring or reestablishing corner:

L-13: SEARCHED AT APPARENT LOCATION OF CORNER AND FOUND ONLY WITNESSES TO SOUTH AND SOUTHWEST (ITEM A-14). ROAD HAS BEEN REBUILT AND APPROX. 3 FEET OF NEW FILL PLACED. CORNER FALLS 4 FT. EAST OF NEWER CULVERT. DID NOT EXCAVATE AREA DUE TO RECENT ROAD CONSTRUCTION. SET CORNER USING CONTROL ON EAST LINE OF ADJACENT PARCEL "B", ITEM #A-16. ACCEPTED LOCATION OF CORNER AS PER REVIEW OF TRAVERSE DATA AND TESTIMONY OF SURVEYOR BRYAN IN ITEM #A-14. SET STANDARD 3/4" X 24" REMON. BAR AND PA #345 CAP #30090.

C. Description of monument for corner and accessories established to perpetuate locating the position of the corner:

L-13: SET STANDARD 3/4" X 24" REMON. BAR AND PA#345 CAP #30090 AT LOCATION OF CORNER AS PER ADJACENT SURVEY. WITNESSED BY:
3/4" REMON. BAR/CAP #30090, L-1 BUNKER HILL, AZ. 89-39-31, 12.21'
SET N&T #30090, W/S 3" ELM, AZ. 187-45-00, 25.70'
SET N&T #30090, E/S P. POLE, AZ. 202-36-00, 212.80'
SET N&T #30090, N/S 36" COTTONWOOD, AZ. 249-42-00, 149.25'
SET N&T #30090, S/S 12" ELM, AZ. 279-35-42, 85.30'

Signed by

David R. Lohr

Date 6-16-97

Surveyor's Michigan License No. 30090



FORM APPROVED BY MICHIGAN STATE BOARD OF PROFESSIONAL SURVEYORS, JAN. 28, 1971

REVISED MAY 14, 1975

REVISED JAN., 1983

REVISED OCT., 1995

P.A. 345 INGHAM COUNTY

PEER APPROVED 6/2/97 m

L-13: INGHAM TOWNSHIP, PART A - CONTINUED

2. CORNER REFERENCED IN SURVEY BY A. JACKSON, COUNTY SURVEYOR, DATED MAY 25, 1839, RECORDED IN FOLDER 1, PAGE 76, (CETA DOSSIER). NO MENTION OF MONUMENT, SAME WITNESSES AS ITEM #1. SURVEY SHOWS DISTANCE NORTH OF 40.095 CH. (2646.27')
3. CORNER REFERENCED IN SURVEY BY A. JACKSON, COUNTY SURVEYOR, DATED MAY 25, 1840, RECORDED IN BOOK 4, PAGE 138. NO MENTION OF MONUMENT, SAME WITNESSES AS ITEM #1. SURVEY SHOWS DISTANCE NORTH OF 160R-9.5 LKS. (2646.27') (NOTE: SURVEY APPEARS TO BE THE SAME SURVEY AS ITEM #2.)
4. CORNER REFERENCED IN SURVEY BY "F.G. LEE", DEP. SURVEYOR, DATED OCT. 28, 1844, RECORDED IN VOL. 1, PAGE 142, (CETA DOSSIER). NO MENTION OF MONUMENT, SAME WITNESSES AS ITEM #1. SURVEY SHOWS DISTANCE NORTH OF 160R-9.5 LKS. (2646.27') (NOTE: SURVEY APPEARS TO BE THE SAME SURVEY AS ITEM #2.)
5. CORNER REFERENCED IN SURVEY BY W.H. RAYNER, CO. SURVEYOR, DATED APRIL 25, 1865, RECORDED IN FOLDER 1, PAGE 75, (CETA DOSSIER). NO MENTION OF MONUMENT, WITNESSED BY: B.O. 8, N 80 1/2 E, 254 LKS (167.64')
HICK. 9, S 83 W, 294 LKS (194.04')
6. CORNER REFERENCED IN SURVEY BY A.P. DRAKE, CO. SURVEYOR, DATED APRIL 16, 1880, RECORDED IN BOOK 3, PAGE 31. (IN SECTION 1, BUNKERHILL TWP.) NO MENTION OF MONUMENT, HOWEVER, IT IS NOTED THAT L-1, BUNKERHILL TWP., IS "A POINT 18 1/2 LKS (12.21') EAST FROM INGHAM 1/4 POST". NO WITNESSES GIVEN.
7. NO REFERENCE MADE ON INGHAM COUNTY GRID MAP, DATED JAN. 1969.
8. SURVEY #2928, BY OSCAR BOSS, RLS #13574, DATED 08/03/72, RECORDED IN LIBER 1, PAGE 431, IS FOR A PARCEL IN THE SOUTHWEST 1/4 OF SECTION 36, T2N, R1E, (INGHAM TOWNSHIP), HOWEVER THE ONLY TIE IS TO THE NORTH 1/4 CORNER OF SECTION 1, T1N, R1E, (BUNKERHILL TOWNSHIP). SAME WITNESSES AS ITEM #A-9.
9. CORNER REFERENCED IN SURVEY #3823, BY OSCAR BOSS, RLS #13574, DATED 06/04/73, RECORDED IN LIBER 1, PAGE 835. "SURVEY IS FOR A PARCEL IN THE NORTHWEST 1/4 OF SECTION 1, T1N, R1E, (BUNKERHILL TOWNSHIP). "N 1/4 CORNER, 1/2" PIPE FD." WITNESSED BY: S 65 W 150.07 NAIL N/S 36" COTTONWOOD
S 32 W 14.89 NAIL N/S WHITE POST
S 81 E 162.39 N/S YIELD SIGN POST

SURVEY SHOWS DISTANCE WEST TO K-1 OF 2629.55'
SURVEY SHOWS DISTANCE SOUTH TO L-2 OF 2833.02'
10. CORNER REFERENCED IN SURVEY #4589, BY OSCAR BOSS, RLS #13574, DATED 04/10/74, RECORDED IN LIBER 1, PAGE 1232. "S 1/4 CORNER, SECTION 36, 1/2" PIPE FOUND." WITNESSED BY: S 65 W 150.07 NAIL N/S 36" COTTONWOOD
S 32 W 14.89 NAIL N/S WHITE POST
S 81 E 162.39 N/S YIELD SIGN POST

SURVEY SHOWS DISTANCE NORTH TO L-12 OF 2644.64'
SURVEY SHOWS DISTANCE WEST TO K-13 OF 2656.68'
11. LCRC, BY OSCAR BOSS, RLS #13574, DATED 04/10/74, RECORDED IN LIBER 5, PAGE 175. "L-13: (ORIGINAL) UNKNOWN... FND. 1/2" PIPE IN EWERS ROAD." WITNESSED BY: S 65 W 150.07 NAIL N/S 36" COTTONWOOD
S 32 W 14.89 NAIL N/S WHITE POST
S 81 E 162.39 N/S YIELD SIGN POST
12. CORNER REFERENCED IN SURVEY BY OSCAR BOSS, RLS #13574, DATED 04/19/74, RECORDED IN LIBER 1, PAGE 1232 (CETA DOSSIER). "S 1/4 CORNER, SECTION 36, 1/2" PIPE FOUND." WITNESSED BY: S 65 W 150.07 NAIL N/S 36" COTTONWOOD
S 32 W 14.89 NAIL N/S WHITE POST
S 81 E 162.39 N/S YIELD SIGN POST

SURVEY SHOWS DISTANCE NORTH TO L-12 OF 2644.64'
SURVEY SHOWS DISTANCE WEST TO K-13 OF 2656.68'

CONTINUED ON PAGE 3.

L-13: INGHAM TOWNSHIP, PART A - CONTINUED

13. CORNER REFERENCED IN SURVEY BY OSCAR BOSS, RLS #13574, DATED 05/18/74, RECORDED IN LIBER 1, PAGE 1254. "S 1/4 CORNER, SECTION 36, 1/2" PIPE FD."
 WITNESSED BY: S 65 W 150.07 NAIL N/S 36" COTTONWOOD
 S 32 W 14.89 NAIL N/S WHITE POST
 S 81 E 162.39 N/S YIELD SIGN POST
 NO DISTANCES SHOWN.

14. SURVEY BY LARRY BRYAN, PS #25832, DATED 11/20/80, RECORDED IN LIBER 7, PAGE 480, STATES: "SOUTH 1/4 CORNER SECTION 36, T2N, R1E, FOUND 3/4" PIPE IN CENTERLINE OF ROAD, LIBER 5, PAGE 175."
 WITNESSED BY:
 FD. NAIL NORTH SIDE 30" COTTONWOOD S 65 W, 150.07'
 FD. IRON FENCE POST N 10 W, 18.90'
 FD. NAIL EAST SIDE POWER POLE, S 35 W, 212.56'

SURVEY SHOWS A DISTANCE NORTH TO L-12 OF 2642.45'. REVIEW OF TRAVERSE COMPUTATION SHEET SHOWS DISTANCE WEST TO K-13 OF 2656.69' AND DISTANCE EAST TO M-13 OF 2652.87'.

15. SURVEY BY LARRY BRYAN, PS #25832, DATED 11/20/80, RECORDED IN LIBER 7, PAGE 484, STATES: "SOUTH 1/4 CORNER SECTION 36, T2N, R1E, FOUND 3/4" PIPE IN CENTERLINE OF ROAD, LIBER 5, PAGE 175."
 WITNESSED BY:
 FD. NAIL NORTH SIDE 30" COTTONWOOD S 65 W, 150.07'
 FD. IRON FENCE POST N 10 W, 18.90'
 FD. NAIL EAST SIDE POWER POLE, S 35 W, 212.56'

SURVEY SHOWS A DISTANCE NORTH TO L-12 OF 2642.45'
 SURVEY SHOWS A DISTANCE EAST TO M-13 OF 2652.87'

16. UNRECORDED SURVEY BY LARRY BRYAN, PS #25832, JOB NUMBER 90-B-29711, DATED 07/10/90, STATES: "SOUTH 1/4 CORNER SECTION 36, T2N, R1E, LIBER 5, PAGE 175. FOUND 3/4" PIPE IN CENTERLINE OF EWERS ROAD."
 WITNESSED BY:
 FD. NAIL & TAG NORTH SIDE COTTONWOOD, S 65 W, 149.25'
 STEEL POST, N 10 W, 21.20'
 FD. NAIL & TAG EAST SIDE POWER POLE, S 35 W, 212.50'

SURVEY SHOWS A DISTANCE NORTH TO L-12 OF 2642.45'
 SURVEY SHOWS A DISTANCE EAST TO M-13 OF 2652.87'
 SURVEY SHOWS A DISTANCE WEST TO K-13 OF 2656.61'

17. NO OTHER REFERENCES FOUND.

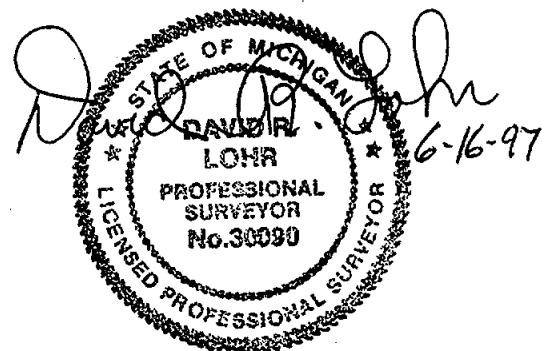

LAND CORNER RECORDATION CERTIFICATE
Filing Requirement of Act 74, Mich. P.A. 1970

Liber

9 Page 199

For corners in

INGHAM

(County)

INGHAM TOWNSHIP

1. Public Land Survey

Located In:

Corner Code #

T 2N R 1E

M-11

T _____ R _____

T _____ R _____

T _____ R _____

T _____ R _____

2. Property Controlling
in Section

S _____

T _____ R _____

S _____

T _____ R _____

3. Miscellaneous
Property in Sec.

S _____

T _____ R _____

S _____

T _____ R _____

FILED

970029264
08/06/1997 09:00:03
REGISTER OF DEEDS
Paula Johnson
INGHAM COUNTY, MI

Register of Deeds Stamp & File Number

4. Lot No. _____, Recorded Plat _____

5. Private Claims _____

I, DAVID R. LOHR, in a field survey on 3/25, 19 97 do hereby state that under requirements of P.A. 74, Michigan P.A. of 1970, the corner points mentioned in lines 1 and 2 above were in conformance with regulations and rules therefore as required in the current manual of survey instructions of the United States Department of the Interior, Bureau of Land Management or by a decree of a Court of Law and/or that the corner points mentioned in lines 3, 4 and 5 above were in conformance with the rules of the Michigan Board of Land Surveyors or by a Decree of a Court of Law; established, re-established, monumented, recovered, found as expressed below:

NOTE: Not more than 2 corners, all in the same town and range, may be recorded on this certificate.

	A	B	C	D	E	F	G	H	I	J	K	L	M
1													
2	6			5		4		3		2		1	
3													
4	7			8		9		10		11		12	
5													
6	18			17		16		15		14		13	
7													
8	19			20		21		22		23		24	
9													
10	30			29		28		27		26		25	
11													
12	31			32		33		34		35		36	
13													

A. Description of original monument and accessories and/or subsequent restoration:

M-11: 1. CORNER SET BY JOSEPH WAMPLER IN FEB. 1824. (EXTERIOR BOUNDARY - INGHAM TOWNSHIP) "SET POST COR 25 & 36 - FW" WITNESSED BY:

"A" (ASPEN) 14 N 46 W 540 LKS (356.4')

"A" (ASPEN) 17 S 14 W 200 LKS (132.0')

NOTES SHOW DISTANCES NORTH & SOUTH OF 40 CH. (2640.0')

CONTINUED ON BACK

B. Description of corner evidence found and/or method applied in restoring or reestablishing corner:

M-11: SEARCHED AT APPARENT LOCATION OF CORNER AND FOUND 1/2" BAR AND CAP #18998 AS PER ITEM #6, PART A: CORNER FALLS 4.7 FT. NORTH OF FENCE TO EAST AND ON CENTERLINE OF MEECH ROAD. FOUND ALL WITNESSES OF ITEM #A-6. DID NOT EXCAVATE DUE TO CORNER FALLING IN 6 FT. FILL AREA AND A LACK OF ANY COUNTY SURVEYOR RECORDS FOR THIS CORNER. ACCEPTED CORNER BASED ON TESTIMONY OF SURVEYOR LESTER IN ITEM #A-6. REPLACED 1/2" IRON WITH STANDARD 3/4" X 24" REMON. BAR AND PA#345 CAP #30090.

C. Description of monument for corner and accessories established to perpetuate locating the position of the corner:

M-11: STANDARD 3/4" X 24" REMON. BAR AND PA#345 CAP #30090 IN CENTERLINE OF MEECH ROAD AND 4.7 FT. NORTH OF FENCE TO EAST. WITNESSED BY:

C/L 6" ST. GATE POST (NORTHERLY) AZ. 71-53-30, 80.33'

C/L 6" ST. GATE POST (SOUTHERLY) AZ. 83-19-00, 76.67'

SET N&T #30090 N/S 12" ELM, AZ. 109-29-30, 42.33'

SET N&T #30090 W/S 15" CHERRY, AZ. 165-22-00, 82.33'

FD. 3/4" PIPE, A-11 WHITE OAK, AZ. 180-00-00, 4.62'

FD. N&T #18998 NE/S 20" WALNUT, AZ. 249-36-00, 25.72'

FD. N&T #18998 NE/S 20" OAK, AZ. 287-49-30, 33.57'

Signed by David R. Lohr

Date 6-16-97

Surveyor's Michigan License No. 30090



2. GLO NOTES REPEATED IN WHITE OAK TOWNSHIP - (WEST BOUNDARY)
BY JOSEPH WAMPLER, DATED FEB. 1826: SAME WITNESSES AS ITEM #1:
3. INTERIOR SUBDIVISION OF WHITE OAK TOWNSHIP BY JOS. WAMPLER,
DATED NOV. 1825, INDICATES THAT A-11 WHITE OAK FALLS 7 LKS
(4.62') SOUTH OF M-11 INGHAM TOWNSHIP.
4. NO REFERENCES TO THIS CORNER WERE FOUND IN THE RECORDS OF THE
COUNTY SURVEYOR.
5. NO REFERENCE MADE ON INGHAM COUNTY GRID MAP, DATED JAN. 1969.
6. LCRC BY RONNIE LESTER, PS #18998, DATED 12/21/76, RECORDED IN LIBER 4,
PAGE 13, STATES: "ORIGINAL MONUMENT AND ACCESSORIES LOST...SET 1/2"
BAR AND CAP ON TOWNSHIP LINE AT GLO FALLING NORTH OF SW CORNER OF
SECTION 30, T2N, R2E, INGHAM COUNTY, MICHIGAN, AS RECORDED IN LIBER 3,
PAGE 355. SE CORNER SEC. 25, T2N, R1E, 1/2" BAR AND CAP", WITNESSED BY:
NAIL & TAG NORTH SIDE 18" OAK, WNW, 33.63'
NAIL & TAG NORTH SIDE 18" WALNUT, WSW, 25.92'
SW CORNER SEC. 30, T2N, R2E, 1/2" PIPE & CAP, SOUTH, 4.62'
3/4" PIPE & CAP, ESE, 33.59'
7. CETA "PRELIMINARY FIELD RECON" REPORT DATED 11/3/77 ONLY INDICATES THAT
RLS #11370 WITNESSES WERE PRESENT, (NO OTHER DATA AVAILABLE)
(THESE WITNESSES WERE FOR A-11 WHITE OAK TWP. LIBER 3, PAGE 355
8. CETA "TRAVERSE POINT WITNESS REPORT" DATED 4/5/78 FOR A-11 WHITE OAK
INDICATES THAT M-11 INGHAM LIES 4.62 FT. NORTH OF A-11 WHITE OAK.
9. CETA "MONUMENTED CORNER REPORT" DATED 11/30/78 STATES "FD. M-11 INGHAM TWP.
AS RECORDED IN LIBER #4 PG.#13 - CHECKED & USED THESE WITNESSES."
SKETCH SHOWS CORNER BEING LOCATED 4.62 FT. NORTH OF A-11 WHITE OAK TWP.
10. SURVEY #80-B-520, BY LARRY BRYAN, PS #25832, DATED 11/20/80, RECORDED IN
LIBER 7, PAGE 484, STATES: "NORTHEAST CORNER, SECTION 36, T2N, R1E,
FD. 1/2" BAR W/CAP R.L.S. NO. 18998 IN CENTERLINE OF ROAD." WITNESSED BY:
FD. NAIL & TAG NORTH SIDE 18" OAK, N40W, 33.74'
FD. NAIL & TAG NORTH SIDE 18" WALNUT, S40W, 25.98'
FD. 3/4" PIPE AT NORTHWEST CORNER OF SECTION 31, T2N, R2E, SOUTH, 4.55'

SURVEY SHOWS A DISTANCE SOUTH TO M-12 OF 2640.08'
CALCULATED DISTANCE WEST TO L-11 OF 2686.61'
11. SURVEY #A-4215, BY RONNIE LESTER, PS #18998, DATED 05/07/92, RECORDED
IN LIBER 6, PAGE 998, STATES: "NORTHEAST CORNER, SECTION 36, T2N, R1E,
1/2" BAR AND CAP. LIBER 4, PAGE 13." WITNESSED BY:
SET NAIL & TAG IN NORTH SIDE 20" WALNUT, 250 AZ., 25.8'
SET NAIL & TAG IN N.E. SIDE 20" OAK, 290 AZ., 33.6'
3/4" PIPE, (A-11) 185 AZ., 4.7'
CENTERLINE OF 6" STEEL GATE POST (SOUTHERLY) 88 AZ., 76.2'
CENTERLINE OF 6" STEEL GATE POST (NORTHERLY) 76 AZ., 80.3'

SURVEY SHOWS A DISTANCE SOUTH TO M-12 OF 2640.13'
12. SURVEY #94-6412, BY RON HELSEL, PS #18994, DATED 11/15/94, RECORDED IN
LIBER 7, PAGE 518, STATES: "SOUTHEAST CORNER, SECTION 25, T2N, R1E,
LIBER 4, PAGE 13. FOUND BAR AND CAP NO. 18998 IN CENTERLINE OF
OSBORNE (MEECH) ROAD." WITNESSED BY:
FD. 1/2" PIPE/CAP #18998 AT SW COR., SEC. 30, T2N, R2E, SOUTH, 4.62'
FD. 3/4" PIPE, S85E, 33.59'
FD. NAIL & TAG NO.18998 IN NORTH SIDE OF 18" WALNUT, S70W, 25.92'
FD. BAR AND CAP NO.18998 IN NORTH SIDE OF OAK, N75W, 33.63'

SURVEY SHOWS A DISTANCE NORTH TO M-10 OF 2667.40'
13. NO OTHER REFERENCES FOUND.

LAND CORNER RECORDATION CERTIFICATE
Filing Requirement of Act 74, Mich. P.A. 1970

Liber 9 Page 201

For corners in

INGHAM

Located in:

Corner Code #

(County)
INGHAM TOWNSHIP

1. Public Land Survey

T 2NR 1E M-12

T R

T R

T R

2. Property Controlling
in Section

S T R

S T R

3. Miscellaneous
Property in Sec.

S T R

S T R

FILED

970029265
08/06/1997 09:00:04
REGISTER OF DEEDS
Paula Johnson
INGHAM COUNTY, MI

Register of Deeds Stamp & File Number

4. Lot No. , Recorded Plat

5. Private Claims

I, DAVID R. LOHR, in a field survey on 3/28, 19 97 do hereby state that under requirements of P.A. 74, Michigan P.A. of 1970, the corner points mentioned in lines 1 and 2 above were in conformance with regulations and rules therefore as required in the current manual of survey instructions of the United States Department of the Interior, Bureau of Land Management or by a decree of a Court of Law and /or that the corner points mentioned in lines 3, 4 and 5 above were in conformance with the rules of the Michigan Board of Land Surveyors or by a Decree of a Court of Law; established, re-established, monumented, recovered, found as expressed below:

NOTE: Not more than 2 corners, all in the same town and range, may be recorded on this certificate.

	A	B	C	D	E	F	G	H	I	J	K	L	M
1													
2	6			5		4		3		2		1	
3													
4	7			8		9		10		11		12	
5													
6	18			17		16		15		14		13	
7													
8	19			20		21		22		23		24	
9													
10	30			29		28		27		26		25	
11													
12	31			32		33		34		35		36	
13													

A. Description of original monument and accessories and/or subsequent restoration:

M-12: 1. CORNER SET BY JOSEPH WAMPLER IN FEB. 1824. (EXTERIOR BOUNDARY - INGHAM TOWNSHIP) "SET QT. POST - FW" WITNESSED BY:

TAM 13 N 62 1/2 W 24 LKS (15.84')

TAM 9 S 23 W 18 LKS (11.88')

NOTES SHOW DISTANCES NORTH & SOUTH OF 40 CH. (2640.0')

2. GLO. NOTES REPEATED IN WHITE OAK TOWNSHIP - (WEST BOUNDARY).

BY JOSEPH WAMPLER, DATED FEB. 1826: SAME WITNESSES AS ITEM #1:

CONTINUED ON BACK

B. Description of corner evidence found and/or method applied in restoring or reestablishing corner:

M-12: SEARCHED AT APPARENT LOCATION OF CORNER AND FOUND 1/2" IRON/CAP #18989 AS PER ITEM #6-PART A. FOUND FOUTY'S WITNESS TO NORTHEAST. ALSO FOUND 1/2" IRON W/CAP #25832 2.28 FT. SOUTH AT A-12 WHITE-OAK AS PER ITEM #8 -PART A. THERE ARE TWO ANCHOR POSTS, BOTH WITH FENCES RUNNING TO NORTH, SOUTH AND EAST. SURVEYOR FOUTY USED WRONG ANCHOR POST WHEN HE SET CORNER AS A-12 WHITE-OAK. ACCEPTED 1/2" IRON/CAP #18989 AS CORNER AS PER TESTIMONY OF SURVEYOR BRYAN IN ITEM #8-PART A. REPLACED 1/2" IRON WITH STANDARD 3/4" X 24" REMON. BAR AND PA #345 CAP #30090.

C. Description of monument for corner and accessories established to perpetuate locating the position of the corner:

M-12: SET STANDARD 3/4" X 24" REMON. BAR AND PA#345 CAP #30090 AT LOCATION OF IRON OF LIBER 6, PAGE 234. CORNER FALLS 2.28 FT. NORTH OF CORNER A-12, WHITE OAK TWP. WITNESSED BY:

FD. N&T #18998 E/S 15" ASH, AZ. 05 DEG., 21.35'

SET N&T #30090 W/S 8" OAK, AZ. 37 DEG., 12.52'

FD. N&T #18998 S/S 12" CHERRY, AZ. 80 DEG., 14.35'

SET N&T #30090 S/S 10" ASH, AZ. 90 DEG., 26.32'

SET N&T #30090 E/S 8" ASH, AZ. 180 DEG., 29.45'

FD. N&T #18998 N/S 15" OAK, AZ. 243 DEG., 13.62'

3/4" BAR W/CAP #30090 (A-12 WH.OAK), AZ. 180 DEG., 2.28'

Signed by David R. Lohr

Date 6-16-97

Surveyor's Michigan License No. 30090

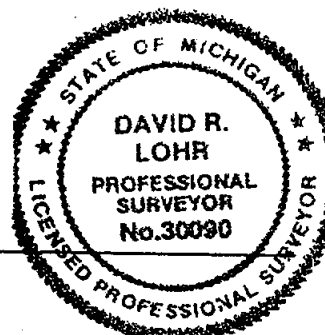

3. CORNER REFERENCED IN SURVEY BY A. JACKSON, COUNTY SURVEYOR, DATED MAY 25, 1839, RECORDED IN FOLDER 1, PAGE 76, (CETA-REMON. DOSSIER). NO MENTION OF MONUMENT OR WITNESSES GIVEN. DOUBLING THE DISTANCE FROM L-12 TO THE NORTH 1/8 CORNER OF THE SOUTHEAST 1/4 (THE NORTHEAST CORNER OF THE SURVEY AS SHOWN) WOULD BE 40.32 CH. (2661.12') FROM M-12 TO L-12.
4. CORNER REFERENCED IN SURVEY BY A. JACKSON, COUNTY SURVEYOR, DATED MAY 25, 1840, RECORDED IN BOOK 4, PAGE 138. THIS ENTRY IS A COPY OF ITEM #3.
5. NO REFERENCE MADE ON INGHAM COUNTY GRID MAP, DATED JAN. 1969.
6. LCRC BY MARVIN FOUTY, PS #18989, DATED 11/08/75, RECORDED IN LIBER 5, PAGE 204, (FOR A-12, WHITE OAK TWP.) STATES: "THE SOUTH 1/2 OF THE SECTION WAS SURVEYED IN JUNE 1900 BY COUNTY SURVEYOR E.A. CALKINS WHO SET AN OAK POST WITH STONE AND ACCESSORIES. CORNER POSITION OCCUPIED BY NEWER ANCHOR POST WITH FENCES NORTH, SOUTH AND EAST... SET 1/2" BAR AND CAP AT BASE OF ANCHOR POST... WITNESSED BY:
NAIL & TAG EAST SIDE 14" MAPLE, NORTH, 21.30'
NAIL & TAG WEST SIDE 6" BEECH, NE, 12.70'
NAIL & TAG NORTH SIDE 6" CHERRY, ENE, 15.03'
7. SURVEY #163, BY MARVIN FOUTY, PS #19989, DATED 11/08/75, RECORDED IN LIBER 2, PAGE 692, (IN THE NORTHEAST 1/4 OF SECTION 31, WHITE OAK TWP.) STATES: "WEST 1/4 CORNER, SECTION 31, T2N, R2E, SET 1/2" BAR & CAP... WITNESSED BY:
NAIL & TAG EAST SIDE 14" MAPLE, NORTH, 21.30'
NAIL & TAG WEST SIDE 6" BEECH, NE, 12.70'
NAIL & TAG NORTH SIDE 6" CHERRY, ENE, 15.03'
SURVEY SHOWS DISTANCE EAST TO C-12 OF 5041.87
8. LCRC BY LARRY BRYAN, PS #25832, DATED 11/20/80, RECORDED IN LIBER 6, PAGE 234, STATES: "ORIGINAL MONUMENT AND ACCESSORIES OBLITERATED... FOUND 1/2" BAR W/CAP AS RECORDED IN LIBER 5, PAGE 204, (A-12, WHITE OAK TWP.) ALSO FOUND ANCHOR POST WITH FENCES N-S-E 2.28' SOUTH. MEASURED NORTH AND SOUTH IN CLOSE ACCORD WITH G.L.O. DISTANCES. ACCEPTED FOUND BAR AT EAST 1/4 CORNER SECTION 36... EAST 1/4 CORNER SECTION 36, FOUND 1/2" BAR W/CAP", WITNESSED BY:
SET 1/2" BAR W/CAP AT WEST 1/4 CORNER SECTION 31, T2N, R2W, SOUTH, 2.28'
SET NAIL & TAG SOUTHEAST SIDE 12" ASH, S35W, 12.42'
SET NAIL & TAG WEST SIDE 8" ELM, N10E, 12.70'
SET NAIL & TAG SOUTH SIDE 8" WILD CHERRY, N45E, 14.72'
9. SURVEY #80-B-520, BY LARRY BRYAN, PS #25832, DATED 11/20/80, RECORDED IN LIBER 7, PAGE 484, STATES: "EAST 1/4 CORNER, SECTION 36, T2N, R1E, FD. 1/2" BAR W/CAP "FOUTY" RECORDED AS WEST 1/4 CORNER SECTION 31, T2N, R2E." WITNESSED BY SAME AS ITEM #8.
SURVEY SHOWS A DISTANCE SOUTH TO M-13 OF 2644.23'
SURVEY SHOWS A DISTANCE NORTH TO M-11 OF 2640.08'
SURVEY SHOWS A DISTANCE WEST TO L-12 OF 2659.05'
10. LCRC BY LARRY BRYAN, PS #25832, DATED 03/20/85, RECORDED IN LIBER 6, PAGE 267, STATES: "ORIGINAL MONUMENT AND ACCESSORIES OBLITERATED... FOUND 1/2" BAR & CAP FOUTY, RECORDED AS WEST 1/4 CORNER SECTION 31, T2N, R2E, LIBER 3, PAGE 562." WITNESSED BY:
SET NAIL & TAG SOUTHEAST SIDE 12" ASH, S35W, 12.42'
SET NAIL & TAG WEST SIDE 8" ELM, N10E, 12.70'
SET NAIL & TAG SOUTH SIDE 8" WILD CHERRY, N45E, 14.72'
1/2" BAR & CAP #25832 WEST 1/4 CORNER SECTION 31, T2N, R2W, SOUTH, 2.28'
11. SURVEY #A-4215, BY RONNIE LESTER, PS #18998, DATED 05/07/92, RECORDED IN LIBER 6, PAGE 998, STATES: "EAST 1/4 CORNER, SECTION 36, T2N, R1E, 1/2" BAR AND CAP (FOUTY) LIBER 6, PAGE 267." WITNESSED BY:
1/2" BAR & CAP #25832 (A-12), 185 AZ., 2.28'
SET NAIL & TAG IN NORTH SIDE 15" OAK, 243 AZ., 13.8'
SET NAIL & TAG IN EAST SIDE 15" ASH, 05 AZ., 21.5'
SET NAIL & TAG IN SOUTH SIDE 12" CHERRY, 80 AZ., 14.6'
FOUND NAIL & TAG IN WEST SIDE 8" DECIDUOUS, 37 AZ., 12.6'
SURVEY SHOWS A DISTANCE NORTH TO M-11 OF 2640.13'
12. NO OTHER REFERENCES FOUND.

LAND CORNER RECORDATION CERTIFICATE
Filing Requirement of Act 74, Mich. P.A. 1970

Liber 9 Page 203

For corners in

INGHAM

(County)

INGHAM TOWNSHIP

1. Public Land Survey

Located In:

Corner Code #

T 2N R 1E M-13

T R

T R

T R

T R

2. Property Controlling
in Section

S T R

3. Miscellaneous
Property in Sec.

S T R

S T R

4. Lot No. , Recorded Plat

5. Private Claims

FILED

970029266
08/06/1997 09:00:06
REGISTER OF DEEDS
Paula Johnson
INGHAM COUNTY, MI

Register of Deeds Stamp & File Number

I, DAVID R. LOHR, in a field survey on 3/25, 19 97 do hereby state that under requirements of P.A. 74, Michigan P.A. of 1970, the corner points mentioned in lines 1 and 2 above were in conformance with regulations and rules therefore as required in the current manual of survey instructions of the United States Department of the Interior, Bureau of Land Management or by a decree of a Court of Law and /or that the corner points mentioned in lines 3, 4 and 5 above were in conformance with the rules of the Michigan Board of Land Surveyors or by a Decree of a Court of Law; established, re-established, monumented, recovered, found as expressed below:

NOTE: Not more than 2 corners, all in the same town and range, may be recorded on this certificate.

A. Description of original monument and accessories and/or subsequent restoration:

M-13: 1. CORNER SET BY JOSEPH WAMPLER IN NOV, 1823. (EXTERIOR BOUNDARY - WHITE OAK TOWNSHIP) "SET POST AT INT. COR. OF T 1 & 2 N., R. 1 & 2 E., fw" WITNESSED BY:

WO 30 in S 19 1/2 W 112 LKS (73.92')

BO 9 " N 30 W 104 LKS (68.64')

NOTES SHOW DISTANCES EAST OF 37.46 CH. (2472.36')

CONTINUED ON BACK

B. Description of corner evidence found and/or method applied in restoring or reestablishing corner:

M-13: SEARCHED AT APPARENT LOCATION OF CORNER AND FOUND 1/2" IRON ON SOUTH SIDE OF 12" ANCHOR POST AS PER ITEM #A-9. ACCEPTED 1/2" AS CORNER BASED ON REVIEW OF SURVEYOR BRYAN'S TRAVERSE OF SECTION 36. ITEM #A-9 SHOWS DISTANCE NORTH OF 2644.23 FT. ITEM #A-10 SHOWS DISTANCE SOUTH OF 2643.94 FT. REPLACED 1/2" IRON WITH STANDARD 3/4" X 24" REMON. BAR AND PA #345 CAP #30090.

C. Description of monument for corner and accessories established to perpetuate locating the position of the corner:

M-13: SET STANDARD 3/4" X 24" REMON. BAR AND PA #345 CAP #30090 AT LOCATION OF 1/2" IRON ON SO. SIDE OF ANCHOR POST AT FENCE INTERSECTION. WITNESSED BY:
FD. N&T #18998, S/S 24" OAK, AZ. 66 DEG., 22.60'
FD. 1/2" IRON/CAP #21275, AZ. 90 DEG., 65.90'
SET N&T #30090, SW/S TRI. MAPLE, AZ. 132 DEG., 43.50'
FD. N&T #18998, E/S 12" CHERRY, AZ. 180 DEG., 5.84'
SET N&T #30090, W/S 30" OAK, AZ. 181 DEG., 45.10'
FD. N&T #18998, SE/S 15" ASH, AZ. 220 DEG., 1.67'

Signed by

David R. Lohr

Date

6-16-97

Surveyor's Michigan License No.

30090

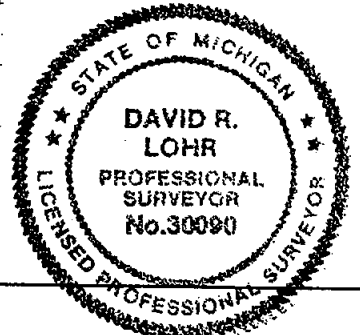

2. TEMP. CORNER??? SET BY JOSEPH WAMPLER ON FEB. 4, 1824. (EXTERIOR BOUNDARY - BUNKERHILL TOWNSHIP) "SET TEMP. POST FOR CORNER OF TOWNS 1 & 2 N., R. 1 & 2 E." WITNESSED BY:
 WO 30 S 19 1/2 W 112 LKS (73.92')
 BO 9 N 30 W 104 LKS (68.64')
 MARGINAL NOTE: LARGE STONE R.OAK 9 N 16 E (NEW) 33LKS. (21.78")
 NOTES SHOW DISTANCES SOUTH OF 40 CH. (2640.0')
3. CORNER REFERENCED IN SURVEY BY E. A. CALKINS, COUNTY SURVEYOR, DATED JUNE 9, 1900, RECORDED IN BOOK 1, PAGE 40, (STEADMAN'S INDEX VOL.5, PG.40). CORNER NOTED AS "STONE" WITNESSED BY: B. OAK 8", S 89 1/2 E, 49 LKS (32.34')
 DOUBLE B. OAK 20", N 15 E, 32 LKS (21.12')
 SURVEY SHOWS DISTANCE NORTH OF 40.085 CH.(2645.61')
 SURVEY SHOWS DISTANCE EAST OF 37.70 CH.(2488.20')
4. NO REFERENCE MADE ON INGHAM COUNTY GRID MAP, DATED JAN. 1969.
5. LCRC, BY AUSTIN C. WILLIAMS, PS #21275, DATED 5/03/78, RECORDED IN LIBER 5, PAGE 152, STATES: "ORIGINAL MONUMENT AND ACCESSORIES OBLITERATED...FOUND 1/2" IRON ROD AT INTERSECTION OF NORTH, SOUTH & EAST FENCE LINES ON SOUTH SIDE OF ANCHOR POST...NW CORNER SECTION 6, T1N, R2E." WITNESSED BY: 20" OAK, NAIL & TAG, N 75 E, 23.21'
 NAIL & TAG IN 14" MAPLE, S 40 W, 1.60'
 12" TWIN MAPLE, S 35 E, 43.50'
6. SURVEY #1688, BY AUSTIN C. WILLIAMS, PS #21275, DATED 5/06/78, RECORDED IN LIBER 3, PAGE 425, STATES: "NW CORNER OF SECTION 6, T1N, R2E." NO MENTION OF MONUMENT. WITNESSED BY:
 NAIL & TAG IN 20" OAK, N 75 E, 23.21'
 NAIL & TAG IN 14" MAPLE, S 40 W, 1.60'
 NAIL & TAG IN 12" TW. MAPLE, S 35 E, 43.50'
7. SURVEY #240, BY MARVIN FOUTY, PS #18989, DATED 08/05/78, RECORDED IN LIBER 3, PAGE 556, STATES: "NE COR., SEC. 1, T1N, R1E, FD. IRON PIPE FROM WITNESSES: TAGS IN 20" OAK, N 75 E, 23.21'
 14" MAPLE, S 40 W, 1.60'
 12" TW. MAP., S 35 E, 43.50'
 SURVEY SHOWS A DISTANCE SOUTH TO M-2 OF 2644.36'
8. SURVEY #2003, BY AUSTIN C. WILLIAMS, PS #21275, DATED AUG. 1980, RECORDED IN LIBER 4, PAGE 138, STATES: "NW CORNER SEC. 6, T1N, R2E." NO MENTION OF MONUMENT. WITNESSED BY:
 NAIL & TAG IN 20" OAK, N 75 E, 23.21'
 NAIL & TAG IN 14" MAPLE, S 40 W, 1.60'
 NAIL & TAG IN 12" TW. MAPLE, S 35 E, 43.50'
 SURVEY SHOWS A DISTANCE EAST TO C-1 OF 4923.70'
 SURVEY SHOWS A DISTANCE SOUTH TO C/L DEXTER TRAIL OF 1759.16'
9. SURVEY BY LARRY BRYAN, PS #25832, DATED 11/20/80, RECORDED IN LIBER 7, PAGE 484, STATES: "SOUTHEAST CORNER SECTION 36, T2N, R1E, FOUND 1/2" BAR AT FENCE INTERSECTION." WITNESSED BY:
 FD. 1/2" BAR W/CAP R.L.S. #21275, EAST, 65.90'
 FD. NAIL & TAG, SE/S 15" ASH, S 45 W, 1.52'
 FD. NAIL & TAG SOUTHEAST SIDE 20" OAK, N 45 E, 23.35'
 SURVEY SHOWS A DISTANCE NORTH TO M-12 OF 2644.23'
 SURVEY SHOWS A DISTANCE WEST TO L-13 OF 2652.87'
10. SURVEY #A-4136, BY RONNIE LESTER, PS #18998, DATED 05/19/89, RECORDED IN LIBER 5, PAGE 1066, STATES: "NORTHEAST CORNER, SECTION 1, T1N, R1E, L 5, P 152. FOUND 1/2" BAR AT BASE FENCE POST." WITNESSED BY:
 SET NAIL & TAG IN S.E. SIDE 18" HICKORY, 220 AZ., 1.7'
 FOUND NAIL AND SHINER IN S.W. SIDE TRIPLE MAPLE, 132 AZ., 43.4'
 SET NAIL & TAG IN SOUTH SIDE 24" OAK, 66 AZ., 22.6'
 SET NAIL & TAG IN WEST SIDE 30" OAK, 185 AZ., 45.1'
 SURVEY SHOWS A DISTANCE SOUTH TO M-2 OF 2643.94'
11. UNRECORDED SURVEY BY LARRY BRYAN, PS #25832, JOB NUMBER 90-B-29711, DATED 07/10/90, STATES: "SOUTHEAST CORNER SECTION 36, T2N, R1E, LIBER 5, PAGE 152, FOUND 1/2" BAR AT FENCE INTERSECTION." WITNESSED BY:
 FOUND NAIL & TAG, SOUTHEAST SIDE 15" ASH, S 45 W, 1.52'
 FOUND NAIL & TAG SOUTHEAST SIDE 20" OAK, N 45 E, 23.35'
 FOUND 1/2" BAR&CAP #21275, EAST, 65.90'
 SURVEY SHOWS A DISTANCE WEST TO L-13 OF 2652.87'
12. NO OTHER REFERENCES FOUND.

LAND CORNER RECORDATION CERTIFICATE

Filing Requirement of Act 74, Mich. P.A. 1970 Liber

9 Page 205

For corners in

INGHAM

Located In:

Corner Code #

(County)

WHITE OAK TOWNSHIP

1. Public Land Survey

T 2N R 2E A-11

T R

T R

T R

2. Property Controlling in Section

S T R

S T R

3. Miscellaneous Property in Sec.

S T R

S T R

FILED

970029257
08/06/1997 09:00:08
REGISTER OF DEEDS
Paula Johnson
INGHAM COUNTY, MI

Register of Deeds Stamp & File Number

4. Lot No. , Recorded Plat

5. Private Claims

I, DAVID R. LOHR, in a field survey on 3/25, 1997 do hereby state that under requirements of P.A. 74, Michigan P.A. of 1970, the corner points mentioned in lines 1 and 2 above were in conformance with regulations and rules therefore as required in the current manual of survey instructions of the United States Department of the Interior, Bureau of Land Management or by a decree of a Court of Law and /or that the corner points mentioned in lines 3, 4 and 5 above were in conformance with the rules of the Michigan Board of Land Surveyors or by a Decree of a Court of Law; established, re-established, monumented, recovered, found as expressed below:

NOTE: Not more than 2 corners, all in the same town and range, may be recorded on this certificate.

A. Description of original monument and accessories and/or subsequent restoration:

A-11: 1. CORNER SET BY JOSEPH WAMPLER, DEP. SURVEYOR, IN NOV. 1823.
"INT W. BD. 7 LKS (4.62') S. OF P, SET P. AT ??? COR. OF 30 & 31, FW"
RO (RED OAK) 23 S 17 E 116 LKS (76.56')
"NO OTHERS"
NOTES SHOW DISTANCE EAST TO B-11 OF 34.31 CH. (2264.46')

CONTINUED ON BACK

B. Description of corner evidence found and/or method applied in restoring or reestablishing corner:

A-11: SEARCHED AT APPARENT LOCATION OF CORNER AND FOUND 3/4" PIPE AS PER ITEM #A-5. ALSO FOUND 1/2" IRON W/CAP #18998 AT M-11 INGHAM TWP. AS PER ITEM #A-7. ACCEPTED 3/4" PIPE AS CORNER. BASED ON TESTIMONY OF SURVEYOR STEADMAN IN ITEM #A-5. COULD NOT REMOVE PIPE, LEFT IN PLACE AND SET PA #345 CAP #30090 ON TOP OF PIPE.

C. Description of monument for corner and accessories established to perpetuate locating the position of the corner:

A-11: 3/4" PIPE WITH PA#345 CAP #30090 AS PER LIBER 3, PAGE 355. CORNER FALLS 4.70 FT. SOUTH OF M-11 INGHAM TOWNSHIP.
C/L 6" ST. GATE POST (NORTHERLY), AZ. 69-02-00, 81.84'
C/L 6" ST. GATE POST (SOUTHERLY), AZ. 80-06-00, 77.33'
SET N&T #30090, N/S 12" ELM, AZ. 103-36-30, 41.00'
SET N&T #30090, W/S 15" CHERRY, AZ. 164-43-00, 77.84'
FD. N&T #18998, NE/S 20" WALNUT, AZ. 259-55-00, 24.50'
FD. N&T #18998, N/S 20" OAK, AZ. 295-07-30, 35.27'
M-11, ING. TWP. 3/4" REMON. BAR, AZ. 360-00-00, 4.62'

WITNESSED BY

Signed by David R. Lohr
Surveyor's Michigan License No. 30090

Date 6-16-97

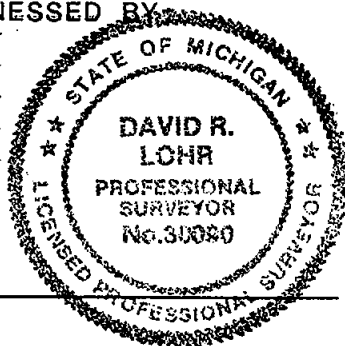

A-11: WHITE OAK TOWNSHIP, PART A - CONTINUED

2. CORNER REFERENCED IN SURVEY BY E. A. CALKINS, DEPUTY COUNTY SURVEYOR, DATED MAY 31 THRU JUNE 4, 1900, RECORDED IN BOOK 1, PAGE 40. NO REFERENCE TO MONUMENT OR WITNESSES.
3. NO REFERENCE MADE ON INGHAM COUNTY GRID MAP, DATED JAN. 1969.
4. LCRC BY RICHARD STEADMAN, PS #11370, DATED 6/16/73, RECORDED IN LIBER 3, PAGE 355, STATES: "ORIGINAL MONUMENT: WOOD POST SET BY JOSEPH WAMPLER, U.S. DEPUTY SURVEYOR IN 1825. BEARING TREES: 23" R. OAK S17E 116 LKS., NO OTHER. I FIND NO PUBLIC RECORD OF A RESTORATION OF THIS CORNER. DUG LARGE, DEEP HOLE IN MEECH ROAD, BUT FOUND NOTHING. RE-ESTABLISHED CORNER OPPOSITE FENCE EAST AND ON NORTHERLY EXTENSION OF FENCE WHICH BEGINS AT SOUTH EDGE OF SWAN ROAD INTERSECTION AND RUNS SOUTH TO WEST 1/4 CORNER OF SECTION 31 (WOOD ANCHOR POST). SET 3/4" IRON PIPE FOR CORNER AT ABOVE DESCRIBED LOCATION. WITNESSED BY:
 3/4" IRON PIPE, EAST, 33.02'
 14" WALNUT, WSW, 24.74'
 12" OAK, WNW, 15.21'
 LARGEST TRUNK OF TRIPLE W. CHERRY, SSE, 77.69'
5. TRAVERSE POINT WITNESS REPORT (CETA REMON PROGRAM, 1978) DATED 4/5/78, STATES: "FOUND 3/4" PIPE W/CAP RLS 11370 ACCORDING TO LIBER 3, PG. 355, ON PHYSICAL C/L OF MEECH RD, DUE WEST OF FENCE LINE EAST 8" BELOW ROAD SURFACE." WITNESSED BY:
 S 25 E, 77.77' FD. N&T 11370 ON W. SIDE 10" WILD CHERRY
 S 85 W, 24.77' FD. N&T 11370 ON S. SIDE 16" WALNUT
 N 82 W, 35.24' FD. N&T 11370 ON NE. SIDE 14" OAK
 DUE E., 33.02' FD. 3/4" PIPE W/RLS 11370 CAP
6. LCRC BY RONNIE LESTER, PS #18998, DATED 11/24/76, RECORDED IN LIBER 4, PAGE 13, RECORDING THE LOCATION OF M-11 INGHAM TOWNSHIP STATES: M-11: "SET 1/2" BAR & CAP ON TOWNSHIP LINE AT GLO FALLING NORTH OF SW CORNER OF SECTION 30, T2N, R2E, INGHAM COUNTY, MICHIGAN, AS RECORDED IN LIBER 3, PAGE 355." SURVEYOR LESTER GOES ON TO USE THIS CORNER (A-11) AS A WITNESS: "SW CORNER, SECTION 30, T2N, R2E, 1/2" PIPE & CAP, SOUTH, 4.62'."
7. SURVEY #80-B-520, BY LARRY BRYAN, PS #25832, DATED 11/20/80, RECORDED IN LIBER 7, PAGE 484, FOR A PARCEL LOCATED IN SECTION 36, T2N, R1E, INGHAM TOWNSHIP, USES THIS CORNER (A-11) AS A WITNESS TO M-11 INGHAM TOWNSHIP. "FD. 3/4" PIPE AT NORTHWEST CORNER OF SECTION 31, T2N, R2E, SOUTH, 4.55'."
8. SURVEY #89627, BY RON HELSEL, PS #18994, DATED 11/27/89, RECORDED IN LIBER 6, PAGE 526, STATES: "NW CORNER, SECTION 31, T2N, R2E, INGHAM COUNTY, MICHIGAN, L3, P.355. NO MENTION OF MONUMENT. SAME WITNESSES AS ITEM #5."
9. SURVEY #91-2183, BY RON HELSEL, PS #18994, DATED 07/01/91, RECORDED IN LIBER 7, PAGE 407, STATES: NORTHWEST CORNER, SECTION 31, T2N, R2E. NO MENTION OF MONUMENT OR WITNESSES.
10. SURVEY #A-4214, BY RONNIE LESTER, PS #18998, DATED 04/28/92, RECORDED IN LIBER 6, PAGE 958, STATES: "NORTHWEST CORNER, SECTION 31, T2N, R2E. 3/4" PIPE, LIBER 3, PAGE 355. WITNESSED BY:
 SET NAIL & TAG IN NORTH SIDE 20" WALNUT, 260 AZ., 24.5'
 SET NAIL & TAG ON WEST SIDE 15" CHERRY, 168 AZ., 77.9'
 CENTERLINE OF 6" STEEL GATE POST, 83 AZ., 76.9'
 CENTERLINE OF 6" STEEL GATE POST, 73 AZ., 81.9'
 SET NAIL & TAG IN N. E. SIDE 20" OAK, 295 AZ., 35.2'
 M-11, INGHAM TOWNSHIP, 1/2" BAR, 05 AZ., 4.7'
 SURVEY SHOWS A DISTANCE SOUTH TO A-12 OF 2637.79'
11. NO OTHER REFERENCES FOUND.

LAND CORNER RECORDATION CERTIFICATE
Filing Requirement of Act 74, Mich. P.A. 1970

Liber

9 Page 207

For corners in

FILED

970029268
08/06/1997 09:00:09
REGISTER OF DEEDS
Paula Johnson
INGHAM COUNTY, MI

INGHAM Located In: Corner Code #
(County)
WHITE OAK TOWNSHIP
1. Public Land Survey T 2N R 2E A-12
T R
T R
T R
2. Property Controlling S T R
in Section S T R
3. Miscellaneous S T R
Property in Sec. S T R

Register of Deeds Stamp & File Number

4. Lot No. , Recorded Plat
5. Private Claims

I, DAVID R. LOHR, in a field survey on 3/28, 19 97 do hereby state that under requirements of P.A. 74, Michigan P.A. of 1970, the corner points mentioned in lines 1 and 2 above were in conformance with regulations and rules therefore as required in the current manual of survey instructions of the United States Department of the Interior, Bureau of Land Management or by a decree of a Court of Law and/or that the corner points mentioned in lines 3, 4 and 5 above were in conformance with the rules of the Michigan Board of Land Surveyors or by a Decree of a Court of Law; established, re-established, monumented, recovered, found as expressed below:

NOTE: Not more than 2 corners, all in the same town and range, may be recorded on this certificate.

A. Description of original monument and accessories and/or subsequent restoration:

A-12: 1. CORNER NOT SET IN GLO SURVEY.

2. CORNER REFERENCED IN SURVEY BY E. A. CALKINS, DEP. COUNTY SURVEYOR, DATED MAY 31 THRU JUNE 4, 1900, RECORDED IN BOOK 1, PAGE 40. "SET OAK POST WITH STONE FW BEARS 3 1/2 lks (2.31') SOUTH OF INGHAM POST. SURVEY SHOWS DISTANCE SOUTH TO A-13 OF 40.085 CH. (2645.61') AND DISTANCE EAST TO B-12 OF 36.20 CH. (2389.2')

B. Description of corner evidence found and/or method applied in restoring or reestablishing corner:

A-12: SEARCHED AT APPARENT LOCATION OF CORNER AND FOUND 1/2" IRON/CAP #25832 AS PER ITEM #A-12. ALSO FOUND 1/2" IRON W/CAP #18989 (FOUTY) 2.28 FT. NORTH AT M-12 INGHAM TWP. AS PER ITEM A-5. FOUTY'S CORNER (#A-3) IS INCORRECTLY RECORDED AS A-12, WHITE-OAK. COUNTY SURVEYOR CALKINS (ITEM #A-2) CALLS FOR CORNER TO BE 2.31 FT. SOUTH OF M-12, INGHAM TWP. ACCEPTED 1/2" IRON /CAP #25832 AS CORNER AS PER TESTIMONY OF SURVEYOR BRYAN IN ITEM #A-9. REPLACED 1/2" IRON WITH STAND. 3/4" X 24" REMON. BAR & PA #345 CAP #30090.

C. Description of monument for corner and accessories established to perpetuate locating the position of the corner:

A-12: SET STANDARD 3/4" X 24" REMON. BAR AND PA#345 CAP #30090 AT LOCATION OF IRON, LIBER 6, PAGE 272. CORNER FALLS 2.28 FT. SOUTH OF INGHAM, M-12.

WITNESSED BY:

FD. N&T #18998, E/S 15" ASH, AZ. 05 DEG., 23.60'
SET N&T #30090, W/S 8" OAK, AZ. 40 DEG., 14.60'
SET N&T #30090, S/S 10" ASH, AZ. 85 DEG., 26.50'
FD. N&T #18998, S/S 12" CHERRY, AZ. 90 DEG., 15.28'
SET N&T #30090, E/S 8" ASH, AZ. 180 DEG., 27.25'
FD. N&T #18998, N/S 15" OAK, AZ. 256 DEG., 12.82'

Signed by David R. Lohr 3/4 BAR/CAP #30090, M-12, INGHAM TWP., AZ. 00 DEG., 2.28'
Surveyor's Michigan License No. 30090 Date 6-16-97



A-12: WHITE OAK TOWNSHIP, PART A - CONTINUED

3. LCRC BY MARVIN FOUTY, PS #18989, DATED 11/08/75, RECORDED IN LIBER 3, PG. 562, STATES: "THE SOUTH 1/2 OF THE SECTION WAS SURVEYED IN JUNE 1900, BY COUNTY SURVEYOR E.A. CALKINS WHO SET AN OAK POST WITH STONE AND ACCESSORIES. CORNER POSITION OCCUPIED BY NEWER ANCHOR POST WITH FENCES NORTH, SOUTH AND EAST... SET 1/2" BAR AND CAP AT BASE OF ANCHOR POST... WITNESSED BY:
 - NAIL & TAG SE SIDE 22" MAPLE, WEST, 25.82'
 - NAIL & TAG NORTH SIDE 32" OAK, EAST, 20.38'
 - NAIL & TAG W SIDE 26" MAPLE, NE, 35.75'
4. LCRC BY MARVIN FOUTY, PS #18989, DATED 11/08/75, RECORDED IN LIBER 5, PG. 204, STATES: "THE SOUTH 1/2 OF THE SECTION WAS SURVEYED IN JUNE 1900, BY COUNTY SURVEYOR E.A. CALKINS WHO SET AN OAK POST WITH STONE AND ACCESSORIES. CORNER POSITION OCCUPIED BY NEWER ANCHOR POST WITH FENCES NORTH, SOUTH AND EAST... SET 1/2" BAR AND CAP AT BASE OF ANCHOR POST... WITNESSED BY:
 - NAIL & TAG EAST SIDE 14" MAPLE, NORTH, 21.30'
 - NAIL & TAG WEST SIDE 6" BEECH, NE, 12.70'
 - NAIL & TAG NORTH SIDE 6" CHERRY, ENE, 15.03'
5. SURVEY #163, BY MARVIN FOUTY, PS #18989, DATED 11/08/75, RECORDED IN LIBER 2, PAGE 692, STATES: "WEST 1/4 CORNER, SECTION 31, T2N, R2E, SET 1/2" BAR & CAP... WITNESSED BY:
 - NAIL & TAG EAST SIDE 14" MAPLE, NORTH, 21.30'
 - NAIL & TAG WEST SIDE 6" BEECH, NE, 12.70'
 - NAIL & TAG NORTH SIDE 6" CHERRY, ENE, 15.03'
 SURVEY SHOWS DISTANCE EAST TO C-12 OF 5041.87
6. SURVEY #1850, BY AUSTIN C. WILLIAMS, PS #21275, DATED APRIL 1979, RECORDED IN LIBER 3, PAGE 953, STATES: "WEST 1/4 CORNER, SEC. 31, T2N, R2E, NO MENTION OF MONUMENT... WITNESSED BY:
 - NAIL & TAG E/S 14" MAPLE, NORTH, 21.30'
 - NAIL & TAG W/S 6" BEECH, NE, 12.70'
 - NAIL & TAG N/S 6" CHERRY, ENE, 15.03'
 SURVEY SHOWS DISTANCE EAST TO C-12 OF 5041.87
7. LCRC BY LARRY BRYAN, PS #25832, DATED 11/04/80, RECORDED IN LIBER 6, PAGE 272, STATES: "ORIGINAL MONUMENT AND ACCESSORIES OBLITERATED... SET 1/2" BAR & CAP AT ANCHOR POST ON TOWNSHIP LINE IN CLOSE ACCORD WITH G.L.O. MEASUREMENTS. WITNESSED BY:
 - SET NAIL & TAG WEST SIDE 8" ELM, N10E, 14.67'
 - SET NAIL & TAG SOUTH SIDE 8" WILD CHERRY, N45E, 15.50'
 - FOUND 1/2" BAR W/CAP "FOUTY" AT BASE OF ANCHOR POST, NORTH, 2.28'.
8. SURVEY #80-B-520, BY LARRY BRYAN, PS #25832, DATED 11/20/80, RECORDED IN LIBER 7, PAGE 484, STATES: "WEST 1/4 CORNER, SECTION 31, T2N, R2E, SET 1/2" BAR W/CAP AT ANCHOR POST ON TOWNSHIP LINE." WITNESSED SAME AS ITEM #9. SURVEY SHOWS A DISTANCE SOUTH TO A-13 OF 2641.95'. SURVEY SHOWS A DISTANCE NORTH TO M-12 INGHAM OF 2.28'.
9. SURVEY #91-2183, BY RON HELSEL, PS #18994, DATED 07/01/91, (REV. 1-4-94) RECORDED IN LIBER 7, PAGE 407, STATES: "WEST 1/4 CORNER, SECTION 31, T2N, R2E. NO MENTION OF MONUMENT OR WITNESSES. SURVEY SHOWS A DISTANCE EAST TO C-12 OF 5041.87'.
10. SURVEY #A-4214, BY RONNIE LESTER, PS #18998, DATED 04/28/92, RECORDED IN LIBER 6, PAGE 958, STATES: "WEST 1/4 CORNER, SECTION 31, T2N, R2E. 1/2" BAR & CAP LIBER 6, PAGE 272. WITNESSED BY:
 - SET NAIL & TAG IN EAST SIDE 15" ASH, 05 AZ., 23.7'
 - SET NAIL & TAG IN SOUTH SIDE 12" CHERRY, 73 AZ., 15.4'
 - SET NAIL & TAG IN NORTH SIDE 15" OAK, 256 AZ., 12.9'
 - FOUND NAIL AND TAG WEST SIDE 8" DECIDUOUS, 40 AZ., 14.8'
 - M-12, INGHAM TOWNSHIP, 1/2" BAR AND CAP, 05 AZ., 2.28'
 SURVEY SHOWS A DISTANCE NORTH TO A-11 OF 2637.79'
 SURVEY SHOWS A DISTANCE EAST TO C-12 OF 5040.80'
11. NO OTHER REFERENCES FOUND.

LAND CORNER RECORDATION CERTIFICATE
Filing Requirement of Act 74, Mich. P.A. 1970

Liber

9 Page 209

For corners in

INGHAM

Located In:

Corner Code #

(County)

BUNKERHILL TOWNSHIP

1. Public Land Survey

T 1N R 1E K-1

2. Property Controlling
in Section

S T R

3. Miscellaneous
Property in Sec.

S T R

4. Lot No. , Recorded Plat

5. Private Claims

FILED

970029269
08/06/1997 09:00:11
REGISTER OF DEEDS
Paula Johnson
INGHAM COUNTY, MI

Register of Deeds Stamp & File Number

I, DAVID R. LOHR, in a field survey on 3/28, 19 97 do hereby state that under requirements of P.A. 74, Michigan P.A. of 1970, the corner points mentioned in lines 1 and 2 above were in conformance with regulations and rules therefore as required in the current manual of survey instructions of the United States Department of the Interior, Bureau of Land Management or by a decree of a Court of Law and/or that the corner points mentioned in lines 3, 4 and 5 above were in conformance with the rules of the Michigan Board of Land Surveyors or by a Decree of a Court of Law; established, re-established, monumented, recovered, found as expressed below:

NOTE: Not more than 2 corners, all in the same town and range, may be recorded on this certificate.

A. Description of original monument and accessories and/or subsequent restoration:

K-1: 1. CORNER SET BY JOSEPH WAMPLER, DEP SURVEYOR, IN FEB., 1826.
"INTERSECT. THE TOWNSHIP LINE 37 LKS EAST" (24.42')
WITNESSED BY: B.O. 11 S 63 W, 34 1/2 LKS (22.77')
" 9 S 60 E, 33 1/2 LKS (22.11')
"NEW" W. OAK 3 N 8 W, 51 LKS (33.66')
NOTES SHOW DISTANCE SOUTH OF 43.27 CH. (2855.82')

CONTINUED ON BACK

B. Description of corner evidence found and/or method applied in restoring or reestablishing corner:

K-1: SEARCHED AT APPARENT LOCATION OF CORNER AND FOUND 1/2" IRON, 10" DEEP, ON FENCE TO SOUTH, AS PER ITEM #A-7. CORNER FALLS 27 FT. NORTH OF 6" X 8" R.R. TIE ANCHOR POST. DID NOT EXCAVATE CORNER DUE TO PREVIOUS EXCAVATION OF 1977, (ITEM A-7. ACCEPTED 1/2" IRON AS CORNER AS PER TESTIMONY OF SURVEYOR BRYAN IN ITEM #A-7. REPLACED 1/2" IRON WITH STANDARD 3/4" X 24" REMON. BAR AND PA #345 CAP #30090. REVIEW OF TRAVERSE DATA FROM BRYAN SURVEY IN SECTION 36, INGHAM TOWNSHIP, JOB #90-B-29711, PLACES THIS CORNER 2641.82 FT. WEST OF L-1.

C. Description of monument for corner and accessories established to perpetuate locating the position of the corner:

K-1: SET STANDARD 3/4" X 24" REMON. BAR AND PA#345 CAP #30090 AT LOCATION OF 1/2" IRON: WITNESSED BY:

SET N&T #30090, E/S 12" CHERRY, AZ. 214-32-30, 55.90'
SET N&T #30090, S/S 36" OAK, AZ. 291-59-00, 62.15'
K-13 INGHAM, 3/4" REMON. BAR, AZ. 270-00-00, 27.05' (GLO=24.42')
SET N&T #30090, E/S 36" OAK, AZ. 309-50-30, 45.64'
FD. N&T #25832, S/S 48" OAK, AZ. 338-55-00, 25.75'

Signed by

David R. Lohr

Date 6-16-97

Surveyor's Michigan License No. 30090



K-1: BUNKERHILL TOWNSHIP, PART A - CONTINUED

2. CORNER REFERENCED IN SURVEY BY A. JACKSON, CO. SURVEYOR, DATED MAY 20, 1843, RECORDED IN BOOK 4, PAGE 116. (OLD VOL. 1, PG. 117) NO MENTION OF MONUMENT OR WITNESSES.
3. CORNER REFERENCED IN SURVEY BY A.P. DRAKE, CO. SURVEYOR, DATED APRIL 16, 1880, RECORDED IN BOOK 3, PAGE 31, (OLD VOL. 3, PG. 172). "POST", WITNESSED BY:
W.O. 3, N 8 W, 51 LKS (33.66')

SURVEY SHOWS DISTANCE EAST TO L-1 OF 40.02 CH. (2641.32')

SURVEY SHOWS DISTANCE SOUTH TO K-2 OF 45.90 CH. (3029.40')

4. CORNER NOT REFERENCED ON INGHAM COUNTY GRID MAP, DATED JAN. 1969,
5. LCRC, BY OSCAR BOSS, RLS #13574, DATED 05/31/73, RECORDED IN LIBER 5, PAGE 10. "K-1:(ORIGINAL) UNKNOWN... 1/2" IRON SET AT INTERSECTION OF ROAD AND FENCE LINE SOUTH." WITNESSED BY: IRON, S 89 E, 33.0'
NAIL S/S 40" OAK, N 20 W, 26.30'
NAIL TOP STUMP, N 53 E, 34.52'
6. CORNER REFERENCED IN SURVEY #3823, BY OSCAR BOSS, RLS #13574, DATED 06/04/73, RECORDED IN LIBER 1, PAGE 835. "NW COR., SEC. 1, T1N, R1E, 1/2" IRON SET."
WITNESSED BY: S 89 E, 33.0 IRON
N 20 W, 26.30, NAIL S/S 40" OAK
N 53 E, 34.52, NAIL TOP STUMP

SURVEY SHOWS DISTANCE EAST TO L-1 OF 2629.55' (ACTUALLY L-13, INGHAM TWP.)

SURVEY SHOWS DISTANCE SOUTH TO K-2 OF 3036.35'

7. CORNER EXCAVATION REPORT (CETA PROJECT) DATED 11/21/1977, BY LARRY BRYAN, FIELD SUPERINTENDENT, STATES: "FD. 1/2" IRON," WITNESSED BY:
OAK 41" DIA. N 20 W 26.30' NAIL W/TAPE FROM OLD WITNESSES ON
SW SIDE OF TREE WAS THERE AND USED.
OAK 6" DIA. N 20 E 28.94' TAG & NAIL SET ON SE SIDE OF TREE
BLACK CHERRY 8" DIA. S 30 W 56.20' NAIL & TAG SET ON SE SIDE OF TREE.
OAK 38" DIA. N 35 W 45.60' TAG & NAIL SET ON E. SIDE OF TREE.
FD. OLD WITNESS W/RLS#13574 ON OLD STUMP BUT WAS NOT USED BECAUSE STUMP
WAS ROTTEN.

REPORT SHOWS THAT A 4' X 4' X 3.5' DEEP HOLE WAS EXCAVATED AROUND 1/2" IRON
REPORT DOES NOT STATE IF ANYTHING WAS RECOVERED. REPORT FURTHER STATES
THAT "RESET NEW 1/2" IRON BAR W/CAP. IN CENTER OF EXCAVATION SITE."
(LOCATION OF PREVIOUS 1/2" IRON BAR)

8. NO OTHER REFERENCES FOUND.

LAND CORNER RECORDATION CERTIFICATE
Filing Requirement of Act 74, Mich. P.A. 1970

Liber

9 Page

213

For corners in

INGHAM

(County)

Located In:

Corner Code #

BUNKERHILL TOWNSHIP

1. Public Land Survey

T 1N R 1E

1-1

T R

T R

T R

T R

2. Property Controlling
in Section

S T R

S T R

3. Miscellaneous
Property in Sec.

S T R

S T R

FILED

970029271
08/06/1997 09:00:14
REGISTER OF DEEDS
Paula Johnson
INGHAM COUNTY, MI

Register of Deeds Stamp & File Number

4. Lot No. , Recorded Plat

5. Private Claims

I, DAVID R. LOHR, in a field survey on 3/28, 1997 do hereby state that under requirements of P.A. 74, Michigan P.A. of 1970, the corner points mentioned in lines 1 and 2 above were in conformance with regulations and rules therefore as required in the current manual of survey instructions of the United States Department of the Interior, Bureau of Land Management or by a decree of a Court of Law and/or that the corner points mentioned in lines 3, 4 and 5 above were in conformance with the rules of the Michigan Board of Land Surveyors or by a Decree of a Court of Law; established, re-established, monumented, recovered, found as expressed below:

NOTE: Not more than 2 corners, all in the same town and range, may be recorded on this certificate.

A. Description of original monument and accessories and/or subsequent restoration:

L-1: 1. CORNER NOT SET IN G.L.O. SURVEY.

2. CORNER REFERENCED IN SURVEY BY A. JACKSON, CO. SURVEYOR, DATED MAY 20, 1843, RECORDED IN BOOK 4, PAGE 116. (OLD VOL. 1, PG.117).

NO MENTION OF MONUMENT. WITNESSED BY: "NO TREES"

NOTES SHOW DISTANCE SOUTH TO 1/8 CORNER OF 91 R, 18L. (1513.38')

CONTINUED ON BACK

B. Description of corner evidence found and/or method applied in restoring or reestablishing corner:

L-1: SEARCHED AT APPARENT LOCATION OF CORNER AND FOUND ONLY WITNESSES TO SOUTH AND SOUTHWEST. THESE ARE THE SAME WITNESSES AS THAT OF L-13, INGHAM TWP. ROAD HAS BEEN REBUILT AND APPROX. 3 FEET OF NEW FILL PLACED. DID NOT EXCAVATE AREA DUE TO RECENT ROAD CONSTRUCTION AND FACT THAT ENTIRE AREA IS IN SWAMP FILL SECTION. THIS CORNER HAS BEEN CONFUSED WITH L-13, INGHAM TOWNSHIP, EVEN THOUGH IT WAS SET BY DRAKE IN 1880. SET CORNER ON TOWNSHIP LINE AT NOTED DISTANCE OF 12.21' (ITEM #A-3) EAST OF L-13, INGHAM TWP. SET STANDARD 3/4" X 24" REMON. BAR AND PA #345 CAP #30090. DISTANCE EAST TO M-1 OF 2640.66 FT. AND WEST TO K-1 OF 2641.89' OBTAINED BY COMPARISON TO RECORDED DISTANCES ON SURVEY RECORDED IN LIBER 7, PAGE 484.

C. Description of monument for corner and accessories established to perpetuate locating the position of the corner:

L-1: SET STANDARD 3/4" X 24" REMON. BAR AND PA#345 CAP #30090 ON TOWNSHIP LINE AT 12.21 FT. EAST OF L-13, INGHAM TWP. WITNESSED BY:

SET N&T #30090, E/S P. POLE,

AZ. 204-48-00, 217.63'

SET N&T #30090, W/S 3" ELM,

AZ. 210-55-00, 29.72'

SET N&T #30090, N/S 36" COTTONWOOD,

AZ. 250-26-30, 160.66'

3/4" REMON. BAR L-13, INGHAM TWP.

AZ. 270-00-00, 12.21'

SET N&T #30090, S/S 12" ELM,

AZ. 293-27-00, 96.30'

Signed by

David R. Lohr

Date

6-16-97

Surveyor's Michigan License No.

30090

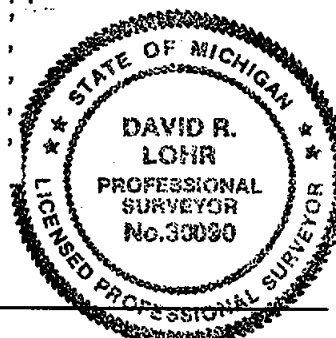

3. CORNER REFERENCED IN SURVEY BY A.P.DRAKE, CO. SURVEYOR, DATED APRIL 16, 1880, RECORDED IN BOOK 3, PAGE 31, (OLD VOL.3, PG. 172). "A POINT, 18 1/2 LKS (12.21') EAST FROM INGHAM 1/4 POST". NO WITNESSES GIVEN.
(THIS IS EQUAL TO 1/2 THE RECORDED G.L.O. FALLING AT K-1, BUNKERHILL)
SURVEY SHOWS DISTANCE SOUTH TO 1/8 CORNER OF 22.21 CH. (1465.86')
SURVEY SHOWS DISTANCE SOUTH TO L-2 OF 42.97 CH. (2836.02')
4. CORNER NOT REFERENCED ON INGHAM COUNTY GRID MAP, DATED JAN. 1969,
5. CORNER REFERENCED IN SURVEY #2929, BY OSCAR BOSS, RLS #13574, DATED 08/03/72, RECORDED IN LIBER 1, PAGE 566. "N 1/4 COR., SEC. 1, T1N, R1E, 1/2" PIPE FOUND." WITNESSED BY: S 65 W, 150.07, NAIL N. SIDE 36" TREE
S 32 W, 14.89, NAIL N. SIDE WHITE POST
S 81 E, 162.39, N. SIDE YIELD SIGN POST
(NOTE: CORNER USED WAS L-13, INGHAM TOWNSHIP.)
6. LCRC, BY OSCAR BOSS, RLS #13574, DATED 08/04/72, RECORDED IN LIBER 2, PAGE 57. "L-1:(ORIGINAL) UNKNOWN...1/2" PIPE FOUND." SAME WITNESSES AS ITEM #5.
7. CORNER REFERENCED IN SURVEY #3634, BY OSCAR BOSS, RLS #13574, DATED 02/21/73, RECORDED IN LIBER 1, PAGE 810. "N 1/4 COR., SEC. 1, T1N, R1E, 1/2" PIPE FOUND." SAME WITNESSES AS ITEM #5. SURVEY SHOWS DISTANCE SOUTH TO L-2 OF 2833.02'
(NOTE: CORNER USED WAS L-13, INGHAM TOWNSHIP.)
8. CORNER REFERENCED IN SURVEY #3823, BY OSCAR BOSS, RLS #13574, DATED 06/04/73, RECORDED IN LIBER 1, PAGE 835. "N 1/4 COR., SEC. 1, T1N, R1E, 1/2" PIPE FOUND." SAME WITNESSES AS ITEM #5. SURVEY SHOWS DISTANCE SOUTH TO L-2 OF 2833.02'
(NOTE: CORNER USED WAS L-13, INGHAM TOWNSHIP.)
9. LCRC, BY OSCAR BOSS, RLS #13574, DATED 04/10/74, RECORDED IN LIBER 5, PAGE 175. "L-13:(INGHAM TWP.) (ORIGINAL) UNKNOWN...FND. 1/2" PIPE IN EWERS ROAD." SAME WITNESSES AS ITEM #5. NOTE: THIS CORNER USED AS L-13 INGHAM TWP.
10. CORNER REFERENCED IN SURVEY #4589, BY OSCAR BOSS, RLS #13574, DATED 04/10/74, RECORDED IN LIBER 1, PAGE 1232. "S 1/4 COR., SEC. 36, T2N, R1E, 1/2" PIPE FD." SAME WITNESSES AS ITEM #5. SURVEY SHOWS DISTANCE WEST TO K-13 OF 2656.68' NOTE: THIS CORNER USED AS L-13 INGHAM TWP.
11. CORNER REFERENCED IN SURVEY #4779, BY OSCAR BOSS, RLS #13574, DATED 05/13/74, RECORDED IN LIBER 1, PAGE 1254. "S 1/4 COR., SEC. 36, T2N, R1E, 1/2" PIPE FD." SAME WITNESSES AS ITEM #5.
NOTE: THIS CORNER USED AS L-13 INGHAM TWP.
12. CORNER REFERENCED IN SURVEY #80-B-574, BY LARRY A. BRYAN, RLS #25832, DATED 11/20/80, RECORDED IN LIBER 7, PAGE 480. "S 1/4 COR., SEC. 36, T2N, R1E, FD. 3/4" PIPE IN CENTERLINE OF ROAD, LIBER 5, PAGE 175."
WITNESSED BY: FD. NAIL NORTH SIDE 30" COTTONWOOD, S 65 W, 150.07
FD. IRON FENCE POST, N 10 W, 18.90'
FD. NAIL EAST SIDE POWER POLE, S 35 W, 212.56'
NOTE: THIS CORNER USED AS L-13 INGHAM TWP.
13. NO OTHER REFERENCES FOUND.