

2927

FILING REQUIREMENT OF ACT 74, MICH. P.A. 1970

1456

270 57

FOR CORNER OF -:

LOCATED 44-2

CORNER CODE NUMBER

FILED

F. PUBLIC LAND SURVEY 1 E. 1 S. 1 W. 6-1

2. PROPERTY CONTROL: _____ S. _____
 _____ IN SECTION _____ S. _____

3. MISCELLANEOUS
PROPERTY IN SECTION _____

b. [REDACTED] NO. [REDACTED] [REDACTED], RE: [REDACTED] ID # [REDACTED]

5. PRIVATE CLAIMS

AUG 48 12 30 PM '77

REGISTER OF DEEDS

Grand M. Lewis
INGHAM COUNTY, MICH.

REGISTER OF DEEDS STAMP AND
FILING NUMBER

I, **OSCAR BOSS**, do hereby certify that under requirements of P.A. 74, Michigan P.A. of 1970, the corner points mentioned in lines 1 and 2 above identified with circles on index code diagram - over - were, in a field survey on **AUGUST 4, 1972**, established, re established, monumented, re monumented, recovered or restored as expressed below and in conformance with regulations and rules therefore as required in the current manual of survey instructions of the United States Department of the Interior, Bureau of Land Management or by a Decree of a court of law. Furthermore, that the corner points mentioned in lines 3, 4 and 5 above were, in a field survey on **AUGUST 4, 1972**, found, recovered, restored, established or re established as expressed below and in conformance with the rules of the Michigan State Board of Registration for Land Surveyors or, by a Decree of a Court of Law.

A. Description of original monument and accessories and of subsequent restoration:
4-1 UNKNOWN

11. Description of corner evidence found and the method applied in restoring or re-establishing corner:
L-1 1/2" PIPE FOUND

6. Description of monument for corners and accessories established to perpetuate locating the position of the corner:

L-1 44-1114

S. 65° W. 150.07 NAIL NORTH SIDE 36" COTTONWOOD
S. 32° W. 14.89 NAIL NORTH SIDE WHITE POST
S. 81° E. 162.39 NORTH SIDE FIELD SIGN POST

SIGNED BY *Quinn Boud*

DATE 8-23-72

SURVEYOR'S MICHIGAN REGISTRATION NO. 13574

FOR STATE AND UNITED STATES AGENCIES:

SIGNED BY

13. A. 11

APPROVED AND SIGNED BY

12411

SURVEYOR'S MICHIGAN REGISTRATION NO.

151

Form No. 20, 10/1/75
U.S. DEPT. OF JUSTICE: OFFICE OF THE ATTORNEY GENERAL, WASHINGTON, D.C. 20530

FOUO - INFORMATION NOT FOR RELEASE TO THE PUBLIC OR FOR DISSEMINATION TO ANY OTHER AGENCY, AND IS NOT TO BE USED IN ANY MANNER THAT COULD BE DETRIMENTAL TO THE NATIONAL DEFENSE.

SOURCE: CORNER RECORDATION CERTIFICATE

TRANSCRIBED from ORIGINAL on file at REGISTER OF DEEDS
~~DUPLICATE~~

INGHAM

LAND CORNER RECORDATION CERTIFICATE
FILING REQUIREMENT OF ACT 74, MICH. P.A. 1970

FOR CORNERS OF--	LOCATED IN--	CORNER CODE NUMBER
1. PUBLIC LAND SURVEY... 36.3 T 2 N. R. 1 E		K-12, K-13, L-12, H-3
2. PROPERTY CONTROLLING IN SECTION... T N. S. R. E		
3. MISCELLANEOUS PROPERTY IN SECTION... T N. S. R. E		
4. LOT NO. RECORDED PLAT		
5. PRIVATE CLAIMS		

LIBER 38 247

FILED

OCT 12 46 PM '74

REGISTER OF DEEDS

Emile M. Lewis
INGHAM COUNTY, MICH.

REGISTER OF DEEDS STAMP AND
FILING NUMBER

I, Oscar Boss do hereby certify that under requirements of P.A. 74, Michigan P.A. of 1970 the corner points mentioned in lines 1 and 2 above (identified with circles on index code diagram - over) were, in a field survey on April 17 1974, established, re-established, monumented, re-monumented, recovered or restored as expressed below and in conformance with regulations and rules therefore as required in the current manual of survey instructions of the United States Department of the Interior, Bureau of Land Management or by a decree of a court of law. Furthermore, that the corner points mentioned in lines 3, 4 and 5 above were, in a field survey on 19, found, recovered, restored, established or re-established as expressed below and in conformance with the rules of the Michigan State Board of Registration for Land Surveyors or, by a Decree of a Court of law:

A. Description of original monument and accessories and/or subsequent restoration:

K-12 Unknown
K-13 Unknown
L-12 Unknown
H-3 Unknown

B. Description of corner evidence found and/or method applied in restoring or re-establishing corner:

K-12 1/2" iron set (fence intersection)
K-13 1/2" iron set (on fence to North)
L-12 1/2" iron set
H-3 1" pipe fd. set at split & on line between SW corner Sec. 4

C. Description of monument for corner and accessories established to perpetuate locating the position of the corner

K-12 W 1/4 corner, Sec. 36 West 11.47 Nail set N/S Db1. trunked tree 12" S. 10°W. 22.94 Nail set E/S 30" Oak S. 35°E. 18.6 Nail set N/E/S 24" Oak	L-12 Center Section, Section 36 S. 85°E. 5.06 Nail set N/S 4" tree N. 88°W. 22.27 Nail set S/S Multi-trunked tree N. 45°W. 15.45 Nail set S/S Multi-trunked tree
K-13 SW corner, Sec. 36 Due East NW corner, Sec. 1, T1N-R1E, iron 27" N. 40°E. 29.99 Nail set S/S 40" Oak N. 70°E. 57.35 Nail set top stump	H-3 S 1/4 CORNER, Section 3 S. 72°E. 104.23 Nail N/S 24" tree S. 12°E. 27.8 West edge cem fence post N. 2°W. 25.55 base of angle post

SIGNED BY Oscar Boss DATE 10-27-74

SURVEYOR'S MICHIGAN REGISTRATION NO. 13574

FOR STATE AND UNITED STATES AGENCIES:

SIGNED BY CHIEF OF SURVEY PARTY DATE

APPROVED AND SIGNED BY MICHIGAN REGISTERED LAND SURVEYOR DATE

SURVEYOR'S MICHIGAN REGISTRATION NO.

Form No. M-10720
Revised 1974 - 1975, 1976, 1977, 1978, 1979, 1980, 1981, 1982, 1983, 1984, 1985, 1986, 1987, 1988, 1989, 1990, 1991, 1992, 1993, 1994, 1995, 1996, 1997, 1998, 1999, 2000, 2001, 2002, 2003, 2004, 2005, 2006, 2007, 2008, 2009, 2010, 2011, 2012, 2013, 2014, 2015, 2016, 2017, 2018, 2019, 2020, 2021, 2022, 2023, 2024, 2025, 2026, 2027, 2028, 2029, 2030, 2031, 2032, 2033, 2034, 2035, 2036, 2037, 2038, 2039, 2040, 2041, 2042, 2043, 2044, 2045, 2046, 2047, 2048, 2049, 2050, 2051, 2052, 2053, 2054, 2055, 2056, 2057, 2058, 2059, 2060, 2061, 2062, 2063, 2064, 2065, 2066, 2067, 2068, 2069, 2070, 2071, 2072, 2073, 2074, 2075, 2076, 2077, 2078, 2079, 2080, 2081, 2082, 2083, 2084, 2085, 2086, 2087, 2088, 2089, 2090, 2091, 2092, 2093, 2094, 2095, 2096, 2097, 2098, 2099, 2100, 2101, 2102, 2103, 2104, 2105, 2106, 2107, 2108, 2109, 2110, 2111, 2112, 2113, 2114, 2115, 2116, 2117, 2118, 2119, 2120, 2121, 2122, 2123, 2124, 2125, 2126, 2127, 2128, 2129, 2130, 2131, 2132, 2133, 2134, 2135, 2136, 2137, 2138, 2139, 2140, 2141, 2142, 2143, 2144, 2145, 2146, 2147, 2148, 2149, 2150, 2151, 2152, 2153, 2154, 2155, 2156, 2157, 2158, 2159, 2160, 2161, 2162, 2163, 2164, 2165, 2166, 2167, 2168, 2169, 2170, 2171, 2172, 2173, 2174, 2175, 2176, 2177, 2178, 2179, 2180, 2181, 2182, 2183, 2184, 2185, 2186, 2187, 2188, 2189, 2190, 2191, 2192, 2193, 2194, 2195, 2196, 2197, 2198, 2199, 2200, 2201, 2202, 2203, 2204, 2205, 2206, 2207, 2208, 2209, 2210, 2211, 2212, 2213, 2214, 2215, 2216, 2217, 2218, 2219, 2220, 2221, 2222, 2223, 2224, 2225, 2226, 2227, 2228, 2229, 2230, 2231, 2232, 2233, 2234, 2235, 2236, 2237, 2238, 2239, 2240, 2241, 2242, 2243, 2244, 2245, 2246, 2247, 2248, 2249, 2250, 2251, 2252, 2253, 2254, 2255, 2256, 2257, 2258, 2259, 2260, 2261, 2262, 2263, 2264, 2265, 2266, 2267, 2268, 2269, 2270, 2271, 2272, 2273, 2274, 2275, 2276, 2277, 2278, 2279, 2280, 2281, 2282, 2283, 2284, 2285, 2286, 2287, 2288, 2289, 2290, 2291, 2292, 2293, 2294, 2295, 2296, 2297, 2298, 2299, 2300, 2301, 2302, 2303, 2304, 2305, 2306, 2307, 2308, 2309, 2310, 2311, 2312, 2313, 2314, 2315, 2316, 2317, 2318, 2319, 2320, 2321, 2322, 2323, 2324, 2325, 2326, 2327, 2328, 2329, 2330, 2331, 2332, 2333, 2334, 2335, 2336, 2337, 2338, 2339, 2340, 2341, 2342, 2343, 2344, 2345, 2346, 2347, 2348, 2349, 2350, 2351, 2352, 2353, 2354, 2355, 2356, 2357, 2358, 2359, 2360, 2361, 2362, 2363, 2364, 2365, 2366, 2367, 2368, 2369, 2370, 2371, 2372, 2373, 2374, 2375, 2376, 2377, 2378, 2379, 2380, 2381, 2382, 2383, 2384, 2385, 2386, 2387, 2388, 2389, 2390, 2391, 2392, 2393, 2394, 2395, 2396, 2397, 2398, 2399, 2400, 2401, 2402, 2403, 2404, 2405, 2406, 2407, 2408, 2409, 2410, 2411, 2412, 2413, 2414, 2415, 2416, 2417, 2418, 2419, 2420, 2421, 2422, 2423, 2424, 2425, 2426, 2427, 2428, 2429, 2430, 2431, 2432, 2433, 2434, 2435, 2436, 2437, 2438, 2439, 2440, 2441, 2442, 2443, 2444, 2445, 2446, 2447, 2448, 2449, 2450, 2451, 2452, 2453, 2454, 2455, 2456, 2457, 2458, 2459, 2460, 2461, 2462, 2463, 2464, 2465, 2466, 2467, 2468, 2469, 2470, 2471, 2472, 2473, 2474, 2475, 2476, 2477, 2478, 2479, 2480, 2481, 2482, 2483, 2484, 2485, 2486, 2487, 2488, 2489, 2490, 2491, 2492, 2493, 2494, 2495, 2496, 2497, 2498, 2499, 2500, 2501, 2502, 2503, 2504, 2505, 2506, 2507, 2508, 2509, 2510, 2511, 2512, 2513, 2514, 2515, 2516, 2517, 2518, 2519, 2520, 2521, 2522, 2523, 2524, 2525, 2526, 2527, 2528, 2529, 2530, 2531, 2532, 2533, 2534, 2535, 2536, 2537, 2538, 2539, 2540, 2541, 2542, 2543, 2544, 2545, 2546, 2547, 2548, 2549, 2550, 2551, 2552, 2553, 2554, 2555, 2556, 2557, 2558, 2559, 2560, 2561, 2562, 2563, 2564, 2565, 2566, 2567, 2568, 2569, 2570, 2571, 2572, 2573, 2574, 2575, 2576, 2577, 2578, 2579, 2580, 2581, 2582, 2583, 2584, 2585, 2586, 2587, 2588, 2589, 2590, 2591, 2592, 2593, 2594, 2595, 2596, 2597, 2598, 2599, 2600, 2601, 2602, 2603, 2604, 2605, 2606, 2607, 2608, 2609, 2610, 2611, 2612, 2613, 2614, 2615, 2616, 2617, 2618, 2619, 2620, 2621, 2622, 2623, 2624, 2625, 2626, 2627, 2628, 2629, 2630, 2631, 2632, 2633, 2634, 2635, 2636, 2637, 2638, 2639, 2640, 2641, 2642, 2643, 2644, 2645, 2646, 2647, 2648, 2649, 2650, 2651, 2652, 2653, 2654, 2655, 2656, 2657, 2658, 2659, 2660, 2661, 2662, 2663, 2664, 2665, 2666, 2667, 2668, 2669, 2670, 2671, 2672, 2673, 2674, 2675, 2676, 2677, 2678, 2679, 2680, 2681, 2682, 2683, 2684, 2685, 2686, 2687, 2688, 2689, 2690, 2691, 2692, 2693, 2694, 2695, 2696, 2697, 2698, 2699, 2700, 2701, 2702, 2703, 2704, 2705, 2706, 2707, 2708, 2709, 2710, 2711, 2712, 2713, 2714, 2715, 2716, 2717, 2718, 2719, 2720, 2721, 2722, 2723, 2724, 2725, 2726, 2727, 2728, 2729, 2730, 2731, 2732, 2733, 2734, 2735, 2736, 2737, 2738, 2739, 2740, 2741, 2742, 2743, 2744, 2745, 2746, 2747, 2748, 2749, 2750, 2751, 2752, 2753, 2754, 2755, 2756, 2757, 2758, 2759, 2760, 2761, 2762, 2763, 2764, 2765, 2766, 2767, 2768, 2769, 2770, 2771, 2772, 2773, 2774, 2775, 2776, 2777, 2778, 2779, 2780, 2781, 2782, 2783, 2784, 2785, 2786, 2787, 2788, 2789, 2790, 2791, 2792, 2793, 2794, 2795, 2796, 2797, 2798, 2799, 2800, 2801, 2802, 2803, 2804, 2805, 2806, 2807, 2808, 2809, 2810, 2811, 2812, 2813, 2814, 2815, 2816, 2817, 2818, 2819, 2820, 2821, 2822, 2823, 2824, 2825, 2826, 2827, 2828, 2829, 2830, 2831, 2832, 2833, 2834, 2835, 2836, 2837, 2838, 2839, 2840, 2841, 2842, 2843, 2844, 2845, 2846, 2847, 2848, 2849, 2850, 2851, 2852, 2853, 2854, 2855, 2856, 2857, 2858, 2859, 2860, 2861, 2862, 2863, 2864, 2865, 2866, 2867, 2868, 2869, 2870, 2871, 2872, 2873, 2874, 2875, 2876, 2877, 2878, 2879, 2880, 2881, 2882, 2883, 2884, 2885, 2886, 2887, 2888, 2889, 2890, 2891, 2892, 2893, 2894, 2895, 2896, 2897, 2898, 2899, 2900, 2901, 2902, 2903, 2904, 2905, 2906, 2907, 2908, 2909, 2910, 2911, 2912, 2913, 2914, 2915, 2916, 2917, 2918, 2919, 2920, 2921, 2922, 2923, 2924, 2925, 2926, 2927, 2928, 2929, 2930, 2931, 2932, 2933, 2934, 2935, 2936, 2937, 2938, 2939, 2940, 2941, 2942, 2943, 2944, 2945, 2946, 2947, 2948, 2949, 2950, 2951, 2952, 2953, 2954, 2955, 2956, 2957, 2958, 2959, 2960, 2961, 2962, 2963, 2964, 2965, 2966, 2967, 2968, 2969, 2970, 2971, 2972, 2973, 2974, 2975, 2976, 2977, 2978, 2979, 2980, 2981, 2982, 2983, 2984, 2985, 2986, 2987, 2988, 2989, 2990, 2991, 2992, 2993, 2994, 2995, 2996, 2997, 2998, 2999, 3000, 3001, 3002, 3003, 3004, 3005, 3006, 3007, 3008, 3009, 3010, 3011, 3012, 3013, 3014, 3015, 3016, 3017, 3018, 3019, 3020, 3021, 3022, 3023, 3024, 3025, 3026, 3027, 3028, 3029, 3030, 3031, 3032, 3033, 3034, 3035, 3036, 3037, 3038, 3039, 3040, 3041, 3042, 3043, 3044, 3045, 3046, 3047, 3048, 3049, 3050, 3051, 3052, 3053, 3054, 3055, 3056, 3057, 3058, 3059, 3060, 3061, 3062, 3063, 3064, 3065, 3066, 3067, 3068, 3069, 3070, 3071, 3072, 3073, 3074, 3075, 3076, 3077, 3078, 3079, 3080, 3081, 3082, 3083, 3084, 3085, 3086, 3087, 3088, 3089, 3090, 3091, 3092, 3093, 3094, 3095, 3096, 3097, 3098, 3099, 3100, 3101, 3102, 3103, 3104, 3105, 3106, 3107, 3108, 3109, 3110, 3111, 3112, 3113, 3114, 3115, 3116, 3117, 3118, 3119, 3120, 3121, 3122, 3123, 3124, 3125, 3126, 3127, 3128, 3129, 3130, 3131, 3132, 3133, 3134, 3135, 3136, 3137, 3138, 3139, 3140, 3141, 3142, 3143, 3144, 3145, 3146, 3147, 3148, 3149, 3150, 3151, 3152, 3153, 3154, 3155, 3156, 3157, 3158, 3159, 3160, 3161, 3162, 3163, 3164, 3165, 3166, 3167, 3168, 3169, 3170, 3171, 3172, 3173, 3174, 3175, 3176, 3177, 3178, 3179, 3180, 3181, 3182, 3183, 3184, 3185, 3186, 3187, 3188, 3189, 3190, 3191, 3192, 3193, 3194, 3195, 3196, 3197, 3198, 3199, 3200, 3201, 3202, 3203, 3204, 3205, 3206, 3207, 3208, 3209, 3210, 3211, 3212, 3213, 3214, 3215, 3216, 3217, 3218, 3219, 3220, 3221, 3222, 3223, 3224, 3225, 3226, 3227, 3228, 3229, 3230, 3231, 3232, 3233, 3234, 3235, 3236, 3237, 3238, 3239, 3240, 3241, 3242, 3243, 3244, 3245, 3246, 3247, 3248, 3249, 3250, 3251, 3252, 3253, 3254, 3255, 3256, 3257, 3258, 3259, 3260, 3261, 3262, 3263, 3264, 3265, 3266, 3267, 3268, 3269, 3270, 3271, 3272, 3273, 3274, 3275, 3276, 3277, 3278, 3279, 3280, 3281, 3282, 3283, 3284, 3285, 3286, 3287, 3288, 3289, 3290, 3291, 3292, 3293, 3294, 3295, 3296, 3297, 3298, 3299, 3300, 3301, 3302, 3303, 3304, 3305, 3306, 3307, 3308, 3309, 3310, 3311, 3312, 3313, 3314, 3315, 3316, 3317, 3318, 3319, 3320, 3321, 3322, 3323, 3324, 3325, 3326, 3327, 3328, 3329, 3330, 3331, 3332, 3333, 3334, 3335, 3336, 3337, 3338, 3339, 3340, 3341, 3342, 3343, 3344, 3345, 3346, 3347, 3348, 3349, 3350, 3351, 3352, 3353, 3354, 3355, 3356, 3357, 3358, 3359, 3360, 3361, 3362, 3363, 3364, 3365, 3366, 3367, 3368, 3369, 3370, 3371, 3372, 3373, 3374, 3375, 3376, 3377, 3378, 3379, 3380, 3381, 3382, 3383, 3384, 3385, 3386, 3387, 3388, 3389, 3390, 3391, 3392, 3393, 3394, 3395, 3396, 3397, 3398, 3399, 3400, 3401, 3402, 3403, 3404, 3405, 3406, 3407, 3408, 3409, 3410, 3411, 3412, 3413, 3414, 3415, 3416, 3417, 3418, 3419, 3420, 3421, 3422, 3423, 3424, 3425, 3426, 3427, 3428, 3429, 3430, 3431, 3432, 3433, 3434, 3435, 3436, 3437, 3438, 3439, 3440, 3441, 3442, 3443, 3444, 3445, 3446, 3447, 3448, 3449, 3450, 3451, 3452, 3453, 3454, 3455, 3456, 3457, 3458, 3459, 3460, 3461, 3462, 3463, 3464, 3465, 3466, 3467, 3468, 3469, 3470, 3471, 3472, 3473, 3474, 3475, 3476, 3477, 3478, 3479, 3480, 3481, 3482, 3483, 3484, 3485, 3486, 3487, 3488, 3489, 3490, 3491, 3492, 3493, 3494, 3495, 3496, 3497, 3498, 3499, 3500, 3501, 3502, 3503, 3504, 3505, 3506, 3507, 3508, 3509, 3510, 3511, 3512, 3513, 3514, 3515, 3516, 3517, 3518, 3519, 3520, 3521, 3522, 3523, 3524, 3525, 3526, 3527, 3528, 3529, 3530, 3531, 3532, 3533, 3534, 3535, 3536, 3537, 3538, 3539, 3540, 3541, 3542, 3543, 3544, 3545, 3546, 3547, 3548, 3549, 3550, 3551, 3552, 3553, 3554, 3555, 3556, 3557, 3558, 3559, 3560, 3561, 3562, 3563, 3564, 3565, 3566, 3567, 3568, 3569, 3570, 3571, 3572, 3573, 3574, 3575, 3576, 3577, 3578, 3579, 3580, 3581, 3582, 3583, 3584, 3585, 3586, 3587, 3588, 3589, 3590, 3591, 3592, 3593, 3594, 3595, 3596, 3597, 3598, 3599, 3600, 3601, 3602, 3603, 3604, 3605, 3606, 3607, 3608, 3609, 3610, 3611, 3612, 3613, 3614, 3615, 3616, 3617, 3618, 3619, 3620, 3621, 3622, 3623, 3624, 3625, 3626, 3627, 3628, 3629, 3630, 3631, 3632, 3633, 3634, 3635, 3636, 3637, 3638, 3639, 3640, 3641, 3642, 3643, 3644, 3645, 3646, 3647, 3648, 3649, 3650, 3651, 3652, 3653, 3654, 3655, 3656, 3657, 3658, 3659, 3660, 3661, 3662, 3663, 3664, 3665, 3666, 3667, 3668, 3669, 3670, 3671, 3672, 3673, 3674, 3675, 3676, 3677, 3678, 3679, 3680, 3681, 3682, 3683, 3684, 3685, 3686, 3687, 3688, 3689, 3690, 3691, 3692, 3693, 3694, 3695, 3696, 3697, 3698, 3699, 3700, 3701, 3702, 3

DUPLICATE

LAND CORNER RECORDATION CERTIFICATE

FILING REQUIREMENT OF ACT 74, MICH. P.A. 1970

LTRER 3 PG 355

FOR CORNERS OF -- LOCATED IN -- CORNER CODE NUMBER

1. PUBLIC LAND SURVEY 1 2N 2 W 2E 1 A-11

2. PROPERTY CONTROL-
ING IN SECTION 1 2N 2 W 2E 1

3. MISCELLANEOUS
PROPERTY IN SECTION 1 2N 2 W 2E 1

4. LOT NO. RECORDED PLAT

5. PRIVATE CLAIMS

FILED

MAR 17 11 21 AM '75
REGISTER OF DEEDS
Ernie M. Lewis
INGHAM COUNTY, MICH

REGISTER OF DEEDS STAMP AND
FILING NUMBER

I, **Richard W. Steadman** do hereby certify that under requirements of P.A. 74, Michigan P.A. of 1970 the corner points mentioned in lines 1 and 2 above (identified with circles on index code diagram - over) were, in a field survey on **June 16 19 73** established, re-established, monumented, re-monumented, recovered or restored as expressed below and in conformance with regulations and rules therefore as required in the current manual of survey instructions of the United States Department of the Interior, Bureau of Land Management or by a decree of a court of law. Furthermore, that the corner points mentioned in lines 3, 4 and 5 above were, in a field survey on 19 found, recovered, restored, established or re-established as expressed below and in conformance with the rules of the Michigan State Board of Registration for Land Surveyors or by a Decree of a Court of law.

A. Description of original monument and accessories and/or subsequent restoration

Original monument: wood post set by Joseph Wampler, U.S. Deputy Surveyor in 1825. Bearing trees: 23" R. Oak S17E 116 lks., no other. I find no public record of a restoration of this corner.

B. Description of corner evidence found and/or method applied in restoring or re-establishing corner:

Dug large, deep hole in Meech Road, but found nothing. Re-established corner opposite fence East and on Northerly extension of fence which begins at south edge of Swan Road intersection and runs South to West 1/4 corner of Section 31 (wood anchor post).

C. Description of monument for corner and accessories established to perpetuate locating the position of the corner

Set 3/4" iron pipe for corner at above described location.

Witnesses:	3/4" iron pipe	East	33.02 ft.
	14" Walnut	W.S.W.	24.74 ft.
	12" Oak	W.N.W.	35.21 ft.
	Largest trunk of triple W. Cherry	S.S.E.	77.69 ft.

SIGNED BY

Richard W. Steadman

DATE February 20, 1975

SURVEYOR'S MICHIGAN REGISTRATION NO 11370

FOR STATE AND UNITED STATES AGENCIES

SIGNED BY

CHIEF OF SURVEY PARTY

DATE

APPROVED AND SIGNED BY

MICHIGAN REGISTERED LAND SURVEYOR

DATE

SURVEYOR'S MICHIGAN REGISTRATION NO.

821

Form No. 68 8-73
HOBBSLEY BROS. & CO. CALAMAZON, MICH

FORM APPROVED BY MICHIGAN STATE BOARD OF REGISTRATION JAN 28 1971
DISTRIBUTED BY MICHIGAN SOCIETY OF REGISTERED LAND SURVEYORS

LAND CORNER RECORDATION CERTIFICATE
FILING REQUIREMENT OF ACT 74, MICH. P.A. 1970

LIBER 3 PG 562
FILED

FOR CORNERS OF -	Sec.	LOCATED IN -	CORNER CODE NUMBER
1. PUBLIC LAND SURVEY	31	2N S. 2E	C11 A12
2. PROPERTY CONTROL		S. R.	
3. MISCELLANEOUS		S. R.	
4. LOT NO.		RECORDED PLAT	
5. PRIVATE CLAIMS			

APR 28 1 59 PM '78
REGISTER OF DEEDS
Carol M. Lewis
INGHAM COUNTY, MICH.
REGISTER OF DEEDS STAMP AND
FILING NUMBER

I, Marvin F. Fouty, do hereby certify that under requirements of P.A. 74, Michigan P.A. of 1970, the corner points mentioned in lines 1 and 2 above were, in a field survey on 11-8, 1975, established, re-established, monumented, re-monumented, recovered or restored as expressed below and in conformance with regulations and rules therefore as required in the current manual of survey instructions of the United States Department of the Interior, Bureau of Land Management or by a decree of a court of law. Furthermore, that the corner points mentioned in lines 3, 4 and 5 above were, in a field survey on 11-8, 1975, found, recovered, restored, established or re-established as expressed below and in conformance with the rules of the Michigan State Board of Registration for Land Surveyors or, by a Decree of a Court of law.

- A. Description of original monument and accessories and/or subsequent restoration:
- C11 Original monument and accessories obliterated. No record of subsequent restoration by the County Surveyor.
 - A12 The South 1/2 of the Section was surveyed in June 1900 by County Surveyor L. A. Calkins who set an oak post with stone and accessories. Corner position occupied by newer anchor post with fences North, South and East.

- B. Description of corner evidence found and/or method applied in restoring or re-establishing corner:
- C11 Set 1/2" bar and cap from adjacent occupation lines.
 - A12 Set 1/2" bar and cap at base of Anchor Post.

- C. Description of monument for corner and accessories established to perpetuate locating the position of the corner:
- C11 W 1/4 Corner Section 31, 12N, R2E 1/2" bar and cap
Nail and tag East side 14" Maple North 21.30'
Nail and tag West side 6" Birch NE 12.70'
Nail and tag North side 6" Cherry NE 15.00'
 - A12 NE Cor. Section 31, 12N, R2E 1/2" bar and cap
Nail and tag SE side 22" Maple West 25.82'
Nail and tag North side 32" Oak East 20.38'
Nail and tag W side 26" Maple NE 35.75'

SIGNED BY Marvin Fouty DATE April 20, 1978
SURVEYOR'S MICHIGAN REGISTRATION NO 18989
FOR STATE AND UNITED STATES AGENCIES:
SIGNED BY _____ DATE _____
APPROVED AND SIGNED BY _____ DATE _____
CHIEF OF SURVEY PARTY
MICHIGAN REGISTERED LAND SURVEYOR

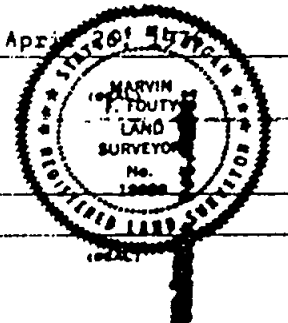

CRIBED from ORIGINAL on file at REGISTER OF DEEDS
~~DUPLICATE~~

LAND CORNER RECORDATION CERTIFICATE

FILING REQUIREMENT OF ACT 74, MICH. P.A. 1970

LIBER 4 13

FOR CORNERS OF: LOCATED IN: CORNER CODE NUMBER

1. PUBLIC LAND SURVEY 25 1 2 1 1 M-10, M-11

2. PROPERTY CONTROLLING IN SECTION N. R. E.

3. MISCELLANEOUS PROPERTY IN SECTION N. R. E.

4. LOT NO. RECORDED PLAT

5. PRIVATE CLAIMS

FILED

MAR 13 4 10 PM '77

REGISTER OF DEEDS
Ingham County, Mich.

REGISTER OF DEEDS STAMP AND FILING NUMBER

I, Ronnie M. Lester, do hereby certify that under requirements of P.A. 74, Michigan P.A. of 1970, the corner points mentioned in lines 1 and 2 above were, in a field survey on November 24, 1976, established, re-established, monumented, re-monumented, recovered or restored as expressed below and in conformance with regulations and rules therefore as required in the current manual of survey instructions of the United States Department of the Interior, Bureau of Land Management or by a decree of a court of law. Furthermore, that the corner points mentioned in lines 3, 4 and 5 above were, in a field survey on 19 found, recovered, restored, established or re-established as expressed below and in conformance with the rules of the Michigan State Board of Registration for Land Surveyors or by a Decree of a Court of law.

A. Description of original monument and accessories and/or subsequent restoration.
M-10 Original monument and accessories obliterated.

M-11 Original monument and accessories lost.

B. Description of corner evidence found and/or method applied in restoring or re-establishing corner.
M-10 Set 1/2" Bar & Cap on Township line on old fence line to West. Corner falls 16.43' North of W 1/4 Corner Sec. 30, T2N, R2E as recorded in Liber 3, Page 349, measure 2647.82' North & 2666.56' South.
M-11 Set 1/2" Bar & Cap on Township line at GLO falling North of SW Corner of Section 30, T2N, R2E, Ingham County, Michigan, as recorded in Liber 3, Page 355.

C. Description of monument for corner and accessories established to perpetuate locating the position of the corner.
M-10 E 1/4 Corner Sec. 25, T2N, R1E, 1/2" Bar & Cap.
Nail & tag #11370 in West side 18" Cherry, NNE, 12.73'
Nail & tag #11370 in South side 10" Hickory, WSW, 32.99'
Nail & tag #11370 in North side 15" Oak, SW, 42.67'
1/2" Bar at W 1/4 Corner Sec. 30, T2N, R2E, South 16.43'
M-11 SE Corner Sec. 25, T2N, R1E, 1/2" Bar & Cap.
Nail & tag in North side 18" Oak, WNW, 33.63'
Nail & tag in North side 18" Walnut, WSW, 25.92'
SW Corner Sec. 30, T2N, R2E, 1/2" Pipe & Cap, South, 4.62'
3/4" Pipe & Cap, ESE, 33.59'

SIGNED BY Ronnie M. Lester DATE Dec 21, 1976

SURVEYOR'S MICHIGAN REGISTRATION NO. 18998

FOR STATE AND UNITED STATES AGENCIES

SIGNED BY _____ DATE _____

APPROVED AND SIGNED BY _____ DATE _____

SURVEYOR'S MICHIGAN REGISTRATION NO. _____



1023

LEG. 5. 10

FOR CORNERS OF: _____ LOCATED IN: _____ CORNER CODE NUMBER _____

1. PUBLIC LAND SURVEY _____

2. PROPERTY CONTROLLED BY _____ K-1; K-2

3. MISCELLANEOUS PROPERTY IN SECTION _____

4. LOT NO. _____, RECORDED PLAT _____

5. PRIVATE CLAIMS _____

REGISTERED AT DEPOS
Paul Johnson
INDIAN COUNTY, WICH.

REGISTER OF DEEDS' STAMP AND
FILING NUMBER _____

I, Oscar Boss, do hereby certify that the requirements of F.A. 74, Major F.A. 1-1970, the corner points mentioned in lines 1 and 2 above were, in a field survey on May 31, 1973, established, reset, identified, monumented, or monumented, removed or re-landed as expressed below and in conformity with regulations and rules thereon as reported in the current map or survey instrument of the United States Department of the Interior, Bureau of Land Management or by a decree of a court of law. Furthermore, that the above points have been monumented, identified and 5 above were, in a field survey on May 31, 1973, found, reset, identified, or identified, in conformity with regulations as expressed below and in conformity with the rules of the Major, Sub-B and 4 illustrations of a field survey on the a Decree of a Court of law.

A Deception of original pronunciation and accessories and of subject's intonation.

K-1 : Unknown

K-2: Unknown

B. Description of corner evidence found and/or method applied in restoring or re-establishing corner:

K-1: 1/2" Iron set at intersection of road and fence line south.

K-2: 1/2" Iron set at intersection of fence lines N-E-W.

C. Description of monument for corner and accessories established to perpetuate locating the position of the corner

Description of monument		Location	
K-1:	NW cor. Sec. 1 Bunker Hill, Set 1/2" Iron Ingham Iron S89°E 33.0' Nail S/S 40" Oak N20°W 26.30' Nail Top stump N53°E 34.52'	W 1/4 Cor. Sec. 1 Bunker Hill, Ingham Set 1/2 " Iron Nail W/S fence post due North 8.51' Nail 1/S 36" tree N50°W 63.5' Nail N/S 6" tree N80°W 113.15'	

SIGNED BY Oscar Bone DATE 9-1-78

SURVEYOR'S MICHIGAN REGISTRATION NO. 13574

FOR STATE AND UNITED STATES AGENCIES:

SIGNED BY _____ DATE _____

APPROVED AND SIGNED BY _____ DATE _____

SURVEYOR'S MICHIGAN REGISTRATION NO. _____

FORM APPROVED BY MICHIGAN STATE BOARD OF HIGHER EDUCATION : JAN 28 1971

1398

MAY PLACE SKETCH ON BACK OR ATTACHED SHEET

LAND CORNER RECORDATION CERTIFICATE

FILING REQUIREMENT OF ACT 74, MICH. PA 1970

FOR CORNERS OF - LOCATED IN - CORNER CODE NUMBER

58 152

300. 1 2 A-1 A-2

FILED

2. PROPERTY CONTROL - INC. IN SECTION

JAN 15 3 36 PM '79

3. MISCELLANEOUS - PROPERTY IN SECTION

REGISTERED

4. LOT NUMBER - RECORDED PLAT

REGISTERED

5. PRIVATE CLAIMS

REGISTERED

I Austin C. Williams do hereby certify that the requirements of Act 74, Michigan, PA 1970, the corner points mentioned in lines 1 and 2 above were in a field survey on May 2, 1978, and were re-established, re-monumented, re-measured, re-located or restored as expressed below and in accordance with the rules and rules therefore as required in the current manual of survey instructions of the Michigan State Board of Land Management or by a decree of a court of law. Furthermore, that the survey was conducted in accordance with the rules and rules therefore as required in the current manual of survey instructions of the Michigan State Board of Land Management or by a decree of a court of law. The survey was conducted in accordance with the rules and rules therefore as required in the current manual of survey instructions of the Michigan State Board of Land Management or by a decree of a court of law. The survey was conducted in accordance with the rules and rules therefore as required in the current manual of survey instructions of the Michigan State Board of Land Management or by a decree of a court of law.

A. Description of original monument and accessories and/or subsequent restoration:

A-1 Original monument and accessories obliterated

A-2 Original monument and accessories obliterated

B. Description of corner evidence found and/or method applied in restoring or re-establishing corner:

A-1 Found 1/2" iron rod at intersection of North, South & East fence lines on south side of anchor post.

A-2 Set 1/2" iron rod with cap at intersection of North, South, & East fence lines. Measurements North & South in close accord with GLO records.

C. Description of monument for corner and accessories established to perpetuate location of the corner:

A-1 NW corner Section 6, T1N, R2E 20" Oak, Nail & tag N75°E 23.21' Nail & tag 14" Maple S40°W 1.60' 12" Twin Maple S35°E 43.50'	A-2 West 1/2 cor. Sec. 6, T1N, R2E Nail & tag 10" Elm North 30.10' Nail & tag 6" Elm S30°E 13.90' Nail & tag 8" Elm N45°E 28.00'
--	---

SIGNED BY Austin C. Williams DATE Jan 16 1979

SURVEYOR'S MICHIGAN REGISTRATION NO. 21275

FOR STATE AND UNITED STATES AGENCIES

SIGNED BY DATE

APPROVED AND SIGNED BY DATE

SURVEYOR'S MICHIGAN REGISTRATION NO.

1539

MAY PLACE SKETCH ON BACK OR ATTACHED SHEET

FORM APPROVED BY MICHIGAN STATE BOARD OF REGISTRATION, JAN 24 1971
REV 122 MAY 1970

LAND CORNER RECORDATION CERTIFICATE FILING REQUIREMENT OF ACT 74, MICH. P.A. 1970

FOR CORNERS OF--

LOCATED IN--

CORNER CODE NUMBER

LIBER

5 PG 175

FILED

JAN 31 10 36 AM '79

REGISTER OF DEEDS
INCHAM COUNTY, MICH.

REGISTER OF DEEDS STAMP AND
FILING NUMBER

1. PUBLIC LAND SURVEY..... T. N. R. E. W.
2. PROPERTY CONTROL..... 36 2 N. R. 1 E. W.
ING IN SECTION
3. MISCELLANEOUS
PROPERTY IN SECTION..... T. N. R. E. W.
4. LOT NO. RECORDED PLAT
5. PRIVATE CLAIMS

L-13 L-13

I, Oscar Ross do hereby certify that under requirements of P.A. 74, Michigan P.A. of 1970, the corner points mentioned in lines 1 and 2 above were, in a field survey on April 10, 1974, established, re-established, monumented, re-monumented, recovered or restored as expressed below and in conformance with regulations and rules therefore as required in the current manual of survey instructions of the United States Department of the Interior, Bureau of Land Management or by a decree of a court of law. Furthermore, that the corner points mentioned in lines 3, 4 and 5 above were, in a field survey on 19, found, recovered, restored, established or re-established as expressed below and in conformance with the rules of the Michigan State Board of Registration for Land Surveyors or, by a Decree of a Court of law:

A. Description of original monument and accessories and or subsequent restoration:

L-13: Unknown

B. Description of corner evidence found and or method applied in restoring or re-establishing corner:

L-13: Fnd. 1/2" Pipe in & Ewers Road.

C. Description of monument for corner and accessories established to perpetuate locating the position of the corner:

L-13: S 1/4 Cor. Sec. 36, T2N-R1E
S65°W 150.07' N. N/S 36" Cottonwood
S32°W 14.89' N. N/S white post
S81°E 162.39' N/S Yield sign post

SIGNED BY Oscar Ross

DATE 1-22-79

SURVEYOR'S MICHIGAN REGISTRATION NO. 13574

FOR STATE AND UNITED STATES AGENCIES:

SIGNED BY CHIEF OF SURVEY PARTY

DATE

APPROVED AND SIGNED BY MICHIGAN REGISTERED LAND SURVEYOR

DATE

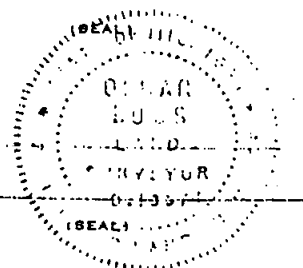

SURVEYOR'S MICHIGAN REGISTRATION NO. 1562 T2N-R1E L-13 ATT. 0

1562

MAY PLACE SKETCH ON BACK OR ATTACHED SHEET

FORM APPROVED BY MICHIGAN STATE BOARD OF REGISTRATION, JAN. 28, 1971
REVISED MAY 14, 1975

LAND CORNER RECORDATION CERTIFICATE

FILING REQUIREMENT OF ACT 74, MICH. P.A. 1970

This Recordation Certificate is to correct the original Recordation Certificate in Liber 3, Page 562. (Witnesses in C below reversed in designation A-12 & C-11)

FOR CORNERS OF -	LOCATED IN -	CORNER CODE NUMBER
1. PUBLIC LAND SURVEY <u>31</u> <u>T. 2N</u> <u>S. R. 2E</u> <u>E.</u>		<u>C11</u> <u>A12</u>
2. PROPERTY CONTROLLING IN SECTION <u>T</u> <u>S. R.</u> <u>E.</u>		
3. MISCELLANEOUS PROPERTY IN SECTION <u>T</u> <u>S. R.</u> <u>E.</u>		
4. LOT NO. _____	RECORDED PLAT _____	
5. PRIVATE CLAIMS _____		

LIBER 58 204
FILED

MAR 13 11 11 AM '79
REGISTER OF DEEDS
Paul Johnson
INGHAM COUNTY, MICH.
REGISTER OF DEEDS STAMP AND
FILING NUMBER

1. Mervin F. Fouty do hereby certify that under requirements of P.A. 74, Michigan P.A. of 1970, the corner points mentioned in lines 1 and 2 above were, in a field survey on 11-8 1975 established, re-established, monumented, re-monumented, recovered or restored as expressed below and in conformance with regulations and rules therefore as required in the current manual of survey instructions of the United States Department of the Interior, Bureau of Land Management or by a decree of a court of law. Furthermore, that the corner points mentioned in lines 3, 4 and 5 above were, in a field survey on _____ 19____ found, recovered, restored, established or re-established as expressed below and in conformance with the rules of the Michigan State Board of Registration for Land Surveyors or, by a Decree of a Court of law:

A. Description of original monument and accessories and/or subsequent restoration:

- C11 Original monument and accessories obliterated. No record of subsequent restoration by the County Surveyor.
- A12 The South 1/2 of the Section was surveyed in June 1900 by County Surveyor E.A. Calkins who set an oak post with stone and accessories. Corner position occupied by newer anchor post with fences North, South and East.

B. Description of corner evidence found and/or method applied in restoring or re-establishing corner:

- C11 Set 1/2" bar and cap from adjacent occupation lines.
- A12 Set 1/2" bar and cap at base of Anchor Post.

C. Description of monument for corner and accessories established to perpetuate locating the position of the corner:

- A12 W 1/4 corner Section 31, T2N, R2E, 1/2" bar and cap
Nail and Tag East side 14" Maple North 21.30'
Nail and Tag West side 6" Beach NE 12.70'
Nail and Tag North side 6" cherry ENE 15.03'
- C11 NE Cor. Section 31, T2N, R2E 1/2" bar and cap
Nail and Tag SE side 28" Maple West 25.82'
Nail and Tag North side 32" Oak East 20.38'
Nail and Tag W side 26" Maple NE 35.75'

SIGNED BY Mervin F. Fouty DATE 2-27-78
SURVEYOR'S MICHIGAN REGISTRATION NO. 18989

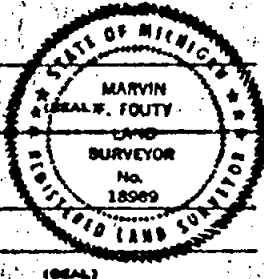

FOR STATE AND UNITED STATES AGENCIES:

SIGNED BY _____ DATE _____
APPROVED AND SIGNED BY _____ DATE _____
SURVEYOR'S MICHIGAN REGISTRATION NO. _____

1587

FORM APPROVED BY MICHIGAN STATE BOARD OF REGISTRATION, JAN. 26, 1977
REVISED MAY 14, 1978

MAY PLACE SKETCH ON BACK OR ATTACHED SHEET

LAND CORNER RECORDATION CERTIFICATE
FILING REQUIREMENT OF ACT 74, MICH. P.A. 1970

East 1/4 corner Section 36, Ingham Twp. LIBER 6 PAGE 234

FOR CORNERS OF:-	LOCATED IN:-	CORNER CODE NUMBER
1. PUBLIC LAND SURVEY	T. <u>2</u> N. R. <u>1</u> E.	<u>M-12</u>
2. PROPERTY CONTROLLING IN SECTION	T. <u> </u> N. R. <u> </u> E.	<u> </u>
3. MISCELLANEOUS PROPERTY IN SECTION	T. <u> </u> N. R. <u> </u> E.	<u> </u>
4. LOT NO. <u> </u> , RECORDED PLAT <u> </u>		
5. PRIVATE CLAIMS <u> </u>		

FILED

FEB 4 10 29 AM '83

REGISTER OF DEEDS

Paula Johnson
INGHAM COUNTY, MICH.

REGISTER OF DEEDS STAMP AND
FILING NUMBER

I, Larry A. Bryan, do hereby certify that under requirements of P.A. 74, Michigan P.A. of 1970, the corner points mentioned in lines 1 and 2 above were, in a field survey on November 20, 1980, established, re-established, monumented, re-monumented, recovered or restored as expressed below and in conformance with regulations and rules therefore as required in the current manual of survey instructions of the United States Department of the Interior, Bureau of Land Management or by a decree of a court of law. Furthermore, that the corner points mentioned in lines 3, 4 and 5 above were, in a field survey on , 19 , found, recovered, restored, established or re-established as expressed below and in conformance with the rules of the Michigan State Board of Registration for Land Surveyors or, by a Decree of a Court of law:

A. Description of original monument and accessories and/or subsequent restoration:

M-12 Original monument and accessories obliterated

B. Description of corner evidence found and/or method applied in restoring or re-establishing corner:

M-12 Found 1/2" bar w/cap as recorded in Liber 5 p 204, also found anchor post with fences N-S-E 2.28' South. Measured North and South in close accord with G.L.O. distances. Accepted found bar at East 1/4 corner Section 36.

C. Description of monument for corner and accessories established to perpetuate locating the position of the corner:

M-12 East 1/4 corner Section 36, found 1/2" bar w/cap
Set 1/2" bar w/cap at West 1/4 corner Section 31, T2N, R2E, South, 2.28'
Set nail & tag Southeast side 12" Ash, S35°W, 12.42'
Set nail & tag West side 8" Elm, N10°E, 12.70'
Set nail & tag South side 8" Wild Cherry, N45°E, 14.72'

SIGNED BY Larry A. Bryan DATE 12-1-80
SURVEYOR'S MICHIGAN REGISTRATION NO. 25832
FOR STATE AND UNITED STATES AGENCIES:
SIGNED BY DATE
APPROVED AND SIGNED BY DATE
CHIEF OF SURVEY PARTY
MICHIGAN REGISTERED LAND SURVEYOR

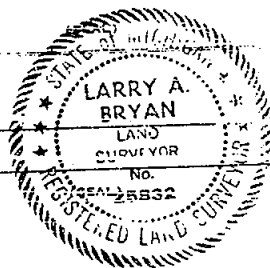

SURVEYOR'S MICHIGAN REGISTRATION NO.

FORM APPROVED BY MICHIGAN STATE BOARD OF REGISTRATION, JAN. 29, 1971
REVISED MAY 14, 1973

1982

MAY PLACE SKETCH ON BACK OR ATTACHED SHEET

LAND CORNER RECORDATION CERTIFICATE

FILING REQUIREMENT OF ACT 74, MICH. P.A.1970

North 1/4 corner Section 36, Ingham Twp., LIBER 6 PAGE 235
Center of Section 36, Ingham Twp.

FOR CORNERS OF--	LOCATED IN--	CORNER CODE NUMBER
1. PUBLIC LAND SURVEY	T. 2 N. R. 1 E.	L-11
2. PROPERTY CONTROLLING IN SECTION	T. 2 N. R. 1 E.	L-12
3. MISCELLANEOUS PROPERTY IN SECTION	T. N. R. W.	
4. LOT NO. _____, RECORDED PLAT _____		
5. PRIVATE CLAIMS _____		

FILED

FEB 4 10 29 AM '83

REGISTER OF DEEDS

Paula Johnson

INGHAM COUNTY, MICH.

REGISTER OF DEEDS STAMP AND FILING NUMBER

I, Larry A. Bryan, do hereby certify that under requirements of P.A. 74, Michigan P.A. of 1970, the corner points mentioned in lines 1 and 2 above were, in a field survey on November 20, 1980, established, re-established, monumented, re-monumented, recovered or restored as expressed below and in conformance with regulations and rules therefore as required in the current manual of survey instructions of the United States Department of the Interior, Bureau of Land Management or by a decree of a court of law. Furthermore, that the corner points mentioned in lines 3, 4 and 5 above were, in a field survey on _____, 19____, found, recovered, restored, established or re-established as expressed below and in conformance with the rules of the Michigan State Board of Registration for Land Surveyors or, by a Decree of a Court of law:

A. Description of original monument and accessories and/or subsequent restoration:

L-11 Original monument and accessories obliterated

L-12 Monument not set in original survey

B. Description of corner evidence found and/or method applied in restoring or re-establishing corner:

L-11 Found no evidence of surveyor restoration of corner, destroyed in construction of drain. Set corner in centerline of drain on North line Section in close accord with G.L.O. distances.

L-12 Set center of Section at intersections of N-S and E-W 1/4 lines.

C. Description of monument for corner and accessories established to perpetuate locating the position of the corner:

L-11 North 1/4 corner Section 36, corner falls in centerline of ditch on N-S fence line set reference iron 12.0' north Witnesses to reference iron. Set nail & tag 8" Ash, N45°W, 16.48'. Set nail & tag 4" Elm, N30°W, 48.52'

L-12 Center of Section 36, set concrete monument.
Pd: 1/2" bar w/cap recorded in Liber 3 page 247, West, 47.37'
Set nail & tag North side Ash clump, N60°E, 25.48'
Set nail & tag North side 6" Ash S15°W, 5.42'

SIGNED BY Larry A. Bryan DATE 12-1-80

SURVEYOR'S MICHIGAN REGISTRATION NO. 25832

FOR STATE AND UNITED STATES AGENCIES:

SIGNED BY _____ DATE _____

APPROVED AND SIGNED BY _____

MICHIGAN REGISTERED LAND SURVEYOR

SURVEYOR'S MICHIGAN REGISTRATION NO. _____



1983

FORM APPROVED BY MICHIGAN STATE BOARD OF REGISTRATION, JAN. 28, 1971
REVISED MAY 14, 1975

MAY PLACE SKETCH ON BACK OR ATTACHED SHEET

LAND CORNER RECORDATION CERTIFICATE

FILING REQUIREMENT OF ACT 74, MICH. P.A. 1970

West 1/4 corner Section 31, White Oak Twp. LIBER 6 PAGE 236

FOR CORNERS OF—	LOCATED IN—	CORNER CODE NUMBER
1. PUBLIC LAND SURVEY	T. 2 N. R. 2 E.	A-12
2. PROPERTY CONTROLLING IN SECTION	T. S. R. E.	
3. MISCELLANEOUS PROPERTY IN SECTION	T. N. S. R. E.	
4. LOT NO.	RECORDED PLAT	
5. PRIVATE CLAIMS		

FILED

FEB 4 10 29 AM '83

REGISTER OF DEEDS

Paula Johnson
INGHAM COUNTY, MICH.

REGISTER OF DEEDS STAMP AND
FILING NUMBER

I, Larry A. Bryan, do hereby certify that under requirements of P.A. 74, Michigan P.A. of 1970, the corner points mentioned in lines 1 and 2 above were, in a field survey on November 20, 1980, established, re-established, monumented, re-monumented, recovered or restored as expressed below and in conformance with regulations and rules therefore as required in the current manual of survey instructions of the United States Department of the Interior, Bureau of Land Management or by a decree of a court of law. Furthermore, that the corner points mentioned in lines 3, 4 and 5 above were, in a field survey on _____, 19____, found, recovered, restored, established or re-established as expressed below and in conformance with the rules of the Michigan State Board of Registration for Land Surveyors or, by a Decree of a Court of law:

A. Description of original monument and accessories and/or subsequent restoration:

A-12 Original monument and accessories obliterated
Corner used by County surveyor E.A. Calkins in 1900

B. Description of corner evidence found and/or method applied in restoring or re-establishing corner:

A-12 Found anchor post with fences N-S-E, also
found anchor post North 2.28' with fences N-S. Measured North and South in close
accord with C.L.O. distances. Accepted anchor post as corner and set 1/2" bar w/cap.

C. Description of monument for corner and accessories established to perpetuate locating the position of the corner:

A-12 West 1/4 corner Section 31
Set 1/2" bar w/cap at anchor post.
Set nail & tag West side 8" Elm, N10°E, 14.67'
Set nail & tag South side 8" Wild Cherry, N45°E, 15.50'
Found 1/2" bar w/cap, East 1/4 corner Section 36, North, 2.28'

SIGNED BY Larry A. Bryan DATE 12-1-80

SURVEYOR'S MICHIGAN REGISTRATION NO. 25832

FOR STATE AND UNITED STATES AGENCIES:

SIGNED BY _____ DATE _____

CHIEF OF SURVEY PARTY

WITNESSED AND SIGNED BY _____ DATE _____

MICHIGAN REGISTRATION BOARD

SURVEYOR'S MICHIGAN REGISTRATION NO. _____

FORM APPROVED BY MICHIGAN STATE BOARD OF REGISTRATION, JAN. 28, 1971
REVISED MAY 14, 1975

1984

MAY PLACE SKETCH ON BACK OR ATTACHED SHEET

LAND CORNER RECORDATION CERTIFICATE

FILING REQUIREMENT OF ACT 74, MICH. P.A. 1970 **6** PAGE **267**

Ingham Township

FILED

FOR CORNERS OF--	LOCATED IN--	CORNER CODE NUMBER
1. PUBLIC LAND SURVEY	T. <u>2</u> N. <u>1</u> R. <u>1</u> W.	M-12, L-12
2. PROPERTY CONTROLLING IN SECTION	T. <u> </u> N. <u> </u> S. <u> </u> R. <u> </u> E. <u> </u> W. <u> </u>	
3. MISCELLANEOUS PROPERTY IN SECTION	T. <u> </u> N. <u> </u> S. <u> </u> R. <u> </u> E. <u> </u> W. <u> </u>	
4. LOT NO. <u> </u> , RECORDED PLAT <u> </u>		
5. PRIVATE CLAIMS <u> </u>		

MAR 29 10 33 AM '85

REGISTER OF DEEDS
Paula Johnson
INGHAM COUNTY, MICH.

REGISTER OF DEEDS STAMP AND FILING NUMBER

I, Larry A. Bryan, do hereby certify that under requirements of P.A. 74, Michigan P.A. of 1970, the corner points mentioned in lines 1 and 2 above were, in a field survey on November 4, 1980, established, re-established, monumented, re-monumented, recovered or restored as expressed below and in conformance with regulations and rules therefore as required in the current manual of survey instructions of the United States Department of the Interior, Bureau of Land Management or by a decree of a court of law. Furthermore, that the corner points mentioned in lines 3, 4 and 5 above were, in a field survey on , 19 , found, recovered, restored, established or re-established as expressed below and in conformance with the rules of the Michigan State Board of Registration for Land Surveyors or, by a Decree of a Court of law:

A. Description of original monument and accessories and/or subsequent restoration:

M-12 Original monument and accessories obliterated.

L-12 No post set in original government survey.

B. Description of corner evidence found and/or method applied in restoring or re-establishing corner:

M-12 Found 1/2" bar & cap Fouty, recorded as West 1/4 corner Section 31, T2N, R2E, Liber 3, Page 562.

L-12 Set concrete monument at intersection of 1/4 lines.

C. Description of monument for corner and accessories established to perpetuate locating the position of the corner:

M-12 East 1/4 corner Sec. 36
Set nail & tag Southeast side 12"
Ash, S35°W, 12.42'
Set nail & tag West side 8" Elm,
N10°E, 12.70'
Set nail & tag South side 18"
Wild Cherry, N45°E, 14.72'
1/2" bar & cap #25832 West
1/4 corner Section 31, T2N, R2E,
South, 2.28'

L-12 Center Sec. 36
Found 1/2" bar w/cap "Boss" re-
corded as center of Section,
West, 47.37'
Set nail & tag North side Ash
clump, N60°E, 25.48'
Set nail & tag North side 6"
Ash, S15°W, 5.42'
Set nail & tag South side 8"
Ash, N45°W, 19.15'

SIGNED BY Larry A. Bryan

DATE 3-20-85

SURVEYOR'S MICHIGAN REGISTRATION NO. 25832

FOR STATE AND UNITED STATES AGENCIES:

SIGNED BY

DATE

APPROVED AND SIGNED BY

MICHIGAN REGISTERED LAND SURVEYOR

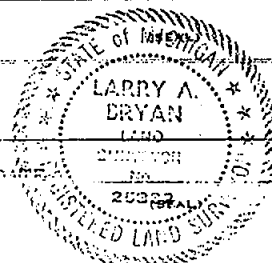

SURVEYOR'S MICHIGAN REGISTRATION NO.

2015

FORM APPROVED BY MICHIGAN STATE BOARD OF REGISTRATION, JAN. 28, 1971
REVISED MAY 14, 1975

MAY PLACE SKETCH ON BACK OR ATTACHED SHEET

LAND CORNER RECORDATION CERTIFICATE

FILING REQUIREMENT OF ACT 74, MICH. P.A. 1970

LIBER

6 PAGE 272

White Oak Township

FILED

FOR CORNERS OF--

LOCATED IN--

CORNER CODE NUMBER

1. PUBLIC LAND SURVEY T. 2 N. R. 2 E. A-12
 2. PROPERTY CONTROL- N. E.
 ING IN SECTION T. S. R. W.
 3. MISCELLANEOUS N. E.
 PROPERTY IN SECTION T. S. R. W.
 4. LOT NO. , RECORDED PLAT
 5. PRIVATE CLAIMS

MAR 29 10 34 AM '85

REGISTER OF DEEDS

James Johnson
 INGHAM COUNTY, MICH.

REGISTER OF DEEDS STAMP AND
 FILING NUMBER

I, Larry A. Bryan, do hereby certify that under requirements of P.A. 74, Michigan P.A. of 1970, the corner points mentioned in lines 1 and 2 above were, in a field survey on November 4, 1980, established, re-established, monumented, re-monumented, recovered or restored as expressed below and in conformance with regulations and rules therefore as required in the current manual of survey instructions of the United States Department of the Interior, Bureau of Land Management or by a decree of a court of law. Furthermore, that the corner points mentioned in lines 3, 4 and 5 above were, in a field survey on _____, 19____, found, recovered, restored, established or re-established as expressed below and in conformance with the rules of the Michigan State Board of Registration for Land Surveyors or, by a Decree of a Court of law:

A. Description of original monument and accessories and/or subsequent restoration:

A-12 Original monument and accessories obliterated

B. Description of corner evidence found and/or method applied in restoring or re-establishing corner:

A-12 Set 1/2" bar & cap at anchor post on township line in close accord with G.L.O measurements.

C. Description of monument for corner and accessories established to perpetuate locating the position of the corner:

A-12 West 1/4 corner Section 31
 Set nail & tag West side 8" Elm, N10°E, 14.67'
 Set nail & tag South side 8" Wild Cherry, N45°E, 15.50'
 Found 1/2" bar w/cap "Fouty" at base of anchor post, North, 2.28'

SIGNED BY Larry A. Bryan DATE 3-19-85
 SURVEYOR'S MICHIGAN REGISTRATION NO. 25832

FOR STATE AND UNITED STATES AGENCIES:

SIGNED BY _____ DATE _____
 CHIEF OF SURVEY PARTY
 APPROVED AND SIGNED BY _____ DATE _____
 MICHIGAN REGISTERED LAND SURVEYOR

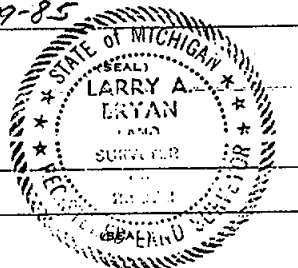

SURVEYOR'S MICHIGAN REGISTRATION NO. _____

FORM APPROVED BY MICHIGAN STATE BOARD OF REGISTRATION, JAN. 28, 1971
 REVISED MAY 14, 1975

2020

MAY PLACE SKETCH ON BACK OR ATTACHED SHEET

LAND CORNER RECORDATION CERTIFICATE
Filing Requirement of Act 74, Mich. P.A. 1970

LIBER 6 Page 366

For corners in

Ingham
(County)

Located In:

Corner Code //

FILED

- | | | | | | |
|-------------------------|---|----|---|----|------|
| 1. Public Land Survey | T | 2N | R | 1E | J-11 |
| | T | 2N | R | 1E | K-11 |
| | T | 2N | R | 1E | J-12 |
| | | | | | |
| 2. Property Controlling | S | | T | R | |
| in Section | S | | T | R | |
| 3. Miscellaneous | S | | T | R | |
| Property in Sec. | S | | T | R | |

MAR 2 9 30 AM '88

REGISTER OF DEEDS

R. J. Jackson

INGHAM COUNTY, MICH.
Register of Deeds Stamp & File Number

4. Lot No. _____ Recorded Plat _____
5. Private Claims _____

I, Larry A. Bryan, in a field survey on September 11, 19 87, do hereby certify that under requirements of P.A. 74, Michigan P.A. of 1970, the corner points mentioned in lines 1 and 2 above were in conformance with regulations and rules therefore as required in the current manual of survey instructions of the United States Department of the Interior, Bureau of Land Management or by a decree of a Court of Law and/or that the corner points mentioned in lines 3, 4 and 5 above were in conformance with the rules of the Michigan Board of Land Surveyors or by a Decree of a Court of Law; established, re-established, monumented, re-monumented, recovered, found as expressed below:

NOTE: Not more than 4 corners, all in the same town and range, may be recorded on this certificate.

A. Description of original monument and accessories and/or subsequent restoration:

J-11 Original monument and accessories obliterated

K-11 Original monument and accessories obliterated

J-12 Not set in original survey. Corner referred to in a survey by A. Jackson in 1848. (Remonumentation office, folder 1, page 73.)

B. Description of corner evidence found and/or method applied in restoring or reestablishing corner:

J-11 Found bar & cap #21275 at the intersection of East, West and South fence lines.

K-11 Found railroad spike in centerline Dexter Trail on East-West fence line.

J-12 Set 1/2" bar & I cap at the intersection of down fences, distances North and East in close accord with County Surveyor's notes.

	A	B	C	D	E	F	G	H	I	J	K	L	M
2	6	5	4	3	2	1							
3													
4	7	8	9	10	11	12							
5													
6	18	17	16	15	14	13							
7													
8	19	20	21	22	23	24							
9													
10	30	29	28	27	26	25							
11													
12	31	32	33	34	35	36							



C. Description of monument for corner and accessories established to perpetuate locating the position of the corner:

J-11 Found N&T #21275 in S Side 12" Elm, N75°E, 34.32'

Found N&T #21275 in N side 14" Elm, N88°E, 35.65'

Found N&T #21275 in E side 16" Beech, South, 15.65'

K-11 Found "pk" nail in S side power pole, N85°E, 27.60'

Found "pk" nail in S side power pole, N80°W, 42.63'

Found "pk" nail in 30" Maple, S30°W, 119.85'

J-12 Set N&T #25832 in W side 30" Walnut, S20°E, 59.13'

Set N&T #25832 in E side 20" Cherry, South, 113.87'

Set N&T #25832 in S side 15" Cherry, S60°W, 40.18'

Signed by

Larry A. Bryan

Date

February 12, 1988

Surveyor's Michigan License No. 25832

FORM APPROVED BY MICHIGAN STATE BOARD OF LAND SURVEYORS JAN. 26, 1971
REVISED MAY 14, 1975
REVISED JAN., 1983