

FILED

LAND CORNER RECORDATION CERTIFICATE
Filing Requirement of Act 74, Mich. P.A. 1970

MAY 10 8 50 AM '94

REGISTER OF DEEDS

Paul Johnson
 INGHAM COUNTY, MICH.

For corners in

Ingham

(County)

Located In:

Corner Code =#

- | | | |
|------------------------------------|-------------------------|------------|
| 1. Public Land Survey | T <u>4N</u> R <u>2W</u> | <u>I-1</u> |
| | T _____ R _____ | _____ |
| | T _____ R _____ | _____ |
| | T _____ R _____ | _____ |
| 2. Property Controlling in Section | S _____ T _____ R _____ | _____ |
| | S _____ T _____ R _____ | _____ |
| 3. Miscellaneous Property in Sec. | S _____ T _____ R _____ | _____ |
| | S _____ T _____ R _____ | _____ |

Register of Deeds Stamp & File Number

4. Lot No. _____, Recorded Plat _____
5. Private Claims _____

I, Larry A. Bryan, in a field survey on April 11, 19 94, do hereby certify that under requirements of P.A. 74, Michigan P.A. of 1970, the corner points mentioned in lines 1 and 2 above were in conformance with regulations and rules therefore as required in the current manual of survey instructions of the United States Department of the Interior, Bureau of Land Management or by a decree of a Court of Law and/or that the corner points mentioned in lines 3, 4 and 5 above were in conformance with the rules of the Michigan Board of Land Surveyors or by a Decree of a Court of Law; established, re-established, monumented, re-monumented, recovered, found as expressed below:

NOTE: Not more than 4 corners, all in the same town and range, may be recorded on this certificate.

- A. Description of original monument and accessories and/or subsequent restoration:

I-1,

1. Corner set in Original Government Survey by Musgrove Evans, Deputy Surveyor, on February 14, 1827. "Int. North boundary 10 lks East of post and set post for corner Secs 2 and 3".
 W. Ash 16 in. S14 1/2W 29 lks
 B. Oak 14 in. S47E 55 lks

(Continued on Back)

- B. Description of corner evidence found and/or method applied in restoring or reestablishing corner:

I-1, Investigation at this corner revealed a 5/8" bar in a monument box 2.2' West of the centerline of Wood Road on a fence line East. All of the witnesses listed in items #4 and #6 were not found with the exception of the Southeast corner, Section 34, T5N, R2W, West 6.65'. Three of the witnesses listed in item #7 were found with the distances noted in part "C" below. Accepted 5/8" bar in monument box as the perpetuated location of I-2.

- C. Description of monument for corner and accessories established to perpetuate locating the position of the corner:

I-1, T4N-R2W

Found 5/8" bar in monument box as noted above.

Found nail & tag #16053 in South side utility pole, S85°E, 37.31'.

Southwest corner brick light base pedestal, S35°E, 62.13'.

Northeast corner brick Granger sign, N70°W, 56.35'.

Found 5/8" bar in monument box, Southeast corner Section 34, T5N, R2W, West, 6.65'.

Signed by

*Larry A. Bryan*Surveyor's Michigan License No. 25832

Date

4-15-94

FORM APPROVED BY MICHIGAN STATE BOARD OF LAND SURVEYORS, JAN. 28, 1971

REVISED MAY 14, 1975

REVISED JAN., 1983

P.A. 345 INGHAM COUNTY

PEER APPROVED 4/13/94 M

2610

PART "A" CONTINUED

2. Corner identified in a survey by T.J. Brown, County Surveyor, on November 19, 1874 (vol. 2, page 115 County Surveyor Records) and on September 28, 1875 (vol. 2, page 129 County Surveyor Records) as "a post from which a Butternut 14 in. diameter bears S11°E 209 1/2 lks and a Butternut 10 in. diameter bears N67°W 62 2/3 lks".
3. Corner referred to in a resurvey of Lansing Township by R.J. Robb, County Surveyor, in August and September of 1909 (vol. 3, page 218 and 219 County Surveyor Records) and identified as a "cement post 3" square on top, 4" square on bottom and 2.5 feet long, witnessed by Maple 10" S-W 50', Butternut N-W 35', row of Maples on East side is 35' East of line".
4. Corner identified by C.E. Smith, survey chief Michigan State Highway Department, January 1965, on Government Monument Witness Form 280, as "1/2" iron³ 1" below black top in the west lane of Wood street, witnesses S65E 23.29 P.Pole, S32W 49.90 24" Maple, S63W 34.14 T.Pole".
5. Corner identified as 1/2 inch iron with witnesses listed in item #4 on Ingham County Road Commission grid map revised January, 1972.
6. Corner recorded by Fred N. White P.S. #12034 on 3/8/72 in Liber 1 of Corners, Page 415 Ingham County Records and on 3/7/74 in Liber 3 of Corners, Page 61 Ingham County Records as "Found 1/2" iron 2.2' West of centerline Wood street. Verified by witnesses from M.S.D.H. records by C.E. Smith". Witnessed by: Power pole S65°E 23.29', 24" Maple S32°W 49.90', Tel. pole S63°W 34.14', SE Cor. Sec. 34, T5N, R2W, West 6.65'.
7. Corner recorded by James E. Stephens P.S. #16053 on July 31, 1991 in Liber 7 of Corners, Page 235 Ingham County Records as "found 1/2 inch iron" in location of item #6. Witnessed by survey tags nailed to: East side utility pole N20°W 111.26 feet, South side of utility pole S85°E 37.32 feet, NE corner of brick Granger sign N85W 56.53 feet, SW corner of brick light pedistal S35°W 62.17 feet.
8. Corner referred to by Ronnie M. Lester P.S. #18998 on August 2, 1972 and recorded in Liber 2 of Corners Page 473 and 474 Clinton County Records and by Maurice H. Mahieu P.S. #28414 on September 6, 1984 and recorded in Liber 2 of Corners Page 531 Clinton County Records as having found 1/2 inch bar 6.66 feet East of I-13, Southeast Corner Section 34, T5N, R2W, Dewitt Township, Clinton County Michigan.
9. Corner shown on a survey by Fred N. White P.S. #12034, dated February 14, 1972 and recorded in Liber 1 of Surveys, Page 294 Ingham County Records as having found 1/2 inch bar with witnesses listed in item #6.
10. Corner shown on a survey by Fred N. White P.S. #12034 dated September 28, 1976 and recorded in Liber 2 of Surveys, Page 958 and 959 Ingham County Records. No monument or witnesses given, but referencing item #6.
11. Corner shown on a survey by James A. Porter P.S. #19003 dated May 19, 1983 and recorded in Liber 4, of Surveys, Page 737 and 738 Ingham County Records, with no monument or witnesses given.
12. Corner shown on a survey by James E. Stephens P.S. #16053 dated August 1, 1991 and recorded in Liber 6 of Surveys, Page 776 and 777 Ingham County Records as having found 1/2 inch bar with witnesses given in item #7.

NOV 29 9 29 AM '94

LAND CORNER RECORDATION CERTIFICATE
Filing Requirement of Act 74, Mich. P.A. 1970

For corners in Lansing Twp.

Ingham

(County)

Located In:

Corner Code ##

1. Public Land Survey T 4N R 2W I-2
T R
T R
T R
2. Property Controlling S T R
in Section S T R
3. Miscellaneous S T R
Property in Sec. S T R
4. Lot No. , Recorded Plat
5. Private Claims

REGISTER OF DEEDS

Ingham County, Mich.

Register of Deeds Stamp & File Number

I, Larry A. Bryan, in a field survey on October 13, 19 94,
do hereby certify that under requirements of P.A. 74, Michigan P.A. of 1970, the corner points mentioned
in lines 1 and 2 above were in conformance with regulations and rules therefore as required in the
current manual of survey instructions of the United States Department of the Interior, Bureau of Land
Management or by a decree of a Court of Law and/or that the corner points mentioned in lines 3, 4 and 5
above were in conformance with the rules of the Michigan Board of Land Surveyors or by a Decree of a
Court of Law; established, re-established, monumented, re-monumented, recovered, found as
expressed below:

**NOTE: Not more than 4 corners, all in the same town and range, may be recorded
on this certificate.**

A. Description of original monument and accessories and/or subsequent restoration:

I-2,

1. Corner set in Original Government Survey by Musgrove Evans, Deputy
Surveyor, on February 14, 1827.

Post set for corner

Sug. 12 in. S20W 19 lks.

Iron w'd. 4 in. N77E 21 lks.

(Continued on Back)

B. Description of corner evidence found and/or method applied in restoring or reestablishing corner:

I-2, Investigation at this corner revealed a 1/2" bar and cap #16053 one
foot west of the centerline of Wood street. The Southeast corner of a
block house #2909 Wood street N51°48'W 32.70' and the Northeast corner of
house #2733 Wood street N57°36'W 91.55' were found from item #9, #18 and
#19. A 1/2" bar West 32.70' was found from item #18, along with a nail and
tag found in the South side of a 52" Oak N80°E 43.79', which agrees with
witnesses from item #5, and in the Northeast side power pole N45°W 41.56'
from item #19. Excavated hole 2.0' x 2.0' centered on found 1/2" bar and
cap #16053. Found bolt spike 0.20' below asphalt surface from item #9, #15
and #18.

(Continued on Back)

C. Description of monument for corner and accessories established to perpetuate locating the position of the corner:

I-2, T4N-R2W

Set 3/4" bar with cap stamped P.A. 345 #25832 in monument box.

Found Southeast corner of block house #2909, N51°48'W, 88.45'.

Found Northeast corner of house #2733, S57°36'W, 91.55'.

Found 1/2" bar, West, 32.70'

Found nail & tag in Northeast side power pole, N30°W, 41.56'.

Found nail & tag #16053 in the South side 52" Oak, N40°E, 43.79'.

Top Northwest corner of a concrete corner post, N80°E, 34.62'.

Centerline of 4" well, S65°W, 101.31'.

Signed by Larry A. Bryan
Surveyor's Michigan License No. 25832

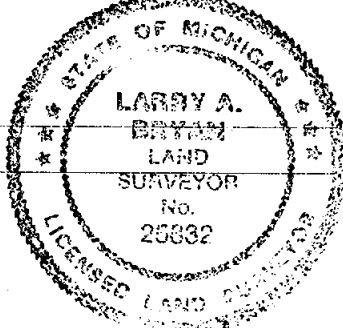
Date 11-23-94

FORM APPROVED BY MICHIGAN STATE BOARD OF LAND SURVEYORS, JAN. 28, 1971
REVISED MAY 14, 1975
REVISED JAN., 1983

P.A. 345 INGHAM COUNTY

PEER APPROVED 11/09/94 M

2718

PART "A" CONTINUED

2. Corner identified in a survey by T.J. Brown, County Surveyor, on November 19, 1874 (vol. 2, page 115 County Surveyor Records) and on September 28, 1875 (vol. 2, page 129 County Surveyor Records) as "a post from which a Butternut 14 in. diameter bears S11°E 209 1/2 lks and a Butternut 10 in. diameter bears N67°W 62 2/3 lks".
3. Corner identified in a survey by A.P. Drake, County Surveyor, on December 22, 1881 (vol. 2, page 203 County Surveyor Records) as "a post from which a Swamp Oak 10 N68 1/3E 68 lks and a B. Walnut 9 S16E 202 3/4 lks".
4. Corner identified in a survey by John McCreary, County Surveyor, on May 30 and 31, 1890 (vol. 2, page 237 County Surveyor Records) as "a gas pipe and brick from which a Sugar 24 N43E 78lks and a Butternut 12 N78E 54 lks".
5. Corner referred to in a resurvey of Lansing Township by R.J. Robb, County Surveyor, in August and September of 1909 (vol. 3, page 218 and 219 County Surveyor Records) and identified a "cement post 3" square on top, 4" square on bottom and 2.5 feet long, witnessed by R. Oak N-W 35', S. Oak N-E 42.8'".
6. Corner identified as stone and pipe witnessed to: Iron East 34.55', 8" Elm S.E. 38.1, 14" Elm S.W. 49.3' on Ingham County Road Commission grid map, revised January, 1972.
7. Corner shown in the private records of Laverne J. Hendryx on County Surveyors Record form for Section 2, T4N, R2W as a gear and pipe on top of stone, with witnesses as listed in item #6.
8. Corner shown on a unrecorded survey by E.J. McCombs, of Consumers Power Company, drawing No. S-F 17553 dated July, 1971, as a 3/4" iron bar 0.8'W. of Pvt. centerline witnessed to: Nail and washer in P. pole N30°W 41.75', Nail and washer in 48" Oak N70°E 43.75', N.W. corner of conc. fence post E. 34.65'.
9. Corner recorded by Clyde K. Stephens P.S. #3829 on July 28, 1971 in Liber 1 of Corners, Page 129 Ingham County Records as "found boat spike at the E 1/4 corner of the section line road (Wood Street). Also on a projection of two old farm fences east and west. This corner as identified herewith has been used and accepted in its present location in excess of 25 years to our knowlege", witnessed to SE. corner of concrete block house #2909 N51°48'W 88.48 feet, NE. corner of a 1-story frame house #2733 S57°36'W 91.50 feet, NW corner of a 1 1/2 story brick house #2810 S63°06'E 123.01 feet.
10. Corner shown on a survey by Clyde K. Stephens P.S. #3829, dated July 26, 1971, recorded in Liber 1 of Surveys, Page 47 and 48, and on March 2, 1972, recorded in Liber 1 of Surveys, Page 327 Ingham County Records as having found a boat spike with witnesses listed in item #9.
11. Corner shown on a survey by Fred N. White P.S. #12034, dated February 14, 1972, recorded in Liber 1 of Surveys, Page 294 Ingham County Records as having found boat spike with witnesses listed in item #9.
12. Corner shown on a survey by James E. Stephens P.S. #16053 dated June 30, 1972, recorded in Liber 1 of Surveys, Page 390 and on December 12, 1972, recorded in Liber 1 of Surveys, Page 581 and 582 Ingham County Records, with no monument or witnesses shown, but referencing item #9.
13. Corner shown on a survey by Ron Helsel P.S. #18994 dated December 5, 1973, recorded in Liber 1 of Surveys, Page 1102 Ingham County Records as having found boat spike with witnesses listed in item #9.
14. Corner shown on a survey by James E. Stephens P.S. #16053 dated December 27, 1974, recorded in Liber 2 of Surveys, Page 272 through 275 Ingham County Records, with no monument or witnesses shown, but referencing item #9.

I-2 Lansing Twp. Continued

PART "A" CONTINUED

15. Corner shown on a survey by Fred N. White P.S. #12034 dated September 28, 1976, recorded in Liber 2 of Surveys, Page 958 and 959 Ingham County Records, with no monument or witnesses given, but referencing item #9.

16. Corner shown on a survey by James A. Porter P.S. #19003 dated February 14, 1977, recorded in Liber 3, of Surveys, Page 214 and 215 Ingham County Records and on October 14, 1977 recorded in Liber 3 of Surveys, Page 1208 Ingham County Records, with no monument or witnesses given but indicating that the corner had been previously recorded.

17. Corner shown on a survey by James A. Porter P.S. #19003 dated May 19, 1983 and recorded in Liber 4, of Surveys, Page 737 and 738 Ingham County Records, with no monument or witnesses given.

18. Corner shown on a survey by Larry A. Bryan P.S. #25832 dated April 27, 1989, recorded in Liber 5 of Surveys, Page 1263 and 1264 Ingham County Records and September 27, 1989, recorded in Liber 6, of Surveys, Page 105 and 106 Ingham County Records as having found boat spike 1' West of centerline of Wood Road on fence line East & West, with the following witnesses: Southeast corner concrete block house #2909 N50°W, 88.48', Northeast corner one story frame house #2733 S60°W, 91.51', found 1/2" bar West 32.70.

19. Corner shown on a survey by James E. Stephens P.S. #16053 dated August 1, 1991 and recorded in Liber 6 of Surveys, Page 776 and 777 Ingham County Records as having found 1/2 inch diameter steel rod witnessed by survey tags nailed to: Utility pole N45°W 41.58 feet, South side of 58" Oak tree N80°E 43.83 feet, SE corner of concrete block house #2909 N51°48'W 88.48 feet, NE corner of a frame house #2733 S57°36'W 91.50 feet.

PART "B" CONTINUED

Continued excavation to a depth of 1.3' and found 3/4" pipe 0.80' long lying flat in another asphalt surface. Continued excavation for another 0.5' and found gear from axle shaft on top of $\pm 0.3' \times \pm 0.8' \times \pm 1.0'$ stone from item #6 and #7. It appears that the gear was used to hold the 3/4" pipe vertical over high point of stone. The location of the 1/2" bar and cap #16053 falls on Southwesterly part of the high point of the stone. Accepted position of 1/2" bar and cap #16053 as the perpetuated location of I-2 and replaced with 3/4" bar with cap stamped P.A. 345 #25832 in monument box.



Larry A. Bryan
11-23-94

FILED

LAND CORNER RECORDATION CERTIFICATE
Filing Requirement of Act 74, Mich. P.A. 1970

For corners in Lansing Twp.

Ingham
(County)

Located In:

Corner Code ##

- | | | | |
|------------------------------------|------|------|-----|
| 1. Public Land Survey | T 4N | R 2W | I-3 |
| | T | R | |
| | T | R | |
| | T | R | |
| 2. Property Controlling in Section | S | T | R |
| | S | T | R |
| 3. Miscellaneous Property in Sec. | S | T | R |
| | S | T | R |

NOV 29 9 30 AM '94

REGISTER OF DEEDS

Ingham County, Mich.

Register of Deeds Stamp & File Number

4. Lot No. _____, Recorded Plat _____
5. Private Claims _____

I, Larry A. Bryan, in a field survey on October 13, 19 94, do hereby certify that under requirements of P.A. 74, Michigan P.A. of 1970, the corner points mentioned in lines 1 and 2 above were in conformance with regulations and rules therefore as required in the current manual of survey instructions of the United States Department of the Interior, Bureau of Land Management or by a decree of a Court of Law and/or that the corner points mentioned in lines 3, 4 and 5 above were in conformance with the rules of the Michigan Board of Land Surveyors or by a Decree of a Court of Law; established, re-established, monumented, re-monumented, recovered, found as expressed below:

NOTE: Not more than 4 corners, all in the same town and range, may be recorded on this certificate.

A. Description of original monument and accessories and/or subsequent restoration:

I-3,

1. Corner set in Original Government Survey by Musgrove Evans, Deputy Surveyor, on February 13, 1827.
Post set for corner to sections 2, 3, 10 and 11.
Sug. 12 in. S58E 13 lks.
Lynn 10 in. N65W 20 lks.

(Continued on Back)

B. Description of corner evidence found and/or method applied in restoring or reestablishing corner:

I-3, Investigation at this corner revealed in 1/2" bar in the centerline of Wood and David streets, with all three witnesses from item #7 found and noted in part "C" below. A nail and brass tag in the Southwest side of a power pole, S60°E 29.14' was found from item #8 along with a nail and tag #30897 in the Northwest side of a power pole, S58°28'W 41.96' and a storm sewer manhole, N40°E 39.10' from item #11. Found 1" pipe Southwest corner Bancroft Hills and Northwest corner Groesbeck Hills Subdivision No.10, East 50.00'. Found pinched pipe Southeast corner of Supervisor's Plat of Ideal Garden Farms N45°W 46.75'. Excavated hole 1.0'x1.0' centered on 1/2" bar to a depth of 2.0' and found old monument box with 1/2" diameter hole in the center of the top.

(Continued on Back)

C. Description of monument for corner and accessories established to perpetuate locating the position of the corner:

I-3, T4N, R2W
Set 3/4" bar with cap stamped P.A. 345 #25832 in monument box.
Southeast corner of brick building, N41°26'W, 112.17'.
Northwest corner of brick duplex #2004 Wood street, N51°34'E. 115.02'.
Northwest corner of garage to #1918 Wood street, S76°55'W, 87.16'.
Found nail & tag #30897 in Northwest side power pole, S58°28'W, 39.39'.
Found nail & brass tag in Southwest side power pole, S69°E, 29.14'.
Centerline storm sewer manhole, N40°E, 39.10'.

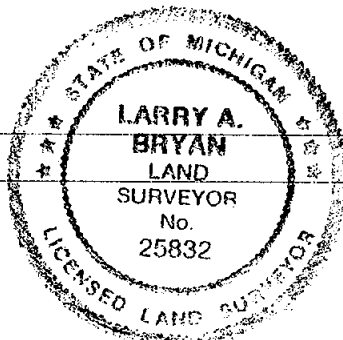
Signed by Larry A. Bryan
Surveyor's Michigan License No. 25832Date 11-23-94FORM APPROVED BY MICHIGAN STATE BOARD OF LAND SURVEYORS, JAN. 28, 1971
REVISED MAY 14, 1975
REVISED JAN., 1983

2719

P.A. 345 INGHAM COUNTY
PEER APPROVED 4/13/94 ML

PART "A" CONTINUED

2. Corner identified in a survey by A.P. Drake, County Surveyor, on December 22, 1881 (vol. 2, page 203 County Surveyor Records) as "a stone to be set from which a Maple 10 N66W 53 1/2 lks and a Elm 5 S78 1/2W 54 1/2 lks".
3. Corner referred to in a survey by John McCreary, County Surveyor, on May 30 and 31, 1890 (vol. 2, page 237 County Surveyor Records) with no monument or witnesses given.
4. Corner referred to in a resurvey of Lansing Township by R.J. Robb, County Surveyor, in August and September of 1909 (vol. 3, page 218 and 219 County Surveyor Records) and identified as a "cement post 3" square on top, 4" square on bottom and 2.5 feet long, witnessed by Ash 6" N-E 38', Bitternut 20" N-E 33.4'".
5. Corner identified in a resurvey of Lansing Township, from a document found in the dossier for I-3 Lansing Township, Ingham County Remonumentation Project, labeled "Horn Notes". This document describes the monumentation and witnesses listed in 1, 2, and 4 above along with the following: "Recovered the concrete post set by Robb and set a standard 1921 monument. The references do not agree with those given by Robb. There was found a tree 23 feet East, and an old fence line running East which agrees with information given by A.N. Bateman who used the corner in platting one acre tracts to the West". Witnessed to: 8" Hickory S60°20'W 31.00' blaze and nail, 5" Elm N41°15'W 48.10' blaze and nail, 14" Bitternut N88°15'E 23.03' blaze and nail.
6. Corner referenced in the private records of Laverne J. Hendryx on County Surveyors Record form for Section 2, T4N, R2W, with no monument given and one witness to a concrete monument 33' East.
7. Corner recorded by James E. Stephens P.S. #16053 on February 8, 1973 in Liber 2 of Corners, Page 351 Ingham County Records and shown on a survey dated December 12, 1972, recorded in Liber 1 of Surveys, Page 581 and 582 Ingham County Records as "a 1/2 inch iron rod found in the centerline of the two section line roads (David Street and Wood Street)". Witnessed to: N41°26'W 112.07 feet to the SE corner of a 1 story brick office building, N51°34'E 115.06 feet to the NW corner of the foundation of a duplex house, S76°55'E 87.23 feet to the NW corner of the garage foundation of a 2 story frame house. The bearing of the section line North of the corner was N0°16'10"E from the plat of Bancroft Hills.
8. Corner recorded by James A. Porter P.S. #19003 on February 20, 1973 in Liber 2 of Corners, Page 363, and on March 31, 1973 in Liber 2 of Corners, Page 417 Ingham County Records and shown on a survey dated February 19, 1973, recorded in Liber 2 of Surveys, Page 217, on February 14, 1977, recorded in Liber 3, of Surveys, Page 214 and 215 and on October 14, 1977 recorded in Liber 3 of Surveys, Page 1208 Ingham County Records as "from plats of Groesbeck Hills and Bancroft Hills found 1/2" iron in Wood Street and David Street intersection". Witnessed to: Bolt Head on Power Pole N49°30'W 43.92 feet, Brass Tag and Nail in Power Pole S58°28'W 41.96 feet, Brass Tag and Nail in Power Pole S69°00'E 29.17 feet.
9. Corner shown on a survey by Ron Helsel P.S. #18994 dated December 5, 1973, recorded in Liber 1 of Surveys Page 1102 Ingham County Records, listing the monument and witnesses for item #8.
10. Corner shown on a survey by Mark W. Witalec P.S. #30897 dated December 28, 1987. recorded in Liber 5 of Surveys, Page 461 through 464 Ingham County Records, as 1/2" iron at Wood St. David St. intersection. Witnessed to: S.E. 29.12' Nail and Brass Tag S.W. side P.P., S.W. 39.35' P.K. and tag #30897 N.W. side Util. P., W.N.W. 77.25' P.K. and tag #30897 S.Side 6" Wood Marker Post, N.E. 39.10' to centerline Sewer M.H. Cover.

PART "A" CONTINUED

11. Corner referred to in Recorded Subdivision Plats: Bancroft Hills, Clyde K. Stephens P.S. #3829, October 11, 1963, Liber 25 of Plats, Page 18; Bancroft Hills No.1, Clyde K. Stephens P.S. #3829, August 23, 1965, Liber 26 of Plats, Page 24; Bancroft Hills No.2, James E. Stephens P.S. #16053, April 4, 1972, Liber 31 of Plats, Page 2; Bancroft Hills No.3, James E. Stephens P.S. #16953, December 7, 1973, Liber 32 of Plats, Page 18; Supervisor's Plat of Groesbeck Hills, Laverne J. Hendryx P.S. #3276, December 30, 1954, Liber 18 of Plats, Page 15; Groesbeck Hills Subdivision No.8, Laverne J. Hendryx P.S. #3276, February 7, 1962, Liber 24 of Plats, Page 1; Groesbeck Hills Subdivision No.10, Clyde K. Stephens P.S. #3829, October 11, 1965, Liber 25 of Plats, Page 13; Groesbeck Hills Subdivision No.11, Clyde K. Stephens P.S. #3829, December 16, 1965, Liber 26 of Plats, Page 39; Supervisor's Plat of Ideal Garden Farms, Francis N. Bateman P.S. #1479, June 12, 1934, Liber 12 of Plats, Page 36.

PART "B" CONTINUED

Witnesses listed above fall in center hole of monument box. Removed top of monument box and found 5/8" bar in cement 8" in diameter. 5/8" bar lines up with center hole in top. Accepted 5/8" bar in cement as the perpetuated location of I-3, raised location and replaced with a 3/4" bar and cap stamped P.A. 345 #25832 in monument box.

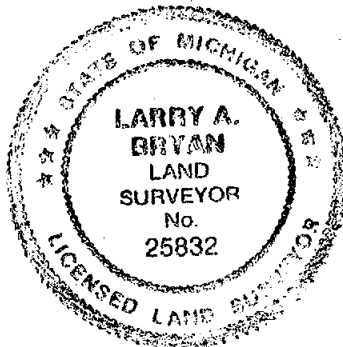

Larry A. Bryan
11-23-94

LAND CORNER RECORDATION CERTIFICATE
Filing Requirement of Act 74, Mich. P.A. 1970

MAY 10 8 50 AM '94
REGISTER OF DEEDS
Ingham County
INGHAM COUNTY, MICH.

For corners in
Ingham
(County)

Located In: Corner Code =#

1. Public Land Survey T 4N R 2W J-1
T R
T R
T R
2. Property Controlling S T R
in Section S T R
3. Miscellaneous S T R
Property in Sec. S T R

Register of Deeds Stamp & File Number

4. Lot No. , Recorded Plat
5. Private Claims

	A	B	C	D	E	F	G	H	I	J	K	L	M
2	6		5		4		3		2		1		
3													
4	7		8		9		10		11		12		
5													
6	18		17		16		15		14		13		
7													
8	19		20		21		22		23		24		
9													
10	30		29		28		27		26		25		
11													
12	31		32		33		34		35		36		
13													

I, Larry A. Bryan, in a field survey on March 10, 19 94, do hereby certify that under requirements of P.A. 74, Michigan P.A. of 1970, the corner points mentioned in lines 1 and 2 above were in conformance with regulations and rules therefore as required in the current manual of survey instructions of the United States Department of the Interior, Bureau of Land Management or by a decree of a Court of Law and/or that the corner points mentioned in lines 3, 4 and 5 above were in conformance with the rules of the Michigan Board of Land Surveyors or by a Decree of a Court of Law; established, re-established, monumented, re-monumented, recovered, found as expressed below:

NOTE: Not more than 4 corners, all in the same town and range, may be recorded on this certificate.

A. Description of original monument and accessories and/or subsequent restoration:
J-1,

1. Corner not set in Original Government Survey.

2. Corner identified in a survey by T.J. Brown, County Surveyor, on November 19, 1874 (vol. 2, Page 115 County Surveyor Records) as "a post from which a Beech 11 in. diameter bears S39 1/2W 33 1/8 lks, and a Sugar 10 in diameter bears N49W 13 lks".

(Continued on Back)

B. Description of corner evidence found and/or method applied in restoring or reestablishing corner:

J-1, Investigation at this corner revealed a copperweld in monument box 9.58' West of the West edge of South bound lane of U.S. 127. A nail and tag #18998 was found in top of a guard rail post N20°W 23.10', and in top of a guard rail post South 21.45' along with a copperweld in monument box, J-13 Dewitt Township, West 9.42' as listed in item #6. Measured 2623.44' to K-1 Lansing Township and 2635.41' to K-13 Dewitt Township. Accepted copperweld in monument box as the perpetuated location of J-1.

C. Description of monument for corner and accessories established to perpetuate locating the position of the corner:

J-1, T4N-R2W

Found copperweld in monument box as noted above.

Found nail & tag #18998 in top of guard rail post, N20°W, 23.10'.

Found nail & tag #18998 in top of guard rail post, South, 21.45'.

Center of "+" in station 910+00 stamped in West edge of South bound U.S. 127, N40°E, 15.00'.

Center of "+" in station 909+70 stamped in West edge of South bound U.S. 127, S35°E, 22.51'.

Signed by Larry A. Bryan
Surveyor's Michigan License No. 25832

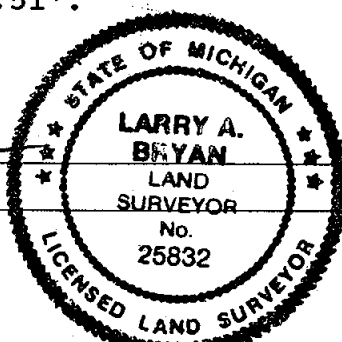

Date 4-15-94

FORM APPROVED BY MICHIGAN STATE BOARD OF LAND SURVEYORS, JAN. 28, 1971
REVISED MAY 14, 1975
REVISED JAN., 1983

P.A. 345 INGHAM COUNTY
PEER APPROVED 4/13/94 ML

PART "A" CONTINUED

3. Corner referred to in a resurvey of Lansing Township by R.J. Robb, County Surveyor, in August and September 1909 (vol. 3, Page 218 and 219 County Surveyor Records) and identified as a "cement post 3" square at top and 4" square on bottom and 2.5 feet long, witnessed by Elm 30" S-W no distance given".
4. Corner identified by C.E. Smith, survey chief Michigan State Highway Department, January 1965, on Government Monument Witness Form 280 as "one inch pipe", witnessed to:
S62E 36.56 14" twin Basswood.
S81E 13.59 13" Hick.
S19E 23.78 17" Oak.
5. Corner identified as 1 inch pipe with witnesses shown in item #4 on Ingham County Road Commission grid map, revised January, 1972 .
6. Corner recorded by Ronnie M. Lester P.S. #18998 on February 5, 1980 in Liber 6 of Corners, Page 53 Ingham County Records, as having found copperweld in monument box ± 9.42 feet East of J-13 Dewitt Township, T5N, R2W, on tree/fence line East and West, and ± 10.0 feet West of West edge of Southbound lane of US 127. Accepted copperweld in monument box and witnessed to:
Nail and Tag, #18998, top of wooden guard rail post, NNW, 23.10'.
Nail and tag, #18998, top of wooden guard rail post, South, 21.43'.
East side of the West leg of sign Post, WNW, 10.17'.
West edge of concrete lane on Southbound US 127, East, 9.58'.
Copperweld in monument box, J-13, Dewitt Twp., T5N, R2W, West 9.42'.
7. Corner referenced by Ronnie M. Lester P.S. #18998 on February 5, 1980 and recorded in Liber 2 of Corners, Page 287 Clinton County Records as having found copperweld in monument box 9.42 feet East of J-13, South 1/4 corner of Section 35, T5N, R2W, Dewitt Township, Clinton County, Michigan.
8. Corner shown on a survey by Douglas K. Richardson P.S. #31603 on March 12, 1987 and recorded in Liber 3 of Surveys, Page 89 and 90, Clinton County Records as having found a copperweld in monument box and listing witnesses in item #6.

LAND CORNER RECORDATION CERTIFICATE
Filing Requirement of Act 74, Mich. P.A. 1970

MAY 10 8 51 AM '94

For corners in

Ingham
(County)

Located In:

Corner Code =#

REGISTER OF DEEDS

Paula Johnson
INGHAM COUNTY, MICH.

- | | | |
|------------------------------------|-----------|-----|
| 1. Public Land Survey | T 4N R 2W | J-2 |
| | T R | |
| | T R | |
| | T R | |
| 2. Property Controlling in Section | S T R | |
| | S T R | |
| 3. Miscellaneous | S T R | |
| Property in Sec. | S T R | |

Register of Deeds Stamp & File Number

4. Lot No. _____, Recorded Plat _____
5. Private Claims _____

	A	B	C	D	E	F	G	H	I	J	K	L	M
2	6	5	4	3									
3													
4	7	8	9	10	11	12							
5													
6	18	17	16	15	14	13							
7													
8	19	20	21	22	23	24							
9													
10	30	29	28	27	26	25							
11													
12	31	32	33	34	35	36							
13													

I, Larry A. Bryan, in a field survey on March 10, 19 94, do hereby certify that under requirements of P.A. 74, Michigan P.A. of 1970, the corner points mentioned in lines 1 and 2 above were in conformance with regulations and rules therefore as required in the current manual of survey instructions of the United States Department of the Interior, Bureau of Land Management or by a decree of a Court of Law and/or that the corner points mentioned in lines 3, 4 and 5 above were in conformance with the rules of the Michigan Board of Land Surveyors or by a Decree of a Court of Law; established, re-established, monumented, re-monumented, recovered, found as expressed below:

NOTE: Not more than 4 corners, all in the same town and range, may be recorded on this certificate.

A. Description of original monument and accessories and/or subsequent restoration:
J-2,

1. Corner not set in Original Government Survey.

2. Corner identified in a survey by T.J. Brown, County Surveyor, on November 19, 1874 (vol. 2, page 115 County Surveyors Records) as "a post from which a Elm 11 in. diameter bears S78W 35 1/2 lks and a Elm 7 in. diameter bears N31 3/4W 40 lks".

(Continued on Back)

B. Description of corner evidence found and/or method applied in restoring or reestablishing corner:

J-2, Investigation at this corner revealed a 18" square concrete post with a 1 1/4" steel pipe in the center ±342' West of U.S. 127 right of way fence. A nail and tag #16053 in the North side of a 30" Hickory, S20°E 113.16' and a 24" Oak, no tag visible, West ±92.5' as noted in item #6. Accepted concrete post with 1 1/4' pipe as the perpetuated location of J-2.

C. Description of monument for corner and accessories established to perpetuate locating the position of the corner:

J-2, T4N-R2W

Found 18" square concrete post with 1 1/4" pipe in center as noted above.
Found nail & tag #16053 in the North side 30" Hickory, S20°E, 113.16'.
Set nail & tag #25832 in the South side 20" Willow East 79.03'.
Set nail & tag #25832 in the North side 12" Elm, S80°W, 31.62'.
Set nail & tag #25832 in the North side 24" Oak, West, 92.47'.
Found bar and cap #16053, East 336.03'.

Signed by Larry A. Bryan
Surveyor's Michigan License No. 25832

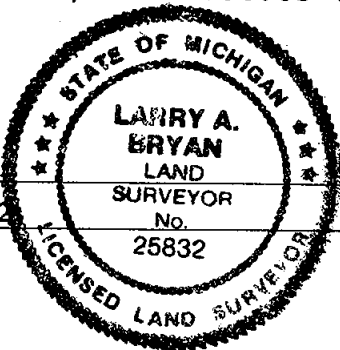

Date 4-15-94

FORM APPROVED BY MICHIGAN STATE BOARD OF LAND SURVEYORS, JAN. 28, 1971
P.A. 345 INGHAM COUNTY
PEER APPROVED 4/13/94
REVISED MAY 14, 1975
REVISED JAN., 1983

PART "A" CONTINUED

3. Corner identified in a survey by A.P. Drake, County Surveyor, on December 22, 1881 (vol. 2, page 203 County Surveyor Records) as "a post from which a Elm 11 in. diameter bears S78W 35 1/2 lks and a Elm 7 in. diameter bears N31 3/4W 40 lks".
4. Corner identified in a survey by John McCreary, County Surveyor, on May 30 and 31, 1890 (vol. 2, page 237 County Surveyor Records) as "a stone and iron, Sugar 16 N1 1/2W 19 1/2 lks, Maple 12 N61 1/2E 47 lks".
5. Corner identified by Clifford Smith, survey chief Michigan State Highway Department, February, 1965, on Government Monument Witness Form 280 as "found 15 inch square concrete post with 2 inch pipe in center for the center of section 2 Lansing twp. Ingham County" witnessed to: 27" Elm S05W 13.20', 22" Elm S29W 14.20', 11" Elm N82W 19.92'.
6. Corner recorded by James E. Stephens P.S. #16053 on May 19, 1977 in Liber 4 of Corners, Page 62 Ingham County Records as "a 18" square corner fence post with a 1 1/4" pipe in the center was found at the intersection of four old fences", witnessed to Survey tag #16053 nailed to the North side of a 24" Oak tree, West 91.46 feet, Survey tag #16053 nailed to the East side of a 24" Hickory tree, South 116.92 feet, Survey tag nailed to the Northeast side of a 30" Hickory tree S40°E 113.08 feet.
7. Corner shown on a survey by James E. Stephens P.S. #16053 dated June 18, 1987, recorded in Liber 5 of Surveys, Page 232 and 233 Ingham County Records and on August 31, 1989, recorded in Liber 5 of Surveys, Page 1152 through 1159 Ingham County Records, with the same monument and witnesses as listed in item #6.

LAND CORNER RECORDATION CERTIFICATE
Filing Requirement of Act 74, Mich. P.A. 1970

MAY 10 8 51 AM '94

For corners in

Ingham

(County)

Located In:

Corner Code #

REGISTER OF DEEDS

Paula Johnson

INGHAM COUNTY, MICH.

- | | | |
|------------------------------------|-----------|-----|
| 1. Public Land Survey | T 4N R 2W | J-3 |
| | T R | |
| | T R | |
| | T R | |
| 2. Property Controlling in Section | S T R | |
| | S T R | |
| 3. Miscellaneous Property in Sec. | S T R | |
| | S T R | |

Register of Deeds Stamp & File Number

4. Lot No. _____, Recorded Plat _____
5. Private Claims _____

I, Larry A. Bryan, in a field survey on March 15, 19 94, do hereby certify that under requirements of P.A. 74, Michigan P.A. of 1970, the corner points mentioned in lines 1 and 2 above were in conformance with regulations and rules therefore as required in the current manual of survey instructions of the United States Department of the Interior, Bureau of Land Management or by a decree of a Court of Law and/or that the corner points mentioned in lines 3, 4 and 5 above were in conformance with the rules of the Michigan Board of Land Surveyors or by a Decree of a Court of Law; established, re-established, monumented, re-monumented, recovered, found as expressed below:

NOTE: Not more than 4 corners, all in the same town and range, may be recorded on this certificate.

A. Description of original monument and accessories and/or subsequent restoration:
J-3,

1. Corner set in Original Government Survey by Musgrove Evans Deputy Surveyor, on February 13, 1827.
Set 1/4 post at average distance on true line from which,
Beech, 9 in. N7W 28 lks.
Lynn 18 in. S2W 19 lks.

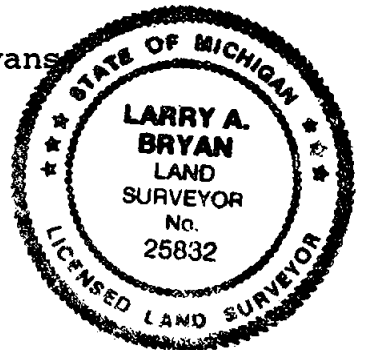

(Continued on Back)

B. Description of corner evidence found and/or method applied in restoring or reestablishing corner:

J-3, Investigation at this corner revealed a 1" pipe inside a 3" diameter concrete monument along East side of a chain link fence. A nail and tag #18998 found in the East side of a power pole S10°W 9.28' and the South side of a 24" Walnut N80°E 25.97' as noted in item #9. Also from item #9 witness to the Southeast corner of house #2808 Tulane N35°E 102.69'. A M.S.D.H. nail and tag in the East side of a power pole S10°W 9.51' was found as noted in item #6. Found 5/8" bar in concrete monument, Southwest corner Lot 99 plat of Somerset, West 136.5' rec. 136.25'. Found 1/2" bar in concrete monument, Northeast corner Kimberly Park, Kimberly Downs No.6, East 169.6' rec. 169.25'. Accepted 1" pipe in concrete monument as the perpetuated location of J-3.

C. Description of monument for corner and accessories established to perpetuate locating the position of the corner:

J-3, T4N-R2W
Found 1" pipe in concrete monument as noted above.
Found nail & tag #18998 in East side of power pole, S10°W, 9.28'.
Found M.S.H.D. nail & tag in East side of power pole, S10°W, 9.51'.
Found nail & tag #18998 in South side of 24" Walnut, N80°E, 25.97'.
Centerline of 2" steel fence post, North, 1.27'.
Centerline of 2" steel fence post, South, 0.55'.
Southeast corner house #2808 Tulane, N35°E, 102.69'.
Southwest corner concrete porch to house #2808 Tulane, N20°E, 72.67'.

Signed by *Larry A. Bryan*
Surveyor's Michigan License No. 25832

Date 4-15-94

PART "A" CONTINUED

2. Corner identified in a survey by A.P. Drake, County Surveyor, on December 22, 1881 (vol. 2, page 203 County Surveyors Records) as "a post from which a sugar 24 S41 1/2W 41 1/2 lks.
3. Corner identified in a survey by R.J. Robb, County Surveyor, on January 27, 1909 (vol. 2, Page 264 County Surveyors Records) and on January 29, 1909 (vol. 5, Page 55 County Surveyors Records) as a post with no witnesses given.
4. Corner referred to in a resurvey of Lansing Township by R.J. Robb, County Surveyor, in August and September of 1909 (vol. 3, page 218 and 219 County Surveyor Records) and identified a "cement post 3" square on top, 4" square on bottom and 2.5 feet long, between three anchor posts".
5. Corner shown in the private records of Laverne J. Hendryx on County Surveyors Record form for Section 2, T4N, R2W as a concrete monument with no witnesses or date given.
6. Corner identified by C.E. Smith, survey chief Michigan State Highway Department, January, 1965, on Government Monument Witness Form 280, as a 3" concrete monument with 1" iron pipe for N1/4 corner Section 11, witness: Due East 26.32 14" Wal., N38W 2.81 4" Maple, S10W 9.37 P.Pole.
7. Corner identified as a 3" concrete monument with 1" pipe with witnesses listed as in #6 above on Ingham County Road Commission grid map, revised January, 1972.
8. Corner recorded by Ronnie M. Lester P.S. #18998 on January 31, 1980 in Liber 6 of Corners, Page 52 Ingham County Records as "found 3" diameter concrete monument with 1 inch pipe 1.4 feet above ground \pm 169 feet West of a concrete plat monument for Kimberly Downs #6, witnesses in close accord with those on MDSH form 280, 1965. Witnessed to: SE corner concrete foundation of house #2808, NE, 102.69', Nail and tag #18998, south side Walnut, East, 25.97', nail and tag #18998, east side power pole, South, 9.24', Nail and tag #18998, south side multi 4" Maple, West, 3.95'.
9. Corner referred to in Recorded Subdivision Plats: Irish Gardens, James E. Stephens P.S. #16053, September 3, 1982, Liber 38 of Plats, Page 27 and 28; Irish Gardens No. 2, James E. Stephens P.S. #16053, May 17, 1988, Liber 43 of Plats, Page 12 and 13; Kimberly Downs No. 3, Clyde K. Stephens P.S. #3829, March 11, 1965, Liber 27, page 4; Kimberly Downs No. 4, Clyde K. Stephens P.S. #3829, December 12, 1966, Liber 27, page 41; Kimberly Downs No. 6, James E. Stephens P.S. #16053, July 27, 1972, Liber 31, page 16; Somerset, Clyde K. Stephens P.S. #3829, October 11, 1963, Liber 25 of Plats, Page 15; Somerset No. 1, Clyde K. Stephens P.S. #3829, January 6, 1965, Liber 26 of Plats, Page 1, Somerset No. 2, Clyde K. Stephens P.S. #3829, August 10, 1965, Liber 26 of Plats, Page 23.

LAND CORNER RECORDATION CERTIFICATE
Filing Requirement of Act 74, Mich. P.A. 1970

Nov 29 9 30 AM '94

REGISTER OF DEEDS
Ingham County, Mich.
INGHAM COUNTY, MICH.

For corners in Lansing Twp.

Ingham

(County)

Located In:

Corner Code --

- | | | | | | |
|------------------------------------|---|----|---|----|-----|
| 1. Public Land Survey | T | 4N | R | 2W | K-1 |
| | T | | R | | |
| | T | | R | | |
| | T | | R | | |
| 2. Property Controlling in Section | S | T | R | | |
| | S | T | R | | |
| 3. Miscellaneous Property in Sec. | S | T | R | | |
| | S | T | R | | |

Register of Deeds Stamp & File Number

4. Lot No. _____, Recorded Plat _____
5. Private Claims _____

I, Larry A. Bryan, in a field survey on February 23, 19 94, do hereby certify that under requirements of P.A. 74, Michigan P.A. of 1970, the corner points mentioned in lines 1 and 2 above were in conformance with regulations and rules therefore as required in the current manual of survey instructions of the United States Department of the Interior, Bureau of Land Management or by a decree of a Court of Law and/or that the corner points mentioned in lines 3, 4 and 5 above were in conformance with the rules of the Michigan Board of Land Surveyors or by a Decree of a Court of Law; established, re-established, monumented, re-monumented, recovered, found as expressed below:

NOTE: Not more than 4 corners, all in the same town and range, may be recorded on this certificate.

- A. Description of original monument and accessories and/or subsequent restoration:
K-1,

1. On Monday Feb. 12th, 1827, Musgrove Evans, U.S. Deputy Surveyor, going North between Sections 1 & 2 "Int. North Boundary 18 lks. West of Post"
Set a Post cor. to Secs. 1 & 2 fw a
B. Ash 5 in S.76W. 265 lks
S. Oak 6 " S.82E. 450 "

(Continued on Back)

- B. Description of corner evidence found and/or method applied in restoring or reestablishing corner:

K-1, Investigation at this corner revealed a 1/2" bar in a concrete monument 11.95 feet West of 3/4" pinched pipe on extension of fence remains to the South. A nail and tag #16053 was found in the North side 6" Elm stump S70°W, 16.05' and in the West side of a 16" Elm stump N05°W, 27.72' as listed in item #6. Accepted 1/2" bar in concrete monument as the perpetuated location of K-1.

- C. Description of monument for corner and accessories established to perpetuate locating the position of the corner:

K-1, T4N-R2W
Found 1/2" bar in concrete monument as noted above.
Found 3/4" pinched pipe, Southwest corner Section 36, T5N, R2W, East 11.95'
Found nail & tag #16053 in North side 6" Elm stump, S70°W, 16.05'
Found nail & tag #16053 in West side 16" Elm stump, N05°W, 27.72'
Set nail & tag #25832 in West side 12" Box Elder, S30°E, 32.93'
Set nail & tag #25832 in North side 10" Poplar, S80°W, 45.33'
Set nail & tag #25832 in East side 8" Ash, N60°W, 66.61'

Signed by Larry A. Bryan
Surveyor's Michigan License No. 25832

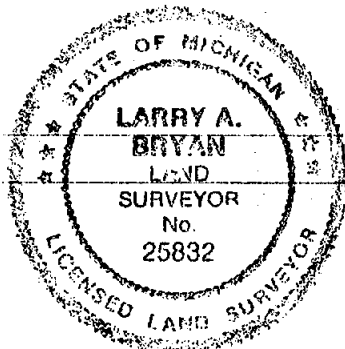

Date 11-23-94

FORM APPROVED BY MICHIGAN STATE BOARD OF LAND SURVEYORS, JAN. 28, 1971
REVISED MAY 14, 1975
REVISED JAN., 1983

P.A. 345 INGHAM COUNTY
PEER APPROVED 5/11/94 AL

PART "A" CONTINUED

2. On Sept. 7, 1847, A. Jackson, County Surveyor, recorded corner with no monument noted witnessed by:
 Tam 16 N59-1/2E 22.53
 no other Tree
 (Vol.2 P.17 of County Surveyor Records)
3. On Nov. 19th, 1874, T.J. Brown, County Surveyor, recorded corner as a "Post" and noted that the bearing trees were gone, no witnesses given.
 (Vol.3 P.91 of County Surveyor Records)
4. Corner referred to in a resurvey of Lansing Township by R.J. Robb County Surveyor, in August and September of 1909 (vol. 3, page 218 and 219 County Surveyor Records) and identified as a "cement post 3" square on top, 4" square on bottom and 2.5 feet long, by an iron post of fence going South, Delta (Dewitt) post 18 lks East, set half way from adj. corners and on true line".
5. Marvin F. Fouty, P.S. #18989, recorded corner on 02/27/75 in Liber 2 of Surveys, Pages 308-309, as having found a 3/4" pipe witnessed by:
 Survey tag and nail South side 6" tree West 36.90'
 Survey tag and nail South side 6" tree East 24.39'
 Survey tag and nail East side 8" tree South 32.98'
6. James E. Stephens, P.S. #16053, recorded corner on 11/15/77 in Liber 4 of Corners, Page 108, and on 06/30/87 in Liber 5 of Surveys, Pages 232-233, as not finding the original monument or accessories and therefore setting a "concrete monument and cap 11.88' West of iron pipe which identifies the SW corner of Section 36, T5N, R2W. Set said monument on a projection of a line between the North 1/4 corner of Section 1 and the Southwest corner of Section 36, T5N, R2W." The concrete monument and cap were witnessed by:
 Survey tag #16053 set in the East side of an 8" Elm tree, N6°36'W, 27.70'
 Survey tag #16053 set in the South side of an 8" Elm tree, S89°34'E, 36.15'
 Survey tag #16053 set in the North side of an 8" Elm tree, N84°12'W, 25.05'
 Iron stake S89°50'12"E, 11.88' - (from Liber 5 Pages 232-233 only)
7. James E. Stephens, P.S. #16053, recorded corner on 09/13/88 in Liber 6 of Corners, Page 391, as rod in concrete monument witnessed by tags nailed to:
 West side of 14" Elm tree North 27.71 feet
 North side of 6" Elm tree S85°W 16.07 feet
 NE side of 14" Elm tree S45°W 39.39 feet
 Iron pipe East 11.88 feet
8. Corner referred to in Recorded Subdivision Plats: The Crossings at Abbott Parkside, James E. Stephens P.S. #16053, January 18, 1991, Liber 46 of Plats, Page 24, 25 and 26; The Crossings at Abbott Parkside No.2, James E. Stephens P.S. #16053, March 12, 1993, Liber 48 of Plats, Page 3 and 4; The Crossings at Abbott Parkside No.3, James E. Stephens P.S. #16053, July 9, 1993, Liber 48 of Plats, Page 22 and 23.

MAY 10 8 51 AM '94

LAND CORNER RECORDATION CERTIFICATE
Filing Requirement of Act 74, Mich. P.A. 1970

For corners in

Ingham
(County)

Located In:

Corner Code #

REGISTER OF DEEDS
Ingham County, Mich.
TNGHAM COUNTY, MICH.

1. Public Land Survey T 4N R 2W K-2
T R
T R
T R
2. Property Controlling S T R
in Section S T R
3. Miscellaneous S T R
Property in Sec. S T R

Register of Deeds Stamp & File Number

4. Lot No. , Recorded Plat
5. Private Claims

	A	B	C	D	E	F	G	H	I	J	K	L	M
2	6	5	4	3	2	1							
3													
4	7	8	9	10	11	12							
5													
6	18	17	16	15	14	13							
7													
8	19	20	21	22	23	24							
9													
10	30	29	28	27	26	25							
11													
12	31	32	33	34	35	36							
13													

I, Larry A. Bryan, in a field survey on February 23, 19 94, do hereby certify that under requirements of P.A. 74, Michigan P.A. of 1970, the corner points mentioned in lines 1 and 2 above were in conformance with regulations and rules therefore as required in the current manual of survey instructions of the United States Department of the Interior, Bureau of Land Management or by a decree of a Court of Law and/or that the corner points mentioned in lines 3, 4 and 5 above were in conformance with the rules of the Michigan Board of Land Surveyors or by a Decree of a Court of Law; established, re-established, monumented, re-monumented, recovered, found as expressed below:

NOTE: Not more than 4 corners, all in the same town and range, may be recorded on this certificate.

A. Description of original monument and accessories and/or subsequent restoration:
K-2,

1. On Monday Feb. 12th, 1827, Musgrove Evans, U.S. Deputy Surveyor,
Set 1/4 Post fw
Sug. 11 N.64-1/2E. 24
Sug. 15 N.57W. 30

(Continued on Back)

B. Description of corner evidence found and/or method applied in restoring or reestablishing corner:

K-2, Investigation at this corner revealed a 5/8" bar in a monument box 36.2' West of centerline of Coolidge Road. All of the witnesses listed in item #10 were found with the distances noted in part "C" below. No monumentation from Haver Acres Sub. No.1 was found due to construction. Accepted 5/8" bar in monument box as perpetuated location of K-2.

C. Description of monument for corner and accessories established to perpetuate locating the position of the corner:

- K-2, T4N-R2W
Found 5/8" bar in monument box as noted above.
Found nail & tag #16053 in West side of a power pole, N05°E, 96.16'.
Found nail & tag #16053 in West side of a 10" Cherry, East, 108.64'.
Found nail & tag #16053 in West side of a power pole, S05°E. 163.84'.
Found P.K. nail in 2'diameter concrete light pole base, S70°E, 96.37'.
Centerline of a fire hydrant, N20°E, 232.30'.
Centerline of the Northeast bolt in a 2' diameter concrete light pole base, S45°W, 39.80'.

Signed by Larry A. Bryan
Surveyor's Michigan License No. 25832

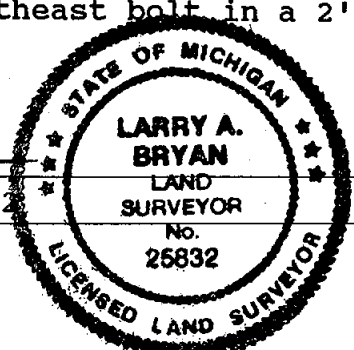

Date 4-15-94

FORM APPROVED BY MICHIGAN STATE BOARD OF LAND SURVEYORS, JAN. 28, 1971
REVISED MAY 14, 1975
REVISED JAN., 1983

P.A. 345 INGHAM COUNTY
PEER APPROVED 4/13/94 m

PART "A" CONTINUED

2. On Sept. 7, 1847, A. Jackson, County Surveyor, recorded corner with no monument noted witnessed by:
 Tam 7 South 12.50 lks.
 no other Tree (Vol.2 P.17 of County Surveyor Records)
3. On Nov. 19th, 1874, T.J. Brown, County Surveyor, recorded corner as a "Post" from which a Sugar 15 inches in diameter bears N.64-1/2E. 24 links distant. (Vol.3 P.91 of County Surveyor Records)
4. On Dec. 22nd, 1881, A.P. Drake, County Surveyor, recorded corner as a Black Walnut Stake with no bearing trees given. (Vol.3 P.185 of County Surveyor Records)
5. Corner referred to in a resurvey of Lansing Township by R.J. Robb County Surveyor in August and September, 1909 (vol. 3, page 218 and 219 County Surveyor Records) as a "cement post 3" square on top, 4" square on bottom and 2.5' long by two posts with one witness to a Ash N60°E 28'
6. Records of L.J. Hendryx, P.S. #3276, supplied by R. Helsel, P.S. #18994, record corner as a square concrete monument with no witnesses given and date unknown.
7. James E. Stephens, P.S. #16053, recorded corner on 11/29/73 in Liber 2 of Corners, Page 559, and on 10/28/80 in Liber 4 of Surveys, Page 149, and on 09/28/82 in Liber 4 of Surveys, Pages 578-584, as having found an old concrete monument in the intersection of a 3-way fence witnessed by:
 Survey tag in the SW side of a 10" Hickory tree, N14°21'E 19.05 feet
 Survey tag in the W. side of a 14" Wild Cherry tree, N85°11'E 8.54 feet
 Survey tag in the N. side of a 24" Oak tree, S9°40'E 11.91 feet
 The bearing of the Section line North of the corner is N0°37'20"W.
8. David L. Clifford, P.S. #25837, recorded corner on 04/06/82 in Liber 4 of Surveys, Page 524, calling only for L2, Pg.559.
9. Maurice H. Mahieu, P.S. #28414, recorded corner on 04/15/83 in Liber 4 of Surveys, Page 702, and on 07/07/83 in Liber 4 of Surveys, page 734, and on 11/19/84 in Liber 4 of Surveys, Page 946, with the same witnesses as listed in item #7.
10. James E. Stephens, P.S. #16053, recorded corner on 06/25/87 in Liber 6 of Corners, Page 337, and on 06/30/87 in Liber 5 of Surveys, Pages 232 - 233, and on 10/17/89 in Liber 5 of Surveys, Pages 1152-1159, stating the monument and its witnesses listed in item #7 were removed during road construction. A 5/8 inch iron rod in a monument box was found that was accepted as the re-established corner witnessed by: Nail and tag in the East side of a utility pole N5°E 96.33 feet, Nail and tag in the North side of a 10" Cherry tree East 108.70 feet, Chiseled "x" in top of concrete curb S45°E 12.52 feet, P.K. nail in concrete base of light pole S70°E 96.40 feet.
11. Douglas K. Richardson, P.S. #31603, recorded corner on 10/06/87 in Liber 5 of Surveys, Page 306, calling only for L2, Pg.559.
12. Maurice H. Mahieu, P.S. #28414, recorded corner on 10/27/87 in Liber 5 of Surveys, Pages 344-345, with the same witnesses as listed in item #10.
13. Corner referred to in Recorded Subdivision Plats: Haver Acres Sub. No.1, Laverne J. Handryx P.S. #3276, October 12, 1953, Liber 17 of Plats, Page 14; The Crossings at Abbott Parkside, James E. Stephens P.S. #16053, January 18, 1991, Liber 46 of Plats, Page 24, 25 and 26.

LAND CORNER RECORDATION CERTIFICATE
Filing Requirement of Act 74, Mich. P.A. 1970

MAY 10 8 52 AM '94

REGISTER OF DEEDS
Randy Johnson
INGHAM COUNTY, MICH.

For corners in

Ingham

(County)

Located In:

Corner Code #

1. Public Land Survey

T 4N R 2W

K-3

T R

T R

T R

T R

2. Property Controlling
in Section

S T R

S T R

3. Miscellaneous

S T R

Property in Sec.

S T R

Register of Deeds Stamp & File Number

4. Lot No. , Recorded Plat

5. Private Claims

	A	B	C	D	E	F	G	H	I	J	K	L	M
2	6	5	4	3	2	1							
3													
4	7	8	9	10	11	12							
5													
6	18	17	16	15	14	13							
7													
8	19	20	21	22	23	24							
9													
10	30	29	28	27	26	25							
11													
12	31	32	33	34	35	36							
13													

I, Larry A. Bryan, in a field survey on February 28, 19 94, do hereby certify that under requirements of P.A. 74, Michigan P.A. of 1970, the corner points mentioned in lines 1 and 2 above were in conformance with regulations and rules therefore as required in the current manual of survey instructions of the United States Department of the Interior, Bureau of Land Management or by a decree of a Court of Law and/or that the corner points mentioned in lines 3, 4 and 5 above were in conformance with the rules of the Michigan Board of Land Surveyors or by a Decree of a Court of Law; established, re-established, monumented, re-monumented, recovered, found as expressed below:

NOTE: Not more than 4 corners, all in the same town and range, may be recorded on this certificate.

A. Description of original monument and accessories and/or subsequent restoration:

K-3,

1. On Monday Feb. 12th, 1827, Musgrove Evans, U.S. Deputy Surveyor, Set Post Cor. to Secs. 1, 2, 11 & 12 fw an Aspen 3 N.45E. 15lks.
Aspen 8 S.52-1/2W. 18lks.

(Continued on Back)

B. Description of corner evidence found and/or method applied in restoring or reestablishing corner:

K-3, Investigation at this corner revealed a 1/2" bar and cap #19003 in monument box ±5.2' East of the centerline of Coolidge Road. One witness listed in item #7 was found, chiseled cross on top of concrete base of church light standard, Northeast, 59.10', along with all the witnesses listed in item #12 and noted in part "C" below. Accepted 1/2" bar and cap #19003 in monument box as the perpetuated location of K-3.

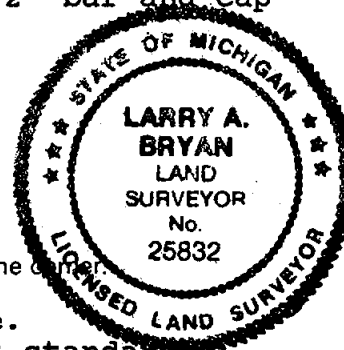

C. Description of monument for corner and accessories established to perpetuate locating the position of the corner:

K-3, T4N-R2W

Found 1/2" bar and cap #19003 in monument box as noted above.

Found chiseled cross on top of concrete base of church light standard, N44°24'W, 59.10'.

Found nail & tag #16053 in Northwest side utility pole, N45°E, 40.32'.

Found nail & tag #16053 in West side light guy pole, S25°E, 76.28'.

Found nail & tag #16053 in North side utility pole, S85°W, 58.75'.

Found nail & tag #16053 in Southwest side utility pole, N35°E 74.19'.

Northwest corner garage to house #1858 Coolidge Road, S70°E, 86.02'.

Southeast corner 4' high by 15" wide brick sign, N30°E, 89.91'.

Centerline of Northeast bolt in 18" diameter concrete light pole base, N70°W, 67.03'.

Signed by Larry A. BryanDate 4-15-94Surveyor's Michigan License No. 25832FORM APPROVED BY MICHIGAN STATE BOARD OF LAND SURVEYORS, JAN. 28, 1971
REVISED MAY 14, 1975
REVISED JAN., 1983P.A. 345 INGHAM COUNTY
PEER APPROVED 4/13/94 M

2615

PART "A" CONTINUED

2. On Dec. 22nd, 1881, A.P. Drake, County Surveyor, recorded corner as a Post found from the original surveys witnessed by: Cottonwood 18 N 3-1/2W, 34-1/4 links, Beech 24 S 27-1/2E, 6 links. (Vol.3, Page 185 of County Surveyor Records).
3. On Jan. 29, 1909, R.J. Robb, County Surveyor, recorded corner as a gas pipe with no witnesses given. (Vol.2 P.264 and Vol.5 P.55 of County Surveyor Records).
4. Corner referred to in a resurvey of Lansing Township by R.J. Robb, County Surveyor, in August and September of 1909 (vol. 3, page 218 and 219 County Surveyors Records) and identified as a "cement post 3" square on top and 4" square on bottom and 2.5 feet long, witnessed by Oak 3" N75°E 41', Ash 2" N50°E 45.5', Ash 2" N45°E 49.3'.
5. Records of L.J. Hendryx, P.S. #3276, supplied by R. Helsel, P.S. #18994, dated 1/25/51 record corner as a "Bolt to Surface" witnessed by: Oak 12" N75°E, 41.1, Maple 12" S55°E, 41.8, NW Cor. House S70°E, 66.4.
6. In Jan. 1965, C.E. Smith, Survey Chief for the Michigan State Highway Department, witnessed corner as a 1/2" iron in centerline of Coolidge Road witnessed by: 23" Maple N85W 34.50, 20" Maple S60E 43.36, 20" Oak N75E 42.84. (from corner witness records of MDOT)
7. James A. Porter, P.S. #19003, recorded corner on 03/01/72 in Liber 1 of Corners, Page 371, as having found a 1/4" reinforcing rod in Coolidge Road surface from the tie recorded on the original plat of Farwood Subdivision, Liber 29, Page 1, Ingham County Records, witnessed by: Chiseled cross on top conc. base of church light standard, N44°24'E, 59.10' Ex. Nail in blazed 20" Maple, N71°46'E, 42.80 feet, Nail with Brass tag in 21" Maple, S57°37'E, 43.00 feet, Nail with Brass tag in 24" Maple, N89°09'W, 34.32 feet.
8. James E. Stephens, P.S. #16053, recorded corner on 11/20/75 in Liber 2 of Surveys, Page 538, and on 05/14/76 in Liber 2 of Surveys, Page 698, and on 05/20/76 in Liber 2 of Surveys, Page 709, and on 10/20/76 in Liber 2 of Surveys, Page 927, as having found a 1/4" re-rod with the same witnesses as listed in item #7.
9. James E. Stephens, P.S. #16053, recorded corner on 10/28/80 in Liber 4 of Surveys, Page 148, and on 09/28/82 in Liber 4 of Surveys, Pages 578-584, as a rod found in the centerline Coolidge Road with the same witnesses as listed in item #7 minus the light standard.
10. James E. Stephens, P.S. #16053, recorded corner on 06/01/83 in Liber 4 of Surveys, Pages 724-728, as a 3/8" iron rod in Coolidge Road with the same witnesses as listed in item #7.
11. Maurice H. Mahieu, P.S. #28414, recorded corner on 07/07/83 in Liber 4 of Surveys, Page 734, and on 11/19/84 in Liber 4 of Surveys, Page 946, as having found an iron rod with the same witnesses as listed in item #7 minus the light standard.
12. Maurice H. Mahieu, P.S. #28414, recorded corner on 06/17/88 in Liber 6 of Corners, Page 376, as having found a 1/2" iron rod in monument box witnessed by: Nail and tag in NW side utility pole N45°E 40.29 feet, Nail and tag in West side Guy pole S25°E 76.47 feet, Nail and tag in North side utility pole S85°W 58.73 feet, Nail and tag in SW side utility pole N35°W 74.19 feet.
13. Corner referred to in Recorded Subdivision Plats: Farwood, Fred N. White P.S. #12034, April 22, 1968, Liber 29 of Plats, Page 1; Farwood North, Donald B. Emery P.E., April 8, 1971, Liber 30 of Plats, Page 21; Farwood South, Donald B. Emery P.E., April 5, 1972, Liber 31 of Plats, Page 3; Irish Gardens No.2, James E. Stephens P.S. #16053, May 17, 1988, Liber 38 of Plats, Page 27 and 28; Pinecrest No.3, Clyde K. Stephens P.S.#3829, February 24, 1965, Liber 26, Page 12 and 13; Pinecrest No.4, Clyde K. Stephens P.S. #3829, July 29, 1968, Liber 29, Page 5; Ramblewood, Clyde K. Stephens P.S. #3829, May 3, 1965, Liber 26 of Plats, Page 15 and 16.