

LAND CORNER RECORDATION CERTIFICATE

Filing Requirement of Act 74, Mich. P.A. 1970

For corners in

INGHAM

(County)

Located In:

Corner Code #

LANSING TOWNSHIP.

1. Public Land Survey

T 4N R 2W

C-1

2. Property Controlling
in Section

S T R

3. Miscellaneous
Property in Sec.

S T R

4. Lot No. F

5. Private Claims

S T R

Paula Johnson
INGHAM COUNTY
REGISTER OF DEEDS

RECORDED

L-10 P-154

CRNR 11.00

2001-060845

Register of Deeds Stamp & File Number

2001-060845

Page: 1 of 2

11/14/2001 08:20A

	A	B	C	D	E	F	G	H	I	J	K	L	M
1													
2	6		5		4			3		2		1	
3													
4	7		8		9			10		11		12	
5													
6	18		17		16			15		14		13	
7													
8	19		20		21			22		23		24	
9													
10	30		29		28			27		26		25	
11													
12	31		32		33			34		35		36	
13													

I, DAVID R. LOHR, PS, in a field survey on 4/25 & 7/17, 2000, do hereby certify that under requirements of P.A. 74, Michigan P.A. of 1970, the corner points mentioned in lines 1 and 2 above were in conformance with regulations and rules therefore as required in the current manual of survey instructions of the United States Department of the Interior, Bureau of Land Management or by a decree of a Court of Law and/or that the corner points mentioned in lines 3, 4 and 5 above were in conformance with the rules of the Michigan Board of Land Surveyors or by a Decree of a Court of Law; established, re-established, monumented, re-monumented, recovered, found as expressed below:

NOTE: Not more than 2 corners, all in the same town and range, may be recorded on this certificate.

A. Description of original monument and accessories and/or subsequent restoration:

- CORNER SET BY MUSGROVE EVANS, U.S. DEPUTY SURVEYOR IN MARCH OF 1827. "INTER. N. BOUNDARY 32 LKS (21.12') EAST OF POST AND SET POST COR. TO SEC. 5 & 6 fw A" WITNESSED BY: BEECH 20", S 14° W, 16 LKS. (10.56') DO 9", S 59° E, 36 LKS. (23.76') GLO NOTES SHOW DISTANCES SOUTH OF 39.22 CH. (2588.52)
- CORNER REFERENCED ON PAGE 153, OF FIELD BOOK #2, BY C.E. HOLLISTER, CLINTON CO. SURVEYOR, DATED APRIL 19, 1899. IN SUMMARY "FROM CORNER TOWN, RAN EAST ... 84.31 (CH.) (5564.46') FOUND STONE," (C-13, DEWITT TWP.) WITNESSED BY: "STONE SET FOR LANSING TWP., 32-1/2 LKS. (21.45') EAST." NO WITNESSES GIVEN FOR LANSING TWP. STONE.
- CORNER REFERENCED IN SURVEY OF LANSING TOWNSHIP IN 1909 BY R.J. ROBB, IN BOOK 5, PAGE 218, AS "CEMENT POST", 2.5 FT. LONG, 3" SQUARE AT TOP AND 4" SQUARE AT BOTTOM, WITNESSED BY: LYNN, N-W 3' AND MAPLE WEST, 21.5 FT. DEWITT COR. WEST 21.4' NO DISTANCES SHOWN ON SURVEY.

CONTINUED ON PAGE 2:

B. Description of corner evidence found and/or method applied in restoring or reestablishing corner:

SEARCHED AT APPARENT LOCATION OF CORNER AND FOUND 1/2" REBAR (NO CAP). AREA HAS BEEN REGRADED DUE TO CONSTRUCTION AND FENCING OF AIRPORT GROUNDS. NO EXCAVATION PERFORMED AT THIS LOCATION. MEASURED WEST 5561.00' TO A-1, WHICH IS IN CLOSE ACCORD TO GLO (CLINTON CO.) DISTANCE OF 5557.53' AND HOLLISTER'S 1899 DISTANCE OF 5564.46'. ACCEPTED LOCATION OF FOUND 1/2" REBAR AS CORNER, HOWEVER, DETERMINED BY TRAVERSE THAT IRON FALLS 0.41 FT. NORTH OF TOWNSHIP LINE. MEASURED FALLING TO C-13, DEWITT TOWNSHIP MATCHES THAT AS RECORDED IN LCRC OF LIBER 6, PAGE 34, AND IN CLOSE ACCORD TO GLO. SET STANDARD INGHAM COUNTY REMON. BAR WITH 2 1/2" ALUMINUM REMON. CAP, ON TOWNSHIP LINE, 0.41' SOUTH OF FOUND 1/2" IRON. UPDATE: 5/21/01 - AT REQUEST OF PEER REVIEW, RETURNED TO SITE AND EXCAVATED IN AN ATTEMPT TO FIND OLD CONCRETE MONUMENT (ITEM #5) EXCAVATED TO DEPTH OF 2.0 FT. IN VERY COMPACT CLAY FILL, FOUND NO OTHER EVIDENCE. CORNER LOCATION FALLS ALONG NORTH EDGE OF AIRPORT SERVICE DRIVE, WHICH APPEARS TO BE IN A FILL SECTION, ANY OLD EVIDENCE WOULD BE UNDER THIS FILL. MEASURED WEST 2660.41' TO B-1, LANSING TWP., EAST 2625.29' TO D-1, LANSING TWP. AND SOUTH 2562.85' TO C-2, LANSING TWP. UPDATE JUNE 2001: EXCAVATED AROUND FOUND CORNER BUT FOUND NO FURTHER EVIDENCE.

C. Description of monument for corner and accessories established to perpetuate locating the position of the corner:

C-1, T4N, R2W, LANSING TOWNSHIP, INGHAM COUNTY. SET STANDARD INGHAM COUNTY REMON. BAR WITH 2 1/2" ALUMINUM REMON. CAP. STAMPED #30090 ON TOWNSHIP LINE. WITNESSED BY: FD. 1/2" IRON (NO CAP), NORTH, 0.41' FD. PK NAIL ON CULVERT, N 00° W, 25.40' FD. PK NAIL ON CULVERT, N 56° W, 63.75' FD. N&T #16053 (STEPHENS), W/S 30" MAPLE, N 21° E, 105.12' SET N&T #30090, W/S 30" MAPLE, N 38° E, 150.05' FOUND C-13, DEWITT TOWNSHIP, PIPE WITH BRASS CAP, N 88° W, 21.50' BEARINGS GIVEN ARE MAGNETIC.



Signed by David R. Lohr

Date OCTOBER 24, 2000

Surveyor's Michigan License No. 30090

FORM APPROVED BY MICHIGAN STATE BOARD OF LAND SURVEYORS, JAN. 26, 1971
REVISED MAY 14, 1975
REVISED JAN., 1983
REVISED OCT, 1995
ADAPTED FOR WORD PROCESSING JAN, 1999

P.A. 345 INGHAM COUNTY
PEER APPROVED 6/19/2001 ML

C-1: T4N, R2W, LANSING TOWNSHIP, PART A: CONTINUED:

4. NORTH-SOUTH 1/4 LINE REFERENCED IN THE FOLLOWING PLATS RECORDED IN INGHAM COUNTY:
A. "LANTEX INDUSTRIAL PARK" DATED FEB. 11, 1965, BY CLYDE K. STEPHENS, RLS AND PE, AND
RECORDED IN LIBER 66 OF PLATS, PAGE 46. NO DISTANCE SHOWN NORTH TO THIS CORNER.
NOTE: PLAT DO NOT MENTION MONUMENT OR GIVE WITNESSES.
5. CORNER REFERENCED IN LCRC, DATED 01/23/80, BY RONNIE M. LESTER, RLS#18998, AND RECORDED IN
LIBER 6, PAGE 34. "FOUND 3" SQUARE CONCRETE MONUMENT SURROUNDED BY OLD RAILROAD SPIKES".
WITNESSED BY: NAIL & TAG, #18998, S/S TWIN 5" ASH, WNW, 38.60'
NAIL & TAG, #18998, S/S MULTI. 4" ASH, NE, 6.88'
NAIL & TAG, #18998, W/S TWIN 8" ASH, SE, 10.65'
NAIL & TAG, #18998, E/S 8" ASH, WEST, 22.05'
C-13 DEWITT TWP., CLINTON CO., 3" BRASS CAP ON 3" IRON PIPE, WEST, 21.50'
6. CORNER REFERENCED IN RECORDED SURVEY, DATED 08/20/87, BY MARK W. WITALEC, PS#30897, AND
RECORDED IN LIBER 5, PAGE 285. FOUND "CONC. MON. SURROUNDED BY STONES." WITNESSED BY:
S.E. 10.65' TO NAIL & TAG #18998, S.W.SIDE 8" TREE
N.E. 6.88' TO NAIL & TAG #18998, S.SIDE 4" TREE
W. 21.50' TO IRON POST WITH BRASS CAP (C-13 DEWITT)
S. 103.69' TO C/L OF R.R.GAUGE
S. 137.15' TO PLAT MON. "LANTEX INDUSTRIAL PARK"
7. NO OTHER REFERENCES FOUND.



2001-060845
Page: 2 of 2
11/14/2001 08:20A

LAND CORNER RECORDATION CERTIFICATE
Filing Requirement of Act 74, Mich. P.A. 1970

For corners in

INGHAM

(County)

Located In:

Corner Code #

LANSING TOWNSHIP.

1. Public Land Survey

T 4N R 2W

C-2

T
T
T
T

R
R
R
R

2. Property Controlling
in Section

S
S

T
T

R
R

3. Miscellaneous
Property in Sec.

S
S

T
T

R
R

4. Lot No. _____, Recorded Plat _____

5. Private Claims _____



2000-051291

Page: 1 of 2

11/30/2000 02:28P

Register of Deeds Stamp & File Number

I, DAVID R. LOHR, in a field survey on 4/25 & 5/23, 2000, do hereby certify that under requirements of P.A. 74, Michigan P.A. of 1970, the corner points mentioned in lines 1 and 2 above were in conformance with regulations and rules therefore as required in the current manual of survey instructions of the United States Department of the Interior, Bureau of Land Management or by a decree of a Court of Law and/or that the corner points mentioned in lines 3, 4 and 5 above were in conformance with the rules of the Michigan Board of Land Surveyors or by a Decree of a Court of Law; established, re-established, monumented, re-monumented, recovered, found as expressed below:

NOTE: Not more than 2 corners, all in the same town and range, may be recorded on this certificate.

A. Description of original monument and accessories and/or subsequent restoration:

1. CORNER SET BY MUSGROVE EVANS, U.S. DEPUTY SURVEYOR IN MARCH OF 1827. "SET 1/4 SEC. POST fw A" WITNESSED BY:

BEECH 14", S 80° W, 3 LKS. (1.98')

ELM 36", S 76° E, 14 LKS. (9.24')

GLO NOTES SHOW DISTANCES SOUTH OF 40 CH. (2640) AND NORTH OF 39.22 CH. (2588.52)

2. CORNER REFERENCED IN SURVEY BY T.J. BROWN, DEP. COUNTY SURVEYOR, DATED AUG. 17, 1864, AND RECORDED IN BOOK 3, PAGE 3, COUNTY SURVEYORS RECORDS. CORNER SHOWN AS "POST", NO WITNESSES GIVEN: SURVEY SHOWS DISTANCE WEST OF 40 CH. (2640') AND SOUTH OF 34.85 CH. (2300.10') TO RIVER BANK.

3. CORNER REFERENCED IN SURVEY BY T.J. BROWN, DEP. COUNTY SURVEYOR, DATED OCT. 20, 1870, AND RECORDED IN BOOK 3, PAGE 16, COUNTY SURVEYORS RECORDS. CORNER SHOWN AS "A STONE, THE TOP OF WHICH IS EVEN WITH THE SURFACE OF THE GROUND", NO WITNESSES GIVEN:

SURVEY SHOWS DISTANCE EAST OF 38.545 CH. (2543.97') AND SOUTH OF 34.95 CH. (2306.70') TO RIVER BANK.

4. CORNER REFERENCED IN SURVEY OF LANSING TOWNSHIP IN 1909 BY R.J.ROBB, IN BOOK 5, PAGE 218, AS "CEMENT POST", 2.5 FT. LONG, 3" SQUARE AT TOP AND 4" SQUARE AT BOTTOM, WITNESSED BY: D. BASSWOOD, 10", S. 23.7' AND ELM 10", S-E 7'. WEST, 21.5 FT. DEWITT COR. WEST 21.4' NO DISTANCES SHOWN ON SURVEY.

CONTINUED ON BACK

B. Description of corner evidence found and/or method applied in restoring or reestablishing corner:

SEARCHED AT APPARENT LOCATION OF CORNER AND 3/4" X 17" PINCH PIPE AS PER LCRC OF LIBER 1, PAGE 575. CORNER FALLS IN FRONT YARD OF HOUSE #2211 DELTA RIVER DRIVE. NO EXCAVATION PERFORMED AT THIS LOCATION. ACCEPTED LOCATION OF FOUND 3/4" PIPE AS CORNER AS RECORDED IN ITEM #8, TRAVERSED WEST 2663.32' TO B-2 AND NORTH 2562.43' TO C-1. SET STANDARD INGHAM COUNTY REMON. BAR WITH 2 1/2" ALUMINUM REMON. CAP.

THIS DOCUMENT IS BEING RE-RECORDED TO PROVIDE PEER REVIEW STAMP OF APPROVAL.

C. Description of monument for corner and accessories established to perpetuate locating the position of the corner:

C-2, T4N, R2W, LANSING TOWNSHIP, INGHAM COUNTY. SET STANDARD INGHAM COUNTY REMON. BAR WITH 2-1/2" ALUMINUM REMON. CAP. STAMPED #30090. WITNESSED BY:

NW COR.OF HOUSE #2827 ARLINGTON DR., N 86° E, 78.03'

NW COR.OF HOUSE #2211 DELTA RIVER DR., S 00° E, 30.35'

NE COR.OF GAR., #2217 DELTA RIVER DR., S 39° W, 39.83'

SET N&T #30090, N/S POWER POLE, S 87° W, 95.88'

FACE OF CURB, DELTA RIVER DR., N 15° W, 25.12'

BEARINGS GIVEN ARE MAGNETIC.



Signed by David R. Lohr

Date NOVEMBER 27, 2000

Surveyor's Michigan License No. 30090

FORM APPROVED BY MICHIGAN STATE BOARD OF LAND SURVEYORS, JAN. 28, 1971
REVISED MAY 14, 1975
REVISED JAN., 1983
REVISED OCT., 1986
ADAPTED FOR WORD PROCESSING JAN., 1989

P.A. 345 INGHAM COUNTY
PEER APPROVED 10/3/2000 RL

C-2: LANSING TOWNSHIP, PART A CONTINUED:

5. CORNER REFERENCED IN THE PLAT OF DELTA GRANDE SUBDIVISION DATED JUNE 7, 1929, BY J.A DINSMORE, REG. CIVIL ENG., AND RECORDED IN LIBER 11 OF PLATS, PAGE 20. NO DISTANCE SHOWN NORTH TO THIS CORNER. NOTE: PLAT DOES NOT MENTION MONUMENT OR GIVE WITNESSES.
6. CORNER REFERENCED IN THE PLAT OF RIVER FOREST SUBDIVISION DATED SEPT. 18, 1946, BY CLYDE K. STEPHENS, CIVIL ENGINEER & LAND SURVEYOR, AND RECORDED IN LIBER 14 OF PLATS, PAGE 5. CORNER IS SHOWN AS "O" AND FALLS WITHIN LOT #69, 13.3 FT. SOUTH OF SOUTH ROW OF DELTA RIVER DRIVE.
7. CORNER REFERENCED IN THE PLAT OF LANTEX INDUSTRIAL PARK, DATED FEB. 11, 1966, BY CLYDE K. STEPHENS, CIVIL ENGINEER & LAND SURVEYOR, AND RECORDED IN LIBER 26 OF PLATS, PAGE 46. NO DISTANCE SHOWN SOUTH TO THIS CORNER.
8. CORNER REFERENCED IN LCRC, DATED NOV. 19, 1971, BY CLYDE K. STEPHENS, RLS #3829 AND RECORDED IN LIBER 1, PAGE 575. "A 3/4" IRON PIPE WAS SET FROM OLD TIES FROM 1946 AND FROM DELTA GRANDE SUB. #1. WITNESSED BY:
 N0°50'W, 85.50 FEET TO A CONCRETE MONUMENT AT THE SE. CORNER OF DELTA GRANDE SUB. #1.
 NW CORNER OF A 1 STORY FRAME HOUSE, N85°33'E, 78.0'
 NW CORNER OF A 1 STORY FRAME HOUSE, #2211, S4°40'E, 30.35'
 N0°50'W, 25.20 FEET TO THE FACE OF THE CURB ON DELTA RIVER DRIVE
9. CORNER REFERENCED IN RECORDED SURVEY, DATED 07/12/76, BY JAMES STEPHENS, PS#16053, AND RECORDED IN LIBER 2, PAGE 854. "EAST 1/4 CORNER, SECTION 6, T4N, R2W, "3/4" IRON PIPE" SAME WITNESSES AS ABOVE.
10. CORNER REFERENCED IN RECORDED SURVEY, DATED 04/28/95, BY DAVID E. ERICKSON, PS#29245, AND RECORDED IN LIBER 7, PAGE 649. "WEST 1/4 CORNER, SECTION 5, (C-2) "END. PINCH PIPE"
 WITNESSED BY:
 N 86° E, 78.03', NW COR. OF 1 STORY HSE. (FOUND)
 S 5° E, 30.45', NW COR. OF 1 STORY HSE. #2211 (FOUND)
 N 1° W, 85.50', CONC. MON. @ SE. COR. DELTA GRANDE SUB. #1. (NOT MEASURED)
 S 41° W, 39.72', NE COR. OF GARAGE TO HSE. #2217. (FOUND)
11. NO OTHER REFERENCES FOUND.



2000-051291

Page: 2 of 2

11/30/2000 02:28P

LAND CORNER RECORDATION CERTIFICATE
Filing Requirement of Act 74, Mich. P.A. 1970

For corners in

INGHAM

(County)

Located In:

Corner Code #

LANSING TOWNSHIP.

1. Public Land Survey

T 4N R 2W

A-1

T R

T R

T R

2. Property Controlling
in Section

S T R

3. Miscellaneous
Property in Sec.

S T R

4. Lot No. , Recorded Plat

5. Private Claims

Paula Johnson
INGHAM COUNTY
REGISTER OF DEEDS
POLARIS SURVEYING CO

RECORDED

L-10 P-32

CRNR 13.00

2000-047313

Register of Deeds Stamp & File Number



2000-047313

Page: 1 of 3

11/07/2000 08:33A

I, DAVID R. LOHR

, in a field survey on JUNE 16, 1999,
do hereby certify that under requirements of P.A. 74, Michigan P.A. of 1970, the corner points mentioned
in lines 1 and 2 above were in conformance with regulations and rules therefore as required in the
current manual of survey instructions of the United States Department of the Interior, Bureau of Land
Management or by a decree of a Court of Law and/or that the corner points mentioned in lines 3, 4 and 5
above were in conformance with the rules of the Michigan Board of Land Surveyors or by a Decree of a
Court of Law; established, re-established, monumented, re-monumented, recovered, found as
expressed below:

NOTE: Not more than 2 corners, all in the same town and range, may be recorded
on this certificate.

A. Description of original monument and accessories and/or subsequent restoration:

1. CORNER SET BY LUCIUS LYON, U.S. DEPUTY SURVEYOR IN FEBRUARY, 1827.

"INT. WEST BOUNDARY 49 LKS (32.34') S. OF (TEMP) POST AND SET POST FW. A " WITNESSED BY:

BEECH 18", S 41 1/2° E, 50 LKS. (33.00')

SUGAR 20", S 75 1/2° W, 36 LKS. (23.76')

GLO NOTES SHOW DISTANCE EAST OF 43.88 CH. (2896.08') and 83.88 (5536.08') (DEWITT TWP)

GLO NOTES SHOW DISTANCES NORTH, AND WEST OF 40.00 CH. (2640.00) (WATERTOWN TWP.)

GLO NOTES SHOW DISTANCE SOUTH OF 39.51 CH. (2607.66') TO M-2 AND 79.51 (5247.66') TO M-3 (DELTA TWP)

2. CORNER REFERENCED IN SURVEY IN SECTION 6 OF LANSING TOWNSHIP, DATED MARCH 1, 1865, BY T.J. BROWN,
DEP. CO. SURVEYOR AND RECORDED IN BOOK 3, PAGE 7, INGHAM COUNTY SURVEYOR RECORDS. SURVEY SHOWS
DISTANCE SOUTH TO A-2 OF 38.93 CH. (2569.38') NO MENTION OF MONUMENT OR WITNESSES GIVEN.

3. CORNER REFERENCED IN SURVEY DATED MAY 10, 1896, BY W.A. ROWE, CO. SURVEYOR, RECORDED IN BOOK 5,
PAGE 7. "AN OLD POST WAS FOUND... O.P.F. ... GAS PIPE"

WITNESSED BY: APPLE 12", N 70 E, 26 LKS. (17.16')

APPLE 12", N 86 E, 65 LKS. (42.90')

CONTINUED ON BACK

B. Description of corner evidence found and/or method applied in restoring or reestablishing corner:

SEARCHED AT APPARENT LOCATION OF CORNER AND FOUND CLINTON COUNTY REMON. PIPE IN MONUMENT BOX AT C/L OF
FRANETTE (OLD WAVERLY ROAD). MON. BOX AND REMON. PIPE ENCASED IN MASSIVE CONCRETE BLOCK AS PER SURVEYOR
PIERSON WHO SET REMON. PIPE IN 1993. DID NOT EXCAVATED INTERIOR OF MON. BOX AS THIS CORNER HAS ALREADY
BEEN PEER REVIEWED AND APPROVED BY CLINTON COUNTY REMON. PROGRAM. ACCEPTED LOCATION OF FOUND CLINTON
COUNTY REMON. PIPE AS STANDARD TOWNSHIP CORNER, PER SURVEYOR PIERSON'S TESTIMONY OF LCRC AS RECORDED IN
LIBER 4, PAGE 16, CLINTON COUNTY RECORDS. (UPDATE-7/01/00) AT REQUEST OF INGHAM PEER REVIEW COMMITTEE,
I DISCUSSED THIS CORNER WITH SURVEYOR PIERSON. HE INDICATED THIS CORNER LOCATION IS BASED ON THE
HISTORICAL LOCATION AS RECOVERED BY MDOT IN 1939 (SEE ITEM A #4). HE RECOVERED A BOATSPIKE WHICH WAS
OVER ANOTHER BOATSPIKE AT A DEPTH OF 24". VERIFIED LOCATION OF CORNER BY RECOVERING MONUMENTATION IN
PLAT OF CULVERS SUBDIVISION (1925) (SEE ITEM 5, PART A) WHICH LIES IMMEDIATELY WEST AND NORTH OF THIS
CORNER. MEASURED WEST 2626.81' TO L-13, WATERTOWN TWP.; EAST 5561.00' TO C-13, DEWITT TWP.; SOUTH
2572.72' TO A-2, LANSING TWP.; AND NORTH 2644.51' TO M-12, WATERTOWN TWP.

C. Description of monument for corner and accessories established to perpetuate locating the position of the corner:

A-1, T4N, R2W, LANSING TOWNSHIP, INGHAM COUNTY. FOUND STANDARD CLINTON COUNTY REMON. PIPE* WITH
2 1/2" ALUMINUM REMON. CAP IN MON. BOX IN FRANETTE ROAD (OLD WAVERLY ROAD). WITNESSED BY:

ED. P.K. NAIL, S/S POWER POLE, N 85° W, 31.65'

ED. N&T #16053, E/S POWER POLE, N 85° W, 31.25'

ED. N&T #16053, W/S POWER POLE, S 12° E, 85.10'

ED. N&T #16053, W/S POWER POLE, N 58° E, 32.40'

ED. N&T #16053, W/S POWER POLE, N 61° E, 52.75'

BEARINGS GIVEN ARE MAGNETIC.

*STANDARD CLINTON COUNTY MONUMENT IS A 2 1/2" DIAMETER STEEL TUBE 30" LONG WITH A
STAMPED BRASS CAP AND A BREAKAWAY MAGNETIC BASE. BRASS CAP IS STAMPED P.S. 30090

Signed by David R. Lohr

Date OCTOBER 24, 2000

Surveyor's Michigan License No. 30090



FORM APPROVED BY MICHIGAN STATE BOARD OF LAND SURVEYORS, JAN. 28, 1971

REVISED MAY 14, 1975

REVISED JAN., 1983

REVISED OCT., 1995

ADAPTED FOR WORD PROCESSING JAN., 1999

P.A. 345 INGHAM COUNTY
PEER APPROVED 10/24/2000 RL

A-1: LANSING TOWNSHIP, PART A CONTINUED:

4. CORNER REFERENCED IN RESURVEY OF LANSING TOWNSHIP, DATED 1909, AND RECORDED IN BOOK 5, PAGE 218, COUNTY SURVEYORS RECORDS, BY R. J. ROBB, "ALL CORNERS ARE MARKED BY CEMENT POSTS 2.5' LONG - 3" SQUARE AT TOP - 4" SQUARE AT BOTTOM." WITNESSED BY:
LOCUST 2" EAST 20'
APPLE 20" N-E 17'
5. CORNER REFERENCED AS THE SOUTHEAST CORNER OF CULVER'S SUBDIVISION, BY SURVEYOR A.S. BATEMAN, DATED 8/25/1925 AND RECORDED IN LIBER 1 OF PLATS, PAGE 48, CLINTON COUNTY RECORDS. NO REFERENCE TO CORNER MONUMENT, WITNESSED BY PLAT MONUMENT 33 FT. WEST.
6. MARGINAL NOTE ON EATON COUNTY ROAD COMMISSION COPY OF ORIGINAL NOTES STATES:
"ST. HIGHWAY 1939 - NE COR SEC 1, 3" D. CONC POST & IRON" WITNESSED BY:
18" APPLE, S 78° E, 72.17'
18" APPLE, S 52° E, 52.98'
4" ELM, S 53° W, 33.79'
7. CORNER REFERENCED IN MSHD PLAN BOOK FOR INGHAM COUNTY AS BEING 2573.47 NORTH OF A-2 (LANSING TWP.) AND 5213.47 FT. NORTH OF A-3, LANSING TOWNSHIP BY STATIONING ALONG AN OFFSET TRAVERSE LINE. NO MENTION OF MONUMENT OR WITNESSES GIVEN.
8. CORNER NOTED IN UNDATED NOTHSTINE NOTES AS A "3 INCH SQR. CONC. POST RAISED WITH 14" BOAT SPIKE." SAME WITNESSES AS IN ITEM #4 ABOVE.
9. CORNER REFERENCED IN THE FOLLOWING PLATS RECORDED IN EATON COUNTY:
A. "SARATOGA FARMS", BY SURVEYOR FRED N. WHITE, RLS #12034, RECORDED 2/21/64, IN LIBER 4 OF PLATS, PAGE 36.
B. "SARATOGA FARMS No.1", BY SURVEYOR FRED N. WHITE, RLS #12034, RECORDED 7/20/65, IN LIBER 4 OF PLATS, PAGE 63.
- ALSO REFERENCED IN THE FOLLOWING PLATS RECORDED IN INGHAM COUNTY:
A. "MOUNT VERNON PARK" DATED OCT. 13, 1969, BY FRED N. WHITE, RLS #12034 AND RECORDED IN LIBER 29 OF PLATS, PAGE 28.
- "NOTE: NONE OF THE ABOVE PLATS MENTION CORNER MONUMENT OR GIVE WITNESSES.
10. CORNER REFERENCED AS M-1, DELTA TOWNSHIP, IN LCRC DATED MARCH 21, 1973, BY JAMES E. STEPHENS, LAND SURVEYOR #16053, AND RECORDED IN LIBER 1, PAGE 342, EATON COUNTY RECORDS. "A 5/8 INCH IRON ROD IN A MONUMENT BOX WAS FOUND IN THE CENTERLINE OF THE SECTION LINE ROAD (FRANETTE ROAD). "THE 5/8 INCH IRON ROD FOUND AT THE NE CORNER WAS LEFT IN POSITION WITH THE FOLLOWING WITNESSES;"
SURVEY TAG IN THE EAST SIDE OF A UTILITY POLE, N 87° 11' W, 31.29'
SURVEY TAG IN THE WEST SIDE OF A UTILITY POLE, N 56° 37' E, 52.55'
SURVEY TAG IN THE NORTH SIDE OF A UTILITY POLE, S 15° 34' E, 90.60'
THE BEARING OF THE SECTION LINE SOUTH OF THE CORNER IS S 0°01'20"W, BASED ON THE PLAT OF SARATOGA FARMS.
11. CORNER REFERENCED AS A-1, LANSING TOWNSHIP, IN LCRC DATED AUG. 29, 1973, BY RON HELSEL, RLS #18994, AND RECORDED IN LIBER 2, PAGE 547, INGHAM COUNTY RECORDS. "FOUND MONUMENT BOX WITH BOAT SPIKE AS DESCRIBED IN MDSH WITNESSES." WITNESSED BY:
18" APPLE, S 78° E, 72.17'
18" APPLE, S 52° E, 52.98'
4" ELM, S 53° W, 33.79'
12. CORNER REFERENCED IN SURVEY BY JOHN A. SELLEK, P.E. AND RLS #02585, DATED AUG. 16, 1973 AND RECORDED IN LIBER 1, PAGE 474. NO MENTION OF MONUMENT OR WITNESSES GIVEN.
13. CORNER REFERENCED IN SURVEYS BY JAMES STEPHENS, PS #16053, DATED APRIL 6, 1973 AND RECORDED IN LIBER 3, PAGE 328 AND 329, AS "5/8" IRON ROD IN MON. BOX." WITNESSED BY:
SURVEY TAG IN THE EAST SIDE OF A UTILITY POLE, N 87° 11' W, 31.29'
SURVEY TAG IN THE WEST SIDE OF A UTILITY POLE, N 56° 37' E, 52.55'
SURVEY TAG IN THE NORTH SIDE OF A UTILITY POLE, S 15° 34' E, 90.60'
14. CORNER REFERENCED IN SURVEY BY RONNIE M. LESTER, RLS #18998, DATED 8/1/74 AND RECORDED IN LIBER 1, PAGE 532, CLINTON COUNTY RECORDS, AS SE COR. SECTION 36, T5N, R3W. "FD. BAR IN MON. BOX." WITNESSED BY:
STEPHENS NAIL & TAG, NORTH SIDE POWER POLE, NE, 52.81'
STEPHENS NAIL & TAG, NE SIDE POWER POLE, SSE, 90.54'
P.K. NAIL, SOUTH SIDE POWER POLE, WEST, 31.60'
15. CORNER REFERENCED IN SURVEY BY JOHN A. SELLEK, P.E. AND RLS #02585, DATED 11/12/79 AND RECORDED IN LIBER 3, PAGE 46. NO MENTION OF MONUMENT OR WITNESSES GIVEN.
16. CORNER REFERENCED IN SURVEY BY FRED N. WHITE, RLS #12034, DATED APRIL 21, 1980 AND RECORDED IN LIBER 3, PAGE 148. NO MENTION OF MONUMENT OR WITNESSES GIVEN.



2000-047313

Page: 2 of 3

11/07/2000 08:33A

A-1: LANSING TOWNSHIP, PART A CONTINUED: SHEET 3:

17. CORNER REFERENCED AS M-1, DELTA TOWNSHIP, IN LCRC DATED JUNE 28, 1982, BY MAURICE H. MAHIEU, LAND SURVEYOR #28414, AND RECORDED IN LIBER 2, PAGE 799, EATON COUNTY RECORDS. "A 5/8 INCH BOAT SPIKE IN A MONUMENT BOX WAS FOUND IN THE CENTERLINE OF THE SECTION LINE ROAD (FRANETTE ROAD)." "THE 5/8" BOAT SPIKE WAS LEFT IN POSITION WITH THE FOLLOWING WITNESSES:
- NAIL AND TAG IN THE EAST SIDE OF A UTILITY POLE, N 86° W, 31.23'
 - NAIL AND TAG IN THE WEST SIDE OF A UTILITY POLE, N 44° E, 32.51'
 - NAIL AND TAG IN THE N.W. SIDE OF A UTILITY POLE, N 48° E, 52.84'
 - NAIL AND TAG IN THE WEST SIDE OF A UTILITY POLE, S 22° E, 85.20'
18. CORNER REFERENCED IN SURVEY BY JAMES STEPHENS, PS #16053, DATED APRIL 12, 1983 AND RECORDED IN LIBER 3, PAGE 573, AS "5/8" BOAT SPIKE IN MON. BOX" WITNESSED BY:
- UT. POLE, N 86° W, 31.23'
 - UT. POLE, N 44° E, 32.51'
 - UT. POLE, N 48° E, 52.84'
 - UT. POLE, S 22° E, 85.20'
19. CORNER REFERENCED IN SURVEY BY DOUGLAS K. RICHARDSON, LLS #31603, DATED APRIL 22, 1986 AND RECORDED IN LIBER 4, PAGE 91. NO MENTION OF MONUMENT OR WITNESSES GIVEN. ONLY REFERENCED AS LIBER 2, PAGE 799. SURVEY SHOWS A DISTANCE WEST TO L-1 OF 2643.22.
20. CORNER REFERENCED AS A-1, LANSING TOWNSHIP, IN LCRC DATED OCT. 20, 1986, BY MARK W. WITALEC, LLS #30897, AND RECORDED IN LIBER 6, PAGE 304, INGHAM COUNTY RECORDS. "FOUND BOAT SPIKE IN MON. BOX (TIES IN L.2, PP.547-548 OBLITERATED)" WITNESSED BY:
- N.E. 52.81' NAIL & TAG #16053 N.W. SIDE P.P.
 - S.S.E. 86.16' TAG #16053 W. SIDE P.P.
 - W. 31.74' P.K. S. SIDE POLE
 - S.S.W. 154.95' P.K. & CAP #30897 (SET) E. SIDE P.P.
21. CORNER REFERENCED IN PLAT OF SARATOGA FARMS NO. 2, BY MARVIN F. FOUTY, RLS # 18989, DATED 12/05/88, AND RECORDED IN LIBER 11, PAGE 58, EATON COUNTY RECORDS. NO MENTION OF MONUMENT OR WITNESSES GIVEN. PLAT SHOWS DISTANCE WEST TO L-1, DELTA TOWNSHIP OF 2642.55 FT.
22. CORNER REFERENCED IN PLAT OF SARATOGA FARMS NO. 3, BY MARVIN F. FOUTY, RLS # 18989, DATED 09/18/90, AND RECORDED IN LIBER 12, PAGE 3 & 4, EATON COUNTY RECORDS. NO MENTION OF MONUMENT OR WITNESSES GIVEN. PLAT SHOWS DISTANCE WEST TO L-1, DELTA TOWNSHIP OF 2642.55 FT.
23. CORNER REFERENCED AS A-13, DEWITT TOWNSHIP, CLINTON COUNTY, IN LCRC DATED OCT. 21, 1993, BY ARDEN S. PIERSON, LLS #13039, AND RECORDED IN LIBER 4, PAGE 16, CLINTON COUNTY RECORDS. SECTION B STATES: "FOUND BOAT SPIKE IN MONUMENT BOX, VERIFIED WITH MDOT REFERENCE POINT - EXCAVATED BELOW AND FOUND BOATSPIKE BURIED 24" - PLACED STANDARD CLINTON COUNTY MONUMENT AND REPLACED MONUMENT BOX." WITNESSED BY:
- BOATSPIKE NORTH 77.06'
 - PK NAIL, S. SIDE TELEPHONE POLE, N 80° W, 31.70'
 - N & T # 16053 NW SIDE TELEPHONE POLE, N 64° E, 52.83'
 - N & T # 16053 W SIDE POWER POLE, S 12° E, 85.20'
 - N & T E. SIDE POWER POLE, S 16° W, 154.95'
24. NO OTHER REFERENCES FOUND.



2000-047313
Page: 3 of 3
11/07/2000 08:33A

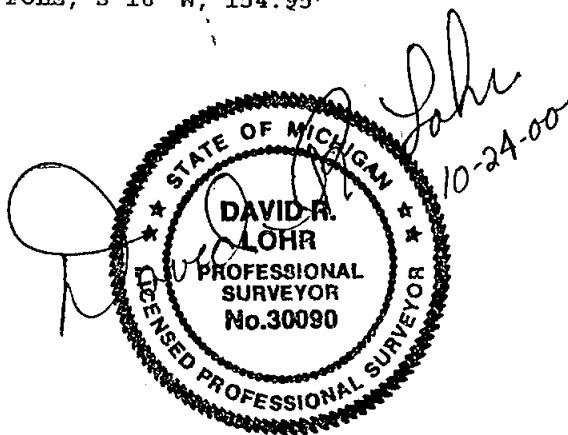

LAND CORNER RECORDATION CERTIFICATE
Filing Requirement of Act 74, Mich. P.A. 1970

For corners in
INGHAM
(County)

Located In:

Corner Code #

LANSING TOWNSHIP.

1. Public Land Survey

T 4N R 2W

A-2

2. Property Controlling
in Section

S T R

3. Miscellaneous
Property in Sec.

S T R

S T R

Paula Johnson
INGHAM COUNTY
REGISTER OF DEEDS
POLARIS SURVEYING CO

RECORDED

L-10 P-35

CRNR 11.00

2000-047314

Register of Deeds Stamp & File Number

4. Lot No. , Recorded Plat

5. Private Claims



2000-047314

Page: 1 of 2

11/07/2000 08:33A

I, DAVID R. LOHR, in a field survey on 06/16/99 & 10/18/00, do hereby certify that under requirements of P.A. 74, Michigan P.A. of 1970, the corner points mentioned in lines 1 and 2 above were in conformance with regulations and rules therefore as required in the current manual of survey instructions of the United States Department of the Interior, Bureau of Land Management or by a decree of a Court of Law and/or that the corner points mentioned in lines 3, 4 and 5 above were in conformance with the rules of the Michigan Board of Land Surveyors or by a Decree of a Court of Law; established, re-established, monumented, re-monumented, recovered, found as expressed below:

NOTE: Not more than 2 corners, all in the same town and range, may be recorded on this certificate.

A. Description of original monument and accessories and/or subsequent restoration:
1. CORNER NOT SET IN ORIGINAL GLO SURVEY.

2. CORNER REFERENCED IN SURVEY OF "EATON ROAD", LANSING TOWNSHIP, SEPT. 28, 1839, BY A. JACKSON, SURVEYOR. "COM. AT THE 1/4 POST ON THE W. LINE OF SEC. 6 IN T4N, R2W,"

WITNESSED BY: ANCHOR POST, N 86°30'E, 20 CH. (1320')

ANCHOR POST, S 56°30'E, 16 CH. (1056')

A STAKE, N 68° E, 48 CH. (3168')

3. CORNER REFERENCED IN SURVEYS DATED AUG. 13-16, 1865, BY T.J. BROWN, DEP. CO. SURVEYOR, RECORDED IN VOL. 3, PAGES 13 AND 16 AS "A POST FROM WHICH A WILLOW 10 INCHES IN DIAMETER BEARS S.27°E, 225.33 LKS" (148.72') SURVEY SHOWS DISTANCE NORTH TO A-1 OF 38.93 CH. (2569.38')

4. CORNER REFERENCED IN SURVEY DATED MAY 10, 1896, BY W.A. ROWE, CO. SURVEYOR, RECORDED IN BOOK 5, PAGE 7. "AN OLD POST WAS FOUND... AND THE E&W 1/4 LINE WAS DETERMINED. Q.P.F. IRON POST"

WITNESSED BY: SUGAR 16", N 29 1/2 W, 210 LKS. (138.6')

SUGAR 14", S 78 1/2 W, 300 LKS. (198')

CONTINUED ON BACK

B. Description of corner evidence found and/or method applied in restoring or reestablishing corner:
SEARCHED AT APPARENT LOCATION OF CORNER AND FOUND 3/4" X 22" PINCH PIPE IN MON. BOX, AT C/L OF WAVERLY ROAD AND DELTA RIVER DRIVE. FOUND SURVEYOR BRYAN'S (#25832) AND STEPHENS (#16053) WITNESS TAGS FOR SURVEYS IN DELTA TOWNSHIP. EXCAVATED INTERIOR OF MON. BOX AND HIT LARGE STONE AT 2.3 FT., DUG ALONG NORTH SIDE TO DEPTH OF 3 FT. AND HIT LARGE FLAT STONE, COULD NOT MOVE EITHER. THIS CORNER HAS HISTORICALLY BEEN USED AS BOTH M-2 DELTA AND A-2 LANSING SINCE AT LEAST 1939 (MDOT WITNESSES) BUT IT IS ACTUALLY A-2, LANSING TOWNSHIP. I BELIEVE THAT THE FLAT "STONE" RECOVERED AT DEPTH OF 3 FEET, MAY BE THE TOP OF THE CONCRETE MONUMENT AS REFERENCED IN ROBB'S RESURVEY OF 1909. MEASURED NORTH 2572.72' TO A-1 IN CLOSE ACCORD WITH SURVEYOR BROWN'S DISTANCE OF 2569.38' (ITEM A-3). ACCEPTED FOUND PIPE AND STONE AS A-2, LANSING TOWNSHIP AND SET STANDARD INGHAM COUNTY REMON. BAR WITH ALUMINUM CAP STAMPED 30090 IN MONUMENT BOX AT LOCATION OF FOUND PIPE AND STONE.

C. Description of monument for corner and accessories established to perpetuate locating the position of the corner:
A-2, T4N, R2W, LANSING TOWNSHIP, INGHAM COUNTY. SET STANDARD INGHAM COUNTY REMON. BAR WITH 2 1/2" ALUMINUM REMON. CAP IN MON. BOX AT WAVERLY AND DELTA RIVER DRIVE. WITNESSED BY:

FD. N&T #16053, S/S POWER POLE, N 53° W, 53.15'

FD. N&T #16053, SE/S POWER POLE, N 44° E, 59.70'

FD. N&T #16053, W/S POWER POLE, N 62° E, 51.43'

FD. N&T #25832, SW/S 36" MAPLE, S 49° E, 68.52'

BEARINGS GIVEN ARE MAGNETIC.

Signed by

David R. Lohr

Date OCTOBER 20, 2000

Surveyor's Michigan License No. 30090

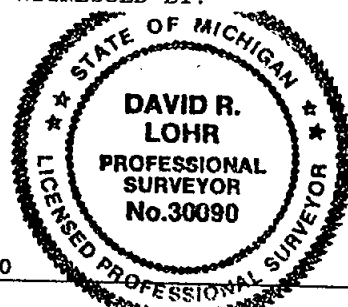

FORM APPROVED BY MICHIGAN STATE BOARD OF LAND SURVEYORS, JAN. 28, 1971

REVISED MAY 14, 1976

REVISED JAN., 1983

REVISED OCT, 1996

ADAPTED FOR WORD PROCESSING JAN, 1999

P.A. 345 INGHAM COUNTY

PEER APPROVED 10/24/2000 ML

A-2: LANSING TOWNSHIP, PART A CONTINUED:

5. CORNER REFERENCED IN RESURVEY OF LANSING TOWNSHIP, DATED 1909, AND RECORDED IN BOOK 5, PG.218, COUNTY SURVEYORS RECORDS, BY R. J. ROBB, "ALL CORNERS ARE MARKED BY CEMENT POSTS 2.5' LONG 3" SQUARE AT TOP - 4" SQUARE AT BOTTOM." WITNESSED BY: "IRON BY SIDE" (MARGINAL NOTE)
ELM 4" N-W 34"
ASH 8" N-W 74'
6. CORNER REFERENCED ON INGHAM COUNTY ROAD COMMISSION WITNESS MAP AS "1965 -MON. BOX"
WITNESSED BY: P.P. NE, 51.61'
18" MAPLE, ESE, 68.07'
COR. POST, SW, 57.87'
P.POLE, NW, 44.17'
15" MAPLE, NNW, 70.52'
7. MARGINAL NOTE ON EATON COUNTY ROAD COMMISSION COPY OF ORIGINAL NOTES STATES:
"ST. HIGHWAY 1939 - W 1/4 PO. SEC. 6-4-2, (LANSING TWP.) 3" (SQUARE) CONC. POST, IRON ON TOP."
WITNESSED BY: NEAREST GROUP 6" ELM, N 72° E, 75.88'
12" MAPLE, S 69° E, 67.89'
20" ASH, N 66° W, 74.67'
8. CORNER REFERENCED IN THE FOLLOWING PLATS RECORDED IN INGHAM COUNTY:
A. "MOUNT VERNON PARK", BY SURVEYOR FRED N. WHITE, RLS #12034, DATED OCT. 13, 1969, RECORDED IN LIBER 29 OF PLATS, PAGE 28.
B. "WAVERLY HEIGHTS No.10", DATED OCT. 9, 1968, BY CLYDE K. STEVENS, RLS #3829, RECORDED IN LIBER 29 OF PLATS, PAGE 16.
C. "VIRGINIA VILLAGE", BY WAYNE H. ABBOTT, JR., P.E., DATED JAN. 8, 1962, BY RECORDED IN LIBER 23 OF PLATS, PAGE 49.
- NOTE: NONE OF THE ABOVE PLATS MENTION MONUMENT OR GIVE WITNESSES. BUT ALL APPEAR TO REFERENCE THE SAME CORNER LOCATION.
9. CORNER REFERENCED IN UNDATED "NORTHSTINE NOTES" AS "3" SQR. CONC. POST, RAISED WITH 1" IRON AND 14" BOAT SPIKE." WITNESSED BY: NEAREST POINT ON GROUP OF 6" ELMS, N 72° E, 75.88 FT.
12" MAPLE- S 69°E, 67.89FT.
20" ASH N 66° W, 74.67 FT.
10. CORNER REFERENCED IN MONUMENTED CORNER REPORT OF THE INGHAM COUNTY REMONUMENTATION PROGRAM, DATED 11-1-79, AS "FOUND 1/2 PIPE IN MON. BOX, WEST 1/4 CORNER SECT. 6. WITNESSED BY:
SET N&T RLS#18998, S/S 20" MAPLE, N 75°W, 99.60'
SET N&T RLS#18998, NE/S 18"MAPLE S 45°E, 69.26'
FD. N&T #16053, W.SIDE 14" P.P., N 45°E, 51.45'
BOTTOM FACE OF 12" STEEL SUPPORT POLE, S 45°W, 49.32'
- NOTE: MARGINAL NOTE STATES "RECORD AS SHOWN - RL - 11/9/79, HOWEVER CORNER WAS NEVER RECORDED.
11. NO OTHER REFERENCES FOUND.



2000-047314

Page: 2 of 2

11/07/2000 08:33A

LAND CORNER RECORDATION CERTIFICATE
Filing Requirement of Act 74, Mich. P.A. 1970

For corners in

INGHAM

(County)

Located In:

Corner Code #

LANSING TOWNSHIP.

1. Public Land Survey

T 4N R 2W

B-1

2. Property Controlling
in Section

S

T

R

S

T

R

3. Miscellaneous
Property in Sec.

S

T

R

S

T

R

4. Lot No. _____, Recorded Plat

5. Private Claims _____

Paula Johnson
INGHAM COUNTY
REGISTER OF DEEDS
POLARIS SURVEYING CO

RECORDED

L-10 P-37

CRNR 11.00

2000-047315

Register of Deeds Stamp & File Number



2000-047315

Page: 1 of 2

11/07/2000 08:33A

I, DAVID R. LOHR

, in a field survey on SEPT. 26, 2000,
do hereby certify that under requirements of P.A. 74, Michigan P.A. of 1970, the corner points mentioned
in lines 1 and 2 above were in conformance with regulations and rules therefore as required in the
current manual of survey instructions of the United States Department of the Interior, Bureau of Land
Management or by a decree of a Court of Law and/or that the corner points mentioned in lines 3, 4 and 5
above were in conformance with the rules of the Michigan Board of Land Surveyors or by a Decree of a
Court of Law; established, re-established, monumented, re-monumented, recovered, found as
expressed below:

NOTE: Not more than 2 corners, all in the same town and range, may be recorded
on this certificate.

A. Description of original monument and accessories and/or subsequent restoration:
1. CORNER NOT SET IN ORIGINAL GOVERNMENT SURVEY.

2. NO REFERENCES TO CORNER FOUND IN INGHAM COUNTY SURVEYOR'S RECORDS.

3. CORNER REFERENCED IN SURVEY OF LANSING TOWNSHIP IN 1909 BY R.J. ROBB, IN BOOK 5, PAGE 218, AS "CEMENT
POST", 2.5 FT. LONG, 3" SQUARE AT TOP AND 4" SQUARE AT BOTTOM. WITNESSED BY:
WILLOW 4", NORTH 38.5' AND ELM 4", S 20° W, 14.5 FT.
NO DISTANCES SHOWN TO ADJACENT CORNERS

CONTINUED ON BACK

B. Description of corner evidence found and/or method applied in restoring or reestablishing corner:

SEARCHED AT APPARENT LOCATION OF CORNER AND FOUND CONCRETE MONUMENT WITH NAIL SET IN TOP AS
HISTORICALLY USED FOR BOTH THE DEWITT TWP. (B-13) AND THE LANSING TWP. (B-1) CORNER. MONUMENT IS A 7"
TRIANGULAR CONCRETE POST AT LEAST 5 FT. IN LENGTH, MARKED "PMRY" (PERE MARQUETTE RAILWAY) ON THE NORTH
FACE AND "R of W" ON THE SOUTHEAST FACE. MONUMENT EXTENDS ABOUT 18" OUT OF GROUND. CORNER FALLS ON
REMAINS OF OLD FENCE TO SOUTH, (ONE POST) AND ON FENCELINE TO NORTH. EXCAVATED AN AREA 21.5 FT EAST, (TO
MATCH GLO FALLING AT C-1) BUT DID NOT FIND ANY EVIDENCE OF ANOTHER CORNER. CORNER FALLS 6.8 FT. SOUTH
OF A LINE BETWEEN A-1 AND C-1. ALSO EXCAVATED AREA 7 FT. NORTH AND 21.5 FT. EAST, BUT FOUND NO EVIDENCE
OF A CORNER. TRAVERSED FROM B-2 (CENTER OF SECTION 6) NORTH THROUGH MONUMENTED NORTH-SOUTH 1/4 LINE OF
NORTHWESTERN SUBS. AND DETERMINED THAT PROJECTED LINE FALLS ABOUT 0.16 FT. EAST OF THE CONCRETE
MONUMENT. MEASURED WEST THE DEEDED DISTANCE OF 154 FT. TO A 7 FT. HIGH FENCELINE AT 153.0 FT. MEASURED
WEST 2922.09' TO A-1 AND EAST 2660.41' TO C-1 AND SOUTH 2561.35' TO B-2. ACCEPTED TRIANGULAR CONCRETE
MONUMENT AS CORNER BASED ON LONG HISTORICAL USAGE IN PLATS DATING BACK TO AT LEAST 1951. GLUED PA 345
ALUMINUM CAP TO TOP OF CONCRETE MONUMENT, LEAVING NAIL IN PLACE.

C. Description of monument for corner and accessories established to perpetuate locating the position of the corner:

B-1, T4N, R2W, LANSING TOWNSHIP, INGHAM COUNTY.

FOUND 7" TRIANGULAR CONCRETE POST WITH NAIL MARKED "PMRY" AND "R OF W".

SET N&T #30090, W/S FENCE POST, S04°W, 28.20'

SET N&T #30090, N/S 14" OAK, N64°W, 19.60'

FD. N/T #18998, S/S 24" OAK, N68°W, 19.65'

FD. N/T #30897, SW/S 16" MAPLE, N23°W, 22.97'

FD. N/T #30897, N/S TW. 16" MAPLE, S89°W, 26.82'

FD. N/T #30897, S/S 14" BOX ELDER, N86°W, 25.88'

FD. N/T #16053, W/S 6" MAPLE, S03°W, 21.88'

BEARINGS GIVEN ARE MAGNETIC.



Signed by

David R. Lohr

Date SEPT. 27, 2000

Surveyor's Michigan License No. 30090

FORM APPROVED BY MICHIGAN STATE BOARD OF LAND SURVEYORS, JAN. 28, 1971

REVISED MAY 14, 1976

REVISED JAN., 1983

REVISED OCT, 1995

ADAPTED FOR WORD PROCESSING JAN, 1999

P.A. 345 INGHAM COUNTY

PEER APPROVED 10/24/2000

B-1: LANSING TOWNSHIP, PART A CONTINUED:

4. NORTH-SOUTH 1/4 LINE REFERENCED IN THE FOLLOWING PLATS RECORDED IN INGHAM COUNTY:
- A. "NORTHWESTERN SUBDIVISION" DATED OCT. 22, 1951, BY CLYDE K. STEPHENS, RLS AND PE, AND RECORDED IN LIBER 16 OF PLATS, PAGE 9. NO DISTANCE SHOWN NORTH TO THIS CORNER.
 - B. "NORTHWESTERN SUBDIVISION NO. 2" DATED NOV. 28, 1955, BY CLYDE K. STEPHENS, RLS AND PE, AND RECORDED IN LIBER 19 OF PLATS, PAGE 29. NO DISTANCE SHOWN NORTH TO THIS CORNER.
 - C. "NORTHWESTERN SUBDIVISION NO. 3" DATED MAY. 29, 1956, BY CLYDE K. STEPHENS, RLS AND PE, AND RECORDED IN LIBER 20 OF PLATS, PAGE 5. NO DISTANCE SHOWN NORTH TO THIS CORNER.
- NOTE: NONE OF THE ABOVE PLATS MENTION MONUMENT OR GIVE WITNESSES.
5. CORNER REFERENCED IN LCRC, DATED 10/29/71, BY JAMES E. STEPHENS, RLS#16053, AND RECORDED IN LIBER 1, PAGE 249. FOUND "CONCRETE POST WITH NAIL". WITNESSED BY:
- SURVEY TAG & NAIL, QUAD 15" BOX ELDER, N 75° E, 25.88'
 - SURVEY TAG & NAIL, TWIN 14" MAPLE, S 83° 45' W, 26.93
 - SURVEY TAG & NAIL, TWIN 14" MAPLE, N 23° 23' W, 22.97'
6. CORNER REFERENCED IN RECORDED SURVEY, DATED 10/29/71, BY JAMES STEPHENS, RLS#16053, AND RECORDED IN LIBER 1, PAGE 145. FOUND "CONCRETE POST WITH NAIL". SAME WITNESSES AS ABOVE.
7. CORNER REFERENCED IN LCRC, DATED 12/10/86, BY MARK W. WITALEC, LLS#30897, AND RECORDED IN LIBER 6, PAGE 305. INGHAM COUNTY RECORDS. "FOUND TRIANGULAR CONCRETE POST WITH NAIL IN TOP. DID NOT FIND ANY OF THE (3) SURVEY TAGS IN L1, PP. 249-250 - BUT TREE LOCATIONS CHECKED". WITNESSED BY:
- N.W. 22.97' P.K. & TAG #30897 S.W. FACE MAPLE
 - S.S.W. 26.93' P.K. & TAG #30897 N. FACE TWIN MAPLE
 - E.N.E. 25.88' P.K. & TAG #30897 S. FACE QUAD BOX ELDER
 - N.N.W. 187.10' P.K. & TAG #30897 3.73' S. OF CENTERLINE OF R.R. GUAGE (ON R.R. TIE)
8. CORNER REFERENCED IN RECORDED SURVEY, DATED 06/22/94, BY JAMES STEPHENS, PS#16053, AND RECORDED IN LIBER 7, PAGE 308. "NORTH 1/4 CORNER, SECTION 6, T4N, R2W, TRIANGULAR CONCRETE POST WITH NAIL IN TOP. WITNESSED BY:
- P.K. & TAG #30897 S.W. FACE MAPLE, N.W. 22.97'
 - P.K. & TAG #30897 N. FACE TWIN MAPLE, S.S.W. 26.93'
 - P.K. & TAG #30897 S. FACE QUAD BOX ELDER, E.N.E. 25.88'
 - NAIL AND TAG #16053 IN WEST SIDE 4" MAPLE, S. 21.93'
- SURVEY SHOWS DISTANCE SOUTH TO B-2 OF 2561.62'
9. CORNER REFERENCED IN RECORDED SURVEY, DATED 05/11/95, BY JAMES STEPHENS, PS#16053, AND RECORDED IN LIBER 7, PAGE 632. "NORTH 1/4 CORNER, SECTION 6, T4N, R2W, TRIANGULAR CONCRETE POST WITH NAIL IN TOP. WITNESSED BY:
- P.K. & TAG #30897 S.W. FACE MAPLE, N.W. 22.97'
 - P.K. & TAG #30897 N. FACE TWIN MAPLE, S.S.W. 26.93'
 - P.K. & TAG #30897 S. FACE QUAD BOX ELDER, E.N.E. 25.88'
 - NAIL AND TAG #16053 IN WEST SIDE 4" MAPLE, S. 21.93'
- SURVEY SHOWS DISTANCE SOUTH TO B-2 OF 2561.62'
10. CORNER REFERENCED IN RECORDED SURVEY, DATED 04/25/96, BY RONNIE M. LESTER, PS#18998, AND RECORDED IN LIBER 7, PAGE 813. "NORTH 1/4 CORNER, SECTION 6, T4N, R2W, TRIANGULAR SHAPED CONCRETE MONUMENT 20" HIGH WITH NAIL IN CENTER. LIBER 6, PAGE 305, INGHAM COUNTY RECORDS. WITNESSED BY:
- FOUND P.K. NAIL AND TAG N.W. SIDE DOUBLE RED MAPLE, AZ.340°, 22.97'
 - FOUND P.K. NAIL AND TAG N.SIDE DOUBLE RED MAPLE, AZ.265°, 26.86'
 - FOUND P.K. NAIL AND TAG S.SIDE QUAD.ASH, AZ.85°, 25.90'
 - SET GALV. NAIL AND BRASS TAG #18998, S. SIDE 5" OAK, AZ.293°, 19.68'
- SURVEY SHOWS DISTANCE WEST TO A-1 OF 2922.08'
11. NO OTHER REFERENCES FOUND.



2000-047315
Page: 2 of 2
11/07/2000 08:33A

LAND CORNER RECORDATION CERTIFICATE

Filing Requirement of Act 74, Mich. P.A. 1970

For corners in

INGHAM

(County)

Located In:

Corner Code #

LANSING TOWNSHIP.

1. Public Land Survey

T 4N R 2W

B-2

2. Property Controlling in Section

S T R

3. Miscellaneous Property in Sec.

S T R

4. Lot No.

Recorded Plat

5. Private Claims

Paula Johnson
INGHAM COUNTY
REGISTER OF DEEDS
POLARIS SURVEYING CO

RECORDED

L-10 P-39

CRNR 11.00

2000-047316

Register of Deeds Stamp & File Number



2000-047316

Page: 1 of 2

11/07/2000 08:33A

I, DAVID R. LOHR, PS, in a field survey on 4/25 & 5/23, 2000, do hereby certify that under requirements of P.A. 74, Michigan P.A. of 1970, the corner points mentioned in lines 1 and 2 above were in conformance with regulations and rules therefore as required in the current manual of survey instructions of the United States Department of the Interior, Bureau of Land Management or by a decree of a Court of Law and/or that the corner points mentioned in lines 3, 4 and 5 above were in conformance with the rules of the Michigan Board of Land Surveyors or by a Decree of a Court of Law; established, re-established, monumented, re-monumented, recovered, found as expressed below:

NOTE: Not more than 2 corners, all in the same town and range, may be recorded on this certificate.

A. Description of original monument and accessories and/or subsequent restoration:
1. CORNER NOT SET IN ORIGINAL GOVERNMENT SURVEY:

2. CORNER REFERENCED IN SURVEY BY T.J. BROWN, DEP. COUNTY SURVEYOR, DATED AUG. 17, 1864, AND RECORDED IN BOOK 3, PAGE 3, COUNTY SURVEYORS RECORDS. CORNER SHOWN AS "POST", WITNESSED BY :
ELM, 15", S 60 1/2° W, 105 LKS. (69.30')
SURVEY SHOWS DISTANCE EAST OF 40 CH. (2640') AND SOUTH OF 39.75 CH. (2623.50')

3. CORNER REFERENCED IN THE FOLLOWING PLATS RECORDED IN INGHAM COUNTY:

- "NORTHWESTERN SUBDIVISION" DATED OCT. 22, 1951, BY CLYDE K. STEPHENS, RLS AND PE, AND RECORDED IN LIBER 16 OF PLATS, PAGE 9. PLAT SHOWS A DISTANCE SOUTH OF 595.86 FT. TO THIS CORNER.
- "NORTHWESTERN SUBDIVISION NO. 1" DATED APRIL 8, 1955, BY CLYDE K. STEPHENS, RLS AND PE, AND RECORDED IN LIBER 18 OF PLATS, PAGE 24. PLAT SHOWS A DISTANCE WEST OF 325.60 FT. TO THIS CORNER.
- "NORTHWESTERN SUBDIVISION NO. 2" DATED NOV. 28, 1955, BY CLYDE K. STEPHENS, RLS AND PE, AND RECORDED IN LIBER 19 OF PLATS, PAGE 29. PLAT SHOWS A DISTANCE SOUTH OF 595.86 FT. TO THIS CORNER.
- "NORTHWESTERN SUBDIVISION NO. 3" DATED MAY. 29, 1956, BY CLYDE K. STEPHENS, RLS AND PE, AND RECORDED IN LIBER 20 OF PLATS, PAGE 5. PLAT SHOWS A DISTANCE SOUTH OF 1133.86 FT. TO THIS CORNER.
- "DELTA RIVER DRIVE ESTATES NO. 1" DATED FEB. 5, 1959, BY HAROLD J. OLVER, RLS AND PE, AND RECORDED IN LIBER 22 OF PLATS, PAGE 26. PLAT SHOWS CORNER BEING THE NORTHEASTERN CORNER OF LOT 25 AND THE NORTHEASTERN CORNER OF THE PLAT.

NOTE: NONE OF THE ABOVE PLATS MENTION MONUMENT OR GIVE WITNESSES.

CONTINUED ON BACK

B. Description of corner evidence found and/or method applied in restoring or reestablishing corner:
SEARCHED AT APPARENT LOCATION OF CORNER AND FOUND CONCRETE MONUMENT AS RECORDED IN ITEM 3-E. CORNER FALLS IN REAR YARD OF 3117 LAFAYETTE ST. REBAR WAS FLUSH WITH TOP OF CONCRETE MONUMENT, CHIPPED AWAY ENOUGH CONCRETE TO SET REMON. CAP ON IT. ACCEPTED CONCRETE MONUMENT AS LONG ACCEPTED SECTION CORNER POSITION AS PER PLATS DATING BACK TO AT LEAST 1959 (ITEM #3-E) MEASURED NORTH 2561.35' TO B-1, WEST 2951.42' TO A-2 AND EAST 2663.32' TO C-2.

C. Description of monument for corner and accessories established to perpetuate locating the position of the corner:
B-2, T4N, R2W, LANSING TOWNSHIP, INGHAM COUNTY. SET STANDARD 2-1/2" ALUMINUM INGHAM COUNTY REMON. CAP. ON FOUND CONCRETE MONUMENT. WITNESSED BY:
C/L STORM MANHOLE, DUE NORTH, 4.30'
FD. N/T, #16053, N/S 4" POST, S 79° E, 5.58'
SET N&T #30090, E/S 4" POST, S 00° W, 9.00'
FD. N/T, #18998, NW/S P. POLE, S 51° W, 8.74'
SE CORNER FRAME GARAGE, N 62° W, 20.78'
SE COR. HOUSE #3117 LAFAYETTE, N 27° W, 40.40'
BEARINGS GIVEN ARE MAGNETIC.



Signed by

David R. Lohr

Date OCTOBER 24, 2000

Surveyor's Michigan License No. 30090

FORM APPROVED BY MICHIGAN STATE BOARD OF LAND SURVEYORS, JAN. 28, 1971
REVISED MAY 14, 1976
REVISED JAN., 1983
REVISED OCT. 1995
ADAPTED FOR WORD PROCESSING JAN, 1998

P.A. 345 EATON COUNTY
PEER APPROVED 10/24/2000 *ML*

B-2: LANSING TOWNSHIP, PART A CONTINUED:

4. CORNER REFERENCED IN RECORDED SURVEY, DATED 08/01/73, BY KAY DON FLUKE, RLS#18988, AND RECORDED IN LIBER 1, PAGE 851. "FOUND 4" CONCRETE CYLINDER WITH BRASS CAP". WITNESSED BY:
DUE NORTH, 3.31', SOUTH EDGE OF RIM OF MANHOLE.
N 35 E, 29.56', NORTHWEST CORNER OF GARAGE.
5. CORNER REFERENCED IN LCRC, DATED 01/22/80, BY RONNIE M. LESTER, RLS#18998, AND RECORDED IN LIBER 6, PAGE 38. "FOUND 1/2" BAR IN 3" CONCRETE MONUMENT". WITNESSED BY:
SE CORNER OF ONE STORY BLOCK HOUSE #3117, LAFAYETTE STREET, NORTH, 40.40' (FOUND)
NW CORNER OF ONE STORY BLOCK HOUSE #2815, NORTHWESTERN STREET, ESE, 64.78' (NOT MEAS.)
NAIL & TAG, 18998, W/S 40" TREE, SOUTH, 2.09' (GONE)
NAIL & TAG, 18998, NW/S POWER POLE, SW, 8.74' (FOUND)
CONCRETE MONUMENT, SOUTH, 317.3' (NOT MEASURED)
6. CORNER REFERENCED IN RECORDED SURVEY, DATED 05/11/95, BY JAMES STEPHENS, PS#16053, AND RECORDED IN LIBER 7, PAGE 632. "CENTER OF SECTION 6, T4N, R2W, 1/2" IRON BAR IN 3" CONCRETE MONUMENT." WITNESSED BY:
SE CORNER OF 1 STORY BLOCK HOUSE #3117, LAFAYETTE STREET, NORTH, 40.40' (FOUND)
NW CORNER OF 1 STORY BLOCK HOUSE #2815, NORTHWESTERN STREET, ESE, 64.76' (NOT MEASURED)
NAIL & TAG, #18998, NW/S POWER POLE, SW, 8.74' (FOUND)
NAIL & TAG, #16053, IN N/S OF 4" X 4" FENCE POST, EAST, 5.58' (FOUND)
SURVEY SHOWS DISTANCE NORTH TO B-1 OF 2561.62'
7. NO OTHER REFERENCES FOUND.



2000-047316
Page: 2 of 2
11/07/2000 08:33A

LAND CORNER RECORDATION CERTIFICATE
Filing Requirement of Act 74, Mich. P.A. 1970

For corners in

INGHAM

(County)

Located In:

Corner Code #

LANSING TOWNSHIP.

1. Public Land Survey

T 4N R 2W

C-2

T R

T R

T R

T R

2. Property Controlling
in Section

S T R

3. Miscellaneous
Property in Sec.

S T R

4. Lot No. Recorded Plat

5. Private Claims



2000-047317

Page: 1 of 2

11/07/2000 08:33A

Paula Johnson
INGHAM COUNTY
REGISTER OF DEEDS
POLARIS SURVEYING CO

RECORDED

L-10 P-41

CRNR 11.00

2000-047317

Register of Deeds Stamp & File Number

I, DAVID R. LOHR, in a field survey on 4/25 & 5/23, 2000, do hereby certify that under requirements of P.A. 74, Michigan P.A. of 1970, the corner points mentioned in lines 1 and 2 above were in conformance with regulations and rules therefore as required in the current manual of survey instructions of the United States Department of the Interior, Bureau of Land Management or by a decree of a Court of Law and/or that the corner points mentioned in lines 3, 4 and 5 above were in conformance with the rules of the Michigan Board of Land Surveyors or by a Decree of a Court of Law; established, re-established, monumented, re-monumented, recovered, found as expressed below:

NOTE: Not more than 2 corners, all in the same town and range, may be recorded on this certificate.

A. Description of original monument and accessories and/or subsequent restoration:
1. CORNER SET BY MUSGROVE EVANS, U.S. DEPUTY SURVEYOR IN MARCH OF 1827. "SET 1/4 SEC. POST fw A" WITNESSED BY:

BEECH 14", S 80° W, 3 LKS. (1.98')

EIM 36", S 76° E, 14 LKS. (9.24')

GLO NOTES SHOW DISTANCES SOUTH OF 40 CH. (2640) AND NORTH OF 39.22 CH. (2588.52)

2. CORNER REFERENCED IN SURVEY BY T.J. BROWN, DEP. COUNTY SURVEYOR, DATED AUG. 17, 1864, AND RECORDED IN BOOK 3, PAGE 3, COUNTY SURVEYORS RECORDS. CORNER SHOWN AS "POST", NO WITNESSES GIVEN: SURVEY SHOWS DISTANCE WEST OF 40 CH. (2640') AND SOUTH OF 34.85 CH. (2300.10') TO RIVER BANK.
3. CORNER REFERENCED IN SURVEY BY T.J. BROWN, DEP. COUNTY SURVEYOR, DATED OCT. 20, 1870, AND RECORDED IN BOOK 3, PAGE 16, COUNTY SURVEYORS RECORDS. CORNER SHOWN AS "A STONE, THE TOP OF WHICH IS EVEN WITH THE SURFACE OF THE GROUND", NO WITNESSES GIVEN: SURVEY SHOWS DISTANCE EAST OF 38.545 CH. (2543.97') AND SOUTH OF 34.95 CH. (2306.70') TO RIVER BANK.
4. CORNER REFERENCED IN SURVEY OF LANSING TOWNSHIP IN 1909 BY R.J.ROBB, IN BOOK 5, PAGE 218, AS "CEMENT POST", 2.5 FT. LONG, 3" SQUARE AT TOP AND 4" SQUARE AT BOTTOM, WITNESSED BY: D. BASSWOOD, 10", S. 23.7' AND EIM 10", S-E 7'. WEST, 21.5 FT. DEWITT COR. WEST 21.4' NO DISTANCES SHOWN ON SURVEY.

CONTINUED ON BACK

B. Description of corner evidence found and/or method applied in restoring or reestablishing corner:
SEARCHED AT APPARENT LOCATION OF CORNER AND 3/4" X 17" PINCH PIPE AS PER LCRC OF LIBER 1, PAGE 575. CORNER FALLS IN FRONT YARD OF HOUSE #2211 DELTA RIVER DRIVE. NO EXCAVATION PERFORMED AT THIS LOCATION. ACCEPTED LOCATION OF FOUND 3/4" PIPE AS CORNER AS RECORDED IN ITEM #8, TRAVERSED WEST 2663.32' to B-2 AND NORTH 2562.43' TO C-1. SET STANDARD INGHAM COUNTY REMON. BAR WITH 2 1/2" ALUMINUM REMON. CAP.

C. Description of monument for corner and accessories established to perpetuate locating the position of the corner:
C-2, T4N, R2W, LANSING TOWNSHIP, INGHAM COUNTY. SET STANDARD INGHAM COUNTY REMON. BAR WITH 2-1/2" ALUMINUM REMON. CAP. STAMPED #30090. WITNESSED BY:

NW COR.OF HOUSE #2827 ARLINGTON DR., N 86° E, 78.03'

NW COR.OF HOUSE #2211 DELTA RIVER DR., S 00° E, 30.35'

NE COR.OF GAR., #2217 DELTA RIVER DR., S 39° W, 39.83'

SET N&T #30090, N/S POWER POLE, S 87° W, 95.88'

FACE OF CURB, DELTA RIVER DR., N 15° W, 25.12'

BEARINGS GIVEN ARE MAGNETIC.



Signed by David R. Lohr

Date OCTOBER 24, 2000

Surveyor's Michigan License No. 30090

C-2: LANSING TOWNSHIP, PART A CONTINUED:

5. CORNER REFERENCED IN THE PLAT OF DELTA GRANDE SUBDIVISION DATED JUNE 7, 1929, BY J.A DINSMORE, REG. CIVIL ENG., AND RECORDED IN LIBER 11 OF PLATS, PAGE 20. NO DISTANCE SHOWN NORTH TO THIS CORNER. NOTE: PLAT DOES NOT MENTION MONUMENT OR GIVE WITNESSES.
6. CORNER REFERENCED IN THE PLAT OF RIVER FOREST SUBDIVISION DATED SEPT. 18, 1946, BY CLYDE K. STEPHENS, CIVIL ENGINEER & LAND SURVEYOR, AND RECORDED IN LIBER 14 OF PLATS, PAGE 5. CORNER IS SHOWN AS "O" AND FALLS WITHIN LOT #69, 13.3 FT. SOUTH OF SOUTH ROW OF DELTA RIVER DRIVE.
7. CORNER REFERENCED IN THE PLAT OF LANTEX INDUSTRIAL PARK, DATED FEB. 11, 1966, BY CLYDE K. STEPHENS, CIVIL ENGINEER & LAND SURVEYOR, AND RECORDED IN LIBER 26 OF PLATS, PAGE 46. NO DISTANCE SHOWN SOUTH TO THIS CORNER.
8. CORNER REFERENCED IN LCRC, DATED NOV. 19, 1971, BY CLYDE K. STEPHENS, RLS #3829 AND RECORDED IN LIBER 1, PAGE 575. "A 3/4" IRON PIPE WAS SET FROM OLD TIES FROM 1946 AND FROM DELTA GRANDE SUB. #1. WITNESSED BY:
 - NO°50'W, 85.50 FEET TO A CONCRETE MONUMENT AT THE SE. CORNER OF DELTA GRANDE SUB. #1.
 - NW CORNER OF A 1 STORY FRAME HOUSE, N85°33'E, 78.0'
 - NW CORNER OF A 1 STORY FRAME HOUSE, #2211, S4°40'E, 30.35'
 - NO°50'W, 25.20 FEET TO THE FACE OF THE CURB ON DELTA RIVER DRIVE
9. CORNER REFERENCED IN RECORDED SURVEY, DATED 07/12/76, BY JAMES STEPHENS, PS#16053, AND RECORDED IN LIBER 2, PAGE 854. "EAST 1/4 CORNER, SECTION 6, T4N, R2W, "3/4" IRON PIPE" SAME WITNESSES AS ABOVE.
10. CORNER REFERENCED IN RECORDED SURVEY, DATED 04/28/95, BY DAVID E. ERICKSON, PS#29245, AND RECORDED IN LIBER 7, PAGE 649. "WEST 1/4 CORNER, SECTION 5, (C-2) "END. PINCH PIPE" WITNESSED BY:
 - N 86° E, 78.03', NW COR. OF 1 STORY HSE. (FOUND)
 - S 5° E, 30.45', NW COR. OF 1 STORY HSE. #2211 (FOUND)
 - N 1° W, 85.50', CONC. MON. @ SE. COR. DELTA GRANDE SUB. #1. (NOT MEASURED)
 - S 41° W, 39.72', NE COR. OF GARAGE TO HSE. #2217. (FOUND)
11. NO OTHER REFERENCES FOUND.



2000-047317
Page: 2 of 2
11/07/2000 08:33A

LAND CORNER RECORDATION CERTIFICATE
Filing Requirement of Act 74, Mich. P.A. 1970

For corners in

INGHAM

(County)

Located In:

Corner Code #

LANSING TOWNSHIP.

1. Public Land Survey

T 4N R 2W

C-3

2. Property Controlling
in Section

S T R

3. Miscellaneous
Property in Sec.

S T R

4. Lot No. _____, Recorded Plat _____

5. Private Claims _____

Paula Johnson

INGHAM COUNTY
REGISTER OF DEEDS
POLARIS SURVEYING CO

RECORDED

L-10 P-43

CRNR 11.00

2000-047318

Register of Deeds Stamp & File Number



2000-047318

Page: 1 of 2

11/07/2000 08:33A

I, DAVID R. LOHR

, in a field survey on OCT. 18, 2000,
do hereby certify that under requirements of P.A. 74, Michigan P.A. of 1970, the corner points mentioned
in lines 1 and 2 above were in conformance with regulations and rules therefore as required in the
current manual of survey instructions of the United States Department of the Interior, Bureau of Land
Management or by a decree of a Court of Law and/or that the corner points mentioned in lines 3, 4 and 5
above were in conformance with the rules of the Michigan Board of Land Surveyors or by a Decree of a
Court of Law; established, re-established, monumented, re-monumented, recovered, found as
expressed below:

NOTE: Not more than 2 corners, all in the same town and range, may be recorded
on this certificate.

A. Description of original monument and accessories and/or subsequent restoration:

1. CORNER SET BY MUSGROVE EVANS, U.S. DEPUTY SURVEYOR IN MARCH OF
1827. "SET POST COR. TO SECS. 5, 6, 7 & 8, fw A" WITNESSED BY:

BEECH 10", N 73° W, 13 LKS. (8.58')

B. OAK 12", N 35° E, 14 LKS. (9.24')

GLO NOTES SHOW DISTANCES NORTH AND SOUTH OF 40 CH. (2640) EAST OF 39.91 CH. (2634.06')
AND WEST OF 40 CH. (2640')

2. CORNER REFERENCED IN SURVEY BY T.J. BROWN, DEP. COUNTY SURVEYOR, DATED AUG. 29, 1864, AND RECORDED
IN BOOK 3, PAGE 14, COUNTY SURVEYORS RECORDS. CORNER SHOWN AS "POINT A", WITNESSED BY:

BEECH 10", N 73° W, 13 LKS. (8.58') AND RED OAK 16", N 35° E, 14 LKS. (9.24')
SURVEY SHOWS DISTANCE SOUTH OF 40.12 CH. (2647.92')

3. CORNER REFERENCED IN SURVEY OF LANSING TOWNSHIP IN 1909 BY R.J. ROBB, IN BOOK 5, PAGE 218, AS "CEMENT
POST", 2.5 FT. LONG, 3" SQUARE AT TOP AND 4" SQUARE AT BOTTOM, WITNESSED BY: RIVERBANK NORTH 24.4',
RIVERBANK WEST, 21'. NO OTHER WITNESSES. NO DISTANCES SHOWN ON SURVEY.

4. CORNER REFERENCED IN SURVEY BY C.M. CADE, CITY OF LANSING ENGINEER, NOT DATED (CIRCA 1921)
"A CEMENT POST WAS FOUND AT THIS POINT. T.J. BROWN USED THE POINT IN 1884. BATEMAN REFUSES TO
ACCEPT THE POINT AS MARKED BY ROBB OWING TO DISCREPANCIES IN MEASUREMENT TO SOUTH AND EAST. NO NEW
MARK WAS SET" NO WITNESSES GIVEN.

NOTE: NO MENTION OF WHAT THE DISCREPANCIES MAY HAVE BEEN BETWEEN BATEMAN'S SURVEY AND ROBB'S
SURVEY. ROBB GIVES NO DISTANCES TO ADJACENT CORNERS.

CONTINUED ON BACK

B. Description of corner evidence found and/or method applied in restoring or reestablishing corner:

SEARCHED AT APPARENT LOCATION OF CORNER AND FOUND BATEMAN'S MONUMENT OF 1928 (ITEM A-5). CORNER
CONSISTS OF A 4" X 4" SQUARE CONCRETE MONUMENT EXTENDING ABOUT 12" OUT OF GROUND, LEANING TO THE
NORTHEAST, ALONG THE SOUTH BANK OF THE GRAND RIVER AS PER LCRC OF LIBER 7, PAGE 331. EXCAVATED
AROUND MONUMENT AND FOUND IT TO BE AT LEAST 3.5 FT. IN LENGTH. RE-ALIGNED MONUMENT TO PLUMB
POSITION AND REWITNESSED. SURROUNDED RE-ALIGNED MONUMENT WITH CONCRETE RIP-RAP, BRICKS, ROCKS AND
CONCRETE MIX TO STABILIZE IT'S POSITION. ACCEPTED LOCATION OF FOUND 4" X 4" MONUMENT
AS CORNER. SET #4 REBAR WITH PLASTIC SURVEY CAP MARKED PS 30090 INSIDE OF 3/4" PIPE.

C. Description of monument for corner and accessories established to perpetuate locating the position of the corner:
C-3, T4N, R2W, LANSING TOWNSHIP, INGHAM COUNTY. FOUND 4" X 4" CONCRETE MONUMENT. WITNESSED BY:

FD. N&T #18998, E/S 36" RED OAK, S 25° W, 21.21'

SET N&T #30090, N/S WOOD POST, S 84° E, 37.53'

SET N&T #30090, S/S 14" ASH, S 50° E, 53.80'

FD. N&T #18998, S/S 30" RED OAK, N 38° W, 8.45'

SET N&T #30090, N/S 7" MAPLE, N 62° E, 21.28'

BEARINGS GIVEN ARE MAGNETIC.



Signed by David R. Lohr

Date OCTOBER 24, 2000

Surveyor's Michigan License No. 30090

FORM APPROVED BY MICHIGAN STATE BOARD OF LAND SURVEYORS, JAN. 28, 1971

REVISED MAY 14, 1976

REVISED JAN., 1983

REVISED OCT, 1996

ADAPTED FOR WORD PROCESSING JAN, 1998

P.A. 345 INGHAM COUNTY
PEER APPROVED 10/3/2000 M

C-3: LANSING TOWNSHIP, PART A CONTINUED:

5. CORNER REFERENCED IN ASSESSOR'S PLAT NO. 11, DATED APRIL 28, 1928, BY A. N. BATEMAN, REGISTERED SURVEYOR, AND RECORDED IN LIBER 10 OF PLATS, PAGE 14, INGHAM COUNTY RECORDS. CORNER DESCRIBED AS "N.W. COR., SEC. 8" A "PERMANENT METAL MONUMENT... ONE INCH IN DIAMETER AND FIVETEEN INCHED IN LENGTH SET IN A CONCRETE BASE FOUR INCHES IN DIAMETER AND FORTY-EIGHT INCHES IN DEPTH."
6. CORNER REFERENCED IN LCRC, DATED 01/28/80, BY RONNIE M. LESTER, RLS #18998, RECORDED IN LIBER 6, PAGE 35. "FOUND 1/2" PIPE IN SQUARE CONCRETE MONUMENT 20' EAST OF EAST BANK OF THE GRAND RIVER. ACCEPTED 1/2" PIPE IN SQUARE CONCRETE MONUMENT AS THAT IDENTIFIED IN CADE'S SURVEY AS CORNER AS THERE HAS BEEN EVIDENCE FOUND TO DISPUTE LOCATION." WITNESSED BY:
 - NAIL & TAG, #18998, S/S 20" OAK, WNW, 7.87'
 - NAIL & TAG, #18998, W/S 8" OAK, NORTH, 13.97'
 - NAIL & TAG, #18998, N/S 4" MAPLE, EAST, 41.13'
 - NAIL & TAG, #18998, E/S 24" OAK, SOUTH, 22.16'
7. CORNER REFERENCED IN LCRC, DATED 07/01/93, BY MARK W. WITALEC, LLS#30897, RECORDED IN LIBER 7, PAGE 331. "FOUND 4" SQUARE CONC. MONUMENT WITH 3/4" IRON PIPE CAST IN CENTER. (MON. LEANS TO N.W. USED CENTERLINE AT GROUND LEVEL)" WITNESSED BY:
 - W.N.W. 8.0' TO N. & T. #18998, S. SIDE 22" OAK
 - N. 14.34' TO N. & T. #18998, W. SIDE 7" TREE
 - E. 41.1' +/- TO MAPLE STUMP
 - S. 21.70' TO N. & T. #18998, E. SIDE 34" OAK
 - E. 37.85' TO SPIKE IN N. SIDE VERT. TIMBER POST
8. CORNER REFERENCED IN SURVEY, DATED 11/04/94, BY MARK W. WITALEC, LLS#30897, AND RECORDED IN LIBER 7, PG.428. SAME DESCRIPTION AND WITNESSES AS ABOVE. SURVEY SHOWS DISTANCE SOUTH TO C-4 OF 2638.98 FT.
9. CORNER REFERENCED IN SURVEY, DATED 02/24/97, BY MARK W. WITALEC, LLS#30897, AND RECORDED IN LIBER 7, PAGE 1022. SAME DESCRIPTION AND WITNESSES AS ABOVE. SURVEY SHOWS DISTANCE EAST TO D-3 OF 2631.68 FT.
10. CORNER REFERENCED IN SURVEY, DATED 03/05/97, BY MARK W. WITALEC, LLS#30897, AND RECORDED IN LIBER 7, PAGE 1061. SAME DESCRIPTION AND WITNESSES AS ABOVE. SURVEY SHOWS DISTANCE EAST TO D-3 OF 2631.68 FT.
11. CORNER REFERENCED IN SURVEY, DATED 06/30/97, BY MARK W. WITALEC, LLS#30897, AND RECORDED IN LIBER 7, PAGE 1194. SAME DESCRIPTION AND WITNESSES AS ABOVE. SURVEY SHOWS DISTANCE EAST TO D-3 OF 2631.68 FT.
12. NO OTHER REFERENCES FOUND.



2000-047318
Page: 2 of 2

11/07/2000 08:33A