

LAND CORNER RECORDATION CERTIFICATE
Filing Requirement of Act 74, Mich. P.A. 1970

For corners in

INGHAM COUNTY

Located In: LANSING TOWNSHIP Corner Code #

FILED

11/28/1995 14:13:44
 REGISTER OF DEEDS
 PAULA JOHNSON
 INGHAM COUNTY, MI

1. Public Land Survey T 4N R 2W K-4
 T R
 T R
 T R
 T R
 2. Property Controlling S T R
 in Section S T R
 3. Miscellaneous S T R
 Property in Sec. S T R
 4. Lot No. _____, Recorded Plat _____
 5. Private Claims _____

Register of Deeds Stamp & File Number

I, Maurice H. Mahieu, in a field survey on October 23, 1995 do hereby certify that under requirements of P.A. 74, Michigan P.A. of 1970, the corner points mentioned in lines 1 and 2 above were in conformance with regulations and rules therefore as required in the current manual of survey instructions of the United States Department of the Interior, Bureau of Land Management or by a decree of a Court of Law and/or that the corner points mentioned in lines 3, 4 and 5 above were in conformance with the rules of the Michigan Board of Land Surveyors or by a Decree of a Court of Law; established, re-established, monumented, re-monumented, recovered, found as expressed below:

NOTE: Not more than 4 corners, all in the same town and range, may be recorded on this certificate.

A. Description of original monument and accessories and/or subsequent restoration:

- The original GLO corner was set by Musgrove Evans, U.S. Deputy Surveyor on Monday Feb. 12, 1827. He states "Set 1/4 Sec. Post on a beech 15 diameter"
- In Liber 5, Page 55 of Ingham County Surveyors Records, by R.J. Robb dated Nov. 18, 1908, calls for corner as "Gas pipe Hickory 10" N-E 53.5 lks, Hickory 10" SW 48.5 lks. The East 1/4 corner was reset at intersection of Section and 1/4 lines."
- Ingham County Road Commission old grid map states " 1/2" iron (MSHD) 1965
 23" Maple N85°W 34.50'
 20" Maple S60°E 43.36'
 20" Oak N75°E 42.84'
- Ingham County Road Commission grid map of 1972 states the same information as A3.

(CONTINUED ON BACK)

B. Description of corner evidence found and/or method applied in restoring or reestablishing corner:

Found 3/4" x 18" iron rod in monument box 6.4' +/- east of centerline of Coolidge road. Jim Stephens, PS #16053 recorded corner in Liber 2, Page 531, corner was a monument in monument box. None of the witness are present. This surveyor must only assume that the LCRC in Liber 2, Page 531 has been recorded for this corner in error and does not put any weight to the information. Stephens also recorded corner in LCRC Liber 2, Page 135 on Nov. 15, 1972 that corner was a 1" iron rod in monument box. Measured N53°E 86.64 feet to SW corner of house #1300. Mark Witalec, PS #30897 recorded corner in LCRC Liber 6, Page 389 was a 3/4" iron rod in monument box. Found all 4 of Witalec witnesses and are in close accord with LCRC. Also found other witnesses, nail & tag #16053 east side utility pole S22°E 99.11'; nail & tag #16053 west side utility pole N23°E 53.31'; 1/2" iron rebar, west, 49.94' and 1/2" iron pipe east 49.97'. Excavated 2' below road surface inside monument box and found no other evidence. Replaced 3/4" iron rod with standard 3/4" x 24" smooth iron rod with cap stamped "PA 345 PS# 28414".

C. Description of monument for corner and accessories established to perpetuate locating the position of the corner:

3/4" x 24" smooth iron rod with cap stamped "PA 345 PS #28414", witnessed by:
 Nail and Tag #16053 Northeast side of utility pole N47°W, 49.67 feet
 Nail and Tag #16053 South side of utility pole S73°E 23.51 feet
 Southwest corner of block foundation of house #1300, N52°E, 86.64 feet
 Northeast corner of block foundation of house #1301, S71°W, 90.39'

Signed by Maurice H. Mahieu Date 11/21/95
 Surveyor's Michigan License No. 28414



(PART A CONTINUED)

5. An Act 74 LCRC was recorded in Liber 2, Page 135 by James E. Stephens PS #16053 on Nov. 15, 1972. Corner is a 1 inch iron rod in a monument box was found in the centerline of the section line road (Coolidge Road). Witnessed by:
 Stephens tag in the NE side of a utility pole N60°20'W 38.70 feet
 Plain tag found in the NE side of a utility pole N21°40'W 65.05 feet
 N53°18'E 86.65 feet to the SW corner of a 1 story frame house #1300
 The bearing of the section line south of the corner is S1°24'50"W
6. Act 132 Certificate of Survey recorded in Liber 1, Page 536, by James E. Stephens PS #16053 on Nov. 14, 1972 called for the same corner material and witnesses as A5
7. Act 74 LCRC recorded in Liber 2, Page 531 by James E. Stephens PS #16053 on Nov. 14, 1972 calls for corner as a "monument in a monument box was found on the South line of the Grand Trunk and Western railroad right of way". Witnessed by:
 Survey tag in the S side of a utility pole N20°31'W 58.30 feet
 Survey tag in the W side of a utility pole N83°20'E 73.48 feet
 S83°45'W 104.93 feet to the NE corner of a 1 story brick factory
 North 0.42 feet to the N gage of a railroad spur
 The bears are based on the West line of Assessor's Plat No. 26
8. An Act 132 Certificate of Survey by James E. Stephens PS #16053 recorded in Liber 2, Page 698 on May 14, 1976 used the same corner material and witnesses as A5.
9. An Act 132 Certificate of Survey by Douglas K. Richardson PS #31603 recorded in Liber 5, Page 418 on November 18, 1987, refers to corner and give Liber 2, Page 135 reference.
10. An Act 74 LCRC as recorded in Liber 6, Page 389 by Mark W. Witalec PS #30897 on Aug 24, 1988. "Found 3/4" R. Rod in a monument box - verified as follows: N.E. 86.75 feet to SW cor. Of House #1300 (Block Cor.) (N53°18'E 86.65' per L2, P. 135)
 NNE 173.02' to found mon at SW cor. of Lot 6, Brandstatter Estates Sub. (172.97; computed from the plat)
 Found R. Rod is on the north line of Frandora Hills No. 1 plat
 Witnesses to corner are:
 NE 86.75' to SW cor. Of Hse. #1300 (Block Cor)
 ESE 23.52' from nail & tag #16053 S Side util. Pole
 SW 65.42' to centerline of pre-cast conc. Light pole
 NW 49.58' to nail & Tag #16053 in NE side of util pole
11. Corner was referred to in the following plats: Hawthorn Sub. Liber 34, Page 2; Farwood Hills #1, Liber 32, Page 27; Farwood Hills No. 2, Liber 34, Page 33; Brandstatter Est., Liber 34, Page 16; Woodingham Dr. Sub. Liber 24, Page 13.
12. Corner was referred to in the following condominium survey plans: Chartwell Condominium and Stone Lake condominium.



LAND CORNER RECORDATION CERTIFICATE
Filing Requirement of Act 74, Mich. P.A. 1970

For corners in

INGHAM COUNTY

Located In: LANSING TOWNSHIP Corner Code #

FILED

11/28/1995 14:13:46
 REGISTER OF DEEDS
 PAULA JOHNSON
 INGHAM COUNTY, MI

1. Public Land Survey	T <u>4N</u> R <u>2W</u>	<u>K-5</u>
	T <u> </u> R <u> </u>	<u> </u>
	T <u> </u> R <u> </u>	<u> </u>
	T <u> </u> R <u> </u>	<u> </u>
2. Property Controlling	S <u> </u> T <u> </u> R <u> </u>	<u> </u>
in Section	S <u> </u> T <u> </u> R <u> </u>	<u> </u>
3. Miscellaneous	S <u> </u> T <u> </u> R <u> </u>	<u> </u>
Property in Sec.	S <u> </u> T <u> </u> R <u> </u>	<u> </u>

Register of Deeds Stamp & File Number

4. Lot No. , Recorded Plat
 5. Private Claims

I, Maurice H. Mahieu, in a field survey on July 13, 1995 do hereby certify that under requirements of P.A. 74, Michigan P.A. of 1970, the corner points mentioned in lines 1 and 2 above were in conformance with regulations and rules therefore as required in the current manual of survey instructions of the United States Department of the Interior, Bureau of Land Management or by a decree of a Court of Law and/or that the corner points mentioned in lines 3, 4 and 5 above were in conformance with the rules of the Michigan Board of Land Surveyors or by a Decree of a Court of Law; established, re-established, monumented, re-monumented, recovered, found as expressed below:

NOTE: Not more than 4 corners, all in the same town and range, may be recorded on this certificate.

A. Description of original monument and accessories and/or subsequent restoration:

1. The original GLO corner was set by Musgrove Evans, U.S. Deputy Surveyor on Monday Feb. 12, 1827 "Set Post cor. To Sec's 11, 12, 13, & 14
 Ironwood 4in N56E 7lks
 Beech 12in N77W 27 lks

2. Michigan Department of Transportation construction plan of M-78 (Saginaw Highway) no date, shows the corner to be 301.37 feet south of the survey centerline of M-78. No indication of corner or witnesses are shown.

3. Plat of TOURAINE dated April 25, 1927 recorded in Liber 9, Page 37 refers to corner as the point of beginning.

4. Act 132 survey recorded in Liber 1, Page 536, by James E. Stephens, P.S. 16053, dated Nov. 14, 1972, shows corner as 3/4" iron pipe in Mon. Box, witnesses by: NW Corner of Brick Wall around pool N59°21'E 61.30'
 SW Corner of Brick Wall around pool S54°53'E 63.80'
 NW Corner of Catch Basin S41°59'W 23.0'

(CONTINUED ON BACK)

B. Description of corner evidence found and/or method applied in restoring or reestablishing corner:

Found 3/4" x 22" iron pipe in monument box in Centerline of Coolidge Road, north of Centerline of Grand River Ave. Found nail & tag #16053 in NW side of utility pole, S W 40.39 feet. Found all 4 of Maurice Mahieu, P.S. #28414 tags as recorded in Liber 7, Page 114: NW corner of catch basin S42W 22.95'; SW corner of brick sign base S65°E, 50.70'; PK nail in northerly pole of billboard support, N40°W 60.56'; centerline of 14" Maple N80°E 40.0'± (nail and tag gone). Found 4 of Mark W. Witalec, PS #30897 witnesses as recorded in Liber 6, Page 390: Back of concrete curb, East 18.33'; nearside of concrete light pole, SW, 62.93'; the remaining two are the catch basin and maple tree same as Mahieu's. Excavated 2 feet below road surface inside monument box. Found no other evidence of corner. Replaced 3/4" pipe with standard 3/4" smooth Iron rod with cap stamped "P.A. 345 P.S.#28414". This surveyor believes that the 3/4" rod is the best location for the corner based on the history of the removed 3/4" pipe.

C. Description of monument for corner and accessories established to perpetuate locating the position of the corner:

3/4" smooth iron rod with cap stamped "P.A. 345 P.S. #28414", witnessed by:
 Northwest corner catch basin, S42°W, 22.95 feet
 Southwest corner brick sign base, S65°E, 50.70 feet
 Nail & tag #28414 in south side 14" Maple, N80°E, 39.97 feet
 PK nail north side of northerly pole for billboard sign, N40°W, 60.56 feet
 Concrete monument, East 32.65 feet

Signed by Maurice H. Mahieu
 Surveyor's Michigan License No. 28414

Date

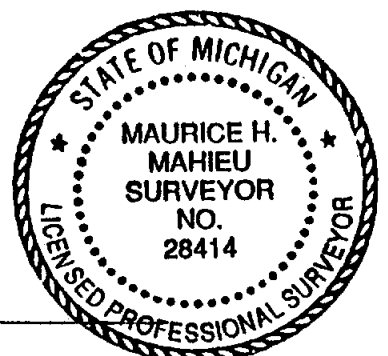
11/21/95

(PART A CONTINUED)

5. Ingham County Road Commission grid map, revised Jan. 1, 1972, calls out the following: Mon box (MSHD 1969)
NW cor. CB S40W 23.0'; Brick Wall N65E 61.3'; Brick Wall S45E 63.8'; 85' N of $\frac{1}{2}$ Grand River Ave.
6. Act 132 Survey by James E. Stephens, P.S. 16053, recorded in Liber 1, Page 1250, dated May 16, 1974, refers to corner, but does not give corner material or witnesses. Refers to Liber 2, Page 148 LCRC
7. Act 74 Certificate recorded in Liber 2, Page 147, dated November 7, 1972, by Clyde K. Stephens RLS #3829 recorded corner as a 3/4" iron pipe in a monument box, witnessed by: N59°21'E 61.30 feet to the NW corner of a brick wall around a swimming pool.
S54°53'E 63.80 feet to the SW corner of a brick wall around a swimming pool.
S41°59'W 23.00 feet to the NW corner of a catch basin
The section line north of the corner was assigned a bearing of N0°19'15"W
8. Act 74 Certificate recorded in Liber 6, Page 390, dated August 16, 1988 by Mark W. Witalec PS 30897 recorded corner as a 1/2" pipe in a monument box, witnessed by: SW, 23.00' to NW corner of a C.B. casting
SW, 62.98' to near side of conc. light pole
ENE, 40.00' to nail & tag #28414 in south side of a 12" Maple tree
E, 18.33' to back of conc. curb
(On the certificate, Mr. Witalec noted that this corner is consistent with MDOT 280 card. This surveyor could not find this card.)
9. Act 74 Certificate recorded in Liber 7, Page 114, by Maurice H. Mahieu, P.S. #28414 dated March 29, 1989 calls for corner to be a 3/4" iron pipe in a monument box, witnessed by: NW corner of a catch basin, S42°W 23.00 feet
SW corner of a brick sign base at ground level S65°E 50.82 feet
Nail and tag in 12" Maple, N80°E 40.00 feet
PK nail in northerly pole of billboard support, N40°W 60.54 feet



LAND CORNER RECORDATION CERTIFICATE
Filing Requirement of Act 74, Mich. P.A. 1970

For corners in

INGHAM COUNTY

Located In: LANSING TOWNSHIP Corner Code #

1. Public Land Survey T 4N R 2W L-5
 T R
 T R
 T R
 T R
 2. Property Controlling S T R
 in Section S T R
 3. Miscellaneous S T R
 Property in Sec. S T R

4. Lot No. _____, Recorded Plat _____
 5. Private Claims _____

FILED

11/28/1995 14:13:49
 REGISTER OF DEEDS
 PAULA JOHNSON
 INGHAM COUNTY, MI

Register of Deeds Stamp & File Number

I, Maurice H. Mahieu, in a field survey on July 13, 1995 do hereby certify that under requirements of P.A. 74, Michigan P.A. of 1970, the corner points mentioned in lines 1 and 2 above were in conformance with regulations and rules therefore as required in the current manual of survey instructions of the United States Department of the Interior, Bureau of Land Management or by a decree of a Court of Law and /or that the corner points mentioned in lines 3, 4 and 5 above were in conformance with the rules of the Michigan Board of Land Surveyors or by a Decree of a Court of Law; established, re-established, monumented, re-monumented, recovered, found as expressed below:

NOTE: Not more that 4 corners, all in the same town and range, may be recorded on this certificate.

A. Description of original monument and accessories and/or subsequent restoration:

1. The original GLO corner was set by Musgrove Evans, U.S. Deputy Surveyor on Monday Feb 12, 1827. Notes state "Set 1/4 Sec. Post at av. dist in true line
 W. Oak 5 N6 1/2E 15lks
 W. Oak 12 S77W 12lks

2. Ingham County Road Commission old grid map does not give corner material, witness of "Iron in Conc. 33.0 E"

3. An Act 74 LCRC recorded in Liber 3, Page 131 by James E. Stephens, PS #16053 on June 12, 1974, as "railroad spike was found in the centerline of the 1/4 line road (Harrison Road). Witnessed by: Survey tag on the NE side of a Twin 14" Oak tree, N47°40'W 46.66 feet; Survey tag on the South side of a power pole, S86°18'E 16.36 feet; Survey tag on the NW side of a 10" Elm tree, S31°46'W 64.65 feet.

4. An ACT 132 Certificate of Survey was recorded in Liber 2, Page 415, by James E. Stephens PS #16053 on Aug 6, 1974 (survey dated June 6, 1974) and used information same as A3.

(CONTINUED ON BACK)

B. Description of corner evidence found and/or method applied in restoring or reestablishing corner:

Found 1"x18" iron rebar in monument box in centerline of Harrison Ave. and 150' +/- north of the centerline of Wildwood Drive. Found 3 of James E. Stephens, PS #16053, witnesses as recorded in Liber 3, Page 131, on June 4, 1974: nail and tag #16053 south side of utility pole, S86°E, 16.37 feet; centerline of 24" Elm, S31°W, 64.60' +/- (no nail & tag); centerline of twin 15" Oak, N47°W, 49.20' +/- (no nail & tag). Also found all 6 of Mark W. Witalec PS#30897, witnesses as recorded in Liber 6, Page 374 on May 11, 1988: Conc. monument, East, 33.05'; centerline of 5 1/2" dia. conc. light pole, NNW, 52.4'; centerline of 5 1/2" dia. conc. light pole, SSE 76.4'; centerline of manhole cover SSW, 27.6'; remaining two witnesses are elm tree and utility pole which are the same as Stephens witnesses. Excavated 2' below road surface inside monument box. Found no other evidence. Replaced 1" rebar with standard 3/4" smooth iron rod and cap stamped "PA 345, PS#28414". This surveyor feels that the location of the 3/4" iron rod is the best location of the corner based on the history of the 1" bar.

C. Description of monument for corner and accessories established to perpetuate locating the position of the corner:

3/4" smooth iron rod with cap stamped "PA345 PS#28414" witnessed by:
 Nail and tag #16053 south side of utility pole, S86°E, 16.37 feet
 Southwest corner of concrete block garage, S53°E, 59.89 feet
 Nail and tag #28414 south side of Triple Oak, N87°W, 38.88 feet
 Southeast corner of brick house #711 S57°W, 73.82'

Signed by Maurice H. Mahieu Date 11/21/95

Surveyor's Michigan License No. 28414



FORM APPROVED BY MICHIGAN STATE BOARD OF LAND SURVEYORS, JAN. 28, 1971
 REVISED MAY 14, 1975
 REVISED JAN, 1983

P.A. 345 INGHAM COUNTY
 PEER APPROVED 11/21/95

(PART A CONTINUED)

5. An Act 74, LCRC was recorded in Liber 6, Page 374 by Mark W. Witalec PS #30897 on May 23, 1988. The Certificate states "Found 1 1/4" iron rod 3" +/- below surface of asphalt pavement. NOTE: This point was recorded as the corner in Liber 3, Page 131-132, Ingham Co. Recorded Corners. The witnesses previously recorded verify this location. Also, Glencairn No. 1 plat monumentation verifies this location." Witness to 1 1/4" rod as: E. 16.36' to survey tag #16053 S. Side of util pole

SW 64.65' +/- to NW side of an elm tree

SSW 32.7' to centerline of a M.H. Cover (Capital Casting)

NNW 52.5' to centerline of a 5 1/2" dia pre-cast conc. Lt. pole

SSE 76.4' to centerline of a 5 1/2" dia. pre-cast conc. Lt. pole

E 33.05 to a conc. Plat mon.

6. Corner was referred to in the following subdivisions: Glencairn No. 1, Liber 8, Page 34; Glencairn No. 2, Liber 12, Page 45; Glencairn No. 3, Liber 13, Page 1; Glencairn No. 4, Liber 15, Page 11; Shaw Estates 3, Liber 33, Page 38



LAND CORNER RECORDATION CERTIFICATE
Filing Requirement of Act 74, Mich. P.A. 1970

For corners in

INGHAM COUNTY

Located In: LANSING TOWNSHIP Corner Code #

FILED

11/28/1995 14:13:48
 REGISTER OF DEEDS
 PAULA JOHNSON
 INGHAM COUNTY, MI

1. Public Land Survey	T	4N	R	2W	L-4
	T		R		
	T		R		
	T		R		
2. Property Controlling	S		T		R
in Section	S		T		R
3. Miscellaneous	S		T		R
Property in Sec.	S		T		R

Register of Deeds Stamp & File Number

4. Lot No. _____, Recorded Plat _____
 5. Private Claims _____

I, Maurice H. Mahieu, in a field survey on July 13, 1995 do hereby certify that under requirements of P.A. 74, Michigan P.A. of 1970, the corner points mentioned in lines 1 and 2 above were in conformance with regulations and rules therefore as required in the current manual of survey instructions of the United States Department of the Interior, Bureau of Land Management or by a decree of a Court of Law and /or that the corner points mentioned in lines 3, 4 and 5 above were in conformance with the rules of the Michigan Board of Land Surveyors or by a Decree of a Court of Law; established, re-established, monumented, re-monumented, recovered, found as expressed below:

NOTE: Not more than 4 corners, all in the same town and range, may be recorded on this certificate.

A. Description of original monument and accessories and/or subsequent restoration:

1. This corner was not set in the original survey of this Township

2. On the Ingham County Road Commission grid sheet (old version) the corner is called out as a pipe in conc. Witnessed by: 12" Pignut 32.9 W
 16" Walnut 30.7 E
 14" Walnut 36.1 SE
 11" Walnut 41.7 SW

3. On the 1972 edition of the Ingham County Road Commission Grid sheet, the same is shown for this corner as A-2

4. An Act 74 Certificate was recorded in Liber 4, Page 268, by Douglas Hooth on August 11, 1978 and calls for corner as "Found 3/8" re-rod with a plastic Surveyors Cap at the surface of Harrison Road, and witnessed by: S45°E Power & Telephone Pole 54.28' N75°E Power & Telephone Pole 37.62' Due West Power Pole 49.50'

(CONTINUED ON BACK)

B. Description of corner evidence found and/or method applied in restoring or reestablishing corner:

Found "T" iron and tag #30897 in monument box in centerline of Harrison Road. Found all 3 of Douglas W. Hooth, #7966, witnesses as recorded in Liber 4, Page 268 on June 6, 1978: Nail and tag "MSHD" north side of utility pole N75°E 37.52'; Nail and tag "MSHD" northeast side of utility pole, SE, 54.27'; Nail and tag "MSHD" north side of utility pole, S85°W, 49.53'. Also found all 5 of Mark W. Witalec, PS#30897, witnesses as recorded in Liber 6, Page 373 on May 13, 1988: back of curb, East, 23.82'; back of curb, west, 24.17'; remaining three witnesses are the same three witnesses recorded by Douglas Hooth. Excavated 2' below road surface inside monument box. Found no other evidence. Replaced "T" iron with standard 3/4"x24" smooth iron rod with cap stamped "PA 345, PS#28414". This surveyor believes that the location of the 3/4" rod is the best position of the corner based on the history of the "T" iron.

C. Description of monument for corner and accessories established to perpetuate locating the position of the corner:

3/4" x 24" smooth iron rod and cap stamped "PA 345 PS#28414"; witnessed by:

Nail and Tag "MSHD" north side utility pole N75°E 37.52 feet
 Nail and Tag "MSHD" northeast side utility pole, S48°E 54.27 feet
 Nail and Tag "MSHD" north side utility pole S86°W 49.53 feet
 Nail and Tag #28414 south side 10" Maple, N54°E 46.70 feet
 Nail and Tag #28414 east side 24" Oak, S34°W 65.85 feet
 Northwest corner brick apartment building, S60°E 86.88 feet
 1/2" iron rod with Cap #31603, West 49.96 feet

Signed by Maurice H. Mahieu Date 11/21/95

Surveyor's Michigan License No. 28414

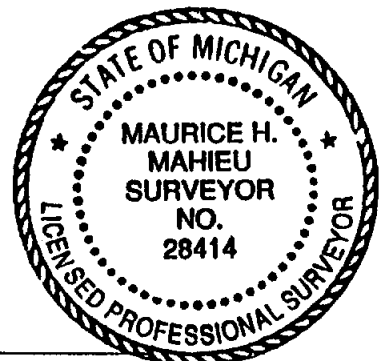

(PART A CONTINUED)

5. Act 74 Certificate recorded in Liber 6, Page 373, by Mark W. Witalec PS #30897, on May 23, 1988 states" Found 1/2" re-rod (no cap) 1"+/- deep in asphalt pavement - Location verified by witnesses in Liber 4, Page 268 and by monumentation in plat of Hickory Ridge No. 1. Witnessed 1/2" Rod with: SE 54.28; to nail & brass tag in NE side utility pole
ENE 37.62' to nail & brass tag in NW side utility pole
W 49.50' to nail & brass tag in N side utility pole
E 24.13' to back of concrete curb
W 24.16' to back of concrete curb
6. Act 132 Certificate of survey recorded in Liber 5, Page 418 by Douglas Richardson PS #31603 dated November 18, 1987 notes Center of Section and refers to A-4 for corner material and witnesses.
7. Act 132 Certificate of survey recorded in Liber 5, Page 1000 by Mark Witalec PS #30897 dated Jan. 25, 1989 calls for Center of Section and show corner material and witnesses same as A-5
8. Corner is referred to in Act 288 Subdivisions of: Shaw Estates Liber 26, Page 17; Shaw Estates No 2, Liber 27, Page 36; Shaw Estates No. 3, Liber 33, Page 38; Hickory Ridge No. 1, Liber 17, Page 13; Hickory Ridge No. 2, Liber 22, Page 12; and Hickory Hill, Liber 31, Page 5



LAND CORNER RECORDATION CERTIFICATE
Filing Requirement of Act 74, Mich. P.A. 1970

Liber

9 Page

74

For corners in
INGHAM COUNTY

Located In: LANSING TWP.

Corner Code #

FILED

960045025
11/22/1996 13:34:31
REGISTER OF DEEDS
Paula Johnson
INGHAM COUNTY, MI

1. Public Land Survey T 4N R 2W M-4
T R
T R
T R
T R
2. Property Controlling S T R
in Section S T R
3. Miscellaneous S T R
Property in Sec. S T R
4. Lot No. , Recorded Plat
5. Private Claims

Register of Deeds Stamp & File Number

	A	B	C	D	E	F	G	H	I	J	K	L	M
1													
2	6			5		4		3		2		1	
3													
4	7			8		9		10		11		12	
5													
6	18			17		16		15		14		13	
7													
8	19			20		21		22		23		24	
9													
10	30			29		28		27		26		25	
11													
12	31			32		33		34		35		36	
13													

I, Maurice H. Mahieu, in a field survey on October 23, 1996 do hereby certify that under requirements of P.A. 74, Michigan P.A. of 1970, the corner points mentioned in lines 1 and 2 above were in conformance with regulations and rules therefore as required in the current manual of survey instructions of the United States Department of the Interior, Bureau of Land Management or by a decree of a Court of Law and for that the corner points mentioned in lines 3, 4 and 5 above were in conformance with the rules of the Michigan Board of Land Surveyors or by a Decree of a Court of Law; established, re-established, monumented, re-monumented, recovered, found as expressed below:

NOTE: Not more than 4 corners, all in the same town and range, may be recorded on this certificate.

A. Description of original monument and accessories and/or subsequent restoration:

- The original GLO Corner was set by Lucius Lyon, U.S. Deputy Surveyor on February 1826, "Set 1/4 Section Post,
Red Oak 11 in. S40°W 28 lks.
Hick 9 in. N43°W 48 lks.
- Ingham County Road Commission Grid Map (OLD) states:
1 1/2" Iron
SE Corner Por. Found 55.2 NW
SP. 24" Oak 39.7 NE
SP 4" Oak 27.9 E
- Ingham County Road Commission Grid Map of 1972 states same as A-2.

See Part A continued on back.

B. Description of corner evidence found and/or method applied in restoring or reestablishing corner:

Searched area in approximate location of 1" rod as noted in A4. Found 1" rod and determined it to be A-4, T4N, R1W as recorded. Found monumentation of plat of Glenn Haven Subdivision and projected line from plat a point shown as the East 1/4 Corner of Section 12. Location to be 6.93 feet north of A-4, Meridian Twp. Discussion with City of East Lansing Engineering Department revealed reconstruction of Abbott Road in the past would make excavation for any evidence of former corner futile. Corner recorded as M-4 by Clyde K. Stephens in A-4 appears to be same corner as A-4, T4N, R1W, in Liber 2, Page 569, as there are two witnesses that are substantially the same. The location as established agrees with MDOT plan information. Set 3/4" x 24" rod with cap stamped "PA 345, PS 28414" in monument box in established location. All previous witnesses to corner have been obliterated. This surveyor believed the corner to have been obliterated and re-established from evidence found from Glenn Haven plat and said location to be the best position.

See Part B continued on back

C. Description of monument for corner and accessories established to perpetuate locating the position of the corner:

3/4" x 24" smooth iron rod with cap stamped "PA 345, P.S. #28414"
Witnessed by:
Nail and tag #28414 North side Power Pole S 82°W 39.57 feet
Nail and tag #28414 Northwest side 8" Locust N 34°E 61.11 feet
Nail and tag #28414 Northeast side Power Pole S 51°E 53.80 feet
Nail and tag #28400 (Greg Ash) Southeast side Power Pole S 27°W 81.64 feet
A-4, T4N, R1W South 6.93 feet

Signed by Maurice H. Mahieu Date 11-11-96
Surveyor's Michigan License No. 28414

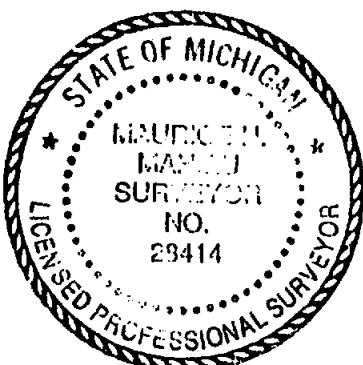

P.A. 345 INGHAM COUNTY
PEER APPROVED 10/31/96 mu

A-4. Act 74 LCRC recorded in Liber 1, Page 7, by Clyde K. Stephens #3829 on June 2, 1971, calls for corner as "1" Rod found in the centerline of the section line road (Abbott Road) Tree ROW on a projection to the West". Witnessed by:
Spike and Stephens Engineering Tag in Power Pole N12° 50' W 144.37'
Stephens tag in Power Pole S 77° 46' W 33.1'
Stephens tag in Power Pole S 63° 08' E 21.65'

A-5. Act 132 Certificate of Survey recorded in Liber 1, Page 3 by Clyde K. Stephens, #3829, dated April 8, 1971 calls for corner and witnesses same as A-4.

A-6. Corner was referred to in the Plat of Glenn Haven Subdivision recorded in Liber 12, Page 50 on April 1939.

A-7. MDOT ROW Map, Sheet #118 of Ingham County ROW Book, shows position of corner to be 396.65' north of centerline of M-78.

LAND CORNER RECORDATION CERTIFICATE
Filing Requirement of Act 74, Mich. P.A. 1970

Liber 9 Page 84

For corners in

INGHAM COUNTY Located In: LANSING TOWNSHIP Corner Code #

FILED

960045036
11/22/1996 13:34:39
REGISTER OF DEEDS
Paula Johnson
INGHAM COUNTY, MI

1. Public Land Survey T 4N R 2W M-5
T R
T R
T R
T R
2. Property Controlling S T R
in Section S T R
3. Miscellaneous S T R
Property in Sec. S T R
4. Lot No. , Recorded Plat
5. Private Claims

Register of Deeds Stamp & File Number

I, Maurice H. Mahieu, in a field survey on Oct. 15, 1996 do hereby certify that under requirements of P.A. 74, Michigan P.A. of 1970, the corner points mentioned in lines 1 and 2 above were in conformance with regulations and rules therefore as required in the current manual of survey instructions of the United States Department of the Interior, Bureau of Land Management or by a decree of a Court of Law and /or that the corner points mentioned in lines 3, 4 and 5 above were in conformance with the rules of the Michigan Board of Land Surveyors or by a Decree of a Court of Law; established, re-established, monumented, re-monumented, recovered, found as expressed below:

NOTE: Not more that 4 corners, all in the same town and range, may be recorded on this certificate.

A. Description of original monument and accessories and/or subsequent restoration:

1. The original GLO Corner was set by Lucius Lyon, U.S. Deputy Surveyor on Feb. 1826

"Set Post Corner to Sections 12 & 13

TAM 6 in. S 53°W 195 lks.

DO 10 in. N19°W 53 lks.

GLO notes for A-5, T4N, R1W is 15 lks south of this corner

2. Ingham County Road Commission Grid Map (Old) states iron in concrete 33.0' East.
3. Ingham County Road Commission Grid Map of 1972 states same as A-2.

See Part A continued on back.

B. Description of corner evidence found and/or method applied in restoring or reestablishing corner:

Found Cap #31603 (Doug Richardson) 9.90 feet north of A-5 (Meridian), no iron below cap. Set standard 3/4" x 8" smooth iron rod with cap stamped "PA 345, PS 28414" 9.90 feet north of A-5 (T4N, R1W) on Township line between A-4 and A-5 (T4N, R1W) grouted into concrete road bed. The distance of 9.90 was shown on the subdivisions noted in A-4. Discussion with City of East Lansing Engineering Department revealed reconstruction of Abbott Road in the past would make excavation for any evidence of former corner futile. The corner falls on the centerline of Abbott Road. The location of the 3/4" rod is the best location for the perpetuation of the corner based on the surrounding subdivisions.

C. Description of monument for corner and accessories established to perpetuate locating the position of the corner:

3/4" x 8" smooth iron with cap stamped "PA 345 PS #28414" witnessed by:

Nail and Tag #16053 (J.E. Stephens) East side Power Pole, S63°W 38.00 feet

Nail and Tag #16053 (J.E. Stephens) West side Power Pole, S 78°E 52.01 feet

Iron with cap #31603, (Douglas Richardson), West 32.98 feet

SW Corner Bldg. #700 Abbott Road, N45°E 68.92 feet

A-5 T4N, R1W, 9.90' South

Signed by Maurice H. Mahieu Date 11-11-96

Surveyor's Michigan License No. 28414



FORM APPROVED BY MICHIGAN STATE BOARD OF LAND SURVEYORS, JAN. 28, 1971
REVISED MAY 14, 1975
REVISED JAN, 1983

P.A. 345 INGHAM COUNTY
PEER APPROVED 10/17/96 *m*

Part A Continued

4. Corner was referred to in the following plats: Assessor's Plat, Lot 52, Angell's Subdivision, Liber 10, Page 48; Assessor's Plat of Elm-Dale Subdivision, Liber 10, Page 47; Assessor's Plat of Lots 22-23-55 of Assessor's Plat of Lot 52, Angell's Subdivision of Lot 80 and parts of Lots 78 & 79, College Grove Plat, Liber 13, Page 2.