

LAND CORNER RECORDATION CERTIFICATE
Filing Requirement of Act 74, Mich. P.A. 1970

Nov 29 9 33 AM '94

For corners in Leroy Twp.

REGISTER OF DEEDS
Ingham County, Mich.
INGHAM COUNTY, MICH.

Ingham (County) Located In: Corner Code 77

1. Public Land Survey	T 3N R 2E	G-1
	T R	
	T R	
	T R	
2. Property Controlling in Section	S T R	
	S T R	
3. Miscellaneous Property in Sec.	S T R	
	S T R	

Register of Deeds Stamp & File Number

4. Lot No. Recorded Plat
5. Private Claims

I, Larry A. Bryan, in a field survey on October 31, 19 94, do hereby certify that under requirements of P.A. 74, Michigan P.A. of 1970, the corner points mentioned in lines 1 and 2 above were in conformance with regulations and rules therefore as required in the current manual of survey instructions of the United States Department of the Interior, Bureau of Land Management or by a decree of a Court of Law and/or that the corner points mentioned in lines 3, 4 and 5 above were in conformance with the rules of the Michigan Board of Land Surveyors or by a Decree of a Court of Law; established, re-established, monumented, re-monumented, recovered, found as expressed below:

NOTE: Not more than 4 corners, all in the same town and range, may be recorded on this certificate.

A. Description of original monument and accessories and/or subsequent restoration:

G-1,

1. Corner set in Original Government Survey by Joseph Wampler, Deputy Surveyor in December, 1825. as "Int. N. Bdy. 10 lks E. of Post. Set post cor S. 3 & 4 fw Ironwood 4 S20E 8, Ironwood 5 S15 1/2W 18".

2. G-13, Locke Township, T4N, R2E, referred to in a survey by A. Jackson, County Surveyor, on October 3, 1853, (vol. 1, page 315 County Surveyor Records) with no monument given, witnessed to Beech 7 N89 1/2°E 5 1/2, Beech 8 N46 1/2°W 10. (Continued on Back)

B. Description of corner evidence found and/or method applied in restoring or reestablishing corner:

G-1, Investigation at this corner revealed a 4" steel fence post in concrete base four feet in diameter with fence North, South and West. Excavated around concrete and post but found nothing. All the witnesses listed in item #8 were found, 18" Ash North, 36.8', 12" Oak South, 32.6', 14" Oak, West, 45.5', 1/2" rerod West, 6.60'. Accepted 4" steel fence post in concrete base as the perpetuated location of G-1 Leroy Township.

C. Description of monument for corner and accessories established to perpetuate locating the position of the corner:

G-1, T3N-R2E

Found 4" steel fence post in concrete base.

Set nail & tag #25832 in West side 18" Ash, North, 36.80'.

Set nail & tag #25832 in West side 12" Oak, South, 32.64'.

Set nail & tag #25832 in North side 14" Oak, West, 45.50'.

Set nail & tag #25832 in East side 8" Ash, S30°W, 25.65'.

Found 1/2" rebar, Southeast corner Section 33, T4N, R2E, West, 6.60'.

Signed by Larry A. Bryan

Surveyor's Michigan License No. 25832

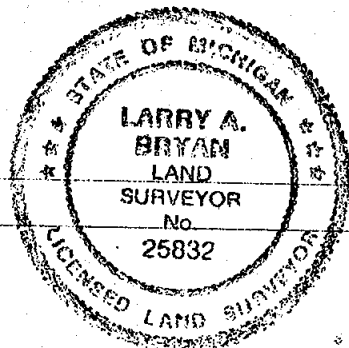

Date 11-23-94

FORM APPROVED BY MICHIGAN STATE BOARD OF LAND SURVEYORS, JAN. 28, 1971
REVISED MAY 14, 1975
REVISED JAN., 1983

P.A. 345 INGHAM COUNTY

PEER APPROVED 11/09/94 dc

2728

PART "A" CONTINUED

3. G-13, Locke Township, T4N, R2E, referred to in a survey by A. Jackson, County Surveyor, on February 1, 1854 (vol. 1, page 335 County Surveyor Records) with no monument given, witnessed to Sugar 16 S77W 35, Beech 6 N72 1/2W 16, Beech 10 N78E 54.
4. G-13, Locke Township, T4N, R2E, referred to in a survey by A. Jackson, County Surveyor, on February 2, 1854 (vol. 1, page 337 County Surveyor Records) with no monument given, but listing witnesses in item #3.
5. Corner referred to in a survey by John McCreary, County Surveyor, on January 22, 1889 (vol. 3, page 35 County Surveyor Records) with no monument or witnesses given.
6. G-13 Locke Township referred to in a survey by Gary R. Boss, P.S. #17022, on September 6, 1978 and recorded in Liber 3, of Surveys, Page 687 through 690, Ingham County Records, as a "1/2" Rerod" Witnessed by: N10°E N. W/S 10" Ash 36.98', East 4" steel post 6.60', West N. N/S 10" Oak 38.73", S15°W N. E/S 4" Maple 10.71'.
7. Corner referred to in a survey by Gary R. Boss, P.S. #17022, on September 6, 1978 and recorded in Liber 3, of Surveys, Page 687 through 690, Ingham County Records, as a "4" steel post and conc." Witnessed by: North 36.70' N. W/S 10" Ash, West 45.33' N. N/S 10" Oak, South 32.3' N. E/S 8" Oak.
8. Corner recorded by Gary R. Boss, P.S. #17022, on September 18, 1978, in Liber 5 of Corners, Page 12, Ingham County Records, as "Found 4" dia. steel fence post-5 feet high, in conc. at fence intersection N-S-W.". Witnessed by: North 36.70' N. W/S 10" Ash, West 45.33' N. N/S 10" Oak, South 32.3' N. E/S 8" Oak, West 6.60' SE cor. Sec. 33, T4N-R2E (1/2" Iron & cap).
9. G-13, Locke Township, T4N, R2E, recorded by Gary R. Boss, P.S. #17022, on September 19, 1978, in Liber 5 of Corners, Page 11, Ingham County Records, as "1/2" rerod set 6.60' West of NE cor. of Sec. 4 T3N-R2E along East-West fence line per government notes." Witnessed by: N10°E N. W/S 10" Ash 36.98', East 4" steel post 6.60', West N. N/S 10" Oak 38.73", S15°W N. E/S 4" Maple 10.71'.
10. G-13 Locke Township referred to in a survey by Fred N. White, P.S. #12034, on August 15, 1984 and recorded in Liber 4, of Surveys, Page 978, no monument and witnesses listed but referencing item #9.

Nov 29 9 34 AM '94

LAND CORNER RECORDATION CERTIFICATE
Filing Requirement of Act 74, Mich. P.A. 1970

For corners in Leroy Twp.

REGISTER OF DEEDS
James Johnson
INGHAM COUNTY, MICH.

Ingham (County) Located In: Corner Code: #

1. Public Land Survey T 3N R 2E G-2
T R
T R
T R

2. Property Controlling S T R
in Section S T R

3. Miscellaneous S T R
Property in Sec. S T R

4. Lot No. Recorded Plat

5. Private Claims

Register of Deeds Stamp & File Number

I, Larry A. Bryan, in a field survey on October 31, 19 94, do hereby certify that under requirements of P.A. 74, Michigan P.A. of 1970, the corner points mentioned in lines 1 and 2 above were in conformance with regulations and rules therefore as required in the current manual of survey instructions of the United States Department of the Interior, Bureau of Land Management or by a decree of a Court of Law and/or that the corner points mentioned in lines 3, 4 and 5 above were in conformance with the rules of the Michigan Board of Land Surveyors or by a Decree of a Court of Law; established, re-established, monumented, re-monumented, recovered, found as expressed below:

NOTE: Not more than 4 corners, all in the same town and range, may be recorded on this certificate.

A. Description of original monument and accessories and/or subsequent restoration:
G-2,

1. Post set in Original Government Survey Joseph Wampler, Deputy Surveyor, in December, 1825, as "set 1/4 post, Beech 7 S11E 27, Beech 3 N22W 12".
2. Corner referred to in a survey by A. Jackson, County Surveyor, on June 22, 1853, (vol. 1, page 309 County Surveyor Records) with no monument given, Beech 3 N22W 12, Sugar 11 N23 1/2E 18 1/2, Beech 7 S11E 27.
(Continued on Back)

B. Description of corner evidence found and/or method applied in restoring or reestablishing corner:

G-2, Investigation at this corner revealed a 1/2" bar and cap #25832 in Anchor Post hole and circle of rocks, with fence lines East, West, North and South with all the witnesses remaining from item #4 and #5. Distances from G-2 to G-3, Rec. 2640.00' from County Surveyor Records, Meas. 2655.76' from item #4. Distances from G-2 to F-2, Rec. 2646.27 from County Surveyor Records Meas. 2659.23' from item #4. Accepted 1/2" bar and cap #25832 as the perpetuated location of G-2 Leroy Township.

C. Description of monument for corner and accessories established to perpetuate locating the position of the corner:

G-2, T3N-R2E
Found 1/2" bar and cap #25832 in Anchor Post hole and circle of rocks.
Set nail & tag #25832 in East side 36" Ash, North, 19.28'.
Set nail & tag #25832 in South side 8" Elm, S80°E 29.32'.
Set nail & tag #25832 in Northwest side 48" Oak, S20°W, 21.19'.
Set nail & tag North side 8" Cherry, West, 23.12'.

Signed by *Larry A. Bryan*
Surveyor's Michigan License No. 25832

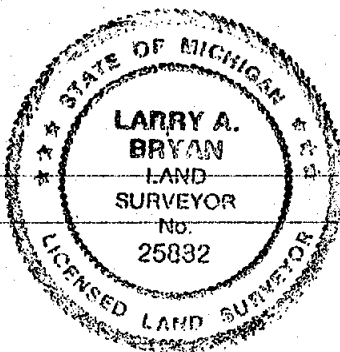

Date 11-23-94

FORM APPROVED BY MICHIGAN STATE BOARD OF LAND SURVEYORS, JAN. 28, 1971
REVISED MAY 14, 1975
REVISED JAN., 1983

P.A. 345 INGHAM COUNTY
PEER APPROVED 11/09/94 *ML*

PART "A" CONTINUED

3. Corner referred to in a survey by John McCreary, County Surveyor, on January 22, 1889, (vol. 3, page 35 County Surveyor Records) with no monument or witnesses given.

4. Corner referred to in a unrecorded survey by Larry A. Bryan, P.S. #25832, on March 12, 1992, Job #92-B-36253, as found anchor post hole and circle of rocks with fence lines North, South, East and West. Set nail & tag #25832 in East side 36" Ash, North, 19.28', Set nail & tag #25832 in South side 8" Elm, S80°E 29.32', Set nail & tag #25832 in Northwest side 48" Oak, S20°W, 21.19', Set nail & tag North side 8" Cherry, West, 23.12'.

5. Corner recorded by Larry A. Bryan, P.S. #25832, on March 12, 1992, and recorded in Liber 7 of Corners, Page 261, Ingham County Records, with the same monument and witnesses noted in item #4.

Nov 29 9 34 AM '94

LAND CORNER RECORDATION CERTIFICATE
Filing Requirement of Act 74, Mich. P.A. 1970

For corners in Leroy Twp.

REGISTER OF DEEDS
Ingham County, Mich.
INGHAM COUNTY, MICH.

Ingham (County) Located In: Corner Code: #

1. Public Land Survey	T 3N R 2E	G-3
	T R	
	T R	
	T R	
2. Property Controlling in Section	S T R	
	S T R	
3. Miscellaneous Property in Sec.	S T R	
	S T R	

Register of Deeds Stamp & File Number

4. Lot No. , Recorded Plat
5. Private Claims

	A	B	C	D	E	F	G	H	I	J	K	L	M
2	6	5	4	3	2	1							
3													
4	7	8	9	10	11	12							
5													
6	18	17	16	15	14	13							
7													
8	19	20	21	22	23	24							
9													
10	30	29	28	27	26	25							
11													
12	31	32	33	34	35	36							
13													

I, Larry A. Bryan in a field survey on October 31, 19 94 do hereby certify that under requirements of P.A. 74, Michigan P.A. of 1970, the corner points mentioned in lines 1 and 2 above were in conformance with regulations and rules therefore as required in the current manual of survey instructions of the United States Department of the Interior, Bureau of Land Management or by a decree of a Court of Law and/or that the corner points mentioned in lines 3, 4 and 5 above were in conformance with the rules of the Michigan Board of Land Surveyors or by a Decree of a Court of Law; established, re-established, monumented, re-monumented, recovered, found as expressed below:

NOTE: Not more than 4 corners, all in the same town and range, may be recorded on this certificate.

A. Description of original monument and accessories and/or subsequent restoration:
G-3,

1. Post set in Original Government Survey Joseph Wampler, Deputy Surveyor, in December, 1825, as "set post cor to 3,4,9 & 10, Lynn. 7 N67E 8, Sugar 4 S31 3/4W 6 1/2".
2. Corner referred to in a survey by A. Jackson, County Surveyor, on June 22, 1853, (vol. 1, page 309 County Surveyor Records) with no monument given, with the same witnesses as listed in item #1. (Continued on Back)

B. Description of corner evidence found and/or method applied in restoring or reestablishing corner:

G-3, Investigation at this corner revealed a 1/2" bar and cap #18989 at base of Anchor post with fence lines East, West and South and two witnesses remaining from items #5, #6 and #7. A 6" Crabapple Northeasterly 12.5' and fence post East 7.30'. Excavated area around post but did not find any other monumentation for the corner. Distances from G-3 to G-2, Rec. 2640.00' from County Surveyor Records, Meas. 2655.76' from item #6. Distances from F-3 to G-3, Rec. 2655.18 from County Surveyor Records, Meas. 2660.66' from item #6. Accepted location of 1/2" bar and cap #18989 as the perpetuated location of G-3 Leroy Township and reset 3/4" x 24" bar with cap stamped P.A. 345 #25832.

C. Description of monument for corner and accessories established to perpetuate locating the position of the corner:

G-3, T3N-R2E
Reset 3/4" x 24" bar with cap stamped P.A. 345 #25832 in location of 1/2" bar and cap noted above.
Set nail & tag #25832 in South side 18" Maple, N80°W, 43.78'.
Found nail & tag in North side 6" Crabapple, N60°E, 12.50'.
Found nail & tag in North side fence post, East, 7.30'.
Northwest corner barn, S10°W, 43.95'.

Signed by Larry A. Bryan
Surveyor's Michigan License No. 25832

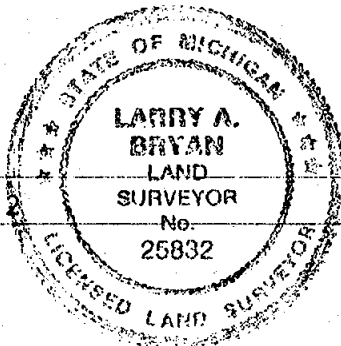

Date 11-23-94

FORM APPROVED BY MICHIGAN STATE BOARD OF LAND SURVEYORS, JAN. 28, 1971
REVISED MAY 14, 1975
REVISED JAN., 1983

P.A. 345 INGHAM COUNTY
PEER APPROVED 11/09/94 MC

PART "A" CONTINUED

3. Corner referred to in a survey by A. Jackson, County Surveyor, on May 22, 1856, (vol. 3, page 109 County Surveyor Records) with no monument given, with the same witnesses as listed in item #1.
4. Corner referred to in a survey by John McCreary, County Surveyor, on January 22, 1889, (vol. 3, page 109 County Surveyor Records) with no monument or witnesses given.
5. Corner referred to in a survey by Marvin F. Fouty, P.S. #18989, on August 7, 1980, recorded in Liber 4 of Surveys, Page 614, Ingham County Records, as "Set 1/2" bar & cap w./wit. Tags and Nails in: N. side 6" Crabapple ENE 12.5', E. side 4" Crabapple North 11.75', N. side Fence post East 7.30'.
6. Corner referred to in a unrecorded survey by Larry A. Bryan, P.S. #25832, dated March 12, 1992, Job #92-B-36253, with the same monument and witnesses listed in item #5.
7. Corner recorded by Larry A. Bryan, P.S. #25832, on March 12, 1992, in Liber 7 of Corners, Page 261, Ingham County Records as "Found 1/2" bar & cap at base of Anchor post, per Fouty survey, fence lines running East, West and South", with the same witnesses as listed in item #5.

LAND CORNER RECORDATION CERTIFICATE
Filing Requirement of Act 74, Mich. P.A. 1970

Nov 29 9 34 AM '94

For corners in Leroy Twp.

Ingham Located In: Corner Code //

REGISTER OF DEEDS
Ingham County, Michigan

1. Public Land Survey T 3N R 2E H-1
T R
T R
T R
2. Property Controlling S T R
in Section S T R
3. Miscellaneous S T R
Property in Sec. S T R

Register of Deeds Stamp & File Number

4. Lot No. , Recorded Plat
5. Private Claims

	A	B	C	D	E	F	G	H	I	J	K	L	M
2	6	5	4	3	2	1							
3													
4	7	8	9	10	11	12							
5													
6	18	17	16	15	14	13							
7													
8	19	20	21	22	23	24							
9													
10	30	29	28	27	26	25							
11													
12	31	32	33	34	35	36							
13													

I, Larry A. Bryan in a field survey on October 31, 19 94, do hereby certify that under requirements of P.A. 74, Michigan P.A. of 1970, the corner points mentioned in lines 1 and 2 above were in conformance with regulations and rules therefore as required in the current manual of survey instructions of the United States Department of the Interior, Bureau of Land Management or by a decree of a Court of Law and/or that the corner points mentioned in lines 3, 4 and 5 above were in conformance with the rules of the Michigan Board of Land Surveyors or by a Decree of a Court of Law; established, re-established, monumented, re-monumented, recovered, found as expressed below:

NOTE: Not more than 4 corners, all in the same town and range, may be recorded on this certificate.

A. Description of original monument and accessories and/or subsequent restoration:
H-1,

1. Corner not set in Original Government Survey.

2. H-13, Locke Township, T4N, R2E, referred to in a survey by A. Jackson, County Surveyor, on October 3, 1853, (vol. 1, page 315 County Surveyor Records) with no monument given, witnessed to Beech 7 N66W 80, Beech 12 N22 1/2°E 12 1/2.

(Continued on Back)

B. Description of corner evidence found and/or method applied in restoring or reestablishing corner:

H-1, Investigation at this corner revealed a 1/2" bar and cap #18998 in concrete 4" in diameter in East-West fence. All of the witness trees from item #5 were found with the bearings and distances listed in Part "C". This corner set by the Ingham County Survey and Remonumentation Project and no further field work was done. Accepted 1/2" bar and cap #18998 in 4" diameter concrete as the location of H-1 Leroy Township.

C. Description of monument for corner and accessories established to perpetuate locating the position of the corner:

H-1, T3N-R2E

Found 1/2" bar and cap #18998 in concrete 4" in diameter in East-West fence.

Set nail & tag #25832 in East side 20" Beech, N50°W, 22.34'.

Found nail & tag #18998 in East side power pole, S30°W, 8.83'.

Set nail & tag #25832 in East side 30" Beech, South, 35.85'.

Found nail & tag #18998 in West side 28" Maple, S25°W, 28.78'.

H-13 Locke, 6" iron fence post set in concrete, West 6.30'.

Signed by Larry A. Bryan
Surveyor's Michigan License No. 25832

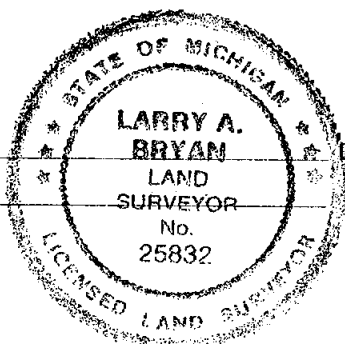

Date 11-23-94

FORM APPROVED BY MICHIGAN STATE BOARD OF LAND SURVEYORS, JAN. 28, 1971
REVISED MAY 14, 1975
REVISED JAN., 1983

P.A. 345 INGHAM COUNTY
PEER APPROVED 11/09/94

PART "A" CONTINUED

3. H-13, Locke Township, T4N, R2E, referred to in a survey by A. Jackson, County Surveyor, on February 1, 1854 (vol. 1, page 337 County Surveyor Records) with no monument given. Witnessed to: Sugar 18 N70E 10, Maple 13 N36W 50.

4. Corner referred to in a survey by John McCearry, County Surveyor, on January 22, 1889 (vol. 3, page 35 County Surveyor Records) with no monument or witnesses given.

5. Corner recorded by Ronnie M. Lester, P.S. #18998, on May 11, 1981 and recorded in Liber 6, of Corners, Page 197, Ingham County Records, as "Field inspection revealed no evidence of corner. Corner considered lost. Set corner on Township line between G-1 and I-1. Measured East 2651.23' to I-1, Measured West 2651.22' to G-1. Corner falls in East-West fence, 6.30 feet East of fenceline North. Witnessed to: Nail & tag, #18998, East side 20" Beech, N50°W, 22.34', Nail & tag, #18998, East side power pole, S30°W, 8.83', Nail & tag, #18998, East side 30" Beech, South, 35.85', Nail & tag, #18998, West side 44" Maple, S25°W, 28.78', H-13 Locke, 6" iron fence post set in concrete, West 6.30'.

6. H-13 Locke Township recorded by Ronnie M. Lester, P.S. #18998, on May 20, 1981 and recorded in Liber 6, of Corners, Page 201, Ingham County Records, as "Field inspection revealed 6" iron fence post set in concrete with fence North East and West. Distance measured North, West and East are in close accord with GLO measurements. Accepted 6" iron fence post as perpetuated location of H-13. Witnessed to: Nail & tag, #18998, East side 20" Beech, N20°W, 19.06', Nail & tag, #18998, East side power pole, South, 6.71', Nail & tag, #18998, East side 30" Beech, S15°E, 35.92', Nail & tag, #18998, West side 44" Maple, S10°W, 26.00', 4" concrete monument at H-1, Leroy, East 6.30'.

950002192 Liber 8
LAND CORNER RECORDATION CERTIFICATE
Filing Requirement of Act 74, Mich. P.A. 1970

Page 505

For corners in

INGHAM
LEROU TOWNSHIP

Located In:

Corner Code #

FILED

11/07/1995 09:05:06
REGISTER OF DEEDS
PAULA JOHNSON
INGHAM COUNTY, MI

1. Public Land Survey T 3N R 2E H-2
T R
T R
T R
2. Property Controlling S T R
in Section S T R
3. Miscellaneous S T R
Property in Section S T R

Register of Deeds Stamp & File Number

4. Lot No. , Recorded Plat
5. Private Claims

I, DAVID R. LOHR, in a field survey on OCTOBER 12, 19 95, do hereby certify that under requirements of P.A. 74, Michigan P.A. of 1970, the corner points mentioned in lines 1 and 2 above were in conformance with regulations and rules therefore as required in the current manual of survey instructions of the United States Department of the Interior, Bureau of Land Management or by a decree of a Court of Law and/or that the corner points mentioned in lines 3, 4 and 5 above were in conformance with the rules of the Michigan Board of Professional Surveyors or by a Decree of a Court of Law; established, re-established, monumented, re-monumented, recovered, found as expressed below:

NOTE: Not more than 4 corners, all in the same town and range, may be recorded on this certificate.

A. Description of original monument and accessories and/or subsequent restoration:

- H-2: 1. CORNER NOT SET DURING ORIGINAL GOVERNMENT SURVEYS
2. RECORDED SURVEYS BY JOHN McCREARY, COUNTY SURVEYOR, IN 1889,
V.3, PG.35, V.3, PG.206 AND FOLDER 1, PG 84, STATE "IRONWOOD STAKE"
WITNESSED BY: BEECH 6" S 30 1/2° W 6 LINKS (3.96')
BEECH 8" N 53° W 52 LINKS (34.65')
3. MISC. RECORDS, LIVINGSTON COUNTY SURVEYOR CLAY W. GORDON, DATED 9/29/39,
BOOK 5, PG. 4, NO MENTION OF MONUMENT OR WITNESSES.
SHOWS DISTANCE SOUTH TO 1/8 CORNER OF 1324.5'
SHOWS DISTANCE NORTH TO NORTH 1/4 CORNER (H-1) OF 1883'

CONTINUED ON BACK

B. Description of corner evidence found and/or method applied in restoring or reestablishing corner:

- H-2: VISITED APPARENT LOCATION OF CORNER AND FOUND NEW TREATED ANCHOR POST ON FENCE RUNNING NORTH AND EAST-WEST, ALSO FOUND ANOTHER ANCHOR POST LOCATED 11.0 FT. EAST WITH FENCE RUNNING TO THE SOUTH. RETRACED FOUTY'S TRAVERSE OF ITEM A:4, AND SET CORNER AT INTERSECTION OF 1/4 LINES. CORNER FALLS 50 NORTH X 1.2 FT. WEST OF WESTERLY ANCHOR POST. FOUND NO EVIDENCE OF ANCIENT OCCUPATION OTHER THAN SCANT REMAINS OF TREE LINE TO NORTH. SET 3/4" X 24" STANDARD REMON. BAR AND P.A. 345 CAP #30090, 50 FT. NORTH X 1.2 FT. WEST OF ANCHOR POST. DISTANCES TO ADJACENT CORNERS MATCH CLOSELY THOSE OF SURVEYOR CLAY W. GORDON (ITEM A-3)

C. Description of monument for corner and accessories established to perpetuate locating the position of the corner:

- H-2: SET 3/4" X 24" STANDARD REMON. BAR AND P.A. 345 CAP #30090
50 FT. NORTH X 1.2 FT. WEST OF ANCHOR POST. WITNESSED BY:
SET. N&T #30090 W/S WOOD FENCE POST AZ. 00-18-36 38.43'
SET. N&T #30090 E/S WOOD ANCHOR POST AZ. 165-22-21 53.32'
SET. N&T #30090 W/S WOOD ANCHOR POST AZ. 177-34-00 50.74'
SET. N&T #30090 SE/S WOOD FENCE POST AZ. 212-26-30 56.02'
TRAV.PT. LE1-18-21, 1/2" REBAR/CAP AZ. 211-28-33 108.93'
BEARING AND DISTANCE TO G-2 AZ. 273-01-17 2662.20'
BEARING AND DISTANCE TO I-2 AZ. 93-01-17 2664.34'
BEARING AND DISTANCE TO H-3 AZ. 179-11-38 2650.08'
BEARING AND DISTANCE TO H-1 AZ. 359-11-36 1885.93'



Signed by David R. Lohr

Date 11/1/95

Surveyor's Michigan License No. 30090

FORM APPROVED BY MICHIGAN STATE BOARD OF PROFESSIONAL SURVEYORS, JAN. 28, 1971
REVISED MAY 14, 1975
REVISED JAN., 1983

P.A. 345 INGHAM COUNTY
PEER APPROVED 10/24/95

Page 2

H-2: PART A - CONTINUED

4. UNRECORDED SURVEY NUMBER 885, BY MARVIN F. FOUTY, PS #18989, DATED 4/15/93 BREAKS DOWN SOUTH 1/2 OF SECTION 3, LEROY TOWNSHIP, BUT DOES NOT SHOW CENTER OF SECTION AS HAVING BEEN SET. CONTACTED SURVEYOR FOUTY AND OBTAINED COPY OF TRAVERSE NOTES AND COMPUTATION DATA.

THIS DOCUMENT
IS A COPY OF THE
ORIGINAL RECORD
AND IS NOT A
REPRODUCTION
OF THE ORIGINAL

LAND CORNER RECORDATION CERTIFICATE
Filing Requirement of Act 74, Mich. P.A. 1970

For corners in

INGHAM

(County)

LEROY TOWNSHIP

Located In:

Corner Code #

FILED

11/07/1995 09:05:08
 REGISTER OF DEEDS
 PAULA JOHNSON
 INGHAM COUNTY, MI

1. Public Land Survey	T	<u>3N</u>	R	<u>2E</u>	<u>H-3</u>
	T		R		
	T		R		
	T		R		
2. Property Controlling in Section	S		T	R	
	S		T	R	
3. Miscellaneous Property in Section	S		T	R	
	S		T	R	

Register of Deeds Stamp & File Number

4. Lot No. _____, Recorded Plat _____
 5. Private Claims _____

I, DAVID R. LOHR, in a field survey on OCTOBER 12, 19 95, do hereby certify that under requirements of P.A. 74, Michigan P.A. of 1970, the corner points mentioned in lines 1 and 2 above were in conformance with regulations and rules therefore as required in the current manual of survey instructions of the United States Department of the Interior, Bureau of Land Management or by a decree of a Court of Law and/or that the corner points mentioned in lines 3, 4 and 5 above were in conformance with the rules of the Michigan Board of Professional Surveyors or by a Decree of a Court of Law; established, re-established, monumented, re-monumented, recovered, found as expressed below:

NOTE: Not more than 4 corners, all in the same town and range, may be recorded on this certificate.

A. Description of original monument and accessories and/or subsequent restoration:

- H-3: 1. POST SET BY JOS. WAMPLER, D.S., IN 1825, WITNESSED BY:
 BEECH 6" S 84° W, 27 LKS. (17.82')
 BEECH 12" S 7-1/2° E, 11-1/2 LKS. (7.59')
2. RECORDED SURVEY BY A. JACKSON, CO. SURVEYOR, DATED 1854, VOL. 1, PG 359, NO MENTION OF MONUMENT, SAME WITNESSES AS ITEM #1.

CONTINUED ON BACK

B. Description of corner evidence found and/or method applied in restoring or reestablishing corner:

H-3: VISITED APPARENT LOCATION OF CORNER AND FOUND ONLY A FENCE LINE RUNNING NORTH-SOUTH. NO EVIDENCE VISIBLE AS TO LOCATION OF CORNER. RETRACED FOURTY'S TRAVERSE OF ITEM A:7, AND SET CORNER MIDWAY ON LINE BETWEEN G-3 AND I-3. CORNER FALLS 16 FT. WEST OF NORTH-SOUTH FENCE LINE. FOUND NO EVIDENCE OF ANCIENT OCCUPATION, AS CORNER FALLS IN PLOWED FIELD. SET 3/4" X 24" STANDARD REMON. BAR AND P.A. 345 CAP #30090, 16 FT. WEST OF FENCE.

C. Description of monument for corner and accessories established to perpetuate locating the position of the corner:

H-3: SET 3/4" X 24" STANDARD REMON BAR AND P.A. 345 CAP 16 FT. WEST OF NORTH-SOUTH FENCELINE AND ON SOUTH SECTION LINE. WITNESSED BY:

SET N&T #30090	NW/S 4" FENCE POST	AZ. 44-40-30	22.31'
SET 1/2" REBAR IN FENCELINE		AZ. 87-08-38	16.16'
SET N&T #30090	SW/S 4" FENCE POST	AZ. 144-00-12	27.72'
SET N&T #30090	W/S 12" ELM	AZ. 174-19-30	153.28'
TRAV. PT. LE1-23-117, 1/2" IRON/CAP		AZ. 272-51-22	633.50'
BEARING AND DISTANCE TO G-3		AZ. 272-51-22	2681.52'
BEARING AND DISTANCE TO H-2		AZ. 359-11-36	2650.06'
BEARING AND DISTANCE TO I-3		AZ. 92-51-22	2681.52'

Signed by David R. Lohr
 Surveyor's Michigan License No. 30090

FORM APPROVED BY MICHIGAN STATE BOARD OF PROFESSIONAL SURVEYORS, JAN. 28, 1971
 REVISED MAY 14, 1975
 REVISED JAN., 1983

P.A. 345 INGHAM COUNTY
 PEER APPROVED 10/24/95



11-1-95

LAND CORNER RECORDATION CERTIFICATE
Filing Requirement of Act 74, Mich. P.A. 1970

OCT 24 8 42 AM '95

For corners in
INGHAM
(County)
LEROY TOWNSHIP

Located In: Corner Code #

REGISTER OF DEEDS
David Johnson
INGHAM COUNTY, MICH.

- | | | | | | |
|--------------------------------------|---|-----------|---|-----------|------------|
| 1. Public Land Survey | T | <u>3N</u> | R | <u>2E</u> | <u>I-1</u> |
| | T | | R | | |
| | T | | R | | |
| | T | | R | | |
| | T | | R | | |
| 2. Property Controlling in Section | S | | T | R | |
| | S | | T | R | |
| 3. Miscellaneous Property In Section | S | | T | R | |
| | S | | T | R | |

Register of Deeds Stamp & File Number

4. Lot No. _____, Recorded Plat _____
5. Private Claims _____

I, DAVID R. LOHR, in a field survey on AUGUST 22, 19 95, do hereby certify that under requirements of P.A. 74, Michigan P.A. of 1970, the corner points mentioned in lines 1 and 2 above were in conformance with regulations and rules therefore as required in the current manual of survey instructions of the United States Department of the Interior, Bureau of Land Management or by a decree of a Court of Law and/or that the corner points mentioned in lines 3, 4 and 5 above were in conformance with the rules of the Michigan Board of Professional Surveyors or by a Decree of a Court of Law; established, re-established, monumented, re-monumented, recovered, found as expressed below:

NOTE: Not more than 4 corners, all in the same town and range, may be recorded on this certificate.

	A	B	C	D	E	F	G	H	I	J	K	L	M
2	6	5	4	3	2	1							
3													
4	7	6	5	4	3	2	1						
5													
6	18	17	16	15	14	13	12	11	10	9	8	7	6
7													
8	19	18	17	16	15	14	13	12	11	10	9	8	7
9													
10	30	29	28	27	26	25	24	23	22	21	20	19	18
11													
12	31	30	29	28	27	26	25	24	23	22	21	20	19
13													

A. Description of original monument and accessories and/or subsequent restoration:

- I-1: 1. POST SET BY JOSEPH WAMPLER, DEPUTY SURVEYOR, IN 1825,
"INT. N. BDY. 3 LKS. W. OF POST & SET POST" WITNESSED BY:
BEECH 20" S 87 1/2° E, 10 LINKS (6.60')
SUGAR 23" S 31° W, 23 LINKS (15.18')
2. RECORDED SURVEY BY JOHN McCREARY, CO. SURVEYOR, DATED 10/20/1890 ,
VOL. 3, PG 39, STATES "STONE...NO TREES".
CONTINUED ON BACK

B. Description of corner evidence found and/or method applied in restoring or reestablishing corner:

- I-1: FOUND 1/2" RE-BAR IN 1" PIPE IN BIT. PAVEMENT AS PER ITEM A-11. CORNER FALLS IN PATCHED AREA AS PREVIOUSLY EXCAVATED AT WEBBERVILLE AND ALLEN ROADS. CORNER LOCATION WAS PREVIOUSLY EXCAVATED BY INGHAM COUNTY REMON. SQUAD IN 1980. ACCEPTED LOCATION OF CORNER BASED ON PREVIOUS EXCAVATION AND REVIEW. EXCAVATED AROUND IRON AND SET MON. BOX OVER IRON. ALSO SET 1/2" X 18" REBAR/CAP 30090 ON STANDARD TOWNSHIP LINE AT RECORD DISTANCE OF 3 LINKS (1.98') TO EAST TO AVOID FURTHER CONFUSION OVER LOCATION OF I-13 LOCKE TOWNSHIP.

C. Description of monument for corner and accessories established to perpetuate locating the position of the corner:

- I-1: FOUND 1/2" IRON INSIDE 1-1/2" PIPE, 4.5 FT. EAST C/L WEBBERVILLE ROAD, SET MON. BOX. WITNESSED BY:
- | | | | | |
|---------------|----------------|----|------|--------|
| SET N&T 30090 | W/S 12" MAPLE | AZ | 14° | 85.92' |
| SET N&T 30090 | W/S 12" MAPLE | AZ | 34° | 48.00' |
| SET N&T 30090 | W/S 30" MAPLE | AZ | 165° | 88.41' |
| SET N&T 30090 | N/S TELE. POLE | AZ | 276° | 56.40' |
| I-13 LOCKE | 1/2" REBAR | AZ | 96° | 1.98' |

Signed by David R. Lohr
Surveyor's Michigan License No. 30090

Date OCT 03 1995

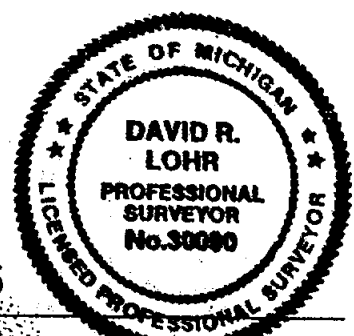

I-1 CONTINUED:

3. NO OTHER REFERENCES FOUND IN COUNTY SURVEYS RECORDS
4. COPY OF LIVINGSTON CO. SURVEYOR NOTES BOOK 55, PAGE 4, DATED 9/29/39, REFERS TO CORNER BUT MAKES NO REFERENCE TO MONUMENT OR WITNESSES.
5. UNDATED INGHAM COUNTY ROAD COMM. GRID MAP REFERS TO CORNER AS "1 1/2" PIPE"
WITNESSED BY: PP W 53.5'
12"ELM ESE 42.0'
16" MAPLE SSE 88.50'
6. UNRECORDED SURVEY # 677393, BY F.N. WHITE, DATED 7/7/67, REFERS TO CORNER BUT MAKES NO REFERENCE TO MONUMENT OR WITNESSES.
7. L.C.R.C. BY OSCAR BOSS, PS #13574, DATED 3/10/72, LIBER 1, PAGE 395, REFERS TO THIS SAME CORNER AS I-13, LOCKE TOWNSHIP. "FOUND 1/2" IRON"
WITNESSED BY: N.E. 35.9' STEEL STREET SIGN
S.E. 89.0' 36" MAPLE
S.W. 113.3 36" MAPLE
8. L.C.R.C. BY OSCAR BOSS, PS #13574, DATED 8/3/72, LIBER 2, PAGE 55, REFERS TO THIS SAME CORNER AS I-13, LOCKE TOWNSHIP. "1/2" FOUND"
WITNESSED BY: WEST 54.14' NAIL NORTH SIDE TELE. POLE
S 18° E 88.60' NAIL WEST SIDE 30" MAPLE
S 10° W. 112.09 NAIL EAST SIDE 30" MAPLE
9. UNRECORDED SURVEY # 71078, BY HERBERT L. MUNZEL, P.E., DATE UNKNOWN, REFERS TO CORNER BUT MAKES NO REFERENCE TO MONUMENT OR WITNESSES.
10. L.C.R.C. BY HERBERT L. MUNZEL, PS #10699, DATED 9/4/73, RECORDED IN L. 2, PG. 525. STATES, "(FOUND) IRON PIPE AT CENTERLINE OF WEBBERVILLE & ALLEN ROADS...PREVIOUS SURVEY ESTABLISHED CORNER". WITNESSED BY:
PROP. CORNER ROW MARKER (IRON PIPE) SET 33' EAST & 33' SOUTH.
11. INGHAM COUNTY REMON. NOTES DATED 7/24/80 SHOW THAT AN EXCAVATION WAS CONDUCTED AT THIS LOCATION. EXCAVATION WAS 6' X 10', THE 1/2" ROD WAS FOUND TO BE DRIVEN INSIDE A 1 1/2" PIPE, 24" IN LENGTH. NO OTHER EVIDENCE WAS FOUND TO CONFLICT WITH CORNER RECORDED IN LIBER 2, PAGE 525. SIGNED, RON LESTER, 8/6/80.
12. UNRECORDED SURVEY BY AUSTIN C. WILLIAMS, PS # 21275, DATED 6/13/86, REFERS TO CORNER BUT MAKES NO REFERENCE TO MONUMENT OR WITNESSES.
13. RECORDED SURVEY BY GARY BOSS, PS #17022, DATED 12/10/86, LIBER 5, PG. 378 "FD. PIPE", WITNESSED BY:
SET NAIL, P. POLE S SIDE DUE WEST, 56.41'
SET NAIL, N SIDE 10" TREE S 70° E 115.89'
SET NAIL, W SIDE 20" HICKORY S 10° E 88.69'
14. RECORDED SURVEY BY MARVIN FOUTY, PS # 18989, DATED 10/10/88, RECORDED IN LIBER 6, PAGE 813, "FOUND 1/2" BAR & CAP. NO WITNESSES.
15. UNRECORDED SURVEY #90632, BY DARYLL HUGHES, PS #19834, DATED 3/28/90, STATES "FD. 1/2" IRON ROD 4 FT. EAST OF CENTERLINE WEBBERVILLE RD. AND AT CENTERLINE OF ALLEN ROAD: WITNESSED BY:
036 DEG. 47.64' FD. NAIL/TAG W/S 8" MAPLE
165 DEG. 88.63' FD. NAIL/TAG W/S 24" OAK
277 DEG. 56.43' FD. NAIL/TAG S/S UTILITY POLE
080 DEG. 91.34' SET NAIL/TAG S/S TWIN 12" MAPLE
16. RECORDED SURVEY BY DARYLL D. HUGHES, PS #19834, DATED 4/8/94, LIBER 7, PAGE 173, STATES "FD. 1/2" IRON ROD 4 FT. EAST OF CL WEBBERVILLE RD. AND AT CENTERLINE OF ALLEN ROAD: SAME WITNESSES AS ITEM 15.

LAND CORNER RECORDATION CERTIFICATE
Filing Requirement of Act 74, Mich. P.A. 1970

For corners in

INGHAM
(County)

Located In:

Corner Code #

LEROU TOWNSHIP

1. Public Land Survey

T 3N R 2EI-2

T _____ R _____

T _____ R _____

T _____ R _____

2. Property Controlling
in Section

S _____ T _____ R _____

S _____ T _____ R _____

3. Miscellaneous

S _____ T _____ R _____

Property in Section

S _____ T _____ R _____

4. Lot No. _____, Recorded Plat _____

5. Private Claims _____

FILED

11/07/1995 09:05:09
 REGISTER OF DEEDS
 PAULA JOHNSON
 INGHAM COUNTY, MI

Register of Deeds Stamp & File Number

I, DAVID R. LOHR, in a field survey on AUGUST 22, 19 95,
 do hereby certify that under requirements of P.A. 74, Michigan P.A. of 1970, the corner points mentioned
 in lines 1 and 2 above were in conformance with regulations and rules therefore as required in the current
 manual of survey instructions of the United States Department of the Interior, Bureau of Land
 Management or by a decree of a Court of Law and/or that the corner points mentioned in lines 3, 4 and
 5 above were in conformance with the rules of the Michigan Board of Professional Surveyors or by a
 Decree of a Court of Law; established, re-established, monumented, re-monumented, recovered, found
 as expressed below:

**NOTE: Not more than 4 corners, all in the same town and range, may be recorded
 on this certificate.**

A. Description of original monument and accessories and/or subsequent restoration:

I-2: 1. POST SET BY JOSEPH WAMPLER, DEPUTY SURVEYOR, IN 1825,
 WITNESSED BY: BEECH 22" S 53 ° W 31 LINKS (20.46')
 BEECH 12" N 35 ° E 30 LINKS (19.80')

2. RECORDED SURVEY BY T.J. BROWN, DEP. CO. SURVEYOR, DATED 12/31/1868,
 VOL. 2, PG 69, STATES "A POST" NO WITNESSES.
 CONTINUED ON BACK

B. Description of corner evidence found and/or method applied in restoring or reestablishing corner:

I-2: SEARCHED AT APPARENT LOCATION AND FOUND 1/2" X 12" REBAR AND CAP
 MARKED, "INGHAM TEMP. PT." FROM 1980 REMON. WITNESSES. IRON
 LIES IN THE CENTER OF PREVIOUSLY EXCAVATED AREA (ROAD PATCHED).
 DUG TO 27" BELOW ASPHALT, NO OTHER EVIDENCE WAS FOUND. ACCEPTED
 LOCATION OF 1/2" IRON AS THAT OF PREVIOUSLY EXCAVATED STONE IN 1978.
 SET 3/4" X 24" REMON. BAR/CAP #30090, IN MON BOX. CONTACTED LOCAL LAND
 OWNER (OMEGA FARMS) AND WAS INFORMED THAT EXTENSIVE SURVEY WAS CONDUCTED
 IN 1993 BY MARV. FOUTY (ITEM A-16). CONTACTED MARV. FOUTY AND OBTAINED
 TRAVERSE NOTES AND COMPUTATION DATA RELATING TO SECTION 3. CORNER FALLS
 2643.56 FT. NORTH OF I-3.

C. Description of monument for corner and accessories established to perpetuate locating the position of the corner:

I-2: SET 3/4" X 24" REMON BAR/CAP #30090 IN MON BOX. WITNESSED BY:
 SET N&T #30090 E/S ELM CLUMP AZ. 15 DEG. 105.92'
 SET N&T #30090 W/S 12" ELM AZ. 156 DEG. 72.40'
 SET N&T #30090 E/S APPLE CLUMP AZ. 172 DEG. 231.78'
 SET N&T #30090 N/S POWER POLE AZ. 276 DEG. 63.65'
 FD. N&T #29238 N/S FENCE POST AZ. 275 DEG. 33.45'
 BEARING & DISTANCE TO I-1 AZ. 358-49-07 1905.25'
 BEARING & DISTANCE TO I-3 AZ. 178-48-38 2643.56'
 BEARING & DISTANCE TO H-2 AZ. 273-01-17 2664.34'



Signed by

David R. Lohr

Date

11-1-95

Surveyor's Michigan License No.

30090

FORM APPROVED BY MICHIGAN STATE BOARD OF PROFESSIONAL SURVEYORS, JAN. 28, 1971
 REVISED MAY 14, 1975
 REVISED JAN., 1983

I-2 CONTINUED:

3. RECORDED SURVEY BY T.J.BROWN, DEP. CO. SURVEYOR, DATED 12/31/1868, VOL. 3, PG 42, STATES "A POST" NO WITNESSES.
4. RECORDED SURVEY BY JOHN McCREARY, CO. SURVEYOR, DATED 1/18/1889, VOL. 3, PG 35, NO REFERENCE TO MONUMENT OR WITNESSES. SHOWS 160 RODS WEST TO H-2.
5. RECORDED SURVEY BY JOHN McCREARY, CO. SURVEYOR, DATED 10/20/1889, VOL. 3, PG 39, STATES, "IRON POST" WITNESSED BY:
SUGAR 16" S12°30'W 128-1/2 (LKS) (84.81')
6. RECORDED SURVEY BY JOHN McCREARY, CO. SURVEYOR, DATED 10/1889, VOL. 3, PG 206, NO REFERENCE TO MONUMENT OR WITNESSES. SHOWS 160 RODS WEST TO H-2.
7. NO OTHER REFERENCES FOUND IN COUNTY SURVEYS RECORDS.
8. AREA WAS EXCAVATED IN 1978 BY THE INGHAM COUNTY REMON. SQUAD #11. A 3/4" X 30" IRON BAR WAS FOUND, FLUSH WITH THE ROAD SURFACE, ON C/L WEBBERVILLE ROAD AND ON FENCE TO WEST. ALSO, A 10" X 12" X 18" POINTED ROCK WAS FOUND ABOUT 0.22 FT WEST, AT A DEPTH OF 16" BELOW ROAD SURFACE. AN AREA 10 FT X 15 FT X 4 FT DEEP WAS EXCAVATED AND NO ADDITIONAL EVIDENCE WAS FOUND. NOTES STATE "RESET PT. "A" (STONE)... REPLACED 3/4" IRON FD. WITH 1/2" REROD AND ING. CO. TEMP.CAP. 10-5-78 C. EVERETT" WITNESSED BY:
S 20° E, 232.20' SET N&T 18998 ON NE/S 20" APPLE
S 80° W, 31.74' SET N&T 18998 ON S/S 36" CHERRY
N 88° W, 63.68' SET N&T 18998 ON N/S P.POLE
DUE NORTH, 329.28' SOUTH EDGE OF CONCRETE BRIDGE
9. PRIVATE RECORD DATA BY AUSTIN C. WILLIAMS, PS #21275, DATED 6/13/86, JOB NUMBER 6273, NO REFERENCE TO MONUMENT OR WITNESSES.
10. RECORDED SURVEY BY GARY BOSS, PS #17022 DATED 12/10/86, LIBER 05, PG.370-371. STATES "FD. 1/2" IRON CAPPED." WITNESSED BY:
SET NAIL N/SIDE FENCE POST N 80° W, 33.41'
SET NAIL W/SIDE 8" TREE S 30° E, 72.55'
SET NAIL W/SIDE 12" TREE N 15° E, 177.20'
11. RECORDED SURVEY BY GARY BOSS, PS #17022 DATED 12/10/86, LIBER 05, PG.378-380. STATES "FOUND 1/2" IRON CAPPED". SAME WITNESSES AS ITEM #10.

RECORDED

I-2; PART A - CONTINUED:

12. L.C.R.C. BY JAMES E. STEPHENS, PS #16053, DATED 08/03/89,
RECORDED IN LIBER 7, PG.140. STATES, "FOUND 1/2 INCH DIAMETER IRON ROD
IN CENTERLINE OF WEBBERVILLE ROAD ON THE PROJECTION OF A FENCE LINE TO
THE WEST" ...IRON ROD WAS LEFT IN POSITION WITH THE FOLLOWING WITNESSES".
FOUND SURVEY TAG/NUMBER 29238 IN CORNER FENCE POST WEST 33.45 FEET
FOUND SURVEY TAG/NUMBER 18998 IN UTILITY POLE WEST 63.65 FEET
SET TAG/NUMBER 16053 IN EAST SIDE OF ELM TREE CLUSTER N25°E 106.00 FEET
SET TAG/NUMBER 16053 IN WEST SIDE OF 10" ELM TREE S 30°E 72.40 FEET
(NOTE: PS #29238 IS BRYAN L. BOSS)
13. RECORDED SURVEY BY JAMES E. STEPHENS, PS #16053, DATED 8/3/89,
LIBER 5, PG.1151. STATES "IRON ROD" WITNESSES SAME AS ITEM #12.
14. RECORDED SURVEY BY JAMES E. STEPHENS, PS #16053, DATED 10/18/90,
LIBER 06, PG.729. STATES "IRON ROD" WITNESSED SAME AS ABOVE #12.
15. PRIVATE RECORD DATA BY DARRELL D. HUGHES, PS #19834, DATED 03/28/90,
JOB NUMBER 90632, STATES "FOUND 1/2" IRON ROD", WITNESSED BY:
156 DEG. 72.55' FD. NAIL/TAG E/S 8" TREE
278 DEG. 33.43' FD. NAIL/TAG N/S FENCE CORNER POST
019 DEG. 106.00' FD. NAIL/TAG E/S MULTI-TRUNK MAPLE
281 DEG. 63.69' FD. NAIL/TAG N/S UTILITY POLE
16. UNRECORDED SURVEY BY MARVIN F. FOUTY, PS #18989, DATED 04/15/93,
JOB NUMBER 885, REFERS TO CORNER, NO MENTION OF MONUMENT OR WITNESSES.
17. RECORDED SURVEY BY DARRELL D. HUGHES, PS #19834, DATED 04/08/94,
LIBER 7, PAGE 173, JOB NUMBER 93131, STATES "FD. 1/2" IRON ROD IN
CENTERLINE WEBBERVILLE RD." WITNESSES SAME AS ITEM #15.

LAND CORNER RECORDATION CERTIFICATE Filing Requirement of Act 74, Mich. P.A. 1970

OCT 24 8 44 AM '95

For corners in

INGHAM

(County)

Located In:

Corner Code #

REGISTER OF DEEDS

David R. Lohr
INGHAM COUNTY, MICH.

LEROY TOWNSHIP

1. Public Land Survey

T 3N R 2EI-3T R T R T R 2. Property Controlling
in SectionS T R S T R

3. Miscellaneous

S T R

Property in Section

S T R

Register of Deeds Stamp & File Number

4. Lot No. , Recorded Plat 5. Private Claims

I, DAVID R. LOHR, in a field survey on AUGUST 22, 19 95,
do hereby certify that under requirements of P.A. 74, Michigan P.A. of 1970, the corner points mentioned
in lines 1 and 2 above were in conformance with regulations and rules therefore as required in the current
manual of survey instructions of the United States Department of the Interior, Bureau of Land
Management or by a decree of a Court of Law and/or that the corner points mentioned in lines 3, 4 and
5 above were in conformance with the rules of the Michigan Board of Professional Surveyors or by a
Decree of a Court of Law; established, re-established, monumented, re-monumented, recovered, found
as expressed below:

NOTE: Not more than 4 corners, all in the same town and range, may be recorded
on this certificate.

A. Description of original monument and accessories and/or subsequent restoration:

- I-3: 1. POST SET BY J. WAMPLER IN 1825,
WITNESSED BY: BEECH 20" S 14 1/2° E 16 LINKS (10.56')
BEECH 10" S 57° W 14 LINKS (9.24')
2. RECORDED SURVEY BY A. JACKSON, CO. SURVEYOR, DATED JUNE 1854,
VOL. 1, PG. 359, NO MENTION OF CORNER
WITNESSED BY: BEECH S 14 1/2° E 16 LINKS (10.56')
BEECH S 57° W 14 LINKS (9.24')
CONTINUED ON BACK

B. Description of corner evidence found and/or method applied in restoring or reestablishing corner:

- I-3: FOUND LARRY BRYAN CAP INSIDE 1" PIPE MENTIONED IN LCRC, L.3 PAGE 521,
AT A DEPTH OF 6". CONTINUED TO DIG AND AT A DEPTH OF 12" FOUND
1" PIPE INSIDE 1 1/2" X 32" PIPE, I BELIEVE THIS TO BE THE "GAS PIPE"
REFERRED TO BY JOHN McCREARY, COUNTY SURVEYOR, IN THE COUNTY SURVEYORS
RECORDS VOLUME 3 PAGE 39. CONTINUED TO DIG AND FOUND 8" TRI-ANGULAR
STONE UNDER THE 1 1/2" X 32" PIPE. LEFT STONE IN PLACE AND
SET 3/4" X 24" REMON BAR AND CAP #30090 IN MON BOX AT INTERSECTION OF
WEBBERVILLE AND PARDEE ROAD.

C. Description of monument for corner and accessories established to perpetuate locating the position of the corner:

- I-3: SET 3/4" X 24" REMON BAR AND CAP #30090 IN MON BOX AT INTERSECTION OF
WEBBERVILLE AND PARDEE ROAD. WITNESSED BY:

FD. P.K NAIL	S/S UTILITY POLE	AZ. 272 DEG.	32.45'
FD. N&T #25832	W/S 36" MAPLE	AZ. 14 DEG.	86.62'
NW CORNER HOUSE	#2996	AZ. 130 DEG.	139.35'
FD. N&T #25832	W/S 36" MAPLE	AZ. 158 DEG.	69.26'
FD. N&T #25832	SE/S 36" MAPLE	AZ. 210 DEG.	95.58'
FD. N&T #17640	(G. YOUNG) NE/S UTIL. POLE	AZ. 112 DEG.	96.03'

Signed by

*David R. Lohr*Date 10/3/95Surveyor's Michigan License No. 30090

FORM APPROVED BY MICHIGAN STATE BOARD OF PROFESSIONAL SURVEYORS, JAN. 28, 1971
REVISED MAY 14, 1975
REVISED JAN., 1983

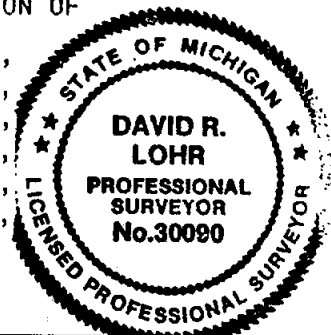

Page 2

I-3 CONTINUED:

3. RECORDED SURVEY BY T.J BROWN, CO. SURVEYOR, DATED 12/31/1868
VOL.3, PAGE 42, NO MENTION OF MONUMENT OR WITNESSES.
4. RECORDED SURVEY BY T.J BROWN, CO. SURVEYOR, DATED 1868
FOLDER 1, PAGE 3, "ESTABLISHED - NO WITNESSES."
5. RECORDED SURVEY BY JOHN McCREARY, CO. SURVEYOR, DATED 10/20/1890
VOL. 3, PG 228, " GAS PIPE" WITNESSED BY:
SUGAR 24" S 24° 45' W 94 LINKS (62.04')
MAPLE 4" N 22° 50' E 74 LINKS (48.84')
6. RECORDED SURVEY BY JOHN McCREARY, CO. SURVEYOR, DATED 1890
FOLDER 1, PG 2, "GAS PIPE"
WITNESSED BY: SUGAR 24" S 24 3/4° W 94 LINKS (62.04')
TREE 4" N 22 1/2° E 74 LINKS (48.84')
7. NO OTHER REFERENCES FOUND IN COUNTY SURVEYS RECORDS
8. RECORDED SURVEY BY OSCAR BOSS, DATED 04/01/74, LIBER 01, PG.1230-1231.
"1" PIPE FD." WITNESSED BY: SW CORNER HOUSE NE 111.70'
NW CORNER HOUSE SE 90.75'
IRON FENCE POST WEST 34.40'
9. L.C.R.C. BY OSCAR BOSS, PS #13574, DATED 01/24/76,
RECORDED IN L.3, PG.521. STATES, "1" PIPE FD", WITNESSES SAME AS ITEM #8.
10. RECORDED SURVEY BY AUSTIN WILLIAMS, PS #21275, DATED 8/23/77
LIBER 03, PG.126-127. NO MENTION OF CORNER OR WITNESSES
11. L.C.R.C. BY JAMES E. STEPHENS, DATED 08/03/89, LIBER 7, PG.141.
"FOUND. 3/4 INCH PIPE ON INTERSECTION OF WEBBERVILLE AND PARDEE RD,
IRON PIPE WAS LEFT IN POSITION." WITNESSED BY:
NAIL/TAG #29238 POWER POLE WEST, 32.44'
NAIL/TAG #29238 30" MAPLE S 30° E, 69.55'
NAIL/TAG #29238 30" MAPLE S 40° W, 95.40'
NW CORNER OF HOUSE #2996 S 45° E, 139.35'
12. RECORDED SURVEY BY GARY R. BOSS, DATED 4/23/79, LIBER 03, PAGE 941-942.
"3/4" PIPE" WITNESSED SAME AS ABOVE #8.

2809

Page 3

I-3 CONTINUED:

13. UNDATED ICRC GRID MAP. "1" PIPE" SAME WITNESSES AS L3-941 ABOVE

14. RECORDED SURVEY BY GARY R. BOSS, DATED 5/19/87, LIBER 05, PAGE 370-371.

"FD. 1/2" PIPE" WITNESSED BY:

SET NAIL	S SIDE	POLE	DUE WEST,	32.46'
SET NAIL	W SIDE	16" TREE	S 20° E,	69.54'
SET NAIL	E SIDE	14" TREE	S 35° W,	95.42'
FD NAIL	W SIDE	22" TREE	N 40° E,	41.22'

15. RECORDED SURVEY BY GARY R. BOSS, DATED 12/10/86, LIBER 05, PAGE 378-380.

"FD 1/2" IRON" WITNESSES SAME AS ITEM #14 ABOVE.

16. RECORDED SURVEY BY MAURICE MAHIEU, PS #23414, DATED 7/18/89

LIBER 05, PAGE 1130-1131. "FD. 1" PIPE 3" BELOW ASPHALT"

WITNESSED BY:

UTILITY POLE	S 60° E	96.03'
UTILITY POLE	WEST	32.52'
36" MAPLE	S 20° E	69.55'
36" MAPLE	S 30° W	95.61'

17. RECORDED SURVEY BY JAMES E. STEPHENS, PS #16053, DATED 8/18/90

LIBER 6 PG. 729. "FD 1/2" IRON" WITNESSED BY:

FD NAIL/TAG #29238	UTILITY POLE	WEST	32.44'
FD NAIL/TAG #29238	30" MAPLE	S 30° E	69.55'
FD NAIL/TAG #29238	30" MAPLE	S 40° W	95.40'
NW CORNER OF HOUSE #2996		S 45° E	139.35'

2809