

SURVEY & REMONUMENTATION

JAN 11 2005

SECTION

Located In:

Comer Code #

1. Public Land Survey
¼ CORNER COMMON
TO SECTIONS 31 & 32
LESLIE TOWNSHIP

T 1N R 1W

C-12

Paula Johnson-
INGHAM COUNTY
REGISTER OF DEEDS
OFFICIAL SEAL



L-11 P-246

CRNR 17.00

2004-062686

2004-062686

Page: 1 of 2

10/05/2004 08:11 A

2. Property Controlling S____ T____ R____
in Section S____ T____ R____

3. Miscellaneous S___ T___ R___

4. Lot No _____, Recorded Plat _____

5. Private Claims

I, Brian Reynolds, in a field survey on JULY 7, 2004 do hereby certify that under requirements of P.A. 74, Michigan P.A. of 1970, the corner points mentioned in lines 1 and 2 above were in conformance with regulations and rules therefore as required in the current manual of survey instructions of the United States Department of the Interior, Bureau of Land Management or by a decree of a Court of Law and/or that the corner points mentioned in lines 3, 4, and 5 above were in conformance with the rules of the Michigan Board of Land Surveyors or by a Decree of a Court of Law; established, re-established, monumented, re-monumented, recovered, found as expressed below.

NOTE: Not more than 2 corners, all in the same town and range, may be recorded on this certificate.

A. Description of original monument and accessories and/or subsequent restoration:

SEE PAGE TWO FOR HISTORICAL SUMMARY

B. Description of corner evidence found and/or method applied in restoring or reestablishing corner:

FOUND 1/2" IRON AT APPROXIMATE CENTERLINE OF ABANDONED BLACKMORE ROAD AND ALL OF KELLER'S WITNESSES, MUCH LARGER NOW, NO NAILS VISIBLE. EXCAVATED 5' X 5' THROUGH 0.8' OF ROAD GRAVEL, TO A TOTAL DEPTH OF 4 FEET THROUGH CLAY, FINAL WIDTH OF HOLE BEING 3' X 3' AT BOTTOM. FOUND NO FURTHER EVIDENCE OF MONUMENTATION. SECTION TRAVERSE PROVED POSITION TO BE MID-POINT ON LINE WITHIN TOLERANCE. ACCEPTED CORNER POSITION BY KELLER AS PROPER RESTORATION OF CORNER.

C. Description of monument for corner and accessories established to perpetuate locating the position of the corner:

WITNESSES TO 3/4" X 24" STEEL FORM PIN AND INGHAM COUNTY ALUMINUM CAP STAMPED "31602"
SET NAIL AND ORANGE PLASTIC TAG "REYNOLDS 31602" IN NORTH SIDE OF 48" OAK NAZ 273° 33.36'
SET NAIL AND PLASTIC TAG IN NORTHWEST SIDE OF 18" HICKORY NAZ 217° 44.18'
SET NAIL AND PLASTIC TAG IN EAST SIDE OF 30" HICKORY NAZ 341° 57.92'
SET NAIL AND PLASTIC TAG IN SOUTHWEST SIDE OF 34" OAK NAZ 134° 26.24'
C-13 IS S00°16'21"W 2650.27'
B-12 IS N89°49'54"W 2646.66'
C-11 IS N00°16'27"E, 2650.31'

P.A. 345 INGHAM COUNTY

PEER APPROVED 8/31/2004 *M*

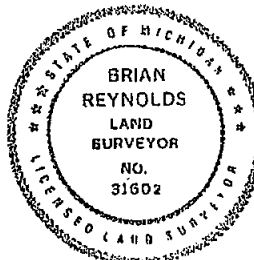

Signed by _____

Date August 30, 2004

Surveyor's Michigan License No. 31602

FORM APPROVED BY MICHIGAN STATE BOARD OF LAND SURVEYORS. JAN. 28, 1971
REVISED MAY 14, 1975 REVISED JANUARY, 1983 REVISED OCTOBER 1995

PAGE TWO

A. Description of original monument and accessories and/or subsequent restoration: T1N R1W C-12 CONTINUED

1. GENERAL LAND OFFICE DEPUTY SURVEYOR HERVEY PARKE, 1826, W. OAK 24 S87-1/2W 31
Do. 18 S60-1/2E 111
2. NOTHING ON ROAD COMMISSION WITNESS MAP
3. SURVEYS OF SEVERAL PARCELS IN SECTION 32 BY COUNTY SURVEYOR ANSON JACKSON, VARIOUS
DATES FROM 1839 THROUGH 1845, VOLUME ONE, PAGE 3, NO MENTION OF MONUMENT, WITNESSED BY
"W. OAK 24 S87-1/2W 31 LKS Do. 18 S60-1/2E 111 LKS. APPLICABLE DISTANCE RECITED INDICATES
160 RODS TO D-11. THE TRANSCRIPTION CONTAINS THE FOLLOWING EDITORIAL COMMENT, "NOTE:
THE FOREGOING SURVEYS No.36, No. 128 AND No 236 ALL BEAR RECORD ON PAGE 2 OF THE ORIGINAL
SURVEYS BY A. JACKSON IN SUBDIVISION OF SECTION 32 OF LESLIE TOWNSHIP. IT WILL ALSO BE SEEN
THAT THEY BEAR DIFFERENT DATE AND TAKEN ALTOGETHER IT IS RATHER A QUEER RECORD." THE
NOTE IS SIGNED BY JOHN MCCREARY AS COPYIST.
4. COUNTY SURVEYOR SURVEY BY ANSON JACKSON, DATED JANUARY 20, 1841, VOLUME 1, PAGE 8, NO
MONUMENT RECITED, WITNESSED BY "W. OAK 24 N72-1/4E 18 LKS Do. 17 N80-1/2E 26 LKS..."
JACKSON INDICATES A DISTANCE OF "...79R23..." (PRESUMABLY 79 RODS PLUS 23 LINKS = 1318.68
FEET) TO CORNER NORTH, SAME DISTANCE FROM THERE TO C-11.
5. COUNTY SURVEYOR SURVEY BY ANSON JACKSON, DATED FEBRUARY 17, 1848, VOLUME 1, PAGE 216,
NO MONUMENT RECITED, WITNESSED BY "W. OAK 24 S87-1/2W 31 Do. 18 S60-1/2E 111..."
JACKSON INDICATES A DISTANCE OF "...80R17..." (PRESUMABLY 80 RODS PLUS 17 LINKS = 1331.22
FEET) TO CORNER NORTH, SAME DISTANCE FROM THERE TO C-11, AND A DISTANCE OF 159 RODS 21
(LINKS) (2637.36 FEET) TO B-12.
6. A SURVEY OF THE EAST 1/2 OF THE SOUTHEAST 1/4 OF SECTION 31 BY COUNTY SURVEYOR A. JACKSON,
DATED JANUARY 20, 1841, VOLUME 1, PAGE 8. NO MONUMENT RECITED. WITNESSED BY
"W. OAK 24 S89-1/2W 31 LKS Do 18 S60-1/2E 111 LKS" DISTANCE SHOWN TO ALIQUOT
CORNER WEST 79 RODS 23 LINKS.
7. SURVEY OF SEVERAL PARCELS IN SECTION 31 BY COUNTY SURVEYOR A. JACKSON, DATED AUGUST 25,
1855, VOLUME 3, PAGE 81. SUBJECT CORNER NECESSARILY WOULD HAVE BEEN USED FOR THIS
SURVEY, BUT NO MONUMENT OR WITNESSES ARE RECITED. THE DISTANCE FROM B-12 TO 1/8 CORNER
MIDWAY TO SUBJECT C-12 IS IMPLIED AS 79 RODS 23 LINKS.
8. LAND CORNER RECORDATION CERTIFICATE LIBER 3, PAGE 367 BY RONALD W. KELLER, P.S. 20707,
RECORDED APRIL 22, 1975; PART A: BLANK. PART B: "SET 5/16" REBAR SINGLE PROPORTIONATE
MEASUREMENT". PART C: "18" OAK S45°E 36.45', 16" HICKORY S42°W 44.29', 18" HICKORY N16°W 57.33',
1' NORTH OF OLD FENCE TO WEST, NEAR CENTER LINE OF GRAVEL ROAD BED"



2004-062586
Page: 2 of 2
10/05/2004 08:11 A

SURVEY &
REMONUMENTATION

JAN 11 2005

SECTION

SURVEY & REMONUMENTATION

LAND CORNER RECORDATION CERTIFICATE
Filing Requirement of Act 74, Mich. P.A. 1970

JAN 13 2005

For Corners in
INGHAM
(county)

Located In:

Corner Code #

6-835
6-1131

SECTION

1. Public Land Survey
CORNER COMMON TO
SECTIONS 29, 30, 31 & 32
LESLIE TOWNSHIP

T 1N R 1W
T R
T R
T R

C-11

Paula Johnson
INGHAM COUNTY
REGISTER OF DEEDS
OFFICIAL SEAL



L-11 P-339

CRNR 17.00

2004-077400



2004-077400

Page: 1 of 2
12/27/2004 08:08P

2. Property Controlling S T R
In Section S T R

Register of Deeds Stamp & File Number

3. Miscellaneous S T R

4. Lot No , Recorded Plat

5. Private Claims

I, Brian Reynolds, in a field survey on August 30, 2004, do hereby certify that under requirements of P.A. 74, Michigan P.A. of 1970, the corner points mentioned in lines 1 and 2 above were in conformance with regulations and rules therefore as required in the current manual of survey instructions of the United States Department of the Interior, Bureau of Land Management or by a decree of a Court of Law and/or that the corner points mentioned in lines 3, 4, and 5 above were in conformance with the rules of the Michigan Board of Land Surveyors or by a Decree of a Court of Law; established, re-established, monumented, re-monumented, recovered, found as expressed below.

NOTE: Not more than 2 corners, all in the same town and range, may be recorded on this certificate.

A. Description of original monument and accessories and/or subsequent restoration:

SEE PAGE TWO FOR HISTORICAL SUMMARY.

B. Description of corner evidence found and/or method applied in restoring or reestablishing corner:

FOUND 1/2" IRON PIPE IN MONUMENT BOX AT APPARENT CORNER LOCATION. DID NOT EXCAVATE, AS THE CORNER RECORD BY SURVEYOR STEADMAN INDICATES THAT ANOTHER EXCAVATION WOULD BE UNNECESSARY. ACCEPTED THE METHOD FOR RESTORATION OF THE CORNER AS DESCRIBED BY STEADMAN. ACCEPTED THE FOUND 1/2" PIPE IN MONUMENT BOX AS PROPER RESTORATION OF THE CORNER POSITION. REPLACED PIPE WITH STANDARD MONUMENT AND CAP, AND WITNESSED AS DESCRIBED BELOW.

C. Description of monument for corner and accessories established to perpetuate locating the position of the corner:

WITNESSES TO STANDARD 3/4" X 24" STEEL FORM PIN WITH ALUMINUM CAP STAMPED "31602"
FOUND NAIL & TAG No. 18998 IN THE SOUTH SIDE OF A 48" OAK NAZ 54° 47.40'
FOUND NAIL & TAG No. 25832 (LARRY BRYAN, P.S.) IN THE SOUTHWEST SIDE OF A 48" OAK NAZ 323° 65.72'
FOUND NAIL & TAG No. 18998 IN THE NORTHEAST SIDE OF A 60" OAK NAZ 198° 104.74'
SET NAIL & TAG No. 31602 IN THE EAST SIDE OF AS 8" MAPLE NAZ 222° 46.80'
C-12 IS S00°15'27"W 2650.31'
B-11 IS N89°58'18"W 2655.32'
C-10 IS N00°01'45"W 2640.45'

P.A. 345 INGHAM COUNTY
PEER APPROVED: 8/31/2004 M

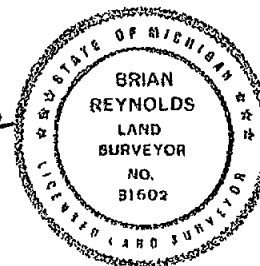

Signed by

[Signature]

Date August 30, 2004

Surveyor's Michigan License No 31602

FORM APPROVED BY MICHIGAN STATE BOARD OF LAND SURVEYORS, JAN. 28, 1971
REVISED MAY 14, 1975 REVISED JANUARY, 1983 REVISED OCTOBER 1995

SURVEY &
REMONUMENTATION



2004-077400
Page: 2 of 2
12/27/2004 08:09P

JAN 12 2005

PAGE TWO

SECTION

A. Description of original monument and accessories and/or subsequent restoration: T1N R1W C-11 CONTINUED

1. GENERAL LAND OFFICE DEPUTY SURVEYOR HERVEY PARKE, FEBRUARY 24TH, 1826, W. OAK 28 N56E 13-1/2 Do. 12 N88E 179
2. NOTHING ON ROAD COMMISSION WITNESS MAP
3. SURVEY OF TWO PARCELS IN SECTION 30 BY COUNTY SURVEYOR A. JACKSON, DATED MARCH 31, 1845, VOLUME 1, PAGE 12. SUBJECT CORNER WITNESSED BY W OAK 26 S18W 48-1/2 LKS W OAK 30 N12E 50 LKS, NO MONUMENT RECITED. THE DISTANCE TO B-11 IS SHOWN AS "160R 18 L."
4. SURVEYS OF SEVERAL PARCELS IN SECTION 32 BY COUNTY SURVEYOR ANSON JACKSON, VARIOUS DATES FROM 1839 THROUGH 1845, VOLUME ONE, PAGE 3, NO MENTION OF MONUMENT, WITNESSED BY "W. OAK 28 N56E 13-1/2 LKS Do. 12 N88E 179 LKS. APPLICABLE DISTANCE RECITED INDICATES 160 RODS TO D-11. THE TRANSCRIPTION CONTAINS THE FOLLOWING EDITORIAL COMMENT, "NOTE: THE FOREGOING SURVEYS No.38, No. 128 AND No 236 ALL BEAR RECORD ON PAGE 2 OF THE ORIGINAL SURVEYS BY A. JACKSON IN SUBDIVISION OF SECTION 32 OF LESLIE TOWNSHIP. IT WILL ALSO BE SEEN THAT THEY BEAR DIFFERENT DATE AND TAKEN ALTOGETHER IT IS RATHER A QUEER RECORD." THE NOTE IS SIGNED BY JOHN McCREARY (?) AS COPYIST.
5. SURVEY OF SEVERAL PARCELS IN SECTION 30 BY COUNTY SURVEYOR A. JACKSON, DATED APRIL 17, 1845, VOLUME 1, PAGE 13. SUBJECT CORNER WITNESSED BY "W OAK 20 N56E 13-1/2 LKS Do. 12 N88E 179 LKS." BUT NO MONUMENT RECITED. A DISTANCE TO 1/8 CORNER NORTH IS SHOWN AS "80R"
6. COUNTY SURVEYOR SURVEY BY ANSON JACKSON, DATED FEBRUARY 17, 1848, VOLUME 1, PAGE 216, NO MONUMENT RECITED, WITNESSED BY "W. OAK 28 N56E 13-1/2 Do. 12 N88E 179..." JACKSON INDICATES A DISTANCE OF "...80R17..." (PRESUMABLY 80 RODS PLUS 17 LINKS = 1331.22 FEET) TO CORNER SOUTH, SAME DISTANCE FROM THERE TO C-12.
7. SURVEY OF SEVERAL PARCELS IN SECTION 30 BY COUNTY SURVEYOR T.J. BROWN, DATED MAY 6, 1873, VOLUME 2, PAGE 98. SUBJECT CORNER NOT WITNESSED, NO MONUMENT RECITED. A DISTANCE FROM C-10 TO 1/8 CORNER BETWEEN IS SHOWN AS 20 CHAINS.
8. LAND CORNER RECORDATION CERTIFICATE LIBER 3, PAGE 367 BY RONALD W. KELLER, P.S. No. 20707, PART "A" IS BLANK; PART "B" LISTS EIGHT CORNERS. REGARDING THE SUBJECT CORNER, IT READS, "C-11 FOUND MONUMENT BOX."; PART "C" LISTS MONUMENT AND WITNESSES FOR SEVEN CORNERS, THE SUBJECT CORNER BEING OMITTED.
9. ACT 132 SURVEY BY G.A. STEADMAN & SON, INC. SIGNED BY RICHARD W. STEADMAN, P.S. 11370, LIBER 2, PAGES 90-91, RECORDED SEPTEMBER 6, 1974, "S.W. COR. SEC. 29, T1N, R1W, FOUND STONE & RAISED WITH 1/2" IRON PIPE TELEPHONE POLE EAST 46.44' 24" OAK S.E. 33.75' 22" OAK N.E. 35.11'
10. LAND CORNER RECORDATION CERTIFICATE LIBER 5, PAGE 21 BY RICHARD W. STEADMAN, P.S. No. 11370, RECORDED 10-18-1978 PART "A" READS, "ORIGINAL MONUMENT: WOOD POST BY HARVEY PARKE, U.S. DEPUTY SURVEYOR IN 1826; BEARING TREES: 28" W. OAK N55°E 13-1/2 LKS. AND 12" W. OAK N88°E 179 LKS. ACCORDING TO VOLUME 1, PAGE 12, COUNTY SURVEYOR'S RECORDS (1845), THIS CORNER WAS USED TO ESTABLISH THE 1/8 POST NEXT NORTH; ACCORDING TO VOLUME 1 PAGE 2 (1843), IT WAS USED TO SET THE 1/8 POST NEXT EAST. I FIND NO FURTHER PERTINENT INFORMATION IN THE PUBLIC RECORD." PART "B" READS, "DUG LARGE HOLE IN THE INTERSECTION OF BLACKMORE AND OLDS ROADS, BUT FOUND NOTHING BUT A BOAT SPIKE. RE-ESTABLISHED CORNER THE SAME DISTANCE SOUTH OF THE 1/8 LINE FENCE NEXT NORTH, THAT SAID FENCE IS SOUTH OF THE QUARTER NEXT NORTH; ALSO THE SAME DISTANCE WEST OF THE 1/8 LINE FENCE NEXT EAST, THAT SAID FENCE IS WEST OF THE QUARTER CORNER NEXT EAST." PART "C" READS, SET 1/2" IRON PIPE AND MONUMENT BOX TO MARK THE CORNER. WITNESSES:
N.E. CORNER CONC. HEADWALL E.S.E. 40.63 FT. N.W. CORNER CONC. HEADWALL E.N.E. 34.52 FT.
24" OAK N.E. 48.72 FT. 18" OAK N.W. 65.48 FT 38" OAK S.W. 106.99 FT.
11. FROM THE CORNER DOSSIER FOR THE INGHAM COUNTY SURVEY AND REMONUMENTATION PROJECT, TRAVERSE POINT WITNESS REPORT DATED 1-13-1978, THE SUBJECT CORNER IS TRAVERSE POINT No. 3011 WITH THE FOLLOWING DESCRIPTION: "FD. MONUMENT BOX IN N-S & E-W C/L
SURVEY TAG ON NW SIDE OF 34" OAK N45°E 48.60'
SURVEY TAG ON SW SIDE OF 30" OAK N40°W 65.29'
SURVEY TAG ON E. SIDE OF 38" OAK S30°W 106.95' ALL WITNESSES HAD RLS #11370 TAGS." THE SKETCH SHOWS THE SUBJECT CORNER LABELED "FD. MON. BOX W/ 1/2" IRON BAR & CAP."
12. ACT 132 SURVEY BY ACCOLADE, INC.. SIGNED BY RON HELSEL, P.S. 18994, LIBER 6, PAGE 1131, RECORDED APRIL 12, 1993, NO MONUMENT RECITED, WITNESSED BY: FD N & T 24" OAK, NE, 48.72' FD N & T 18" OAK, NW, 65.48' FD N & T 38" OAK, SW, 106.99' SET N & T A. POST, N45°E, 46.30'
13. ACT 132 SURVEY BY RONNIE M. LESTER, LIBER 8, PAGE 835
DATED 4-12-2001 RECITES "1" PIPE IN MONUMENT BOX
LIBER 5 PAGE 21
SET GALVANIZED OAK AND 1 1/2" ALUMINUM TAG STAMPED "PS 18994
WITNESS" IN ALL OF THE FOLLOWING:
SOUTH SIDE 36" OAK MAG AZ 58° 47.33'
SOUTHWEST SIDE 36" OAK MAG AZ 328° 03.85'
NORTHEAST SIDE 40" OAK MAG AZ 205° 104.90'
NW COR STEEL
I BEAM POST
MAG AZ 181°
125.00'

LAND CORNER RECORDATION CERTIFICATE
Filing Requirement of Act 74, Mich. P.A. 1970

SURVEY &
REMONUMENTATION

JAN 11 2005

SECTION

For Corners in
INGHAM
(county)

Located In:

Corner Code #

1. Public Land Survey
CORNER COMMON
TO SECTIONS 31 & 32
LESLIE TOWNSHIP
ON BASE LINE

T 1N R 1W
T R
T R
T R

C-13

Paula Johnson-
INGHAM COUNTY
REGISTER OF DEEDS
OFFICIAL SEAL



L-11 P-248

CRNR 14.00

2004-062687

2004-062687

Page: 1 of 1
10/05/2004 08:11 A

2. Property Controlling
in Section S T R
S T R

3. Miscellaneous S T R

4. Lot No , Recorded Plat

5. Private Claims

I, Brian Reynolds, in a field survey on JULY 13, 2004 do hereby certify that under requirements of P.A. 74, Michigan P.A. of 1970, the corner points mentioned in lines 1 and 2 above were in conformance with regulations and rules therefore as required in the current manual of survey instructions of the United States Department of the Interior, Bureau of Land Management or by a decree of a Court of Law and/or that the corner points mentioned in lines 3, 4, and 5 above were in conformance with the rules of the Michigan Board of Land Surveyors or by a Decree of a Court of Law; established, re-established, monumented, re-monumented, recovered, found as expressed below.

NOTE: Not more than 2 corners, all in the same town and range, may be recorded on this certificate.

	A	B	C	D	E	F	G	H	I	J	K	L	M
1													
2	6	5	4	3	2	1							
3													
4	7	8	9	10	11	12							
5													
6	18	17	16	15	14	13							
7													
8	19	20	21	22	23	24							
9													
10	30	29	28	27	26	25							
11													
12	31	32	33	34	35	36							
13													

A. Description of original monument and accessories and/or subsequent restoration:

1. GENERAL LAND OFFICE DEPUTY SURVEYOR JOHN MULLETT, 1825,
W.O. 15 IN. N21E 13 Do. 19 N73-1/2W 35-1/2
2. NOTHING ON ROAD COMMISSION WITNESS MAP
3. A SURVEY OF THE EAST 1/2 OF THE SOUTHEAST 1/4 OF SECTION 31 BY COUNTY SURVEYOR A. JACKSON,
DATED JANUARY 20, 1841, VOLUME 1, PAGE 8. NO MONUMENT RECITED. WITNESSED BY
"W. OAK 15 N21E 13 LKS Do 19 N73-1/2W 111 LKS" DISTANCE SHOWN TO ALIQUOT
CORNER WEST 79 RODS 23 LINKS.
4. LAND CORNER RECORDATION CERTIFICATE LIBER 3, PAGE 367 BY RONALD W. KELLER, P.S. 20707,
PART "A" IS BLANK, PART "B" SET 5-16" REBAR AT RECORDED GOVERNMENT JOG."
PART "C" "C-13 20" OAK S5°E± 41.20' C/L ROAD SIGN S15°E± 28.00'
SW COR. OF TELE BOX N70°E± 43.65' 20" OAK S5°E± 41.20'
NEAR N. EDGE OF ROAD GRAVEL 24" OAK S37W±51.00'
5. ACT 132 SURVEY BY WOLVERINE ENGINEERS & SURVEYORS, INC. SIGNED BY GEORGE M. YOUNG, P.S.
17640, LIBER 4, PAGE 1250, RECORDED JUNE 22, 1988, MONUMENT AND WITNESSES SAME AS LCRC L. 3
P. 367

B. Description of corner evidence found and/or method applied in restoring or reestablishing corner:

FOUND 1/2" X 2.4' REBAR WITH CAP No. 18657 (GLENN A. FAUSER, P.S.) AND ONE WITNESS BY KELLER, 20" OAK
S05°E 41.20'. EXCAVATED A 3' DIAMETER HOLE THROUGH 1 FOOT OF ROAD GRAVEL, THEN SAND TO 2 FEET
DEEP. WIDENED HOLE TO 3.5' DIAMETER, AT 2.8 FEET ENCOUNTERED CLAY, CONTINUED DIGGING TO A FINAL
DEPTH OF 4 FEET, PROBED LATERALLY THROUGH SAND ANOTHER 1.5 FEET, FOUND NO ADDITIONAL EVIDENCE
OF PREVIOUS MONUMENTATION. ACCEPTED FOUND IRON AS BEST AVAILABLE EVIDENCE OF CORNER
POSITION. REPLACED WITH STANDARD MONUMENT AND CAP.

C. Description of monument for corner and accessories established to perpetuate locating the position of the corner:

WITNESSES TO 3/4" X 24" FORM PIN WITH ALUMINUM CAP STAMPED "31602"
FOUND NAIL & SHINER IN THE WEST SIDE OF A 36" OAK NAZ 218° 53.38'
FOUND NAIL & BLANK SHINER IN THE NORTH SIDE OF A 30" OAK NAZ 170 40.94'
FOUND NAIL & BLANK SHINER IN THE SOUTH SIDE OF AN 8" FENCE POST NAZ 64° 44.78'
SET NAIL & PLASTIC TAG No. 31602 IN THE WEST SIDE OF A 24" OAK NAZ 37° 60.10'
ON NORTH EDGE OF GRAVEL ROAD (BASE LINE ROAD)
IN LINE WITH CENTER OF ABANDONED BLACKMORE ROAD TO THE NORTH.
C-12 IS N00°15'21"E, 2650.27' B-13 IS N89°42'33"W, 2638.07'
IRON REPRESENTING THE CORRESPONDING CLOSING CORNER N89°24'16"W 29.24'

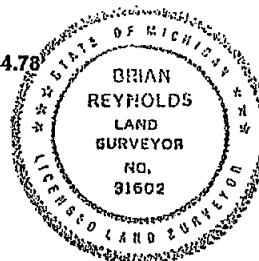

Signed by

P.A. 345 INGHAM COUNTY
PEER APPROVED 8/31/2004 PC

Date August 30, 2004

Surveyor's Michigan License No 31602

FORM APPROVED BY MICHIGAN STATE BOARD OF LAND SURVEYORS. JAN. 28, 1971

REVISED MAY 14, 1975 REVISED JANUARY, 1983 REVISED OCTOBER 1995

INGHAM COUNTY REMONUMENTATION
LAND CORNER RECORDATION CERTIFICATE

Filing Requirement of Act 74, Mich. P.A. 1970

For Corners in
INGHAM
(county)

Located In: Corner Code #

1. Public Land Survey
1/4 CORNER COMMON
TO SECTIONS 29 & 32
LESLIE TOWNSHIP

T 1N R 1W
T _____ R _____
T _____ R _____
T _____ R _____
S _____ T _____ R _____
S _____ T _____ R _____
S _____ T _____ R _____

D-11

B: 13 P: 239 08/06/2008 11:24 AM
2008-031798 LAND CORNERS Receipt #45017
Paula Johnson, Ingham County, Michigan

Pages: 2



4. Lot No _____, Recorded Plat _____
5. Private Claims _____

I, Brian Reynolds, in a field survey on APRIL 17 & 30, 2008 do hereby certify that under the requirements of P.A. 74, Michigan P.A. of 1970, the corner points mentioned in lines 1 and 2 above were in conformance with regulations and rules therefore as required in the current manual of survey instructions of the United States Department of the Interior, Bureau of Land Management or by a decree of a Court of Law and/or that the corner points mentioned in lines 3, 4, and 5 above were in conformance with the rules of the Michigan Board of Land Surveyors or by a Decree of a Court of Law; established, re-established, monumented, re-monumented, recovered, found as expressed below.

NOTE: Not more than 2 corners, in the same town and range, may be recorded on this certificate.

A. Description of original monument and accessories and/or subsequent restoration:

1826 GENERAL LAND OFFICE DEPUTY SURVEYOR HERVEY PARKE, FEBRUARY, 1826, "... EAST ON RAND. BET'N SEC'S 29 & 32 ... 80.22 INT. N & S LINE 2 LKS N OF P. WEST ON TRUE LINE ... 40.11 SET 1/4 POST AT AV. D. F/W
B. OAK 10 S3E 74-1/2 B. ASH 7 N86E 37 ..."

CORNER HISTORY CONTINUED ON PAGE TWO

	A	B	C	D	E	F	G	H	I	J	K	L	M
1													
2	6		5		4		3		2		1		
3													
4	7		8		9		10		11		12		
5													
6	18		17		16		15		14		13		
7													
8	19		20		21		22		23		24		
9													
10	30		29		28		27		26		25		
11													
12	31		32		33		34		35		36		
13													

B. Description of corner evidence found and/or method applied in restoring or reestablishing corner:

On April 17th, 2008, found two 1/2" irons side by side 3.5 feet south of the centerline of an east-west bituminous road (Olds Road). Both oak witnesses from Keller (1975) remain. All witnesses by Helsel (1992) and Lester (2001) remain. One iron was a very long rerod, the top 4 inches above the bituminous grade and bent to lie flat on the road surface. The other iron was an uncapped 18" x 1/2" smoothbar. Removed the 18" iron, excavated around the rerod. After excavating through 8 inches of bituminous roadway, we were able to twist and turn the iron, and slowly extract it from the gravel subgrade. At the point that about 2 feet of the iron was above grade, the iron could not be raised any further, nor could it be driven back. Broke the iron off below road grade, left and returned April 30th to excavate wider and deeper. Ultimately removed the entire 1/2" iron rerod which was 36" long. That rerod in turn was found to be inside a 3/4" by 36" iron pipe. Excavated further, found no other evidence of corner monumentation. Accepted the long rerod inside the long iron pipe as representing the true corner position. Removed the pipe, replaced it with a standard 3/4" by 24" form pin monument with Ingham County aluminum cap, installed monument box, witnessed as described below.

C. Description of monument for corner and accessories established to perpetuate locating the position of the corner:

WITNESSES TO 3/4" X 24" FORM PIN MONUMENT WITH AN
INGHAM COUNTY ALUMINUM CAP IN A MONUMENT BOX

FOUND NAIL & "KEBS" TAG IN THE WEST SIDE OF A 32" OAK SOUTH 29.28 FEET

FOUND NAIL & "18998" TAG IN THE SOUTH SIDE OF A 36" OAK N70°W 70.42 FEET

FOUND NAIL & "18998" TAG IN THE WEST SIDE OF AN 8" HICKORY N5°W 29.78 FEET

FOUND PK NAIL IN THE WEST SIDE OF A 6" POST NORTH 28.90 FEET

FOUND NAIL & TAG No. 18998 IN THE SOUTH SIDE OF A 32" OAK N79°E 117.86 FEET

TO C-11 IS WESTERLY 2655.95 FEET TO E-11 IS EASTERLY 2657.11 FEET

TO D-12 IS SOUTHERLY 2654.29 FEET 3.5± FEET SOUTH OF PHYSICAL ROAD CENTERLINE

NOTE: "KEBS" = KYES ENGINEERING - BRYAN SURVEYING, INC.

P.A. 345 INGHAM COUNTY
PEER APPROVED 6/3/2008 RL

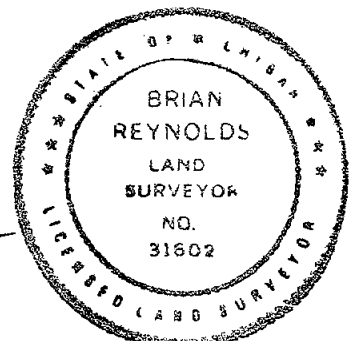

Signed by [Signature]
Surveyor's Michigan License No 31602

Date JUNE 5, 2008

FORM APPROVED BY MICHIGAN STATE BOARD OF LAND SURVEYORS. JAN. 28, 1971

REVISED MAY 14, 1975 REVISED JANUARY, 1983 REVISED OCTOBER 1995

PAGE TWO

A. Description of original monument and accessories and/or subsequent restoration: T1N R1W D-11 CONTINUED

- 1839-1843 ON PAGE 3 OF BOOK 4-A IS A COMPILATION OF THREE SURVEYS, EACH OF AN 80-ACRE ALIQUOT PART OF SECTION 32, BY COUNTY SURVEYOR ANSON JACKSON, LISTED AS SURVEYS No. 36, No. 128, AND No. 263. NO MONUMENT OR WITNESSES ARE DESCRIBED FOR THE SUBJECT CORNER. HOWEVER, ON THE SURVEY LABELED "No. 36" A DISTANCE IS SHOWN NORTH FROM CORNER D-12, 80 (RODS) 3 (LINKS), IMPLYING A DISTANCE FROM D-12 TO D-11 OF 40 CHAINS - 6 LINKS (2643.96 FEET). ALSO, ON THE SURVEY LABELED "No. 263" THE DISTANCE EAST FROM C-11 IS SHOWN AS 80 RODS, IMPLYING A DISTANCE FROM C-11 TO D-11 OF 2640 FEET. BOTH OF THESE RECORDS IMPLY THAT JACKSON FOUND AND MEASURED TO SUBJECT CORNER D-11. A NOTE ADDENDUM BY COPYIST JOHN McCREARY READS, "... THE FOREGOING SURVEYS ... ALL BEAR RECORD ON PAGE 2 OF THE ORIGINAL SURVEYS BY A. JACKSON IN SUBDIVISION OF SECTION 32 OF LESLIE TOWNSHIP. IT WILL BE SEEN THAT THEY BEAR DIFFERENT DATE AND TAKEN ALTOGETHER IT IS A RATHER QUEER RECORD. ..."
- 1845 MARCH 31 A SURVEY OF MOST OF THE SOUTHEAST 1/4 OF SECTION 29 BY COUNTY SURVEYOR ANSON JACKSON RECORDED IN VOLUME 1 ON PAGE 12, THE SUBJECT CORNER IS WITNESSED BY, "... B. OAK 10 S3E 94-1/2 LKS B. ASH 7 N8E 51 LKS ..." MONUMENT NOT DESCRIBED. JACKSON SHOWS A DISTANCE TO THE MID-POINT TOWARD E-11 OF 80 RODS 9 LINKS (IMPLIED DISTANCE TO E-11 = 2651.88 FEET).
- 1906 IN A SURVEY OF MOST OF THE NORTH 1/2 OF SECTION 29 BY COUNTY SURVEYOR ANSON JACKSON, DATED MAY 28TH 1859, RECORDED IN VOLUME 1 ON PAGE 5, JACKSON MAKES NO MENTION OF THE SUBJECT CORNER. A MARGINAL NOTE READS, "... 12, 27, 13, 22, 26, 23, REMARKED 1906. 26 AND 27 DETERMINED BY DIVIDING DISTANCES PROPORTIONATELY. MEECH ..." ON THE PLAT, THE SUBJECT CORNER IS LABELED "23", CORNER E-11 IS LABELED "21", THE CORNER MIDWAY BETWEEN THE IS LABELED "22". THE PLAT IS ALTERED TO SHOW A DISTANCE FROM D-11 TO E-11 OF "... 161- 5-1/2 FT ..." PRESUMABLY 161 RODS, 5-1/2 FEET = 2662 FEET. CORNER DESCRIPTION FOR THE SUBJECT CORNER D-11 IS ALTERED TO READ, "... STONE ..." THE POINT "26", NOT A USUAL POINT ON THE SECTION PLAT GRID, IS SHOWN THE NOMINAL 660 FEET EAST OF THE SUBJECT CORNER, AND IS ALSO LABELED "... STONE ..."
- 1954 NOTES FROM THE SURVEY IN ANTICIPATION OF THE US-127 FREEWAY, PROJECT 33-79, SURVEYED FROM OCTOBER 1954 TO APRIL 1955, F. HOLMES, PARTY CHIEF. "WIT TO 1/4 COR. 29-32
MSHD TAG - 12" W. CHERRY - N - 31.11' MSHD TAG - 12" OAK - S - 27.56'
MSHD TAG - 37" ELM - S42°W - 47.82' FROM THE SUBJECT CORNER, THE SKETCH SHOWS EASTERLY 2590.81 FEET ALONG SECTION LINE TO THE SURVEY CENTERLINE, THEN ANOTHER 67.06 FEET TO CORNER E-11, WHICH IS ALSO WITNESSED. MONUMENT NOT RECITED FOR EITHER CORNER.
- UNDATED FROM THE INGHAM COUNTY ROAD COMMISSION CORNER WITNESS SHEET, "... 3/4" PIPE
12" CHERRY N. 31.11' 12" OAK S. 29.56' 37" ELM S.W. 47.82' ..."
- 1975 LAND CORNER RECORDATION CERTIFICATE RECORDED APRIL 22, 1975 IN LIBER 3, PAGE 367 BY RONALD W. KELLER, P.S. No. 20707, PART A IS BLANK, PART B READS, "... D-11 FOUND 1" PIPE BELOW BLACKTOP, BROUGHT TO SURFACE WITH 5/8" REBAR ..." PART C READS, "... D-11 ON LINE WITH N-S FENCE 2' SOUTH OF BLACKTOP C/L 10" OAK N80W± 71.22' 18" OAK SOUTH 29.20' FEN. COR. POST NORTH 29.80' ..."
- 1978 TRAVERSE POINT WITNESS REPORT FROM THE FORMER INGHAM COUNTY SURVEY AND REMONUMENTATION PROJECT, L. BRYAN AS TECH. SUP'R, "... FD. 5/16 REROD BENT OVER AT TOP, 2.51' S. OF C/L OF RD. ...
1) PK NAIL ON W. SIDE OF 24" OAK DUE SOUTH 29.15' 2) PK NAIL ON S. SIDE OF 30" OAK N45°W 71.18'
3) PK NAIL ON W. SIDE OF ROUND WOODEN CORNER POST DUE NORTH 28.79' ..."
- 1979 ACT 132 SURVEY BY FAUSER & KELLER, INC., SIGNED AND SEALED BY RONALD W. KELLER, P.S. No. 20707, RECORDED SEPTEMBER 13, 1979 IN LIBER 3 OF SURVEYS, PAGES 1027-1029, "... N 1/4 POST SECTION 32 ..." NOT FURTHER DESCRIBED. DISTANCE TO E-11 SHOWN AS 2657.51 FEET.
- 1985 SEPTEMBER 30 ACT 132 SURVEY BY POLARIS SURVEYING CO., SIGNED AND SEALED BY RONNIE M. LESTER, P.S. No. 18998, RECORDED OCTOBER 7, 1985 IN LIBER 4 OF SURVEYS ON PAGE 1107-1108, DRAWING SHOWS CORNER AS "... SOUTH 1/4 COR., SEC. 29, T1N, R1W ..." WITNESSED AS, "... SOUTH 1/4 CORNER SECTION 29, T1N, R1W LIBER 3, PAGE 367
NAIL AND TAG ON SOUTH SIDE 40" OAK, W.N.W. 70.65' NAIL AND TAG ON S.W. SIDE 12" ELM, N.W. 43.54'
NAIL AND TAG ON WEST SIDE FENCEPOST, NORTH 28.84'
NAIL AND TAG ON WEST SIDE 24" OAK, SOUTH 29.56' ..."
- 1989 OCTOBER 17 ACT 132 SURVEY BY ACCOLADE, INC., SIGNED AND SEALED BY RON HELSEL, P.S. No. 18994, RECORDED NOVEMBER 20, 1990 IN LIBER 6 OF SURVEYS, PAGE 522, "... N 1/4 CORNER SECTION 32 T1N R1W INGHAM COUNTY MICHIGAN L.3, P.367 ..." NOT FURTHER DESCRIBED.
- 1992 AUGUST 12 TWO ACT 132 SURVEYS BY ACCOLADE, INC., SIGNED AND SEALED BY RON HELSEL, P.S. No. 18994, RECORDED APRIL 12, 1993 IN LIBER 6 OF SURVEYS, PAGE 1131 AND PAGE 1135, "... SOUTH 1/4 CORNER SECTION 29 T1N, R1W L.3, P.367 ..." MONUMENT AND WITNESSES DESCRIBED AS, "... FD. 1/2" REBAR 2' SOUTH OF C/L OF OLDS RD. FD. N & T 22" OAK, N80°W, 71.22'
FD. N & T 18" OAK, SOUTH, 29.20' FD. N & T A. POST, NORTH, 29.80'
SET N & T 28" OAK, N85°E, 117.89'
- 2001 APRIL 12 ACT 132 SURVEY BY POLARIS SURVEYING CO., SIGNED AND SEALED BY RONNIE M. LESTER, P.S. No. 18998, DRAWING SHOWS CORNER AS "... SOUTH 1/4 CORNER SECTION 29, T1N, R1W 1/2" BAR. LIBER 3, PAGE 367 ..." WITNESSES DESCRIBE CORNER AS, "... SOUTH 1/4 CORNER SECTION 29, T1N, R1W 1/2" BAR. LIBER 3, PAGE 367 SET GALVANIZED NAIL AND 1-1/2" ALUMINUM TAG STAMPED 'PS 18998 WITNESS' WEST SIDE 10" SHAGBARK MAG. AZ 355°, 29.79'
SET GALVANIZED NAIL AND 1-1/2" ALUMINUM TAG STAMPED 'PS 18998 WITNESS' SOUTH SIDE 40" OAK MAG. AZ 294°, 70.48'
SET GALVANIZED NAIL AND 1-1/2" ALUMINUM TAG STAMPED 'PS 18998 WITNESS' SOUTH SIDE 36" OAK MAG. AZ 83°, 117.90'
SET GALVANIZED NAIL AND 1-1/2" ALUMINUM TAG STAMPED 'PS 18998 WITNESS' WEST SIDE 30" OAK MAG. AZ 186°, 29.57' ..."
DRAWING SHOWS 2655.88 FEET TO C-11

INGHAM COUNTY REMONUMENTATION
LAND CORNER RECORDATION CERTIFICATE
Filing Requirement of Act 74, Mich. P.A. 1970

For Corners in
INGHAM
(county)

Located In: Corner Code #

1. Public Land Survey
CENTER 1/4 CORNER
SECTION 32
LESLIE TOWNSHIP

T 1N R 1W

D-12

2. Property Controlling
in Section

S T R

3. Miscellaneous

S T R

4. Lot No , Recorded Plat

5. Private Claims

B: 13 P: 238 08/06/2008 11:24 AM
2008-031797 LAND CORNERS Receipt #45017
Paula Johnson, Ingham County, Michigan

Pages: 2



	A	B	C	D	E	F	G	H	I	J	K	L	M
1													
2	6		5		4		3		2		1		
3													
4	7		8		9		10		11		12		
5													
6	18		17		16		15		14		13		
7													
8	19		20		21		22		23		24		
9													
10	30		29		28		27		26		25		
11													
12	31		32		33		34		35		36		
13													

I, Brian Reynolds, in a field survey on APRIL 17, 2008 do hereby certify that under the requirements of P.A. 74, Michigan P.A. of 1970, the corner points mentioned in lines 1 and 2 above were in conformance with regulations and rules therefore as required in the current manual of survey instructions of the United States Department of the Interior, Bureau of Land Management or by a decree of a Court of Law and/or that the corner points mentioned in lines 3, 4, and 5 above were in conformance with the rules of the Michigan Board of Land Surveyors or by a Decree of a Court of Law; established, re-established, monumented, re-monumented, recovered, found as expressed below.

NOTE: Not more than 2 corners, in the same town and range, may be recorded on this certificate.

A. Description of original monument and accessories and/or subsequent restoration:

CENTER OF SECTION NOT MONUMENTED BY THE GENERAL LAND OFFICE SURVEY

CORNER HISTORY CONTINUED ON PAGE TWO

B. Description of corner evidence found and/or method applied in restoring or reestablishing corner:

Found an 8" x 2-1/2" x 20" stone with a 1-1/4" x 24" plastic coated pipe on the south side of the stone in a 4-way fence corner. Accepted found stone as a proper perpetuation of the corner position originally monumented by County Surveyor Anson Jackson. Replaced stone with a standard 3" x 24" steel form pin monument with aluminum Ingham County cap stamped "31602", witnessed as described below. Traversed all of Section 32, found the remonumented position to be 4.74 feet south of a direct line between C-12 and E-12, and 7.73 feet west of a direct line between D-11 and D-13.

C. Description of monument for corner and accessories established to perpetuate locating the position of the corner:

WITNESSES TO 3/4" X 24" STEEL FORM PIN MONUMENT WITH AN
INGHAM COUNTY ALUMINUM CAP STAMPED "31602"

SET MAG NAIL AND REMON TAG IN THE NORTH SIDE OF A 12" SASSAFRASS WEST 2.59 FEET
SET MAG NAIL AND REMON TAG IN THE SOUTHWEST SIDE OF A 10" CHERRY S20°E 9.10 FEET
SET MAG NAIL AND REMON TAG IN THE WEST SIDE OF A 12" SASSAFRASS N09°E 12.85 FEET
SET MAG NAIL AND REMON TAG IN THE SOUTH SIDE OF A 24" CHERRY EAST 9.55 FEET
TO C-12 IS WESTERLY 2647.64 FEET TO E-12 IS EASTERLY 2668.60 FEET
TO D-11 IS NORTHERLY 2654.29 FEET TO D-13 IS SOUTHERLY 2645.67 FEET
FENCES NORTH, SOUTH, EAST & WEST

NOTE: MAG NAIL & REMON TAG = MAGNETIC NAIL & 1-1/2" ALUMINUM TAG STAMPED "INGHAM PA 345 WITNESS"

P.A. 345 INGHAM COUNTY
PEER APPROVED 6/3/2008 RL

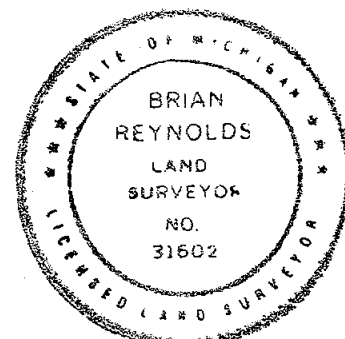

Signed by Brian Reynolds
Surveyor's Michigan License No 31602

Date JUNE 5, 2008

FORM APPROVED BY MICHIGAN STATE BOARD OF LAND SURVEYORS. JAN. 28, 1971
REVISED MAY 14, 1975 REVISED JANUARY, 1983 REVISED OCTOBER 1995

PAGE TWO

A. Description of original monument and accessories and/or subsequent restoration: T1N R1W D-12 CONTINUED

1839-1843 ON PAGE 3 OF BOOK 4-A IS A COMPILATION OF THREE SURVEYS, EACH OF AN 80-ACRE ALIQUOT PART OF SECTION 32, BY COUNTY SURVEYOR ANSON JACKSON, LISTED AS SURVEYS No. 36, No. 128, AND No. 263. NO MONUMENT IS LISTED. HOWEVER, IDENTICAL WITNESSES ARE DESCRIBED FOR THE SUBJECT CORNER FROM BOTH SURVEYS No. 36 AND 128, "... W OAK 18 S36W 10 LKS W. OAK 22 S56W 51 LKS. ..." ON THE SURVEY LABELED "No. 36" A DISTANCE IS SHOWN NORTH FROM THE SUBJECT CORNER D-12, 80 (RODS) 3 (LINKS), IMPLYING A DISTANCE FROM D-12 TO D-11 OF 40 CHAINS - 6 LINKS (2643.96 FEET) TO D-11. ALSO, ON THE SURVEY LABELED "No. 128" A DISTANCES IS SHOWN SOUTH OF 79 (RODS) 24 (LINKS), IMPLYING A DISTANCE OF 159 RODS 23 LINKS (2638.68 FEET). ALSO, ON THE SURVEY LABELED "No 263" THE DISTANCE EAST FROM C-12 IS SHOWN AS 79 (RODS) 20 (LINKS), IMPLYING A DISTANCE FROM C-12 TO D-12 OF IMPLYING A DISTANCE FROM C-12 OF 2633.40 FEET. ALL OF THESE RECORDS IMPLY THAT JACKSON MONUMENTED AND MEASURED TO SUBJECT CORNER D-12. A NOTE ADDENDUM BY COPYIST JOHN McCREARY READS, "... THE FOREGOING SURVEYS ... ALL BEAR RECORD ON PAGE 2 OF THE ORIGINAL SURVEYS BY A. JACKSON IN SUBDIVISION OF SECTION 32 OF LESLIE TOWNSHIP. IT WILL BE SEEN THAT THEY BEAR DIFFERENT DATE AND TAKEN ALTOGETHER IT IS A RATHER QUEER RECORD. ..."

UNDATED FROM THE INGHAM COUNTY ROAD COMMISSION CORNER WITNESS SHEET, "... INTERSECTION OF FENCES ..."

1998 AUGUST 20 PRIVATE NOTES BY DAVID L. CLIFFORD, P.S. No. 25837, ENGER SURVEYING & ENGINEERING, "...D-12 FD 8" X 2" X 24" STONE @ 4 WAY FEN SET 1/2" PIPE @ S. SIDE
N&T 25837 S. SIDE 10" WALNUT WEST 2.8' N&T 25837 W. SIDE 14" WALNUT N9°E 13.0'
N&T 25837 W. SIDE 22" WALNUT S39°E 20.2' N&T 25837 E. SIDE 6" WALNUT S41°W 16.45' ..."
THE DRAWING FROM THAT SURVEY, SIGNED AND SEALED BY RONALD L. ENGER, P.S. No. 28409, RECORDED IN LIBER 8 OF SURVEYS ON PAGE 857, SHOWS N89°43'34"E 2668.61 TO E-12, WITNESSES SAME AS IN THE NOTES.

INGHAM COUNTY REMONUMENTATION
LAND CORNER RECORDATION CERTIFICATE
Filing Requirement of Act 74, Mich. P.A. 1970

For Corners in
INGHAM
(county)

Located In: Corner Code #

1. Public Land Survey
STANDARD 1/4 CORNER
SECTION 32 ON BASE LINE
LESLIE TOWNSHIP

T 1N R 1W D-13

2. Property Controlling
in Section

S T R
S T R

3. Miscellaneous

S T R

4. Lot No , Recorded Plat

5. Private Claims

B: 13 P: 237 08/06/2008 11:24 AM
2008-031796 LAND CORNERS Receipt #45017
Paula Johnson, Ingham County, Michigan

Pages: 1



I, Brian Reynolds, in a field survey on APRIL 21, 2008 do hereby certify that under the requirements of P.A. 74, Michigan P.A. of 1970, the corner points mentioned in lines 1 and 2 above were in conformance with regulations and rules therefore as required in the current manual of survey instructions of the United States Department of the Interior, Bureau of Land Management or by a decree of a Court of Law and/or that the corner points mentioned in lines 3, 4, and 5 above were in conformance with the rules of the Michigan Board of Land Surveyors or by a Decree of a Court of Law, established, re-established, monumented, re-monumented, recovered, found as expressed below.

NOTE: Not more than 2 corners, in the same town and range, may be recorded on this certificate.

A. Description of original monument and accessories and/or subsequent restoration:

1824 GENERAL LAND OFFICE DEPUTY SURVEYOR JOHN MULLETT, JANUARY 21, 1824, "... WEST ON SOUTH B'DY SEC. 32
... 40.00 SET 1/4 SEC. POST F/W W. O. 38 N87-1/2W 54 Do. 38 N44E 138 ..."

1839-1843 ON PAGE 3 OF BOOK 4-A IS A COMPILATION OF THREE SURVEYS, EACH OF AN 80-ACRE ALIQUOT PART OF SECTION 32, BY COUNTY SURVEYOR ANSON JACKSON, LISTED AS SURVEYS No. 36, No. 128, AND No. 263. NO MONUMENT OR WITNESSES ARE DESCRIBED FOR THE SUBJECT CORNER. HOWEVER, ON THE SURVEY LABELED "No. 128" A DISTANCE IS SHOWN NORTH FROM CORNER D-12, 79 (RODS) 24 (LINKS), IMPLYING A DISTANCE FROM D-12 TO D-13 OF 39 CHAINS - 90 LINKS (2633.80 FEET). THIS RECORD IMPLIES THAT JACKSON FOUND AND MEASURED TO SUBJECT CORNER D-13. A NOTE ADDENDUM BY COPYIST JOHN McCREARY READS, "... THE FOREGOING SURVEYS ... ALL BEAR RECORD ON PAGE 2 OF THE ORIGINAL SURVEYS BY A. JACKSON IN SUBDIVISION OF SECTION 32 OF LESLIE TOWNSHIP. IT WILL BE SEEN THAT THEY BEAR DIFFERENT DATE AND TAKEN ALTOGETHER IT IS A RATHER QUEER RECORD. ..."

1975 LAND CORNER RECORDATION CERTIFICATE, LIBER 3, PAGE 367, RECORDED APRIL 22, 1975 BY RONALD W. KELLER, P.S. No. 20707, PART A IS BLANK, PART B READS, "... D-13 SET 5/16" REBAR SINGLE PROPORTIONATE MEASUREMENT..." PART C READS, "... D-13 16" HICK S70E 45.30' 18" OAK N20W 37.20' 12" HICK N45W 20.57' 36" OAK NORTH 15.25' IN LINE WITH FENCE TO NORTH NEAR N. EDGE OF ROAD GRAVEL ..."

B. Description of corner evidence found and/or method applied in restoring or reestablishing corner:

Found 1/2" iron, cap illegible. Oak witness north remains from Keller (1975), all other witnesses gone. Excavated around the iron, found it to be 36" long. Excavated a hole 2 feet wide to a depth of 3.5 feet. At 2 feet below grade, encountered hard clay. At 3.5 feet deep, encountered water table, could dig no further. Traverse confirmed that found iron is less than 0.5 feet from the mid-point between adjacent standard corners. Accepted found iron as representing the true corner position. Refilled hole and replaced found iron with standard 3/4" x 24" steel form pin monument with Ingham County aluminum cap stamped "31602" (top of cap approximately 6 inches below gravel grade), witnessed as described below.

C. Description of monument for corner and accessories established to perpetuate locating the position of the corner:

WITNESSES TO 3/4" X 24" FORM PIN MONUMENT WITH A INGHAM COUNTY ALUMINUM CAP
FOUND NAIL & ACCOLADE TAG IN THE NORTHEAST SIDE OF A 34" HICKORY S20°W 37.04 FEET
SET MAG NAIL & REMON TAG IN THE SOUTHWEST SIDE OF A 14" HICKORY S40°E 44.99 FEET
SET MAG NAIL & REMON TAG IN THE EAST SIDE OF A 60" OAK NORTH 15.15 FEET
SET MAG NAIL & REMON TAG IN THE NORTHEAST SIDE OF A 12" HICKORY N40°W 20.70 FEET
CENTERLINE OF EAST-WEST GRAVEL ROAD (BASE LINE ROAD) SOUTH 6 ± FEET
TO C-13 IS WESTERLY 2654.72 FEET TO E-13 IS EASTERLY 2655.48 FEET
TO D-12 IS NORTHERLY 2645.67 FEET IN LINE WITH OLD FENCE NORTH
MAG NAIL & REMON TAG = MAGNETIC NAIL AND 1-1/2" ALUMINUM TAG STAMPED "INGHAM P.A. 345 WITNESS"

P.A. 345 INGHAM COUNTY
PEER APPROVED 6/3/2008 M

Signed by Brian Reynolds
Surveyor's Michigan License No. 31602

Date JUNE 3, 2008

FORM APPROVED BY MICHIGAN STATE BOARD OF LAND SURVEYORS, JAN 20, 1971

REVISED MAY 14, 1975 REVISED JANUARY, 1983 REVISED OCTOBER 1995

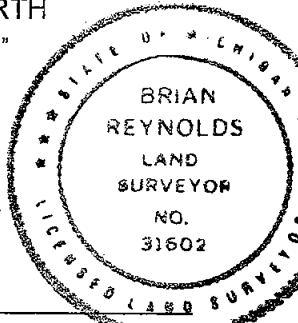

INGHAM COUNTY REMONUMENTATION
LAND CORNER RECORDATION CERTIFICATE

Filing Requirement of Act 74, Mich. P.A. 1970

For Corners in
INGHAM
(county)

Located In: Corner Code #

1. Public Land Survey
CORNER COMMON TO
SECTIONS 28, 29, 32 & 33
LESLIE TOWNSHIP

T 1N R 1W E-11

2. Property Controlling
in Section

S T R

3. Miscellaneous

S T R

4. Lot No , Recorded Plat

5. Private Claims

B: 13 P: 236 08/06/2008 11:24 AM
2008-031795 LAND CORNERS Receipt #45017
Paula Johnson, Ingham County, Michigan

Pages: 2



er

I, Brian Reynolds, in a field survey on APRIL 17, 2008 do hereby certify that under the requirements of P.A. 74, Michigan P.A. of 1970, the corner points mentioned in lines 1 and 2 above were in conformance with regulations and rules therefore as required in the current manual of survey instructions of the United States Department of the Interior, Bureau of Land Management or by a decree of a Court of Law and/or that the corner points mentioned in lines 3, 4, and 5 above were in conformance with the rules of the Michigan Board of Land Surveyors or by a Decree of a Court of Law; established, re-established, monumented, re-monumented, recovered, found as expressed below.

NOTE: Not more than 2 corners, in the same town and range, may be recorded on this certificate.

	A	B	C	D	E	F	G	H	I	J	K	L	M
1													
2		6		5		4		3		2		1	
3													
4		7		8		9		10		11		12	
5													
6		18		17		16		15		14		13	
7													
8		19		20		21		22		23		24	
9													
10		30		29		28		27		26		25	
11													
12		31		32		33		34		35		36	
13													

A. Description of original monument and accessories and/or subsequent restoration:

1826 GENERAL LAND OFFICE DEPUTY SURVEYOR HERVEY PARKE, FEBRUARY, 1826, "... NORTH BETWEEN SEC'S 32 & 33 80.00 SET POST COR SEC'S 28, 29, 32, & 33 W. OAK 26 S18W 48-1/2 Do. 30 N12E 50 ..."

CORNER HISTORY CONTINUED ON PAGE TWO

B. Description of corner evidence found and/or method applied in restoring or reestablishing corner:

Found a boat spike 1.5 feet below grade in a monument box on the bituminous shoulder of the southbound lanes of the US-127 freeway, 2± feet east of the west edge of the bituminous shoulder. The guard rail post and culvert abutment recited by surveyors Keller, Fauser, and Helsel are all missing. Excavated through the monument box to 2± feet, found no further evidence of prior monumentation. Highway construction has almost certainly destroyed any monumentation from before c. 1956. Accepted the found boat spike as representing the true corner position. Replaced the boat spike with a standard Ingham County monument and cap, witnessed as described below.

C. Description of monument for corner and accessories established to perpetuate locating the position of the corner:

WITNESSES TO 3/4" X 24" STEEL FORM PIN MONUMENT WITH AN
INGHAM COUNTY ALUMINUM CAP STAMPED "31602" IN A MONUMENT BOX
FOUND NAIL & TAG No. 18998 IN THE SOUTHEAST SIDE OF A TRIPLE POPLAR S15°W 88.90 FEET
SET MAG NAIL AND REMON TAG IN THE NORTH SIDE OF A 12" POPLAR S51°W 66.90 FEET
SET MAG NAIL AND REMON TAG IN THE NORTH SIDE OF A 6" X 8" GUARD RAIL POST S74°W 79.22 FEET
SET MAG NAIL AND REMON TAG IN THE SOUTH SIDE OF A 6" X 8" GUARD RAIL POST N65°W 90.32 FEET
SET MAG NAIL AND REMON TAG IN THE EAST SIDE OF A 6" POPLAR CLUSTER N34°W 110.48 FEET
TO D-11 IS WESTERLY 2657.11 FEET TO E-12 IS SOUTHERLY 2653.08 FEET
3.5± FEET SOUTH OF PROJECTED CENTERLINE OF OLDS ROAD TO THE WEST
CORNER IS LOCATED IN THE BITUMINOUS PAVED SHOULDER ON THE WEST SIDE OF THE
SOUTHBOUND LANES OF THE US-127 FREEWAY.

NOTE: MAG NAIL & REMON TAG = MAGNETIC NAIL & 1-1/2" ALUMINUM TAG STAMPED "INGHAM PA 345 WITNESS"

NOTE: P.S. No. 18998 is Ronnie M. Lester, P.S.

P.A. 345 INGHAM COUNTY
PEER APPROVED 6/03/2008 M

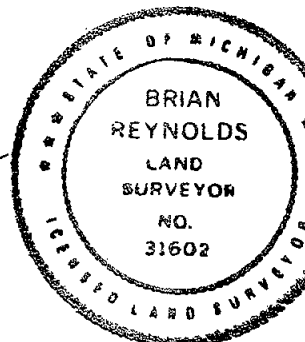

Signed by Brian Reynolds
Surveyor's Michigan License No. 31602

Date JUNE 5, 2008

FORM APPROVED BY MICHIGAN STATE BOARD OF LAND SURVEYORS. JAN. 28, 1971

REVISED MAY 14, 1975 REVISED JANUARY, 1983 REVISED OCTOBER 1995

A. Description of original monument and accessories and/or subsequent restoration: T1N R1W E-11 CONTINUED

- 1839-1843 ON PAGE 3 OF COUNTY SURVEYOR VOLUME 1 IS A COMPILATION OF THREE SURVEYS, EACH OF AN 80-ACRE ALIQUOT PART OF SECTION 32, BY COUNTY SURVEYOR ANSON JACKSON, LISTED AS SURVEYS No. 36, No. 128, AND No. 263. NO MONUMENT OR WITNESSES ARE DESCRIBED FOR THE SUBJECT CORNER. HOWEVER, ON THE SURVEY LABELED "No. 36" A DISTANCE IS SHOWN NORTH FROM CORNER E-12, 80 (RODS) 7 (LINKS), IMPLYING A DISTANCE FROM D-12 TO D-11 OF 40 CHAINS - 14 LINKS (2649.24 FEET). THIS RECORD IMPLIES THAT JACKSON FOUND AND MEASURED TO SUBJECT CORNER E-11. A NOTE ADDENDUM BY COPYIST JOHN McCREARY READS, "... THE FOREGOING SURVEYS ... ALL BEAR RECORD ON PAGE 2 OF THE ORIGINAL SURVEYS BY A. JACKSON IN SUBDIVISION OF SECTION 32 OF LESLIE TOWNSHIP. IT WILL BE SEEN THAT THEY BEAR DIFFERENT DATE AND TAKEN ALTOGETHER IT IS A RATHER QUEER RECORD. ..."
- 1839 MARCH 6-7 A SECTION BREAKDOWN OF MOST OF SECTION 33 BY COUNTY SURVEYOR ANSON JACKSON RECORDED IN VOLUME 1 ON PAGE 4, THE SUBJECT CORNER IS WITNESSED BY, "... W. OAK 26 S18W 48-1/2 LKS Do. 30 N12E 50 LKS ..." MONUMENT NOT DESCRIBED. JACKSON SHOWS A DISTANCE TO THE MID-POINT TOWARD F-11 OF 80 RODS 5-1/2 LINKS (IMPLIED DISTANCE TO F-11 = 2647.26 FEET) AND A DISTANCE TO E-12 OF 160 RODS 14 LINKS (2649.24 FEET).
- 1845 MARCH 31 A SURVEY OF MOST OF THE SOUTHEAST 1/4 OF SECTION 29 BY COUNTY SURVEYOR ANSON JACKSON RECORDED IN VOLUME 1 ON PAGE 12, THE SUBJECT CORNER IS WITNESSED BY, "... B. OAK 10 S3E 94-1/2 LKS B. ASH 7 N8E 51 LKS ..." MONUMENT NOT DESCRIBED. JACKSON SHOWS A DISTANCE TO THE MID-POINT TOWARD D-11 OF 80 RODS 9 LINKS (IMPLIED DISTANCE TO D-11 = 2651.88 FEET).
- 1906 IN A SURVEY OF MOST OF THE NORTH 1/2 OF SECTION 29 BY COUNTY SURVEYOR ANSON JACKSON, DATED MAY 28TH 1859, RECORDED IN VOLUME 1 ON PAGE 5, JACKSON MAKES NO MENTION OF THE SUBJECT CORNER. A MARGINAL NOTE READS, "... 12, 27, 13, 22, 26, 23, REMARKED 1906. 26 AND 27 DETERMINED BY DIVIDING DISTANCES PROPORTIONATELY. MEECH ..." ON THE PLAT, THE SUBJECT CORNER IS LABELED "21", CORNER D-11 IS LABELED "23", THE CORNER MIDWAY BETWEEN THEM IS LABELED "22". THE PLAT IS ALTERED TO SHOW A DISTANCE FROM D-11 TO E-11 OF "... 161- 5-1/2 FT ..." PRESUMABLY 161 RODS, 5-1/2 FEET = 2662 FEET. CORNER DESCRIPTION FOR THE SUBJECT CORNER E-11 IS ALTERED TO READ, "... IRON IN HIGHWAY ..."
- UNDATED FROM THE INGHAM COUNTY ROAD COMMISSION CORNER WITNESS SHEET, "... 1" PIPE
26" ELM E.N.E. 54.40' 36" OAK S.S.E. 80.37' GUY POLE N.W. 46.83' P.P. S.W. 47.6' ..."
- 1954 NOTES FROM THE SURVEY IN ANTICIPATION OF THE US-127 FREEWAY, PROJECT 33-79, SURVEYED FROM OCTOBER 1954 TO APRIL 1955, F. HOLMES, PARTY CHIEF. "WIT TO SEC. COR. 29-28-32-33
MSHD TAG - ELM - ENE - 54.40' MSHD TAG - OAK - SSE - 80.37'
MSHD TAG - GUY POLE - NW - 46.83' MSHD TAG - P. POLE - SW - 47.60' ..." FROM THE SUBJECT CORNER, THE SKETCH SHOWS 67.06 FEET EASTERLY ALONG THE SECTION LINE TO THE SURVEY CENTERLINE, AND WESTERLY 2590.81 FEET TO CORNER D-11, WHICH IS ALSO WITNESSED. MONUMENT NOT RECITED FOR EITHER CORNER.
- 1975 LAND CORNER RECORDATION CERTIFICATE RECORDED APRIL 22, 1975 IN LIBER 3, PAGE 367 BY RONALD W. KELLER, P.S. No. 20707, PART A IS BLANK, PART B READS, "... E-11 FOUND IRON BAR ..." PART C READS, "... E-11 SOUTH GUARD RAIL POST S60W± 82.16' NE COR. CULVERT ABUTMENT S50W± 82.08' W. R/W FENCE WEST 51.50' COR. IS 6' W. OF W. EDGE SOUTH BOUND PAVEMENT ..."
- 1975 JULY ACT 132 SURVEY BY FAUSER & KELLER, INC., SIGNED AND SEALED BY GLENN A. FAUSER, P.S. No. 18657, RECORDED FEBRUARY 18, 1976 IN LIBER 2 OF SURVEYS, PAGE 637, "... NW CORNER SECTION 33 ..." NOT FURTHER DESCRIBED. DRAWING INDICATES THE CORNER TO BE WITHIN THE 200 FOOT WIDE RIGHT OF WAY FOR HIGHWAY US-127, 155.62 FEET WESTERLY ALONG SECTION LINE FROM THE EASTERLY RIGHT OF WAY LINE.
- 1979 APRIL 24 ACT 132 SURVEY BY FAUSER & KELLER, INC., SIGNED AND SEALED BY RONALD W. KELLER, P.S. No. 20707, RECORDED NOVEMBER 20, 1990 IN LIBER 6 OF SURVEYS, PAGE 522, "... NE CORNER SECTION 32 T1N R1W INGHAM COUNTY MICHIGAN L.3, P.367 ..." NOT FURTHER DESCRIBED.
- 1979 ACT 132 SURVEY BY FAUSER & KELLER, INC., SIGNED AND SEALED BY RONALD W. KELLER, P.S. No. 20707, RECORDED SEPTEMBER 13, 1979 IN LIBER 3 OF SURVEYS, PAGES 1027-1029, "... NE CORNER SECTION 32 T1N R1W ..." NOT FURTHER DESCRIBED. DISTANCE TO D-11 SHOWN AS 2657.51 FEET.
TO E-12 IMPLIED 2653.98 FEET
- 1980 OCTOBER 23 ACT 132 SURVEY BY FAUSER & KELLER, INC., SIGNED AND SEALED BY RONALD W. KELLER, P.S. No. 20707, RECORDED FEBRUARY 5, 1981 IN LIBER 4 OF SURVEYS ON PAGE 227. MONUMENT NOT DESCRIBED. NO WITNESSES. TO E-12 SHOWN AS S00°43'22"E 2653.99 FEET.
- 1989 OCTOBER 17 ACT 132 SURVEY BY ACCOLADE, INC., SIGNED AND SEALED BY RON HELSEL, P.S. No. 18994, RECORDED NOVEMBER 20, 1990 IN LIBER 6 OF SURVEYS, PAGE 522, "... NE CORNER SECTION 32 T1N R1W INGHAM COUNTY MICHIGAN L.3, P.367 ..." NOT FURTHER DESCRIBED.
- 1992 AUGUST 12 ACT 132 SURVEY BY ACCOLADE, INC., SIGNED AND SEALED BY RON HELSEL, P.S. No. 18994, RECORDED APRIL 12, 1993 IN LIBER 6 OF SURVEYS, PAGE 1135, "... SE CORNER SECTION 29 T1N, R1W L.3, P.367 ..." MONUMENT NOT DESCRIBED, WITNESSED BY "... S. GUARD RAIL POST S60°W, 82.16'. NE COR CULVERT ABUTMENT, SSW, 82.06' W R/W FENCE WEST, 51.50' COR IS ±6' W OF W EDGE SOUTH BOUND PAVEMENT. ..."

INGHAM COUNTY REMONUMENTATION
LAND CORNER RECORDATION CERTIFICATE
Filing Requirement of Act 74, Mich. P.A. 1970

For Corners in
INGHAM
(county)

Located In: Corner Code #

1. Public Land Survey
1/4 CORNER COMMON
TO SECTIONS 32 & 33
LESLIE TOWNSHIP

T 1N R 1W E-12

2. Property Controlling
in Section

S T R
S T R

3. Miscellaneous

S T R

4. Lot No , Recorded Plat

5. Private Claims

B: 13 P: 235 08/06/2008 11:24 AM
2008-031794 LAND CORNERS Receipt #45017
Paula Johnson, Ingham County, Michigan

Pages: 2



I, Brian Reynolds, in a field survey on APRIL 30, 2008 do hereby certify that under the requirements of P.A. 74, Michigan P.A. of 1970, the corner points mentioned in lines 1 and 2 above were in conformance with regulations and rules therefore as required in the current manual of survey instructions of the United States Department of the Interior, Bureau of Land Management or by a decree of a Court of Law and/or that the corner points mentioned in lines 3, 4, and 5 above were in conformance with the rules of the Michigan Board of Land Surveyors or by a Decree of a Court of Law; established, re-established, monumented, re-monumented, recovered, found as expressed below.

NOTE: Not more than 2 corners, in the same town and range, may be recorded on this certificate.

A. Description of original monument and accessories and/or subsequent restoration:

1826 GENERAL LAND OFFICE DEPUTY SURVEYOR HERVEY PARKE, FEBRUARY, 1826, "... NORTH BETWEEN SEC'S 32 & 33 40.00 SET 1/4 SEC. POST Y. OAK 18 N62E 162-1/2 Do. 20 S55-1/2W 106 ..."

CORNER HISTORY CONTINUED ON PAGE TWO

B. Description of corner evidence found and/or method applied in restoring or reestablishing corner:

Found a boat spike 6 inches below the bituminous road surface on the centerline of a north-south road (Churchill Road) in line with occupation to the west. Also found two witnesses by Keller (1975), all witnesses by Lester (1992) and Enger (1998), all closely matching the distances of record. Excavated to 2+ feet below road, found no further evidence of monumentation. Traverse of section 32 confirms that the found boat spike was less than two feet from the mid-point between adjoining corners north and south. Accepted the boat spike as representing the true corner location. Replaced boat spike with standard monument and cap, installed monument box, witnessed as described below.

C. Description of monument for corner and accessories established to perpetuate locating the position of the corner:

WITNESSES TO 3/4" X 24" FORM PIN MONUMENT WITH AN
INGHAM COUNTY ALUMINUM CAP STAMPED "31602"

FOUND NAIL & TAG No. 18998 IN THE SOUTH SIDE OF A UTILITY POLE N30°W 65.96 FEET
FOUND NAIL & TAG No. 18998 IN THE SOUTHWEST SIDE OF A UTILITY POLE S77°E 88.56 FEET
SET MAG NAIL & REMON TAG IN THE SOUTH SIDE OF AN 8" CHERRY N46°E 49.24 FEET
SET MAG NAIL & REMON TAG IN THE SOUTH SIDE OF AN 8" OAK N74°E 42.96 FEET
FOUND NAIL & TAG No. 25837 IN A ROTTED FENCE CORNER POST WEST 31.04 FEET
FOUND NAIL & TAG No. 25837 IN THE NORTHWEST SIDE OF A POWER POLE S15°W 158.20 FEET
TO E-11 IS NORTHERLY 2653.08 FEET TO E-13 IS SOUTHERLY 2649.33 FEET
TO D-12 IS WESTERLY 2668.60 FEET IN LINE WITH OCCUPATION WEST
ON CENTERLINE OF CHURCHILL ROAD (BITUMINOUS)

NOTE: MAG NAIL & REMON TAG = MAGNETIC NAIL & 1-1/2" ALUMINUM TAG STAMPED "INGHAM PA 345 WITNESS"

Signed by Brian Reynolds
Surveyor's Michigan License No 31602

Date JUNE 5, 2008

FORM APPROVED BY MICHIGAN STATE BOARD OF LAND SURVEYORS, JAN. 28, 1971

REVISED MAY 14, 1975 REVISED JANUARY, 1983 REVISED OCTOBER 1995

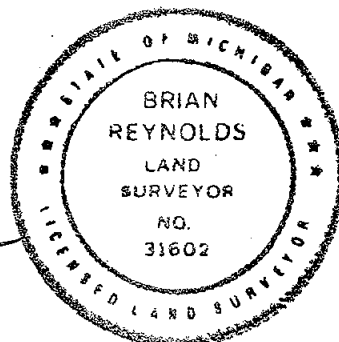

PAGE TWO

A. Description of original monument and accessories and/or subsequent restoration: T1N R1W E-12 CONTINUED

- 1839-1843 ON PAGE 3 OF BOOK 4-A IS A COMPILATION OF THREE SURVEYS, EACH OF AN 80-ACRE ALIQUOT PART OF SECTION 32, BY COUNTY SURVEYOR ANSON JACKSON, LISTED AS SURVEYS No. 36, No. 128, AND No. 263. NO MONUMENT IS LISTED. HOWEVER, IDENTICAL WITNESSES ARE DESCRIBED FOR THE SUBJECT CORNER FROM BOTH SURVEYS No. 36 AND 128, "... Y OAK 18 N62E 162-1/2 LKS Y. OAK 20 S55W 106 LKS. ..." ON THE SURVEY LABELED "No. 36" A DISTANCE IS SHOWN NORTH FROM THE SUBJECT CORNER E-12, 80 (RODS) 7 (LINKS), IMPLYING A DISTANCE FROM D-12 TO D-11 OF 40 CHAINS - 14 LINKS (2649.24 FEET) TO E-11. ALSO, ON THE SURVEY LABELED "No. 128" A DISTANCE IS SHOWN SOUTH OF 80 (RODS) 2 (LINKS), IMPLYING A DISTANCE OF 160 RODS 4 LINKS (2642.64 FEET). BOTH OF THESE RECORDS IMPLY THAT JACKSON FOUND AND MEASURED TO SUBJECT CORNER E-12. A NOTE ADDENDUM BY COPYIST JOHN McCREARY READS, "... THE FOREGOING SURVEYS ... ALL BEAR RECORD ON PAGE 2 OF THE ORIGINAL SURVEYS BY A. JACKSON IN SUBDIVISION OF SECTION 32 OF LESLIE TOWNSHIP. IT WILL BE SEEN THAT THEY BEAR DIFFERENT DATE AND TAKEN ALTOGETHER IT IS A RATHER QUEER RECORD. ..."
- 1839 MARCH 6-7 A SECTION BREAKDOWN OF MOST OF SECTION 33 BY COUNTY SURVEYOR ANSON JACKSON RECORDED IN VOLUME 1 ON PAGE 4, THE SUBJECT CORNER IS WITNESSED BY, "... Y. OAK 18 N62E 162-1/2 LKS Do. 20 S55W 106 LKS ..." MONUMENT NOT DESCRIBED. JACKSON SHOWS A DISTANCE TO THE MID-POINT TOWARD F-12 OF 80 RODS 11-1/2 LINKS (IMPLIED DISTANCE TO F-12 = 2655.18 FEET), AND A DISTANCE TO E-11 OF 160 RODS 14 LINKS (2649.24 FEET).
- 1841 FEBRUARY 1ST A SURVEY OF A NOMINAL 40 ACRE PARCEL IN SECTION 33 BY COUNTY SURVEYOR ANSON JACKSON RECORDED IN VOLUME 1 ON PAGE 9, THE SUBJECT CORNER IS WITNESSED BY, "... Y. OAK 18 N62E 162-1/2 LKS Do. 20 S55W 106 LKS ..." MONUMENT NOT DESCRIBED. JACKSON SHOWS A DISTANCE TO THE MID-POINT TOWARD E-13 OF 80 RODS 2 LINKS (IMPLIED DISTANCE TO E-13 = 2642.64 FEET), AND A DISTANCE TO THE MID-POINT TOWARD F-12 OF 80 RODS 11 LINKS (IMPLIED DISTANCE TO F-12 = 2654.52 FEET)
- 1975 LAND CORNER RECORDATION CERTIFICATE RECORDED APRIL 22, 1975 IN LIBER 3, PAGE 367 BY RONALD W. KELLER, P.S. No. 20707, PART A IS BLANK, PART B READS, "... E-12 FOUND BOAT SPIKE ..." PART C READS, "... E-12 ON LINE (ILLEGIBLE) FENCE CEDAR FENCE COR. POST WEST 31.72' P.POLE N60W± 66.83' P.POLE S80E± 88.65' ..."
- 1980 OCTOBER 23 ACT 132 SURVEY BY FAUSER & KELLER, INC., SIGNED AND SEALED BY RONALD W. KELLER, P.S. No. 20707, RECORDED FEBRUARY 5, 1981 IN LIBER 4 OF SURVEYS ON PAGE 227. MONUMENT NOT DESCRIBED. NO WITNESSES. TO E-11 SHOWN AS N00°43'22"W 2653.99 FEET. TO E-13 SHOWN AS S00°21'57"E 2649.30 FEET.
- 1992 MAY 29 ACT 132 SURVEY BY POLARIS SURVEYING CO., SIGNED AND SEALED BY RONNIE M. LESTER, P.S. No. 18998, RECORDED JULY 10, 1992 IN LIBER 6 OF SURVEYS ON PAGES 1000-1002, LAND IN SECTION 33, ON THE DRAWING THE CORNER IS LABELED AS "... WEST 1/4 CORNER SECTION 33, T1N, R1W BOATSPIKE ..." WITNESSED AS, "... WEST 1/4 CORNER SECTION 33, T1N, R1W. BOATSPIKE CENTERLINE ROAD. LIBER 3 PAGE 267. SET NAIL & TAG ON NORTH SIDE FENCE CORNER POST 275° AZ., 31.4' SET NAIL & TAG IN SOUTH SIDE UTILITY POLE 334° AZ., 66.2' SET NAIL & TAG IN SOUTH SIDE UTILITY POLE 107° AZ., 88.6' SET NAIL & TAG IN WEST SIDE 10" CHERRY 50° AZ., 49.3' DRAWING SHOWS A TOTAL DIRECTION AND DISTANCE TO G-12 OF S89°56'45"E 5306.00 FEET.
- 1998 AUGUST 26 ACT 132 SURVEY BY ENGER SURVEYING & ENGINEERING, SIGNED AND SEALED BY RONALD L. ENGER, P.S. No. 28409, LIBER 8 OF SURVEYS, RECORDED MAY 9, 2001, PAGE 857 "... E-12 EAST 1/4 CORNER SECTION 32 RECORDED IN LIBER 3 PAGE 367 BOAT SPIKE NAIL & TAG 25837 (DAVID L. CLIFFORD, P.S.) SOUTH SIDE SPLIT RAIL FENCE POST WEST 31.10' NAIL & TAG 25837 NW SIDE UTILITY POLE S17°W 158.25' NAIL & TAG 18998 SOUTH SIDE UTILITY POLE N60°W 66.95' NAIL & TAG 18998 SOUTH SIDE UTILITY POLE S80°E 88.65'

INGHAM COUNTY REMONUMENTATION
LAND CORNER RECORDATION CERTIFICATE
Filing Requirement of Act 74, Mich. P.A. 1970

For Corners in
INGHAM
(county)

Located In: Corner Code #

1. Public Land Survey T 1N R 1W E-13
STANDARD CORNER COMMON T R
TO SECTIONS 32 & 33 T R
LESLIE TOWNSHIP (ON BASE LINE) T R
2. Property Controlling S T R
in Section S T R
3. Miscellaneous S T R
4. Lot No , Recorded Plat
5. Private Claims

B: 13 P: 234 08/06/2008 11:24 AM
2008-031793 LAND CORNERS Receipt #45017
Paula Johnson, Ingham County, Michigan

Pages: 2



I, Brian Reynolds, in a field survey on APRIL 18, 2008 do hereby certify that under the requirements of P.A. 74, Michigan P.A. of 1970, the corner points mentioned in lines 1 and 2 above were in conformance with regulations and rules therefore as required in the current manual of survey instructions of the United States Department of the Interior, Bureau of Land Management or by a decree of a Court of Law and/or that the corner points mentioned in lines 3, 4, and 5 above were in conformance with the rules of the Michigan Board of Land Surveyors or by a Decree of a Court of Law; established, re-established, monumented, re-monumented, recovered, found as expressed below.

NOTE: Not more than 2 corners, in the same town and range, may be recorded on this certificate.

A. Description of original monument and accessories and/or subsequent restoration:

1824 GENERAL LAND OFFICE DEPUTY SURVEYOR JOHN MULLETT, JANUARY 21, 1824, "... WEST ON SOUTH B'DY SEC. 33
.... 80.00 SET P. COR. SEC'S 32 & 33 F/W W. OAK 18 N72E 160 Do. 16 N10-1/2W 121 ..."

	A	B	C	D	E	F	G	H	I	J	K	L	M
1													
2		6		5		4		3		2		1	
3													
4		7		8		9		10		11		12	
5													
6		18		17		16		15		14		13	
7													
8		19		20		21		22		23		24	
9													
10		30		29		28		27		26		25	
11													
12		31		32		33		34		35		36	
13													

CORNER HISTORY CONTINUED ON PAGE TWO

B. Description of corner evidence found and/or method applied in restoring or reestablishing corner:

Found 3/4" pipe, 20" long in a monument box on the centerline of Base Line Road, 20± feet west of the centerline of Churchill Road as it crosses the base line, no lid on the monument box. Also, found an iron in a monument box representing the corresponding closing corner, as noted by Keller (1975). All other witnesses were gone. The box was filled with bituminous paving material, and the rim of the box was below at least two courses of pavement. Excavated through the box to a depth of 2.5 ± feet, found no additional evidence of prior monumentation. Accepted found iron as representing the true corner position. Raised the monument box with two rings, (there was nearly room for three rings) and lid. Installed standard 3/4" x 24" steel form pin monument with aluminum Ingham County cap stamped "31602", witnessed as described below.

C. Description of monument for corner and accessories established to perpetuate locating the position of the corner:

WITNESSES TO 3/4" X 24" STEEL FORM PIN MONUMENT WITH AN
INGHAM COUNTY ALUMINUM CAP STAMPED "31602" IN A MONUMENT BOX
FOUND NAIL & MSHD TAG IN THE EAST SIDE OF A UTILITY POLE S53°W 122.86 FEET
FOUND NAIL & MSHD TAG IN THE SOUTHEAST SIDE OF A UTILITY POLE S47°W 93.46 FEET
FOUND NAIL & SHINER TAG IN THE SOUTHEAST SIDE OF A UTILITY POLE S47°W 93.44 FEET
FOUND NAIL & MSHD TAG IN THE EAST SIDE OF A UTILITY POLE N23°W 124.56 FEET
FOUND PK NAIL IN THE SOUTH FACE OF A UTILITY POLE N24°W 124.30 FEET
FOUND NAIL IN THE WEST SIDE OF A 40" OAK N12°E 91.62 FEET
FOUND NAIL IN THE WEST SIDE OF A 4" WOOD POST (LEANING) S40°E 47.89 FEET
FOUND NAIL IN THE WEST ROOT OF A 24" PINE S11°E 53.37 FEET
APPARENT CORRESPONDING CLOSING CORNER (1/2" IRON IN BOX) IS WEST 45.00 FEET
CHURCHILL ROAD (NORTH - SOUTH) IS BITUMINOUS SURFACE, BASE LINE ROAD IS GRAVEL
BOTH STANDARD AND CLOSING CORNERS FALL IN THE BITUMINOUS INTERSECTION APRON
TO D-13 IS WESTERLY 2655.48 FEET TO E-12 IS NORTHERLY 2649.33 FEET

P.A. 345 INGHAM COUNTY
PEER APPROVED 6/3/2008 M

Signed by [Signature]
Surveyor's Michigan License No 31602

Date JUNE 5, 2008

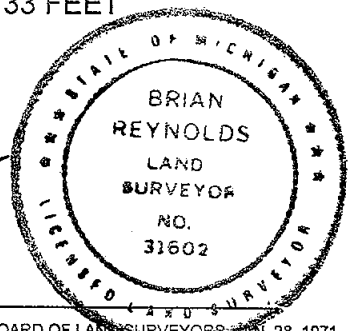

FORM APPROVED BY MICHIGAN STATE BOARD OF LAND SURVEYORS JAN. 28, 1971

REVISED MAY 14, 1975 REVISED JANUARY, 1983 REVISED OCTOBER 1995

PAGE TWO

A. Description of original monument and accessories and/or subsequent restoration T1N R1W E-13 CONTINUED

- 1839-1843 ON PAGE 3 OF BOOK 4-A IS A COMPILATION OF THREE SURVEYS, EACH OF AN 80-ACRE ALIQUOT PART OF SECTION 32, BY COUNTY SURVEYOR ANSON JACKSON, LISTED AS SURVEYS No. 36, No. 128, AND No. 263. NO MONUMENT OR WITNESSES ARE DESCRIBED FOR THE SUBJECT CORNER. HOWEVER, ON THE SURVEY LABELED "No. 128" A DISTANCE IS SHOWN NORTH FROM CORNER E-12, 80 (RODS) 2 (LINKS), IMPLYING A DISTANCE FROM E-12 TO E-13 OF 40 CHAINS - 4 LINKS (2642.64 FEET. THIS RECORD IMPLIES THAT JACKSON FOUND AND MEASURED TO SUBJECT CORNER E-13. A NOTE ADDENDUM BY COPYIST JOHN McCREARY READS, "... THE FOREGOING SURVEYS ... ALL BEAR RECORD ON PAGE 2 OF THE ORIGINAL SURVEYS BY A. JACKSON IN SUBDIVISION OF SECTION 32 OF LESLIE TOWNSHIP. IT WILL BE SEEN THAT THEY BEAR DIFFERENT DATE AND TAKEN ALTOGETHER IT IS A RATHER QUEER RECORD. ..."
- 1839 MARCH 6-7 A SECTION BREAKDOWN OF MOST OF SECTION 33 BY COUNTY SURVEYOR ANSON JACKSON RECORDED IN VOLME 1 ON PAGE 4, THE SUBJECT CORNER IS WITNESSED BY, "... W. OAK 18 N72E 160 LKS Do. 16 N10-1/2W 121 LKS ..." MONUMENT NOT DESCRIBED. JACKSON SHOWS A DISTANCE TO THE MID-POINT TOWARD F-13 OF 80 RODS 5 LINKS (IMPLIED DISTANCE TO F-11 = 2646.6 FEET), NO DISTANCE SHOWN TO E-12.
- 1954 NOTES FROM THE SURVEY IN ANTICIPATION OF THE US-127 FREEWAY, PROJECT 33-79, SURVEYED FROM OCTOBER 1954 TO APRIL 1955, F. HOLMES, PARTY CHIEF. "WIT TO SEC. COR. SECS 32-33 MSHD TAG - 36" OAK - N15°E - 91.88' MSHD TAG - 15" W. NUT - S70°E - 116.90' S.W. COR. SCHOOL PORCH N41°E 78.17' ..." FROM THE SUBJECT CORNER, THE SKETCH SHOWS 2629.13 FEET EASTERLY ALONG THE BASE LINE TO THE SURVEY CENTERLINE, AND WESTERLY 44.7 FEET TO THE CLOSING CORNER, WHICH IS ALSO WITNESSED. MONUMENT NOT RECITED FOR EITHER CORNER.
- 1966 MICHIGAN STATE HIGHWAY DEPARTMENT CORNER CARD FORM 280, DATED JANUARY, 1966, ATTRIBUTED TO SURVEY CHIEF "SMITH", CORNER DESCRIBED AS, "... FOUND 3/4" IRON IN CENTER OF BASE LINE ROAD FOR THE SOUTH WEST CORNER OF SECTION 33 LESLIE TOWNSHIP INGHAM COUNTY. S.W. COR. SCHOOL PORCH N41E 78.17' 37" OAK N15E 91.88' P.POLE S43W 93.40' ..."
- 1967 FROM THE INGHAM COUNTY ROAD COMMISSION CORNER WITNESS SHEET, "... 3/4" IRON (M.S.H.D. 1967) P.P. S43°W 93.40' 37" OAK N15°E 91.88' S.W. COR. SCHOOL PORCH N41°E 78.17' ..." THE CORRESPONDING CLOSING CORNER IS SHOWN AS 44.7 FEET WEST.
- UNDATED REGARDING THE CORRESPONDING CLOSING CORNER, FROM THE INGHAM COUNTY ROAD COMMISSION CORNER WITNESS SHEET, NO MONUMENT DESCRIBED, WITNESSED BY, "... P.P. N. 115.11' 21" OAK W.S.W. 87.88' 11" WALNUT W.S.W. 101.0' P.P. S.S.W. 91.34' ..."
- 1975 LAND CORNER RECORDATION CERTIFICATE RECORDED APRIL 22, 1975 IN LIBER 3, PAGE 367 BY RONALD W. KELLER, P.S. No. 20707, PART A IS BLANK, PART B READS, "... E-13 FOUND MONUMENT BOX ..." PART C READS, "... E-13 RD. SIGN N60E± 32.22' FEN. COR. POST SOUTH 37.81' RD. SIGN S45W± 71.45' NE COR SEC 5, WEST, 44.65 ..."
- 1980 OCTOBER 23 ACT 132 SURVEY BY FAUSER & KELLER, INC., SIGNED AND SEALED BY RONALD W. KELLER, P.S. No. 20707, RECORDED FEBRUARY 5, 1981 IN LIBER 4 OF SURVEYS ON PAGE 227. MONUMENT NOT DESCRIBED. NO WITNESSES. TO E-12 SHOWN AS N00°21'57"W 2649.30 FEET.
- 1998 AUGUST 26 ACT 132 SURVEY BY ENGER SURVEYING & ENGINEERING, SIGNED AND SEALED BY RONALD L. ENGER, P.S. No. 28409, RECORDED MAY 9TH, 2001 IN LIBER 8 OF SURVEYS ON PAGE 857 "...E-13 SE CORNER SECTION 32 RECORDED IN LIBER 3 PAGE 367 3/4" IRON PIPE MDSHT NAIL & TAG IN SE SIDE UTILITY POLE S25°W 45.48' NAIL & TAG IN NW SIDE UTILITY POLE N72°E 62.67' NAIL & TAG 18998 IN WEST SIDE 32" ASH N20°E 102.80' NAIL & TAG 16053 IN EAST SIDE 30" MAPLE N25°W 59.09' ..." THE DRAWING SHOWS N00°00'00"E 2649.44 TO E-12.