

# LAND CORNER RECORDATION CERTIFICATE

FILING REQUIREMENT OF ACT 74, MICH. P.A. 1970  
SW corner, Section 29, T4N, R2E, Locke Township  
Ingham County

IBER 3 11 221

FOR CORNERS OF:-	LOCATED IN:-	CORNER CODE NUMBER
1. PUBLIC LAND SURVEY	1 4N 2E 1	C-11
2. PROPERTY CONTROLLING IN SECTION	N. R. E.	
3. MIN. ELEVATIONS PROPERTY IN SECTION	N. R. E.	
4. LOT NO.	RECORDED PLAT	
5. PRIVATE CLAIMS		

FILED

SEP 18 9 53 AM '74

REGISTER OF DEEDS

*Paul M. Lewis*  
INGHAM COUNTY, MICH.

REGISTER OF DEEDS STAMP AND FILING NUMBER

I, **James E. Stephens**, do hereby certify that under requirements of P.A. 74, Michigan P.A. of 1970 the corner points mentioned in lines 1 and 2 above (identified with circles on index code diagram - over) were, in a field survey on **July 15, 1974**, established, re-established, monumented, re-monumented, recovered or restored as expressed below and in conformance with regulations and rules therefore as required in the current manual of survey instructions of the United States Department of the Interior, Bureau of Land Management or by a decree of a court of law. Furthermore, that the corner points mentioned in lines 3, 4 and 5 above were, in a field survey on **19**, found recovered, restored, established or re-established as expressed below and in conformance with the rules of the Michigan State Board of Registration for Land Surveyors or, by a Decree of a Court of law:

A. Description of original monument and accessories and/or subsequent restoration:

The original monument and accessories were not found.

B. Description of corner evidence found and/or method applied in restoring or re-establishing corner

A railroad spike was set in the centerline of Harris Road and on the projection of a fence line to the East.

Researched records of 8 area Registered Land Surveyors.

C. Description of monument for corner and accessories established to perpetuate locating the position of the corner

The railroad spike set was left in place with the following witnesses;

SW corner of a 3 inch angle iron fence post, S89°16'E 27.0 feet.  
Survey tag in SW side of a 28" Oak tree, S62°33'E 23.49 feet.  
Survey tag in SW side of a 12" Oak tree, S30°30'E 38.82 feet.

SIGNED BY *James E. Stephens*  
SURVEYOR'S MICHIGAN REGISTRATION NO. 16053  
FOR STATE AND UNITED STATES AGENTS

DATE August 1, 1974

SIGNED BY  
APPROVED AND SIGNED BY

DATE

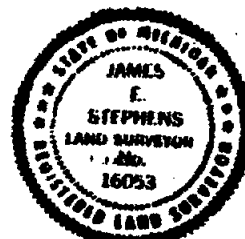

SURVEYOR'S MICHIGAN REGISTRATION NO.

754

Form No. 101, 10/73  
MICHIGAN BOARD OF REGISTRATION

FORM APPROVED BY MICHIGAN STATE BOARD OF REGISTRATION JAN. 28, 1973  
DISTRIBUTED BY MICHIGAN SOCIETY OF REGISTERED LAND SURVEYORS

INGHAM COUNTY - LOCKE TWP.

LAND CORNER RECORDATION CERTIFICATE  
FILING REQUIREMENT OF ACT 74, MICH. P.A. 1970

Line: 4 N 274

FOR CORNERS OF--	LOCATED IN--	CORNER CODE NUMBER
1. PUBLIC LAND SURVEY	T. 4 N. R. 2 E.	A-12
2. PROPERTY CONTROLLING IN SECTION	T. N. R. E.	
3. MISCELLANEOUS PROPERTY IN SECTION	T. N. R. E.	
4. LOT NO. _____, RECORDED PLAT _____		
5. PRIVATE CLAIMS _____		

FILED

AUG 11 12 53 PM '78

REGISTER OF DEEDS  
Paul Johnson  
INGHAM COUNTY, MICH.

REGISTER OF DEEDS STAMP AND  
FILING NUMBER

I, Ronnie M. Lester, do hereby certify that under requirements of P.A. 74, Michigan P.A. of 1970, the corner points mentioned in lines 1 and 2 above were, in a field survey on May 22, 19 78, established, re-established, monumented, re-monumented, recovered or restored as expressed below and in conformance with regulations and rules therefore as required in the current manual of survey instructions of the United States Department of the Interior, Bureau of Land Management or by a decree of a court of law. Furthermore, that the corner points mentioned in lines 3, 4 and 5 above were, in a field survey on \_\_\_\_\_, 19\_\_\_\_, found, recovered, restored, established or re-established as expressed below and in conformance with the rules of the Michigan State Board of Registration for Land Surveyors or, by a Decree of a Court of law:

- A. Description of original monument and accessories and/or subsequent restoration:  
A-12

No record of corner being established in original government survey.  
There is no available public record of subsequent establishment or restoration although corner was undoubtedly set by the County Surveyor.

- B. Description of corner evidence found and/or method applied in restoring or re-establishing corner:  
A-12

Excavated hole 3' x 5' at average depth of 3' at a location south of the centerline of Rowley Road. Found axle with wood stake along side with 3 broken bricks below and rocks under the bricks all in line with cemetery fence to north and 5' south of centerline of Rowley Road. Corner +9' south of 1" bar at M-12, T4N-R1E, (1.3, p.491) Ingham County Register of Deeds.  
Excavation conducted by Ingham County Survey and Remonumentation Project crew.

- C. Description of monument for corner and accessories established to perpetuate locating the position of the corner:  
A-12

West  $\frac{1}{2}$  Corner Section 31, T4N-R2W.  
Set 4" x 36" concrete monument with  $\frac{1}{2}$ " x 38" rerod with cap #18998 in monument box with lid at location of axle as described above:  
Center top concrete and steel fence post, south, 19.99'  
Top southeast corner concrete corner post, north, 32.67'  
Nail & tag, #18998 east side 24" Maple, SW, 31.00'  
Nail & tag, #18998 north side 26" Maple, W.S.W., 52.60'  
1" iron bar, M-12, T4N-R1E, Williamston Twp., north, 9.00'

SIGNED BY Ronnie M. Lester DATE Aug 9, 1978

SURVEYOR'S MICHIGAN REGISTRATION NO. 18998

~~REGISTERED LAND SURVEYOR~~

SIGNED BY \_\_\_\_\_ DATE \_\_\_\_\_

APPROVED AND SIGNED BY Paul Johnson DATE 8-9-78

Director, Ingham County Survey and  
Remonumentation Project

SURVEYOR'S MICHIGAN REGISTRATION NO. 17624

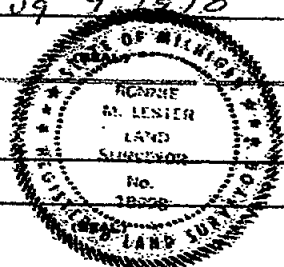

1270

FORM APPROVED BY MICHIGAN STATE BOARD OF REGISTRATION, JAN. 28, 1971  
REVISED MAY-14, 1975

MAY PLACE SKETCH ON BACK OR ATTACHED SHEET

INGHAM COUNTY - LOCKE TWP.

# LAND CORNER RECORDATION CERTIFICATE

FILING REQUIREMENT OF ACT 74, MICH. P.A. 1970

FOR CORNERS OF--	LOCATED IN--	CORNER CODE NUMBER
1. PUBLIC LAND SURVEY	T. 4 N. R. 2 E.	C-12
2. PROPERTY CONTROLLING IN SECTION	T. N. S. R. E. W.	
3. MISCELLANEOUS PROPERTY IN SECTION	T. N. S. R. E. W.	
4. LOT NO.	RECORDED PLAT	
5. PRIVATE CLAIMS		

USER 4 16 324

FILED

SEP 5 9 54 AM '78

REGISTER OF DEEDS

Paula Johnson  
INGHAM COUNTY, MICH.

REGISTER OF DEEDS STAMP AND FILING NUMBER

I, Ronnie M. Lester do hereby certify that under requirements of P.A. 74, Michigan P.A. of 1970, the corner points mentioned in lines 1 and 2 above were, in a field survey on May 22, 1978, established, re-established, monumented, re-monumented, recovered or restored as expressed below and in conformance with regulations and rules therefore as required in the current manual of survey instructions of the United States Department of the Interior, Bureau of Land Management or by a decree of a court of law. Furthermore, that the corner points mentioned in lines 3, 4 and 5 above were, in a field survey on           , 19      , found, recovered, restored, established or re-established as expressed below and in conformance with the rules of the Michigan State Board of Registration for Land Surveyors or, by a Decree of a Court of law:

A. Description of original monument and accessories and/or subsequent restoration:  
C-12

Post set by J. Wampler in original government survey between March 29 and April 16, 1826.

Corner referred to in subsequent surveys by A. Jackson, County Surveyor, February, 1854 (v.2, p.181) and March, 1856 (v.2, p.281).

Corner identified as stone by Ingham County Road Commission records revised grid map, 1969.

B. Description of corner evidence found and/or method applied in restoring or re-establishing corner:  
C-12

Excavated a hole 5.9' x 5.2' to an average depth of 4' in the centerline of Rowley Road and Harris Road on a fence line to the south. Found 3/4" iron bar on centerline of Rowley Road and + 3.0' west of centerline of Harris Road. Found a pile of 3" to 4" rocks over a 6" x 8" broken logging saw blade, which was on top of a 1' x 2' x 3' large pointed rock surrounded by broken china. The large pointed rock was 8" below the road surface, + 3.0' west of the centerline of Harris Road and fence line to south and + 2.5' north of the centerline of Rowley Road. Accepted large pointed rock as corner. Excavation conducted by Ingham Co. Survey and Monumentation Project crew.

C. Description of monument for corner and accessories established to perpetuate locating the position of the corner:  
C-12

E<sub>2</sub> Corner, Section 31, T4N-R2E

Set 4" x 36" concrete monument with 1/2" x 38" rerod with cap #18998, in monument box with cover in location of pointed rock described above:

Nail & tag, #18998, west side 30" Dogwood, NNE, 79.62'

Nail & tag, #18998, north side Power Pole, SE, 49.23'

Nail & tag, #18998, north side Power Pole, ENE, 143.23'

Nail & tag, #18998, north side 24" Hickory, ESE, 236.41'

Top center of buried Cable Box, NW, 43.32'

SIGNED BY Ronnie M. Lester DATE 8/31/78

SURVEYOR'S MICHIGAN REGISTRATION NO. 18998

~~REGISTERED LAND SURVEYOR~~

SIGNED BY Gary D. Lester DATE 8-31-78

APPROVED AND SIGNED BY Gary D. Lester DATE 8-31-78

DIRECTOR, INGHAM COUNTY SURVEY AND MONUMENTATION PROJECT

REGISTERED LAND SURVEYOR REGISTRATION NO. 17624

FORM APPROVED BY MICHIGAN STATE BOARD OF REGISTRATION, JAN. 23, 1971

REVISOR MAY 14, 1975

MAY PLACE SKETCH ON BACK OR ATTACHED SHEET

1318

# LAND CORNER RECORDATION CERTIFICATE

FILING REQUIREMENT OF ACT 74, MICH. P.A. 1970

FOR CORNERS OF—	LOCATED IN—	CORNER CODE NUMBER
1. PUBLIC LAND SURVEY <u>30</u> T. <u>4</u> N. <u>2</u> E.		<u>A-11</u>
2. PROPERTY CONTROLLING IN SECTION <u>      </u> T. <u>      </u> N. <u>      </u> E.		
3. MISCELLANEOUS PROPERTY IN SECTION <u>      </u> T. <u>      </u> N. <u>      </u> E.		
4. LOT NO. <u>      </u> , RECORDED PLAT <u>      </u>		
5. PRIVATE CLAIMS <u>      </u>		

LIBER 5 PG 135

FILED

JAN 9 3 53 PM '79

REGISTER OF DEEDS

*Paula Johnson*

INGHAM COUNTY, MICH.

REGISTER OF DEEDS STAMP AND FILING NUMBER

I, James A. Porter, do hereby certify that under requirements of P.A. 74, Michigan P.A. of 1970, the corner points mentioned in lines 1 and 2 above were, in a field survey on 10-11-, 1978, established, re-established, monumented, re-monumented, recovered or restored as expressed below and in conformance with regulations and rules therefore as required in the current manual of survey instructions of the United States Department of the Interior, Bureau of Land Management or by a decree of a court of law. Furthermore, that the corner points mentioned in lines 3, 4 and 5 above were, in a field survey on       , 19      , found, recovered, restored, established or re-established as expressed below and in conformance with the rules of the Michigan State Board of Registration for Land Surveyors or, by a decree of a court of law:

A. Description of original monument and accessories and/or subsequent restoration:

Original post and witnesses destroyed.

B. Description of corner evidence found and/or method applied in restoring or re-establishing corner:

Found stone 14.07 feet South of corner M-11. Set #4 rebar with cap alongside.

C. Description of monument for corner and accessories established to perpetuate locating the position of the corner:

Witnesses to #4 rebar:

Nail & Tag in:

6" Oak	North	40.43 feet
6" Elm	N6° E	34.00 feet
6" Maple	N30° E	20.08 feet
30" Db1. Elm	East	7.92 feet

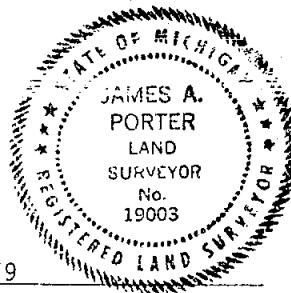

SIGNED BY James A. Porter DATE 1-9-79

SURVEYOR'S MICHIGAN REGISTRATION NO. 19003

(SEAL)

FOR STATE AND UNITED STATES AGENCIES:

SIGNED BY        DATE       

CHIEF OF SURVEY PARTY

APPROVED AND SIGNED BY        DATE       

MICHIGAN REGISTERED LAND SURVEYOR

(SEAL)

SURVEYOR'S MICHIGAN REGISTRATION NO.       

FORM APPROVED BY MICHIGAN STATE BOARD OF REGISTRATION, JAN. 25, 1971  
REVISED MAY 14, 1975

MAY PLACE SKETCH ON BACK OR ATTACHED SHEET

**LAND CORNER RECORDATION CERTIFICATE**  
**Filing Requirement of Act 74, Mich. P.A. 1970**

**FILED**

For corners in

Ingham  
(County)

Located In:

Corner Code ##

AUG 28 1 07 PM '89

REGISTER OF DEEDS

*Paula Johnson*  
 INGHAM COUNTY, MICH.

Register of Deeds Stamp &amp; File Number

- |                                    |                         |             |
|------------------------------------|-------------------------|-------------|
| 1. Public Land Survey              | T <u>4N</u> R <u>2E</u> | <u>B-13</u> |
|                                    | T _____ R _____         | _____       |
|                                    | T _____ R _____         | _____       |
|                                    | T _____ R _____         | _____       |
| 2. Property Controlling in Section | S _____ T _____ R _____ | _____       |
|                                    | S _____ T _____ R _____ | _____       |
| 3. Miscellaneous Property in Sec.  | S _____ T _____ R _____ | _____       |
|                                    | S _____ T _____ R _____ | _____       |

4. Lot No. \_\_\_\_\_, Recorded Plat \_\_\_\_\_
5. Private Claims \_\_\_\_\_

	A	B	C	D	E	F	G	H	I	J	K	L	M
2	6	5	4	3	2	1							
3													
4	7	8	9	10	11	12							
5													
6	13	17	16	15	14	13							
7													
8	19	20	21	22	23	24							
9													
10	30	29	28	27	26	25							
11													
12													
13													

I, Larry A. Bryan, in a field survey on June 15, 19 89, do hereby certify that under requirements of P.A. 74, Michigan P.A. of 1970, the corner points mentioned in lines 1 and 2 above were in conformance with regulations and rules therefore as required in the current manual of survey instructions of the United States Department of the Interior, Bureau of Land Management or by a decree of a Court of Law and/or that the corner points mentioned in lines 3, 4 and 5 above were in conformance with the rules of the Michigan Board of Land Surveyors or by a Decree of a Court of Law; established, re-established, monumented, re-monumented, recovered, found as expressed below:

**NOTE:** Not more than 4 corners, all in the same town and range, may be recorded on this certificate.

A. Description of original monument and accessories and/or subsequent restoration:  
B-13 Original monument and accessories destroyed.

B. Description of corner evidence found and/or method applied in restoring or reestablishing corner:

B-13 Found pinch pipe as called for on the Plat of Glen Dor subdivision as recorded in Liber 23 of Plats Page 13 of the Ingham County Records.



C. Description of monument for corner and accessories established to perpetuate locating the position of the corner:

B-13 South 1/4 corner Section 31, T4N, R2E.  
Found pinch pipe.  
Found concrete monument Northeast corner Lot 43, N35°E, 94.33'  
Found pinch pipe Northeast corner Lot 44, N67°E, 33.66'  
Found pinch pipe Northwest corner Lot 44, N60°W, 122.45'

Signed by Larry A. Bryan

Date

8-23-89Surveyor's Michigan License No. 25832

FILED

**LAND CORNER RECORDATION CERTIFICATE**  
**Filing Requirement of Act 74, Mich. P.A. 1970**

For corners in

Ingham  
 (County)

Located In:

Corner Code ##

- |                                    |                         |             |
|------------------------------------|-------------------------|-------------|
| 1. Public Land Survey              | T <u>4N</u> R <u>2E</u> | <u>B-13</u> |
|                                    | T <u>3N</u> R <u>2E</u> | <u>B-1</u>  |
|                                    | T _____ R _____         | _____       |
|                                    | T _____ R _____         | _____       |
| 2. Property Controlling in Section | S _____ T _____ R _____ | _____       |
|                                    | S _____ T _____ R _____ | _____       |
| 3. Miscellaneous Property in Sec.  | S _____ T _____ R _____ | _____       |
|                                    | S _____ T _____ R _____ | _____       |

DEC 28 8 59 AM '89

REGISTER OF DEEDS

INGHAM COUNTY, MICH.

Register of Deeds Stamp &amp; File Number

4. Lot No. \_\_\_\_\_, Recorded Plat \_\_\_\_\_
5. Private Claims \_\_\_\_\_

I, Larry A. Bryan, in a field survey on December 21, 1989, do hereby certify that under requirements of P.A. 74, Michigan P.A. of 1970, the corner points mentioned in lines 1 and 2 above were in conformance with regulations and rules therefore as required in the current manual of survey instructions of the United States Department of the Interior, Bureau of Land Management or by a decree of a Court of Law and/or that the corner points mentioned in lines 3, 4 and 5 above were in conformance with the rules of the Michigan Board of Land Surveyors or by a Decree of a Court of Law; established, re-established, monumented, re-monumented, recovered, found as expressed below:

NOTE: All monuments and corners are in the same town and range and are shown on this certificate.

	A	B	C	D	E	F	G	H	I	J	K	L	M
2	6	5	4	3	2	1							
3													
4	7	8	9	10	11	12							
5													
6	18	17	16	15	14	13							
7													
8	19	20	21	22	23	24							
9													
10	30	29	28	27	26	25							
11													
12	31	32	33	34	35	36							
13													

A. Description of original monument and accessories and/or subsequent restoration:

- B-13 Original monument and accessories obliterated, corner is shown on the recorded Plat of Glen Dor Subdivision.
- B-1 No corner set in original government survey, corner is shown on the recorded Plat of Glen Dor Subdivision.

B. Description of corner evidence found and/or method applied in restoring or reestablishing corner:

- B-13 Found pinch pipe in accordance with the measurements on Glen Dor Subdivision.
- B-1 Unable to locate corner because a garage has been built over the location of the monument. Set mathematical location for corner only.

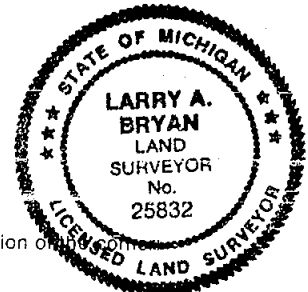

C. Description of monument for corner and accessories established to perpetuate locating the position of corner:

- B-13 South 1/4 corner Section 31, T4N, R2E.  
 Found pinch pipe.  
 Found concrete monument Northeast corner Lot 43, Glen Dor Sub., N35°E, 94.33'  
 Found pinch pipe Northeast corner Lot 44 Glen Dor Sub., N67°E, 33.66'  
 Found pinch pipe Northwest corner Lot 44 Glen Dor Sub., N60°W, 122.45'
- B-1 North 1/4 corner Section 6, T3N, R2E.  
 No monument set, mathematical location only.  
 Concrete monument Northeast corner Lot 43 Glen Dor Sub., N51°43'09"E, 121.52'  
 Concrete monument corner of Lot 45 Glen Dor Sub., S17°30'53"E, 135.30'  
 Pinch pipe, South 1/4 corner Section 31, T4N, R2E, S88°11'46"E, 40.26'

Signed by Larry A. Bryan Date 12-26-89

Surveyor's Michigan License No. 25832

**LAND CORNER RECORDATION CERTIFICATE**  
**Filing Requirement of Act 74, Mich. P.A. 1970**

For corners in  
Ingham  
(County)

Located in:

Corner Code: ##

- |                                    |   |      |
|------------------------------------|---|------|
| 1. Public Land Survey              | T <u>4N</u> R <u>1E</u>                   | M-13 |
|                                    | T <u>    </u> R <u>    </u>               |      |
|                                    | T <u>    </u> R <u>    </u>               |      |
|                                    | T <u>    </u> R <u>    </u>               |      |
| 2. Property Controlling in Section | S <u>    </u> T <u>    </u> R <u>    </u> |      |
|                                    | S <u>    </u> T <u>    </u> R <u>    </u> |      |
| 3. Miscellaneous Property in Sec.  | S <u>    </u> T <u>    </u> R <u>    </u> |      |
|                                    | S <u>    </u> T <u>    </u> R <u>    </u> |      |

Register of Deeds Stamp & File Number

4. Lot No. \_\_\_\_\_, Recorded Plat \_\_\_\_\_  
 5. Private Claims \_\_\_\_\_

Larry A. Bryan, in a field survey on June 6, to 96, do hereby certify that under requirements of P.A. 74, Michigan P.A. of 1970, the corner points mentioned in Article 1 and 2 above were in compliance with regulations and rules therefore as required in the current manual of survey instructions of the United States Department of the Interior, Bureau of Land Management or by a decree of a Court of Law and/or that the corner points mentioned in lines 3, 4 and 5 above were in compliance with the rules of the Michigan Board of Land Surveyors or by a Decree of a Court of Law, established, re-established, monumented, re-monumented, recovered, found as expressed below:

NOTE: Not more than 5 corners, all in the same town and range, may be recorded on this certificate.

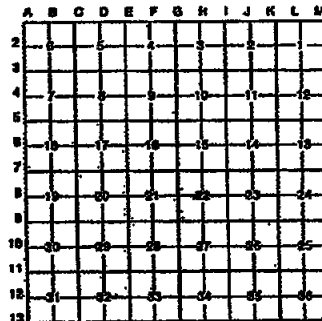

- A. Description of original monument and accessories and/or subsequent restoration:
1. Post set in original government survey by J. Wampler, February 17, 1824
  2. Survey by A. Jackson, County Surveyor, January 20, 1847, lists the following witnesses: Maple 10 S66E 150, and Willow 5 N42W 5.
  3. Survey by George M. Young, July 1, 1981, (Liber 4, Page 417) states that the corner is inaccessible but lists the following witnesses: P.K. Nail, N88°26'39"W, 1736.59'; Nail & tag, P.P., N20°W, 45.38'; Nail & tag, 12" Poplar, S26°W, 54.20'; and Nail & tag, 24" Poplar, South 60.78'.
  4. Survey by George M. Young, September 4, 1981, (Liber 4, Page 423) shows the same description and witnesses as item 3.
- B. Description of corner evidence found and/or method applied in restoring or reestablishing corner:

Corner B11 in swamp, found no evidence of previous corners. Set 3/4" pipe, 5' in length, with cap # 25832, by double proportional measurements to M-13, T4N, R1E; M-12, T4N, R1E; M-2, T4N, R1E; and C-13, T4N, R2E, all distance in close accord with G.L.O. measurements. Note: B-13, T4N, R2E was not used in proportion due to inconsistencies with G.L.O. measurements. 171' short to M-13, T4N, R1E, and 68' long to C-13, T4N, R2E. A lack of any remaining evidence at corner location (corner is in Glen Dor subdivision, with no occupational or deed evidence along section lines) and a lack of information on how the section corner shown on Glen Dor subdivision was established.  
 Dist to M-13, T4N, R1E, 2636.39' Dist to M-12, T4N, R1E, 2645.71'  
 Dist to M-2, T4N, R1E, 2230.55' Dist to C-13, T4N, R2E, 3893.57'

- C. Description of monument for corner and accessories established to perpetuate locating the position of the corner:

Set 3/4" pipe, 5' in length, with cap # 25832 in swamp.  
 Set nail & tag 25832 in West side of 8" Maple, N80°E, 39.25'  
 Set nail & tag 25832 in East side of 24" Willow, N80°W, 70.24'  
 Set nail & tag 25832 in South side of utility pole, S80°W, 96.66'  
 Set nail & tag 25832 in West side of 8" Poplar, S30°W, 81.49'

Signed by Larry A. Bryan  
 Surveyor's Michigan License No. 25832

Date 6-20-96

FORM APPROVED BY MICHIGAN STATE



LAND CORNER RECORDATION CERTIFICATE  
Filing Requirement of Act 74, Mich. P.A. 1970

For corners in

Ingham  
(County)

Located in:

Corner Code #

1. Public Land Survey

T 4N R 2E

C-13

2. Property Controlling  
in Section

S T R

3. Miscellaneous  
Property in Sec.

S T R

4. Lot No.

Recorded Plat

5. Private Claims

Paula Johnson  
INGHAM COUNTY  
REGISTER OF DEEDS  
LANDMARK SURVEYING PC

L-10 P-107

CRNR 9.99

2001-032285

2001-032285

Page: 1 of 1  
07/02/2001 10:13A

Register of Deeds Stamp  
& File Number

Mark L. VanRaemdonck, in a field survey on March 26, 2001, do hereby certify that under requirements of P.A. 74, Michigan P.A. of 1970, the corner points mentioned in lines 1 and 2 above were in conformance with regulations and rules therefore as required in the current manual of survey instructions of the United States Department of the Interior, Bureau of Land Management or by a decree of a Court of Law and/or that the corner points mentioned in lines 3, 4 and 5 above were in conformance with the rules of the Michigan Board of Land Surveyors or by a Decree of a Court of Law; established, re-established, monumented, re-monumented, recovered, found as expressed below:

NOTE: Not more than 2 corners, all in the same town and range, may be recorded on this certificate.

A. Description of original monument and accessories and/or subsequent restoration:

Original monument and accessories have been obliterated. Found no evidence of subsequent restoration. GLO map for T3N-R2E shows a jog of 122 links (80.62 feet) East of the Northwest corner of Section 5

	A	B	C	D	E	F	G	H	I	J	K	L	M
2													
3													
4													
5													
6													
7													
8													
9													
10													
11													
12													
13													

B. Description of corner evidence found and/or method applied in restoring or re-establishing corner:

Located the Northwest corner of Section 5, T3N-R2E. It is monumented by a steel "T" post. The plat of "Chula Vista" recorded in Liber 45, Page 20 is bounded on the North by the North line of Section 5, T3N-R2E. I located a concrete monument on the North line of Section 5 809.99 feet East of the Northwest corner of Section 5, T3N-R2E. I re-established the corner position on the line between the steel "T" post and the concrete monument at the GLO distance of 80.62 feet East of the steel "T" post. I accepted this location as the careful and faithful re-establishment of the original corner position based on the best available evidence.

C. Description of monument for corner and accessories to perpetuate locating the position of the corner:

Drove a 1/2" diameter rerod, 18" long, with a yellow plastic cap stamped "LANDMARK PS 24622" at the position described in Section B above. The rerod is witnessed by the following accessories:

S70°W 63.05' Set nail & tag in SE face of 20" Ash  
North 54.00' Found nail & tag #25832 in E. face 20" Maple  
N60°E 58.35' Found nail & tag #25832 in SE face triple Maple  
West 80.62' "T" post at NE corner Section 6, T3N-R2E  
East 729.37' Conc. monument at NW corner Lot 11 of the Plat of "Chula Vista"



Signed by Mark L. VanRaemdonck

Date APRIL 3, 2001

Surveyor's Michigan License No. 24622