

LAND CORNER RECORDATION CERTIFICATE  
Filing Requirement of Act 74, Mich. P.A. 1970

OCT 27 10 56 AM '93

For corners in

Ingham  
(County)

Located In:

Corner Code ##

REGISTER OF DEEDS

*Russ Johnson*  
INGHAM COUNTY, MICH.

- |                                    |                         |            |
|------------------------------------|-------------------------|------------|
| 1. Public Land Survey              | T <u>4N</u> R <u>1W</u> | <u>K-9</u> |
|                                    | T _____ R _____         | _____      |
|                                    | T _____ R _____         | _____      |
|                                    | T _____ R _____         | _____      |
| 2. Property Controlling in Section | S _____ T _____ R _____ | _____      |
|                                    | S _____ T _____ R _____ | _____      |
| 3. Miscellaneous Property in Sec.  | S _____ T _____ R _____ | _____      |
|                                    | S _____ T _____ R _____ | _____      |

Register of Deeds Stamp & File Number

4. Lot No. \_\_\_\_\_, Recorded Plat \_\_\_\_\_
5. Private Claims \_\_\_\_\_

	A	B	C	D	E	F	G	H	I	J	K	L	M
2	6		5		4		3		2		1		
3													
4	7		8		9		10		11		12		
5													
6	18		17		16		15		14		13		
7													
8	19		20		21		22		23		24		
9													
10	30		29		28		27		26		25		
11													
12	31		32		33		34		35		36		
13													

I, Larry A. Bryan, in a field survey on September 14,, 19 93, do hereby certify that under requirements of P.A. 74, Michigan P.A. of 1970, the corner points mentioned in lines 1 and 2 above were in conformance with regulations and rules therefore as required in the current manual of survey instructions of the United States Department of the Interior, Bureau of Land Management or by a decree of a Court of Law and/or that the corner points mentioned in lines 3, 4 and 5 above were in conformance with the rules of the Michigan Board of Land Surveyors or by a Decree of a Court of Law; established, re-established, monumented, re-monumented, recovered, found as expressed below:

NOTE: Not more than 4 corners, all in the same town and range, may be recorded on this certificate.

A. Description of original monument and accessories and/or subsequent restoration:  
K-9,

1. Set post cor. to Secs. 23, 24, 25 & 26 (From GLO Notes of Lucius Lyon, Deputy Surveyor, 1827)  
W.O. 10in. N34E 40lks.  
Do. 9" N46W 26"

(Continued on Back)

B. Description of corner evidence found and/or method applied in restoring or reestablishing corner:

K-9, Investigation at this corner location revealed a 1 1/2" square bar on a fence to the North. The witnesses of MSHD and the subsequent surveyors listed matched closely with the location of the 1 1/2" bar, and therefore it was accepted as the perpetuated location of K-9.

C. Description of monument for corner and accessories established to perpetuate locating the position of the corner:

K-9, T4N-R1W  
Found 1 1/2" square bar as noted above  
Found nail and tag #25832 North side 12" Cherry, East, 41.02'  
Northwest corner garage foundation, house #955, N65°E, 159.20'  
Set nail and tag #25832 South side 8" Cherry, S65°E, 37.33'  
Northeast leg of Consumers Power Transmission Tower at base, S15°W, 47.49'

Signed by Larry A. Bryan  
Surveyor's Michigan License No. 25832

Date 10-13-93

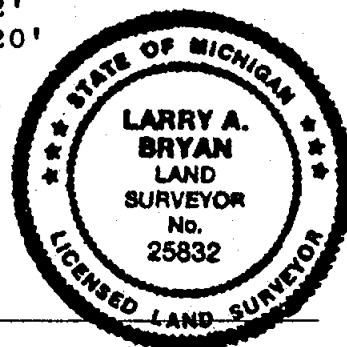

FORM APPROVED BY MICHIGAN STATE BOARD OF LAND SURVEYORS, JAN. 28, 1971  
REVISED MAY 14, 1975  
REVISED JAN., 1983

P.A. 345 INGHAM COUNTY  
PEER APPROVED 9/28/93 *rw*

## PART "A" CONTINUED

2. The Michigan State Highway Department (MSHD) on 05/25/59, with C. Smith as the Survey Chief, found a 1 1/8" iron with the following witness:

Consumers Power Co. Tower #2930 N.E. Corner S15W 47.6'

3. The MSHD in April 1967, with C.E. Smith as the Survey Chief, found a 1 1/2" iron with the following witnesses:

4" Hickory Due N 19.80

6" W. Cherry Due E 41.13

Base NW Leg Tower #9820 S24W 51.60

4. James E. Stephens, LS #16053, recorded corner on 08/13/71 in Liber 1 of Corners, Page 111, and on 08/16/71 in Liber 1 of Surveys, Page 56, as having found a 1 1/2" square iron bar at the intersection of three old farm fences with the following witnesses:

S28°49'W 3.20 feet to a Stephens Engineering tag in a 6 inch Oak

S7°47'W 48.0 feet to the NE. corner of a Consumers Power Company transmission tower

Stephens tag in a 6 inch Oak S6°17'E 20.80 feet

5. Ron Helsel, LS #18994, recorded corner on 03/27/74 in Liber 1 of Surveys, Page 1177, as having found a 1 1/2" iron with the following witnesses:

S7°47'W, 48.0 ft., tag 6" Oak

S6°17'E, 20.80 ft., tag 6" Oak

S7°47'W, 48.0 ft., NE Cor. Cons. Power Trans Tower

6. James E. Stephens, LS #16053, recorded corner on 12/04/78 in Liber 3 of Surveys, Pages 641-648, and on 09/16/82 in Liber 4 of Surveys, Page 574, as having found a 1 1/2" square iron bar with the same witnesses as listed in #4 above.

7. Marvin F. Fouty, LS #18989, recorded corner on 01/18/81 in Liber 4 of Surveys, Pages 305 & 311, as having found a 1 1/2" square iron bar with the following witnesses:

Tag in 6" Oak SW 3.20'

NE Cor. Consumers Power Co. Transmission Tower SW 48.0'

Tag in 6" Oak SE 20.80'

8. Austin C. Williams, LS #21275, recorded corner on 03/22/83 in Liber 4 of Surveys, Pages 654-655, with no monument mentioned, with the same witnesses as listed in #4 above.

9. Larry A. Bryan, LS #25832, witnessed corner on 12/20/90 in a survey with Job #90-B-31109, as having found a 1 1/2" square bar on fence lines North and West with the following witnesses:

Set nail and tag #25832 South side 14" Cherry, East, 41.23'

Centerline Southwest bolt of satellite dish, N30°E, 113.58'

Northeast corner of Northeast leg C.P.C. Tower, S08°W, 48.00'

10. David R. Lohr, LS #30090, recorded corner on 02/08/93 in Liber 6 of Surveys, Pages 1110-1111, showing a distance of 2642.41' to L-9, with no particular monument noted and no witnesses given for K-9.

LAND CORNER RECORDATION CERTIFICATE  
Filing Requirement of Act 74, Mich. P.A. 1970

OCT 27 10 56 AM '93

For corners in

Ingham  
(County)

Located In:

Corner Code #

REGISTER OF DEEDS

*James J. Johnson*  
INGHAM COUNTY, MICH.

- |                                    |                         |            |
|------------------------------------|-------------------------|------------|
| 1. Public Land Survey              | T <u>4N</u> R <u>1W</u> | <u>I-9</u> |
|                                    | T _____ R _____         | _____      |
|                                    | T _____ R _____         | _____      |
|                                    | T _____ R _____         | _____      |
| 2. Property Controlling in Section | S _____ T _____ R _____ | _____      |
|                                    | S _____ T _____ R _____ | _____      |
| 3. Miscellaneous                   | S _____ T _____ R _____ | _____      |
| Property in Sec.                   | S _____ T _____ R _____ | _____      |

Register of Deeds Stamp & File Number

4. Lot No. \_\_\_\_\_, Recorded Plat \_\_\_\_\_  
5. Private Claims \_\_\_\_\_

	A	B	C	D	E	F	G	H	I	J	K	L	M
2	6		5		4		3		2		1		
3													
4	7		8		9		10		11		12		
5													
6	18		17		16		15		14		13		
7													
8	19		20		21		22		23		24		
9													
10	30		29		28		27		26		25		
11													
12	31		32		33		34		35		36		
13													

I, Larry A. Bryan, in a field survey on September 14th, 19 93, do hereby certify that under requirements of P.A. 74, Michigan P.A. of 1970, the corner points mentioned in lines 1 and 2 above were in conformance with regulations and rules therefore as required in the current manual of survey instructions of the United States Department of the Interior, Bureau of Land Management or by a decree of a Court of Law and/or that the corner points mentioned in lines 3, 4 and 5 above were in conformance with the rules of the Michigan Board of Land Surveyors or by a Decree of a Court of Law; established, re-established, monumented, re-monumented, recovered, found as expressed below:

NOTE: Not more than 4 corners, all in the same town and range, may be recorded on this certificate.

A. Description of original monument and accessories and/or subsequent restoration:

I-9,

1. Set post Cor to Secs. 22, 23, 26, & 27 (From GLO Notes of Lucius Lyon, Deputy Surveyor, 1827)  
B.O. 26 in S71E 68lks  
W.O. 24 " N71W 58"

(Continued on Back)

B. Description of corner evidence found and/or method applied in restoring or reestablishing corner:

I-9, Investigation at this corner location revealed a 4" square concrete monument with a 1/2" rebar on chain link fence to West, on older wire fence to East, 0.4' East of chain link fence to South, and 2' North of chain link fence East. The witnesses of the Ingham County Road Commission, M.D.O.T., and the subsequent surveyors listed matched closely with the location of the monument, therefore it was accepted as the perpetuated location of I-9.

C. Description of monument for corner and accessories established to perpetuate locating the position of the corner:

I-9, T4N-R1W

Found 4" square concrete monument with a 1/2" rebar as noted above.

Found nail and tag #16053 Northwest side 20" Oak, N65°E, 14.80'

Found nail and tag #16053 West side 32" Oak, North, 25.42'

Found nail and tag #16053 North side 10" Maple, East, 15.85'

Found nail and tag #17624 (G.Lester) Northeast side 30" Oak, N50°W, 21.28'

Signed by Larry A. Bryan

Date 10-13-93

Surveyor's Michigan License No. 25832

FORM APPROVED BY MICHIGAN STATE BOARD OF LAND SURVEYORS JAN 1971  
REVISED MAY 1975  
REMOVED JAN. 1983

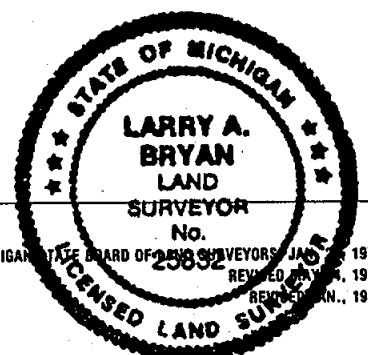

2527

P.A. 345 INGHAM COUNTY  
PEER APPROVED 10/5/93 RA

## PART "A" CONTINUED

2. Corner recorded to be an anchor post by County Surveyor R.J. Robb in a survey dated March 13, 1909 (Vol 5, P 56), in which he stated he found the corner from witnesses and measurements.

3. The Ingham County Road Commission (date unknown) witnessed the corner as follows:

10" Oak NE 14.8'  
18" Oak NW 22.0'  
12" Oak N 24.5'

4. Charles C. Wilson, LS #13604, recorded corner on 08/31/72 in Liber 2 of Corners, Page 83, and in Liber 1 of Surveys, Pages 419-421, as having found a concrete monument per plat of "Forest Hills Subdivision" with the following witnesses:

16" Oak NE'LY 14.8'  
24" Oak NW'LY 22.0'  
24" Oak N'LY 25.5'

5. Ron Helsel, LS #18994, recorded corner on 11/09/73 in Liber 1 of Surveys, Pages 1015-1017, as having found a concrete monument with the same witnesses as #4 above.

6. Marvin F. Fouty, LS #18989, recorded corner on 09/04/74 in Liber 2 of Surveys, Page 82, with no particular monument noted and the same witnesses as #4 above.

7. Maynard R. Dyer, LS #21565, recorded corner on 04/29/80 in Liber 4 of Surveys, Pages 1-4, with no particular monument noted and the same witnesses as #4 above.

8. Maurice H. Mahieu, LS #28414, recorded corner on 04/10/85 in Liber 4 of Surveys, Pages 1007-1008, as having found a concrete monument with the same witnesses as #4 above.

9. Larry A. Bryan, LS #25832, recorded corner on 01/20/86 on Job #86-B-8578, as having found a concrete monument with the following witnesses:

Found nail and tag #17624 Northeast side 24" Oak, N45°W, 21.81'  
Found nail and tag #17624 Southeast side 16" Oak, N50°E, 15.11'  
Found nail and tag #18998 East side 24" Oak, N05°W, 29.95'

10. James E. Stephens, LS #16053, recorded corner on 11/03/86 in Liber 6 of Corners, Page 301, and in Liber 5 of Surveys, Pages 81 & 86-87, as having found the concrete monument per #4 above with the following witnesses:

16" Oak tree Northeasterly 14.8 feet  
24" Oak tree Northwesterly 21.3 feet  
24" Oak tree Northerly 25.5 feet  
8" Maple tree East 15.85 feet

11. The Michigan Department of Transportation (M.D.O.T.) on 12/22/92, with Thomas Moran, LS #25860, as the Survey Chief, found a concrete plat monument with chain link fence going E, W, & S, with the following witnesses:

N47°W, 21.30', 26" Oak (Nail NE)  
North, 25.41', 27" Oak (Nail W)  
N65°E, 14.79', 20" Oak (Nail NW)  
West, 0.36', Fence corner post

LAND CORNER RECORDATION CERTIFICATE  
Filing Requirement of Act 74, Mich. P.A. 1970

OCT 27 10 56 AM '93

For corners in

Ingham  
(County)

Located In:

Corner Code #

REGISTER OF DEEDS

*Daniel Johnson*  
INGHAM COUNTY, MICH.

- |                                    |                         |            |
|------------------------------------|-------------------------|------------|
| 1. Public Land Survey              | T <u>4N</u> R <u>1W</u> | <u>J-9</u> |
|                                    | T _____ R _____         | _____      |
|                                    | T _____ R _____         | _____      |
|                                    | T _____ R _____         | _____      |
| 2. Property Controlling in Section | S _____ T _____ R _____ | _____      |
|                                    | S _____ T _____ R _____ | _____      |
| 3. Miscellaneous Property in Sec.  | S _____ T _____ R _____ | _____      |
|                                    | S _____ T _____ R _____ | _____      |

Register of Deeds Stamp & File Number

4. Lot No. \_\_\_\_\_, Recorded Plat \_\_\_\_\_
5. Private Claims \_\_\_\_\_

I, Larry A. Bryan, in a field survey on September 14th, 19 93, do hereby certify that under requirements of P.A. 74, Michigan P.A. of 1970, the corner points mentioned in lines 1 and 2 above were in conformance with regulations and rules therefore as required in the current manual of survey instructions of the United States Department of the Interior, Bureau of Land Management or by a decree of a Court of Law and/or that the corner points mentioned in lines 3, 4 and 5 above were in conformance with the rules of the Michigan Board of Land Surveyors or by a Decree of a Court of Law; established, re-established, monumented, re-monumented, recovered, found as expressed below:

NOTE: Not more than 4 corners, all in the same town and range, may be recorded on this certificate.

A. Description of original monument and accessories and/or subsequent restoration:  
J-9,

1. Set 1/4 Post at av. d on true line, Marked on a Tam. 4in diam.  
(No witnesses given, from GLO Notes of Lucius Lyon, Deputy Surveyor, 1827)
- (Continued on Back)

B. Description of corner evidence found and/or method applied in restoring or reestablishing corner:

J-9, Investigation at this corner location revealed a 1 1/2" square bar in a monument box 9.5' East of the centerline of Cornell Road. The witnesses of MSHD, Consumers Power Company, and the subsequent surveyors listed matched closely with the location of the 1 1/2" square bar, therefore it was accepted as the perpetuated location of J-9.

C. Description of monument for corner and accessories established to perpetuate locating the position of the corner:

J-9, T4N-R1W  
Found a 1 1/2" square bar in monument box as noted above.  
Found MSHD nail and tag in South side utility pole, West, 44.36'  
Found PK nail and tag in East side 27" Oak, S10°E, 40.63'  
Set nail and tag #25832 in East side 24" Oak, N40°W, 52.10'  
Set nail and tag #25832 in East side 30" Oak, N05°E, 114.51'

Signed by Larry A. Bryan

Date 10-13-93

Surveyor's Michigan License No. 25832

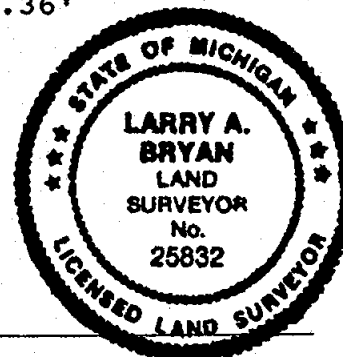

FORM APPROVED BY MICHIGAN STATE BOARD OF LAND SURVEYORS, JAN. 28, 1971  
REVISED MAY 14, 1975  
REVISED JAN., 1983

P.A. 345 INGHAM COUNTY  
PEER APPROVED 10/5/93 rw

2529

## PART "A" CONTINUED

2. Corner recorded to be 4" Tamarack by County Surveyor A. Jackson with no witnesses given. (Vol.2 P.95 of County Surveyor Records, date unknown)
3. The Michigan State Highway Department (MSHD) on 05/25/59, with C.E. Smith as the Survey Chief, found a 1 1/8" iron and used the following witnesses:  
 9" Oak, S10°E, 40.40'  
 5" Oak, S60°E, 8.20'  
 8" Oak, N85°E, 21.10'  
 Iron property point, East, 33.0'
4. The MSHD in April 1967, C.E. Smith as the Survey Chief, found a 1 1/2" iron 10' East of the centerline of Cornell Road with the and used the following witnesses:  
 14" Oak, N40°W, 52.23'  
 P.Pole, Due West, 44.20'  
 10" Oak, S65°E, 8.26'  
 Concrete monument, Due East, 33.00'
5. Consumers Power Company found a iron bar (date unknown) and used the following witnesses:  
 Plat monument, East, 33.0'  
 8" Oak, N39°W, 52.09'  
 Power pole, N84°W, 44.14'  
 Elm, S52°E, 55.67'  
 14" Elm, N14°E, 68.47'
6. Charles C. Wilson, LS #13604, recorded corner on 08/31/72 in Liber 2 of Corners, Page 85, and in Liber 1 of Surveys, Pages 419-421, as having found a 1 1/2" iron bar with the following witnesses:  
 Plat monument, Easterly, 33.00'  
 Concrete monument, Westerly, 33.00'  
 10" Oak, N39°W, 52.1'  
 Power pole, N84°W, 44.1'
7. Ron Helsel, LS #18994, recorded corner on 11/09/73 in Liber 1 of Surveys, Pages 1015-1017, as having found a 1/2" iron bar per the witnesses listed in #6 above.
8. James E. Stephens, LS #16053, recorded corner on 11/08/86 in Liber 6 of Corners, Page 302, and in Liber 5 of Surveys, Pages 81-87, as having found a 1 1/2" iron bar with the following witnesses:  
 10" Oak, N39°W, 52.1'  
 Utility pole, West, 44.35'  
 Plat monument, Easterly, 33.00'  
 Concrete monument, Westerly, 33.00'
9. The Michigan Department of Transportation on 12/22/92, with Thomas Moran, LS #25860, as Survey Chief, found a 1 1/2" square iron bar and set a cast iron monument box over the bar with the following witnesses:  
 East, 32.90', concrete plat monument  
 West, 32.85', concrete monument  
 West, 44.36', power pole (Nail South side)  
 S10°E, 40.63', 27" Oak, (Nail East side)  
 West, 9.40', centerline pavement (Cornell Road)
10. Thomas G. Moran, LS #25860, recorded corner on 02/23/93 in Liber 7 of Corners, Page 316, as having found a 1 1/2" iron bar in a monument box per the witnesses listed in #9 above.

Nov 15 11 40 AM '93  
REGISTER OF DEEDS  
*Paula Johnson*  
INGHAM COUNTY, MICH.

LAND CORNER RECORDATION CERTIFICATE  
Filing Requirement of Act 74, Mich. P.A. 1970

For corners in Ingham Located In: Corner Code ##  
(County)

1. Public Land Survey	T <u>4N</u> R <u>1W</u>	<u>K-10</u>
	T _____ R _____	_____
	T _____ R _____	_____
	T _____ R _____	_____
2. Property Controlling in Section	S _____ T _____ R _____	_____
	S _____ T _____ R _____	_____
3. Miscellaneous Property in Sec.	S _____ T _____ R _____	_____
	S _____ T _____ R _____	_____

4. Lot No. \_\_\_\_\_, Recorded Plat \_\_\_\_\_  
5. Private Claims \_\_\_\_\_

Register of Deeds Stamp & File Number

I, Larry A. Bryan, in a field survey on October 5, 19 93, do hereby certify that under requirements of P.A. 74, Michigan P.A. of 1970, the corner points mentioned in lines 1 and 2 above were in conformance with regulations and rules therefore as required in the current manual of survey instructions of the United States Department of the Interior, Bureau of Land Management or by a decree of a Court of Law and/or that the corner points mentioned in lines 3, 4 and 5 above were in conformance with the rules of the Michigan Board of Land Surveyors or by a Decree of a Court of Law; established, re-established, monumented, re-monumented, recovered, found as expressed below:

	A	B	C	D	E	F	G	H	I	J	K	L	M
2	6		5		4		3		2		1		
3													
4	7		8		9		10		11		12		
5													
6	18		17		16		15		14		13		
7													
8	19		20		21		22		23		24		
9													
10	30		29		28		27		26		25		
11													
12	31		32		33		34		35		36		
13													

NOTE: Not more than 4 corners, all in the same town and range, may be recorded on this certificate.

A. Description of original monument and accessories and/or subsequent restoration:  
K-10,

- 1. In 1827, Lucius Lyon, U.S. Deputy Surveyor, Set 1/4 Sec Post Maple 4in. N88W 42lks
- B. Ash 8 " S76E 18"

(Continued on Back)

B. Description of corner evidence found and/or method applied in restoring or reestablishing corner:

K-10, Investigation at this corner location revealed a 1" pipe in a 8" clay tile  $\pm$ 40' South of North edge of swamp under East line of Consumers Power Company wires. The 6" Maple in Item #3 above was found as well as Stephens tags in the two trees listed in Item #5. The 1" pipe was therefore accepted as the perpetuated location of K-10.

C. Description of monument for corner and accessories established to perpetuate locating the position of the corner:

K-10, T4N-R1W  
Found 1" pipe in 8" clay tile as noted above.  
Found nail & tag #16053 Northwest side 10" Hickory, N60°E, 76.21'  
Base of Southeast leg Consumers Power Tower, N03°W, 97.80'  
Set nail & tag #25832 North side 12" Maple, N75°E, 55.84'  
Set nail & tag #25832 South side 8" Oak, N40°W, 96.88'

Signed by *Larry A. Bryan* Date 10-5-93  
Surveyor's Michigan License No. 25832

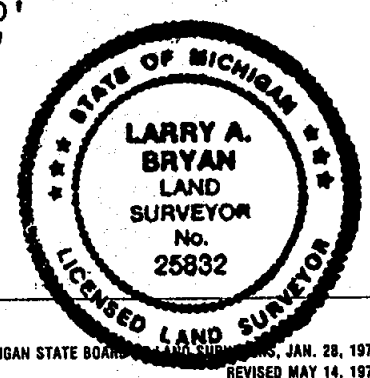

## PART "A" CONTINUED

2. Louis D. Preston, County Surveyor, recorded corner on April 13th, 1879 (Vol.2 P.84 of County Surveyor Records), as an original 1/4 Post with no witnesses given..
3. Phil Wetoskey, LS #19847, of the Michigan State Highway Department, witnessed corner in April 1967 as having found a 1" gas pipe witnessed by:  
N50W 39.34 4" Oak  
N22E 39.63 4" Maple  
N75E 56.02 6" Maple  
(from MDSH witness records)
4. Charles C. Wilson, LS #13604, recorded corner on 08/31/72 in Liber 2 of Corners, Page 89, as having found a 1 1/2" pipe in 8" tile in old fence N-S, 50' S of old fence E'LY, witnessed by:  
SE corner of tower N'LY 98'  
at North edge of swamp
5. James E. Stephens, LS #16053, recorded corner on 10/30/78 in Liber 5 of Corners, Page 64, and on 12/04/78 in Liber 3 of Surveys, Pages 641-652, as having found a 1" iron pipe inside a 10" clay pipe witnessed by:  
N3°W 97.97' to SE edge of base of SE leg of power tower  
N75°E 55.84' to nail and tag in North side of 11" Maple Tree  
N60°E 76.21' to nail and tag in NW side of twin 10" Shagbark Hickory Tree
6. Austin C. Williams, LS #21275, recorded corner on 11/17/78 in Liber 3 of Surveys, Pages 612-613, and on 04/02/79 in Liber 3 of Surveys, Pages 821-822, with no particular monument noted witnessed by:  
SE corner of tower N'ly 98' at edge of swamp
7. Douglas K. Richardson, LS #31603, recorded corner on 11/23/88 in Liber 5 of Surveys, Page 541, with no particular monument noted and no witnesses given.

2556





Nov 15 11 38 AM '93

LAND CORNER RECORDATION CERTIFICATE  
Filing Requirement of Act 74, Mich. P.A. 1970

For corners in

Ingham  
(County)

Located In:

Corner Code ##

- |                                    |   |    |   |    |      |
|------------------------------------|---|----|---|----|------|
| 1. Public Land Survey              | T | 4N | R | 1W | I-10 |
|                                    | T |    | R |    |      |
|                                    | T |    | R |    |      |
|                                    | T |    | R |    |      |
| 2. Property Controlling in Section | S |    | T | R  |      |
|                                    | S |    | T | R  |      |
| 3. Miscellaneous Property in Sec.  | S |    | T | R  |      |
|                                    | S |    | T | R  |      |
4. Lot No. \_\_\_\_\_, Recorded Plat \_\_\_\_\_
5. Private Claims \_\_\_\_\_

REGISTER OF DEEDS  
*Donald Johnson*  
INGHAM COUNTY, MICH.

Register of Deeds Stamp &amp; File Number

I, Larry A. Bryan, in a field survey on September 16, 19 93, do hereby certify that under requirements of P.A. 74, Michigan P.A. of 1970, the corner points mentioned in lines 1 and 2 above were in conformance with regulations and rules therefore as required in the current manual of survey instructions of the United States Department of the Interior, Bureau of Land Management or by a decree of a Court of Law and/or that the corner points mentioned in lines 3, 4 and 5 above were in conformance with the rules of the Michigan Board of Land Surveyors or by a Decree of a Court of Law; established, re-established, monumented, re-monumented, recovered, found as expressed below:

NOTE: Not more than 4 corners, all in the same town and range, may be recorded on this certificate.

A. Description of original monument and accessories and/or subsequent restoration:  
I-10,

1. In 1827, Lucius Lyon, U.S. Deputy Surveyor, Set 1/4 Sec. post.  
W.O. 12in S39W 50lks.  
Do 20" S52E 45"

(Continued on Back)

B. Description of corner evidence found and/or method applied in restoring or reestablishing corner:

I-10, Investigation at this corner location revealed a 1/2" bar and cap, number unreadable, ±1' North of the centerline of Hatch Road, ±49' East of the centerline of Greenwood Drive to the North. The witnesses of Wilson's remain: Busted up concrete plat monument N40°W 48.14', recorded 48.38' in Forest Hills Subdivision No.2, L19 Pg2, 8/15/55, by LaVerne J. Hendryx, LS #3276,; centerline of utility pole, North, ±38.1'; centerline 40" Oak, N75°E, ±68.4'; measured and recorded South 43.00' to concrete plat monument for Northwest corner River Downs Subdivision, L20 Pgs13-14, 8/01/56, by Harold R. Henry; 45" Oak, S60°W, ±42.5'; and the witnesses of the subsequent surveyors listed match closely with the location of the 1/2" bar. Excavation of a 12" X 18" area around the 1/2" bar revealed no additional evidence and therefore it was accepted as the perpetuated location of I-10.

C. Description of monument for corner and accessories established to perpetuate locating the position of the corner:

I-10, T4N-R1W  
Set 3/4" X 24" smooth steel bar and cap imprinted "PA345 PS 25832" in monument box.  
Found nail and tag #16053 North side 45" Oak, S60°W, 42.36'  
Found nail and tag #19003 West side utility pole, South, 30.10'  
Set nail and tag #25832 South side 18" Oak, N65°E, 44.34'  
Found nail and tag #16053 East side twin 10" Oak, N05°W, 26.12'

Signed by

Surveyor's Michigan License No. 25832Date 10-5-93

FORM APPROVED BY MICHIGAN STATE BOARD OF LAND SURVEYORS, JAN. 19, 1977

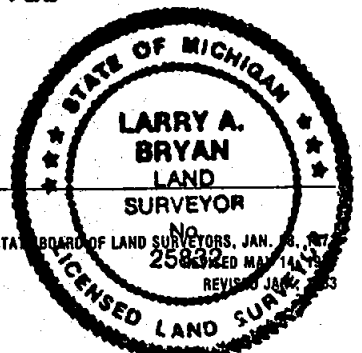
P.A. 345 INGHAM COUNTY  
PEER APPROVED 10/28/93

2552

## PART "A" CONTINUED

2. Charles C. Wilson, LS #13604, recorded corner on 08/31/72 in Liber 2 of Corners, Page 87, and in Liber 1 of Surveys, Pages 419-421, as having found a 3/4" iron pipe with the following witnesses:

Conc. Plat Monument S'LY 43.0

32" Oak S60°W 44.6

Conc. plat monument N40°W 48.2

Power Pole N'LY 38.2

36" Oak N75°E 68.4

3. James A. Porter, LS #19003, recorded corner on 06/05/75 in Liber 2 of Surveys, Pages 372-377 and 716-717, with no particular monument noted and no witnesses given.

4. Ron Helsel, LS #18994, recorded corner on 03/23/76 in Liber 2 of Surveys, Page 648, with no particular monument noted, with the following witness:

Conc. Mon. 43.0' South, NW Cor. River Down Sub.

5. Marvin Fouty, LS #18989, recorded corner on 09/07/76 in Liber 2 of Surveys, Page 861, with no reference to monument found, with the same witnesses as #2 above.

6. Larry A. Bryan, LS #25832, witnessed corner on 12/10/81 in Job #81-B-1028, as having found a 3/4" pipe in the centerline of Hatch Road with the following witnesses:

Fd. "Stephens" tag #16053 in North side 30" Oak, S60°W, 42.36'

Fd. "Porter" tag #19003 in West side Power pole, South, 30.10'

Centerline of Fire Hydrant, N30°W, 52.20'

7. James E. Stephens, LS #16053, recorded corner on 12/02/81 in Liber 4 of Surveys, Page 411, and on 02/05/82 in Liber 4 of Surveys, Page 498, as having found a 3/4" iron bar with the following witnesses:

Nail and tag in E. side 10" TW Oak NNW 26.08'

N&T in S. side 16" Oak NE 44.34'

N&T in N. side 40" Oak SW 42.38'

N&T in W. side ut. pole S 30.12'

8. Maurice H. Mahieu, LS #28414, recorded corner in Feb. 1986 in Liber 4 of Surveys, Page 1205, as a 1/2" iron bar with the same witnesses as #7 above.

9. Larry A. Bryan, LS #25832, recorded corner on 07/02/90 in Liber 6 of Surveys, Pages 227-228, as having found a bar and cap in the centerline of Hatch Road with the following witnesses:

Found nail and tag #16053 in East side of 12" twin Oak, N05°W, 26.12'

Found nail and tag #16053 in Southeast side 18" Oak, N50°E, 44.37'

Found nail and tag #16053 in North side 60" Oak, S60°W, 42.36'

Found nail and tag #16053 in West side utility pole, South, 30.10'

Nov 15 11 39 AM '93

LAND CORNER RECORDATION CERTIFICATE  
Filing Requirement of Act 74, Mich. P.A. 1970

REGISTER OF DEEDS

*Paula Johnson*

INGHAM COUNTY, MICH.

For corners in

Ingham

(County)

Located In:

Corner Code #

1. Public Land Survey

T 4N R 1W

J-10

T R

T R

T R

T R

2. Property Controlling  
in Section

S T R

S T R

3. Miscellaneous  
Property in Sec.

S T R

S T R

Register of Deeds Stamp &amp; File Number

4. Lot No. , Recorded Plat

5. Private Claims

	A	B	C	D	E	F	G	H	I	J	K	L	M
2	6		5		4		3		2		1		
3													
4	7		8		9		10		11		12		
5													
6	18		17		16		15		14		13		
7													
8	19		20		21		22		23		24		
9													
10	30		29		28		27		26		25		
11													
12	31		32		33		34		35		36		
13													

I, Larry A. Bryan, in a field survey on September 16, 19 93,

do hereby certify that under requirements of P.A. 74, Michigan P.A. of 1970, the corner points mentioned in lines 1 and 2 above were in conformance with regulations and rules therefore as required in the current manual of survey instructions of the United States Department of the Interior, Bureau of Land Management or by a decree of a Court of Law and/or that the corner points mentioned in lines 3, 4 and 5 above were in conformance with the rules of the Michigan Board of Land Surveyors or by a Decree of a Court of Law; established, re-established, monumented, re-monumented, recovered, found as expressed below:

NOTE: Not more than 4 corners, all in the same town and range, may be recorded on this certificate.

A. Description of original monument and accessories and/or subsequent restoration:  
J-10,

1. Center of Section 26, there is no record of this corner being established in original government survey.

(Continued on Back)

B. Description of corner evidence found and/or method applied in restoring or reestablishing corner:

J-10, Investigation at this corner location revealed a 1/2" bar 2' West of the centerline of Cornell Road and 9.2' North of the centerline of Hatch Road. The witnesses that remained of Helsel's and Bryan's checked closely with the location of the 1/2" bar. None of Wilson's witnesses were found. It was recorded by the Bryan survey and the Porter survey that the distance between J-10 and I-10 was 2638.91'. The Wilson survey records this distance as 2639.34'. Found Monument East 49.92', recorded 50.00' in The Shoals Subdivision, L36 Pgs12-13, 5/8/79, by James E. Stephens. Found monument N45°E 63.85', recorded 63.85' for Southwest corner Ashbury Commons Subdivision, L32 Pgs25-26, 2/12/74, by James A. Porter. Found monument N45°W 63.48', recorded 63.11' for Southeast corner of Cornell Woods No. 4 Subdivision, L45 Pgs46-49, 4/02/90,

(Continued on Back)

C. Description of monument for corner and accessories established to perpetuate locating the position of the corner:

J-10, T4N, R1W

Set 3/4" X 24" smooth steel bar and cap imprinted "PA 345 PS 25832" in monument box.

Set nail and tag #25832 West side 10" Oak, N30°E, 52.13'

Set nail and tag #25832 North side 18" Oak, East, 64.50'

Set nail and tag #25832 East side 14" Elm, S20°W, 159.91'

Set nail and tag #25832 South side 15" Oak, N75°W, 150.47'

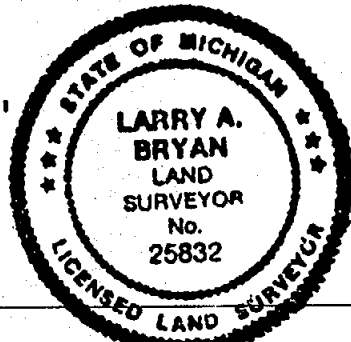
Signed by Larry A. BryanDate 10-5-93Surveyor's Michigan License No. 25832FORM APPROVED BY MICHIGAN STATE BOARD OF LAND SURVEYORS, JAN. 28, 1971  
REVISED MAY 14, 1975  
REVISED JAN., 1983P.A. 345 INGHAM COUNTY  
PEER APPROVED 10/28/93

2553

## PART "A" CONTINUED

2. Louis D. Preston, County Surveyor, established corner in a survey dated April 13, 1879. No specific monument was noted, it was witnessed by a 15" White Oak, S41°W, 119 links (Volume 2, Page 84).
3. Corner witnessed by Consumers Power Company as a 1 1/4" iron rod (date unknown, from Liber 2 of Corners, Page 81) witnessed by:  
24" Elm, NW, 40.5'  
Power Pole, E-NE, 19.4'  
Face of stone column, Southerly, 31.5'
4. Charles C. Wilson, LS #13604, recorded corner on 08/31/72 in Liber 2 of Corners, Page 81, and in Liber 1 of Surveys, Pages 419-421, as having found an iron rod per the witnesses listed in #3 above.
5. James A. Porter, LS #19003, recorded corner on 06/05/75 in Liber 2 of Surveys, Pages 372-377 and 716-717, with no particular monument noted and no witnesses given.
6. Ron Helsel, LS #18994, recorded corner on 03/23/76 in Liber 3 of Corners, Page 551, and in Liber 2 of Surveys, Page 648, as having found a 1 1/2" iron bar 15 feet more or less East of edge of bit. road, 10 feet more or less North of centerline of Hatch Road, 5 feet more or less West of centerline of Cornell Road. He noted that the witnesses as recorded by Charles C. Wilson in #4 above were not in accord with the position of the corner. Helsel's witnesses were as follows:  
South, 3.36 feet to East edge of East leg of road sign  
N45°W, 57.44', nail and tag in 24" Oak  
S87°E, 25.86', Polaris nail and tag in 30" Oak
7. Larry A. Bryan, LS #25832, recorded corner on 12/10/81 on Job No. 81-B-1028 as having found a 1/2" bar with the following witnesses:  
Found Polaris tag South side 30" Oak, S85°E, 25.86'  
Centerline of fire hydrant, S30°E, 61.90'  
Centerline of concrete light pole, S30°W, 48.00'

## PART "B" CONTINUED

by William A. Johnson, LS #14764. The location of the 1/2" bar was therefore accepted as the perpetuated location of J-10 and it was replaced with a 3/4" X 24" smooth steel bar and cap imprinted "PA 345 PS 25832" in monument box.

2553



Nov 15 11 39 AM '93

LAND CORNER RECORDATION CERTIFICATE  
Filing Requirement of Act 74, Mich. P.A. 1970

REGISTER OF DEEDS

Paula Johnson

INGHAM COUNTY, MICH.

For corners in

Ingham  
(County)

Located In:

Corner Code ##

- |                                    |           |      |
|------------------------------------|-----------|------|
| 1. Public Land Survey              | T 4N R 1W | K-11 |
|                                    | T R       |      |
|                                    | T R       |      |
|                                    | T R       |      |
| 2. Property Controlling in Section | S T R     |      |
|                                    | S T R     |      |
| 3. Miscellaneous Property in Sec.  | S T R     |      |
|                                    | S T R     |      |
4. Lot No. \_\_\_\_\_, Recorded Plat \_\_\_\_\_
5. Private Claims \_\_\_\_\_

Register of Deeds Stamp &amp; File Number

	A	B	C	D	E	F	G	H	I	J	K	L	M
2	6		5		4		3		2		1		
3													
4	7		8		9		10		11		12		
5													
6	18		17		16		15		14		13		
7													
8	19		20		21		22		23		24		
9													
10	30		29		28		27		26		25		
11													
12	31		32		33		34		35		36		
13													

I, Larry A. Bryan, in a field survey on September 9, 19 93, do hereby certify that under requirements of P.A. 74, Michigan P.A. of 1970, the corner points mentioned in lines 1 and 2 above were in conformance with regulations and rules therefore as required in the current manual of survey instructions of the United States Department of the Interior, Bureau of Land Management or by a decree of a Court of Law and/or that the corner points mentioned in lines 3, 4 and 5 above were in conformance with the rules of the Michigan Board of Land Surveyors or by a Decree of a Court of Law; established, re-established, monumented, re-monumented, recovered, found as expressed below:

NOTE: Not more than 4 corners, all in the same town and range, may be recorded on this certificate.

A. Description of original monument and accessories and/or subsequent restoration:  
K-11,

1. In 1827, Lucius Lyon, U.S. Deputy Surveyor, Set post Cor to  
Secs. 25, 26, 35 & 36 :  
Sycamore 10in N25E 131ks  
Maple 10" S30W 14"

B. Description of corner evidence found and/or method applied in restoring or reestablishing corner:

K-11, Investigation at this corner location revealed a 1 1/4" pipe ±45' East of the centerline of Consumers Power Towers and ±64' West of bank of Red Cedar River. The two sets of MDSH witnesses listed above in Items #3 & #5 are in conflict with each other. Both monuments called for in those witnesses were located. It appears from the second set of witnesses from MDSH in 1967, they found and accepted the 1 1/4" gas pipe set by Consumers Power Company, and these witnesses check closely with Stephens' and the location of the 1 1/4" pipe. It was therefore accepted as the perpetuated location of K-11.

C. Description of monument for corner and accessories established to perpetuate locating the position of the corner:

K-11, T4N-R1W  
Found 1 1/4" pipe as noted above.  
Set nail and tag #25832 North side 14" Maple, S80°E, 53.50'  
Set nail and tag #25832 East side twin 14" Box Elder, S35°E, 35.40'  
Set nail and tag #25832 North side 14" Ash, S80°W, 111.34'  
Set nail and tag #25832 West side twin 12" Ash, N30°E, 77.45'  
Southeast leg Consumers Power Tower, N13°W, 135.45'  
"T" Iron fence post, N50°E, 29.83'

Signed by Larry A. Bryan  
Surveyor's Michigan License No. 25832

Date 10-5-93

FORM APPROVED BY MICHIGAN STATE BOARD OF LAND SURVEYORS, JAN. 1971  
REVISED JAN., 1983

2554

P.A. 345 INGHAM COUNTY  
PEER APPROVED 10/21/93 R

## PART "A" CONTINUED

2. The corner is referred to as an "Original Corner" with no specific monument or accessories noted in a survey by County Surveyor Louis D. Preston on April 13, 1879.

3. The Michigan State Highway Department (MDSH) on 05/25/59, with C. Smith as the Survey Chief, found a 2" wooden stake and replaced it with a "T" iron fence post with the following witnesses:  
Southeast leg Consumers Power Tower, N28°W, 130.91'  
Rivers edge May 11, 1959, Due East, 32.0'  
(from MDSH witness records)

4. Records from an Ingham County Remonumentation Office Dossier for K-11 record Consumers Power Company (date unknown) as having found a hub stake and set a 1 1/4" x 30" gas pipe with the following witnesses:  
15' East of line of towers N. #2937  
Southeast leg of tower #2938, N13°20'W, 135.5'

5. The MDSH in April, 1967, with Philip Wetoskey, LS #19847, as the Survey Chief, found a 1 1/4" gas pipe with the following witnesses:  
N13°W, 135.50', Southeast leg Power Tower  
N78°E, 49.12', 9" Box Elder  
S80°E, 53.50', 9" Maple  
S35°E, 35.48', 12" Twin Box Elder  
(from MDSH witness records)

6. James E. Stephens, LS #16053, recorded corner on 10/03/78 in Liber 5 of Corners, Page 63, and on 12/04/78 in Liber 3 of Surveys, Pages 648-652, as having found a 1 1/4" iron pipe with the following witnesses:  
Southeast leg of Power tower, N13°W, 135.50'  
A tag in a 9" Box Elder, N78°E, 49.10'  
A tag in a 9" Maple tree, S80°E, 53.50'  
A tag in a 12" Box Elder, S35°E, 35.40'

2554

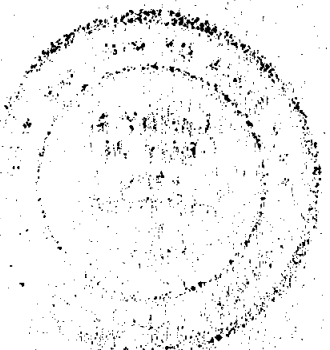

LAND CORNER RECORDATION CERTIFICATE  
Filing Requirement of Act 74, Mich. P.A. 1970

OCT 27 10 57 AM '93

For corners in

Ingham  
(County)

Located In:

Corner Code #

REGISTER OF DEEDS

INGHAM COUNTY, MICH.

1. Public Land Survey T 4N R 1W I-11  
T \_\_\_\_\_ R \_\_\_\_\_  
T \_\_\_\_\_ R \_\_\_\_\_  
T \_\_\_\_\_ R \_\_\_\_\_
2. Property Controlling S \_\_\_\_\_ T \_\_\_\_\_ R \_\_\_\_\_  
in Section S \_\_\_\_\_ T \_\_\_\_\_ R \_\_\_\_\_
3. Miscellaneous S \_\_\_\_\_ T \_\_\_\_\_ R \_\_\_\_\_  
Property in Sec. S \_\_\_\_\_ T \_\_\_\_\_ R \_\_\_\_\_

Register of Deeds Stamp & File Number

4. Lot No. \_\_\_\_\_, Recorded Plat \_\_\_\_\_
5. Private Claims \_\_\_\_\_

I, Larry A. Bryan, in a field survey on October 2, 19 93, do hereby certify that under requirements of P.A. 74, Michigan P.A. of 1970, the corner points mentioned in lines 1 and 2 above were in conformance with regulations and rules therefore as required in the current manual of survey instructions of the United States Department of the Interior, Bureau of Land Management or by a decree of a Court of Law and/or that the corner points mentioned in lines 3, 4 and 5 above were in conformance with the rules of the Michigan Board of Land Surveyors or by a Decree of a Court of Law; established, re-established, monumented, re-monumented, recovered, found as expressed below:

NOTE: Not more than 4 corners, all in the same town and range, may be recorded on this certificate.

A. Description of original monument and accessories and/or subsequent restoration:

I-11,

1. In 1827, Lucius Lyon, U.S. Deputy Surveyor, Set Post Cor to Secs. 26, 27, 34 & 35  
Be. 8in N24W 15lks.  
Sug 22" S24E 14"

(Continued on Back)

B. Description of corner evidence found and/or method applied in restoring or reestablishing corner:

I-11, Investigation at this corner location revealed a 4" square concrete monument with 1/2" bar ±18' East of tree line. All of the witness trees Fouty called for in Item #2 above remained including one of his tags in the 16" Walnut S14°W. A Stephens' tag was found close to the distance called for by Fouty in the 10" Elm Southwest. Another 4" square concrete monument with 1/2" bar was found South 144.36 feet in a Northwest-Southeast fence on the North side of railroad tracks. This monument is shown on the plat of Sylvan Glen Subdivision. The location of the witnessed monument was therefore accepted as the perpetuated location of I-11.

C. Description of monument for corner and accessories established to perpetuate locating the position of the corner:

I-11, T4N-R1W

- Found 4" square concrete monument with 1/2" bar as noted above.  
Found nail and tag #18989 West side 16" Walnut, S14°W, 123.14'  
Found nail and cap #16053 Northwest side 10" Elm, S45°W, 48.11'  
Set nail & tag #25832 West side 8" White Pine, S20°E, 24.79'  
Set nail & tag #25832 East side Twin 10" Elm, N05°W, 38.52'

Signed by Larry A. Bryan  
Surveyor's Michigan License No. 25832

Date 10-15-93

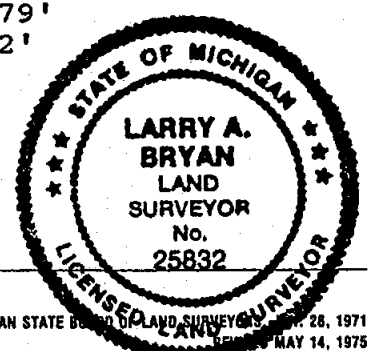

FORM APPROVED BY MICHIGAN STATE BOARD OF LAND SURVEYORS, MAY 14, 1975  
REVISED JAN., 1983

P.A. 345 INGHAM COUNTY  
PEER APPROVED 10/5/93 m

## PART "A" CONTINUED

2. Marvin F. Fouty, LS #18989, recorded corner on 09/04/74 in Liber 3 of Corners, Page 215, and on 11/08/74 in Liber 2 of Surveys, Pages 126-128, as having found a 4" square concrete monument with 1/2" bar from the recorded plat of Sylvan Glen Subdivision, Liber 20 of Plats, Page 32, on 12/05/56 by G.A. Steadman, witnessed by:

Nail and Tag in NE side 6" Twin Elm NW 38.52'

Nail and Tag in West side 4" Elm SW 48.15'

Nail and Tag in West side 16" Walnut S 123.20'

3. Marvin F. Fouty, LS #18989, recorded corner on 09/07/76 in Liber 2 of Surveys, Page 865, as a "Bar in Mon" with no witnesses given.

4. James E. Stephens, LS #16053, recorded corner on 01/05/78 in Liber 3 of Surveys, Page 211, and on 12/06/79 in Liber 3 of Surveys, Page 1095, as a 4" square mon. witnessed by:

Survey Tag #18989 Fnd. nailed to NE side 6" Twin Elm Tree NW 38.52'

Survey Tag #18989 Fnd. nailed to W. side 4" Elm SW 48.15'

Survey Tag #18989 Fnd. nailed to W. side 16" Walnut Tree S. 123.20'



LAND CORNER RECORDATION CERTIFICATE  
Filing Requirement of Act 74, Mich. P.A. 1970

OCT 27 10 57 AM '93

For corners in

Ingham  
(County)

Located In:

Corner Code =#

REGISTER OF DEEDS  
*Paul Johnson*  
INGHAM COUNTY, MICH.

- |                                    |                         |             |
|------------------------------------|-------------------------|-------------|
| 1. Public Land Survey              | T <u>4N</u> R <u>1W</u> | <u>J-11</u> |
|                                    | T _____ R _____         | _____       |
|                                    | T _____ R _____         | _____       |
|                                    | T _____ R _____         | _____       |
| 2. Property Controlling in Section | S _____ T _____ R _____ | _____       |
|                                    | S _____ T _____ R _____ | _____       |
| 3. Miscellaneous Property in Sec.  | S _____ T _____ R _____ | _____       |
|                                    | S _____ T _____ R _____ | _____       |

Register of Deeds Stamp &amp; File Number

4. Lot No. \_\_\_\_\_, Recorded Plat \_\_\_\_\_
5. Private Claims \_\_\_\_\_

	A	B	C	D	E	F	G	H	I	J	K	L	M
2	6		5		4		3		2		1		
3													
4	7		8		9		10		11		12		
5													
6	18		17		16		15		14		13		
7													
8	19		20		21		22		23		24		
9													
10	30		29		28		27		26		25		
11													
12	31		32		33		34		35		36		
13													

I, Larry A. Bryan, in a field survey on September 14th, 19 93, do hereby certify that under requirements of P.A. 74, Michigan P.A. of 1970, the corner points mentioned in lines 1 and 2 above were in conformance with regulations and rules therefore as required in the current manual of survey instructions of the United States Department of the Interior, Bureau of Land Management or by a decree of a Court of Law and/or that the corner points mentioned in lines 3, 4 and 5 above were in conformance with the rules of the Michigan Board of Land Surveyors or by a Decree of a Court of Law; established, re-established, monumented, re-monumented, recovered, found as expressed below:

NOTE: Not more than 4 corners, all in the same town and range, may be recorded on this certificate.

- A. Description of original monument and accessories and/or subsequent restoration:  
J-11,

1. Set 1/4 Sec. post on true line (From GLO Notes of Lucius Lyon, Deputy Surveyor, 1827)  
W.O. 3in. N31E 52lks  
B.O. 8" S43E 26"

(Continued on Back)

- B. Description of corner evidence found and/or method applied in restoring or reestablishing corner:

J-11, Investigation at this corner location revealed a 1 1/2" pipe on wire fence remains to West and South. Proved pipe to be the perpetuated location of J-11 by the Stephens' witnesses in #3 above.

- C. Description of monument for corner and accessories established to perpetuate locating the position of the corner:

J-11, T4N-R1W  
1 1/2" pipe as noted above  
Found nail and tag #16053 West side 20" Oak, N48°E, 33.15'  
Set nail and tag #25832 South side 20" Cherry, N86°W, 15.09'  
Set nail and tag #25832 West side 16" Ash, 37.04'  
Set nail and tag #25832 West side West trunk twin 8" Oak, N12°W, 37.15'



Signed by Larry A. Bryan  
Surveyor's Michigan License No. 25832

Date 10-13-93

## PART "A" CONTINUED

2. In a survey dated April 13, 1879 (Vol. 2, P. 84), Louis D. Preston, County Surveyor, recorded the original Quarter Post gone but gave the following witnesses with no particular monument noted:

White Oak 15 S29W 39L

W Oak 16 N22W 66L

3. James E. Stephens, LS #16053, recorded corner on 01/18/77 in Liber 4 of Corners, Page 3, as having found a 1 1/2" iron pipe at the base of an old fence, with pieces of the fence found North, South, and West of the corner, stating he had checked the records of 6 area Registered Land Surveyors, with the following witnesses:

Survey tag on the East side of a 16" Wild Cherry, N86°01'W, 14.66 feet

Survey tag on the Southwest side of a 12" Oak, N48°27'E, 33.21 feet

Survey tag on the Northwest side of a 8" Maple, S24°44'E, 36.81 feet

4. John A. Sellek, LS #2265, recorded corner on 05/15/80 in Liber 4 of Surveys, Pages 26-27, as having found a 1 1/2" pipe with the same witnesses as #3 above.