

For corners in  
ONONDAGA TOWNSHIP  
INGHAM COUNTY

**Corner Code #**

- |      |      |   |
|------|------|---|
| T 1N | R 2W | A5  |
| T    | R    |   |
| T    | R    |   |
| T    | R    | B:  |
| T    | R    | 2008  |
| T    | R    | Paul  |
| T    | R    |  |
| T    | R    |   |
| T    | R    |   |

**Pages: 2**

3. Miscellaneous  
Property in Sec.

4. Lot No. \_\_\_\_\_, Recorded Plat \_\_\_\_\_  
5. Private Claims \_\_\_\_\_

**NOTE: Not more than 2 comers, all in the same town and range, may be recorded on this certificate.**

[illegible]

- A. Description of original monument and accessories and/or subsequent restoration:

PLEASE SEE PAGE 2 FOR HISTORICAL INFORMATION

- B. Description of corner evidence found and/or method applied in restoring or reestablishing corner:

AMENDED A5 - M5 = 12.23', AMENDED A5 - B5 = 2797.76', AMENDED A5 - M6 = 2649.91', AMENDED A5 - A6 = 2651.36',  
AMENDED A5 - A7 = 5302.73'

STANDARD CORNER A5 - M5 = 12.23', STANDARD A5 - B5 = 2798.12', STANDARD A5 - M6 = 2649.91', STANDARD A5 - A6 = 2651.36', STANDARD A5 - A7 = 5302.73'

- C. Description of monument for corner and accessories established to perpetuate locating the position of the corner:

N35W, 48.08' SET REMON NAIL & TAG NORTHEAST SIDE 10" HICKORY  
S50W, 37.28' SET REMON NAIL & TAG SOUTHEAST SIDE 10" HICKORY  
S20E, 138.13' SET REMON NAIL & TAG SOUTHWEST SIDE POWER POLE  
N80E, 48.70 SET REMON NAIL & TAG SOUTH SIDE POWER POLE

P.A. 345 INGHAM COUNTY  
PEER APPROVED: 6/3/2008 *MC*

N35W, 47.87' SET REMON NAIL & TAG NORTHEAST SIDE 10" HICKORY  
S50W, 37.00' SET REMON NAIL & TAG SOUTHEAST SIDE 10" HICKORY  
S20E, 138.25' SET REMON NAIL & TAG SOUTHWEST SIDE POWER POLE  
N80E, 49.06' SET REMON NAIL & TAG SOUTH SIDE POWER POLE

REMON NAIL & TAG = SET MAGNETIC NAIL AND 1-1/2 " ALUMINUM TAG STAMPED "INGHAM COUNTY, MISSISSIPPI 345"

Signed by Wendy S. K. B.

Date 6/13/58

Surveyor's Michigan License No. 47969

FORM APPROVED BY MICHIGAN STATE BOARD OF PROFESSIONAL SURVEYORS, JAN. 28,  
1971  
REVISED MAY 14, 1975  
REVISED JAN. 1983

INGHAM COUNTY, ONONDAGA TOWNSHIP, T1N-R2W, CORNER A5

1 OCT-DEC 1825 - GLO - HARVEY PARKE, DEPUTY SURVEYOR - INTERSECTED RANGE LINE AND WEST BOUNDARY 21 LINKS (13.86') SOUTH OF POST AND SET POST  
WHITE OAK 24" N71W 25 LINKS (16.50')  
DOUBLE WHITE OAK 36" S30E 35 LINKS (23.10')  
A5-M5 = 21 LINKS (13.86') (GLO)  
A5-B5 = 42.14 CHAINS (2781.24')

2. 1841 - COUNTY SURVEYOR NOTES - BOOK 4 PAGE 25, A. JACKSON - LISTS WITNESSES BUT DOES NOT DESCRIBE CORNER  
SAME AS GLO

3. 1847 - COUNTY SURVEYOR NOTES - T.J. BROWN - LISTS WITNESSES BUT DOES NOT DESCRIBE  
SAME AS GLO

4. JANUARY 1, 1972 - ROAD COMMISSION NOTES - PLOW POINT, BRICK, IRON  
WEST 76.6' 20" HICKORY  
NORTH NORTHEAST 135.5' 12" HICKORY  
WEST 33.0' ANCHOR POST  
EAST 31.3' FENCE  
A5-M5 = NORTH 11.88'  
A5-A6 = 2626.14'  
A5-A7 = 79.93 CHAINS (5275.38)

5. DECEMBER 20, 1977 - CETA FILES - RON LESTER / L.FAUST - FOUND 1/2" BAR - 5' EAST OF CENTER OF WAVERLY ROAD  
WEST - BELL TELEPHONE CABLE BOX & TREE / FENCE LINE  
EAST 6.57' SET TRAVERSE POINT

NO ADDITIONAL EVIDENCE FOUND

LAND CORNER RECORDATION CERTIFICATE  
Filing Requirement of Act 74, Mich. P.A. 1970

For corners in  
ONONDAGA TOWNSHIP  
INGHAM COUNTY

Located In: Corner Code #

1. Public Land Survey

T 1N R 2W A6

2. Property Controlling  
In Section

S

T

R

3. Miscellaneous  
Property in Sec.

S

T

R

S

T

R

B: 13 P: 225 06/30/2008 08:33 AM  
2008-026356 LAND CORNERS Receipt #43397  
Paula Johnson, Ingham County, Michigan

Pages: 1



Register of Deeds Stamp & File Number

	A	B	C	D	E	F	G	H	I	J	K	L	M
1													
2	6		5		4		3		2		1		
3													
4	7		8		9		10		11		12		
5													
6	18		17		16		15		14		13		
7													
8	19		20		21		22		23		24		
9													
10	30		29		28		27		26		25		
11													
12	31		32		33		34		35		36		
13													

I, Wendy S. Parsons, in a field survey on FEBRUARY 28, 2008 do hereby state that under requirements of P.A. 74, Michigan P.A. of 1970, the corner points mentioned in lines 1 and 2 above were in conformance with regulations and rules therefore as required in the current manual of survey instructions of the United States Department of the Interior, Bureau of Land Management or by decree of a Court of Law and/or that the corner points mentioned in lines 3, 4 and 5 above were in conformance with the rules of the Michigan Board of Land Surveyors or by a Degree of a Court of Law; established, re-established, monumented, recovered, found as expressed below:

NOTE: Not more than 2 corners, all in the same town and range, may be recorded on this certificate.

A. Description of original monument and accessories and/or subsequent restoration:

1. NOT SET BY GLO

2. 1841 - COUNTY SURVEYOR NOTES - BOOK 4, PAGE 25, A. JACKSON - LISTS WITNESSES BUT DOES NOT DESCRIBE CORNER

S19W 55 LINKS (36.3') 20" WHITE OAK  
N51-1/2E 75 LINKS (49.5') 24" WHITE OAK  
A6 - B6 = 169 RODS (2788.50')

3. DECEMBER 20, 1977 - CETA - LARRY BRYAN / A. FAUST - NO INFORMATION REGARDING FOUND OR SET INFORMATION IN REGARDS TO CORNER A6.

NO ADDITIONAL INFORMATION FOUND

B. Description of corner evidence found and/or method applied in restoring or reestablishing corner:

SEARCHED APPARENT LOCATION FOR CORNER. NO OCCUPATION OR EVIDENCE OF CORNER WAS LOCATED. SET ONONDAGA CORNER A6 MIDWAY BETWEEN ONONDAGA CORNERS A7 AND A5 ON THE EATON COUNTY, HAMLIN TOWNSHIP M LINES. THE CALCULATED LOCATION FALLS 1.45 FEET SOUTH OF HAMLIN CORNER M5. SET 3/4" X 24" SOLID BAR AND 2-1/2" ALUMINUM CAP MARKED PA 345 INGHAM COUNTY AND STAMPED PS 47969 0.30 FEET BELOW GRADE, IN MONUMENT BOX, 2 FEET EAST OF CENTERLINE OF WAVERLY ROAD (ASPHALT) AND 1/2 MILE NORTH OF KINNEVILLE HIGHWAY.

A6 - M6 = NORTH 1.45', A6 - A5 = 2651.36', A6 - M5 = 2663.59', A6 - B6 = 2802.01', A6 - A7 = 2651.36', A6 - M7 = 2660.74'

C. Description of monument for corner and accessories established to perpetuate locating the position of the corner:

SET ONONDAGA CORNER A6 MIDWAY BETWEEN ONONDAGA CORNERS A7 AND A5 ON THE EATON COUNTY, HAMLIN TOWNSHIP M LINES. THE CALCULATED LOCATION FALLS 1.45 FEET SOUTH OF HAMLIN CORNER M5. SET 3/4" X 24" SOLID BAR AND 2-1/2" ALUMINUM CAP MARKED PA 345 INGHAM COUNTY AND STAMPED PS 47969 0.30 FEET BELOW GRADE, IN MONUMENT BOX, 2 FEET EAST OF CENTERLINE OF WAVERLY ROAD (ASPHALT) AND 1/2 MILE NORTH OF KINNEVILLE HIGHWAY.

N20W, 36.34' FOUND NAIL & TAG #18998 (RON LESTER), EAST NORTHEAST SIDE  
S50W, 42.03' FOUND NAIL & TAG #25832 (LARRY BRYAN), SOUTHEAST SIDE, 10" HICKORY  
S32E, 109.45' FOUND NAIL & TAG #25832, 31588, 41095 (LARRY BRYAN, JEFFERY AUTENRIETH, ANTHONY BUMSTEAD)  
NORTHEAST SIDE 18" MAPLE  
N78E, 33.98' NORTHWESTERLY EDGE OF BRICK VFW SIGN  
NORTH 1.45' HAMLIN CORNER M6

NOTE: FOUND NAIL & TAGS WERE ORIGINALLY SET TO WITNESS HAMLIN CORNER M6

Signed by WSP

Date 6/13/08

Surveyor's Michigan License No. 47969

FORM APPROVED BY MICHIGAN STATE BOARD OF PROFESSIONAL SURVEYORS, JAN. 28, 1971

P.A. 345 INGHAM COUNTY

PEER APPROVED 6/03/2008

REVISED MAY 14, 1975  
REVISED JAN., 1983  
REVISED OCT., 1995



For corners in  
ONONDAGA TOWNSHIP  
INGHAM COUNTY

Corner Code #

- T 1N R 2W A7

- S T R  
 S T R  
 S T R  
 S T R  
 S T R
- Paula  

- C T R  
S T R  
S T R

B: 13 P: 226 06/30/2008 08:33 AM  
2008-026357 LAND CORNERS Receipt #43397  
Paula Johnson, Ingham County, Michigan

**Pages: 3**



4. Lot No. \_\_\_\_\_, Recorded Plat \_\_\_\_\_  
5. Private Claims \_\_\_\_\_

I, Wendy S. Parsons, in a field survey on MARCH 4, 2008 do hereby state that under requirements of P.A. 74, Michigan P.A. of 1970, the corner points mentioned in lines 1 and 2 above were in conformance with regulations and rules therefore as required in the current manual of survey instructions of the United States Department of the Interior, Bureau of Land Management or by decree of a Court of Law and/or that the corner points mentioned in lines 3, 4 and 5 above were in conformance with the rules of the Michigan Board of Land Surveyors or by a Degree of a Court of Law; established, re-established, monumented, recovered, found as expressed below:

**NOTE:** Not more than 2 corners, all in the same town and range, may be recorded on this certificate.

**A. Description of original monument and accessories and/or subsequent restoration:**

PLEASE SEE PAGE 2 FOR HISTORICAL INFORMATION

B. Description of corner evidence found and/or method applied in restoring or reestablishing corner:

SEARCHED APPARENT LOCATION FOR CORNER, FOUND 1/2" ANGLE IRON 0.2' BELOW GRADE IN A MONUMENT BOX AT THE CENTERLINE INTERSECTION OF WAVERLY ROAD & KINNEVILLE HIGHWAY. FOUND POINT IS ON THE HAMLINE M-LINE. REMOVED ANGLE IRON AND FOUND A 3/4" PIPE WITH A 1/2" BAR INSIDE IT. FOUND MONUMENTATION TO BE CONSISTENT WITH PREVIOUSLY RECORDED WITNESSES. DISTANCES TO ADJACENT GOVERNMENT CORNERS TO THE NORTH AND SOUTH ARE IN HARMONY WITH PREVIOUSLY RECORDED INFORMATION. MEASUREMENTS TO B7 TO THE EAST ARE INCONSISTENT DUE TO A MULTIPLE CORNER SITUATION AT B7. ACCEPTED FOUND ANGLE IRON WITH 3/4" PIPE AND 1/2" BAR BELOW AND REPLACED WITH 3/4" X 24" SOLID BAR AND 2-1/2" ALUMINUM CAP MARKED PA 345 INGHAM COUNTY AND STAMPED PS 47969. REMONUMENTED POINT WAS SET 0.3' BELOW GRADE AND IN MONUMENT BOX IN THE CENTERLINE INTERSECTION OF WAVERLY ROAD (ASPHALT) & KINNEVILLE HIGHWAY (ASPHALT).

A7 - A6 = 2651.36', A7 - M6 (HAMLIN TWP.) = 2652.81', A7 - B7 = 2783.86', A7 - M7 (HAMLIN TWP.) = 9.38', A7 - A8 = 2658.80',  
A7 - M8 (HAMLIN TWP.) = 2668.46'

C. Description of monument for corner and accessories established to perpetuate locating the position of the corner:

ACCEPTED FOUND ANGLE IRON WITH 3/4" PIPE AND 1/2" BAR BELOW AND REPLACED WITH 3/4" X 24" SOLID BAR AND 2-1/2" ALUMINUM CAP MARKED PA 345 INGHAM COUNTY AND STAMPED PS 47969. REMONUMENTED POINT WAS SET 0.3' BELOW GRADE AND IN MONUMENT BOX AT THE CENTERLINE INTERSECTION OF WAVERLY ROAD (ASPHALT) & KINNEVILLE HIGHWAY (ASPHALT).

SOUTH 9.38' FOUND EATON COUNTY REMONUMENTATION BAR & CAP #47969 IN MONUMENT BOX ON THE CENTERLINE OF WAVERLY ROAD (HAMLIN M6).  
N55W 21.45' FOUND EATON COUNTY REMONUMENTATION BAR & CAP #47969 IN MONUMENT BOX ON THE CENTERLINE OF

N55W 81.45' FOUND EATON COUNTY REMON NAIL & TAG NORTHEAST SIDE 30" ELM  
N30E 99.71' FOUND EATON COUNTY REMON NAIL & TAG SOUTHEAST SIDE 12" BOX ELDER  
S10E 139.90' FOUND EATON COUNTY REMON NAIL & TAG WEST SIDE POWER POLE

REMON NAIL & TAG = SET MAGNETIC NAIL AND 1-1/2 " ALUMINUM TAG STAMPED "INGHAM COUNTY, WY" WITNESS P. 34

Signed by W.S.R. B.

Date 6/13/68

Surveyor's Michigan License No. 47969

FORM APPROVED BY MICHIGAN STATE BOARD OF PROFESSIONAL SURVEYORS, JAN. 28,  
1971  
REVISED MAY 14, 1975  
REVISED JAN., 1983  
REVISED OCT., 1995

P.A. 345 INGHAM COUNTY  
PEER APPROVED: 6/3/2008 *lu*

1. 1825 - GLO - HARVEY PARKE, DEPUTY SURVEYOR - INTERSECTED THE WEST BOUNDARY 14 LINKS (9.24')  
NORTH OF POST  
POPLAR 12" N84E 45-1/2 LINKS (30.03')  
BLACK OAK 8" S56E 59 LINKS (38.94')  
A7 - HAMLIN M7 = SOUTH 14 LINKS (9.24'), A7 - B7 = 42.24 CHAINS (2787.84')

2. JANUARY 1, 1972 - EATON COUNTY ROAD COMMISSION NOTES - 1" PIPE  
NE 45.0' ROAD SIGN  
ENE 114.1' 18" OAK  
SE 44.7' USGS BM  
SSW 66.4' 8" OAK

3. JUNE 22, 1972 - PA74 - LIBER 2, PAGE 21 - CLYDE STEPHENS PS#3829 -  
A: THE ORIGINAL MONUMENT AND ACCESSORIES OBLITERATED  
B: A "T" IRON WAS FOUND IN THE CENTERLINE OF THE TWO SECTION LINE ROADS (KINNEVILLE ROAD AND WAVERLY ROAD)  
C: THE "T" IRON FOUND AT THE NORTHWEST CORNER WAS LEFT IN POSITION WITH THE FOLLOWING WITNESSES  
N40°33'E 55.10' SURVEY TAG IN THE SW/S OF UTILITY POLE  
S63°58'E 41.79' SURVEY TAG IN THE NW/S OF UTILITY POLE  
S66°47'W 48.45' SURVEY TAG IN THE NE/S OF UTILITY POLE  
THE BEARING OF THE SECTION LINE EAST OF CORNER IS N89°25'E

4. MAY 17, 1977 - PA74 - LIBER 4, PAGE 80 - RON HELSEL, PS#18994  
A: ORIGINAL MONUMENT OBLITERATED  
B: FOUND "T" IRON AS RECORDED IN LIBER 2, PAGE 21 BY SURVEYOR STEPHENS - WITNESSES ALL OBLITERATED. SET NEW WITNESSES  
C: NW CORNER, SECTION 19  
S45E 44.66' USGS MON. GEOLOGICAL SURVEY  
N20W 94.31' NAIL & TAG IN 30" WILLOW TREE  
N45E 46.88' CENTERLINE CONCRETE MANHOLE (CATCHBASIN)  
N50W 81.62' 81.62' NAIL & TAG IN 24" CHINESE ELM TREE

5. MAY 17, 1977 PA132 - LIBER 2, PAGE 1226 - RON HELSEL, PS#18994 - FOUND "T" IRON AS RECORDED IN LIBER 2, PAGE 21 BY SURVEYOR STEPHENS. WITNESSES ALL OBLITERATED. SET NEW WITNESSES (SEE ITEM A4 ABOVE FOR WITNESSES)

6. JUNE 17, 1977 - PA132 - LIBER 2, PAGE 1246 - LAVERNE HENDRYX, PS#3276 - SHOWS CORNER ON SURVEY BUT DOES DESCRIBE OR LIST WITNESSES

7. NOVEMBER 3, 1977 - CETA NOTES - CREW: MARK Y. & DAVE K. - FOUND IRON BAR - NO ADDITIONAL INFORMATION OR WITNESSES LISTED

8. MARCH 28, 1978 - PA132 - LIBER 3, PAGE 456 - LAVERNE HENDRYX, PS#3276 - SHOWS CORNER ON SURVEY BUT DOES DESCRIBE OR LIST WITNESSES

9. JULY 29, 1986 - PA132 - LIBER 5, PAGE 425 - DOUGLAS RICHARDSON, PS#31603 - REFERS TO LIBER 4, PAGE 80  
A7 - B7 = 2783.35'

10. JULY 21, 1991 - PA132 - LIBER 6, PAGE 971 - DAVID LOHR - PS#30090 - FOUND IRON IN MON BOX  
AZ 315 (N45W) 46.24' SET N&T 10" TREE  
AZ 51 (N51E) 50.47' ROAD SIGN POST  
AZ 180 (SOUTH) 9.24' PIPE IN MON BOX  
AZ 228 (S48W) 42.37' STEEL ANCHOR POST  
A7 - B7 = 2726.15', A7 - M7 = SOUTH 9.24', A7 - M8 = 2668.63'

11. FEBRUARY 16, 1995 - PA74 - LIBER 8, PAGE 435 & MARCH 29, 1995 - PA 132 - LIBER 7, PAGE 630-631 - JAMES STEPHENS, PS#16053 -

A: ORIGINAL MONUMENT AND ACCESSORIES WERE NOT FOUND.  
B: 1/2" ANGLE IRON BAR IN MONUMENT BOX WAS FOUND AT INTERSECTION OF CENTERLINES OF WAVERLEY ROAD AND KINNEVILLE ROAD, AS INDICATED ON LAND CORNER RECORDATION CERTIFICATE RECORDED IN LIBER 4, PAGE 80. THIS CERTIFICATE IS BEING PREPARED TO UP-DATE WITNESS INFORMATION.  
C: 1/2" ANGLE IRON BAR IN MONUMENT BOX WITNESSED BY:  
SOUTH 9.24' 1/2" DIAMETER ROAD IN MONUMENT BOX  
S45E 46.63' 1/2" ROD AND CAP NO. 30090  
N45W 46.27' SET N&T NE/S 14" ELM TREE  
S45W 42.45' NE CORNER 3" STEEL ANGLE IRON CORNER FENCE POST

12. MARCH 29, 1995 - PA 132 - LIBER 7, PAGE 630-631 - JAMES STEPHENS, PS#16053 - 1/2" ANGLE IRON BAR IN MONUMENT BOX WAS FOUND AT INTERSECTION OF CENTERLINES OF WAVERLEY ROAD AND KINNEVILLE ROAD, AS INDICATED ON LAND CORNER RECORDATION CERTIFICATE RECORDED IN LIBER 4, PAGE 80 (SEE ITEM A-11 ABOVE FOR WITNESSES)  
A7 - B7 - 2726.15', A7 - HAMLIN M8 = 2668.63'

13. DECEMBER 12, 1996 - PA 132 - LIBER 6, PAGE 569, DECEMBER 20, 1996 - PA132 - LIBER 6, PAGE 585, FEBRUARY 6, 1997 - PA132 - LIBER 7, PAGE 5 & FEBRUARY 6, 1997 - PA132 - LIBER 7, PAGE 27 - LARRY BRYAN, PS#25832 - CORNER A7 IS LISTED AS A WITNESS TO CORNER M7 AND DESCRIBED AS FOUND ANGLE IRON IN MONUMENT BOX  
SOUTH 9.27' FOUND 1/2" BAR IN MONUMENT BOX 3' WEST OF CL OF WAVERLY ROAD AND 10' SOUTH OF CL OF KINNEVILLE ROAD (HAMLIN CORNER M7)

cont. on Page 3

14. DECEMBER 3, 1997 - PA132 - LIBER 8, PAGE 109 - JAMES STEPHENS, PS#16053 - 1/2" ANGLE IRON BAR IN MONUMENT BOX WITNESSED BY:  
SOUTH 9.24' 1/2" DIAMETER ROAD IN MONUMENT BOX  
S45E 46.63' 1/2" ROD AND CAP NO. 30090  
N45W 46.27' SET N&T NE/S 14" ELM TREE  
S45W 42.45' NE CORNER 3" STEEL ANGLE IRON CORNER FENCE POST  
A7 - HAMLIN M8 = 2668.58'

15. JULY 2, 2002 - PA132 - LIBER 10, PAGE 936 - ANTHONY BUMSTEAD, PS#41095 - CORNER A7 IS LISTED AS A WITNESS TO CORNER M7 AND DESCRIBED AS FOUND ANGLE IRON IN MONUMENT BOX (SEE ITEM A-13 ABOVE FOR WITNESSES)

16. OCTOBER 20, 2003 - PA132 - LIBER 8, PAGE 1249 - JEFF AUTENRIETH, PS#21588 - FOUND 1/2" ANGLE IRON IN MONUMENT BOX 4' WEST AND 15' OF INTERSECTION OF KINNEVILLE AND WATKINS ROADS.  
SOUTH 9.20' FOUND 1/2" BAR IN BOX  
S45E 46.15' FOUND 1/2" BAR  
S45W 42.42' NORTHEAST CORNER 3" STEEL ANGLE POST  
N45°8'W 46.27' SET KEBS N&T NE/S 20" ELM  
A7 - B7 = 2726.10, A7 - HAMLIN M7 = SOUTH 9.20

NO ADDITIONAL EVIDENCE FOUND

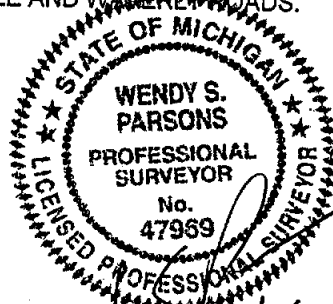

P.A. 345 INGHAM COUNTY  
PEER APPROVED 6/3/2008 *me*

LAND CORNER RECORDATION CERTIFICATE  
Filing Requirement of Act 74, Mich. P.A. 1970

For corners in  
ONONDAGA TOWNSHIP  
INGHAM COUNTY

Located In: Corner Code #

1. Public Land Survey

T 1N R 2W B5

2. Property Controlling  
In Section

S T R

3. Miscellaneous  
Property in Sec.

S T R

B: 14 P: 16 11/20/2008 11:14 AM  
2008-044685 LAND CORNERS Receipt #48240  
Paula Johnson, Ingham County, Michigan

Pages: 1



Register of Deeds Stamp & File Number

	A	B	C	D	E	F	G	H	I	J	K	L	M
1													
2	6		5		4		3		2		1		
3													
4	7		8		9		10		11		12		
5													
6	18		17		16		15		14		13		
7													
8	19		20		21		22		23		24		
9													
10	30		29		28		27		26		25		
11													
12	31		32		33		34		35		36		
13													

4. Lot No. \_\_\_\_\_, Recorded Plat \_\_\_\_\_

5. Private Claims \_\_\_\_\_

I, Wendy S. Parsons, in a field survey on MARCH 13, 2008 do hereby state that under requirements of P.A. 74, Michigan P.A. of 1970, the corner points mentioned in lines 1 and 2 above were in conformance with regulations and rules therefore as required in the current manual of survey instructions of the United States Department of the Interior, Bureau of Land Management or by decree of a Court of Law and/or that the corner points mentioned in lines 3, 4 and 5 above were in conformance with the rules of the Michigan Board of Land Surveyors or by a Degree of a Court of Law; established, re-established, monumented, recovered, found as expressed below:

NOTE: Not more than 2 corners, all in the same town and range, may be recorded on this certificate.

A. Description of original monument and accessories and/or subsequent restoration:

1826 - GLO - HARVEY PARKE, DEPUTY SURVEYOR - SET A 1/4 SECTION POST  
WHITE OAK 12" N36W 30 LINKS (19.80')  
MAPLE 18" S47E 31 LINKS (20.46')  
B5 - C5 = 40 CHAINS (2640'), B5 - A5 = 42.14 CHAINS (2781.24')

NO ADDITIONAL INFORMATION FOUND

P.A. 345 INGHAM COUNTY

PEER APPROVED 6/3/2008 M



B. Description of corner evidence found and/or method applied in restoring or reestablishing corner:

SEARCHED APPARENT LOCATION FOR CORNER. FOUND AREA WAS CLEARED FOR AGRICULTURAL USES IN THE PAST AND NO EVIDENCE OF ORIGINAL CORNER OR WITNESSES REMAIN. COMPUTED LOCATION OF B5 ON LINE BETWEEN CORNERS C5 AND A5 (AMENDED) AND SET AT A PRORATED DISTANCE OF 2655.85 FEET FROM C5. SET WITH 3/4" X 24" SOLID BAR AND 2-1/2" ALUMINUM CAP MARKED PA 345 INGHAM COUNTY AND STAMPED PS 47969 ON THE SIDE OF HILL APPROXIMATELY 100' WEST OF A WOODED AREA ON HIGH GROUND AND APPROXIMATELY 60 EAST OF A LOW AREA TO THE WEST, WITH STANDING WATER. SET CORNER WAS SET 2" ABOVE GRADE AND SURROUNDED BY THREE WOOD LATHS.

B5 - C5 = 2655.85', B5 - A5 (STANDARD) = 2798.12', B5 - A5 (AMENDED) = 2797.76'

C. Description of monument for corner and accessories established to perpetuate locating the position of the corner:

COMPUTED LOCATION OF B5 ON LINE BETWEEN CORNERS C5 AND A5 AND SET AT A PRORATED DISTANCE OF 2656.01 FEET FROM C5. SET WITH 3/4" X 24" SOLID BAR AND 2-1/2" ALUMINUM CAP MARKED PA 345 INGHAM COUNTY AND STAMPED PS 47969 ON THE SIDE OF HILL APPROXIMATELY 100' WEST OF A WOODED AREA ON HIGH GROUND AND APPROXIMATELY 60 EAST OF A LOW AREA TO THE WEST, WITH STANDING WATER. SET CORNER WAS SET 2" ABOVE GRADE AND SURROUNDED BY THREE WOOD LATHS

S60W 84.22' SET REMON NAIL & TAG NORTH SIDE 8" HICKORY 3 FEET ABOVE GRADE  
S88W 148.08' SET REMON NAIL & TAG SOUTH SIDE 20" TWIN HICKORY 1 FOOT ABOVE GRADE  
EAST 2656.01' FOUND INGHAM COUNTY REMON BAR & CAP IN MONUMENT BOX AT ONONDAGA CORNER C5  
WEST 2797.76' FOUND 3/4" PINCHED PIPE AT AMENDED CORNER A5 IN MON BOX 4 FEET EAST OF THE CENTERLINE OF WAVERLY ROAD (ASPHALT).  
WEST 2798.12' FOUND INGHAM COUNTY REMON BAR & CAP AT STANDARD CORNER A5 IN MON BOX 4 FEET EAST OF THE CENTERLINE OF WAVERLY ROAD (ASPHALT).  
SOUTH 2652.80' FOUND INGHAM COUNTY REMON BAR & CAP IN MONUMENT BOX AT ONONDAGA CORNER B6 AT THE NORTH BASE OF 4" WOOD FENCE POST.

REMON NAIL & TAG = SET MAGNETIC NAIL AND 1-1/2" ALUMINUM TAG STAMPED "INGHAM COUNTY WITNESS PA 345"

Signed by WSP BS.

Date 11/12/08

Surveyor's Michigan License No. 47969

LAND CORNER RECORDATION CERTIFICATE  
Filing Requirement of Act 74, Mich. P.A. 1970

For corners in  
ONONDAGA TOWNSHIP  
INGHAM COUNTY

Located In: Corner Code #

1. Public Land Survey T 1N R 2W B6  
T R  
T R  
T R  
2. Property Controlling S T R  
In Section S T R  
3. Miscellaneous S T R  
Property in Sec. S T R

B: 14 P: 17 11/20/2008 11:14 AM  
2008-044686 LAND CORNERS Receipt #48240  
Paula Johnson, Ingham County, Michigan

Pages: 2



4. Lot No. , Recorded Plat  
5. Private Claims

I, Wendy S. Parsons, in a field survey on MARCH 13, 2008 do hereby state that under requirements of P.A. 74, Michigan P.A. of 1970, the corner points mentioned in lines 1 and 2 above were in conformance with regulations and rules therefore as required in the current manual of survey instructions of the United States Department of the Interior, Bureau of Land Management or by decree of a Court of Law and/or that the corner points mentioned in lines 3, 4 and 5 above were in conformance with the rules of the Michigan Board of Land Surveyors or by a Degree of a Court of Law; established, re-established, monumented, recovered, found as expressed below:

NOTE: Not more than 2 comers, all in the same town and range, may be recorded on this certificate.

- A. Description of original monument and accessories and/or subsequent restoration:

PLEASE SEE PAGE 2 FOR HISTORICAL INFORMATION

Register of Deeds Stamp & File Number												
1	A	B	C	D	E	F	G	H	I	J	K	L
2	6	5	4	3	2	1						
3												
4	7	8	9	10	11	12						
5												
6	17	16	15	14	13							
7												
8	19	20	21	22	23	24						
9												
10	30	29	28	27	26	25						
11												
12	31	32	33	34	35	36						
13												

P.A. 345 INGHAM COUNTY  
PEER APPROVED 8/19/2008 M

- B. Description of corner evidence found and/or method applied in restoring or reestablishing corner:

SEARCHED APPARENT LOCATION OF CORNER AND FOUND 1/2" BAR AT THE NORTH BASE OF A 4"x4" WOOD FENCE POST AS SET BY RICHARDSON IN 1986, WITH OLD FENCE LINES RUNNING TO THE EAST AND WEST. NO EVIDENCE REMAINS OF FENCE LINE RUNNING TO NORTH AND SOUTH. EAST-WEST FENCE LINE IS IN THE NORTH EDGE OF LARGE WOODED AREA WITH AGRICULTURAL FIELDS TO THE NORTH. FOUND 2 WITNESSES TO BE CONSISTENT WITH THOSE NOTED BY LESTER IN 1999, ONE OF WHICH MATCHES RICHARDSON'S 1986 INFORMATION. MEASURED DISTANCES TO ADJOINING PLSS CORNERS ARE VARIABLE DUE TO MULTIPLE CORNER LOCATIONS AT CORNERS C6 AND B7. FOUND POINT TO BE 0.65 FEET SOUTH AND 11.06' EAST OF THE INTERSECTION OF THE 1/4 LINES AS REMONUMENTED. REPLACED FOUND 1/2" BAR WITH 3/4" X 24" SOLID BAR AND 2-1/2" ALUMINUM CAP MARKED PA 345 INGHAM COUNTY AND STAMPED PS 47969 AT THE NORTH BASE OF 4"x4" WOOD FENCE POST. REMON CORNER WAS SET 3" ABOVE GRADE.

B6 - A6 = 2802.01', B6 - B5 = 2652.80', B6 - C6 (AS REMONUMENTED) = 2653.25', B6 - PROPERTY CONTROLLING CORNER AT C6 = 2650.94; B6 - B7 (AS REMONUMENTED) = 2652.12'; B6 - PROPERTY CONTROLLING CORNER AT B7 = 2639.33',

- C. Description of monument for corner and accessories established to perpetuate locating the position of the corner:

REPLACED FOUND 1/2" BAR WITH 3/4" X 24" SOLID BAR AND 2-1/2" ALUMINUM CAP MARKED PA 345 INGHAM COUNTY AND STAMPED PS 47969 AT THE BASE OF 4"x4" WOOD FENCE POST. REMON CORNER WAS SET 3" ABOVE GRADE.

S73W 39.80' FOUND LESTER NAIL & TAG NORTH SIDE 24" OAK  
S40°W 24.44' FOUND LESTER NAIL & TAG NORTHWEST SIDE 24" CHERRY  
S30W 16.27' SET REMON NAIL & TAG NORTH SIDE 20" CHERRY  
N89E 40.44' SET REMON NAIL & TAG SOUTH SIDE 30" OAK

REMON NAIL & TAG = SET MAGNETIC NAIL AND 1-1/2 " ALUMINUM TAG  
STAMPED "INGHAM COUNTY WITNESS PA 345"

Signed by W.S. Parsons

Date 11/12/08

Surveyor's Michigan License No. 47969



1. NOT SET BY GLO

2. FEBRUARY 18, 1841 - COUNTY SURVEYOR NOTES BOOK 4, PAGE 25- A. JACKSON - NO DESCRIPTION OF CORNER NOTED ON SURVEY

WHITE OAK 16" N75W 36-1/2 LINKS (24.09')

WHITE OAK 11" N58-1/2E 46 LINKS (30.36')

B6 - A6 = 169 RODS (2788.50'), B6 - B7 = 159 RODS (2623.50')

3. JULY 29, 1986 - PA74 - LIBER 6, PAGE 358 - DOUGLAS K. RICHARDSON PS # 31603 - PART A: NOT ORIGINALLY MONUMENTED

PART B: ESTABLISHED CORNER AT THE INTERSECTION OF N-S AND E-W 1/4 LINE FENCES.

PART C: SET 1/2" IRON AND CAP

NAIL & TAG NORTH SIDE 15" OAK, S80W, 18.61'

NAIL & TAG WEST SIDE 12" CHERRY, S35W, 25.29'

NAIL & TAG WEST SIDE 8" OAK, S05W, 16.27'

NAIL & TAG NORTH SIDE 10" CHERRY, S40E, 16.44'

4. JULY 29, 1986 - PA132 - LIBER 5, PAGE 425 - DOUGLAS K. RICHARDSON PS # 31603 - SET 1/2" IRON AND CAP R.L.S. #12034 (FRED WHITE) AT INTERSECTION OF N-S AND E-W LINE FENCES.

NAIL & TAG NORTH SIDE 15" OAK, S80W, 18.61'

NAIL & TAG WEST SIDE 12" CHERRY, S35W, 25.29'

NAIL & TAG WEST SIDE 8" OAK, S05W, 16.27'

NAIL & TAG NORTH SIDE 10" CHERRY, S40E, 16.44'

B6 - C6 = 2652.10', B6 - B7 = 2653.23'

5. FEBRUARY 12, 1999 - PA132 - LIBER 8, PAGE 455 - RON LESTER PS #18998 - FOUND 1/2" BAR. LIBER 6, PAGE 358

SET GALVANIZED NAIL AND 1-1/4" BRASS TAG STAMPED #18998 LESTER  
NORTH SIDE 24" OAK AZ 253 (S73W), 18.50'

SET GALVANIZED NAIL AND 1-1/4" BRASS TAG STAMPED #18998 LESTER  
WEST SIDE 12" CHERRY AZ 216 (S36W), 25.29'

SET GALVANIZED NAIL AND 1-1/4" BRASS TAG STAMPED #18998 LESTER  
NORTH SIDE 12" CHERRY AZ 132 (S48E), 16.44'

SET GALVANIZED NAIL AND 1-1/4" BRASS TAG STAMPED #18998 LESTER  
NORTH SIDE 15" OAK AZ 266 (S86W), 39.79'

B6 - C6 = 2653.25'

NO ADDITIONAL EVIDENCE FOUND

LAND CORNER RECORDATION CERTIFICATE  
Filing Requirement of Act 74, Mich. P.A. 1970

For corners in  
ONONDAGA TOWNSHIP  
INGHAM COUNTY

Located In: Corner Code #

1. Public Land Survey

T 1N R 2W B7

2. Property Controlling  
In Section

S T R

3. Miscellaneous  
Property in Sec.

S T R  
S T R  
S T R

B: 14 P: 18 11/20/2008 11:14 AM  
2008-044687 LAND CORNERS Receipt #48240  
Paula Johnson, Ingham County, Michigan

Pages: 3



Register of Deeds Stamp & File Number

	A	B	C	D	E	F	G	H	I	J	K	L	M
1													
2	6		5		4		3		2		1		
3													
4	7		8		9		10		11		12		
5													
6	18		17		16		15		14		13		
7													
8	19		20		21		22		23		24		
9													
10	30		29		28		27		26		25		
11													
12	31		32		33		34		35		36		
13													

4. Lot No. \_\_\_\_\_, Recorded Plat \_\_\_\_\_  
5. Private Claims \_\_\_\_\_

I, Wendy S. Parsons, in a field survey on MARCH 10, 2008 do hereby state that under requirements of P.A. 74, Michigan P.A. of 1970, the corner points mentioned in lines 1 and 2 above were in conformance with regulations and rules therefore as required in the current manual of survey instructions of the United States Department of the Interior, Bureau of Land Management or by decree of a Court of Law and/or that the corner points mentioned in lines 3, 4 and 5 above were in conformance with the rules of the Michigan Board of Land Surveyors or by a Degree of a Court of Law; established, re-established, monumented, recovered, found as expressed below:

NOTE: Not more than 2 corners, all in the same town and range, may be recorded on this certificate.

A. Description of original monument and accessories and/or subsequent restoration:

PLEASE SEE PAGE 2 FOR HISTORICAL INFORMATION

B. Description of corner evidence found and/or method applied in restoring or reestablishing corner:

SEARCHED APPARENT LOCATION FOR CORNER. FOUND BOAT SPIKE DESCRIBED BY CLYDE STEPHENS IN 1972, IN THE CENTERLINE OF KINNEVILLE HIGHWAY CLOSE TO MIDWAY BETWEEN, BUT 13.8' NORTH OF LINE BETWEEN ONONDAGA CORNERS A7 & C7. ALSO FOUND BAR AND CAP #31603 AS SET BY RICHARDSON IN 1986, 2.7' SOUTH OF THE SOUTH EDGE OF PAVEMENT OF KINNEVILLE HIGHWAY, ON LINE WITH A FENCE LINE TO THE NORTH AND ONLINE BETWEEN ONONDAGA CORNERS A7 & C7. RICHARDSON'S BAR & CAP IS 13.79 FEET SOUTH AND 58.00 FEET EAST OF THE BOAT SPIKE. RICHARDSON'S BAR & CAP IS CLOSE TO 1 ROD WEST (MEASURED 16.21') OF THE PRORATED LOCATION OF CORNER B7

AS THIS IS A CLOSING SECTION, THE CORRECT PROCEDURE TO ESTABLISH THIS CORNER IS AT THE PRORATED GLO DISTANCE ONLINE AND BETWEEN CORNERS A7 AND C7 AND NOT AT THE MIDPOINT BETWEEN THEM. ACCEPTED SURVEYOR RICHARDSON'S POSITION AS AN OBLITERATED CORNER POSITION, ACCOUNTING FOR OCCUPATION IN THE IMMEDIATE VICINITY (FENCE LINE TO THE NORTH). EXCAVATED BELOW RICHARDSON'S CORNER THROUGH 18" OF GRAVEL AND 12" OF CLAY AND FOUND NO FURTHER EVIDENCE OF CORNER. THE RICHARDSON BAR AND CAP IS ACCEPTED AS ONONDAGA CORNER B7 AND WAS REPLACED WITH 3/4" X 24" SOLID BAR AND 2-1/2" ALUMINUM CAP MARKED PA 345 INGHAM COUNTY AND STAMPED PS 47969, 0.5' BELOW THE GRAVEL SHOULDER OF KINNEVILLE HIGHWAY, 2.7' SOUTH OF THE SOUTH EDGE OF ASPHALT. THE BOAT SPIKE IS ACCEPTED AS A PROPERTY CONTROLLING CORNER. SEE PAGE 3 FOR MEASURED DISTANCES TO ADJOINING GOVERNMENT CORNERS

C. Description of monument for corner and accessories established to perpetuate locating the position of the corner:

CORNER B7  
REPLACED FOUND BAR AND CAP #31603 WITH 3/4" X 24" SOLID BAR AND 2-1/2" ALUMINUM CAP MARKED PA 345 INGHAM COUNTY AND STAMPED PS 47969, 0.5' BELOW THE GRAVEL SHOULDER OF KINNEVILLE HIGHWAY, 2.7' SOUTH OF THE SOUTH EDGE OF ASPHALT  
N77W 59.58' FOUND BOAT SPIKE IN THE CENTERLINE OF KINNEVILLE HIGHWAY (PROPERTY CONTROLLING CORNER)  
N5°E 42.31' FOUND KEBS NAIL & TAG SOUTH SIDE 24" ELM  
S20W 56.10' SET REMON NAIL & TAG, NORTHWEST SIDE 12" PINE  
S80°W, 75.77' SET REMON NAIL & TAG, NORTH SIDE 8" ELM

PROPERTY CONTROLLING CORNER

FOUND BOAT SPIKE IN THE CENTERLINE OF KINNEVILLE HIGHWAY (ASPHALT)  
S77E 59.58' REMONUMENTED ONONDAGA CORNER B7  
N65°E 68.14' FOUND KEBS NAIL & TAG SOUTH SIDE 24" ELM  
S30E 76.62' SET REMON NAIL & TAG, NORTHWEST SIDE 12" PINE  
S30°W, 31.23' SET REMON NAIL & TAG, NORTH SIDE 8" ELM

KEBS NAIL & TAG = KYES ENGINEERING AND BRYAN SURVEYING NAIL & TAG STAMPED 25832 (LARRY BRYAN), 31588 (JEFF AUTENREITH), 41095 (ANTHONY BUMSTEAD), 39079 (MICHAEL GROAT)  
REMON NAIL & TAG = SET MAGNETIC NAIL AND 1-1/2" ALUMINUM TAG STAMPED "INGHAM COUNTY WITNESS PA 345"

Signed by W.S.P. PS.

Date 11/12/08

Surveyor's Michigan License No. 47969

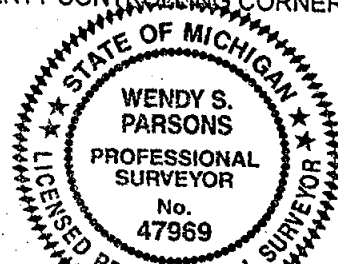

1. 1826 - GLO - HARVEY PARKE, DEPUTY SURVEYOR - SET 1/4 POST  
POPLAR 8" N75E 30 LINKS (19.80')  
ELM 8" S51W 18-1/2 LINKS (12.21')  
B7-A7 = 42.24 CHAINS (2787.84')  
B7-C7 = 40 CHAINS (2640')

2. FEBRUARY 18, 1841 - COUNTY SURVEYOR NOTES BOOK 4, PAGE 25- A. JACKSON - NO DESCRIPTION OF CORNER  
NOTED ON SURVEY  
ELM 8" S51W 18-1/2 LINKS (12.21')  
B6 - B7 = 159 RODS (2623.50')

3. JUNE 22, 1972 - PA74 - LIBER 2, PAGE 23 - CLYDE STEPHENS P.S.#3829 - A BOAT SPIKE WAS FOUND IN THE  
CENTERLINE OF THE SECTION LINE ROAD (KINNEVILLE ROAD)  
N33°06'E 56.50' SURVEY TAG IN THE SOUTHEAST SIDE 8" MULBERRY  
N65°43'E 64.60' SURVEY TAG IN TOP OF FENCE POST  
S33°13'W 99.00' SURVEY TAG IN NORTH SIDE 8" POPLAR  
INTERIOR ANGLE C7-B7-A7 = 179°25'

(BOAT SPIKE)

4. SEPTEMBER -OCTOBER 1972- PA132'S - LIBER 1, PAGE 590, 591, 592 - LAVERNE HENDRYX - PS #3276 - BOAT SPIKE  
- REFERS TO STEPHENS LCRC  
STEPHENS B7-C7 = 2725.45'

(BOAT SPIKE)

5. MAY 1, 1973 - PA132 - LIBER 1, PAGE 759 - JAMES STEPHENS, PS #16053 - REFERS TO LIBER 2, PAGE 23  
(BOAT SPIKE)

6. OCTOBER 5, 1973 - PA132 - LIBER 1, PAGE 1063 - RON LESTER PS #18998 - LISTS WITNESSES BUT DOES NOT  
DESCRIBE CORNER  
NNE 56.46' STEPHENS NAIL & TAG EAST SIDE 10" POPLAR  
NE 65.04' NAIL & TAG SE ANCHOR POST  
SW 98.93' STEPHENS NAIL & TAG EAST SIDE 8" TWIN POPLAR

(BOAT SPIKE)

7. MAY 17, 1977 - PA132 - LIBER 2, PAGE 1223 - RON HELSEL, PS #18994 - REFERS TO LIBER 2, PAGE 23  
(BOAT SPIKE)

8. JUNE 17, 1977 - PA132 - LIBER 2, PAGE 1246 - LAVERNE HENDRYX, PS # 3276, SURVEY SHOWS CORNER BUT DOES  
NOT DESCRIBE OR LIST WITNESSES  
(BOAT SPIKE)

9. DECEMBER 23, 1977 - CETA - LARRY BRYAN PS #228532 - FOUND RAILROAD SPIKE IN CENTERLINE BELLEVUE RD.  
207' +/- FROM EAST RAIL AT CROSSING  
N65°43'E 64.58' TOP OF FENCE POST  
N33°06'E 55.90' SURVEY TAG IN THE SOUTHEAST SIDE 8" MULBERRY  
S33°13'W 98.98' SURVEY TAG IN NORTH SIDE 8" POPLAR

(BOAT SPIKE)

10. MARCH 28, 1978 - PA132 - LIBER 3, PAGE 456 - LAVERNE HENDRYX, PS #3276 - SURVEY SHOWS CORNER BUT DOES  
NOT DESCRIBE OR LIST WITNESSES  
(BOAT SPIKE)

11. JULY 29, 1986 - PA74 - LIBER 6, PAGE 358 & PA132 - LIBER 5, PAGE 425- DOUG RICHARDSON - PS #31603 - RE-  
ESTABLISHED CORNER ON LINE BETWEEN SE AND SW SECTION CORNER ON PRODUCTION OF FENCE LINE TO THE  
NORTH. BOAT SPIKE RECORDED IN LIBER 2, PAGE 23 WAS FOUND TO BE AT SPLIT, MORE OR LESS, BETWEEN SE AND  
SW CORNERS AS WAS NOT ACCEPTED  
N77W 59.52' BOAT SPIKE  
NORTH 42.92' NAIL & TAG SOUTHWEST SIDE 15" ELM  
N40E 56.60' NAIL & TAG SOUTHEAST SIDE TRIPLE APPLE  
S80E 189.34' NAIL & TAG NORTH SIDE 15" ELM  
NORTH 13' CENTERLINE KINNEVILLE ROAD,  
B7-B6 = 2653.23',  
B7 - C7 = 2667.92',  
B7-A7 = 2725.35'

(RICHARDSON'S BAR & CAP)

12. JUNE 10, 1988 - PA132 - LIBER 5, PAGE 489 - DAVID LOHR, PS #30090 - FD BOAT SPIKE ON CL KINNEVILLE ROAD  
N10W 31.50' NAIL & TAG 6" TWIN ELM  
N65E 64.55' PK IN ANCHOR POST  
N75E 102.33' NAIL & TAG 10" CHERRY  
S80E 59.55' 1/2 B&C #12034  
B7-C7 = 2726.03'

(BOAT SPIKE)

13. JULY 24, 1991 - PA132 - LIBER 6, PAGE 971 - DAVID LOHR, PS #30090 - FD IRON ON CL  
AZ65 (N65E) 67.41' SET NAIL & TAG 14" ELM  
AZ205 (S25W) 36.28' SET NAIL & TAG 4" ELM  
AZ233 (S47W) 68.93' SET NAIL & TAG 5" PINE  
AZ345 (N15W) 31.49' SET NAIL & TAG 8" ELM  
B7-A7 = 2726.15'

(BOAT SPIKE)

14. DECEMBER 18, 1992 - PA132 - LIBER 6, PAGE 1185 - RON HELSEL PS #18994 - REFERS TO LIBER 2, PAGE 23, BUT WITNESSES LISTED CONFORM TO RICHARDSON 1986 CORNER - FOUND 1/2" IRON & CAP  
N77W, 59.52' BOAT SPIKE  
NORTH 43.25; NAIL & TAG SOUTHWEST SIDE 15" ELM  
S80E, 189.34'  
NAIL & TAG, NORTH SIDE 15" ELM  
NORTH 13' CL KINNEVILLE ROAD  
N55E 78.00' CENTER LINE RED GAS LINE RISER  
(RICHARDSON'S BAR & CAP)

15. FEBRUARY 28, 1995 - PA 74 - LIBER 8, PAGE 436 - JAMES STEPHENS PS #16053  
A. ORIGINAL MONUMENT AND ACCESSORIES WERE NOT FOUND  
B. FOUND BOAT SPIKE IN CENTERLINE OF KINNEVILLE ROAD AS INDICATED IN LAND CORNER RECORDATION CERTIFICATE RECORDED IN LIBER 6, PAGE 358. THIS CERTIFICATE IS BEING PREPARED TO UPDATE WITNESS INFORMATION  
C. BOAT SPIKE IN CENTERLINE OF KINNEVILLE ROAD WITNESSED BY:  
NAIL & TAG #25832 SOUTHEAST SIDE TWIN 12" ELM TREE, N10W 31.10'  
NAIL & TAG #16053 SOUTHEAST SIDE 16" ELM TREE, N50E 67.45'  
NAIL & TAG #16053 EAST SIDE 8" ELM TREE, S15W 36.15'  
NAIL & TAG #16053 SE/E 8" RED PINE TREE, S40W 68.92'  
(PART B REFERS TO RICHARDSON'S LCRC BUT PART C'S WITNESSES AGREE WITH BOAT SPIKE)

16. MARCH 29, 1995 - PA132 - LIBER 7, PAGE 630 & 631 - JAMES STEPHENS PS #16053 - BOAT SPIKE IN CENTERLINE OF KINNEVILLE ROAD WITNESSED BY:  
NAIL & TAG #25832 SOUTHEAST SIDE TWIN 12" ELM TREE, N10W 31.10'  
NAIL & TAG #16053 SOUTHEAST SIDE 16" ELM TREE, N50E 67.45'  
NAIL & TAG #16053 EAST SIDE 8" ELM TREE, S15W 36.15'  
NAIL & TAG #16053 SE/E 8" RED PINE TREE, S40W 68.92'  
STEPHENS CORNER B7-A7 = 2726.15'  
(BOAT SPIKE)

17. SEPTEMBER 14, 1998 - PLAT OF "ELK RIDGE" - MARVIN FOUTY, PS #1898 - LIBER 52 OF PLATS, PAGE 44-45 - REFERS TO LIBER 6, PAGE 358  
(RICHARDSON'S BAR & CAP)

18. DECEMBER 28, 1999 - PA132 - LIBER 8, PAGE 663 - MARVIN FOUTY, PS #18989 - REFERS TO LIBER 6, PAGE 358.  
B7 - C7 = 2668.00' (FOUTY 1999)  
(RICHARDSON'S BAR & CAP)

19. OCTOBER 20, 2003 - PA132 - LIBER 8, PAGE 1249 - JEFF AUTENRIETH, PS #31588 - REFERS TO LIBER 8, PAGE 436  
FOUND BOAT SPIKE IN CENTERLINE OF KINNEVILLE ROAD  
S15W 35.35' SET KEBS NAIL & TAG WEST SIDE 4" ELM  
S55W 69.74' SET KEBS NAIL & TAG NORTHWEST SIDE 8" POPLAR  
S10W 31.10' SET KEBS NAIL & TAG SOUTHEAST SIDE 20" TWIN ELM  
N50E 67.45' SET KEBS NAIL & TAG SOUTHEAST SIDE 18" ELM  
B7 - A7 = 2726.10'  
(BOAT SPIKE)

NO ADDITIONAL EVIDENCE FOUND

P.A. 345 INGHAM COUNTY  
PEER APPROVED 8/19/2008 *W*

PART B CONTINUED:

2008 MEASURED DISTANCES TO ADJOINING GOVERNMENT CORNERS:

B7 - B6 = 2652.12'  
B7 - C7 = 2667.82'  
B7 - A7 = 2783.86'  
B7 - CENTERLINE OF RAILROAD TRACKS - WEST 287'

PROPERTY CONTROLLING CORNER AT B7 (PCC/B7) - B6 = 2639.33',  
PCC/B7 - C7 = 2725.85'  
PCC/B7 - A7 = 2725.90'  
PCC/B7 - CENTERLINE OF RAILROAD TRACKS - WEST 255'

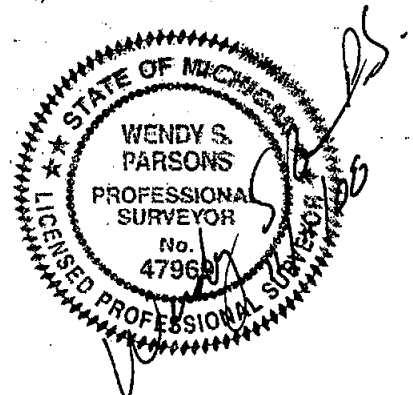

LAND CORNER RECORDATION CERTIFICATE  
Filing Requirement of Act 74, Mich. P.A. 1970

For corners in  
ONONDAGA TOWNSHIP  
INGHAM COUNTY

Located In:

Corner Code #

1. Public Land Survey

T 1N R 2W C5

2. Property Controlling  
In Section

S T R  
S T R  
S T R  
S T R

3. Miscellaneous  
Property in Sec.

B: 14 P: 19 11/20/2008 11:14 AM  
2008-044688 LAND CORNERS Receipt #48240  
Paula Johnson, Ingham County, Michigan

Pages: 2



4. Lot No. \_\_\_\_\_, Recorded Plat \_\_\_\_\_

5. Private Claims \_\_\_\_\_

I, Wendy S. Parsons, in a field survey on MARCH 11, 2008 do hereby state that under requirements of P.A. 74, Michigan P.A. of 1970, the corner points mentioned in lines 1 and 2 above were in conformance with regulations and rules therefore as required in the current manual of survey instructions of the United States Department of the Interior, Bureau of Land Management or by decree of a Court of Law and/or that the corner points mentioned in lines 3, 4 and 5 above were in conformance with the rules of the Michigan Board of Land Surveyors or by a Degree of a Court of Law; established, re-established, monumented, recovered, found as expressed below:

NOTE: Not more than 2 corners, all in the same town and range, may be recorded on this certificate.

A. Description of original monument and accessories and/or subsequent restoration:

PLEASE SEE PAGE 2 FOR HISTORICAL INFORMATION

Register of Deeds Stamp & File Number

	A	B	C	D	E	F	G	H	I	J	K	L
1												
2	6		5		4		3		2		1	
3												
4	7		8		9		10		11		12	
5												
6	18		17		16		15		14		13	
7												
8	19		20		21		22		23		24	
9												
10	30		29		28		27		26		25	
11												
12	31		32		33		34		35		36	
13												

P.A. 345 INGHAM COUNTY

PEER APPROVED 8/19/2008 *W*

B. Description of corner evidence found and/or method applied in restoring or reestablishing corner:

SEARCHED APPARENT LOCATION FOR CORNER. FOUND 3/4" BAR IN A SMALL, DAMAGED MONUMENT BOX, 1 FOOT WEST OF THE CENTERLINE OF GALE ROAD (ASPHALT). REMOVED MONUMENT BOX AND EXCAVATED THROUGH ASPHALT, 6" OF SAND AND 12" OF SAND AND FOUND NO FURTHER EVIDENCE OF CORNER. DID NOT EXCAVATE FURTHER DUE TO LESTER'S EXTENSIVE WORK IN 1978. LOCATED MULTIPLE WITNESSES WHICH DATE BACK TO GEER'S 1998 SURVEY AND SURVEYS BY HELSEL AND BELAND. MEASUREMENTS TO THE SOUTH IS IN AGREEMENT WITH CLOSE ACCORD WITH THAT SET BY THE GLO AS 3.21 CHAINS (211.86'). REPLACED 3/4" BAR WITH 3/4" X 24" SOLID BAR MONUMENT BOX, 1 FOOT WEST OF THE CENTERLINE OF GALE ROAD.

C5 - C3 = 5310.55', C5 - NORTH EDGE OF GRAND RIVER = 407.94', C5 - SOUTH EDGE GRAND RIVER = 205.38', C5 - E5 = 5362.78', C5 - C6 (REMON) = 2652.76', C5 - C6 (PROPERTY CONTROLLING CORNER) = 2653.49', C5 - B5 = 2655.85'

C. Description of monument for corner and accessories established to perpetuate locating the position of the corner:

REPLACED 3/4" BAR WITH 3/4" X 24" SOLID BAR AND 2-1/2" ALUMINUM CAP MARKED PA 345 INGHAM COUNTY AND STAMPED PS 47969 0.3' BELOW GRADE IN A NEW MONUMENT BOX, 1 FOOT WEST OF THE CENTERLINE OF GALE ROAD.

N43°E, 66.50' FOUND NAIL & TAG, WEST SIDE 24" OAK  
N50°E 38.82' FOUND NAIL & TAG, NORTHWEST SIDE 22" OAK  
S27°W 68.10' FOUND NAIL & TAG SOUTHEAST SIDE 14" LOCUST  
N45°W, 45.25' FOUND NAIL & TAG NORTHEAST SIDE 18" HICKORY

P.A. 345 INGHAM COUNTY

PEER APPROVED \_\_\_\_\_



Signed by

*Wendy S. Parsons*

Date

11/12/08

Surveyor's Michigan License No.

47969

1. 1825 - GLO - HARVEY PARKE, DEPUTY SURVEYOR - SET POST CORNER TO SEC. 7,8,17 & 18  
 MAPLE 12" S74W, 7-1/2 LINKS (4.95')  
 BLACK OAK 7" S03E - 24 LINKS (15.84')  
 C5 - C4 = 40 CHAINS (2640'), C5 - D5 = 40.34 CHAINS (2662.44'), C5 - C6 = 40 CHAINS (2640'), C5 - B5 = 40 CHAINS (2640'), C5 - MC A (NORTH) 3.21 CHAINS (211.86'), C5 - MC B (NORTH) 5.31' CHAINS (350.46'), C5 - MC C (EAST) = 30.59 CHAINS (2018.94'), C5 - MC D (EAST) = 32.16 CHAINS (2122.56')
2. NOVEMBER 13, 1847 - COUNTY SURVEYOR NOTES - BOOK C - PAGE 4- TJ BROWN - DOES NOT DESCRIBE CORNER, WITNESSES ARE SAME AS GLO
3. JUNE 9, 1978 - PA74 - LIBER 4, PAGE 366 - RON LESTER - PS #18998
  - A. POST SET BY HARVEY PARKE IN ORIGINAL GOVERNMENT SURVEY DATED OCT., 1825 TO JAN. 1826. CORNER REFERRED TO IN SURVEY BY TJ BROWN, COUNTY SURVEYOR, DATED NOV. 13, 1847 (v.C, p.4)
  - B. EXCAVATED HOLE 10'x15' TO AN AVERAGE DEPTH OF 3.5' IN CENTERLINE OF GALE ROAD AND CENTERED ON EXTENDED FENCE LINE EAST. FOUND 3/4" x2' WHITE PAINTED PIPE JUST BELOW ROAD SURFACE ON FENCE LINE TO EAST AND IN CENTERLINE OF GALE ROAD. FOUND 3 PLOW PRONGS, 3.5' BELOW SURFACE ALONG SIDE AND BENT OVER A 1" x 2.5' IRON ROD SUPPORTED BY 2 WOOD STAKES 6" APART, +/- 1.5' WEST OF CENTERLINE OF GALE ROAD ON EXTENDED FENCE LINE EAST. ACCEPTED 1" ROD AS CORNER. EXCAVATION CONDUCTED BY INGHAM COUNTY SURVEY & REMONUMENTATION PROJECT CREW
  - C. SET 4" x 36" CONCRETE MONUMENT WITH 1/2"x38" REROD WITH CAP #18998 AND CONCRETE COLLAR AND COVER AT LOCATION OF IRON BAR DESCRIBED ABOVE  
 EAST NORTHEAST 44.00' NAIL & TAG #18998 NORTH SIDE 30" OAK  
 SOUTHEAST, 39.15' NAIL & TAG #18998 SOUTHWEST SIDE 12" OAK  
 WEST SOUTHWEST, 30.35' NAIL & TAG #18998 NORTH SIDE 10" HICKORY  
 NORTHWEST 44.48' NAIL & TAG #18998 EAST SIDE 16" WALNUT
4. OCTOBER, 1979 - PA132 - LIBER 3, PAGE 1074 - AUSTIN WILLIAMS PS #21275 - DOES NOT DESCRIBE CORNER, SEE WITNESSES BELOW  
 EAST NORTHEAST 44.00' NAIL & TAG #18998 NORTH SIDE 30" OAK  
 SOUTHEAST, 39.15' NAIL & TAG #18998 SOUTHWEST SIDE 12" OAK  
 WEST SOUTHWEST, 30.35' NAIL & TAG #18998 NORTH SIDE 10" HICKORY  
 NORTHWEST 44.48' NAIL & TAG #18998 EAST SIDE 16" WALNUT  
 C5 - D5 = 2659.99', C5 - E5 = 5365.51'
5. NOVEMBER 25, 1998 - PA74 - LIBER 9, PAGE 445 - J. DEAN GEERS PS #33977 - FOUND PK NAIL NEAR CENTER OF ROAD WAY - SET MONUMENT BOX WITH 3/4" IRON PIN  
 N43E 66.54' NAIL IN WEST SIDE 525mm (20") WHITE OAK  
 S55E 38.75' NAIL IN SOUTHWEST SIDE 450mm (18") LOCUST  
 S27W 68.14' NAIL IN SOUTHEAST SIDE 375mm (15") LOCUST  
 N46W 45.23' NAIL IN NORTHEAST SIDE 650mm (25") HICKORY
6. JUNE 26, 2001 - PA132 - LIBER 8, PAGE 921 - RON HELSEL PS #18994- FOUND 3/4" PIPE IN MON BOX IN CL OF GALE ROAD  
 NAZ 27 (N27E) 57.0' SET NAIL & TAG TOP OF GUARD RAIL POST  
 NAZ 122 (S58E) 38.15' FOUND B & C #18989  
 (NO BEARING) 45.25' FOUND SURVEY MARKER SPIKE NORTHEAST SIDE 14" HICKORY  
 NAZ 262 (S82W) 43.85' SET NAIL & TAG N SIDE 14" LOCUST  
 C5 - C6 = 2652.99'
7. JULY 7, 2003 - PA132 - LIBER 8, PAGE 1187 - JEFF AUTENREITH PS #31588 - REFERS TO LIBER 9, PAGE 445 (1979 GEERS PA74) - FOUND 3/4" BAR IN CENTERLINE OF GALE ROAD IN MONUMENT BOX  
 N40W 44.77' FOUND NAIL & TAG #18998 E SIDE 18" WALNUT  
 N70E 43.88' FOUND NAIL & TAG NORTHWEST SIDE 22" OAK  
 S50E 38.82' FOUND NAIL & TAG SOUTHWEST SIDE 18" LOCUST  
 S40W 68.23' FOUND SURVEY MARKER IN E SIDE 20" LOCUST  
 C5 - C4 = 2660.61'
8. AUGUST 18, 2005 - PA132 - LIBER 9, PAGE 221 - CHRISTOPHER BELAND PS #49106 - REFERS TO LIBER 9, PAGE 445 - FOUND FORM PIN IN MONUMENT BOX, 1' WEST OF CL OF GALE ROAD  
 N43E 66.65' FOUND NAIL & TAG WEST SIDE 24" OAK  
 S27W 68.15' FOUND NAIL & TAG SOUTHEAST SIDE 14" LOCUST  
 N46W 45.25' FOUND NAIL & TAG NORTHEAST SIDE 18" HICKORY  
 S55E 30.08' FOUND NAIL & TAG #18994 - NORTH SIDE 12" LOCUST  
 C5 - C6 = 2652.87'

NO ADDITIONAL EVIDENCE FOUND

LAND CORNER RECORDATION CERTIFICATE  
Filing Requirement of Act 74, Mich. P.A. 1970

For corners in  
ONONDAGA TOWNSHIP  
INGHAM COUNTY

Located In: Corner Code #

1. Public Land Survey T 1N R 2W C6  
T R  
T R  
T R  
2. Property Controlling S T R  
In Section S T R  
3. Miscellaneous S T R  
Property in Sec. S T R

B: 14 P: 20 11/20/2008 11:14 AM Pages: 3  
2008-044689 LAND CORNERS Receipt #48240  
Paula Johnson, Ingham County, Michigan



Register of Deeds Stamp & File Number

1	A	B	C	D	E	F	G	H	I	J	K	L	M
2	6		5		4		3		2		1		
3													
4	7		8		9		10		11		12		
5													
6	18		17		16		15		14		13		
7													
8	19		20		21		22		23		24		
9													
10	30		29		28		27		26		25		
11													
12	31		32		33		34		35		36		
13													

4. Lot No. , Recorded Plat  
5. Private Claims

I, Wendy S. Parsons, in a field survey on FEBRUARY 22, 2008 & JULY 8, 2008 do hereby state that under requirements of P.A. 74, Michigan P.A. of 1970, the corner points mentioned in lines 1 and 2 above were in conformance with regulations and rules therefore as required in the current manual of survey instructions of the United States Department of the Interior, Bureau of Land Management or by decree of a Court of Law and/or that the corner points mentioned in lines 3, 4 and 5 above were in conformance with the rules of the Michigan Board of Land Surveyors or by a Degree of a Court of Law; established, re-established, monumented, recovered, found as expressed below:

NOTE: Not more than 2 corners, all in the same town and range, may be recorded on this certificate.

A. Description of original monument and accessories and/or subsequent restoration:

PLEASE SEE PAGE 2 FOR HISTORICAL INFORMATION

B. Description of corner evidence found and/or method applied in restoring or reestablishing corner:

PLEASE SEE PAGE 3 FOR CORNER EVIDENCE AND RESTORATION INFORMATION

C. Description of monument for corner and accessories established to perpetuate locating the position of the corner:

CORNER C6

ACCEPTED THE FOUND 5/8" BAR WITH UNREADABLE CAP AS ONONDAGA CORNER C6 AND REPLACED IT WITH 3/4" X 24" SOLID BAR AND 2-1/2" ALUMINUM CAP MARKED PA 345 INGHAM COUNTY AND STAMPED PS 47969 IN A MONUMENT BOX, 1 FOOT WEST OF THE CENTERLINE OF GALE ROAD (ASPHALT)

S85°W, 2.42' FOUND 1/2" BAR IN ASPHALT (PROPERTY CONTROLLING CORNER)

S35°E, 43.23 FOUND NAIL & TAG #25832 (LARRY BRYAN), WEST SIDE 24" MAPLE

N62°W, 112.70' SOUTHEAST CORNER OF FOUNDATION AT HOUSE #3728 GALE ROAD

S62°W, 26.42' SET REMON NAIL & TAG EAST SIDE 12" WALNUT

N38°W, 48.54' SET REMON NAIL & TAG, EAST SIDE 46" OAK

PROPERTY CONTROLLING CORNER

FOUND 1/2" BAR, 3.3' WEST OF THE CENTERLINE OF GALE ROAD (ASPHALT)

N85°E, 2.42' REMONUMENTED ONONDAGA CORNER C6

S38°E, 44.00 FOUND NAIL & TAG #25832 (LARRY BRYAN), WEST SIDE 24" MAPLE

N61°W, 111.03' SOUTHEAST CORNER OF FOUNDATION AT HOUSE #3728 GALE ROAD

S61°W, 24.04' SET REMON NAIL & TAG EAST SIDE 12" WALNUT

N35°W, 47.76' SET REMON NAIL & TAG, EAST SIDE 46" OAK

REMON NAIL & TAG = SET MAGNETIC NAIL AND 1-1/2" ALUMINUM TAG STAMPED "INGHAM COUNTY WITNESS PA 345

Signed by WSP

Date 11/13/08

Surveyor's Michigan License No. 47969

FORM APPROVED BY MICHIGAN STATE BOARD OF PROFESSIONAL SURVEYORS, JAN. 28, 1971

REVISED MAY 14, 1975  
REVISED JAN., 1983  
REVISED OCT., 1995



**PART A:**

**1. 1826 - GLO - HARVEY PARKE, DEPUTY SURVEYOR - SET 1/4 SEC POST**

WHITE OAK 11" N89E 2.8 LINKS (1.84')

WHITE OAK 12" S75W 14 LINKS (9.24')

C6 - C5 = 40 CHAINS (2640'), C6 - C7 = 40 CHAINS (2640')

**2. JANUARY 22, 1848 - COUNTY SURVEYOR NOTES, BOOK 2, PAGE 46 - A. JACKSON - SHOWS CORNER ON SKETCH BUT DOES NOT LIST WITNESSES OR DIST TO ADJ. GOVERNMENT CORNERS**

**3. 1854 - ADDITIONAL WITNESSES LISTED IN GLO MARGINS**

BLACK OAK 12" S87E 40 LINKS (26.4')

WHITE OAK 22" N31W 73 LINKS (48.18')

**4. APRIL 9, 1877 - COUNTY SURVEYOR NOTES- BOOK 2, PAGE 149- A.P. DRAKE - STONE**

BLACK OAK 12" S87E 40 LINKS (26.4')

WHITE OAK 22" N31W 73 LINKS (48.18')

HICKORY 12" S28W 81 LINKS (53.46')

MAPLE 5" N50E 61-1/2 LINKS (40.59')

**5. FEBRUARY 18, 1892 - COUNTY SURVEYOR NOTES FROM CETA FILE - A. JACKSON - SHOWS CORNER ON SKETCH BUT DOES NOT DESCRIBE, WITNESSES LISTED BELOW**

BLACK OAK 12" S87E 20 LINKS (13.2')

WHITE OAK 22" N31W 73 LINKS (48.18')

**6. MAY -JUNE 1978 - CETA FILES - FIELD NOTES - L. BRYAN - PS #25832 - EXCAVATED 10' x15' AREA INCLUDING AREA BETWEEN EAST-BOUND FENCE AND WEST BOUND FENCE. FOUND RR SPIKE ON LINE WITH EASTERLY FENCE LINE ALSO FOUND SPIKE IN LINE WITH WESTERLY FENCE LINE (10.4' SOUTH OF EASTERLY FENCE LINE) ALSO FOUND LARGE PILE OF STONES WITH LARGEST STONE IN CENTER UNDER SPIKE, 5.2' WEST OF CENTERLINE OF ROAD - SET 1/2" IRON W/CAP (ING. CO.) AT LARGE STONE**

WEST 30' FENCE LINE RUNNING TO THE WEST

WEST 30' FOUND 1/2" PROP. IRON

**7. JULY 22, 1980 - CETA FILES - RON LESTER - PS #18998 - FOUND 1/2" BAR & CAP IN ROAD SURFACE IN PREVIOUSLY EXCAVATED AREA INLINE WITH FENCE RUNNING TO THE EAST -EXTENDED EXCAVATION TO EAST (6'X14') AREA TO 2.7' DEPTH - DID NOT ENCOUNTER TOP SOIL - LETTER SUBMITTED TO LAVERNE HENDRIX REQUESTING THAT HE RECORD THIS CORNER (PRESUMABLY)**

EAST FENCE LINE RUNNING TO EAST

**8. JULY 29, 1986 - PA74 - LIBER 6, PAGE 358- DOUGLAS RICHARDSON - PS #31603**

A. ORIGINAL MONUMENT AND ACCESSORIES OBLITERATED. SUBSEQUENT RESTORATION NOT ON RECORD.

B. FOUND 1/2" IRON AND CAP (RLS NO. NOT READABLE).

C. EAST 1/4 CORNER, SECTION 18, T1N, R2W

FOUND 1/2" IRON AND CAP

NAIL & TAG EAST SIDE 36" OAK, N20W, 46.97'

NAIL & TAG N/S 30" OAK, N45E, 34.88'

NAIL & TAG SOUTHWEST SIDE 24" MAPLE, S45E 44.90'

NAIL & TAG EAST SIDE 12" ELM, S45E, 23.55'

**9. JULY, 1986 - PA132 - LIBER 5, PAGE 426 - DOUGLAS RICHARDSON - PS #31603 -SEE ITEM A8 ABOVE**

C6 - C7 = 2654.19', C6 - B6 = 2652.10'

**10. DECEMBER 18, 1992 - PA132 - LIBER 6, PAGE 1186 - RON HELSEL - PS #18994 - FOUND 1/2" IRON & CAP  
SEE ITEM A8 ABOVE**

**11. OCTOBER 15, 1998 - PA74 (RECORDED IN 2002) - LIBER 10, PAGE 224 - DAVID CLIFFORD, PS #25837 -**

A. HERVEY PARKE D.S SET POST IN ORIGINAL GOVERNMENT SURVEY IN MARCH, 1826. W.O. 10" N89°E 28 LKS. W.O. 22" N31W 73 LKS,

A. JACKSON, COUNTY SURVEYOR USED CORNER IN A SURVEY RECORDED IN VOLUME 2 INGHAM COUNTY SURVEYOR RECORDS PAGE 46 IN JAN. 1848 WITH NO MENTION OF MONUMENT OR WITNESSES.

A.P. DRAKE, COUNTY SURVEYOR, USED CORNER IN A SURVEY RECORDED IN VOLUME 3 INGHAM COUNTY SURVEYOR RECORDS PAGE 130 IN APRIL 1877 AS A STONE FROM WHICH A 12" HICKORY BEARS S28W 81 LINKS

G.EDWIN STATES, COUNTY SURVEYOR, IN A MARGINAL NOTE ON DRAKES SURVEY DATED SEP. 1892 DESCRIBES CORNER AS A STONE, B.O. 12" S87E, 40 LKS (26.4'), W.O. 22" N31W, 73 LKS (48.2')

THE INGHAM COUNTY REMONUMENTATION PROGRAM OF THE LATE 1970'S EXCAVATED A 20' NORTH-SOUTH BY 12' EAST-WEST HOLE 3 FOOT DEEP AND FOUND A RAILROAD SPIKE ON CENTERLINE GALE ROAD ON FENCE LINE TO EAST, THE RAILROAD SPIKE WAS REMOVED AND NEVER REPLACED OR WITNESSED. SUBSEQUENT TO EXCAVATION AND BEFORE CORNER STATUS WAS FINALIZED A 1/2" BAR & CAP WAS SET BY LAVERNE HENDRYX RLS #3263 IN THE EXCAVATION SITE. A LETTER WAS SENT TO HENDRYX ASKING HIM TO RECORD CORNER IF HE WAS SATISFIED WITH LOCATION AND NO FURTHER ACTION WAS TAKEN BY REMONUMENTATION STAFF

DOUG RICHARDSON, RLS #31603 RECORDED CORNER IN LIBER 6 OF CORNERS PAGE 358 IN OCTOBER, 1986 AS A FOUND 1/2" REBAR WITH UNREADABLE CAP, NAIL & TAG EAST SIDE 36" OAK, N20W, 46.97', NAIL & TAG N/S 30" OAK, N45E, 34.88', NAIL & TAG SOUTHWEST SIDE 24" MAPLE, S45E 44.90', NAIL & TAG EAST SIDE 12" ELM, S45E, 23.55'

B. SEARCHED APPARENT LOCATION AND FOUND 1/2" BAR & CAP 2' WEST OF CENTERLINE GALE ROAD AND 2' SOUTH OF FENCE LINE TO EAST. TRAVERSE OF SECTION LINE REVEALED THAT THIS POSITION IS HALFWAY AND ON LINE BETWEEN THE SECTION CORNERS. BOTH OF STATES WITNESSES STILL STAND AND WHEN INTERSECTED, INDICATED A SPOT ON THE CENTERLINE AND ON FENCE LINE TO THE EAST. I BELIEVE THAT THIS WAS THE CORNER LOCATION OF THE SPIKE BEFORE IT WAS REMOVED AND REPRESENTS THE HISTORICAL LOCATION OF CORNER. SET 3/4" BAR & CAP AT INTERSECTION OF STATES WITNESSES AND ACCEPTED IT AS PERPETUATION OF CORNER LOCATION

C. 3/4" BAR & ORANGE PLASTIC CAP STAMPED RLS 25837 ON CENTERLINE GALE ROAD ON FENCE LINE TO EAST  
FOUND NAIL & TAG #25832 - SOUTHWEST SIDE 21" MAPLE, S35E, 43.26'  
FOUND NAIL & TAG #25832, WEST SIDE 37" OAK, N61E, 31.20'  
FOUND PK NAIL, EAST SIDE 48" OAK, N28W, 47.60'  
SET NAIL & TAG #28409 - NORTHEAST SIDE 12" WALNUT, S60W, 26.34'

**PART A CONTINUED:**

**12. FEB. 12, 1999 – PA132 – LIBER 8, PAGE 456 – RON LESTER PS #18998 – FOUND BAR & CAP #25837**  
 AZ60 (N60E) 31.38' FOUND NAIL & TAG #25832 – NORTHWEST SIDE 20" OAK  
 AZ145 (S35E) 43.23' FOUND NAIL & TAG #25832 – WEST SIDE 24" MAPLE  
 AZ236 (S56W) 26.32' FOUND NAIL & TAG #28409 – SOUTHEAST SIDE 12" ELM  
 AZ298 112.80' (N62W) SE COR HOUSE FOUNDATION #3738  
 SOUTH 8.88' FOUND 1/2" BAR  
 C6 – C7 = 2654.63', C6 – B6 = 2653.25'

**13. JUNE 26, 2001 – PA132 – LIBER 8, PAGE 921 – RON HELSEL PS #18994 – FOUND 1/2" BAR AND CAP#28414 IN CENTERLINE OF GALE ROAD**  
 AZ60 (N60E) 31.38' FOUND NAIL & TAG #25832 – NORTHWEST SIDE 20" OAK  
 AZ145 (S35E) 43.23' FOUND NAIL & TAG #25832 – WEST SIDE 24" MAPLE  
 AZ236 (S56W) 26.32' FOUND NAIL & TAG #28409 (RON ENGER) – SOUTHEAST SIDE 12" ELM  
 AZ298 112.80' (N62W) SE COR HOUSE FOUNDATION #3738  
 SOUTH 8.88' FOUND 1/2" BAR (1999 ONLY)  
 C6 – C5 = 2652.99'  
 C6 – E6 = 5347.56'

**14. AUGUST 18, 2005 – PA132 – LIBER 9, PAGE 227 – CHRISTOPHER BELAND – PS #49106 – REFERS TO LIBER 10, PAGE 224 (CLIFFORD – 1998)**  
 S35E, 43.26' – FOUND NAIL & TAG #25832 – SOUTHWEST SIDE 21" MAPLE  
 N61E, 31.20' FOUND NAIL & TAG #25832, WEST SIDE 37" OAK  
 N28W, 47.60' – FOUND PK NAIL, EAST SIDE 48" OAK  
 S60W, 26.34' – FOUND NAIL & TAG #28409 (RON ENGER) – NORTHEAST SIDE 12" WALNUT  
 C6 – C5 = 2652.87', C6 – D6 = 2665.16', C6 – E6 = 5347.21'

**NO ADDITIONAL EVIDENCE FOUND**

**PART B:**

SEARCHED APPARENT LOCATION OF CORNER. FOUND 5/8" BAR WITH UNREADABLE CAP, 1 FOOT WEST OF THE CENTERLINE OF GALE ROAD (ASPHALT). ALSO FOUND 1/2" BAR IN THE ASPHALT, 0.75' SOUTH AND 2.31' WEST OF THE 5/8" BAR. FOUND REMNANTS OF FENCE RUNNING TO THE EAST ON LINE WITH THE 5/8" BAR. CLIFFORD'S 1998 LCRC INDICATED THAT IN THE LATE 1970'S, THE CETA PROGRAM FOUND A RAILROAD SPIKE ON A FENCE LINE TO THE EAST WHICH WAS NEVER REPLACED AFTER CETA EXCAVATION. ADDITIONAL CETA WORK PERFORMED IN 1980 FOUND A 1/2" BAR AND CAP SET BY HENDRYX. AT THIS TIME, A LETTER WAS SENT BY LESTER TO HENDRYX REQUESTING THAT HE RECORD HIS CORNER AND NO FURTHER ACTION WAS TAKEN BY THE CETA PROGRAM. RESEARCH PERFORMED IN 2008 BY PARSONS DID NOT YIELD ANY RECORDED LCRC'S OR SURVEYS BY HENDRYX IN RELATION TO THIS CORNER. THE FOUND 1/2" BAR NOTED ABOVE WAS FOUND TO BE CLOSE TO MIDWAY AND ONLINE BETWEEN ONONDAGA CORNERS C5 & C7 AND IS PRESUMABLY THE POINT SET BY HENDRYX. FIELD EVIDENCE INDICATED THAT RICHARDSON'S 1986 SURVEY USED THIS 1/2" BAR. IN 1998 CLIFFORD FINDS THE HENDRYX IRON BUT RE-ESTABLISHES THE NOW MISSING CETA SPIKE WITH HIS BAR & CAP #25837. SUBSEQUENT SURVEYS BY LESTER, HELSEL AND BELAND USE THE CLIFFORD BAR AND CAP. FIELD EVIDENCE INDICATES THAT THE FOUND 5/8" IRON IS IN THE LOCATION OF CLIFFORD'S 1998 BAR & CAP WHICH IS ALSO A PERPETUATION OF THE SPIKE FOUND BY CETA. NO EVIDENCE OF OCCUPATION WAS LOCATED WEST OF EITHER POINT. EXCAVATED BELOW BOTH IRONS THROUGH 10" ASPHALT, 9" OF GRAVEL AND 21" OF CLAY AND NO ADDITIONAL EVIDENCE WAS LOCATED. ACCEPTED THE FOUND 5/8" BAR WITH UNREADABLE CAP AS ONONDAGA CORNER C6 AND REPLACED IT WITH 3/4" X 24" SOLID BAR AND 2-1/2" ALUMINUM CAP MARKED PA 345 INGHAM COUNTY AND STAMPED PS 47969 IN A MONUMENT BOX. ACCEPTED THE 1/2" BAR AS A PROPERTY CONTROLLING CORNER (PCC/C6).

C6 – C5 = 2652.76', C6 – E6 = 5347.58, C6 – C7 = 2654.61, C6 – B6 = 2653.25'  
 PCC/C6 – C5 = 2653.49', PCC/C6 – E6 = 5349.89', PCC/C6 – C7 = 2653.88, PCC/C6 – B5 = 2650.94'

P.A. 345 INGHAM COUNTY  
 PEER APPROVED 11/13/2008 M



LAND CORNER RECORDATION CERTIFICATE  
Filing Requirement of Act 74, Mich. P.A. 1970

For corners in  
ONONDAGA TOWNSHIP  
INGHAM COUNTY

Located In: Corner Code #

1. Public Land Survey

T 1N R 2W C7

2. Property Controlling  
In Section

S T R

3. Miscellaneous  
Property in Sec.

S T R

S T R

B: 14 P: 21 11/20/2008 11:14 AM  
2008-044690 LAND CORNERS Receipt #48240  
Paula Johnson, Ingham County, Michigan

Pages: 2



Register of Deeds Stamp & File Number

1	A	B	C	D	E	F	G	H	I	J	K	L	M
2	6		5		4		3		2		1		
3													
4	7		8		9		10		11		12		
5													
6	18		17		16		15		14		13		
7													
8	19		20		21		22		23		24		
9													
10	30		29		28		27		26		25		
11													
12	31		32		33		34		35		36		
13													

4. Lot No. \_\_\_\_\_, Recorded Plat \_\_\_\_\_

5. Private Claims \_\_\_\_\_

I, Wendy S. Parsons, in a field survey on MARCH 10, 2008 do hereby state that under requirements of P.A. 74, Michigan P.A. of 1970, the corner points mentioned in lines 1 and 2 above were in conformance with regulations and rules therefore as required in the current manual of survey instructions of the United States Department of the Interior, Bureau of Land Management or by decree of a Court of Law and/or that the corner points mentioned in lines 3, 4 and 5 above were in conformance with the rules of the Michigan Board of Land Surveyors or by a Degree of a Court of Law; established, re-established, monumented, recovered, found as expressed below:

NOTE: Not more than 2 corners, all in the same town and range, may be recorded on this certificate.

A. Description of original monument and accessories and/or subsequent restoration:

PLEASE SEE PAGE 2 FOR HISTORICAL INFORMATION

P.A. 345 INGHAM COUNTY

PEER APPROVED 6/3/2008 ML

B. Description of corner evidence found and/or method applied in restoring or reestablishing corner:

SEARCHED APPARENT LOCATION OF CORNER. FOUND 1/2" PIPE WITH UNREADABLE CAP IN MONUMENT BOX AT THE CENTERLINE-CENTERLINE INTERSECTION OF KINNEVILLE HIGHWAY AND GALE ROAD, 6" BELOW GRADE. FOUND 3 WITNESSES DATING BACK TO STEPHENS 1972 LCRC. EXCAVATED THROUGH 2.5 FEET OF GRAVEL AND 0.5 FEET OF SAND AND FOUND NO ADDITIONAL EVIDENCE OF CORNER. DISTANCES TO ADJOINING GOVERNMENT CORNERS ARE VARIABLE DUE TO MULTIPLE RECORDED LOCATIONS AT THE OTHER CORNERS. REPLACED FOUND 1/2" PIPE WITH CAP WITH 3/4" X 24" SOLID BAR AND 2-1/2" ALUMINUM CAP MARKED PA 345 INGHAM COUNTY AND STAMPED PS 47969 IN EXISTING MONUMENT BOX AT THE CENTERLINE INTERSECTION OF KINNEVILLE HIGHWAY AND GALE ROAD (BOTH ASPHALT).

C7 - C6 = 2654.61' C7 - PROPERTY CONTROLLING CORNER AT C6 = 2653.88', C7 - D7 = 2670.22', C7 - C8 (5/8" BAR SET BY ENGER) = 2660.82', C7 - C8 (1/2" IRON ROD SET BY LESTER) = 2662.13', C7 - B7 = 2667.87', C7 - PROPERTY CONTROLLING CORNER AT B7 = 2725.85'

C. Description of monument for corner and accessories established to perpetuate locating the position of the corner:

REPLACED FOUND 1/2" PIPE WITH UNREADABLE CAP WITH 3/4" X 24" SOLID BAR AND 2-1/2" ALUMINUM CAP MARKED PA 345 INGHAM COUNTY AND STAMPED PS 47969 IN EXISTING MONUMENT BOX AT THE CENTERLINE INTERSECTION OF KINNEVILLE HIGHWAY AND GALE ROAD (BOTH ASPHALT).

S24E 71.96' FOUND READABLE NAIL & TAG NORTHEAST SIDE 40" OAK  
S17E 101.60' FOUND NAIL & TAG #3829 WEST SIDE 36" OAK  
S40W, 105.46' SET REMON NAIL & TAG SOUTHEAST SIDE 18" MAPLE  
N11E, 139.50' SET REMON NAIL & TAG NORTHEAST SIDE 48" OAK

REMON NAIL & TAG = SET MAGNETIC NAIL AND 1-1/2" ALUMINUM TAG  
STAMPED "INGHAM COUNTY WITNESS PA 345"



Signed by

*W.S. Parsons*

Date

11/12/08

Surveyor's Michigan License No.

47969

FORM APPROVED BY MICHIGAN STATE BOARD OF PROFESSIONAL SURVEYORS, JAN. 28, 1971

REVISED MAY 14, 1975  
REVISED JAN., 1983  
REVISED OCT., 1985

INGHAM COUNTY, ONONDAGA TOWNSHIP, T1N-R2W, CORNER C7

1. 1825 – GLO – HARVEY PARKE, DEPUTY SURVEYOR – SET 1/4 POST TO SECTIONS 17, 18, 19, 20  
WHITE OAK 16" S59W, 19 LINKS (12.54')  
WHITE OAK 16" S85E 75 LINKS (49.50')  
C7-C6=40 CHAINS (2640'), C7-D7=40.13 CHAINS (2648.58'), C7-C8=40 CHAINS (2640'), C7-B7=40 CHAINS (2640')
2. AUGUST 26, 1852 – COUNTY SURVEYOR NOTES – A. JACKSON – LISTS SAME WITNESSES AS GLO
3. MAY 29, 1877 – COUNTY SURVEYOR NOTES – A.P. DRAKE  
WHITE OAK 20" N22-1/2E 137-2/3 LINKS (90.86')  
BLACK OAK 12" N73-3/4W 132-1/4 LINKS (87.29')
4. UNDATED – COUNTY SURVEYOR NOTES – R. ROBB – STONE – NO WITNESSES LISTED
5. 1971 – INGHAM COUNTY ROAD COMMISSION MAP – 1-1/4" IRON  
NE 47.25' MBT (MICHIGAN BELL TELEPHONE) RISER  
SSE 72.74' 40" OAK  
NW 36.00' T.P.
6. JUNE 22, 1972 – PA74 – LIBER 2, PAGE 19 – CLYDE STEPHENS, PS#3829 –  
A: THE ORIGINAL MONUMENT AND ACCESSORIES OBLITERATED  
B: A 1 INCH IRON WAS FOUND IN THE CENTERLINE OF THE TWO SECTION LINE ROADS (GALE ROAD AND KINNEVILLE ROAD)  
C: THE 1 INCH IRON FOUND AT THE NE CORNER WAS LEFT IN POSITION WITH THE FOLLOWING WITNESSES:  
N10°47'E, 139.50' SURVEY TAG WEST SIDE 36" OAK  
S23°55'E, 71.98' SURVEY TAG NORTHEAST SIDE 36" OAK  
S17°08'E, 101.17' SURVEY TAG WEST SIDE 36" OAK  
BEARING TO SECTION LINE WEST OF THE CORNER IS WEST
7. SEPTEMBER -OCTOBER 1972– PA132'S – LIBER 1, PAGE 590, 591, 592 – LAVERNE HENDRYX – PS#3276 –DOES NOT WITNESS CORNER BUT SHOWS DISTANCES TO THE WEST (TO B7)  
C7 - STEPHENS B7 = 2725.45'
8. MAY 1, 1973 – PA132 – LIBER 1, PAGE 759 – JAMES STEPHENS, PS #16053 – REFERS TO LIBER 2, PAGE 19
9. OCTOBER 5, 1973 – PA132 – LIBER 1, PAGE 1063 – RON LESTER, PS#18998 - FOUND 1/2" BAR & CAP  
NNE 139.50' STEPHEN'S NAIL & TAG WEST SIDE 45" OAK  
NE 45.09' NAIL & TAG WEST SIDE ANCHOR POST  
SE 72.29' STEPHEN'S NAIL & TAG EAST SIDE 40" OAK  
C7-C8= 2662.04'
10. APRIL 9, 1977 – PA132 – LIBER 2, PAGE 1251 – LAVERNE HENDRYX, PS#3276 – REFERS TO LIBER 2, PAGE 19
11. JULY 29, 1986 – PA132 – LIBER 5, PAGE 425 – DOUGLAS RICHARDSON, PS#31603 – REFERS TO LIBER 2, PAGE 19  
C7-C6= 2654.19', C7-RICHARDSON B7 = 2667.92
12. JUNE 10, 1988 – PA132 – LIBER 5, PAGE 489 – DAVID LOHR, PS#30090 – FOUND 3/4" PIPE IN MON BOX ON CL-CL  
N15E 139.40' NAIL & TAG 48" OAK  
N45E 45.06' NAIL & TAG ANCHOR POST  
S25E 71.87' NAIL & TAG 30" OAK  
S20E 101.13' NAIL & TAG 30" OAK  
C7 - STEPHENS B7 = 2726.03'
13. MAY 7, 1992 – PA 132 – LIBER 6, PAGE 1108, JUNE 29, 1992 – LIBER 6, PAGE 1102, & OCTOBER 2, 1992 - LIBER 6, PAGE 1104 – DAVID LOHR PS#30090- FD 3/4" PIPE IN MON BOX  
N15E 139.40' NAIL & TAG 48" OAK  
N45E 45.06' NAIL & TAG ANCHOR POST  
S25E 71.87' NAIL & TAG 30" OAK  
S20E 101.13' NAIL & TAG 30" OAK  
C7-D7 = 2670.26', C7-C8 = 2662.12'
14. DECEMBER 18, 1992 – PA132 – LIBER 6, PAGE 1185 – RON HELSEL, PS# 18994 – REFERS TO LIBER 2, PAGE 19
15. JUNE 24, 1993 – PA132 – LIBER 6, PAGE 1242 – GLENN FAUSER, PS#18657 – FOUND SPIKE AT INTERSECTION KINNEVILLE/GALE RD  
N50W 46.65' W. TOP CENTER STEEL CULVERT  
N75E 46.90' TOP CENTER SQUARE TEL. BOX  
S10E 72.12' SET NAIL & RIBBON WEST SIDE 36" OAK  
S10W 53.40 W. TOP CENTER STEEL CULVERT  
C7-D7= 2670.05'
16. APRIL 18, 1994 – PA132 – LIBER 7, PAGE 383 – RON HELSEL, PS#18994 – FOUND 1" IRON AT CENTERLINE OF GALE RD & KINNEVILLE ROAD  
N10°47'E, 139.50' FOUND NAIL & TAG WEST SIDE 36" OAK  
S23°56'E, 71.98' FOUND NAIL & TAG NORTHEAST SIDE 36" OAK  
S17°08'E, 101.17' FOUND NAIL & TAG WEST SIDE 36" OAK  
N45°E, 45.06' FOUND NAIL & TAG NO. 11370 IN ANCHOR POST  
C7-D7 = 2670.06'
17. SEPTEMBER 14, 1998 –PLAT OF " ELK RIDGE" – LIBER 52 OF PLATS, PAGE 44-45 – REFERS TO LIBER 2 PAGE 19  
C7-C8 = 2662.00', C7-RICHARDSON B7 = 2668.00'
18. DECEMBER 28, 1998 – PA132 – LIBER 8, PAGE 663 – MARVIN FOUTY PS#18989- REFERS TO LIBER 2, PAGE 19  
C7-RICHARDSON B7 = 2668.00'
19. FEBRUARY 12, 1999 – PA132 – LIBER 8, PAGE 455 – RON LESTER PS#18998– FOUND 1-3/4" BAR IN MONUMENT BOX  
AZ60 (N60E) 31.38' FOUND NAIL & TAG #25832, NORTHWEST SIDE 20" OAK  
AZ145 (S35E) 43.23' FOUND NAIL & TAG #25832 WEST SIDE 24" MAPLE  
AZ236 (S56W) 26.32' FOUND NAIL & TAG #28409 SOUTHEAST SIDE 12" ELM  
AZ298 (N62W) SE CORNER HOUSE FOUNDATION #3738  
C7-C6=2654.63'

NO ADDITIONAL EVIDENCE FOUND