

SURVEY & REMONUMENTATION

LIBER 8 PAGE 413

FILED

DEC 1 10 04 AM '94

REGISTER OF DEEDS

INGHAM COUNTY, MICH.

LAND CORNER RECORDATION CERTIFICATE Filing Requirement of Act 74, Mich. P.A. 1970

For corners in
INGHAM

APR 10 1995

(County)

ONONDAGA

COMMISSION

Located In:

Corner Code #

1. Public Land Survey	T	1N	R	2W	K-9
	T		R		
	T		R		
	T		R		
2. Property Controlling in Section	S	T	R		
	S	T	R		
3. Miscellaneous Property In Sec.	S	T	R		
	S	T	R		

Register of Deeds Stamp & File Number

4. Lot No. _____ Recorded Plat _____
5. Private Claims _____

	A	B	C	D	E	F	G	H	I	J	K	L	M
2	6		5		4		3		2		1		
3													
4	7		8		9		10		11		12		
5													
6	13		14		15		16		17		18		
7													
8	19		20		21		22		23		24		
9													
10	25		26		27		28		29		30		
11													
12	31		32		33		34		35		36		
13													

1. **RONALD L. ENGER** in a field survey on **SEPTEMBER 2**, 19 **94**

do hereby certify that under requirements of P.A. 74, Michigan P.A. of 1970, the corner points mentioned in lines 1 and 2 above were in conformance with regulations and rules therefore as required in the current manual of survey instructions of the United States Department of the Interior, Bureau of Land Management or by a decree of a Court of Law and/or that the corner points mentioned in lines 3, 4 and 5 above were in conformance with the rules of the Michigan Board of Land Surveyors or by a Decree of a Court of Law; established, re-established, monumented, re-monumented, recovered, found as expressed below:

NOTE: Not more than 4 corners, all in the same town and range, may be recorded on this certificate.

A. Description of original monument and accessories and/or subsequent restoration:

1. ORIGINAL POST SET BY HERVEY PARKE, DEPUTY SURVEYOR, ON DEC. 26, 1825.
W.O. 30 S14W 64 (42.2')
B.O. N½E 101 (66.7')

2. A MARGINAL NOTE IN THE INGHAM COUNTY REGISTER OF DEEDS' COPY OF GLO NOTES
"NEW B. CHERRY 6 S7½W 193 (127.4') COR SCHOOL HOUSE N41½E. 179½ (118.5)"

CONTINUED ON BACK

B. Description of corner evidence found and/or method applied in restoring or reestablishing corner:

SEARCHED AT APPARENT LOCATION OF CORNER AND FOUND BOAT SPIKE 1' SOUTH OF CENTERLINE BELLEVUE ROAD AND 1.5' WEST OF THE CENTERLINE OF EDGAR ROAD AND PROVED IT TO BE IN THE LOCATION RECORDED BY ME BY 4 OF THE 1988 WITNESSES STILL IN EXISTENCE. WITH THE HELP OF A LOCAL RESIDENT AND FORMER STUDENT OF THE SCHOOL MENTIONED IN ITEM A2 FOUND SW CORNER OF STONE FOUNDATION OF SAID SCHOOL AND MEASURED N40°E 118'±/- FROM BOAT SPIKE TO SCHOOL CORNER. EXCAVATED TO A DEPTH OF 4 FEET AROUND BOAT SPIKE AND FOUND NOTHING MORE. ACCEPTED BOAT SPIKE AS PERPETUATION OF CORNER BECAUSE OF AGREEMENT WITH HISTORICAL WITNESSES AND SET STANDARD BAR AND PA 345 CAP AND MONUMENT BOX. MEASURED SOUTH 2628.06' TO K-10. MEASURED WEST 2638.48' TO J-9. MEASUREMENTS ARE FROM TRAVERSE PERFORMED DURING SUPER COLLIDER PROJECT OF 1988.

C. Description of monument for corner and accessories established to perpetuate locating the position of the corner:

K-9 T1N R2W
3/4" X 24" SMOOTH STEEL BAR AND PA 345 CAP PS 28409 IN MONUMENT BOX
NAIL & TAG 28409 IN WEST SIDE 33" LOCUST, NAZ 162°, 35.04'
NAIL & TAG 28409 IN S.E. SIDE 22" MAPLE, NAZ 57°, 48.06'
NAIL & TAG 28409 IN EAST SIDE 20" MAPLE, NAZ 338°, 65.90'
S.E. CORNER FOUNDATION OF HOUSE #4030, NAZ 330°, 93.57'
N.E. CORNER GARAGE FOUNDATION, NAZ 158°, 100.21'
INGHAM COUNTY TEMPORARY POINT (½" BAR & CAP), NAZ 182°, 8.58'

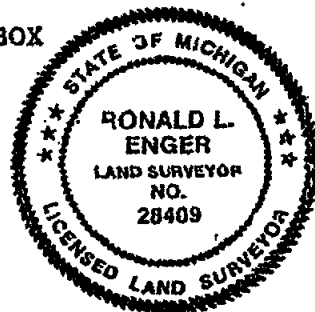

Signed by Ronald L. Enger Date NOVEMBER 1, 1994

Surveyor's Michigan License No. 28409

2760

P.A. 345 INGHAM COUNTY
PEER APPROVED 11/09/94

FORM APPROVED BY MICHIGAN STATE BOARD OF LAND SURVEYORS, JAN. 28, 1971
REVISED MAY 14, 1973
REVISED JAN., 1983

K-9 T1N R2W
PART A CONTINUED

3. A. JACKSON, CO. SURVEYOR, USED CORNER IN OCT. 1839 (VOL 1, PAGE 18)
STUMP W.O. 18 N28E 39
W.O. 16 N86E 40

4. A MARGINAL NOTE ON ITEM 3 BY W.H. RAYNER GIVES SAME WITNESSES AS IN ITEM 2.

5. A MARGINAL NOTE ON ITEM 3 BY W.H. RAYNER: "THIS SECTION CORNER 23, 24, 25, & 26 I LOCATED FROM THE BEST AUTHORITY AND AT THE BEST OF MY ABILITY WITHOUT PARTIALITY TO ANYONE APRIL 25, 1866."

6. T.J. BROWN, COUNTY SURVEYOR, USED CORNER IN SEPT. 1872 (VOL. 3, PAGE 63) WITH SAME MONUMENT AND WITNESSES AS ITEMS 2 AND 4.

7. INGHAM COUNTY ROAD COMMISSION -- GRID MAP

1/2" IRON, STONE
30" ELM, NNW 68.95'
26" LOCUST NW 47.85'
14" MAPLE ENE 86.27'
T.P. SOUTH 63.85'

8. FRED WHITE LS 12034 RECORDED CORNER (LIBER 2 OF CORNERS, PAGE 201) AND USED IN A SURVEY (LIBER 1, PAGE 687 IN SEPT. 1972.

FD. BOLT SPIKE
15" MAPLE N60°E 47.83'
36" LOCUST S03°E 28.35'
15" MAPLE N78°E 82.90'

9. GLENN FAUSER, LS 18657, USED CORNER IN FEBRUARY, 1979 (LIBER 3 OF SURVEYS, PAGE 830) WITH NO MENTION OF MONUMENT OR WITNESSES.

10. A. WILLIAMS, LS 21265, USED CORNER IN MARCH, 1979, (LIBER 3 OF SURVEYS, PAGE 961) WITH SAME MON. AND WITNESSES AS ITEM 8.

11. RON ENGER, LS 28409, RECORDED CORNER IN NOVEMBER, 1988 (LIBER 7 OF CORNERS, PAGE 103) AS A BOAT SPIKE PROVED TO OCCUPY SAME LOCATION AS CORNER RECORDED BY FRED WHITE BY TWO OF WHITE'S WITNESSES STILL IN EXISTENCE.

SE COR HOUSE FDN., #4030, 330°NAZ 93.6'
NAIL AND TAG E. SIDE 14" MAPLE 338° NAZ 66.0'
NAIL AND TAG W. SIDE 40" LOCUST 178° NAZ. 28.4'
NAIL AND TAG SE SIDE 24" MAPLE 57° NAZ 48.1'
NAIL AND TAG S. SIDE OF 15" MAPLE 75°NAZ 82.4'
NE COR GAR. 161°NAZ 100.2'

CORNER IS 1' SOUTH OF CENTERLINE BELLEVUE RD. AND 1.5' WEST OF CENTERLINE EDGAR RD.

12. BRUCE ANTCLIFF LS 25826 USED CORNER IN NOV. 1988 (LIBER 5 OF SURVEYS, PAGES 932-947 AND 952-967) WITH SAME MONUMENT AND WITNESSES AS ITEM 11.

13. J. GRANGER, LS 16041, USE CORNER IN A SURVEY IN JANUARY, 1994 (LIBER 7 OF SURVEYS, PAGES 79-82) WITH REFERENCE TO LIBER 7 OF CORNERS, PAGE 103.

LAND CORNER RECORDATION CERTIFICATE
Filing Requirement of Act 74, Mich. P.A. 1970

For Corners in
INGHAM
(county)

Located In:

Corner Code #

1. Public Land Survey
CORNER COMMON
TO SECTIONS 13 & 24
ONONDAGA TOWNSHIP
ON RANGE LINE

T 1N R 2W

M-07

T R

T R

T R

Paula Johnson
INGHAM COUNTY
REGISTER OF DEEDS
REYNOLDS LAND SURVEYING & M

RECORDED

L-10 P-294

CRNR 11.00

2002-075418

2. Property Controlling
in Section

S

T R

S

T R



2002-075418

Page: 1 of 2

11/21/2002 08:06A

Register of Deeds Stamp & File Number

3. Miscellaneous

S

T R

4. Lot No , Recorded Plat

5. Private Claims

I, Brian Reynolds, in a field survey on May 29, 2002 do hereby certify that under requirements of P.A. 74, Michigan P.A. of 1970, the corner points mentioned in lines 1 and 2 above were in conformance with regulations and rules therefore as required in the current manual of survey

instructions of the United States Department of the Interior, Bureau of Land Management or by a decree of a Court of Law and/or that the corner points mentioned in lines 3, 4, and 5 above were in conformance with the rules of the Michigan Board of Land Surveyors or by a Decree of a Court of Law; established, re-established, monumented, re-monumented, recovered, found as expressed below.

NOTE: Not more than 2 corners, all in the same town and range, may be recorded on this certificate.

A. Description of original monument and accessories and/or subsequent restoration:

1. GENERAL LAND OFFICE SURVEY BY DEPUTY SURVEYORS JOSEPH WAMPLER AND JOHN MULLETT, " ...SET POST COR. TO SEC'S 13 & 24 F/W A Be 18 in. S9W 90 lks. Do. 8" N39W 27...."
2. DEPUTY COUNTY SURVEYOR E. A. CALKINS, SMALL FIELD BOOK PAGES 150-151, AUGUST 28-29, 1900, "SURVEY OF LINES UPON SEC. 13, T. 1 N., R. 2 W.....COM AT SW CORNER OF SAID SEC. 13,...SET OFF 5 L SOUTH RAN N89 3/4°E ON RANDOM, AT 40.00 SET TEMP POST, AT 79.50 A POINT 11 1/2 L SOUTH OF SEC. CORNER...COM AT NE COR OF SEC 13, STONE, SET OFF 14 L. EAST, RAN SOUTH ON RANDOM, AT 40.15 A POINT 7 L. EAST OF 1/4 POST, AT 80.20 SET STONE BY MEASUREMENTS UPON SEC. 18 LESLIE, FOR SEC. CORNER F/W HICK. 10 N16W 138 1/2 L. APPLE 14 S39E 72 L.
TWO OTHER TRANSCRIPTIONS OF THE SAME SURVEY AS FOUND IN THE CORNER DOSSIER
c.1978 CALL FOR A "STONE SET WITH SMALL STONES" AND SAME WITNESSES
HISTORICAL SUMMARY CONTINUED ON THE REVERSE OF THIS FORM

B. Description of corner evidence found and/or method applied in restoring or reestablishing corner:

FOUND CONCRETE MONUMENT IN MONUMENT BOX WITH CAP #18998 IN VERY GOOD CONDITION. ACCEPTED FOUND MONUMENT AS PROPER PERPETUATION OF CORNER POSITION BY CALKINS, RAYMER AND LESTER. REPLACED PLASTIC CAP #18998 WITH PLASTIC CAP #31602, THEN PLACED STANDARD ALUMINUM CAP STAMPED "31602" OVER THAT, AND REWITNESSED AS DESCRIBED BELOW.

C. Description of monument for corner and accessories established to perpetuate locating the position of the corner:

WITNESSES TO CONCRETE MONUMENT IN MON BOX WITH ALUMINUM INGHAM REMON CAP STAMPED "31602"
FOUND NAIL & TAG #18998 IN THE NORTHWEST SIDE OF A 15" CHERRY (TWIN) N17°38'W 93.50'
SET NAIL & PLASTIC TAG #31602 IN THE NORTHWEST SIDE OF A 15" SPRUCE S16°49'W 127.42'
FOUND NAIL & TAG #18998 IN THE WEST SIDE OF A 24" WALNUT S07°33'W 233.12'
TOP CENTER OF A 4" STEEL FENCE POST S24°42'W 66.69' A-7 T1N R1W LESLIE NORTH 3.29'
8.5±' NORTH OF E-W CENTERLINE (KINNEVILLE ROAD) 4.5±' EAST OF N-S CENTERLINE (RIDLEY ROAD)

P.A. 345 INGHAM COUNTY
PEER APPROVED 6/4/02 ML



Signed by

Date

11/12/2002

Surveyor's Michigan License No 31602

FORM APPROVED BY MICHIGAN STATE BOARD OF LAND SURVEYORS. JAN. 28, 1971

REVISED MAY 14, 1975

REVISED JANUARY, 1983

REVISED OCTOBER 1995

A. Description of original monument and accessories and/or subsequent restoration: (T1N R2W M07 CONTINUED)

3. PHOTOCOPY OF SURVEY OF PARCELS IN SECTION 24 BY W. H. RAYNER, COUNTY SURVEYOR, UNDATED BUT c.1905, ATTACHMENT No. 9 TO c.1978 CORNER DOSSIER, "B. CHERRY 8 N42W 103 1/2"
4. NO CORNER DATA SHOWN ON THE ROAD COMMISSION WITNESS MAP.
5. LCRC BY DON DAVIS, P. S. #17617, DATED AUGUST 25, 1978, PART A BLANK, PART B, "FOUND 3/4 INCH PIPE AS SET BY PREVIOUS SURVEYOR FOR WORK IN THIS SECTION." PART C "3/4 INCH PIPE FENCE POST N45°W 29.95 FEET FENCE POST N45°E 39.00 FEET 24" CHERRY S45°W 66.11 FEET
6. LCRC BY RONNIE LESTER P. S. #18998, DATED 5/20/1981, PART B, "EXCAVATED AREA 13' X 10' AT INTERSECTION OF ROADS TO A DEPTH OF 2.0'. FOUND LARGE ROCK SURROUNDED BY SMALL ROCKS AS CALLED FOR BY E. A. CALKINS AT A-7 LESLIE. FURTHER EXCAVATION REVEALED DISTURBED STONE PILE ±3.3' SOUTH WHICH WAS INTERPRETED TO REPRESENT THE STONE PILE SET BY CALKINS AT M-7...SET CONCRETE MONUMENT WITH CAP #18998 AT SOUTHERLY STONE PILE. MEASURED NORTH TO M-6 2637.81'; MEASURED TO SOUTH TO M-8 2653.14' CORNER RECORDED BY OTHER SURVEYOR IS 6.7' WEST. EXCAVATION CONDUCTED BY INGHAM COUNTY SURVEY AND REMONUMENTATION PROJECT CREW." PART C "SET 4" X 36" CONCRETE MONUMENT, COLLAR AND CAP #18998 AT LOCATION DESCRIBED ABOVE: NAIL & TAG, #18998, NORTHWEST SIDE TWIN 12" WILD CHERRY, S70°W, 110.43' NAIL & TAG, #18998, NORTHWEST SIDE TWIN 24" WILD CHERRY, S50°W, 72.56' NAIL & TAG, #18998, NORTHWEST SIDE TWIN 12" WILD CHERRY, S45°W, 52.33' 4" CONCRETE MONUMENT, A-7 LESLIE NORTH 3.30'



2002-075418
Page: 2 of 2
11/21/2002 08:06A

LAND CORNER RECORDATION CERTIFICATE
Filing Requirement of Act 74, Mich. P.A. 1970

For Corners in
INGHAM
(county)

Located In:

Corner Code #

1. Public Land Survey
CORNER COMMON TO
SECTIONS 13, 14, 23 & 24
ONONDAGA TOWNSHIP

T 1N R 2W
T _____ R _____
T _____ R _____
T _____ R _____

K-07

Paula Johnson
INGHAM COUNTY
REGISTER OF DEEDS
OFFICIAL SEAL



L-11 P-23

CRNR 17.00

2003-087371

2. Property Controlling S _____ T _____ R _____
in Section S _____ T _____ R _____



2003-087371

Page: 1 of 2

09/30/2003 09:37A

Register of Deeds Stamp & File Number

3. Miscellaneous S _____ T _____ R _____

4. Lot No _____, Recorded Plat _____

5. Private Claims _____

I, Brian Reynolds, in a field survey on April 1, 2002 do hereby certify that under requirements of P.A. 74, Michigan P.A. of 1970, the corner points mentioned in lines 1 and 2 above were in conformance with regulations and rules therefore as required in the current manual of survey instructions of the United States Department of the Interior, Bureau of Land Management or by a decree of a Court of Law and/or that the corner points mentioned in lines 3, 4, and 5 above were in conformance with the rules of the Michigan Board of Land Surveyors or by a Decree of a Court of Law; established, re-established, monumented, re-monumented, recovered, found as expressed below.

NOTE: Not more than 2 corners, all in the same town and range, may be recorded on this certificate.

A. Description of original monument and accessories and/or subsequent restoration:

SEE REVERSE SIDE OF THIS FORM FOR HISTORICAL SUMMARY

B. Description of corner evidence found and/or method applied in restoring or reestablishing corner:

FOUND 3/4" IRON PIPE IN BITUMINOUS ROAD, APPROXIMATELY 1 FOOT WEST AND 1 FOOT SOUTH OF THE INTERSECTION OF CURRENT CENTERLINES. ALL WITNESSES FROM PREVIOUS RECORDINGS BY WILLIAMS, HELSEL AND FAUSER ARE GONE, EXCEPT THE WOOD ANCHOR POST (RAILROAD TIE) TO THE SOUTHWEST, WHICH IS LEANING TO THE SOUTHWEST. THERE ARE TWO WITNESS NAILS AND TAGS IN THE FENCE POST, ONE ON THE NORTH SIDE IS OLD FADED PLASTIC INSCRIBED "12034" (FRED N. WHITE, P.S.), THE OTHER ON THE SOUTHWEST CORNER IS A WHITE SHINER WITH NO IDENTIFICATION. EXCAVATED AN AREA 2' EAST-WEST BY 4' NORTH-SOUTH, CENTERED ON FOUND PIPE, TO A DEPTH OF 4 FEET, ENCOUNTERED BLACK MUCK AND WATER. FOUND NO TRACE OF STONE OR CROCKERY. ACCEPTED FOUND IRON AS BEST AVAILABLE EVIDENCE OF CORNER POSITION. REPLACED FOUND IRON WITH STANDARD 3/4" BY 24" IRON BAR AND ALUMINUM REMON CAP. INSTALLED MONUMENT BOX.

C. Description of monument for corner and accessories established to perpetuate locating the position of the corner:

WITNESSES TO STANDARD MONUMENT IN MON BOX WITH ALUMINUM INGHAM REMON CAP STAMPED "31602"

SET PK NAIL IN WEST SIDE OF CONCRETE CATCH BASIN NAZ 107° 88.17'
FOUND OLD NAIL AND TAG IN NORTH SIDE OF FENCE POST (N-S FENCE) NAZ 234° 47.15'
FOUND NAIL AND TAG No. 28414 (MAURICE MAHIEU, PS) IN NW SIDE OF 10" ELM CLUSTER NAZ 12° 139.87'
FOUND NAIL AND TAG IN EAST SIDE OF MAPLE CLUSTER NAZ 207° 75.65'
SOUTHWEST CORNER OF 1.5' X 3' RISER BOX NAZ 45° 48.37'

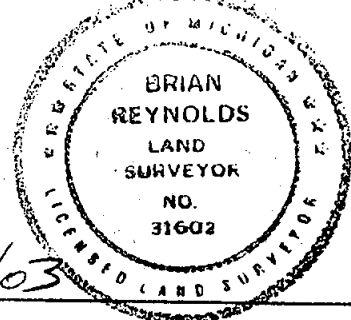

Signed by [Signature]

Date 6/17/03

Surveyor's Michigan License No 31602

FORM APPROVED BY MICHIGAN STATE BOARD OF LAND SURVEYORS, JAN. 28, 1971
REVISED MAY 14, 1975 REVISED JANUARY, 1983 REVISED OCTOBER 1995

P.A. 345 INGHAM COUNTY
PEER APPROVED 6/17/2003 NL

A. Description of original monument and accessories and/or subsequent restoration (K-07 T1N R2W CONTINUED)

1. GENERAL LAND OFFICE DEPUTY SURVEYOR HERVEY PARKE, 1826, "...80.00 SET POST COR. TO SEC'S 13, 14, 23 & 24 F/W AN ELM 14 in. N61E 9 lks TAM. 16 SOUTH 38 1/2....."
2. DEPUTY COUNTY SURVEYOR E. A. CALKINS, SMALL FIELD BOOK PAGES 150-151, AUGUST 28-29, 1900, "SURVEY OF LINES UPON SEC. 13, T. 1 N., R. 2 W.....COM AT SW CORNER OF SAID SEC. 13, A STONE F/W W. OAK N20°W 113 LSWP. W. OAK 12 N27°W 89 LCHERRY 6 S25 1/4W 63 1/2 L."
3. ROAD COMMISSION WITNESS MAP, "STONE 18" OAK NW 59.7' 14" ELM NE 160.9'
4. ACT 74 LAND CORNER RECORDATION CERTIFICATE LIBER 4, PAGE 28 BY AUSTIN C. WILLIAMS, P.S. No. 21275, DATED AND RECORDED APRIL 1977, PART A: "ORIGINAL MONUMENT AND WITNESSES OBLITERATED", PART B: "FOUND 1" IRON PIPE IN CENTERLINE OF KINNEVILLE ROAD (SOUTHWEST CORNER OF SECTION 13, T1N, R2W,) AND 3' WEST OF CENTERLINE OF EDGAR ROAD" PART "C" NAIL IN 40" OAK, N30°W, 59.28' NAIL IN RR TIE FENCE POST, S50°W, 46.20' CENTERLINE OF STOP SIGN POST, N60°E, 47.70'
5. ACT 74 LAND CORNER RECORDATION CERTIFICATE LIBER 4, PAGE 58 BY RON HELSEL, P.S. No. 18994, DATED MARCH, 1977 AND RECORDED MAY, 1977, PART A: "NE CORNER OF SECTION 23 - FOUND 3/4" IRON PIPE 2 FT. MORE OR LESS WEST OF CENTERLINE EDGAR ROAD AND 2 FT. MORE OR LESS SOUTH OF CENTERLINE KINNEVILLE ROAD. CORNER IN ACCORD WITH G.L.O. MEASUREMENT N-S AND WEST", PART B: "NE CORNER OF SECTION 23 - USED 3/4" IRON PIPE AND WITNESSED" PART "C" NE CORNER, SECTION 23 3/4" IRON PIPE N45°W, 38.57' CENTERLINE STREET NAME SIGN, N25°W, 59.30' N & T IN 40" OAK S45°W, 46.23' N & T IN WOOD ANCHOR POST
6. ACT 74 LAND CORNER RECORDATION CERTIFICATE LIBER 5, PAGE 367 BY GLENN A. FAUSER, P.S. No. 18657, DATED AUGUST, 1978 AND RECORDED DECEMBER, 1979, PART A IS LEFT BLANK PART B: "FOUND 3/4" PIPE CENTERLINE KINNEVILLE ROAD AND EDGAR ROAD: NW CORNER" PART "C" NORTHWEST CORNER" IRON PIPE N45°W, 38.57' CENTERLINE STREET NAME SIGN, N25°W, 59.30' N & T IN 40" OAK S45°W, 46.23' N & T IN WOOD ANCHOR POST



2003-087371

Page: 2 of 2

09/30/2003 09:37A

LAND CORNER RECORDATION CERTIFICATE
Filing Requirement of Act 74, Mich. P.A. 1970

For Corners in
INGHAM
(county)

Located In:

Corner Code #

1. Public Land Survey
1/4 CORNER COMMON
TO SECTIONS 13 & 24
ONONDAGA TOWNSHIP

T 1N R 2W
T _____ R _____
T _____ R _____
T _____ R _____

L-07

Paula Johnson
INGHAM COUNTY
REGISTER OF DEEDS
OFFICIAL SEAL



L-11 P-111

CRNR 17.00

2003-105261

2. Property Controlling
in Section

S _____ T _____ R _____
S _____ T _____ R _____



2003-105261

Page: 1 of 2

12/09/2003 08:50A

Register of Deeds Stamp & File Number

3. Miscellaneous

S _____ T _____ R _____

4. Lot No _____, Recorded Plat _____

5. Private Claims _____

I, Brian Reynolds, in a field survey on April 1, 2002 do hereby certify that under requirements of P.A. 74, Michigan P.A. of 1970, the corner points mentioned in lines 1 and 2 above were in conformance with regulations and rules therefore as required in the current manual of survey instructions of the United States Department of the Interior, Bureau of Land Management or by a decree of a Court of Law and/or that the corner points mentioned in lines 3, 4, and 5 above were in conformance with the rules of the Michigan Board of Land Surveyors or by a Decree of a Court of Law; established, re-established, monumented, re-monumented, recovered, found as expressed below.

NOTE: Not more than 2 corners, all in the same town and range, may be recorded on this certificate.

A. Description of original monument and accessories and/or subsequent restoration:

SEE PAGE TWO OF THIS FORM FOR HISTORICAL SUMMARY

B. Description of corner evidence found and/or method applied in restoring or reestablishing corner:

FOUND 1/2" IRON IN BITUMINOUS ROAD, IN LINE WITH OCCUPATION NORTH AND SOUTH. EXCAVATED A 2' X 2' X 4' DEEP AREA, AT ABOUT 2' BELOW GRADE, FOUND ORANGE PLASTIC CAP No. 17640 (GEORGE M. YOUNG, P.S.). FOUND NO ADDITIONAL EVIDENCE OF PREVIOUS MONUMENTATION. AT ABOUT 3.5 FEET, ENCOUNTERED WATER TABLE, SHORTLY THEREAFTER, THE HOLE BEGAN COLLAPSING AS IT FILLED WITH WATER. ACCEPTED FOUND IRON AS BEST AVAILABLE EVIDENCE OF CORNER POSITION. REPLACED FOUND IRON WITH STANDARD INGHAM COUNTY MONUMENT AND CAP, INSTALLED MONUMENT BOX.

C. Description of monument for corner and accessories established to perpetuate locating the position of the corner:

WITNESSES TO STANDARD REMON IRON (3/4" X 24" W/ALUMINUM CAP STAMPED "31602")

FOUND "PK" AND TAG NO. 39100 (TERRY L. WEIGMAN, P.S.) IN NORTH SIDE OF 40" OAK NAZ 237° 39.65'
SET NAIL AND TAG IN WEST SIDE OF 6" MAPLE CLUSTER NAZ 03° 28.72'
SET NAIL & TAG IN SOUTH SIDE OF 8" MAPLE NAZ 280° 76.15'
SET NAIL & TAG IN WEST SIDE OF 8" MAPLE NAZ 177° 33.13'
SET NAIL & TAG IN SOUTH SIDE OF 20" HICKORY NAZ 118° 52.09'
K-07 IS S89°20'41"W 2633.08' L-06 IS N00°19'08"W 2635.89'
L-08 IS S00°03'26"W 2641.29' M-06 IS N89°13'11"E 2623.06'

P.A. 345 INGHAM COUNTY

PEER APPROVED 9/30/2003 RL

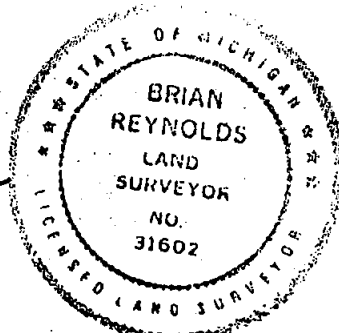

Signed by

Date

NOVEMBER 30, 2003

Surveyor's Michigan License No

31602

A. Description of original monument and accessories and/or subsequent restoration (T1N R2W L-07 Continued):

1. **GENERAL LAND OFFICE DEPUTY SURVEYOR HERVEY PARKE, 1826, "WEST CORRECTED BETWEEN SECS 13 & 24...39.80 SET 1/4 SEC POST COR. AVER. DIST. ON TRUE LINE Be 10 in. N34E 9 lks Do. 10 in S42W 10 LKS**
2. **ACT 74 LAND CORNER RECORDATION CERTIFICATE LIBER 4, PAGE 28, BY AUSTIN C. WILLIAMS, P.S. NO. 21275, DATED AND FILED APRIL, 1977, PART "A": "ORIGINAL MONUMENT AND ACCESSORIES OBLITERATED" PART "B": "S 1/4 CORNER OF SECTION 13, T1N, R2W, INGHAM COUNTY FOUND 3/4" IRON PIPE 4' NORTH OF CENTERLINE OF KINNEVILLE ROAD, AND IN LINE WITH NORTH AND SOUTH FENCES." PART "C" "1/2" IRON ROD, SOUTH, 33.0' 6" ASH, N30°W, 33.0' 36" OAK, SOUTH 60° WEST, 40.34'**
3. **DOSSIER FROM INGHAM COUNTY SURVEY AND REMONUMENTATION PROJECT TRAVERSE POINT WITNESS REPORT, JANUARY 1977: "PINCH PIPE, FOUND 3/4" PIPE 4' N. OF CENTERLINE KINNEVILLE ROAD T&N SET 30.38' FENCE POST DUE N. T&N SET 34.71' 10" HICKORY 75°S.E. T&N SET 40.28' 40" DIA OAK 60°S.W 33.00' 1/2" IRON ROD DUE S.**
4. **PRELIMINARY CORNER FIELD INSPECTION SHEET, NOVEMBER 1977, INDICATES "PIPE 'BENT' IN ASPHALT**

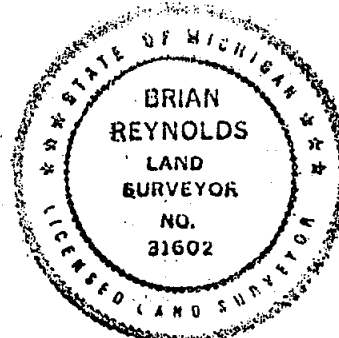

2003-105261
Page: 2 of 2
12/09/2003 08:50A

LAND CORNER RECORDATION CERTIFICATE
Filing Requirement of Act 74, Mich. P.A. 1970

For Corners in
INGHAM
(county)

Located In:

Corner Code #

1. Public Land Survey
EAST 1/4 CORNER
SECTION 24
ONONDAGA TOWNSHIP

T 1N R 2W
T _____ R _____
T _____ R _____
T _____ R _____

M-08

Paula Johnson
INGHAM COUNTY
REGISTER OF DEEDS
OFFICIAL SEAL



L-11 P-115

CRNR 17.00

2003-105263

2. Property Controlling
in Section S _____ T _____ R _____
S _____ T _____ R _____



2003-105263

Page: 1 of 2

12/09/2003 08:50A

3. Miscellaneous S _____ T _____ R _____

Register of Deeds Stamp & File Number

4. Lot No _____, Recorded Plat _____
5. Private Claims _____

I, Brian Reynolds, in a field survey on June 16, 2003 do hereby certify that under requirements of P.A. 74, Michigan P.A. of 1970, the corner points mentioned in lines 1 and 2 above were in conformance with regulations and rules therefore as required in the current manual of survey instructions of the United States Department of the Interior, Bureau of Land Management or by a decree of a Court of Law and/or that the corner points mentioned in lines 3, 4, and 5 above were in conformance with the rules of the Michigan Board of Land Surveyors or by a Decree of a Court of Law; established, re-established, monumented, re-monumented, recovered, found as expressed below.

NOTE: Not more than 2 corners, all in the same town and range, may be recorded on this certificate.

A. Description of original monument and accessories and/or subsequent restoration:

SEE PAGE TWO FOR HISTORICAL SUMMARY

B. Description of corner evidence found and/or method applied in restoring or reestablishing corner:

THE CORNER DOSSIER FROM THE PREVIOUS INGHAM COUNTY SURVEY AND REMONUMENTATION PROJECT c. 1977-1981 DESCRIBES SUCH THOROUGH INVESTIGATION AND EXCAVATION THAT A MAJOR EXCAVATION WAS DEEMED UNNECESSARY. FOUND 1/2" IRON AND FLAGGING 5'± EAST OF CENTER LINE. FOUND AND CHECKED WITNESSES FROM 1988 L.C.R.C. BY SURVEYOR LESTER. TRAVERSED ALL OF SECTION 24, TYING IN FOUND MONUMENTATION AND OCCUPATION. IT APPEARS FROM THE SEQUENCE DESCRIBED IN PART "A" THAT AN EXTENSIVE (IF NOT EXHAUSTIVE) SEARCH FOR THE SUBJECT CORNER WAS DONE BEGINNING IN VERY EARLY 1978. IN THE COURSE OF THAT INVESTIGATION, THE MONUMENTED POSITION RECORDED BY FAUSER WAS OBLITERATED. THAT WORK CULMINATED WITH THE CORNER POSITION DECLARED LOST, AND THE SETTING OF A (THEN) STANDARD MONUMENT WITH CONCRETE COLLAR AND CAP AT THE MID-POINT ON LINE BETWEEN M-07 AND M-09. THAT MONUMENT AND CORNER POSITION WAS NEVER RECORDED. IN THE COURSE OF REVIEWING THE SECTION MEASUREMENTS AND WITNESSES, IT BECAME CLEAR THAT THE "1/2" BAR AND CAP....TEMP. POINT" RECITED BY SURVEYOR LESTER WAS IN FACT THE PREVIOUSLY MONUMENTED (BUT UNRECORDED) MID-POINT ON LINE FROM 1981. REJECTED THE 1981 DETERMINATION THAT THE CORNER WAS LOST. ACCEPTED THE MONUMENT FOUND AND RECORDED BY FAUSER, AND SUBSEQUENTLY RESTORED BY LESTER. DUG 2' X 2' X 2', FOUND NO FURTHER CORNER EVIDENCE. REPLACED IRON WITH STANDARD REMONUMENTATION IRON & ALUMINUM CAP AND INSTALLED MONUMENT BOX.

	A	B	C	D	E	F	G	H	I	J	K	L	M
1													
2	6		5		4		3		2		1		
3													
4	7		8		9		10		11		12		
5													
6	18		17		16		15		14		13		
7													
8	19		20		21		22		23		24		
9													
10	30		29		28		27		26		25		
11													
12	31		32		33		34		35		36		
13													

C. Description of monument for corner and accessories established to perpetuate locating the position of the corner:

WITNESSES TO STANDARD REMONUMENTATION IRON & ALUMINUM CAP STAMPED "31602"
FOUND NAIL & TAG IN THE SOUTH EAST SIDE OF A 20" WALNUT NAZ 40° 53.23'
FOUND NAIL & TAG #18998 IN THE WEST SIDE OF A 24" WALNUT NAZ 147° 45.19'
FOUND 1/2" IRON NAZ 145° 4.30'
SET NAIL & TAG #31602 IN THE EAST SIDE OF A 36" MAPLE NAZ 340° 82.09'
FOUND NAIL & TAG #KEBS (KYES ENGINEERING - BRYAN SURVEYING) IN THE SOUTH SIDE OF A 12" MAPLE NAZ 299° 42.07'

P.A. 345 INGHAM COUNTY
PEER APPROVED 11/25/2003 *ML*

Signed by

Date NOVEMBER 24, 2003

Surveyor's Michigan License No 31602

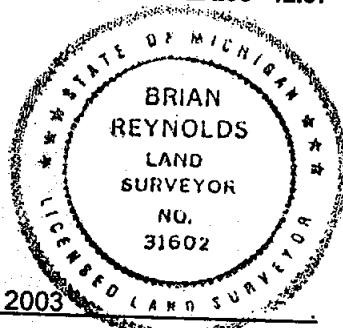

A. Description of original monument and accessories and/or subsequent restoration: (T1N R2W M-08 CONTINUED)

1. GENERAL LAND OFFICE SURVEY BY JOHN MULLETT, D.S., "40.00 SET 1/4 SEC. POST FW. AN IRON.W.D. 6 in. S14W 39 lks. MAPLE 16 in. N10W 53 lks.
2. SURVEY OF THE NORTH 1/2 OF THE SOUTHEAST 1/4 OF SECTION 24 BY A. JACKSON, COUNTY SURVEYOR, DATED APRIL 8, 1854, VOLUME 2, PAGE 194, CORNER IS LABELED "B" ON THE PLAT; IN THE NOTES, NO MONUMENT IS DESCRIBED, THE FOLLOWING WITNESSES ARE LISTED, "MAPLE 16 N10W 53 TAMARACK 6 S14W 39
3. A RETRACEMENT OF THE SURVEY OF THE NORTH 1/2 OF THE SOUTHEAST 1/4 OF SECTION 24 BY A. P. DRAKE, COUNTY SURVEYOR, DATED JUNE 3, 1878, VOLUME 2, PAGE 194, CORNER IS LABELED "B" ON THE PLAT; IN THE NOTES, NO MONUMENT IS DESCRIBED, THE FOLLOWING WITNESSES ARE LISTED, " MAPLE 16 N10W 53 TAMARACK 6 S14W 39 "
4. A SURVEY OF TWO 40 ACRE PARCELS IN SECTION 24, THE NORTHEAST 1/4 OF THE NORTHEAST 1/4, AND THE NORTHWEST 1/4 OF THE SOUTHWEST 1/4, BY W. H. RAYMER, APRIL 25 197?, MAKES NO MENTION OF THE SUBJECT CORNER.
5. LAND CORNER RECORDATION CERTIFICATE BY GLENN C. FAUSER, RECORDED 12-11-79, LIBER 5, PAGE 365, PART "A" IS BLANK, PART "B" "FOUND 3/4" PINCHED PIPE 5' EAST OF CENTERLINE OF RIDLEY ROAD.:EAST 1/4 POST. PART "C" M-8 EAST 1/4 POST S45°E 12" WALNUT 45.24' TO NAIL AND RIBBON N30°E 16" WALNUT 53.21' TO NAIL AND RIBBON N25°W 24" MAPLE 82.45' TO NAIL AND RIBBON N45°W 24" MAPLE 87.25' TO NAIL AND RIBBON CORNER IS 5' EAST OF CENTERLINE RIDLEY ROAD
6. FROM THE CORNER DOSSIER OF THE INGHAM COUNTY SURVEY AND REMONUMENTATION PROJECT, c. 1978, TRAVERSE POINT WITNESS REPORT DATED JANUARY ? 1978, OFFERS NO INFORMATION RELEVANT TO THE SUBJECT CORNER. THE CORNER EXCAVATION REPORT (ONE OF SEVERAL SHEETS) DATED 6-6-1978 INDICATES A FOUND 3/4" PINCH PIPE 23.13' EAST-SOUTHEAST OF THE TRAVERSE POINT. THE INITIAL EXCAVATION APPEARS TO HAVE BEEN A 10.5' X 10' CENTERED ABOUT 1 FOOT EAST OF NORTH-SOUTH ROAD CENTERLINE AND THE AVERAGE OF THE FENCES EAST AND WEST. THE PINCH PIPE IS SHOWN AS 6'± EAST OF CENTERLINE, 5.5' NORTH OF FENCE EAST, 4.3' NORTH OF FENCE WEST, AND WAS WITNESSED AS FOLLOWS: S45E 12" WALNUT 45.24' N30E 16" WALNUT 53.21' N25W 24" MAPLE 82.45' N45W 24" MAPLE 87.25' AN UNSIGNED MARGINAL NOTE INDICATE, "THIS CORNER RECORDED BY FAUSER AS OF 12-19-79. HE USES 3/4 PINCH PIPE AS SHOWN HERE. DETERMINE LOCATION OF MIDWAY & ON LINE. MAY ALSO BE COMMON WITH A-8 LESLIE. ANOTHER UNSIGNED MARGINAL NOTE INSTRUCTS TO EXTEND EXCAVATION 4' TO THE EAST. ANOTHER MARGINAL NOTE SIGNED BY L. BRYAN READS, "SEE NO REASON FOR MORE EXCAVATION. THIS AREA IS A CUT AREA AND CORNER I BELIEVE IS LOST." WHAT APPEARS TO BE THE FINAL UNSIGNED MARGINAL NOTE, THIS TIME ON THE MANILA FOLDER ITSELF, READS, "DISTANCE RECHECK GIVES NO NEW INFORMATION ON POSSIBLE EXCAVATION SITE. SET CORNER MIDWAY AND ON LINE BETWEEN M-7 AND M-9. USE FOUND 3/4" PIPE AS WITNESS TO NEW CORNER. CONTINUE EXCAVATION ONLY IF MIDWAY AND ON LINE FALLS OUTSIDE PREVIOUS EXCAVATION AREA." THE MONUMENTED CORNER REPORT, DATED 5-28-81, UNDER TOWNSHIP IS LISTED AS "M-8 ONONDAGA/ A-8 LESLIE," UNDER CORNER CODE IS LISTED AS "COMMON CORNER". THE SKETCH SHOWS THE CORNER 7.6' EAST OF ROAD CENTERLINE, AND LABELED "M-8 ONONDAGA/A-8 LESLIE SET MON. COLLAR & CAP RLS 18998" THE WITNESSES READ, " WITNESSES FOR M-8 ONONDAGA (COMMON WITH A-8 LESLIE) SET NAIL & TAG (RLS #18998) ON: 1. USED SE CORNER WHITE HOUSE (#4240) N60°W 99.78' 2. E. SIDE 14" MAPLE N35°W 86.72' 3. W. SIDE 10" BASSWOOD N25°E 46.36' 4. W, SIDE 8" CHERRY S E 54.12'
7. LAND CORNER RECORDATION CERTIFICATE BY RONNIE M. LESTER, P.S. No. 18998, LIBER 7 PAGE 17, RECORDED OCTOBER 19, 1988, PART "A" "ORIGINAL MONUMENT AND ACCESSORIES OBLITERATED. CORNER IDENTIFIED AS 3/4" PINCH PIPE OCTOBER 15, 1979 IN CORNER CERTIFICATE AS RECORDED IN LIBER 5, PAGE 365 BY G. FAUSER. PART "B" "FIELD INVESTIGATION AT THIS CORNER REVEALED NO 3/4" PIPE AS IDENTIFIED IN LIBER 5, PAGE 365. ALL FOUR ACCESSORIES WERE FOUND AND A 1/2" BAR WAS SET IN ASPHALT AT LOCATION AS DEFINED BY FAUSER IN 1979. PART "C" "1/2" BAR 5' EAST OF CENTERLINE RIDLEY ROAD ON OCCUPATION LINES EAST AND WEST SET NAIL AND TAG IN EAST SIDE 36" MAPLE, 340° AZ., 82.5' SET NAIL AND TAG IN EAST SIDE 36" MAPLE, 316° AZ., 87.1' SET NAIL AND TAG IN WEST SIDE 16" WALNUT, 147° AZ., 45.3' SET NAIL AND TAG IN EAST SIDE 16" WALNUT, 40° AZ., 53.2' S.E. CORNER STONE FOUNDATION, 292° AZ., 96.1' 1/2" BAR AND CAP (INGHAM CO. TEMP. POINT) 150°AZ., 4.3'



2003-105263

Page: 2 of 2

12/09/2003 08:50A

LAND CORNER RECORDATION CERTIFICATE
Filing Requirement of Act 74, Mich. P.A. 1970

For Corners in
INGHAM
(county)

Located In:

Corner Code #

1. Public Land Survey
1/4 CORNER COMMON TO
SECTIONS 23 & 24
ONONDAGA TOWNSHIP

T 1N R 2W
T _____ R _____
T _____ R _____
T _____ R _____

K-08

Paula Johnson
INGHAM COUNTY
REGISTER OF DEEDS
OFFICIAL SEAL



L-11 P-118

CRNR 14.00

2003-105265



2003-105265

Page: 1 of 1
12/09/2003 08:50A

2. Property Controlling S _____ T _____ R _____
in Section S _____ T _____ R _____

Register of Deeds Stamp & File Number

3. Miscellaneous S _____ T _____ R _____

4. Lot No _____ Recorded Plat _____
5. Private Claims _____

I, Brian Reynolds, in a field survey on June 16, 2003 do hereby certify that under requirements of P.A. 74, Michigan P.A. of 1970, the corner points mentioned in lines 1 and 2 above were in conformance with regulations and rules therefore as required in the current manual of survey instructions of the United States Department of the Interior, Bureau of Land Management or by a decree of a Court of Law and/or that the corner points mentioned in lines 3, 4, and 5 above were in conformance with the rules of the Michigan Board of Land Surveyors or by a Decree of a Court of Law; established, re-established, monumented, re-monumented, recovered, found as expressed below.

NOTE: Not more than 2 corners, all in the same town and range, may be recorded on this certificate.

	A	B	C	D	E	F	G	H	I	J	K	L	M
1													
2	6	5	4	3	2	1							
3													
4	7	8	9	10	11	12							
5													
6	18	17	16	15	14	13							
7													
8	19	20	21	22	23	24							
9													
10	30	29	28	27	26	25							
11													
12	31	32	33	34	35	36							
13													

A. Description of original monument and accessories and/or subsequent restoration:

- GENERAL LAND OFFICE DEPUTY SURVEYOR HERVEY PARKE, 1826, "...40.00 SET 1/4 SEC. POST FW A
W.O. 14 in. S1 1/2E 18 lks. Do. 18" S68W 233 lks....."
- MARGINAL NOTE IN THE POCKET SIZED TRANSCRIPTION OF THE GENERAL LAND OFFICE NOTES, PAGE 29,
"W O 6 in. S44°E 79 lks. Rayner W O 7 in. N88 1/4°W 87 3/4 lks. Rayner"
- FROM THE CORNER DOSSIER OF THE INGHAM COUNTY SURVEY AND REMONUMENTATION PROJECT, c. 1980, A PHOTOCOPY OF AN UNSIGNED, UNDATED SURVEY "FROM W.H. RAYMER BOOK OF NOTES" OF TWO 40 ACRE PARCELS IN SECTION 24. SUBJECT CORNER IS LABELED "F" SAME WITNESSES AS ITEM No. 2 ABOVE.
- NO CORNER DATA SHOWN ON THE ROAD COMMISSION WITNESS MAP
- LAND CORNER RECORDATION CERTIFICATE, LIBER 4, PAGE 58, BY RON HELSEL, P.S. 18994, DATED MARCH 10, 1977,
PART "A": "...FND. 3/4" IRON PIPE 5 FT. MORE OR LESS WEST OF CENTERLINE OF EDGAR ROAD ON LINE WITH E-W 1/4 LINE FENCES. CORNER WITNESSED BY P.K. NAILS CORNER IN ACCORD WITH G.L.O MEASUREMENTS NORTH AND SOUTH."
PART "B" "USED 3/4" PIPE AND REWITNESSED," PART "C" "...3/4" IRON PIPE WEST, 26.58 FT. N & T 15" MAPLE S50°E, 49.79 FT. N & T IN 28" OAK WEST, 20.66 FT. N & T IN ANCHOR POST"
- FROM THE CORNER DOSSIER OF THE INGHAM COUNTY SURVEY AND REMONUMENTATION PROJECT, c. 1980, PRELIMINARY FIELD INSPECTION REPORT DATED NOVEMBER 4, 1977, UNDER "VISIBLE MONUMENT EVIDENCE" THE BOX FOR "PIPE" IS CHECKED, AS IS THE BOX FOR "OTHER", AFTER WHICH THE LINE IS A DESCRIPTION "RLS 12034", NO FURTHER CLARIFICATION. THE ASSOCIATED SKETCH INDICATES A PIPE GRAPHICALLY ON THE WEST SIDE OF EDGAR ROAD, AND AN "RLS CAP & NAIL IN FENCE POST" WITH TWO DOTS APPARENTLY INDICATING THAT THE RLS CAP AND THE NAIL WERE SEPARATE ENTITIES. THE SKETCH SIMILARLY INDICATES A "MAPLE" ON THE WEST SIDE OF THE ROAD WITH AN "RLS CAP" ABOVE A "NAIL" THE SKETCH ALSO INDICATES A TREE ON THE EAST SIDE OF THE ROAD WITH "P.K. NAIL & ORANGE RIBBON". NO BEARINGS OR DISTANCES TO APPARENT FOUND WITNESSES.
- FROM THE CORNER DOSSIER OF THE INGHAM COUNTY SURVEY AND REMONUMENTATION PROJECT, c. 1980, TRAVERSE POINT WITNESS REPORT DATED 1-12-1978, ONE WITNESS TO THE TRAVERSE POINT IS A "1" IRON PIPE THAT IS 5' W. C/L ON DIRECT LINE TO FENCE LINE." THE ASSOCIATED SKETCH INDICATES AN ANCHOR POST DIRECTLY WEST OF THE PIPE, WITH FENCES RUNNING WEST AND NORTH.

B. Description of corner evidence found and/or method applied in restoring or reestablishing corner:

FOUND 3/4" PIPE WITH A PK NAIL & FLAGGING IN THE CENTER OF IT 7.5'± WEST OF CENTERLINE.
DUG A HOLE 2'X2'X4'± THROUGH HARD CLAY, FOUND NO FURTHER EVIDENCE OF MONUMENTATION. ACCEPTED PIPE AS BEST AVAILABLE EVIDENCE OF CORNER POSITION AND REPLACED IT WITH STANDARD 3/4"X24" REMONUMENTATION IRON & ALUMINUM CAP STAMPED #31602, INSTALLED A MONUMENT BOX.

C. Description of monument for corner and accessories established to perpetuate locating the position of the corner:

STANDARD 3/4"X24"REMONUMENTATION IRON & ALUMINUM CAP STAMPED #31602 IN A MONUMENT BOX
FOUND NAIL & TAG #28409 (RON ENGER, P.S.) IN THE NORTH SIDE OF A 36" MAPLE NAZ 265° 26.635'
FOUND NAIL & PLASTIC TAG NO NUMBER IN THE SOUTH SIDE OF A 6"X8" WOOD POST NAZ 270° 20.65'
FOUND NAIL & TAG #18998 IN THE EAST SIDE OF A 30" MAPLE NAZ 340° 58.23' CENTER LINE OF THE ROAD IS EAST-7.5'±
SET NAIL & TAG #31602 IN THE SOUTH SIDE OF AN 8" OAK NAZ 91° 39.73'
TO K-07 IS N00°00'45"W, 2638.44 FEET TO K-09 IS S00°02'52"E, 2631.52 FEET

Signed by [Signature]
Surveyor's Michigan License No 31602

P.A. 345 INGHAM COUNTY
PEER APPROVED 11/25/2003 RL

Date NOVEMBER 24, 2003

FORM APPROVED BY MICHIGAN STATE BOARD OF LAND SURVEYORS JAN. 28, 1971
REVISED MAY 14, 1975 REVISED JANUARY, 1983 REVISED OCTOBER 1995

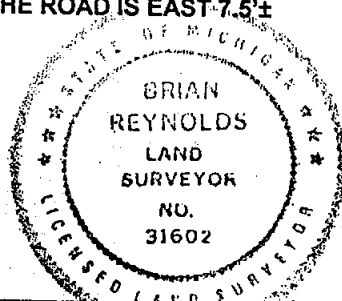

LAND CORNER RECORDATION CERTIFICATE
Filing Requirement of Act 74, Mich. P.A. 1970

For Corners in
INGHAM
(county)

Located In:

Corner Code #

1. Public Land Survey
CENTER 1/4 CORNER
SECTION 24
ONONDAGA TOWNSHIP

T 1N R 2W

L-08

T _____ R _____

T _____ R _____

T _____ R _____

Paula Johnson-
INGHAM COUNTY
REGISTER OF DEEDS
OFFICIAL SEAL



L-11 P-232

CRNR 17.00

2004-062678



2004-062678

Page: 1 of 2

10/05/2004 08:11 A

2. Property Controlling S _____ T _____ R _____
in Section S _____ T _____ R _____

Register of Deeds Stamp & File Number

3. Miscellaneous S _____ T _____ R _____

4. Lot No _____, Recorded Plat _____

5. Private Claims _____

I, Brian Reynolds, in a field survey on JUNE 19, 2003 do hereby certify that under requirements of P.A. 74, Michigan P.A. of 1970, the corner points mentioned in lines 1 and 2 above were in conformance with regulations and rules therefore as required in the current manual of survey instructions of the United States Department of the Interior, Bureau of Land Management or by a decree of a Court of Law and/or that the corner points mentioned in lines 3, 4, and 5 above were in conformance with the rules of the Michigan Board of Land Surveyors or by a Decree of a Court of Law; established, re-established, monumented, re-monumented, recovered, found as expressed below.

NOTE: Not more than 2 corners, all in the same town and range, may be recorded on this certificate.

	A	B	C	D	E	F	G	H	I	J	K	L	M
1													
2	6		5		4		3		2		1		
3													
4	7		8		9		10		11		12		
5													
6	18		17		16		15		14		13		
7													
8	19		20		21		22		23		24		
9													
10	30		29		28		27		26		25		
11													
12	31		32		33		34		35		36		
13													

A. Description of original monument and accessories and/or subsequent restoration:

1. SUBJECT CENTER 1/4 CORNER NOT SET BY GENERAL LAND OFFICE SURVEY.
2. SURVEY OF THE NORTH 1/2 OF THE SOUTHEAST 1/4 OF SECTION 24 BY COUNTY SURVEYOR ANSON JACKSON, DATED APRIL 8, 1854, PLAT OF SURVEY LABELS THE SUBJECT CORNER AS "A;" THE NOTES DO NOT DESCRIBE A MONUMENT, BUT THE CORNER IS WITNESSED BY, "B. ASH 15 N67E 25 1/2 LINKS (Do) 13 S57W 35 LINKS" AN APPARENT TRANSCRIPTION OF THE SURVEY BY JACKSON, SIGNED AND DATED BY COUNTY SURVEYOR A. P. DRAKE, JUNE 3RD, 1878, AGAIN, NO MONUMENT DESCRIBED, WITNESSES THE SAME AS ABOVE. FROM THE SUBJECT CORNER TO THE MID-POINT BETWEEN L-08 AND L-09, JACKSON RECORDS 19.86 CHAINS, DRAKE RECORDS 79 RODS 11 LINKS, THE SOUTH LINE OF THE NORTH 1/2 OF THE SOUTHEAST 1/4 IS RECORDED AS 19.58 CHAINS BY JACKSON, 158 RODS 8 LINKS BY DRAKE. THE ORIGINAL DISTANCE FROM SUBJECT L-08 TO M-08 IS LINED OUT ON THE JACKSON SURVEY, AND 59.56 IS WRITTEN IN; THE DRAKE SURVEY SHOWS 158 RODS 6 LINKS (2610.96') THE DISTANCE BY DRAKE IS PLAUSIBLE; THE DISTANCE BY JACKSON IS NOT.

SEE PAGE TWO FOR CONTINUATION OF CORNER HISTORY

B. Description of corner evidence found and/or method applied in restoring or reestablishing corner.

AT APPARENT CENTER OF SECTION, FOUND 3/4" CAPPED PIPE AS DESCRIBED BY SURVEYOR LESTER. TRAVERSED ALL OF SECTION 24, INCLUDING AN OPEN-ENDED TIE TO THE SUBJECT CORNER. RESULTING COMPUTATIONS INDICATED FOUND PIPE WAS LESS THAN 0.2 FEET FROM BOTH 1/4 LINES. ACCEPTED FOUND PIPE AS PROPER ESTABLISHMENT OF CORNER POSITION. LEFT FOUND PIPE IN PLACE, INSTALLED ALUMINUM REMON CAP STAMPED "31602" ON TOP OF PIPE. FOUND ALL OF SURVEYOR LESTER'S WITNESSES TO BE GOOD.

C. Description of monument for corner and accessories established to perpetuate locating the position of the corner:

WITNESSES TO 3/4" X 24" PIPE WITH ALUMINUM CAP AS STAMPED "31602".

FOUND NAIL AND TAG IN SOUTH SIDE 15" SOFT MAPLE, 310° AZ, 8.3'

FOUND NAIL AND TAG IN WEST SIDE RAILROAD TIE FENCE CORNER POST, 205° AZ, 2.2'

FOUND NAIL AND TAG IN WEST SIDE 36" OAK, 150° AZ, 44.4'

FOUND NAIL AND TAG IN WEST SIDE 10" OAK, 175° AZ, 48.5'

M-08 IS N89°23'57"E 2625.78'

K-08 IS S89°24'26"W 2635.11'

L-07 IS N00°03'26"W 2641.29'

L-09 IS S00°02'55"E 2643.58'

P.A. 345 INGHAM COUNTY
PEER APPROVED 8/31/2004 RL

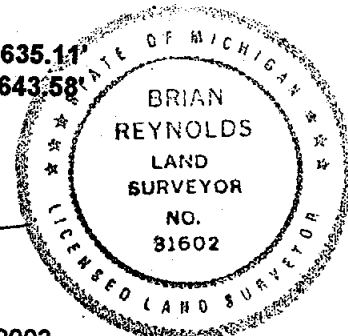

Signed by [Signature]

Date NOVEMBER 24, 2003

Surveyor's Michigan License No 31602

PAGE TWO

A. Description of original monument and accessories and/or subsequent restoration: (T1N R2W L-08 CONTINUED)

3. A TRANSCRIPTION OF SURVEYS OF TWO NON-CONTIGUOUS 1/4-1/4 SECTION PARCELS IN SECTION 24, ATTRIBUTED AS, "FROM W. H. RAYNER BOOK OF NOTES." THE FIRST PORTION OF THE NOTES DESCRIBE THE CORNERS OF THE NW 1/4 OF THE SW 1/4 OF SECTION 24, BY "W. H. RAYNER, APRIL 25, '66. THE SECOND PORTION OF THE NOTES DESCRIBE THE CORNERS OF THE NE 1/4 OF THE NE 1/4 OF SECTION 24, BY "W. H. R," MARCH 13TH, 1872. THE LAST PORTION OF THE NOTES DESCRIBE K-07 AND K-08 ONLY, AND "THIS LAST BY PRESTON," NO DATE. IN ALL OF THIS, THE SUBJECT L-08 IS NEVER EXPLICITLY MENTIONED, ONLY IMPLIED.
4. LAND CORNER RECORDATION CERTIFICATE BY RONNIE LESTER RECORDED OCTOBER 19, 1988 IN LIBER 7, PAGE 16 PART "A" RECITES THE SURVEY BY A. JACKSON, ITEM No. 2 ABOVE PART "B" FIELD INVESTIGATION AT THIS LOCATION REVEALED NO EVIDENCE OF JACKSON'S CORNER OR ACCESSORIES TO THE CORNER. JOG IN EAST-WEST FENCE AND NO FENCE TO THE SOUTH MADE FENCE LINE LOCATION INCONCLUSIVE. SET 3/4" X 24" PIPE AT INTERSECTION OF NORTH-SOUTH AND EAST-WEST 1/4 LINES CORNER FALLS 0.7' EAST OF NORTH-SOUTH FENCE AND 2.0' NORTH OF FENCE EAST AND 4.5' NORTH OF FENCE WEST. PART "C" 3/4" X 24" PIPE WITH IDENTIFICATION CAP AS DESCRIBED ABOVE.
SET NAIL AND TAG IN SOUTH SIDE 15" SOFT MAPLE, 310° AZ, 8.3'
SET NAIL AND TAG IN WEST SIDE RAILROAD TIE FENCE CORNER POST, 205° AZ, 2.2'
SET NAIL AND TAG IN WEST SIDE 36" OAK, 150° AZ, 44.4'
SET NAIL AND TAG IN WEST SIDE 10" OAK, 175° AZ, 48.5'



2004-062678

Page: 2 of 2

10/05/2004 08:11 A

LAND CORNER RECORDATION CERTIFICATE
Filing Requirement of Act 74, Mich. P.A. 1970

For Corners in
INGHAM
(county)

Located In:

Corner Code #

1. Public Land Survey
1/4 CORNER COMMON TO
SECTIONS 24 AND 25
ONONDAGA TOWNSHIP

T 1N R 2W

L-09

T R

T R

T R

Paula Johnson-
INGHAM COUNTY
REGISTER OF DEEDS
OFFICIAL SEAL



L-11 P-234

CRNR 14.00

2004-062679

2. Property Controlling S T R
in Section S T R



2004-062679

Page: 1 of 1

10/05/2004 08:11 A

Register of Deeds Stamp & File Number

3. Miscellaneous S T R

4. Lot No _____, Recorded Plat _____

5. Private Claims _____

I, Brian Reynolds, in a field survey on June 17, 2003 do hereby certify that under requirements of P.A. 74, Michigan P.A. of 1970, the corner points mentioned in lines 1 and 2 above were in conformance with regulations and rules therefore as required in the current manual of survey instructions of the United States Department of the Interior, Bureau of Land Management or by a decree of a Court of Law and/or that the corner points mentioned in lines 3, 4, and 5 above were in conformance with the rules of the Michigan Board of Land Surveyors or by a Decree of a Court of Law; established, re-established, monumented, re-monumented, recovered, found as expressed below.

NOTE: Not more than 2 corners, all in the same town and range, may be recorded on this certificate.

	A	B	C	D	E	F	G	H	I	J	K	L	M
1													
2		6		5		4		3		2		1	
3													
4		7		8		9		10		11		12	
5													
6		18		17		16		15		14		13	
7													
8		19		20		21		22		23		24	
9													
10		30		29		28		27		26		25	
11													
12		31		32		33		34		35		36	
13													

- GENERAL LAND OFFICE DEPUTY SURVEYOR HERVEY PARKE, 1826, "WEST CORRECTED....39.99 SET 1/4 SEC. POST AT AV. D. ON THE TRUE LINE, FW IRONWOOD 5 IN. S70E 1LK Do. 5 IN. N78W 16
- SURVEY OF THE NORTH 1/2 OF THE SOUTHEAST 1/4 OF SECTION 24 BY A. JACKSON, COUNTY SURVEYOR, DATED APRIL 8, 1854, VOLUME 2, PAGE 194, NO MONUMENT OR WITNESSES RECITED.
- LAND CORNER RECORDATION CERTIFICATE BY FRED N. WHITE, P.S. No. 12034, RECORDED 11-28-72, LIBER 2, PAGE 199, PART "A" "ORIGINAL CORNER AND WITNESSES OBLITERATED," PART "B" "SET 1/2" IRON BY PROPORTIONAL MEASUREMENT AND ON A DIRECT LINE BETWEEN SECTION CORNERS (CORNER FALLS 2.5' SOUTH OF CENTERLINE)" PART "C" "SET 1/2" IRON BAR ANCHOR POST NORTH 36.03' 12" TAMARACK S04°00'W 44.86' 12" TAMARACK S30°00'W 48.92'.."
- FROM THE CORNER DOSSIER OF THE INGHAM COUNTY SURVEY AND REMONUMENTATION PROJECT, c. 1978, TRAVERSE POINT WITNESS REPORT DATED 1-4-1978, THE SUBJECT CORNER IS TRAVERSE POINT No. 2138 DESCRIBED AS "FOUND 1/2" IRON BAR 4.30 S. C/L" GRAPHICALLY SHOWN AS 8.04' NORTH OF THE SOUTH EDGE OF THE TRAVELED ROADWAY, AND WITH THE FOLLOWING WITNESSES, "N. 36.04' ANCOHOR (sic) POST S. 44.76' 12" TAMARACK S.S.W. 48.80' 12" TAMARACK
- LAND CORNER RECORDATION CERTIFICATE BY GLENN C. FAUSER, P.S. 18657, RECORDED 12-11-79, LIBER 5, PAGE 365, PART "A" IS BLANK, PART "B" "FOUND 1/2" RE-ROD 4.4' NORTH OF CENTERLINE OF BELLEVUE ROAD. :SOUTH 1/4 POST. PART "C" L-9 SOUTH 1/4 POST NORTH FENCE CORNER POST 36.08' EXISTING TAG RLS 12034 N25°W 12" CEDAR 48.90' TO NAIL & WASHER N5°E NORTHEAST CORNER OF PORCH HOUSE #3771 57.80'

B. Description of corner evidence found and/or method applied in restoring or reestablishing corner:
FOUND 1/2" IRON 5'± SOUTH OF THE CENTERLINE OF BELLEVUE HWY. DUG A HOLE 2'X2' THROUGH THE BITUMINOUS SURFACE. AT 1.0'± ENCOUNTERED A SECOND LAYER OF BITUMINOUS. EXCAVATED THROUGH THAT TO A FINAL DEPTH OF ABOUT 4'±, FOUND NO EVIDENCE OF PREVIOUS MONUMENTATION. ACCEPTED FOUND IRON AS BEST AVAILABLE EVIDENCE OF CORNER POSITION. REPLACED FOUND IRON WITH STANDARD 3/4"X24" REMONUMENTATION IRON AND ALUMINUM CAP STAMPED #31602, AND INSTALLED A MONUMENT BOX

C. Description of monument for corner and accessories established to perpetuate locating the position of the corner:
WITNESSES TO 3/4" X 24" STEEL FORM PIN WITH ALUMINUM CAP STAMPED #31602 IN MONUMENT BOX.
SET NAIL & TAG #31602 IN THE EAST SIDE OF A 24" PINE NAZ 185° 45.06'
SET NAIL & TAG #31602 IN THE SOUTHEAST SIDE OF A 24" PINE NAZ 204° 48.96'
SET NAIL & TAG #31602 IN THE SOUTHWEST SIDE OF A 30" BOX ELDER NAZ 128° 94.87'
SET NAIL & TAG #31602 IN THE WEST SIDE OF A 6"X8" POST NAZ 28° 41.35'
NORTHEAST CORNER OF A BARN NAZ 167° 162.325'
NORTHEAST CORNER OF HOUSE #3771 NAZ 175° 64.22'

K-09 IS N89°40'10"W 2635.05'
L-08 IS N00°02'55"W 2643.58'
M-09 IS N89°40'46"E 2634.84'

Signed by

Surveyor's Michigan License No 31602

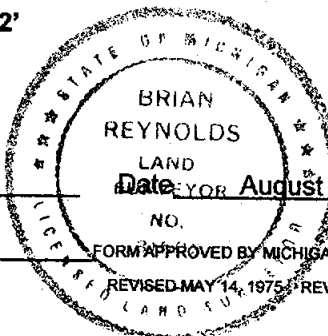

P.A. 345 INGHAM COUNTY
PEER APPROVED 8/31/2004

Date: August 22, 2004

FORM APPROVED BY MICHIGAN STATE BOARD OF LAND SURVEYORS. JAN. 28, 1971
REVISED MAY 14, 1975 REVISED JANUARY, 1983 REVISED OCTOBER 1995

LAND CORNER RECORDATION CERTIFICATE
Filing Requirement of Act 74, Mich. P.A. 1970

For Corners in
INGHAM
(county)

Located In:

Corner Code #

1. Public Land Survey
CORNER COMMON TO
SECTIONS 24 & 25
ONONDAGA TOWNSHIP
ON RANGE LINE

T 1N R 2W

M-09

T____ R____
T____ R____
T____ R____

Paula Johnson-
INGHAM COUNTY
REGISTER OF DEEDS
OFFICIAL SEAL



L-11 P-235

CRNR 17.00

2004-062680



2004-062680

Page: 1 of 2
10/05/2004 08:11 A

Register of Deeds Stamp & File Number

2. Property Controlling S____ T____ R____
in Section S____ T____ R____

3. Miscellaneous S____ T____ R____

4. Lot No____, Recorded Plat____

5. Private Claims____

I, Brian Reynolds, in a field survey on JUNE 18, 2003 do hereby certify that under requirements of P.A. 74, Michigan P.A. of 1970, the corner points mentioned in lines 1 and 2 above were in conformance with regulations and rules therefore as required in the current manual of survey instructions of the United States Department of the Interior, Bureau of Land Management or by a decree of a Court of Law and/or that the corner points mentioned in lines 3, 4, and 5 above were in conformance with the rules of the Michigan Board of Land Surveyors or by a Decree of a Court of Law; established, re-established, monumented, re-monumented, recovered, found as expressed below.

NOTE: Not more than 2 corners, all in the same town and range, may be recorded on this certificate.

	A	B	C	D	E	F	G	H	I	J	K	L	M
1													
2		6		5		4		3		2		1	
3													
4		7		8		9		10		11		12	
5													
6		18		17		16		15		14		13	
7													
8		19		20		21		22		23		24	
9													
10		30		29		28		27		26		25	
11													
12		31		32		33		34		35		36	
13													

A. Description of original monument and accessories and/or subsequent restoration:

SEE PAGE TWO FOR HISTORICAL SUMMARY

B. Description of corner evidence found and/or method applied in restoring or reestablishing corner:

FOUND BOAT SPIKE 1.5±' NORTH OF CENTERLINE OF BELLEVUE ROAD. PROCEEDED TO DIG A 2' X 2' X 4.5' HOLE BENEATH THE ROAD THROUGH ABOUT 14" OF BITUMINOUS, THEN SAND, THEN HARD CLAY. FOUND NO ADDITIONAL EVIDENCE OF PREVIOUS MONUMENTATION. ACCEPTED FOUND BOAT SPIKE AS BEST AVAILABLE EVIDENCE OF CORNER POSITION. REPLACED WITH REMONUMENTATION IRON AND ALUMINUM CAP AND INSTALLED MONUMENT BOX.

C. Description of monument for corner and accessories established to perpetuate locating the position of the corner:

WITNESSES TO 3/4" X 24" STEEL FORM PIN WITH ALUMINUM CAP STAMPED "31602" IN MONUMENT BOX
FOUND NAIL AND "KEBS" TAG IN THE NORTH EAST SIDE OF A 24" MAPLE NAZ 329° AT 53.21'
FOUND NAIL AND TAG IN THE EAST SIDE OF A 24" MAPLE NAZ 329° 52.81'
FOUND NAIL AND TAG #18998 (RONNIE M. LESTER, P.S.) IN THE SOUTHSIDE OF A 30" HICKORY NAZ 72° 108.04'
FOUND NAIL IN THE NORTH SIDE OF A 40" MAPLE NAZ 109° 88.66'
SET NAIL AND TAG #31602 IN THE SOUTH SIDE OF A 30" MAPLE NAZ 295° 67.63'
REMONUMENTATION IRON W/CAP IN MONUMENT BOX AT A-09 T1N R1W LIES SOUTH 3.28'
L-09 IS S89°40'46"W 2634.84'
M-08 IS N00°14'46"W 2656.40'

P.A. 345 INGHAM COUNTY

PEER APPROVED 8/31/2004 M



Signed by

Date AUGUST 22, 2004

Surveyor's Michigan License No 31602

FORM APPROVED BY MICHIGAN STATE BOARD OF LAND SURVEYORS. JAN. 28, 1971
REVISED MAY 14, 1975 REVISED JANUARY, 1983 REVISED OCTOBER 1995

PAGE TWO

A. Description of original monument and accessories and/or subsequent restoration: T1N R2W M-09 CONTINUED

1. GENERAL LAND OFFICE SURVEY BY JOHN MULLETT, D.S., "80.00 SET POST COR. TO SECS. 24 & 25 FW.
A W.O. 18 in. S7W 82 lks. SUGAR 7 in. N13W 74 lks.
2. SURVEY OF THE NORTH 1/2 OF THE SOUTHEAST 1/4 OF SECTION 24 BY A. JACKSON, COUNTY SURVEYOR, DATED APRIL 8, 1854, VOLUME 2, PAGE 194, CORNER IS LABELED "E" ON THE PLAT; IN THE NOTES, "IRON STAKE DRIVEN, THE FOLLOWING WITNESS IS LISTED, "ELM 24 N36 1/4W 43" A MARGINAL NOTE READS, "I FOUND OLD CORNER AND REWITNESSED, A. P. DRAKE 1878
3. A RETRACEMENT OF THE JACKSON SURVEY OF THE NORTH 1/2 OF THE SOUTHEAST 1/4 OF SECTION 24 BY A. P. DRAKE, COUNTY SURVEYOR, DATED JUNE 3, 1878, VOLUME 2, PAGE 194, CORNER IS LABELED "E" ON THE PLAT; IN THE NOTES, "AT "E" I FIND THE ORIGINAL SEC. CORNER AND DRIVE AN IRON STAKE FROM WHICH AN ELM 24 IN. BEARS N36 1/4W 43 LKS. THIS WOULD SEEM TO INDICATE THAT THE ENTIRE ENTRY IN JACKSON'S NOTES REGARDING THE SUBJECT CORNER WAS BY DRAKE, NOT JACKSON.
4. LAND CORNER RECORDATION CERTIFICATE, LIBER 2 PAGE 203 BY FRED N. WHITE, P.S. 12034, DATED SEPTEMBER 15, 1972, PART "A" READS "ORIGINAL CORNER AND WITNESSES OBLITERATED" PART "B" READS, "FOUND BOLT SPIKE. VERIFIED BY ADJOINING CORNERS & PROPERTY LINES. PART "C" READS, "LEFT BOLT SPIKE FROM WITNESSES 30" MAPLE S60°E 89.05'
14" POPULAR (sic) N72°30'E 108.08' 20" MAPLE N64°00'W 68.35'
5. LAND CORNER RECORDATION CERTIFICATE, LIBER 5 PAGE 367 BY GLENN A. FAUSER, P.S. 18657, DATED SEPTEMBER 15, 1972, PART "A" IS BLANK PART "B" READS, "FOUND 1/2" REROD PART "C" READS, "FD. 1/2" REROD N55W 24" MAPLE 67.03' N65W 30" MAPLE 94.12'
N60E 34" MAPLE 88.53' FD 1/2" REROD & CAP 3.27' SOUTH OF CORNER
6. FROM THE CORNER DOSSIER OF THE INGHAM COUNTY SURVEY AND REMONUMENTATION PROJECT, c. 1980, PRELIMINARY FIELD INSPECTION REPORT DATED NOVEMBER 4, 1977, UNDER "VISIBLE MONUMENT EVIDENCE" THE BOX FOR "OTHER" IS CHECKED, AFTER WHICH THE LINE IS A DESCRIPTION "YELLOW CAP", NO FURTHER CLARIFICATION. THE ASSOCIATED SKETCH INDICATES A "YELLOW CAP" GRAPHICALLY ON THE SOUTH SIDE OF THE CENTER OF BELLEVUE ROAD, AND APPROXIMATELY IN LINE WITH THE CENTER OF RIDLEY ROAD, APPARENTLY REFERRING TO THE CORRESPONDING CLOSING CORNER.
7. FROM THE CORNER DOSSIER OF THE INGHAM COUNTY SURVEY AND REMONUMENTATION PROJECT, c. 1980, TRAVERSE POINT WITNESS REPORT DATED 1-4-1978, THE SUBJECT CORNER IS TRAVERSE POINT No. 2129 DESCRIBED AS "FOUND BOLT SPIKE IN C/L OF BOTH RDS," GRAPHICALLY SHOWN AS 11.80' NORTH OF THE SOUTH EDGE OF THE TRAVELED ROADWAY, AND WITH THE FOLLOWING WITNESSES, "N.W. 67.27' 20" MAPLE E.NE. 108.10' 14" POPULAR (sic) E.SE. 89.01' 30" MAPLE



2004-062680
Page: 2 of 2
10/05/2004 08:11 A