

LAND CORNER RECORDATION CERTIFICATE  
Filing Requirement of Act 74, Mich. P.A. 1970

For corners in

Liber 9 Page 264

INGHAM	Located In:	Corner Code #
(County)		
STOCKBRIDGE TOWNSHIP		
1. Public Land Survey	T 1N R 2E	A-2
	T R	
	T R	
	T R	
2. Property Controlling	S T R	
in Section	S T R	
3. Miscellaneous	S T R	
Property in Sec.	S T R	

FILED

970044056  
11/05/1997 12:39:46  
REGISTER OF DEEDS  
Paula Johnson  
INGHAM COUNTY, MI

Register of Deeds Stamp & File Number

4. Lot No. , Recorded Plat  
5. Private Claims

I, DAVID L. CLIFFORD, in a field survey on SEPT. 23, 1997 do hereby state that under requirements of P.A. 74, Michigan P.A. of 1970, the corner points mentioned in lines 1 and 2 above were in conformance with regulations and rules therefore as required in the current manual of survey instructions of the United States Department of the Interior, Bureau of Land Management or by a decree of a Court of Law and /or that the corner points mentioned in lines 3, 4 and 5 above were in conformance with the rules of the Michigan Board of Land Surveyors or by a Decree of a Court of Law; established, re-established, monumented, recovered, found as expressed below:

NOTE: Not more than 2 corners, all in the same town and range, may be recorded on this certificate.

	A	B	C	D	E	F	G	H	I	J	K	L	M
1													
2	6		5		4		3		2		1		
3													
4	7		8		9		10		11		12		
5													
6	18		17		16		15		14		13		
7													
8	19		20		21		22		23		24		
9													
10	30		29		28		27		26		25		
11													
12	31		32		33		34		35		36		
13													

- A. Description of original monument and accessories and/or subsequent restoration:
- JOSEPH WAMPLER D.S. SET POST FOR M-2, T1N, R1E IN FEBRUARY 1824.  
TAMARACK 8" N12W 289LKS (190.7')  
"NO OTHER TREE"
  - CORNER NOT SET IN ORIGINAL GOVERNMENT SURVEY
  - THERE IS NO PUBLIC RECORD OF ESTABLISHMENT OF THE CORNER BY THE INGHAM COUNTY SURVEYOR.
  - AUSTIN WILLIAMS RLS 21275 USED CORNER IN ACT 132 SURVEYS RECORDED IN LIBER 3 PAGE 425 IN MAY 1978 AND LIBER 4 PAGE 646 IN SEPTEMBER 1981 AND RECORDED IT IN LIBER 5 PAGE 152 OF CORNERS IN JANUARY 1979 AS 1/2" ROD SET AT INTERSECTION OF FENCES NORTH, SOUTH AND EAST. NAIL & TAG 10" ELM, NORTH, 10.10'; NAIL & TAG 8" ELM, S30°E, 13.40'  
NAIL & TAG 8" ELM, N45°E, 28.00'.
  - GEORGE YOUNG, RLS 17640, USED CORNER IN AN ACT 132 SURVEY RECORDED IN LIBER 4 PAGE 552 IN JUNE 1982 WITH SAME MONUMENT AND WITNESSES AS ITEM 4.

B. Description of corner evidence found and/or method applied in restoring or reestablishing corner:  
SEARCHED AT APPARENT LOCATION OF CORNER AND FOUND 1/2" BAR AND CAP #21275 IN OLD ANCHOR POST HOLE 59.44' SOUTH OF M-2, T1N, R1E (3/4" BAR & PA 345 PS 30090 CAP). TRAVERSED ALL OF SECTION 6 AND ACCEPTED BAR & CAP AS CORNER BECAUSE OF CLOSE RELATIONSHIP TO PROPORTIONAL MEASUREMENT IN RELATION TO THE STANDARD LINE, LONG USAGE AND THE FACT THAT I CANNOT THINK OF A BETTER PLACE FOR IT. AMENDED CORNER LOCATION BY EXTENDING EAST-WEST 1/4 LINE 1.68' WEST TO THE STANDARD LINE. SET 3/4" BAR & PA 345 CAP AT THIS LOCATION. CORNER STILL FALLS IN ANCHOR POST HOLE. MEASURED NORTH 2703.56' TO A-1. MEASURED SOUTH 2678.87' TO A-3. MEASURED EAST 2304.30' TO B-2.

C. Description of monument for corner and accessories established to perpetuate locating the position of the corner:

A-2 T1N R2E  
3/4" X 24" SMOOTH STEEL BAR WITH YELLOW PLASTIC CAP IMPRINTED PA 345 PS 25837  
3/4" BAR WITH YELLOW PLASTIC CAP IMPRINTED PA 345 PS 30090(DAVE LOHR), (M-2, T1N, R1E), 0° NAZ, 59.44'  
SET NAIL AND TAG # 25837 IN SOUTH SIDE 7" ASH, 86° NAZ., 18.70'  
FOUND NAIL AND TAG # 30090 IN WEST SIDE 15" ASH, 357° NAZ., 11.04'  
1/2" BAR & CAP 21275 (OFF LINE MONUMENT), 90° NAZ., 1.68'  
SET NAIL & TAG #25837 IN WEST SIDE 10" ASH, 157° NAZ., 13.90'  
SET NAIL AND TAG #25837 IN EAST SIDE 13" ASH, 182° NAZ., 36.30'  
CORNER LIES 10' EAST OF CENTERLINE OPEN COUNTY DRAIN

Signed by David L. Clifford  
Surveyor's Michigan License No. 25837

Date OCTOBER 25, 1997

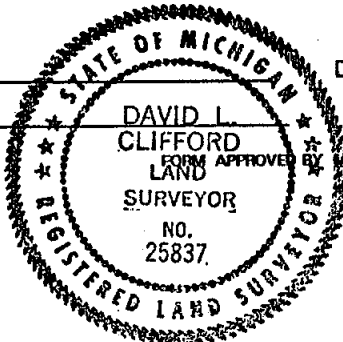

MICHIGAN STATE BOARD OF PROFESSIONAL SURVEYORS,  
JAN. 28, 1971  
REVISED MAY 14, 1975  
REVISED JAN., 1983  
REVISED OCT., 1995

P.A. 345 INGHAM COUNTY  
PEER APPROVED 10/30/97 M

LAND CORNER RECORDATION CERTIFICATE  
Filing Requirement of Act 74, Mich. P.A. 1970

For corners in

Liber 9 Page 265

INGHAM COUNTY  
(County)

Located In:

Corner #

STOCKBRIDGE TOWNSHIP

1. Public Land Survey

T 1N R 2E

A-3

T R

T R

T R

T R

2. Property Controlling  
in Section

S

T R

S

T R

3. Miscellaneous

S

T R

Property in Sec.

S

T R

FILED

970044057  
11/05/1997 12:39:51  
REGISTER OF DEEDS  
Paula Johnson  
INGHAM COUNTY, MI

Register of Deeds Stamp & File Number

4. Lot No. , Recorded Plat

5. Private Claims

I, DAVID L. CLIFFORD, in a field survey on OCTOBER 3, 1997

do hereby state that under requirements of P.A. 74, Michigan P.A. of 1970, the corner points mentioned in lines 1 and 2 above were in conformance with regulations and rules therefore as required in the current manual of survey instructions of the United States Department of the Interior, Bureau of Land Management or by a decree of a Court of Law and /or that the corner points mentioned in lines 3, 4 and 5 above were in conformance with the rules of the Michigan Board of Land Surveyors or by a Decree of a Court of Law; established, re-established, monumented, recovered, found as expressed below:

NOTE: Not more than 2 corners, all in the same town and range, may be recorded on this certificate.

	A	B	C	D	E	F	G	H	I	J	K	L	M
1													
2		6		5		4		3		2		1	
3													
4		7		8		9		10		11		12	
5													
6		18		17		16		15		14		13	
7													
8		19		20		21		22		23		24	
9													
10		30		29		28		27		26		25	
11													
12		31		32		33		34		35		36	
13													

A. Description of original monument and accessories and/or subsequent restoration:

- JOSEPH WAMPLER D.S. SET POST FOR M-3, T1N, R1E, IN ORIGINAL GOVERNMENT SURVEY IN FEBRUARY 1824: ASPEN 12" N½W 1077LKS; NO OTHER TREE.
- SYLVESTER SIBLEY D.S. SET POST 100 LINKS (66') SOUTH OF M-3, T1N, R1W, IN ORIGINAL GOVERNMENT SURVEY: "NO TREES FOR BEARINGS, IN MARSH"
- E.A. CALKINS, COUNTY SURVEYOR, STATES THAT HE STAKED CENTERLINE OF DOUGLAS DRAIN ON THE SECTION LINE BETWEEN SECTIONS 6 & 7 BUT DOES NOT MENTION CORNER WHEN LINE IS DESCRIBED IN THE MINUTES OF SURVEY FOR THE DOUGLAS DRAIN.
- W.E. ZIMMER PE OF WOLVERINE ENGINEERS & SURVEYORS CALLS FOR CORNER TO FALL AT THE POINT WHERE THE DOUGLAS DRAIN TURNS NORTH IN A SURVEY PERFORMED IN OCTOBER 1968.
- M. MAHIEU, LPS # 28414 SET A 1½" PIPE AT THE INTERSECTION OF DITCHES NORTH & EAST BASED ON THE DISTANCES RECORDED BY ZIMMER ON HIS 1968 SURVEY.

B. Description of corner evidence found and/or method applied in restoring or reestablishing corner:

SEARCHED AT APPARENT LOCATION OF CORNER AND FOUND A 1½" PIPE 13.2' SOUTH OF ANOTHER 1½" PIPE RECORDED IN LIBER 4 PAGE 14 AS M-3 T1N, R1E. AFTER TRAVERSEING ALL OF SECTIONS 6 & 7 OF STOCKBRIDGE TOWNSHIP AND SECTION 12 OF BUNKERHILL TOWNSHIP THIS SURVEYOR WAS CONVINCED THAT NEITHER PIPE MARKED EITHER OF THE CORNER POSITIONS ESTABLISHED BY THE GOVERNMENT SURVEY IN 1824 & 1825. REESTABLISHED M-3 BUNKERHILL BY SINGLE PROPORTIONATE MEASUREMENT AND SET A-3 STOCKBRIDGE 66' (THE GLO FALLING) SOUTH OF IT. IT IS MY OPINION THAT THESE POSITIONS ARE VERY CLOSE TO THE POSITIONS OF THE CORNERS AS THEY WERE ORIGINALLY ESTABLISHED. SET 1½" GALVANIZED PIPE WITH PA 345 CAP IN EAST EDGE OF DRAIN FROM SOUTH.

C. Description of monument for corner and accessories established to perpetuate locating the position of the corner:

A-3 T1N, R2E

1½" GALVANIZED STEEL PIPE & YELLOW PLASTIC CAP IMPRINTED PA 345 PS 25837 IN EAST EDGE DRAIN

FOUND NAIL & TAG #28414 SOUTH SIDE 15" MULTIPLE BOX ELDER, 265° NAZ, 23.55'

SET NAIL & TAG #25837 EAST SIDE 12" ELM, 226° NAZ, 33.25'

FOUND NAIL & TAG #28414 WEST SIDE 6" POPLAR, 07° NAZ, 59.93'

SET NAIL & TAG #25837 EAST SIDE 16" POPLAR, 346° NAZ, 32.81'

SET NAIL & TAG #25837, EAST SIDE 15" WILLOW, 342° NAZ, 40.32'

1½" GALVANIZED STEEL PIPE & CAP (M-3, T1N, R1E), 0° NAZ, 66.00'

1½" GALVANIZED STEEL PIPE (PROPERTY CONTROLLING CORNER), 0° NAZ, 43.63'

1½" GALVANIZED STEEL PIPE (PROPERTY CONTROLLING CORNER), 0° NAZ, 30.43'

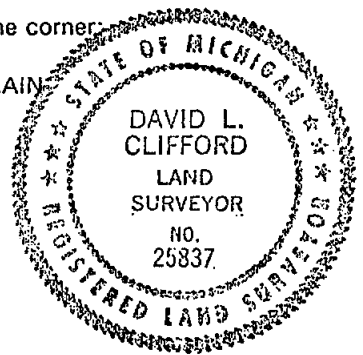

Signed by David L. Clifford  
Surveyor's Michigan License No. 25837

Date OCTOBER 15, 1997

FORM APPROVED BY MICHIGAN STATE BOARD OF PROFESSIONAL SURVEYORS, JAN. 28, 1971  
REVISED MAY 14, 1975  
REVISED JAN., 1983  
REVISED OCT., 1985

P.A. 345 INGHAM COUNTY  
PEER APPROVED 10/16/97 M

LAND CORNER RECORDATION CERTIFICATE  
Filing Requirement of Act 74, Mich. P.A. 1970

For corners in

Liber 9 Page 266

INGHAM COUNTY Located In: Corner Code #

(County)

STOCKBRIDGE TOWNSHIP

1. Public Land Survey

T 1N R 2E

B-1

T R

T R

T R

2. Property Controlling  
in Section

S T R

S T R

3. Miscellaneous

S T R

Property in Sec.

S T R

FILED

970044058  
11/05/1997 12:39:52  
REGISTER OF DEEDS  
Paula Johnson  
INGHAM COUNTY, MI

Register of Deeds Stamp & File Number

4. Lot No. , Recorded Plat

5. Private Claims

	A	B	C	D	E	F	G	H	I	J	K	L	M
1													
2	6	5	4	3	2	1							
3													
4	7	8	9	10	11	12							
5													
6	18	17	16	15	14	13							
7													
8	19	20	21	22	23	24							
9													
10	30	29	28	27	26	25							
11													
12	31	32	33	34	35	36							
13													

I, DAVID L. CLIFFORD

, in a field survey on OCTOBER 3 19 97  
do hereby state that under requirements of P.A. 74, Michigan P.A. of 1970, the corner points  
mentioned in lines 1 and 2 above were in conformance with regulations and rules therefore as  
required in the current manual of survey instructions of the United States Department of the Interior,  
Bureau of Land Management or by a decree of a Court of Law and /or that the corner points  
mentioned in lines 3, 4 and 5 above were in conformance with the rules of the Michigan Board of  
Land Surveyors or by a Decree of a Court of Law; established, re-established, monumented,  
recovered, found as expressed below:

NOTE: Not more than 2 corners, all in the same town and range, may be recorded  
on this certificate.

A. Description of original monument and accessories and/or subsequent restoration:

1. CORNER NOT SET IN ORIGINAL GOVERNMENT SURVEY.

2. JOHN YOKUM, FORMER WASHTENAW COUNTY SURVEYOR APPARENTLY USED CORNER WHILE MEASURING THE NORTH-SOUTH  
1/4 LINE OF SECTION 6. THIS INFORMATION IS RECORDED IN HIS PRIVATE RECORDS (NOW IN THE POSSESSION OF WOLVERINE  
ENGINEERS AND SURVEYORS ). THESE RECORDS ARE IN A BOUND FIELD BOOK DATED 1878.

B. Description of corner evidence found and/or method applied in restoring or reestablishing corner:

SEARCHED AT APPARENT LOCATION OF CORNER(ON AN EAST-WEST FENCE LINE 190' TO 220 FEET WEST OF B-13, T2N, R2W).  
EXCAVATED 30' BY 4' HOLE 2' DEEP ALONG SAID FENCE LINE AND FOUND NO HISTORICAL EVIDENCE OF CORNER. FOUND A 1/2"  
BAR & CAP #25832 IN FENCE LINE 106.6 FEET WEST OF STANDARD CORNER. THIS IS THE MEAN OF THE FALLING AT NORTHEAST  
AND NORTHWEST CORNERS OF THE SECTION AND I DO NOT BELIEVE THAT THIS IS THE PROPER METHOD TO USE IN A LOST  
CORNER REESTABLISHMENT OF THE NORTH 1/4 CORNER OF SECTION 6. CONSIDERED THIS A LOST CORNER AND SET 3/4" BAR &  
CAP ON STANDARD LINE BY PROPORTIONATE MEASUREMENT IN RELATION TO GLO FALLING AT NORTHEAST CORNER OF  
SECTION 6. CORNER LIES 213.2 FEET WEST OF B-13, T2N, R2W THE SAME FALLING AS AT THE NORTHEAST CORNER OF SECTION  
6. MEASURED EAST 2657.20' TO C-1. MEASURED WEST 2269.80' TO A-1. MEASURED SOUTH 2691.24 TO B-2

C. Description of monument for corner and accessories established to perpetuate locating the position of the corner:

3/4" X 24' SMOOTH STEEL BAR & YELLOW PLASTIC CAP IMPRINTED PA 345 PS 25837  
N.E. CORNER 10" I-BEAM ANCHOR POST, 269° NAZ, 117.63'  
SET NAIL & TAG #25837 SOUTH SIDE 18" WHITE OAK, 263° NAZ, 142.48'  
SET NAIL & TAG #25837 SOUTH SIDE RAILROAD TIE FENCE POST, 89° NAZ, 20.16'  
SET NAIL & TAG #25837 NORTH SIDE 4" HICKORY, 75° NAZ, 111.88'  
FOUND 1/2" BAR & CAP #25832, 90° NAZ, 106.6'  
FOUND 1 1/4" STEEL SHAFT & 1/2" BAR & CAP #18998 (B-13, T2N, R2E), 90° NAZ, 213.20'

Signed by

David L. Clifford

Date OCTOBER 29, 1997

Surveyor's Michigan License No. 25837

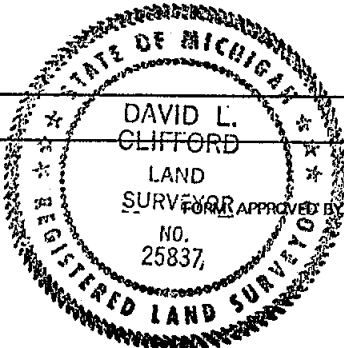

P.A. 345 INGHAM COUNTY  
PEER APPROVED 10/16/97 m

FORM APPROVED BY MICHIGAN STATE BOARD OF PROFESSIONAL SURVEYORS, JAN. 28, 1971  
REVISED MAY 14, 1975  
REVISED JAN., 1983  
REVISED OCT., 1985

LAND CORNER RECORDATION CERTIFICATE  
Filing Requirement of Act 74, Mich. P.A. 1970

For corners in

Liber 9 Page 267

INGHAM COUNTY  
(County)

Located In:

Corner Code #

STOCKBRIDGE TOWNSHIP

1. Public Land Survey

T 1N R 2E

B-2

2. Property Controlling  
in Section

S T R

3. Miscellaneous  
Property in Sec.

S T R

FILED

970044059  
11/05/1997 12:39:54  
REGISTER OF DEEDS  
Paula Johnson  
INGHAM COUNTY, MI

Register of Deeds Stamp & File Number

4. Lot No. \_\_\_\_\_, Recorded Plat \_\_\_\_\_  
5. Private Claims \_\_\_\_\_

	A	B	C	D	E	F	G	H	I	J	K	L	M
1													
2		6		5		4		3		2		1	
3													
4		7		8		9		10		11		12	
5													
6		18		17		16		15		14		13	
7													
8		19		20		21		22		23		24	
9													
10		30		29		28		27		26		25	
11													
12		31		32		33		34		35		36	
13													

I, DAVID L. CLIFFORD

, in a field survey on OCTOBER 3 19 97

do hereby state that under requirements of P.A. 74, Michigan P.A. of 1970, the corner points mentioned in lines 1 and 2 above were in conformance with regulations and rules therefore as required in the current manual of survey instructions of the United States Department of the Interior, Bureau of Land Management or by a decree of a Court of Law and /or that the corner points mentioned in lines 3, 4 and 5 above were in conformance with the rules of the Michigan Board of Land Surveyors or by a Decree of a Court of Law; established, re-established, monumented, recovered, found as expressed below:

NOTE: Not more than 2 corners, all in the same town and range, may be recorded on this certificate.

A. Description of original monument and accessories and/or subsequent restoration:

1. CORNER NOT SET IN ORIGINAL GOVERNMENT SURVEY.

2. JOHN YOKUM, FORMER WASHTENAW COUNTY SURVEYOR APPARENTLY USED CORNER WHILE MEASURING THE NORTH-SOUTH 1/4 LINE OF SECTION 6. THIS INFORMATION IS RECORDED IN HIS PRIVATE RECORDS (NOW IN THE POSSESSION OF WOLVERINE ENGINEERS AND SURVEYORS ). THESE RECORDS ARE IN A BOUND FIELD BOOK DATED 1878.

3. OSCAR BOSS, RLS 13574, USED CORNER IN AN ACT 132 SURVEY RECORDED IN LIBER 2 PAGE 123 AND RECORDED AN ACT 74 CERTIFICATE IN LIBER 3 PAGE 117 IN NOVEMBER 1973 AS A SET 1/2" IRON AT FENCE INTERSECTION: S05°E, 1.67', NAIL W/S 36" OAK; S02°E, 23.78' NAIL W/S 12" OAK; WEST, 15.18', NAIL N/S 6" OAK

4. AUSTIN WILLIAMS, RLS 21275, USED CORNER IN ACT 132 SURVEYS RECORDED IN LIBER 3, PAGE 425 IN MAY 1978 AND LIBER 4 PAGE 646 IN SEPTEMBER 1981 WITH SAME MONUMENT & WITNESSES AS ITEM 3

5. GEORGE YOUNG, RLS #17640, USED CORNER IN AN ACT 132 SURVEY RECORDED IN LIBER 4 PAGE 552 IN JULY, 1982 WITH SAME MONUMENT AND WITNESSES AS ITEM 3.

6. RON HELSEL, RLS 18994 USED CORNER IN AN ACT 132 SURVEY RECORDED IN LIBER 7 PAGE 101 AND RECORDED AN ACT 74 CERTIFICATE IN LIBER 8 PAGE 115 IN MARCH 1994 AS A FOUND 1/2" BAR AT 3 WAY FENCE CORNER

SET NAIL & TAG #18994 NORTH SIDE 44" OAK, EAST, 2.94', SET NAIL & TAG #18994 NORTH SIDE 12" ELM, N83°W, 3.95', SET NAIL & TAG # 18994 WEST SIDE 44" OAK, S05°e, 1.67', SET NAIL & TAG #18994 NORTH SIDE 6" OAK, S85°W, 15.09'.

7. M. MAHIEU USED CORNER IN AN ACT 132 SURVEY RECORDED IN LIBER 7 PAGE 613 IN APRIL 1995 WITH SAME MONUMENT AND WITNESSES AS ITEM 6.

B. Description of corner evidence found and/or method applied in restoring or reestablishing corner:

SEARCHED AT APPARENT LOCATION OF CORNER AND FOUND A 1/2" BAR AND CAP # 18994 AT EAST-WEST-SOUTH FENCE INTERSECTION MATCHING ALL WITNESSES FROM PART A. AFTER TRAVERSING ALL OF SECTION 6 THIS SURVEYOR WAS CONVINCED THAT JOHN YOKUM HAD ATTEMPTED TO SET CORNER 1/2 MILE FROM C-2 AND B-3. ALTHOUGH THIS PLACES CORNER 25' SOUTH AND 9' EAST OF INTERSECTION OF 1/4 LINES ACCEPTED EXISTING MONUMENTATION AS PERPETUATION OF CORNER BECAUSE OF REGULAR USAGE. REPLACED 1/2" BAR & CAP WITH 3/4" BAR & CAP. MEASURED EAST 2641.10' TO C-2. MEASURED WEST 2304.30' TO A-2. MEASURED SOUTH 2644.88 TO B-3. MEASURED NORTH 2691.24 TO B-1.

C. Description of monument for corner and accessories established to perpetuate locating the position of the corner:

B-2 T1N, R2E

3/4" X 24' SMOOTH STEEL BAR & YELLOW PLASTIC CAP IMPRINTED PA 345 PS 25837 AT 3 WAY FENCE CORNER

FOUND NAIL & TAG 18994 WEST SIDE 40" OAK, 120° NAZ, 1.63'

SET NAIL & TAG #25837 NORTH SIDE 17" MAPLE, 90° NAZ, 30.25'

SET NAIL & TAG #25837 SOUTH SIDE 7" CHERRY, 290° NAZ, 16.86'

SET NAIL & TAG #25837 SOUTH SIDE 7" MAPLE, 40° NAZ, 31.20'

FOUND NAIL & TAG #18998, NORTH SIDE 40" OAK, 85° NAZ, 2.90'

Signed by David L. Clifford

Date OCTOBER 29, 1997

Surveyor's Michigan License No. 25837

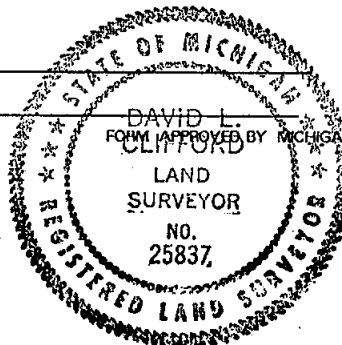

P.A. 345 INGHAM COUNTY  
PEER APPROVED 10/16/97

MICHIGAN STATE BOARD OF PROFESSIONAL SURVEYORS, JAN. 28, 1971  
REVISED MAY 14, 1975  
REVISED JAN., 1983  
REVISED OCT., 1985

LAND CORNER RECORDATION CERTIFICATE  
Filing Requirement of Act 74, Mich. P.A. 1970

Liber 9 Page 268

For corners in

INGHAM COUNTY  
(County)

Located in:

Corner Code #

STOCKBRIDGE TOWNSHIP

1. Public Land Survey

T 1N R 2E

B-3

2. Property Controlling  
in Section

S T R

3. Miscellaneous  
Property in Sec.

S T R

4. Lot No. , Recorded Plat

5. Private Claims

FILED

970044060  
11/05/1997 12:39:56  
REGISTER OF DEEDS  
Paula Johnson  
INGHAM COUNTY, MI

Register of Deeds Stamp & File Number

I, DAVID L. CLIFFORD, in a field survey on SEPTEMBER 2, 1997

do hereby state that under requirements of P.A. 74, Michigan P.A. of 1970, the corner points mentioned in lines 1 and 2 above were in conformance with regulations and rules therefore as required in the current manual of survey instructions of the United States Department of the Interior, Bureau of Land Management or by a decree of a Court of Law and /or that the corner points mentioned in lines 3, 4 and 5 above were in conformance with the rules of the Michigan Board of Land Surveyors or by a Decree of a Court of Law; established, re-established, monumented, recovered, found as expressed below:

NOTE: Not more than 2 corners, all in the same town and range, may be recorded on this certificate.

	A	B	C	D	E	F	G	H	I	J	K	L	M
1													
2		6		5		4		3		2		1	
3													
4		7		8		9		10		11		12	
5													
6		18		17		16		15		14		13	
7													
8		19		20		21		22		23		24	
9													
10		30		29		28		27		26		25	
11													
12		31		32		33		34		35		36	
13													

A. Description of original monument and accessories and/or subsequent restoration:

- JOSEPH WAMPLER D.S. SET POST FOR CORNER IN ORIGINAL GOVERNMENT SURVEY IN NOVEMBER 1825: W.O. 17" S43½W 103LKS; ASPEN 8" N44W, 79½LKS.
- RON HELSEL, RLS 18994 USED CORNER IN AN ACT 132 SURVEY RECORDED IN LIBER 7 PAGE 101 AND RECORDED AN ACT 74 CERTIFICATES IN LIBER 8 PAGE 116 & LIBER 8 PAGE 117 IN MARCH 1994 AS A FOUND 3/4" PIPE, SET BY WOLVERINE ENGINEERS IN A SURVEY DATED JUNE 10, 1992, DESCRIBED AS SET AT N & E-W FENCE LINES: SET GALV. NAIL & TAG #18994 E/SIDE 14" ASH, SOUTH, 72.17'; FOUND NAIL & TAG #28414 E/SIDE 14" ASH, S20°W, 26.70'; SET GALV. NAIL & TAG #18994 E/SIDE 16" ASH, S25°E, 77.86'; SET GALV. NAIL & TAG #18994 S/SIDE 8" ELM, S80°E, 44.20'. R. HELSEL ALSO STATES THAT HE EXCAVATED DOWN TO A PILE OF FIELD STONES IN A LARGE CIRCLE.
- M. MAHIEU LPS #28414 USED CORNER IN AN ACT 132 SURVEY RECORDED IN LIBER 7 PAGE 613 IN APRIL 1995 AS A FOUND 3/4" PIPE WITH SAME MONUMENT & WITNESSES AS ITEM 3

B. Description of corner evidence found and/or method applied in restoring or reestablishing corner:

SEARCHED AT APPARENT LOCATION OF CORNER AND FOUND A 3/4" PIPE AT EAST-WEST-NORTH FENCE INTERSECTION MATCHING ALL WITNESSES FROM PART A. AFTER TRAVERSING ALL OF SECTION 6 ACCEPTED 3/4" PIPE AS PERPETUATION OF ORIGINAL CORNER BECAUSE OF AGREEMENT WITH PRORATIONAL MEASUREMENT TO ORIGINAL GOVERNMENT MEASUREMENT AND OCCUPATION. CAPPED 3/4" PIPE WITH PA 345 CAP. MEASURED EAST 2658.20' TO C-3. MEASURED WEST 2302.98' TO A-3. MEASURED NORTH 2644.88' TO B-2.

C. Description of monument for corner and accessories established to perpetuate locating the position of the corner:

B-3 T1N, R2E  
3/4" STEEL PIPE & YELLOW PLASTIC CAP IMPRINTED PA 345 PS 25837 AT 3 WAY FENCE CORNER  
FOUND NAIL & TAG #18994 EAST SIDE 14" ASH, 185° NAZ, 72.17'  
SET NAIL & TAG #25837 WEST SIDE 28" OAK, 05° NAZ, 104.0'  
FOUND NAIL & TAG #28414 EAST SIDE 14" ASH, 205° NAZ, 26.70'  
FOUND NAIL & TAG #18994 EAST SIDE 16" ASH, 170° NAZ, 77.85'  
FOUND NAIL & TAG #18989, SOUTH SIDE 8" DEAD ASH, 90° NAZ, 36.50'

Signed by David L. Clifford

Date OCTOBER 14, 1997

Surveyor's Michigan License No. 25837

FORM APPROVED BY MICHIGAN STATE BOARD OF PROFESSIONAL SURVEYORS, JAN. 28, 1971

REVISED MAY 14, 1975

REVISED JAN., 1983

REVISED OCT., 1995

P.A. 345 INGHAM COUNTY  
PEER APPROVED 10/16/97 M

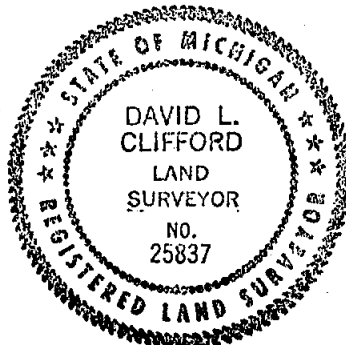

LAND CORNER RECORDATION CERTIFICATE  
Filing Requirement of Act 74, Mich. P.A. 1970

Liber 9 Page 271

For corners in

INGHAM COUNTY  
(County)

Located In:

Corner Code #

BUNKERHILL TOWNSHIP

1. Public Land Survey

T 1 N R 1 E

M-4

2. Property Controlling  
in Section

S T

T R

3. Miscellaneous  
Property in Sec.

S T

T R

FILED

970044063  
11/05/1997 12:40:01  
REGISTER OF DEEDS  
Paula Johnson  
INGHAM COUNTY, MI

Register of Deeds Stamp & File Number

4. Lot No. , Recorded Plat

5. Private Claims

	A	B	C	D	E	F	G	H	I	J	K	L	M
1													
2		6		5		4		3		2		1	
3													
4		7		8		9		10		11		12	
5													
6		18		17		16		15		14		13	
7													
8		19		20		21		22		23		24	
9													
10		30		29		28		27		26		25	
11													
12		31		32		33		34		35		36	
13													

I, DAVID L. CLIFFORD

, in a field survey on OCTOBER 2, 1997

do hereby state that under requirements of P.A. 74, Michigan P.A. of 1970, the corner points mentioned in lines 1 and 2 above were in conformance with regulations and rules therefore as required in the current manual of survey instructions of the United States Department of the Interior, Bureau of Land Management or by a decree of a Court of Law and /or that the corner points mentioned in lines 3, 4 and 5 above were in conformance with the rules of the Michigan Board of Land Surveyors or by a Decree of a Court of Law; established, re-established, monumented, recovered, found as expressed below:

NOTE: Not more than 2 corners, all in the same town and range, may be recorded on this certificate.

A. Description of original monument and accessories and/or subsequent restoration:

- JOSEPH WAMPLER D.S. SET POST FOR CORNER IN ORIGINAL GOVERNMENT SURVEY IN FEBRUARY 1824: W.O. 22" N37½W 64LKS; B.O. 32' S66W 150LKS
- A MARGINAL NOTE IN THE INGHAM COUNTY COPY OF THE GLO NOTES STATES: SET STONE, POTTERY & GLASS; W.O. 12" S31W 63, HICKORY 12" N7W 240; J.H. MULLETT APRIL 20, 1884.
- W.E. ZIMMER OF WOLVERINE ENGINEERS AND SURVEYORS SET A 3/4" BAR IN PARMAN ROAD ON A FENCE LINE TO THE WEST IN A SURVEY IN OCTOBER 1968.
- AN INGHAM COUNTY REMONUMENTATION EXCAVATION CREW FOUND A 3/4"X18" BAR 3' WEST OF CENTERLINE PARMAN ROAD ON A FENCE LINE TO THE WEST IN A 10' X 10' X 4.5' DEEP EXCAVATION ON JULY 16, 1979. THEY REMOVED THE BAR AND WITNESSED IT WITH 3 "PK WITNESSES": SE 7.43', SW 7.22', NE 7.45'
- M. MAHIEU, LPS #28414 RECORDED CORNER IN LIBER 7 PAGE 290 IN SEPTEMBER 1992 AS A FOUND 1/2" BAR: NAIL & TAG # 28414 NORTH SIDE 32" HICKORY, S70°E, 88.65', NAIL & TAG 28414 NORTH SIDE 4" OAK, S85°E, 40.50', WEST EDGE SIGN POST, S30°E, 34.60', EAST EDGE SIGN POST, S20°W, 29.85'.
- THIS SURVEYOR IN AN ACT 132 SURVEY IN MAY 1997 TRAVERSED ALL OF SECTION 12 AND TIED INTO MOST OF THE MONUMENTATION OF ZIMMERS 1968 SURVEY AND UPON FINDING THAT RECORDED CORNER DID NOT MATCH LOCATION ACCORDING TO SURVEY RECOVERED REMONUMENTATION CREWS 3 PK WITNESSES AND REESTABLISHED POSITION OF CORNER AT POINT IRON WAS FOUND IN 1979. AS THIS POINT MATCHES MONUMENTATION OF 1968 SURVEY AND ALL OCCUPATION IN SE CORNER OF SECTION 12 ACCEPTED IT AS PERPETUATION OF CORNER AND SET 3/4" REBAR & CAP "RON ENGER #28409": N&T #28414, N. SIDE 32" HICKORY, 114° NAZ, 89.45'; N&T 28414, N. SIDE 4" OAK, 100° NAZ, 41.00'; N&T 28409, E. SIDE 20" HICK., 354° NAZ, 111.15'; N&T 28409, N. SIDE 24" TWIN HICKORY, 108° NAZ, 122.65'; CENTERLINE 2" HICKORY, 111° NAZ, 49.45'

B. Description of corner evidence found and/or method applied in restoring or reestablishing corner:

SEARCHED AT APPARENT LOCATION OF CORNER AND FOUND A 3/4" BAR & CAP MATCHING WITNESSES OF ITEM 6 PART A. ACCEPTED THIS POSITION AS PERPETUATION OF CORNER BECAUSE OF REASONS LISTED IN ITEM 6 PART A. PLACED PA 345 CAP ON IRON & SET MONUMENT BOX.

C. Description of monument for corner and accessories established to perpetuate locating the position of the corner:

M-4 T1N, R1E  
3/4" X 24" REBAR & YELLOW PLASTIC CAP IMPRINTED PA 345 PS 25837 IN MONUMENT BOX  
FOUND NAIL & TAG #28414 NORTH SIDE 32" HICKORY, 114° NAZ, 89.45'  
FOUND NAIL & TAG #28414 NORTH SIDE 4" OAK, 100° NAZ, 41.00'  
FOUND NAIL & TAG #28409 EAST SIDE 20" HICKORY, 354° NAZ, 111.15'  
FOUND NAIL & TAG #28409 NORTH SIDE 24" TWIN HICKORY, 108° NAZ, 122.65'  
CENTERLINE 2" HICKORY, 111° NAZ, 49.45'  
1/2" STEEL BAR, 180° NAZ, 2.00'

Signed by David L. Clifford  
Surveyor's Michigan License No. 25837

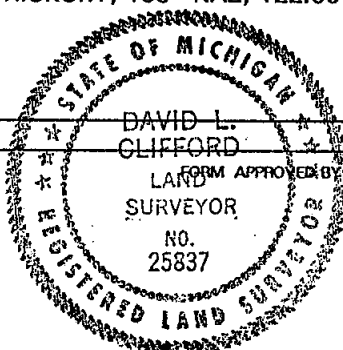

Date OCTOBER 14, 1997

P.A. 345 INGHAM COUNTY  
PEER APPROVED: 10/16/97 m

MICHIGAN STATE BOARD OF PROFESSIONAL SURVEYORS, JAN. 28, 1971  
REVISED MAY 14, 1975  
REVISED JAN., 1983  
REVISED OCT., 1995

LAND CORNER RECORDATION CERTIFICATE  
Filing Requirement of Act 74, Mich. P.A. 1970

Liber

9 Page 272

For corners in

INGHAM COUNTY

(County)

Located In:

Corner #

BUNKERHILL TOWNSHIP

1. Public Land Survey

T 1N R 1E

M-3

2. Property Controlling  
in Section

S T R

3. Miscellaneous  
Property in Sec.

S T R

4. Lot No. , Recorded Plat

5. Private Claims

FILED

970044064  
11/05/1997 12:40:02  
REGISTER OF DEEDS  
Paula Johnson  
INGHAM COUNTY, MI

Register of Deeds Stamp & File Number

I, DAVID L. CLIFFORD, in a field survey on OCTOBER 3, 1997 do hereby state that under requirements of P.A. 74, Michigan P.A. of 1970, the corner points mentioned in lines 1 and 2 above were in conformance with regulations and rules therefore as required in the current manual of survey instructions of the United States Department of the Interior, Bureau of Land Management or by a decree of a Court of Law and /or that the corner points mentioned in lines 3, 4 and 5 above were in conformance with the rules of the Michigan Board of Land Surveyors or by a Decree of a Court of Law; established, re-established, monumented, recovered, found as expressed below:

NOTE: Not more than 2 corners, all in the same town and range, may be recorded on this certificate.

	A	B	C	D	E	F	G	H	I	J	K	L	M
1													
2		6		5		4		3		2		1	
3													
4		7		8		9		10		11		12	
5													
6		18		17		16		15		14		13	
7													
8		19		20		21		22		23		24	
9													
10		30		29		28		27		26		25	
11													
12		31		32		33		34		35		36	
13													

A. Description of original monument and accessories and/or subsequent restoration:

- JOSEPH WAMPLER D.S. SET POST FOR CORNER IN ORIGINAL GOVERNMENT SURVEY IN FEBRUARY 1824: ASPEN 12" N½W 1077LKS; NO OTHER TREE.
- E.A. CALKINS, COUNTY SURVEYOR CALLS FOR CORNER TO FALL IN THE MIDDLE OF THE DOUGLAS DRAIN
- R. STEADMAN, RLS 11370 USED CORNER IN ACT 132 SURVEYS RECORDED IN LIBER 2 PAGE 1034 IN DECEMBER 1976, LIBER 2 PAGE 1037 IN MARCH 1977, LIBER 4 PAGE 799 AND LIBER 6 PAGE 619 IN JANUARY 1986 AND RECORDED AN ACT 74 CERTIFICATE IN LIBER 48 PAGE 14 IN FEBRUARY 1977 AS A SET 1/2" IRON PIPE IN CENTER OF DITCHES RUNNING NORTH & WEST: 6" WILD CHERRY, EAST, 12.6'; 4" POPLAR, N30°E, 17.80'; 6" BOX ELDER, N27°W, 22.00.

CONTINUED ON BACK

B. Description of corner evidence found and/or method applied in restoring or reestablishing corner:

SEARCHED AT APPARENT LOCATION OF CORNER AND FOUND A 1 ¼" PIPE MATCHING WITNESSES OF PART A. AFTER TRAVERSING ALL OF SECTION 6 & 7 T1N, R2E, AND SECTION 12, T1N, R1E, DETERMINED THAT CORNER WAS NOT IN POSITION OF ORIGINAL GOVERNMENT CORNER. MEASUREMENT ALONG THE LAST 3 MILES OF THE TOWNSHIP LINE SHOW THAT THE DISTANCES BETWEEN THE 1/2 MILE CORNERS ARE ABOUT 2673' AND IN PROPORTION TO THE GOVERNMENT DISTANCES THE LAST HALF MILE SHOULD BE ABOUT 2644' WHICH IT IS. THE DISTANCE FROM M-4 TO THE 1 ¼" PIPE IS 2649.79' AND FROM THE 1 ¼" PIPE TO M-2 THE DISTANCE IS 2694.51'. DISCUSSED LOCATION OF DITCH TO WEST WITH JACK GARNER, FARMER WHO OWNS THE FARM TO THE SOUTHWEST OF CORNER AND WAS TOLD THAT HIS FATHER ATTEMPTED TO PUT DITCH ON THE NORTHERLY PORTION OF HIS PROPERTY WHEN HE DUG IT IN THE 1960'S. THIS WOULD PLACE THE CORNER NORTH OF THE DITCH. TIED INTO GARNERS NORTH FENCE WHERE IT CROSSES PARMAN ROAD 1600' WEST OF CORNER AND FOUND THAT IT LIES 12.5' NORTH OF SECTION LINE AS DEFINED BY L-3 AND 1 ¼" PIPE. SET 1 ¼" PIPE & PA 345 CAP HALF WAY BETWEEN M-4 & M-2 USING 1 ¼" PIPE FOR LINE BECAUSE OF CALKINS LOCATION OF CORNER IN THE CENTER OF THE DOUGLAS DRAIN.

C. Description of monument for corner and accessories established to perpetuate locating the position of the corner:

- B-3 T1N, R2E  
1 ¼" GALVANIZED STEEL PIPE & YELLOW PLASTIC CAP IMPRINTED PA 345 PS 25837 IN CENTERLINE DOUGLAS DRAIN  
FOUND NAIL & TAG #28414 SOUTH SIDE 154" MULTIPLE BOX ELDER, 199° NAZ, 71.74'  
SET NAIL & TAG #25837 EAST SIDE 12" ELM, 195° NAZ, 92.12'  
FOUND NAIL & TAG #28414 WEST SIDE 6" POPLAR, 132° NAZ, 9.65'  
SET NAIL & TAG #25837 EAST SIDE 16" POPLAR, 193° NAZ, 35.02'  
SET NAIL & TAG #25837, EAST SIDE 15" WILLOW, 204° NAZ, 30.53'  
1 ¼" GALVANIZED STEEL PIPE & CAP (A-3, T1N, R2E), 180° NAZ, 66.00'  
1 ¼" GALVANIZED STEEL PIPE (PROPERTY CONTROLLING CORNER), 180° NAZ, 22.36'  
1 ¼" GALVANIZED STEEL PIPE (PROPERTY CONTROLLING CORNER), 180° NAZ, 35.56'

Signed by David L. Clifford

Surveyor's Michigan License No. 25837

Date OCTOBER 14, 1997

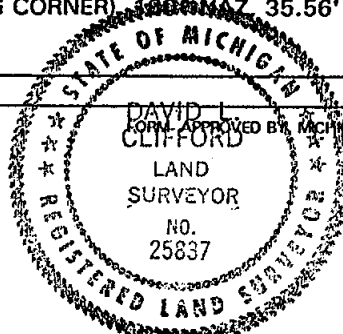

P.A. 345 INGHAM COUNTY  
PEER APPROVED 10/16/97 m

4. G. YOUNG LPS #17640 USED CORNER IN AN ACT 132 SURVEYS RECORDED IN LIBER 4 PAGE 787 IN AUGUST 1981 AND LIBER 4 PAGE 14 IN NOVEMBER 1981 WITH THE SAME MONUMENT & WITNESSES AS ITEM 4.
5. L. BRYAN LPS #25832 USED CORNER IN AN UNRECORDED ACT 132 SURVEY IN AUGUST 1982 AND AN ACT 132 SURVEY RECORDED IN LIBER 6 PAGE 242 IN JANUARY 1988 AS A 3/4" REBAR WITH SAME WITNESSES AS ITEM 4.
6. M. MAHIEU LPS #28414 USED CORNER IN AN ACT 132 SURVEY RECORDED IN LIBER 6 PAGE 1013 IN JUNE 1992 AS A SET 1 1/2" PIPE: N&T 28414 N. SIDE 15" WILLOW, S80W, 14.27; N&T #28414 E. SIDE 8" BOX ELDER, N15W, 21.07'; N&T #28414 W. SIDE 6" POPLAR, N15E, 17.67'; N&T #28414 N. SIDE 18" POPLAR, S45W, 14.18'