

LAND CORNER RECORDATION CERTIFICATE
Filing Requirement of Act 74, Mich. P.A. 1970
VEVAY TOWNSHIP

For corners in

INGHAM Located In: Corner Code #
(County)

1. Public Land Survey T 2N R 1W C-13
T R
T R
T R
2. Property Controlling S T R
in Section S T R
3. Miscellaneous S T R
Property in Sec. S T R

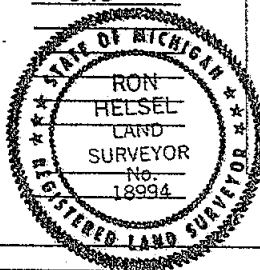

Register of Deeds Stamp & File Number

4. Lot No. , Recorded Plat
5. Private Claims

I, RON HELSEL, in a field survey on MAY 4, 2001 do hereby state that under requirements of P.A. 74, Michigan P.A. of 1970, the corner points mentioned in lines 1 and 2 above were in conformance with regulations and rules therefore as required in the current manual of survey instructions of the United States Department of the Interior, Bureau of Land Management or by a decree of a Court of Law and/or that the corner points mentioned in lines 3, 4 and 5 above were in conformance with the rules of the Michigan Board of Land Surveyors or by a Decree of a Court of Law; established, re-established, monumented, recovered, found as expressed below:

NOTE: Not more than 2 corners, all in the same town and range, may be recorded on this certificate.

A. Description of original monument and accessories and/or subsequent restoration:
ORIGINAL MONUMENT: POST SET BY J. MULLET, U.S. DEPUTY SURVEYOR, MAY, 1825, SET ON STANDARD LINE 40 CHAINS WEST OF D-13. BEECH 15", N51E, 15 LINKS; BEECH 10" (NOTHING GIVEN). MARGIN NOTE: STONE & CROCKERY, 5" WALNUT, S54-1/4W, 100 LINKS.

1) VOL. 2, PAGE 97, CO. SURVEYOR T.J. BROWN CALLED FOR STONE & CROCKERY AND WITNESS OF THE WALNUT FROM ABOVE. RECORDED 40 CHAINS TO B-13 20 CHAINS NORTH TO THE EAST 1/16 CORNER OF SE 1/4.
2) I.C.R.C. GRID MAP CALLED FOR BOAT SPIKE 19" ELM SSW, 42.83 FEET; P.P. NNE, 75.87 FEET (DATE UNKNOWN)
3) P.A. 74 CORNER, LIBER 3, PAGE 185, REC. 7-12-1974 BY G. YOUNG, P.S. NO. 17640. "FOUND MDSH MONUMENT BOX WITH 5/8" IRON." NAIL IN POWER POLE N10E, 66.12'; NAIL AND WASHER IN P. POLE N40W, 95.55'; NAIL AND WASHER IN 24" WALNUT, S35W, 110.80'. SURVEY REC. IN LIBER 1, PAGE 1134 AND RE-RECORDED IN LIBER 2, PAGE 56 BY SAME G. YOUNG, 2-20-74 & 6-30-74, GAVE SAME WITNESSES AS 2-A ABOVE.
4) P.A. 74 CORNER, LIBER 7, PAGE 93, REC. 1-30-89 BY R. ENGER, P.S. NO. 28409. HE FOUND A 1" PIPE & CAP NO. 11370 (R. STEADMAN) & "PROVED IT TO BE AT CORNER POSITION PREVIOUSLY RECORDED BY POWER POLE IN THE NE QUADRANT AND THE POWER POLE IN THE NW QUADRANT." NAIL & CAP IN S/SIDE U. POLE, 314° NAZ., 95.6'; 1" PIPE IN MONUMENT BOX, C-1, T1N, R1W, 276° NAZ., 149.1'; C/L OF WEST END OF CONC. CULVERT, 284° NAZ., 98.9'; WHITE SHINER IN EAST SIDE OF U. POLE, 23° NAZ., 66.0'; NAIL & TAG "SECTION. COR" IN SOUTH SIDE OF 30" CHERRY, 82° NAZ., 149.2'; PIPE & CAP 11370 IS ON C/L OF EXTENDED TUTTLE ROAD TO NORTH.

B. Description of corner evidence found and/or method applied in restoring or reestablishing corner:
FOUND 3/4" PIPE & CAP #11370 AT POSITION DESCRIBED IN 4-A ABOVE. EXCAVATED DOWN & FOUND 5/8" BAR X11" LONG UNDER THE PIPE, IT APPEARS THAT THE BAR IS A BOAT SPIKE WITH THE HEAD BROKEN OFF. EXCAVATED 2.7 FEET FURTHER AND FOUND A BROKEN POINTED STONE LEANING IN A SOUTHERLY DIRECTION SURROUNDED WITH PIECES OF BROKEN CROCKERY. ACCEPTED THE POSITION OF THE 3/4" PIPE AS FAITHFUL PERPETUATION OF THE T.J. BROWN CORNER FROM 1-A ABOVE. MEASURED WEST 149.16 FEET TO C-1 OF LESLIE TOWNSHIP. WHICH MATCHED THE G.L.O. FALLING OF 2.26 CHAINS.

C. Description of monument for corner and accessories established to perpetuate locating the position of the corner:
STANDARD INGHAM CO. DISK STAMPED P.S. 18994 AND 3/4" PIPE IN MONUMENT BOX ON C/L OF PLAINS ROAD & ON C/L OF EXTENDED TUTTLE ROAD TO THE NORTH.
WEST, 149.16 FEET TO C-1, T1N, R1W, STANDARD INGHAM CO. DISK AND 3/4" BY 24" IRON PIN..
FOUND NAIL & WHITE SHINER EAST/SIDE OLD LOPPED OFF POWER POLE, NAZ. 24°, 66.04 FEET
SET NAIL & TAG #18994 EAST/SIDE OF NEWER POWER POLE, NAZ. 28°, 67.35 FEET
SET NAIL & TAG #18994 SOUTH/SIDE OF 30" CHERRY OVER EXISTING LARGE SPIKE, NAZ. 82°, 149.17 FEET
SET NAIL & TAG #18994 ABOVE BENT NAIL & TAG #18998 (R. LESTER), S/SIDE POWER POLE, NAZ. 316°, 95.63 FEET
CENTERLINE OF WEST END CONC. CULVERT, NAZ. 284°, 98.8 FEET

A	B	C	D	E	F	G	H	I	J	K	L	M
1												
2	6	5	4	3	2	1						
3												
4	7	6	5	4	3	2	1					
5												
6	18	17	16	15	14	13						
7												
8	19	18	17	16	15	14	13	12	11	10	9	8
9												
10	30	29	28	27	26	25						
11												
12	31	30	29	28	27	26	25	24	23	22	21	20
13												

Signed by Ron Helsel
Surveyor's Michigan License No. 18994

Date 7-7-2001



2001-043036
Page: 1 of 1
08/20/2001 08:28A

P.A. 345 INGHAM COUNTY
PEER APPROVED 6/19/2001 RL

LAND CORNER RECORDATION CERTIFICATE
Filing Requirement of Act 74, Mich. P.A. 1970
VEVAY TOWNSHIP

For corners in

INGHAM

(County)

Located In:

Corner Code #

1. Public Land Survey

T 2N R 1W

C-11

T R

T R

T R

2. Property Controlling
in Section

S T R

S T R

3. Miscellaneous

S T R

Property in SECTION.

S T R

4. Lot No. , Recorded Plat

5. Private Claims

I, RON HELSEL, in A field survey on JULY 10, 2002 do hereby state that under requirements of P.A. 74, Michigan P.A. of 1970, the corner points mentioned in lines 1 and 2 above were in conformance with regulations and rules therefore as required in the current manual of survey instructions of the United States Department of the Interior, Bureau of Land Management or by A decree of A Court of Law and/or that the corner points mentioned in lines 3, 4 and 5 above were in conformance with the rules of the Michigan Board of Land Surveyors or by A Decree of A Court of Law; established, re-established, monumented, recovered, found as expressed below:

NOTE: Not more than 2 corners, all in the same town and range, may be recorded on this certificate.

A. Description of original monument and accessories and/or subsequent restoration:
ORIGINAL MONUMENT: POST SET BY HERVEY PARKE, U.S. DEPUTY SURVEYOR, MAR. 1826. 80.00 CHAINS FROM C-13. W. OAK 14", S38E, 31-1/2 LINKS; B. ASH 12" N85-1/2W, 5 LINKS.

1) VOL. 1, PAGE 89, A. JACKSON CO. SURVEYOR, SEPT. 13, 1843. ORIGINAL WITNESSES WERE CITED.

2) P.A. 132 SURVEY, LIBER 1, PAGE 167, L. HENDRYX, P.S. 3276, DEC. 16, 1971. CORNER NOT IDENTIFIED OR WITNESSED.

3) P.A. 132 SURVEY, LIBER 2, PAGE 208, L. HENDRYX, NOV. 22, 1974. CORNER NOT IDENTIFIED OR WITNESSED.

4) P.A. 132 SURVEY, LIBER 3, PAGE 100, A. WILLIAMS, P.S. 21275, NOV. 22, 1977. HE CALLED FOR CORNER IN LIBER 3, PAGE 211, WHICH IS RECORDED AS: E-10 AND E-11.

5) P.A. 74 CORNER, LIBER 4, PAGE 191, L. HENDRYX, CORNER FORM DATED NOV. 23, 1971 AND RECORDED ON APRIL 26, 1978. "FOUND IRON IN INT. BARNES AND TUTTLE RD." NAIL 40" OAK, NNW, 91.90; SPK PP NW, 57.30; SPK TEL. POLE, NNE, 76.74.

6) P.A. CORNER, LIBER 6, PAGE 396, R. LESTER, #18998, SEPT. 23, 1988. "NO EVIDENCE OF IRON AS CALLED FOR IN LIBER 4, PAGE 191. SET BAR AT LOCATION OF LIBER 4, PAGE 191, USING TWO EXISTING ACCESSORIES." FOUND NAIL & WHITE SHINER IN NORTHEAST SIDE UTILITY POLE, 328° AZ., 57.3 FT.; FOUND NAIL & WHITE SHINER IN EAST SIDE 48" OAK, 350° AZ., 91.9 FT.; SET NAIL & TAG IN WEST SIDE TRIPLE 8" OAK, 173° AZ., 117.9 FT.; SET NAIL & TAG IN SOUTH SIDE 20" OAK, 82° AZ., 134.0 FT.

7) P.A. 132 SURVEY, LIBER 5, PAGES 896-897, B. ANTCLIFF, P.S. #25826, JAN. 30, 1989. "FOUND 1/2" IRON." SAME WITNESSES AS 6-A, ABOVE.

B. Description of corner evidence found and/or method applied in restoring or reestablishing corner:

FOUND A 1/2" IRON BAR AT THE INTERSECTION OF BARNES AND TUTTLE ROADS. THE UTILITY POLE AND 20" OAK WERE STILL STANDING FROM 6-A, ABOVE. EXCAVATED BELOW 1/2" BAR DOWN THROUGH 12" OF GRAVEL, THEN SAND TO CLAY ROAD BED. FOUND A FEW PIECES OF BRICK NOTHING ELSE. ACCEPTED THE POSITION OF THE 1/2" BAR AS THE BEST AVAILABLE EVIDENCE OF THE CORNER. REPLACED IT WITH A STANDARD INGHAM COUNTY MONUMENT DESCRIBED AS A 3/4" BY 24" STEEL FORM PIN WITH AN ALUMINUM DISK STAMPED P.A. 345, P.S. 18994 IN A MONUMENT BOX. CORNER 1 FOOT SOUTH OF C/L BARNES ROAD AND ON C/L OF TUTTLE. MEASURED WEST, 2649.62 FEET TO B-11. SURVEYOR ANTCLIFF RECORDED 2649.60' IN 7-A, ABOVE. MEASURED SOUTH, 2649.08 FEET TO C-12. MEASURED SOUTH, 5299.41 FEET TO C-13.

C. Description of monument for corner and accessories established to perpetuate locating the position of the corner:

STANDARD INGHAM COUNTY MONUMENT AS DESCRIBED ABOVE, IN MONUMENT BOX.
FOUND NAIL & TAG #25832, L. BRYAN, P.S., SOUTH/SIDE 22" OAK, NAZ. 85°, 133.91 FEET
SET 1/2" BAR AND CAP #18994 BETWEEN LEGS OF STOP SIGN, NAZ. 168°, 57.72 FEET
SET NAIL & TAG #18994 NORTH/SIDE 30" OAK, NAZ. 267°, 269.70 FEET
SET NAIL & TAG #18994 EAST/SIDE UTILITY POLE BELOW NAIL & SHINER, NAZ. 330°, 57.38 FEET

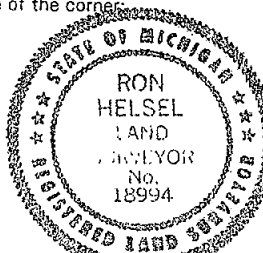

Signed by

Ron Helsel

Date

Aug. 10, 2002

Surveyor's Michigan License No.

18994

FORM APPROVED BY MICHIGAN STATE BOARD OF PROFESSIONAL SURVEYORS, JAN. 28, 1971

REVISED MAY 14, 1976

REVISED JAN., 1983

REVISED OCT., 1986

P.A. 345 INGHAM COUNTY

PEER APPROVED *8/6/2002* *ML*



LAND CORNER RECORDATION CERTIFICATE

Filing Requirement of Act 74, Mich. P.A. 1970

VEVAY TOWNSHIP

For corners in

INGHAM

(County)

Located In:

Corner Code #

1. Public Land Survey T 2N R 1W D-12
T R
T R
T R
2. Property Controlling S T R
in Section S T R
3. Miscellaneous S T R
Property in Section S T R

4. Lot No. , Recorded Plat 5. Private Claims

I, RON HELSEL, in A field survey on FEB. 26, 2005 do hereby state that under requirements of P.A. 74, Michigan P.A. of 1970, the corner points mentioned in lines 1 and 2 above were in conformance with regulations and rules therefore as required in the current manual of survey instructions of the United States Department of the Interior, Bureau of Land Management or by A decree of A Court of Law and /or that the corner points mentioned in lines 3, 4 and 5 above were in conformance with the rules of the Michigan Board of Land Surveyors or by A Decree of A Court of Law; established, re-established, monumented, recovered, found as expressed below:

NOTE: Not more than 2 corners, all in the same town and range, may be recorded on this certificate.

A. Description of original monument and accessories and/or subsequent restoration:
CORNER NOT SET IN ORIGINAL GOVERNMENT SURVEY.

1) VOL1, PAGE 37, DEC. 17, 1841, C.S. A. JACKSON CALLED FOR A CORNER, WHICH HE DID NOT DESCRIBE. BEECH 13", N84-1/2 W, 18-1/2 LINKS; SUGAR 24", N11W, 51 LINKS. RECORDED MEASUREMENTS OF 160 RODS 15 LINKS TO D-13; 79 RODS 18 LINKS TO WEST 1/16 CORNER; 80 RODS 9-1/2 LINS TO NORTH 1/16 CORNER; AND 159 RODS 17 LINKS TO E-12.

2) FROM THE INGHAM COUNTY CETA FILE, FOUND COPIES LABELED MISC. FIELD NOTES, COLLECTION 10 AND FOLDER 2, PAGE 68A AND 68B, DATED AS: "PROBABLY IN 1854", A. JACKSON C.S. THIS SURVEY IS A SPLIT OF THE SURVEY IN ITEM 2 ABOVE, AND GIVES THE SAME WITNESSES TO D-12 AND IDENTICAL MEASUREMENTS TO D-13, E-12, AND 1/16 CORNERS TO NORTH AND WEST.

(CONTINUED ON BACK SIDE)

B. Description of corner evidence found and/or method applied in restoring or reestablishing corner:

FOUND AN 1/2" RE-ROD INCASED IN A 4" DIAMETER CONCRETE MONUMENT 1.5 FEET EAST OF CENTERLINE LAXTON ROAD. AREA IS IN A 6 TO 7 FOOT ROAD FILL. FOUND THE TELEPHONE POLE AND A SNAG OF THE ELM AS REMAINING WITNESSES. FOUND THE INGHAM COUNTY TRAVERSE POINT 3.25 FEET SOUTH. SINCE THIS CORNER WAS DEEMED LOST BY SURVEYOR LESTER AND WAS SET AT THE INTERSECTION OF THE 1/4 LINES, I ACCEPTED THIS POSITION. SET AN INGHAM COUNTY DISK STAMPED P.A. 345, P.S. 18994 ON TOP OF THE CONCRETE MONUMENT. CORNER 0.5 FEET EAST OF CENTERLINE OF LAXTON ROAD AND 47 FEET ± NORTH OF AN EAST-WEST COUNTY DRAIN. SET AN IRON MONUMENT BOX.

C. Description of monument for corner and accessories established to perpetuate locating the position of the corner:

AN ALUMINUM DISK STAMPED P.A. 345, P.S. NO. 18994 ON TOP OF A 4" DIAMETER CONCRETE MONUMENT 0.5 FEET EAST OF CENTERLINE OF LAXTON ROAD.

FOUND NAIL & TAG 18998 SOUTH/SIDE TELEPHONE POLE, AZ. 252°, 31.20 FEET

FOUND KEBS NAIL & TAG WEST/SIDE A QUAD-ELM, AZ. 175°, 114.24 FEET

FOUND KEBS NAIL & TAG WEST/SIDE 12" OAK, AZ. 17°, 115.79 FEET

INGHAM COUNTY TRAVERSE IRON 10" DEEP, AZ. 200°, 3.25 FEET

LARGE C.M.P. UNDER LAXTON ROAD, SOUTH, 47 FEET ±

	A	B	C	D	E	F	G	H	I	J	K	L	M
1													
2		6		5		4		3		2		1	
3													
4		7		8		9		10		11		12	
5													
6		18		17		16		15		14		13	
7													
8		19		20		21		22		23		24	
9													
10		30		29		28		27		26		25	
11													
12		31		32		33		34		35		36	
13													

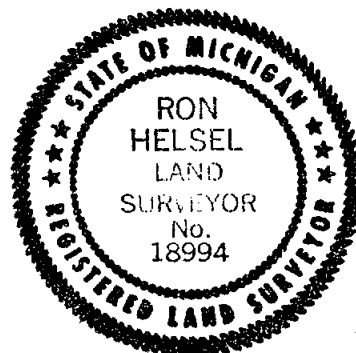

Signed by

Date

3-23-2005

Surveyor's Michigan License No.

18994

D-12, T2N, R1W, VEVAY TOWNSHIP CONTINUED

3) P.A. 74 CORNER, LIBER 6, PAGE 187, JUNE 4, 1981, R. LESTER P.S. 18998. "EXCAVATED A (HOLE) 6' X 6' TO A DEPTH OF 6.2 FEET. EXCAVATION ABANDONED AS NATURAL GROUND HAD NOT BEEN REACHED. SET CORNER AT INTERSECTION OF NORTH-SOUTH AND EAST-WEST 1/4 LINES. CORNER FALLS 1.6' EAST OF CENTERLINE OF NORTH-SOUTH ROAD AND 1.6' NORTH OF EAST-WEST FENCE. MEASURED EAST, 2638.02', WEST, 2644.45', NORTH, 2655.48', SOUTH, 2650.40'. EXCAVATION CONDUCTED BY INGHAM COUNTY SURVEY AND REMONUMENTATION PROJECT CREW. SET 4" X 36" CONCRETE MONUMENT, COLLAR AND #18998 CAP AT LOCATION DESCRIBED ABOVE."

NAIL & TAG #18998, SOUTH SIDE 30" ASH, N40°W, 30.73'

NAIL & TAG #18998 SOUTH SIDE TELEPHONE POLE, S80°W, 31.20'

NAIL & TAG #18998 SOUTHWEST SIDE 8" ELM, N30°E, 28.50'

NAIL & TAG #18998 NORTH SIDE 8" ELM, EAST, 24.60'

4) P.A. 132 SURVEY, LIBER 8, PAGE 1171, AUG. 29, 2003, R. LESTER P.S. 18998. "MONUMENT AND CAP #18998, LIBER 6, PAGE 187." RECORDED 2655.80 FEET TO D-11.

INGHAM COUNTY TEMP. POINT MAG. AZ. 200°, 3.25'

FOUND NAIL & TAG #18998 SOUTH SIDE U. POLE MAG. AZ. 252°, 31.20'

FOUND KEBS NAIL & TAG WEST SIDE MULTI-ELM MAG. AZ. 175°, 114.25'

FOUND KEBS NAIL & TAG WEST SIDE 12" OAK MAG. AZ. 17°, 115.80'

5) P.A. 132 SURVEY, LIBER 8, PAGE 1202, SEPT. 8, 2003, M. MAHIEU P.S. 28414. CORNER DESCRIPTION AND WITNESSES WERE NOT GIVEN. RECORDED 2655.82 FEET TO D-11.

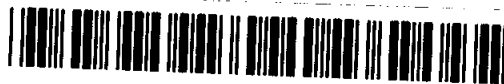

2005-016718

Page: 2 of 2

04/01/2005 08:31A



LAND CORNER RECORDATION CERTIFICATE

Filing Requirement of Act 74, Mich. P.A. 1970

VEVAY TOWNSHIP

For corners in

INGHAM

(County)

Located In:

Corner Code #

1. Public Land Survey T 2N R 1W D-11
T R
T R
T R
2. Property Controlling S T R
in Section S T R
3. Miscellaneous S T R
Property in Section S T R

P.A. 345 INGHAM COUNTY
PEER APPROVED 3/22/2005 *rm*
Register of Deeds Stamp & File Number

4. Lot No. , Recorded Plat

5. Private Claims

I, RON HELSEL, in A field survey on FEB. 26, 2005 do hereby state that under requirements of P.A. 74, Michigan P.A. of 1970, the corner points mentioned in lines 1 and 2 above were in conformance with regulations and rules therefore as required in the current manual of survey instructions of the United States Department of the Interior, Bureau of Land Management or by A decree of A Court of Law and /or that the corner points mentioned in lines 3, 4 and 5 above were in conformance with the rules of the Michigan Board of Land Surveyors or by A Decree of A Court of Law; established, re-established, monumented, recovered, found as expressed below:

NOTE: Not more than 2 comers, all in the same town and range, may be recorded on this certificate.

A. Description of original monument and accessories and/or subsequent restoration:
ORIGINAL MONUMENT: POST SET BY H. PARKE, DEPUTY SURVEYOR, MAR. 1826.
SET AT 39.85 CHAINS ON TRUE LINE. SUGAR 20", N26W; ELM 18", S48E, 18-1/2 LINKS.

- 1) VOL. 1, PAGE 89, SEPT. 3, 1843, A. JACKSON C. S. CITES WITNESSES FROM GLO. RECORDED 160 RODS TO D-10 AND 157 RODS 47 LINKS (2637.69') TO C-11.
- 2) VOL. 1, PAGE 90, SEPT. 15, 1843, A. JACKSON, C.S. REFERS TO CORNER ONLY, NO DESCRIPTION OF MONUMENT OR WITNESSES.
- 3) FROM INGHAM COUNTY CETA FILE : NOTHSTINE NOTES: DATE UNKNOWN, MSHD TAG 38" MAPLE, N46°W, 45.45'; MSHD TAG 20" ELM, N19°E, 52.06'; MSHD NAIL & TAG 9" WALNUT, S17°E, 48.25'. MONUMENT NOT DESCRIBED.
- 4) I.C.R.C. GRID MAP (1969) CALLS FOR 3/4" PIPE TO WIT: GUY POLE, E.S.E. 37.43'; 22" WALNUT, S.S.W. 81.00'; P.P., W.N.W. 75.50'.

(CONTINUED ON BACK SIDE)

B. Description of corner evidence found and/or method applied in restoring or reestablishing corner:
FOUND A MUSHROOMED 5/8" IRON BAR DRIVEN INTO A 3/4" PIPE IN A MONUMENT BOX IN THE INTERSECTION OF C/L'S OF BARNES AND LAXTON ROADS. THERE HAS BEEN MAJOR CLEARING OF THE INTERSECTION BY THE COUNTY ROAD COMMISSION. THE ONLY WITNESS FROM THE ICRC GRID MAP, IS A STUMP FOR THE MAPLE NW. DISTANCE TIES TO E-11BY SURVEYORS LOHR, BRYAN, MAHIEU AND LESTER ARE IN VERY CLOSE ACCORD AND MATCH THE POLARIS SECTION BREAKDOWN FOR SETTING THE CENTER OF SECTION 32. EXCAVATION THRU THE MONUMENT BOX FOUND ANOTHER PIECE OF METAL ABOUT 3 FEET DEEP. ACCEPTED THE PIPE AS THE CORNER CALLED FOR IN NOTHSTINE'S NOTES AND SET A STANDARD INGHAM COUNTY DISK STAMPED P.A. 345, P.S. 18994 ON TOP OF THE MUSHROOMED 5/8" IRON BAR THAT IS WEDGED INTO THE 3/4" PIPE.

C. Description of monument for corner and accessories established to perpetuate locating the position of the corner:
ALUMINUM DISK STAMPED P.A. 345, P.S. NO. 18994 OVER A 5/8" IRON ROD & 3/4" PIPE @ INTERSECTION OF ROADS.
SET NAIL & TAG 18994 IN PLACE OF P.K. NAIL SOUTH/SIDE POWER POLE, AZ. 315°, 75.30 FEET
FOUND NAIL & TAG 28409 NORTH/SIDE 26" WALNUT, AZ. 260°, 175.46 FEET
FOUND KEBS NAIL & TAG SOUTH/SIDE 18" APPLE, AZ. 195°, 79.86 FEET
FOUND NAIL & TAG 28409 EAST/SIDE 18" WALNUT, AZ. 358°, 157.08 FEET
FOUND NAIL & TAG 28414 SOUTH/SIDE POWER POLE, AZ. 72.60 FEET

Signed by Ron Helsel

Date 3-23-2005

Surveyor'S Michigan License No. 18994

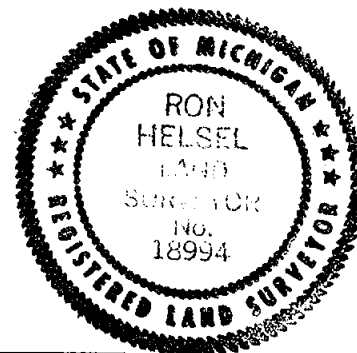

D-11 T2N, R1W, VEVAY TOWNSHIP CONTINUED

- 5) P.A. 132 SURVEY, LIBER 3, PAGE 100, NOV. 22, 1977, A. WILLIAMS P.S. 21275. HE REFERS TO LIBER 1, PAGE 631 AS THE CORNER ONLY. NO MONUMENT OR WITNESSES WERE GIVEN. NOTE: (LIBER 1, PAGE 631 IS A P.A. 74 CORNER FOR F-11 & G-11 OF VEVAY TOWNSHIP, RECORDED JULY 3, 1972 BY JOHN BUDZIK P.S. 18982.)
- 6) P.A. 74 CORNER, LIBER 4, PAGE 283, AUG. 16, 1978, A. WILLIAMS. "FOUND 3/4" PIPE IRON BAR IN MONUMENT BOX IN INTERSECTION OF LAXTON & BARNES ROADS."
NAIL & TAG IN 30" MAPLE, N45°W, 45.79'
NAIL & TAG (#11370) IN FENCE POST, N50°E, 45.25'
CENTERLINE OF 2" STEEL SIGN POST, S47°W, 36.83'
- 7) P.A. 132 SURVEY, LIBER 5, PAGES 1017-1019, MAR. 10, 1989, D. LOHR P.S. 30090. CITED SAME MONUMENT & WITNESSES AS ITEM 6 ABOVE. RECORDED 2639.98 FEET TO D-10 & 2635.93 FEET TO E-11.
- 8) P.A. 74 CORNER, LIBER 7, PAGE 98, JAN. 30, 1989, R. ENGER P.S. 28409. "FOUND 3/4" PIPE IN MONUMENT BOX AND PROVED IT TO BE AT CORNER POSITION PREVIOUSLY RECORDED BY 30" MAPLE (NOW STUMP) IN THE NORTHWEST QUADRANT AND BY THE FENCE POST IN THE NORTHEAST QUADRANT."
STUMP OF 30" MAPLE, N45°W, 45.79'
NAIL & TAG #11370 IN FENCE POST, N50°E, 45.25'
P-K NAIL IN POWER POLE (SOUTH SIDE), NORTHWEST, 75.43'
#50 NAIL AND TAG IN 24" WALNUT, SSW, 175.47'
- 9) P.A. 132 SURVEY, LIBER 6, PAGES 120-121, APRIL 20, 1990, L. BRYAN P.S. 25832. "FOUND 3/4" PIPE IN MONUMENT BOX IN THE CENTER LINES OF LAXTON & BARNES RD." RECORDED 2635.87' TO E-11 & 2640.14' TO D-10.
FOUND NAIL & TAG NORTH SIDE CRABAPPLE, N75°W, 79.35'
FOUND P.K. NAIL NORTH SIDE POWER POLE, N45°W, 75.45'
SET NAIL & TAG NORTHEAST SIDE FENCE POST, N50°E, 45.79'
- 10) P.A. 74 CORNER LIBER 9, PAGE 326, SEPT. 01, 1998, G. BONNO P.S. 32332. "FOUND 5/8" ROD IN MONUMENT BOX."
N40E, 46.03' FOUND NAIL & TAG #25832 IN E FACE OF A CORNER FENCE POST
S20W, 159.00', FOUND NAIL & TAG #11370 IN E FACE POWER POLE
N70W, 97.52', FOUND NAIL & FLAGGING IN N FACE 10" APPLE TREE
N65W, 79.28', FOUND NAIL & FLAGGING IN N FACE 13" APPLE TREE
N50W, 75.42', FOUND PK IN SOUTHWEST FACE POWER POLE
EAST, 2635.80' E-11
- 11) P.A. 132 SURVEY, LIBER 8, PAGE 1147, JUNE 19, 2003, M. MAHIEU P.S. 28414. " FOUND 5/8" ROD IN MON. BOX."
RECORDED 2635.82 FEET TO E-11.
SET NAIL & TAG #28414 S. SIDE UTILITY POLE, N34°E, 72.60'
FND. P.K. NAIL SOUTHWEST SIDE UTILITY POLE, N50°W, 75.42'
FND. NAIL NORTH SIDE 10" APPLE, N70°W, 97.52'
FND. NAIL N. SIDE 15" APPLE, N65°W, 79.28'
- 12) P.A. 132 SURVEY, LIBER 8, PAGE 1171, JULY 29, 2003, R. LESTER P.S. 18998. "3/4" BAR IN MONUMENT BOX. LIBER 7, PAGE 98."
RECORDED 2635.82 FEET TO E-11 AND 2655.80 FEET TO D-12.
FOUND P.K. NAIL IN SOUTH SIDE U. POLE, MAG. AZ. 315°, 75.30'
FOUND NAIL & TAG #28414 SOUTH SIDE U. POLE MAG. AZ. 62°, 72.60'
FOUND KEBS NAIL & TAG SOUTHWEST SIDE 18" APPLE MAG. AZ. 295°, 79.86'
FOUND NAIL & TAG #28409 EAST SIDE 18" WALNUT MAG. AZ. 358°, 157.09'
- 13) P.A. 132 SURVEY, LIBER 8, PAGE 1202, SEPT. 8, 2003, M. MAHIEU. CORNER MONUMENT AND WITNESS WERE NOT GIVEN.
RECORDED 2655.82 FEET TO D-12.



LAND CORNER RECORDATION CERTIFICATE

Filing Requirement of Act 74, Mich. P.A. 1970

VEVAY TOWNSHIP

For corners in

INGHAM

(County)

Located In:

Corner Code #

1. Public Land Survey T 2N R 1W D-13
T R
T R
T R
2. Property Controlling S T R
in Section S T R
3. Miscellaneous S T R
Property in Section S T R

P.A. 345 INGHAM COUNTY
PEER APPROVED 3/22/2005 RL

Register of Deeds Stamp & File Number

4. Lot No. , Recorded Plat
5. Private Claims

I, RON HELSEL, in A field survey on JAN. 12, 2005 do hereby state that under requirements of P.A. 74, Michigan P.A. of 1970, the corner points mentioned in lines 1 and 2 above were in conformance with regulations and rules therefore as required in the current manual of survey instructions of the United States Department of the Interior, Bureau of Land Management or by A decree of A Court of Law and /or that the corner points mentioned in lines 3, 4 and 5 above were in conformance with the rules of the Michigan Board of Land Surveyors or by A Decree of A Court of Law; established, re-established, monumented, recovered, found as expressed below:

NOTE: Not more than 2 comers, all in the same town and range, may be recorded on this certificate.

A. Description of original monument and accessories and/or subsequent restoration:
ORIGINAL MONUMENT: POST SET BY J. MULLET, DEPUTY SURVEYOR, MAY 6, 1825. 40.00 SET 40 CHAINS, LYNN 8", N65E, 12 LINKS; BEECH 9" N76W, 35 LINKS. MARGIN NOTE CALLS FOR STONE & CROCKERY.

1) VOL. 1, PAGE 37, DEC. 17, 1841, C.S.. A. JACKSON, CORNER NOT IDENTIFIED.
CALLED FOR A BEECH 18", N79E, 60 LINKS & BEECH 7", N79W, 26 LINKS.

RECORDED A DISTANCE OF 79 RODS 20 LINKS TO THE WEST 1/16 CORNER AND 2649.9 FEET TO D-12

2) MARGIN NOTE IN I.C.R.C. GRID MAP CALLS FOR A 2" IRON, 42" MAPLE, S.W. 35.59'; 44"; MAPLE, S.E. 41.4'; P.P. N.W. 46.92'; N.W. COR. HOUSE FOND. S.W. 76.7'

3) P.A. 74 CORNER, LIBER 1, PAGE 347, FEB. 16, 1972, R. LESTER P.S. 18998. HE CALLED FOR THE ROAD COMM. WITNESSES FROM ITEM 2 ABOVE. "FOUND BOAT SPIKE CENTERLINE PLAINS ROAD AND 2' WEST OF CENTERLINE LAXTON ROAD TO NORTH." NAIL & TAG N.W. SIDE 48" MAPLE, S.W., 35.53'; NAIL & TAG N.E. SIDE 48" MAPLE, S.E., 41.41' CENTERLINE OF USGS CONCRETE MARKER N.E., 41.40'

(CONTINUED ON BACK SIDE)

B. Description of corner evidence found and/or method applied in restoring or reestablishing corner:

FROM ITEMS 2 & 3 ABOVE, FOUND NORTHWEST CORNER OF HOUSE FND. & THE MAPLE TREE, SE. THE USGS MONUMENT WAS FOUND IN A HORIZONTAL POSITION AND THE POWER POLE NORTHWEST HAS BEEN REPLACED. FOUND A 1" PIPE IN A MONUMENT BOX IN CENTERLINE PLAINS ROAD AT POSITION OF ITEM 3 ABOVE. EXCAVATED & FOUND PIPE INSIDE A 2" PIPE OVER A LARGE FIELD STONE. ACCEPTED THE POSITION OF THE 2" PIPE AS A MARKER FOR THE CORNER. PLACED A STANDARD INGHAM COUNTY MONUMENT INSIDE THE 2" PIPE WHICH WAS 10" BELOW THE ROAD SURFACE. MEASURED EAST, 2640.55 FEET TO E-13

C. Description of monument for corner and accessories established to perpetuate locating the position of the corner:

3/4" X 24" FORM PIN AND ALUMINUM DISK STAMPED P.A. 345, P.S. NO. 18994 IN MONUMENT BOX 2.5 FEET ± WEST OF CENTERLINE OF LAXTON ROAD TO THE NORTH AND ON CENTERLINE PLAINS ROAD.

MEASURED WEST, 136.35 FEET TO A CONCRETE MONUMENT AT D-1, T1N, R1W, LESLIE TOWNSHIP. (LIBER 6, PAGE 84)

FOUND TAG #17624, (REPLACED NAIL) IN NORTHEAST/SIDE 48" MAPLE, S44°E, 41.35 FEET

FOUND KEBS NAIL & TAG NORTH/SIDE 46" MAPLE, S70°W, 58.15 FEET.

FOUND NAIL & TAG #28414 (M. MAHIEU) SOUTHWEST/SIDE POWER POLE, N33°W, 44.82 FEET

FOUND KEBS NAIL & TAG EAST/SIDE TELE POLE, N15°W, 63.35 FEET

NORTHWEST CORNER HOUSE FOUNDATION, S22°W, 76.70 FEET

	A	B	C	D	E	F	G	H	I	J	K	L	M
1													
2		6		5		4		3		2		1	
3													
4		7		8		9		10		11		12	
5													
6		18		17		16		15		14		13	
7													
8		19		20		21		22		23		24	
9													
10		30		29		28		27		26		25	
11													
12		31		32		33		34		35		36	
13													

Signed by Ron Helsel

Date 3-23-2005

Surveyor's Michigan License No. 18994

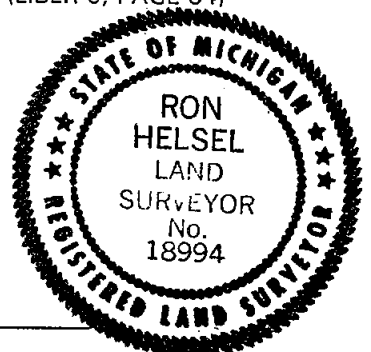

D-13 T2N, R1W, VEVAY TOWNSHIP, CONTINUED

4) P.A. 132 SURVEY, LIBER 1, PAGES 193-196, FEB. 16, 1972, R. M. FOUTY P.S. 18989. CORNER MONUMENT NOT IDENTIFIED, WITNESSES SAME AS ITEM 3 ABOVE. RECORDED 2517.49 FEET TO E-1, T1N, R1W LESLIE TOWNSHIP.

5) P.A. 132 SURVEY, LIBER 1, PAGES 674-676, APRIL 11, 1973, R. LESTER. CORNER MONUMENT NOT IDENTIFIED, WITNESSES SAME AS ITEM 3 ABOVE. RECORDED 2517.49 FEET TO E-1, T1N, R1W, LESLIE TOWNSHIP.

6) P.A. 74 CORNER FOR D-1 LESLIE TOWNSHIP, T1N, R1W, LIBER 6, PAGE 84, AUG. 27, 1980, R. LESTER. AFTER A 10' X 16' HOLE WAS EXCAVATED, A CONCRETE MONUMENT WAS SET MIDWAY BETWEEN C-1 AND E-1. CORNER WITNESS OF ± 136.38 FEET, EAST TO D-13.

7) P.A. 132 SURVEY, LIBER 9, PAGE 2, JAN. 13, 2004, P. NORDER P.S. 44288. "FOUND NAIL IN 1' PIPE IN MONUMENT BOX IN CENTERLINE PLAINS ROAD." RECORDED 2640.52' TO E-13.

NAIL & TAG "POLARIS SURVEYS INC. RLS NO. 17624" (G. LESTER) NORTH SIDE 48" MAPLE NAZ. $130^{\circ} 41.36'$

NAIL & TAG "POLARIS SURVEYS INC. RLS NO. 17624" NORTH SIDE 36" MAPLE NAZ. $245^{\circ} 58.13'$

1/2" PIPE IN SQUARE CONCRETE BASE (USGS MON?) NAZ $50^{\circ} 41.41'$

NORTHWEST CORNER FOUNDATION, HOUSE #2751 NAZ. $200^{\circ} 76.67'$



2005-016721

Page: 2 of 2

04/01/2005 08:31A



LAND CORNER RECORDATION CERTIFICATE

Filing Requirement of Act 74, Mich. P.A. 1970

For corners in

VEVAY TOWNSHIP

INGHAM

(County)

Located In:

Corner Code #

1. Public Land Survey

T 2N R 1W

E-11

T R

T R

T R

2. Property Controlling
in Section

S T R

S T R

3. Miscellaneous

S T R

Property in Section

S T R

4. Lot No. , Recorded Plat

5. Private Claims

I, RON HELSEL, in A field survey on MARCH 16, 2005 do hereby state that under requirements of P.A. 74, Michigan P.A. of 1970, the corner points mentioned in lines 1 and 2 above were in conformance with regulations and rules therefore as required in the current manual of survey instructions of the United States Department of the Interior, Bureau of Land Management or by A decree of A Court of Law and /or that the corner points mentioned in lines 3, 4 and 5 above were in conformance with the rules of the Michigan Board of Land Surveyors or by A Decree of A Court of Law; established, re-established, monumented, recovered, found as expressed below:

NOTE: Not more than 2 comers, all in the same town and range, may be recorded on this certificate.

A. Description of original monument and accessories and/or subsequent restoration:

ORIGINAL MONUMENT: POST SET BY H. PARKE, US DEPUTY SURVEYOR, MAR., 1826. SET 40 CHAINS. BEECH 12", N44W, 2 LINKS; IRONWOOD 10", N78E, 22-1/2 LINKS. MARGIN NOTE, DATE & SOURCE UNKNOWN, APPLE DOUBLE, S.E. PART 8", N37E, 147-1/2 LINKS.

1) VOL. 1, PAGE 32, DEC. 4, 1840, A. JACKSON C.S.. CITED ORIGINAL BEARING TREES. RECORDED 160 RODS 4 LINKS TO F-11.

2) VOL. 1, PAGE 33, DEC. 5, 1840, A. JACKSON C.S.. CITED ORIGINAL BEARING TREES. RECORDED 80 RODS 2 LINKS TO 1/16 CORNER TO EAST & 79 RODS 24 LINKS TO 1/16 CORNER TO NORTH.

3) VOL. 3, PAGE 70, APRIL 17, 1873, T. J. BROWN C.S.. " A POST, NO BEARINGS TAKEN"

4) NOTHSTINE'S NOTES, DATE UNKNOWN. 3/4" X 1/4" X 10" IRON PIN: 6" BOX ELDER, S66E, 53.27'; 5" BOX ELDER, N62E, 79.14'; 18" LOCUST, S28E, 52.60' (I BELIEVE THESE WITNESSES WERE PRIOR TO THE CONSTRUCTION OF THE BARNES ROAD BRIDGE.)

(CONTINUED ON BACK SIDE)

B. Description of corner evidence found and/or method applied in restoring or reestablishing corner:

FOUND A 5/8" X 24" COPPER WELD ROD IN A MONUMENT BOX 39.2 FEET EAST OF THE EAST EDGE OF THE BRIDGE DECK OVER US 127. FOUND SEVERAL WITNESSES FROM THE P.A. 132 SURVEYS AND ALL THE WITNESSES FROM PA. 74 CORNER IN ITEM 13 ABOVE. AREA IN A \pm 25 FOOT FILL FOR THE BRIDGE APPROACH RAMP. ACCEPTED THIS POSITION AS THE BEST AVAILABLE FOR THE PERPETUATION OF THE CORNER.

C. Description of monument for corner and accessories established to perpetuate locating the position of the corner:

3/4" X 24" FORM PIN AND ALUMINUM DISK STAMPED P.A. 345, P.S. NO. 18994 IN A MONUMENT BOX, IN THE CENTERLINE OF BARNES ROAD 39. 2 FEET EAST OF THE EAST EDGE OF BRIDGE DECK OVER US 127.

FOUND NORTHERLY BOLT OF STEEL GUARD RAIL AT EAST CONCRETE RAIL POST OF BRIDGE, N63°W, 42.68 FEET

FOUND SOUTHERLY BOLT OF STEEL GUARD RAIL AT EAST CONCRETE RAIL POST OF BRIDGE, S70°W, 42.66 FEET

FOUND NAIL & TAG #30090, EAST/SIDE 6" X 10" WOOD RAIL POST, N35°W, 24.65 FEET

FOUND NAIL & TAG #30090, WEST/SIDE 6" X 10" WOOD RAIL POST, S03°E, 21.16 FEET

FOUND NAIL & TAG #39096 (J. RAUSER), ON TOP OF 6" X 10" WOOD RAIL POST, N36°E, 26.97 FEET

FOUND NAIL & TAG #25832 (L. BRYAN), ON TOP OF 6" X 10" WOOD RAIL POST, S18°E, 23.38 FEET

Signed by

Ron Helsel

Date 3-23-2005

Surveyor's Michigan License No. 18994

P.A. 345 INGHAM COUNTY
PEER APPROVED 3/23/2005 RL

Register of Deeds Stamp & File Number

	A	B	C	D	E	F	G	H	I	J	K	L	M
1													
2	6		5		4		3		2		1		
3													
4	7		8		9		10		11		12		
5													
6	18		17		16		15		14		13		
7													
8	19		20		21		22		23		24		
9													
10	30		29		28		27		26		25		
11													
12	31		32		33		34		35		36		
13													

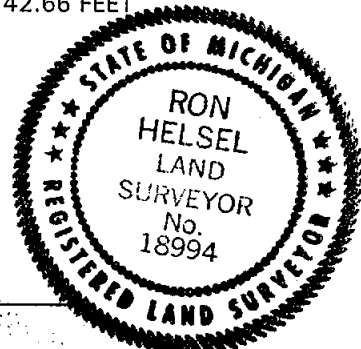

E-11 VEVAY TOWNSHIP, T2N, R1W CONTINUED

5) M-DOT HIGHWAY PLANS OF US 127 CALLS FOR THE CORNER TO BE 67.16' EAST OF THE SURVEY CENTERLINE OF US 127 & 92.17' EAST OF THE CENTERLINE OF THE NORTH BOUND LANE.

6) INGHAM CO. ROAD COMM. GRID MAP (1969), CALLS FOR A MONUMENT BOX
S.W. BRIDGE COR. WSW, 41.18'
END BRIDGE WEST, 38.80'
N.W. BRIDGE CORNER, WNW, 41.19' (SHOULD OF BEEN NORTHEAST BRIDGE CORNER)

7) P.A. 74 CORNER LIBER 3, PAGE 211, AUG. 26, 1974, R. LESTER P.S. 18998. "FOUND 1/2" BAR IN MONUMENT BOX AS CALLED FOR IN MDSH RECORDS."

"I" BEAM GUARD POST, NORTH, 18.24' (I BEAM REPLACED, RAIL POSTS NOW WOOD)
P.K. NAIL IN ASPHALT, WNW, 40.09'
P.K. NAIL IN ASPHALT, WSW, 39.44'

8) P.A. 132 SURVEY, LIBER 2, PAGES 78-79, AUG. 26, 1974, R. LESTER. MONUMENT & WITNESSES SAME AS ABOVE.

9) P.A. 132 SURVEY, LIBER 5, PAGES 1017-1019, MAR. 10, 1989, D. LOHR P.S. 30090. MONUMENT & WITNESSES SAME AS ITEM 7 ABOVE. RECORDED 2635.95 FEET TO D-11 & 2655.84 FEET TO E-10.

10) P.A. 132 SURVEY, LIBER 6, PAGES 120-121, APRIL 20, 1990, L. BRYAN P.S. 25832. MONUMENT & WITNESSES SAME AS ITEM 7 ABOVE. RECORDED 2635.87 FEET TO D-11.

11) P.A. 132 SURVEY, LIBER 6, PAGES 277-278, JULY 31, 1990, D. LOHR. RECORDED 2642.42 FEET TO F-11 AND 2655.84 FEET TO E-10. "FOUND 1/2" IRON IN MONUMENT BOX."

FD. NAIL & TAG WOOD GUARD POST, NORTH, 21.77'
FD. NAIL & TAG WOOD GUARD POST, S10°E, 23.42'
SET NAIL & TAG WOOD GUARD POST, SOUTH, 21.18'
SET NAIL & TAG WOOD GUARD POST, N30°W, 24.62'



2005-016724
Page: 2 of 2
04/01/2005 08:31P

12) P.A. 132 SURVEY, LIBER 7, PAGE 1141 & 1142, APRIL 12, 1993, R. HELSEL P.S. 18994. "FOUND RE-BAR IN MONUMENT BOX." CITED LIBER 3 OF CORNERS, PAGE 37, ONLY.

13) P.A. 74 CORNER, LIBER 9, PAGE 327, SEPT. 1, 1998, G. BONNO P.S. 32332. "FOUND 16MM (5/8") ROD IN MONUMENT BOX."
WEST, 11.95 M (39.2") EAST END OF BRIDGE DECK AT CENTERLINE BARNES ROAD.
N30E 8.208 M (26.93') SET PK AND TAG #39096 (J. RAUSER)
S20E 7.135M (23.41') FOUND NAIL AND TAG #25832 IN TOP OF WOOD GUARD RAIL POST
N70W 13.009M (42.68') TOP CENTER OF N'LY BOLT HOLDING IRON RAIL TO CONCRETE RAIL
S70W 13.009M (42.68') TOP CENTER OF S'LY BOLT HOLDING IRON RAIL TO CONCRETE RAIL
WEST 803.392M (2635.80') D-11
EAST 805.362M (2642.26') F-11

14) P.A. 132 SURVEY LIBER 8, PAGES 1147, JUNE 19, 2003, M. MAHIEU P.S. 28414. "FOUND 5/8" ROD IN MON. BOX." RECORDED 2635.82 FEET TO D-11

FOUND NAIL & TAG #39096 TOP WOOD GUARD RAIL POST, N30°E, 26.93'
FOUND NAIL & TAG #25832 TOP WOOD GUARD RAIL POST, S20°E, 23.41'
TOP CENTER N'LY BOLT FOR RAILING, N70°W, 42.68'
TOP CENTER S'LY BOLT FOR RAILING, S70°W, 42.68'

15) P.A. 132 SURVEY, LIBER 8, PAGES 1171, JULY 29, 2003, R. LESTER. RECORDED 2635.82 FEET TO D-11. " BAR IN MONUMENT BOX, LIBER 9, PAGE 326. WITNESSES OF RECORD."

EAST END OF BRIDGE DECK AT CENTERLINE OF BARNES ROAD, WEST, 39.20'
P.K. NAIL & TAG #39096, TOP OF WOOD POST, N30°E, 26.93'
NAIL & TAG #25832 TOP WOOD POST, S20°E, 23.41'
TOP CENTER OF NLY BOLT HOLDING IRON RAIL TO CONCRETE RAIL, N70°W, 42.68'

16) P.A. 132 SURVEY, LIBER 8, PAGE 11182, AUG. 13, 2003, R. LESTER. RECORDED 2635.82 FEET TO D-11. MONUMENT AND WITNESSES SAME AS ITEM 15 ABOVE..



LAND CORNER RECORDATION CERTIFICATE
Filing Requirement of Act 74, Mich. P.A. 1970
VEVAY TOWNSHIP

For corners in

INGHAM

(County)

Located In:

Corner Code #

1. Public Land Survey T 2N R 1W E-13
T R
T R
T R
2. Property Controlling S T R
in Section S T R
3. Miscellaneous S T R
Property in Section S T R

P.A. 345 INGHAM COUNTY
PEER APPROVED 3/22/2005/16

Register of Deeds Stamp & File Number

4. Lot No. , Recorded Plat
5. Private Claims

I, RON HELSEL, in A field survey on FEB. 26, 2005 do hereby state that under requirements of P.A. 74, Michigan P.A. of 1970, the corner points mentioned in lines 1 and 2 above were in conformance with regulations and rules therefore as required in the current manual of survey instructions of the United States Department of the Interior, Bureau of Land Management or by A decree of A Court of Law and /or that the corner points mentioned in lines 3, 4 and 5 above were in conformance with the rules of the Michigan Board of Land Surveyors or by A Decree of A Court of Law; established, re-established, monumented, recovered, found as expressed below:

NOTE: Not more than 2 comers, all in the same town and range, may be recorded on this certificate.

A. Description of original monument and accessories and/or subsequent restoration:

ORIGINAL MONUMENT: POST SET BY J. MULLET DEPUTY SURVEYOR, MAY 6, 1825. BLACK OAK 16", N63E, 19 LINKS; ELM 10", N79W, 36 LINKS.

1) VOL. 1, PAGE 37, DEC. 17, 1841, A. JACKSON, C. S. FOUND ORIGINAL BEARING TREES. RECORDED 160 RODS 5 LINKS TO E-12.

2) FROM INGHAM COUNTY CETA FILE: FOLDER 1 PAGE 18, APRIL 9, 1866, W. H.

RAYNOR, C. S. CORNER MONUMENT NOT IDENTIFIED. SUG. 4" N67-1/2E, 102-1/2 LINKS; SUG. 4" N67-1/2E, 135 LINKS. WEST, 1.91 CHAINS TO E-1 LESLIE TOWNSHIP, T1N, R1W.

3) I.C.R.C. GRID MAP CALLS FOR A 1" PIPE, 14" ELM, NNW, 95.27'; 13" ELM, S. 101.96'; END POST S.W. 42.98'

4) NOTHSTINE'S NOTES: BOAT SPIKE: APPLE 16", S66E, 53.27'; APPLE 14", N30E, 48.80'; APPLE 12", N17W, 45.74'.

5) M-DOT MAP FOR US-27, FILE 33-R-3, PAGE 13 GIVES A TIE OF 126.73' TO E-1, LESLIE TOWNSHIP, T1N, R1W.

(CONTINUED ON BACK SIDE)

B. Description of corner evidence found and/or method applied in restoring or reestablishing corner:

FOUND THE CONCRETE MONUMENT AS DESCRIBED BY SURVEYOR LESTER IN ITEM 7 ABOVE. FOUND WITNESSES OF THE TWO WOOD POSTS AND THE STUMP OF THE MAPLE. ASH GONE. ALSO FOUND THE INGHAM COUNTY TRAVERSE POINT 4 FEET WEST OF THE WEST EDGE OF HULL ROAD. ACCEPTED THE POSITION OF THE MONUMENT ON THE EXCAVATION DONE IN 1978. EXCAVATED AND FOUND A CONCRETE COLLAR. REMOVED COLLAR AND THE TOP 4" ON THE CONCRETE MONUMENT SET A STANDARD INGHAM COUNTY MONUMENT DISK ON TOP STAMPED P.A. 345, P.S. 18994. SET A STEEL MONUMENT BOX. MEASURED WEST 2640.55 FEET TO D-13 AND WEST 124.10 FEET TO E-1, T1N, R1W, LESLIE TOWNSHIP. (GLO 126.06 FEET)

C. Description of monument for corner and accessories established to perpetuate locating the position of the corner:

AN ALUMINUM DISK STAMPED P.A. 345, P.S. NO. 18994 IN MONUMENT BOX 1.5 FEET NORTH OF CENTERLINE OF PLAINS ROAD AND 59 FEET ± EAST OF THE CENTERLINE OF HULL ROAD.

FOUND NAIL & TAG #28414, EAST/SIDE NEW POWER POLE, AZ. 345°, 60.48 FEET

FOUND KEBS NAIL & TAG SOUTHWEST/SIDE WOOD ANCHOR POST, AZ. 316°, 39.15 FEET

U.S. GEOLOGICAL SURVEY MONUMENT IN 4-1/2" MONUMENT BOX, AZ. 314°, 57.26 FEET

FOUND MD SH NAIL & TAG NORTHWEST/SIDE WOOD ANCHOR POST, AZ. 235°, 42.10 FEET

CETA TRAVERSE POINT, WEST, 73.62 FEET

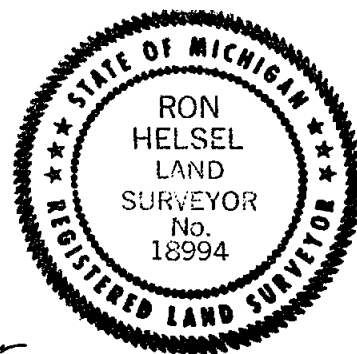

Signed by Ron Helsel

Date 3-23-2005

Surveyor'S Michigan License No. 18994

E-13, T2N, R1W, VEVAY TOWNSHIP CONTINUED

6) FROM CETA DOSSIER, FIELD FORM, DATED JULY 14, 1978. "FOUND A 1" PIPE. FOUND SMALL PIECE OF IRON 1.1 X 0.15' THICK TOP & 1/4" BOTTOM. FOUND BROKEN PIECE OF SAME WITH PIECE OF WOOD LEANING AGAINST IT. (LARGE PIECE WAS ALMOST DIRECTLY UNDER 1" PIPE) REPLACED WITH CONCRETE MONUMENT AND WITNESSED AS FOLLOWS:"

SET NAIL & TAG N/S 10" ELM S80E, 191.08'

SET NAIL & TAG N/S 8" ELM CLUSTER S85E (NO DISTANCE GIVEN)

SET NAIL & TAG E/S 4" ELM, S05E, 27.58'

FOUND P.K. NAIL E/S P.P., N35W, 60.32'

FOUND NAIL & TAG E/S 18" MAPLE, N55W, 112.63'

GAVE A TIE TO A TRAVERSE POINT OF WEST, 73.52'

7) P.A. 74 CORNER, LIBER 5, PAGE 74, NOV. 30, 1978, R. LESTER P.S. 18998. IN SECTION A OF THIS DOCUMENT, IT ERRONEOUSLY STATES THAT ORIGINAL POST WAS SET BY JOSEPH WAMPLER IN FEB.-MARCH, 1826. (THE ORIGINAL GOVERNMENT SURVEY OF THE SOUTH LINE OF VEVAY TOWNSHIP WAS CONDUCTED BY JOHN MULLET IN MAY OF 1825.)

"EXCAVATED A HOLE 4' X 4' TO AN AVERAGE DEPTH OF 1' ON THE CENTERLINE OF PLAINS ROAD EAST, AND \pm 59' EAST OF THE CENTERLINE OF HULL ROAD. FOUND A 1" PIPE ON THE CENTERLINE OF PLAINS ROAD EAST. FOUND A LARGE PIECE OF IRON (1.1' X 0.15' X 1") WITH SMALLER BROKEN PIECE BELOW IT AND A PIECE OF WOOD LEANING AGAINST SMALL IRON PIECE, \pm 2.2' NORTH OF THE CENTERLINE OF PLAINS ROAD EAST AND \pm 59.5 FEET EAST OF THE CENTERLINE OF HULL ROAD. MEASURED EAST TO F-13 \pm 2640'; AND WEST TO D-13 2630' IN CLOSE ACCORD WITH G.L.O. DISTANCES. ACCEPTED LARGE PIECE OF IRON WITH SMALLER BROKEN PIECE AND PIECE OF WOOD LEANING AGAINST IRON AS CORNER. EXCAVATION DONE BY INGHAM COUNTY SURVEY AND REMONUMENTATION PROJECT CREW. SET 4" X 36" CONCRETE MONUMENT WITH 1/2" X 38" REROD AND CAP #18998, AND CONCRETE SLEEVE AT LOCATION OF LARGE AND SMALL IRON WITH PIECE OF WOOD DESCRIBED ABOVE."

NAIL & TAG #18998, NORTH SIDE 4" ASH, SSE, 27.56'

FOUND NAIL & TAG #11370, NORTHWEST SIDE WOOD CORNER POST, NORTHWEST, 39.62'

FOUND POLARIS SURVEY MARKER, WEST SIDE OF 14" MAPLE, NORTHWEST, 112.60'

FOUND MSHD NAIL & TAG NORTHWEST SIDE WOOD CORNER POST, NORTHWEST, 42.15'

8) P.A. 132 SURVEY, LIBER 9, PAGE 2, JAN. 13, 2004, P. NORDER P. S. 44288. THIS WAS A SURVEY IN THE NORTHEAST 1/4 OF SECTION 5, T1N, T1W, LESLIE TOWNSHIP. E-13 WAS NOT IDENTIFIED OR WITNESSED. RECORDED A DISTANCE OF 2640.52 FEET TO D-13 AND 124.06 FEET TO E-1 OF LESLIE TOWNSHIP. CALLED FOR THE AMENDED CORNER OF E-1 TO BE 0.47 FEET NORTH OF RECORDED E-1.



2005-016725
Page: 2 of 2

04/01/2005 08:31P



LAND CORNER RECORDATION CERTIFICATE

Filing Requirement of Act 74, Mich. P.A. 1970

For corners in

VEVAY TOWNSHIP

INGHAM

(County)

Located In:

Corner Code #

1. Public Land Survey T 2N R 1W E-12
T R
T R
T R
2. Property Controlling S T R
in Section S T R
3. Miscellaneous S T R
Property in Section S T R

P.A. 345 INGHAM COUNTY
PEER APPROVED 3/22/2005 RL

Register of Deeds Stamp & File Number

4. Lot No. , Recorded Plat
5. Private Claims

I, RON HELSEL, in A field survey on FEB. 26, 2005 do hereby state that under requirements of P.A. 74, Michigan P.A. of 1970, the corner points mentioned in lines 1 and 2 above were in conformance with regulations and rules therefore as required in the current manual of survey instructions of the United States Department of the Interior, Bureau of Land Management or by A Decree of A Court of Law and /or that the corner points mentioned in lines 3, 4 and 5 above were in conformance with the rules of the Michigan Board of Land Surveyors or by A Decree of A Court of Law; established, re-established, monumented, recovered, found as expressed below:

NOTE: Not more than 2 corners, all in the same town and range, may be recorded on this certificate.

A. Description of original monument and accessories and/or subsequent restoration:
ORIGINAL MONUMENT: POST SET BY H. PARKE, DEPUTY SURVEYOR, MAR. 1826.
WILLOW 8", S2W, 78 LINKS; B. ASH 5", N10E, 107 LINKS

- 1) VOL. 1, PAGE 32, DEC. 4, 1840, A. JACKSON C.S., HE CITED THE ORIGINAL BEARING TREES. RECORDED 158 RODS 48 LINKS TO F-12
2) VOL. 1, PAGE 37, DEC. 17, 1841, A. JACKSON C. S. HE CITED ORIGINAL BEARING TREES. RECORDED 159 RODS 17 LINKS TO D-12 AND 160 RODS 5 LINKS TO E-13.
3) VOL. 2, PAGE 94, NO DATE GIVEN, A. JACKSON C. S.. ORIGINAL BEARING TREES CITED, ONLY.
4) FOLDER 1, PAGE 18, APRIL 9, 1866, W. H. RAYNOR C.S. RECORDED 160 RODS TO E-13. CORNER NOT IDENTIFIED OR WITNESSED.
5) P.A. 74 CORNER, LIBER 6, PAGE 95, AUG. 29, 1980, R. LESTER P.S. 18998. "CORNER RE-ESTABLISHED MIDWAY & ON LINE BETWEEN E-11 AND E-13, 10' WEST CENTERLINE OF HULL ROAD & SOUTH OF CULVERT \pm 14'. MEASURED SOUTH \pm 2651.8' TO E-13 & NORTH TO E-11 2651.8'. NO EXCAVATION DONE TO PAST CONSTRUCTION PERFORMED FOR SERVICE ROAD AND CULVERT. SET 4' X 36" CONCRETE MONUMENT WITH 1/2" X 38" REROD & CAP#18998, WITH CONCRETE COLLAR & COVER IN LOCATION OF RE-ESTABLISHED CORNER DESCRIBED ABOVE.
NORTHEAST CORNER OF CONCRETE ABUTMENT FOR CULVERT, ENE, 29.57'
SOUTHEAST CORNER OF CONCRETE ABUTMENT FOR CULVERT, EAST, 27.67'
HIGH POINT ON TOP CENTERLINE 18" CMP, NNW, 20.78'
FOUND 5/8" BAR IN CENTERLINE OF HULL ROAD, NORTHEAST, 14.71'

B. Description of corner evidence found and/or method applied in restoring or reestablishing corner:
DEEMED THE ORIGINAL CORNER LOST TO HIGHWAY CONSTRUCTION AND ACCEPTED THE POSITION AS DETERMINED BY SURVEYOR LESTER IN ITEM 5 ABOVE. FOUND THE CONCRETE MONUMENT AND COLLAR 9.5 FEET WEST OF THE CENTERLINE OF HULL ROAD. EXCAVATED AND CUT OFF THE TOP 4" OF THE 1/2" IRON RE-ROD AND CONCRETE MONUMENT AND REMOVED THE CONCRETE COLLAR. SET A STANDARD INGHAM COUNTY DISK ON TOP AND PLACED A STEEL MONUMENT BOX.

C. Description of monument for corner and accessories established to perpetuate locating the position of the corner:
32" CONCRETE MONUMENT AND 1/2" RE-ROD IN A MONUMENT BOX WITH AN ALUMINUM INGHAM COUNTY DISK STAMPED P.A. 345, P.S. 18994, LOCATED 9.5 FEET WEST OF THE CENTERLINE OF HULL ROAD.
FOUND A MAG. NAIL AT THE TOP WEST END OF AN 18" CMP, N35°W, 22.85 FEET
FOUND A MAG. NAIL AT THE TOP EAST END OF AN 18" CMP, B85°E, 32.34 FEET
FOUND KEBS NAIL & TAG ON EAST POST OF BARNES ROAD EXIT SIGN, S46°E, 58.62 FEET
CENTERLINE OF A SANITARY MANHOLE, S70°E, 40.65 FEET

	A	B	C	D	E	F	G	H	I	J	K	L	M
1													
2	6			5		4		3		2		1	
3													
4	7		8		9		10		11		12		
5													
6	18		17		16		15		14		13		
7													
8	19		20		21		22		23		24		
9													
10	30		29		28		27		26		25		
11													
12	31		32		33		34		35		36		
13													

Signed by Ron Helsel
Surveyor'S Michigan License No. 18994

Date 3-23-2005

