

# INDEX TO PUBLIC LAND SURVEY CORNER RECORDATIONS FILED IN

TOWN 3 <sup>NORTH</sup><sub>SOUTH</sub>, RANGE 1 <sup>EAST</sup><sub>WEST</sub>

## TOWNSHIP CORNER NUMBERING CODE DIAGRAM

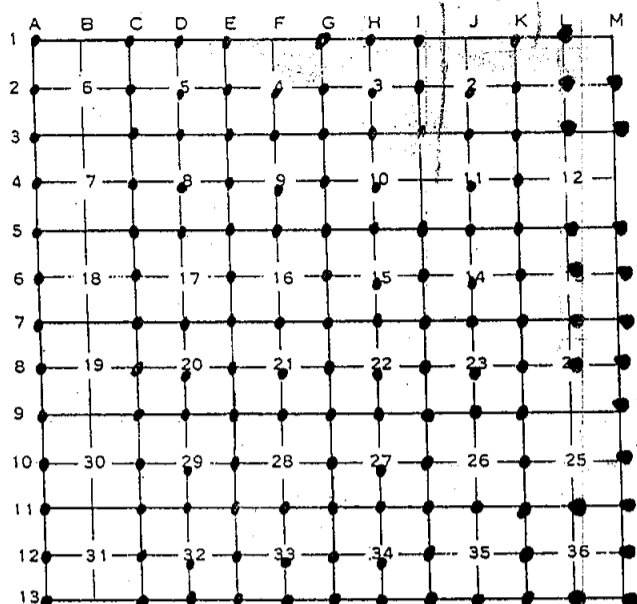

CORNER INDEX

CODE NO.	FILING NUMBER	CODE NO.	FILING NUMBER
----------	---------------	----------	---------------

A-1	L9P233	D-1	L5P149 L9P49
A-2	L3P634 L5P133	D-2	L5P148 L8P627
A-3	L5P210 L9P237	D-3	L2P357 L8P588
A-4	L4P202 L3P413	D-4	L4P25
A-5	L4P99 L9P241	D-5	L3P101 L4P24
A-6	L4P99 L9P331	D-6	
A-7	L4P99 L9P332	D-7	L2P173 L3P101
A-8	L5P357	D-8	L5P88
A-9	L1P533	D-9	L1P377 L4P4
A-10	L5P358	D-10	L4P235
A-11	L4P233	D-11	L5P308
A-12	L5P288	D-12	L4P60
A-13	L5P323	D-13	L4P59 L5P305

B-1		E-1	L8P622
B-2		E-2	L4P87 L8P582
B-3		E-3	L2P355 L8P586
B-4		E-4	L3P47 L4P25
B-5		E-5	L2P185 L4P24
B-6		E-6	L3P7
B-7		E-7	L2P171 L3P101
B-8		E-8	L2P167
B-9		E-9	L2P169
B-10		E-10	L4P4
B-11		E-11	L1P511 L2P193
B-12		E-12	L1P516
B-13		E-13	L1P505 L6P114

C-1	L9P1	F-1	L10P9
C-2	L5P140 L8P623	F-2	L3P563 L10P5
C-3	L4P230 L5P150	F-3	L3P77 9-460
C-4	L7P32 L9P242	F-4	L3P77
C-5	L4P101 L9P243	F-5	L3P5
C-6	L9P333	F-6	
C-7	L2P183 L9P334	F-7	L2P179 L4P88
C-8	11-160	F-8	L2P175
C-9	L1P533 L2P189	F-9	L2P537
C-10	L8P302	F-10	
C-11	L4P190 L4P233	F-11	L1P507
C-12	L4P60	F-12	L3P99
C-13	L4P59	F-13	L1P501

*Whartfield Sup*

## CORNER INDEX

CODE NO.	FILING NUMBER	CODE NO.	FILING NUMBER
G-1	L9P576	K-1	L6P349
G-2	L3P563 L10P10	K-2	L3P163 L7P21
G-3	L3P563 L9P467	K-3	L3P163 L7P21
G-4	L8P620	K-4	L3P75
G-5	L3P3	K-5	L1P391 L1P601
G-6	L3P1 L7P256	K-6	L1P599
G-7	L2P191 L7P257	K-7	L3P99
G-8	L3P525	K-8	L5P118
G-9	L2P187	K-9	L5P121 L8P7
G-10	L7P58	K-10	L5P78 L8P5
G-11	L1P509	K-11	L4P221
G-12	L5P246	K-12	L4P120
G-13	L1P503 L3P233	K-13	L5P102

H-1	L4P243 10-392	L-1	L6P233 L7P4
H-2	L4P201 L4P243	L-2	L7P4
H-3	L4P151 10-388	L-3	L5P248 L7P5
H-4	L3P510	L-4	
H-5	L1P619	L-5	L4P10
H-6	L6P119	L-6	L4P10
H-7	L2P181 L9P384	L-7	L3P99
H-8	L6P142 L9P384	L-8	L3P335
H-9	L3P71	L-9	
H-10	L3P71 L7P58	L-10	
H-11	L5P75 L8P1	L-11	L3P525 L7P210
H-12	L3P233	L-12	
H-13	L6P93 L3P233	L-13	L5P103

I-1	L3P29 L6P244	M-1	
I-2	L5P247 10-382	M-2	L3P482 L6P133
I-3	L5P79 10-381	M-3	L5P82
I-4		M-4	
I-5	L1P621 L2P495	M-5	L4P358
I-6	L1P617	M-6	L6P76
I-7	L3P414	M-7	L3P99 L6P143
I-8	L3P69	M-8	L5P239
I-9	L3P109	M-9	L6P126
I-10	L3P71 L6P307	M-10	L5P83 L7P211
I-11	L3P411	M-11	L3P525 L7P209
I-12	L3P411	M-12	L4P120 L7P208
I-13	L3P411	M-13	L5P309

INDEX TO PUBLIC LAND SURVEY CORNER RECORDATIONS FILED IN

TOWN 3 NORTH SOUTH, RANGE 1 EAST WEST

TOWNSHIP CORNER NUMBERING CODE DIAGRAM

	A	B	C	D	E	F	G	H	I	J	K	L	M
1													
2	6		5		4		3		2		1		
3													
4	7		8		9		10		11		12		
5													
6	18		17		16		15		14		13		
7													
8	19		20		21		22		23		24		
9													
10	30		29		28		27		26		25		
11													
12	31		32		33		34		35		36		
13													

Wheatfield Sup - Page 2

CORNER INDEX

CODE NO.	FILING NUMBER	CODE NO.	FILING NUMBER
G-1		K-1	
G-2		K-2	
G-3		K-3	
G-4		K-4	
G-5		K-5	L9P448
G-6		K-6	
G-7		K-7	
G-8		K-8	
G-9		K-9	
G-10		K-10	
G-11		K-11	
G-12		K-12	
G-13		K-13	

CORNER INDEX

CODE NO.	FILING NUMBER	CODE NO.	FILING NUMBER	CODE NO.	FILING NUMBER	CODE NO.	FILING NUMBER
A-1		D-1		H-1		L-1	
A-2	L9P235	D-2		H-2	10-390	L-2	
A-3		D-3		H-3		L-3	
A-4	L5P50 L9P239	D-4		H-4		L-4	
A-5		D-5		H-5		L-5	
A-6		D-6		H-6		L-6	
A-7		D-7		H-7		L-7	
A-8		D-8		H-8		L-8	
A-9		D-9		H-9		L-9	
A-10		D-10		H-10		L-10	
A-11		D-11		H-11		L-11	L9P385
A-12		D-12		H-12		L-12	
A-13		D-13		H-13		L-13	
B-1		E-1		I-1	L6P349 10-220 10-386	M-1	
B-2		E-2		I-2		M-2	L7P6v
B-3		E-3		I-3		M-3	
B-4		E-4		I-4		M-4	
B-5		E-5		I-5		M-5	
B-6		E-6		I-6		M-6	
B-7		E-7		I-7		M-7	
B-8		E-8		I-8		M-8	
B-9		E-9		I-9		M-9	
B-10		E-10		I-10		M-10	L9P385
B-11		E-11		I-11		M-11	L9P385
B-12		E-12		I-12		M-12	
B-13		E-13		I-13		M-13	
C-1		F-1		J-1			
C-2		F-2		J-2			
C-3	L8P625	F-3		J-3			
C-4		F-4		J-4			
C-5		F-5		J-5			
C-6		F-6		J-6			
C-7		F-7	L7P255	J-7			
C-8		F-8		J-8			
C-9		F-9		J-9			
C-10		F-10		J-10			
C-11		F-11		J-11			
C-12		F-12		J-12			
C-13		F-13		J-13			

## LAND CORNER RECORDATION CERTIFICATE

FILING REQUIREMENT OF ACT 74, MICH. P.A. 1970

LIBER

3 PG. 163

FILED

FOR CORNERS OF--	Sec.	LOCATED IN--	CORNER CODE NUMBER
1. PUBLIC LAND SURVEY	2	T. 3 N. R. 1 E.	K-2, K-3
2. PROPERTY CONTROLLING IN SECTION	T	N. S. R. E.	
3. MISCELLANEOUS PROPERTY IN SECTION	T	N. S. R. E.	
4. LOT NO. . . . . , RECORDED PLAT . . . . .			
5. PRIVATE CLAIMS . . . . .			

Jul 12 2 06 PM '74

REGISTER OF DEEDS

*Emil M. Lester*  
 INGHAM COUNTY, MICH.

REGISTER OF DEEDS STAMP AND FILING NUMBER

I, Ronnie M. Lester do hereby certify that under requirements of P.A. 74, Michigan P.A. of 1970 the corner points mentioned in lines 1 and 2 above (identified with circles on index code diagram - over) were, in a field survey on May 21, 1974, established, re-established, monumented, re-monumented, recovered or restored as expressed below and in conformance with regulations and rules therefore as required in the current manual of survey instructions of the United States Department of the Interior, Bureau of Land Management or by a decree of a court of law. Furthermore, that the corner points mentioned in lines 3, 4 and 5 above were, in a field survey on 19, found, recovered, restored, established or re-established as expressed below and in conformance with the rules of the Michigan State Board of Registration for Land Surveyors or, by a Decree of a Court of law:

A. Description of original monument and accessories and or subsequent restoration:

K-2, 3/8" iron rod &amp; witnesses.

K-3, Boatspike &amp; witnesses.

B. Description of corner evidence found and/or method applied in restoring or re-establishing corner:

K-2, Found 3/8" square bar from witnesses supplied by Stephens Engineering.

K-3, Found boatspike from witnesses supplied by Stephens Engineering.

C. Description of monument for corner and accessories established to perpetuate locating the position of the corner:

K-2, E 1/4 Corner Section 2, T3N, R1E

Found 3/8" sq. bar in apparent centerline Williamston Rd. &amp; old fence line East.

SE corner of church, NW, 141.49'

P.K. nail North side power pole, West, 63.07'

Nail &amp; tag South side power pole, East, 31.66'

K-3, SE Corner Section 2, T3N, R1E

Found boatspike 6' West of apparent centerline Williamston Rd. North &amp; South &amp; on apparent centerline Linn Road East &amp; West.

Nail &amp; tag North side power pole, WNW, 92.02'

Nail &amp; tag West side 16" maple, SW, 53.65'

Nail &amp; atg South side power pole, ENE, 215.24'

SIGNED BY Ronnie M. LesterDATE May 23, 1974SURVEYOR'S MICHIGAN REGISTRATION NO. 18998

FOR STATE AND UNITED STATES AGENCIES:

SIGNED BY \_\_\_\_\_

CHIEF OF SURVEY PARTY

DATE \_\_\_\_\_

APPROVED AND SIGNED BY \_\_\_\_\_

MICHIGAN REGISTERED LAND SURVEYOR

DATE \_\_\_\_\_

(SEAL)

SURVEYOR'S MICHIGAN REGISTRATION NO. \_\_\_\_\_

Form No. ML M735  
DOUBLE DAY BROS. & CO., KALAMAZOO, MICH.FORM APPROVED BY MICHIGAN STATE BOARD OF REGISTRATION, JAN. 28, 1971  
DISTRIBUTED BY MICHIGAN SOCIETY OF REGISTERED LAND SURVEYORS

# LAND CORNER RECORDATION CERTIFICATE

FILING REQUIREMENT OF ACT 74, MICH. P.A. 1970

FOR CORNERS OF—

LOCATED IN—

CORNER CODE NUMBER

LIBER

3 PC 482

1. PUBLIC LAND SURVEY

T 3N S. R. 1E W.

M-2

FILED

2. PROPERTY CONTROLLING IN SECTION

T 3N S. R. W.

3. MISCELLANEOUS PROPERTY IN SECTION

T 3N S. R. W.

4. LOT NO.

RECORDED PLAT

5. PRIVATE CLAIMS

NOV 25 9 34 AM '75

REGISTER OF DEEDS

*Ernest M. Lewis*  
INGHAM COUNTY, MICH

REGISTER OF DEEDS STAMP AND FILING NUMBER

I, **George M. Young** do hereby certify that under requirements of P.A. 74, Michigan P.A. of 1970 the corner points mentioned in lines 1 and 2 above (identified with circles on index code diagram—over) were, in a field survey on **9-15** to **75**, established, re-established, monumented, re-monumented, recovered or restored as expressed below and in conformance with regulations and rules therefore as required in the current manual of survey instructions of the United States Department of the Interior, Bureau of Land Management or by a decree of a court of law. Furthermore, that the corner points mentioned in lines 3, 4 and 5 above were, in a field survey on **19**, found, recovered, restored, established or re-established as expressed below and in conformance with the rules of the Michigan State Board of Registration for Land Surveyors or, by a Decree of a Court of law:

A. Description of original monument and accessories and of subsequent restoration:

M-2 Unknown

B. Description of corner evidence found and of method applied in restoring or re-establishing corner:

M-2 Found MDSH Boat Spike in West Edge of road



C. Description of monument for corner and accessories established to perpetuate locating the position of the corner:

M-2 Found MDSH Boat Spike - Nail & Washer in 6" Elm S45°E 41.68'  
Nail & Washer in 6" Elm N50°W 22.65'  
Nail in face of 18" Cherry "W" 30.28'

SIGNED BY *George M. Young*

DATE November 7, 1975

SURVEYOR'S MICHIGAN REGISTRATION NO. 17640

(SEAL)

FOR STATE AND UNITED STATES AGENCIES:

SIGNED BY \_\_\_\_\_  
CHIEF OF SURVEY PARTY

DATE

APPROVED AND SIGNED BY \_\_\_\_\_

MICHIGAN REGISTERED LAND SURVEYOR

DATE

(SEAL)

SURVEYOR'S MICHIGAN REGISTRATION NO. \_\_\_\_\_

895

Form No. MLM735  
DOUBLCOX, BRCS, & CO., KALAMAZOO, MICH.

FORM APPROVED BY MICHIGAN STATE BOARD OF REGISTRATION, JAN. 28, 1973  
DISTRIBUTED BY MICHIGAN SOCIETY OF REGISTERED LAND SURVEYORS

# LAND CORNER RECORDATION CERTIFICATE

## FILING REQUIREMENT OF ACT 74, MICH. P.A.1970

FOR CORNERS OF:-	LOCATED IN:-	CORNER CODE NUMBER
1. PUBLIC LAND SURVEY	T. <u>3</u> N. R. <u>1</u> E.	<u>M-3</u>
2. PROPERTY CONTROLLING IN SECTION	T. <u>      </u> N. S. R. <u>      </u> E.	
3. MISCELLANEOUS PROPERTY IN SECTION	T. <u>      </u> N. S. R. <u>      </u> E.	
4. LOT NO. <u>      </u> RECORDED PLAT <u>      </u>		
5. PRIVATE CLAIMS <u>      </u>		

LIBER 5 PG 82

FILED

Nov 30 1 27 PM '78

REGISTER OF DEEDS

*Paula Johnson*

INGHAM COUNTY, MICH.

REGISTER OF DEEDS STAMP AND FILING NUMBER

I, Ronnie M. Lester, do hereby certify that under requirements of P.A. 74, Michigan P.A. of 1970, the corner points mentioned in lines 1 and 2 above were, in a field survey on July 24, 1978, established, re-established, monumented, re-monumented, recovered or restored as expressed below and in conformance with regulations and rules therefore as required in the current manual of survey instructions of the United States Department of the Interior, Bureau of Land Management or by a decree of a court of law. Furthermore, that the corner points mentioned in lines 3, 4 and 5 above were, in a field survey on       , 19      , found, recovered, restored, established or re-established as expressed below and in conformance with the rules of the Michigan State Board of Registration for Land Surveyors or, by a Decree of a Court of law:

A. Description of original monument and accessories and/or subsequent restoration:

M-3

Post set in original government survey by J. Wampler dated Feb.-March, 1826.

Corner identified as 3/4" pipe by MDSHT Government Witness Form 280 and by

Consumers Power.

Corner referred to by MDSHT in a Right of Way Map.

Corner identified as 1" pipe by Ingham County Road Commission in a revised map

dated Jan. 1, 1969.

B. Description of corner evidence found and/or method applied in restoring or re-establishing corner:

M-3

Excavated a hole 5' x 5' to an average depth of 3.7' on the intersection of the centerlines of Linn and Meech Roads. Found 3/4" iron pipe below the surface at the intersection of the centerline of Linn and Meech Roads. Accepted 3/4" iron pipe as described by Consumers Power and MSDHT Form 280. Measured north  $\pm 128'$  to A-3, Leroy Twp. T3N-R2E in close accord with G.L.O. falling distance. Excavation conducted by Ingham County Survey and Remonumentation Project crew.

C. Description of monument for corner and accessories established to perpetuate locating the position of the corner:

M-3

Southeast Corner, Section 1, T3N-R1E

Set 4" x 36" concrete monument with 1/2" x 38" rerod and cap #18998, in place of 3/4" iron pipe as described above:

Nail & tag, #18998, northeast side 20" Maple, NW, 44.32'

Nail & tag, #18998, south side 26" Maple, WNW, 61.08'

Nail & tag, #18998, east side 18" Maple, NNW, 117.6'

Nail & tag, #18998, west Twin Elm, SSE, 72.12'

SIGNED BY Ronnie M. Lester

DATE 11/29/78

SURVEYOR'S MICHIGAN REGISTRATION NO. 18998

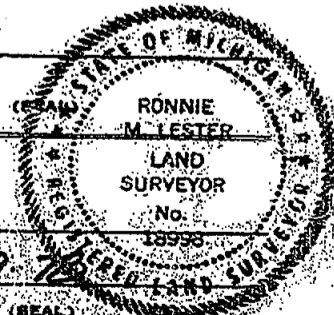

SIGNED BY

CHIEF OF SURVEY PARTY

DATE

APPROVED AND SIGNED BY

Gary D. Lester  
MICHIGAN REGISTERED LAND SURVEYOR

DATE 11-29-78

Director, Ingham County Survey and Remonumentation Project

SURVEYOR'S MICHIGAN REGISTRATION NO. 17624

1469

FORM APPROVED BY MICHIGAN STATE BOARD OF REGISTRATION, JAN. 28, 1971  
REVISED MAY 14, 1975

MAY PLACE SKETCH ON BACK OR ATTACHED SHEET



INGHAM COUNTY-WHEATFIELD TWP.  
LAND CORNER RECORDATION CERTIFICATE  
FILING REQUIREMENT OF ACT 74, MICH. P.A.1970

FOR CORNERS OF--	LOCATED IN--	CORNER CODE NUMBER
1. PUBLIC LAND SURVEY_____	T. <u>3</u> N. <u>1</u> E. <u>X</u> S. <u>X</u> R. <u>1</u>	<u>L-3</u>
2. PROPERTY CONTROLLING IN SECTION_____	T. _____ N. _____ E. _____ S. _____ R. _____ W. _____	_____
3. MISCELLANEOUS PROPERTY IN SECTION_____	T. _____ N. _____ E. _____ S. _____ R. _____ W. _____	_____
4. LOT NO. _____, RECORDED PLAT _____		
5. PRIVATE CLAIMS _____		

LIBER 5 PG 248  
FILED

JUN 12 8 34 AM '79  
REGISTER OF DEEDS  
*Paula Johnson*  
INGHAM COUNTY, MICH.

REGISTER OF DEEDS STAMP AND  
FILING NUMBER

I, Ronnie M. Lester, do hereby certify that under requirements of P.A. 74, Michigan P.A. of 1970, the corner points mentioned in lines 1 and 2 above were, in a field survey on February 23, 1979, established, re-established, monumented, re-monumented, recovered or restored as expressed below and in conformance with regulations and rules therefore as required in the current manual of survey instructions of the United States Department of the Interior, Bureau of Land Management or by a decree of a court of law. Furthermore, that the corner points mentioned in lines 3, 4 and 5 above were, in a field survey on \_\_\_\_\_, 19\_\_\_\_, found, recovered, restored, established or re-established as expressed below and in conformance with the rules of the Michigan State Board of Registration for Land Surveyors or, by a Decree of a Court of law:

A. Description of original monument and accessories and/or subsequent restoration:

L-3

Post set in original government survey by J. Wampler between February 20 and March 3, 1826.

No public record available showing any subsequent perpetuation.

B. Description of corner evidence found and/or method applied in restoring or re-establishing corner:

L-3

Excavated a hole 4' x 6' to an average depth of 5' on the centerline of Linn Road and on fenceline to the south. Excavated a second hole 4' x 5' to an average depth of 5' on the centerline of Linn Road and + 12.0' east of fenceline to the south and + 3.0' west of fenceline to the north. Excavations revealed no physical evidence of monumentation. Physical features (fences) were considered to be inconclusive. Corner considered to be lost and re-established by placing midway and on line between M-3 and K-3. Corner falls +2.0' east of fence north and in centerline of Linn Road in area of 24" C.M.P. Measured + 2655' west to K-3 and + 2655' east to M-3. Excavation conducted by Ingham County Survey and Remonumentation Project crew.

C. Description of monument for corner and accessories established to perpetuate locating the position of the corner:

L-3

N $\frac{1}{2}$  Corner, Section 12, T3N-R1E

Set 4" x 36" concrete monument with  $\frac{1}{2}$ " x 38" rerod and cap #18998 in location of corner described above:

Nail & tag, #18998, northwest side 10" Triple Maple, SSW, 24.73'

Nail & tag, #18998, south side 10" Twin Ash, NW, 69.54'

Nail & tag, #18998, southeast side 24" Maple, North, 33.66'

Nail & tag, #18998, northwest side 12" Twin Maple, NE, 53.03'

SIGNED BY

*Ronnie M. Lester*

DATE June 6, 1979

SURVEYOR'S MICHIGAN REGISTRATION NO. 18998

(SEAL)



SIGNED BY

CHIEF OF SURVEY PARTY

DATE

APPROVED AND SIGNED BY

MICHIGAN REGISTERED LAND SURVEYOR

DATE 6-6-79

(SEAL)



Director, Ingham County Survey and Remonumentation Project

SURVEYOR'S MICHIGAN REGISTRATION NO. 17624

1631

FORM APPROVED BY MICHIGAN STATE BOARD OF REGISTRATION, JAN. 28, 1971  
REVISED MAY 14, 1975

MAY PLACE SKETCH ON BACK OR ATTACHED SHEET

# LAND CORNER RECORDATION CERTIFICATE

FILING REQUIREMENT OF ACT 74, MICH. P.A.1970

SE 1/4 Section 1, Wheatfield Twp. Ingham County

FOR CORNERS OF--:	LOCATED IN--:	CORNER CODE NUMBER
1. PUBLIC LAND SURVEY_____ T. <u>3</u> N. <u>2</u> , R. <u>1</u> E. <u>2</u>		M-2
2. PROPERTY CONTROLL- ING IN SECTION_____ ,T. _____ N. _____ E. _____ S. _____ W. _____		
3. MISCELLANEOUS PROPERTY IN SECTION_____ ,T. _____ N. _____ E. _____ S. _____ W. _____		
4. LOT NO. _____ , RECORDED PLAT _____		
5. PRIVATE CLAIMS _____		

LIBER 6 133

FILED

Dec 12 3 20 PM '80

REGISTER OF DEEDS

*Paula Johnson*

INGHAM COUNTY, MICH.

REGISTER OF DEEDS STAMP AND  
FILING NUMBER

I, James E. Stephens, do hereby certify that under requirements of P.A. 74, Michigan P.A. of 1970, the corner points mentioned in lines 1 and 2 above were, in a field survey on November 25, 1980, established, re-established, monumented, re-monumented, recovered or restored as expressed below and in conformance with regulations and rules therefore as required in the current manual of survey instructions of the United States Department of the Interior, Bureau of Land Management or by a decree of a court of law. Furthermore, that the corner points mentioned in lines 3, 4 and 5 above were, in a field survey on \_\_\_\_\_, 19\_\_\_\_, found, recovered, restored, established or re-established as expressed below and in conformance with the rules of the Michigan State Board of Registration for Land Surveyors or, by a Decree of a Court of law:

A. Description of original monument and accessories and/or subsequent restoration:

Post set in original government survey by J. Wampler dated Feb.-March 1826.

Corner identified as 1" pipe by Ingham County Road Commission in 1969.

Corner recorded by George M. Young on November 7, 1975 in Liber 3, Page 482

B. Description of corner evidence found and/or method applied in restoring or re-establishing corner:

Found boat spike as recorded on land corner recordation certificate in Liber 3, Page 482. Also found one witness in 18" Cherry tree (now stump).

This corner is being re-recorded to update witness information.

C. Description of monument for corner and accessories established to perpetuate locating the position of the corner:

Found boat spike:  
Nail & tag #16053 in E side 22" Cherry stump West 30.18'  
Nail & tag # 16053 in N.E. side 3" Elm N.W. 24.55'  
Nail & tag # 16053 in N.W. side 6" Elm N.E. 35.92'  
Nail & tag # 16053 in N. side 4" Elm East 30.20'

SIGNED BY James E. Stephens DATE November 26, 1980

SURVEYOR'S MICHIGAN REGISTRATION NO. 16053

(SEAL)

FOR STATE AND UNITED STATES AGENCIES:

SIGNED BY \_\_\_\_\_ DATE \_\_\_\_\_

CHIEF OF SURVEY PARTY

APPROVED AND SIGNED BY \_\_\_\_\_ DATE \_\_\_\_\_

MICHIGAN REGISTERED LAND SURVEYOR

SURVEYOR'S MICHIGAN REGISTRATION NO. \_\_\_\_\_

1882

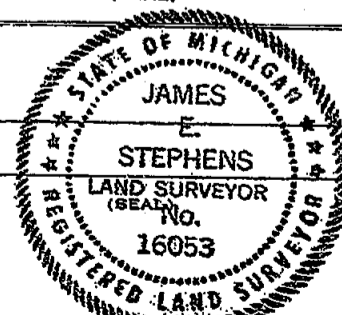

FORM APPROVED BY MICHIGAN STATE BOARD OF REGISTRATION, JAN. 28, 1971  
REVISED MAY 14, 1975

MAY PLACE SKETCH ON BACK OR ATTACHED SHEET

# LAND CORNER RECORDATION CERTIFICATE

FILING REQUIREMENT OF ACT 74, MICH. P.A. 1970

North 1/4 corner Section 1, T3N, R1E

FOR CORNERS OF--	LOCATED IN--	CORNER CODE NUMBER
1. PUBLIC LAND SURVEY	T. <u>3</u> N. <u>8</u> R. <u>1</u> E. <u>W</u>	<u>L-1</u>
2. PROPERTY CONTROLLING IN SECTION	T. <u>      </u> N. <u>      </u> S. <u>      </u> R. <u>      </u> E. <u>      </u> W. <u>      </u>	
3. MISCELLANEOUS PROPERTY IN SECTION	T. <u>      </u> N. <u>      </u> S. <u>      </u> R. <u>      </u> E. <u>      </u> W. <u>      </u>	
4. LOT NO. <u>      </u> , RECORDED PLAT <u>      </u>		
5. PRIVATE CLAIMS <u>      </u>		

LIBER 6 PAGE 233  
FILED

FEB 1 1 17 PM '83

REGISTER OF DEEDS  
*Paula Johnson*  
INGHAM COUNTY, MICH.

REGISTER OF DEEDS STAMP AND  
FILING NUMBER

I, Larry A. Bryan, do hereby certify that under requirements of P.A. 74, Michigan P.A. of 1970, the corner points mentioned in lines 1 and 2 above were, in a field survey on January 7, 1981, established, re-established, monumented, re-monumented, recovered or restored as expressed below and in conformance with regulations and rules therefore as required in the current manual of survey instructions of the United States Department of the Interior, Bureau of Land Management or by a decree of a court of law. Furthermore, that the corner points mentioned in lines 3, 4 and 5 above were, in a field survey on       , 19      , found, recovered, restored, established or re-established as expressed below and in conformance with the rules of the Michigan State Board of Registration for Land Surveyors or, by a Decree of a Court of law:

A. Description of original monument and accessories and/or subsequent restoration:

A-1 Corner not set in original survey  
Corner used in Assessor's plat No. 4 village and Township of Williamston.

B. Description of corner evidence found and/or method applied in restoring or re-establishing corner:

A-1 Corner set on East-West fence line from existing irons according to assessor's Plat No. 4

C. Description of monument for corner and accessories established to perpetuate locating the position of the corner:

A-1 North 1/4 corner Section 1, T3N, R1E, set 1/2" bar w/cap  
Found 1" pipe in concrete, South 1/4 corner Section 36, N85°E, 14.86'  
Set nail & tag West side 24" Walnut, East, 42.44'  
Set nail & tag Southwest side power pole, North, 45.93'  
Southeast corner of garage, N05°W, 38.95'

SIGNED BY Larry A. Bryan DATE 1-7-81

SURVEYOR'S MICHIGAN REGISTRATION NO. 25832

FOR STATE AND UNITED STATES AGENCIES:

SIGNED BY        DATE       

APPROVED AND SIGNED BY        DATE       

SURVEYOR'S MICHIGAN REGISTRATION NO.       



1981

FORM APPROVED BY MICHIGAN STATE BOARD OF REGISTRATION, JAN. 28, 1971  
REVISED MAY 14, 1975

MAY PLACE SKETCH ON BACK OR ATTACHED SHEET

LAND CORNER RECORDATION CERTIFICATE  
Filing Requirement of Act 74, Mich. P.A. 1970

EIBER

6 PAGE 349

For corners in

Ingham

(County)

Located in:

Corner Code ##

FILED

1. Public Land Survey

T 3N R 1E

11, K1

2. Property Controlling  
in Section

S T R

3. Miscellaneous  
Property in Sec.

S T R

4. Lot No. , Recorded Plat

5. Private Claims

NOV 2 10 52 AM '87

REGISTER OF DEEDS

Paula Johnson

INGHAM COUNTY, MICH.

Register of Deeds Stamp & File Number

I, BRUCE L. FLOYD, in a field survey on October 16, 19 87,  
do hereby certify that under requirements of P.A. 74, Michigan P.A. of 1970, the corner points mentioned  
in lines 1 and 2 above were in conformance with regulations and rules therefore as required in the  
current manual of survey instructions of the United States Department of the Interior, Bureau of Land  
Management or by a decree of a Court of Law and/or that the corner points mentioned in lines 3, 4 and 5  
above were in conformance with the rules of the Michigan Board of Land Surveyors or by a Decree of a  
Court of Law; established, re-established, monumented, re-monumented, recovered, found as  
expressed below:

NOTE: Not more than 4 corners, all in the same town and range, may be recorded  
on this certificate.

A. Description of original monument and accessories and/or subsequent restoration:

11 - Original monument lost; 1" bar, previously recorded, was destroyed by new ditch  
excavation.

K1 - Original monument lost; sewer construction has destroyed all evidence in road.

B. Description of corner evidence found and/or method applied in restoring or reestablishing corner:

11 - Reset corner from witnesses; 1/2" rerod with cap #28068 in ditch, West side of Corwin Road.

K1 - Set 1/2" rerod with cap #28068 in location fitting monumentation of Owen's third addition  
to the village (now city) of Williamston. Iron is 0.5' East of east edge of west sidewalk  
of Putnam Street.

C. Description of monument for corner and accessories established to perpetuate locating the position of the corner:

11 - NW corner Section 2 T3N-R1E  
City of Williamston, Ingham Co. Mi.  
Left 1/2" rerod as set in ditch.

WITNESSES:

Aluminum corner fence post S85°W 23.38'  
RR X Sign N05°E 18.12'  
PK Nail in power pole S10°W 12.00'  
1/2" rerod property iron EAST 33.05"  
1" bar, SW corner Sec 35 T4N-R1E  
EAST 65.88'

K1 - NE corner Section 2 T3N-R1E  
City of Williamston, Ingham County, Michigan.  
Left 1/2" rerod as set, 0.5' East of West sidewalk.

WITNESSES:

3/4" bar, SE cor Sec 35 T4N-R1E S89°16'36"E 29.23'  
Property iron N89°16'36"W 7.79'  
Property iron S89°16'36"E 61.38'  
N & T in S side power pole N85°27'54"E 49.29'  
N & T in S side power pole N03°50'16"E 2.98'  
N & T in N side 36" maple S79°29'41"E 66.58'

Signed by Bruce L. Floyd  
Surveyor's Michigan License No. 28068

Date October 19, 1987

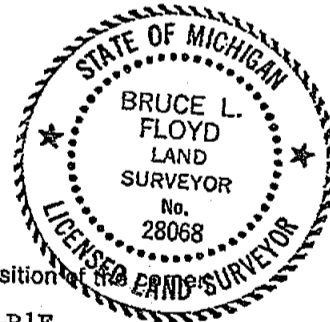

LAND CORNER RECORDATION CERTIFICATE  
Filing Requirement of Act 74, Mich. P.A. 1970

LIBER 7 PAGE 2

For corners in

FILED

Ingham  
County

Located in:

Corner Code #/

- 1 Public Land Survey T 1N R 1E  
T 3N R 1E  
T R  
T R  
2 Property Controlling S T R  
in Section S T R  
3 Miscellaneous S T R  
Property in Sec S T R

K-2  
K-3

OCT 6 9 37 AM '88

REGISTER OF DEEDS  
JACKSON MICH

Register of Deeds Stamp & File Number

- 4 Lot No. Recorded Plat  
5 Private Claims

I, Maurice H. Mahieu, in a field survey on August 25, 1988, do hereby certify that under requirements of P.A. 74, Michigan P.A. of 1970, the corner points mentioned in lines 1 and 2 above were in conformance with regulations and rules therefore as required in the current manual of survey instructions of the United States Department of the Interior, Bureau of Land Management or by a decree of a Court of Law and/or that the corner points mentioned in lines 3, 4 and 5 above were in conformance with the rules of the Michigan Board of Land Surveyors or by a Decree of a Court of Law, established, re-established, monumented, re-monumented, recovered, found as expressed below

NOTE: Not more than 4 corners, all in the same town and range, may be recorded on this certificate.

A Description of original monument and accessories and/or subsequent restoration.

- K-2 Original monuments and accessories were not found  
K-3 Original monuments and accessories were not found

B Description of corner evidence found and/or method applied in restoring or reestablishing corner

K-2 3/8" Bar as recorded in Land Corner Recordation Certificate in Liber 3, Page 163 was destroyed during construction of sewers and roads. Found two of the previous witnesses and found a nail with tag that corresponds to witnesses.

K-3 Boat spike as recorded in Land Corner Recordation Certificate in Liber 3, Page 163, was overlaid by asphalt during new road construction. Found P.K. Nail in new asphalt with two corresponding witnesses

C Description of monument for corner and accessories established to perpetuate locating the position of the corner.

K-2 Left nail in place, witnessed by S.E. Corner of Church addition N.W. 122.60' Nail in Telephone Pole S 70° W 30.10', Nail in North Side of Power Pole West 62.64 feet; Nail in South Side Power Pole East 31.93 feet

K-3 Left nail in place, witnessed by Nail & Tag in North Side Power Pole WNW 92.02 feet; Nail & Tag in South Side power pole ENE 215.04 feet Nail & Washer w/No. 25832 in Telephone Pole WNW 94.30 feet; Nail in Telephone Pole SW 49.65 feet

Signed by

Maurice H. Mahieu  
28414

Surveyor's Michigan License No.

Date

SEPT. 8, 1988

FORM APPROVED BY MICHIGAN STATE BOARD OF LAND SURVEYORS, JAN. 28, 1971  
REVISED MAY 14, 1975  
REVISED JAN. 1983

	A	B	C	D	E	F	G	H	I	J	K	L	M
2	6		5		4		3		2		1		
3													
4	7		8		9		10		11		12		
5													
6	13		17		16		15		14		13		
7													
8	19		20		21		22		23		24		
9													
10	30		29		28		27		26		25		
11													
12	31		32		33		34		35		36		
13													

21-18

LAND CORNER RECORDATION CERTIFICATE  
Filing Requirement of Act 74, Mich. P.A. 1970

LIBER 7 PAGE 4

For corners in

FILED

Ingham County	Located In:	Corner Code #/
1 Public Land Survey	T 3N R 1E	L-2
	T 3N R 1E	L-1
	T R	
	T R	
2 Property Controlling in Section	S T R	
	S T R	
3 Miscellaneous Property in Sec	S T R	
	S T R	
4 Lot No	Recorded Plat	
5 Private Claims		

OCT 6 9 38 AM '88

REGISTER OF DEEDS

REGISTER OF DEEDS

Register of Deeds Stamp & File Number

	A	B	C	D	E	F	G	H	I	J	K	L	M
2	6	5	4	3	2	1							
3													
4	7	8	9	10	11	12							
5													
6	8	17	16	15	14	13							
7													
8	19	20	21	22	23	24							
9													
10	30	29	28	27	26	25							
11													
12	31	32	33	34	35	36							
13													

I, Maurice H. Mahieu, in a field survey on September 6, 1988, do hereby certify that under requirements of P.A. 74, Michigan P.A. of 1970, the corner points mentioned in lines 1 and 2 above were in conformance with regulations and rules therefore as required in the current manual of survey instructions of the United States Department of the Interior, Bureau of Land Management; or by a decree of a Court of Law and/or that the corner points mentioned in lines 3, 4 and 5 above were in conformance with the rules of the Michigan Board of Land Surveyors or by a Decree of a Court of Law, established, re-established, monumented, re-monumented, recovered, found as expressed below

NOTE: Not more than 4 corners, all in the same town and range, may be recorded on this certificate.

A Description of original monument and accessories and/or subsequent restoration  
L-2 Corner was not set in original government survey  
L-1 Corner was not set in original government survey

B Description of corner evidence found and/or method applied in restoring or reestablishing corner  
L-2 Set 1/2" Iron Rod w/cap at intersection of Quarter lines  
L-1 Set 1/2" Iron Rod w/cap from information in records of offices of Wolverine Engineering Company

C Description of monument for corner and accessories established to perpetuate locating the position of the corner

L-2 1/2" Iron Rod witnessed by:  
P.K. Nail in Utility Pole S 25° E 23.00 feet  
Guy Anchor S 50° W 35.30 feet  
Guy Anchor S 75° W 48.25 feet  
Nail in 4" Elm N 45° W 13.70 feet  
L-1 1/2" Iron Rod witnessed by:  
1" Pipe for S 1/4 Cor, Sec 36, T4N R1E, E 14.86'  
Nail & Tag in West Side 24" Walnut East 42.44'  
Nail & Tag in Southwest Side of Utility Pole North 45.93'  
S.E. Corner of Garage N 5° W 38.95'

Signed by *Maurice H. Mahieu*  
Surveyor's Michigan License No *28414*

Date *Sept 6, 1988*

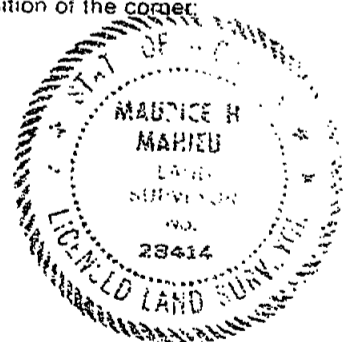

# LAND CORNER RECORDATION CERTIFICATE

## Filing Requirement of Act 74, Mich. P.A. 1970

For corners in

Ingham  
County

Located in:

Corner Code #

FILED

1 Public Land Survey

T 3N R 1E

L-3

2. Property Controlling  
in Section

S

T

R

3. Miscellaneous  
Property in Sec

S

T

R

4 Lot No.

Recorded Plat

5 Private Claims

OCT 6 9 38 AM '88

REGISTER OF DEEDS

TOWN OF LINDEN

Register of Deeds Stamp &amp; File Number

	A	B	C	D	E	F	G	H	I	J	K	L	M
2	6		5		4		3		2		1		
3													
4	7		8		9		10		11		12		
5													
6	18		17		16		15		14		13		
7													
8	19		20		21		22		23		24		
9													
10	30		29		28		27		26		25		
11													
12	31		32		33		34		35		36		
13													

I, Maurice H. Mahieu, in a field survey on August 25, 1988, do hereby certify that under requirements of P.A. 74, Michigan P.A. of 1970, the corner points mentioned in lines 1 and 2 above were in conformance with regulations and rules therefore as required in the current manual of survey instructions of the United States Department of the Interior, Bureau of Land Management or by a decree of a Court of Law and/or that the corner points mentioned in lines 3, 4 and 5 above were in conformance with the rules of the Michigan Board of Land Surveyors or by a Decree of a Court of Law, established, re-established, monumented, re-monumented, recovered, found as expressed below

NOTE: Not more than 4 corners, all in the same town and range, may be recorded on this certificate.

A Description of original monument and accessories and/or subsequent restoration:

L-3 Original monument and accessories set in 1826 by J. Wampler was not found

B. Description of corner evidence found and/or method applied in restoring or reestablishing corner.

L-3 The 4" x 36" concrete monument as recorded in Liber 5, Page 248 in Land Corner Recordation Certificates was destroyed during construction of new C.M.P. being placed across Linn Road according to Ingham County Road Commission. The witnesses were found and a 1/2" Iron Road was placed per the witnesses.

C. Description of monument for corner and accessories established to perpetuate locating the position of the corner

L-3 1/2" Iron Road witnessed by:  
Nail & Tag #18998, Northwest side 10" Triple Maple SSW 24.73'  
Nail & Tag #18998, South Side 10" Twin Ash N.W. 69.54'  
Nail & Tag #18998, Southeast Side 24" Maple North 33.66'  
Nail & Tag #18998, Northwest Side 12" Twin Maple N.E. 53.03'

Signed by *Maurice H. Mahieu*  
Surveyor's Michigan License No. 28414

Date Sept. 8, 1988

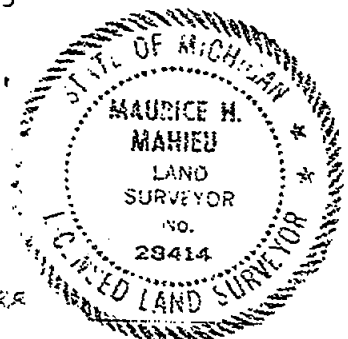

2151

# LAND CORNER RECORDATION CERTIFICATE

## Filing Requirement of Act 74, Mich. P.A. 1970

FILED

For corners in

Ingham  
County

Located In:

Corner Code #1

OCT 6 9 38 AM '88

REGISTER OF DEEDS

JAN 10 1988

Register of Deeds Stamp &amp; File Number

- 1 Public Land Survey T 3N R 1E 1-2  
T R  
T R  
T R
- 2 Property Controlling S T R  
in Section S T R  
3. Miscellaneous S T R  
Property in Sec S T R
- 4 Lot No. Recorded Plat  
5. Private Claims

	A	B	C	D	E	F	G	H	I	J	K	L	M
2	6	5	4	3	2	1							
3													
4	7	8	9	10	11	12							
5													
6	18	17	16	15	14	13							
7													
8	19	20	21	22	23	24							
9													
10	30	29	28	27	26	25							
11													
12	31	32	33	34	35	36							
13													

I, Maurice H. Mahieu in a field survey on August 25 19 88 do hereby certify that under requirements of P.A. 74, Michigan P.A. of 1970, the corner points mentioned in lines 1 and 2 above were in conformance with regulations and rules therefore as required in the current manual of survey instructions of the United States Department of the Interior, Bureau of Land Management or by a decree of a Court of Law and/or that the corner points mentioned in lines 3, 4 and 5 above were in conformance with the rules of the Michigan Board of Land Surveyors or by a Decree of a Court of Law, established, re-established, monumented re-monumented, recovered, found as expressed below

NOTE: Not more than 4 corners, all in the same town and range, may be recorded on this certificate.

A Description of original monument and accessories and/or subsequent restoration

M-2 Original monument and accessories not found

B. Description of corner evidence found and/or method applied in restoring or reestablishing corner

Found boat spike as recorded in Land Corner Certificate Liber 6, Page 133.  
This corner is being recorded to update the witnesses.

C Description of monument for corner and accessories established to perpetuate locating the position of the corner

Left boat spike in place witnessed by:

- Nail & Tag No. 16053 in East Side 22" Cherry Stump West 30.18'
- Nail & Tag No. 16053 in N.E. Side 3" Elm N.W. 24.55'
- Nail in West Face Tw. 8" Elm S 35° E 64.35'
- Nail in N.W. Face 4" Elm S 40° W 26.10'

Signed by *Maurice H. Mahieu*  
Surveyor's Michigan License No. 28414

Date

SEPT 8, 1988

2152

LAND CORNER RECORDATION CERTIFICATE  
Filing Requirement of Act 74, Mich. P.A. 1970

For corners in

Ingham

(County)

Located In:

Corner Code #

1. Public Land Survey

T 3N R 1E

K-3

T R

T R

T R

T R

2. Property Controlling  
In Section

S

T R

S

T R

3. Miscellaneous  
Property In Sec.

S

T R

S

T R

Paula Johnson  
INGHAM COUNTY  
REGISTER OF DEEDS  
STEPHENS-KYES

RECORDED

CRNR 9.00

L-10 P-293

2002-074515

2002-074515

Page: 1 of 1

11/18/2002 08:48A

Register of Deeds Stamp & File Number

4. Lot No. , Recorded Plat

5. Private Claims

I, James E. Stephens, in a field survey on Nov. 12, 2002 do hereby state that under requirements of P.A. 74 Michigan P.A. of 1970, the corner points mentioned in lines 1 and 2 above were in conformance with regulations and rules therefore as required in the current manual of survey instructions of the United States Department of the Interior, Bureau of Land Management or by a decree of a Court of Law and/or that the corner points mentioned in lines 3, 4 and 5 above were in conformance with the rules of the Michigan Board of Land Surveyors or by a Decree of a Court of Law; established, re-established, monumented, recovered, found as expressed below:

NOTE: Not more than 2 corners, all in the same town and range, may be recorded on this certificate.

A. Description of original monument and accessories and/or subsequent restoration:

Original monument and accessories were not found.

B. Description of corner evidence found and/or method applied in restoring or reestablishing corner:

Witnessed existing corner as previously recorded prior to Williamston Road reconstruction. Re-established corner with 1/2" diameter steel rod and cap No. 16053 in monument box.

C. Description of monument for corner and accessories established to perpetuate locating the position of the corner:

1/2" diameter steel rod and cap No. 16053 in monument box witnessed by:

Nail & Tag No. 16053 in South side of utility pole N69°W 92.12'

Nail & Tag No. 16053 in East side of utility pole S44°W 53.10'

Nail & Tag No. 16053 in South side of utility pole N66°E 68.49'

Nail & Tag No. 16053 in North side of utility pole S47°E 85.87'



Signed by

*James E. Stephens*

Date November 13, 2002

Surveyor's Michigan License No.

16053

INDEX TO PUBLIC LAND SURVEY CORNER RECORDATIONS FILED IN

TOWN 4 NORTH SOUTH, RANGE 1 EAST WEST

TOWNSHIP CORNER NUMBERING CODE DIAGRAM

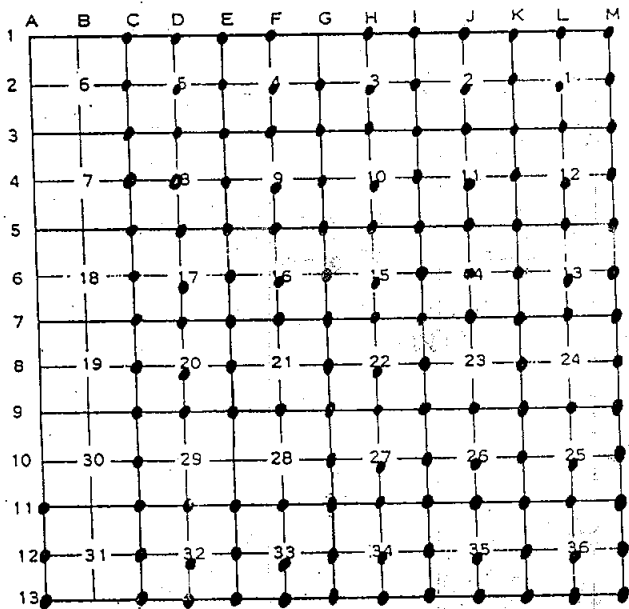

CORNER INDEX

CODE NO.	FILING NUMBER	CODE NO.	FILING NUMBER
A-1		D-1	<u>L5 P69 L6 P328</u>
A-2		D-2	<u>L4 P107 10-292</u>
A-3		D-3	<u>L3 P333 L7 P139</u>
A-4		D-4	<u>10-281</u>
A-5		D-5	<u>L5 P289 L9 P564</u>
A-6		D-6	<u>L6 P283</u>
A-7		D-7	<u>L1 P499</u>
A-8		D-8	<u>L3 P468</u>
A-9		D-9	<u>L1 P577</u>
A-10		D-10	
A-11	<u>L4 P355 L9 P258</u>	D-11	<u>L7 P190 L8 P594</u>
A-12	<u>L3 P625 L9 P260</u>	D-12	<u>L8 P602</u>
A-13	<u>L3 P625 L9 P233</u>	D-13	<u>L7 P141 L8 P598</u>
B-1		E-1	<u>L3 P161</u>
B-2		E-2	<u>L1 P221</u>
B-3		E-3	<u>L1 P223 L2 P539</u>
B-4		E-4	<u>L1 P597 L2 P541</u>
B-5		E-5	<u>L1 P23 L7 P139</u>
B-6		E-6	<u>L6 P115 10-233</u>
B-7		E-7	<u>L3 P465 L3 P465</u>
B-8		E-8	<u>L3 P476</u>
B-9		E-9	<u>L1 P493</u>
B-10		E-10	
B-11		E-11	<u>L2 P403 L7 P192</u>
B-12		E-12	<u>L4 P90 L5 P281</u>
B-13		E-13	<u>L1 P179 L4 P90</u>
C-1	<u>L5 P69 L6 P328</u>	F-1	<u>L4 P384 L5 P95</u>
C-2	<u>L3 P524 L4 P106</u>	F-2	<u>L5 P100</u>
C-3	<u>L4 P106 10-288</u>	F-3	<u>L1 P9 L2 P573</u>
C-4	<u>L10 P282</u>	F-4	<u>L2 P539</u>
C-5	<u>L3 P627 10-284</u>	F-5	<u>L1 P21 L2 P541</u>
C-6	<u>L6 P81</u>	F-6	<u>L6 P157 10-231</u>
C-7	<u>L1 P497</u>	F-7	<u>L5 P364 L7 P55</u>
C-8	<u>L1 P495 L9 P313</u>	F-8	
C-9	<u>L1 P491</u>	F-9	<u>L1 P425 L3 P65</u>
C-10	<u>L4 P26</u>	F-10	
C-11	<u>L8 P621</u>	F-11	<u>L2 P403 L9 P468</u>
C-12	<u>L9 P2</u>	F-12	<u>L6 P113 L10 P194</u>
C-13	<u>L9 P4</u>	F-13	<u>L7 P259 L9 P581</u>

*Williamstown Sup*

CORNER INDEX

CODE NO.	FILING NUMBER	CODE NO.	FILING NUMBER
G-1	<u>L1 P147 L9 P386</u>	K-1	<u>L6 P82</u>
G-2	<u>L1 P13 L2 P513</u>	K-2	<u>L1 P155</u>
G-3	<u>L3 P67 L6 P207</u>	K-3	<u>L1 P157</u>
G-4	<u>L5 P286 L5 P321</u>	K-4	<u>L1 P91</u>
G-5	<u>L3 P13</u>	K-5	<u>L1 P553 L7 P124</u>
G-6	<u>L3 P15</u>	K-6	<u>L1 P555</u>
G-7	<u>L3 P626</u>	K-7	<u>L1 P271</u>
G-8	<u>L1 P423 L3 P65</u>	K-8	<u>L1 P269 10-410</u>
G-9	<u>L6 P202</u>	K-9	<u>L2 P227 L2 P295 10</u>
G-10	<u>L5 P14 L9 P579</u>	K-10	<u>L2 P225 11-154</u>
G-11	<u>L1 P11 L9 P470</u>	K-11	<u>L3 P498</u>
G-12	<u>L1 P429 L9 P580</u>	K-12	<u>L3 P496</u>
G-13		K-13	<u>L6 P351</u>
H-1	<u>L1 P137 L9 P387</u>	L-1	<u>L3 P537</u>
H-2	<u>L1 P149</u>	L-2	<u>L2 P373</u>
H-3	<u>L3 P550</u>	L-3	<u>L2 P375</u>
H-4	<u>L1 P225</u>	L-4	<u>L5 P251</u>
H-5	<u>L1 P227 L6 P240</u>	L-5	<u>L2 P603</u>
H-6	<u>L3 P13 L6 P368</u>	L-6	<u>L6 P229 L9 P164</u>
H-7	<u>L1 P235</u>	L-7	<u>L5 P296</u>
H-8	<u>L2 P575 L3 P73</u>	L-8	
H-9	<u>L2 P481 L3 P73</u>	L-9	<u>L2 P483</u>
H-10	<u>L7 P123</u>	L-10	<u>L2 P483</u>
H-11	<u>L2 P481 10-385</u>	L-11	<u>L1 P413</u>
H-12	<u>L1 P433 L2 P485</u>	L-12	<u>L4 P207</u>
H-13	<u>L1 P431 L2 P485</u>	L-13	<u>L6 P232</u>
I-1	<u>L1 P139</u>	M-1	<u>L3 P337</u>
I-2	<u>L1 P153</u>	M-2	<u>L5 P257</u>
I-3	<u>L6 P270</u>	M-3	<u>L5 P242</u>
I-4	<u>L3 P299 L9 P446</u>	M-4	<u>L4 P316</u>
I-5	<u>L1 P229 L9 P447</u>	M-5	<u>L5 P301</u>
I-6	<u>L1 P239 10-236</u>	M-6	<u>L4 P67</u>
I-7	<u>L1 P237</u>	M-7	<u>L4 P166</u>
I-8	<u>L3 P257</u>	M-8	<u>L5 P191</u>
I-9	<u>L2 P37 L3 P73</u>	M-9	<u>L5 P136</u>
I-10	<u>L6 P204</u>	M-10	<u>L5 P136</u>
I-11	<u>L6 P169 10-384</u>	M-11	<u>L5 P137 L9 P160</u>
I-12	<u>L6 P203 10-383</u>	M-12	<u>L3 P491</u>
I-13	<u>L2 P301 L6 P351</u>	M-13	<u>L8 P619</u>
J-1	<u>L1 P141</u>		
J-2	<u>L1 P151</u>		
J-3	<u>L1 P95 L1 P159</u>		
J-4	<u>L1 P93 L3 P51</u>		
J-5	<u>L1 P551</u>		
J-6	<u>10-234</u>		
J-7	<u>L1 P557</u>		
J-8			
J-9	<u>L1 P209 L1 P457</u>		
J-10	<u>L1 P211 L1 P453</u>		
J-11	<u>L1 P455 L3 P391</u>		
J-12	<u>L3 P500</u>		
J-13	<u>L6 P350</u>		

INDEX TO PUBLIC LAND SURVEY CORNER RECORDATIONS FILED IN

TOWN 4 NORTH SOUTH, RANGE 1 EAST WEST

TOWNSHIP CORNER NUMBERING CODE DIAGRAM

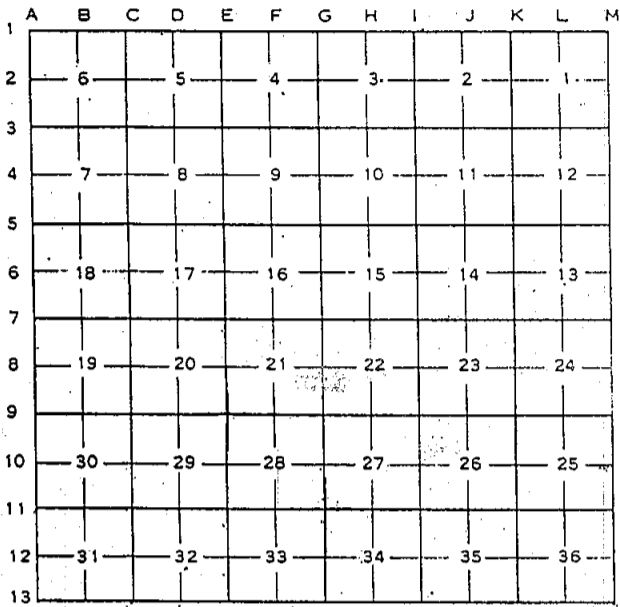

Williamstown Sup - Page 2

CORNER INDEX

CODE NO.	FILING NUMBER	CODE NO.	FILING NUMBER
A-1		D-1	10-279
A-2		D-2	
A-3		D-3	10-283
A-4		D-4	
A-5		D-5	10-277
A-6		D-6	
A-7		D-7	
A-8		D-8	
A-9		D-9	
A-10		D-10	
A-11		D-11	
A-12		D-12	
A-13		D-13	
B-1		E-1	
B-2		E-2	
B-3		E-3	
B-4		E-4	L7P139
B-5		E-5	L8P374 L9P564
B-6		E-6	
B-7		E-7	10-229
B-8		E-8	
B-9		E-9	
B-10		E-10	
B-11		E-11	L8P600
B-12		E-12	L7P193 L8P596
B-13		E-13	L7P194 L8P629
C-1	10-289	F-1	L9P386
C-2	10-291	F-2	
C-3		F-3	L8P376
C-4		F-4	
C-5		F-5	10-230
C-6		F-6	
C-7		F-7	10-232
C-8		F-8	
C-9		F-9	
C-10		F-10	
C-11		F-11	
C-12		F-12	
C-13		F-13	

CODE NO.	FILING NUMBER	CODE NO.	FILING NUMBER
G-1		K-1	
G-2		K-2	
G-3		K-3	
G-4		K-4	
G-5	L8P378	K-5	10-234
G-6		K-6	
G-7		K-7	
G-8		K-8	
G-9		K-9	
G-10		K-10	
G-11		K-11	
G-12		K-12	
G-13		K-13	
H-1		L-1	
H-2		L-2	
H-3		L-3	
H-4		L-4	
H-5		L-5	
H-6		L-6	
H-7		L-7	
H-8		L-8	
H-9		L-9	
H-10		L-10	
H-11		L-11	
H-12	11-134	L-12	
H-13	L5P99 10-396	L-13	
I-1		M-1	
I-2		M-2	
I-3		M-3	
I-4		M-4	
I-5		M-5	
I-6		M-6	
I-7		M-7	
I-8		M-8	
I-9		M-9	
I-10		M-10	
I-11		M-11	
I-12		M-12	
I-13	10-394	M-13	
J-1			
J-2			
J-3			
J-4			
J-5			
J-6			
J-7			
J-8			
J-9	L2P37		
J-10			
J-11			
J-12			
J-13			

# LAND CORNER RECORDATION CERTIFICATE

FILING REQUIREMENT OF ACT 74, MICH. P.A.1970

South 1/4 corner Section 36, Williamston Twp.

FOR CORNERS OF--:	LOCATED IN--:	CORNER CODE NUMBER
1. PUBLIC LAND SURVEY_____ T. <u>4</u> N. <u>1</u> S. <u>1</u> E. <u>W</u>		<u>L-13</u>
2. PROPERTY CONTROLL- ING IN SECTION_____ ,T. _____ N. _____ S. _____ R. _____ E. _____ W. _____		
3. MISCELLANEOUS PROPERTY IN SECTION_____ ,T. _____ N. _____ S. _____ R. _____ E. _____ W. _____		
4. LOT NO. _____ , RECORDED PLAT _____		
5. PRIVATE CLAIMS _____		

LIBER 6 PAGE 232  
FILED

FEB 1 1 16 PM '83  
REGISTER OF DEEDS  
*Paula Johnson*  
INGHAM COUNTY, MICH.

REGISTER OF DEEDS STAMP AND  
FILING NUMBER

I, Larry A. Bryan, do hereby certify that under requirements of P.A. 74, Michigan P.A. of 1970, the corner points mentioned in lines 1 and 2 above were, in a field survey on January 7, 1981, established, re-established, monumented, re-monumented, recovered or restored as expressed below and in conformance with regulations and rules therefore as required in the current manual of survey instructions of the United States Department of the Interior, Bureau of Land Management or by a decree of a court of law. Furthermore, that the corner points mentioned in lines 3, 4 and 5 above were, in a field survey on \_\_\_\_\_, 19\_\_\_\_, found, recovered, restored, established or re-established as expressed below and in conformance with the rules of the Michigan State Board of Registration for Land Surveyors or, by a Decree of a Court of law:

A. Description of original monument and accessories and/or subsequent restoration:

L-13 Original monument and accessories obliterated  
Corner used in assessor's plat No. 4 Village and Township of Williamston

B. Description of corner evidence found and/or method applied in restoring or re-establishing corner:

L-13 Found 1" pipe in concrete on East-West fence line. Monumentation verified by measurments to existing irons according to assessor's plat No. 4

C. Description of monument for corner and accessories established to perpetuate locating the position of the corner:

L-13 South 1/4 corner Section 36, fd., 1" pipe in concrete  
Set 1/2" bar w/cap, North 1/4 corner Section 1, S85°W, 14.86'  
Set nail & tag West side 24" Walnut, N80°E, 27.88'  
Set nail & tag Southwest side power pole, N30°W, 50.20'  
Southeast corner of garage, N40°W, 96.99'

SIGNED BY Larry A. Bryan DATE 1-7-81

SURVEYOR'S MICHIGAN REGISTRATION NO. 25832

FOR STATE AND UNITED STATES AGENCIES:

SIGNED BY \_\_\_\_\_ DATE \_\_\_\_\_

CHIEF OF SURVEY PARTY

APPROVED AND SIGNED BY \_\_\_\_\_ DATE \_\_\_\_\_

MICHIGAN REGISTERED LAND SURVEYOR



SURVEYOR'S MICHIGAN REGISTRATION NO. \_\_\_\_\_

1980

FORM APPROVED BY MICHIGAN STATE BOARD OF REGISTRATION, JAN. 28, 1971  
REVISED MAY 14, 1975

MAY PLACE SKETCH ON BACK OR ATTACHED SHEET

LAND CORNER RECORDATION CERTIFICATE  
Filing Requirement of Act 74, Mich. P.A. 1970

LIBER 6 PAGE 351

For corners in

Ingham

(County)

Located In:

Corner Code ##

FILED

1. Public Land Survey T 4N R 1E I13, K13  
T R  
T R  
T R  
T R
2. Property Controlling S T R  
in Section S T R  
3. Miscellaneous S T R  
Property in Sec. S T R
4. Lot No. , Recorded Plat  
5. Private Claims

Nov 2 10 32 AM '87

REGISTER OF DEEDS

Paula Johnson

INGHAM COUNTY, MICH.

Register of Deeds Stamp & File Number

I, BRUCE L. FLOYD, in a field survey on October 16, 19 87, do hereby certify that under requirements of P.A. 74, Michigan P.A. of 1970, the corner points mentioned in lines 1 and 2 above were in conformance with regulations and rules therefore as required in the current manual of survey instructions of the United States Department of the Interior, Bureau of Land Management or by a decree of a Court of Law and/or that the corner points mentioned in lines 3, 4 and 5 above were in conformance with the rules of the Michigan Board of Land Surveyors or by a Decree of a Court of Law; established, re-established, monumented, re-monumented, recovered, found as expressed below.

NOTE: Not more than 4 corners, all in the same town and range, may be recorded on this certificate.

A. Description of original monument and accessories and/or subsequent restoration:

I13 - Original monument lost; found 1" iron bar as previously recorded in L2 P301.

K13 - Original monument lost; sewer construction has destroyed all evidence in road.

B. Description of corner evidence found and/or method applied in restoring or reestablishing corner:

I13 - Found 1" bar

K13 - Set 3/4" bar in location fitting monumentation of Owens's third addition to the the village (now, city) of Williamston. Bar is 2' East of centerline of Putnam Street.

C. Description of monument for corner and accessories established to perpetuate locating the position of the corner:

I13 - SW corner Section 35 T4N-R1E  
City of Williamston, Ingham Co. Mi.  
Left 1" bar as found.

K13 - SE corner Section 35 T4N-R1E  
City of Williamston, Ingham Co. Mi.  
Left 3/4" bar as set in Putnam Street.

WITNESSES:

Nail & Tag in N. side 20" hickory East 11.58'  
Nail & Tag in E. side 24" maple S15°W 48.35'  
NW corner stone porch, house #3454 S20°E 33.01'  
3/4" rerod, property iron West 32.78'  
1/2" rerod, NW cor Sec 2 T3N-R1E West 65.88'

WITNESSES:

1/2" rerod NE cor. Sec. 2 T3N-R1E N89° 16'36"W 29.23'  
Property iron N89°16'36"W 37.02'  
Property iron S89°16'36"E 32.15'  
N & T in S. side power pole N77°54'17"E 20.36'  
N & T in S. side power pole N83°25'55"W 29.22'  
N & T in N. side 36" maple S72°00'19"E 38.10'

Signed by Bruce L. Floyd  
Surveyor's Michigan License No. 28068

October 19, 1987

FORM APPROVED BY MICHIGAN STATE BOARD OF LAND SURVEYORS, JAN. 23, 1971  
REVISED MAY 14, 1975  
REVISED JAN., 1983

2098

LAND CORNER RECORDATION CERTIFICATE  
Filing Requirement of Act 74, Mich. P.A. 1970

For corners in  
Ingham  
(County)

Located In:

Corner Code: #

- |                         |                         |      |
|-------------------------|-------------------------|------|
| 1. Public Land Survey   | T <u>4N</u> R <u>1E</u> | M-13 |
|                         | T _____ R _____         |      |
|                         | T _____ R _____         |      |
|                         | T _____ R _____         |      |
| 2. Property Controlling | S _____ T _____ R _____ |      |
| in Section              | S _____ T _____ R _____ |      |
| 3. Miscellaneous        | S _____ T _____ R _____ |      |
| Property in Sec.        | S _____ T _____ R _____ |      |

**FILED**  
07/01/1996 14:50:33  
REGISTER OF DEEDS  
Paula Johnson  
INGHAM COUNTY, MI

Register of Deeds Stamp & File Number

4. Lot No. \_\_\_\_\_, Recorded Plat \_\_\_\_\_  
5. Private Claims \_\_\_\_\_

	A	B	C	D	E	F	G	H	I	J	K	L	M
2	6	5	4	3	2	1							
3													
4	7	8	9	10	11	12							
5													
6	18	17	16	15	14	13							
7													
8	19	20	21	22	23	24							
9													
10	30	29	28	27	26	25							
11													
12	31	32	33	34	35	36							
13													

Larry A. Bryan, in a field survey on June 6, 19 96  
do hereby certify that under requirements of P.A. 74, Michigan P.A. of 1970, the corner points mentioned in lines 1 and 2 above were in conformance with regulations and rules therefore as required in the current manual of survey instructions of the United States Department of the Interior, Bureau of Land Management or by a decree of a Court of Law and/or that the corner points mentioned in lines 3, 4 and 5 above were in conformance with the rules of the Michigan Board of Land Surveyors or by a Decree of a Court of Law, established, re-established, monumented, re-monumented, recovered, found as expressed below:

**NOTE:** Not more than 4 corners, all in the same town and range, may be recorded on this certificate.

A. Description of original monument and accessories and/or subsequent restoration:

1. Post set in original government survey by J. Wampler, February 17, 1824
2. Survey by A. Jackson, County Surveyor, January 20, 1847, lists the following witnesses: Maple 10 S66E 150, and Willow 5 N42W 5.
3. Survey by George M. Young, July 1, 1981, (Liber 4, Page 417) states that the corner is inaccessible but lists the following witnesses: P.K. Nail, N88°26'39"W 1736.59'; Nail & tag, P.P., N20°W, 45.38'; Nail & tag, 12" Poplar, S20°W, 54.20'; and Nail & tag, 24" Poplar, South 60.78'.
4. Survey by George M. Young, September 4, 1981, (Liber 4, Page 423) shows the same description and witnesses as item 3.

B. Description of corner evidence found and/or method applied in restoring or reestablishing corner:

Corner falls in swamp, found no evidence of previous corners.  
Set 3/4" pipe, 5' in length, with cap # 25832, by double proportional measurements to L-13, T4N, R1E; M-12, T4N, R1E; M-2, T3N, R1E; and C-13, T4N, R2E; all distance in close accord with G.L.O. measurements. Note: B-13, T4N, R2E was not used in proration due to inconsistencies with G.L.O. measurements (71' short to L-13, T4N, R1E; and 68' long to C-13, T4N, R2E), a lack of any remaining evidence at corner location (corner is in Glen Dor Subdivision, with no occupational or deed evidence along section lines), and a lack of information on how the section corner shown on Glen Dor Subdivision was established.  
Dist to L-13, T4N, R1E, 2636.39' Dist to M-12, T4N, R1E, 2645.71'  
Dist to M-2, T3N, R1E, 2230.55' Dist to C-13, T4N, R2E, 3893.57'

C. Description of monument for corner and accessories established to perpetuate locating the position of the corner:

Set 3/4" pipe, 5' in length, with cap # 25832 in swamp.  
Set nail & tag 25832 in West side of 8" Maple, N80°E, 39.25'  
Set nail & tag 25832 in East side of 24" Willow, N80°W, 70.24'  
Set nail & tag 25832 in South side of utility pole, S80°W, 96.66'  
Set nail & tag 25832 in West side of 8" Poplar, S30°W, 81.49'

Signed by Larry A. Bryan Date 6-20-96  
Surveyor's Michigan License No. 25832

FORM APPROVED BY MICHIGAN STATE BOARD OF LAND SURVEYORS  
RECEIVED MAY 17 1996  
CELESTINE 1983

