

LAND CORNER RECORDATION CERTIFICATE
Filing Requirement of Act 74, Mich. P.A. 1970

For corners in
WHEATFIELD TOWNSHIP
INGHAM COUNTY

Located in: Corner Code #

1. Public Land Survey

T 3N R 1E I-1

T
T
T
T
S
S
S
S
T
T
T
T
R
R
R
R
R
R
R
R
R
R
R
R

Paula Johnson
INGHAM COUNTY
REGISTER OF DEEDS

L-10 P-386

RECORDED CRNR 11.00

2002-083095

2002-083095

Page: 1 of 2

12/26/2002 03:35P

Register of Deeds Stamp & File Number

4. Lot No. _____, Recorded Plat _____

5. Private Claims _____

I, Scott E. Koch, in a field survey on April 15, 2002 do hereby state that under requirements of P.A. 74, Michigan P.A. of 1970, the corner points mentioned in lines 1 and 2 above were in conformance with regulations and rules therefore as required in the current manual of survey instructions of the United States Department of the Interior, Bureau of Land Management or by decree of a Court of Law and/or that the corner points mentioned in lines 3, 4 and 5 above were in conformance with the rules of the Michigan Board of Land Surveyors or by a Degree of a Court of Law; established, re-established, monumented, recovered, found as expressed below:

NOTE: Not more than 2 corners, all in the same town and range, may be recorded on this certificate.

A. Description of original monument and accessories and/or subsequent restoration:

March, 1826 - G.L.O., Joseph Wampler, Deputy Surveyor, (Page 40) North between Sec. 2 & 3, intersected North boundary 100 lks West of post, Set post, 74.18 chs. (4895.88 feet)

Beech 20 in. dia. S35°W, 35 lks. (23.10 feet)
Beech 11 in. dia. S36°E, 44 lks. (29.04 feet)

January 20, 1847 - County Surveyor Notes (Pages 192-193), A. Jackson, does not describe monument

Beech 20 in. dia. S35°W, 35 lks. (23.10 feet)
Beech 11 in. dia. S36°E, 44 lks. (29.04 feet)

May 3, 1876 - County Surveyor Notes (Pages 137-138), T. J. Brown, calls for a post, no witnesses given.

December 19, 1973 - PA 74 (Liber 3, Page 29) James A. Porter, PS #19003, Found 5/8" iron.

Railroad crossing sign, NNE, 11.45 feet
Nail in Power Pole, SSW, 12.00 feet
SW Corner Sec. 35, East 65.88 feet

Continued on Back

B. Description of corner evidence found and/or method applied in restoring or reestablishing corner:

Found 1/2" bar and cap #25832 in a monument box, 8.5 feet West of West side of pavement for Corwin Road. Appears to be a new monument box, and bar set by KEBS Inc. Corwin Road appears to have been reconstructed over the past year. Position matches location monumented by KEBS. Accepted KEBS bar as the best evidence available and replaced with Ingham County Remonumentation cap stamped PS 41103.

C. Description of monument for corner and accessories established to perpetuate locating the position of the corner:

Set Ingham County Remonumentation cap stamped PS 41103 over existing iron in monument box.

Fd. PK nail in West face of Power Pole, N10°W, 14.76'

Section Corner, SW corner Section 35, T4N, R1E, Fd 1 1/2" pipe, East, 65.90'

Found Nail and Tag #25832 in SW side 24" Sugar Maple, S30°E, 70.91'

Fd. Nail and Tag #25832 in East side of 30" Sugar Maple, S20°W, 68.20'



Signed by Scott E. Koch

Date 12/17/02

Surveyor's Michigan License No. 41103

FORM APPROVED BY MICHIGAN STATE BOARD OF PROFESSIONAL SURVEYORS, JAN. 28, 1971
REVISED MAY 14, 1975
REVISED JAN., 1983
REVISED OCT., 1995

P.A. 345 INGHAM COUNTY
PEER APPROVED 11/1/02 M

I-1 Wheatfield Township, Ingham County

October 19, 1987 - PA 74 (Liber 6, Page 349) Bruce L. Floyd, PS #28068, Reset corner from witnesses; 1/2" rerod with cap #28068 in ditch, West side of Corwin Road.

Aluminum corner fence post, S85°W, 23.38'

RR X sign, N05°E, 18.11'

PK nail in power pole, East, 33.05'

1" bar, SW corner Sec. 35, East, 65.88'

January 24, 2002 - PA 74 (Liber 10, Page 220) Jeffrey K. Autenrieth, PS #31588, Corner position recovered on October 24, 2001 prior to reconstruction of Corwin Road. Found 1/2" bar and cap #28068 (Bruce L. Floyd) as recorded in Liber 6 of Corners, Page 349. Also found monumentation from Liber 6 of Corners, Page 244, and from Liber 3 of Corners, Page 29, one to two feet deeper and within 0.20 feet of each other. Offset corner position outside of construction area. Returned on November 2, 2001, and reset 1/2" bar with "KEBS" cap in a monument box from offset witnesses set prior to reconstruction.

Set "KEBS" Nail & Tag in East side 30" Maple, S20°W, 69.36 feet

Set "KEBS" Nail & Tag in Southwest side 24" Maple, S30°E, 70.95 feet

Set "KEBS" Nail & Tag in West side Utility Pole, N35°E, 97.65 feet

Found Nail & Tag #30897 in North side Utility Pole, S65°W, 113.08 feet

1" Bar, Southwest Corner Section 35, Williamstown Township, East 65.88 feet

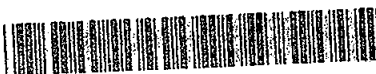

2002-083095
Page: 2 of 2
12/26/2002 03:35P

LAND CORNER RECORDATION CERTIFICATE
Filing Requirement of Act 74, Mich. P.A. 1970

For corners in
WHEATFIELD TOWNSHIP
INGHAM COUNTY

Located In:

Corner Code #

1. Public Land Survey

T 3N R 1E

I-2

2. Property Controlling
In Section

S

T

R

3. Miscellaneous
Property in Sec.

S

T

R

S

T

R

Paula Johnson
INGHAM COUNTY
REGISTER OF DEEDS

RECORDED

L-10 P-382

CRNR 9.00

2002-083091

2002-083091

Page: 1 of 1

12/26/2002 03:35P

Register of Deeds Stamp & File Number

4. Lot No. _____, Recorded Plat _____

5. Private Claims _____

I, Scott E. Koch, in a field survey on April 16, 2002 do hereby state that under requirements of P.A. 74, Michigan P.A. of 1970, the corner points mentioned in lines 1 and 2 above were in conformance with regulations and rules therefore as required in the current manual of survey instructions of the United States Department of the Interior, Bureau of Land Management or by decree of a Court of Law and/or that the corner points mentioned in lines 3, 4 and 5 above were in conformance with the rules of the Michigan Board of Land Surveyors or by a Degree of a Court of Law; established, re-established, monumented, recovered, found as expressed below:

NOTE: Not more than 2 corners, all in the same town and range, may be recorded on this certificate.

A. Description of original monument and accessories and/or subsequent restoration:

March, 1826 - G.L.O., Joseph Wampler, Deputy Surveyor, (Page 40) North between Sec. 2 & 3, Set 1/4 sec. post, 40 chs. (2640 feet)
Beech 12 in. dia. N07°W, 8 lks. (5.28 feet)
Beech 10 in. dia. N63°E, 30 lks. (19.80 feet)

January 20, 1847 - County Surveyor Notes (Pages 192-193), A. Jackson, does not describe monument
Beech 12 in. dia. N07°W, 8 lks. (5.28 feet)
Beech 10 in. dia. N63°E, 30 lks. (19.80 feet)

May 3, 1876 - County Surveyor Notes (Pages 137-138), T. J. Brown, calls for a post, no witnesses given.

January 1, 1969 - Ingham County Road Commission Township Map, calls for a pipe, with fence West, 30.00 feet.

March 27, 1969 - MDSHT Government Monument Witness Card Form 280 calls for a 3/4" iron, no witnesses given.

June 6, 1979 - PA 74 (Liber 5, Page 247) Ronnie M. Lester, PS #18998,
Excavated a hole 4.2' x 5.5' to an average depth of 3.0' on the centerline of Corwin Road and on fence lines to the East and West. Found a 3/4" pipe 0.8' below road surface on the centerline of Corwin Road and on line with power poles to the East and West. Measured North approx. 2240' to I-1 and South approx. 2650' to I-3 both measurements in close accord with G.L.O. distances. Accepted 3/4" iron pipe for corner as called for by Government Monument Witness Form 280 and in the records of the Ingham County Road Commission. Set 4" x 36" concrete Monument.

Found Nail & Tag, Stephens Engineering, S. Side P. Pole, East, 25.78'
Found Nail & Tag, Stephens Engineering, N. Side P. Pole, WNW, 28.62'
Nail & Tag, #18998, NW side 4" Elm, NE, 47.17'
Nail & Tag, #18998, SW side 4" Cherry, SE, 42.31'

B. Description of corner evidence found and/or method applied in restoring or reestablishing corner:

Found 1/2" bar in concrete as called for on PA 74 recorded in Liber 5, Page 247. Monument lies approx. 3' West of centerline of Corwin Road. according to PA 74 recorded in Liber 5, Page 247 monument measures in accord with G.L.O. Set Ingham County Remonumentation cap stamped 41103 on found 1/2" bar in concrete. Accepted iron in concrete as the best available evidence of the position of original corner.

C. Description of monument for corner and accessories established to perpetuate locating the position of the corner:
Set Ingham County Remonumentation Aluminum cap stamped PS 411 on 1/2" bar in concrete.

Found Nail & Tag #25832 in 6" Elm, N30°E, 60.91'
Found Nail & Tag #25832 in North face of Power Pole, East, 26.08'
Found Nail & Tag in NE face of wood fence post, N83°W, 30.40'
Found Nail & Tag #25832 in North face of Power Pole, N89°W, 28.32'

Signed by

Date 12/17/02

Surveyor's Michigan License No. 41103

FORM APPROVED BY MICHIGAN STATE BOARD OF PROFESSIONAL SURVEYORS, JAN. 28, 1971
REVISED MAY 14, 1975
REVISED JAN., 1983
REVISED OCT., 1995



P.A. 345 INGHAM COUNTY
PEER APPROVED 12/04/2002

LAND CORNER RECORDATION CERTIFICATE
Filing Requirement of Act 74, Mich. P.A. 1970

For corners in
WHEATFIELD TOWNSHIP
INGHAM COUNTY

Located In:

Corner Code #

1. Public Land Survey

T 3N R 1E I-3

Paula Johnson
INGHAM COUNTY
REGISTER OF DEEDS

2. Property Controlling
In Section

S T R

3. Miscellaneous
Property in Sec.

S T R

RECORDED L-10 P-381

CRNR 9.00

2002-083090

Page: 1 of 1

12/26/2002 03:35P

Register of Deeds Stamp & File Number

4. Lot No. _____ Recorded Plat _____
5. Private Claims _____

I, Scott E. Koch, in a field survey on April 15, 2002 do hereby state that under requirements of P.A. 74, Michigan P.A. of 1970, the corner points mentioned in lines 1 and 2 above were in conformance with regulations and rules therefore as required in the current manual of survey instructions of the United States Department of the Interior, Bureau of Land Management or by decree of a Court of Law and/or that the corner points mentioned in lines 3, 4 and 5 above were in conformance with the rules of the Michigan Board of Land Surveyors or by a Decree of a Court of Law; established, re-established, monumented, recovered, found as expressed below:

NOTE: Not more than 2 corners, all in the same town and range, may be recorded on this certificate.

A. Description of original monument and accessories and/or subsequent restoration:

March, 1826 - G.L.O., Joseph Wampler, Deputy Surveyor, (Page 38) North between Sec. 10 & 11, set post cor for secs. 2, 3, 10 & 11
Beech 18 in. dia. S61.5°E, 18 lks. (11.88 feet)
Ironwood 6 in. dia. S39.5°W, 23 lks. (15.18 feet)

January 20, 1847 - County Surveyor Notes (Pages 192-193), A. Jackson, does not describe monument
Beech 18 in. dia. S61.5°E, 18 lks. (11.88 feet)
Ironwood 6 in. dia. S39.5°W, 23 lks. (15.18 feet)

May 3, 1876 - County Surveyor Notes (Pages 137-138), T. J. Brown, calls for a post
Elm 22 in. dia. N29°W, 107.75 lks. (71.11 feet)

November 29, 1978 - PA 74 (Liber 5, Page 79) Ronnie M. Lester, PS #18998,
Excavated a hole 15.5' x 10.1' to an average depth of 4.3' on the centerline of Linn Road, East of the centerline of Corwin Road and on fence line to the South. Found boat spike 0.5' below surface. Found 1/2" iron rod 0.9' below surface, directly beneath found boat spike, approx. 1.0' South of centerline of Linn Road, approx 10.0' East of centerline of Corwin Road, and on fence line to the South. Accepted boat spike and 1/2" iron rod as corner. Two witnesses remain as shown in Stephens survey records dated 1969, both in close accord with monumentation found.
Set 4" x 36" concrete monument with 1/2" x 38" rebar and cap #18998, with concrete collar and cover at location of boat spike and 1/2" iron rod described above.
East centerline 4" steel Anchor post, 1' above ground, South, 29.91'
South centerline 4" steel Anchor post, 0.6' above ground, NW, 60.19'
Found Nail & Tag, Stephens Engineering, West side P. Pole, NE, 40.11'
Northwest corner block foundation house #1500, SSE, 114.41'

B. Description of corner evidence found and/or method applied in restoring or reestablishing corner:
Found what was believed to be a 1/2" bar with cap - cap number was destroyed; dug through 4" of asphalt; 3" of concrete with wire mesh and 2" of fine coarse gravel to discover that the 1/2" bar is actually a 4" concrete monument. After verifying the location of the monument, an Ingham County Remonumentation disk was fitted over the iron of the monument; and a monument box was put in place centered around the monument. The monument fit in accord with witnesses from LCRC recorded in 1978. Accepted monument as the best available evidence of the position of the original corner.

C. Description of monument for corner and accessories established to perpetuate locating the position of the corner:

Aluminum disk stamped PS 41103 set on 4" concrete monument
East centerline 4" steel Anchor post, 1' above ground, South, 29.91'
South centerline 4" steel Anchor post, 0.6' above ground, N40°W, 60.19'
Found Nail & Tag, Stephens Engineering, West side P. Pole, N45°E, 40.11'
Northwest corner block foundation house #1500, S20°E, 114.41'
NE edge of channel iron fence post, S05°W, 33.30'
S. edge of centerline of metal concrete fence post, N80°W, 67.90'

Signed by Scott E. Koch

Date 12/17/02

Surveyor's Michigan License No. 41103

FORM APPROVED BY MICHIGAN STATE BOARD OF PROFESSIONAL SURVEYORS, JAN. 28, 1971
REVISED MAY 14, 1975
REVISED JAN., 1983
REVISED OCT., 1995



P.A. 345 INGHAM COUNTY
PEER APPROVED 6/04/02

LAND CORNER RECORDATION CERTIFICATE
Filing Requirement of Act 74, Mich. P.A. 1970

For corners in

INGHAM

(County)

Located In:

Corner Code #

WHEATFIELD TOWNSHIP.

1. Public Land Survey

T 3N R 1E

J-1

T R

T R

T R

T R

2. Property Controlling
in Section

S T R

S T R

3. Miscellaneous
Property in Sec.

S T R

S T R

4. Lot No. , Recorded Plat

5. Private Claims

Paula Johnson-
INGHAM COUNTY
REGISTER OF DEEDS
OFFICIAL SEAL



L-11 P-315

CRNR 14.00

2004-072990

Register of Deeds Stamp & File Number

	A	B	C	D	E	F	G	H	I	J	K	L	M
1													
2	6		5		4		3		2		1		
3													
4	7		8		9		10		11		12		
5													
6	18		17		16		15		14		13		
7													
8	19		20		21		22		23		24		
9													
10	30		29		28		27		26		25		
11													
12	31		32		33		34		35		36		
13													

I, ANTHONY BUMSTEAD, P.S., in a field survey on 4/13 & 4/15, 2004

do hereby certify that under requirements of P.A. 74, Michigan P.A. of 1970, the corner points mentioned in lines 1 and 2 above were in conformance with regulations and rules therefore as required in the current manual of survey instructions of the United States Department of the Interior, Bureau of Land Management or by a decree of a Court of Law and/or that the corner points mentioned in lines 3, 4 and 5 above were in conformance with the rules of the Michigan Board of Land Surveyors or by a Decree of a Court of Law; established, re-established, monumented, re-monumented, recovered, found as expressed below:

NOTE: Not more than 2 corners, all in the same town and range, may be recorded on this certificate.

A. Description of original monument and accessories and/or subsequent restoration:

1) CORNER NOT SET IN ORIGINAL GOVERNMENT SURVEY.

2) CORNER NOT REFERENCED IN RECORDS OF COUNTY SURVEYOR.

3) CORNER MAY BE REFERENCED IN SURVEY BY J. McCREARY, COUNTY SURVEYOR, DATED 1893, AND RECORDED IN FOLDER 1, PAGE 5. "SURVEY FOR A PLAT FOR OWEN ESTATES." NO MENTION OF MONUMENT. WITNESSED BY: BEECH 18", S 14° W, 94-3/4 LKS. (83.49')
"12-1/2 LINKS NORTH OF FENCE, 6.10 CH. N. OF R.R. R/W."
NOTE: THIS MAY BE INFORMATION FOR J-13, T4N, R1E??

4) NO OTHER REFERENCES FOUND.

B. Description of corner evidence found and/or method applied in restoring or reestablishing corner:

SEARCHED AT APPARENT LOCATION OF CORNER 48' WEST OF RECORDED J-13, T4N, R1E AND FOUND NO EVIDENCE OF ANY CORNER OR OCCUPATION TO SOUTH. CORNER FALLS IN APPLE ORCHARD SOUTH OF HOUSE #605. TRAVERSED TOWNSHIP LINE FROM I-1 EAST TO K-1 AND SET CORNER MIDWAY BETWEEN I-1 AND K-1 AND ON STANDARD LINE. SET STANDARD INGHAM COUNTY 3/4" X 24" REMON. BAR & PA 345 CAP #41095 AT CALCULATED POSITION 47.89' WEST OF J-13. MEASURED EAST AND WEST 2671.81'.

C. Description of monument for corner and accessories established to perpetuate locating the position of the corner:

J-1, T3N, R1, WHEATFIELD TOWNSHIP, INGHAM COUNTY. SET STANDARD INGHAM COUNTY 3/4" X 24" REMON. BAR & PA 345 CAP #41095 MIDWAY AND ON STANDARD LINE. WITNESSED BY:

SET N&T #30090, S/S 20" APPLE,

SET N/T #30090, W/S 20" APPLE,

SET N&T #30090, NW/S 18" APPLE,

SET N/T #30090, SW/S 16" APPLE,

FD. 1/2" BAR/CAP #28068 (BRUCE FLOYD), J-13-T4N,R1E,

SOUTHEAST CORNER HOUSE #605,

N 60 E, 22.82'

S 17 E, 45.83'

N 50 W, 16.35'

N 40 W, 18.68'

DUE EAST, 47.89'

N 16 E, 187.3'+/-



2004-072990

Page: 1 of 1

12/01/2004 08:17 A

Signed by

Anthony Bumstead

Date

AUGUST 4, 2004

Surveyor's Michigan License No.

41095



FORM APPROVED BY MICHIGAN STATE BOARD OF LAND SURVEYORS, JAN. 28, 1971

REVISED MAY 14, 1975

REVISED JAN., 1983

REVISED OCT, 1995

ADAPTED FOR WORD PROCESSING JAN, 1999

P.A. 345 INGHAM COUNTY

PEER APPROVED 2/13/2004 *AL*

LAND CORNER RECORDATION CERTIFICATE

Filing Requirement of Act 74, Mich. P.A. 1970

For corners in

INGHAM

(County)

Located In:

Corner Code #

WHEATFIELD TOWNSHIP.

1. Public Land Survey

T 3N R 1E

J-2

2. Property Controlling in Section

S

T

R

3. Miscellaneous Property in Sec.

S

T

R

4. Lot No. Recorded Plat

5. Private Claims

Paula Johnson-
INGHAM COUNTY
REGISTER OF DEEDS
OFFICIAL SEAL



L-11 P-301

CRNR 17.00

2004-072983

Register of Deeds Stamp & File Number

	A	B	C	D	E	F	G	H	I	J	K	L	M
1													
2	6	5	4	3									
3													
4	7	8	9	10	11	12							
5													
6	18	17	16	15	14	13							
7													
8	19	20	21	22	23	24							
9													
10	30	29	28	27	26	25							
11													
12	31	32	33	34	35	36							
13													

I, ANTHONY BUMSTEAD, in a field survey on SEPTEMBER 21, 2004,

do hereby certify that under requirements of P.A. 74, Michigan P.A. of 1970, the corner points mentioned in lines 1 and 2 above were in conformance with regulations and rules therefore as required in the current manual of survey instructions of the United States Department of the Interior, Bureau of Land Management or by a decree of a Court of Law and/or that the corner points mentioned in lines 3, 4 and 5 above were in conformance with the rules of the Michigan Board of Land Surveyors or by a Decree of a Court of Law; established, re-established, monumented, re-monumented, recovered, found as expressed below:

NOTE: Not more than 2 corners, all in the same town and range, may be recorded on this certificate.

A. Description of original monument and accessories and/or subsequent restoration:

- CORNER NOT SET IN ORIGINAL GOVERNMENT SURVEY.
- CORNER REFERENCED IN SURVEY BY UNKNOWN COUNTY SURVEYOR, DATED 1844-1845 AND RECORDED IN BOOK 4, PAGE 156. NO MENTION OF MONUMENT. WITNESSED BY:

ELM 9", N 6 E, 27-1/2 LKS. (18.15')

B. ASH, 6", N 68-3/4 E, 28 LKS. (18.48')

SURVEY SHOWS DISTANCES EAST OF 1637 RODS, 22 LKS. (2704.02').

- CORNER REFERENCED IN FOLLOWING SURVEYS BY DAVID L. CLIFFORD, RLS #25837: RECORDED IN LIBER 4, PAGE 521, DATED 02/18/82: RECORDED IN LIBER 4, PAGE 522, DATED 02/18/82:

"WITNESSES TO CENTER OF SECTION 2, T3N, R1E.

SURVEY TAGS IN:" 24" OAK - WSW, 29.71'

8" POPLAR - ESE, 31.32'

6" SOFT MAPLE - SSE, 28.08'

8" POPLAR - NORTH, 14.32'

SURVEYS SHOWS A DISTANCE EAST OF 2659.12'.



2004-072983

Page: 1 of 2

12/01/2004 08:17 A

CONTINUED ON PAGE 2

B. Description of corner evidence found and/or method applied in restoring or reestablishing corner:

SEARCHED AT APPARENT LOCATION OF CORNER AND FOUND 1/2" REBAR, (NO CAP) ON EAST-WEST FENCE, AND REMAINS OF ANCIENT FENCE TO SOUTH. TRAVERSED SECTION TWO AND FOUND REBAR TO BE 0.95' NORTH AND 24.86' EAST OF INTERSECTION OF THE 1/4 LINES. IT IS POSSIBLE THIS LOCATION WAS SET USING J-13, T4N, R1E, WHICH IS 47.89' EAST OF J-1, TO INTERSECT THE 1/4 LINES. EXAMINATION OF THE COUNTY SURVEYOR NOTES HOWEVER (ITEM A-2 ABOVE), INDICATES THE CORNER WAS FOUND AS THERE ARE NO WITNESSES OR MEASURED VALUES TO NORTH OR WEST 1/4 CORNERS OF SECTION 2 (WHICH WOULD INDICATE HE SET THE POSITION AT THE INTERSECTION OF THE 1/4 LINES). SEARCHED AREA ±25' WEST OF BAR AND FOUND NO EVIDENCE OF CORNER OR OCCUPATION. ALSO SEARCHED ±46' WEST OF BAR WHICH IS THE DISTANCE SHOWN ON THE COUNTY SURVEY AND FOUND NOTHING. THERE IS NOT ENOUGH INFORMATION ON THE COUNTY SURVEY TO COMPARE MEASURED VALUES TO. ACCEPTED POSITION OF FOUND REBAR AS IT APPEARS TO BE COUNTY SURVEYOR POSITION OF FOUND CORNER AND USED BY MANY SURVEYORS AS CORRECT LOCATION FOR J-2. SET STANDARD INGHAM COUNTY 3/4" X 24" REMON. BAR & PA 345 CAP #41095 AT LOCATION OF FOUND REBAR.

C. Description of monument for corner and accessories established to perpetuate locating the position of the corner:

J-2, T3N, R1, WHEATFIELD TOWNSHIP, INGHAM COUNTY. SET STANDARD INGHAM COUNTY 3/4" X 24" REMON. BAR & PA 345 CAP #41095 AT LOCATION OF FOUND REBAR. WITNESSED BY:

FD. nail & tag #30090 (Dave Lohr), South side 14" POPLAR, S 68 E, 25.05'

FD. nail & tag #28414, West side 12" OAK, S 26 W, 5.30'

FD. nail & tag #39100, North side 30" OAK, S 83 W, 30.00'

FD. nail & tag #28414, South side 10" POPLAR, WEST, 3.43'

FD. nail & tag #30090, East side 16" POPLAR, N 00 W, 13.54'

P.A. 345 INGHAM COUNTY
PEER APPROVED 10/12/2004

Signed by

Surveyor's Michigan License No. 41095

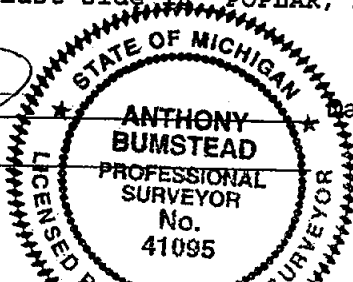

Date October 11, 2004

J-2, T3N, R1E, WHEATFIELD TOWNSHIP, INGHAM COUNTY. PART A - CONTINUED - PAGE 2:

- 4) CORNER REFERENCED IN FOLLOWING UNRECORDED SURVEYS BY MARVIN F. FOUTY, LLS #18989.
JOB NO. B-1065, DATED 09/25/95:
JOB NO. B-1070, DATED 11/03/95:
AS "FND. BAR & CAP #28537." NO WITNESSES GIVEN. SURVEYS SHOW A DISTANCE SOUTH OF 2643.59' AND EAST OF 2658.64'.
- 5) CORNER REFERENCED IN FOLLOWING RECORDED SURVEY BY MAURICE H. MAHIEU, LLS #28414:
RECORDED IN LIBER 7, PAGE 764, DATED 03/22/96:
"CENTER OF SECTION 2, T3N, R1E, CITY OF WILLIAMSTON, INGHAM COUNTY, MICHIGAN." NO MENTION OF MONUMENT OR WITNESSES GIVEN, NO DISTANCES TO ADJACENT SECTION CORNERS SHOWN.
- 6) CORNER REFERENCED IN FOLLOWING UNRECORDED SURVEYS (24" X 36" DRAWINGS) BY LARRY A. BRYAN, LLS #25832:
JOB NO. 96-T-50999, DATED 03/04/96:
JOB NO. 96-B-50913, DATED 03/04/96:
"CENTER OF SECTION 2, T3N, R1E, LIBER 4 OF SURVEYS, PAGE 523. FOUND 1/2" BAR & CAP #25837 ON EAST-WEST FENCE LINE." WITNESSED BY:
FOUND NAIL & TAG NORTH SIDE 12" ELM, SOUTH, 5.21'
FOUND NAIL & TAG NORTH SIDE 12" ELM, S 50 W, 5.35'
FOUND NAIL & TAG SOUTH SIDE 10" ELM, WEST, 3.44'
SET NAIL & TAG SOUTH SIDE 12" POPLAR, EAST, 25.10'
SURVEYS SHOW A DISTANCE SOUTH OF 2643.13' AND WEST OF 2682.43'.
- 7) CORNER REFERENCED IN LCRC BY TERRY L. WIEGMAN, LS #39100, DATED 12/09/99 AND RECORDED IN LIBER 9, PAGE 563.
PART B STATES: "FOUND 1/2" REBAR AT INTERSECTION OF FENCE LINES E,W,N, &S. SURVEYOR CLIFFORD WITNESSED THIS CORNER IN LIBER 4 OF SURVEYS, PAGES 522 & 523 AS FOLLOWS; SURVEY TAGS IN 24" OAK - WSW, 29.71'
8" POPLAR - ESE, 31.32'
6" SOFT MAPLE - SSE, 28.08'
8" POPLAR - NORTH, 14.32'
ALSO FOUND CORNER IN ACCORD WITH SURVEYOR FOUTY PROJ. NO. B1070 (FOUTY CALLS FOR BAR & CAP 28537), ALSO FOUND CORNER IN ACCORD WITH SURVEYOR MAHIEU RECORDED SURVEY IN LIBER 7, PAGES 764 & 765.
PART C STATES: "1/2" REBAR AT INTERSECTION OF FENCE LINES E,W,N, &S WITNESSED AS FOLLOWS:
N&T TAG (28414) IN WEST SIDE 10" DEAD OAK - SOUTH, 5.21'
N&T TAG (28414) IN SOUTH SIDE 10" MAPLE - WEST, 3.46'
N&T TAG (39100) IN NORTH SIDE 24" OAK - S 85 W, 29.71'
N&T TAG (25832) IN SOUTH SIDE 10" POPLAR - S 85 E, 25.05'
N&T TAG (28414) IN NE SIDE 12" POPLAR - N 5 W, 14.34'
- 8) CORNER REFERENCED IN FOLLOWING PLATS BY TERRY L. WIEGMAN, LS #39100:
PLYMOUTH LANDING, DATED 10/10/99 AND RECORDED IN LIBER 53, PAGE 34-36.
PLYMOUTH LANDING NO. 2, DATED 03/05/01 AND RECORDED IN LIBER 54, PAGE 32-33.
"CENTER OF SECTION 2, T3N, R1E, LIBER 9, PAGE 563.
NO MENTION OF MONUMENT OR WITNESSES GIVEN. PLATS SHOW A DISTANCE EAST OF 2658.24'.
- 9) NO OTHER REFERENCES FOUND.



2004-072983

Page: 2 of 2

12/01/2004 08:17 A

LAND CORNER RECORDATION CERTIFICATE

Filing Requirement of Act 74, Mich. P.A. 1970

or corners in
INGHAM
(County)

Located In:

Corner Code #

HEATFIELD TOWNSHIP.

1. Public Land Survey

T 3N R 1E

J-3

T R

T R

T R

S T R

S T R

S T R

S T R

Property Controlling
In Section

Miscellaneous

Property In Sec.

Lot No.

Recorded Plat

Private Claims

Paula Johnson-
INGHAM COUNTY
REGISTER OF DEEDS
OFFICIAL SEAL



L-11 P-313

CRNR 17.00

2004-072989

Register of Deeds Stamp & File Number

	A	B	C	D	E	F	G	H	I	J	K	L	M
1													
2	6		5		4		3		2		1		
3													
4	7		8		9		10		11		12		
5													
6	18		17		16		15		14		13		
7													
8	19		20		21		22		23		24		
9													
10	30		29		28		27		26		25		
11													
12	31		32		33		34		35		36		
13													

ANTHONY BUMSTEAD, P.S., in a field survey on **APRIL 13, 2004**, hereby certify that under requirements of P.A. 74, Michigan P.A. of 1970, the corner points mentioned in lines 1 and 2 above were in conformance with regulations and rules therefore as required in the current manual of survey instructions of the United States Department of the Interior, Bureau of Land Management or by a decree of a Court of Law and/or that the corner points mentioned in lines 3, 4 and 5 above were in conformance with the rules of the Michigan Board of Land Surveyors or by a Decree of a Court of Law; established, re-established, monumented, re-monumented, recovered, found as expressed below:

NOTE: Not more than 2 corners, all in the same town and range, may be recorded on this certificate.

Description of original monument and accessories and/or subsequent restoration:

1) CORNER SET BY J. WAMPLER, DEP. SURVEYOR IN FEB. 1826.

"SET 1/4 SEC. POST AT AVER. DIST." WITNESSED BY:

BEECH, 18", N 46-1/2° W, 9-1/2 LKS. (59.57')

DO, 15", S 1/2° W, 18 LKS. (11.88')

NOTES SHOW A DISTANCE EAST AND WEST OF 40.30 CH. (2659.80').

2) CORNER REFERENCED IN SURVEY BY UNKNOWN COUNTY SURVEYOR, DATED 1844-1845 AND RECORDED IN BOOK 4, PAGE 156. NO MENTION OF MONUMENT, SAME WITNESSES AS ITEM A-1 ABOVE. SURVEY SHOWS NO DISTANCES AT ADJACENT SECTION CORNERS.

3) CORNER REFERENCED IN UNRECORDED SURVEY BY CLYDE K. STEPHENS, DATED 3/18/68, JOB NO. L-11551A. NO MENTION OF MONUMENT OR WITNESSES GIVEN. SURVEY SHOWS AN IRON STAKE 33.00' NORTH OF CORNER. WITNESS FORM FROM STEPHENS ENG. SHOWS "IRON ROD FOUND 3/6/68 AND REPLACED FROM THE REMAINING WITNESSES, MARCH 1969." WITNESSED BY:

NORTH, 27.92', POWER POLE (E. SIDE)

NE, 107.16', POWER POLE (S. SIDE)

SOUTH, 31.82', POWER POLE (W. SIDE)

CONTINUED ON PAGE 2:

Description of corner evidence found and/or method applied in restoring or reestablishing corner:

SEARCHED AT APPARENT LOCATION OF CORNER AND FOUND BIT. PATCH AND STRONG MAGNETIC PULL ON C/L OF LINN ROAD AND OCCUPATION LINE NORTH AND SOUTH. EXCAVATED PATCH TO FIND BURIED CONCRETE MONUMENT BOX WITH 1/2" REBAR IN 4" CONCRETE MONUMENT AS PER ITEM A-5 ABOVE.

DID NOT EXCAVATE FURTHER AS THIS CORNER HAD EXTENSIVE EXCAVATION IN 1980.

ACCEPTED POSITION OF FOUND CONCRETE MONUMENT AND SET STANDARD INGHAM COUNTY REMON. PA 345 CAP #41095 ON TOP OF REBAR IN MONUMENT. RAISED MON. BOX TO GRADE WITH RISER RING & COVER.

Description of monument for corner and accessories established to perpetuate locating the position of the corner:
J-3, T3N, R1E, WHEATFIELD TOWNSHIP, INGHAM COUNTY. SET STANDARD INGHAM COUNTY REMON. PA 345 CAP #41095 ON TOP OF FOUND CONCRETE MONUMENT.

FD. NAIL & TAG #25832, SOUTHEAST SIDE 36" MAPLE,

SET NAIL & TAG #30090, WEST SIDE 12" ELM,

FD. 1/2" REBAR & CAP #25832,

FD. NAIL & TAG #25832, EAST SIDE POWER POLE,

FD. NAIL & TAG #16053 (JIM STEPHENS), EAST SIDE POWER POLE,

N 35 E, 44.65'

S 35 E, 53.87'

SOUTH, 32.90'

S 02 W, 31.85'

N 01 W, 28.25'

P.A. 345 INGHAM COUNTY

PEER APPROVED 7/13/2004 *RL*

igned by Anthony Bumstead Date AUGUST 04, 2004

urveyor's Michigan License No. 41095

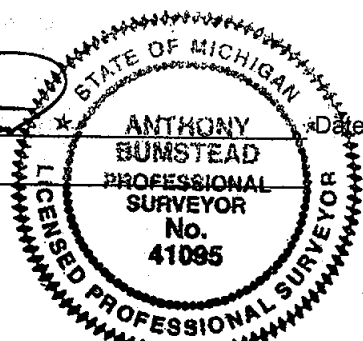

FORM APPROVED BY MICHIGAN STATE BOARD OF LAND SURVEYORS, JAN. 28, 1971

REVISED MAY 14, 1975

REVISED JAN., 1983

REVISED OCT, 1995

ADAPTED FOR WORD PROCESSING JAN, 1999



2004-072989

Page: 1 of 2

12/01/2004 08:17 A

4) CORNER NOT REFERENCED ON THE INGHAM COUNTY ROAD COMMISSION GRID MAP.

5) CORNER REFERENCED IN LCRC BY RONNIE M. LESTER, DATED 7/3/80 AND RECORDED IN LIBER 6, PAGE 123.

PART B STATES: "EXCAVATED A 10' X 10' HOLE TO AN AVERAGE DEPTH OF 3.6' ON THE CENTERLINE OF LINN ROAD, ON FENCE LINE NORTH AND SOUTH. FOUND 1/2" IRON 1/3' BELOW ROAD SURFACE ON CENTERLINE OF LINN ROAD AND FENCE NORTH AND SOUTH. CONDUCTED SECOND EXCAVATION 13.3' WEST FROM PREVIOUS EXCAVATION SITE. EXCAVATED A 10' X 10' HOLE TO AN AVERAGE DEPTH OF 3.6' ON THE CENTERLINE OF LINN ROAD. FOUND NO EVIDENCE OF CORNER. ACCEPTED 1/2" IRON FOUND IN FIRST EXCAVATION AS PERPETUATION OF CORNER. MEASURED WEST TO I-3, 2632.88'. MEASURED EAST TO K-3, 2681.05'. UNEQUAL MEASUREMENTS ALSO REFLECTED IN OLD COUNTY SURVEYORS RECORDS. EXCAVATION CONDUCTED BY INGHAM COUNTY SURVEY AND REMONUMENTATION PROJECT CREW."

PART C STATES: "S 1/4 CORNER, SECTION 2, T3N, R1E, SET 4" X 36" CONCRETE MONUMENT WITH 1/21/2" X 38" REROD AND CAP #18998, WITH CONCRETE COLLAR AND COVER IN LOCATION DESCRIBED ABOVE." WITNESSED BY;

NAIL & TAG, #18998,	SOUTHEAST SIDE 40" MAPLE, NE,	42.96'
NAIL & STEPHENS ENGINEER TAG, EAST SIDE POWER POLE, NORTH,		28.08'
NAIL & STEPHENS ENGINEER TAG, SOUTH SIDE POWER POLE, ENE,		107.15'
NAIL & STEPHENS ENGINEER TAG, WEST SIDE POWER POLE, SOUTH,		31.98'

6) CORNER REFERENCED IN UNRECORDED SURVEY BY LARRY A. BRYAN, RLS #25832, JOB NO.85-B-7494, DATED 10/30/85, AS "FOUND 4" CONCRETE MONUMENT IN CONCRETE COLLAR ON FENCE LINE NORTH & SOUTH, CENTERLINE LINN ROAD, LIBER 6, PAGE 123." SAME WITNESSES AS ITEM A-5 ABOVE. NO DISTANCES TO ADJACENT SECTION CORNERS SHOWN.

7) CORNER REFERENCED IN FOLLOWING UNRECORDED SURVEYS BY MARVIN F. FOUTY, LLS #18989.
JOB NO. B-1065, DATED 09/25/95:
JOB NO. B-1070, DATED 11/03/95:
JOB NO. B-1241, DATED 03/12/97: AS "FND. MON." NO WITNESSES GIVEN. SURVEYS SHOW A DISTANCE NORTH OF 2643.59' AND EAST OF 2681.46'.

8) CORNER REFERENCED IN FOLLOWING UNRECORDED SURVEY BY LARRY A. BRYAN, RLS #25832.
JOB NO. 94-B-46674, DATED 8/19/94: AS "FOUND BAR & CAP IN CENTERLINE OF LINN ROAD ON FENCE LINE NORTH." WITNESSED BY:
FOUND STEPHENS NAIL & TAG, EAST SIDE POWER POLE, NORTH, 28.25'
FOUND STEPHENS NAIL & TAG, WEST SIDE POWER POLE, SOUTH, 31.75'
FOUND STEPHENS NAIL & TAG, SOUTHEAST SIDE POWER POLE, N 70 E, 107.15'
SURVEY SHOWS A DISTANCE EAST OF 2680.84'.

9) CORNER REFERENCED IN FOLLOWING RECORDED SURVEY BY LARRY A. BRYAN, RLS #25832.
JOB NO. 96-B-52559, DATED 10/01/96, RECORDED IN LIBER 7, PAGE 905:
AS "FOUND BAR & CAP IN CENTERLINE OF LINN ROAD ON FENCE LINE NORTH." WITNESSED BY:
FOUND STEPHENS NAIL & TAG, EAST SIDE POWER POLE, NORTH, 28.25'
FOUND STEPHENS NAIL & TAG, WEST SIDE POWER POLE, SOUTH, 31.75'
FOUND STEPHENS NAIL & TAG, SOUTHEAST SIDE POWER POLE, N 70 E, 107.15'
SURVEY SHOWS A DISTANCE EAST OF 2680.84' AND SOUTH OF 2607.49'.

10) CORNER REFERENCED IN FOLLOWING UNRECORDED SURVEYS (24" X 36" DRAWINGS) BY LARRY A. BRYAN, LLS #28832:
JOB NO. 96-B-50899, DATED 03/04/96:
JOB NO. 96-B-50913, DATED 03/04/96:
"SOUTH 1/4 CORNER OF SECTION 2, T3N, R1E, LIBER 6, PAGE 123. FOUND 1/2" BAR IN C/L LINN ROAD." WITNESSED BY: FOUND STEPHENS NAIL & TAG EAST SIDE POWER POLE, NORTH, 28.13'
FOUND STEPHENS NAIL & TAG SOUTH SIDE POWER POLE, N 50 E, 107.28'
SET NAIL & TAG SOUTHEAST SIDE 48" MAPLE, N 18 E, 44.65'
SET NAIL & TAG EAST SIDE POWER POLE, SOUTH, 31.97'
SURVEYS SHOW A DISTANCE EAST OF 2680.47' AND NORTH OF 2643.13'.

11) CORNER REFERENCED IN FOLLOWING UNRECORDED SURVEY BY LARRY A. BRYAN, RLS #25832.
JOB NO. 98-B-56915, DATED 07/07/98: AS "FOUND BAR & CAP CENTERLINE OF LINN ROAD, FENCE LINE NORTH." WITNESSED BY:
FOUND STEPHENS NAIL & TAG, EAST SIDE POWER POLE, NORTH, 28.30'
FOUND NAIL & TAG, WEST SIDE POWER POLE, SOUTH, 31.95'
FOUND NAIL & TAG #25832, SOUTHEAST SIDE 40" MAPLE, N 20 E, 44.64'
FOUND STEPHENS NAIL & TAG, SOUTHEAST SIDE POWER POLE, N 70 E, 107.20'
SURVEY SHOWS A DISTANCE EAST OF 2681.04'.

12) NO OTHER REFERENCES FOUND.



2004-072989

Page: 2 of 2

12/01/2004 08:17 A

LAND CORNER RECORDATION CERTIFICATE

Filing Requirement of Act 74, Mich. P.A. 1970

For corners in

INGHAM

(County)

Located In:

Corner Code #

WHEATFIELD TOWNSHIP.

1. Public Land Survey

T 3N R 1E

K-1

T R

T R

T R

T R

T R

T R

2. Property Controlling
in Section

S

S

S

S

3. Miscellaneous
Property in Sec.

S

S

4. Lot No. , Recorded Plat

5. Private Claims

Paula Johnson-
INGHAM COUNTY
REGISTER OF DEEDS
OFFICIAL SEAL



L-11 P-311

CRNR 17.00

2004-072988

Register of Deeds Stamp & File Number

	A	B	C	D	E	F	G	H	I	J	K	L	M
1													
2	6	5	4	3	2	1							
3													
4	7	8	9	10	11	12							
5													
6	18	17	16	15	14	13							
7													
8	19	20	21	22	23	24							
9													
10	30	29	28	27	26	25							
11													
12	31	32	33	34	35	36							
13													

I, **ANTHONY BUMSTEAD, P.S.**, in a field survey on **APRIL 06, 2004**, do hereby certify that under requirements of P.A. 74, Michigan P.A. of 1970, the corner points mentioned in lines 1 and 2 above were in conformance with regulations and rules therefore as required in the current manual of survey instructions of the United States Department of the Interior, Bureau of Land Management or by a decree of a Court of Law and/or that the corner points mentioned in lines 3, 4 and 5 above were in conformance with the rules of the Michigan Board of Land Surveyors or by a Decree of a Court of Law; established, re-established, monumented, re-monumented, recovered, found as expressed below:

NOTE: Not more than 2 corners, all in the same town and range, may be recorded on this certificate.

A. Description of original monument and accessories and/or subsequent restoration:

1) CORNER SET BY J. WAMPLER, DEP. SURVEYOR IN FEB. 1826.

"INTER. N. BOUND. 45 LKS. (29.70') W. OF POST, SET POST AT INTERSECTION COR."

WITNESSED BY: W. OAK 11", S 45° E, 15-1/2 LKS. (10.23')

SUGAR 36", S 19° W, 24 LKS. (15.84')

NOTES SHOW A DISTANCE SOUTH OF 33.44 CH. (2207.04')

2) CORNER REFERENCED IN SURVEY BY A. JACKSON, COUNTY SURVEYOR, NO DATED (CIRCA 1846-1847) AND RECORDED IN BOOK 1, PAGE 191. NO MENTION OF MONUMENT, SAME WITNESSES AS ITEM A-1 ABOVE. SURVEY SHOWS NO DISTANCES TO ADJACENT SECTION CORNERS.

CONTINUED ON PAGE 2:

B. Description of corner evidence found and/or method applied in restoring or reestablishing corner:

SEARCHED AT APPARENT LOCATION OF CORNER AND FOUND REBAR (NO CAP), ABOUT 27' WEST C/L PUTNAM ST., 0.3' EAST OF EAST EDGE OF SIDEWALK AND 6.5' WEST OF BACK OF WEST CURB ON C/L PUTNAM ST. DID NOT EXCAVATE. ACCEPTED POSITION OF FOUND REBAR AS THE PERPETUATED LOCATION OF McCREARY'S CORNER FOR THE PLAT OF OWENS ESTATES, AS FLOYD NOTES THAT HE SET CORNER PER PLAT MONUMENTATION AND SET STANDARD 3/4" x 24" INGHAM COUNTY REMON. BAR AND PA 345 CAP #41095 AT FOUND POSITION.

C. Description of monument for corner and accessories established to perpetuate locating the position of the corner:

K-1, T3N, R1, WHEATFIELD TOWNSHIP, INGHAM COUNTY. SET STANDARD 3/4"x 24" INGHAM COUNTY REMON. BAR AND PA 345 CAP #41095 IN POSITION OF FOUND REBAR. WITNESSED BY:

FD. NAIL & TAG #28068, S/S P. POLE, EAST, 3.03'

FD. NAIL & TAG #28068, S/S P. POLE, S 88 E, 49.33'

SET NAIL & TAG #30090, SW/S 28" MAPLE, S 50 E, 66.10'

NORTHEAST CORNER STONE PORCH #322, S 40 W, 43.28'

FD. RAILROAD SPIKE (K-13, T4N, R1E), DUE EAST, 29.15'



2004-072988

Page: 1 of 2

12/01/2004 08:17 A

Signed by

Anthony Bumstead

Date

AUGUST 04, 2004

Surveyor's Michigan License No. 41095

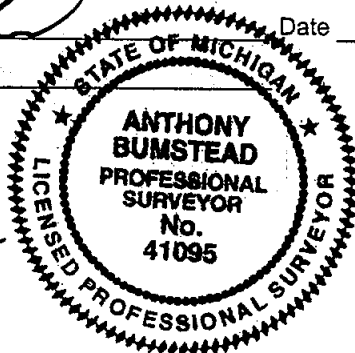

FORM APPROVED BY MICHIGAN STATE BOARD OF LAND SURVEYORS, JAN. 28, 1971

REVISED MAY 14, 1975

REVISED JAN. 1983

REVISED OCT. 1985

ADAPTED FOR WORD PROCESSING JAN, 1999

P.A. 345 INGHAM COUNTY

PEER APPROVED 7/13/2004 *mu*

K-1, T3N, R1E, WHEATFIELD TOWNSHIP, INGHAM COUNTY. PART A - CONTINUED - PAGE 2:

- 3) CORNER REFERENCED IN SURVEY BY A. JACKSON, COUNTY SURVEYOR, DATED 01/20/1847, AND RECORDED IN BOOK 1, PAGE 192. NO MENTION OF MONUMENT, SAME WITNESSES AS ITEM A-1 ABOVE. SURVEY SHOWS NO DISTANCES TO ADJACENT SECTION CORNERS.
- 4) CORNER REFERENCED IN PLAT OF "OWENS THIRD ADDITION" TO THE VILLAGE OF WILLIAMSTON," BY H.D. BARTHOLOMEW, SURVEYOR, DATED 8/18/1887, AND RECORDED IN LIBER 1, PAGE 11. NO MENTION OF MONUMENT OR WITNESSES GIVEN. PLAT SHOWS A DISTANCE WEST OF 840.2 FT. TO THE NORTHWEST CORNER OF THE PLAT.
- 5) CORNER REFERENCED IN SURVEY BY J. McCREARY, COUNTY SURVEYOR, DATED 1893, AND RECORDED IN FOLDER 1, PAGE 5. "SURVEY FOR A PLAT FOR OWEN ESTATES." "STONE WITH BRICK." WITNESSED BY: W. OAK 16", S 89° W, 126-1/2 LKS. (83.49')
SUGAR 8", S 74°-55' E, 76-1/2 LKS. (50.49')
SURVEY SHOWS A DISTANCE WEST TO I-1 OF 80.25 CH. (5296.50').
- 6) CORNER REFERENCED IN LCRC BY BRUCE L. FLOYD, LLS #28068, DATED 10/16/87 AND RECORDED IN LIBER 6, PAGE 349.
PART A STATES: "K-1, ORIGINAL MONUMENT LOST; SEWER CONSTRUCTION HAS DESTROYED ALL EVIDENCE IN ROAD."
PART B STATES: "K-1, SET 1/2" REROD WITH CAP #28068 IN LOCATION FITTING MONUMENTATION F OWEN'S THIRD ADDITION TO THE VILLAGE (NOW CITY) OF WILLIAMSTON. IRON IS 0.5' EAST OF EAST EDGE OF WEST SIDEWALK OF PUTNAM STREET."
PART C STATES: "K-1, NE CORNER, SECTION 2, T3N, R1E ... LEFT 1/2" REROD AS SET, 0.5' EAST OF SIDEWALK." WITNESSED BY:
3/4" BAR, SE COR SEC 35 T4N-R1E, S 89-16-36 E, 29.23'
PROPERTY IRON, N 89-16-36 W, 7.79'
PROPERTY IRON, S 89-16-36 E, 61.38'
N & T IN S SIDE POWER POLE, N 85-27-54 E, 49.29'
N & T IN S SIDE POWER POLE, N 03-50-16 E, 2.98'
N & T IN N SIDE 36" MAPLE, S 79-29-41 E, 66.58'
- 7) NO OTHER REFERENCES FOUND.



2004-072988

Page: 2 of 2

12/01/2004 08:17 A

LAND CORNER RECORDATION CERTIFICATE

Filing Requirement of Act 74, Mich. P.A. 1970

For corners in

INGHAM

(County)

Located In:

Corner Code #

WHEATFIELD TOWNSHIP.

1. Public Land Survey

T 3N R 1E

K-2

2. Property Controlling
in Section

S T R

3. Miscellaneous
Property in Sec.

S T R

4. Lot No. , Recorded Plat

5. Private Claims

Paula Johnson-
INGHAM COUNTY
REGISTER OF DEEDS
OFFICIAL SEAL



L-11 P-316

CRNR 20.00

2004-072991

Register of Deeds Stamp & File Number

	A	B	C	D	E	F	G	H	I	J	K	L	M
1													
2	6	5	4	3	2	1							
3													
4	7	8	9	10	11	12							
5													
6	18	17	16	15	14	13							
7													
8	19	20	21	22	23	24							
9													
10	30	29	28	27	26	25							
11													
12	31	32	33	34	35	36							
13													

I, ANTHONY BUMSTEAD, P.S., in a field survey on 4/06 & 4/13, 2004

do hereby certify that under requirements of P.A. 74, Michigan P.A. of 1970, the corner points mentioned in lines 1 and 2 above were in conformance with regulations and rules therefore as required in the current manual of survey instructions of the United States Department of the Interior, Bureau of Land Management or by a decree of a Court of Law and/or that the corner points mentioned in lines 3, 4 and 5 above were in conformance with the rules of the Michigan Board of Land Surveyors or by a Decree of a Court of Law; established, re-established, monumented, re-monumented, recovered, found as expressed below:

NOTE: Not more than 2 corners, all in the same town and range, may be recorded on this certificate.

A. Description of original monument and accessories and/or subsequent restoration:

1) CORNER SET BY J. WAMPLER, DEP. SURVEYOR IN FEB. 1826. "SET 1/4 SEC. POST FW." WITNESSED BY:

BEECH, 6", N 40° W, 8 LKS. (5.28')

LYNN, 26", N 57° E, 26 LKS. (17.16')

NOTES SHOW A DISTANCE SOUTH OF 40 CH. (2640.0') AND NORTH OF 33.44 CH. (2207.04').

2) CORNER REFERENCED IN SURVEY BY UNKNOWN COUNTY SURVEYOR, DATED 1844-1845 AND RECORDED IN BOOK 4, PAGE 156. NO MENTION OF MONUMENT, SAME WITNESSES AS ITEM A-1 ABOVE. SURVEY SHOWS A DISTANCE WEST OF 165? RODS, 22 LKS. (2736.02'?).

3) CORNER REFERENCED IN SURVEY BY A. JACKSON, COUNTY SURVEYOR, NOT DATED (CIRCA 1846-1847) AND RECORDED IN BOOK 4, PAGE 192. NO MENTION OF MONUMENT, SAME WITNESSES AS ITEM A-1 ABOVE. SURVEY SHOWS NO DISTANCES TO ADJACENT SECTION CORNERS.

CONTINUED ON PAGE 2:

B. Description of corner evidence found and/or method applied in restoring or reestablishing corner:

SEARCHED AT APPARENT LOCATION OF CORNER AND FOUND BAR & CAP (SMASHED), ON C/L PUTNAM ST. (WILLIAMSTON ROAD) AND 15 FT. SOUTH OF SOUTH CURB LINE OF INDUSTRIAL PARK DRIVE TO THE EAST. EXCAVATED THRU THREE LAYERS OF BIT. PAVING AND SET NEW MONUMENT BOX AROUND FOUND REBAR. ACCEPTED POSITION OF FOUND BAR & CAP AND SET STANDARD 3/4" x 24" INGHAM COUNTY REMON. BAR AND PA 345 CAP #41095 IN NEW MONUMENT BOX.

C. Description of monument for corner and accessories established to perpetuate locating the position of the corner:

K-2, T3N, R1, WHEATFIELD TOWNSHIP, INGHAM COUNTY. SET STANDARD 3/4" x 24" INGHAM COUNTY REMON. BAR AND PA 345 CAP #41095 IN POSITION OF FOUND BAR & CAP. WITNESSED BY:

SET NAIL & TAG #30090, E/S P. POLE, N 10 W, 141.35'

SOUTHEAST CORNER OF CHURCH, N 39 W, 122.55'

FD. NAIL & TAG #28414, N/S P. POLE, DUE WEST, 62.62'

FD. NAIL & TAG #28414, N/S P. POLE, S 77 W, 29.25'



2004-072991

Page: 1 of 3

12/01/2004 08:17 A

P.A. 345 INGHAM COUNTY

PEER APPROVED 7/13/2004 RL

Signed by

Anthony Bumstead

Surveyor's Michigan License No. 41095

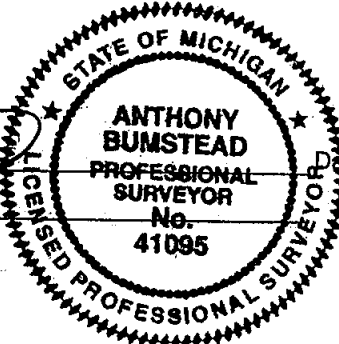

AUGUST 4, 2004

FORM APPROVED BY MICHIGAN STATE BOARD OF LAND SURVEYORS, JAN. 28, 1971

REVISED MAY 14, 1975

REVISED JAN., 1983

REVISED OCT, 1995

ADAPTED FOR WORD PROCESSING JAN, 1999

K-2, T3N, R1E, WHEATFIELD TOWNSHIP, INGHAM COUNTY. PART A - CONTINUED - PAGE 2:

- 4) CORNER REFERENCED IN SURVEY BY A. JACKSON, COUNTY SURVEYOR, DATED 01/20/1847, AND RECORDED IN BOOK 1, PAGE 191. NO MENTION OF MONUMENT, SAME WITNESSES AS ITEM A-1 ABOVE. SURVEY SHOWS A DISTANCE EAST TO M-2 OF 5285.28'.
- 5) CORNER REFERENCED IN SURVEY BY J. McCREARY, COUNTY SURVEYOR, DATED 1893, AND RECORDED IN FOLDER 1, PAGE 5. "SURVEY FOR A PLAT FOR OWEN ESTATES." "STONE MON. WITH BRICK." WITNESSED BY: SUGAR 14", S 47° E, 66 LKS. (43.56')
SUGAR 12", N 58° E, 67 LKS. (44.22')
SURVEY SHOWS A DISTANCE WEST TO I-2 OF 80.47 CH. (5311.02').
- 6) CORNER REFERENCED IN PLAT OF "TURNER'S SUBDIVISION" BY DONALD B. EMERY, PE # ?????, DATED 5/21/62 AND RECORDED IN LIBER 24, PAGE 14. "SE CORNER OF NE 1/4 OF SECTION 2, T3N, R1E. NO MENTION OF MONUMENT OR WITNESSES GIVEN. NO DISTANCE TO ADJACENT SECTION CORNERS GIVEN.
- 7) CORNER REFERENCED IN INGHAM COUNTY ROAD COMM. GRID SHEET, DATED 1969, AS "5/8" IRON." WITNESSED BY:
- | | | |
|---------------------|--------|-----|
| SP. 8" ELM, | 58.2, | NW |
| SP. 24" MAPLE, | 44.6, | SE |
| SP. ANCH. POST, | 33.9, | E |
| SP. ANCH. POST, | 34.0, | W |
| NE COR. HOUSE WALL, | 61.45, | WSW |
- 8) CORNER REFERENCED IN LCRC BY RONNIE M. LESTER, RLS #18998, DATED 5/21/74 AND RECORDED IN LIBER 3, PAGE 163.
PART A STATES: "K-2, 3/8" IRON ROD & WITNESSES."
PART B STATES: "K-2, FOUND 3/8" IRON ROD FROM WITNESSES SUPPLIED BY STEPHENS ENGINEERING."
PART C STATES: "K-2, E 1/4 CORNER, SECTION 2, T3N, R1E. FOUND 3/8" SQ. BAR IN APPARENT CENTERLINE OF WILLIAMSTON RD. & OLD FENCE LINE EAST." WITNESSED BY:
- | | |
|------------------------------------|--------------|
| SE CORNER OF CHURCH, | NW, 141.49' |
| P.K. NAIL NORTH SIDE POWER POLE, | WEST, 63.07' |
| NAIL & TAG, SOUTH SIDE POWER POLE, | EAST, 31.66' |
- 9) CORNER REFERENCED IN FOLLOWING SURVEYS BY RONNIE M. LESTER, RLS #18998:
RECORDED IN LIBER 1, PAGE 1244., DATED 05/21/74:
RECORDED IN LIBER 2, PAGE 37, DATED 05/21/74:
RECORDED IN LIBER 3, PAGE 54, DATED 08/10/77:
"FOUND 1/2" BAR, RECORDED L3, P.163." SAME WITNESSES AS ITEM A-8 ABOVE.
SURVEYS SHOW A DISTANCE SOUTH OF 2632.39'.
- 10) CORNER REFERENCED IN SURVEY BY FRED N. WHITE, RLS #12034, DATED 05/09/75 AND RECORDED IN LIBER 2, PAGE 488. "E 1/4 CORNER, SECTION 2, T3N, R1E, (REC. LIBER 3, PG. 163). NO WITNESSES GIVEN. SURVEY SHOWS A DISTANCE SOUTH OF 2632.26'.
- 11) CORNER REFERENCED IN FOLLOWING SURVEYS BY DAVID L. CLIFFORD, RLS #25837:
RECORDED IN LIBER 4, PAGE 521, DATED 02/18/82:
RECORDED IN LIBER 4, PAGE 522, DATED 02/18/82:
"E 1/4 CORNER, SECTION 2, T3N, R1E, CITY OF WILLIAMSTON, INGHAM CO., MI., (LIBER 3, PG. 163). NO WITNESSES GIVEN. SURVEYS SHOW A DISTANCE WEST OF 2659.12'.
- 12) CORNER REFERENCED IN LCRC BY MAURICE H. MAHIEU, LLS #28414, DATED 08/25/88 AND RECORDED IN LIBER 7, PAGE 2.
PART A STATES: "K-2, ORIGINAL MONUMENTS AND ACCESSORIES WERE NOT FOUND."
PART B STATES: "K-2, 3/8" BAR AS RECORDED IN LAND CORNER RECORDATION CERTIFICATE IN LIBER 3, PAGE 163, WAS DESTROYED DURING CONSTRUCTION OF SEWERS AND ROADS. FOUND TWO OF THE PREVIOUS WITNESSES AND FOUND A NAIL WITH TAG THAT CORRESPONDS TO WITNESSES."
PART C STATES: "K-2, LEFT NAIL IN PLACE, WITNESSED BY:
- | | |
|-----------------------------------|----------------|
| S.E. CORNER OF CHURCH ADDITION, | NW, 122.60' |
| NAIL IN TELEPHONE POLE, | S 70 W, 30.10' |
| NAIL IN NORTH SIDE OF POWER POLE, | WEST, 62.64' |
| NAIL IN SOUTH SIDE OF POWER POLE, | EAST, 31.93' |
- 13) CORNER REFERENCED IN FOLLOWING RECORDED SURVEYS BY MAURICE H. MAHIEU, LLS #28414:
RECORDED IN LIBER 5, PAGE 523, DATED 09/08/88:
RECORDED IN LIBER 7, PAGE 458, DATED 12/01/94:
RECORDED IN LIBER 7, PAGE 764, DATED 03/22/96:
"FOUND NAIL IN ROAD WITNESSED BY." SAME WITNESSES AS ITEM A-10 ABOVE.
SURVEYS SHOW A DISTANCE EAST OF 2650.61' TO L-2, EAST OF 5308.21' TO M-2 AND SOUTH OF 2631.47'.



2004-072991

Page: 2 of 3

12/01/2004 08:17 A

- 14) CORNER REFERENCED IN FOLLOWING UNRECORDED SURVEYS BY MARVIN F. FOUTY, LLS #18989.
JOB NO. B-1065, DATED 09/25/95:
JOB NO. B-1070, DATED 11/03/95:
JOB NO. B-1241, DATED 03/12/97:
AS "FND. BAR & CAP #28414." NO WITNESSES GIVEN. SURVEYS SHOW A DISTANCE SOUTH OF 2632.01' AND WEST OF 2658.64'.
- 15) CORNER REFERENCED IN FOLLOWING UNRECORDED SURVEYS (24" X 36" DRAWINGS) BY LARRY A. BRYAN, LLS #28832:
JOB NO. 96-B-50899, DATED 03/04/96:
JOB NO. 97-B-54186, DATED ??/??/97:
"EAST 1/4 CORNER OF SECTION 2, (OR WEST 1/4 CORNER OF SECTION 1), T3N, R1E, LIBER 7, PAGE 2. FOUND 1/2" BAR & CAP #28414 IN C/L WILLIAMSTON ROAD." WITNESSED BY:
FOUND NAIL & TAG #28414, NORTHEAST SIDE POWER POLE, S 70 W, 29.30'
SOUTHEAST CORNER CHURCH FOUNDATION, N 45 W, 122.35'
C/L FIRE HYDRANT, EAST, 89.35'
C/L STORM MANHOLE, N 30 E, 20.80'
SURVEYS SHOW A DISTANCE WEST OF 2657.93' AND SOUTH OF 2649.99'.
- 16) CORNER REFERENCED IN FOLLOWING CONDOMINIUM MASTER DEEDS;
WILLIAMSBURG CONDOMINIUMS, SUBDIVISION PLAN NO. 122, BY TIMOTHY E. BEBEE,
PS #39074, DATED 6/10/97:
PINE MEADOWS CONDOMINIUMS, SUBDIVISION PLAN NO. 127, BY ROGER P. MAHONEY,
PS #41105, DATED 10/29/97:
NO MENTION OF MONUMENT OR WITNESSES GIVEN, NO DISTANCES TO ADJACENT SECTION CORNERS GIVEN.
- 17) CORNER REFERENCED IN FOLLOWING PLATS BY TERRY L. WIEGMAN, LS #39100:
PLYMOUTH LANDING, DATED 10/10/99 AND RECORDED IN LIBER 53, PAGE 34-37.
PLYMOUTH LANDING NO. 2, DATED 03/05/01 AND RECORDED IN LIBER 54, PAGE 32-33.
"EAST 1/4 CORNER OF SECTION 2, T3N, R1E, LIBER 7, PAGE 2.
NO MENTION OF MONUMENT OR WITNESSES GIVEN. PLATS SHOW A DISTANCE WEST OF 2658.24' AND SOUTH OF 2631.50'.
- 18) NO OTHER REFERENCES FOUND.



2004-072991

Page: 3 of 3

12/01/2004 08:17 A



P.A. 345 INGHAM COUNTY
PEER APPROVED 7/13/2004 *AL*

LAND CORNER RECORDATION CERTIFICATE
Filing Requirement of Act 74, Mich. P.A. 1970

For corners in

INGHAM

(County)

Located In:

Corner Code #

WHEATFIELD TOWNSHIP.

1. Public Land Survey

T 3N R 1E

K-3

T R

T R

T R

T R

2. Property Controlling
In Section

S T R

S T R

3. Miscellaneous
Property in Sec.

S T R

S T R

4. Lot No. Recorded Plat

5. Private Claims

Paula Johnson-
INGHAM COUNTY
REGISTER OF DEEDS
OFFICIAL SEAL



L-11 P-319

CRNR 23.00

2004-072992

Register of Deeds Stamp & File Number

	A	B	C	D	E	F	G	H	I	J	K	L	M
1													
2	6	5	4	3	2	1							
3													
4	7	8	9	10	11	12							
5													
6	18	17	16	15	14	13							
7													
8	19	20	21	22	23	24							
9													
10	30	29	28	27	26	25							
11													
12	31	32	33	34	35	36							
13													

I, ANTHONY BUMSTEAD, in a field survey on SEPTEMBER 24, 2004,

do hereby certify that under requirements of P.A. 74, Michigan P.A. of 1970, the corner points mentioned in lines 1 and 2 above were in conformance with regulations and rules therefore as required in the current manual of survey instructions of the United States Department of the Interior, Bureau of Land Management or by a decree of a Court of Law and/or that the corner points mentioned in lines 3, 4 and 5 above were in conformance with the rules of the Michigan Board of Land Surveyors or by a Decree of a Court of Law; established, re-established, monumented, re-monumented, recovered, found as expressed below:

NOTE: Not more than 2 corners, all in the same town and range, may be recorded on this certificate.

A. Description of original monument and accessories and/or subsequent restoration:

1) CORNER SET BY J. WAMPLER, DEP. SURVEYOR IN FEB. 1826.

"SET POST COR. SECT. 1, 2, 11 & 12." WITNESSED BY:

BEECH, 12", S 50° E, 1-1/2 LKS. (0.99')

HICKORY, 11", N 14° W, 32-1/2 LKS. (21.45')

NOTES SHOW A DISTANCE WEST OF 40.30 CH. (2659.80'), EAST OF 40.35 CH. (2663.10') AND NORTH & SOUTH OF 40 CH. (2640.0')

2) CORNER REFERENCED IN SURVEY BY UNKNOWN COUNTY SURVEYOR, DATED 1844-1845 AND RECORDED IN BOOK 4, PAGE 156. NO MENTION OF MONUMENT, SAME WITNESSES AS ITEM A-1 ABOVE. SURVEY SHOWS NO DISTANCES AT ADJACENT SECTION CORNERS.

3) CORNER REFERENCED IN INGHAM COUNTY ROAD COMM. GRID SHEET, DATED 1969, AS "1" PIPE."

WITNESSED BY; U.S.G.S BM, N 26 W, 46.12'

34" MAPLE, N 24 E, 63.6'

10" MAPLE, S 44 W, 53.46'

COR. POST, N 41 E, 41.82'

CONTINUED ON PAGE 2:

B. Description of corner evidence found and/or method applied in restoring or reestablishing corner:

SEARCHED AT APPARENT LOCATION OF CORNER AND FOUND 1/2" X 24" REBAR AND CAP #16053 IN MON. BOX, ON C/L LINN ROAD AND ±4' WEST OF PAINTED C/L OF WILLIAMSTON ROADS. DID NOT EXCAVATE INTERIOR OF MON. BOX. ACCEPTED POSITION OF FOUND REBAR & CAP AND SET STANDARD 3/4" X 24" INGHAM COUNTY REMON. BAR AND PA 345 CAP #41095.

MEASURED EAST TO L-3: 2654.60'

MEASURED NORTH TO K-2: 2631.69'

MEASURED WEST TO J-3: 2681.16'

BRYAN SURVEYS MEASURED SOUTH TO K-4: 2629.69'



2004-072992

Page: 1 of 4

12/01/2004 08:17 A

C. Description of monument for corner and accessories established to perpetuate locating the position of the corner:

K-3, T3N, R1, WHEATFIELD TOWNSHIP, INGHAM COUNTY. SET STANDARD 3/4" X 24" INGHAM COUNTY REMON. BAR AND PA 345 CAP #41095 IN POSITION OF FOUND REBAR & CAP #16053.

FD. NAIL & TAG #16053, South side utility pole, N 70 E, 68.51'

FD. NAIL & TAG #16053, North side utility pole, S 44 E, 85.91'

FD. NAIL & TAG #30090, Northwest side 27" PINE, S 30 W, 114.22'

FD. NAIL & TAG #16053, South side utility pole, N 70 W, 92.20'

Signed by

Anthony Bumstead

Surveyor's Michigan License No. 41095

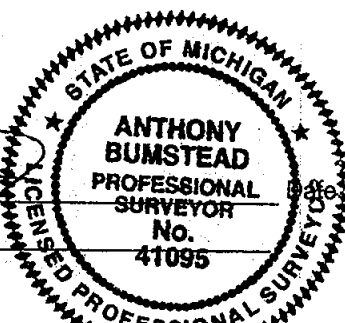

P.A. 345 INGHAM COUNTY

PEER APPROVED 10/12/2004 *He*

October 11, 2004

K-3, T3N, R1E, WHEATFIELD TOWNSHIP, INGHAM COUNTY. PART A - CONTINUED - PAGE 2:

- 4) CORNER REFERENCED IN LCRC BY RONNIE M. LESTER, RLS #18998, DATED 5/21/74 AND RECORDED IN LIBER 3, PAGE 163.
 PART A STATES: "K-3, BOATSPIKE & WITNESSES."
 PART B STATES: "K-3, FOUND BOATSPIKE FROM WITNESSES SUPPLIED BY STEPHENS ENGINEERING."
 PART C STATES: "K-3, SE CORNER, SECTION 2, T3N, R1E. FOUND BOATSPIKE 6' WEST OF APPARENT CENTERLINE WILLIAMSTON RD. NORTH & SOUTH & ON APPARENT CENTERLINE LINN ROAD EAST & WEST." WITNESSED BY:
 NAIL & TAG, NORTH SIDE POWER POLE, WNW, 92.02'
 NAIL & TAG, WEST SIDE 16" MAPLE, SW, 53.65'
 NAIL & TAG, SOUTH SIDE POWER POLE, ENE, 215.24'
- 5) CORNER REFERENCED IN FOLLOWING SURVEYS BY RONNIE M. LESTER, RLS #18998:
 RECORDED IN LIBER 1, PAGE 1244, DATED 05/21/74:
 RECORDED IN LIBER 2, PAGE 37, DATED 05/21/74:
 RECORDED IN LIBER 3, PAGE 54, DATED 08/10/77:
 "FOUND 3/8" BAR." SAME WITNESSES AS ITEM A-4 ABOVE.
 SURVEYS SHOW A DISTANCE NORTH OF 2632.15'.
- 6) CORNER REFERENCED IN SURVEY BY FRED N. WHITE, RLS #12034, DATED 05/09/75 AND RECORDED IN LIBER 2, PAGE 488. "SE CORNER, SECTION 2, T3N, R1E, (LIBER 3, PG. 163). NO WITNESSES GIVEN. SURVEY SHOWS A DISTANCE NORTH OF 2632.26'.
- 7) CORNER REFERENCED IN SURVEY BY RONNIE M. LESTER, RLS #18998, DATED 08/10/77, AND RECORDED IN LIBER 3, PAGE 54. "FD. BOAT SPIKE, RECORDED L3, P.163." SAME WITNESSES AS ITEM A-4 ABOVE. SURVEY SHOWS A DISTANCE NORTH OF 2632.39'.
- 8) CORNER REFERENCED IN FOLLOWING UNRECORDED SURVEYS BY LARRY A. BRYAN, RLS #25832.
 JOB NO. 85-B-7494, DATED 10/30/85: AS "FOUND "PK" NAIL INTERSECTION WITNESSES RECORDED IN LIBER 3, PAGE 163". WITNESSED BY:
 FOUND STEPHENS NAIL & TAG, NORTH SIDE UTILITY POLE, N 70 W, 92.08'
 FOUND STEPHENS NAIL & TAG, SOUTH SIDE UTILITY POLE, N 80 E, 215.18'
 SET NAIL & TAG, SOUTHEAST SIDE 24" MAPLE, S 75 W, 124.41'
 SET NAIL & TAG, EAST SIDE UTILITY POLE, N 20 W, 94.46'
 SURVEYS SHOW NO DISTANCES TO ANY ADJACENT SECTION CORNERS.
- 9) CORNER REFERENCED IN LCRC BY MAURICE H. MAHIEU, LLS #28414, DATED 08/25/88 AND RECORDED IN LIBER 7, PAGE 2.
 PART A STATES: "K-3, ORIGINAL MONUMENTS AND ACCESSORIES WERE NOT FOUND."
 PART B STATES: "K-3, BOAT SPIKE AS RECORDED IN LAND CORNER RECORDATION CERTIFICATE IN LIBER 3, PAGE 163, WAS OVERLAID BY ASPHALT DURING NEW ROAD CONSTRUCTION.
 FOUND P.K.NAIL IN NEW ASPHALT WITH TWO CORRESPONDING WITNESSES."
 PART C STATES: "K-3, LEFT NAIL IN PLACE, WITNESSED BY::
 NAIL & TAG IN NORTH SIDE POWER POLE, WNW, 92.02'
 NAIL & TAG IN SOUTH SIDE POWER POLE, ENE, 215.24'
 NAIL & WASHERW/NO. 25832 IN TELEPHONE POLE, WNW, 94.30'
 NAIL IN TELEPHONE POLE, SW, 49.65'
- 10) CORNER REFERENCED IN FOLLOWING RECORDED SURVEYS BY MAURICE H. MAHIEU, LLS #28414:
 RECORDED IN LIBER 5, PAGE 523, DATED 09/08/88:
 RECORDED IN LIBER 7, PAGE 458, DATED 12/01/94:
 RECORDED IN LIBER 7, PAGE 800, DATED 05/01/96:
 "FOUND NAIL IN ROAD WITNESSED BY." SAME WITNESSES AS ITEM A-9 ABOVE, EXCEPT.
 NAIL POWER POLE, ENE, 212.04'
 SURVEYS SHOW A DISTANCE EAST OF 2654.52' AND NORTH OF 2631.47'.
- 11) CORNER REFERENCED IN FOLLOWING RECORDED SURVEYS BY DAVID R. LOHR, LLS #30090:
 RECORDED IN LIBER 6, PAGE 962, DATED 10/24/91:
 RECORDED IN LIBER 7, PAGE 881, DATED 03/14/96:
 RECORDED IN LIBER 7, PAGE 1239, DATED 05/06/97:
 RECORDED IN LIBER 8, PAGE 764, DATED 04/15/99:
 "FOUND PK NAIL 4' WEST OF C/L." WITNESSED BY:
 NAIL & TAG POWER POLE, N 75 W, 92.02'
 NAIL & TAG POWER POLE, N 20 E, 212.04'
 NAIL & TAG POWER POLE, N 15 W, 94.30'
 NAIL & TAG POWER POLE, S 40 W, 49.65'
 SURVEYS SHOW A DISTANCE EAST OF 2654.67' AND SOUTH OF 2629.73'.



2004-072992
 Page: 2 of 4
 12/01/2004 08:17 A

CORNER REFERENCED IN FOLLOWING UNRECORDED SURVEYS BY LARRY A. BRYAN, RLS #25832.

JOB NO. 94-B-46674, DATED 08/19/94:

JOB NO. 95-B-50206, DATED 11/03/95:

AS "FOUND 1/2" BAR & CAP 4' FEET WEST OF THE CENTERLINE OF WILLIAMSTON ROAD AND 2' NORTH OF THE CENTERLINE OF LINN ROAD."

WITNESSED BY: FOUND NAIL & TAG #25832, EAST SIDE POWER POLE, N 20 W, 95.28'
FOUND STEPHENS NAIL & TAG, NORTHEAST SIDE POWER POLE, N 70 W, 92.02'
FOUND NAIL & TAG #25832, SOUTHEAST SIDE 24" MAPLE, S 70 W, 124.41'
NAIL & TAG POWER POLE, S 40 W, 49.65'

SURVEYS SHOW A DISTANCE EAST OF 2654.62', WEST OF 2680.84' AND SOUTH OF 2629.68'.

13) CORNER REFERENCED IN FOLLOWING UNRECORDED SURVEYS BY LARRY A. BRYAN, RLS #25832.

JOB NO. 98-B-56915, DATED 07/07/98:

JOB NO. 99-B-59902, DATED 07/01/99:

AS "FOUND (1/2") BAR & CAP 4' FEET WEST OF CENTERLINE OF WILLIAMSTON ROAD, 2' NORTH OF CENTERLINE OF LINN ROAD." WITNESSED BY:

FOUND NAIL & TAG #25832, SOUTH SIDE OF POWER POLE, N 70 E, 60.42'
FOUND NAIL & TAG #25832, SOUTHEAST SIDE OF POWER POLE, S 45 W, 49.65'
FOUND STEPHENS NAIL & TAG, NORTHEAST SIDE OF POWER POLE, N 70 W, 92.04'

SURVEYS SHOW A DISTANCE WEST OF 2681.01' AND SOUTH OF 2629.82'.

14) CORNER REFERENCED IN FOLLOWING UNRECORDED SURVEYS BY LARRY A. BRYAN, RLS #25832.

JOB NO. 95-B-50206, DATED 11/03/95:

JOB NO. 99-B-59902, DATED 07/01/99:

JOB NO. 99-B-59902-1, DATED 07/09/99:

AS "FOUND 1/2" BAR & CAP 4' FEET WEST OF CENTERLINE OF WILLIAMSTON RD. AND 2' NORTH OF CENTERLINE LINN ROAD." WITNESSED BY:

FOUND NAIL & TAG #25832, EAST SIDE POWER POLE, N 20 W, 95.28'
FOUND STEPHENS NAIL & TAG, NORTHEAST SIDE OF POWER POLE, N 70 W, 92.02'
FOUND NAIL & TAG #25832, SOUTHEAST SIDE 24" MAPLE, S 70 W, 124.41'

SURVEYS SHOW A DISTANCE SOUTH OF 2629.69'.

15) CORNER REFERENCED IN FOLLOWING UNRECORDED SURVEYS BY MARVIN F. FOUTY, LLS #18989.

JOB NO. B-1065, DATED 09/25/95:

JOB NO. B-1070, DATED 11/03/95:

JOB NO. B-1241, DATED 03/12/97:

AS "FND. BAR & CAP #28414." NO WITNESSES GIVEN. SURVEYS SHOW A DISTANCE NORTH OF 2632.01' AND WEST OF 2681.46'.

16) CORNER REFERENCED IN FOLLOWING UNRECORDED SURVEY (24" X 36" DRAWINGS) BY LARRY A. BRYAN, LLS #28832:

JOB NO. 96-B-50899, DATED 03/04/96:

"FOUND 1/2" BAR & CAP #28414, 2' NORTH/LINN ROAD, 2' FEET WEST/WILLIAMSTON ROAD."

WITNESSED BY: FOUND NAIL & TAG #28414, SOUTH SIDE POWER POLE, N 48 W, 91.93'
FOUND NAIL & TAG #25832, EAST SIDE POWER POLE, N 15 W, 94.27'
SET NAIL & TAG, EAST SIDE POWER POLE, S 45 W, 49.63'
SET NAIL & TAG, SOUTHSIDE POWER POLE, N 55 E, 60.42'

SURVEY SHOWS A DISTANCE WEST OF 2680.47' AND NORTH OF 2631.22'.

17) CORNER REFERENCED IN FOLLOWING RECORDED SURVEYS BY LARRY A. BRYAN, RLS #25832.

LIBER 7, PAGE 906, DATED 10/01/96:

AS "FOUND PK NAIL 4' FEET WEST OF THE CENTERLINE OF WILLIAMSTON ROAD & 2' NORTH OF THE CENTERLINE OF LINN ROAD."

WITNESSED BY: FOUND NAIL & TAG #25832, EAST SIDE POWER POLE, N 20 W, 95.28'
FOUND STEPHENS NAIL & TAG, NORTHEAST SIDE POWER POLE, N 70 W, 92.02'
FOUND NAIL & TAG, SOUTHEAST SIDE 24" MAPLE, S 70 W, 124.41'

SURVEYS SHOW A DISTANCE WEST OF 2680.84'.

18) CORNER REFERENCED IN FOLLOWING PLATS BY TERRY L. WIEGMAN, LS #39100:

PLYMOUTH LANDING, DATED 10/10/99 AND RECORDED IN LIBER 53, PAGE 34-37.

PLYMOUTH LANDING NO. 2, DATED 03/05/01 AND RECORDED IN LIBER 54, PAGE 32-33.

PLYMOUTH LANDING NO. 3, DATED 06/17/01 AND RECORDED IN LIBER 55, PAGE 06-08.

"SOUTHEAST CORNER OF SECTION 2, T3N, R1E, LIBER 7, PAGE 2.

NO MENTION OF MONUMENT OR WITNESSES GIVEN. PLATS SHOW A DISTANCE NORTH OF 2631.50' AND WEST OF 2680.76'.

19) CORNER REFERENCED IN FOLLOWING UNRECORDED SURVEY (24" X 36" DRAWINGS) BY JEFFREY K. AUTENRIETH, PS #31588:

JOB NO. 00-B-63214, DATED ??/??/00:

NO MENTION OF MONUMENT OR WITNESSES GIVEN. SURVEY SHOWS A DISTANCE WEST OF 2681.01', AND SOUTH OF 2629.82'.

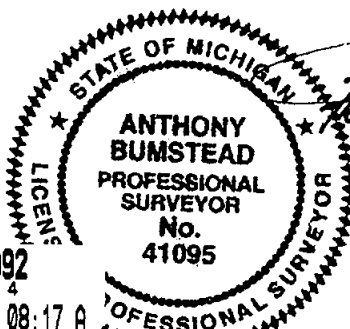

2004-072992

Page: 3 of 4

12/01/2004 08:17 A

20) CORNER REFERENCED IN FOLLOWING RECORDED SURVEY BY JEFFREY K. AUTENRIETH, PS #31588.
LIBER 8, PAGE 1047, DATED 09/28/01: NO MENTION OF MONUMENT OR WITNESSES GIVEN.
SURVEY SHOWS A DISTANCE EAST OF 2654.67'.

21) CORNER REFERENCED IN LCRC BY JAMES E. STEPHENS, PS #16053, DATED 11/12/02 AND RECORDED
IN LIBER 10, PAGE 293.

PART A STATES: "ORIGINAL MONUMENTS AND ACCESSORIES WERE NOT FOUND."

PART B STATES: "WITNESSED EXISTING CORNER AS PREVIOUSLY RECORDED PRIOR TO WILLIAMSTON
ROAD RECONSTRUCTION. RE-ESTABLISHED CORNER WITH 1/2" DIAMETER STEEL ROD
AND CAP NO. 16053 IN MONUMENT BOX."

PART C STATES: "1/2" DIAMETER STEEL ROD AND CAP NO. 16053 IN MONUMENT BOX WITNESSED BY:
NAIL & TAG NO. 16053 IN SOUTH SIDE OF UTILITY POLE, N 69 W, 92.12'
NAIL & TAG NO. 16053 IN EAST SIDE OF UTILITY POLE, S 44 W, 53.10'
NAIL & TAG NO. 16053 IN SOUTH SIDE OF UTILITY POLE, N 66 E, 68.49'
NAIL & TAG NO. 16053 IN NORTH SIDE OF UTILITY POLE, S 47 E, 85.87'

22) CORNER REFERENCED IN FOLLOWING PLAT BY TERRY L. WIEGMAN, LS #39100:

PLYMOUTH LANDING NO. 3, DATED 06/17/01 AND RECORDED IN LIBER 55, PAGE 06-08.

"SOUTH 1/4 CORNER OF SECTION 2, T3N, R1E, LIBER 6, PAGE 123.

NO MENTION OF MONUMENT OR WITNESSES GIVEN. PLAT SHOWS A DISTANCE WEST OF 2680.76'.

23) NO OTHER REFERENCES FOUND.



2004-072992

Page: 4 of 4

12/01/2004 08:17 A

LAND CORNER RECORDATION CERTIFICATE
Filing Requirement of Act 74, Mich. P.A. 1970

For corners in
WHEATFIELD TOWNSHIP
INGHAM COUNTY

Located In:

Corner Code #

1. Public Land Survey

T 3N

R 1E

I-3

T

R

T

R

T

R

S

T

R

S

T

R

S

T

R

2. Property Controlling
In Section

S

T

R

S

T

R

3. Miscellaneous
Property in Sec.

S

T

R

S

T

R

Paula Johnson
INGHAM COUNTY
REGISTER OF DEEDS

RECORDED

L-10 P-381

CRNR 9.00

2002-083090

2002-083090

Page: 1 of 1

12/26/2002 03:35P

Register of Deeds Stamp & File Number

4. Lot No. , Recorded Plat

5. Private Claims

I, Scott E. Koch, in a field survey on April 15, 2002 do hereby state that under requirements of P.A. 74, Michigan P.A. of 1970, the corner points mentioned in lines 1 and 2 above were in conformance with regulations and rules therefore as required in the current manual of survey instructions of the United States Department of the Interior, Bureau of Land Management or by decree of a Court of Law and/or that the corner points mentioned in lines 3, 4 and 5 above were in conformance with the rules of the Michigan Board of Land Surveyors or by a Degree of a Court of Law; established, re-established, monumented, recovered, found as expressed below:

NOTE: Not more than 2 corners, all in the same town and range, may be recorded on this certificate.

A. Description of original monument and accessories and/or subsequent restoration:

March, 1826 - G.L.O., Joseph Wampler, Deputy Surveyor, (Page 38) North between Sec. 10 & 11, set post cor for secs. 2, 3, 10 & 11

Beech 18 in. dia. S61.5°E, 18 lks. (11.88 feet)

Ironwood 6 in. dia. S39.5°W, 23 lks. (15.18 feet)

January 20, 1847 - County Surveyor Notes (Pages 192-193), A. Jackson, does not describe monument

Beech 18 in. dia. S61.5°E, 18 lks. (11.88 feet)

Ironwood 6 in. dia. S39.5°W, 23 lks. (15.18 feet)

May 3, 1876 - County Surveyor Notes (Pages 137-138), T. J. Brown, calls for a post

Elm 22 in. dia. N29°W, 107.75 lks. (71.11 feet)

November 29, 1978 - PA 74 (Liber 5, Page 79) Ronnie M. Lester, PS #18998,

Excavated a hole 15.5' x 10.1' to an average depth of 4.3' on the centerline of Linn Road, East of the centerline of Corwin Road and on fence line to the South. Found boat spike 0.5' below surface. Found 1/2" iron rod 0.9' below surface, directly beneath found boat spike, approx. 1.0' South of centerline of Linn Road, approx 10.0' East of centerline of Corwin Road, and on fence line to the South. Accepted boat spike and 1/2" iron rod as corner. Two witnesses remain as shown in Stephens survey records dated 1969, both in close accord with monumentation found.

Set 4" x 36" concrete monument with 1/2" x 38" rerod and cap #18998, with concrete collar and cover at location of boat spike and 1/2" iron rod described above.

East centerline 4" steel Anchor post, 1' above ground, South, 29.91'

South centerline 4" steel Anchor post, 0.6' above ground, NW, 60.19'

Found Nail & Tag, Stephens Engineering, West side P. Pole, NE, 40.11'

Northwest corner block foundation house #1500, SSE, 114.41'

B. Description of corner evidence found and/or method applied in restoring or reestablishing corner:

Found what was believed to be a 1/2" bar with cap - cap number was destroyed; dug through 4" of asphalt; 3" of concrete with wire mesh and 2" of fine coarse gravel to discover that the 1/2" bar is actually a 4" concrete monument. After verifying the location of the monument, an Ingham County Remonumentation disk was fitted over the iron of the monument; and a monument box was put in place centered around the monument. The monument fit in accord with witnesses from LCRC recorded in 1978. Accepted monument as the best available evidence of the position of the original corner.

C. Description of monument for corner and accessories established to perpetuate locating the position of the corner:

Aluminum disk stamped PS 41103 set on 4" concrete monument

East centerline 4" steel Anchor post, 1' above ground, South, 29.91'

South centerline 4" steel Anchor post, 0.6' above ground, N40°W, 60.19'

Found Nail & Tag, Stephens Engineering, West side P. Pole, N45°E, 40.11'

Northwest corner block foundation house #1500, S20°E, 114.41'

NE edge of channel iron fence post, S05°W, 33.30'

S. edge of centerline of metal concrete fence post, N80°W, 67.90'

Signed by

Scott E. Koch

Date

12/17/02

Surveyor's Michigan License No.

41103

FORM APPROVED BY MICHIGAN STATE BOARD OF PROFESSIONAL SURVEYORS, JAN. 28, 1971

REVISED MAY 14, 1975

REVISED JAN. 1983

REVISED OCT., 1995

P.A. 345 INGHAM COUNTY

PEER APPROVED 6/04/02

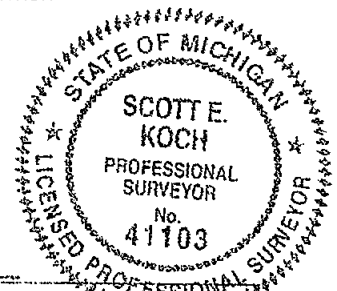

LAND CORNER RECORDATION CERTIFICATE
Filing Requirement of Act 74, Mich. P.A. 1970

For corners in
WHEATFIELD TOWNSHIP
INGHAM COUNTY

Located In:

Corner Code #

1. Public Land Survey

T 3N R 1E

1-2

2. Property Controlling
In Section

S

T R

3. Miscellaneous
Property in Sec.

S

T R

S

T R

Paula Johnson
INGHAM COUNTY
REGISTER OF DEEDS

RECORDED

L-10 P-382

CRNR 9.00

2002-083091

2002-083091

Page: 1 of 1

12/26/2002 03:35P

Register of Deeds Stamp & File Number

4. Lot No. _____, Recorded Plat _____

5. Private Claims _____

I, Scott E. Koch, in a field survey on April 16, 2002 do hereby state that under requirements of P.A. 74, Michigan P.A. of 1970, the corner points mentioned in lines 1 and 2 above were in conformance with regulations and rules therefore as required in the current manual of survey instructions of the United States Department of the Interior, Bureau of Land Management or by decree of a Court of Law and/or that the corner points mentioned in lines 3, 4 and 5 above were in conformance with the rules of the Michigan Board of Land Surveyors or by a Degree of a Court of Law; established, re-established, monumented, recovered, found as expressed below:

NOTE: Not more than 2 corners, all in the same town and range, may be recorded on this certificate.

A. Description of original monument and accessories and/or subsequent restoration:

March, 1826 - G.L.O., Joseph Wampler, Deputy Surveyor, (Page 40) North between Sec. 2 & 3, Set 1/4 sec. post, 40 chs. (2640 feet)
Beech 12 in. dia. N07°W, 8 lks. (5.28 feet)
Beech 10 in. dia. N63°E, 30 lks. (19.80 feet)

January 20, 1847 - County Surveyor Notes (Pages 192-193), A. Jackson, does not describe monument
Beech 12 in. dia. N07°W, 8 lks. (5.28 feet)
Beech 10 in. dia. N63°E, 30 lks. (19.80 feet)

May 3, 1876 - County Surveyor Notes (Pages 137-138), T. J. Brown, calls for a post, no witnesses given.

January 1, 1969 - Ingham County Road Commission Township Map, calls for a pipe, with fence West, 30.00 feet.

March 27, 1969 - MDSHT Government Monument Witness Card Form 280 calls for a 3/4" iron, no witnesses given.

June 6, 1979 - PA 74 (Liber 5, Page 247) Ronnie M. Lester, PS #18998, Excavated a hole 4.2' x 5.5' to an average depth of 3.0' on the centerline of Corwin Road and on fence lines to the East and West. Found a 3/4" pipe 0.8' below road surface on the centerline of Corwin Road and on line with power poles to the East and West. Measured North approx. 2240' to I-1 and South approx. 2650' to I-3 both measurements in close accord with G.L.O. distances. Accepted 3/4" iron pipe for corner as called for by Government Monument Witness Form 280 and in the records of the Ingham County Road Commission. Set 4" x 36" concrete Monument.

Found Nail & Tag, Stephens Engineering, S. Side P. Pole, East, 25.78'
Found Nail & Tag, Stephens Engineering, N. Side P. Pole, WNW, 28.62'
Nail & Tag, #18998, NW side 4" Elm, NE, 47.17'
Nail & Tag, #18998, SW side 4" Cherry, SE, 42.31'

B. Description of corner evidence found and/or method applied in restoring or reestablishing corner:

Found 1/2" bar in concrete as called for on PA 74 recorded in Liber 5, Page 247. Monument lies approx. 3' West of centerline of Corwin Road, according to PA 74 recorded in Liber 5, Page 247 monument measures in accord with G.L.O. Set Ingham County Remonumentation cap stamped 41103 on found 1/2" bar in concrete. Accepted iron in concrete as the best available evidence of the position of original corner.

C. Description of monument for corner and accessories established to perpetuate locating the position of the corner:

Set Ingham County Remonumentation Aluminum cap stamped PS 411 on 1/2" bar in concrete.

Found Nail & Tag #25832 in 6" Elm, N30°E, 60.91'
Found Nail & Tag #25832 in North face of Power Pole, East, 26.08'
Found Nail & Tag in NE face of wood fence post, N83°W, 30.40'
Found Nail & Tag #25832 in North face of Power Pole, N89°W, 28.32'

Signed by

Date

12/17/02

Surveyor's Michigan License No. 41103

FORM APPROVED BY MICHIGAN STATE BOARD OF PROFESSIONAL SURVEYORS, JAN. 28, 1971
REVISED MAY 14, 1975
REVISED JAN., 1983
REVISED OCT., 1995

P.A. 345 INGHAM COUNTY
PEER APPROVED 6/04/2007

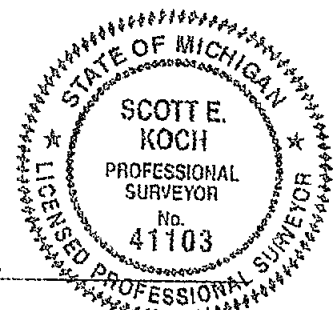

LAND CORNER RECORDATION CERTIFICATE
Filing Requirement of Act 74, Mich. P.A. 1970

For corners in
WHEATFIELD TOWNSHIP
INGHAM COUNTY

Located In:

Corner Code #

1. Public Land Survey

T 3N R 1E

I-1

T R

T R

T R

S T R

S T R

S T R

2. Property Controlling
In Section

3. Miscellaneous
Property in Sec.

Paula Johnson
INGHAM COUNTY
REGISTER OF DEEDS

RECORDED

L-10 P-386

CRNR 11.00

2002-083095

2002-083095

Page: 1 of 2

12/26/2002 03:35P

Register of Deeds Stamp & File Number

4. Lot No. _____, Recorded Plat _____

5. Private Claims _____

I, Scott E. Koch, in a field survey on April 15, 2002 do hereby state that under requirements of P.A. 74, Michigan P.A. of 1970, the corner points mentioned in lines 1 and 2 above were in conformance with regulations and rules therefore as required in the current manual of survey instructions of the United States Department of the Interior, Bureau of Land Management or by decree of a Court of Law and/or that the corner points mentioned in lines 3, 4 and 5 above were in conformance with the rules of the Michigan Board of Land Surveyors or by a Degree of a Court of Law; established, re-established, monumented, recovered, found as expressed below:

NOTE: Not more than 2 corners, all in the same town and range, may be recorded on this certificate.

A. Description of original monument and accessories and/or subsequent restoration:

March, 1826 - G.L.O., Joseph Wampler, Deputy Surveyor, (Page 40) North between Sec. 2 & 3, intersected North boundary 100 lks West of post, Set post, 74.18 chs. (4895.88 feet)

Beech 20 in. dia. S35°W, 35 lks. (23.10 feet)

Beech 11 in. dia. S36°E, 44 lks. (29.04 feet)

January 20, 1847 - County Surveyor Notes (Pages 192-193), A. Jackson, does not describe monument

Beech 20 in. dia. S35°W, 35 lks. (23.10 feet)

Beech 11 in. dia. S36°E, 44 lks. (29.04 feet)

May 3, 1876 - County Surveyor Notes (Pages 137-138), T. J. Brown, calls for a post, no witnesses given.

December 19, 1973 - PA 74 (Liber 3, Page 29) James A. Porter, PS #19003, Found 5/8" iron.

Railroad crossing sign, NNE, 11.45 feet

Nail in Power Pole, SSW, 12.00 feet

SW Corner Sec. 35, East 65.88 feet

Continued on Back

B. Description of corner evidence found and/or method applied in restoring or reestablishing corner:

Found 1/2" bar and cap #25832 in a monument box, 8.5 feet West of West side of pavement for Corwin Road. Appears to be a new monument box, and bar set by KEBS Inc. Corwin Road appears to have been reconstructed over the past year. Position matches location monumented by KEBS. Accepted KEBS bar as the best evidence available and replaced with Ingham County Remonumentation cap stamped PS 41103.

C. Description of monument for corner and accessories established to perpetuate locating the position of the corner:
Set Ingham County Remonumentation cap stamped PS 41103 over existing iron in monument box.

Fd. PK nail in West face of Power Pole, N10°W, 14.76'
Section Corner, SW corner Section 35, T4N, R1E, Fd 1 1/2" pipe, East, 65.90'
Found Nail and Tag #25832 in SW side 24" Sugar Maple, S30°E, 70.91'
Fd. Nail and Tag #25832 in East side of 30" Sugar Maple, S20°W, 68.20'



Signed by

Date 12/17/02

Surveyor's Michigan License No. 41103

FORM APPROVED BY MICHIGAN STATE BOARD OF PROFESSIONAL SURVEYORS, JAN. 28, 1971
REVISED MAY 14, 1975
REVISED JAN., 1983
REVISED OCT., 1995

P.A. 345 INGHAM COUNTY
PEER APPROVED 11/1/02 M

I-1 Wheatfield Township, Ingham County

October 19, 1987 – PA 74 (Liber 6, Page 349) Bruce L. Floyd, PS #28068, Reset corner from witnesses; 1/2" rerod with cap #28068 in ditch, West side of Corwin Road.

Aluminum corner fence post, S85°W, 23.38'

RR X sign, N05°E, 18.11'

PK nail in power pole, East, 33.05'

1" bar, SW corner Sec. 35, East, 65.88'

January 24, 2002 – PA 74 (Liber 10, Page 220) Jeffrey K. Autenrieth, PS #31588, Corner position recovered on October 24, 2001 prior to reconstruction of Corwin Road. Found 1/2" bar and cap #28068 (Bruce L. Floyd) as recorded in Liber 6 of Corners, Page 349. Also found monumentation from Liber 6 of Corners, Page 244, and from Liber 3 of Corners, Page 29, one to two feet deeper and within 0.20 feet of each other. Offset corner position outside of construction area. Returned on November 2, 2001, and reset 1/2" bar with "KEBS" cap in a monument box from offset witnesses set prior to reconstruction.

Set "KEBS" Nail & Tag in East side 30" Maple, S20°W, 69.36 feet

Set "KEBS" Nail & Tag in Southwest side 24" Maple, S30°E, 70.95 feet

Set "KEBS" Nail & Tag in West side Utility Pole, N35°E, 97.65 feet

Found Nail & Tag #30897 in North side Utility Pole, S65°W, 113.08 feet

1" Bar, Southwest Corner Section 35, Williamstown Township, East 65.88 feet

