

LAND CORNER RECORDATION CERTIFICATE
Filing Requirement of Act 74, Mich. P.A. 1970
WHEATFIELD TOWNSHIP

Liber 9 Page 1

For corners in

INGHAM
(County)

Located In:

Corner Code ##

1. Public Land Survey T 3N R 1E C-1
T R
T R
T R
2. Property Controlling S T R
in Section S T R
3. Miscellaneous S T R
Property in Sec. S T R

4. Lot No. , Recorded Plat
5. Private Claims

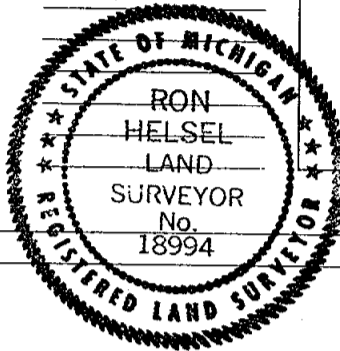

FILED
960037630

10/01/1996 11:13:20
REGISTER OF DEEDS
Paula Johnson
INGHAM COUNTY, MI

Register of Deeds Stamp & File Number

I, RON HELSEL, in a field survey on SEPT. 12, 19 96,
do hereby certify that under requirements of P.A. 74, Michigan P.A. of 1970, the corner points mentioned
in lines 1 and 2 above were in conformance with regulations and rules therefore as required in the
current manual of survey instructions of the United States Department of the Interior, Bureau of Land
Management or by a decree of a Court of Law and/or that the corner points mentioned in lines 3, 4 and 5
above were in conformance with the rules of the Michigan Board of Land Surveyors or by a Decree of a
Court of Law; established, re-established, monumented, re-monumented, recovered, found as
expressed below:

NOTE: Not more than 4 corners, all in the same town and range, may be recorded
on this certificate.

	A	B	C	D	E	F	G	H	I	J	K	L	M
2	6		5		4		3		2		1		
3													
4	7		8		9		10		11		12		
5													
6	18		17		16		15		14		13		
7													
8	19		20		21		22		23		24		
9													
10	30		29		28		27		26		25		
11													
12	31		32		33		34		35		36		
13													

- A. Description of original monument and accessories and/or subsequent restoration:
ORIGINAL MONUMENT: POST SET BY J. WAMPLER, U.S. DEPUTY SURVEYOR, MARCH, 1826,
74 LINKS WEST OF POST
BEECH 8", S15 1/2W, 27 LINKS
BEECH 8", S49°E, 44 LINKS
1) A SURVEY WAS RECORDED IN LIBER 3, PGS. 578 & 579, FIELD DATED NOV. 03, 1977
BY A. PIERSON P.S. NO. 13039. HIS SURVEY IGNORED THIS CORNER AND LINE WAS
RAN FROM D-1 TO A-1 ALONG THE TOWNSHIP LINE.
2) DID NOT FIND FURTHER MENTION OF THIS CORNER IN PUBLIC OR PRIVATE RECORDS.
- B. Description of corner evidence found and/or method applied in restoring or reestablishing corner:
NO EVIDENCE WAS FOUND IN THE PROBABLE AREA OF THIS CORNER. OWNERSHIP BOTH
NORTH AND SOUTH OF THE TOWNSHIP LINE HAS BEEN DEEDED WITH SECTIONS 5 & 6
ALONG WITH SECTIONS 31 & 32 AS PARENT PARCELS, RESPECTIVELY. DEEMED
THIS CORNER TO BE LOST AND SET THE CORNER AT THE GOVERNMENT FALLING OF 74
LINKS WEST OF C-13 (T4N, R1E). CORNER LANDED IN THE SOUTH EDGE OF A 14"
W. CHERRY. SET 3/4" X 24" STANDARD FORM PIN & CAP 3.00 FEET SOUTH OF THE
CORNER ON LINE WITH C-2 (1/4 COR. COMMON TO SEC. 5 & SEC. 6).
- C. Description of monument for corner and accessories established to perpetuate locating the position of the corner:
3/4" X 24" STEEL FORM PIN WITH CAP LABELED P.A. 345, P.S. NO. 18994 3.00 FEET
SOUTH AND ON SECTION LINE TO SOUTH.
SET NAIL & TAG NO. 18994 ON SOUTH/SIDE POWER POLE AZ. 288°, 46.35 FEET
SET NAIL & TAG NO. 18994 ON EAST/SIDE 14" W. CHERRY AZ. 08°, 3.32 FEET
SW COR. OF CONC. DRIVEWAY TO HOUSE #3560 az. 43°, 67.99 FEET
SE COR. OF CONC. DRIVEWAY TO HOUSE #3560 AZ. 59°, 88.41 FEET

Signed by Ron Helsel Date SEPT. 18, 1996
Surveyor's Michigan License No. 18994

P.A. 345 INGHAM COUNTY
PEER APPROVED 9/19/96 RL

LAND CORNER RECORDATION CERTIFICATE
Filing Requirement of Act 74, Mich. P.A. 1970

For corners in

INGHAM
 (County)

Located In:

WHEATFIELD TOWNSHIP

Corner Code =#

FILED

960034294
 09/06/1996 13:18:32
 REGISTER OF DEEDS
 Paula Johnson
 INGHAM COUNTY, MI

1. Public Land Survey

T 3N R 1E

C-2

T _____ R _____

T _____ R _____

T _____ R _____

2. Property Controlling
in Section

S _____ T _____ R _____

S _____ T _____ R _____

3. Miscellaneous
Property in Sec.

S _____ T _____ R _____

S _____ T _____ R _____

4. Lot No. _____, Recorded Plat _____

5. Private Claims _____



Register of Deeds Stamp & File Number

I, RON HELSEL, in a field survey on MAY 8, 19 96

do hereby certify that under requirements of P.A. 74, Michigan P.A. of 1970, the corner points mentioned in lines 1 and 2 above were in conformance with regulations and rules therefore as required in the current manual of survey instructions of the United States Department of the Interior, Bureau of Land Management or by a decree of a Court of Law and/or that the corner points mentioned in lines 3, 4 and 5 above were in conformance with the rules of the Michigan Board of Land Surveyors or by a Decree of a Court of Law; established, re-established, monumented, re-monumented, recovered, found as expressed below:

NOTE: Not more than 4 corners, all in the same town and range, may be recorded on this certificate.

A. Description of original monument and accessories and/or subsequent restoration:

ORIGINAL MONUMENT: POST SET BY J. WAMPLER, U.S. DEPUTY SURVEYOR, MARCH, 1826.
 BEECH 17" S34E, 16 LINKS
 BEECH 11" N42W, 29 LINKS

1) FROM INGHAM COUNTY DOSSIER, FOLDER 1, PAGE 1, DATED FEB. 18, 1901, E.A. CALKINS CO. SURVEYOR, ELM 6" N67 1/2E, 62 1/2 LINKS
 SURVEY ONLY APPLIED TO CORNERS AND DID NOT DESCRIBE MARKERS OR GIVE MEASUREMENTS.

2) A SURVEY WAS RECORDED IN LIBER 3, PGS. 578 & 579, DATED 11-3-77 BY A.S. PIERSON NO. 13039.

B. Description of corner evidence found and/or method applied in restoring or reestablishing corner:

"CONTINUED ON BACK"

FOUND DRIVE SHAFT AS DESCRIBED BY SURVEYOR STEADMAN IN EAST-WEST FENCE LINE. EXCAVATED 10 FEET WEST AND EAST ALONG FENCE LINES FROM THE SHAFT. DID NOT FIND ANY INDICATION OF THE CORNER. ACCEPTED THE DRIVE SHAFT AS SET BY STEADMAN AS A MARKER FOR THE CORNER. CORNER COMPUTED TO BE 2.13 FEET NORTH OF THE LINE BETWEEN D-2 (CENTER OF SEC. 5) AND A-2 (WEST 1/4 COR. OF SEC. 6).

C. Description of monument for corner and accessories established to perpetuate locating the position of the corner:

4 FOOT BY 2" IRON DRIVE SHAFT WITH 6" BELL END WITH CAP LABELED P.A. 345, P.S. NO. 18994 AT GROUND LEVEL IN E-W FENCE LINE
 SET NAIL & TAG NO. 18994 EAST/SIDE 20" BASSWOOD, AZ. 342°, 7.41'
 SET NAIL & TAG NO. 18994 NORTH/SIDE 24" BASSWOOD, AZ. 260°, 14.02'
 SET NAIL & TAG NO. 18994 NORTH/SIDE 24" OAK, AZ. 88°, 35.64'
 SET NAIL & TAG NO. 18994 SOUTH/SIDE 8" OAK, AZ. 84°, 16.20'
 SET NAIL & TAG NO. 18994 NW/SIDE 6" MAPLE, AZ. 47°, 10.42'
 MEAS. WEST, 550.15 FEET TO A-2
 MEAS. EAST, 2656.84 FEET TO D-2
 MEAS. SOUTH, 2622.51 FEET TO C-3

Signed by

Surveyor's Michigan License No.

Date

P.A. 345 INGHAM COUNTY

PEER APPROVED 8/22/96 RL

FORM APPROVED BY MICHIGAN STATE BOARD OF LAND SURVEYORS, JAN. 28, 1971
 REVISED MAY 14, 1975
 REVISED JAN., 1983

"A" CONTINUED

THE SURVEY ESTABLISHED AN EAST-WEST 1/4 LINE FROM THE WEST 1/4 CORNER OF SECTION 6 TO THE CENTER OF SECTION 5. THE VICINITY OF C-2 WAS LABELED AS APPROXIMATE SECTION LINE BETWEEN SEC. 5 & SEC. 6.

- 3) A L.C.R.C. WAS RECORDED IN LIBER 5, PAGE 140, DATED MAY 7, 1973 & RECORDED JAN. 16, 1979 BY R.W. STEADMAN NO. 11370. "FOUND ANCHOR POST AT THE 1/8 POST NEXT EAST AND AT THE CENTER OF THE SECTION NEXT EAST. PROJECTED THIS LINE WEST AND SET CORNER THE SAME DISTANCE WEST OF 1/8 POST THAT 1/8 POST IS WEST OF CENTER OF SECTION. CORNER FALLS IN EAST-WEST FENCE".

"SET 2" IRON DRIVE SHAFT 4' LONG WITH 6" BELL END JUST ABOVE GROUND LEVEL TO MARK THIS CORNER."

7" BASSWOOD N.W 7.73' (FOUND TREE)

14" BASSWOOD W.SW 13.92' (FOUND TREE)

14" OAK E.SE 35.85' (FOUND TREE)

- 4) A SURVEY WAS RECORDED IN LIBER 5, PAGES 506-507 BY R. LESTER P.S. NO. 18998, DATED SEPT. 8, 1988. HE RAN A LINE BETWEEN THE CENTER OF SECTION 5 AND THE WEST 1/4 COR. OF SEC. 6, AND IGNORED THIS CORNER.
- 5) A SURVEY WAS RECORDED IN LIBER 4, PAGES 1012-1013 BY R. LESTER, DATED MARCH 13, 1985. A LINE WAS RAN BETWEEN THE SAME CORNERS AS 4-A ABOVE.

Rept No	27477
CRNR	9.00
MSSR	2.00
Total	11.00

LAND CORNER RECORDATION CERTIFICATE

Liber

Page 625

Filing Requirement of Act 74, Mich. P.A. 1970

WHEATFIELD TOWNSHIP

For corners in

INGHAM
(County)

Located In:

Corner Code #/

1. Public Land Survey T 3N R 1E C-3
T R
T R
T R
2. Property Controlling S T R
in Section S T R
3. Miscellaneous S T R
Property in Sec. S T R

4. Lot No. , Recorded Plat
5. Private Claims

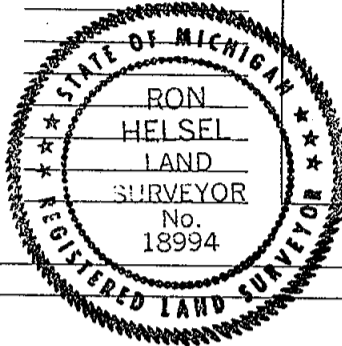

FILED

960034295
09/06/1996 13:18:33
REGISTER OF DEEDS
Paula Johnson
INGHAM COUNTY, MI

Register of Deeds Stamp & File Number

I, RON HELSEL, in a field survey on MAY 7, 1996, do hereby certify that under requirements of P.A. 74, Michigan P.A. of 1970, the corner points mentioned in lines 1 and 2 above were in conformance with regulations and rules therefore as required in the current manual of survey instructions of the United States Department of the Interior, Bureau of Land Management or by a decree of a Court of Law and/or that the corner points mentioned in lines 3, 4 and 5 above were in conformance with the rules of the Michigan Board of Land Surveyors or by a Decree of a Court of Law; established, re-established, monumented, re-monumented, recovered, found as expressed below:

NOTE: Not more than 4 corners, all in the same town and range, may be recorded on this certificate.

- A. Description of original monument and accessories and/or subsequent restoration:
ORIGINAL MONUMENT: POST SET BY J. WAMPLER, U.S. DEPUTY SURVEYOR, MARCH 1826.
SUGAR 7" N87E, 4 LINKS
BEECH 9" N60W, 29 LINKS
- 1) FROM ING. REMONT. DOSSIER CIRCA 1979, FOLDER #1, PAGE 11, JUNE 23, 1865, W. H. RAYNER CO. SURVEYOR, CORNER NOT IDENTIFIED.
ELM 4" S66 1/4E, 108 LINKS (GONE)
ELM 15" S19 3/4E, 107 LINKS (GONE)
- 2) FORM 280 MSHD CIRCA 1959-1960
1" IRON PIPE TO SURFACE FOUND STONE
19" ELM S62°W, 78.93' (GONE)

"CONTINUED ON BACK"

- B. Description of corner evidence found and/or method applied in restoring or reestablishing corner:
FOUND MON. BOX & 3/4" PIPE 1.5' BELOW SURFACE OF LINN RD. & 1.7' NORTH OF CENTERLINE. ROAD ± 3' OF FILL ABOVE EXISTING GROUND. EXCAVATED TO CLAY ROAD BED & ACCEPTED STEADMAN'S RECREATION OF THE CORNER FROM MDSH WITNESSES & MEASUREMENTS. RAISED 3/4" X 24" PIPE WITH STEEL SLEEVE AND MON. BOX COLLAR TO ROAD GRADE. SET CAP LABELED P.A. 345, P.S. NO. 18994 IN PIPE.

- C. Description of monument for corner and accessories established to perpetuate locating the position of the corner:
3/4" PIPE AND CAP IN MON. BOX 1.7' NORTH CENTERLINE LINN ROAD
FOUND NAIL & TAG NO. 11370 SOUTH/SIDE UTILITY POLE, AZ. 78°, 86.10 FEET
FOUND NAIL & TAG NO. 17640 SOUTH/SIDE TWIN 10" MAPLE, AZ. 73°, 61.25 FEET
SET NAIL & TAG NO. 18994 WEST/SIDE 12" ELM, AZ. 42°, 34.16 FEET
SET NAIL & TAG NO. 18994 SOUTH/SIDE 8" ELM, AZ. 315°, 55.91 FEET
SET NAIL & TAG NO. 18994 SW/SIDE 10" ELM, AZ. 305°, 41.46 FEET
SET NAIL & TAG NO. 18994 NW/SIDE QUAD 10" BASSWOOD, AZ. 59°, 51.18 FEET

Signed by

Ron Helsel

Date

Aug. 15, 1996

Surveyor's Michigan License No.

18994

P.A. 345 INGHAM COUNTY
PEER APPROVED 8/22/96 RL

FORM APPROVED BY MICHIGAN STATE BOARD OF LAND SURVEYORS, JAN. 28, 1971
REVISED MAY 14, 1975
REVISED JAN., 1983

"A" CONTINUED

- 20" ELM S38°W, 44.07' (GONE)
 12" ELM S22°E, 35.82' (GONE)
- 3) INGHAM COUNTY ROAD COM. MAP
 3/4" PIPE COR POST N. 30.0' (GONE)
 COR POST S, 25.3' (GONE)
 P.P. W.S.W. 34.3' (GONE)
 19" ELM S62°W, 78.9'
 20" ELM S38°W, 44.1'
 12" ELM S22°E, 35.8'
- 4) A L.C.R.C. WAS RECORDED IN LIBER 4, PAGE 220, FIELD DATED, 8-16-73 BY P.S. M. FOUTY NO. 18989. "FOUND 1/2" IRON BAR IN MONUMENT BOX IN LINN ROAD".
 NW COR. SECTION 8, T3N, R1E, 1/2' BAR IN MON. BOX
 NAIL & TAG WEST SIDE 3" ELM, NORTH 25.41' (SEE BELOW)
 NAIL & TAG IN UTILITY POLE ENE 86.09' (FOUND, SEE BELOW)
 NAIL & TAG IN 3" ELM, ESE, 55.55' (GONE)
- 5) A L.C.R.C. WAS RECORDED IN LIBER 5, PAGE 150, FIELD DATED APRIL 25, 1973 (RECORDED 1-16-79) BY P.S. R. STEADMAN NO. 11370. "CORNER WAS SET FROM MDSH WITNESS AFTER EXCAVATION". SET 3/4" PIPE AND MON. BOX
 3" ELM NORTH 25.41' (FOUND STUMP OF 8" ELM)
 TELEPHONE POLE ENE 86.09 FEET (FOUND)
 3" ELM ESE 55.55 FEET (GONE)
- 6) A SURVEY WAS RECORDED IN LIBER 1, PAGE 914-915 AUG. 30, 1973 BY M. FOUTY WITNESSED SAME AS (4-A) ABOVE.
- 7) SURVEYS WERE RECORDED IN LIBER 5, PAGES 166 AND 197, DATED 26 NOV. 86 & 14 APRIL 87 BY G.M. YOUNG P.S. NO. 17640. THE SURVEY REC. IN LIBER 5, PG. 197 SUPERCEDED THE SURVEY IN LIBER 5, PG. 166.
 FOUND 3/4" IRON PIPE AND MON. BOX
 WITNESSED THE SAME AS (5-A) ABOVE

Rept No	27477
CRNR	9.00
MSSR	2.00
Total	11.00

679

LAND CORNER RECORDATION CERTIFICATE

Liber

9 Page

49

Filing Requirement of Act 74, Mich. P.A. 1970

WHEATFIELD TOWNSHIP

For corners in

INGHAM
(County)

Located in:

Corner Code #

1. Public Land Survey T 3N R 1E D-1
T R
T R
T R
2. Property Controlling S T R
in Section S T R
3. Miscellaneous S T R
Property in Sec. S T R

4. Lot No. , Recorded Plat
5. Private Claims

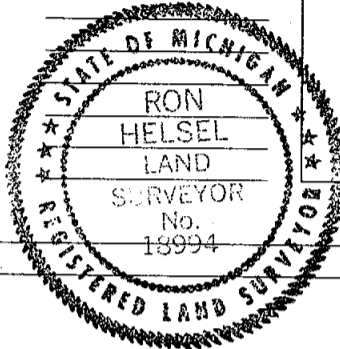

FILED

RECORDED
960043082
11/08/1996 14:28:41
REGISTER OF DEEDS
Paula Johnson
INGHAM COUNTY, MI

Register of Deeds Stamp & File Number

	A	B	C	D	E	F	G	H	I	J	K	L	M
2	6		5		4		3		2		1		
3													
4	7		8		9		10		11		12		
5													
6	18		17		16		15		14		13		
7													
8	19		20		21		22		23		24		
9													
10	30		29		28		27		26		25		
11													
12	31		32		33		34		35		36		
13													

I, RON HELSEL, in a field survey on Sept. 6, 19 96, do hereby certify that under requirements of P.A. 74, Michigan P.A. of 1970, the corner points mentioned in lines 1 and 2 above were in conformance with regulations and rules therefore as required in the current manual of survey instructions of the United States Department of the Interior, Bureau of Land Management or by a decree of a Court of Law and/or that the corner points mentioned in lines 3, 4 and 5 above were in conformance with the rules of the Michigan Board of Land Surveyors or by a Decree of a Court of Law; established, re-established, monumented, re-monumented, recovered, found as expressed below:

NOTE: Not more than 4 corners, all in the same town and range, may be recorded on this certificate.

A. Description of original monument and accessories and/or subsequent restoration:

THIS CORNER WAS NOT SET IN THE ORIGINAL GOVERNMENT SURVEY

- 1) DID NOT FIND ANY COUNTY SURVEYOR RECORDS REFERENCED TO THIS CORNER.
- 2) A L.C.R.C. WAS RECORDED BY A. PIERSON NO. 13039 IN LIBER 5, PG. 149, FIELD DATED NOV. 3, 1977 AND RECORDED 1-16-1979. "FOUND REMAINS OF OLD WOOD ANCHOR POST AT INTERSECTION OF FENCES EAST, WEST, AND SOUTH". "DROVE "T" IRON FENCE POST IN REMAINS OF OLD ANCHOR POST. NOT WITNESSED; NO AVAILABLE WITNESS OBJECTS NEAR CORNER." A SURVEY BY PIERSON, RECORDED IN LIBER 3, PGS. 578 & 579, DATED NOV. 3, 1977 CALLED FOR THE STEEL "T" POST WITH NO WITNESSES.

CONTINUED ON BACK

B. Description of corner evidence found and/or method applied in restoring or reestablishing corner:

FOUND STEEL "T" FENCE POST DRIVEN INTO REMAINS OF OLD ANCHOR POST AT REMAINS OF FENCE LINES NORTH, SOUTH, EAST & WEST. POSITION OF THE POST WAS 0.5'± WEST OF THE SOUTH 1/4 CORNER (D-13) OF SECTION 32, T4N, R1E. A TRAVERSE OF THE TOWNSHIP LINE DEEMED THIS POSITION NOT TO BE IN ACCORD WITH THE GOVERNMENT SURVEY OF SECTION 5. EXCAVATED A 6' X 4' HOLE 49.8'± WEST OF D-13 AND FOUND A PIECE OF ROTTED ANCHOR POST WRAPPED IN FENCE WIRE UNDER GRASS AND 2" OF TOPSOIL IN THE REMAINS OF AN EAST-WEST FENCE LINE AND IN A PLOW ROW BETWEEN FIELDS NORTH & SOUTH. AT 8" DEEP FOUND A 10" ROUND STONE, UNDER THIS STONE 2.5' DEEP FOUND A POINTED DIAMOND SHAPED STONE 16" LONG & 10" WIDE LEANING TO THE SOUTH IN A CIRCLE OF FIELD STONES AND CHUNKS OF CLAY POTTERY. RAISED STONE TO GRADE AND SET ON SOUTH SIDE OF 3/4" X 24" STEEL FORM PIN & CAP LABELED P.A. 345, NO. 18994. ACCEPTED THE STONE AS A MARKER SET BY A COUNTY SURVEYOR IN AN UNRECORDED SURVEY. THE MEAN GOVERNMENT SURVEY FALLINGS FOR C-1 & E-1 AVERAGED 49.83 FEET.

CONTINUED ON BACK

C. Description of monument for corner and accessories established to perpetuate locating the position of the corner:

3/4" X 24" STEEL FORM PIN AND CAP IN NORTH SIDE OF POINTED DIAMOND SHAPED STONE IN REMNANTS OF EAST-WEST FENCE LINE.
EAST, 49.19 FEET D-13 T4N, R1E (1 1/2" STEEL PIPE)
EAST, 14'± CENTER OF DEAD ELM CLUMP
SET NAIL & TAG NO. 18994 N/SIDE 5" ELM, AZ. 274°, 34.55'
SET NAIL & TAG NO. 18994 SE/SIDE 10" ASPEN, AZ. 47°, 70.83'
SET NAIL & TAG NO. 18994 N/SIDE 14" CHERRY, AZ. 66°, 50.56'
MEAS. WEST TO NW COR (5) 2638.07'
MEAS. EAST TO NE COR (5) 2633.55'
MEAS. SOUTH TO C.O.S. (5) 2300.18'

Signed by

Ron Helsel

Date SEPT. 16, 1996

Surveyor's Michigan License No. 18994

P.A. 345 INGHAM COUNTY

PEER APPROVED 10/17/96 *M*

FORM APPROVED BY MICHIGAN STATE BOARD OF LAND SURVEYORS, JAN. 28, 1971

REVISED MAY 14, 1975

REVISED JAN., 1983

"A" CONTINUED

- 3) SURVEYS BY R. LESTER NO. 18998, RECORDED IN LIBER 4, PGS. 1012 & 1013, DATED 3-13-85 AND IN LIBER 5, PGS. 507 & 508, DATED 9-8-88, CALLED FOR A "STEEL FENCE POST IN FENCE CORNER. FENCES NORTH, SOUTH, EAST, & WEST".

"B" CONTINUED

MEASURED 49.19 FEET EAST TO D-13. (SOUTH 1/4 COR SEC. 32 T4N, R1E)

INDEXED COPY
b7c b7d
REGISTERED OF DEEDS
JAN 10 1989
RECORDED
FILED

FILED

2 1986

22

LAND CORNER RECORDATION CERTIFICATE
Filing Requirement of Act 74, Mich. P.A. 1970
WHEATFIELD TOWNSHIP

For corners in

INGHAM
(County)

Located In:

Corner Code #

FILED

960034296
09/06/1996 13:18:34
REGISTER OF DEEDS
Paula Johnson
INGHAM COUNTY, MI

1. Public Land Survey T 3N R 1E D-2
T R
T R
T R
2. Property Controlling S T R
in Section S T R
3. Miscellaneous S T R
Property in Sec. S T R



Register of Deeds Stamp & File Number

4. Lot No. , Recorded Plat
5. Private Claims

	A	B	C	D	E	F	G	H	I	J	K	L	M
2	6		5		4		3		2		1		
3													
4	7		8		9		10		11		12		
5													
6	18		17		16		15		14		13		
7													
8	19		20		21		22		23		24		
9													
10	30		29		28		27		26		25		
11													
12	31		32		33		34		35		36		
13													

I, RON HELSEL, in a field survey on MAY 18, 19 96, do hereby certify that under requirements of P.A. 74, Michigan P.A. of 1970, the corner points mentioned in lines 1 and 2 above were in conformance with regulations and rules therefore as required in the current manual of survey instructions of the United States Department of the Interior, Bureau of Land Management or by a decree of a Court of Law and/or that the corner points mentioned in lines 3, 4 and 5 above were in conformance with the rules of the Michigan Board of Land Surveyors or by a Decree of a Court of Law; established, re-established, monumented, re-monumented, recovered, found as expressed below:

NOTE: Not more than 4 corners, all in the same town and range, may be recorded on this certificate.

- A. Description of original monument and accessories and/or subsequent restoration:
THIS CORNER WAS NOT SET IN THE ORIGINAL GOVERNMENT SURVEYS. DID NOT FIND ANY COUNTY SURVEYS REFERENCE TO THIS CORNER.
1) A L.C.R.C. WAS RECORDED BY R. STEADMAN P.S. NO. 11370, FIELD DATED MAY 10, 1973 AND RECORDED JAN. 16, 1979 IN LIBER 5, PAGE 148. HE USED THE WOOD ANCHOR POST AT THE "INTERSECTION OF FENCES NORTH, SOUTH, EAST AND WEST.
1 1/2" OAK SE 5.40 FEET
3" OAK SW 18.20 FEET
3" APPLE SOUTH 5.50 FEET
"CONTINUED ON BACK"
- B. Description of corner evidence found and/or method applied in restoring or reestablishing corner:
FOUND T-BAR FENCE POST DRIVEN INTO THE CENTER OF THE ROTTED REMAINS OF A VERY OLD WOOD ANCHOR POST. FENCES TO NORTH, SOUTH, EAST & WEST. LOCATED ON THE SOUTH BANK OF A EAST-WEST DRAIN. EXCAVATED A CIRCLE AROUND THE OLD POST DOWN ABOUT 2 FEET. FOUND SEVERAL STONES BUT NOTHING ELSE. COMPUTED LOCATION OF THE STEEL POST AS BEING 0.55' SOUTH OF A LINE BETWEEN THE EAST-WEST 1/4 CORNERS AND 1.4 FEET ± WEST OF THE LINE BETWEEN THE NORTH-SOUTH 1/4 CORNERS. ACCEPTED THE POSITION OF THE STEEL FENCE POST AS THE LOCATION OF THE CENTER OF SECTION 5. SET A 3/4" X 24" STEEL FORM PIN & CAP LABELED P.A. 345, P.S. NO. 18994 ON THE SOUTH OF THE STEEL POST TO CONFORM WITH P.A. 345.
- C. Description of monument for corner and accessories established to perpetuate locating the position of the corner:
STEEL "T" FENCE POST ON S/BANK OF DRAIN
FOUND NAIL & TAG NO. 11370 NORTH/SIDE 4" OAK AZ. 168°, 5.65'
FOUND NAIL & TAG NO. 11370 NW/SIDE 6" OAK AZ. 205°, 18.70'
SET NAIL & TAG NO. 18994 SOUTH/SIDE 14" BUTTERNUT AZ. 272°, 6.28'
SET NAIL & TAG NO. 18994 EAST/SIDE 4" OAK AZ. 260°, 14.87'
MEA. 2640.86' TO EAST 1/4 CORNER
MEA. 2656.84' TO WEST 1/4 CORNER
MEA. 2618.60' TO SOUTH 1/4 CORNER

Signed by

Ron Helsel

Date

AUG. 19, 1996

Surveyor's Michigan License No.

18994

P.A. 345 INGHAM COUNTY

PEER APPROVED B/22/96 RL

FORM APPROVED BY MICHIGAN STATE BOARD OF LAND SURVEYORS, JAN. 28, 1971
REVISED MAY 14, 1975
REVISED JAN., 1983

"A" CONTINUED

- 2) A SURVEY WAS RECORDED IN LIBER 3, PAGES 578 -579 BY A. PIERSON, P.S. NO. 13039, FIELD DATED 11-03-1977 AND RECORDED 10-8-78. HE SET A STEEL FENCE POST IN THE REMAINS OF THE OLD WOOD ANCHOR POST DESCRIBED BY STEADMAN (1-A ABOVE). NO WITNESSES WERE GIVEN.
- 3) SURVEYS WERE RECORDED IN LIBER 4, PGS. 1012-1013, DATED 3-13-85 AND IN LIBER 5, PGS. 507-508, DATED SEPT. 8, 1988 BY R. LESTER P.S. NO. 18998. BOTH SURVEYS CALLED A STEEL FENCE POST ON THE SOUTH BANK OF AN EAST-WEST DRAIN AT THE INTERSECTION OF FENCES TO EAST, WEST & NORTH. LIBER 4 SURVEY CITED THE SAME WITNESSES AS L.C.R.C. (1-A ABOVE). THE LIBER 5 SURVEY WAS WITNESSED AS:
3" OAK S.E. 5.4' (FOUND)
5" OAK S.W. 18.2' (FOUND)
5" APPLE SOUTH, 5.5' (GONE)
- 4) A SURVEY WAS RECORDED IN LIBER 5, PG. 125 BY D. LOHR P.S. NO. 30090, DATED 5-29-1986. STEADMAN'S L.C.R.C. IN (1-A ABOVE) WAS CITED WITH NO WITNESSES.
- 5) A SURVEY WAS RECORDED IN LIBER 5, PG. 166, DATED 26, NOV. 1986 AND RERECORDED IN LIBER 5, PG. 197, DATED 14, APRIL, 1987 BY G. YOUNG P.S. NO. 17640. HE CITED THE WITNESSES THE SAME AS L.C.R.C. BY STEADMAN (1-A ABOVE).
- 6) A SURVEY WAS RECORDED IN LIBER 5, PG. 405 DATED DEC. 1987 BY G. YOUNG. "FOUND WOOD ANCHOR POST" WITNESSES SAME AS ABOVE.

Rept No	27477
CRNR	9.00
MSSR	2.00
Total	11.00

702

LAND CORNER RECORDATION CERTIFICATE

Filing Requirement of Act 74, Mich. P.A. 1970

FILED

For corners in

INGHAM
(County)Located In: WHEATFIELD TOWNSHIP
Corner Code =#

1. Public Land Survey T 3N R 1E D-3
T _____ R _____
T _____ R _____
T _____ R _____
2. Property Controlling S _____ T _____ R _____
in Section S _____ T _____ R _____
3. Miscellaneous S _____ T _____ R _____
Property in Sec. S _____ T _____ R _____

NOV 29 9 53 AM '95

REGISTER OF DEEDS

Ingham County, Mich.

Register of Deeds Stamp & File Number

4. Lot No. _____, Recorded Plat _____
5. Private Claims _____

I, RON HELSEL, in a field survey on OCTOBER 19, 19 95, do hereby certify that under requirements of P.A. 74, Michigan P.A. of 1970, the corner points mentioned in lines 1 and 2 above were in conformance with regulations and rules therefore as required in the current manual of survey instructions of the United States Department of the Interior, Bureau of Land Management or by a decree of a Court of Law and/or that the corner points mentioned in lines 3, 4 and 5 above were in conformance with the rules of the Michigan Board of Land Surveyors or by a Decree of a Court of Law; established, re-established, monumented, re-monumented, recovered, found as expressed below:

NOTE: Not more than 4 corners, all in the same town and range, may be recorded on this certificate.

	A	B	C	D	E	F	G	H	I	J	K	L	M
2	6		5		4		3		2		1		
3													
4	7		8		9		10		11		12		
5													
6	18		17		16		15		14		13		
7													
8	19		20		21		22		23		24		
9													
10	30		29		28		27		26		25		
11													
12	31		32		33		34		35		36		
13													

- A. Description of original monument and accessories and/or subsequent restoration:
ORIGINAL MONUMENT: POST SET BY J. WAMPLER U.S. DEPUTY SURVEYOR, MARCH 1826.
BEECH 18, S70W, 16 LINKS
BEECH 9, S44E, 21 LINKS

- 1) FROM THE OFFICE OF FRED WHITE ENGINEERING, MDSH FORM 280 CARD, CIRCA 1950'S. 1" IRON PIPE TO SURFACE, FOUND STONE.
23" ELM, S10°E, 26.20' (FOUND STUMP)
17" ELM, N56°E, 55.46' (GONE)
15" ELM, N50°W, 47.54' (FOUND STUMP)

(CONTINUED ON BACK)

- B. Description of corner evidence found and/or method applied in restoring or reestablishing corner:
FOUND 1/2" REBAR IN MON. BOX 1.0' NORTH OF CENTERLINE OF LINN ROAD ON OLD FENCE LINES NORTH & SOUTH. EXCAVATED AND FOUND 3' DEEP A 4" X 6" X 12" SQUARE SHAPED STONE WRAPPED IN FENCE AND WIRE UNDER THE REBAR. ACCEPTED THE POSITION OF THE REBAR ALONG WITH ELM STUMPS FROM MDSH WITNESSES AS THE MARKER FOR THIS CORNER. SET 3/4" X 24" FORM PIN AND CAP P.A. 345, P.S. 18994.

- C. Description of monument for corner and accessories established to perpetuate locating the position of the corner:
3/4" BY 24" FORM PIN AND CAP.

CENTERLINE 4" STEEL ANCHOR POST AZ. 3°, 32.96'
SET NAIL & TAG #18994 NW SIDE 8" ALDER AZ. 114°, 103.46'
SET NAIL & TAG #18994 NORTH SIDE 10" ELM AZ. 242°, 49.92'
FOUND STEPHENS NAIL & TAG #16053 W/SIDE 36" OAK AZ. 71°, 123.62'
FOUND BRYAN NAIL & TAG #25832 SW/SIDE 10" CHERRY AZ. 13°, 38.43'



Signed by Ron Helsel Date NOV. 6, 1995
Surveyor's Michigan License No. 18994

"A" CONTINUED

- 2) SURVEYS WERE RECORDED IN LIBER 1, PAGES 585 & 586 DATED DEC. 27, 1972 TOGETHER WITH A L.C.R.C. RECORDED IN LIBER 2, PAGE 357, DATED DEC. 26, 1972 BY J.E. STEPHENS #16053. HE FOUND A 1/2" IRON ROD IN THE CENTERLINE OF LINN ROAD ON LINE WITH FENCES NORTH & SOUTH N2°55'W, 32.80' TO SOUTH EDGE OF 4" PIPE ANCHOR POST (FOUND)
SURVEY TAG IN W. SIDE OF 36" OAK, N75°55'E, 123.70' (FOUND)
SURVEY TAG IN N. SIDE OF 36" DEAD ELM, S14°04'E, 25.73' (FOUND STUMP)
- 3) A SURVEY RECORDED IN LIBER 1, PAGES 914-915, DATED 8-30-73 BY M.F. FOUTY #18989 CALLED FOR AN IRON BAR IN MON BOX.
NAIL & TAG IN WEST SIDE 3" CRABAPPLE SSE, 40.65' (GONE)
CENTERLINE 4" STEEL ANCHOR POST NORTH 32.98' (FOUND)
- 4) A SURVEY RECORDED IN LIBER 5, PAGE 125, DATED MAY 29, 1986 BY D.R. LOHR #30090 DID NOT IDENTIFY OR GIVE WITNESSES TO THIS CORNER.
- 5) A SURVEY RECORDED IN LIBER 5, PAGE 197, DATED APRIL 14, 1987 BY G.M. YOUNG #17640 CALLED FOR A 1/2" IRON ROD WITH WITNESSES THE SAME AS "2-A" ABOVE.
- 6) A SURVEY RECORDED IN LIBER 5, PAGES 405-406 BY G.M. YOUNG, DEC. 1987 DID NOT IDENTIFY OR GIVE WITNESSES TO THIS CORNER.
- 7) SURVEYS BY L.A. BRYAN #25832 RECORDED IN LIBER 6, PAGES 24-25 & LIBER 6, PAGES 28-29, DATED JAN. 27, 1989 & MAY 31, 1989 RESPECTIVELY CALLED FOR A 1/2" BAR IN MON. BOX 1' NORTH CENTERLINE OF LINN RD.
FOUND NAIL & TAG #3829 WEST SIDE 30" OAK, N80°E, 123.70'
BOLT ON EAST SIDE 4" STEEL POST, NORTH, 32.98' (FOUND)
SET NAIL & TAG SW SIDE 12" CHERRY, N15W, 38.43' (FOUND)
- 8) A SURVEY RECORDED IN LIBER 6, PAGES 824-825, MAY 31, 1990 BY M.F. FOUTY #18989 CITED L2, P. 355 L.C.R.C. ONLY.

LAND CORNER RECORDATION CERTIFICATE

Liber

8 Page 622

Filing Requirement of Act 74, Mich. P.A. 1970

WHEATFIELD TOWNSHIP

For corners in
INGHAM
(County)

Located In:

Corner Code =#

FILED

960034293
09/06/1996 13:18:30
REGISTER OF DEEDS
Paula Johnson
INGHAM COUNTY, MI

- | | | | | | |
|------------------------------------|---|----|---|----|-----|
| 1. Public Land Survey | T | 3N | R | 1E | E-1 |
| | T | | R | | |
| | T | | R | | |
| | T | | R | | |
| 2. Property Controlling in Section | S | | T | R | |
| | S | | T | R | |
| 3. Miscellaneous Property in Sec. | S | | T | R | |
| | S | | T | R | |

Register of Deeds Stamp & File Number

4. Lot No. _____, Recorded Plat _____
5. Private Claims _____

	A	B	C	D	E	F	G	H	I	J	K	L	M
2	6		5		4		3		2		1		
3													
4	7		8		9		10		11		12		
5													
6	18		17		16		15		14		13		
7													
8	19		20		21		22		23		24		
9													
10	30		29		28		27		26		25		
11													
12	31		32		33		34		35		36		
13													

I, RON HELSEL, in a field survey on NOVEMBER 14, 1995, do hereby certify that under requirements of P.A. 74, Michigan P.A. of 1970, the corner points mentioned in lines 1 and 2 above were in conformance with regulations and rules therefore as required in the current manual of survey instructions of the United States Department of the Interior, Bureau of Land Management or by a decree of a Court of Law and/or that the corner points mentioned in lines 3, 4 and 5 above were in conformance with the rules of the Michigan Board of Land Surveyors or by a Decree of a Court of Law; established, re-established, monumented, re-monumented, recovered, found as expressed below:

NOTE: Not more than 4 corners, all in the same town and range, may be recorded on this certificate.

- A. Description of original monument and accessories and/or subsequent restoration:
ORIGINAL MONUMENT: POST SET BY J. WAMPLER, U.S. DEPUTY SURVEYOR, MARCH 1826.
INTERSECTED N. BOUNDARY 77 LINKS WEST OF POST 75.20 CHAINS N. OF SE COR. SEC. 5.
SUGAR 12" S52W, 11 LINKS
BEECH 5" S32E, 4 LINKS
1) DID NOT FIND ANY REFERENCE TO THIS CORNER IN EITHER PUBLIC OR PRIVATE RECORDS.

- B. Description of corner evidence found and/or method applied in restoring or reestablishing corner:
EXCAVATED IN PROBABLE AREA NORTH & SOUTH OF AN EXISTING FENCE LINE ON THE CENTERLINE OF BURKLEY ROAD TO THE SOUTH WHICH WAS FOUND TO BE IN CLOSE ACCORD OF THE TWP. JOG & PHYSICAL CENTERLINE OF BURKLEY ROAD TO THE NORTH. FOUND SEVERAL STONES ENTWINED WITH TREE ROOTS ALONG WITH THE ROTTED REMAINS OF AT LEAST (3) PREVIOUS ANCHOR POSTS. COULD NOT SET A MARKER ON LINE BETWEEN THE STANDARD CORNERS 77 LINKS WEST OF E-13 BECAUSE OF A 3" STEEL BRACE FOR AN ANCHOR POST AND THE ENTWINED TREE ROOTS WITH STONES. SET A 3/4" FORM PIN AND CAP LABELED P.A. 345, P.S. #18994 3.00' SOUTH AND ON LINE WITH E-2 FROM A POINT 77 LINKS (50.82') WEST AND ON LINE BETWEEN D-13 AND E-13.

- C. Description of monument for corner and accessories established to perpetuate locating the position of the corner:
3/4" X 24" FORM PIN & CAP #18994 3.00' SOUTH OF TOWNSHIP LINE.
SET NAIL & TAG #18994 SOUTH SIDE TWIN PIGNUT AZ. 64°, 2.80'
SET NAIL & TAG #18994 EAST SIDE 10" MAPLE AZ. 208°, 81.27'
SET NAIL & TAG #18994 SOUTH SIDE POWER POLE AZ. 92°, 57.88'
NE CORNER PORCH FND. AZ. 248°, 104.42'
E-13 WILLIAMSTOWN TWP. AZ. 89°, 50.80'
1/2" IRON PIPE IN MON. BOX AZ. 83°, 27.16'
MEASURED 2287.92' TO E-2 (G.L.O. 2323.2') 35.2 CHAINS

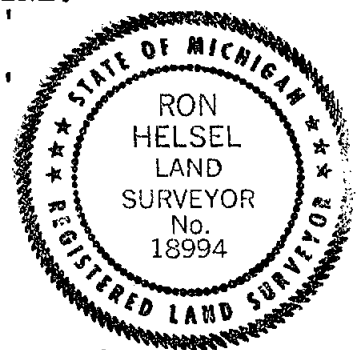

Signed by Ron Helsel

Date NOV. 16, 1995

Surveyor's Michigan License No. 18994

FORM APPROVED BY MICHIGAN STATE BOARD OF LAND SURVEYORS, JAN. 28, 1971
REVISED MAY 14, 1975
REVISED JAN., 1983

P.A. 345 INGHAM COUNTY
PEER APPROVED 8/22/96 RL

LAND CORNER RECORDATION CERTIFICATE

Filing Requirement of Act 74, Mich. P.A. 1970

WHEATFIELD TOWNSHIP

For corners in

INGHAM
(County)

Located In:

Corner Code =#

FILED

1. Public Land Survey T 3N R 1E E-2
 T _____ R _____
 T _____ R _____
 T _____ R _____
2. Property Controlling S _____ T _____ R _____
 in Section S _____ T _____ R _____
3. Miscellaneous S _____ T _____ R _____
 Property in Sec. S _____ T _____ R _____

Nov 29 9 53 AM '95

REGISTER OF DEEDS

Paula Johnson

INGHAM COUNTY, MICH.

Register of Deeds Stamp & File Number

4. Lot No. _____, Recorded Plat _____
5. Private Claims _____

	A	B	C	D	E	F	G	H	I	J	K	L	M
2	6	5	4	3	2	1							
3													
4	7	8	9	10	11	12							
5													
6	18	17	16	15	14	13							
7													
8	19	20	21	22	23	24							
9													
10	30	29	28	27	26	25							
11													
12	31	32	33	34	35	36							
13													

I, RON HELSEL, in a field survey on OCTOBER 13, 19 95, do hereby certify that under requirements of P.A. 74, Michigan P.A. of 1970, the corner points mentioned in lines 1 and 2 above were in conformance with regulations and rules therefore as required in the current manual of survey instructions of the United States Department of the Interior, Bureau of Land Management or by a decree of a Court of Law and/or that the corner points mentioned in lines 3, 4 and 5 above were in conformance with the rules of the Michigan Board of Land Surveyors or by a Decree of a Court of Law; established, re-established, monumented, re-monumented, recovered, found as expressed below:

NOTE: Not more than 4 corners, all in the same town and range, may be recorded on this certificate.

A. Description of original monument and accessories and/or subsequent restoration:

ORIGINAL MONUMENT: POST SET BY J. WAMPLER, U.S. DEPUTY SURVEYOR, MARCH 1826,

BEECH 16 N54W, 21 LINKS

SUGAR 17 S79E, 19 1/2 LINKS

1) A L.C.R.C. WAS RECORDED BY L. HENDRYX #3276, JULY 6, 1976 IN LIBER 4, Pg.87

HE SET A #4 IRON (1/2" REBAR).

GAS PIPE, E. 33.0' (FOUND)

CENTER OF 7" OAK NNW, 43'-10"

CENTER OF 4" HICKORY SE, 32'-3"

(CONTINUED ON BACK)

B. Description of corner evidence found and/or method applied in restoring or reestablishing corner:

FOUND 8" X 1/2" REBAR IN MONUMENT BOX IN CENTERLINE OF BURKLEY ROAD. FOUND A 1/2" PIPE 33' EAST ON REMNANTS OF FENCE LINE TO EAST. ROTTED WOOD ANCHOR POST TO THE WEST. EXCAVATED AND FOUND A RIBBED 10" SPIKE OVER THE TOP OF A POINTED STONE 2.7 FEET DEEP. DIRECTLY BELOW THE 1/2" REBAR. ACCEPTED THE POSITION OF THE STONE AND REBAR AND SET 3/4" X 24" FORM PIN AND CAP LABELED P. ACT 345, P.S. 18994.

C. Description of monument for corner and accessories established to perpetuate locating the position of the corner:

3/4" FORM PIN & CAP IN CENTERLINE BURKLEY ROAD.
 SET NAIL & TAG #18994 SW/SIDE 8" ASPEN AZ. 143°, 32.38'
 SET NAIL & TAG #18994 NE/SIDE 20" OAK AZ. 339°, 33.90'
 SET NAIL & TAG #18994 S/SIDE 8" ELM AZ. 277°, 24.29'
 FOUND 1/2" PIPE EAST, 33.01'
 CENTERLINE STEEL GATE POST AZ. 40°, 56.40'
 CENTERLINE STEEL GATE POST AZ. 79°, 41.02'
 MEASURED 2631.71' TO E3



Signed by Ron Helsel
 Surveyor's Michigan License No. 18994

Date NOV. 6, 1995

320003232 119618

1995283

FORM APPROVED BY MICHIGAN STATE BOARD OF LAND SURVEYORS, JAN. 28, 1971

P.A. 345 INGHAM COUNTY
 PEER APPROVED 11/7/95

REVISED MAY 14, 1975
 REVISED JAN., 1983

"A" CONTINUED

(NOTE: DID NOT FIND HENDRYX SURVEY(S) IN PRIVATE OR PUBLIC RECORDS REFERENCED TO THIS CORNER.)

- 2) A SURVEY WAS RECORDED IN LIBER 5, PAGE 125, DATED MAY 29, 1986 BY D. R. LOHR #30090. HE ONLY CITED LIBER 4, PG. 87 L.C.R.C. ABOVE.
- 3) A SURVEY WAS RECORDED IN LIBER 5, PAGES 405-406, DATED DEC. 1987, BY G. M. YOUNG #17640. HE CITED THE SAME WITNESSES AS "1-A" ABOVE.
- 4) A SURVEY WAS RECORDED IN LIBER 5, PAGES 824-825, DATED MAY 31, 1990 BY M. F. FOUTY #18989. HE ONLY CITED LIBER 4, PG. 87 L.C.R.C. ABOVE.

LAND CORNER RECORDATION CERTIFICATE
Filing Requirement of Act 74, Mich. P.A. 1970

FILED

For corners in

WHEATFIELD TOWNSHIP

INGHAM
(County)

Located In:

Corner Code =#

Nov 29 9 54 AM '95

1. Public Land Survey

T 3N R 1E

E-3

T R

T R

T R

2. Property Controlling
in Section

S T R

S T R

3. Miscellaneous
Property in Sec.

S T R

S T R

4. Lot No. , Recorded Plat

5. Private Claims



REGISTER OF DEEDS

Paula Johnson
INGHAM COUNTY, MICH.

Register of Deeds Stamp & File Number

	A	B	C	D	E	F	G	H	I	J	K	L	M
2	6		5		4		3		2		1		
3													
4	7		8		9		10		11		12		
5													
6	18		17		16		15		14		13		
7													
8	19		20		21		22		23		24		
9													
10	30		29		28		27		26		25		
11													
12	31		32		33		34		35		36		
13													

I, RON HELSEL, in a field survey on OCTOBER 19, 19 95, do hereby certify that under requirements of P.A. 74, Michigan P.A. of 1970, the corner points mentioned in lines 1 and 2 above were in conformance with regulations and rules therefore as required in the current manual of survey instructions of the United States Department of the Interior, Bureau of Land Management or by a decree of a Court of Law and/or that the corner points mentioned in lines 3, 4 and 5 above were in conformance with the rules of the Michigan Board of Land Surveyors or by a Decree of a Court of Law; established, re-established, monumented, re-monumented, recovered, found as expressed below:

NOTE: Not more than 4 corners, all in the same town and range, may be recorded on this certificate.

A. Description of original monument and accessories and/or subsequent restoration:

ORIGINAL MONUMENT: POST SET BY J. WAMPLER U.S. DEPUTY SURVEYOR, MARCH 1826.
IRONWOOD 5" S80W, 13 LINKS
ASH 36" N44E, 21 1/2 LINKS

1) COUNTY SURVEYOR, T.J. BROWN IDENTIFIED THIS CORNER AS A STONE IN A SURVEY RECORDED IN LIBER 3, PAGE 69, DATED MARCH 21, 1873. NO WITNESSES.

(CONTINUED ON BACK)

B. Description of corner evidence found and/or method applied in restoring or reestablishing corner:

FOUND 3/4" X 12" BOLT AT GRADE, EXCAVATED AND FOUND 1/2" X 18" BENT PIPE 4" UNDER ASPHALT AT 2.1 FEET BELOW GRADE FOUND OLD WOOD STAKE AND A POINTED STONE LYING NE'LY. ACCEPTED THE BOTTOM OF THE 1/2" PIPE AS THE LOCATION OF CORNER AND RAISED TO GRADE WITH A 3/4" X 24" STEEL FORM PIN WITH CAP #18994 PA 345. SET MONUMENT BOX CORNER LOCATED IN CENTERLINE OF BURKLEY AND LINN ROADS.

C. Description of monument for corner and accessories established to perpetuate locating the position of the corner:

3/4" BY 24" STEEL FORM PIN IN MON. BOX
FOUND LESTER NAIL & TAG NORTH SIDE 12" SPRUCE AZ. 110°, 86.92'
FOUND STEPHENS NAIL & TAG WEST SIDE UTILITY POLE AZ. 56°, 42.02'
FOUND STEPHENS NAIL & TAG SOUTH SIDE 36" OAK AZ. 25°, 54.80'
SET NAIL & TAG #18994 NORTH SIDE R.R. TIE ANCHOR POST, AZ. 264°, 147.00'
FOUND LESTER NAIL & TAG EAST SIDE 16" HICKORY AZ. 355°, 185.88'

Signed by

Date

NOV. 6, 1995

Surveyor's Michigan License No.

18994

950003981 Liber 8

18994

P.A. 345 INGHAM COUNTY

PEER APPROVED 11/7/95

FORM APPROVED BY MICHIGAN STATE BOARD OF LAND SURVEYORS, JAN. 28, 1971
REVISED MAY 14, 1975
REVISED JAN., 1983

"A" CONTINUED

- 2) FROM THE CARD FILES OF FRED WHITE ENGINEERING, M.S.H.D. FORM 280, CIRCA 1950's & INGHAM CO. ROAD COMM. GRID MAPS, DATED JAN. 1969 1" IRON PIPE TO SURFACE, FOUND STAKE
 18" OAK N22°E, 56.28' (FOUND)
 25" OAK N26°W, 57.40' (GONE)
 NE CORNER HOUSE FOUND, S43°W, 76.60 (GONE)
- 3) SURVEYS WERE RECORDED IN LIBER 1, PAGES 547 & 548, MOV. 9, 1972 BY L. HENDRYX #3276 CORNER MARKER & WITNESSES NOT IDENTIFIED.
- 4) SURVEYS WERE RECORDED IN LIBER 1, PAGES 585 & 586, DEC. 27, 1972 ALONG WITH A L.C.R.C. LIBER 2, PAGE 355, DATED 12-26-1972 BY J.E. STEPHENS #16053. HE FOUND A 1/2" PIPE AND WITNESSED AS:
 SURVEY TAG IN S. SIDE 36" OAK, N28°39'W, 56.55' (FOUND STUMP)
 SURVEY TAG IN S. SIDE 30" OAK, N20°12'E, 55.07" (FOUND)
 SURVEY TAG IN W. SIDE UTILITY POLE, N50°41'E, 41.97' (FOUND)
- 5) A SURVEY WAS RECORDED IN LIBER 3, PAGES 562 & 563 BY M.F. FOUTY #18989, DATED 8-21-78. HE CALLED FOR A 1/2" BAR WITH WITNESSES THE SAME AS "4-A" ABOVE.
- 6) A SURVEY WAS RECORDED IN LIBER 5, PAGE 125 BY D.R. LOHR #30090, DATED 5-29-1986. HE DID NOT IDENTIFY MONUMENT OR WITNESS.
- 7) A SURVEY WAS RECORDED IN LIBER 5, PAGES 405-406, DATED DEC. 1987 BY G.M. YOUNG #17640. HE CALLED FOR A 1/2" PIPE AND WITNESSES SAME AS "4-A" ABOVE.
- 8) SURVEYS WERE RECORDED BY L.A. BRYAN #25832 IN LIBER 6, PGS. 25-26, JAN. 27, 1989 AND IN LIBER 6, PGS. 28-29, DATED MAY 31, 1989. BOTH CALLED FOR A 3/4" BOLT.
 FOUND NAIL & TAG SOUTH SIDE 40" OAK, N30W, 56.44'
 FOUND NAIL & TAG SOUTH SIDE 36" OAK, N20E, 54.94'
 FOUND NAIL & TAG WEST SIDE POWER POLE, N50E, 42.05'
- 9) A SURVEY WAS RECORDED IN LIBER 6, PGS. 824-825, DATED MAY 31, 1990 BY M. F. FOUTY. NO MARKER OR WITNESSES WERE IDENTIFIED.
- 10) A SURVEY WAS RECORDED IN LIBER 6, PGS. 929-930, DATED 9-20-91 BY R. M. LESTER #18998. HE CALLED FOR A 1/2" IRON PIPE
 FOUND STEPHENS NAIL & TAG WEST SIDE UTILITY POLE, 56° AZ., 42.0'
 FOUND STEPHENS NAIL & TAG SOUTH SIDE 36" OAK, 25 AZ., 54.8'
 SET NAIL & TAG NORTH SIDE 14" SPRUCE, 110° AZ., 86.9' (FOUND)
 SET NAIL & TAG EAST SIDE 16" HICKORY, 355° AZ., 185.9' (FOUND)