

LAND CORNER RECORDATION CERTIFICATE  
Filing Requirement of Act 74, Mich. P.A. 1970

Liber

9 Page 205

For corners in

INGHAM

Located In:

Corner Code #

(County)

WHITE OAK TOWNSHIP

1. Public Land Survey

T2N R2E A-11

2. Property Controlling  
in Section

S T R

3. Miscellaneous  
Property in Sec.

S T R

4. Lot No. , Recorded Plat

5. Private Claims

I, DAVID R. LOHR, in a field survey on 3/25, 1997 do hereby state that under requirements of P.A. 74, Michigan P.A. of 1970, the corner points mentioned in lines 1 and 2 above were in conformance with regulations and rules therefore as required in the current manual of survey instructions of the United States Department of the Interior, Bureau of Land Management or by a decree of a Court of Law and/or that the corner points mentioned in lines 3, 4 and 5 above were in conformance with the rules of the Michigan Board of Land Surveyors or by a Decree of a Court of Law; established, re-established, monumented, recovered, found as expressed below:

NOTE: Not more than 2 corners, all in the same town and range, may be recorded on this certificate.

A. Description of original monument and accessories and/or subsequent restoration:

A-11: 1. CORNER SET BY JOSEPH WAMPLER, DEP. SURVEYOR, IN NOV. 1823.  
"INT W. BD. 7 LKS (4.62') S. OF P, SET P. AT ??? COR. OF 30 & 31, FW"  
RO (RED OAK): 23 S 17 E 116 LKS (76.56')  
"NO OTHERS"  
NOTES SHOW DISTANCE EAST TO B-11 OF 34.31 CH. (2264.46')

CONTINUED ON BACK

B. Description of corner evidence found and/or method applied in restoring or reestablishing corner:

A-11: SEARCHED AT APPARENT LOCATION OF CORNER AND FOUND 3/4" PIPE AS PER ITEM #A-5. ALSO FOUND 1/2" IRON W/CAP #18998 AT M-11 INGHAM TWP. AS PER ITEM #A-7. ACCEPTED 3/4" PIPE AS CORNER BASED ON TESTIMONY OF SURVEYOR STEADMAN IN ITEM #A-5. COULD NOT REMOVE PIPE, LEFT IN PLACE AND SET PA #345 CAP #30090 ON TOP OF PIPE.

C. Description of monument for corner and accessories established to perpetuate locating the position of the corner:

A-11: 3/4" PIPE WITH PA#345 CAP #30090 AS PER LIBER 3, PAGE 355. CORNER FALLS 4.70 FT. SOUTH OF M-11 INGHAM TOWNSHIP.  
C/L 6" ST. GATE POST (NORTHERLY), AZ. 69-02-00, 81.84'  
C/L 6" ST. GATE POST (SOUTHERLY), AZ. 80-06-00, 77.33'  
SET N&T #30090, N/S 12" ELM, AZ. 103-36-30, 41.00'  
SET N&T #30090, W/S 15" CHERRY, AZ. 164-43-00, 77.84'  
FD. N&T #18998, NE/S 20" WALNUT, AZ. 259-55-00, 24.50'  
FD. N&T #18998, N/S 20" OAK, AZ. 295-07-30, 35.27'  
M-11, ING. TWP. 3/4" REMON. BAR, AZ. 360-00-00, 4.62'

Signed by David R. Lohr  
Surveyor's Michigan License No. 30090

Date 6-16-97

FILED

970029267  
08/06/1997 09:00:08  
REGISTER OF DEEDS  
Paula Johnson  
INGHAM COUNTY, MI

Register of Deeds Stamp & File Number

	A	B	C	D	E	F	G	H	I	J	K	L	M
1													
2	6		5		4		3		2		1		
3													
4	7		8		9		10		11		12		
5													
6	18		17		16		15		14		13		
7													
8	19		20		21		22		23		24		
9													
10	30		29		28		27		26		25		
11													
12	31		32		33		34		35		36		
13													

## A-11: WHITE OAK TOWNSHIP, PART A - CONTINUED

2. CORNER REFERENCED IN SURVEY BY E. A. CALKINS, DEPUTY COUNTY SURVEYOR, DATED MAY 31 THRU JUNE 4, 1900, RECORDED IN BOOK 1, PAGE 40.  
NO REFERENCE TO MONUMENT OR WITNESSES.
3. NO REFERENCE MADE ON INGHAM COUNTY GRID MAP, DATED JAN. 1969.
4. LCRC BY RICHARD STEADMAN, PS #11370, DATED 6/16/73, RECORDED IN LIBER 3, PAGE 355, STATES: "ORIGINAL MONUMENT: WOOD POST SET BY JOSEPH WAMPLER, U.S. DEPUTY SURVEYOR IN 1825. BEARING TREES: 23" R. OAK S17E 116 LKS., NO OTHER. I FIND NO PUBLIC RECORD OF A RESTORATION OF THIS CORNER. DUG LARGE, DEEP HOLE IN MEECH ROAD, BUT FOUND NOTHING. RE-ESTABLISHED CORNER OPPOSITE FENCE EAST AND ON NORTHERLY EXTENSION OF FENCE WHICH BEGINS AT SOUTH EDGE OF SWAN ROAD INTERSECTION AND RUNS SOUTH TO WEST 1/4 CORNER OF SECTION 31 (WOOD ANCHOR POST). SET 3/4" IRON PIPE FOR CORNER AT ABOVE DESCRIBED LOCATION. WITNESSED BY:  

3/4" IRON PIPE,	EAST,	33.02'
14" WALNUT,	WSW,	24.74'
12" OAK,	WNW,	15.21'

LARGEST TRUNK OF TRIPLE W. CHERRY, SSE, 77.69'
5. TRAVERSE POINT WITNESS REPORT (CETA REMON PROGRAM, 1978) DATED 4/5/78, STATES: "FOUND 3/4" PIPE W/CAP RLS 11370 ACCORDING TO LIBER 3, PG. 355, ON PHYSICAL C/L OF MEECH RD, DUE WEST OF FENCE LINE EAST 8" BELOW ROAD SURFACE." WITNESSED BY:  

S 25 E,	77.77'	FD. N&T 11370 ON W. SIDE 10" WILD CHERRY
S 85 W,	24.77'	FD. N&T 11370 ON S. SIDE 16" WALNUT
N 82 W,	35.24'	FD. N&T 11370 ON NE. SIDE 14" OAK
DUE E.,	33.02'	FD. 3/4" PIPE W/RLS 11370 CAP
6. LCRC BY RONNIE LESTER, PS #18998, DATED 11/24/76, RECORDED IN LIBER 4, PAGE 13, RECORDING THE LOCATION OF M-11 INGHAM TOWNSHIP STATES: M-11: "SET 1/2" BAR & CAP ON TOWNSHIP LINE AT GLO FALLING NORTH OF SW CORNER OF SECTION 30, T2N, R2E, INGHAM COUNTY, MICHIGAN, AS RECORDED IN LIBER 3, PAGE 355." SURVEYOR LESTER GOES ON TO USE THIS CORNER (A-11) AS A WITNESS: "SW CORNER, SECTION 30, T2N, R2E, 1/2" PIPE & CAP, SOUTH, 4.62'."
7. SURVEY #80-B-520, BY LARRY BRYAN, PS #25832, DATED 11/20/80, RECORDED IN LIBER 7, PAGE 484, FOR A PARCEL LOCATED IN SECTION 36, T2N, R1E, INGHAM TOWNSHIP, USES THIS CORNER (A-11) AS A WITNESS TO M-11 INGHAM TOWNSHIP. "FD. 3/4" PIPE AT NORTHWEST CORNER OF SECTION 31, T2N, R2E, SOUTH, 4.55'."
8. SURVEY #89627, BY RON HELSEL, PS #18994, DATED 11/27/89, RECORDED IN LIBER 6, PAGE 526, STATES: "NW CORNER, SECTION 31, T2N, R2E, INGHAM COUNTY, MICHIGAN, L3, P.355. NO MENTION OF MONUMENT. SAME WITNESSES AS ITEM #5."
9. SURVEY #91-2183, BY RON HELSEL, PS #18994, DATED 07/01/91, RECORDED IN LIBER 7, PAGE 407, STATES: NORTHWEST CORNER, SECTION 31, T2N, R2E. NO MENTION OF MONUMENT OR WITNESSES.
10. SURVEY #A-4214, BY RONNIE LESTER, PS #18998, DATED 04/28/92, RECORDED IN LIBER 6, PAGE 958, STATES: "NORTHWEST CORNER, SECTION 31, T2N, R2E. 3/4" PIPE, LIBER 3, PAGE 355. WITNESSED BY:  

SET NAIL & TAG IN NORTH SIDE 20" WALNUT,	260 AZ.,	24.5'
SET NAIL & TAG ON WEST SIDE 15" CHERRY,	168 AZ.,	77.9'
CENTERLINE OF 6" STEEL GATE POST,	83 AZ.,	76.9'
CENTERLINE OF 6" STEEL GATE POST,	73 AZ.,	81.9'
SET NAIL & TAG IN N. E. SIDE 20" OAK,	295 AZ.,	35.2'
M-11, INGHAM TOWNSHIP, 1/2" BAR,	05 AZ.,	4.7'

SURVEY SHOWS A DISTANCE SOUTH TO A-12 OF 2637.79'
11. NO OTHER REFERENCES FOUND.

LAND CORNER RECORDATION CERTIFICATE  
Filing Requirement of Act 74, Mich. P.A. 1970

Liber

9 Page 207

For corners in

INGHAM

(County)

Located In:

Corner Code #

WHITE OAK TOWNSHIP  
1. Public Land Survey

T 2N R 2E A-12

T     R    

T     R    

T     R    

2. Property Controlling  
in Section

S     T     R    

S     T     R    

3. Miscellaneous  
Property in Sec.

S     T     R    

S     T     R    

FILED

970029268  
08/06/1997 09:00:09  
REGISTER OF DEEDS  
Paula Johnson  
INGHAM COUNTY, MI

Register of Deeds Stamp & File Number

4. Lot No.       , Recorded Plat       

5. Private Claims       

I, DAVID R. LOHR, in a field survey on 3/28, 19 97 do hereby state that under requirements of P.A. 74, Michigan P.A. of 1970, the corner points mentioned in lines 1 and 2 above were in conformance with regulations and rules therefore as required in the current manual of survey instructions of the United States Department of the Interior, Bureau of Land Management or by a decree of a Court of Law and/or that the corner points mentioned in lines 3, 4 and 5 above were in conformance with the rules of the Michigan Board of Land Surveyors or by a Decree of a Court of Law; established, re-established, monumented, recovered, found as expressed below:

NOTE: Not more than 2 corners, all in the same town and range, may be recorded on this certificate.

A. Description of original monument and accessories and/or subsequent restoration:

A-12: 1. CORNER NOT SET IN GLO SURVEY.

2. CORNER REFERENCED IN SURVEY BY E. A. CALKINS, DEP. COUNTY SURVEYOR, DATED MAY 31 THRU JUNE 4, 1900, RECORDED IN BOOK 1, PAGE 40. "SET OAK POST WITH STONE FW BEARS 3 1/21ks (2.31') SOUTH OF INGHAM POST. SURVEY SHOWS DISTANCE SOUTH TO A-13 OF 40.085 CH. (2645.61') AND DISTANCE EAST TO B-12 OF 36.20 CH. (2389.2')

CONTINUED ON BACK.

B. Description of corner evidence found and/or method applied in restoring or reestablishing corner:

A-12: SEARCHED AT APPARENT LOCATION OF CORNER AND FOUND 1/2" IRON/CAP #25832 AS PER ITEM #A-12. ALSO FOUND 1/2" IRON W/CAP #18989 (FOUTY) 2.28 FT. NORTH AT M-12 INGHAM TWP. AS PER ITEM A-5. FOUTY'S CORNER (#A-3) IS INCORRECTLY RECORDED AS A-12, WHITE-OAK. COUNTY SURVEYOR CALKINS (ITEM #A-2) CALLS FOR CORNER TO BE 2.31 FT. SOUTH OF M-12, INGHAM TWP. ACCEPTED 1/2" IRON /CAP #25832 AS CORNER AS PER TESTIMONY OF SURVEYOR BRYAN IN ITEM #A-9. REPLACED 1/2" IRON WITH STAND. 3/4"X 24" REMON. BAR & PA #345 CAP #30090.

C. Description of monument for corner and accessories established to perpetuate locating the position of the corner:

A-12: SET STANDARD 3/4" X 24" REMON. BAR AND PA#345 CAP #30090 AT LOCATION OF IRON, LIBER 6, PAGE 272. CORNER FALLS 2.28 FT. SOUTH OF INGHAM, M-12.

WITNESSED BY:

FD. N&T #18998, E/S 15" ASH, AZ. 05 DEG., 23.60'

SET N&T #30090, W/S 8" OAK, AZ. 40 DEG., 14.60'

SET N&T #30090, S/S 10" ASH, AZ. 85 DEG., 26.50'

FD. N&T #18998, S/S 12" CHERRY, AZ. 90 DEG., 15.28'

SET N&T #30090, E/S 8" ASH, AZ. 180 DEG., 27.25'

FD. N&T #18998, N/S 15" OAK, AZ. 256 DEG., 12.82'

Signed by David R. Lohr 3/4" BAR/CAP #30090, M-12, INGHAM TWP., AZ. 00 DEG., 2.28'

Surveyor's Michigan License No. 30090

## A-12: WHITE OAK TOWNSHIP, PART A - CONTINUED

3. LCRC BY MARVIN FOUTY, PS #18989, DATED 11/08/75, RECORDED IN LIBER 3, PG. 562, STATES: "THE SOUTH 1/2 OF THE SECTION WAS SURVEYED IN JUNE 1900, BY COUNTY SURVEYOR E.A. CALKINS WHO SET AN OAK POST WITH STONE AND ACCESSORIES. CORNER POSITION OCCUPIED BY NEWER ANCHOR POST WITH FENCES NORTH, SOUTH AND EAST...SET 1/2" BAR AND CAP AT BASE OF ANCHOR POST...WITNESSED BY:  
 NAIL & TAG SE SIDE 22" MAPLE, WEST, 25.82'  
 NAIL & TAG NORTH SIDE 32" OAK, EAST, 20.38'  
 NAIL & TAG W SIDE 26" MAPLE, NE, 35.75'
4. LCRC BY MARVIN FOUTY, PS #18989, DATED 11/08/75, RECORDED IN LIBER 5, PG. 204, STATES: "THE SOUTH 1/2 OF THE SECTION WAS SURVEYED IN JUNE 1900, BY COUNTY SURVEYOR E.A. CALKINS WHO SET AN OAK POST WITH STONE AND ACCESSORIES. CORNER POSITION OCCUPIED BY NEWER ANCHOR POST WITH FENCES NORTH, SOUTH AND EAST...SET 1/2" BAR AND CAP AT BASE OF ANCHOR POST...WITNESSED BY:  
 NAIL & TAG EAST SIDE 14" MAPLE, NORTH, 21.30'  
 NAIL & TAG WEST SIDE 6" BEECH, NE, 12.70'  
 NAIL & TAG NORTH SIDE 6" CHERRY, ENE, 15.03'
5. SURVEY #163, BY MARVIN FOUTY, PS #18989, DATED 11/08/75, RECORDED IN LIBER 2, PAGE 692, STATES: "WEST 1/4 CORNER, SECTION 31, T2N, R2E, SET 1/2" BAR & CAP... WITNESSED BY:  
 NAIL & TAG EAST SIDE 14" MAPLE, NORTH, 21.30'  
 NAIL & TAG WEST SIDE 6" BEECH, NE, 12.70'  
 NAIL & TAG NORTH SIDE 6" CHERRY, ENE, 15.03'  
 SURVEY SHOWS DISTANCE EAST TO C-12 OF 5041.87
6. SURVEY #1850, BY AUSTIN C. WILLIAMS, PS #21275, DATED APRIL 1979, RECORDED IN LIBER 3, PAGE 953, STATES: "WEST 1/4 CORNER, SEC. 31, T2N, R2E, NO MENTION OF MONUMENT... WITNESSED BY:  
 NAIL & TAG E/S 14" MAPLE, NORTH, 21.30'  
 NAIL & TAG W/S 6" BEECH, NE, 12.70'  
 NAIL & TAG N/S 6" CHERRY, ENE, 15.03'  
 SURVEY SHOWS DISTANCE EAST TO C-12 OF 5041.87
7. LCRC BY LARRY BRYAN, PS #25832, DATED 11/04/80, RECORDED IN LIBER 6, PAGE 272, STATES: "ORIGINAL MONUMENT AND ACCESSORIES OBLITERATED...SET 1/2" BAR & CAP AT ANCHOR POST ON TOWNSHIP LINE IN CLOSE ACCORD WITH G.L.O. MEASUREMENTS. WITNESSED BY:  
 SET NAIL & TAG WEST SIDE 8" ELM, N10E, 14.67'  
 SET NAIL & TAG SOUTH SIDE 8" WILD CHERRY, N45E, 15.50'  
 FOUND 1/2" BAR W/CAP "FOUTY" AT BASE OF ANCHOR POST, NORTH, 2.28'.
8. SURVEY #80-B-520, BY LARRY BRYAN, PS #25832, DATED 11/20/80, RECORDED IN LIBER 7, PAGE 484, STATES: "WEST 1/4 CORNER, SECTION 31, T2N, R2E, SET 1/2" BAR W/CAP AT ANCHOR POST ON TOWNSHIP LINE." WITNESSED SAME AS ITEM #9. SURVEY SHOWS A DISTANCE SOUTH TO A-13 OF 2641.95'. SURVEY SHOWS A DISTANCE NORTH TO M-12 INGHAM OF 2.28'.
9. SURVEY #91-2183, BY RON HELSEL, PS #18994, DATED 07/01/91, (REV. 1-4-94) RECORDED IN LIBER 7, PAGE 407, STATES: "WEST 1/4 CORNER, SECTION 31, T2N, R2E. NO MENTION OF MONUMENT OR WITNESSES. SURVEY SHOWS A DISTANCE EAST TO C-12 OF 5041.87'.
10. SURVEY #A-4214, BY RONNIE LESTER, PS #18998, DATED 04/28/92, RECORDED IN LIBER 6, PAGE 958, STATES: "WEST 1/4 CORNER, SECTION 31, T2N, R2E. 1/2" BAR & CAP LIBER 6, PAGE 272. WITNESSED BY:  
 SET NAIL & TAG IN EAST SIDE 15" ASH, 05 AZ., 23.7'  
 SET NAIL & TAG IN SOUTH SIDE 12" CHERRY, 73 AZ., 15.4'  
 SET NAIL & TAG IN NORTH SIDE 15" OAK, 256 AZ., 12.9'  
 FOUND NAIL AND TAG WEST SIDE 8" DECIDUOUS, 40 AZ., 14.8'  
 M-12, INGHAM TOWNSHIP, 1/2" BAR AND CAP, 05 AZ., 2.28'  
 SURVEY SHOWS A DISTANCE NORTH TO A-11 OF 2637.79'  
 SURVEY SHOWS A DISTANCE EAST TO C-12 OF 5040.80'
11. NO OTHER REFERENCES FOUND.

LAND CORNER RECORDATION CERTIFICATE  
Filing Requirement of Act 74, Mich. P.A. 1970

Liber 9 Page 203

For corners in

INGHAM

(County)

INGHAM TOWNSHIP

1. Public Land Survey

Located In:

Corner Code #

A-13 W.O.

T 2N R 1E

M-13

T R

T R

T R

T R

2. Property Controlling  
in Section

S

T R

3. Miscellaneous

S

T R

Property in Sec.

S

T R

FILED

970029266  
08/06/1997 09:00:06  
REGISTER OF DEEDS  
Paula Johnson  
INGHAM COUNTY, MI

Register of Deeds Stamp & File Number

4. Lot No. \_\_\_\_\_, Recorded Plat \_\_\_\_\_

5. Private Claims \_\_\_\_\_

I, DAVID R. LOHR, in a field survey on 3/25, 19 97 do hereby state that under requirements of P.A. 74, Michigan P.A. of 1970, the corner points mentioned in lines 1 and 2 above were in conformance with regulations and rules therefore as required in the current manual of survey instructions of the United States Department of the Interior, Bureau of Land Management or by a decree of a Court of Law and/or that the corner points mentioned in lines 3, 4 and 5 above were in conformance with the rules of the Michigan Board of Land Surveyors or by a Decree of a Court of Law; established, re-established, monumented, recovered, found as expressed below:

NOTE: Not more than 2 corners, all in the same town and range, may be recorded on this certificate.

	A	B	C	D	E	F	G	H	I	J	K	L	M
1													
2	6		5		4		3		2		1		
3													
4	7		8		9		10		11		12		
5													
6	18		17		16		15		14		13		
7													
8	19		20		21		22		23		24		
9													
10	30		29		28		27		26		25		
11													
12	31		32		33		34						
13													

A. Description of original monument and accessories and/or subsequent restoration:

M-13: 1. CORNER SET BY JOSEPH WAMPLER IN NOV, 1823. (EXTERIOR BOUNDARY - WHITE OAK TOWNSHIP) "SET POST AT INT. COR. OF T 1 & 2 N., R. 1 & 2 E., fw" WITNESSED BY:  
WO 30 in S 19 1/2 W 112 LKS (73.92')  
BO 9 " N 30 W 104 LKS (68.64')  
NOTES SHOW DISTANCES EAST OF 37.46 CH. (2472.36')

CONTINUED ON BACK

B. Description of corner evidence found and/or method applied in restoring or reestablishing corner:

M-13: SEARCHED AT APPARENT LOCATION OF CORNER AND FOUND 1/2" IRON ON SOUTH SIDE OF 12" ANCHOR POST AS PER ITEM #A-9. ACCEPTED 1/2" AS CORNER BASED ON REVIEW OF SURVEYOR BRYAN'S TRAVERSE OF SECTION 36. ITEM #A-9 SHOWS DISTANCE NORTH OF 2644.23 FT. ITEM #A-10 SHOWS DISTANCE SOUTH OF 2643.94 FT. REPLACED 1/2" IRON WITH STANDARD 3/4" X 24" REMON. BAR AND PA #345 CAP #30090.

C. Description of monument for corner and accessories established to perpetuate locating the position of the corner:

M-13: SET STANDARD 3/4" X 24" REMON. BAR AND PA #345 CAP #30090 AT LOCATION OF 1/2" IRON ON SO. SIDE OF ANCHOR POST AT FENCE INTERSECTION. WITNESSED BY:  
FD. N&T #18998, S/S 24" OAK, AZ. 66 DEG., 22.60'  
FD. 1/2" IRON/CAP #21275, AZ. 90 DEG., 65.90'  
SET N&T #30090, SW/S TRI. MAPLE, AZ. 132 DEG., 43.50'  
FD. N&T #18998, E/S 12" CHERRY, AZ. 180 DEG., 5.84'  
SET N&T #30090, W/S 30" OAK, AZ. 181 DEG., 45.10'  
FD. N&T #18998, SE/S 15" ASH, AZ. 220 DEG., 1.67'

Signed by

David R. Lohr

Date

6-16-97

Surveyor's Michigan License No.

30090

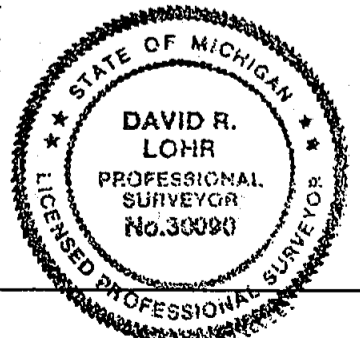

2. TEMP. CORNER??? SET BY JOSEPH WAMPLER ON FEB. 4, 1824. (EXTERIOR BOUNDARY - BUNKERHILL TOWNSHIP) "SET TEMP. POST FOR CORNER OF TOWNS 1 & 2 N., R. 1 & 2 E." WITNESSED BY:  
WO 30 S 19 1/2 W 112 LKS (73.92')  
BO 9 N 30 W 104 LKS (68.64')  
MARGINAL NOTE: LARGE STONE R.OAK 9 N 16 E (NEW) 33LKS. (21.78")  
NOTES SHOW DISTANCES SOUTH OF 40 CH. (2640.0')
3. CORNER REFERENCED IN SURVEY BY E. A. CALKINS, COUNTY SURVEYOR, DATED JUNE 9, 1900, RECORDED IN BOOK 1, PAGE 40, (STEADMAN'S INDEX VOL.5, PG.40). CORNER NOTED AS "STONE" WITNESSED BY: B. OAK 8", S 89 1/2 E, 49 LKS (32.34')  
DOUBLE B. OAK 20", N 15 E, 32 LKS (21.12')  
SURVEY SHOWS DISTANCE NORTH OF 40.085 CH. (2645.61')  
SURVEY SHOWS DISTANCE EAST OF 37.70 CH. (2488.20')
4. NO REFERENCE MADE ON INGHAM COUNTY GRID MAP, DATED JAN. 1969.
5. LCRC, BY AUSTIN C. WILLIAMS, PS #21275, DATED 5/03/78, RECORDED IN LIBER 5, PAGE 152, STATES: "ORIGINAL MONUMENT AND ACCESSORIES OBLITERATED...FOUND 1/2" IRON ROD AT INTERSECTION OF NORTH, SOUTH & EAST FENCE LINES ON SOUTH SIDE OF ANCHOR POST...NW CORNER SECTION 6, T1N, R2E." WITNESSED BY: 20" OAK, NAIL & TAG, N 75 E, 23.21'  
NAIL & TAG IN 14" MAPLE, S 40 W, 1.60'  
12" TWIN MAPLE, S 35 E, 43.50'
6. SURVEY #1688, BY AUSTIN C. WILLIAMS, PS #21275, DATED 5/06/78, RECORDED IN LIBER 3, PAGE 425, STATES: "NW CORNER OF SECTION 6, T1N, R2E." NO MENTION OF MONUMENT. WITNESSED BY:  
NAIL & TAG IN 20" OAK, N 75 E, 23.21'  
NAIL & TAG IN 14" MAPLE, S 40 W, 1.60'  
NAIL & TAG IN 12" TW. MAPLE, S 35 E, 43.50'
7. SURVEY #240, BY MARVIN FOUTY, PS #18989, DATED 08/05/78, RECORDED IN LIBER 3, PAGE 556, STATES: "NE COR., SEC. 1, T1N, R1E, FD. IRON PIPE FROM WITNESSES: TAGS IN 20" OAK, N 75 E, 23.21'  
14" MAPLE, S 40 W, 1.60'  
12" TW. MAP., S 35 E, 43.50'  
SURVEY SHOWS A DISTANCE SOUTH TO M-2 OF 2644.36'
8. SURVEY #2003, BY AUSTIN C. WILLIAMS, PS #21275, DATED AUG. 1980, RECORDED IN LIBER 4, PAGE 138, STATES: "NW CORNER SEC. 6, T1N, R2E." NO MENTION OF MONUMENT. WITNESSED BY:  
NAIL & TAG IN 20" OAK, N 75 E, 23.21'  
NAIL & TAG IN 14" MAPLE, S 40 W, 1.60'  
NAIL & TAG IN 12" TW. MAPLE, S 35 E, 43.50'  
SURVEY SHOWS A DISTANCE EAST TO C-1 OF 4923.70'  
SURVEY SHOWS A DISTANCE SOUTH TO C/L DEXTER TRAIL OF 1759.16'
9. SURVEY BY LARRY BRYAN, PS #25832, DATED 11/20/80, RECORDED IN LIBER 7, PAGE 484, STATES: "SOUTHEAST CORNER SECTION 36, T2N, R1E, FOUND 1/2" BAR AT FENCE INTERSECTION." WITNESSED BY:  
FD. 1/2" BAR W/CAP R.L.S. #21275, EAST, 65.90'  
FD. NAIL & TAG, SE/S 15" ASH, S 45 W, 1.52'  
FD. NAIL & TAG SOUTHEAST SIDE 20" OAK, N 45 E, 23.35'  
SURVEY SHOWS A DISTANCE NORTH TO M-12 OF 2644.23'  
SURVEY SHOWS A DISTANCE WEST TO L-13 OF 2652.87'
10. SURVEY #A-4136, BY RONNIE LESTER, PS #18998, DATED 05/19/89, RECORDED IN LIBER 5, PAGE 1066, STATES: "NORTHEAST CORNER, SECTION 1, T1N, R1E, L 5, P 152. FOUND 1/2" BAR AT BASE FENCE POST." WITNESSED BY:  
SET NAIL & TAG IN S.E. SIDE 18" HICKORY, 220 AZ., 1.7'  
FOUND NAIL AND SHINER IN S.W. SIDE TRIPLE MAPLE, 132 AZ., 43.4'  
SET NAIL & TAG IN SOUTH SIDE 24" OAK, 66 AZ., 22.6'  
SET NAIL & TAG IN WEST SIDE 30" OAK, 185 AZ., 45.1'  
SURVEY SHOWS A DISTANCE SOUTH TO M-2 OF 2643.94'
11. UNRECORDED SURVEY BY LARRY BRYAN, PS #25832, JOB NUMBER 90-B-29711, DATED 07/10/90, STATES: "SOUTHEAST CORNER SECTION 36, T2N, R1E, LIBER 5, PAGE 152, FOUND 1/2" BAR AT FENCE INTERSECTION." WITNESSED BY:  
FOUND NAIL & TAG, SOUTHEAST SIDE 15" ASH, S 45 W, 1.52'  
FOUND NAIL & TAG SOUTHEAST SIDE 20" OAK, N 45 E, 23.35'  
FOUND 1/2" BAR&CAP #21275, EAST, 65.90'  
SURVEY SHOWS A DISTANCE WEST TO L-13 OF 2652.87'
12. NO OTHER REFERENCES FOUND.

FILED

White Oak

LAND CORNER RECORDATION CERTIFICATE  
Filing Requirement of Act 74, Mich. P.A. 1970

For corners in

Ingham

(County)

Located In:

Corner Code ##

1. Public Land Survey

T 2N R 2E B-11

2. Property Controlling  
in Section

S T

3. Miscellaneous  
Property in Sec.

S T

4. Lot No. , Recorded Plat

5. Private Claims

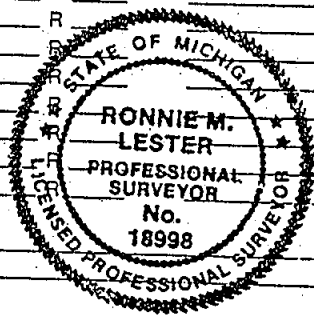
NOV 10 11:40 AM '93  
NOV 10 11:40 AM '93REGISTER OF DEEDS  
Ingham County, Michigan

Register of Deeds Stamp &amp; File Number

Ronnie M. Lester

November 5, 1993

do hereby certify that under requirements of P.A. 74, Michigan P.A. of 1970, the corner points mentioned in lines 1 and 2 above were in conformance with regulations and rules therefore as required in the current manual of survey instructions of the United States Department of the Interior, Bureau of Land Management or by a decree of a Court of Law and/or that the corner points mentioned in lines 3, 4 and 5 above were in conformance with the rules of the Michigan Board of Land Surveyors or by a Decree of a Court of Law; established, re-established, monumented, re-monumented, recovered, found as expressed below:

NOTE: Not more than 4 corners, all in the same town and range, may be recorded on this certificate.

	A	B	C	D	E	F	G	H	I	J	K	L	M
2	6	5	4	3	2	1							
3													
4	7	8	9	10	11	12							
5													
6	18	17	16	15	14	13							
7													
8	19	20	21	22	23	24							
9													
10	30	29	28	27	26	25							
11													
12	31	32	33	34	35	36							
13													

A. Description of original monument and accessories and/or subsequent restoration:

- (1) GLO record indicates: Wood post set by Joseph Wampler, US Deputy Surveyor in 1825. Witnesses: 20" oak, N84°W, 41 links and 26" elm, S42 1/2°W, 66 links.  
 (2) Ingham County Surveyor Records indicate that E.A. Caulkins, Deputy County Surveyor in a survey dated May 31, 1900, as recorded in Volume 5 page 40 of swamp oak, 15", S46°W, 48 links.  
 (3) Richard Steadman, PS #11370, in Land Corner Recordation Certificate (LCRC) recorded in Liber 3, Page 357 per PA 74, 1970, dated 6/16/1973 indicates: "Found wood anchor post at fourway fence intersection" CONTINUED ON BACK

B. Description of corner evidence found and/or method applied in restoring or reestablishing corner:

Investigation at this corner location revealed a 1/2" re-bar located 1.6' South of a 2" pipe and 5.5' South of a barb wire fence running East and West. No occupation North or South.  
 Found remnants of nail and ribbon or scar at three of four witness trees as noted in (4) of part "A". Accepted this 1/2" re-bar as perpetuated location of B-11. Measured East 2653.67' (Stephens 2654.92'; GLO 2640'); Measured West 2273.62' (GLO 2264.46'), Measured South 2643.08' (E.A. Caulkins 2649.24'). Set identification cap on 1/2" re-bar.

C. Description of monument for corner and accessories established to perpetuate locating the position of the corner:

North 1/4 corner Section 31, T2N, R2E. 1/2" re-bar and identification cap as described above.  
 Set galvanized nail and 1 1/4" brass tag stamped "LS 18998" East side 18: cottonwood, 223° az., 12.55'  
 Set galvanized nail and 1 1/4" brass tag stamped "LS 18998" West side 24" oak, 355° az., 4.68'  
 Set galvanized nail and 1 1/4" brass tag stamped "LS 18998" Northeast side 15" oak, 340° az., 26.60'  
 Set galvanized nail and 1 1/4" brass tag stamped "LS 18998" North side 12" oak, 295° az., 12.35'

Signed by Ronnie M. LesterDate November 8, 1993Surveyor's Michigan License No. 18998FORM APPROVED BY MICHIGAN STATE BOARD OF LAND SURVEYORS, JAN 27, 1971  
REVISED JAN 1972  
REVISED JAN 1973P.A. 345 INGHAM COUNTY  
PEER APPROVED 11/9/93

2548

CONTINUED FROM FRONT OF PAGE - "A"

- (3) continued: "I assume the wood anchor post marks the corner". Witnesses:  
14" oak, North, 4.9'  
8" oak, NNW 26.6'  
twin 4" ironwood, WNW, 23.5'
- (4) James Stephens, PS #16053, in LCRC recorded in Liber 6, Page 37 per PA 74, 1970, dated 2/21/1980 indicates: "Found 1/2" rod at fence intersection - bent. Replaced with another 1/2" bar from previously recorded witnesses". Witnesses:  
Nail in NW side 12" oak, NNW 12.19'  
Nail in East side 17" oak, North 26.6'  
Nail in West side 20" oak, North 4.9'  
Nail in East side 12" poplar, SW 12.71'
- (5) James Stephens, PS #16053 in Certificate of survey recorded per PA 132, 1970, as recorded in Liber 4, Page 17, dated 2/28/1980 calls for monument and witnesses as indicated in (4).
- (6) James Stephens, PS #16053 in Certificate of survey recorded per PA 132, 1970, as recorded in Liber 4, Page 19, dated 2/28/1980 calls for monument and witnesses as indicated in (4).
- (7) James Stephens, PS #16053 in Certificate of survey recorded per PA 132, 1970, as recorded in Liber 4, Page 21, dated 2/28/1980 calls for monument and witnesses as indicated in (4).
- No other information found on public record.

001EH3673 0008 MSSR 1980

001EH3673 0008 CORNER 1980

White Oak

## LAND CORNER RECORDATION CERTIFICATE

Filing Requirement of Act 74, Mich. P.A. 1970

FILED

For corners in

Ingham

Located in:

Corner Code #2

1. Public Land Survey

T 2N R 2E B-12

2. Property Controlling  
in Section

T	R
T	R
T	R
S	T
S	T
S	T

3. Miscellaneous  
Property in Sec.

4. Lot No.

Recorded Plat

5. Private Claims

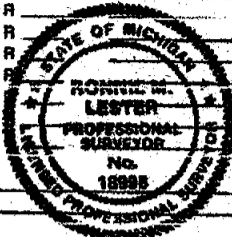

NOV 10 11 40 AM '93

 REGISTERED  
 INGHAM COUNTY, MICH.

Register of Deeds Stamp &amp; File Number

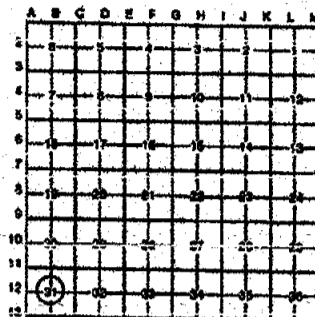

Ronnie M. Lester November 8 93

I, in a field survey on November 8, 1993, do hereby certify that under requirements of P.A. 74, Michigan P.A. of 1970, the corner points mentioned in lines 1 and 2 above were in conformance with regulations and rules therefore as required in the current manual of survey instructions of the United States Department of the Interior, Bureau of Land Management or by a decree of a Court of Law and/or that the corner points mentioned in lines 3, 4 and 5 above were in conformance with the rules of the Michigan Board of Land Surveyors or by a Decree of a Court of Law; established, re-established, monumented, re-monumented, re-covered, found as expressed below:

NOTE: Not more than 4 corners, all in the same town and range, may be recorded on this certificate.

A. Description of original monument and accessories and/or subsequent restoration:

No record of corner being established in original government survey.

Ingham County Surveyor's notes as recorded in Book 15, Page 141 dated May 31, June 1, 2, and 4, 1900 by E.A. Caulkins, Deputy County Surveyor indicate: "Went then to center of Section 31 and at point of intersection of 1/4 lines set iron rod beside post for corner from which bears: cherry 15", S68 1/2°, 168 links and Black oak, 8", S79 1/2°W 150 links". County Survey record and map of survey shows distances North, South, East, and West.

B. Description of corner evidence found and/or method applied in restoring or reestablishing corner:

Initial investigation at site revealed no evidence of corner location. No occupation lines North and South and irregular tree row East and West. Intersected East-West and North-South 1/4 lines. (Note: E.A. Caulkins calls for corner 12.2' North of East 1/4 corner as recorded in Liber 3, Page 325 of LCRC-used Caulkins location for computation) Investigation at this computed location revealed a 1" x 1/4" steel rod with flat top, 1.0 feet below surface of ground, that falls 1.24' North of East-West 1/4 line and 0.34' West of North-South 1/4 line. Measured North 2643.08 (Co. Surv. 2649.24') South 2659.16' (Co. Surv. 2658.81') East 2653.05' (Co. Surv. 2657.16') West 2386.94' (Co. Surv. 2389.30'). No question that this is corner set by Caulkins in 1900 survey. Set 1/2" bar and identification cap at surface of ground over 1" bar. Set 2"x 2" oak hub adjacent and 1"x 2" oak stake adjacent. Corner falls 5' South of East-West tree line. No Occupation North or South.

C. Description of monument for corner and accessories established to perpetuate locating the position of the corner:

Center of Section 31, T2N, R2E. 1/2" bar and cap over 1" bar.  
 Set galvanized nail and 1 1/4" brass tag stamped "LS 18998" in blaze on West side triple 30" red maple, 164° az., 16.51'  
 Set galvanized nail and 1 1/4" brass tag stamped "LS 18998" in blaze on South side 18" wild cherry, 87° az., 28.47'  
 Set galvanized nail and 1 1/4" brass tag stamped "LS 18998" in blaze on North side 24" red maple, 120° az., 56.60'  
 Set galvanized nail and 1 1/4" brass tag stamped "LS 18998" in blaze on East side 10" oak, 335° az., 6.38'

Signed by Ronnie M. Lester

Date

November 8, 1993

Surveyor's Michigan License No. 18998

 FORM SUPPLIED BY INGHAM STATE BOARD OF LAND SURVEYORS, JAN. 28, 1971  
 REVISED MAY 14, 1976  
 REISSUED JAN., 1982

2550

 P.A. 348 INGHAM COUNTY  
 PEER APPROVED 11/9/93 M.

White Oak

LAND CORNER RECORDATION CERTIFICATE  
Filing Requirement of Act 74, Mich. P.A. 1970

FILED

For corners in

Ingham County

Located in:

Corner Code: 2E

NOV 10 11 40 AM '93

REGISTER OF DEEDS

Frank O. Jenson

INGHAM COUNTY, MICH.

1. Public Land Survey

T 2N R 2E B-13

2. Property Controlling  
in Section

S T R

3. Miscellaneous  
Property in Sec.

S T R

4. Lot No. \_\_\_\_\_, Recorded Plat \_\_\_\_\_

5. Private Claims \_\_\_\_\_



Register of Deeds Stamp & File Number

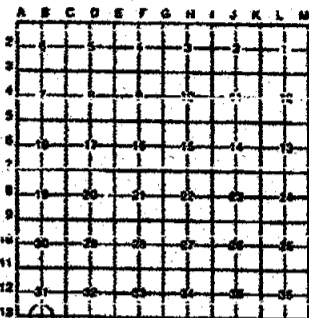

Ronnie M. Lester

November 5, 1993

I, in a field survey on November 5, 1993, do hereby certify that under requirements of P.A. 74, Michigan P.A. of 1970, the corner points mentioned in lines 1 and 2 above were in conformance with regulations and rules therefore as required in the current annual of survey instructions of the United States Department of the Interior, Bureau of Land Management or by a decree of a Court of Law and/or that the corner points mentioned in lines 3, 4 and 5 above were in conformance with the rules of the Michigan Board of Land Surveyors or by a Decree of a Court of Law; established, re-established, monumented, re-monumented, recovered, found as expressed before:

NOTE: Not more than 4 corners, all in the same town and range, may be recorded on this certificate.

A. Description of original monument and accessories and/or subsequent restoration:

- (1) GLO record indicates: Wood post set by Joseph Wampler, NS Deputy Surveyor in 1825. Witnesses: 11" b oak, N68°W, 112 links and 9" w oak, N66°E, 99 links.
- (2) Ingham County Surveyor Records indicate that E.A. Caulkins, Deputy County Surveyor in a survey dated May 31, 1900, as recorded in Volume 5 page 40 of County Surveyor records indicates: "Set a 1 1/4" steel mower shaft from which bears 7" w oak N54°W 228 1/2 links and 12" r oak, N89°W 150 links".

CONTINUED ON BACK OF DOCUMENT

B. Description of corner evidence found and/or method applied in restoring or reestablishing corner:

Investigation at this location revealed the 1 1/4" steel shaft to be in place as set by Caulkins and reported by Steadman in 1975. Measured North 2659.16' (Co. Surv. 2658.81') Measured East to 1" bar left by Caulkins 1329.15' (Caulkins 1327.92'). Set 1/2" bar and cap on South side of shaft. Falls in East-West fence line 27.6' East of fence corner post with fence to North only.

C. Description of monument for corner and accessories established to perpetuate locating the position of the corner:

- 1 1/4" steel shaft with 1/2" bar and identification cap at South edge as described above.
- Set galvanized nail and 1 1/4" brass tag stamped "LS 18998" South side twin 30" red oak, 95° az., 69.75'
- Set galvanized nail and 1 1/4" brass tag stamped "LS 18998" South side 18" cherry 310° az., 1.60'
- Set galvanized nail and 1 1/4" brass tag stamped "LS 18998" South side 12" apple, 285° az., 23.65'
- Set galvanized nail and 1 1/4" brass tag stamped "LS 18998" East side 10" shagbark hickory, 340° az., 64.58'

Signed by Ronnie M. Lester

Date November 8, 1993

Surveyor's Michigan License No. 18998

FORM APPROVED BY MICHIGAN STATE BOARD OF LAND SURVEYORS, JULY 26, 1971  
REVISED MAY 14, 1976  
REVISED JULY, 1989

2549

P.A. 545 INGHAM COUNTY  
PEER APPROVED 11/9/93 R

CONTINUED FROM FRONT OF PAGE - "A"

(3) Richard Steadman, PS #11370, in Land Corner Recordation Certificate (LCRC) recorded in Liber 3, Page 353 per PA 74, 1970, dated 3/17/1975 indicates: "Found 1 1/4" steel corner shaft with stones as set by E.A. Caulkins in a survey dated May 31, 1900. Corner in East-West fence".

Witnesses:

Wood anchor post (fence North) West, 28.5'  
36" oak, WNW, 101.34' (Stump only remaining 11/5/1993).  
20" oak, East, 69.67'  
5" w. cherry, N.W., 1.77'

No other documentation found on public record.

001ER5473	0008	RECOR	\$2.00
001ER5473	0008	EXNER	\$9.00

LAND CORNER RECORDATION CERTIFICATE  
Filing Requirement of Act 74, Mich. P.A. 1970

Liber 9 Page 269

For corners in

INGHAM COUNTY  
(County)

Located In:

Corner Code #

WHITE OAK TOWNSHIP

1. Public Land Survey

T 2N R 2E

C-11

T R

T R

T R

T R

2. Property Controlling  
in Section

S

T R

S

T R

3. Miscellaneous

S

T R

Property in Sec.

S

T R

FILED

970044061  
11/05/1997 12:39:57  
REGISTER OF DEEDS  
Paula Johnson  
INGHAM COUNTY, MI

Register of Deeds Stamp & File Number

4. Lot No. , Recorded Plat

5. Private Claims

I, DAVID L. CLIFFORD, in a field survey on AUGUST 25, 1997  
do hereby state that under requirements of P.A. 74, Michigan P.A. of 1970, the corner points  
mentioned in lines 1 and 2 above were in conformance with regulations and rules therefore as  
required in the current manual of survey instructions of the United States Department of the Interior,  
Bureau of Land Management or by a decree of a Court of Law and /or that the corner points  
mentioned in lines 3, 4 and 5 above were in conformance with the rules of the Michigan Board of  
Land Surveyors or by a Decree of a Court of Law; established, re-established, monumented,  
recovered, found as expressed below:

NOTE: Not more than 2 corners, all in the same town and range, may be recorded  
on this certificate.

	A	B	C	D	E	F	G	H	I	J	K	L	M
1													
2	6		5		4		3		2		1		
3													
4	7		8		9		10		11		12		
5													
6	18		17		16		15		14		13		
7													
8	19		20		21		22		23		24		
9													
10	30		29		28		27		26		25		
11													
12	31		32		33		34		35		36		
13													

A. Description of original monument and accessories and/or subsequent restoration:

1. JOSEPH WAMPLER D.S. SET POST IN ORIGINAL GOVERNMENT SURVEY IN  
NOVEMBER 1825: B.O. 20" N12-3/4E 36LKS; W.O. 23" S6-3/4W 43LKS
2. J. YOKUM, FORMER WASHTENAW COUNTY SURVEYOR WITNESSED CORNER IN 1878 AND RECORDED THEM IN HIS PRIVATE  
NOTES (NOW IN THE POSSESSION OF WOLVERINE ENGINEERS & SURVEYORS); W.O. 8" N78½W 57LKS, ELM 6" N13½E 37LKS
3. A.P. DRAKE, COUNTY SURVEYOR, STATES IN A SURVEY OF THE NW 1/4 OF SECTION 32 RECORDED IN VOLUME 3 PAGE 180 IN  
JULY 1881 THAT CORNER IS A STONE PLACED BY MR. YOKUM OF WASHTENAW COUNTY: W.O. 10" N79½W 57½LKS (37.8')
4. M. FOUTY, LPS #18989, RECORDED CORNER IN LIBER 3 PAGE 562 IN APRIL 1976 & RERECORDED IT IN LIBER 5 PAGE 204 IN  
MARCH 1979 BECAUSE HE HAD THE WITNESSES TRANSPOSED ON THE FIRST RECORDING: AFTER FINDING NO RECORD OF  
SUBSEQUENT RESTORATION BY THE COUNTY SURVEYOR HE SET 1/2" BAR & CAP FROM ADJACENT OCCUPATION LINES; NAIL &  
TAG SE SIDE 22" MAPLE WEST 25.82', NAIL & TAG NORTH SIDE 32" OAK EAST 20.38', NAIL & TAG W. SIDE 26" MAPLE NE 35.75'
- 5 J STEPHENS LPS # 16053 USED CORNER IN AN ACT 132 SURVEY RECORDED IN LIBER 4 PAGE 17 IN FEBRUARY 1980 WITH  
SAME WITNESSES AS ITEM 4

B. Description of corner evidence found and/or method applied in restoring or reestablishing corner:

SEARCHED AT APPARENT LOCATION OF CORNER AND FOUND A 1/2" BAR & MUTILATED CAP 2' EAST OF CENTERLINE PROCTER  
ROAD OPPOSITE ANCHOR POST TO WEST, MATCHING ALL FOUTY WITNESSES. YOKUM & DRAKES 10" OAK WITNESS TREE STILL  
STANDS (NOW 56") AND WITNESS DISTANCE IS NOT BEST FIT TO BAR. PULLED 36' FROM FACE OF 56" OAK AND EXCAVATED 6'  
X 6' HOLE 2' DEEP INTO NATURAL GROUND. HOLE ENCOMPASSED LOCATION OF BAR. FOUND NO FURTHER INDICATION OF  
CORNER. AS ROAD APPEARS TO BE CUT 2-3' IN THIS AREA BELIEVE STONE WAS DESTROYED IN THIS CUT. ACCEPTED 1/2" BAR  
AS CORNER MARKER BECAUSE OF INABILITY TO RECOVER ANY OTHER EVIDENCE OF A HISTORICAL NATURE. REPLACED 1/2" BAR  
WITH 3/4" BAR & PA 345 CAP.

C. Description of monument for corner and accessories established to perpetuate locating the position of the corner:

C-11 T2N, R2E  
3/4" X 24" STEEL BAR & YELLOW PLASTIC CAP IMPRINTED PA 345 PS 25837  
FOUND NAIL & TAG #18998 (RON LESTER) WEST SIDE 30" MAPLE, 30° NAZ, 35.75'  
SET NAIL & TAG #28409 (RON ENGER) SE SIDE 10" MAPLE, 215° NAZ, 45.42'  
FOUND NAIL & TAG #18998 NORTH SIDE 35" OAK, 100° NAZ, 20.39'  
FOUND NAIL & TAG #18998 SOUTH SIDE 23" MAPLE, 280° NAZ, 25.63'  
FOUND NAIL & TAG #18998 NORTH SIDE 56" OAK, 285° NAZ, 40.78'

Signed by David L. Clifford  
Surveyor's Michigan License No. 25837

Date OCTOBER 15, 1997

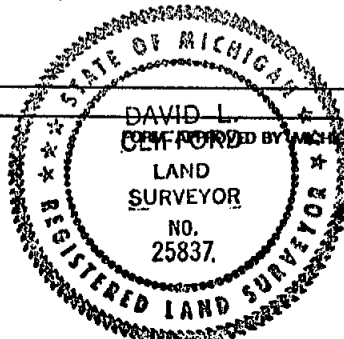

P.A. 345 INGHAM COUNTY  
PEER APPROVED 10/16/97 M

REVISOR: JAMES H. HARRIS, JR., JAN. 28, 1971  
REVISED MAY 14, 1975  
REVISED JAN., 1983  
REVISED OCT., 1985

LAND CORNER RECORDATION CERTIFICATE  
Filing Requirement of Act 74, Mich. P.A. 1970

For corners in

Liber 9 Page 269

INGHAM COUNTY

(County)

Located in:

Corner Code #

WHITE OAK TOWNSHIP

1. Public Land Survey

T 2N R 2E

C-11

T R

T R

T R

2. Property Controlling  
in Section

S T R

S T R

3. Miscellaneous

S T R

Property in Sec.

S T R

FILED

970044061  
11/05/1997 12:39:57  
REGISTER OF DEEDS  
Paula Johnson  
INGHAM COUNTY, MI

Register of Deeds Stamp & File Number

4. Lot No. , Recorded Plat

5. Private Claims

	A	B	C	D	E	F	G	H	I	J	K	L	M
1													
2	6		5		4		3		2		1		
3													
4	7		8		9		10		11		12		
5													
6	18		17		16		15		14		13		
7													
8	19		20		21		22		23		24		
9													
10	30		29		28		27		26		25		
11													
12	31		32		33		34		35		36		
13													

I, DAVID L. CLIFFORD

, in a field survey on AUGUST 25, 1997  
do hereby state that under requirements of P.A. 74, Michigan P.A. of 1970, the corner points  
mentioned in lines 1 and 2 above were in conformance with regulations and rules therefore as  
required in the current manual of survey instructions of the United States Department of the Interior,  
Bureau of Land Management or by a decree of a Court of Law and /or that the corner points  
mentioned in lines 3, 4 and 5 above were in conformance with the rules of the Michigan Board of  
Land Surveyors or by a Decree of a Court of Law; established, re-established, monumented,  
recovered, found as expressed below:

NOTE: Not more than 2 corners, all in the same town and range, may be recorded  
on this certificate.

A. Description of original monument and accessories and/or subsequent restoration:

1. JOSEPH WAMPLER D.S. SET POST IN ORIGINAL GOVERNMENT SURVEY IN  
NOVEMBER 1825: B.O. 20" N12-3/4E 36LKS; W.O. 23" S6-3/4W 43LKS
2. J. YOKUM, FORMER WASHTENAW COUNTY SURVEYOR WITNESSED CORNER IN 1878 AND RECORDED THEM IN HIS PRIVATE  
NOTES (NOW IN THE POSSESSION OF WOLVERINE ENGINEERS & SURVEYORS); W.O. 8" N78 1/2 W 57LKS, ELM 6" N13 1/2 E 37LKS
3. A.P. DRAKE, COUNTY SURVEYOR, STATES IN A SURVEY OF THE NW 1/4 OF SECTION 32 RECORDED IN VOLUME 3 PAGE 180 IN  
JULY 1881 THAT CORNER IS A STONE PLACED BY MR. YOKUM OF WASHTENAW COUNTY: W.O. 10" N79 1/2 W 57 1/4 LKS (37.8')
4. M. FOUTY, LPS #18989, RECORDED CORNER IN LIBER 3 PAGE 562 IN APRIL 1976 & RERECORDED IT IN LIBER 5 PAGE 204 IN  
MARCH 1979 BECAUSE HE HAD THE WITNESSES TRANSPOSED ON THE FIRST RECORDING: AFTER FINDING NO RECORD OF  
SUBSEQUENT RESTORATION BY THE COUNTY SURVEYOR HE SET 1/2" BAR & CAP FROM ADJACENT OCCUPATION LINES; NAIL &  
TAG SE SIDE 22" MAPLE WEST 25.82', NAIL & TAG NORTH SIDE 32" OAK EAST 20.38', NAIL & TAG W. SIDE 26" MAPLE NE 35.75'
- 5 J STEPHENS LPS # 16053 USED CORNER IN AN ACT 132 SURVEY RECORDED IN LIBER 4 PAGE 17 IN FEBRUARY 1980 WITH  
SAME WITNESSES AS ITEM 4

B. Description of corner evidence found and/or method applied in restoring or reestablishing corner:

SEARCHED AT APPARENT LOCATION OF CORNER AND FOUND A 1/2" BAR & MUTILATED CAP 2' EAST OF CENTERLINE PROCTER  
ROAD OPPOSITE ANCHOR POST TO WEST, MATCHING ALL FOUTY WITNESSES. YOKUM & DRAKES 10" OAK WITNESS TREE STILL  
STANDS (NOW 56") AND WITNESS DISTANCE IS NOT BEST FIT TO BAR. PULLED 36' FROM FACE OF 56" OAK AND EXCAVATED 6'  
X 6' HOLE 2' DEEP INTO NATURAL GROUND. HOLE ENCOMPASSED LOCATION OF BAR. FOUND NO FURTHER INDICATION OF  
CORNER. AS ROAD APPEARS TO BE CUT 2-3' IN THIS AREA BELIEVE STONE WAS DESTROYED IN THIS CUT. ACCEPTED 1/2" BAR  
AS CORNER MARKER BECAUSE OF INABILITY TO RECOVER ANY OTHER EVIDENCE OF A HISTORICAL NATURE. REPLACED 1/2" BAR  
WITH 3/4" BAR & PA 345 CAP.

C. Description of monument for corner and accessories established to perpetuate locating the position of the corner:

C-11 T2N, R2E

- 3/4" X 24" STEEL BAR & YELLOW PLASTIC CAP IMPRINTED PA 345 PS 25837  
FOUND NAIL & TAG #18998 (RON LESTER) WEST SIDE 30" MAPLE, 30° NAZ, 35.75'  
SET NAIL & TAG #28409 (RON ENGER) SE SIDE 10" MAPLE, 215° NAZ, 45.42'  
FOUND NAIL & TAG #18998 NORTH SIDE 35" OAK, 100° NAZ, 20.39'  
FOUND NAIL & TAG #18998 SOUTH SIDE 23" MAPLE, 280° NAZ, 25.63'  
FOUND NAIL & TAG #18998 NORTH SIDE 56" OAK, 285° NAZ, 40.78'

Signed by David L. Clifford  
Surveyor's Michigan License No. 25837

Date OCTOBER 15, 1997

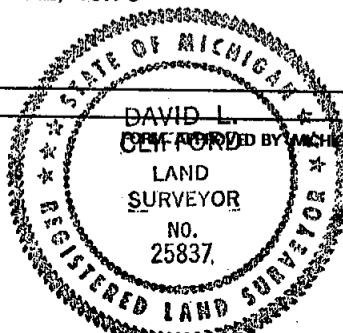

P.A. 345 INGHAM COUNTY  
PEER APPROVED 10/16/97 M

REVISOR MAY 14, 1975  
REVISED JAN., 1983  
REVISED OCT., 1985

## Libr 9: Page 188

Located in: Corner Code #

**FILED**

97005948  
OFFICE OF THE  
REGISTER OF DEEDS  
Paula Johnson  
LITCHFIELD COUNTY, CT

### Register of Deeds Stamp & File Number

1. Public Land Survey		T2N	R2E	G-12
		T	R	
		T	R	
		T	R	
2. Property Controlling in Section	S	T	R	
	S	T	R	
3. Miscellaneous Property in Sec.	S	T	R	
	S	T	R	

4. Lot No. \_\_\_\_\_ Recorded Plat \_\_\_\_\_  
5. Private Claims \_\_\_\_\_

I, Maurice H. Maheu, in a field survey on April 8, 1994 do hereby state that under requirements of P.A. 74, Michigan P.A. 191-1979, the corner points mentioned in lines 1 and 2 above were in conformance with regulations and rules therefore as required in the current manual of survey instructions of the United States Department of the Interior, Bureau of Land Management or by a decree of a Court of Law and for that the corner points mentioned in lines 3, 4 and 5 above were in conformance with the rules of the Michigan Board of Land Surveyors or by a Decree of a Court of Law; established, re-established, monuments, recovered, found as expressed above.

NOTE: Not more than 2 comers, all in the same town and range, may be recorded on this certificate.

**A. Description of original monument and accessories and/or subsequent restoration:**

1. GLO corner set by Joseph Wampler, US Deputy Surveyor, on November 30, 1823  
10/20/2001 Sat. 11:00 AM. 100' S 14° E 20 S 14° E
2. Surveyor of the 1st. Grange County Survey on Liber 2, Page 199 on May 3, 1881 set  
this corner at the NW corner of School House N 55 3/4° E 114 1/4° S. SE Cor.  
of Beaver Monument N 21 3/4° W 150 1/4 S.
3. Surveyed by A. Clarke in 1887. Page 411 on June 4, 1890 calls for "Stone &  
Brick, F. W. Bear's SW Corner of School House S 55 3/4° E 114 1/4° S; SE Corner of  
Degeert Monument NW 200 3/4 S.

**See Part A continued on back**

B. Description of corner evidence found and/or method applied in restoring or reestablishing corner:

Found 1/4 rod as recorded in Liber 3, Page 325. In an uncompleted survey in April 1894 by this surveyor, the witness of E.A. Calkins of the Degeen Monument was located. Measured southeast of monument 200 3/4 links (132.5'). Dig 2' diameter hole 142' from monument. Found a corner of stone and brick. Found a corner of stone and brick. Measured 13.07 feet north of West 1/4 corner recorded in Liber 3, Page 325, measured 130.3' SSE of the Southeast Corner of Degeen Monument (corner of headstone). Set 4' x 38" concrete monument with 1/4" iron rod and cap #23414 over location of stone. Set monument box and cover over corner monument. Assume the A. P. Drake distance of 150.14' to monument was in error and E.A. Calkins dimension of 200 3/4' is correct. The found stone is assumed to be the stone set by A. P. Drake. County Surveyors and the perpetuated location for the corner.

C. Description of monument for corner and accessories established to perpetuate locating the position of the corner:

Set 4" x 36" monument with W iron rod with cap #22414, witnessed by:  
 Set 4" x 160" iron rod with cap #22415, 3670' N 58.5° E 58.70 feet  
 Nail and Tag #18998 South Side 32' Oak N40° W 77.04 feet  
 Nail and Tag #22414 East side Utility Pole S50° E 58.70 feet  
 Nail Iron Tag #22414 North side Utility Pole N50° E 40.50 feet  
 Centerline of 3" diameter metal fence corner post N45° E 36.72 feet  
 3/4" iron rod (3" P 325) South 13.07 feet  
 Southeast Corner of Davenport Monument, N20° W 13.25 feet

Signed by *M. J. Quinn & H. Mahon* Date *7-8-41*

FORM APPROVED BY MICHIGAN STATE BOARD OF PROFESSIONAL SURVEYORS, JAN. 26, 1971  
REVISED MAY 14 1975

PUBLISHED JAN. 1962  
 BOSTON, OCT. 1962



P.A. 345 INGHAM COUNTY  
FEEB APPROVED 3/25/07

4. Ingham County Road Commission Old Map of 1988 calls for 1" iron witness by: P.P. NE 60.70'  
P.C. SE 68.32'  
14" Oak NW 82.83'  
3" Fence Post NE 87.46.46'
5. Act 74 LORC in Liber 3, Page 325 on Jan. 29, 1975 by George M. Young, P.S. 17940 calls for found 3/4" iron rod witness by:  
Nail in 18" Oak NW 80.35'  
Nail in 18" Oak NW 80.35'  
Face of 2" iron post N 20° W 46.35'
6. An Act 132 Survey recorded by George Young P.S. 17940 in Liber 2, Page 283 dated Jan. 29, 1975 calls for same as A-5.
7. An Act 132 Survey by George Young P.S. 17940 in Liber 2, Page 327 dated April 1, 1975 calls for same as A-5.
8. An Act 132 Survey recorded by Marv Fouly P.S. 18889 in Liber 2, Page 632 dated April 28, 1978 calls for same as A-5.
9. An Act 132 Survey recorded by Austin Williams P.S. 21275 in Liber 3, Page 653 dated Aug. 7, 1978 calls for same as A-5.
10. An Act 132 Survey recorded by James E. Stephens P.S. 18093 in Liber 4, Pages 17 through 22 dated May 7, 1980 calls for same as A-5.
11. Act 132 Survey by George Young P.S. 17940 recorded in Liber 5, Page 518 on October 6, 1988 calls for: Found 3/4" iron rod witness by:  
Nail in 18" Oak NW 80.35'  
Nail in 18" Oak NW 80.47'  
Face of 2" iron post NW 46.35'
12. Act 132 Survey recorded by Ronnie Lester, P.S. 18888 in Liber 6, Page 958, 959, dated June 5, 1992 calls for 3/4" iron bar, witness by:  
Found nail and cap West side U.L. Pole 61° az, 47.8'  
Nailhead corner corner 60°/90° Elevation, 142' az, 151.1'  
Set nail and cap in South side 34° Oak 301° az, 80.2'  
Face of 3" steel fence corner post at cemetery 324° az, 46.3'
13. In private records of Wolverine Engineers and Surveyors, Inc. of an uncompleted job April 1994 calls for set concrete monument  
Explanation in Part B.
14. An Act 132 survey by Maurice Mahieu, P.S. 28414 recorded in Liber 7, Page 399 dated August 9, 1994 calls for corner as dictated by this  
certificate and the corner recorded in Liber 3, Page 325 as a property controlling corner.
15. An Act 132 Survey recorded by Ron Heald P.S. 18894 in Liber 7, Page 407 dated November 15, 1994 calls for same as A-5.

Act 132  
1994  
11.11.94

EIFED

**LAND CORNER RECORDATION CERTIFICATE**  
**Filing Requirement of Act 74, Mich. P.A. 1970**

For corners in

INGHAM COUNTY  
 (County)

Located In:

Corner Code #

WHITE OAK TOWNSHIP

1. Public Land Survey

T 2N R 2EC-13

T \_\_\_\_\_ R \_\_\_\_\_

T \_\_\_\_\_ R \_\_\_\_\_

T \_\_\_\_\_ R \_\_\_\_\_

T \_\_\_\_\_ R \_\_\_\_\_

2. Property Controlling  
in Section

S \_\_\_\_\_ T \_\_\_\_\_ R \_\_\_\_\_

S \_\_\_\_\_ T \_\_\_\_\_ R \_\_\_\_\_

3. Miscellaneous  
Property in Sec.

S \_\_\_\_\_ T \_\_\_\_\_ R \_\_\_\_\_

S \_\_\_\_\_ T \_\_\_\_\_ R \_\_\_\_\_

4. Lot No. \_\_\_\_\_, Recorded Plat \_\_\_\_\_

5. Private Claims \_\_\_\_\_

DEC 1 8 06 AM '94

REGISTER OF DEEDS

*David L. Clifford*  
 INGHAM COUNTY, MICH.

Register of Deeds Stamp &amp; File Number

I, David L. Clifford a field survey on April 23, 1994,  
 do hereby certify that under requirements of P.A. 74, Michigan P.A. of 1970, the corner points mentioned  
 in lines 1 and 2 above were in conformance with regulations and rules therefore as required in the  
 current manual of survey instructions of the United States Department of the Interior, Bureau of Land  
 Management or by a decree of a Court of Law and/or that the corner points mentioned in lines 3, 4 and 5  
 above were in conformance with the rules of the Michigan Board of Land Surveyors or by a Decree of a  
 Court of Law; established, re-established, monumented, re-monumented, recovered, found as  
 expressed below:

**NOTE: Not more than 4 corners, all in the same town and range, may be recorded  
 on this certificate.**

A. Description of original monument and accessories and/or subsequent restoration:

1. Original Post set by J. Wampler D.S. in Aug. 1824

W.O. 20 N51E 6 (4.0')

Maple 9 N58E 98½ (65.0')

2. Corner Used by W.A. Rowe Co. Surveyor in Oct. 1895

recorded in Field book 15 page 26 in which he stated that  
 he found the original post and witnesses in good condition  
 and he found the original post at the N.W. Corner  
 of Sec. 5 Stockbridge in good condition and in the  
 proper relationship to the S.W. Cor. of Sec. 32  
 White Oak Township.

OVER

B. Description of corner evidence found and/or method applied in restoring or reestablishing corner:

Searched at aparent location of corner and found Anchor  
 Post hole 213.2 feet East of C1 Stockbridge Township  
 This being the exact GLO falling I accepted Post Hole  
 as location of corner and set Standard Bar & PA 345  
 Cap in Center of large mound of stone after excavating  
 around post hole and finding a fantastic amount of  
 run of the mill fence post stones. Measured East  
 2631.43' to D13 White Oak Township.

C. Description of monument for corner and accessories established to perpetuate locating the position of the corner:

Set Standard 3/4" Steel Bar and PA 345 Cap PS #25837  
 in Anchor Post Hole At East-West-North Fence Corner

Set Nail &amp; Tag#25837 in S. Side 12" Hick. Naz 98° 40.42'

Set Nail &amp; Tag#25837 in W. Side 36" Map. Naz 190° 39.91'

Set Nail &amp; Tag#25837 in W. Side 14" Hick. Naz 217° 49.93'

Set Nail &amp; Tag#25837 in SE Side 22" Swamp Oak Naz 238° 25.74'

3/4" Pipe (C-1, T1N, R2E) Naz 272° 213.20'

Signed by David Clifford Date Oct. 11 1994Surveyor's Michigan License No. 25837

P.A. 345 INGHAM COUNTY

PEER APPROVED 10/12/94

2749

3. George Young L.S. #17640 recorded corner in Liber 3 of  
corners page 325 in Jan. 1975 as an anchor post.

LIBER

8 PAGE 392

Nail in 24" Maple South 39.95'

Nail in 12" Hick. S40°W 49.57'

Nail in 18" Oak S50°W 25.76'

4. George Young used corner in surveys recorded in liber 2  
of surveys page 263 in Jan. 1975 and liber 2 page 327  
in April 1975 with the same mon. & witnesses as in item  
3.

2749

LAND CORNER RECORDATION CERTIFICATE  
Filing Requirement of Act 74, Mich. P.A. 1970

LIBER 8 PAGE 391  
FILED

For corners in

INGHAM COUNTY

Located in:

Corner Code: #

WHITE OAK TOWNSHIP

1. Public Land Survey

T 2N R 2E

C-13

Dec 1 8 06 AM '94

REGISTER OF DEEDS

Paul Johnson  
INGHAM COUNTY, MICH.

Register of Deeds Stamp & File Number

4. Lot No. \_\_\_\_\_, Recorded Plat \_\_\_\_\_

5. Private Claims \_\_\_\_\_

I, David L. Clifford a field surveyor on April 23, 1994  
do hereby certify that under requirements of P.A. 74, Michigan P.A. of 1970, the corner points mentioned  
in lines 1 and 2 above were in conformance with regulations and rules therefore as required in the  
current manual of survey instructions of the United States Department of the Interior, Bureau of Land  
Management or by a decree of a Court of Law and/or that the corner points mentioned in lines 3, 4 and 5  
above were in conformance with the rules of the Michigan Board of Land Surveyors or by a Decree of a  
Court of Law; established, re-established, monumented, re-monumented, recovered, found, as  
expressed below:

NOTE: Not more than 4 corners, all in the same town and range, may be recorded  
on this certificate.

A. Description of original monument and accessories and/or subsequent restoration:

1. Original Post set by J. Wampler D.S. in Aug. 1824  
W.O. 20 N51E 6 (4.0')

2. Corner Used by W.A. Rowe Co. Surveyor in Oct. 1895  
recorded in Field book 15 page 26 in which he stated that  
he found the original post and witnesses in good condition  
and he found the original post at the N.W. Corner  
of Sec. 5 Stockbridge in good condition and in the  
proper relationship to the S.W. Cor. of Sec. 32  
White Oak Township.

OVER

B. Description of corner evidence found and/or method applied in restoring or reestablishing corner:

Searched at apparent location of corner and found Anchor  
Post hole 213.2 feet East of C1 Stockbridge Township  
This being the exact GLO falling I accepted Post Hole  
as location of corner and set Standard Bar & PA 345  
Cap in Center of large mound of stone after excavating  
around post hole and finding a fantastic amount of  
run of the mill fence post stones. Measured East  
2631.43' to D13 White Oak Township.

C. Description of monument for corner and accessories established to perpetuate locating the position of the corner:

Set Standard 3/4" Steel Bar and PA 345 Cap PS #25837  
in Anchor Post Hole At East-West-North Fence Corner

Set Nail & Tag #25637 in S. Side 12" Hick. Naz 98° 40.42'  
Set Nail & Tag #25837 in W. Side 36" Map. Naz 190° 39.91'  
Set Nail & Tag #25837 in W. Side 14" Hick. Naz 217° 49.93'  
Set Nail & Tag #25837 in SE Side 22" Swamp Oak Naz 238° 25.74'  
3/4" Pipe (C-1, T1N, R2E) Naz 272° 213.20'

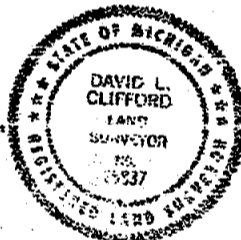

Signed by David L. Clifford

Date Oct. 11 1994

Surveyor's Michigan License No. 25837

2749

P.A. 345 INGHAM COUNTY  
PEER APPROVED 10/12/94

APPROVED BY MICHIGAN STATE BOARD OF LAND SURVEYORS, JAN. 23, 1971  
REVISED MAY 14, 1973  
REVISED JAN. 1982

3. George Young L.S. 127640 recorded corner in Liber 3 of LIBER  
corners page 325 in Jan. 1975 as an anchor post.

8 PAUL 392

Nail in 24" Maple South 39.95'

Nail in 12" Hick. S40°W 49.57'

Nail in 18" Oak S50°W 25.76'

4. George Young used corner in surveys recorded in Liber 2  
of surveys page 263 in Jan. 1975 and Liber 2 page 327  
in April 1975 with the same mon. & witnesses as in item  
3.

2749