

LAND CORNER RECORDATION CERTIFICATE
FILING REQUIREMENT OF ACT 74, MICH. P.A. 1970

LIBER 3 PG 193

FOR CORNERS OF:- LOCATED IN:- CORNER CODE NUMBER
1. PUBLIC LAND SURVEY T 2 S. R. 2 E. E-11, E-12
2. PROPERTY CONTROL- S. R. E.
ING IN SECTION
3. MISCELLANEOUS S. R. E.
PROPERTY IN SECTION
4. LOT NO. RECORDED PLAT
5. PRIVATE CLAIMS

FILED

JUL 16 12 58 PM '74
REGISTER OF DEEDS
Linda M. Young
INGHAM COUNTY, MICH.

REGISTER OF DEEDS STAMP AND
FILING NUMBER

I, George M. Young do hereby certify that under requirements of P.A. 74, Michigan P.A. of 1970 the corner points mentioned in lines 1 and 2 above identified with circles on index code diagram - over were in a field survey on Feb. 15, 1974, established, re-established, monumented, re-monumented, recovered or restored as expressed below and in conformance with regulations and rules therefore as required in the current manual of survey instructions of the United States Department of the Interior, Bureau of Land Management or by a decree of a court of law. Furthermore, that the corner points mentioned in lines 3, 4 and 5 above were in a field survey on 1974, found, recovered, restored, established or re-established as expressed below and in conformance with the rules of the Michigan State Board of Registration for Land Surveyors or, by a Decree of a court of law:

A. Description of original monument and accessories and of subsequent restoration:

E-11 No Evidence of original Cor. Found
E-12 No Evidence of original Cor. Found

B. Description of corner evidence found and of method applied in restoring or re-establishing corner:

E-11 Found 3/4" Pipe
E-12 Found 3/4" Pipe

C. Description of monument for corner and accessories established to perpetuate locating the position of the corner:

E-11 Ties to Pipe: P.K. Nail in 18" Walnut N 87° E 26.15'
P.K. Nail in 12" Walnut W 27.19'
P.K. Nail in 8" Walnut E 34.60'
E-12 Ties to Pipe: Spike in P.P. N 20° E 49.63'
Nail in 24" Hickory S 45° W 51.46'
Edge of Asphalt West 10.4'



SIGNED BY George M. Young

DATE May 23, 1974

SURVEYOR'S MICHIGAN REGISTRATION NO. 17640

(SEAL)

FOR STATE AND UNITED STATES AGENCIES:

SIGNED BY

CHIEF OF SURVEY PARTY

DATE

APPROVED AND SIGNED BY

MICHIGAN REGISTERED LAND SURVEYOR

DATE

(SEAL)

SURVEYOR'S MICHIGAN REGISTRATION NO.

740

Form No. MLM736
DOUGLASS BROS. & CO., Kalamazoo, MICH.

FORM APPROVED BY MICHIGAN STATE BOARD OF REGISTRATION, JAN. 25, 1971
DISTRIBUTED BY MICHIGAN SOCIETY OF REGISTERED LAND SURVEYORS

CORNER NUMBERING CODE DIAGRAMS FOR IDENTIFYING LAND CORNER RECORDATIONS AND INDEXING

FOR PUBLIC LAND SURVEY CORNERS IN THE
T. 2N, R. 2E (MENTIONED OVER)

	A	B	C	D	E	F	G	H	I	J	K	L	M
2	6		5		4		3		2		1		
3													
4	7		8		9		10		11		12		
5													
6	18		17		16		15		14		13		
7													
8	19		20		21		22		23		24		
9													
10	30		29		28		27		26		25		
11													
12	31		32		33		34		35		36		
13													

Apply letter prefix for corner points encircled above
for identifying corner recordation numbers over.

FOR PROPERTY CONTROLLING AND MISC.
PROPERTY CORNERS WITHIN THE SECTION
(MENTIONED OVER AND EXCLUDE LOT CORNER)

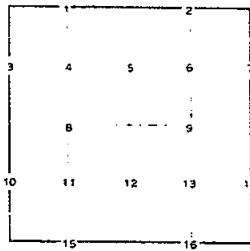

1. Above coded numbers are positioned on 1/16 fractional lines of the section.
2. Township corner code numbers shall be applied to corners of above typical section not numbered.
3. Miscellaneous property corners within a section, located at points other than numbered above, shall be referenced to at least two of above corner code numbers.
4. Private claim corners to be tied to rectangular land corners if possible - sketch required below.

EXPLANATORY SKETCH IF NECESSARY -- BELOW

Blank area for explanatory sketch.

16# 46535 *000500 LHS

LAND CORNER RECORDATION CERTIFICATE

FILING REQUIREMENT OF ACT 74, MICH. P.A. 1970

W 1/4 corner, Section 36, T4N, R1W, Meridian Township
Ingham County

3 PG 293

FOR CORNERS OF—

LOCATED IN—

CORNER CODE NUMBER

LIBER

FILED

1. PUBLIC LAND SURVEY T. 4N N. R. 1W W. K-12

2. PROPERTY CONTROLLING IN SECTION T. N. R. W.

3. MISCELLANEOUS PROPERTY IN SECTION T. N. R. W.

4. LOT NO. RECORDED PLAT

5. PRIVATE CLAIMS

Nov 22 10 29 AM '74

REGISTER OF DEEDS

Emil M. Lewis
INGHAM COUNTY, MICH.

REGISTER OF DEEDS STAMP AND
FILING NUMBER

I, James E. Stephens do hereby certify that under requirements of P.A. 74, Michigan P.A. of 1970 the corner points mentioned in lines 1 and 2 above (identified with circles on index code diagram—overlaid) were, in a field survey on October 8 1974, established, re-established, monumented, re-monumented, recovered or restored as expressed below and in conformance with regulations and rules therefore as required in the current manual of survey instructions of the United States Department of the Interior, Bureau of Land Management or by a decree of a court of law. Furthermore, that the corner points mentioned in lines 3, 4 and 5 above were, in a field survey on 19 1974, found, recovered, restored, established or re-established as expressed below and in conformance with the rules of the Michigan State Board of Registration for Land Surveyors or, by a Decree of a Court of law:

A. Description of original monument and accessories and or subsequent restoration:

The original monument and accessories were not found.

B. Description of corner evidence found and/or method applied in restoring or re-establishing corner:

M.D.S.H. & T. information calls for a pointed stone, none was found. No witness tags were found in witness trees. Dimensions from witness trees intersect in the center of a 3" diameter steel fence post, at the intersection of three fences, North, South, and East of the corner.

Researched records of 8 area Registered Land Surveyors.

C. Description of monument for corner and accessories established to perpetuate locating the position of the corner:

The 3 inch diameter steel corner fence post was determined as being at the 1/4 corner and was witnessed as follows:

Survey tag in the South side of a 30" Twin Poplar tree, N10°14'E 30.22 feet.
Survey tag in the North side of a 24" Triple Oak tree, S23°17'E 26.07 feet.
Survey tag in the East side of a 22" Poplar tree, S43°25'W 32.14 feet.

SIGNED BY James E. Stephens DATE October 10, 1974

SURVEYOR'S MICHIGAN REGISTRATION NO. 16053

FOR STATE AND UNITED STATES AGENCIES:

SIGNED BY _____ DATE _____

APPROVED AND SIGNED BY _____ DATE _____



SURVEYOR'S MICHIGAN REGISTRATION NO. _____

790

Form No. 34, 1973
DOUBLEDAY PAGE, & CO., HALEMARTON, MICH.

FORM APPROVED BY MICHIGAN STATE BOARD OF REGISTRATION, JAN. 28, 1971
DISTRIBUTED BY MICHIGAN SOCIETY OF REGISTERED LAND SURVEYORS

CORNER NUMBERING CODE DIAGRAMS FOR IDENTIFYING LAND CORNER RECORDATIONS AND INDEXING

FOR PUBLIC LAND SURVEY CORNERS IN THE
T. 4N R. 1W (MENTIONED OVER)

	A	B	C	D	E	F	G	H	I	J	K	L	M
2	6		5		4		3		2		1		
3													
4	7		8		9		10		11		12		
5													
6	16		17		18		15		14		13		
7													
8	19		20		21		22		23		24		
9													
10	30		29		28		27		26		25		
11													
12	31		32		33		34		35		36		
13													

Apply letter prefix for corner points encircled above
for identifying corner recordation numbers over.

FOR PROPERTY CONTROLLING AND MISC.
PROPERTY CORNERS WITHIN THE SECTION
(MENTIONED OVER AND EXCLUDE LOT CORNER)

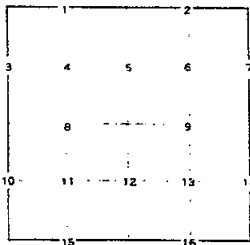

- 1. Above coded numbers are positioned on 1/16 fractional lines of the section.
- 2. Township corner code numbers shall be applied to corners of above typical section not numbered.
- 3. Miscellaneous property corners within a section, located at points other than numbered above, shall be referenced to at least two of above corner code numbers.
- 4. Private claim corners to be tied to rectangular land corners if possible - sketch required below.

EXPLANATORY SKETCH IF NECESSARY -- BELOW

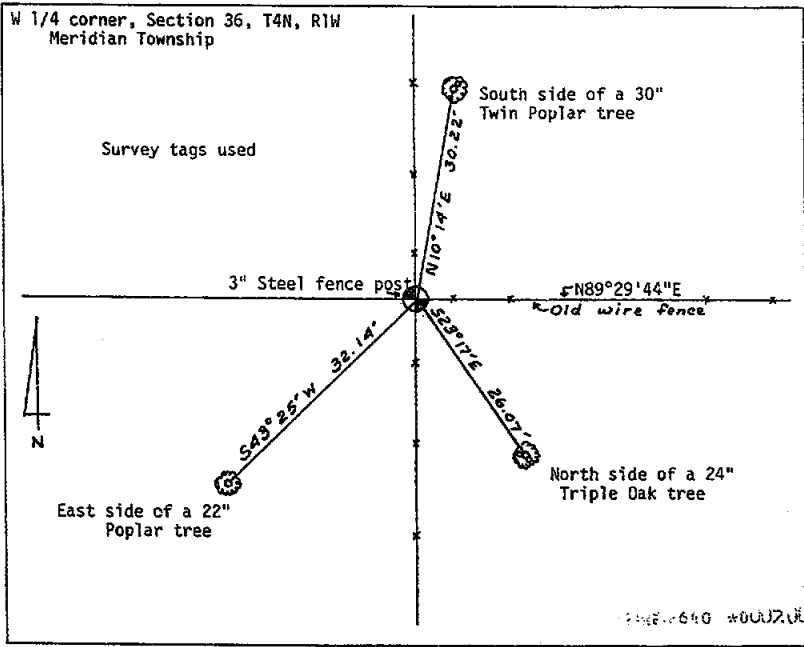

LAND CORNER RECORDATION CERTIFICATE

FILING REQUIREMENT OF ACT 74, MICH. P.A. 1970

LIBER

3 PG 403

FOR CORNERS OF—

LOCATED IN—

CORNER CODE NUMBER

1. PUBLIC LAND SURVEY 27 T. 2 S. R. 2 E. G-11, H-10, H-11

FILED

2. PROPERTY CONTROLLING IN SECTION T S. R. E. W.

JUL 15 11 34 AM '75

3. MISCELLANEOUS PROPERTY IN SECTION T S. R. E. W.

REGISTER OF DEEDS

George M. Young
INGHAM COUNTY, MICH.

4. LOT NO. RECORDED PLAT

5. PRIVATE CLAIMS

REGISTER OF DEEDS STAMP AND
FILING NUMBER

I, George M. Young do hereby certify that under requirements of P.A. 74, Michigan P.A. of 1970 the corner points mentioned in lines 1 and 2 above (identified with circles on index code diagram—over) were, in a field survey on June 5, 1975, established, re-established, monumented, re-monumented, recovered or restored as expressed below and in conformance with regulations and rules therefore as required in the current manual of survey instructions of the United States Department of the Interior, Bureau of Land Management or by a decree of a court of law. Furthermore, that the corner points mentioned in lines 3, 4 and 5 above were, in a field survey on 19, found, recovered, restored, established or re-established as expressed below and in conformance with the rules of the Michigan State Board of Registration for Land Surveyors or, by a Decree of a Court of law:

A. Description of original monument and accessories and/or subsequent restoration:

G-11 Original monument & Accessories not found

H-10 Original monument & Accessories not found

H-11 Original monument & Accessories not found

B. Description of corner evidence found and/or method applied in restoring or re-establishing corner:

G-11 Found 1 1/4" iron pipe

H-10 Found 3/4" iron in Mont. Box

H-11 Found 3/4" iron in Mont. Box

C. Description of monument for corner and accessories established to perpetuate locating the position of the corner:

G-11 Found 1 1/4" iron pipe - Nail & Tag 12" Oak W.S.W. 4.65'
Nail & Tag 12" Oak N 12.32'
Nail & Tag 8" Maple NE 29.75'
H-10 Found 3/4" iron - Nail & Tag P.O. N.N.W. 107.22'
Nail & Tag 8" Maple W 45.57'
H-11 Found 3/4" iron - Nail & Tag 24" Maple N.W. 82.53'
Nail & Tag 36" Maple W.N.W. 30.15'
W. Edge Asphalt M-52 E 31.30'

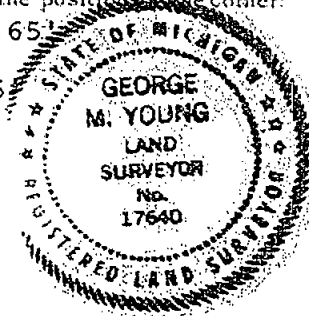

SIGNED BY *George M. Young* DATE July 11, 1975

SURVEYOR'S MICHIGAN REGISTRATION NO. 17640

(SEAL)

FOR STATE AND UNITED STATES AGENCIES:

SIGNED BY _____ DATE _____

CHIEF OF SURVEY PARTY

APPROVED AND SIGNED BY _____ DATE _____

MICHIGAN REGISTERED LAND SURVEYOR

(SEAL)

SURVEYOR'S MICHIGAN REGISTRATION NO. 17640

845

Form No. MLW735
DOUGLASS BROS. & CO., Kalamazoo, MICH.

FORM APPROVED BY MICHIGAN STATE BOARD OF REGISTRATION, JAN. 28, 1971
DISTRIBUTED BY MICHIGAN SOCIETY OF REGISTERED LAND SURVEYORS

LAND CORNER RECORDATION CERTIFICATE

FILING REQUIREMENT OF ACT 74, MICH. P.A. 1970

LIBER

4 PG 212

FILED

FOR CORNERS OF-- LOCATED IN-- CORNER CODE NUMBER

1. PUBLIC LAND SURVEY 1 2N 2E 1 W F-10, F-11

2. PROPERTY CONTROLLING IN SECTION 1 2E 1 W

3. MISCELLANEOUS PROPERTY IN SECTION 1 2E 1 W

4. LOT NO. RECORDED PLAT

5. PRIVATE CLAIMS

JUN 20 8 36 AM '78

REGISTER OF DEEDS

Paula Johnson
INGHAM COUNTY, MICH.

REGISTER OF DEEDS STAMP AND
FILING NUMBER

I, George M. Young, do hereby certify that under requirements of P.A. 74, Michigan P.A. of 1970, the corner points mentioned in lines 1 and 2 above were, in a field survey on 10/07, 1977, established, re-established, monumented, re-monumented, recovered or restored as expressed below and in conformance with regulations and rules therefore as required in the current manual of survey instructions of the United States Department of the Interior, Bureau of Land Management or by a decree of a court of law. Furthermore, that the corner points mentioned in lines 3, 4 and 5 above were, in a field survey on 10/07, 1977, found, recovered, restored, established or re-established as expressed below and in conformance with the rules of the Michigan State Board of Registration for Land Surveyors or, by a Decree of a Court of law:

A. Description of original monument and accessories and or subsequent restoration:

F-10 Lost

F-11 Lost

B. Description of corner evidence found and or method applied in restoring or re-establishing corner.

F-10 Found anchor post. Set 1/2" Re-rod and cap beside it.

F-11 Found anchor post. Set 1/2" x 18" re-rod beside it.

C. Description of monument for corner and accessories established to perpetuate locating the position of the

F-10 Anchor Post with Iron
1/2" x 18" Steel rod S 00° 04' 02" E 696.59'
1/2" x 18" Steel rod N 86° 35' 31" W 1,326.52'
(No ties open field)

F-11 Nail and Cap 6" Maple N 05° E 18.60'
Nail and cap 6" Maple N 50° E 6.20'
Nail and cap 12" Maple N 50° W 4.50'

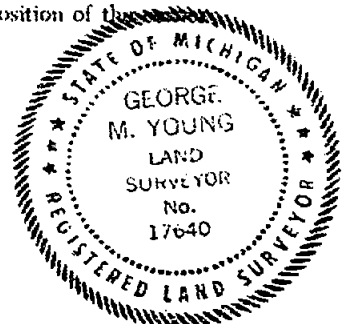

SIGNED BY George M. Young

DATE June 14, 1978

SURVEYOR'S MICHIGAN REGISTRATION NO. 17640

(SEAL)

FOR STATE AND UNITED STATES AGENCIES:

SIGNED BY _____
CHIEF OF SURVEY PARTY

DATE _____

APPROVED AND SIGNED BY _____
MICHIGAN REGISTERED LAND SURVEYOR

DATE _____

(SEAL)

SURVEYOR'S MICHIGAN REGISTRATION NO. _____

FORM APPROVED BY MICHIGAN STATE BOARD OF REGISTRATION, JAN. 28, 1971
REVISED MAY 14, 1975

1209

MAY PLACE SKETCH ON BACK OR ATTACHED SHEET

INGHAM COUNTY-WHITE OAK TWP.
LAND CORNER RECORDATION CERTIFICATE
FILING REQUIREMENT OF ACT 74, MICH. P.A.1970

LIBER 5 PG 269

FILED

AUG 2 12 41 PM '79

REGISTER OF DEEDS

Paula Johnson

INGHAM COUNTY, MICH.

REGISTER OF DEEDS STAMP AND
FILING NUMBER

FOR CORNERS OF-- LOCATED IN-- CORNER CODE NUMBER

1. PUBLIC LAND SURVEY	T. <u>2</u> N. <u>X</u> R. <u>2</u> E. <u>X</u>	G-12
2. PROPERTY CONTROLLING IN SECTION	T. _____ N. _____ R. _____ E. _____	
3. MISCELLANEOUS PROPERTY IN SECTION	T. _____ N. _____ R. _____ E. _____	
4. LOT NO. _____, RECORDED PLAT _____		
5. PRIVATE CLAIMS _____		

I, Ronnie M. Lester, do hereby certify that under requirements of P.A. 74, Michigan P.A. of 1970, the corner points mentioned in lines 1 and 2 above were, in a field survey on June 19, 1979, established, re-established, monumented, re-monumented, recovered or restored as expressed below and in conformance with regulations and rules therefore as required in the current manual of survey instructions of the United States Department of the Interior, Bureau of Land Management or by a decree of a court of law. Furthermore, that the corner points mentioned in lines 3, 4 and 5 above were, in a field survey on _____, 19____, found, recovered, restored, established or re-established as expressed below and in conformance with the rules of the Michigan State Board of Registration for Land Surveyors or, by a Decree of a Court of law:

A. Description of original monument and accessories and/or subsequent restoration:

G-12

Post set in original government survey by Joseph Wampler dated between Nov. 22 and 30, 1825.

Corner referred to in surveys by A. Jackson, County Surveyor, Sept. 11, 1838 (v.1, p.147), Jan. 28, 1842 (v.1, p.153) and Jan. 14, 1855 (v.2, p.243).

Corner referred to in Misc. Field Notes by T.J. Brown, County Surveyor, Oct. 16, 1879 (White Oak-brown folder, p.41b).

B. Description of corner evidence found and/or method applied in restoring or re-establishing corner:

G-12

Excavated a hole 10' x 10' to an average depth of 2.0' on the centerline of Swan Road and on fence/tree line to the north and south. Found pointed rock standing straight up and surrounded by smaller rocks in brown clay 2.0' below road surface on fence/tree line to the north and south and + 1.0' south of the centerline of Swan Road. Measured west + 2656' to F-12 and east + 2667' to H-12. Accepted pointed rock for corner.

Excavation conducted by Ingham County Survey and Remonumentation Project crew.

C. Description of monument for corner and accessories established to perpetuate locating the position of the corner:

G-12

W $\frac{1}{2}$ Corner, Section 34, T2N-R2E

Set 4" x 36" concrete monument with $\frac{1}{2}$ " x 38" rerod and cap #18998 with concrete collar and cover in location of pointed rock described above:

Nail & tag, #18998, northwest side 10" Walnut, NE, 166.95'

Nail & tag, #18998, east side 12" Walnut, NNW, 48.64'

Nail & tag, #18998, west side 4" Hickory, South, 71.37'

Nail & tag, #18998, north side 12" Walnut, ENE, 379.42'

SIGNED BY Ronnie M. Lester

DATE 7/31/79

SURVEYOR'S MICHIGAN REGISTRATION NO. 18998

SIGNED BY

CHIEF OF SURVEY PARTY

DATE

APPROVED AND SIGNED BY

MICHIGAN REGISTERED LAND SURVEYOR

DATE 7/31/79

Director, Ingham County Survey and Remonumentation Project

REGISTRATION NO. 17624

1651

FORM APPROVED BY MICHIGAN STATE BOARD OF REGISTRATION, JAN. 28, 1971
REVISED MAY 14, 1975

MAY PLACE SKETCH ON BACK OR ATTACHED SHEET

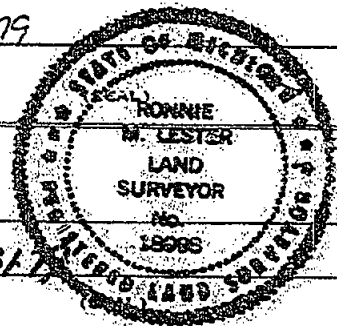
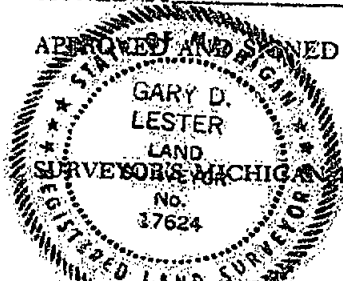

INGHAM COUNTY-WHITE OAK TWP.
LAND CORNER RECORDATION CERTIFICATE
FILING REQUIREMENT OF ACT 74, MICH. P.A.1970

FOR CORNERS OF:-	LOCATED IN:-	CORNER CODE NUMBER
1. PUBLIC LAND SURVEY..... T. <u>2</u> N. <u>X</u> R. <u>2</u> E. <u>X</u>		F-12
2. PROPERTY CONTROLL- ING IN SECTION..... T. N. S. R. E. W.		
3. MISCELLANEOUS PROPERTY IN SECTION..... T. N. S. R. E. W.		
4. LOT NO., RECORDED PLAT		
5. PRIVATE CLAIMS		

LIBER 5 PG 270
FILED

AUG 2 12 41 PM '79

REGISTER OF DEEDS

Paula Johnson
INGHAM COUNTY, MICH.

REGISTER OF DEEDS STAMP AND
FILING NUMBER

I, Ronnie M. Lester, do hereby certify that under requirements of P.A. 74, Michigan P.A. of 1970, the corner points mentioned in lines 1 and 2 above were, in a field survey on June 4, 1979, established, re-established, monumented, re-monumented, recovered or restored as expressed below and in conformance with regulations and rules therefore as required in the current manual of survey instructions of the United States Department of the Interior, Bureau of Land Management or by a decree of a court of law. Furthermore, that the corner points mentioned in lines 3, 4 and 5 above were, in a field survey on, 19...., found, recovered, restored, established or re-established as expressed below and in conformance with the rules of the Michigan State Board of Registration for Land Surveyors or, by a Decree of a Court of law:

A. Description of original monument and accessories and/or subsequent restoration:
F-12

No post set in original government survey.

Corner referred to in surveys by A. Jackson, County Surveyor, Sept. 10, 1838 (v.1, p.147) and Jan. 14, 1855 (v.2, p.243).

Corner referred to in Miscellaneous Field Notes by T.J. Brown, County Surveyor, Oct. 16, 1879 (White Oak-brown folder, p.41b).

Corner set as an iron, MDSHT Government Monument Witness Form 280, Nov. 2, 1968.

Corner identified as iron in the Ingham County Road Commission records, revised grid map, 1959.

B. Description of corner evidence found and/or method applied in restoring or re-establishing corner:
F-12

Excavated a hole 10' x 10' to an average depth of 1.6' at the intersection of the centerlines of Swan and Oakley Roads and fence/tree line north. Found 5/8" iron at road surface, at the intersection of Swan and Oakley Roads. No other monumentation found.

Measured west + 2648.0' to E-12 and + 2656.0' east to G-12. Location of irons is in close accord with the witnesses as given in the records of the Ingham County Road Commission and MDSHT Form 280. Accepted iron for corner.

Excavation conducted by Ingham County Survey and Re-monumentation Project crews.

C. Description of monument for corner and accessories established to perpetuate locating the position of the corner:
F-12

Center of Section 33, T2N-R2E

Set 4" x 36" concrete monument with 1/2" x 38" rerod and cap #18998 with concrete collar and cover in location of iron described above:

Nail & tag, #18998, northwest corner fence post, SW, 38.57'

Nail & tag, #18998, southwest side 12" Hickory, NW, 43.10'

Nail & tag, #18998, east side 12" Ash, North, 25.67'

Nail & tag, #18998, east side 10" Oak, SE, 58.53'

SIGNED BY Ronnie M. Lester

DATE 7/31/79

SURVEYOR'S MICHIGAN REGISTRATION NO. 18998

SIGNED BY

DATE

APPROVED AND SIGNED BY

CHIEF OF SURVEY PARTY

MICHIGAN REGISTERED LAND SURVEYOR

Director, Ingham County Survey and
Re-monumentation Project

REGISTRATION NO. 17624

1652

FORM APPROVED BY MICHIGAN STATE BOARD OF REGISTRATION, JAN. 28, 1971
REVISED MAY 14, 1975

MAY PLACE SKETCH ON BACK OR ATTACHED SHEET

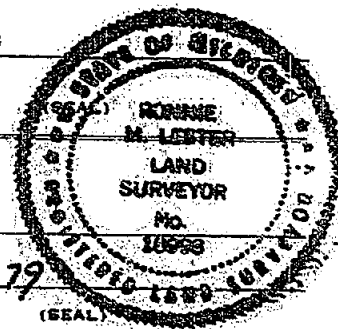

LAND CORNER RECORDATION CERTIFICATE
Filing Requirement of Act 74, Mich. P.A. 1970

FILED

For corners in

INGHAM
County

Located in:

Corner Code //

(WHITE OAK TWP)

1. Public Land Survey	T	2N	R	2E	E-13
	T		R		
	T		R		
	T		R		
2. Property Controlling in Section	S	T	R		
3. Miscellaneous Property in Sec	S	T	R		
	S	T	R		

NOV 1 3 42 PM '88

REGISTER OF DEEDS

REGISTER OF DEEDS

Register of Deeds Stamp & File Number

4. Lot No. , Recorded Plat
 5. Private Claims

	A	B	C	D	E	F	G	H	I	J	K	L	M
2	6	5	4	3	2	1							
3	7	6	5	4	3	2	1						
4	8	7	6	5	4	3	2	1					
5	9	8	7	6	5	4	3	2	1				
6	10	9	8	7	6	5	4	3	2	1			
7	11	10	9	8	7	6	5	4	3	2	1		
8	12	11	10	9	8	7	6	5	4	3	2	1	
9	13	12	11	10	9	8	7	6	5	4	3	2	1
10	14	13	12	11	10	9	8	7	6	5	4	3	2
11	15	14	13	12	11	10	9	8	7	6	5	4	3
12	16	15	14	13	12	11	10	9	8	7	6	5	4
13	17	16	15	14	13	12	11	10	9	8	7	6	5

David L. Clifford, a field survey on June 28, 1988, do hereby certify that under requirements of P.A. 74, Michigan P.A. of 1970, the corner points mentioned in lines 1 and 2 above were in conformance with regulations and rules therefore as required in the current manual of survey instructions of the United States Department of the Interior, Bureau of Land Management or by a decree of a Court of Law and/or that the corner points mentioned in lines 3, 4 and 5 above were in conformance with the rules of the Michigan Board of Land Surveyors or by a Decree of a Court of Law, established, re-established, monumented, re-monumented, recovered found as expressed below.

NOTE: Not more than 4 corners, all in the same town and range, may be recorded on this certificate.

A. Description of original monument and accessories and/or subsequent restoration

E-13

Post set in original government survey.
 Corner referred to in subsequent survey by A. Jackson, County Surveyor, dated June 26, 1854.
 W.A. Rowe, County Surveyor, indicated in notes found in Field Book 15, Page 26 of Misc. Ingham County Surveyor Notes that he found the old post October 15 and 16, 1895 during survey to locate the $\frac{5}{8}$ " Post of Section 32, White Oak and the $\frac{1}{4}$ " Post of Section 5, Stockbridge.

B. Description of corner evidence found and/or method applied in restoring or reestablishing corner

E-13

Accepted corner post of fence line to north as physical evidence perpetuating the corner position of the SW Corner, Sec 36, T2N, R2E, supported by corner post of fence line to south 195.4' West, in perfect accord with GLO falling of 296 links to NW Corner Sec 4, T1N, R2E

C. Description of monument for corner and accessories established to perpetuate locating the position of the corner

E-13

SE Corner Section 32, T2N, R2E
 Set $1\frac{1}{2}$ " Iron Pipe at base of fence corner post of fence line to North
 24" Maple, East 17.55'
 Triple 15" Maple, S10E, 32.45'
 $1\frac{1}{2}$ " Iron Pipe (E-1, T1N, R2E), West, 195.36'
 24" Maple, N70W, 28.90'

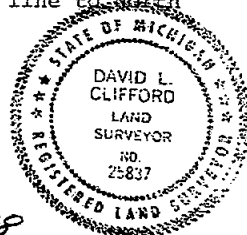

Signed by

David L. Clifford

Date

10/31/88

Surveyor's Michigan License No 25837

FORM APPROVED BY MICHIGAN STATE BOARD OF LAND SURVEYORS, JAN. 20, 1971
 REVISED MAY 14, 1975
 REVISED JAN 1983

2185

LAND CORNER RECORDATION CERTIFICATE
Filing Requirement of Act 74, Mich. P.A. 1970

LIBER 7 PAGE 76

FILED

JAN 30 8 34 AM '89

REGISTER OF DEEDS

INGHAM COUNTY, MICH.

Register of Deeds Stamp & File Number

For corners in
INGHAM

County

Located In:

Corner Code #

1. Public Land Survey

T 1N R 2E

G-13

T R

T R

T R

2. Property Controlling
in Section

S

T R

S

T R

3. Miscellaneous
Property in Sec.

S

T R

S

T R

4. Lot No.

Recorded Plat

5. Private Claims

I, Ronald L. Enger, in a field survey on August 30, 1988, do hereby certify that under requirements of P.A. 74, Michigan P.A. of 1970, the corner points mentioned in lines 1 and 2 above were in conformance with regulations and rules therefore as required in the current manual of survey instructions of the United States Department of the Interior, Bureau of Land Management or by a decree of a Court of Law and/or that the corner points mentioned in lines 3, 4 and 5 above were in conformance with the rules of the Michigan Board of Land Surveyors or by a Decree of a Court of Law, established, re-established, monumented, re-monumented, recovered, found as expressed below:

NOTE: Not more than 4 corners, all in the same town and range, may be recorded on this certificate.

A. Description of original monument and accessories and/or subsequent restoration:

Corner previously recorded on January 16, 1979 in Liber 5, Page 154 by Austin C. Williams, LS# 21275 as 1/2" Iron Bar with witnesses: SE Corner Steel Shed, N45W, 95.85'; Nail and Tag in Fence Post, West, 22.0'; Nail and Tag in 8" Cherry, N88E, 43.40'.

B. Description of corner evidence found and/or method applied in restoring or reestablishing corner:

Found 1/2" Iron Bar and proved it to be according to Williams' recordation by the SE Corner of Steel Shed (barn) in the NW quadrant.

C. Description of monument for corner and accessories established to perpetuate locating the position of the corner:

1/2" Iron Bar
Chiseled "X" in Concrete Culvert (N1/4 Section 4, T1S, R2E), West, 234.54'
Nail and Shiner in North side of 20" Oak, N88E, 56.4'
SE Corner of Barn, N28W, 95.2'
Fence Post, N84W, 154.8'

Corner recovered for Superconducting Super Collider project surveys

Signed by

R. Enger

Date 8 DEC 88

Surveyor's Michigan License No.

28409

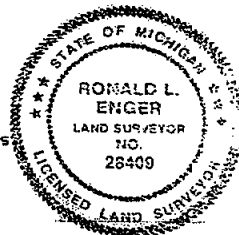

FORM APPROVED BY MICHIGAN STATE BOARD OF LAND SURVEYORS, JAN. 28, 1971
REVISED MAY 14, 1975
REVISED JAN., 1983

2222

FILED

LIBER 8 PAGE 266

LAND CORNER RECORDATION CERTIFICATE OCT 26 11 41 AM '94
Filing Requirement of Act 74, Mich. P.A. 1970

For corners in

INGHAM (County)

Located in:

Corner Code #

1. WHITE OAK TOWNSHIP

T 2N R 2E
T
T
T
S
S
S

F-13

2. Property Controlling
in Section

3. Miscellaneous
Property in Sec.

4. Lot No. , Recorded Plat
5. Private Claims

REGISTER OF DEEDS
INGHAM COUNTY, MICH.

Register of Deeds Stamp & File Number

1. David Clifford in a field survey on July 9, 1994, do hereby certify that under requirements of P.A. 74, Michigan P.A. of 1970, the corner points mentioned in lines 1 and 2 above were in conformance with regulations and rules therefore as required in the current manual of survey instructions of the United States Department of the Interior, Bureau of Land Management or by a decree of a Court of Law and/or that the corner points mentioned in lines 3, 4 and 5 above were in conformance with the rules of the Michigan Board of Land Surveyors or by a Decree of a Court of Law, established, re-established, monumented, re-monumented, recovered, found as expressed below:

NOTE: Not more than 4 corners, all in the same town and range, may be recorded on this certificate.

A. Description of original monument and accessories and/or subsequent restoration:

1. Original Post set by J. Wampler D.S. in Aug. 1824
W.O. 7" N16½E 7
W.O. 17 S60W 70
2. Corner Used by T.J. Brown Dep. Co. Surveyor in Oct. 1879
recorded in Vol. 3 page 186 with no mention of mon. or witnesses.

(OVER)

B. Description of corner evidence found and/or method applied in restoring or reestablishing corner:

Searched at apparent location of corner and found 4" conc. mon. as described in item A-4. Accepted Mon. as perpetuation of corner because of previous excavation. Mon. was pushed up above grade and the top 10" had to be cut off. Capped mon. with PA 345 Cap and left in place 6" below grade. Measured East 2654.39 to G-13. Measured West 2648.21' to E-13.

C. Description of monument for corner and accessories established to perpetuate locating the position of the corner:

4" Conc. Mon. on centerline Oakley Rd. & on very faint occupation line to West

Set Nail & Tag#25837 in S. Side 21" Oak Naz 270° 33.40'
Set Nail & Tag#25837 in W. Side 17" Oak Naz 164° 91.65'
Set Nail & Tag#25837 in W. Side 18" Basswood Naz 66° 24.41'
Set Nail & Tag#25837 in N. Side 18" Basswood Naz 15° 76.44'
1½" Pipe (F-1, T1N, R2E) Naz 272° 151.80'

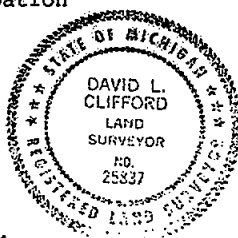

Signed by David Clifford Date AUGUST 9, 1994

Surveyor's Michigan License No. 25837

2681

P.A. 345 INGHAM COUNTY
FEER APPROVED 8/10/94 AL

FORM APPROVED BY MICHIGAN STATE BOARD OF LAND SURVEYORS, JAN. 28, 1974
REVISED MAY 14, 1975
REVISED JAN. 1983

2681

LIBER 8 PAUL 257

3. Ingham County Road Commission Records call for a stone
15" Oak West 83.0'
4. Ronnie Lester L.S. #18998 recorded corner during the Ingham
Co. Remonumentation program of the late 70's in July 1979
in Liber 5 page 262 as a 4"X36" Conc. Mon. replacing a found
stone & crockery after excavation.

Nail & tag #18998, S. side 18" Oak West 33.41'
Nail & tag #18998, N. side 18" Ash ENE, 24.57'
Nail & tag #18998, E. side 16" Maple NE 76.39'
Nail & tag #18998, W. side 12" Ash SE 44.50'

001E#8602	0002	MSSR	\$2.00
001E#8602	0002	CORNER	\$9.00

LAND CORNER RECORDATION CERTIFICATE

Oct 26 11 41 AM '94
Filing Requirement of Act 74, Mich. P.A. 1970

For corners in

INGHAM

(County)

Located In:

Corner Code ~~11~~

REGISTER OF DEEDS

INGHAM COUNTY, MICH.

Register of Deeds Stamp & File Number

1. WHITE OAK TOWNSHIP

Public Land Survey

2N 2E

F-13

2. Property Controlling
in Section

S

S

S

S

S

S

S

S

S

S

S

S

S

S

S

S

S

S

S

S

S

S

S

S

S

S

S

S

S

S

S

S

S

S

S

S

S

S

S

S

S

S

S

S

S

S

S

S

S

S

S

S

S

S

S

S

S

S

S

S

S

S

S

S

S

S

S

S

S

S

S

S

S

S

S

S

S

S

S

S

S

S

S

S

S

4. Lot No. , Recorded Plat

5. Private Claims

I, David Clifford in a field survey on July 9, 1994, do hereby certify that under requirements of P.A. 74, Michigan P.A. of 1970, the corner points mentioned in lines 1 and 2 above were in conformance with regulations and rules therefore as required in the current manual of survey instructions of the United States Department of the Interior, Bureau of Land Management, or by a decree of a Court of Law and/or that the corner points mentioned in lines 3, 4 and 5 above were in conformance with the rules of the Michigan Board of Land Surveyors or by a Decree of a Court of Law, established, re-established, monumented, re-monumented, recovered, found as expressed below:

NOTE: Not more than 4 corners, all in the same town and range, may be recorded on this certificate.

A. Description of original monument and accessories and/or subsequent restoration:

1. Original Post set by J. Wampler D.S. in Aug. 1824
W.O. 7" N16½E 7
W.O. 17 S60W 70

2. Corner Used by T.J. Brown Dep. Co. Surveyor in Oct. 1879
recorded in Vol. 3 page 186 with no mention of mon. or witnesses.

(OVER)

B. Description of corner evidence found and/or method applied in restoring or reestablishing corner:

Searched at apparent location of corner and found 4" conc. mon. as described in item A-4. Accepted Mon. as perpetuation of corner because of previous excavation. Mon. was pushed up above grade and the top 10" had to be cut off. Capped mon. with PA 345 Cap and left in place 6" below grade. Measured East 2654.39 to G-13. Measured West 2648.21' to E-13.

C. Description of monument for corner and accessories established to perpetuate locating the position of the corner:

4" Conc. Mon. on centerline Oakley Rd. & on very faint occupation line to West

Set Nail & Tag#25837 in S. Side 21" Oak Naz 270° 33.40'
Set Nail & Tag#25837 in W. Side 17" Oak Naz 164° 91.65'
Set Nail & Tag#25837 in W. Side 18" Basswood Naz 66° 24.41'
Set Nail & Tag#25837 in N. Side 18" Basswood Naz 15° 76.44'
1½" Pipe (F-1, T1N, R2E) Naz 272° 151.80'

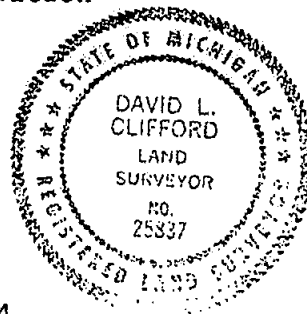

Signed by

David Clifford

Date AUGUST 9, 1994

Surveyor's Michigan License No. 25837

2681

P.A. 345 INGHAM COUNTY

PEER APPROVED 8/10/94 RL

FORM APPROVED BY MICHIGAN STATE BOARD OF LAND SURVEYORS, JAN. 28, 1971
REVISED MAY 14, 1975
REVISED JAN. 1983

3. Ingham County Road Commission Records call for a stone
15" Oak West 83.0'
4. Ronnie Lester L.S. #18998 recorded corner during the Ingham
Co. Remonumentation program of the late 70's in July 1979
in Liber 5 page 262 as a 4"x36" Conc. Mon. replacing a found
stone & crockery after excavation.

Nail & tag #18998, S. side 18" Oak West 33.41'
Nail & tag #18998, N. side 18" Ash ENE, 24.57'
Nail & tag #18998, E. side 16" Maple NE 76.39'
Nail & tag #18998, W. side 12" Ash SE 44.50'

001E#8602	0002	MSSR	\$2.00
001E#8602	0002	CORNER	\$9.00

LAND CORNER RECORDATION CERTIFICATE
Filing Requirement of Act 74, Mich. P.A. 1970

For corners in

LEER 8 PAGE 385
FILED

INGHAM COUNTY
(County)

Located in:

Corner Code #

WHITE OAK TOWNSHIP

1. Public Land Survey

T 2N R 2E

E-13

T R

T R

T R

S T R

S T R

S T R

S T R

2. Property Controlling
in Section

3. Miscellaneous
Property in Sec.

4. Lot No. , Recorded Plat

5. Private Claims

DEC 1 8 05 AM '94

REGISTER OF DEEDS

Paul Johnson

INGHAM COUNTY, MICH.

Register of Deeds Stamp & File Number

I, Dave Clifford, in a field survey on Sep. 3, 1994, do hereby certify that under requirements of P.A. 74, Michigan P.A. of 1970, the corner points mentioned in lines 1 and 2 above were in conformance with regulations and rules therefore as required in the current manual of survey instructions of the United States Department of the Interior, Bureau of Land Management or by a decree of a Court of Law and/or that the corner points mentioned in lines 3, 4 and 5 above were in conformance with the rules of the Michigan Board of Land Surveyors or by a Decree of a Court of Law; established, re-established, monumented, re-monumented, recovered, found as expressed below:

NOTE: Not more than 4 corners, all in the same town and range, may be recorded on this certificate.

A. Description of original monument and accessories and/or subsequent restoration:

1. Original Post set by J. Wampler D.S. in Aug. 1824
Tam. 5 N58E 17(11.22')
Tam. 6 N43W 38(25.08')
2. Corner used by A. Jackson Co. Surv. in June 1854 recorded in Vol 2 Page 206 with same mon. & Wit. as in item 1.
3. Corner Used by W.A. Rowe Co. Surveyor in Oct. 1895 recorded in Field book 15 page 26 in which he stated that he found the old post.

(Over)

B. Description of corner evidence found and/or method applied in restoring or reestablishing corner:

Searched at apparent location of corner and found 1 1/4" pipe at South base of North-East fence corner post. Excavated all around fence post and found nothing but average fence post stones. Measured West 195.36 feet (the exact GLO falling) to E-1 Stockbridge Township (a 1 1/4" pipe at the North end of a fence to the South). Accepted Pipe as perpetuation of corner because of its relationship to occupation and closing corner and capped with PA345 cap.

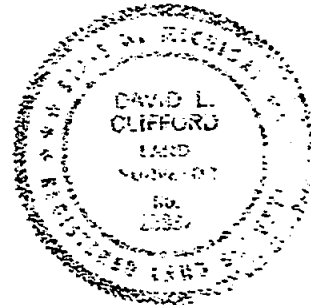

C. Description of monument for corner and accessories established to perpetuate locating the position of the corner:

1 1/4" Iron Pipe and PA 345 Cap PS #25837 at South base of Anchor Post at East-North Fence Corner

Set Nail & Tag#25837 in N. Side 8" Maple Naz 240° 31.55'
Set Nail & Tag#25837 in W. Side 18" Trip. Maple Naz 170° 32.15'
Set Nail & Tag#25837 in N. Side 18" Maple Naz 100° 31.90'
1 1/4" Pipe & PA 345 Cap PS 25837(E-1, T1N, R2E) Naz 270° 195.36'

Signed by Dave Clifford
Surveyor's Michigan License No. 25837

Date Oct 11, 1994

2746

P.A. 345 INGHAM COUNTY
PEER APPROVED 11/9/94

FORM APPROVED BY MICHIGAN STATE BOARD OF LAND SURVEYORS, JAN. 28, 1971
REVISED MAY 14, 1975
REVISED JAN. 1983

A. (Continued from front side)

LIBER 8 PAGE 386

4. This Surveyor recorded corner in Liber 7 page 39 in Nov. 1988 during the Super Collider project as a $1\frac{1}{4}$ " pipe set at base of Anchor post of East-North fence.

24" Maple East 17.55'

Triple 15" Maple S10E 32.45'

24" Maple N70W 28.90'

$1\frac{1}{4}$ " Iron Pipe (E-1, T1N, R2E) West 195.36'

2746

LAND CORNER RECORDATION CERTIFICATE
Filing Requirement of Act 74, Mich. P.A. 1970

L'BER

8 PAGE 387

FILED

For corners in

INGHAM COUNTY
(County)

Located In:

Corner Code #

White Oak Township

1. Public Land Survey

T 2N R 2E G-13

T R

T R

T R

2. Property Controlling
in Section

S T R

S T R

3. Miscellaneous
Property in Sec.

S T R

S T R

DEC 1 8 06 AM '94

REGISTERED
DEEDS
REGISTERED
DEEDS
REGISTERED
DEEDS

Register of Deeds Stamp & File Number

4. Lot No. , Recorded Plat

5. Private Claims

	A	B	C	D	E	F	G	H	I	J	K	L	M
2	6	5	4	3	2	1							
3													
4	7	8	9	10	11	12							
5													
6	18	17	16	15	14	13							
7													
8	19	20	21	22	23	24							
9													
10	30	29	28	27	26	25							
11													
12	31	32	33	34	35	36							
13													

I, Dave Clifford, in a field survey on Sep 3, 19 94
do hereby certify that under requirements of P.A. 74, Michigan P.A. of 1970, the corner points mentioned
in lines 1 and 2 above were in conformance with regulations and rules therefore as required in the
current manual of survey instructions of the United States Department of the Interior, Bureau of Land
Management or by a decree of a Court of Law and/or that the corner points mentioned in lines 3, 4 and 5
above were in conformance with the rules of the Michigan Board of Land Surveyors or by a Decree of a
Court of Law; established, re-established, monumented, re-monumented, recovered, found as
expressed below:

NOTE: Not more than 4 corners, all in the same town and range, may be recorded
on this certificate.

A. Description of original monument and accessories and/or subsequent restoration:

1. Original Post set by J. Wampler D.S. in Aug. 1824
Tam. 9 N70E 103(67.98')
Tam. 15 N40W 228(150.48')
2. In a marginal note, to a survey by T.J. Brown Co. Surveyor
recorded in Vol 2, page 251 in Jan 1851, W.A. Rowe Co. Surveyor
proved G-1 Stockbridge Township by using G-13 White Oak
Township which he found the post and the witnesses of in
Oct. 1895.

(OVER)

B. Description of corner evidence found and/or method applied in restoring or reestablishing corner:
Searched at apparent location of corner and found
3/4" pipe on South bank of East-West ditch and 20' East
of North-South ditch. Dug all around area and found
no other evidence of corner. Accepted pipe as Corner
and capped with PA 345 cap.



C. Description of monument for corner and accessories established to perpetuate locating the position of the corner:
3/4" Iron Pipe and PA 345 Cap PS #25837, 5' South of
centerline East-West ditch and 20' East of North-South
ditch.

Set Nail & Tag#25837 in E. Side 18" Maple Stump Naz 225° 12.30'
Set Nail & Tag#25837 in W. Side 12" Mult. Maple Naz 168° 6.15'
Set Nail & Tag#25837 in S. Side 18" Maple Naz 90° 34.65'
Set Nail & Tag#25837 in N. side 8" Mult. Maple Naz. 134° 35.25'
3/4" pipe & PA 345 Cap PS 25837(G-1, T1N, R2E) Naz 268° 114.81'

Signed by

Dave Clifford

Date

Oct 11, 1994

Surveyor's Michigan License No.

25837

2747

P.A. 345 INGHAM COUNTY

PEER APPROVED 10/12/94 me

FORM APPROVED BY MICHIGAN STATE BOARD OF LAND SURVEYORS, JAN. 28, 1971
REVISED MAY 14, 1975
REVISED JAN. 1983

- LIBER 8 PAUL 388
3. F.K. Holmes LS 14094 set a 3/4" iron pipe in the North post of a fence from the South for G-1 Stockbridge township for MDSH&T in Sep. 1965
 4. This surveyor found anchor post used by Holmes for G-1 Stockbridge while working on the Super Collider Project in Aug. 1988 and using it for direction set G-1 6.65 feet North of it on the Township line. This Surveyor then set a 3/4" pipe at G-13 White Oak at the GLO falling (114.81') East on the Township line.
 6. Ron Enger LS 28409 Recorded Corner in Liber 7 of Corners page 76 in Jan 1989 during the Super Collider Project as a 3/4" pipe.
3/4" pipe (G-1, T1N, R2E) West 114.84'
Nail & Cap #25837 in 14" Maple S10°W 12.30'
Nail & Cap #25837 in 18" Twin Maple S5°E 6.20"
Nail & Cap #25837 in 36" Maple S50°E 53.4'
 7. In clarification of method used to establish position of corner in 1988 this surveyor and Ron Enger PS #28409 elected to use F.K. Holmes monument on line monument at the closing corner G-1, T1N, R2E, for direction only (In accordance with proper survey procedure) to establish the true position of of G-1 on the township line of T2N, R2E, which falls 6.65' North of the anchor post found by Holmes. The position of G-13, T2N, R2E was then established by setting it at the GLO falling of 114.81'.