

# LAND CORNER RECORDATION CERTIFICATE

FILING REQUIREMENT OF ACT 74, MICH. P.A. 1970

FOR CORNERS OF -- LOCATED IN -- CORNER CODE NUMBER

1. PUBLIC LAND SURVEY 35 T 2N R 2E I-11, I-12, I-13

2. PROPERTY CONTROLLING IN SECTION T S. R. E.

3. MISCELLANEOUS PROPERTY IN SECTION T S. R. E.

4. LOT NO. RECORDED PLAT

5. PRIVATE CLAIMS

LIBER

3 PC 397

FILED

JUL 15 11 34 AM '75

REGISTER OF DEEDS

*George M. Young*  
INGHAM COUNTY, MICH.

REGISTER OF DEEDS STAMP AND FILING NUMBER

I, George M. Young do hereby certify that under requirements of P.A. 74, Michigan P.A. of 1970 the corner points mentioned in lines 1 and 2 above (identified with circles on index code diagram - over) were, in a field survey on June 5, 1975, established, re-established, monumented, re-monumented, recovered or restored as expressed below and in conformance with regulations and rules therefore as required in the current manual of survey instructions of the United States Department of the Interior, Bureau of Land Management or by a decree of a court of law. Furthermore, that the corner points mentioned in lines 3, 4 and 5 above were, in a field survey on 19, found, recovered, restored, established or re-established as expressed below and in conformance with the rules of the Michigan State Board of Registration for Land Surveyors or, by a Decree of a Court of law:

A. Description of original monument and accessories and or subsequent restoration:

- I-11 Original monument & accessories not found
- I-12 Original monument & accessories not found
- I-13 Original monument & accessories not found

B. Description of corner evidence found and or method applied in restoring or re-establishing corner:

- I-11 Found 1 1/2" iron pipe
- I-12 Set 1/2" Re Rod with Cap by proportionate measurement from adjacent corners
- I-13 Found 2" iron pipe

C. Description of monument for corner and accessories established to perpetuate locating the position of the corner:

- I-11 Found 1 1/2" iron pipe - Nail & Washer in 24" Walnut N.W. 85.67'  
Nail & Washer in 24" Maple E 33.10'  
Nail & Washer in 18" Oak SE 34.60'
- I-12 Set 1/2" Re Rod with Cap - Nail & Washer in 15" Ash N.N.W. 74.11'  
Nail & Washer in 24" Maple N.E. 45.35'  
Nail & Washer in 24" Walnut S.S.E. 81.81'
- I-13 Found 2" iron pipe - Nail & Washer in 20" Walnut N.W. 77.38'  
Nail & Washer in 18" Walnut N.N.E. 74.48'  
Nail & Washer in 24" Poplar NE 51.90'

SIGNED BY *George M. Young* DATE July 11, 1975

SURVEYOR'S MICHIGAN REGISTRATION NO. 17640

(SEAL)

FOR STATE AND UNITED STATES AGENCIES:

SIGNED BY \_\_\_\_\_ DATE \_\_\_\_\_

CHIEF OF SURVEY PARTY

APPROVED AND SIGNED BY \_\_\_\_\_ DATE \_\_\_\_\_

MICHIGAN REGISTERED LAND SURVEYOR

(SEAL)

SURVEYOR'S MICHIGAN REGISTRATION NO. \_\_\_\_\_

842

Form No. ML M735  
DOMLENAY BROS. & CO., KALAMAZOO, MICH.

FORM APPROVED BY MICHIGAN STATE BOARD OF REGISTRATION, JAN. 28, 1971  
DISTRIBUTED BY MICHIGAN SOCIETY OF REGISTERED LAND SURVEYORS

LAND CORNER RECORDATION CERTIFICATE  
FILING REQUIREMENT OF ACT 74, MICH. P.A.1970

FOR CORNERS OF— LOCATED IN— CORNER CODE NUMBER

LIBER

3 15 399

FILED

1. PUBLIC LAND SURVEY 35 1. 2 S. R. 2 1/4 J-11  
34 H-12

2. PROPERTY CONTROLLING IN SECTION T S. R. E.

3. MISCELLANEOUS PROPERTY IN SECTION T S. R. E.

4. LOT NO. RECORDED PLAT

5. PRIVATE CLAIMS

JUL 15 11 34 AM '75

REGISTER OF DEEDS

Ernest M. Lewis  
WYOMING COUNTY, MICH.

REGISTER OF DEEDS STAMP AND  
FILING NUMBER

I, do hereby certify that under requirements of P.A. 74, Michigan P.A. of 1970 the corner points mentioned in lines 1 and 2 above (identified with circles on index code diagram—over) were, in a field survey on June 5, 1975 established, re-established, monumented, re-monumented, recovered or restored as expressed below and in conformance with regulations and rules therefore as required in the current manual of survey instructions of the United States Department of the Interior, Bureau of Land Management or by a decree of a court of law. Furthermore, that the corner points mentioned in lines 3, 4 and 5 above were, in a field survey on April 29, 1975 found, recovered, restored, established or re-established as expressed below and in conformance with the rules of the Michigan State Board of Registration for Land Surveyors or, by a Decree of a Court of law:

A. Description of original monument and accessories and/or subsequent restoration:

J-11 Original monument & accessories not found

H-12 Original monument & accessories not found

B. Description of corner evidence found and/or method applied in restoring or re-establishing

J-11 Found iron

H-12 Found 3/4" iron in monument box, Flush with asphalt

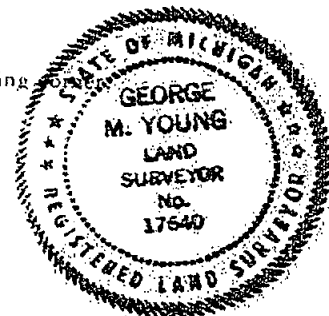

C. Description of monument for corner and accessories established to perpetuate locating the position of the corner:

J-11 Found iron - Nail & Washer in 18" Maple NW 22.77'  
Nail & Washer in 12" Maple SE 18.68'  
Nail & Washer in 8" Sassafrass S.S.E. 4.06'

H-12 Found 3/4 iron - Top SE cor. concrete r/w Marker W.N.W. 127.80'  
B.M. Nail in E face of 36" Oak W.S.W. 125.05'  
Nail in 10" Maple S.S.W. 118.90'

SIGNED BY George M. Young DATE July 11, 1975

SURVEYOR'S MICHIGAN REGISTRATION NO. 17640

(SEAL)

FOR STATE AND UNITED STATES AGENCIES:

SIGNED BY \_\_\_\_\_ DATE \_\_\_\_\_  
CHIEF OF SURVEY PARTY

APPROVED AND SIGNED BY \_\_\_\_\_ DATE \_\_\_\_\_  
MICHIGAN REGISTERED LAND SURVEYOR

(SEAL)

843 SURVEYOR'S MICHIGAN REGISTRATION NO. \_\_\_\_\_

Form No. MCM756  
DOUBLCPAY, BROS. & CO., KALAMAZOO, MICH.

FORM APPROVED BY MICHIGAN STATE BOARD OF REGISTRATION, JAN. 28, 1973  
DISTRIBUTED BY MICHIGAN SOCIETY OF REGISTERED LAND SURVEYORS

# LAND CORNER RECORDATION CERTIFICATE

FILING REQUIREMENT OF ACT 74, MICH. P.A. 1970

LIBER

3 PG 403

FOR CORNERS OF--

LOCATED IN--

CORNER CODE NUMBER

1. PUBLIC LAND SURVEY 27 T. 2 N. R. 2 W. G-11, H-10, H-11

FILED

2. PROPERTY CONTROLLING IN SECTION T. N. R. W.

3. MISCELLANEOUS PROPERTY IN SECTION T. N. R. W.

4. LOT NO. RECORDED PLAT

5. PRIVATE CLAIMS

JUL 15 11 34 AM '75

REGISTER OF DEEDS

Paul M. Lewis  
INGHAM COUNTY, MICH

REGISTER OF DEEDS STAMP AND  
FILING NUMBER

I, George M. Young do hereby certify that under requirements of P.A. 74, Michigan P.A. of 1970 the corner points mentioned in lines 1 and 2 above (identified with circles on index code diagram--over) were, in a field survey on June 5, 1975, established, re-established, monumented, re-monumented, recovered or restored as expressed below and in conformance with regulations and rules therefore as required in the current manual of survey instructions of the United States Department of the Interior, Bureau of Land Management or by a decree of a court of law. Furthermore, that the corner points mentioned in lines 3, 4 and 5 above were, in a field survey on 19, found, recovered, restored, established or re-established as expressed below and in conformance with the rules of the Michigan State Board of Registration for Land Surveyors or, by a Decree of a Court of law:

A. Description of original monument and accessories and/or subsequent restoration:

G-11 Original monument & Accessories not found

H-10 Original monument & Accessories not found

H-11 Original monument & Accessories not found

B. Description of corner evidence found and/or method applied in restoring or re-establishing corner:

G-11 Found 1 1/4" iron pipe

H-10 Found 3/4" iron in Mont. Box

H-11 Found 3/4" iron in Mont. Box

C. Description of monument for corner and accessories established to perpetuate locating the position of the corner:

G-11 Found 1 1/4" iron pipe - Nail & Tag 12" Oak W.S.W. 4.65'  
Nail & Tag 12" Oak N 12.32'

H-10 Found 3/4" iron - Nail & Tag P.O. N.N.W. 107.22'

Nail & Tag 8" Maple W 45.57'

H-11 Found 3/4" iron - Nail & Tag 24" Maple N.W. 82.53'

Nail & Tag 36" Maple W.N.W. 30.15'

W. Edge Asphalt M-52 E 31.30'

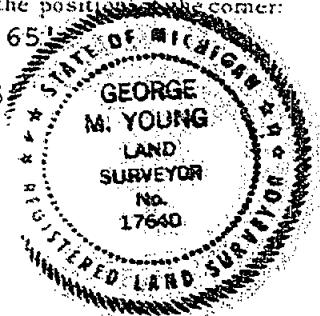

SIGNED BY George M. Young DATE July 11, 1975

SURVEYOR'S MICHIGAN REGISTRATION NO. 17640

(SEAL)

FOR STATE AND UNITED STATES AGENCIES:

SIGNED BY \_\_\_\_\_ DATE \_\_\_\_\_

CHIEF OF SURVEY PARTY

APPROVED AND SIGNED BY \_\_\_\_\_ DATE \_\_\_\_\_

MICHIGAN REGISTERED LAND SURVEYOR

(SEAL)

845

SURVEYOR'S MICHIGAN REGISTRATION NO. \_\_\_\_\_

Form No. MLM735  
DOUBLEDAY, BROOKS, & CO., Kalamazoo, MICH.

FORM APPROVED BY MICHIGAN STATE BOARD OF REGISTRATION, JAN. 28, 1971  
DISTRIBUTED BY MICHIGAN SOCIETY OF REGISTERED LAND SURVEYORS

# LAND CORNER RECORDATION CERTIFICATE

FILING REQUIREMENT OF ACT 74, MICH. P.A. 1970

LIBER

4 PG

73

FOR CORNERS OF -:

LOCATED IN - STOCKBROCK TWP.

CORNER CODE NUMBER

1. PUBLIC LAND SURVEY

T. 1 N. 2 E. 1-1

FILED

2. PROPERTY CONTROLLING IN SECTION

T.    N.    E.     
S.    R.    W.   

3. MISCELLANEOUS

PROPERTY IN SECTION

T.    N.    E.     
S.    R.    W.   

4. LOT NO.

RECORDED PLAT

5. PRIVATE CLAIMS

JAN 30 11 43 AM '77

REGISTER OF DEEDS

*Paula Johnson*  
INGHAM COUNTY, MICH.

REGISTER OF DEEDS STAMP AND  
FILING NUMBER

1. Karol R. Piotrowski

do hereby certify that under requirements of P.A. 74, Michigan P.A. of 1970, the corner points mentioned in lines 1 and 2 above were, in a field survey on June 5, 1975, established, re-established, monumented, re-monumented, recovered or restored as expressed below and in conformance with regulations and rules therefore as required in the current manual of survey instructions of the United States Department of the Interior, Bureau of Land Management or by a decree of a court of law. Furthermore, that the corner points mentioned in lines 3, 4 and 5 above were, in a field survey on   , 19  , found, recovered, restored, established or re-established as expressed below and in conformance with the rules of the Michigan State Board of Registration for Land Surveyors or, by a Decree of a Court of law:

A. Description of ~~original monument and accessories and/or~~ subsequent restoration:

I-1 Railroad spike, original monument unknown

B. ~~Description of corner evidence found and/or~~ method applied in restoring or re-establishing corner.

I-1 Set Railroad spike using SE and SW corner Section 35, T2N-R2E for line, and using old occupied line described as the East line of the W'ly 14½ rods of the NW Frac. ¼, NW Frac. ¼ Sec. 2, T1N-R2E for distance

C. Description of monument for corner and accessories established to perpetuate locating the position of the corner:

N15°E 71.3' to 11" Box Elder  
N20°W 86.6' to 17" Walnut  
NORTH 6' to centerline of M-36  
WEST 16.5' to SW corner Sec. 35, T2N-R2E  
S20°W 53.75' to road sign

SIGNED BY Karol R. Piotrowski

DATE 6-5-75

SURVEYOR'S MICHIGAN REGISTRATION NO. 9685

FOR STATE AND UNITED STATES AGENCIES:

SIGNED BY

CHIEF OF SURVEY PARTY

DATE

APPROVED AND SIGNED BY

MICHIGAN REGISTERED LAND SURVEYOR

DATE

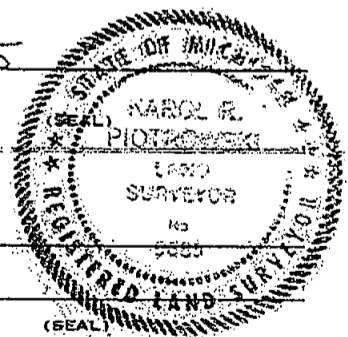

SURVEYOR'S MICHIGAN REGISTRATION NO.   

FORM APPROVED BY MICHIGAN STATE BOARD OF REGISTRATION, JAN. 28, 1971  
REVISED MAY 14, 1975

1075

MAY PLACE SKETCH ON BACK OR ATTACHED SHEET

1. 连接

5 PC 269

FILED

AUG 2 12 41 PM '73

# REGISTER OF DEEDS

Paula Johnson  
INGHAM COUNTY, MICH.

REGISTER OF DEEDS STAMP AND  
FILING NUMBER

<b>FOR CORNERS OF:-</b>	<b>LOCATED IN:-</b>	<b>CORNER CODE NUMBER</b>
-------------------------	---------------------	---------------------------

1. PUBLIC LAND SURVEY \_\_\_\_\_ T. 2 <sup>N.</sup>~~S.~~ R. 2 <sup>E.</sup>~~S.~~ G-12

2. PROPERTY CONTROLLING IN SECTION \_\_\_\_\_, T. \_\_\_\_\_, N. \_\_\_\_\_, S., R. \_\_\_\_\_, E. \_\_\_\_\_, W. \_\_\_\_\_.

3. MISCELLANEOUS  
PROPERTY IN SECTION \_\_\_\_\_ T. \_\_\_\_\_ S. \_\_\_\_\_ R. \_\_\_\_\_ E. \_\_\_\_\_ W. \_\_\_\_\_

4. LOT NO. \_\_\_\_\_, RECORDED PLAT \_\_\_\_\_

5. PRIVATE CLAIMS \_\_\_\_\_

A. Description of original monument and accessories and/or subsequent restoration:

G-12

Post set in original government survey by Joseph Wampler dated between Nov. 22 and 30, 1825.

Corner referred to in surveys by A. Jackson, County Surveyor, Sept. 11, 1838 (v.1, p.147), Jan. 28, 1842 (v.1, p.153) and Jan. 14, 1855 (v.2, p.243).

Corner referred to in Misc. Field Notes by T.J. Brown, County Surveyor, Oct. 16, 1879 (White Oak-brown folder, p.41b).

B. Description of corner evidence found and/or method applied in restoring or re-establishing corner:

G-12

Excavated a hole 10' x 10' to an average depth of 2.0' on the centerline of Swan Road and on fence/tree line to the north and south. Found pointed rock standing straight up and surrounded by smaller rocks in brown clay 2.0' below road surface on fence/tree line to the north and south and  $\pm 1.0'$  south of the centerline of Swan Road. Measured west  $\pm 2656'$  to F-12 and east  $\pm 2667'$  to H-12. Accepted pointed rock for corner.

Excavation conducted by Ingham County Survey and Remonumentation Project crew.

C. Description of monument for corner and accessories established to perpetuate locating the position of the corner:

G-12

W $\frac{1}{4}$  Corner, Section 34, T2N-R2E

Set 4" x 36" concrete monument with  $\frac{1}{2}$ " x 38" rerod and cap #18998 with concrete collar and cover in location of pointed rock described above:

Nail & tag, #18998, northwest side 10" Walnut, NE, 166.95'

Nail & tag, #18998, east side 12" Walnut, NNW, 48.54'

Nail & tag, #18998, west side 4" Hickory, South, 71.37'

Nail & tag, #18998, north side 12" Walnut, ENE, 379.42'

SIGNED BY Gordon M. Lester

DATE 7/31/79

**SURVEYOR'S MICHIGAN REGISTRATION NO. 18998**

~~XXXXXXXXXXXXXXXXXXXXXXXXXXXXXXXXXXXXXXXXXXXX~~

**SIGNED BY:**

DATE \_\_\_\_\_

APPROVED AND SIGNED BY

CHIEF OF SURVEY PART

MICHIGAN REGISTERED LAND SURVEYOR

DATE 7.31

Director, Ingham County Survey and  
Re monumentation Project

SURVEYOR'S MICHIGAN REGISTRATION NO. 17624

1651

FORM APPROVED BY MICHIGAN STATE BOARD OF REGISTRATION, JAN. 28, 1971  
REVISED MAY 14, 1975

MAY PLACE SKETCH ON BACK OR ATTACHED SHEET

INGHAM COUNTY - WHITE OAK TWP.  
LAND CORNER RECORDATION CERTIFICATE  
FILING REQUIREMENT OF ACT 74, MICH. P.A.1970

LIBER 6 PG 24

FILED

MAR 5 11 31 AM '80

REGISTER OF DEEDS

Paula Johnson  
INGHAM COUNTY, MICH.

REGISTER OF DEEDS STAMP AND  
FILING NUMBER

FOR CORNERS OF --	LOCATED IN --	CORNER CODE NUMBER
1. PUBLIC LAND SURVEY _____ T. <u>2</u> N. <u>2</u> E. <u>W</u>		H-13
2. PROPERTY CONTROLLING IN SECTION _____ T. _____ N. _____ S. _____ R. _____ E. _____ W. _____		
3. MISCELLANEOUS PROPERTY IN SECTION _____ T. _____ N. _____ S. _____ R. _____ E. _____ W. _____		
4. LOT NO. _____, RECORDED PLAT _____		
5. PRIVATE CLAIMS _____		

I, Ronnie M. Lester, do hereby certify that under requirements of P.A. 74, Michigan P.A. of 1970, the corner points mentioned in lines 1 and 2 above were, in a field survey on October 25, 1979, established, re-established, monumented, re-monumented, recovered or restored as expressed below and in conformance with regulations and rules therefore as required in the current manual of survey instructions of the United States Department of the Interior, Bureau of Land Management or by a decree of a court of law. Furthermore, that the corner points mentioned in lines 3, 4 and 5 above were, in a field survey on \_\_\_\_\_, 19\_\_\_\_, found, recovered, restored, established or re-established as expressed below and in conformance with the rules of the Michigan State Board of Registration for Land Surveyors or, by a Decree of a Court of law:

A. Description of original monument and accessories and/or subsequent restoration:

Post set in original government survey by J. Wampler, November 22-30, 1825.  
Corner referred to in a survey of State Road (now Carter Road and Stockbridge Road) by R. Paterson, Co. Surveyor, July 6, 1849, in Misc. Ingham County Surveyor's Field Notes.  
Corner identified as a post, iron shaft, and crockery in a survey by W.A. Rowe, October 11 and 12, 1895.  
Corner identified as an iron and crockery in the notes of Wm. Barryman, Co. Surveyor, date unknown.

B. Description of corner evidence found and/or method applied in restoring or re-establishing corner:

During investigation found  $\frac{1}{2}$ " iron in monument box at intersection of the centerline of Stockbridge Road and centerline of M-36 east. Accepted  $\frac{1}{2}$ " iron in monument box for corner as called for by MDSHT records. Measured north + 2652' to H-12.  
Investigation conducted by the Ingham County Survey and Remonumentation Project crew.

C. Description of monument for corner and accessories established to perpetuate locating the position of the corner:

S $\frac{1}{4}$  Corner, Section 34, T2N-R2E  
Found  $\frac{1}{2}$ " iron in monument box in location described above:  
Southeast corner foundation of house #2490, NW, 113.95'  
Nail & tag, #18998, north side bottom of triple wild Cherry, West, 176.90'  
Top center on south end of culvert, WNW, 61.15'  
South end of curb on the southeast side of road, SE, 59.23'  
Found MDSHT nail & tag on south side of power pole, West, 77.30'  
 $\frac{1}{2}$ " iron in monument box, H-1 Stockbridge Twp., T1N-R2E, West, 29.20'

SIGNED BY Ronnie M. Lester  
SURVEYOR'S MICHIGAN REGISTRATION NO. 18998

SIGNED BY \_\_\_\_\_

APPROVED AND SIGNED BY \_\_\_\_\_

CHIEF OF SURVEY PARTY

GARY D. LESTER  
LAND SURVEYOR  
DATE: 17624  
DIRECTOR, Ingham County Survey and Remonumentation Project

SURVEYOR'S MICHIGAN REGISTRATION NO. 17624

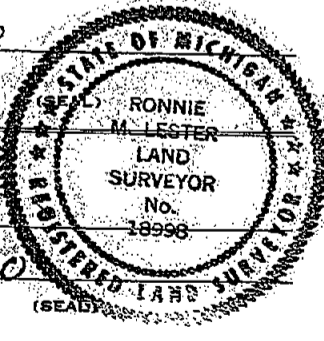
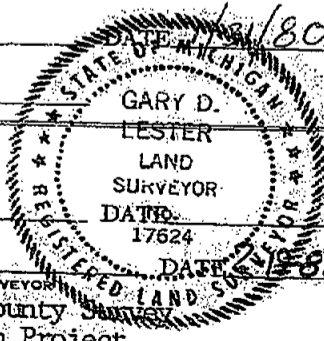

1780

FORM APPROVED BY MICHIGAN STATE BOARD OF REGISTRATION, JAN. 28, 1971  
REVISED MAY 14, 1975

MAY PLACE SKETCH ON BACK OR ATTACHED SHEET

Continuation of Part A

H-13

Corner identified as a granite stone and 3/4" pipe in MDSHT Form 280, September 24, 1965.

Corner identified as a 3/4" pipe in Ingham County Road Commission records, revised grid map, 1969.

LAND CORNER RECORDATION CERTIFICATE  
Filing Requirement of Act 74, Mich. P.A. 1970

LIBER PAGE 245

FILED

For corners in  
Ingham

(County)

Located In:

Corner Code --

1. Public Land Survey

T 2N R 2E

I-11

T 2N R 2E

J-11

T R

T R

2. Property Controlling  
in Section

S T R

S T R

3. Miscellaneous  
Property in Sec.

S T R

S T R

4. Lot No. , Recorded Plat

5. Private Claims

Dec 20 9 35 AM '91

REGISTER OF DEEDS

INGHAM COUNTY, MICH.

Register of Deeds Stamp & File Number

I, Gary R. Boss, in a field survey on December 12, 1991, do hereby certify that under requirements of P.A. 74, Michigan P.A. of 1970, the corner points mentioned in lines 1 and 2 above were in conformance with regulations and rules therefore as required in the current manual of survey instructions of the United States Department of the Interior, Bureau of Land Management or by a decree of a Court of Law and/or that the corner points mentioned in lines 3, 4 and 5 above were in conformance with the rules of the Michigan Board of Land Surveyors or by a Decree of a Court of Law, established, re-established, monumented, re-monumented, recovered, found as expressed below:

NOTE: Not more than 4 corners, all in the same town and range, may be recorded on this certificate.

A. Description of original monument and accessories and/or subsequent restoration:

I-11: Found 1 1/2" Iron Pipe L.3, P. 397.

J-11: Found Iron L.3, P. 399.

B. Description of corner evidence found and/or method applied in restoring or reestablishing corner:

I-11: Found 1/2" Iron

J-11: Found 1/2" Iron Pipe

C. Description of monument for corner and accessories established to perpetuate locating the position of the corner:

I-11: East 33.11 Nail & Tag #25877 S/S 24" Maple

S45°E 23.77' Fd. Nail & Tag SW/S 10" Oak

N88°W 36.81' Fd. Nail & Tag S/S 5" Walnut

N35°W 58.90' Fd. Nail & Tag E/S 8" Walnut

J-11: S25°W 44.19' Nail & Tag E/S 15" Hickory

S70°W 27.90' Nail & Tag S/S 12" Cherry

S5°E 4.02' Nail & Tag W/S 10" Locust

S60°E 18.76' Nail & Tag #25837 NE/S 18" Maple

Signed by

Gary R. Boss

Date

12/13/91

Surveyor's Michigan License No.

17022

FORM APPROVED BY MICHIGAN STATE BOARD OF LAND SURVEYORS, JAN. 28, 1971  
REVISED MAY 14, 1975  
REVISED JAN., 1983

2391