

LAND CORNER RECORDATION CERTIFICATE  
Filing Requirement of Act 74, Mich. P.A. 1970  
WILLIAMSTOWN TOWNSHIP  
(AMENDED CORNER)

For corners in

INGHAM  
(County)

Located In: Corner Code #

1. Public Land Survey T 4N R 1E  
T R  
T R  
T R  
2. Property Controlling S T R  
in Section S T R  
3. Miscellaneous S T R  
Property in SECTION. S T R

C-1

Paula Johnson  
INGHAM COUNTY  
REGISTER OF DEEDS RECORDED  
RON HELSEL PROFESSIONAL SUR CRNR 11.00

L-10 P-289

2002-074476

2002-074476

Page: 1 of 2

11/18/2002 08:34A

Register of Deeds Stamp & File Number

4. Lot No. , Recorded Plat  
5. Private Claims

I, RON HELSEL, in A field survey on AUG. 07, 2002 do hereby state that under requirements of P.A. 74, Michigan P.A. of 1970, the corner points mentioned in lines 1 and 2 above were in conformance with regulations and rules therefore as required in the current manual of survey instructions of the United States Department of the Interior, Bureau of Land Management or by A decree of A Court of Law and /or that the corner points mentioned in lines 3, 4 and 5 above were in conformance with the rules of the Michigan Board of Land Surveyors or by A Decree of A Court of Law; established, re-established, monumented, recovered, found as expressed below:

NOTE: Not more than 2 corners, all in the same town and range, may be recorded on this certificate.

A. Description of original monument and accessories and/or subsequent restoration:  
ORIGINAL MONUMENT: POST SET BY J. WAMPLER, U.S. DEPUTY SURVEYOR, FEB. 1824.

AT 50.26 CHAINS INTERSECTED MERIDIAN 31.75 CHAINS NORTH OF CORNER OF TOWNSHIP. 4 & 5 NORTH AND R1W. ASPEN 9", S39-1/2 E, 13 LINKS; ASPEN 10" N29E, 20-1/2 LINKS.

1) ROAD BOOK 1-A, PAGE 1, FEB. 1-3, 1911, SHIAWASSEE CO. SURVEYOR, V. W. ROYCE. RECORDED A DISTANCE OF 50 CHAINS 44 LINKS (3329.04 FEET FROM E-13 TO C-13. SET D-13 AT 40 CHAINS 14-1/2 LINKS (2649.57 FT.) CORNER MONUMENT AT C-13, IE C-1, T4N, R1E CALLS FOR A POST AGREED TO.

2) FIELD BOOK 31, PAGE 6, 1958, SHIAWASSEE CO. SURVEYOR O. M. ELLIOT CALLED FOR A 3 WAY FENCE AT THE CORNER HICKORY 11", N2°W, 14.75'; OAK 16", N88°E, 24.22'; OAK 21", S29°E, 54.60'

(CONTINUED ON BACK SIDE)

B. Description of corner evidence found and/or method applied in restoring or reestablishing corner:  
FOUND BOTH MARKERS FOR THE CORNER DESCRIBED BY SURVEYORS LESTER AND BRYAN. THE FENCES NOTED BY SURVEYOR BRYAN TO THE SOUTH AND EAST, ALONG WITH THE BROKEN WOOD ANCHOR POST HAVE BEEN REMOVED. HOWEVER, FOUND ENOUGH REMNANTS OF A WOVEN WIRE FENCE TO THE EAST THAT PUT IT AT THE LOCATION OF THE PIPE FOUND BY BRYAN. EXCAVATION AT THE LESTER IRON FOUND PIECES OF THE SMALLER GAUGE OF THE WOVEN WIRE FENCE AND NOTHING ELSE. THE 1" PIPE WAS 30" LONG AND WAS DRIVEN IN AT AN ANGLE WITH THE TOP BEING OVER A HOLE IN THE CENTER OF A CIRCLE OF FIELD STONES. DEEMED THAT THE CORNER SET BY SURVEYOR LESTER WAS SET AT THE TOP OF THE FALLEN POST. EXCAVATED DOWN 3 FEET IN THE CIRCLE OF FIELD STONES AND FOUND A STONE WITH A GROOVE SPOT ON TOP. DID NOT FIND ANY OTHER ACCESSORIES. MEASURED 3320.18 FEET FROM E-13 TO C-13 (C-1). G.L.O. 50.26 CHAINS (3317.16') ROYCE 50.44 CHAINS (3329.04'). MEASURED SOUTH 2099.8 FEET (G.L.O. 31.75 CHAINS OR 2095.50') TO NE CORNER SECTION 1, T4N, R1W. ACCEPTED THE POSITION OF THE 1" PIPE AS THE BEST AVAILABLE EVIDENCE FOR THE HISTORICAL AND AMENDED CORNER, AND SET A STANDARD INGHAM COUNTY STEEL ROD & DISK IN THE HOLE UNDER THE TOP OF THE LEANING PIPE AND OVER THE GROOVED STONE.

C. Description of monument for corner and accessories established to perpetuate locating the position of the corner:  
3/4" BY 24" STEEL ROD WITH AN ALUMINUM DISK STAMPED P.A. 345, P.S. NO. 18994. (AMENDED CORNER)

SET NAIL & TAG #18994 EAST/SIDE 27" W. OAK, NAZ. 350°, 10.41 FEET

SET NAIL & TAG #18994 SOUTH/SIDE 14" ASH, NAZ. 52°, 26.89 FEET

SET NAIL & TAG #18994 EAST/SIDE 16" ASH, NAZ. 20°, 33.80 FEET

SET NAIL & TAG #18994 SOUTH/SIDE 12" MAPLE, NAZ. 266°, 23.14 FEET

SET NAIL & TAG #18994 WEST/SIDE 7" ASH, NAZ. 207°, 17.07 FEET

1/2" BAR AND CAP NO. 18998, N30°24'E, 6.45 FEET

SOUTH, 2099.8 FEET TO M-1, T4N, R1W

EAST, 677.07 FEET TO D-13, T5N, R1E,

EAST, 840.75 FEET TO D-1



Signed by Ron Helsel  
Surveyor'S Michigan License No. 18994

Date 11-06-02

P.A. 345 INGHAM COUNTY  
PEER APPROVED 10/24/2002 M

(C-1 WILLIAMSTOWN TOWNSHIP. T4N, R1E)

3) P.A. 132 SURVEYS LIBER 1, PAGE 49 DEC. 3, 1971 & LIBER 1, PAGE 519, OCT. 15, 1973, SHIAWASSEE COUNTY RECORDS, BY L. HENDRYX P.S. #3276 REFERS TO THE CORNER BUT DOES NOT DESCRIBE, WITNESS OR GIVE ANY SECTION LINE TIES TO ADJOINING CORNERS.

4) P.A. 132 SURVEYS LIBER 3, PAGES 464-470, JULY 28, 1978, R. LESTER P.S. #18998. "SET 1/2" BAR & CAP"  
NAIL & TAG EAST SIDE 8" ASH NE, 20.93' (GIVES A TIE OF 831.95' TO D-1)  
NAIL & TAG SOUTH SIDE 18" OAK ESE, 18.64'  
NAIL & TAG NORTH SIDE 29" OAK WNW, 7.74'

5) P.A. 74 CORNER, LIBER 5, PAGE 69, NOV. 27, 1978, R. LESTER. "SET 1/2" BAR & CAP AT BASE OF OLD BROKEN CORNER POST, FENCES SOUTH AND EAST FROM POST." WITNESSES THE SAME AS 4-A, ABOVE.

6) P.A. 74 CORNER LIBER 6, PAGE 328, APRIL 28, 1987, L. BRYAN P.S. #25832. "CORNER REFERRED TO BY V.W. ROVCE IN SURVEY DATED FEB., 1911. (SHIAWASSEE CO.) FOUND PINCH PIPE AT BASE OF OLD CORNER POST, FENCE LINES NORTH-SOUTH AND EAST, 1/2" BAR & CAP #18998 AS RECORDED IN LIBER 5, PAGE 69, NORTHEAST 6.40 FEET."  
SET NAIL & TAG EAST/SIDE 36" OAK, NORTH, 10.00 FEET  
SET NAIL & TAG SOUTH SIDE 12" ASH, N45°E, 26.93 FEET  
SET NAIL & TAG NORTH SIDE 22" WALNUT, S50°E, 26.49 FEET

7) P.A. 74 CORNER (FOR D-13 OF SHIAWASSEE COUNTY, WOODHULL TOWNSHIP. T5, R1E) LIBER 2, PAGE 898, SEPT. 22, 1994, T. WIEGMAN P.S. #39100. SECTION "B" OF FORM " MEASUREMENTS TO THE SW CORNER OF SECTION 32 (SAME AS NW CORNER SECTION 5, T4N, R1E, LIBER 6 PAGE 328, INGHAM COUNTY RECORDS) SHOWED IT TO FALL 13.70' SOUTH OF THE EXTENDED SOUTH LINE OF GREEN HILLS NO. 1. THE LOCATION OF THIS CORNER WAS QUESTIONED BY SURVEYOR ROYCE IN HIS FEBRUARY 1, 1911 SURVEY RECORDED IN BOOK F OF SURVEYS AND WAS ADVISED BY THE PROSECUTING ATTORNEY TO USE THE EXISTING FENCE CORNER. "



2002-074476

Page: 2 of 2

11/18/2002 08:34A

LAND CORNER RECORDATION CERTIFICATE  
Filing Requirement of Act 74, Mich. P.A. 1970  
WILLIAMSTOWN TOWNSHIP

For corners in

INGHAM

(County)

Located In:

Corner Code #

1. Public Land Survey

T 4N R 1E

C-2

Paula Johnson  
INGHAM COUNTY  
REGISTER OF DEEDS  
RON HELSEL PROFESSIONAL SUR

L-10 P-291

RECORDED  
CRNR 9.00

2002-074477

2. Property Controlling  
in Section

S T R  
S T R



2002-074477

Page: 1 of 1

11/18/2002 08:34A

Register of Deeds Stamp & File Number

3. Miscellaneous

S T R  
S T R

Property in SECTION.

4. Lot No. , Recorded Plat

5. Private Claims

I, RON HELSEL, in A field survey on OCT. 3, 2002 do hereby state that under requirements of P.A. 74, Michigan P.A. of 1970, the corner points mentioned in lines 1 and 2 above were in conformance with regulations and rules therefore as required in the current manual of survey instructions of the United States Department of the Interior, Bureau of Land Management or by A decree of A Court of Law and /or that the corner points mentioned in lines 3, 4 and 5 above were in conformance with the rules of the Michigan Board of Land Surveyors or by A Decree of A Court of Law; established, re-established, monumented, recovered, found as expressed below:

NOTE: Not more than 2 corners, all in the same town and range, may be recorded on this certificate.

A. Description of original monument and accessories and/or subsequent restoration:  
CORNER NOT SET IN ORIGINAL GOVERNMENT SURVEY.

1) VOL. 1, PG. 191, CO. SURVEYOR A. JACKSON, JUNE, 1843, DID NOT IDENTIFY CORNER MARKER. WITNESSED AS TAM 5", N77W 4 LINKS; TAM 5", S56-1/2W 14 LINKS. RECORDED DISTANCE OF 71 RODS TO THE CENTER OF SECTION. OCT. 18, 1890, CO. SURVEYOR J. MCCREARY RECORDED A DISTANCE OF 69 RODS 15 LINKS TO THE CENTER OF SECTION 5 ON SAME SURVEY OF JACKSON'S.

2) GRAND BEND SUBDIVISION, LIBER 22 OF PLATS PAGE 37, 1959, MAX ROGERS. CORNER NOT REFERRED TO ON PLAT.

3) P.A. 74 CORNER, LIBER 3, PAGE 564, MAY 3, 1976, JAMES STEPHENS P.S. #16053. "CHECKED RECORDS OF 9 AREA LAND SURVEYORS. A 3/4" IRON PIPE WAS SET ON A PROJECTION OF A LINE BETWEEN THE NE CORNER OF SECTION. 1, T4N, R1W AND THE WEST LINE OF GRAND BEND SUBDIVISION AT IT'S INTERSECTION WITH A PROJECTION OF AN OLD FENCE LINE EAST OF THE CORNER. SURVEY TAG ON THE EAST SIDE OF A 5" POPLAR TREE, S84°08'W, 71.97 FEET; SURVEY TAG ON THE SE SIDE OF A 6" WILD CHERRY TREE, N49°38'W, 73.56 FEET; N89°24'E, 27.89 FEET TO A 1" SOLID IRON ROD FOUND AT FENCE INTERSECTION.

4) P.A. 132 SURVEY LIBER 2, PAGES 720-721, MAY 3, 1976, J. STEPHENS. SAME AS ABOVE.

5) P.A. 74 CORNER, LIBER 4, PAGE 106, NOV. 7, 1977, R. LESTER P.S. #18998. "SET 4" CONCRETE MONUMENT ON TOWN LINE AS ESTABLISHED BY NE & SE CORNERS OF SECTION. 1, T4N, R1W ON TOWN LINE. TAPE INDEXED DISTANCE 2621.26' NORTH OF SW CORNER OF SECTION. 5. MEASURED NORTH TO NE COR. SECTION 1, T4N, R1W, 1472.54' MEASURED NORTH 152.50' TO ERRONEOUSLY RECORDED CORNER SHOWN IN L 3, P 564. NAIL & TAG IN NORTH SIDE 6' POPLAR, WEST, 75.25'; NAIL & TAG IN SW SIDE 6" POPLAR, NW, 60.42'; 3/4" PIPE AS RECORDED IN L 3, P 564 NORTH, 152.50'.

B. Description of corner evidence found and/or method applied in restoring or reestablishing corner:

FOUND THE CONCRETE MONUMENT AS SET BY SURVEYOR LESTER IN 5-A ABOVE BY MEASURING FROM THE NORTHEAST CORNER OF SECTION 1, T4N, R1W AND USING THE WEST LINE OF GRAND BEND FOR LINE. AREA IS IN A LOW MARSH WITH DENSE DOGWOOD AND BRUSH. WADED AND CUT A LINE THROUGH AND OVER THICK FOLIAGE, MANY TIMES CRAWLING ON TOP AND VERY SELDOM SEEING GROUND. FOUND THE 3/4" PIPE AS SET BY SURVEYOR STEPHENS AT 152.5 FEET NORTH OF THE CONCRETE MONUMENT. DID NOT FIND ANY EVIDENCE OF FENCE LINES ANY WHERE.. MEASURED EAST, 1138.32 FEET TO D-2. LESTER'S NOTES CALLED FOR A DISTANCE OF 1138.61 FEET. MCCREARY RECORDED 1148.4 FEET. ACCEPTED THE POSITION OF THE MONUMENT AS THE BEST AVAILABLE EVIDENCE FOR THE CORNER AND SET A PLASTIC CAP ON TOP THE MON. MARKED CORNER WITH A "T" STEEL FENCE POST ON THE SOUTH AND A 1" DIAMETER STEEL POST ON THE NORTH. MONUMENT IN WATER ABOUT 8" ABOVE MUCKY GROUND.

C. Description of monument for corner and accessories established to perpetuate locating the position of the corner:

4" DIAMETER BY 36" CONCRETE MONUMENT WITH 1/2" REROD IN CENTER WITH CAP NO. 18994.

3/4" PINCH PIPE NORTH, 152.5 FEET

SET NAIL & TAG EAST/SIDE 4" MAPLE, AZ. 340°, 12.09 FEET

SET NAIL & TAG SOUTH/SIDE 4" POPLAR, AZ. 130°, 67.2 FEET

SET NAIL & TAG NORTH/SIDE 3" MAPLE, AZ. 270°, 26.80 FEET

EAST, 1138.32 FEET TO D-2

SOUTH, 2621.36 FEET TO C-3

NORTH, ± 1472.5 FEET TO M-1, T4N, R1W, MERIDIAN TOWNSHIP

Signed by

*Ron Helsel*

Surveyor's Michigan License No.

18994

Date

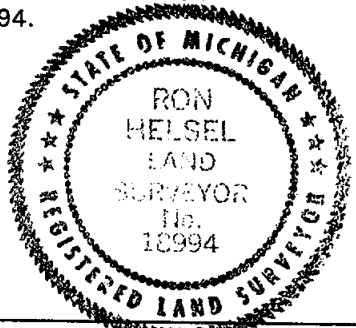

11-06-02



LAND CORNER RECORDATION CERTIFICATE  
Filing Requirement of Act 74, Mich. P.A. 1970  
WILLIAMSTOWN TOWNSHIP

For corners in

INGHAM

(County)

Located In:

Corner Code #

1. Public Land Survey

T 4N R 1E

D-1

T R

T R

T R

T R

2. Property Controlling  
in Section

S T R

S T R

3. Miscellaneous

S T R

Property in SECTION.

S T R

Paula Johnson

INGHAM COUNTY

REGISTER OF DEEDS

RON HELSEL PROFESSIONAL SUR

L-10 P-279

CRNR 11.00

2002-065243

2002-065243

Page: 1 of 2

10/17/2002 08:09A

Register of Deeds Stamp & File Number

4. Lot No. , Recorded Plat

5. Private Claims

I, RON HELSEL, in A field survey on AUG. 21, 2002 do hereby state that under requirements of P.A. 74, Michigan P.A. of 1970, the corner points mentioned in lines 1 and 2 above were in conformance with regulations and rules therefore as required in the current manual of survey instructions of the United States Department of the Interior, Bureau of Land Management or by A decree of A Court of Law and /or that the corner points mentioned in lines 3, 4 and 5 above were in conformance with the rules of the Michigan Board of Land Surveyors or by A Decree of A Court of Law; established, re-established, monumented, recovered, found as expressed below:

NOTE: Not more than 2 corners, all in the same town and range, may be recorded on this certificate.

A. Description of original monument and accessories and/or subsequent restoration:  
CORNER NOT SET IN ORIGINAL GOVERNMENT SURVEY.

1) VOL. 1, PAGE 191, JUNE 16, 1943, A. JACKSON CO. SURVEYOR. IN A SURVEY OF THE NORTH FRACTIONAL 1/2 OF SECTION 5, SURVEYOR JACKSON FAILED TO IDENTIFY OR WITNESSES THIS CORNER. HE GAVE A DISTANCE OF 160 RODS TO E-1.

2) P.A. 74 CORNER LIBER 5, PAGE 69, NOV. 27, 1978, R. LESTER, P.S. 18998. "SET 1/2" BAR & CAP ON LINE BETWEEN NW CORNER SECTION 5, AND NE CORNER

SECTION 5, AT PROPORTIONAL MEASUREMENT FROM NE CORNER. MEASURED EAST, 2636.90, MEASURED WEST 831.94'. SET 38 FEET SOUTH OF FENCE EAST & WEST AND 26 FEET WEST OF FENCE NORTH AND SOUTH." NAIL & TAG WEST SIDE 12" POPLAR, NE, 25.30'; NAIL & TAG SOUTH SIDE 18" OAK, WEST, 21.35'; NAIL & TAG WEST SIDE 10" POPLAR, SW, 1.98'

3) P.A. 74 CORNER LIBER 6, PAGE 328, APRIL 28, 1987, L. BRYAN P.S. 25832. "SET 1/2" BAR & CAP AT BASE OF OLD CORNER POST, FENCE LINES SOUTH, EAST-WEST, 1/2" BAR & CAP #18998 AS RECORDED IN LIBER 5, PAGE 69, SOUTH 38 FEET AND WEST 20 FEET." SET NAIL & TAG EAST SIDE 14" OAK, N10°E, 16.87'; SET NAIL & TAG WEST SIDE 6" OAK, WEST, 11.41'; SET NAIL & TAG WEST SIDE 10" APPLE, S45°E, 11.93 FEET.

((CONTINUED ON BACK SIDE))

B. Description of corner evidence found and/or method applied in restoring or reestablishing corner:

FOUND BOTH CORNERS AS SET BY SURVEYOR'S LESTER AND BRYAN. TRAVERSED COUNTY LINE BETWEEN E-1 AND D-13 OF WOODHULL TOWNSHIP. T5N, R1E. FOUND THE CORNER AS SET BY SURVEYOR BRYAN TO BE 0.15 FEET SOUTH OF THE LINE BETWEEN E-13 AND D-13. THE SOUTH 1/4 CORNER OF SECTION 32 WOODHULL WAS SET BY SURVEYOR T. WIEGMAN, #39100 FROM E-13 ON THE SOUTH LINE OF GREEN HILLS NO. 1 AS EXTENDED WEST AND AT A PRORATED DISTANCE TO C-13 (C-1). EXCAVATED AT THE POSITION OF THE CORNER AS SET BY L. BRYAN IN 3-A ABOVE. AND FOUND A CIRCLE OF FIELD STONES AROUND A HOLE WHICH WAS THE APPARENT ANCHOR POST LOCATION. ACCEPTED THE POSITION OF THE BRYAN CORNER AS THE CLOSING CORNER AND SET A STANDARD INGHAM COUNTY MONUMENT AT THE AMENDED POSITION 0.15 FEET NORTH AND ON THE STANDARD LINE BETWEEN D-13 AND E-13. STANDARD INGHAM COUNTY MONUMENT IS DESCRIBED AS A 24" BY 3/4" STEEL ROD WITH AN ALUMINUM DISK STAMPED P.A. 345, P.S. 18994. CORNER 0.2 FEET SOUTH OF A 5 FOOT HIGH, EAST-WEST WOOD FENCE LINE.

C. Description of monument for corner and accessories established to perpetuate locating the position of the corner:  
STANDARD INGHAM COUNTY MONUMENT AS DESCRIBED ABOVE.

FOUND BAR & CAP #39100 EAST, 60.5 FEET (SET AS A PROPERTY CORNER IN SECTION 32 OF T5N, R1E)  
D-13 (5N, R1E) WEST, 183.67 FEET

FOUND NAIL & TAG #39100 (T. WIEGMAN) SE/SIDE 12" POPLAR, NAZ. 150°, 23.86 FEET

FOUND NAIL & TAG #39100 EAST/SIDE 8" POPLAR, NAZ. 203°, 19.13 FEET

FOUND NAIL & TAG #39100 NORTH/SIDE 10" OAK, NAZ. 124°, 18.69 FEET

FOUND NAIL & TAG #39100 SOUTH/SIDE 10" OAK, WEST, 11.27 FEET

Signed by

*Ron Helsel*

Surveyor'S Michigan License No. 18994

Date

*Sept. 4, 2002*



- 4) P.A. 132 SURVEY RECORDED IN LIBER 2, PAGES 16-17, JULY 12, 1974, R. LESTER #18998. SURVEY ABUTS THE SOUTH LINE OF GREEN HILLS NO. 1 AS RECORDED IN LIBER 11, PAGE 188, SHIAWASSEE COUNTY RECORDS. 1/4 CORNER NOT IDENTIFIED.
- 5) P.A. 132 SURVEY RECORDED IN LIBER 3, PAGES 464-470, JULY 28, 1978, R. LESTER #18998. CALLED FOR SAME CORNER MARKER AND WITNESSES AS 2-A, ABOVE



2002-065243  
Page: 2 of 2  
10/17/2002 08:09A

For corners in

**Located In:**

**Corner Code #**

## 1. Public Land Survey

T 4N	R 1E
T	R
T	R
T	R
T	R
T	R

D-2

Paula Johnson  
INGHAM COUNTY  
REGISTER OF DEEDS      RECORDED  
RON HELSEL PROFESSIONAL SUR

L-10 P-292

2002-074478

## 2. Property Controlling in Section

S\_\_\_\_\_ T\_\_\_\_\_ R\_\_\_\_\_  
S\_\_\_\_\_ T\_\_\_\_\_ R\_\_\_\_\_

**3. Miscellaneous  
Property in SECTION.**

S\_\_\_\_\_ T\_\_\_\_\_ R\_\_\_\_\_  
S\_\_\_\_\_ T\_\_\_\_\_ R\_\_\_\_\_

**Register of Deeds Stamp & File Number**

4. Lot No. \_\_\_\_\_, Recorded Plat

## 5. Private Claims

I, RON HELSEL, in A field survey on SEPT. 10, 2002 do hereby state that under requirements of P.A. 74, Michigan P.A. of 1970, the corner points mentioned in lines 1 and 2 above were in conformance with regulations and rules therefore as required in the current manual of survey instructions of the United States Department of the Interior, Bureau of Land Management or by A decree of A Court of Law and /or that the corner points mentioned in lines 3, 4 and 5 above were in conformance with the rules of the Michigan Board of Land Surveyors or by A Decree of A Court of Law; established, re-established, monumented, recovered, found as expressed below:

**NOTE:** Not more than 2 corners, all in the same town and range, may be recorded on this certificate.

A. Description of original monument and accessories and/or subsequent restoration:  
CORNER NOT SET IN ORIGINAL GOVERNMENT SURVEY

1) VOL. 1, PAGE 191, JUNE 10, 1843, A. JACKSON CO. SURVEYOR. DID NOT IDENTIFY MARKER, WITNESSED AS: TAM 6", N34-1/2E, 14 LINKS; B. OAK 18", N45-1/2W, 70-1/2 LINKS. RECORDED DISTANCE OF 159 RODS EAST TO E-3 AND 71 RODS WEST TO C-2. ON OCT. 18, 1890 CO. SURVEYOR J. MCCREARY ON SAME SURVEY RECORDED A DISTANCE OF 69 RODS 15 LINKS TO C-2.

2) P.A. 74 CORNER LIBER 4, PAGE 107, NOV. 9, 1977, R. LESTER P.S. #18998. FOUND OLD 1/2" PIPE ON OCCUPATION LINES NORTH AND EAST. USED LINE BETWEEN THIS PIPE AND SOUTH 1/4 CORNER OF SECTION INTERSECTED WITH LINE BETWEEN EAST 1/4 CORNER AND WEST 1/4 CORNER TO SET CENTER OF SECTION. MEASURED EAST 2630.29 FEET; MEASURED WEST 1138.61 FEET & SOUTH 2630.77 FEET." SET 1/2" BAR & CAP. NAIL & TAG IN EAST SIDE 5" MAPLE, NNW, 17.65 FEET; NAIL & TAG NORTH SIDE 8" MAPLE, WEST, 7.00 FEET; NAIL & TAG IN EAST SIDE 5" MAPLE, SSW, 5.16 FEET; FENCE TO EAST, SOUTH 43.4 FEET.

3) P.A 132 SURVEYS LIBER 3, PAGES 77-83, NOV. 7, 1977, R. LESTER. SAME CORNER MARKER AND WITNESSES AS ABOVE.  
4) UNRECORDED SURVEY, NOV. 30, 2001, T. WIEGMAN P.S. 39100. FOUND 1/2" B&C: N&T S/S 40" OAK, N65E, 26.33'; N&T E/S 10" MAPLE, NORTH, 15.80'; N&T N/S 15" MAPLE, N70W, 7.20' FENCE COR. SOUTH, 43.4' REC. A DISTANCE OF 2630.42 FEET TO E-2 & 3609.95' TO D-1.

B. Description of corner evidence found and/or method applied in restoring or reestablishing corner:  
FOUND THE 1/2" BAR AND CAP NO. 18988. TRAVERSE FOUND THE CORNER TO BE 4.22 FEET WEST OF THE NORTH-SOUTH 1/4 LINE AND ON LINE BETWEEN THE WEST AND EAST 1/4 CORNERS. JACKSON RECORDED A DISTANCE OF 2626.14 FEET TO E-2, LESTER 2630.29 FEET. MCCREARY RECORDED A DISTANCE OF 1148.4 FEET TO C-2 AND LESTER 1138.61 FEET. ACCEPTED THE POSITION OF THE 1/2" BAR AS THE PROPER LOCATION OF THE JACKSON CORNER AND REPLACED IT WITH A STANDARD INGHAM COUNTY MONUMENT WHICH IS A 3/4" BY 24" IRON BAR WITH AN ALUMINUM DISK STAMPED P.A. 345, P.S. NO. 18994.

C. Description of monument for corner and accessories established to perpetuate locating the position of the corner:  
STANDARD INGHAM COUNTY MONUMENT AS DESCRIBED ABOVE IN NORTH-SOUTH FENCE LINE, STEEL POST ON NORTH SIDE.  
1/2" BAR & CAP #39100 AT SOUTHERLY R/W OF GRAND TRUNK RAILROAD, ON N-S 1/4 LINE NORTH, 123.51 FEET  
3/4" PIPE AT R.R. TIE POST, SOUTH 44.00 FEET

FOUND NAIL & TAG #39100 NORTH/SIDE 12" MAPLE, NAZ. 271°, 7.17 FEET  
FOUND NAIL & TAG #39100 EAST/SIDE 9" MAPLE, NAZ. 338°, 15.80 FEET  
FOUND NAIL & TAG #39100 SOUTH/SIDE 42" MAPLE, NAZ. 68°, 26.38 FEET  
FOUND NAIL & TAG #39100 EAST/SIDE 6" MAPLE, NAZ. 195°, 5.10 FEET  
SET NAIL & TAG #18994 NORTH/SIDE 8" MAPLE, NAZ. 124°, 25.21 FEET  
MEAS. EAST, 2630.42 FEET TO E-2  
MEAS. WEST, 1138.32 FEET TO C-2  
MEAS. NORTH, 3609.89 FEET D-1  
MEAS. SOUTH, 2630.35 FEET TO D-3

Signed by Gon Kessel  
Surveyor'S Michigan License No. 18994

Date 11-06-02

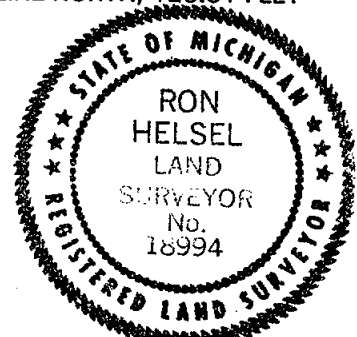

P.A. 345 INGHAM COUNTY  
PEER APPROVED 10/24/2002 *M*

FORM APPROVED BY MICHIGAN STATE BOARD OF PROFESSIONAL SURVEYORS, JAN. 28, 1971  
REVISED MAY 14, 1976  
REVISED JAN., 1983  
REVISED OCT., 1995

LAND CORNER RECORDATION CERTIFICATE  
Filing Requirement of Act 74, Mich. P.A. 1970  
WILLIAMSTOWN TOWNSHIP

For corners in

INGHAM

(County)

Located In:

Corner Code #

1. Public Land Survey

T 4N R 1E

D-3

T R

T R

T R

2. Property Controlling  
in Section

S T R

S T R

3. Miscellaneous

S T R

Property in SECTION.

S T R

Paula Johnson  
INGHAM COUNTY  
REGISTER OF DEEDS  
RON HELSEL PROFESSIONAL SUR

RECORDED  
CRNR 9.00

L-10 P-283

2002-065246

2002-065246

Page: 1 of 1

10/17/2002 08:09A

Register of Deeds Stamp & File Number

4. Lot No. , Recorded Plat

5. Private Claims

I, RON HELSEL, in A field survey on AUG. 21, 2002 do hereby state that under requirements of P.A. 74, Michigan, P.A. of 1970, the corner points mentioned in lines 1 and 2 above were in conformance with regulations and rules therefore as required in the current manual of survey instructions of the United States Department of the Interior, Bureau of Land Management or by A decree of A Court of Law and /or that the corner points mentioned in lines 3, 4 and 5 above were in conformance with the rules of the Michigan Board of Land Surveyors or by A Decree of A Court of Law; established, re-established, monumented, recovered, found as expressed below:

NOTE: Not more than 2 corners, all in the same town and range, may be recorded on this certificate.

A. Description of original monument and accessories and/or subsequent restoration:

ORIGINAL MONUMENT: POST SET BY J. WAMPLER, U.S. DEPUTY SURVEYOR, MAR. 1826. WEST BETWEEN 5 & 8 SET POST AT 40 CHAINS; INTERSECT MERIDIAN AT 61.18 CHAINS. W.O 16", S31W, 178-1/2 LINKS; W.O. 18" S55-1/2W, 248 LINKS.

MARGIN NOTE: HICKORY 6", S50-1/2W, 231 LINKS; HICKORY 5", N41W, 259 LINKS.

1) VOL 1, PAGE 191, JUNE 16, 1843, CO. SURVEYOR A. JACKSON CALLED FOR THE HICKORY TREES, AS NOTED IN THE MARGIN ABOVE.

2) P.A. 74 CORNER LIBER 3, PAGE 333, FIELD DATED JULY 10, 1974 & RECORDED FEB. 18, 1975. R. LESTER, P.S. #18988. "SET 1/2" BAR AT INTERSECTION OF FENCES NORTH, SOUTH, EAST, & WEST. MEASUREMENT TO EAST IN CLOSE ACCORD WITH ORIGINAL GOVERNMENT NOTES." NAIL & TAG NE SIDE 7" CHERRY, SE 9.72'; NAIL & TAG EAST SIDE TWIN 10" APPLE, SSE, 23.10'; NAIL & TAG SOUTH SIDE 10" CHERRY, WNW 12.48'.

3) P.A 132 SURVEY, LIBER 2, PAGE 64-66, AUG. 26, 1974 RE-RECORDED AUG. 26, 1975, LIBER 438-440, R. LESTER P.S #18998. SAME MARKER AND WITNESSES AS 2-A ABOVE.

4) P.A. 132 SURVEY, LIBER 3, PAGES 77-83, NOV. 7, 1977, R. LESTER P.S. #18998. RECORDED A DISTANCE OF 2632.15 TO E-3. SAME MARKER & WITNESSES AS 2-A ABOVE.

B. Description of corner evidence found and/or method applied in restoring or reestablishing corner:

FOUND THE 1/2" BAR AS SET BY SURVEYOR LESTER WITH ALL 3 BEARING TREES STILL STANDING. EXCAVATED AT THE BASE OF A WOOD ANCHOR POST AND FOUND A CIRCLE OF FIELD STONES. MEASURED EAST 2632.33 FEET TO E-3. MEASURED SOUTH 2633.49 FEET TO THE INTERSECTION OF THE 1/4 LINES. ACCEPTED THE POSITION OF THE BAR AS THE BEST AVAILABLE EVIDENCE OF THE CORNER AND REPLACED THE BAR WITH A STANDARD INGHAM COUNTY MONUMENT DESCRIBED AS A 24' BY 3/4" IRON PIN WITH AN ALUM. DISK STAMPED P.A. 345, P.S. NO. 18994. FENCES TO WEST, EAST AND NORTH. FENCE TO SOUTH HAS BEEN REMOVED.

C. Description of monument for corner and accessories established to perpetuate locating the position of the corner:

STANDARD INGHAM COUNTY MONUMENT AS DESCRIBED ABOVE IN FENCE LINE 1200 FEET MORE OR LESS NORTH OF THE CENTER LINE OF SHOESMITH ROAD.

SET NAIL & TAG #18994 NORTH/SIDE TWIN 10" CHERRY, NAZ. 130°, 9.72 FEET

SET NAIL & TAG #18994 SOUTH/SIDE TWIN 20" CHERRY, NAZ. 285°, 12.48 FEET

FOUND NAIL & TAG #30101 (K. SHELLNBARGER) EAST/SIDE TRIPLE 12" APPLE, NAZ.. 172°, 26.31 FEET

SET NAIL & TAG #18994 WEST/SIDE 8" OAK, NAZ. 147°, 39.22 FEET

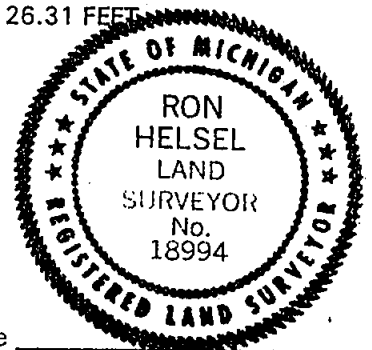

Signed by

*Ron Helsel*

Date

*Sept. 4, 2002*

Surveyor's Michigan License No. 18994

P.A. 345 INGHAM COUNTY

PEER APPROVED *9/24/2002 M*

FORM APPROVED BY MICHIGAN STATE BOARD OF PROFESSIONAL SURVEYORS, JAN. 28, 1971

REVISED MAY 14, 1976

REVISED JAN., 1983

REVISED OCT., 1996



DEC 3 9 25 AM '93  
REGISTER OF DEEDS  
Ingham County, Mich.

LAND CORNER RECORDATION CERTIFICATE  
Filing Requirement of Act 74, Mich. P.A. 1970

For corners in

INGHAM  
(County)

Located In:

Corner Code ##

- |                                    |   |    |   |    |     |
|------------------------------------|---|----|---|----|-----|
| 1. Public Land Survey              | T | 4N | R | 1E | E-1 |
|                                    | T |    | R |    |     |
|                                    | T |    | R |    |     |
|                                    | T |    | R |    |     |
| 2. Property Controlling in Section | S |    | T | R  |     |
|                                    | S |    | T | R  |     |
| 3. Miscellaneous                   | S |    | T | R  |     |
| Property in Sec.                   | S |    | T | R  |     |

Register of Deeds Stamp & File Number

4. Lot No. \_\_\_\_\_, Recorded Plat \_\_\_\_\_  
5. Private Claims \_\_\_\_\_

I, MARVIN FOUTY, in a field survey on AUGUST 21, 19 93, do hereby certify that under requirements of P.A. 74, Michigan P.A. of 1970, the corner points mentioned in lines 1 and 2 above were in conformance with regulations and rules therefore as required in the current manual of survey instructions of the United States Department of the Interior, Bureau of Land Management or by a decree of a Court of Law and/or that the corner points mentioned in lines 3, 4 and 5 above were in conformance with the rules of the Michigan Board of Land Surveyors or by a Decree of a Court of Law; established, re-established, monumented, re-monumented, recovered, found as expressed below:

NOTE: Not more than 4 corners, all in the same town and range, may be recorded on this certificate.

A. Description of original monument and accessories and/or subsequent restoration:

- Post set in the original government survey by Joseph Wampler Deputy Surveyor in March of 1826 with the following references "94.52 intercepted N Bdy 236 lks (155.76') E. of Post with the following witnesses:  
Aspen 10 S54E 15 1/2 (10.2')  
Tam 16 S79W 182 (120.1')"

- County Surveyor A. P. Drake reported using the corner in a survey dated March, 1879 and recorded in Volume 3, Page 143 County Surveyor's records with no mention of monument or witnesses.

B. Description of corner evidence found and/or method applied in restoring or reestablishing corner:

Searched at the probable location of corner and found a "P.K." nail in asphalt drive using Surveyor Bryan's witnesses. Pulled R. Lester's distances to Westerly witnesses and could not get the distance to the SE corner of Section 32, T5 N, R1E, to match R. Lester's Distance. The Monument recorded at this point is a 1/2" Bar & Cap (Not a railroad spike) and falls 2' South of the Township line at 155.76 feet (The GLO call) not 160.35 feet as R. Lester's witness calls for. At the Township line a pointed stone was found at the GLO falling. Tied in Darlo Sub to verify corner and found that PK does indeed fall at location as reported in Subdivision Survey. Accepted PK as the corner and replaced the PK with standard 3/4" Bar & Cap. Standard 3/4" x 24" Ingham County Remonumentation Bar & PA 345 Cap #18989 in Bit. Drive

C. Description of monument for corner and accessories established to perpetuate locating the position of the corner:

SE Cor. Sec. 32, T5N, R1E (Stone) West 155.76'  
SE Cor. Lot 53, Green Hills No. 1 - 4" Conc. Mon. West 193.94'  
Found Nail & Tag #25832 in SW Side Utility Pole AZ 105 deg. 11.60'  
Centerline South Side 15" Hickory AZ 67 deg. 118.30'  
Centerline South Side 28" Maple AZ 44 deg. 115.15'  
Set Nail & Tag #25837 in North Side Util Pole AZ 270 deg. 44.35'

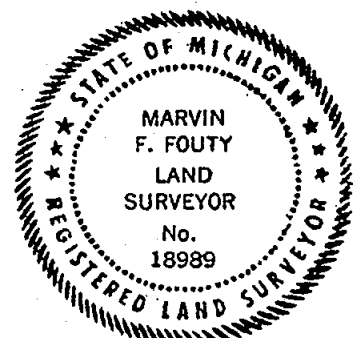

Signed by Marvin Fouty Date Nov. 5, 1993  
Surveyor's Michigan License No. 18989

3. Ronnie Lester LS# 18998 recorded the corner on July 12, 1974 in Liber 3 of Corners Page 161 as a set 1/2" Bar & Cap from the recorded plat of Dar-Lo Subdivision as recorded in Liber 25, Page 27 Ingham County Records by Surveyor Max F. Rogers in 1964 with the following witnesses: "SE Cor Sec 32, T5N, R1E, railroad spike West 160.35'; SE Cor Lot 53 Greenhills No. 1, 4" Conc. Monument West 193.94; 3/4" Rebar, East 18.82.
4. Ronnie Lester again reported using the corner in a survey in February, 1975 and recorded in Liber 2 of Surveys, Page 316 with the same witnesses as in No. 3 above.
5. Richard Steadman LS #11370 reported using the corner on May 14, 1976 and recorded it in Liber 2 of Surveys page 711, Ingham County Records and recorded November 29, 1976 in Liber 2 of surveys Page 945 as a 1/2" iron rod with the same witnesses as R. Lester's LCRC.
6. Richard Steadman again used the corner in a survey on December 30, 1977 and recorded in Liber 3 Page 272 with the same monument and witnesses as on Ronnie Lester's LCRC.
7. Ronnie Lester again reported using the corner in a survey in June 1978 and recorded in Liber 3 of Surveys, Page 464 with the same witnesses as 3 above.
8. Richard Steadman again used the corner in a survey on August 17, 1985 and recorded in Liber 4, Page 1242 as a 1/2" rod with no mention of witnesses.
9. Larry Bryan LS #25832 reported using the corner on March 27, 1990 and recorded in Liber 6 of Surveys Page 81, as a found "P.K." nail in an asphalt drive and rerecorded on August 16, 1990 in Liber 6 of corners, Page 250, with the following witnesses:  
"Set Nail & Tag in NE side power pole 550°E 11.64';  
Set Nail & Tag in S side power pole N55°W 44.4';  
Set Nail & Tag in NW side 40" Maple N60° 115.55".



**LAND CORNER RECORDATION CERTIFICATE**  
**Filing Requirement of Act 74, Mich. P.A. 1970**

For corners in

INGHAM

(County)

Located In:

Corner Code =#

**FILED**

DEC 2 9 31 AM '93

REGISTER OF DEEDS

*Paula Johnson*  
 INGHAM COUNTY, MICH.

Register of Deeds Stamp &amp; File Number

1. Public Land Survey	T <u>4N</u> R <u>1E</u>	<u>E-2</u>
	T _____ R _____	_____
	T _____ R _____	_____
	T _____ R _____	_____
2. Property Controlling	S _____ T _____ R _____	_____
in Section	S _____ T _____ R _____	_____
3. Miscellaneous	S _____ T _____ R _____	_____
Property in Sec.	S _____ T _____ R _____	_____

4. Lot No. \_\_\_\_\_, Recorded Plat \_\_\_\_\_

5. Private Claims \_\_\_\_\_

I, Marvin Fouty, in a field survey on September 4, 19 93, do hereby certify that under requirements of P.A. 74, Michigan P.A. of 1970, the corner points mentioned in lines 1 and 2 above were in conformance with regulations and rules therefore as required in the current manual of survey instructions of the United States Department of the Interior, Bureau of Land Management or by a decree of a Court of Law and/or that the corner points mentioned in lines 3, 4 and 5 above were in conformance with the rules of the Michigan Board of Land Surveyors or by a Decree of a Court of Law; established, re-established, monumented, re-monumented, recovered, found as expressed below:

**NOTE:** Not more than 4 corners, all in the same town and range, may be recorded on this certificate.

A. Description of original monument and accessories and/or subsequent restoration:

1. A Post was set in the original government surveys by Joseph Wampler D.S. in March 1826 with the following witnesses: B Oak 18 N45 1/2 W 71 1/2 (47.2')  
 DO 17 N20 1/2E 99 (65.3')

2. A.P. Drake County Surveyor reported using the corner in a survey dated March 1879 and recorded in Volume 3, Page 143 Ingham County Surveyor's Records with no mention of monument or witnesses.

(Continued on Back)

B. Description of corner evidence found and/or method applied in restoring or reestablishing corner:

Searched at probable location of corner and found the 1/2" bar in monument box matching witnesses in Section A (3) and (9). Excavated bottom of monument box to a depth of 3' and found nothing. A cut section in the road exists at this point and the monument was probably removed in construction. Accepted 1/2" bar as corner because of long usage and with no evidence to the contrary. Replaced very old & corroded 1/2" bar with standard bar & cap. Fences East and West.

Field work conducted by David Clifford, PS No. 25837

C. Description of monument for corner and accessories established to perpetuate locating the position of the corner:

Standard 3/4" x 24" Ingham County Remonumentation Bar & PA 345 Cap #18989 in Monument Box  
 N.E. Corner House Foundation AZ. 290° 120.67'  
 Set Nail & Tag #25837 in west side of 43" Oak AZ. 42° 64.23'  
 Set Nail & Tag #25837 in corner fence post AZ. 90° 34.20'  
 Set Nail & Tag #25837 in Corner fence post AZ 270° 33.50'  
 2 1/2" Concrete Monument AZ 90° 33.20'

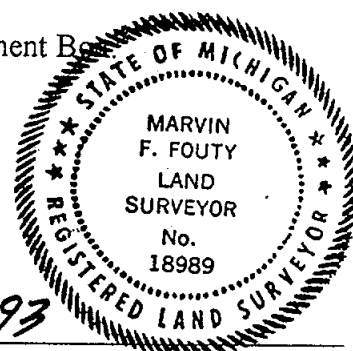

Signed by *Marvin Fouty*  
 Surveyor's Michigan License No. 18989

Date NOV. 19, 1993

FORM APPROVED BY MICHIGAN STATE BOARD OF LAND SURVEYORS, JAN. 28, 1971

REVISED MAY 14, 1975  
REVISED JAN., 1983

P.A. 345 INGHAM COUNTY  
 PEER APPROVED 10/21/93 m

2572

3. Fred White LS #12034 recorded the corner on Nov 11, 1971 in Liber 1 of Corners Page 221 and reported using the corner on September 7, 1971 in Liber 1 of Surveys page 125 and rerecorded with the following witnesses:  
N.E. Corner House foundation N50°W 120.67'  
30" Oak N45°E 64.21'  
Corner Post East 34.17'
4. James Porter LS #19003 reported using the corner on 7/27/73 and recorded in Liber 1 of Surveys Page 1139 Ingham County Records with no mention of monument or witnesses.
5. Ronnie Lester LS # 18998 reported using the corner on 2/4/75 and recorded in Liber 2 of Surveys, Page 317 with the same monument and witnesses as 3 above.
6. Surveyor Steadman LS #11370 reported using the corner on 5/14/76 and recorded in Liber 2 of Surveys Page 712 Ingham County Records and rerecorded on 11/29/76 in Liber 2 Page 495 as a 1/2" rod with the same witnesses as on Fred White's LCRC.
7. Surveyor Lester again reported using the corner in October of 1977 and recorded in Liber 3 of Surveys, Page 83 with witnesses:  
Nail and Tag in West side 27" Elm S35 E 53.72'  
Nail and Tag in South Side wood anchor post N50 E, 40.18'  
centerline 3" iron anchor post west 32.87'
8. Surveyor Steadman again reported using the corner on 12/30/77 and recorded in Liber 2 of Surveys Page 272 with the same monument and witnesses.
9. Surveyor Lester again reported using the corner in June of 1978 and recorded in Liber 3 of Surveys, Page 470 with the same monument and witnesses as in 7 above.
10. Surveyor Lester again reported using the corner in Sept. of 1978 and recorded in Liber 3 of Surveys, Page 723 with the same monument and witnesses as in 7 above.
11. Surveyor David L. Clifford LS #25837 reported using the corner on March 19, 1980 and recorded in Liber 3 of Surveys Page 1210 with no mention of monument or witnesses.
12. Surveyor Steadman again reported using the corner on 8/17/85 and recorded in Liber 4 of surveys page 1242 as a 1/2" bar with no mention of witnesses.
- 13 Surveyor Larry Bryan LS #25832 reported using the corner on July 16, 1990 and recorded in Liber 6 of Surveys Page 81 and used on Survey recorded in Liber 6 of surveys Page 252 as a 1/2" Bar in monument box with the following witnesses:  
Set Nail & Tag in Southeast side 40" Oak, N45°E, 64.23'  
Found Nail & Tag #12034 in North side fence post, East, 34.17'  
Northeast corner house foundation, N50°W 120.67'

FILED

**LAND CORNER RECORDATION CERTIFICATE**  
**Filing Requirement of Act 74, Mich. P.A. 1970**

DEC 3 9 25 AM '93

REGISTER OF DEEDS

INGHAM COUNTY, MICH.

For corners in

INGHAM

(County)

Located In:

Corner Code #

1. Public Land Survey

T 4NR 1EE-3

T \_\_\_\_\_

R \_\_\_\_\_

T \_\_\_\_\_

R \_\_\_\_\_

T \_\_\_\_\_

R \_\_\_\_\_

2. Property Controlling  
in Section

S \_\_\_\_\_

T \_\_\_\_\_

R \_\_\_\_\_

S \_\_\_\_\_

T \_\_\_\_\_

R \_\_\_\_\_

3. Miscellaneous  
Property in Sec.

S \_\_\_\_\_

T \_\_\_\_\_

R \_\_\_\_\_

S \_\_\_\_\_

T \_\_\_\_\_

R \_\_\_\_\_

Register of Deeds Stamp &amp; File Number

4. Lot No. \_\_\_\_\_, Recorded Plat \_\_\_\_\_

5. Private Claims \_\_\_\_\_

I, MARVIN FOUTY, in a field survey on AUGUST 2, 19 93,

do hereby certify that under requirements of P.A. 74, Michigan P.A. of 1970, the corner points mentioned in lines 1 and 2 above were in conformance with regulations and rules therefore as required in the current manual of survey instructions of the United States Department of the Interior, Bureau of Land Management or by a decree of a Court of Law and/or that the corner points mentioned in lines 3, 4 and 5 above were in conformance with the rules of the Michigan Board of Land Surveyors or by a Decree of a Court of Law; established, re-established, monumented, re-monumented, recovered, found as expressed below:

**NOTE: Not more than 4 corners, all in the same town and range, may be recorded on this certificate.**

A. Description of original monument and accessories and/or subsequent restoration:

1. Post set in Original Government Survey by Joseph Wampler D. S. in March 1826 with the following witnesses:  
B. Oak 18 561 1/2W 51 1/2 (34.0')  
W Oak 13 N 61 1/2E 62 1/2 (41.25')

2. County Surveyor A.P. Drake reported using the corner in a survey dated March 1879 and recorded in Volume 2, page 143 County Surveyor's Records as a set stone with no mention of witnesses.

B. Description of corner evidence found and/or method applied in restoring or reestablishing corner:

Searched at probable location of the corner and found a 1/2" bar in a monument box using witnesses from A (6) and (10) above. Excavated the bottom of the monument box and at a depth of 2.5 feet found stone which seems to be lying on side or is flat. Accepted stone as corner as described by A.P. Drake in 1879. Set standard bar & cap in place of 1/2" bar on top of stone. Corner is 2.5 East of centerline Shoeman & 1.5' North of centerline Gulick on fence line to West.

Field work conducted by D. Clifford PS#25837

C. Description of monument for corner and accessories established to perpetuate locating the position of the corner:

Standard 3/4" X 24" Ingham County Remonumentation Bar & PA 345 Cap #18989 in Mon Box.  
Set Nail & Tag #25837 in 29" Hickory AZ 142° 53.85'  
Set Nail & Tag #25837 in Telephone Pole Anchor Post AZ 121° 53.85'  
Centerline 3" Iron Anchor Post AZ, 270°, 32.90'  
Found Nail & Tag #25832 (Bryan) in 11" Hickory AZ 261° 36.95'

Signed by Marvin Fouty Date Nov. 5, 1993Surveyor's Michigan License No. 18989

P.A. 345 INGHAM COUNTY  
 PEER APPROVED 10/05/93

FORM APPROVED BY MICHIGAN STATE BOARD OF LAND SURVEYORS, JAN. 28, 1971  
 REVISED MAY 14, 1975  
 REVISED JAN., 1983

2593

3. Fred White LS #12034 recorded the corner on Nov. 12, 1971 in Liber 1 of corners Page 223 as a Found 1/2" Bar with the following witnesses:  
24" Hickory S35°W 53.78'  
4" Concrete Post West 32.92'  
Street Sign N45°E 36.98'
4. Surveyor White reported using the corner on Sept. 7, 1971 and recorded in Liber 1 of Surveys Page 125 Ingham County Records and rerecorded in October 1972 in Liber 1 Page 681 as a Found 1/2" bar with the same witnesses as on his LCRC.
5. Surveyor Jim Porter LS#19003 reported using the corner on July 27, 1973 and recorded in Liber 1 of Surveys page 1139 Ingham County Records with no mention of monument or witnesses.
6. Surveyor Ron Helsel LS #18994 recorded the corner on Nov. 9, 1973 in Liber 2 of Corners page 539 as a Found 3/4" rebar with the following witnesses:  
N & T W. side 27" Elm S35°E, 53.72';  
N & T S. side wood anchor post Centerline 3" iron anchor post West 32.87'
7. Surveyor Ronnie Lester LS #18998 reported using the corner on March 1, 1974 and recorded in Liber 1 of surveys Page 1184 as a Found 3/4" Bar with the same witnesses as on Surveyor Helsel's LCRC.
8. Surveyor Helsel reported using the corner on March 27, 1974 and recorded in Liber 1 of Surveys Page 1173 with no mention of monument or witnesses.
9. Surveyor White reported using the corner on May 26, 1978 and recorded in Liber 3 of Surveys, page 514 with reference to Surveyor R. Helsel's LCRC.
10. Surveyor David L. Clifford LS #25837 reported using the corner on March 3, 1979 and recorded in Liber 3 of surveys with no mention of monument or witnesses:
11. Surveyor Marvin Fouty LS #18989 reported using the corner on June 28, 1987 and recorded in Liber 5 of surveys Page 575 as a Found 3/4" re-bar with the following witnesses:  
Nail in 27" Elm S35°E, 53.72'  
Nail in anchor post, N50°E, 40.18'  
3" Iron Anchor post, West 32.87'